

HOLYOKE COMMERCIAL BUILDINGS

PHILLIPS COUNTY, COLORADO

NEW LISTING



3.8±
TOTAL ACRES

PHILLIPS COUNTY, CO



Two commercial properties for sale located just east of Holyoke city limits.

For More Information:

Marc Reck, Broker
marcreck@reckagri.com

Ben Gardiner, Broker Assoc.
bgardiner@reckagri.com



Office
970.522.7770
Toll Free
800.748.2589
reckagri.com

Location & Aerial Maps

OVERVIEW

Established buildings with heat, storage, air, office & more! Ideal for any type of storage and/or to run your business out of i.e. farm equipment, truck storage/repair, seed, fertilizer, etc.



SCAN QR WITH YOUR PHONE CAMERA
View more details, photos, an interactive map & more!



Parcel #1



Parcel #2



Parcel Descriptions + Photos

PARCEL #1

- ADDRESS: 315 N Sunflower Dr, Holyoke, CO
- Total Acres: 2.32±
- 90' x 60' shop (5,400 sq ft); insulated, cement floor, overhead radiant heat
- Attached 30' x 30' office (900 sq ft) w/ 4 offices, 2 bath + kitchen
- Add'l 48' x 40' warehouse (1,920 sq ft); insulated, cement floor, parts room + loft
- Commercial well & septic
- R/E Taxes: \$9,730.36 (2024)
- LEGAL: Block 5, Lots 26-34 of the Auskeef Commercial Park, Holyoke, CO

ASKING: \$585,000



PARCEL #2

- ADDRESS: 219 N Sunflower Dr, Holyoke, CO
- Total Acres: 1.55±
- 100' x 60' garage/shop (6,000 sq ft); heated, insulated, cement floor
- R/E Taxes: \$4,293.08 (2024)
- LEGAL: Block 1, Lots 1-6 of the Auskeef Commercial Park, Holyoke, CO

ASKING: \$340,000

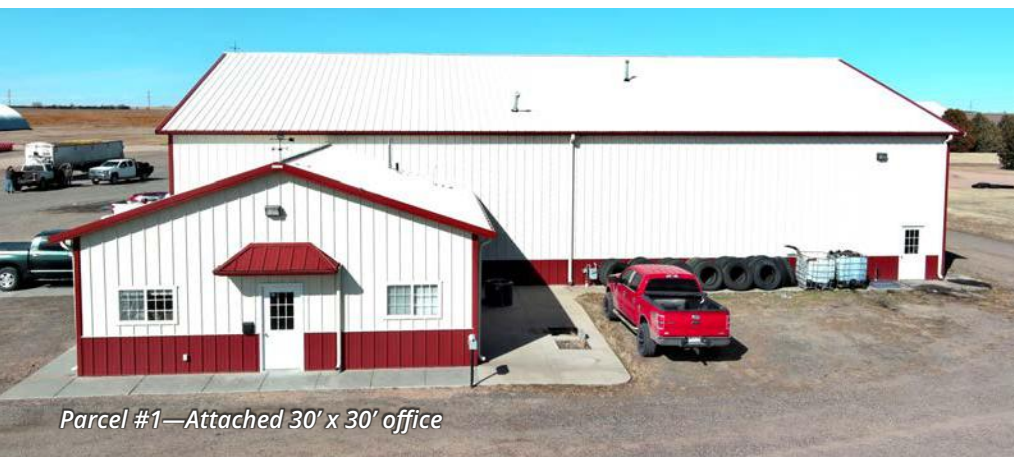

The proof is in the numbers.

We connect buyers and sellers of ag real estate like no one else can - and we have the reputation and relationships to prove it.

929,846

total acres sold

18,674

auction attendees

432

successful auctions

What's inside:

HOLYOKE COMMERCIAL BUILDINGS

2 Parcels

3.8± total acres

NEW LISTING!



Holyoke Commercial Buildings

3.8± Total Acres | 2 Parcels

NEW LISTING



Commercial buildings located just east of the Holyoke, CO city limits being offered for sale in 2 parcels. Can be purchased together or separately.

