



PARC 55

— SAN FRANCISCO —

A HILTON HOTEL

CONFERENCES

& EVENTS



Experience the cosmopolitan charm of San Francisco at Parc 55.

Our location allows access to the city's most vibrant neighborhoods,
each with a distinct personality: Union Square, Mid-Market, Fisherman's

Wharf, North Beach, Chinatown, Japan Town, SOMA and the Mission.

As the setting for your next event, Parc 55 offers countless opportunities for
discovery and adventure.





LOCATION

• • • • •

At Parc 55, guests will find everything they need to savor San Francisco their way. A convenient location near the Moscone Center and Union Square allows business, leisure and group guests easy access to whatever their itinerary might hold as well as easy transportation to and from San Francisco International Airport and Oakland International Airport aboard Bay Area Rapid Transit (BART).

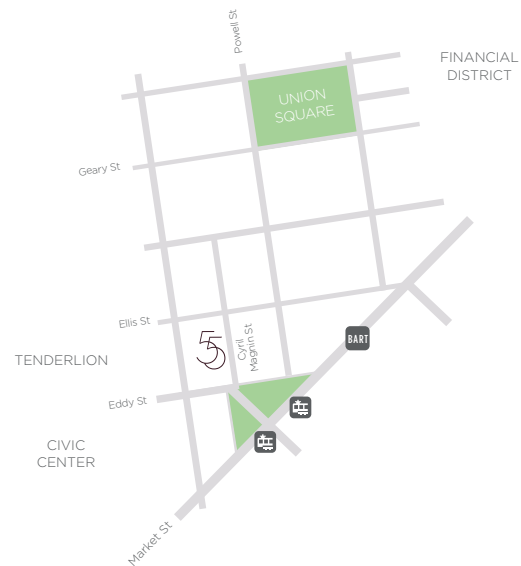



55



AT A GLANCE

• • • • •

When planning an event with Parc 55 San Francisco,
if you can dream it, we can make it a reality.

Combining top-of-the-line amenities and facilities with
a boutique heart, Parc 55 offers personal connections
through thoughtful service and attention to detail.
With over 30,000 square feet of flexible function space,
we cater to the unique needs of groups from 10 to 700.

As part of the Hilton family of hotels, we understand
the importance of quality and consistency, and value
the loyalty of our returning guests. All 23 of our
function rooms are equipped with high-speed wireless
internet access, and the majority feature windows with
views of the city. Our priority is to ensure our guests
fondly remember the experiences and interactions
they had within our walls.



Cyril Magnin Ballroom



Cyril Magnin Foyer



Cyril Magnin Ballroom

LEVEL TWO

MAIN ENTRANCE

CABLE 55

GUEST RECEPTION

HAIGHT

FEDEX

DIVISADERO

SUTRO

	DIMENSIONS	SQUARE FOOTAGE	CEILING HEIGHT	CLASSROOM (3 PER 8')	CLASSROOM (4 PER 8')	CONFERENCE	HOLLOW SQUARE	RECEPTION	ROUNDS	THEATER	U SHAPE
FEDEX	31'x25'	527	8' 10"	-	-	-	-	-	-	-	-
HAIGHT	33'x17'7"	511	8' 10"	12	16	20	20	25	30	40	20
DIVISADERO	23'x38'	792	8' 10"	27	32	24	26	60	50	65	24
SUTRO	40'x28'	1,118	8' 10"	30	40	28	28	80	60	66	28

.....

Elevator

Stairs

Meeting / Conference Rooms

LEVEL THREE

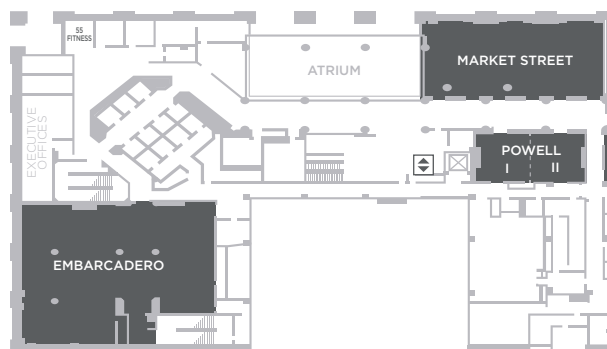

LEVEL FOUR

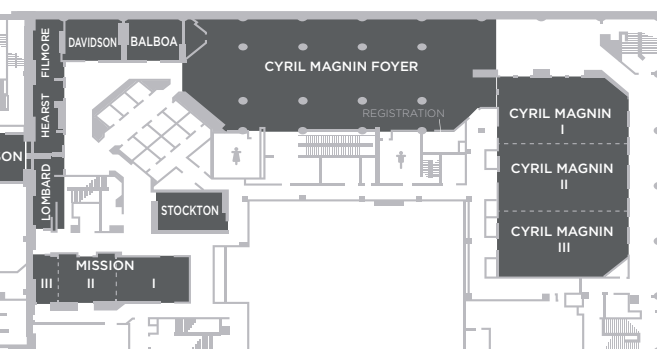

	DIMENSIONS	SQUARE FOOTAGE	CEILING HEIGHT	CLASSROOM (3 PER 8')	CLASSROOM (4 PER 8')	CONFERENCE	HOLLOW SQUARE	RECEPTION	ROUNDS	THEATER	U SHAPE
EMBARCADERO	71'x81'	5,060	8' 10"	160	212	50	60	350	360	300	50
MARKET STREET	40'x74'	2,960	8' 10"	90	120	44	48	250	210	220	40
MASON	25'x24'	600	8' 10"	22	28	20	22	40	40	50	20
POWELL	24'x46'	1,104	8' 10"	36	48	32	40	80	80	120	32
POWELL I	24'x23'	552	8' 10"	24	32	20	22	30	40	60	20
POWELL II	24'x23'	552	8' 10"	24	32	20	22	30	40	60	20

	DIMENSIONS	SQUARE FOOTAGE	CEILING HEIGHT	CLASSROOM (3 PER 8')	CLASSROOM (4 PER 8')	CONFERENCE	HOLLOW SQUARE	RECEPTION	ROUNDS	THEATER	U SHAPE
CYRIL MAGNIN BALLROOM	55'x103'	5,670	12'6"	205	340	100	80	800	440	700	90
CYRIL MAGNIN I	55'x34'	1,890	12'6"	72	104	44	52	300	150	175	46
CYRIL MAGNIN II	55'x35'	1,925	12'6"	72	104	44	52	300	150	175	46
CYRIL MAGNIN III	55'x34'	1,890	12'6"	72	104	44	52	300	150	175	46
CYRIL MAGNIN FOYER*	57'x120'	6,840	8' 10"	-	-	-	-	800	320	-	-
BALBOA	22'x25'	550	8' 10"	21	28	20	22	50	40	45	20
DAVIDSON	22'x25'	550	8' 10"	21	28	20	22	50	40	45	20
FILMORE	19'x31'	589	8' 10"	21	28	24	20	50	40	45	20
HEARST	19'x37'	703	8' 10"	18	24	28	20	60	40	45	20
LOMBARD	13'x37'	518	8' 10"	15	20	24	20	40	30	40	20
STOCKTON	30'x20'	600	8' 10"	24	32	22	22	50	50	30	22
MISSION	24'x71'	1,704	8' 10"	75	100	44	54	200	100	140	46
MISSION I	24'x31'	744	8' 10"	30	40	22	22	75	40	60	22
MISSION II	24'x25'	600	8' 10"	24	32	20	22	50	40	50	20
MISSION III	24'x15'	360	8' 10"	12	16	20	16	24	20	24	20

* Capacities do not include audio visual.
Total square footage of Cyril Magnin Foyer is 7,912 including all surrounding pre-function.

