

# 953 W. BELMONT AVE.

LAKEVIEW, CHICAGO

 **Newcastle**  
INVESTORS

Rarely available retail in Lakeview



KRISTEN L. MARTIN, *Vice President, Retail Leasing*

(312) 252-1418

[kmartin@newcastleinvestors.com](mailto:kmartin@newcastleinvestors.com)

[NEWCASTLEINVESTORS.COM](http://NEWCASTLEINVESTORS.COM)



# MARKET EVOLUTION

- Dynamic, vibrant, 7 day-a-week market
- Dense, affluent surrounding population
- Walking distance to Wrigley Field
- Home to great mix of local, national, small shop and big box retailers

# PROPERTY FEATURES

- Incredible opportunity at Belmont CTA station entrance (2.3M riders from this entrance in 2023)
- 2,393 SF available, call for details
- Existing restaurant infrastructure
- 52 feet of wraparound frontage
- 30,400 vehicles pass the site daily

# AREA DEMOGRAPHICS

MILES	POPULATION	HOUSEHOLD INCOME
0.25	6,207	\$179,680
0.50	24,453	\$184,268
0.75	60,398	\$173,117
1.00	100,483	\$176,360

# AREA RETAILERS



**THE VIC THEATRE**



**CHIPOTLE**



**CHEESIE'S PUB & GRUB**



**ANN SATHER RESTAURANT**

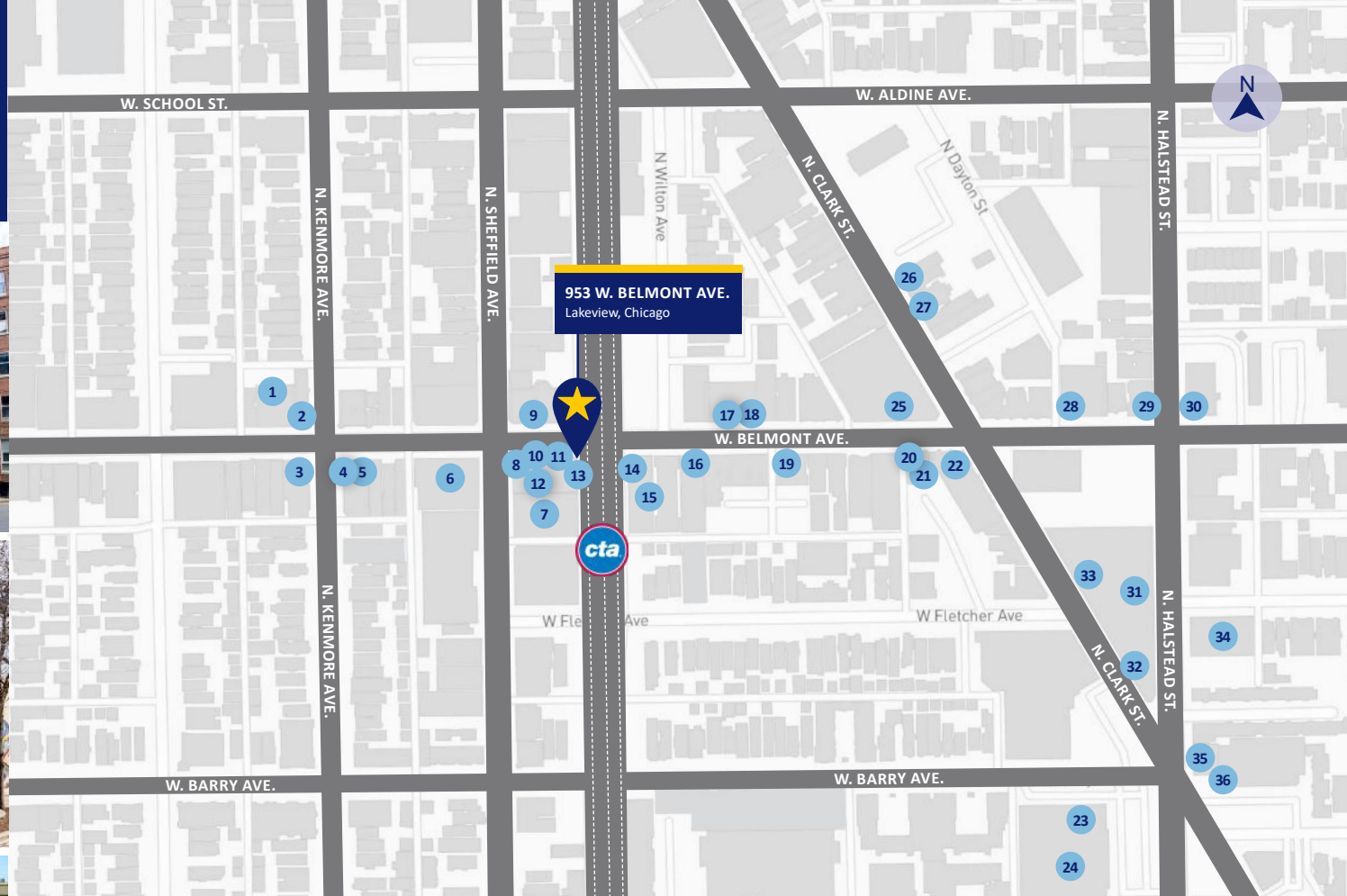

## AREA RETAILER DIRECTORY

- |                         |                             |                           |                          |
|-------------------------|-----------------------------|---------------------------|--------------------------|
| 1. BIG & little's       | 10. Milo's Hair Studio      | 19. Ann Sather Restaurant | 28. Ragstock             |
| 2. Giordano's           | 11. Chicago Bagel Authority | 20. Mixteco               | 29. Furious Spoon        |
| 3. Kriser's Natural Pet | 12. The Barre Code          | 21. Aloha                 | 30. Drew's on Halstead   |
| 4. Chipotle             | 13. Dunkin'                 | 22. Starbucks             | 31. Michaels             |
| 5. Native Foods Cafe    | 14. Pedestrian Coffee       | 23. Walgreens             | 32. DSW                  |
| 6. Western Union        | 15. Devil Dawgs             | 24. PETCO                 | 33. Marshalls            |
| 7. The Vic Theatre      | 16. Reckless Records        | 25. Target                | 34. Briar Street Theatre |
| 8. Dentologie           | 17. Potbelly                | 26. Kanela                | 35. Domino's             |
| 9. Cheesie's Pub & Grub | 18. Taco Bell               | 27. Bánh Mi & Co          | 36. CVS Pharmacy         |

**953 W. BELMONT AVE.** Lakeview, Chicago



N. SHEFFIELD AVE.

N. MILTON AVE.

2,393 SF AVAILABLE

953 W. BELMONT AVE.  
Lakeview, Chicago

CHEESIE'S  
PUB &  
GRUB



W. BELMONT AVE.

Dentologic

MILIOS  
HAIR STUDIO

CBA



DUNKIN'



DAVE'S  
BAGELS

RECKLESS  
RECORDS

WESTERN  
UNION

the  
vic

AERIAL DETAIL

# FLOOR PLAN



W. BELMONT AVENUE

N. SHEFFIELD AVENUE

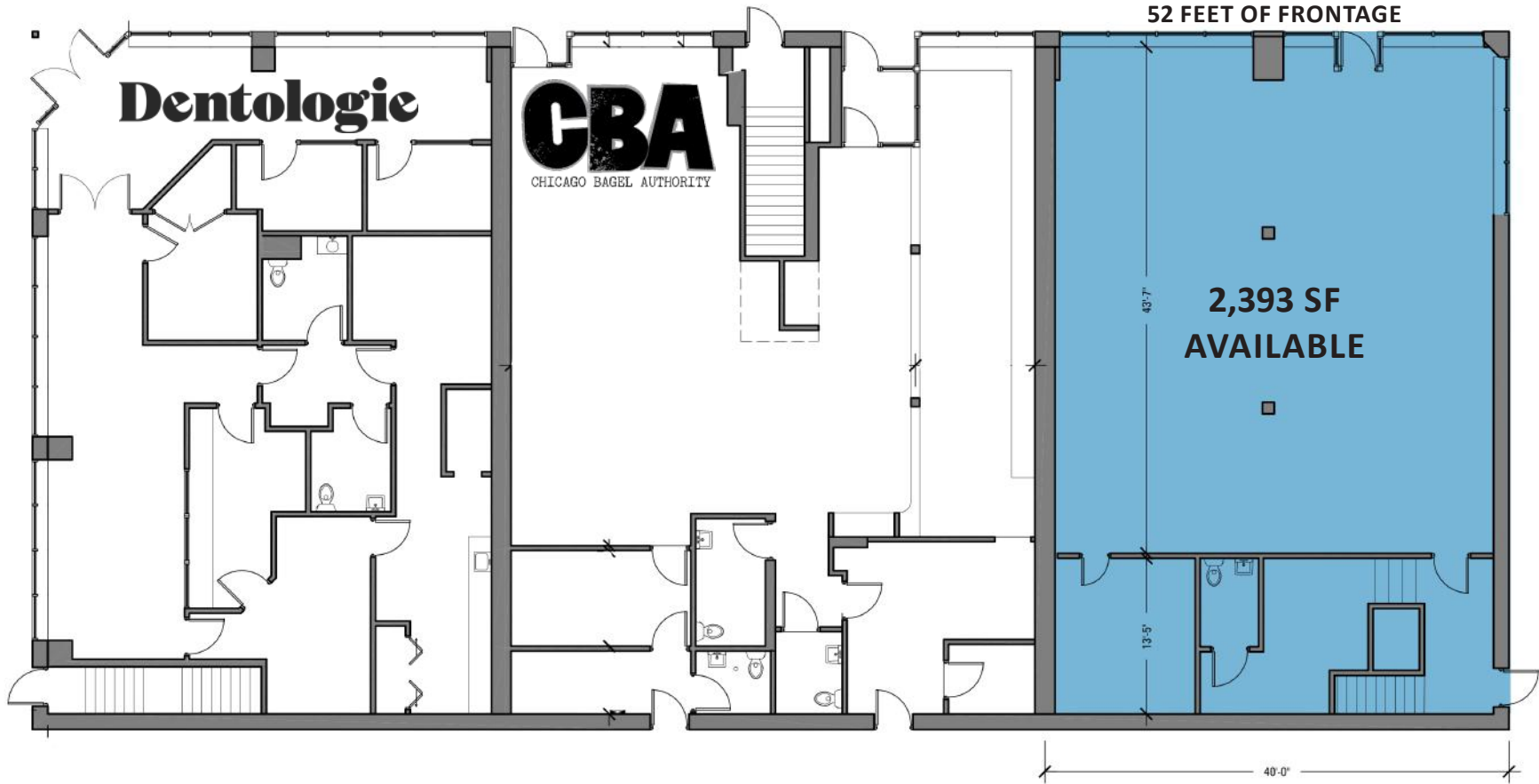

## ABOUT NEWCASTLE RETAIL

**16**

**WALKABLE**  
Neighborhoods

**60+**

**WELL-CAPITALIZED**  
Properties

**600K+**

**SQUARE FEET**  
of Prime Retail Space

**160+**

**NOTABLE**  
Retail Tenants

## FOR MORE INFORMATION

### **KRISTEN L. MARTIN**

Vice President, Retail Leasing

(312) 252-1418

[kmartin@newcastleinvestors.com](mailto:kmartin@newcastleinvestors.com)

### **SAM HERGOTT**

Vice President, Retail Leasing

(312) 252-1452

[shergott@newcastleinvestors.com](mailto:shergott@newcastleinvestors.com)

All information furnished regarding property for sale, rental or financing is from sources deemed reliable, but no warranty or representation is made to the accuracy thereof and same is submitted to errors, omissions, change of price, rental or other conditions prior to sale, lease or financing or withdrawal without notice. No liability of any kind is to be imposed on the broker herein.



**Newcastle**

**INVESTORS**

[NEWCASTLEINVESTORS.COM](http://NEWCASTLEINVESTORS.COM)