



# 2025 PRODUCT CATALOG



# ABOUT US



Since its inception in 1980, **J.Dub's Metalworks** has distinguished itself in proficiently crafting functional, decorative, and architecturally inspired silhouetted images for a diverse clientele encompassing both private and commercial sectors. Specializing in the meticulous creation of decorative balcony panels tailored specifically for deck or loft railings.

Sister Company, **Split Mountain Metals**, established in 2014, is a vibrant enterprise nestled in the picturesque location of Belgrade, Montana. Specializes in local metal artwork, signs, and other custom metalwork, reflecting the unique essence of each individual and their lifestyle. Best known for creating the Capital's Christmas Tree Star in 2017.

Under the astute ownership and management of the **Brenteson Family**—comprised of Brad, Carley, and their daughter Maura—They are dedicated to delivering unparalleled customer satisfaction.

Upholding the values of excellence, precision, and client satisfaction, we remain steadfast in our commitment to collaborating with visionary individuals to bring their unique concepts to life. Through our dedication to innovation, we continuously push the boundaries of conventional metal design, striving to exceed expectations with every project.



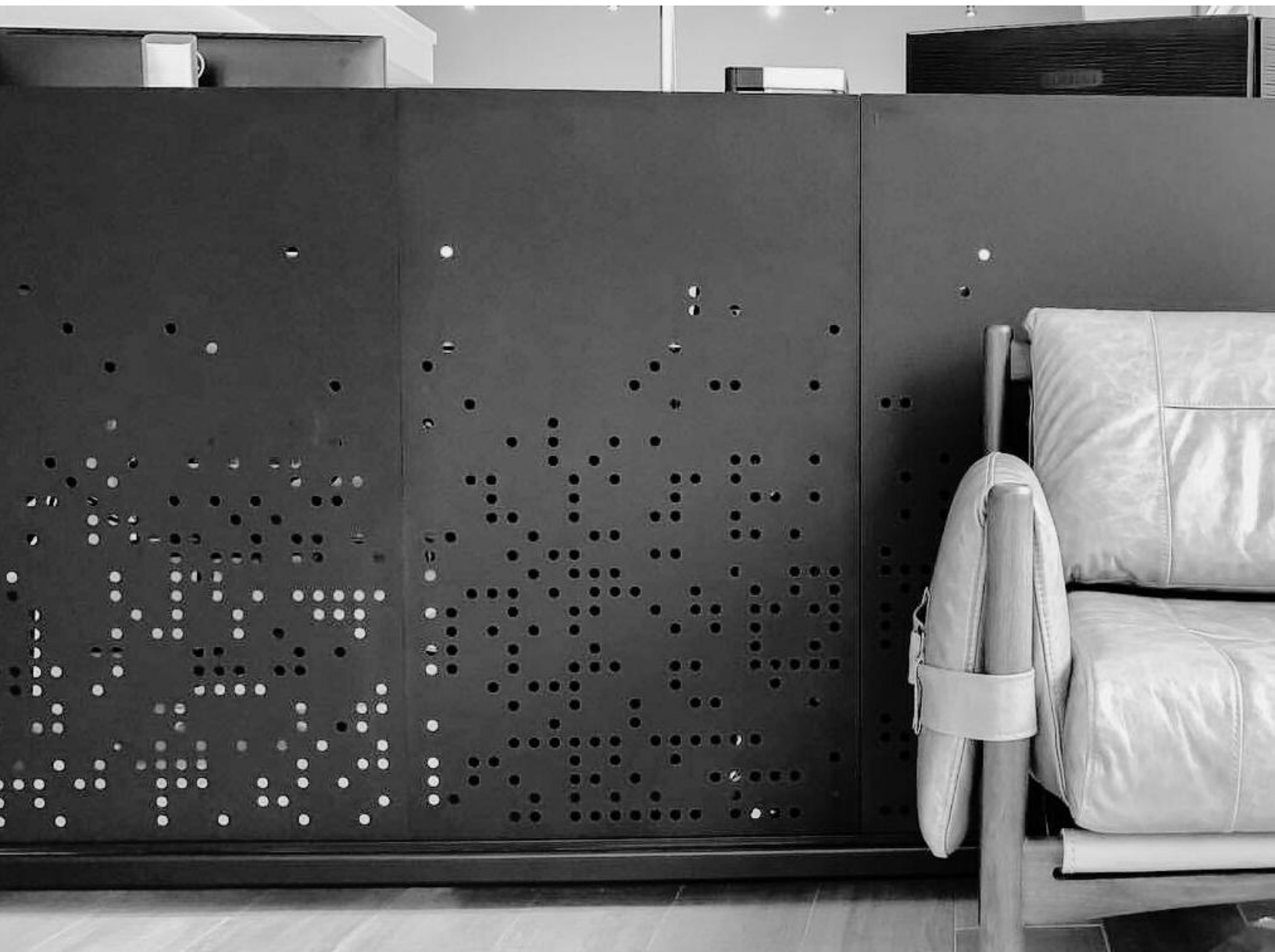

# CONTENTS



**BALCONY PANELS**



**ARCHITECTURAL RAILING**



**CUSTOM SIGNS**



**GATES**



**FIRESCREENS**



**ADDITIONAL PRODUCTS**

# PANEL TYPES



**Flat** balcony panels present the optimal choice for discerning builders seeking expedited turnaround times and cost-efficiency. These panels are designed with an additional 1" margin on each side to seamlessly integrate into grooved posts and rails or accommodate quarter-round framing. Please note that wood framing materials are not provided by J.Dub's.



**Trimmed** balcony panels provide a simplified installation process while still necessitating top and bottom railings. Simply specify the size required for your open space between posts and railings, and we will incorporate a 1.5" x .1875" metal strap around the perimeter with pre-drilled holes for effortless mounting. Please be advised that wood materials for framing are not included by J.Dub's.



**Finished** balcony panels provide the simplest installation solution, eliminating the need for top and bottom rails, trim, or grooving of logs. These panels are furnished with both top and bottom metal railings, side trim featuring pre-drilled holes for mounting, and 4" spacer feet for added stability. Please note that wood materials are not provided by J.Dub's.

# PANEL SIZING

FLAT



TRIMMED



FINISHED





# FLAT PANELS

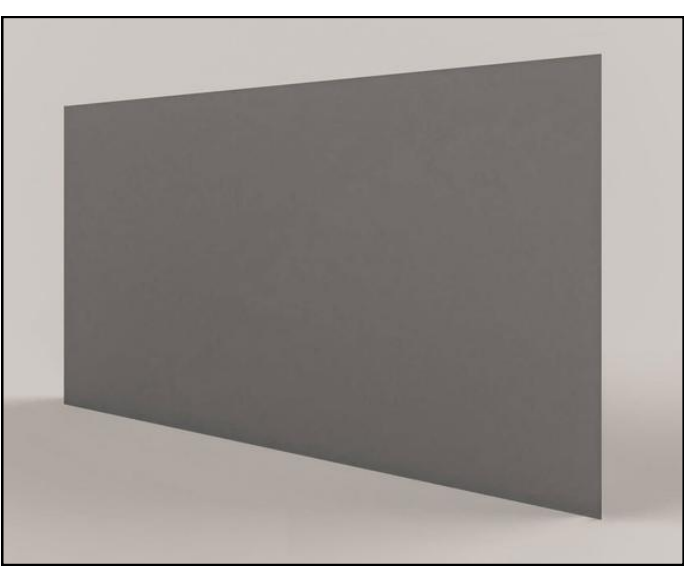
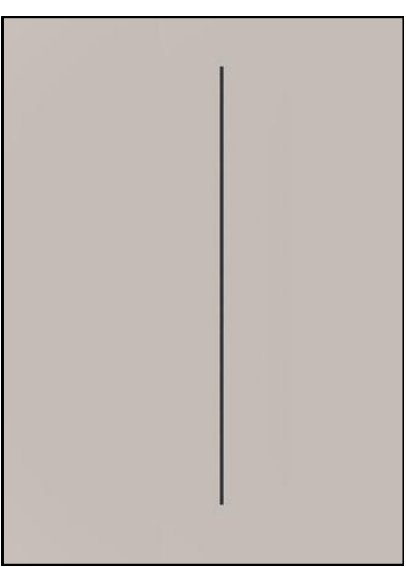
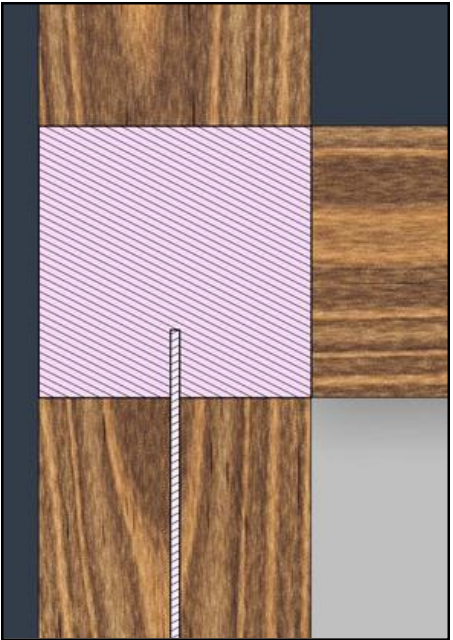



# TRIMMED PANELS

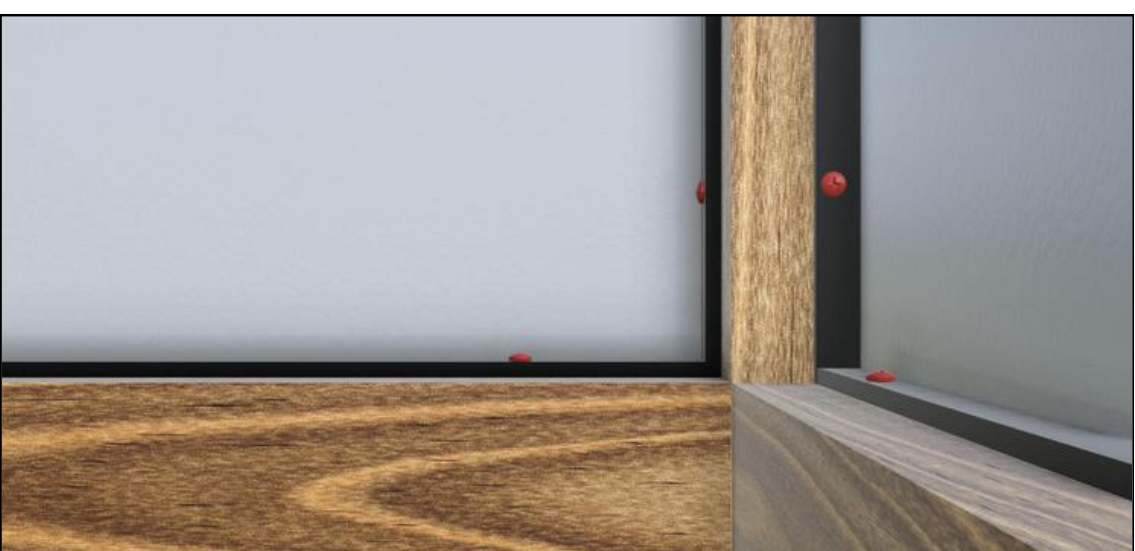
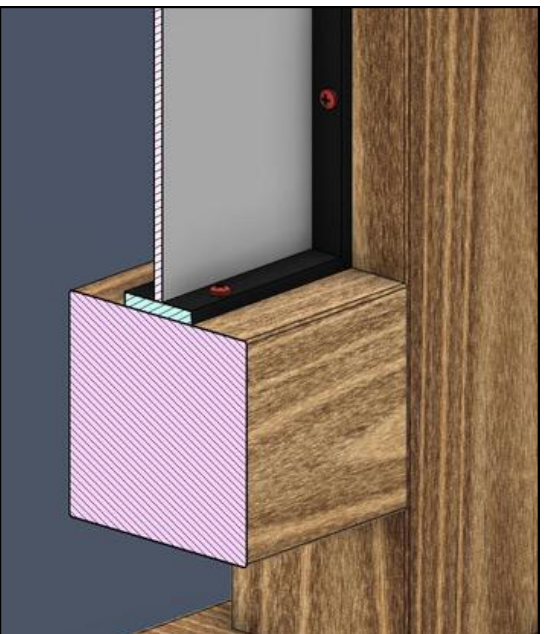
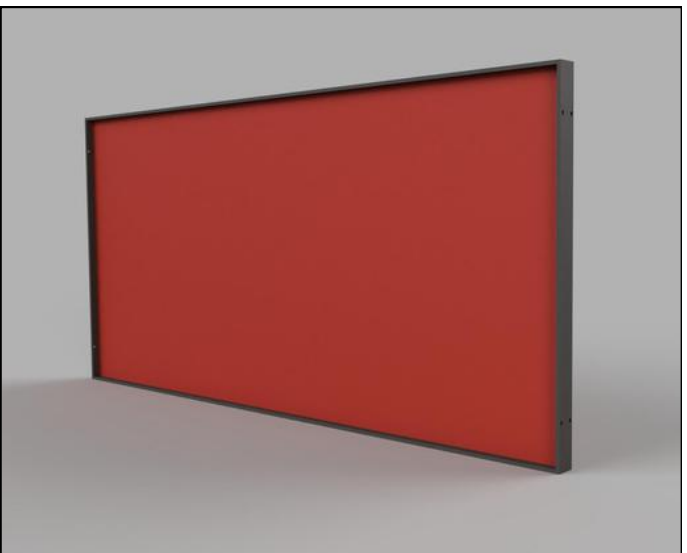
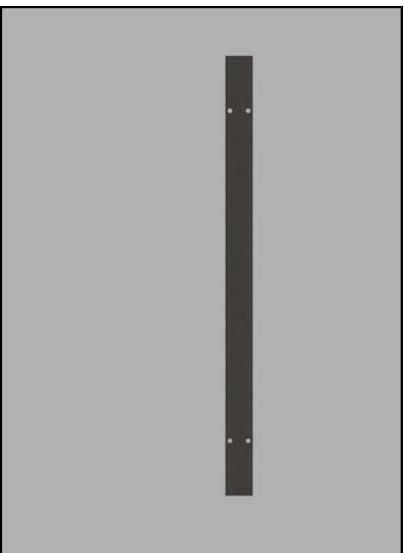

# FINISHED PANELS

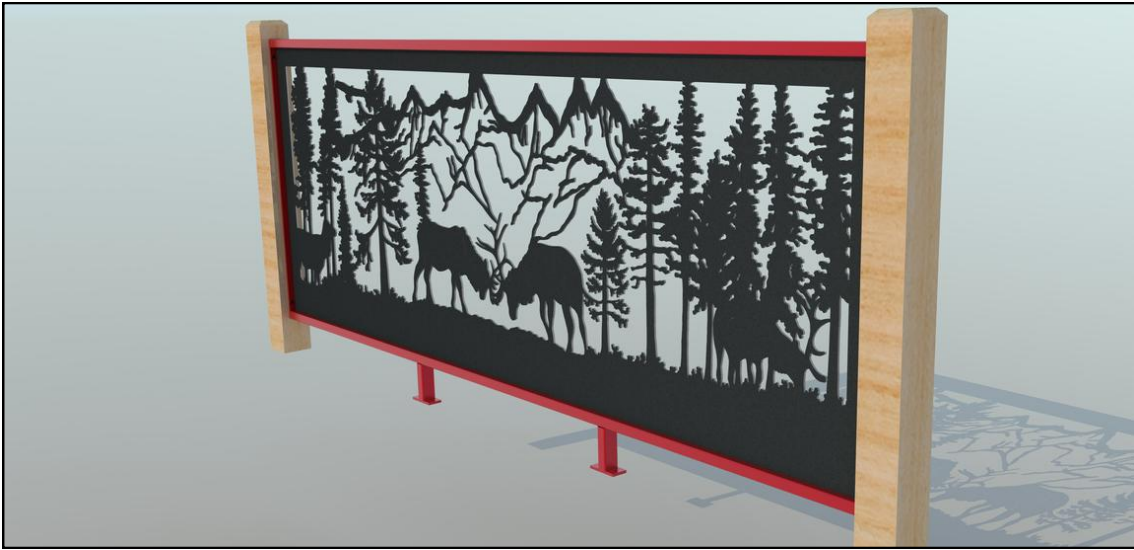
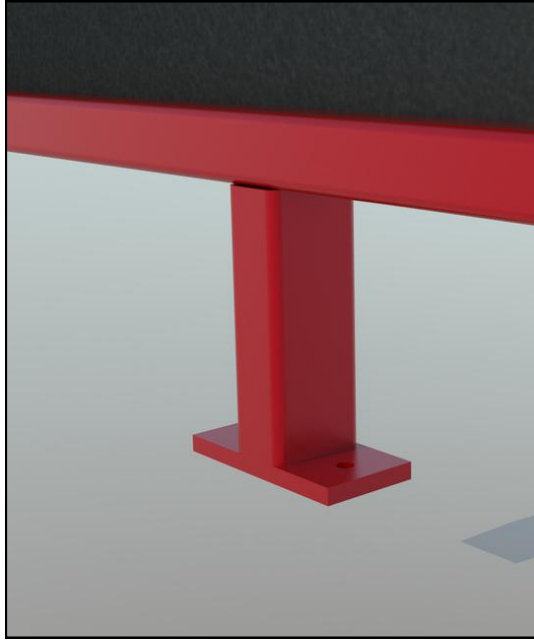
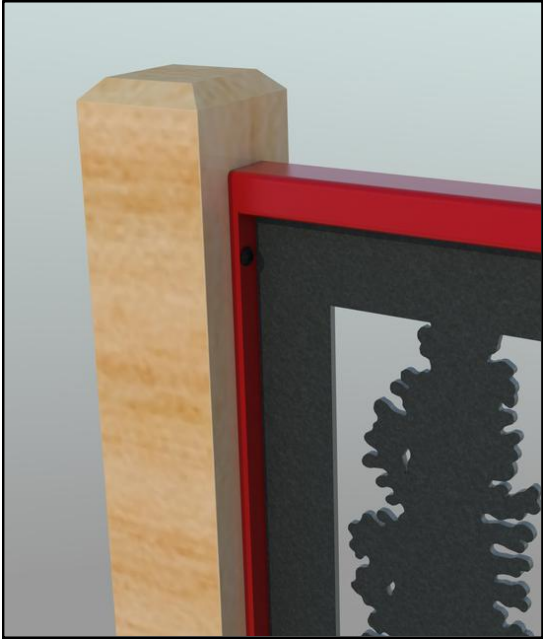
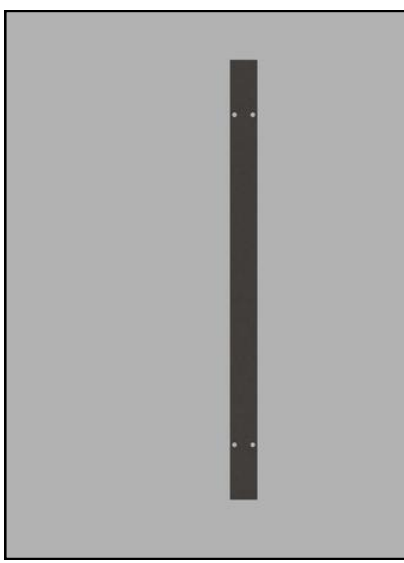
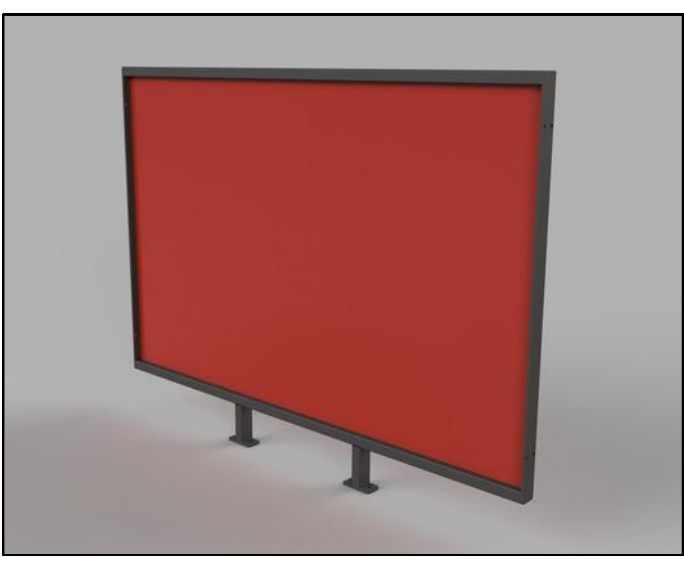



# PANEL PROJECTS





# ARCHITECTURAL RAILING



Seeking a contemporary aesthetic? Look no further than our horizontal and vertical handrails. Crafted from robust 1" x 1" square tubing and finished with a matte black powder coating, these rails are engineered for enduring durability in various weather conditions. Each set includes top and bottom metal railings along with side trim, facilitating easy mounting to steel or wood posts.



# RAILING PROJECTS

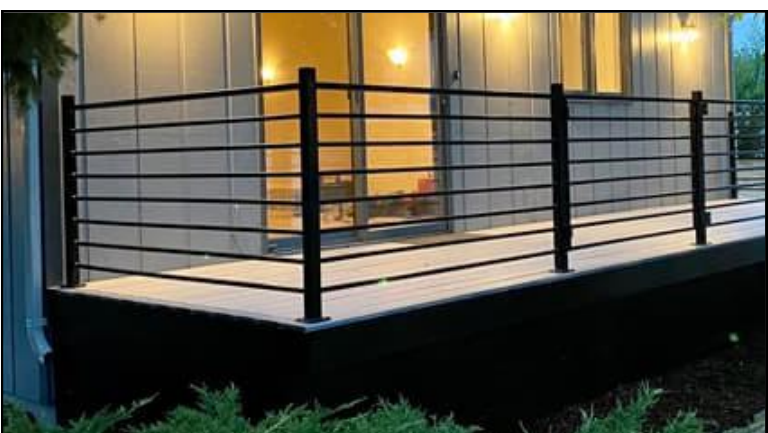
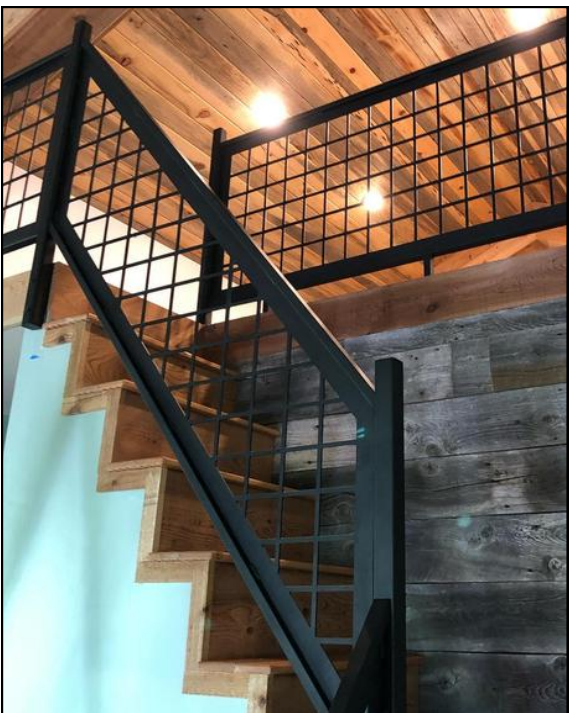



# CUSTOM SIGNS

Our custom signs are expertly crafted from 10 or 12-gauge steel depending on application and coated with a resilient black powder finish, ensuring protection against inclement weather conditions. These versatile signs can be mounted using any preferred method, with hanging signs being our most sought-after option.





# MOUNTING STYLES

FLUSH

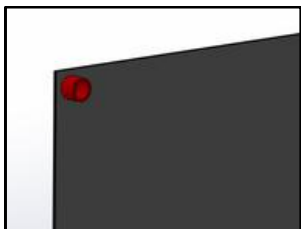
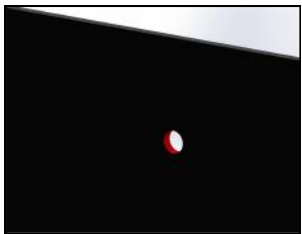
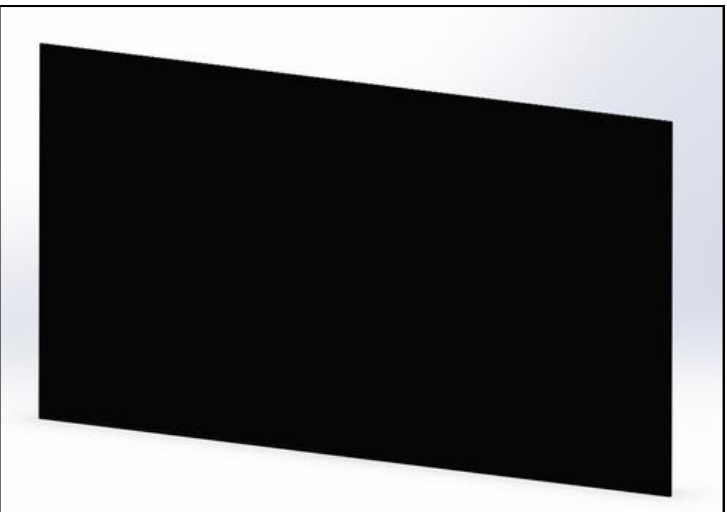

POST MOUNT

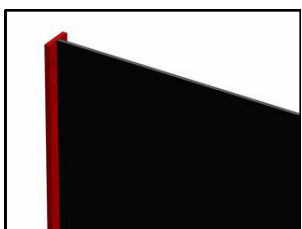
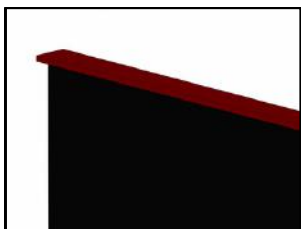
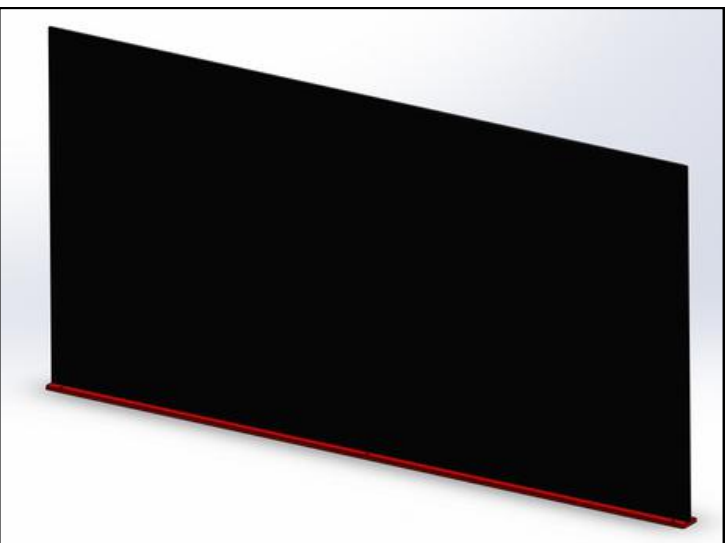

HANGING

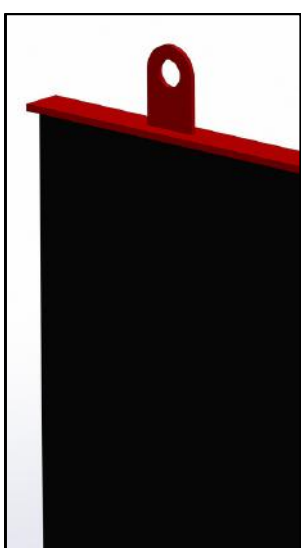
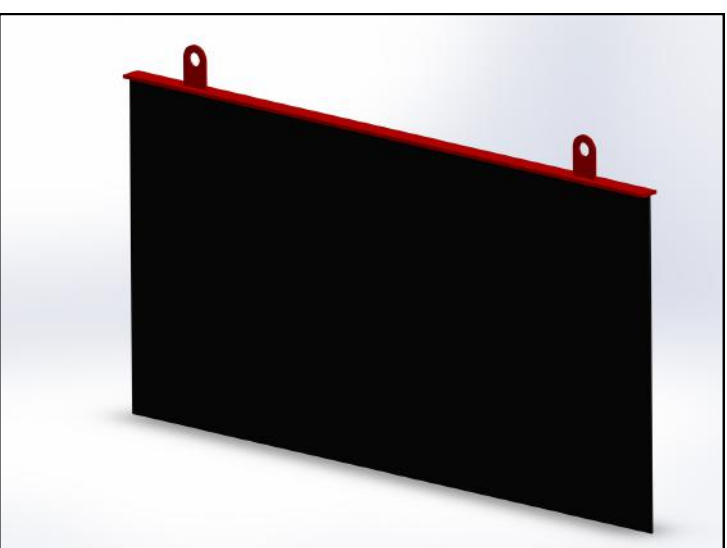





# SIGN PROJECTS

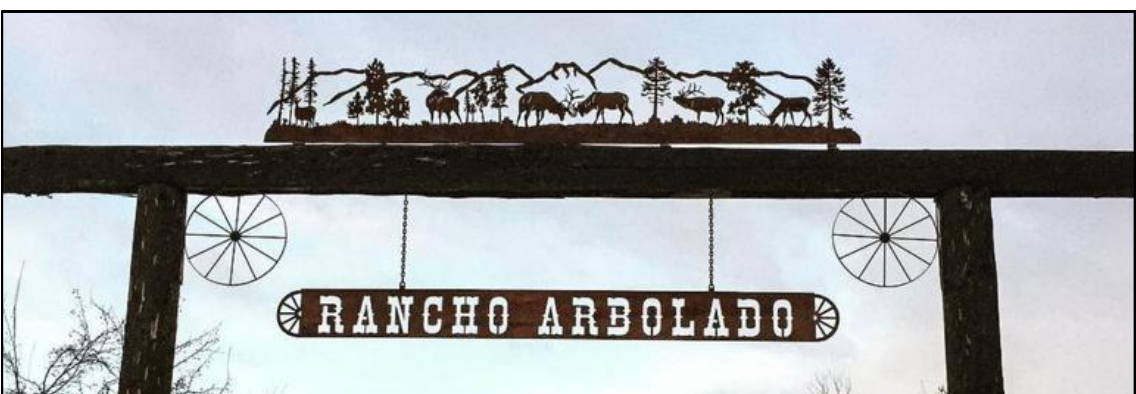
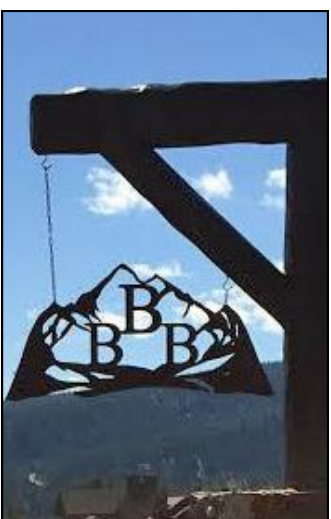



# GATES

Each of our gates is meticulously tailored to your unique space and design preferences. We pride ourselves on crafting 100% customized gates, ensuring that no two are alike. Please don't hesitate to reach out with your ideas, and our team will work closely with you to bring your vision to life. Your satisfaction is our top priority, and we're committed to making your gate dreams a reality.





# GATE PROJECTS





# FIRE SCREENS

Our fire screens are exclusively custom-designed, ensuring that each piece is utterly unique and tailored to your specific preferences. We take pride in crafting fire screens that transcend the ordinary, embodying a style that is truly exceptional. As no two fireplaces are alike, we invite you to share your vision with us so that we can bring it to fruition.





# FIRE SCREEN PROJECTS



# WEATHERVANES

Sustaining the longstanding tradition of the weathervane since its inception as J.Dubs' inaugural product, our offerings encompass both standard designs & one of a kind creations tailored to you. Our mounting solutions include a Peak Mount, affixed to the roof pitch with bolts, or a Cupola Mount.





# WEATHERVANE PROJECTS

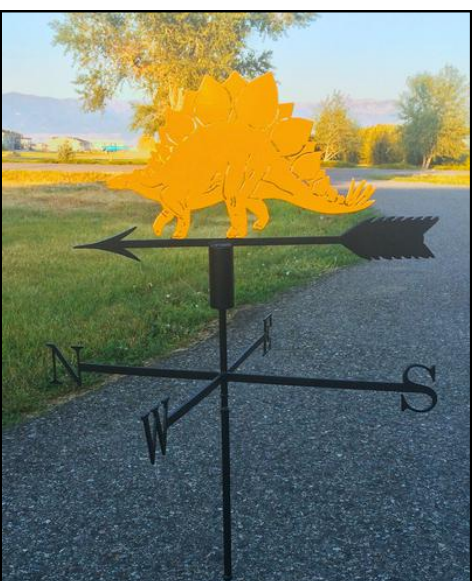



# COAT RACKS

Our selection of coatracks is customizable to suit your preferences, offering both pre-designed options and the flexibility to realize bespoke designs tailored to your vision. Crafted predominantly from 10 or 12-gauge steel, our coatracks boast durability and strength. Choose from an array of hook configurations to meet your specific needs and aesthetic preferences.



# COAT RACK PROJECTS

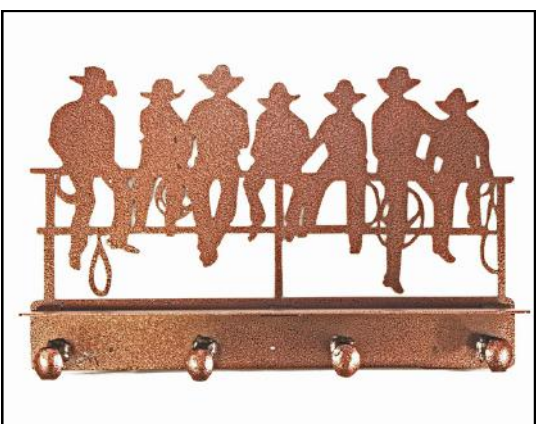
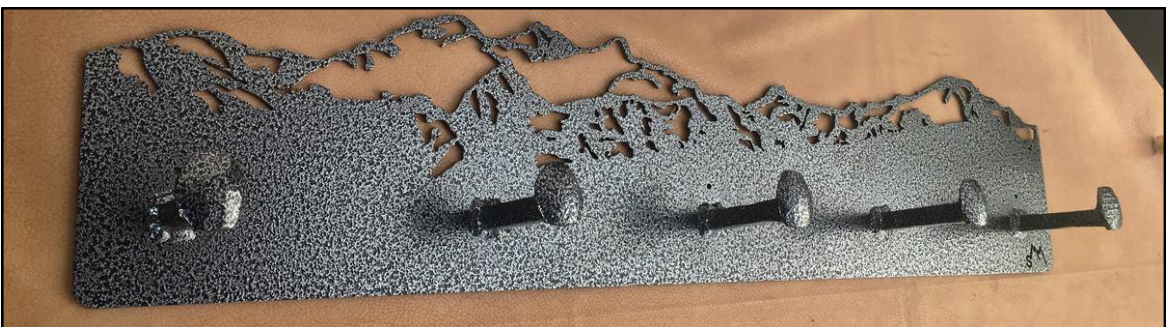



# DOOR PANELS

Our door covers are meticulously crafted utilizing our exclusive image collection. Each cover can be tailor-made to perfectly suit your door dimensions. Constructed from high-quality 10-gauge steel, they stand at a standard height of 6 feet, ensuring both durability and aesthetic appeal.





# DOOR PANEL PROJECTS

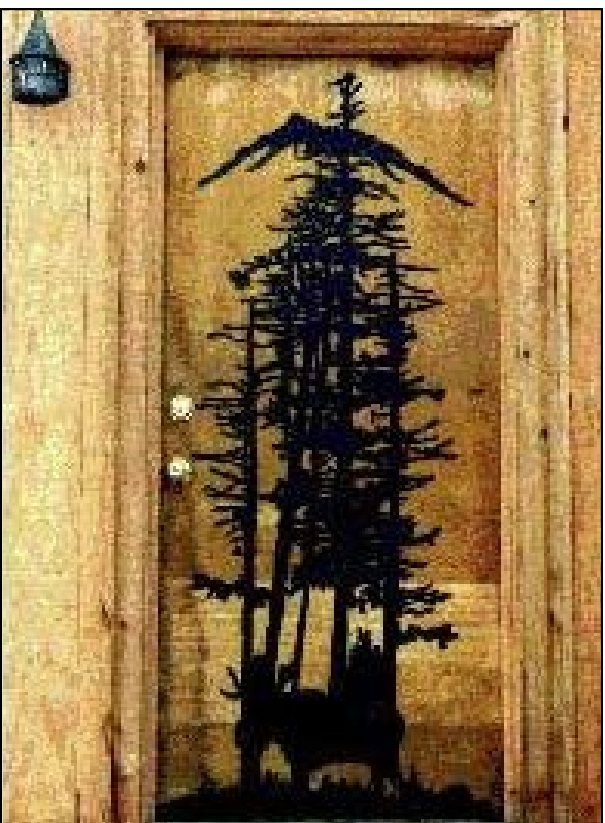

# OTHER PROJECTS









# WHY US



With an unwavering commitment to durability, our panels are meticulously engineered to withstand the rigors of time. Setting us apart from the competition, we prioritize the use of heavy-duty materials to ensure unparalleled quality and longevity. Crafted from 3/16" thick steel—equivalent to three quarters stacked atop one another—our panels boast exceptional strength and resilience.

Similarly, our signs are meticulously fashioned from 10-gauge steel. This substantial thickness guarantees robustness, offering a level of durability that surpasses industry standards. In contrast, competitors often utilize metal that is merely half as thick, compromising on the overall durability of their products.

While our products may exhibit slightly greater weight due to their robust construction, this characteristic serves as a testament to their enduring nature. Rest assured, each item is meticulously engineered to withstand the test of time, promising a lifetime of reliable performance and providing you with a sound investment that endures for generations.



# MOST ASKED QUESTIONS

## **What is your lead time?**

Our current lead time is 4 to 6 weeks from the date of receiving the minimum 50% deposit to the day we ship out your project.

## **Do you do customization for design or mounting styles?**

We have an exceptional in-house design team that can customize the design to your exact specifications. Additionally, our fabrication team is highly skilled and can tailor the mounting style of your projects according to your projects needs.

## **Why do you have an enrollment fee for custom projects?**

We have an \$97 enrollment fee to keep the costs of our panels low while still allowing for full customization of your project. We are proud of our world class design team and want their work to be valued as we rely on them for their artistic expertise.

## **Why do you use thicker material than your competitors?**

We prioritize the longevity and durability of our work, & exceed industry standards. We take pride in delivering superior quality and reliability, ensuring that our customers have long-lasting and robust solutions that outshine the competition!

## **What powder coat colors do you offer?**

As Henry Ford once said, "You can have any color as long as it's black." After years of experience, we have determined that a fine textured matte black powder coat is the most durable option.

## **Do you keep items in stock, that are ready to ship?**

No, we do not keep items in stock. We practice "Just in time manufacturing" due to the large quantity and variations of products we offer.

## **How do I pay?**

We will send you an invoice via our Quickbooks account to pay electronically. We need a minimum deposit of 50% down to put your project in production (after estimate/concept drawing is approved). The remaining balance will be needed prior to the shipment of your product.

## **How do you ship my product?**

We offer Free UPS Shipping to the lower 48 States. For larger Items over a certain length or weight and larger balcony panel projects must be shipped via LTL Freight.

# J.DUB'S METALWORKS PRICE SHEET

Prices noted below are only estimated costs and are subject to change.

An official quote will be provided prior to purchase.

## BALCONY PANELS

COST PER LINEAR FOOT

### FLAT PANELS

SIZE RANGE	24" - 38"
PRICE RANGE	\$225 - \$278
CURRENT SALE	\$169-\$209

### TRIMMED PANELS

SIZE RANGE	24" - 38"
PRICE RANGE	\$255 - \$360
CURRENT SALE	\$190-\$295

### FINISHED PANELS

SIZE RANGE	36"
PRICE RANGE	\$360
CURRENT SALE	\$295

## MODERN RAIL

COST PER LINEAR FOOT

SIZE RANGE	36" & 42"
PRICE RANGE	\$300-\$338
CURRENT 35% OFF SALE	\$195-\$220

## RANCH SIGNS

COST PER SQUARE FOOT USING 10ga STEEL

SQUARE FOOT RANGE	1 - 20 SQ/FT	21 - 30 SQ/FT	31 - 40 SQ/FT
ROUGH COST	\$100	\$85	\$70
CURRENT 25% OFF SALE	\$75	\$64	\$53

\* MATERIAL CAN CHANGE BASED ON SIZE, MOUNTING STYLE, OR PER REQUEST\*



## LINEAR FOOT

Only involves the length of an item.

Divide total number of inches by 12 to convert to feet.

$$60" \div 12" = 5 \text{ LINEAR FEET}$$

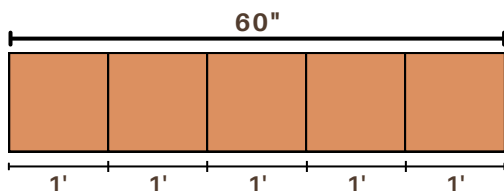

## SQUARE FOOT

Involves the amount of flat space covering an area.

Multiply the length by the width.

Divide total number of inches by 12 to convert to feet.

$$4' \times 2' = 8 \text{ SQUARE FEET}$$

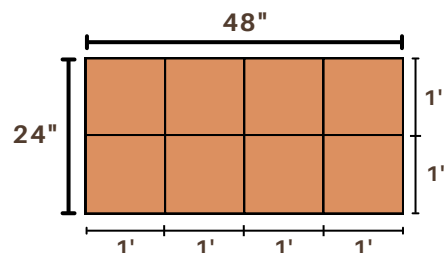

\*\* PRICES ABOVE ARE FOR CUSTOM DESIGNS - SEE OUR WEBSITE FOR STOCK DESIGN PRICING \*\*





MS 7000