



*A guide for
new businesses
in Central
Bedfordshire*

This guide is designed to help businesses new to Central Bedfordshire easily locate the essential registrations and services necessary to operate a business locally. It also provides information on additional services to help you thrive and grow in your new home.

Each new business to the area is given a dedicated account manager within the council to make their relocation or expansion as efficient as possible. To learn more about relocation support, download [Central Bedfordshire: The opportunity for investing businesses](#) or contact our team.

Sustainability Support

We aim to lead by example in our everyday practices, encouraging and supporting our residents and businesses to do likewise. The Council has adopted its [Sustainability Plan 2020-2030](#) which outlines the steps we will take to become carbon neutral by 2030. As a new or existing business in the area, find out how we can support you to adopt sustainable practices. Contact BeGreen@centralbedfordshire.gov.uk or visit www.centralbedfordshire.gov.uk/be-green for more information.



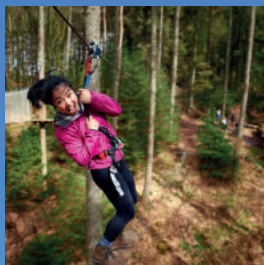

Essential contacts – council services

To learn more about the services listed below visit www.centralbedfordshire.gov.uk and search for the relevant team.



Business rates

Required to register your business premises for business rates (also called nondomestic rates). Visit our webpage to register your Business Rates online.

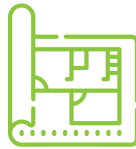

Planning permission

This may be required for any change of use of the property, physical changes to the property, installation of some types of signage for the property (company logo, names, etc). We recommend you consult with landlord first if premises are leased.



Trading Standards

Trading Standards support and encourage businesses by providing advice and information to help businesses comply with the law. This includes product safety, intellectual property, fair trading e.g. product description, age restricted goods, animal welfare, and more.

Staff relocation

If you have staff who are considering relocating their home to Central Bedfordshire, our lifestyle guide is a “must read”. Providing essential information about Central Bedfordshire towns, facilities, schools, quality of life, places to enjoy and more, this guide will give your staff a head start in choosing the right location for them and their families.

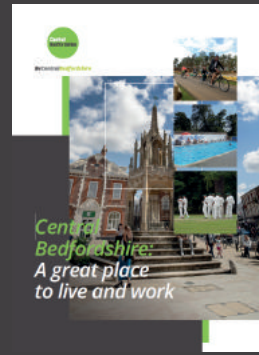

Licensing

Licensing is a requirement for only certain types of businesses. To check if your business activity requires any form of licensing, especially food and hospitality businesses, please check our Licensing webpages.



Commercial waste

We have a duty to collect commercial waste, if requested. However, we advise a company requiring a waste collection service to seek quotes from the private sector as this is invariably the most cost-effective solution. We take an active interest in how commercial waste is collected and disposed of and can require businesses to provide details of the arrangements they have in place.



Health & safety at work

Health & Safety Executive (HSE) and local authorities (LAs) are responsible for enforcing health and safety legislation. Together they ensure that duty holders manage the health and safety of their workforce and those affected by their work.

Essential services – council and partners



SEMLEP Growth Hub

Helping local businesses realise their ambition through free impartial information, advice/guidance and links to grants and other finance programmes.



Chamber of Commerce

Providing access to business support programmes, events and export support to both members and non-members.



Experience Bedfordshire

Providing promotional opportunities and business support to those that rely on visitors and tourism in Bedfordshire.



Federation of Small Businesses

Promoting and protecting the interests of the self-employed and owners of small firms through advocacy and business support provision.

Central Bedfordshire Council provides access to a range of dedicated services for businesses investing, growing or moving into the area, including access to workforce recruitment, education and training solutions, access to local supply chains, business networks and events, specialist advice and more.

To ensure that your business has the best opportunity to thrive and grow, we would like to introduce you to some of these key partner services. More business support partners can be found at www.becentralbedfordshire.co.uk.



Bedfordshire Employment and Skills Academy (BESA)

BESA will provide support for your recruitment plans, including local labour market intelligence. They will lead the partnership between you and the local employment, skills and training sector including apprenticeships programmes and help secure government funding to support training and up-skilling.



Green Business Network

Provides services to help businesses navigate environmental legislation and explore other ways of addressing their impact on the environment.



Bedford College Group

With specialisms including motorsport, agriculture, animal and equine studies, BCG work with over 1300 employers of all sizes to support apprenticeships and employee development.



Cranfield University

Postgraduate research university specialising in science, engineering, design, technology and management. Working closely with world class businesses and SMEs in Knowledge Transfer Partnerships.



Cranfield School of Management

Repeatedly ranking in the Top 10 UK Business Schools. Their Logistics and Supply Chain Management MSc ranked 2nd in the UK and 11th in the QS World University Rankings 2022



University of Bedfordshire

A public research university with campuses in Bedford and Luton, specialising in Creative Arts, Education & Sport, Technology and Health & Social Sciences.



**Central
Bedfordshire**

BeCentralBedfordshire

***Contact us to find out how we can help
your business...***

Tel: +44 (0) 300 300 8272

Email: info@becentralbedfordshire.co.uk

Linkedin: *Be Central Bedfordshire
Economic Growth Partnership*

Twitter: [@BeCentralBeds](https://twitter.com/BeCentralBeds)

Website: www.becentralbedfordshire.co.uk