



ABI
MDF Doors & Mouldings
Catalogue





ABI manufactures high quality primed MDF products including interior doors, baseboards, casings, interior door framing and cosmetic paneling for construction finishing. MDF has no knots, grain or warping and its smooth surface gives way easily to the saw, leaving no splinters, burns, or tear-outs. We proudly produce in Alberta with shipping capability throughout the world.

MOULDINGS

BASEBOARD.....	4
Flat series.....	5
1 X Flat series.....	6
Profiles.....	7

CASING.....	12
Flat series.....	13
Profiles.....	14

HEADER.....	17
--------------------	-----------

URBAN SERIES.....	19
--------------------------	-----------

DOOR JAMB.....	21
-----------------------	-----------

CORNICE & CROWN.....	23
---------------------------------	-----------

OTHER.....	25
-------------------	-----------

DOORS

ABI STANDARD SIZING.....	28
---------------------------------	-----------

SHAKER & BEVEL OPTIONS.....	29
--	-----------

RAISED PANEL OPTIONS.....	30
----------------------------------	-----------

ESSENTIAL COLLECTION.....	31
----------------------------------	-----------

ELEGANT COLLECTION.....	34
--------------------------------	-----------

NOVEL COLLECTION.....	36
------------------------------	-----------

CONTACT US.....	38
------------------------	-----------





BASEBOARD

Baseboards play a vital role in making your home look complete. Baseboard is a trim that covers the lowest part of an interior wall. It serves a purpose in hiding the joint where the walls meet the floor, which might otherwise not be very appealing. A stylish baseboard can have a dramatic impact on the look of your room.

Flat Series

1 X Flat Series

Profiles

*Drawings shown are not to scale, if you have any specific questions about the dimensions or proportions of our mouldings, please do not hesitate to contact us.



15MM



B2333K - 15MM x 3-1/2"

B2333B - 15MM x 5"

B2333D - 15MM x 5-1/2"

B2333R - 15MM x 6"

12MM



B2333F - 12MM x 3"

B2333L - 12MM x 3-1/4"

B2333 - 12MM x 4"

B225 - 12MM x 4" - 1/4" radius

B2333P - 12MM x 4-1/2"

B2333A - 12MM x 5"

B2251 - 12MM x 5" - 1/4" radius

B2333G - 12MM x 5-1/2"

B2333C - 12MM x 6"

B2333H - 12MM x 6-1/2"

B2333E - 12MM x 7"

B2333Q - 12MM x 9-1/8"

9MM



B2333M - 9MM x 3"

B2333N - 9MM x 3-1/2"



1 X 2 - 17MM x 1-1/2"

1 X 3 - 17MM x 2-1/2"

1 X 4 - 17MM x 3-1/2"

1 X 5 - 17MM x 4-1/2"

1 X 6 - 17MM x 5-1/2"

1 X 7 - 17MM x 6-1/2"

1 X 8 - 17MM x 7-1/4"

1 X 10 - 17MM x 9-1/8"

1 X 12 - 17MM x 11-1/4" UNFINISHED

E2E - eased 2 edges

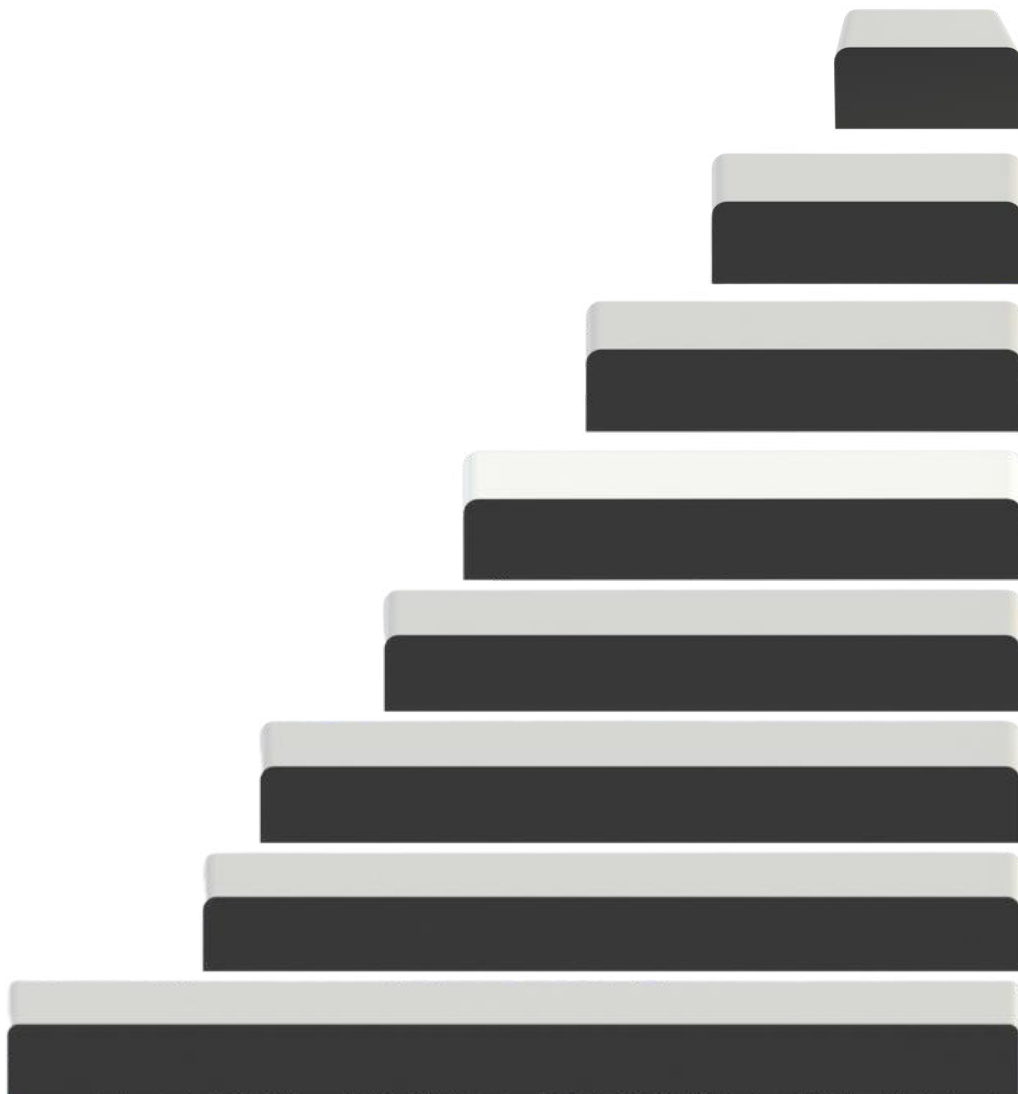

BASEBOARD - 1 X FLAT SERIES



15MM



B2473
15MM x 3-7/8"



B2751
15MM x 4"



B272
15MM x 4-1/8"



B211
15MM x 4-1/4"



B255
15MM x 4-1/4"



B2453
15MM x 5"



B275
15MM x 5"



B2111
15MM x 5-1/4"



B235
15MM x 5-1/4"



B2451
15MM x 5-1/4"



BA100
15MM x 5-1/4"



B2474
15MM x 5-1/2"



B260
15MM x 5-1/2"



B2081
15MM x 6"



B236
15MM x 6"



B288
15MM x 6"



B265
15MM x 6-1/2"



B2651
15MM x 6-1/2"



B2651B
15MM x 9"

12MM



B2055
12MM x 3-1/4"



B228
12MM x 3-1/4"

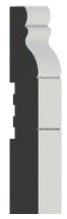

B205
12MM x 3-1/2"



B2127
12MM x 3-1/2"



B2471
12MM x 3-7/8"



B2475
12MM x 4"



B2478
12MM x 4"



B224
12MM x 4"

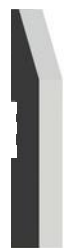

B237
12MM x 4"



B246
12MM x 4"



B2495
12MM x 4"



B261
12MM x 4"



B266
12MM x 4"



B2814
12MM x 4"



B2242
12MM x 5"



B238
12MM x 5"



B26951
12MM x 5"

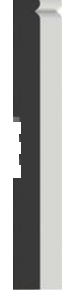

B2241
12MM x 5-1/4"



B2465
12MM x 5-1/2"



B24956
12MM x 6"





Miscellaneous



B256
9MM x 3-1/4"



B257
9MM x 3-1/4"



B2573
9MM x 4-1/4"



B2431
17MM x 8"



B209
3/4" x 4-1/4"



B245
3/4" x 5-1/2"



B243
1" x 8"

There are no
limits to
creativity.

At ABI Mouldings, we take pride in offering a wide range of custom MDF mouldings to meet the unique needs and preferences of our customers. Our custom mouldings are crafted with precision and attention to detail to provide you with a product that exceeds your expectations.

We are committed to providing our customers with the highest quality product and exceptional customer service. Our team is here to help!



CUSTOM



CASING

Casing is the finishing touch to door or window installations. Adding decorative door and window casing is an easy way to compliment any room in your home. They are generally thicker than base mouldings adding a dramatic affect to any room. There are countless styles to choose from, giving customers many options.

Flat Series

Profiles

*Drawings shown are not to scale, if you have any specific questions about the dimensions or proportions of our mouldings, please do not hesitate to contact us.



15MM



- C3333P - 15MM x 2"
- C3333J - 15MM x 2-1/2"
- C3333G - 15MM x 3"
- C325 - 15MM x 3" - 1/4" radius
- C3333B - 15MM x 3-1/2"
- C3333H - 15MM x 4"

12MM



- C3333 - 12MM x 1-1/2"
- C3333K - 12MM x 2-1/4"
- C3333D - 12MM x 2-1/2"
- C3333A - 12MM x 3-1/2"

9MM and 3/4"



- C3333M - 9MM x 2-1/4"
- C3333E - 3/4" x 2-1/2"
- C3333F - 3/4" x 3"
- C3333C - 3/4" x 3-1/2"

15MM



C328
15MM x 2-1/4"



C3471
15MM x 2-1/2"



C3472
15MM x 2-1/2"



C3731
15MM x 2-1/2"



C375
15MM x 2-1/2"



C3124
15MM x 2-3/4"



C373
15MM x 2-7/8"



C3112
15MM x 3"



C324
15MM x 3"



C326
15MM x 3"



C337
15MM x 3"



C338
15MM x 3"



C3435
15MM x 3"



C346
15MM x 3"



C3477
15MM x 3"



C3495
15MM x 3"



C366
15MM x 3"



C335
15MM x 3-1/4"



C3695
15MM x 3-1/4"



C372
15MM x 3-1/4"



C3751
15MM x 3-1/4"



C3461
15MM x 3-1/2"



12MM and 9MM



C3055
12MM x 2-1/2"



C305
12MM x 2-3/4"



C3125
12MM x 2-3/4"



C302
9MM x 2-1/4"



C356
9MM x 2-1/4"



C357
9MM x 2-1/4"

17MM, 3/4" and 1"



C3474
17MM x 3-1/2"



C309
3/4" x 2-5/8"



C3473
3/4" x 2-3/4"



C311
3/4" x 3"



C388
3/4" x 3"



C316
3/4" x 3-1/4"



C317
3/4" x 3-1/4"



C360
3/4" x 3-1/2"



C345
3/4" x 3-1/2"



C365
3/4" x 3-1/2"



CA100
3/4" x 3-1/2"



C314
3/4" x 3-3/4"



C370
3/4" x 3-3/4"



C3081
3/4" x 4"



C343
1" x 3-1/4"



C3431
1" x 3-3/4"

HEADER

A header is a type of decorative trim or moulding that is typically installed at the top of a door or window frame, or as a decorative element above cabinetry or built-in shelves. Its purpose is to provide a finished look to the opening and to add architectural interest to the space.

They come in a wide range of styles and designs, from simple and understated to ornate and highly detailed.

Header mouldings are a stylish way to add interest and architectural detail to a room, while also providing a finished look to doors, windows, and cabinetry.

*Drawings shown are not to scale, if you have any specific questions about the dimensions or proportions of our mouldings, please do not hesitate to contact us.



H8384
1" x 4"



H8385
1" x 5"



H8386
1" x 6"



H393
1-1/4" x 3-3/4"



H392
1-1/4" x 3-3/4"



H390
1-1/4" x 4-3/16"



H391
1-1/4" x 5-1/4"



H3928
1-1/4" x 5-1/2"

URBAN SERIES

Our NEW Urban Series adds visual interest and texture to walls and ceilings, creating a more dynamic and layered look in a room. It's versatility allows it to be used in a variety of settings, from living rooms and bedrooms to bathrooms and kitchens. It is easy to install and can be done by a skilled DIYer or a professional carpenter. This makes it an accessible option for homeowners who want to upgrade their interiors. Overall, Urban Series mouldings are a great way to add character and charm to any interior space.

*Drawings shown are not to scale, if you have any specific questions about the dimensions or proportions of our mouldings, please do not hesitate to contact us.



1/4"
GAP

U100
12MM x 5-1/2"



1/4"
GAP

U101
12MM x 7-1/4"



1/8"
GAP

U102
12MM x 5-1/2"



1/8"
GAP

U103
12MM x 7-1/4"



U800
9MM x 5-3/4"



U8876
9MM x 6-1/4"



U200
17MM x 5-1/2"



U201
17MM x 5-1/2"



1"
SLAT
3/8"
GAP

U202
17MM x 7-1/8"



1"
SLAT
1/2"
GAP

U203
17MM x 7-1/2"



2-1/4"
SLAT
3/8"
GAP

U204
17MM x 8-1/8"

URBAN SERIES

DOOR JAMB

A door jamb is the vertical portion of a door frame that surrounds and supports the door. It consists of two upright pieces, one on each side of the door, and a horizontal piece, called the header, that connects the two uprights at the top.

Flat Jamb

Rabbeted Jamb

Door Stop

*Drawings shown are not to scale, if you have any specific questions about the dimensions or proportions of our mouldings, please do not hesitate to contact us.





Flat Jamb

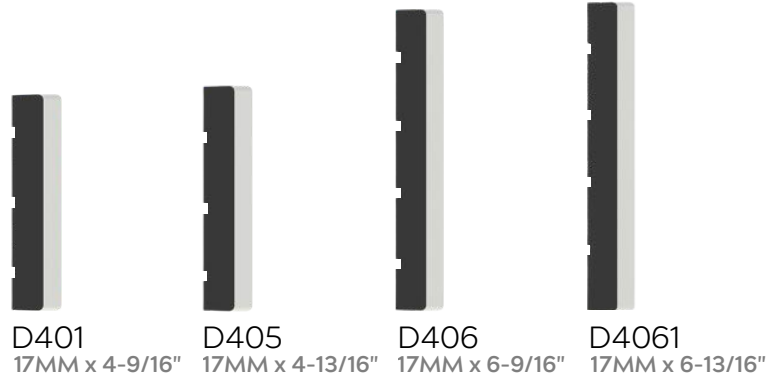

Rabbeted Jamb

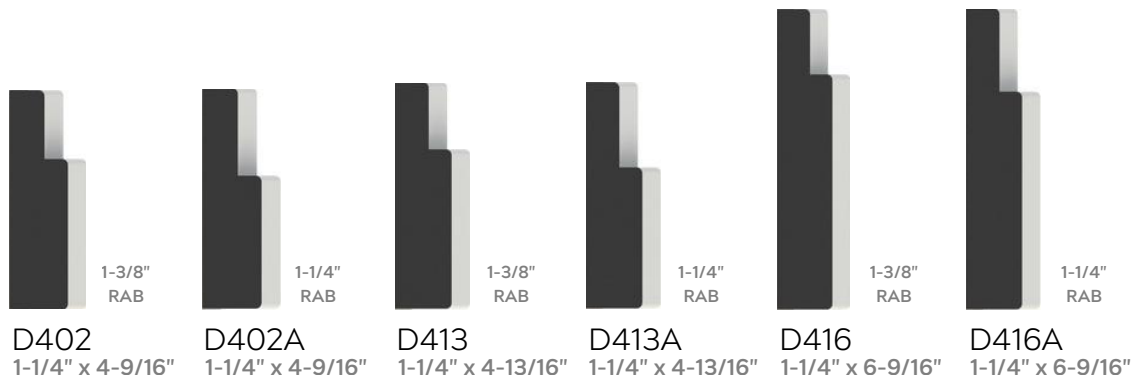

Door Stop

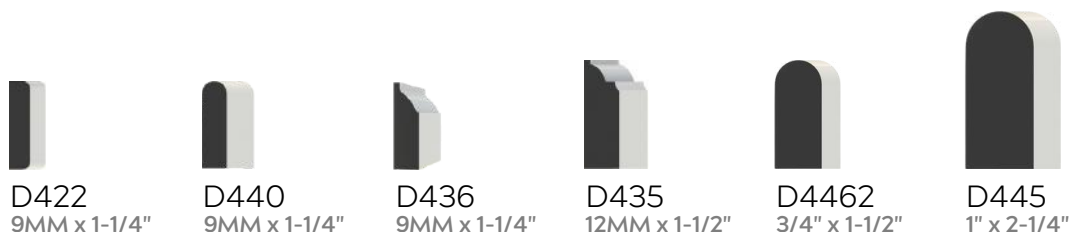

CORNICE & CROWN

Cornice and crown moulding are two types of decorative trim used to enhance the appearance of a room or building.

They can be used to conceal the joint between the wall and ceiling, add visual interest to a room, and create a sense of height and grandeur.

While cornice and crown moulding are similar in purpose and design, they are typically used in different areas of a room. Both types of moulding can add elegance and sophistication to a space, and the choice between the two will depend on the specific design goals and aesthetic preferences of the homeowner or designer.

*Drawings shown are not to scale, if you have any specific questions about the dimensions or proportions of our mouldings, please do not hesitate to contact us.

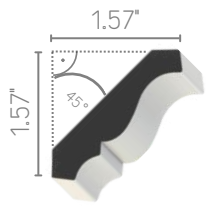

E570
12MM x 2-1/4"

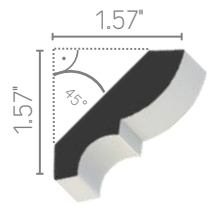

E572
12MM x 2-1/4"

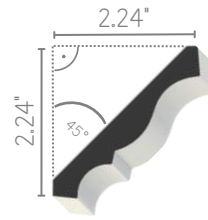

E573
12MM x 3-1/4"

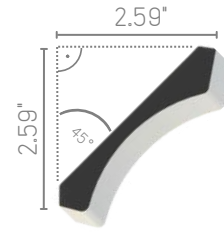

E5898
17MM x 3-3/4"

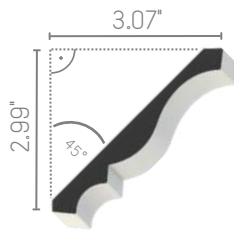

E574
12MM x 4-1/4"

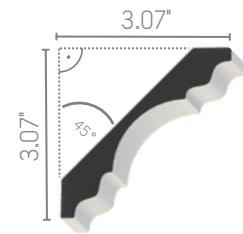

E583
17MM x 4-3/8"

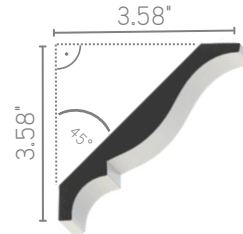

E575
17MM x 5"

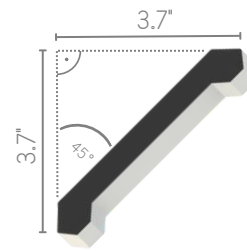

E561
3/4\" x 5-1/8"

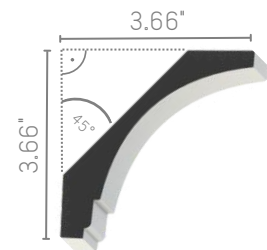

E560
1-1/4\" x 5-1/4"

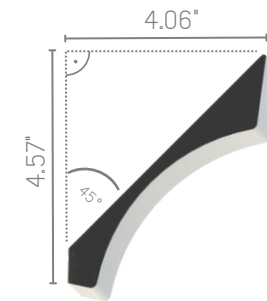

E565
1\" x 6"

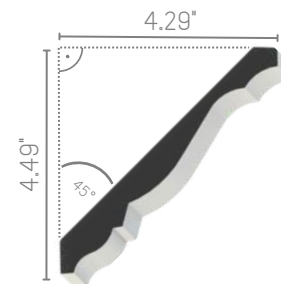

E576
17MM x 6-1/8"



F642
12MM x 11/16"



F646
3/4\" x 1-1/4"



F649
1-1/8\" x 1-7/8"



F648
1-1/4\" x 2-1/2"



OTHER

Astragals

Chair Rails

Half & Quarter Rounds

Plinths



*Drawings shown are not to scale, if you have any specific questions about the dimensions or proportions of our mouldings, please do not hesitate to contact us.



H840
1" x 1-1/2"

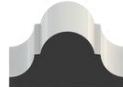

A115
3/4" x 1-1/2"



A119
12MM x 1-1/2"



A122
17MM x 1-5/8"



A190
3/4" x 3"



A128
3/4" x 1-1/2"



A126
9MM x 3/4"



F606
3/4" x 3/4"



P940
1" x 8" x 20"



P941
1" x 8" x 20"



P942
1" x 8" x 20"



P945
1" x 8" x 20"

Plinth blocks also available in 3/4" thickness.

MDF DOORS



ABI Standard Sizing

Shaker & Bevel Options

Raised Panel Options

Essential Collection

Elegant Collection

Novel Collection

*Drawings shown are not to scale, if you have any specific questions about the dimensions or proportions of our mouldings, please do not hesitate to contact us.

ABI STANDARD SIZING

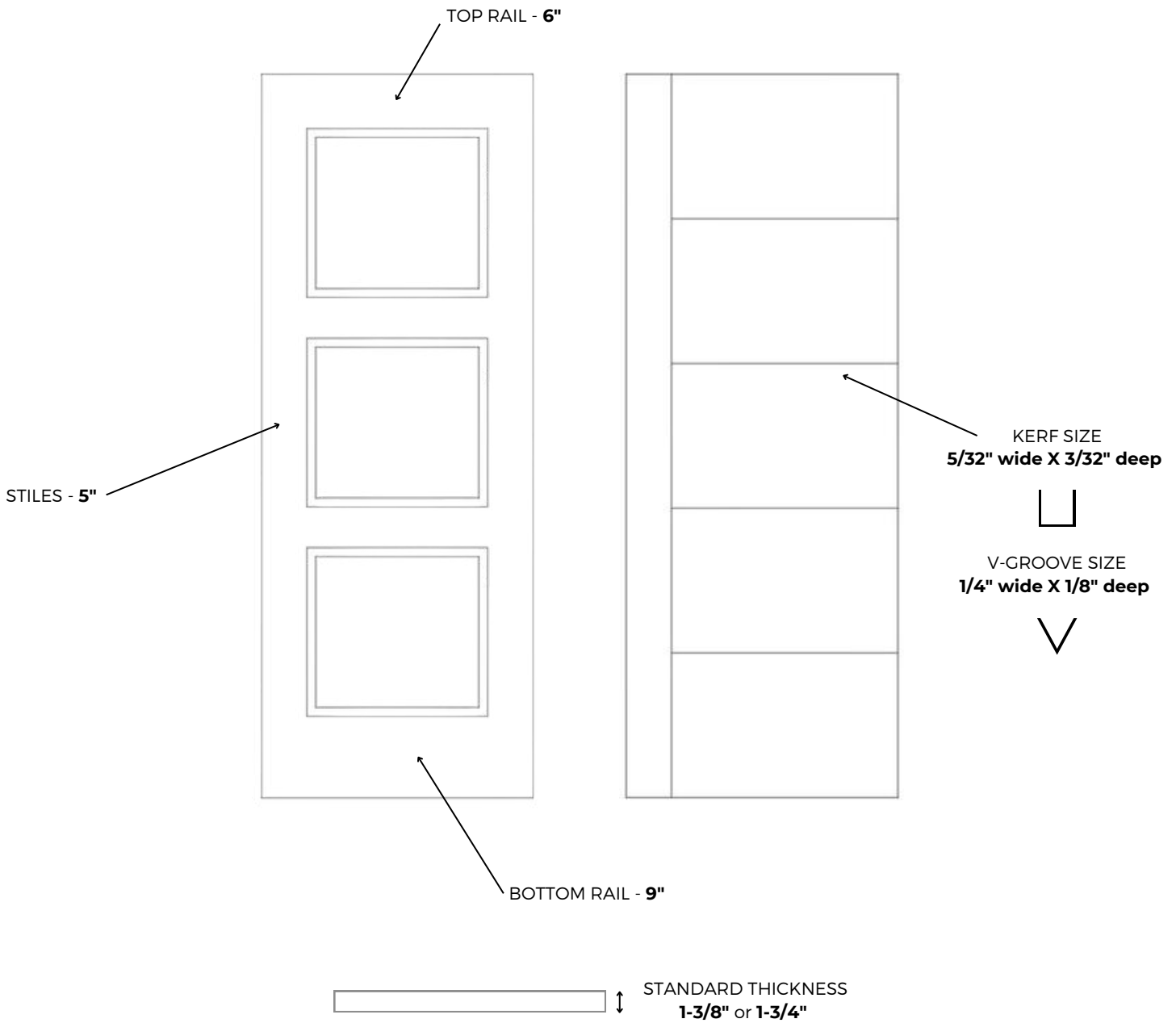

NOTES

Standard thickness: 1-3/8" or 1-3/4"

Kerf cut: 5/32" wide X 3/32" deep

V-groove: 1/4" wide X 1/8" deep

Standard dimensions for stiles are 5", top rail is 6" and bottom rail is 9".

Customization of our doors is available (restrictions may apply). Please consult with our representative for more information.



SHAKER OPTIONS

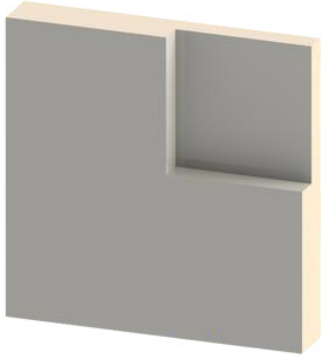

S STANDARD



2S 2 STEP (1")

BEVEL OPTIONS

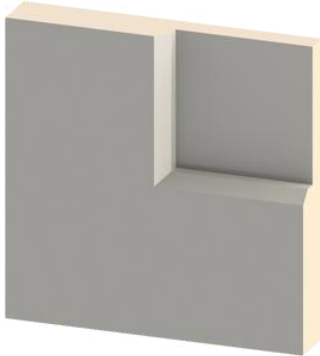

HALF

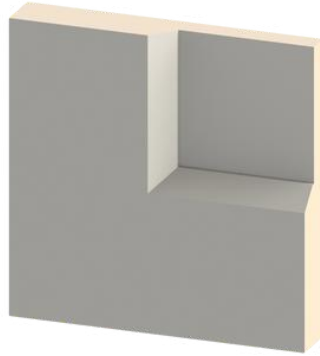

FULL



DOUBLE



RAISED PANEL OPTIONS

STANDARD:

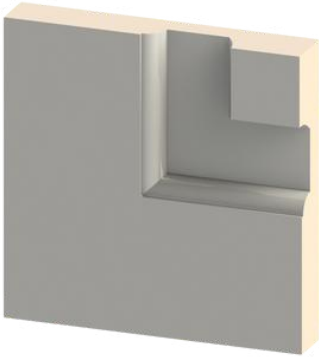

A CRESCENT

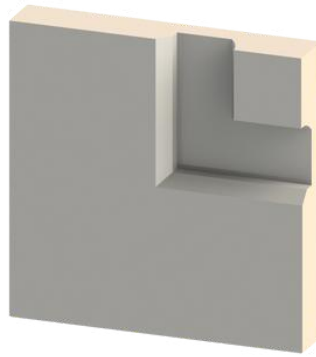

B VISTA

CHOOSE YOUR STYLE:

Selecting the perfect raised panel design is an expression of your personal style. Whether you lean towards classic charm, modern minimalism, or intricate details, our collection has the ideal door to complement your vision.

[Contact us to discuss customization options.](#)

PREMIUM:

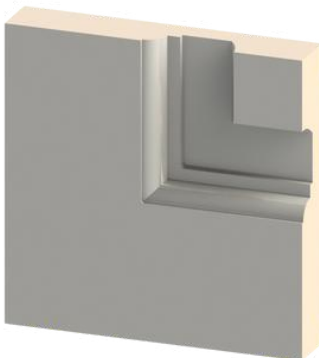

C CASCADE
(minimum thickness 1-3/4")



D HARMONY

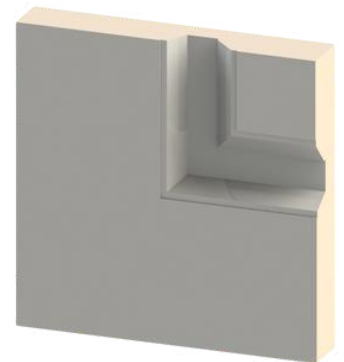

E RIVER SIDE

PREMIUM PLUS:

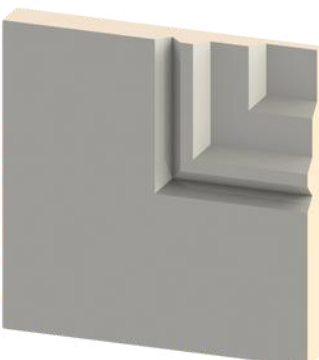

F ASTRA

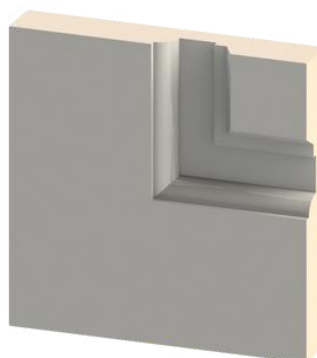

G OLYMPIC



ESSENTIAL COLLECTION

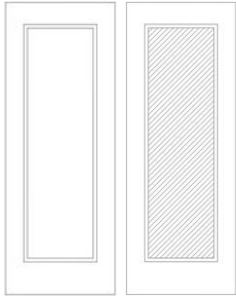

EDEN	options:	glass:	width:	height:
shaker door	*S or 2S	AVAILABLE	16"-48"	80"-96"
bevelled door	*HALF or FULL or DOUBLE	AVAILABLE	16"-48"	80"-96"
raised panel door	**AVAILABLE	N/A	20"-48"	80"-96"

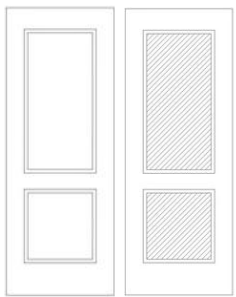

BRIDGLAND	options:	glass:	width:	height:
shaker door	*S or 2S	AVAILABLE	16"-48"	80"-96"
bevelled door	*HALF or FULL or DOUBLE	AVAILABLE	16"-48"	80"-96"
raised panel door	**AVAILABLE	N/A	20"-48"	80"-96"

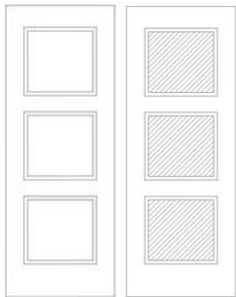

CHESTER	options:	glass:	width:	height:
shaker door	*S or 2S	AVAILABLE	16"-48"	80"-96"
bevelled door	*HALF or FULL or DOUBLE	AVAILABLE	16"-48"	80"-96"
raised panel door	**AVAILABLE	N/A	20"-48"	80"-96"

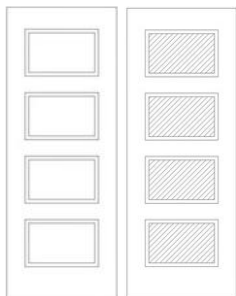

PALMER	options:	glass:	width:	height:
shaker door	*S or 2S	AVAILABLE	16"-48"	80"-96"
bevelled door	*HALF or FULL or DOUBLE	AVAILABLE	16"-48"	80"-96"
raised panel door	**AVAILABLE	N/A	20"-48"	80"-96"

* Illustrations on page 29

** Illustrations on page 30

All doors available unfinished or primed.

For custom sizing options, inquiries, and orders - please contact us.



ESSENTIAL COLLECTION

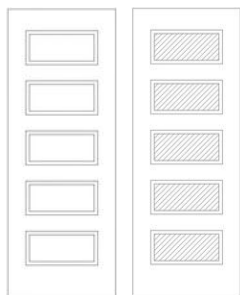

FABLE	options:	glass:	width:	height:
shaker door	*S or 2S	AVAILABLE	16"-48"	80"-96"
bevelled door	*HALF or FULL or DOUBLE	AVAILABLE	16"-48"	80"-96"
raised panel door	**AVAILABLE	N/A	20"-48"	80"-96"

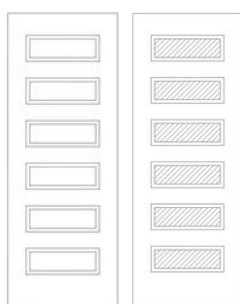

FAIRVIEW	options:	glass:	width:	height:
shaker door	*S or 2S	AVAILABLE	16"-48"	80"-96"
bevelled door	*HALF or FULL or DOUBLE	AVAILABLE	16"-48"	80"-96"
raised panel door	**AVAILABLE	N/A	20"-48"	80"-96"

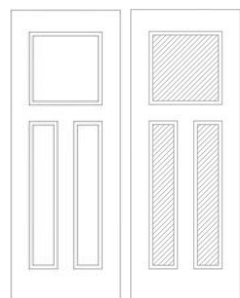

COPPER	options:	glass:	width:	height:
shaker door	*S or 2S	AVAILABLE	20"-48"	80"-96"
bevelled door	*HALF or FULL or DOUBLE	AVAILABLE	20"-48"	80"-96"
raised panel door	**AVAILABLE	N/A	24"-48"	80"-96"

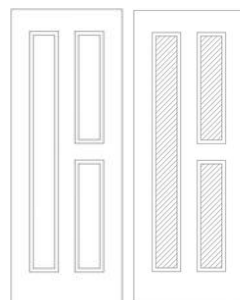

AMBER	options:	glass:	width:	height:
shaker door	*S or 2S	AVAILABLE	20"-48"	80"-96"
bevelled door	*HALF or FULL or DOUBLE	AVAILABLE	20"-48"	80"-96"
raised panel door	**AVAILABLE	N/A	24"-48"	80"-96"

* Illustrations on page 29

** Illustrations on page 30

All doors available unfinished or primed.

For custom sizing options, inquiries, and orders - please contact us.



ESSENTIAL COLLECTION

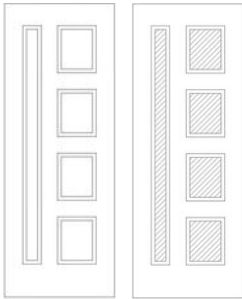

GLASSGOW	options:	glass:	width:	height:
shaker door	*S or 2S	AVAILABLE	20"-48"	80"-96"
bevelled door	*HALF or FULL or DOUBLE	AVAILABLE	20"-48"	80"-96"
raised panel door	**AVAILABLE	N/A	24"-48"	80"-96"

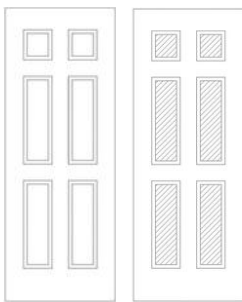

SAMSON	options:	glass:	width:	height:
shaker door	*S or 2S	AVAILABLE	20"-48"	80"-96"
bevelled door	*HALF or FULL or DOUBLE	AVAILABLE	20"-48"	80"-96"
raised panel door	**AVAILABLE	N/A	24"-48"	80"-96"

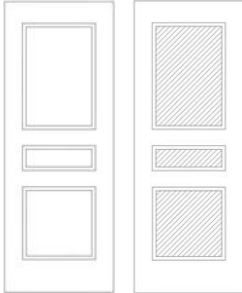

LAWSON	options:	glass:	width:	height:
shaker door	*S or 2S	AVAILABLE	16"-48"	80"-96"
bevelled door	*HALF or FULL or DOUBLE	AVAILABLE	16"-48"	80"-96"
raised panel door	**AVAILABLE	N/A	20"-48"	80"-96"

* Illustrations on page 29

** Illustrations on page 30

All doors available unfinished or primed.

For custom sizing options, inquiries, and orders - please contact us.



ELEGANT COLLECTION

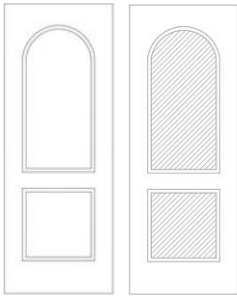

WALES	options:	glass:	width:	height:
shaker door	*S or 2S	AVAILABLE	20"-48"	80"-96"
bevelled door	*HALF or FULL or DOUBLE	AVAILABLE	20"-48"	80"-96"
raised panel door	**AVAILABLE	N/A	20"-48"	80"-96"

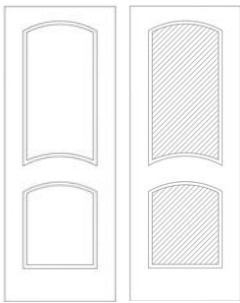

RAE	options:	glass:	width:	height:
shaker door	*S or 2S	AVAILABLE	20"-48"	80"-96"
bevelled door	*HALF or FULL or DOUBLE	AVAILABLE	20"-48"	80"-96"
raised panel door	**AVAILABLE	N/A	20"-48"	80"-96"

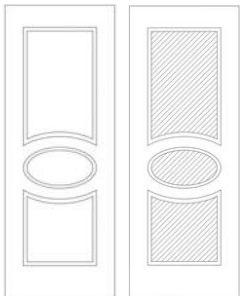

SUNDANCE	options:	glass:	width:	height:
shaker door	*S or 2S	AVAILABLE	20"-48"	80"-96"
bevelled door	*HALF or FULL or DOUBLE	AVAILABLE	20"-48"	80"-96"
raised panel door	**AVAILABLE	N/A	24"-48"	80"-96"

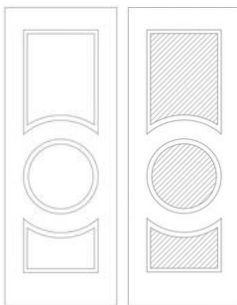

FRASER	options:	glass:	width:	height:
shaker door	*S or 2S	AVAILABLE	20"-48"	80"-96"
bevelled door	*HALF or FULL or DOUBLE	AVAILABLE	20"-48"	80"-96"
raised panel door	**AVAILABLE	N/A	24"-48"	80"-96"

* Illustrations on page 29

** Illustrations on page 30

All doors available unfinished or primed.

For custom sizing options, inquiries, and orders - please contact us.



ELEGANT COLLECTION

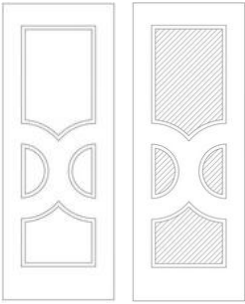

COMMONWEALTH	options:	glass:	width:	height:
shaker door	*S or 2S	AVAILABLE	20"-48"	80"-96"
bevelled door	*HALF or FULL or DOUBLE	AVAILABLE	20"-48"	80"-96"
raised panel door	**AVAILABLE	N/A	24"-48"	80"-96"

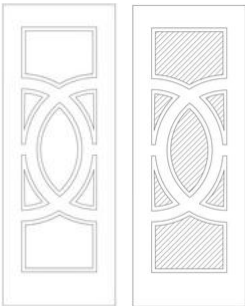

BEACON	options:	glass:	width:	height:
shaker door	*S or 2S	AVAILABLE	20"-48"	80"-96"
bevelled door	*HALF or FULL or DOUBLE	AVAILABLE	20"-48"	80"-96"
raised panel door	**AVAILABLE	N/A	24"-48"	80"-96"

* Illustrations on page 29

** Illustrations on page 30

All doors available unfinished or primed.

For custom sizing options, inquiries, and orders - please contact us.



NOVEL COLLECTION

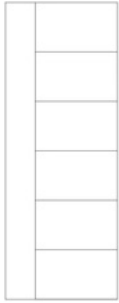

CHINOOK			width:	height:
	kerf cut	5/32" WIDE x 3/32" DEEP	16"-48"	80"-96"
	v-groove	1/4" WIDE x 1/8" DEEP	16"-48"	80"-96"



MONARCH			width:	height:
	kerf cut	5/32" WIDE x 3/32" DEEP	20"-48"	80"-96"
	v-groove	1/4" WIDE x 1/8" DEEP	20"-48"	80"-96"



NOMAD			width:	height:
	kerf cut	5/32" WIDE x 3/32" DEEP	16"-48"	80"-96"
	v-groove	1/4" WIDE x 1/8" DEEP	16"-48"	80"-96"



KENT			width:	height:
	kerf cut	5/32" WIDE x 3/32" DEEP	16"-48"	80"-96"
	v-groove	1/4" WIDE x 1/8" DEEP	16"-48"	80"-96"

* Illustrations on page 29

** Illustrations on page 30

All doors available unfinished or primed.

For custom sizing options, inquiries, and orders - please contact us.



NOVEL COLLECTION

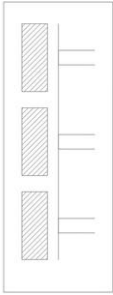

DEVON	options:	glass:	width:	height:
shaker door	*S	AVAILABLE	20"-48"	80"-96"
bevelled door	*HALF or FULL or DOUBLE	AVAILABLE	20"-48"	80"-96"
raised panel door	N/A			

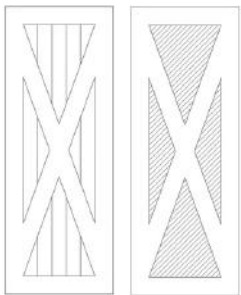

BARLOW	options:	glass:	width:	height:
shaker door	*S	AVAILABLE	20"-48"	80"-96"
bevelled door	*HALF or FULL or DOUBLE	AVAILABLE	20"-48"	80"-96"
raised panel door	N/A			

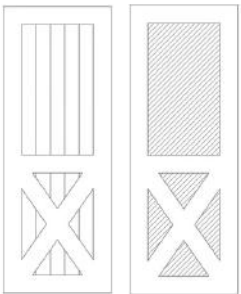

PRAIRIE	options:	glass:	width:	height:
shaker door	*S	AVAILABLE	20"-48"	80"-96"
bevelled door	*HALF or FULL or DOUBLE	AVAILABLE	20"-48"	80"-96"
raised panel door	N/A			

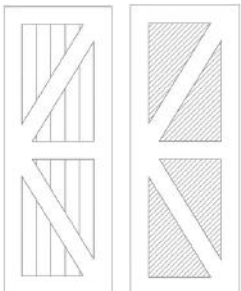

WIND	options:	glass:	width:	height:
shaker door	*S	AVAILABLE	20"-48"	80"-96"
bevelled door	*HALF or FULL or DOUBLE	AVAILABLE	20"-48"	80"-96"
raised panel door	N/A			

* Illustrations on page 29

** Illustrations on page 30

All doors available unfinished or primed.

For custom sizing options, inquiries, and orders - please contact us.





ABI MOULDINGS

3131 57 Avenue SE
Calgary, AB T2C 0B1

Tel: (403) 730-1850

If you are looking to purchase any of our products, please contact one of our distributors. Thank you for your interest in ABI Mouldings!

CONTACT US



www.createwithabi.ca

