

NUTS

Prevailing Torque Lock Nuts Grade 8 • Cad and Waxed

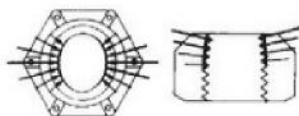

Part No.	Thread Size	Hex Width	Unit Pkg.
12697	1/4"-20 USS	7/16"	50
12705	1/4"-28 SAE	7/16"	50
12698	5/16"-18 USS	1/2"	50
12699	3/8"-16 USS	9/16"	50
12707	3/8"-24 SAE	9/16"	50
12700	7/16"-14 USS	11/16"	50
12708	7/16"-20 SAE	11/16"	50
12701	1/2"-13 USS	3/4"	25
12709	1/2"-20 SAE	3/4"	25
12710	9/16"-18 SAE	7/8"	25
12703	5/8"-11 USS	15/16"	10
12711	5/8"-18 SAE	15/16"	10
12704	3/4"-10 USS	1-1/8"	10

Hexagon Machine Screw Nuts Zinc Plated Steel



Part No.	Thread Size	Hex Width	Unit Pkg.
727	6-32	5/16"	100
728	8-32	11/32"	100
729	10-32	3/8"	100
730	10-24	3/8"	100
731	12-24	7/16"	100
733	1/4"-20	7/16"	100

Reversible Lock Nuts Grade 2 • Zinc Plated



Part No.	Thread Size	Hex Width	Unit Pkg.
11740	1/4"-20	7/16"	100
11741	5/16"-18	1/2"	100
11742	3/8"-16	9/16"	50
11743	1/2"-13	3/4"	25
11744	5/8"-11	15/16"	25

Hexagon Machine Screw Nuts Double Chamfered • Plain Brass



Part No.	Thread Size	Hex Width	Unit Pkg.
3868	10-24 USS	3/8"	100



Slotted Hex Nuts Zinc Finish

Part No.	Thread Size	Hex Width	Slot Width	Unit Pkg.
12723	5/8"-18	15/16"	3/16"-15/64"	25



Nylon Insert Lock Nuts Grade 2 • Zinc Plated

Part No.	Thread Size	Hex Width	Unit Pkg.
9535	8-32	11/32"	100
9536	10-24 USS	3/8"	100
9537	10-32 SAE	3/8"	100
9538	12-24	7/16"	100
9539	1/4"-20 USS	7/16"	100
9540	1/4"-28 SAE	7/16"	100
9541	5/16"-18 USS	1/2"	50
9542	5/16"-24 SAE	1/2"	50
9543	3/8"-16 USS	9/16"	50
9544	3/8"-24 SAE	9/16"	50
9545	7/16"-14 USS	5/8"	50
9546	7/16"-20 SAE	5/8"	50
9547	1/2"-13 USS	3/4"	50
9548	1/2"-20 SAE	3/4"	50
15863	5/8"-11 USS	15/16"	25
15864	5/8"-18 SAE	15/16"	25
15865	3/4"-10 USS	1-1/8"	25

Finished USS (Coarse) & SAE (Fine) Hexagon Nuts Grade 2 • Zinc Plated



Part No.	Thread Size	Hex Width	Unit Pkg.
3541	1/4"-20 USS	7/16"	100
3542	1/4"-28 SAE	7/16"	100
3543	5/16"-18 USS	1/2"	100
3544	5/16"-24 SAE	1/2"	100
3545	3/8"-16 USS	9/16"	100
3546	3/8"-24 SAE	9/16"	100
3547	7/16"-14 USS	11/16"	100
3548	7/16"-20 SAE	11/16"	100
3549	1/2"-13 USS	3/4"	100
3550	1/2"-20 SAE	3/4"	100
8659	9/16"-12 USS	7/8"	50
8660	9/16"-18 SAE	7/8"	50
8661	5/8"-11 USS	15/16"	50
8662	5/8"-18 SAE	15/16"	50
8663	3/4"-10 USS	1-1/8"	50

Finished USS (Coarse) & SAE (Fine) Hex Nuts Grade 5 • Zinc Plated



Fully Certified for S.A.E. J995 Standard
Proof Load: 120,000 PSI
C32 Max. Rockwell Hardness

Part No.	Thread Size	Hex Width	Unit Pkg.
15586	1/4"-20 USS	7/16"	100
15595	1/4"-28 SAE	7/16"	100
15587	5/16"-18 USS	1/2"	100
15596	5/16"-24 SAE	1/2"	100
15588	3/8"-16 USS	9/16"	100
15597	3/8"-24 SAE	9/16"	100
15589	7/16"-14 USS	11/16"	50
15598	7/16"-20 SAE	11/16"	50
15590	1/2"-13 USS	3/4"	50
15599	1/2"-20 SAE	3/4"	50
16981	9/16"-12 USS	7/8"	25
15591	5/8"-11 USS	15/16"	25
15592	3/4"-10 USS	1-1/8"	25
15601	3/4"-16 SAE	1-1/8"	25
15594	1"-8 USS	1-15/32"	10



Finished USS (Coarse) & SAE (Fine) Hexagon Nuts Grade 8 • Zinc & Yellow Plated High Alloy

Part No.	Thread Size	Hex Width	Unit Pkg.
9300	1/4"-20 USS	7/16"	100
9307	1/4"-28 SAE	7/16"	100
9301	5/16"-18 USS	1/2"	100
9308	5/16"-24 SAE	1/2"	100
9302	3/8"-16 USS	9/16"	100
9309	3/8"-24 SAE	9/16"	100
9303	7/16"-14 USS	11/16"	50
9310	7/16"-20 SAE	11/16"	50
9304	1/2"-13 USS	3/4"	50
9311	1/2"-20 SAE	3/4"	50
9305	5/8"-11 USS	15/16"	25
9312	5/8"-18 SAE	15/16"	25
9306	3/4"-10 USS	1-1/8"	25



Ziptwist Wing Nut

Part No.	Thread Size	O.D.	Height	Finish	Unit Pkg.
18531	6mm	5/8"	7/32"	Black	50

NUTS



Washer Base Wing Nuts Zinc Alloy

Part No.	Thread Size	Wing Spread	Overall Height	Washer O.D.	Unit Pkg.
10036	1/4"-20	1"	1/2"	3/4"	50



Finished USS (Coarse) & SAE (Fine) Hex Nuts Grade 8 • Zinc & Yellow Plated

Fully Certified for S.A.E. J995 Standard
Proof Load: 150,000 PSI
C24-C32 Max. Rockwell Hardness for 1/4 thru 5/8
C26-C34 Max. Rockwell Hardness for 3/4 thru 1

Part No.	Thread Size	Hex Width	Unit Pkg.
15640	1/4"-20 USS	7/16"	100
15649	1/4"-28 SAE	7/16"	100
15641	5/16"-18 USS	1/2"	100
15650	5/16"-24 SAE	1/2"	100
15642	3/8"-16 USS	9/16"	100
15651	3/8"-24 SAE	9/16"	100
15643	7/16"-14 USS	11/16"	50
15652	7/16"-20 SAE	11/16"	50
15644	1/2"-13 USS	3/4"	50
15653	1/2"-20 SAE	3/4"	50
16983	9/16"-12 USS	7/8"	25
15645	5/8"-11 USS	15/16"	25
15654	5/8"-18 SAE	15/16"	25
15646	3/4"-10 USS	1-1/8"	15



Keps® Lock Washer & Nut Zinc Plated

Part No.	Thread Size	Hex Width	Unit Pkg.
3492	6-32	5/16"	100
3493	8-32	11/32"	100
3494	10-24	3/8"	100
3495	10-32	3/8"	100
3496	1/4"-20	7/16"	100
3497	1/4"-28	7/16"	100
3498	5/16"-18	1/2"	100
3499	5/16"-24	1/2"	100
3500	3/8"-16	9/16"	100



Square Nuts

Part No.	Thread Size	Width	Finish	Unit Pkg.
3249	3/16"-24	3/8"	Bright Zinc	100
3250	1/4"-20	7/16"	Bright Zinc	100

NUTS



Cage Nuts Phosphate Plated

Part No.	Thread Size	Fits Sq. Hole	Panel Range	Unit Pkg.
3144	1/4"-20	3/8"	.064-.105"	50
10773	1/4"-20	3/8"	.064-.105"	25
3798	5/16"-18	1/2"	.023-.063"	50



Spin Lock Nuts with Serrations



Part No.	Thread Size	Flange O.D.	Hex Width	Unit Pkg.	
Standard Flange - Zinc Plated					
14878	8-32	15/32"	11/32"	100	
14873	10-24	USS	1/2"	3/8"	100
14874	1/4"-20	USS	19/32"	7/16"	100
14875	5/16"-18	USS	11/16"	1/2"	100
14876	3/8"-16	USS	3/4"	9/16"	100
14877	7/16"-14	USS	15/16"	11/16"	50
17084	1/2"-13	USS	1"	3/4"	25
Large Flange - Black Phosphate					
2769	1/4"-20	USS	11/16"	7/16"	100
5167	5/16"-18	USS	13/16"	1/2"	100
5596	3/8"-16	USS	7/8"	9/16"	100



Wing Nuts Nickel Plated

Part No.	Size	Unit Pkg.
3741	1/4"-20	100
3743	3/8"-16	50



Self-Locking Wing Nuts Bright Zinc Chromate

Part No.	Size	Unit Pkg.
9846	1/4"-20	100



Pushnut Bolt Retainers For Threaded Fasteners



Part No.	Bolt Dia.	O.D.	Finish	Unit Pkg.
16851	9/64" (#6)	11/32"	Zinc	100
10085	5/32" (#8)	3/8"	Phos.	100
16852	3/16" (#10)	7/16"	Phos.	100
10086	1/4"	1/2"	Zinc	100
10087	5/16"	5/8"	Zinc	100
9297	3/8"	25/32"	Zinc	100
9298	7/16"	27/32"	Zinc	100
9299	1/2"	15/16"	Zinc	100

For an assortment of Pushnut Bolt Retainers see Fit-Kit No. 6164



Washer Lock Nuts Zinc Plated



Part No.	Thread Size	Hex Width	O.D.	Unit Pkg.
2554	6-32	5/16"	7/16"	100
2555	8-32	11/32"	15/32"	100
2556	10-32	3/8"	1/2"	100
2557	10-24	3/8"	1/2"	100
2558	10-24	3/8"	3/4"	100
2560	12-24	3/8"	3/4"	100
2561	1/4"-20	7/16"	19/32"	100
2562	1/4"-20	7/16"	13/16"	100
10764	5/16"-18	1/2"	13/16"	100



Flat Push-On Retainers For Non-Threaded Fasteners



Part No.	Stud Size	O.D.	Plating	Unit Pkg.
8861	1/16"	3/16"	Phos	100
8862	3/32"	3/16"	Phos	100
8863	1/8"	3/8"	Zinc	100
8864	5/32"	7/16"	Zinc	100
8865	3/16"	7/16"	Zinc	100
8867	.240"	17/32"	Zinc	100
8868	1/4"	17/32"	Zinc	100
8869	5/16"	5/8"	Zinc	100
10374	3/8"	3/4"	Zinc	100
10375	1/2"	1"	Zinc	100
21080	5/8"	1"	Zinc	100



Hex Pal Nuts Plated



Part No.	Thread Size	Hex Width	Unit Pkg.
3975	3/8"-24	9/16"	100
8858	1/2"-20	3/4"	100



Acorn Cap Nuts Nickel Plated

Part No.	Thread Size	Hex Width	Height	Unit Pkg.
11179	8-32	5/16"	9/32"	100
11180	10-24	3/8"	11/32"	100
11181	10-32	3/8"	11/32"	100
11182	1/4"-20	7/16"	3/8"	50
11183	5/16"-18	9/16"	7/16"	50
11184	3/8"-16	5/8"	1/2"	25

NUTS



Free Spinning Washer Nuts



Part No.	Thread Size	Washer O.D.	Hex Size	Height	Plating	O.E.M. No.	Unit Pkg.
16770	#10-24	3/8"	5/16"	11/64"	Zinc & Yellow	383255-S36	100
16771	#10-32	3/8"	5/16"	11/64"	Zinc & Yellow		100
15345	1/4"-20	5/8"	7/16"	9/32"	Zinc & Yellow	3866846, 385400	50
15347	1/4"-20	7/8"	7/16"	5/16"	Phosphate	45334,6023204, 6025004	50
15350	5/16"-18	3/4"	1/2"	3/8"	Phosphate	6025007	50
15351	3/8"-16	7/8"	9/16"	7/16"	Phosphate	376785	25

For metric sizes of Free Spinning Washer Nuts, refer to page 139

THREAD CUTTING NUTS



3400
Zinc

Stud Size: 1/8"
Hex: 1/4"

UNIT PACKAGE: 200



3401
Zinc

Stud Size: 1/8"
Hex: 5/16"

UNIT PACKAGE: 200



2895
Zinc

Stud Size: 1/8"
Hex: 5/16"
Washer Diameter: 17/32"

UNIT PACKAGE: 100



2896
Zinc

Stud Size: 3/16"
Hex: 3/8"
Washer Diameter: 5/8"

UNIT PACKAGE: 100



2897
Zinc

Stud Size: 1/4"
Hex: 7/16"
Washer Diameter: 19/32"

UNIT PACKAGE: 100



3403
Zinc

Stud Size: 1/8"
Hex: 5/16"
Washer Diameter: 7/16"

UNIT PACKAGE: 200



3404
Zinc

Stud Size: 3/16"
Hex: 3/8"
Washer Diameter: 1/2"

UNIT PACKAGE: 200



8855
Zinc

Stud Size: 5/32"
Hex: 3/8"
Washer Diameter: 9/16"

UNIT PACKAGE: 100



3405
Zinc

Stud Size: 1/4"
Hex: 7/16"
Washer Diameter: 11/16"

UNIT PACKAGE: 200



10733
Zinc

Stud Size: 5/16"
Hex: 1/2"
Washer Diameter: 7/8"

UNIT PACKAGE: 100

WHEEL STUDS, BOLTS AND NUTS

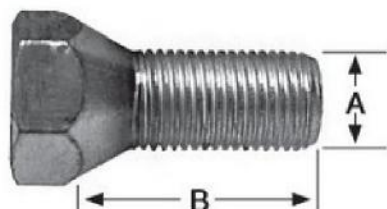

Type #1

Wheel Studs & Bolts
Grade 8 Steel • Plated
UNIT PACKAGE: 10

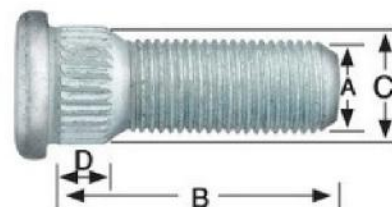

Type #2

Part No.	Type	Diameter (A)	Length (B)	Knurl Dia. (C)	Shoulder Length (D)	Application
14225	1	1/2"-20	1.070"/1.100"	N/A	N/A	Universal (3/4" Hex)
14227	2	1/2"-20	1.510"/1.540"	.618"/.628"	.310"/.330"	GM 76-55; Int. 80-67
14228	2	7/16"-20	1.380"/1.410"	.556"/.566"	.300"/.320"	GM 51-On
14231	2	1/2"-20	1.615"/1.635"	.618"/.628"	.440"/.460"	Ford 62-On
14235	2	1/2"-20	1.620"/1.650"	.618"/.628"	.630"/.650"	Dodge Tk 82-69; Ford 72-65; GMC 70-60
14237	2	1/2"-20	1.435"/1.465"	.556"/.566"	.420"/.440"	Ford 75-73
14241	2	7/16"-20	1.470"/1.500"	.460"/.470"	.333"/.343"	Chrysler 76-64; GM 84-62; Jeep 82-74
14244	2	1/2"-20	1.720"/1.750"	.615"/.625"	.445"/.460"	Ford 75-On

Wheel Nuts



Type 1 (Outer)



Type 3
(Stainless Steel Cap)



Type 5



Type 2 (Inner)



Type 4
(Stainless Steel Cap)



Type 6
(Stainless Steel Cap)

Part No.	Unit Pkg.	Type	Size	Height	Hex	O.E.M No.
8742	50	1	1/2"-20	9/16"	3/4"	Chry: 2409826
8744	50	1	1/2"-20	5/8"	13/16"	GM: 413945, 516637 Ford: COAZ-1012A
8746	50	1	7/16"-20	9/16"	3/4"	Chry: 2072728
12520	5	2	3/4"-16 L.H. (Inner) 1-1/8"-16 L.H. (Outer)	2-7/32"	13/16" Sq.	Budd: 10709
12521	5	1	1-1/8"-16 L.H.	7/8"	1-1/2"	Budd: 37892
12522	5	2	3/4"-16 (Inner) R.H. 1-1/8"-16 (Outer) R.H.	2-7/32"	13/16" Sq.	Budd: 10708
12523	5	1	1-1/8"-16	7/8"	1-1/2"	Budd: 37891
12524	5	1	3/4"-16 L.H.	7/8"	1-1/2"	Budd: 37889
12525	5	1	3/4"-16	7/8"	1-1/2"	Budd: 37888
12617	5	5	12mm-1.5	23mm	19mm	Chry: 6500092
12675	25	1	12mm-1.5	14mm	19mm	GM: 9590477
12695	5	4	12mm-1.5	34mm	19mm	GM: 10018202
12715	10	1	12mm-1.5	14mm	19mm	Chry: 6500526
14253	10	1	12mm-1.25	16mm	21mm	Nissan: 40224-21001
17353	5	6	12mm-1.5	30mm	19mm	Chry: 6502738
18163	5	4	1/2"-20	1-11/32"	3/4"	Chry: J4006956

TRUCK WHEEL HARDWARE

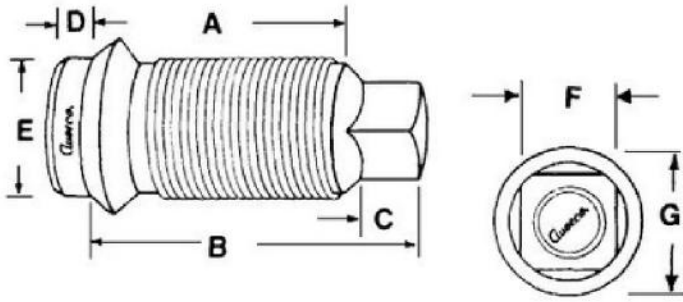

1-1/8" Inner Cap Nuts
3/4"-16 Inner Thread; 1-1/8"-16 Outer Thread
Zinc Plated

Part No.	Thread		Dimensions							Unit Pkg.
	Type	Description	A	B	C	D	E	F	G	
12520	LH	for Steel Wheels	1-7/16"	2-7/32"	17/32"		1-3/16"	13/16"	1-13/32"	5
12522	RH	for Steel Wheels	1-7/16"	2-7/32"	17/32"		1-3/16"	13/16"	1-13/32"	5
15004	LH	for Steel/Alum. Combo	1-15/16"	2-5/8"	19/32"		1-7/32"	13/16"	1-13/32"	5
15009	RH	for Alum. Wheels; GR 8	1-21/32"	2-21/32"	5/8"	5/16"	1-1/8"	13/16"	1-13/32"	5
15010	LH	for Alum. Wheels; GR 8	1-21/32"	2-21/32"	5/8"	5/16"	1-1/8"	13/16"	1-13/32"	5

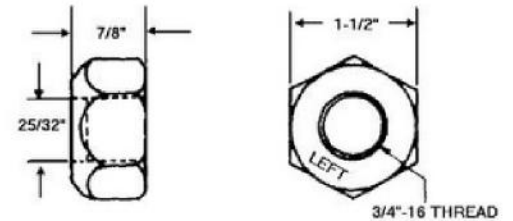
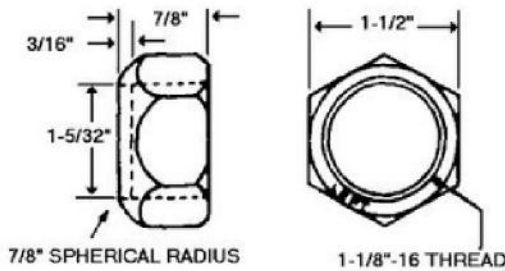

1-1/8" Outer Cap Nut
Zinc Plated

Part No.	Description	Unit Pkg.
12521	LH	5
12523	RH	5

3/4" Outer Cap Nut
Single (3/4") Mounting Front & Rear
Zinc Plated

Part No.	Description	Unit Pkg.
12524	LH	5
12525	RH	5



Flange Wheel Nuts

Part No.	Thread	Hex Size	Flange O.D.	Unit Pkg.
15011	5/8"-18(RH)	1-1/8"	1-5/8"	10



Rim Clamp Nuts
Zinc Plated

Part No.	Thread	Hex Size	Unit Pkg.
15015	3/4"-10	1-1/4"	25

TRUCK WHEEL HARDWARE

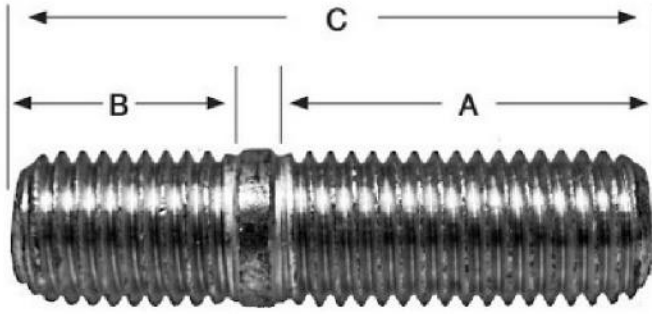

Rim Studs
Grade 8 • Zinc Plated

Part No.	A Dia. & Length	B Dia. & Length	C Overall Length	Unit Pkg.
15017	3/4"-10 USS x 1-13/16"	3/4"-10 USS x 7/8"	3"	25
15018	3/4"-10 USS x 1-7/8"	3/4"-10 USS x 1"	3-1/8"	25

Truck Wheel Hardware Interchange

The numbers listed in this interchange are cross referenced to the closest equivalent Auveco part. In some instances the parts are not identical, however the Auveco part is designed to service the same application

Part No.	Part No.	Part No.	Part No.	Part No.	Part No.
ALCOA		DAYTON		GMC	
5988-L	15010	5715	15017	2201406	12522
5988-R	15009	5716	15015	2201407	12520
BATCO		6654	15016	279670L	12521
13-3005-R	12522	8411	15018	279670R	12523
13-3008-L	15004	DAYTON WALTHER		NUTURN	
13-3012-L	12521	08-853501	12523	W-5	15016
13-3013-L	12524	08-853502	12521	W-6	15017
13-3026-L	15010	08-853701	12522	W-8	15015
13-3026-R	15009	08-853702	12520	W-11	12522
13-6003	15017	EUCLID		W-12	12520
13-6005	15018	4956-A	15017	W-13	12523
13-8004	15015	4958	15016	W-14	12521
BUDD		4963	15015	W-15	12525
10708	12522	5549-L	12520	W-16	12524
35337	15004	5549-R	12522	W-159	15004
37888	12525	5552-L	12521	W-246	15018
37889	12524	5552-R	12523	W-486	15009
37891	12523	5652-L	12524	W-487	15010
37892	12521	5652-R	12525		
95188	15011	5706	15018		
		5735-L	15004		
		5735-R	15003		
		5988-L	15010		
		5988-R	15009		