



Specification

BISLEY



Think it. Click it. Love it.

BOB® by Bisley is the beautifully hand-crafted, magnetic, display unit that lets you click, twist and re-think storage at home. Combining high-quality, smooth plywood with exposed edges and a selection of durable, steel accessories, BOB is a welcome addition to a living room, hallway, or an open plan space where subtle room division is needed.

The vision of award-winning designer Paul Kelly, in collaboration with Bisley's unrivalled storage expertise, BOB transcends the way we think about storage. Secured using a self-adjusting, technology-friendly magnetic system, BOB is strong enough to click and hold everything together, yet light enough to move with a simple twist.

Originally crafted to store a music devotee's vinyl collection, BOB is both timeless and adaptable. With its smooth sliding doors and additional shelves, showcase your treasures or cleverly conceal bulky toys with BOB's customisable features.

If you can think it, BOB can help you create it.



Features

Designed and built using high-quality, durable plywood, with beautifully exposed, raw plywood edges.

Secured together with a magnetic system.

Available in classic white.

Hand finished with care and precision.

Push to open doors and drawers.

Available in eleven reconfigurable kits with seven single unit add ons.

Steel liners available in full or half sizes and 34 paint options.

No self-assembly required.

Minimum two-year guarantee.

Made in the UK.





Benefits

Reconfigurable - effortlessly switch BOB to suit your space and click it into place with the simple magnetic system.

Dual-facing - with magnets in four sides, you can twist BOB® units to suit your storage needs.

Flawlessly clean - finished in classic white with beautifully exposed plywood edges, BOB is a timeless design.

Adaptable - create countless configurations with BOB and grow your collection with seven additional single units available, plus a range of steel accessories.

Versatile - smart and simple, BOB® is a beautiful addition to the home or office.

Precision - each unit is hand finished to Bisley's exacting standards.

Easy - each unit arrives fully assembled ready to click into place.

Range Overview

BOB® is 380mm (13”) deep.

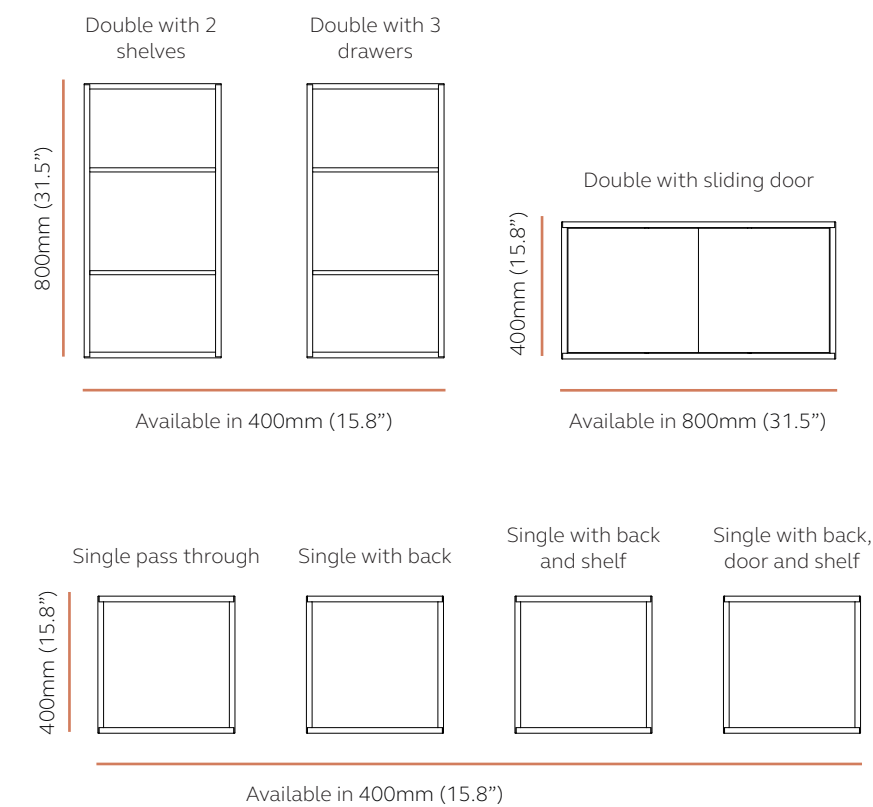

BOB® kit examples

With a choice of small, medium and large kits, BOB® will arrive fully assembled so you can click it into place right away.

BOB® can also grow as you do. Add any of the seven extra units, available to purchase separately, which will perfectly fit into your existing design.

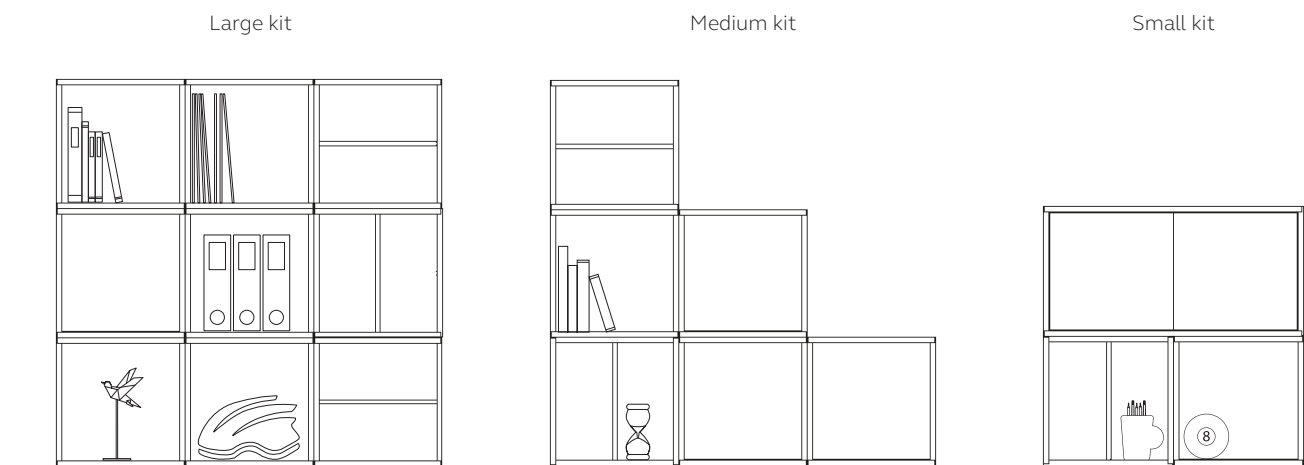

Individual Units

W: 400mm (15.8") H:800mm (31.5") D:380mm (13")

| Product Code | Description |
|--------------|----------------------------------------------|
| BOBDOCBS | Double unit, open with back panel, 2 shelves |
| BOBDODR | Double unit, 3 drawers |

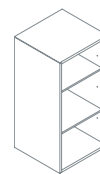

BOBDOCBS

W: 800mm (31.5") H:400mm (15.8") D:380mm (13")

| Product Code | Description |
|--------------|---------------------------|
| BOBDOSD | Double unit, sliding door |

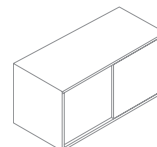

BOBDOSD

W: 400mm (15.8") H:400mm (15.8") D:380mm (13")

| Product Code | Description |
|--------------|------------------------------------------------|
| BOBSIOB | Single unit, pass through (no shelf positions) |
| BOBSICB | Single unit, open with back panel |
| BOBSICBS | Single unit, open with back panel and shelf |
| BOBSICD | Single unit, push-to-open door and shelf |

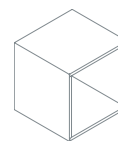

BOBSIOB

Kits

| Product Code | Description |
|--------------|-------------------------------------------------------------|
| BOBSMALL1 | 1 single, pass-through |
| | 1 single, open with back panel and shelf |
| | 1 double, sliding door (dividers available as an accessory) |

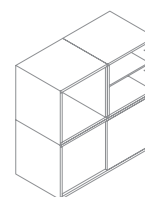

BOBSMALL1

| Product Code | Description |
|--------------|------------------------------------------------|
| BOBSMALL2 | 1 double, open with back panel and 2 shelves |
| | 1 single, open with back panel |
| | 1 single, push-to-open cupboard door and shelf |

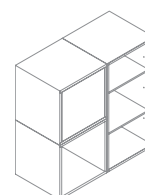

BOBSMALL2

Product Code

Description

BOBSMALL3

1 double, 3 drawer unit
1 single, push-to-open cupboard door and shelf
1 single, open with back panel and shelf

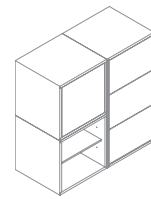

BOBSMALL3

Product Code

Description

BOBSMALL4

1 single, push to open cupboard door and shelf
2 singles open with back panel and shelf
1 single open with back panel

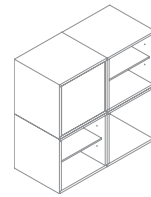

BOBSMALL4

Product Code

Description

BOBMEDIUM1

2 singles, open with back panel and shelf
1 single, push-to-open cupboard door with shelf
1 single, pass-through
1 double, sliding door

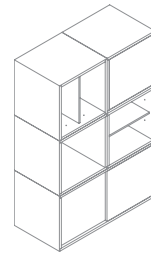

BOBMEDIUM1

Product Code

Description

BOBMEDIUM2

1 double, 3 drawers
2 singles, pass-through
1 single, open with back panel and shelf
1 single, open with back panel

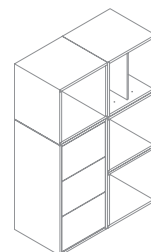

BOBMEDIUM2

Product Code

Description

BOBMEDIUM3

1 single, pass-through
1 single, open with back panel and shelf
1 double, sliding door
1 double, open with back panel and 2 shelves

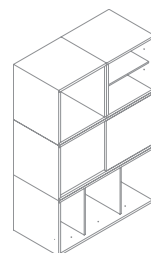

BOBMEDIUM3

Product Code

Description

BOBMEDIUM4

2 singles, open with back panel and shelf
2 singles, push-to-open cupboard door and shelf
1 single, pass-through unit
1 single, open with back panel

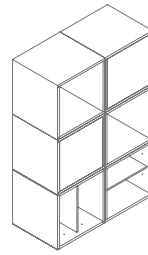

BOBMEDIUM4

Product Code

Description

BOBLARGE1

5 singles, pass-through
1 single, push-to-open cupboard door with shelf
3 singles, open with back panel and shelf

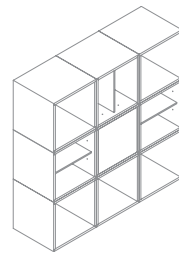

BOBLARGE1

Product Code

Description

BOBLARGE2

1 double, 3 drawers
1 double, open with back panel and 2 shelves
2 singles, push-to-open cupboard door with shelf units
2 singles, pass-through
1 single, open with back panels and shelf

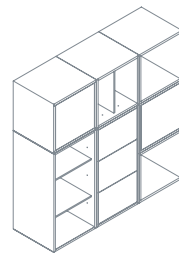

BOBLARGE2

Product Code

Description

BOBLARGE3

1 double, 3 drawers
1 double, sliding door
2 singles, pass-through
2 singles, open with back panel and shelf
1 single, open with back panel

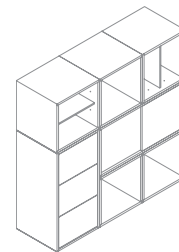

BOBLARGE3

Accessories

| Shelf | | | | Thickness: 12mm (0.5") |
|--------------|----------------------------------------------------|---------------|---------------|-------------------------------------------------------------------------------------------------|
| Product Code | Description | Width | Depth |  BOBSHELF |
| BOBSHELF | Compatible with all units except sliding door unit | 366mm (14.4") | 330mm (13") | |
| BOBSHELFSM | Compatible with sliding door unit. | 366mm (14.4") | 310mm (12.2") | |

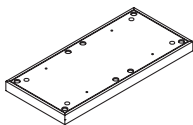
| Plinth | | | |  BOB08PLINTH |
|--------------|-----------------------------------|----------------|-------------|----------------------------------------------------------------------------------------------------|
| Product Code | Description | Width | Height | |
| BOB08PLINTH | Steel plinth with adjustable feet | 780mm (30.7") | 56mm (2.2") | |
| BOB12PLINTH | Steel plinth with adjustable feet | 1180mm (46.4") | 56mm (2.2") | |

| Steel Liners | | | | | |
|--------------|------------------|---------------|---------------|---------------------------------------------------------------------------------------|---------------------------------------------------------------------------------------|
| Product Code | Description | Width | Height | | |
| BOBFSL | Full steel liner | 361mm (14.2") | 352mm (13.8") |  |  |
| BOBHSL | Half steel liner | 361mm (14.2") | 171mm (6.7") | | |
| | | | | BOBFSL | BOBHSL |



Specification Notes

Locking options:

There are no locking options available for BOB.

Finish options:

All BOB units are available white laminated plywood. For larger projects alternative finishes are available, please speak to your Bisley representative for more information.



Platinum White
562

Accessories

BOB steel liners are available in from our paint palette.

BOB steel plinth is available in white only.

Safety guidance:

- Take care when lifting and stacking units.
- Use with caution, product contains strong magnets.
- Make sure your BOB is on a flat surface.
- Only sit on single units with a back panel.
- Do not stack any higher than 1600mm (63") high (four single BOB units high).
- Do not exceed the maximum weight load capacity of the drawers and shelves (8kg).
- Do not stack your three-drawer unit on top of any other BOB units.
- Do not sit on double or pass-through units.
- Do not lift double units alone.
- Do not use excessive amounts of liquid to clean your BOB.

BISLEY