

**REBUILD
2 SERVE**

Strengthening Our Foundation for the Future

Our Campaign To Build A New
Fr. John Guiliani Parish Center
& Child Development Center



ST. PHILIP NERI
Catholic Church

Fort Mill, South Carolina



Strengthening Our Foundation for the Future



St. Philip Neri

Just as those before us have done, we are called to build a better church, and to leave a legacy of improvement for those who will follow us.

For over 32 years, St. Philip Neri Catholic Church has been blessed to serve the growing Fort Mill area. From our humble beginnings, we have grown into a vibrant Catholic faith community centered on the celebration of the sacraments, evangelization, formation, and service.

Looking forward, to continue to grow and live out our mission, we need to take additional steps to strengthen our foundation for the future. Simply stated, our current facilities do not provide room for parish ministries, events, and activities to grow.

Parish leadership, based on feasibility studies, professional consultation, financial analysis, parishioner input, and prayerful discernment, has carefully studied our options. Plans have been evaluated, and where necessary, refined. While earlier concepts envisioned two separate new buildings, continued study revealed the most responsible path forward is to replace the Fr. John Giuliani Parish Center and Child Development Center with a new, expanded, and improved facility on the existing site.

Our earlier *Rebuild to Serve* campaign established a strong foundation for this vision. Today, we are renewing and focusing that effort through **Rebuild 2 Serve: Strengthening Our Foundation for the Future** with one clear purpose: to build a new Parish Center, inclusive of dedicated space for the St. Philip Neri Child Development Center, that will support the life and mission of St. Philip Neri Catholic Church for generations to come.



Our Challenge

Our current Parish Center building has been problematic since it was built in 1998. Starting with the damage caused by the 2004 winter snowstorm, the building has continued to present ongoing structural challenges and functional limitations. It is also operating at full capacity and cannot support any further growth.

Space is at Capacity

Our parish has continually grown since it was founded and since the Fr. John Giuliani Parish Center was built. We serve over 3,380 registered households. Looking forward, Fort Mill remains the second fastest growing South Carolina town, growing 37% since 2022 (based on the 2023 Census data). Yet, today, our Parish Center is at full capacity with no space for our parish ministries, events, and activities to grow.

Structural Damage & Functional Limitations

The building's aging structure, kitchen, and electrical system limitations impact the space's overall functionality and usability.

- Roof leaks continue to reoccur, forcing us to deal with and pay for increasingly costly repairs.
- The electrical system is being used to the limits of the original design, and to upgrade it as desired is increasingly costly.
- The kitchen is undersized and poorly laid out for our current and future needs and should be completely upgraded to efficiently serve our ministries, parish events, and large community events.



Five years ago, an engineering study explored how to expand the Parish Center. The results determined that just the needed repairs, without expansion, would cost well over \$2 million at that time. Even then, the building would still not meet our needs.

Our Solution

Building a New Fr. John Giuliani Parish Center

One Building Concept

The original vision for the *Rebuild to Serve* effort envisioned two separate buildings: a new Fr. John Giuliani Parish Center on the existing site, and a new building for the St. Philip Neri Child Development Center (CDC) and additional meeting space. However, as we moved forward to technical planning, we determined that the two-building concept was not feasible based on two critical factors:

- **Cost:** it became clear that the amount of site work required for the proposed second building would significantly exceed the initial expectations as well as requiring modifications to the church's main entrance.
- **Accessibility:** the design was going to require reducing the courtyard size as well as limiting its driveway entrance. This would have impacted numerous aspects of campus activities and limited emergency vehicle access.

A one building concept was the unanimous consensus of the Pastor, Construction Committee, Parish leaders, architect, and builder.

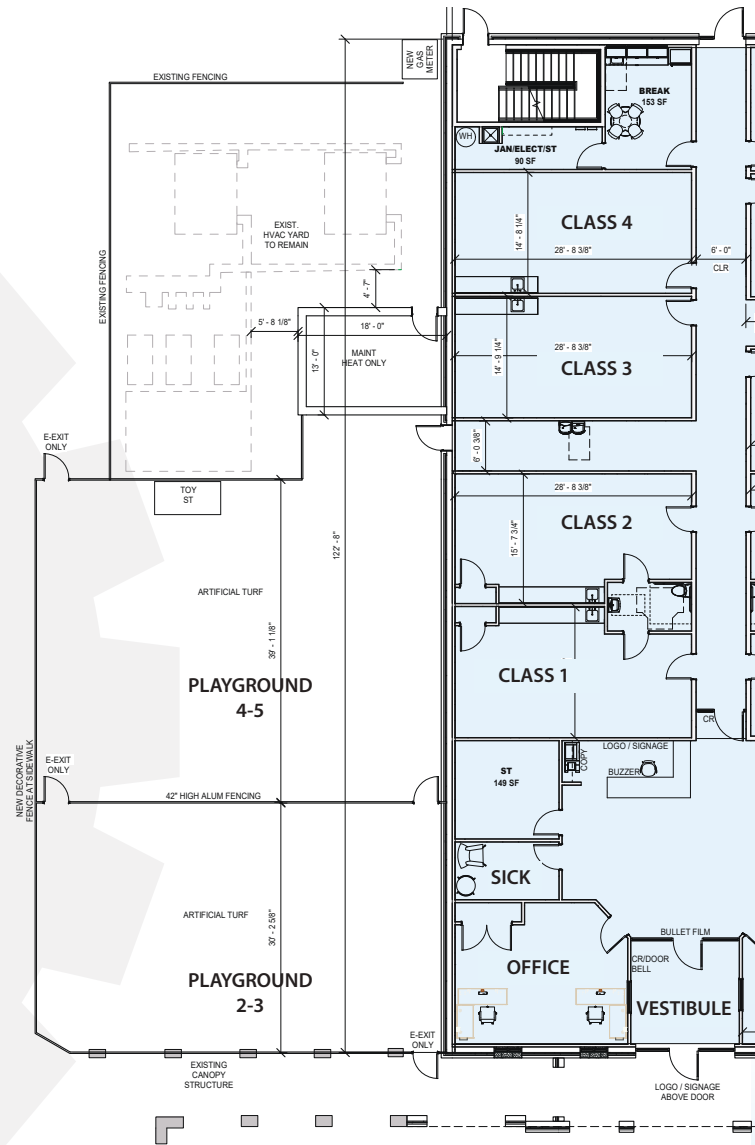

The new two-story building will provide expanded space for the Parish Center, the Child Development Center, and include additional meeting space for formation opportunities and ministry growth. While the second floor will not be built out immediately, its inclusion in the design allows us to plan for future growth and ministry needs as they arise.



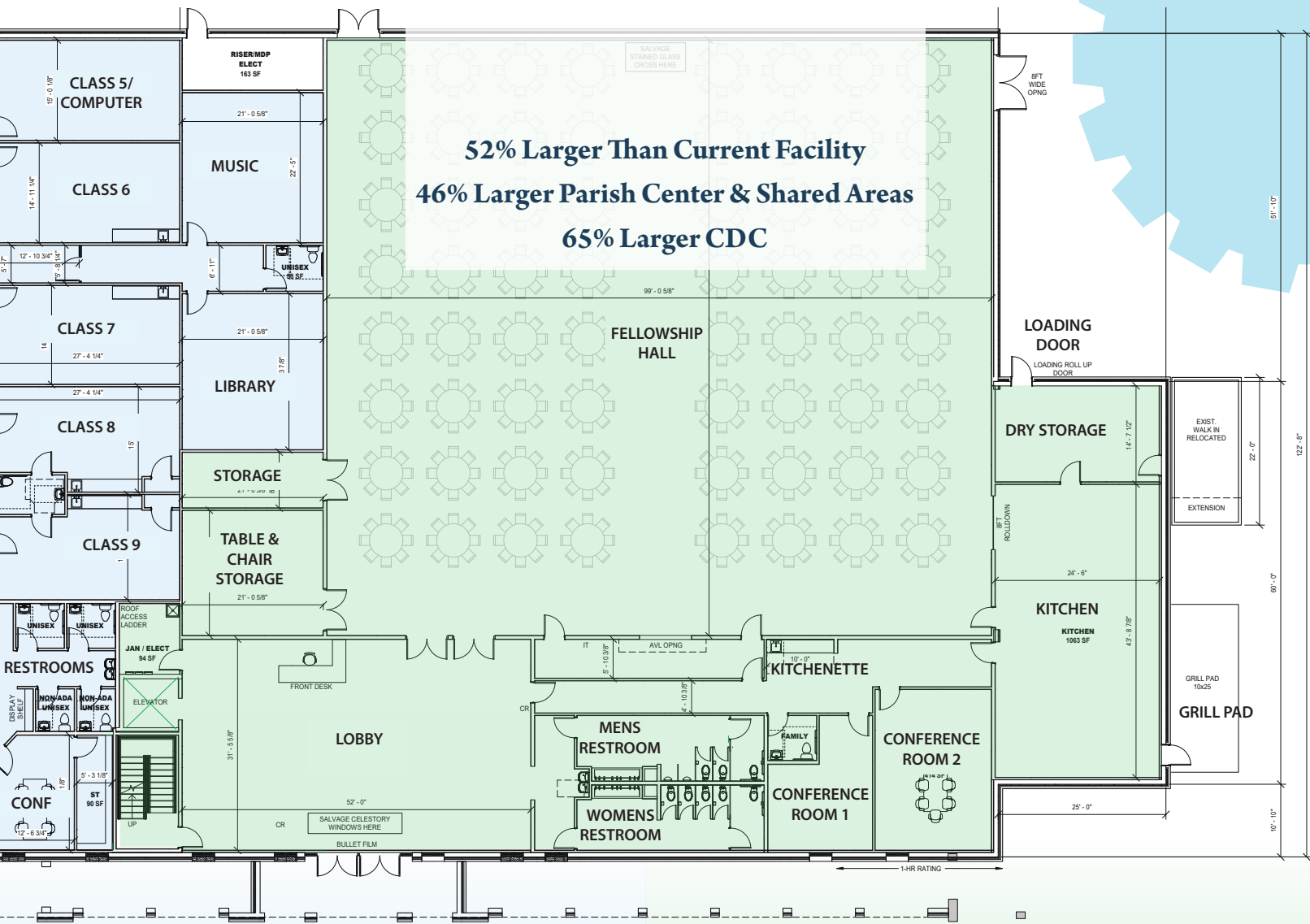

St Philip Neri Child Development Center (CDC)

A dedicated Child Development Center space will better support our educational mission in a secure, age-appropriate facility. It also will free the Parish Center for weekday use by other ministries and events.

The main entrance will lead into a generous lobby providing transition space for greeting and security check-in. Adjacent to the lobby will be a conference room, well-suited for meetings, small groups, or administrative use. The heart of this space will be a large, open, central gathering area for flexible use. An administrative office for staff will be conveniently located near the entrance.

In addition to the shared gathering and support spaces, there will be nine classrooms designed for flexibility and growth. These will be available for formation programs, small groups, and ministries.

Multiple restroom options include child-size restrooms situated between classroom pairs for better accessibility and supervision. The sick room will be expanded and storage areas modified to ensure a healthier and more organized environment.

A dedicated music room and library have been added to enhance the children's learning environment.

Parish Center

A large welcoming lobby will feature two separate conference rooms, ADA-accessible restrooms, a family restroom, and an elevator, to ensure all are welcome.

Comfortable accommodation for 500 people will provide ample room for the parish events, meals, celebrations, and fellowship events that bring our faith and local communities together.

A large, fully equipped, commercial-grade kitchen will include the appliances, layout, storage, and equipment needed to successfully cook and serve small and large events. It also will feature expanded storage room, an outside loading dock, and an outdoor grill pad.

The Rebuild 2 Serve campaign is not just about money or buildings; it's about how can we be good disciples and grow our faith community to serve the mission set forth by the parishioners of St. Philip Neri Catholic Church. Having a new Fr. John Giuliani Parish Center and Child Development Center will allow us to do just that in a space that truly meets our needs.



Our Campaign

How to Give

To ensure that we reach our goals and potential, we ask you to consider special gifts over and above your regular contributions. Gifts can be given to the campaign in a variety of ways:



Pledges are payable over three years and may be paid in monthly, quarterly, semi-annual, or annual installments by cash, credit card, or direct deposit. A 10% or more initial investment is requested.

Non-Cash Gifts* include **securities** such as stocks, bonds or gifts through qualified charitable distributions such as IRA rollovers; **real estate** such as marketable land, homes, vacation homes, and rental or commercial properties; or **valuable personal property** such as precious metals, gems, jewelry, artwork, collectables and even new or slightly used or classic automobiles, watercraft and motor homes.

Deferred Gifts* are gifts that are arranged to be received later such as new or fully paid-up life insurance policies, certain trust arrangements or gifts through a person's will by bequest.

Matching Gifts may enable you to double or even triple your gift. If you serve on a board, work for, or are retired from a company that matches charitable gifts, check to see if our campaign qualifies.

*All non-cash and deferred gifts must be approved by the church before acceptance.

Our Goals

\$8,000,000
Ultimate Goal

- Complete the first floor of the new Parish Center and Child Development Center *without debt*.
- Begin planning second floor buildout.

\$6,000,000
Minimum Goal

Plus \$2.8 million raised in previous campaign

- Demolish existing building.
- Begin construction of the new Parish Center and Child Development Center.

"Each of you should give what you have decided in your heart to give, not reluctantly or under compulsion, for God loves a cheerful giver."
2 Corinthians 9:7

Levels of Support Needed to Succeed

In order to reach our financial objectives, we need both a substantial number of givers and a few substantial gifts.

MINIMUM GOAL		
Gifts Needed	Size of Gift	Minimum Needed
1	\$ 600,000 or More	\$ 600,000
2	\$ 300,000 – \$ 600,000	\$ 600,000
4	\$ 150,000 – \$ 300,000	\$ 600,000
8	\$ 75,000 – \$ 150,000	\$ 600,000
12	\$ 50,000 – \$ 75,000	\$ 600,000
24	\$ 25,000 – \$ 50,000	\$ 600,000
120	\$ 5,000 – \$ 25,000	\$ 600,000
893	Less Than \$ 5,000	\$1,800,000
1,064	TOTAL	\$ 6,000,000

ULTIMATE GOAL		
Gifts Needed	Size of Gift	Minimum Needed
1	\$ 800,000 or More	\$ 800,000
2	\$ 400,000 – \$ 800,000	\$ 800,000
4	\$ 200,000 – \$ 400,000	\$ 800,000
8	\$ 100,000 – \$ 200,000	\$ 800,000
16	\$ 50,000 – \$ 100,000	\$ 800,000
32	\$ 25,000 – \$ 50,000	\$ 800,000
80	\$ 10,000 – \$ 25,000	\$ 800,000
921	Less Than \$ 10,000	\$2,400,000
1,064	TOTAL	\$ 8,000,000

Giving Opportunities

You have the opportunity to make a deeply personal impact by designating your gift to a specific area of need. These special giving opportunities showcase the meaningful difference your generosity can make. Additionally, with church approval, these gifts can be dedicated in honor or memory of someone special to you.

Child Development Center	\$ 1,200,000
Classrooms (9)	\$ 200,000 each
Office	\$ 100,000
Library	\$ 100,000
Standard ADA Restrooms	\$ 150,000
Computer/Music Room	\$ 100,000
Conference Rooms (3)	\$ 75,000 each
Break Room / Kitchenette	\$ 50,000
Playground (2)	\$ 50,000 each
Lobby	\$ 25,000
Parish Center	\$ 800,000
Kitchen (Commercial)	\$ 600,000
Lobby	\$ 450,000
ADA Restrooms	\$ 300,000
Elevator	\$ 150,000
Family Restroom	\$ 100,000
Dry Storage	\$ 10,000
Grill Pad	\$ 5,000

The gift amounts listed do not necessarily reflect an opportunity's actual cost. Rather, they approximate its actual cost, factor in its value, visibility, and prominence, the needs of our campaign and our community's gift abilities. Recognition rights will be granted once payment for the opportunity is fully received. Fully funded gifts may be made in honor or memory of a loved one and will be acknowledged to them or their family. Opportunity donors will have their names and the names of those they are honoring commemorated in a special way, as will all other campaign donors.

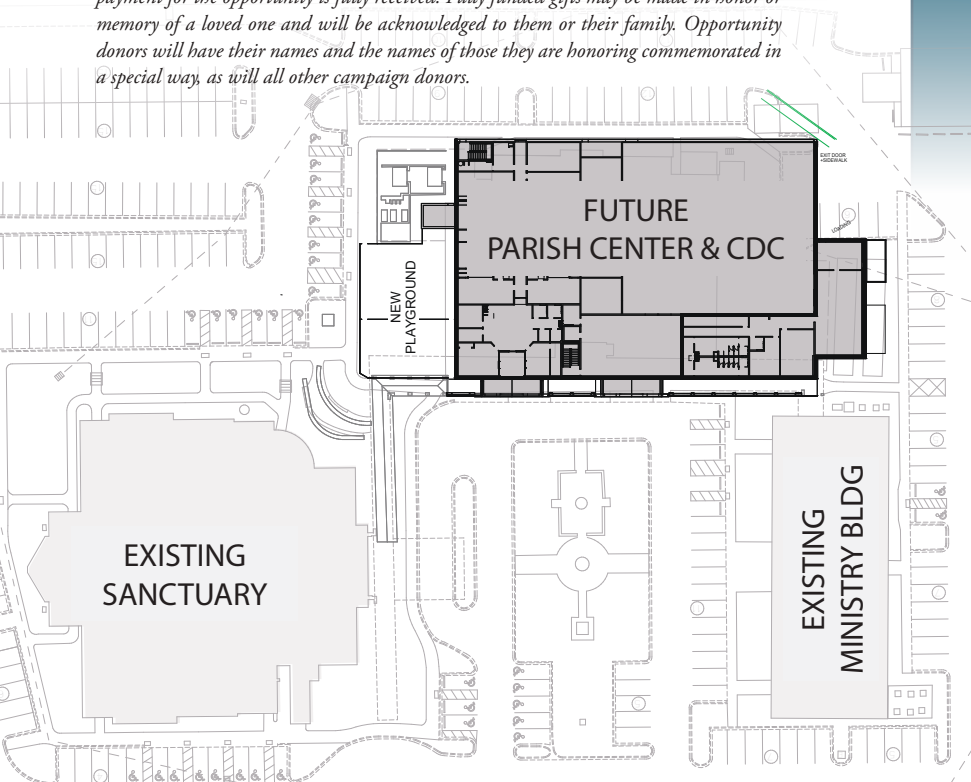

Join Us!

No matter the size or form of your gift, your support is both urgently needed and deeply appreciated. When we come together, through prayers, service, generosity, and, for some, extraordinary giving, we make this campaign not only possible but powerful.

With God's help and the combined efforts of our community, we will achieve our goals. And when we do, all we've accomplished so far will simply be the foundation for an even more vibrant and faithful future.

We invite you to be part of this transformative journey that will strengthen our church and expand our ability to serve God and one another for years to come.

Capital Campaign Prayer

Heavenly Father,

We thank You for the gifts of faith, fellowship, and generosity that have blessed St. Philip Neri Parish.

As we begin this campaign to Rebuild 2 Serve, we honor the devotion and sacrifice of those who laid the foundation of our parish.

Guide us forward with generous and willing hearts, that we may continue to serve You and one another with courage, love, and joy. Through the intercession of Saint Philip Neri and through Christ our Lord.

Amen.

Suggested Pledge Plans

Three Year Pledges

Gift Level	Total Gift	Initial (10%) Investment	Daily*	Weekly*	Payment Plans			
					Monthly (36)	Quarterly (12)	Semi-Annually (6)	Annually (3)
Leadership	\$1,000,000	\$100,000	\$821.92	\$5,769.23	\$25,000	\$75,000	\$150,000	\$300,000
	\$750,000	\$75,000	\$616.44	\$4,326.92	\$18,750	\$56,250	\$112,500	\$225,000
	\$500,000	\$50,000	\$410.96	\$2,884.62	\$12,500	\$37,500	\$75,000	\$150,000
	\$250,000	\$25,000	\$205.48	\$1,442.31	\$6,250	\$18,750	\$37,500	\$75,000
	\$100,000	\$10,000	\$82.19	\$576.92	\$2,500	\$7,500	\$15,000	\$30,000
Pacesetting	\$75,000	\$7,500	\$61.64	\$432.69	\$1,875	\$5,625	\$11,250	\$22,500
	\$50,000	\$5,000	\$41.10	\$288.46	\$1,250	\$3,750	\$7,500	\$15,000
	\$40,000	\$4,000	\$32.88	\$230.77	\$1,000	\$3,000	\$6,000	\$12,000
	\$30,000	\$3,000	\$24.66	\$173.08	\$750	\$2,250	\$4,500	\$9,000
	\$25,000	\$2,500	\$20.55	\$144.23	\$625	\$1,875	\$3,750	\$7,500
Major	\$20,000	\$2,000	\$16.44	\$115.38	\$500	\$1,500	\$3,000	\$6,000
	\$15,000	\$1,500	\$12.33	\$86.54	\$375	\$1,125	\$2,250	\$4,500
	\$10,000	\$1,000	\$8.22	\$57.69	\$250	\$750	\$1,500	\$3,000
	\$5,000	\$500	\$4.11	\$28.85	\$125	\$375	\$750	\$1,500
Community	\$4,000	\$400	\$3.29	\$23.08	\$100	\$300	\$600	\$1,200
	\$3,000	\$300	\$2.47	\$17.31	\$75	\$225	\$450	\$900
	\$2,000	\$200	\$1.64	\$11.54	\$50	\$150	\$300	\$600

*These figures are provided for illustration purposes only. To minimize costs, suggested payment plans include monthly, quarterly, semi-annual, or annual installments.



“As each one has received a gift, use it to serve one another as good stewards of God’s varied grace.”

Colossians 3:17