



Proudly Manufactured by
General Pump SINCE 1975
Company



PACKAGED PUMPING STATIONS

1300 662 787 www.generalpumps.com.au sales@generalpumps.com.au

Introduction

Established in 1975, General Pump Company has built up a reputation based on performance and service with an unwavering commitment to customer service and excellence in product quality, backed by years of industry knowledge and experience.

General Pump Company is capable of investigation, design, assembly, commissioning & testing and maintenance & repair of quality products that can be designed and customised to the highest Australian and International Engineering Standards. Our commitment to quality, safety, and customer service ensures the solution to your pump requirements can be delivered to the highest standard.



What are Ultraflow Packaged Pumping Stations used for?

Draining sewage or stormwater from a residence or commercial building is not always simple. Draining to the sewer or stormwater main by gravity may be impossible – the connection maybe above the building or it might be just at the same level. In some situations draining to the sewer main or stormwater main by gravity maybe very difficult- concrete slabs, rock and other obstructions can make it difficult or very expensive to excavate for drainage pipework. These difficulties are not impossibilities. By installing an Ultraflow packaged pumping station it is possible to transfer sewage or stormwater to the desired connection point. General Pump Company manufactures and stocks a large range of Ultraflow packaged pumping stations for almost any application.

How does an Ultraflow Packaged Pumping Station work?

Sewage or stormwater from a residence or commercial building drains into the pumpwell (tank) by gravity. The liquid level rises in the pumpwell and when the liquid reaches a determined level, a float switch will start the submersible pump. The pump will continue to operate until the liquid level in the pumpwell falls to a determined level and will then shut down.

Where a second pump has been installed in the pumpwell, the system function is different. When the liquid level rises in the pumpwell to a determined level, one pump will start. If the liquid level continues to rise, the second pump will start. Both pumps will continue to operate until the liquid level in the pumpwell falls to a determined level and both pumps will shut down. Pumps will start alternately each time a pump is called for. If one pump fails, the second pump will start and operate immediately.

It is recommended that a high level alarm is fitted to a packaged pumping station. This ensures that when there is a high liquid level in the pumpwell due to a pipe blockage or pump failure, an alarm is activated.

What does an Ultraflow Packaged Pumping Station include?

A packaged pumping station consists of:

- Reinforced fibreglass or polythylene pumpwell which can be installed in ground or above ground.
- Single, dual, triplex or quad submersible pump/s mounted inside the tank/pumpwell complete with 'in-tank' pipe-work and valves.
- Pipework available in PVC, HDPE, ABS or Cast Iron.
- Valves available in brass, cast iron, stainless or plastic. (Valves available in an Integral or separate valve chamber.)
- Pumps can be installed free standing or with a guide rail system with galvanised steel or stainless steel guide rail poles.
- An electrical control panel with alarms is available as an option for single pump systems but is mandatory for multiple pump systems. Float level switches, probes or ultrasonic level controls.

Easy handling & Installation.

The use of reinforced fibreglass or polythylene pumpwells makes handling, transportation and installation very easy. The pumpwell is rigid & tough but also lightweight. Smaller cranes and lifting equipment can be used compared to the heavy cranes required for lifting the sections of precast concrete pumpwells. This is very beneficial especially where there is limited access and steep terrain at the site. The pumpwells are fully fitted out with plumbing and guide rails (if required). Also, the pumpwells are manufactured with a 'benched' base. All this provides a very significant reduction in installation time and cost.

Simple maintenance.

Not only are the Ultraflow packaged pumping stations easy to install, but they are simple to maintain. The maintenance schedule can be carried out by inexperienced persons by following the simple step by step procedures outlined in the service manual.

Taking responsibility for the environment.

Concrete pumpwells, either precast or poured on site, are commonly used for pumping stations. They are known to crack/fracture over a period of time due to ground movement and acidity in subsoils. This allows sewage to leak from the tank, contaminating the surrounding subsoil. Tree roots will venture into the concrete tanks creating further damage and thus contamination.

Reinforced fibreglass or polythylene pumpwells are superior in durability compared to concrete tanks. The use of reinforced fibreglass pumpwells almost eliminates the possibility of contamination occurring.

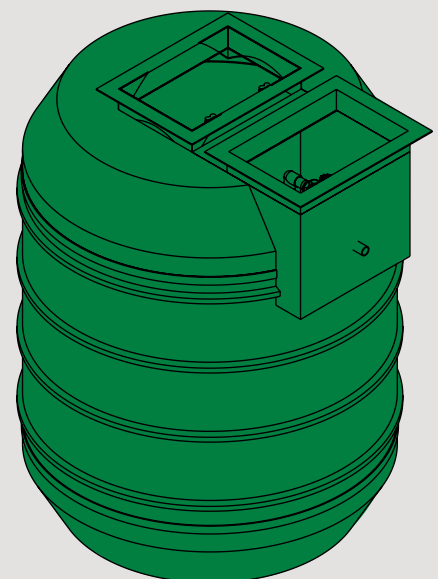

REINFORCED POLYETHYLENE PUMPWELLS

100L PUMPWELL

Pumpwell Material: Reinforced Polyethylene

Weight: 9kg (excluding pump)

Access Cover: 450mm x 450mm

Cover Types: Reinforced Polyethylene
Cast Iron (Class B & D)
Galvanised Grate (Class B & D)

Pipework: PVC pipe & fittings, PVC valves

Controls: Optional with single pump systems

Pump Options: Single pump

Liquids: Raw sewage
Trade waste
Effluent
Stormwater

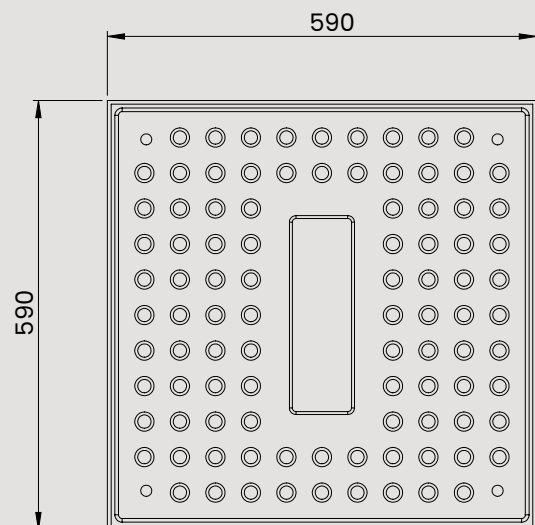
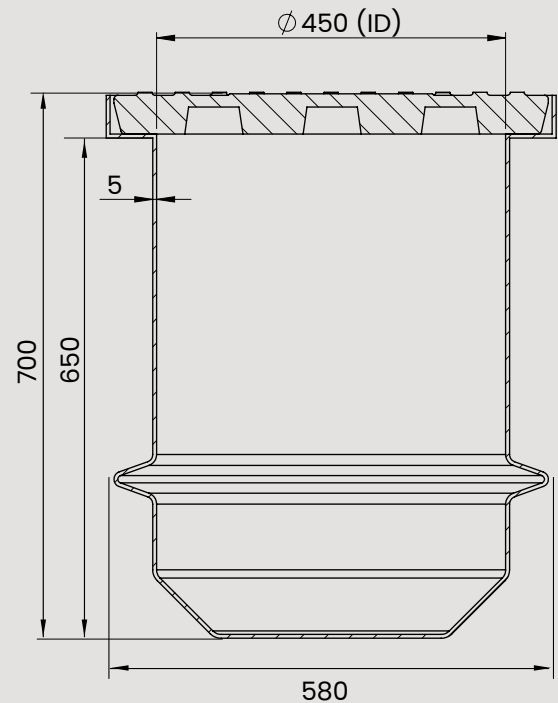

PACKAGED
**PUMPING
STATIONS**

Manufactured to AS1546.1-2008 & AS4766.2006
NSW Dept of Health Approved

250L PUMPWELL

Pumpwell Material: Reinforced Polyethylene

Weight: 22kg (excluding pump)

Access Cover: 600mm x 600mm

Cover Types: Reinforced Polyethylene
 Cast Iron (Class B & D)
 Galvanised Grate (Class B & D)

Pipework: PVC pipe & fittings, brass valves

Controls: Optional with single pump systems.
 Necessary with dual pump systems.

Pump Options: Single & dual pumps

Liquids: Raw sewage
 Trade waste
 Effluent
 Stormwater

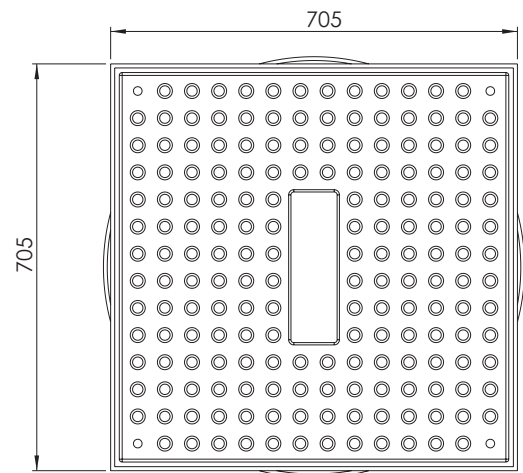
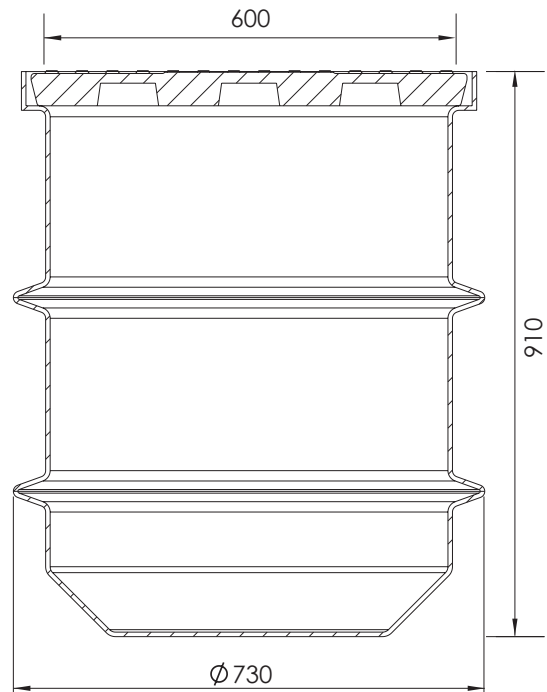

**PACKAGED
 PUMPING
 STATIONS**

Manufactured to AS1546.1-2008 & AS4766.2006
 NSW Dept of Health Approved

350L PUMPWELL

Pumpwell Material: Reinforced Polyethylene

Weight: 30kg (excluding pump)

Access Cover: 600mm x 600mm

Cover Types: Reinforced Polyethylene
 Cast Iron (Class B & D)
 Galvanised Grate (Class B & D)

Pipework: PVC pipe & fittings, brass valves

Controls: Optional with single pump systems.
 Necessary with dual pump systems.

Pump Options: Single & dual pumps

Liquids: Raw sewage
 Trade waste
 Effluent
 Stormwater

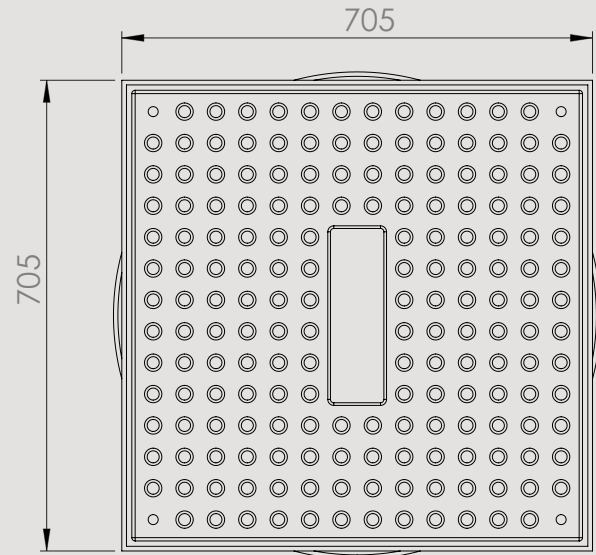
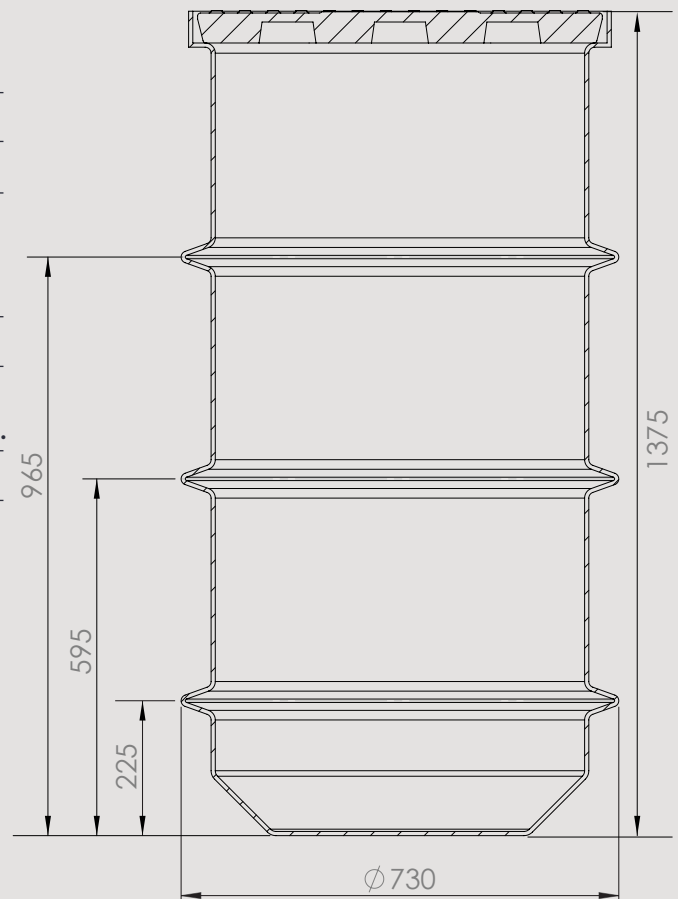

**PACKAGED
 PUMPING
 STATIONS**

Manufactured to AS1546.1-2008 & AS4766.2006
 NSW Dept of Health Approved

700L PUMPWELL

Pumpwell Material: Reinforced Polyethylene

Weight: 38kg (excluding pump)

Access Cover: 600mm x 600mm

Cover Types: Reinforced Polyethylene
 Cast Iron (Class B & D)
 Galvanised Grate (Class B & D)

Pipework: PVC pipe & fittings, brass valves

Controls: Optional with single pump systems.
 Necessary with dual pump systems.

Pump Options: Single & dual pumps

Liquids: Raw sewage
 Trade waste
 Effluent
 Stormwater

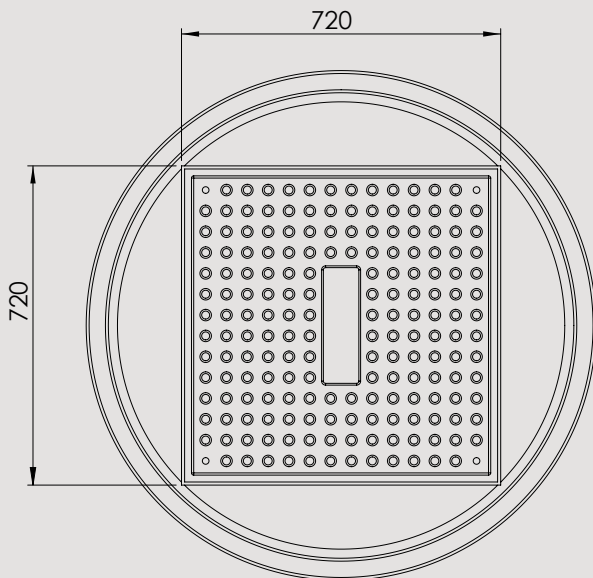
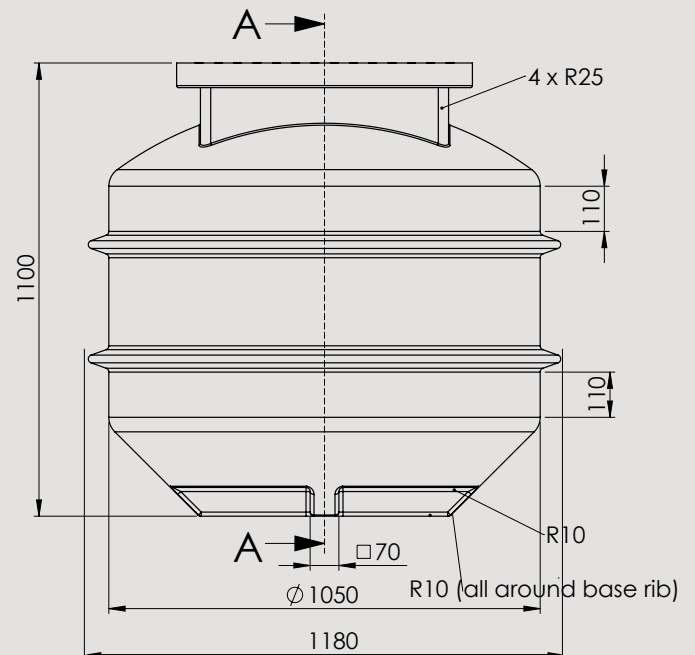

General Pump Company stocks a range of standard sized pumpwells ranging from 100L to 5000L. This means an 'ULTRAFLOW' packaged pumping station can be quickly assembled with single or dual pumps, guide rails if required, plumbing and switchgear and delivered to site in the shortest possible time.



**PACKAGED
 PUMPING
 STATIONS**

Manufactured to AS1546.1-2008 & AS4766.2006
 NSW Dept of Health Approved

1200L PUMPWELL

Pumpwell Material: Reinforced Polyethylene

Weight: 150kg (excluding pump)

Access Cover: 600mm x 600mm/900mmx600mm

Cover Types: Reinforced Polyethylene
 Cast Iron (Class B & D)
 Galvanised Grate (Class B & D)

Pipework: PVC pipe & fittings, brass valves

Controls: Optional with single pump systems.
 Necessary with dual pump systems.

Pump Options: Single & dual pumps

Liquids: Raw sewage
 Trade waste
 Effluent
 Stormwater

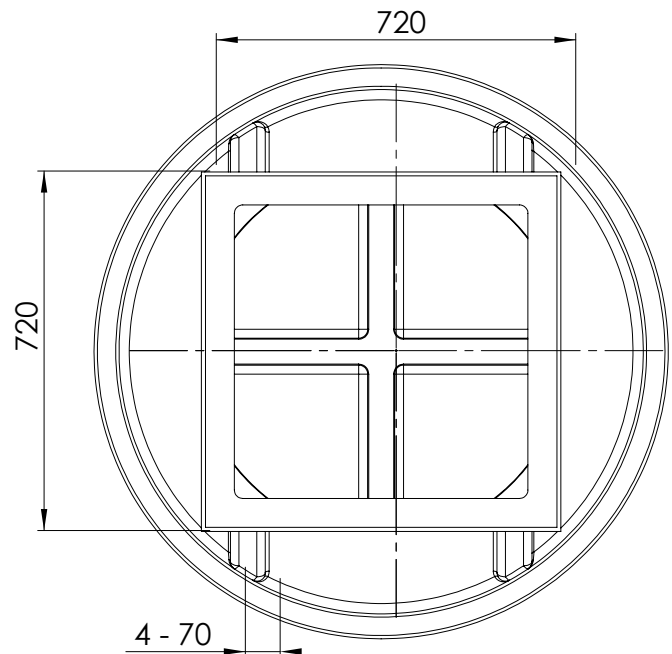
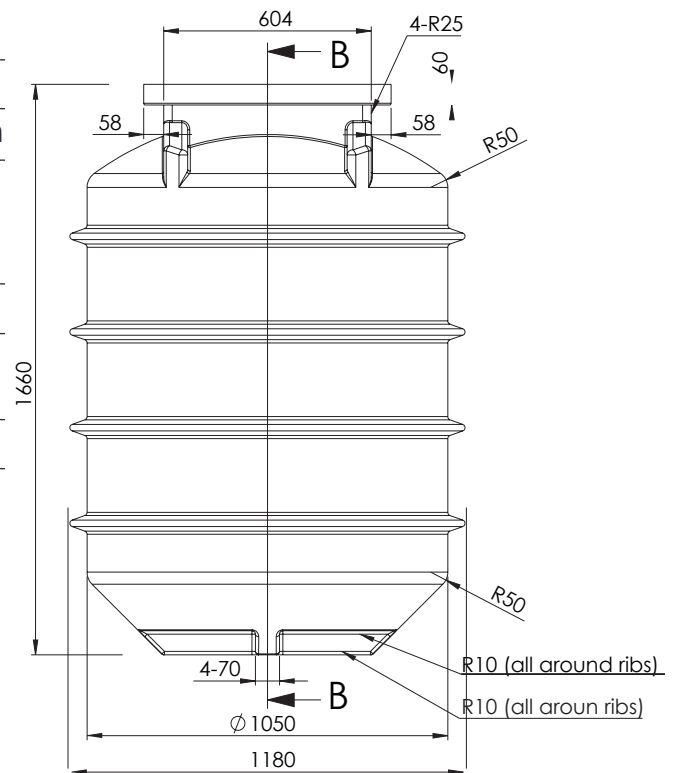

**PACKAGED
 PUMPING
 STATIONS**

Manufactured to AS1546.1-2008 & AS4766.2006
 NSW Dept of Health Approved



2000L PUMPWELL

Pumpwell Material: Reinforced Polyethylene

Weight: 150kg (excluding pump)

Access Cover: 600mm x 600mm

Cover Types: Reinforced Polyethylene
Cast Iron (Class B & D)
Galvanised Grate (Class B & D)

Pipework: PVC pipe & fittings, brass valves

Controls: Optional with single pump systems.
Necessary with dual pump systems.

Pump Options: Single & dual pumps

Liquids: Raw sewage
Trade waste
Effluent
Stormwater

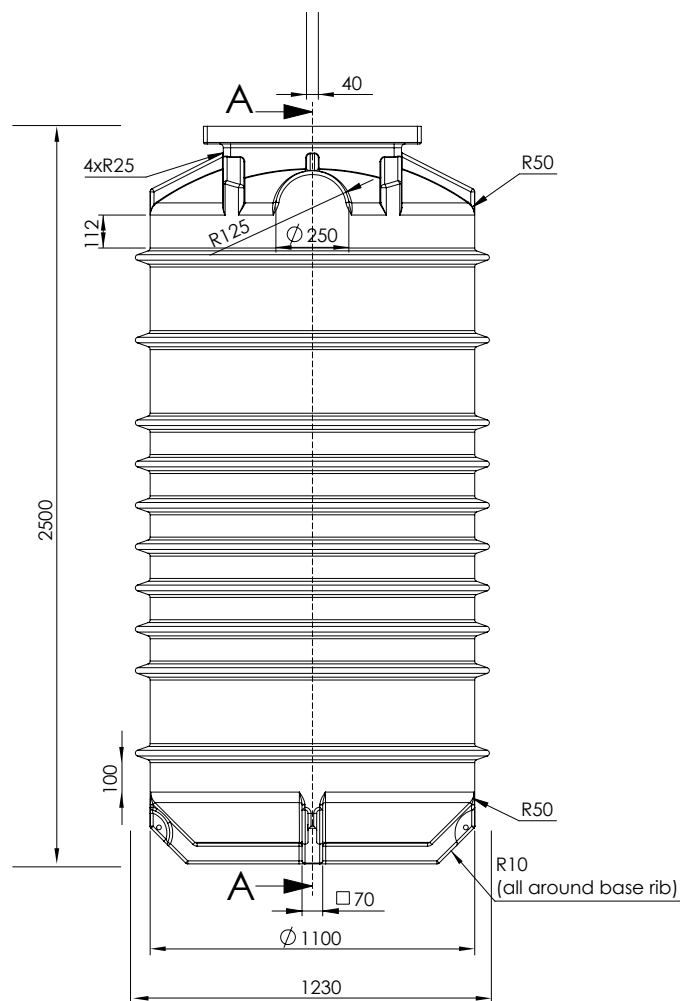
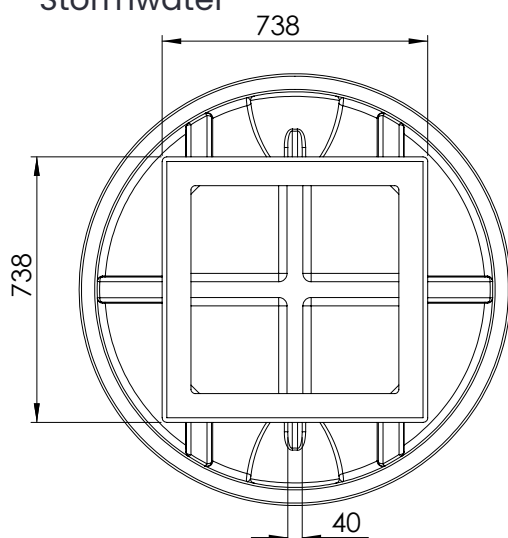

Manufactured to AS1546.1-2008 & AS4766.2006
NSW Dept of Health Approved

3000L PUMPWELL

Pumpwell Material: Reinforced Polyethylene

Weight: 180kg (excluding pump)

Access Cover: 900mmx600mm

Cover Types: Reinforced Polyethylene
Cast Iron (Class B & D)
Galvanised Grate (Class B & D)

Pipework: PVC pipe & fittings, brass valves

Controls: Optional with single pump systems.
Necessary with multiple pump systems.

Pump Options: Single, dual, triples, quad pumps

Liquids: Raw sewage
Trade waste
Effluent
Stormwater

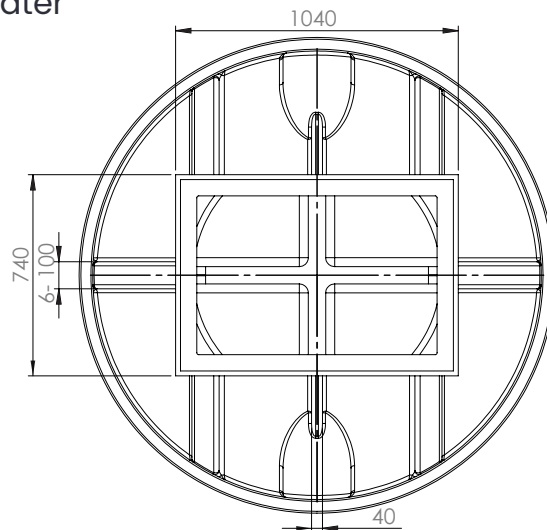
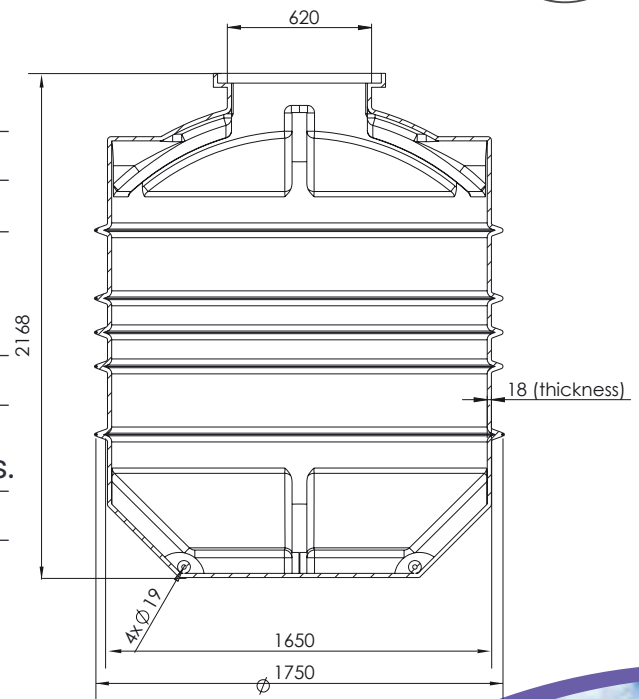

Manufactured to AS1546.1-2008 & AS4766.2006
NSW Dept of Health Approved

5000L PUMPWELL

Pumpwell Material: Reinforced Polyethylene

Weight: 250kg (excluding pump)

Access Cover: 900mmx600mm

Cover Types: Reinforced Polyethylene
 Cast Iron (Class B & D)
 Galvanised Grate (Class B & D)

Pipework: PVC pipe & fittings, brass valves

Controls: Optional with multiple pump systems.
 Necessary with dual pump systems.

Pump Options: Single, dual, triplex & quad pumps

Liquids: Raw sewage
 Trade waste
 Effluent
 Stormwater

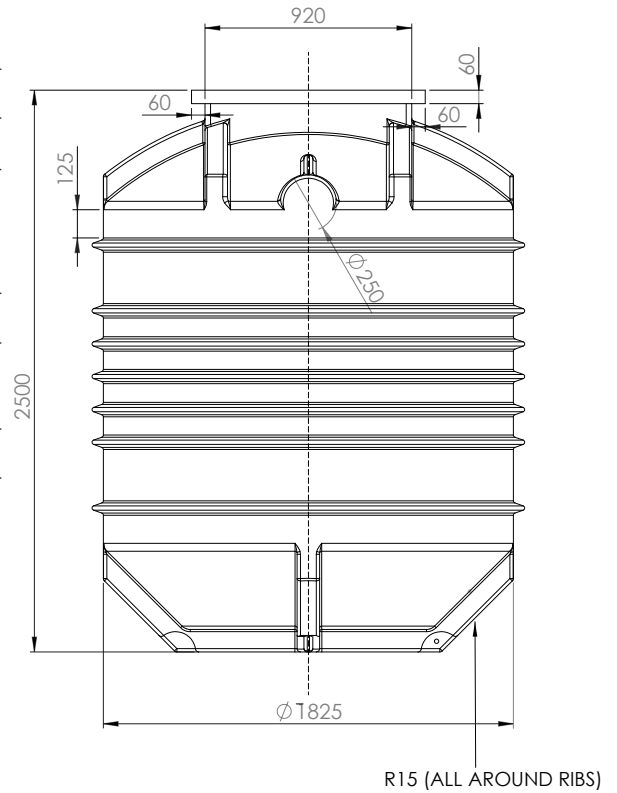

Manufactured to AS1546.1-2008 & AS4766.2006
 NSW Dept of Health Approved

REINFORCED FIBREGLASS PUMPWELLS

VERTICAL PUMPWELLS

"d" Internal Diameter Metres	"D" External Diameter Metres	"H" Overall Height Metres
0.6	0.7	0.6 – 2.5
1.0	1.2	0.9 – 4.0
1.2	1.4	1.0 – 10.0
1.4	1.6	1.5 – 10.0
1.5	1.8	1.5 – 10.0
1.9	2.2	2.0 – 10.0
2.1	2.4	2.0 – 10.0
2.4	2.7	2.5 – 10.0
2.8	3.1	3.0 – 10.0

VOLUME IN LITRES= ('d'÷2)² x 3.14 x'H'x 1000

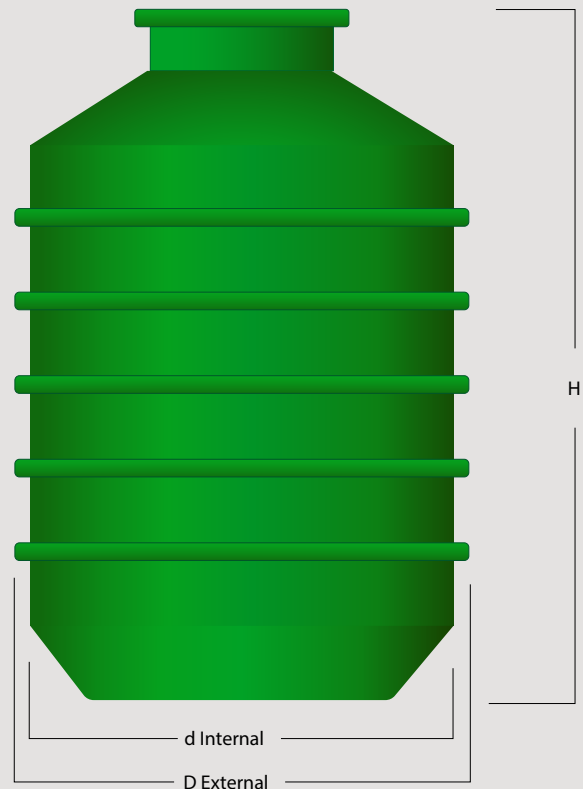

HORIZONTAL PUMPWELLS

"d" Internal Diameter Metres	"D" External Diameter Metres	"L" Overall Length Metres
0.6	0.7	0.6 – 1.0
1.0	1.2	0.9 – 4.0
1.2	1.4	1.0 – 10.0
1.4	1.6	1.5 – 10.0
1.5	1.8	1.5 – 10.0
1.9	2.2	2.0 – 10.0
2.1	2.4	2.0 – 10.0
2.4	2.7	2.5 – 10.0
2.8	3.1	3.0 – 10.0

VOLUME IN LITRES= ('d'÷2)² x 3.14 x'L'x 1000

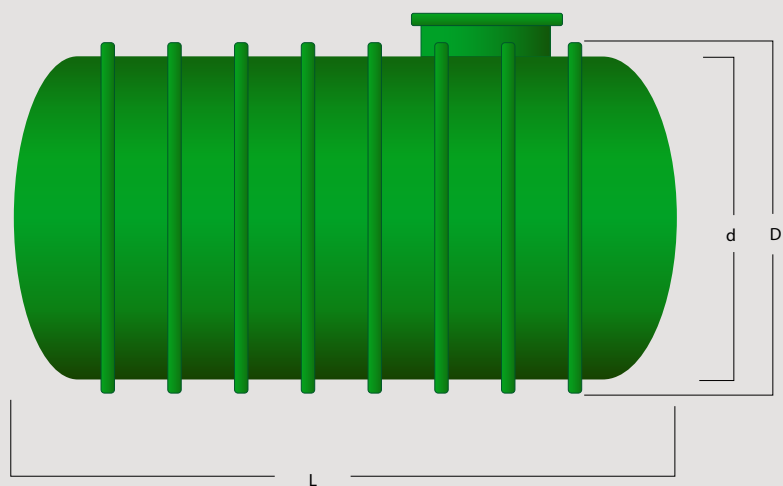

*The above tank options are available for above ground or water charged applications.

Manufactured to BS4994—1987, ASME RTP-1-2011 & AS2634-1983 standards

REINFORCED POLYETHYLENE PUMPWELLS

ACCESSORIES

Access Covers & Grates

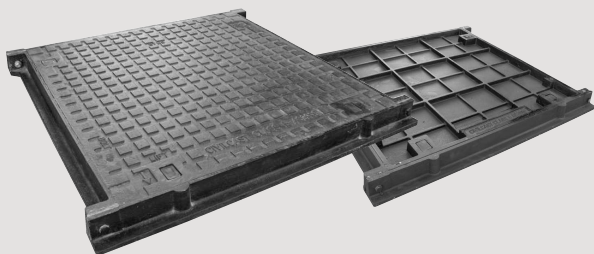

Concrete Infill & Solid Top Gatic Lids

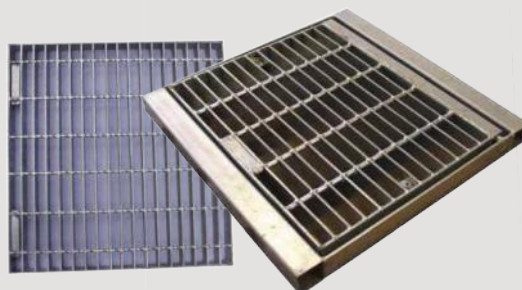

Metal Grate Lids

Risers for Polyethylene Pumpwells

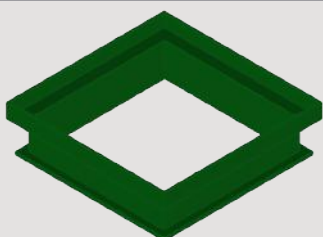

150mm for access 600mm x 600mm

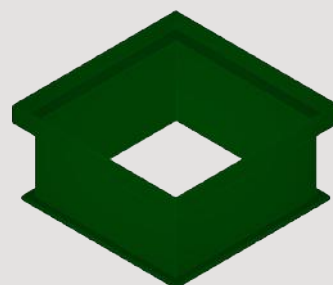

300mm for access 600mm x 600mm

*Other custom sizes available on request for Fibreglass pumpwells.

Pump & Pipework Configuration



Single Pump



Dual Pump



Guide Rail System

PACKAGED
PUMPING
STATIONS

CONTROLLERS & LEVEL SWITCHES FOR PACKAGED PUMPING STATIONS



Dual Pump Controllers



Premium Pump Controllers



Single Pump Controllers

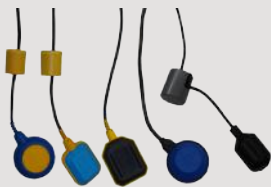

Float Level Switches



Level Probes

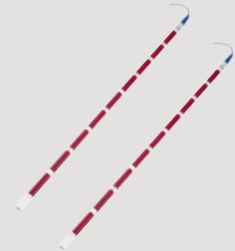

Multirode Probes

PUMPS FOR PACKAGED PUMPING STATIONS

DRAINAGE



LARGE DRAINAGE



HEAVY LARGE DRAINAGE



SEWAGE CUTTER



GRINDER



WASTE WATER VORTEX



General Pump Company can also provide pumps of your choice and specification. General Pump Company has been supplying and servicing pumps since 1975 and now represents more than 240 pump manufacturers from around the world. Some well known brands include:-

• ULTRAFLOW • FLYGT • GRUNDFOS • DAVEY • EBARA • TSURUMI • LOWARA • CALPEDA • ZENIT • PENTAIR • HOMA • SARLIN • FORRERS • ROBOT • KSB AJAX • E.I.M • SAKURAGAWA • ORANGE • And many other brands.

General Pump Company is also able to offer submersible pumps which are approved for Class 1 Zone 2 installations

CONSTRUCT



DELIVER



INSTALL



COMPLETE



"General Pump Company were able to supply the sewage pump station quickly using good quality and reliable equipment at a very reasonable price. Great guys to deal with, I will be definitely dealing with them again, and would recommend anyone to contact General Pump Company with their pump requirements."

G.B, Dural, NSW

"Thank you again for all your help with this project. I will certainly be using you again on any other projects that come up. Your service has been extremely professional and helped us successfully complete our project on time and within our budget. This is certainly a rare commodity these days."

Z.M., Buddina, QLD.



PACKAGED
PUMPING
STATIONS



We simply know pumps better....

General Pump Company are the leading domestic, commercial and industrial pump manufacturers in Australia. Family owned and managed, the business has grown over more than four decades from a small pump supplier in Sydney to a company that services a wide range of clients all over the world.



PACKAGED
PUMPING
STATIONS

1300 662 787 www.generalpumps.com.au sales@generalpumps.com.au

Head Office: 22 Sommerville Cct, Emu Plains NSW 2750