



The Baja® Wrangler® 2 is an FDA Class II Medical Device designed to aid individuals with mobility impairments.



**BAJAMOBILITY.COM**



# BAJA® WRANGLER® 2

Rugged and built to last, the Baja® Wrangler® 2 is everything you want in an outdoor scooter. Equipped with front and rear suspension, this aggressive scooter is designed for cruising on walking trails or driving around your property. Make your adventures legendary with the Baja Wrangler 2!

PROUDLY  
MADE IN  
**USA**  
of foreign and  
domestic parts

BA401

FDA Class II Medical Device<sup>2</sup>



**450 LBS.**  
WEIGHT CAPACITY

**21.4**  
MILE RANGE\*

**11.5 MPH**  
TOP SPEED\*\*

**94.75"**  
TURNING RADIUS

\* Range shown is with a user weight of up to 200 lbs. and with 100 AH batteries

\*\* Speed shown is at 200-lb. user weight

White Camo

Midnight Camo

Desert Camo

Orange Crush

Green Machine

True Blue







**BAJA WRANGLER 2**





Venture with confidence knowing you're equipped with the perfect blend of power and agility for all your journeys. An impressive ground clearance will get you through those rough spots with ease, and you'll be flying on flat terrain with a top speed of 8 mph. With a lithium battery that delivers a 29-mile range, the Bandit is built to keep you moving all day.

BA140

FDA Class II Medical Device<sup>1</sup>



**400 LBS.**  
WEIGHT CAPACITY

**29**  
MILE RANGE\*

**8 MPH**  
TOP SPEED

**53"**  
TURNING RADIUS

\*Range shown based on 40Ah lithium battery pack and user weight of 220 lbs. or less.

Black Camo

White Camo

Camo

Sage (matte)

Tan (matte)







**BAJA BANDIT**



# BAJA RAPTOR 2

## 3-WHEEL SCOOTER

The Baja® Raptor 2 3-wheel scooter champions speed and maneuverability. Reach speeds of up to 14 mph with a per-charge range of 31 miles. Experience ergonomic throttle controls and a fully-adjustable seat, which lets you adjust your ride and squeeze more fun out of your days in the open air.

BA300

NON-MEDICAL DEVICE<sup>2</sup>



**400 LBS.**  
WEIGHT CAPACITY

**31**  
MILE RANGE\*

**14 MPH**  
TOP SPEED

**60"**  
TURNING RADIUS

\*Range shown was calculated with a user weight of up to 220-lbs.

Candy Apple Red

Matte Black\*\*





The front shroud panel comes in seven colors. Order the **CANDY APPLE RED** model and receive the matching insert. Order the **MATTE BLACK** model (shown below) and choose any other color insert at no extra charge. Additional color inserts may be purchased as an accessory.



3 - WHEEL

**BAJA RAPTOR 2**



# BAJA RAPTOR 2

## 4-WHEEL SCOOTER

The Baja® Raptor 2 4-wheel scooter is built to handle it all (and then some) in signature style. With top-of-the-line features, unmatched speeds and best-in-class battery life, this sleek and sophisticated ride moves with ease. The boldest Baja yet, the Raptor 2 races onward and inspires new adventures.

BA340

NON-MEDICAL DEVICE<sup>2</sup>



**400 LBS.**  
WEIGHT CAPACITY

**21.2**  
MILE RANGE\*

**13 MPH**  
TOP SPEED

**92.5"**  
TURNING RADIUS

\*Range shown was calculated with a user weight of up to 200-lbs.

Candy Apple Red

Matte Black\*\*





The front shroud panel comes in seven colors. Order the **CANDY APPLE RED** model and receive the matching insert. Order the **MATTE BLACK** model (shown below) and choose any other color insert at no extra charge. Additional color inserts may be purchased as an accessory.



4 - WHEEL

**BAJA RAPTOR 2**



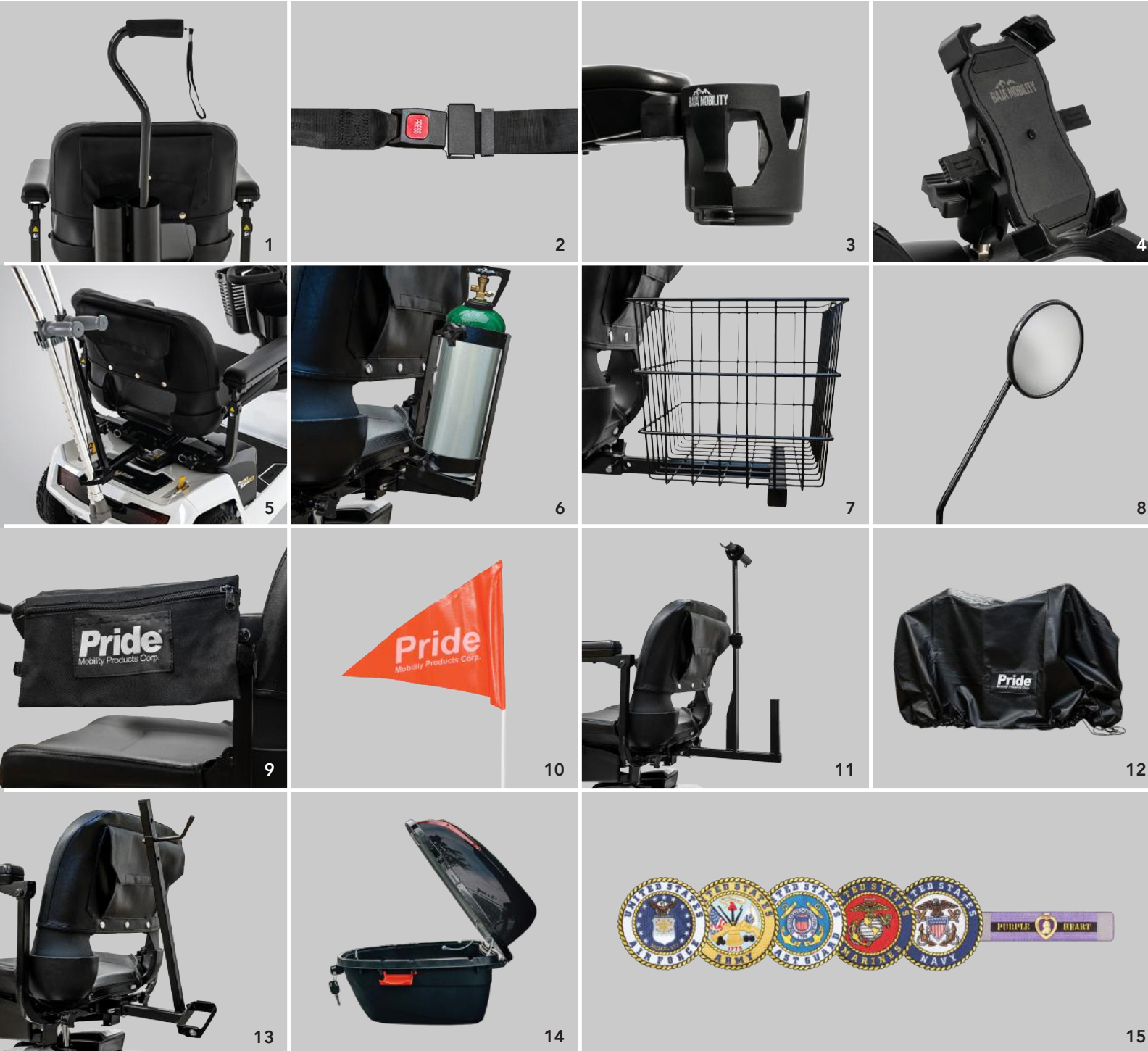

- 1) 3" single or double cane/crutch holder
- 2) 50/60/70" lap belt
- 3) Cup holder
- 4) Cell phone holder
- 5) Forearm crutch holder
- 6) Oxygen holder
- 7) Rear basket
- 8) Rearview mirror
- 9) Saddlebag
- 10) Safety flag
- 11) Walker holder
- 12) Weather cover
- 13) Wishbone crutch holder
- 14) Storage pod
- 15) Military patches

# ACCESSORIES

Cup holder, rear basket and saddlebag can be ordered as a bundle.

Only one rear accessory can be used at a time.



MODEL	WRANGLER® 2 (BA400)	BANDIT (BA140)	RAPTOR 2 3-WHEEL (BA300)	RAPTOR 2 4-WHEEL (BA340)
WEIGHT CAPACITY	450 lbs.	400 lbs.	400 lbs.	
MAXIMUM SPEED <sup>10</sup>	Up to 11.5 mph at 200 lbs. Up to 10.6 mph at 450 lbs.	Up to 8 mph at 400 lbs.	Up to 14 mph	Up to 13 mph
GROUND CLEARANCE <sup>4, 6</sup>	8.25" at mid-frame 5.5" at motor	1.57" at motor skid plate 2.68" at front bumper 4.45" at mid-deck	3.58" at mid-frame	
TURNING RADIUS <sup>4</sup>	94.75"	53"	59.64"	92.52"
LENGTH / WIDTH <sup>4, 5</sup>	Length: 61.25" Width: 33	Length: 49.6" Width: 27.83"	Length: 59.3" Width: 27.17"	Length: 62.2" Width: 27.17"
SEAT-TO-DECK HEIGHT	20.5-22"	18.11"	19.14"	
FRONT WHEELS (TIRES)	14.5" tubeless pneumatic	9.4" solid	16" tubeless pneumatic	
REAR WHEELS (TIRES)	14.5" tubeless pneumatic	9.4" solid	16" tubeless pneumatic	
SUSPENSION	Front and rear (CTS)	Front and rear	Front and rear	
RANGE PER CHARGE <sup>9, 10</sup>	75 AH: Up to 16.5 miles at 200 lbs. 75 AH: Up to 13.3 miles at 450 lbs.  100 AH: Up to 21.4 miles at 200 lbs. 100 AH: Up to 17.3 miles at 450 lbs.	20 AH Battery Pack: Up to 14.5 miles at 220 lbs. Up to 11.25 miles at 400 lbs.  40 AH Battery Pack: Up to 29 miles at 220 lbs. Up to 22.5 miles at 400 lbs.	Up to 31 miles at 220 lbs. at low speed  Up to 19 miles at 400 lbs. at full speed	Up to 21.2 miles at 200 lbs.  Up to 15.1 miles at 400 lbs.
TOTAL WEIGHT WITHOUT BATTERIES <sup>4</sup>	274 lbs.	162.6 lbs.	318.8 lbs.	341.8 lbs.
STANDARD SEATING	Black vinyl high-back with limited recline memory foam seat with sliders  Weight: 48.6 lbs. Size: 16"x16-18" or 18"x18-20"	Black vinyl stadium seat with sliders  Weight: 34.8 lbs. Size: 18"W x 17"D	Black vinyl limited reclining high-back with sliders  Weight: 45.6 lbs. Size: 20"W x 18"D	
DRIVE SYSTEM	24-volt DC motor, rear-wheel drive, dual in-line	Rear-wheel drive, sealed transaxle with 36-volt DC motor	Rear-wheel drive, sealed transaxle with 24-volt DC motor	
BRAKING SYSTEM	Regenerative and electromechanical	Regenerative and electromechanical	Regenerative and electromechanical	
BATTERIES <sup>7, 8</sup>	(2) 75 AH (100 AH optional) 75 AH weight: 48 lbs. 100 AH weight: 60.5 lbs.	Lithium-ion battery pack 20 AH weight: 20.8 lbs. 40 AH weight: 35.2 lbs.	(2) 12-volt, deep cycle, 75 AH Weight: 53 lbs each	
BATTERY CHARGER	8 amp, off-board	4 amp, off-board	8 amp, off-board	
HCPCS CODES	K0899 - power mobility device not coded by PDAC	K0899 - power mobility device not coded by PDAC	Non-medical device	
WARRANTY	Frame: lifetime limited Drivetrain: 2-year limited Electronics: 2-year limited Battery: 6-months	Frame: lifetime limited Drivetrain: 2-year limited Electronics: 2-year limited Battery: 3 years	Frame: lifetime limited Drivetrain: 2-year limited Electronics: 2-year limited Battery: 6-months	





800.800.8586 | [bajamobility.com](http://bajamobility.com) |      

1. FDA Class II Medical Devices are designed to aid individuals with mobility impairments.
2. This product is not a medical device and is not intended to assist, treat, diagnose, or alleviate any medical condition or disability.
3. Optional.
4. Due to manufacturing tolerances and continual product improvement, this specification can be subject to variance of + or - 3%.
5. Width of base (not including seat).
6. Does not account for anti-tip clearance.
7. Deep cycle (AGM or gel cell type recommended).
8. Battery weight may vary based on manufacturer.
9. Tested in accordance with ANSI/RESNA, WC Vol 2, Section 4 and ISO 7176-4 standards. Results derived from theoretical calculations based on battery specifications and drive system performance. Test conducted at maximum weight capacity.
10. Varies with user weight, terrain type, battery amp-hour (AH), battery charge, battery condition and tire condition. This specification can be subject to a variance of (+ or -) 10%.

NOTE: All specifications subject to change without notice.

The information contained herein is correct at the time of publication; we reserve the right to alter specifications without prior notice. Speed and range vary with user weight, terrain type, battery charge, battery condition and tire pressure. Due to manufacturing tolerances and continual product improvement, length, width, turning radius and ground clearance can be subject to variance of + or - 3 %. Dimensions listed are for scooter only. Overall measurements will vary based on seating and accessory selections.

HCPCS codes provided should not be considered as legal advice and do not guarantee reimbursement. DME providers are responsible for determining appropriate billing codes when submitting for insurance reimbursement.

