

# FLOODED

## HIGH PERFORMANCE & RESISTANCE



### TECHNOLOGY

**FDC Series** are Deep Cycle liquid electrolyte batteries specifically designed for **intensive use** in industrial or leisure applications such as golf carts, cleaning machine, and aerial work platforms. Their robust construction featuring thick positive and negative **grid plates** made from a special alloy provides high resistance to deep cycling, **low self-discharge**, and a **long reliable service life** even under demanding operating conditions.

### GENERAL INFORMATION

- » **Technology:** *Flooded Lead-acid (Flat Plate)*
- » **Available voltages:** *6V, 8V, 12V*
- » **Capacities from:** *120Ah to 344Ah (5hr)*
- » **Cycle life:**
  - *Up to 800 cycles at 80% DOD\* (50% capacity @20°C)*
  - *Up to 1100 cycles at 50% DOD\* (50% capacity @20°C)**\*Depth Of Discharge*
- » **Case material:** *Polypropylene*

### FEATURES

- » **Excellent deep-discharge resilience:** *longer life under frequent deep cycles*
- » **Low-maintenance design:** *fewer service interventions*
- » **Lead-alloy terminals:** *high vibration resistance*
- » **Reinforced grid plates:** *improved cyclic performance*
- » **99.9% pure lead negative plates:** *better deep-cycle capability*
- » **High charging efficiency:** *shorter charge times*
- » **Low water consumption:** *reduced maintenance and lower runaway risk*
- » **Reliable in harsh temperatures:** *stable performance in extreme conditions*
- » **Low self-discharge:** *longer shelf life*

### APPLICATIONS



DESIGNATION	P/N	BOX SIZE	VOLTAGE (V)	CAPACITY Ah (20hr)	CAPACITY Ah (5hr)	RESERVE CAPACITY (min)		DIMENSIONS (+/- 2 mm)				POLARITY	TERMINAL
						@25A	@75A	L	W	H	Total Height		
FDC-605	593001	GC2	6	210	175	383	105	259	179	245	276	⎓ +	EHPT
FDC-105	593002	GC2	6	225	185	447	115	259	179	245	276	⎓ +	EHPT
FDC-125	593003	GC2	6	240	195	488	132	259	179	245	276	⎓ +	EHPT
FDC-305	593037	902	6	330	271	711	195	296	176	343	366	⎓ +	DUAL
FDC-L16	593036	903	6	420	344	850	220	296	176	402	425	⎓ +	DUAL
FDC-875	593005	GC8	8	170	145	295	75	262	181	245	276	⎓ -	EHPT
FDC-1275	593007	GC12	12	150	120	280	70	329	181	245	276	⎓ -	EHPT

## TERMINAL CONFIGURATIONS

Ø5/16"

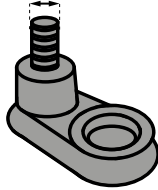

**EHPT**

» Terminal height: 38mm

» Torque values: 11-12nm

Ø6.6mm

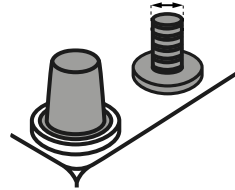

**DUAL**

## CYCLE LIFE

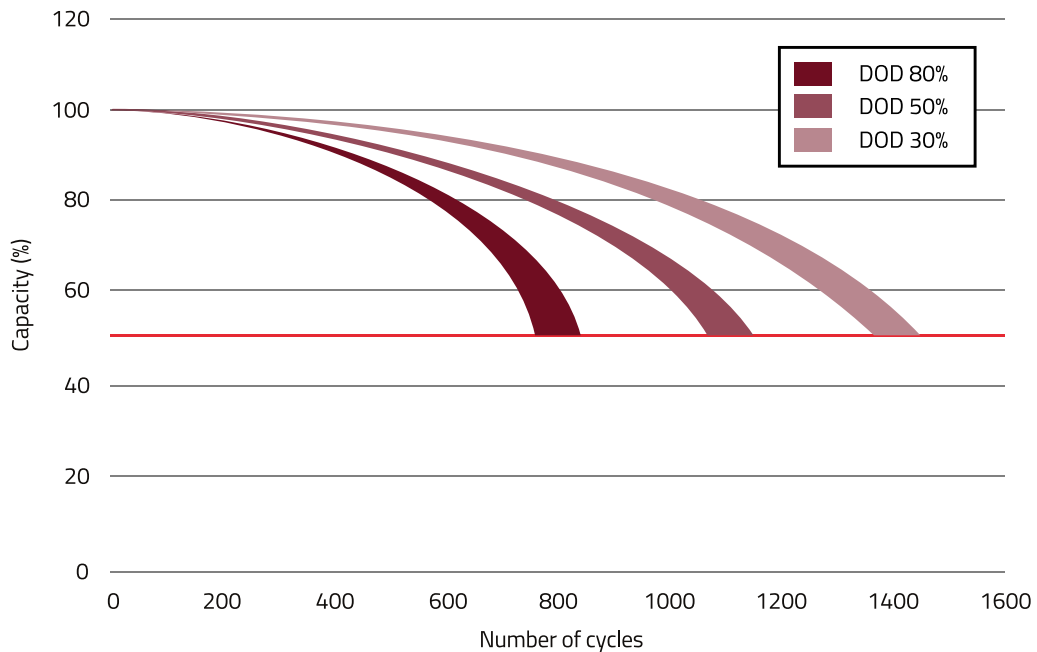

## WATERING KIT



» Available for GC2, GC8 and GC12 batteries: see page 14