

Winchelsea Star

Price \$1



Your Weekly Community Newspaper

Since 1977

Vol 46 Ed 26

Tuesday 11 July 2023

winchelseastar.org.au



Lions Changeover

The Winchelsea Lions Club new committee (L-R): David Yandell, Don Smith, Graham Kenafacke, Karen McPherson, Raymond Van den Brandt, Murray Aisbett, Sam Inglis

by Linda Carter

The Winchelsea Lions Club held their Changeover Dinner to welcome a new president and committee.

Over 50 members and guests enjoyed the delicious roasts by Libby and her catering team and a very friendly and happy atmosphere prevailed over the whole evening.

Zone Chairman Allan Osmand presented 30 year chevrons to Murray Aisbett and Alan Maxwell, a 15 year chevron to Linda Carter and Annie Coles a 10 year award.

Murray Aisbett presented his outgoing report saying how much he had enjoyed his 3 years as President and some of the Lions activities such as paper recycling and sheep poo. He gave a special thank you to David and Trevor and Laurie Davey for helping with loading the paper.

Other activities included BBQ's at Bunnings and IGA, and helping the community and the RSL with Anzac and Remembrance days, the community expo and many other events. Murray also thanked the partners for their support and noted all members contribute in their own special ways.

He wished incoming President Sam well to capably take the club forward.

Installing Officer Robbie Clark, himself a Lion of 40 years, installed Sam Inglis as new President and his team of officers, some old some new.

Sam in his opening address said how proud he was to be elected President and wished the club success in the way forward.

Winchelsea Lions Club continues to grow with new members and exciting new projects.

See more photos inside, P3

SURF COAST

ARTS Trail

SAT 5 - SUN 6 AUGUST 10AM - 4PM



Image: Artist Lauren Barton, Bellmore Clay

CHECK IN AND WIN!



Pre-register for the Surf Coast Arts Trail for the chance to win one of three \$250 prizes* and be the first to receive the Arts Trail Map to start planning your weekend.

Scan the QR code at each studio you visit to 'check in' and you will gain another entry in the draw. The more studios you check in to, the more chance you have to win.

*Closes 5pm 6 Aug, 2023. Drawn on Aug 16, 2023. Winners notified by email. Prizes includes 3 x \$250 prepaid eftpos gift cards. See website for extended T&C's

@surfcoastartmatters | surfcoastartmatters.com.au



Have your say on our draft Climate Emergency Action Plan 2023-25

Council's draft Climate Emergency Action Plan 2023-25 has been developed to continue delivering on our Climate Emergency Response Plan commitments.

We welcome your feedback on the draft Action Plan, especially the actions that have more interaction with our community.

View the draft action plan and provide feedback at: surfcoast.vic.gov.au/CEAP.

Submissions close Sunday 30 July 2023.

To access a hard copy of the above document or submission form, contact us at surfcoast.vic.gov.au/request or call 5261 0600.

M&B WOOD PLUMBING

Call Matt - 0418 319 357
mbwoodplumbing.au

Servicing Winchelsea & surrounds

- General maintenance & blocked drains
- Gas fitting & hot water service upgrades
- New homes & renovations

- Domestic and Commercial hire equipment
- Industrial welding gas
- Digging and Earthmoving equipment
- New trailers and trailer repairs
- Firewood
- Stockists of Royal Oil Lubricants products
- LPG for domestic and commercial requirements

Give Chris and the Team a call on 5232 1177 or email info@colachire.com.au
www.colachire.com.au
 101 Wallace St Colac 3250

CHOOK RUN
 Chooks/Pullets For Sale
 Delivering to Winchelsea
 Hopkin Street, Eastern Reserve
 26 July
 Sexed and Vaccinated - Hyline Brown
Kelvin 0400 559 559
BALLARAT CHOOKS

All your caulking & waterproofing needs
 • Bathrooms (tiles, mirrors, vanities, bathtubs, shower)
 • Kitchens • Flooring (skirtings, tiles, floorboards)
 • Splash Backs • Pool Joints • Brick Work
 • Expansion Joints
 Phone/Text/Email: luke@westcoastsealants.com

LUKE BATH
 CAULKING CONTRACTOR
 0406 845 098
westcoastsealants.com
 PROVIDING QUALITY WORK SINCE 1995

YOUR advert here??
 Contact
 advertising
 @winchelseastar.org.au

Chiropractic - Remedial Massage - Myotherapy - Sound Healing - Breathwork

Chiropractic care for:

- Stress & Anxiety
- Body Aches & Tension
- Poor Sleep
- Pain Management
- Family Wellbeing
- Health Longevity

03 5267 2240 Shop 4/21 Hesse St Winchelsea <https://onebodychiropractic.com.au/>





Clockwise from top left;

Zone Chairman Allan Osmand presents 30 year chevron to Alan Maxwell

Allan Osmand presents 10 year chevron to Annie Coles

Allan Osmand presents 30 year chevron to Murray Aisbett

Allan Osmand presents 15 year chevron to Linda Carter



Murray Aisbett hands over Presidency to Sam Inalis



Hullo From Our Police Officers

Sergeant Troy Morrow:

My name is Troy, but at the office they call me "Moz". I've come from a busy metropolitan police station where I was a detective managing the Criminal Investigation Unit. I'm now enjoying my time at Winchelsea as the officer in charge and am enjoying the overall reduction of crime in town. In my spare time, I like to coach a local footy team, as well as go to Geelong Cats footy matches. I also enjoy riding my motorbike during the warmer months.



Leading Senior Constable Shayne McTigue:

My name is Shayne, but the other members call me "Tigga". I have been

working at Winchelsea for about a year now but have 30 years' experience in and around the Geelong Region. I came here to help deliver a better

service to a smaller community. In my spare time I like to help at my local suburban footy team and enjoy travelling to exotic locations around the world.

Leading Senior Constable Trent Mellington:

My name is Trent, nickname "Mello". I've been working at Winchelsea for 3 years now and have over 20 years' experience in and around the Geelong and Surf Coast Region. I grew up locally and have enjoyed being back and policing the local community. Hobbies include riding motorbikes, tennis, football, camping and travel.

Leading Senior Constable Clayton Schmidt:

My name is Clayton, but I'm more often referred to around the office as, "Schnitzel", which is either due to my surname, or my deep appreciation of chicken meat. I've been working at Winchelsea for 3 years also, and I too have come to appreciate the sense of community in Winchelsea. When I'm not working, I enjoy riding motorbikes, following various sports from around the world, and am also partial to travelling the world.

Senior Constable Aimee Ward (not pictured):

My name is Aimee, but around the office am known as "Wardy", I work part time at the present as I am enjoying motherhood with my 15 month year old daughter. I am a passionate Demons supporter who enjoys serving the local community.

How is the high cost of living affecting you?

The team from Sarah Mansfield MP's office will be visiting Winchelsea on **Wed 19th July** from 2pm to 4pm to hear from you!

Winchelsea IGA

SARAH MANSFIELD MP
MEMBER FOR WESTERN VICTORIA

@sarahmansfieldgreens @sarahmansfield
sarah.mansfield@parliament.vic.gov.au 03 5222 1941

Moriac Veterinary Clinic
0447 781 089
PHONE 24 HOURS
784 HENDY MAIN ROAD MORIA
info@moriacvet.com
www.moriacvetclinic.com.au
HOURS // Monday - Friday: 8am - 5pm



Winchelsea Community Action Plan Released

by Tony Phelps, working group

The working group for the Winchelsea Community Action Plan (CAP), under the guiding hand of the project coordinator, has put together the results of the last few months of community input, discussion and consultation. This means the CAP moves to the next stage - where interested individuals and groups with a passion for a particular project or item can start to unpack what's actually entailed in making it happen.

The CAP will be presented to Surf Coast Shire Council (officers and Councillors) at a Briefing on August 8th, however, that is certainly not the objective of this whole project. Winchelsea now has a list of issues, projects and ambitions that reflect what residents are calling for, and it is up to the community to get involved as appropriate to get the ball rolling. There has been a fascinating mix of suggestions and ideas - from the quick & easy through to long-term major infrastructure.

Some items in the list are in fact already underway - for example, directly as a result of people's wish for the

Winchelsea Carols to be resuscitated this year, it looks like that is indeed going to happen. Is that something you'd like to be involved with? Volunteers are needed to assist with the organising of a significant event, from market stalls, through a PA system, to setting the program. Someone will even need to get in touch with the elves to make sure Santa turns up with a stash of lollies to give out.

Other items have been bubbling away in the background for quite some time. The Growing Winchelsea volunteer organisation has a particularly strong interest in ensuring that the town's various developments aren't left to head off in their own directions but rather follow guidelines that retain the 'feel' of Winchelsea that we enjoy now as a place to live, work and play. An example is the Growing Winchelsea subcommittee that was formed to follow through on the replacement mud-hut building after the non-consultative debacle of the initial design. Another example is the Growing Winchelsea subcommittee pushing along the Winchelsea Arboretum Trail project to beautify and link walking paths across the town - with significant wins under their belt already, more is actively planned over the coming months. Find out more about Growing Winchelsea at growingwinchelsea.com



The Winchelsea Community Action Plan includes an umbrella Community Vision and 6 key themes that fall under it. Each key theme has its own goals and its own list of priority projects plus additional project ideas - all received through the Winchelsea community. It's important to note that whether a project is 'priority' or not isn't overly important because any project will only progress if locals want it to and get together to make it progress.

While we sort out a suitable home to make the CAP accessible to all anytime online, we can send it to you via email. Just send an email to CommunityPlan@winchhouse.org.au with a Subject of "Plan please".

Look out for more about the Winchelsea Community Action Plan over the coming weeks - right here in your local community newspaper! You can also follow the CAP Facebook Page at facebook.com/winchelseacommunityplan



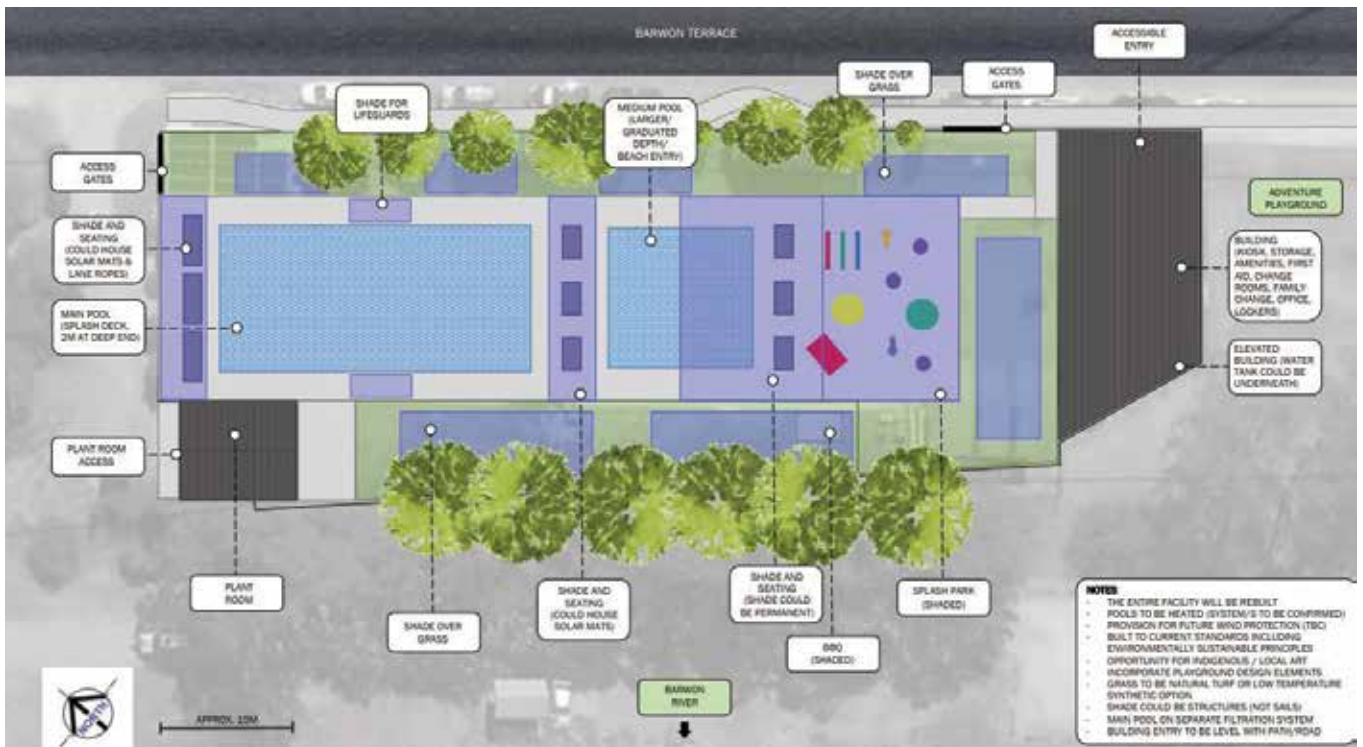

CONCEPT DESIGN

Pool redevelopment proceeding

Redevelopment of Winchelsea Pool is ready to start following awarding of the design and construction contract.

Council resolved at its June meeting to award the contract to Bowden Corporation, providing a green light for the provision of renewed aquatic facilities for the town and region into the future.

Detailed design will proceed across several months, with construction planned for completion during the 2024-25 summer.

The much-loved existing pool has reached the end of its serviceable life after having provided summer fun for families and visitors since 1963.

The redevelopment will include:

- Demolition and removal of the existing pools, pump house, amenity and shade structures and concrete concourses.
- Replacement of 25-metre and leisure pools.

- Replacement of concourses, pool surrounds and drainage systems.
- Construction of a zero-depth splash park, with elements to be confirmed.
- Construction of a new plant room and amenities building incorporating kiosk, first aid, and office.

The redevelopment will occupy the same space on Barwon Terrace, but include the new splash park, and the amenities building will be relocated to the south-east of the site to create a more central entry point and better connection with the adjoining Adventure Park.

Input from earlier community engagement and a Community Reference Group will inform detailed design, and updates will be shared as the design process progresses.

surfcoast.vic.gov.au/winchprojects





Kim Waite and Jody Smith admiring Vee Anscombe's crocheted bedspread under construction. Each 'tile' takes 2-3 hours to complete.



Kim Waite and Jody Smith admiring Vee Anscombe's crocheted bedspread under construction. Each 'tile' takes 2-3 hours to complete.

Textile Exhibition At Shire Hall

Jill Evans

Community Developer, Winchelsea Shire Hall

Come and enjoy a transformation of the Shire Hall this weekend and next weekend. Talk to the makers, learn about their craft. Share your enthusiasm for these skills that we want others to learn.

Open each day from 10 - 2, gold coin donation.



Jocelyn from Chile and Judy from Birregurra were impressed with the beautiful quilt by Sandra Walter

Editor: You can chat to the exhibitors, some of whom will be demonstrating their work, which includes crochet, patchwork, quilting, knitting, twining, bobbin lace, wool spinning, scrap booking and much more. I think you will be as impressed as I was with skills on show!



Winchelsea Star

contact us

FREE SUBSCRIPTION

winchelseastar.org.au

ADVERTISING

advertising@winchelseastar.org.au 0408 102 802

600 online subscribers,
250 copies printed for outlets around Winchelsea

NEWS

Email news@winchelseastar.org.au
Leave hard copy at IGA Supermarket

ARTICLES ARE MOST WELCOME

Include name and address of the sender

DEADLINES FOR ARTICLES

5pm Fridays
4pm Sundays hard copy articles left at IGA
6pm Sundays online sports results and weekend events

follow us

ONLINE

winchelseastar.org.au

FACEBOOK

facebook.com/TheWinchelseaStar

PRODUCTION

Editors:	Cerrie Fogan, Yvonne Stevens, Judy Cameron
Advertising:	Sasha Gauntlett, Neil McInnes
Layout:	Susan Corby, Tony Phelps
Printing:	Winchelsea Community House
Website:	Winch Websites

COMMITTEE

President:	president@winchelseastar.org.au Mick O'Mara
Treasurer:	treasurer@winchelseastar.org.au Cathy Cheadle
Secretary:	secretary@winchelseastar.org.au Tony Phelps
Members:	Linda Carter, Sasha Gauntlett, Neil McInnes, Judy Cameron, Yvonne Stevens, Cerrie Forgan,

© Winchelsea Star Org. Inc. All rights reserved
Winchelsea Star Organisation Inc.
Reg. No. A1479, ABN: 57 207 411 958
winchelseastar.org.au PO Box 5, Winchelsea, 3241
Views expressed are not necessarily those of the
Winchelsea Star or its Committee. The Winchelsea
Star reserves the right to edit or not publish any article.



You can write for the Star

We want the Star to inform, engage, inspire, & interest the residents of Winchelsea and surrounds. And we need your writings to get there.

The Star has no actual reporters or designated writers - we publish what you send us. If you have some news, an opinion, an interest or perspective, or a story - we'd love you to send it in for publication.

The Star loves to hear anything of direct interest to the Winchelsea community. The more local content we can put in, the better!

How much can I write?

You can write just one article. You can start a new column about something you're interested in. You can send us a series of articles following a theme. What would **you** write about?

Your article can spread over 1 or 2 pages (approx 850 words), or you can write longer pieces and split them across multiple editions.

Add a photo or two, an article title and author's name (preferably).

Can you publish my photos?

A picture is worth a thousand words - but context is very interesting too! If you've taken a photo you'd like in the Star, add a few words describing where, when, who, why and/or what.

Ask permission to use photos

When you send us a photo, you give us implied permission for reproduction.

You have liability when publishing an image, so be sure you own the image or have written approval to use it. It is easy for copyright owners to find stolen images online, where the Star can be found.

Legalities

Our Editors will not approve anything libellous (ie. when a false statement is published in written form and does harm to a victim). The Star is a community newspaper - 'for' and 'against' opinions on contentious topics are welcome, but attacking individuals or groups is not.

We look forward to hearing from you.
Simply email editor@winchelseastar.org.au

Parents Behaving Badly

The W.F.N.C. Inc has received several memos through the Club Junior Football Coordinator and Secretary in regards to Junior parents behaving badly in Football and Netball across the B.F.N.L., G.D.F.N.L, and the G.F.N.L.

The Codes of Conduct in these Football and Netball Leagues are clear in regards to the attitude and treatment toward these Volunteers, and to those who have paid positions, they include Coaches, Trainers, Umpires, Club Committee and Club Members who have jobs to do at training times and on Game Days.

Abuse, intimidation, presenting in areas where only those who have a commitment on the day need and should be such as Coaches and Trainers/First Aid personal cannot be tolerated.

Our Winchelsea Blues Football and Netball Club has great supporters, sponsors, volunteers second to none, Life Members who continue to contribute to the club and we have achieved great comradeship within the ranks of the Senior Footballers and Netballers. Junior Netball has never been stronger in all areas, Junior Football has started with the rebuild for the Club. Again, this is due to the likes of Mark Sostheim and the Auskick parents, Lachie Kendall and Byron Mathison who volunteer their time and are encouraged by Junior parents who wish to see their children in a Navy Winchelsea Blue Jumper, we are in a great position as a Club to move with the township and community as it grows in numbers over the next 10 years. Let's all continue to work hard to keep it that way !!

WHO ARE THE WINCHELSEA BLUES ?? WHO IS THE CLUB?

YOU ARE.

PLAYERS PAST AND PRESENT, PARENTS OF JUNIOR PLAYERS, SUPPORTERS,

VOLUNTEERS, COMMITTEE PAST AND PRESENT, LIFE MEMBERS, SPONSORS,

SOCIAL MEMBERS,

WE ARE ALL THE WINCHELSEA BLUES!

Let's continue to be proud of who we are and what we are trying to achieve.

Communication is key to allowing the Club to evolve in the very best way it can for all players, members and volunteer coaches, umpires etc.

The issues of appalling behaviour coming through to the Club can only reinforce how sad it would be if the W.F.N.C. were forced to implement bans for any of the issues other Clubs have had to deal with.



There are clubs such as in the Essendon District Football and Netball League who are engaging Match Day Managers to control "exclusion areas" around Umpires, Coaches and Trainers. Yarra Valley and Frankston Football and Netball Leagues also have these Match Day Managers . These are Volunteers who could be doing other work on their Game Days.

The Winchelsea Football & Netball Club Committee welcomes written feedback/suggestions from Club members, parents, volunteers and supporters. Constructive opinion is a vital part of any organisation, be it sporting or otherwise.

All such written feedback should be channelled through the Secretary, at present - Janet Fletcher,

e mail – janet_daintree@yahoo.com.au , mob: 0400 783 408.
Club postal address is W.F.N.C., PO Box 56, Winchelsea. 3241.

GO BLUES!



Winchelsea Land and Rivercare

Planting time
Come and give a hand.

**First Saturday of the month
9am – 10.30**

August 5th

Meet at Guye Reserve,
Barwon Terrace

Come and join us,
all helpers welcome

OZ TREES NURSERY & TREE PLANTING SERVICES

- Affordable seedlings—over 200 species
 - Complete plantation service—farm forestry, shelter, aesthetics
 - Deep ripping & mound ploughing. Rotary bed forming
 - Our experienced staff will help you select species for your site conditions and needs
- Also available—tree planting tools, milk cartons, plastic tree guards & bamboo stakes

569 Warrowie Rd. Colac
P: 5233 6280 F: 5233 6393
E: info@oztrees.com.au
W: www.oztrees.com.au
Open Monday—Friday
9am—4:30pm



Phone OzTrees for professional advice,

MRP Steelworx

Matthew Partridge
p 0418 672 334
e mrpsteelworx@yahoo.com.au

Welding Service

- Onsite welding
- Farm maintenance
- Farm machinery & equipment repairs
- Cattle & sheep yards
- Custom built trailers
- Supply & install gates

Plasterer & Painter

Daryl Hecker

Domestic & Commercial
Renovations & Repairs
Suspended Ceilings
Dustless Sanding
New Homes
Extensions



Ph 0419 194 799

direct TEMPORARY FENCING

FOR HIRE - SUPPLIED & ERECTED - 7 DAYS
GEELONG - BELLARINE - COLAC - SURF COAST
PHONE CAM 0417 310 800

DownRyte Excavations



- Excavations
- Drilling and Piling
- Rock Placement
- Tree and Stump Removal

Sean Hunwick
Mobile: 0409 447 288
Email: downryte@activ8.net.au

CONCRETER

Alister Aitken

No job to big or small

- Driveways - Carports - Crossovers - Footpaths - Sheds Slabs - Colored Concrete - Concrete sealing - Exposed Aggregate - & more -

Call or text for a no obligation free quote

Servicing our local Winchelsea & Surrounding Areas

alaiken.aa@gmail.com or Alister - 0411 871 950

A.B.N 47 228 574 460

B & H Modifications Bob Verity



55 Stephenson Road
Winchelsea 3241
Ph: 5267 2467
Mobile: 0411 610 678

Industrial Sewing Machine Work

Caravan Annexes, Trailer Covers,
Shade Sails, Alterations and
Repairs to
Camping and Tents.
Clear PVC Blinds
Repairs to CLEAN Horse Rugs
No Job Too Small
Email: bobverity@southernphone.com.au

WINCHELSEA CONCRETING

• Driveways • Sheds • Decorative Concrete • Raft Slabs

Robert Murphy

☎ 0438 235 237

✉ winchelseaconcreting@outlook.com

Knuckey's Winchelsea Ph: 5267 2011

Knuckey's have in stock a complete range of batteries to suit tractor, heavy machinery, cars, utes

The largest range of the best oil for your vehicles—**CASTROL**—
'when only the best will do'

The largest range of V belts.
A, B, C, D M Sections
Bolts and nuts for all occasions
Steel cut to size

Anglesea Players

This is the last chance to see the Anglesea Players production of "Shadows of Angels", before they take the show to the Edinburgh Fringe Festival.

Where: Lorne Community Connect

When: Saturday 22 July: Matinee 3-4 pm
Evening 7-8 pm

Set in the city slums of 1920s Australia and based on true events, 'Shadows of Angels' sees four women recollect the part each played in a crime on one hot, volatile day.

The horrific event set in motion an investigation and opened up a mystery from the past that connected these four very different individuals. 'Shadows of Angels' explores the desperate lives and dangerous minds of female criminals, challenging ideas of gender, sexuality, poverty and crime.

Featuring Fleur Murphy's poetic language, a live original score performed live by Kirstin Honey, and masterful direction by Iris Walshe-Howling and Janine McKenzie.

Purchase tickets at trybooking:

<https://www.trybooking.com/CIMTE>

OR

Lorne Community Connect – Door Sales

If ticket prices are a barrier to coming to the show, please contact the event organiser.



THOUSANDS TO 'BAND TOGETHER' FOR ROAD SAFETY ROUND

Victoria's football and netball communities will rally behind road safety this week, donning blue armbands to honour people killed on Victorian roads and affirm a shared goal to reduce road trauma.

The fourth annual initiative running across the state from July 21-23 will see thousands of Victorians from country and suburban football and netball leagues 'Band Together', wearing blue armbands to honour those lives that have been touched by road trauma and to promote road safety in their communities.

Players, coaches, volunteers and supporters from more than 1000 AFL Victoria-affiliated clubs will wear the bespoke armband, which features a QR code linking people to an online hub of stories from people affected by road trauma.

This year, 165 people have been tragically killed on Victorian roads with road deaths in regional areas a continued concern with 94 fatalities this year compared to 73 at the same time in 2022.

The number of young Victorians aged between 21 and 39 who have died on the roads has risen by more than 20.

The TAC and AFL Victoria's Road Safety Round provides the perfect platform to speak directly to the thousands of Victorians traveling hundreds of kilometres on the state's roads for games and training every year.

Road Safety Round is just one aspect of the TAC's long-standing partnership with AFL Victoria, with the TAC Club Rewards Program offering clubs up to \$10,000 for their efforts in promoting safe driving behaviours throughout the season.

Find out more about Road Safety Round and the TAC Club Rewards Program at <http://tac.vic.gov.au>



Winchelsea Pram Walks

Explore pram-friendly walking routes in your local area with a member of the Surf Coast Shire Child and Family Health team. Come along, have a chat, and meet other parents with little ones!

No bookings required, simply show up!

Third Tuesday of the month

Cafe La Hoot, 1 Willis Street, Winchelsea, 3241
FREE

Tuesday, 15 August 2023 | 10:00 AM - 11:00 AM

Tuesday, 19 September 2023 | 10:00 AM - 11:00 AM

Tuesday, 17 October 2023 | 10:00 AM - 11:00 AM

Tuesday, 21 November 2023 | 10:00 AM - 11:00 AM

Child and Family Health 5261 0549
childandfamily@surfcoast.vic.gov.au



SERVICES AND ACTIVITIES IN WINCHELSEA

VLINE TRAIN SERVICES

TO MELBOURNE:

Mon - Fri 6:41 am, 7:57am, 11:14am, 2:08pm, 5:01pm, 7:23pm
Sat - Sun 9:26am, 1:30pm, 7:18pm

TO WARRNAMBOOL:

Mon - Fri 8:56am, 11:55am, 2:50pm, 5:27pm, 6:45pm, 8:50pm
Sat - Sun 8:47am, 2:46pm, 8:34pm

WINCHELSEA GIRL GUIDES AUSTRALIA VICTORIA GIRL GUIDES

Our Unit meets at the Catholic Church Hall,
Harding St Winchelsea each Monday 4.30pm-6pm
All girls 5yrs- 15yrs Welcome!
Contact Yvonne Orchard 0448 672 630
or Bonnie Stokes 0401 386 274



COUNTRY WOMEN'S ASSOCIATION

7pm second Wednesday of month
Winchelsea Senior Citizens' Hall



1ST MODDA AND 1ST WINCHELSEA SCOUT GROUP

Joey's: Tuesdays of school term 5-6pm
Cubs: Mondays of school term 6:30-8pm
Scouts: Tuesdays of school term 6:30-8:30pm
All at Modewarre Hall, Cape Otway Rd
Venturers: Wed at Walton's Rd Venturer Den
Contact Marie McPadden 0409 330147

WINCHELSEA SES



Meeting and training
every Wednesday

Visitors and enquiries welcome
0408 102 802



BUS TO THE HUB

For reservations on the weekly bus
to the Eastern Reserve Hub,
please phone 52671202.



WINCHELSEA AND DISTRICT COMBINED PROBUS CLUB

Meets 1st Monday of the month at 10am.
Senior Citizens Rooms,
Harding St, Winchelsea.
New members always welcome.
Enquiries Linda 0439 817 263.

SURF COAST MOBILE LIBRARY

Hesse St, Fridays, 2pm-5pm
Surf Coast Mobile Library
parked in Hesse Street (outside Shire Hall)
Fridays between 2:00 and 5:00pm
unless it is a Public Holiday.

WINCHELSEA TRANSFER STATION

55 Cressy Road, Winchelsea

Monday	Closed	Tuesday	2pm-4pm
Wednesday	Closed	Thursday	2pm - 4pm
Friday	Closed	Saturday	1.30-3.30pm
Sunday	9.30-12.30pm		

Accepts household garbage, mixed commercial
and industrial waste, mixed construction
and demolition waste.
Accepts recyclable materials.
Accepts one recycle bin two waste bins.
Does NOT accept clean fill.

WINCHELSEA TAXI

0429 672 888 or 5267 2888
Wheelchair accessible
10 seater bus available.

WINCHELSEA PLAYGROUP

Every second Thursday 10am-12pm
St Thomas Anglican Church Hall
cnr Barwon Tce and Hopkins St, Winchelsea
Contact: Melissa 0456181268
Facebook - Winchelsea Playgroup 2019
New families welcome

Snowmen at Playgroup?!

Winchelsea Playgroup enjoyed lots of Winter Fun on Thursday 29th June at St Thomas Anglican Church Hall.... we had some past Playgroup members come along too due to School Holidays.

Children came dressed in winter clothing and icy blue colours, and made lovely fluffy white 2D Snowmen using cotton balls, paper hats, carrot noses and scarves. We also had Snowmen to colour, as well as winter mittens, skating bears and snuggling penguins; and special icy-blue coloured playdough to play and mould.

Included in our winter fun was Snowmen Bowling, made from 6 giant bowling pins and a ball - the snowmen had their very own real knitted scarves and stood on blue foam to look like ice. Think there might be some future league bowlers amongst our playgroup children with all the strikes we saw!



AND we even had fake snow! It looked like snow, felt like snow and was cold like snow - but it didn't melt. A toy polar bear and plastic trees made the perfect wintry scene with the children using their hands, scoops and spoons to dig and pile up the snow, and to make mini-Snowmen. It looked so real when we sprinkled the snow from our fingertips above the wintry scene.

To make your own Fake Snow simply mix 3 cups Baking Soda and ½ cup white conditioner/body lotion (if the mix is too wet, add a little more baking soda). It'll keep for 6-10days in an air tight container.

Call/text me (Mel) on 0456181268 if you have any questions - leave a message if I don't answer. Also check out our Facebook page 'Winchelsea Playgroup 2019' for full details, regular news and updates. All our Facebook Page Join Requests require 4 questions to be answered before we can consider approving your request.



“Which way to the beach?”: Council seeks community input on new wayfinding signage

Surf Coast Shire Council is seeking community feedback on a Torquay Wayfinding Signage Strategy and Design Guidelines, which aims to help the community and visitors better navigate the township and identify key places of interest.

A recent audit of Torquay's township identified opportunities to improve wayfinding signage, with a focus on readability and interpretation, as well as to ensure cohesion across signage in terms of colour, design and typography.

Council officers have liaised with Wadawurrung Traditional Owners and will continue to work on the potential to incorporate dual language placenames and Welcome to Country wording and artwork on gateways and identification signs.

The community have the opportunity to have their say on the draft strategy and design guidelines, which include two colour options for the signage: charcoal or aqua.

Once finalised and endorsed, Council will commence the manufacture and installation stage of the project within Torquay, with a view to applying the strategy and guidelines to other townships across the Shire in the future.

Have your say via the survey by 4 August at: surfcoast.vic.gov.au/wayfinding



WINCHELSEA BOWLS CLUB Ph 52672241



Winchelsea Community House and Shire Hall

Hours: Monday-Friday 9.00am -2.00pm

Address: 28 Hesse Street, Winchelsea

Phone: 52672028

www.winchhouse.org.au

Email: reception@winchhouse.org.au

Term 3, 2023

Basic Barista/Coffee Making Skills

Coffee 101— Learn all the basics in making a superb cup of liquid gold. Gain some hands on experience for hospitality or simply to grow your skills for your coffee machine at home. Café Skills short 4 session course. Participation Certificate on completion
When: Fridays 28/7, 4/8, 11/8 and 25/8 10am-12 noon
\$50 for 4 weeks, Winchelsea Shire Hall Kitchen
Bookings essential to reception@winchhouse.org.au

Sound Healing Sessions

When: Wed 19th July, Wed 16th August & Thur 14th Sep
7.30pm-8.30pm, Winchelsea Shire Hall Space
\$40 per session, Bookings now open
Please call Vicki on 0400 149 749

Art Classes-Painting - All The Basics and More!

When -Thursdays 13th July– 10th Aug 2023 (5 weeks)
1pm-3pm, Winchelsea Community House Star Room
Term 3, 5 classes \$275
A class that progresses through water-based mediums, with a dual focus on subject matter and materials. Try our watercolour pencils combined with watercolours and gouache, while revisiting the colour wheel and colour mixing. Relax into the rhythm, with friendly facilitation.
Challenge yourself to a personal project, one you've always promised yourself. Tuition is tailored to individual level and pace, where achievable realistic exercises are set.
Bookings and enquiries now open via email to Hinterlandartschool@gmail.com
PH: 0493 479 447

Singing Group

When: Wednesday afternoons
4.45pm-6.00pm, Winchelsea Shire Hall Space
\$5 per session, Under 16 Free
Re-Commencing: Wednesday 12th July, 2023
Bookings now open via email to reception@winchhouse.org.au

Power Saving Bonus

Don't forget to lodge your claim before the current round ends on 31/8/23. We can help you do this.

Experienced Tai Chi

When: Friday mornings 9.30am-10.30am
Winchelsea Community House Space
\$100 for 10 week program
Re-Commencing Friday 14th July, 2023
Bookings now open via email to reception@winchhouse.org.au

Knitting Group

Come along and learn to knit or bring your knitting project and come and chat with others.
When: Thursday mornings, 10.30-12 noon
Winchelsea Community House
Re-Commencing: Thursday 13th July, 2023

Chatty Cafe

When: Friday mornings 10.30am-12 noon
Winchelsea Shire Hall Space
No bookings required
We will have our Chatty Café Volunteers present to welcome you! A place to sit, relax and chat.
Re-Commencing : Friday 14th July, 2023

Crochet Group

When: Alternate Saturday afternoons
1.30pm, Winchelsea Community House Space
\$5 per session
Re-Commencing: Saturday 15th July, 2023

Learn to Spin Classes

Wanting to learn to Spin
When: Thursday mornings, 10.30am-12 noon
Four weeks commencing Thursday 27th July, 2023
Winchelsea Community House, \$40 for 4 sessions
Bring your own wheel and a large cloth for the floor, under the wheel. Bring your own wool, carders & combs if you have them. Some wheels may be available but please let us know.
Bookings essential to reception@winchhouse.org.au

Textiles Exhibition

Saturday 22nd and Sunday 23rd July, 2023
Winchelsea Shire Hall – 10am-2pm Gold Coin Donation

Council endorses further climate emergency response and action

Surf Coast Shire Council has updated its Climate Emergency Response Plan 2021-2031, with enhanced focus on adapting to the impacts of climate change, and addition of an emissions reduction roadmap.

Council resolved at its June meeting to approve changes to the plan and also endorsed a separate draft 2023-2025 Climate Emergency Action Plan for public exhibition.

"Council is pleased to be making further decisive steps forward on our climate emergency response with these actions," Cr Kate Gazzard said. "The 2021-2031 Climate Emergency Response Plan provides strategic long-term vision, goals and actions for managing Council's response to the climate emergency, while action plans are developed every two years setting ambitious but practical shorter-term goals.

"We are proud to have reached some important and meaningful climate response milestones since Council's declaration of a climate emergency in 2019 but aspire to more under the guidance of these plans.

"And in striving to demonstrate climate emergency leadership we hope to inspire and empower climate action across our community."

The updated Climate Emergency



Response Plan now includes an Emissions Reduction Target and Roadmap adopted in April 2022, and a Climate Adaptation Planning Framework.

Key goals within the response plan include reducing emissions within Council's operational control to zero by 2030, excluding Anglesea Landfill and building resilience to ensure we thrive within a changing climate. Building resilience recognises the impact of climate change and the frequency of increasingly severe weather events which can have significant impact on Council infrastructure including road and stormwater networks.

Council's corporate operational achievements since 2019 include transition to 100 per cent renewable electricity, reduction in non-landfill greenhouse gas emissions by more than 40 per cent, installation of extensive solar systems and battery storage on Council buildings, and

achieving Climate Active Carbon Neutral Standard certification.

The 2023-25 Action Plan sets out actions under six goals including that Council:

- Is carbon neutral
- Generates, stores and uses renewable energy
- Is working with local Registered Aboriginal Parties and First Nations on Climate Change, and
- Facilitates and empowers community responses to the Climate Emergency.

The Action Plan is on display for public comment until 31 July via www.surfcoast.vic.gov.au/CEAP.



The Climate Report
by Judy Cameron

While planet earth soared to record air and sea temperatures Australian media was dominated by:

- Submarine tourism tragedy kills 5
- Taylor Swift tickets sold out
- Game of cricket controversy

"Crop failures, water shortages, fire, flood, war. Climate catastrophe coming at us like a freight train and the media is in La-la land." Prof. Eliot Jacobson @EliotJacobson.

The 7 hottest days on Earth in the last 100,000+ years all happened in the last week:

- July 6 ~ 17.23°C / 63.01°F
- July 7 ~ 17.20°C / 62.96°F
- July 4 ~ 17.18°C / 62.93°F
- July 5 ~ 17.18°C / 62.92°F
- July 8 ~ 17.17°C / 62.90°F
- July 10 ~ 17.12°C / 62.81°F
- July 9 ~ 17.11°C / 62.79°F

"We are in uncharted territory and we can expect more records to fall as El Niño develops further and these impacts will extend into 2024... This is worrying news for the planet."

**NO MATTER WHAT
YOUR PROBLEM, DODDS
ELECTRIX CAN DEFUSE
THE SITUATION.**

RURAL, INDUSTRIAL, COMMERCIAL, DOMESTIC
PHONE 0438 887 360
EMAIL: DODDSY@FASTMAIL.FM
PO BOX 36 BIRREGURRA, VICTORIA 324
REC: 17520 ABN: 64 581 250 880



5234 6585 0417 385 984

*For all your septic tank, grease traps
and interceptor pits servicing.
Locally owned and operated*

Antique Repairs

By **Doug Burns** est. 1976

- All Furniture
- French polishing
- Carving
- Veneering
- Wood Turning
- Porcelain



Unusual Requests Welcome

180 Barwon Terrace, Winchelsea

0428 672 704



**Winchelsea
Supermarket**

Trading Hours
Monday to Saturday

8.30am to 7.30pm

Sunday

10am to 7pm

Ph: 5267 2676

29 Main St, Winchelsea

TRENCHES & HOLES PTY LTD.



PHILLIP ROBERTSON

☎ **0427 672 945**

WINCHELSEA

- **General Earth Works**
- **Driveways**
- **Trencher**
- **Kanga Loader**
- **Grader**
- **Excavator Work (3.5 & 6.5 Tonne)**
- **Tip Truck**
- **Rock Breaker**
- **Post Holes & Shed Footings**

A.B.N 74006896898

Scott McDonald
0423 413 829



S.J.R AUTOMOTIVE

ABN 642 483 646 39
13 ALSOP DRIVE, WINCHELSEA, VIC 3241

The Little Laundry

- Standard size load washing/drying clothes, next day service
- Free pick up/delivery 5km radius IGA
- Blanket washing (no animal bedding please)
- Ironing available
- Other options and deals available

Melissa 0488 444 351

Water Delivery



Stainless Tanker Up to 22,000 ltr loads
Barwon Water Registered

Domestic & Rural Water Supplies

Call Wazza

Mob: 0428 877 260

Email: wazza@wazzas.com.au Web: wazzaswater.com



Café La Hoot

have you tried
'owl' coffee?

1 willis st cafelahoot@gmail.com 0407 528 999



WINCHELSEA CRICKET CLUB INC

NOTICE OF ANNUAL GENERAL MEETING 2023

70 Hopkins Street, Winchelsea, Vic, 3241

PO BOX 122, Winchelsea, Vic, 3241

EMAIL: winchelseacricketclub1858@outlook.com

Wednesday 2nd of August, 2023 at 7 p.m.

Members Room Eastern Reserve

NOMINATIONS are invited for all positions and must be lodged with the Secretary 2 days prior to the 2nd of August, 2023. Please show your support for your local Cricket Club and volunteer your services for the Executive and General Committee. **WE NEED YOU** to get involved and to ensure the continuance of our Cricket Club that will enter its 165th year!

NOMINATION FORM

I _____ hereby nominate for the incoming Committee of Management for the Winchelsea Cricket Club season 2023/24 (tick the nomination position)

Name of Candidate

Candidate signature

President

Secretary

Committee Member

Vice President

Treasurer

Junior Vice President

Nominated by _____

Seconded by _____

Completed nomination forms must be lodged with the Secretary TWO days before the Annual General Meeting. Email winchelseacricketclub1858@outlook.com or PO Box 122 Winchelsea, 3241.

There's never been a better time to travel by public transport

It means that travelling by V/Line, local trains, buses or trams—no matter where you are in Victoria—will be accessible and affordable for everyone.

The regional fare cap is continuing to be extremely popular with Victorians, with around five million trips taken on the V/Line network and more than \$15 million saved by passengers since the start of the cap in March 2023.

No matter where you live in Victoria, it will cost you the same amount to travel. The most you'll pay is the same as a daily capped fare, which is currently \$10 full fare, or \$5 for concession.

For shorter regional trips, it will be even less.

And with weekend saver discounts, travel on Victoria's regional network on weekends and public holidays, and your daily fare will currently only be \$7.20 or \$3.60 concession.

You'll need either a myki, V/Line paper ticket or bus paper ticket for your journey. To find out which ticket you'll need, see Regional tickets on the V/Line website.

Since the introduction of the fare cap V/Line has added more than 100 additional special services every month and will shortly be consulting with customers as part of its review of bookings and reservations policies for long-distance lines.

Make the most of fairer regional fares

Get out and enjoy the best of Victoria.

Plan ahead and consider travelling during less busy times to avoid the crowds.

Take advantage of fairer fares to:

- visit family and friends
- get to a medical appointment in town
- go shopping
- work between different locations
- connect with nature
- experience a festival or special event.



On behalf of the Market committee I would like to thank the Winchelsea Community bank for sponsoring our new sign and our coloured flags for our market day.

Thankyou,
Lesley / Growing Winchelsea Inc

HESSE RURAL HEALTH

Rokewood
Bannockburn
Beeac
Winchelsea

Acute Care*
Urgent Care*
Residential Aged Care*
Community Nursing
Dietetics
Physiotherapy
Occupational Therapy

Diabetes Education
Social Support Groups
Counselling
Home Care
Health Promotion
* services from Winchelsea only

www.hesseruralhealth.com.au
P: (03) 5267 1200 E: reception@hesse.vic.gov.au



Fox bounty collection details

Geelong

Address: 16 Cadman Terrace, North Geelong.

Time: 9:30 – 11:30 am

Dates:

- Tuesday 1 August
- Tuesday 29 August
- Tuesday 26 September
- Tuesday 24 October.

Colac

Please note: Bounty collections at Colac have been relocated to 23A Hugh Murray Drive, Colac East.

Time: 1:30 – 3:30 pm

Dates:

- Tuesday 1 August
- Tuesday 29 August
- Tuesday 26 September
- Tuesday 24 October.

More than 90 Victorian schools, councils and not-for-profit organisations will receive vital funding to promote and deliver road safety programs in a fight to reduce trauma and save lives.

Minister for Roads and Road Safety Melissa Horne said 251 initiatives have received funding under this year's \$1.5 million Community Road Safety Grants Program (CRSGP) to deliver targeted education programs to tackle local road safety issues.

This important program will help all road users, including drivers, motorcyclists and bike riders, and our most vulnerable road users including pedestrians, school aged children, the elderly and users of mobility devices.

The latest grant funding includes funding for active transport related projects including bike education initiatives to improve safety for students and families walking and riding to school, support for culturally and linguistic diverse communities to be safe road users and young driver education.

The program supports the Victorian Road Safety Strategy 2021-2030, which aims to halve road deaths and reduce serious injuries by 2030 and eliminate road deaths by 2050.

For more information on the programs, please visit the VicRoads website <https://jo.my/roadsafety>

Winchelsea and District Historical Society

facebook.com/Winchelseaanddistricthistoricalsociety/

Winchelsea Street Names

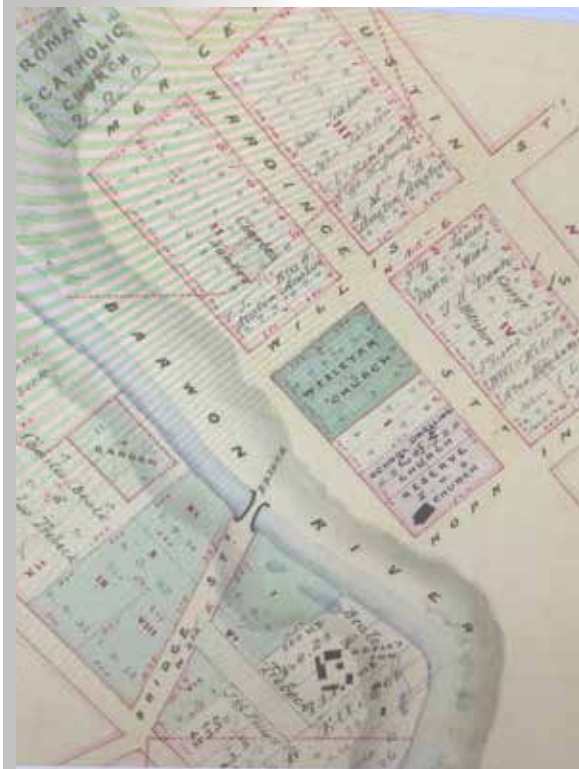

WILLIS STREET

Edward Willis and R.H. Willis are mentioned in the History of Barrabool as early pioneers in Gnarwarre & district.



AFS BOOKKEEPING



"Your local bookkeeper"

Bookkeeping
Administration
Payroll
BAS Services
Xero / Myob
Reckon / Quickbooks
Registered BAS Agent

Angelique Snetselaar

0456 077 485

info@afsbookkeeping.com.au
www.afsbookkeeping.com.au



SOUTHERN GRAIN STORAGE PTY. LTD.

AG SUPPLIES FERTILISER GRAIN STORAGE SEED CLEANING

(03) 5267 2351



5234 6585 0417 385 984
For all your domestic & stock water.
Also available for road and civil construction
Local owned and operated.

Kyeema
Rural Fencing Pty. Ltd.
Jason Armstrong & Jay Hawker
1080 Princes Lane, Ombersley, Victoria 3241
0419 565085 (Jason)
0416 585817 (Jay)
kyeemafarm@kyeemafarm.com.au
Also incorporating domestic and rural tree trimming services.



Your Taxation &

Superannuation Specialists.

Winchelsea

5267 2673

www.surftax.com.au

ven1g10064

All About Mowers & Chainsaws
Repairs to all makes and models of ride on mowers, domestic mowers, pumps, chainsaws, brushcutters and small engines.
Trading Hours: Mon - Fri 8am - 5pm Saturday 8am - 12 noon
5267 2266 Cnr Princes Hwy & Lennox St Winchelsea
www.allaboutmowers.com.au
accounts@allaboutmowers.com.au

FERRIS COX STIHL VIGTA

Simco Plumbing and Gasfitting

24/7 Emergency service Ph:0400643976

- All General Plumbing and Gasfitting
- Roof and Gutters, Hot Water service changeover
- Split Systems, Air Conditioning and Wood Heaters
- Irrigation, Septic and Treatment plants
- Excavation, Bobcat and Tipper
- Rain water Tank installation
- Renovations and Extensions
- Gas conversions and servicing

Simon McGillivray

Lic:109610. Free quotes, Fast and friendly service

WINCH WEBSITES
WEB SOLUTIONS SIMPLIFIED.

WEBSITES

GROW business
INCREASE reach
SAVE time



Find out what a website could do for you
winchwebsites.com.au
04 887766 20

DAVIC AG

CONTRACTING AND EARTHMOVING

For all your harvesting needs
Mowing, raking, round bailing, paddock prepping, spreading and sowing

Call Dave on **0417 579 973** Bamba

A total of 39 COVID-related deaths were reported to the department in the past week.

In the past week, 543 positive PCR tests were reported to the Department. The recommendation to report positive RATs was removed on 30 June.

The total number of reported COVID-related deaths in Victoria since the pandemic began is 8,189.

Of Victorians aged 18 and over, 19 per cent have recorded a vaccination or COVID diagnosis in the past six months. This means 4.2 million Victorians are eligible for a 2023 booster dose.

Of Victorians aged 65 and over, 50 per cent have recorded a vaccination or COVID diagnosis in the past six months. The remaining 50 per cent are recommended to receive a COVID vaccine whenever possible. Of Victorians aged 50 to 64, 21 per cent have recorded a vaccination or COVID diagnosis in the past six months.

Steps to protect yourself and others

Protecting yourself from getting infected is the best way to protect yourself and the community. If you don't get Covid, you can't spread Covid.

These six steps can help you stay ahead of Covid:

- **Wear a mask:** a high-quality and well-fitted mask can protect you and others from the virus.
- **Get your 2023 booster:** new bivalent vaccines targeting Omicron variants are available at your GP or local pharmacy. To find out if you're eligible for your next booster, visit

the Coronavirus website. Flu vaccines are also now available.

- **Let fresh air in:** open windows and doors when you can – it reduces the spread of the virus.
- **Get tested:** if you have symptoms, take a rapid antigen test.
- **Stay at home:** if you have Covid, you should stay at home for at least five days and until you have no symptoms.
- **Talk to your doctor:** if you are at risk of falling very sick, you may be eligible for Covid and influenza medicines – and early testing and diagnosis are important. With expanded criteria, more people are now eligible for Covid medicines.

RATs available through local councils

All Victorians are eligible to pick up two free packets of rapid antigen tests (RATs) through their local council.

Antivirals and other medicines

Oral antiviral medications remain highly effective against all currently circulating Covid subvariants to reduce severe disease and prevent death.

Information on eligibility to receive antivirals can be found at the Coronavirus website coronavirus.vic.gov.au/covid-19-medicines

2023 boosters

Eligible Victorians who have not had a Covid vaccination or confirmed infection in the past six months can now receive their 2023 booster. This is irrespective of how many prior doses a person has received. Vaccination continues to provide the best protection against becoming severely unwell or dying from Covid.

For those not infected or vaccinated in the past six months, a 2023 booster is recommended for:

- All adults aged 65 years and over
- Adults 18-64 years who have medical comorbidities or disability with significant or complex health needs.

For those not infected or vaccinated in the past six months, a 2023 booster should be considered for:

- Adults 18-64 with no risk factors for severe Covid
- Children and adolescents aged 5-17 who have medical comorbidities or disability with significant or complex health needs.

Victorians are encouraged to book a free booster appointment through their local GP or pharmacy. You can find your nearest vaccination provider through the Health Direct Service Finder <https://covid-vaccine.healthdirect.gov.au/booking/>



Winchelsea Star

COMMUNITY Noticeboard

FREE ADS

email editor@winchelseastar.org.au
or leave at Winchelsea IGA

FREE TO A GOOD HOME

1 PIANOLA with approximately 150 rolls of music. Need to get relocated as to close off deceased estate. Contact Jeanette 0409418766 or John 0438396492

TEXTILE EXHIBITION

15/16 and 22/23 July 2023

Winchelsea Shire Hall will be hosting a Textile Exhibition in July. It will be open from 10am-2pm. Make sure you come and view the wonderful work being displayed.

FOR SALE

THE GOON SHOW BOOKS
8 SPIKE MILLIGAN
2 PETER SELLARS
\$30

1 PAIR CITROEN CAR MATS \$15
CAR BROCHURES (EUROPEAN)
VARIOUS PRICES.
PHONE 0425 872 122

POSITION WANTED

Local mum seeks casual position as companion for elderly lady or as house sitter, pet sitter, horse care etc.
Ph: 52 672 987

OP SHOP SALE

Current Sales:
Material - Large quantity heavily reduced prices. \$5 per bag
Picture Frames - Half price.

Winchelsea Churches



Winchelsea Uniting Church

Hesse St, Winchelsea 3241
uca.winchelsea@gmail.com
0475 777 301
Services 9.30am Sundays

St John's Catholic Church

July Mass times: 5pm.
July 1, 8, 15, 22, 29
Harding St, Winchelsea 3241
Father Joseph Panackal
0404598558

St Thomas' Anglican Church

Barwon Tce, Winchelsea
Rev'd Phil Jacobson
stthomaswac@gmail.com
0477 672 042



Thought for the Week

"Between you and the one you trust.

There is total openness,
complete confidence.

The one you trust will never
fail you or leave you.

No matter what happens to you."

John Bader,
Former U/C Accredited
Lay Preacher

Letter to the Editor

CONQUERING THE CORRUGATIONS WALK

27-28th May 2023

On reading the information for the walk in the Star it brought back many memories growing up at The Falls (McMillans property) in the late 40's early 50's, and as a four year old walking mobs of sheep from the Falls to the saleyards at Inverleigh.

Then starting school at Inverleigh in 1952 travelling the corrugations and sand drifts to and from school each day in an "A" model Ford, occasionally in Paddy Dixon's horse and cart.

The "A" model rattled to pieces on the corrugations and was finally replaced by a red Ford Prefect panel van which was number one rabbit transporter taking rabbits from the Falls and Englewood Park to the rabbit chiller in Inverleigh and kids to school (and mum had her licence then and could drive the little red beast)

The Prefect rode the corrugations till 1955 when we moved to Buckley. Then school was a one mile walk across Les Swaby's paddocks. Mud and frost in winter, grass seeds and snakes etc in summer.

When these memories triggered the brain I took part in the walk for old times sake and enjoyed every minute. Great company and plenty of chatter.

David Loone, Winchelsea.

Growing old takes work but three things can help us prepare

Growing up, I was told it is a privilege to get older and reminded not everyone has the opportunity.

But rather than later life being celebrated and respected, over time many of us have come to believe it is problematic and therefore something to be feared.

That's partly because we're living longer, so collectively older age is somewhat uncharted territory. It requires a lot more preparation than in past generations.

Researchers know very little about how prepared we feel for ageing in Australia, what aspects of preparation are a priority and what factors impact our capacity to prepare.

National Seniors Australia's new research enriches our understanding of all these things, based on a survey of 3400 people aged 50 and older.

It turns out that a glass half full or empty attitude can make a difference to our preparedness.

Our research has confirmed this intuitive link between older people's attitudes towards ageing and their readiness for it.

Just over two-thirds of our survey respondents felt somewhat or very prepared for ageing, but those who had ageing concerns were significantly less likely to feel prepared.

Conversely, respondents who agreed there are positive aspects to ageing were 340% more likely to feel prepared for it.

That's a significant difference, associated with a sunnier outlook on getting older.

Age, health and wealth all affect our readiness for later life too.

The research showed older and wealthier people were significantly more likely to feel prepared, while those in poor health were nearly 30% less likely to feel prepared.

So, what does preparation for ageing mean to these older Australians?

The survey invited respondents to comment on their ageing preparation experiences and sentiments.

The comments highlighted several life areas in which preparations are required, the primary domains being health, accommodation and finances.

The survey revealed that across all life areas, feeling prepared is associated with taking action, gaining knowledge and having a positive mind set.

As one 68-year-old respondent explained, "Our finances and living arrangements have been planned for many years and make ageing somewhat easier."

On the other hand, comments about being unprepared highlighted worry and the barriers to preparation.

As a 70-year-old respondent shared, "The biggest concern is my lack of understanding of the aged care sector, options and how to pay for it."

Overall, the comments suggest older people need three kinds of support to prepare for ageing.

Structural change such as housing and income security are essential enablers because without access to these material supports any preparations will be inadequate.

Good information about how to prepare is also valuable. People need to know what to expect from their ageing bodies, what changes to make in their lives, and how to navigate our social support systems in later life.

Emotional resilience is the third factor, to help people challenge negative expectations and fears that prevent them from making preparations. We could all benefit from cultivating that magical positive attitude to ageing.

While ageing can present changing circumstances, taking action to prepare for it helps maintain quality of life – it buffers against health-related challenges and increases opportunities for fulfillment and satisfaction.

When it comes to maintaining quality of life, preparation is key.

National Seniors will use this information to help inform its policy and advocacy work supporting quality of later life for older people.

Our full report, Preparation for Ageing and Later Life, can be downloaded from the National Seniors Australia website at <https://jo.my/ageing>

Dr Diane Hosking is the Head of Research at National Seniors Australia





WINCHELSEA FACEBOOK GROUPS AND PAGES

What's on in Winchelsea: Promoting Winchelsea Flyers, Local Events, Small Business	facebook.com/WhatsoninWinchelsea
Winchelsea FREE Free only	facebook.com/groups/winchelseafree
Winchelsea Community Information Australia positive discussion	facebook.com/groups/207538644446972
Winchelsea Classifieds 3241 For Sale only	facebook.com/groups/216942861684082
Winchelsea Lost and Found Lost Pets	facebook.com/groups/768187693217518
Winchelsea Op Shop	facebook.com/HospitalAuxiliaryOpShopWinchelsea
Winchelsea Shire Hall (Community Centre)	facebook.com/WinchelseaShireHall
Winchelsea Community House	facebook.com/winchelseacommunityhouse
Winchelsea Coronavirus Community Support Group	facebook.com/groups/2676957719207927/
The Green Winchelsea Residents	facebook.com/groups/515322772623126
Growing Winchelsea Inc	facebook.com/growingwinch
Winchelsea Star	facebook.com/TheWinchelseaStar
Winchelsea Movie Club	facebook.com/winchelseamovies
Winchelsea Community Market	facebook.com/100083362387611
Winchelsea Land and River Care Group	facebook.com/envirowinchelsea/
Upper Barwon Landcare Network	facebook.com/UpperBarwonLandcare
Winchelsea & District Historical Society Inc	facebook.com/Winchelseaanddistricthistoricalsociety/
Winchelsea Wildlife Shelter	www.winchelseawildlifeshelter.com/
SCARS - Surf Coast Animal Rescue Service	facebook.com/groups/415211698950674
Winchelsea Gardeners	facebook.com/groups/779878518703025
Winchelsea & District Historical Society	facebook.com/Winchelseaanddistricthistoricalsociety/
Winchelsea Repertory Society Inc	facebook.com/winchrep/
Winchelsea Globe Theatre	facebook.com/Winchelsea-Globe-Theatre-164790897641678
Winchelsea Uniting Church	facebook.com/winchelseaunitingchurch
St Thomas' Anglican Church	facebook.com/StThomasWinchelsea
St John the Baptist Catholic Church	facebook.com/pages/Winchelsea-Catholic-Church/101775670163180
Winchelsea Mainly Music	facebook.com/groups/668500343953191/
Winchelsea Health Club	facebook.com/WinchelseaHealthClub
Winchelsea Playgroup 2019	facebook.com/groups/551663435367031
Winchelsea Girl Guides	www.guidesvic.org.au/
Winchelsea/Modewarre Scouts	facebook.com/1stModewarreScouts
Winchelsea Fire Brigade	facebook.com/winchelseafirebrigade/
Winchelsea SES	facebook.com/groups/WinchSES
Country Women's Association - CWA Winchelsea Branch	facebook.com/pg/CWAWinchelsea/
Winchelsea Bowls Club	facebook.com/Winchelsea-Bowls-Club-53378333344345/
Winchelsea Blues Cricket Club	facebook.com/groups/8999049476/
Winchelsea Blues FC	facebook.com/WinchelseaFNC/
Mel's Dance Studio	facebook.com/melsdancecentral
Winchelsea Kyokushin Karate Club	facebook.com/winchelseakyokushin
WYLD Winchelsea Youth Leisure and Drop in	facebook.com/groups/569737570027065/
Lions Club of Winchelsea	facebook.com/LionsWinchelsea
Winchelsea Probus	facebook.com/893535194971083
Winchelsea Golf Club	facebook.com/winchelseag/ facebook.com/groups/1324943804676697



Wadawurrung Traditional Owners secure funding for work at Murrk Ngubitj Yarram Yaluk

The Victorian Government has granted Wadawurrung Traditional Owners Aboriginal Corporation nearly \$450,000 for works at Murrk Ngubitj Yarram Yaluk, the site of Barwon Water's former Bellarine Basin, which is being transformed into 30 hectares of public open space.

Wadawurrung Traditional Owners Aboriginal Corporation Interim CEO Liam Murphy said the organisation was thrilled to receive the funding for the important project, that would go toward improving the local environment in line with Wadawurrung values.

The site is unique on the Bellarine Peninsula, and currently there is a thriving wetland, remnant grassy woodlands, wedge tailed eagle and collared sparrowhawk nests and a variety of areas with revegetation opportunities.

Stage 1 works comprised removal of 30 per cent of the pine plantations, removal of the basin walls, the recreation of the Yarram Creek natural alignment and the creation of a master plan for a nature reserve and public space.

SW vic dairy farmers learn about virtual fencing during NZ tour

Six south-west Victorian dairy farmers have learnt about the potential benefits of virtual fencing to manage herd grazing and movement during a New Zealand study tour.

One of the highlights was visiting a large farm of 1800 cows using Halter collars on three herds, prompting a suggestion to lobby the State Government to allow their use in Victoria.

"The farmer took us to a 59ha paddock of Kale and Fodder Beet and simultaneously moved two large groups of animals, at either end of the paddock,

up to the eating face from either side of the paddock," said tour leader Angus Drummond. "All cows moved quietly, none broke out and crossed the virtual fence and then after a while the herds were moved back again, with no fuss."

Mr Drummond said farmers might want the virtual fencing but the price was currently prohibitive.

"They are a very powerful tool and the demonstration showed there was no evidence of cruelty," he said. "The two herds were very relaxed and happy to take and obey the sound cues given to them."



Horse deaths

In short: Agriculture Victoria says 10 horses have died from mysterious causes on separate properties

What's next?

Horse owners are being warned to report sudden illnesses or deaths among animals.

Agriculture Victoria said the animals died quickly with "short term non-specific signs of illness."

<https://jo.my/horsedeaths>

WINCHELSEA LIONS CLUB

PAPER RECYCLING

Paper depot rear of Senior Citizens Rooms Harding Street
NEWSPAPERS,
MAGAZINES,
PHONE BOOKS WANTED



RAISING FUNDS FOR
OUR TOWN & DISTRICT
5267 2011 or 0408 520 606

Winchelsea Men's Shed



For The Community
Men's Shed Kindling/Offcuts
Bags of Kindling/timber offcuts are available for pick up from the Men's Shed on Wednesday's from 9.30 to 2.30.

If you need a delivery made you can call Bill on 0438 083 373. The price for a bag of kindling is now \$7.00 (up from \$5.00).

Nesting Boxes

Bird or animal nesting boxes are available from The Men's Shed.

These can be made to order. Call in on any Wednesday to have a chat.

Winchelsea *mel*



MEL'S DANCE CENTRAL

**MID-YEAR
DANCE
ENROLMENTS**

! NOW OPEN !

FOR ALL AGES PRE-SCHOOL - ADULTS

Jazz - Theatrical Tap - Contemporary
Hip-Hop - Classical Ballet

www.melsdancecentral.com.au



52672192 **R & K Creative Framing**
for all your framing needs

free quotes
pension discount
specialist in Age &
Disability Modifications

Ray & Kim Jansen
10 Witcombe st
Winchelsea 3241

Ray The Home
Maintenance **HANDYMAN**

abn 47928623462

0414672192



mainly music
est. 1992

**Fun, Interactive music sessions for
pre-school children (0-4 y.o.) and
parents/caregivers**

When: Mondays from 10 to 11 am
(runs during school terms)

Where: St Thomas' Hall
25 Barwon Tce.

To Enquire ring: 0407838256

Winchelsea Star

news@winchelsea.star.org.au

News
Events
Stories
Articles

**What's happening
in Winchelsea?**

Community Notices
Letters to the Editor
Sports Results
Local businesses

Like to contribute to the Star?
We're always looking for local content to put into the Star.
Written by locals, of interest to locals

Free to a good home

Box of The Monthly magazines

July 0409417562



Water Supply Specialists

WATER SOLUTIONS

74 Dennis Street, Colac
5231 1861



ALL THINGS WATER:

- PUMPS - PIPES
- FITTINGS - TANKS
- POOL CHEMICALS
- IRRIGATION
- WATER PURIFICATION
- SOLAR - REPAIR



Opera Gala 2023

Didn't quite make it to Italy this Winter?

Don't worry - We've got world class Opera coming to you instead!

Join us on **Saturday, 12th August, 7.30pm**

for an experience like no other.

Opera Australia - a spinetingling performance showcasing everything from breathtaking opera hits to music theatre classics. Even if you've never stepped foot in an opera house, this show will cater to (almost) any taste. The songs are a backdrop to contemporary life, familiar from movies, TV series, advertisements, sporting events and even cartoons

Book your tickets to this unforgettable live event now for a Saturday night to remember.

www.copacc.com.au, at the Box Office or on 03 5232 2077.

TANGO



Pet Grooming

RONNIE.

Winchelsea's
pet groomer.

For appointments
0436 008 989

tangopetgrooming@gmail.com

HF RICHARDSON

PROPERTY

Servicing all your real estate needs

Ken McDonald **0418 524 150**



Residential | Rural Lifestyle | Agricultural Farms





9.00am - Winchelsea
IGA, 29 Main St, Winchelsea

11.00am - Jan Juc
Ocean Blvd Shops

2.30pm- Torquay
Esplanade, near Gilbert Street

3.45pm - Torquay North
The Dunes Village, 222 Fischer Street, Torquay

CONTACT US

115A Bromfield Street, Colac 3250 5231 5046

RichardRiordan.com.au

richard.riordan@parliament.vic.gov.au RichardRiordanforPolwarth



Funded by Parliamentary budget



Charles Stewart & Company are leading livestock and real estate service providers covering Victoria's south west

LIVESTOCK
 Jamie McConachy | 0418 522879
 Peter McConachy | 0408 522878
 Matt Nelson | 0428 315400
 Gerard Bohan | 0400 005541
 Lachie Barclay | 0438 346291
 John Thornton | 0408 526367
 Dougal McIntyre | 0439 575612
 Ross Spitty | 0419 539717

REAL ESTATE
 Michael Stewart | 0418 520467
 Daryl Osborne | 0419 388341
 Anthony McDonald | 0418 593597
 Gerard Bohan | 0400 005541
 Stephen Lugg | 0417 556098
 Josh Lamanna | 0417 586032



Office
56 Bromfield Street, Colac
www.charlesstewart.com.au

Green Lead Electrical

Connecting you to a greener future
REC 79618

0467 097 101



Servicing Geelong & the Surf Coast

Specialising in all residential electrical work including:

- Switch board & lighting upgrades
- Outdoor lighting
- Electrical safety checks
- Energy efficient LED lighting
- Ceiling sweep fans & ventilation
- Energy saving advice

Phone Martin Wilkinson:

0467 097 101

greenlead@outlook.com

1132288-CG18-14

MGT BUILDING & CONSTRUCTION

NEW HOMES | EXTENSIONS | RENOVATIONS

Ph: 0409 433 687



Refinance, renovate or just re-evaluate

With interest rates on the rise, there's never been a better time to review your home loan.

Enquire online at bendigobank.com.au/healthcheck or call your nearest branch on 03 5289 1787.

Community Bank - Winchelsea & District

Bendigo Bank

*Roy Morgan Single Source (Australia), December 2022. All loans are subject to the bank's normal lending criteria. Fees, charges, terms and conditions apply. Please consider your situation and read the Terms and Conditions, available online at www.bendigobank.com.au or upon request from any Bendigo Bank branch, before making a decision. Bendigo and Adelaide Bank Limited ABN 11 068 049 178 AFSL 237879 (1676698-173498-1) (05/22) OUT_29309970, 26/04/2023

Lupton BUILDERS

SPECIALISING IN QUALITY

- NEW HOMES
- ALTERATIONS
- CARPORTS
- BATHROOMS
- EXTENSIONS
- DECKS
- VERANDAHS
- WINDOW REPLACEMENTS
- RENOVATIONS
- PERGOLAS
- RE-GLADS

LEIGH LUPTON
0438 840 104

CHRIS LUPTON
0407 681 514

LEIGHLUPTON17@GMAIL.COM Est. 1977

SIMPLE STORAGE SOLUTIONS

- Personal & Business Storage
- Boat, Caravan & Vehicle Storage
- High Security Premises
- Individually Alarmed Units
- Electric Gate Access
- 7 Day Access & CCTV

YOUR STORAGE PROBLEMS SOLVED

5267 3116
6 ALSOP DRIVE, WINCHELSEA 3241

Pixie Wash

Mobile Doggie Care
Dogs up to 20kg
Pixie Heath
0417 586 080

M & L DRAYTON

PLUMBING SERVICES

REG No 24356 C/A No C02594

- Domestic and Rural Plumbing
- Roofing
- Sewerage & Septic
- LPG & Natural Gas Connections
- Motorised Drain Cleaning
- Backhoe Hire

Phone Mark 5288 7244
PO BOX 98 WINCHELSEA 3241
Mobile 0428 520 142

Commercial | Industrial | Domestic

HAMILTONS

Truck & Bobcat Hire
Give Aaron a Call
0438 438 623





- ❑ LOG BOOK SERVICE
- ❑ AUTO ELECTRICAL
- ❑ TOWING
- ❑ AIR CONDITIONING
- ❑ CLUTCH & BRAKES
- ❑ TYRES
- ❑ WHEEL ALIGNMENT
- ❑ BATTERIES

CAR, TRUCK REPAIRS & Roadworthys

PH: 5267 3001

Mob: 0417 137 457

17 Alsop Drive

Winchelsea Towing
24 Hour Accident and Breakdown Towing
0418 535 402



R.A.K. DAVIS & SONS

CARTAGE CONTRACTORS

WINCHELSEA

SUPPLIER OF ALL QUARRY MATERIALS, TRUCK HIRE

CARTAGE OF GRAIN, LIME, GYPSUM & SUPER

LANDSCAPE & GARDEN SUPPLIES

56 WILLIS ST, WINCHELSEA

Ph – 5267 2094

Ryan – 0438 672 281

Email: rakdavissons@gmail.com

MAKE'N'BREAK MOSAICS

Based in Gherang



Workshops & Private Classes

Learn how to seal, cut, lay tiles & glass and grout

Pick a design from Donna or bring your own!

Call or Email Donna

0414 945 364
make.n.break@outlook.com



NATURAL GAS CONNECTIONS

M. & L DRAYTON
PLUMBING SERVICES

YOUR LOCAL LICENSED

- PLUMBERS (24356)
- GAS FITTERS
- GAS CONVERTERS
- CARBON MONOXIDE TESTING

MARK 0428 520 142

GREAT Bundle Deal on Bosch Hot Water... FROM ELGAS

Buy any Bosch Bluetooth continuous flow hot water model - 16Litre, 20Litre or 26Litre and Receive \$100* in Elgas bonus LPG gas credits

*For more details: www.elgas.com.au/appliances/bosch-optimflow-16-20-26-lpg-bundle-sale



AND... for new customers, an additional \$80 WORTH OF LPG GAS CREDITS** when you open a new LPG Gas account with Elgas



**Further details can be viewed at www.elgas.com.au

Ask about the Elgas Easy Payment Plan - 12 months interest free*** on selected LPG appliances

***Further details can be viewed at: www.elgas.com.au/epp

Automatic tanker gas bottle refill OR gas bottle exchange refill is available for home or business...

Call today or visit our website for our many customer benefits and latest offers

131 161
www.elgas.com.au

ELGAS





Blues News

Janet Fletcher

ROUND 13

Welcome to Blue's News - last Saturday the W.F.N.C. Inc travelled for the second week to an away game – this time to the home of Bell Post Hill at Myers Reserve. We are smack bang in the middle of winter and this weeks weather was just as cold as the previous week, thankfully minus the wind.

RESERVES

Winchelsea Blues 9.13.67 defeated Bell Post Hill Panthers 3.4.22

Five wins on the trot for the Reserves as they again put together 4 solid quarters of football leading throughout the entire game. Slippery conditions made the going tricky for both sides but the Blues handled the conditions better than the home side. Bell Post Hill were short on numbers and had no bench for the game, but while tiredness played a part in the last half, the game was well and truly won by half time.

BEST:

Bailey Forssman, Josh Freeman, Zachary Ross, Dougal Robb, Zedakai Copland, Jack Todd

SENIORS

Winchelsea Blues 7.5.47 were defeated by Bell Post Hill Panthers 12.13.85

Players out for the Blues through injury was always going to make last Saturday's clash against League Ladder leaders Bell Post Hill a big task. Forwards Leigh Ellis, Caleb Brown and Jordan Gould meant goals were going to be hard to come by. Tom Stephenson and Brendan Rees out of the midfield also meant life would nit be made easy for the Blues on the Panthers home turf. Losing Adam Walsh in the first quarter did nothing to add to the task head. The Blues gave it their best shot and while losing the game on the scoreboard their endeavour couldn't be questioned.

GOALS:

Tom Henry 2, Tavae Sauni 2, Lachie Kendall, Jordan Huff, and Jonty Scott all 1 goal.

BEST:

Lachie Kendall, Michael Bourdouvalis, Fin Parish, Tom Moloney, Harry Shearer, Tavae Sauni.

This week the Club will host East Geelong, starting times are as usual – Reserves 12 pm and the Seniors at 2pm.

Best wishes to Norm Banham who has been out of action the past couple of weeks. Everyone at the W.F.N.C. wishes Norm a speedy recovery and hope to see him back very

soon. Thank you Norm for all that you do for the Winchelsea Blues.

The Blue's Ball was held on Saturday night with great numbers dressing to impress - by all accounts it was a great night out for the Club.

AUSKICK

Winchelsea Auskick continues to be lots of fun on a Thursday evening, there are just a few more weeks to go of the Auskick season. Mark will have all the details for the wind up of the Auskick 2023.

JUNIOR FOOTBALL

The Under 10's have a night game at Eastern Reserve this Friday evening kicking off at 6pm. The Under 10's have been well supported this season and it would be great to see that continue this week- so rug up and get to the ground if you can. It means a lot to these Junior Players and their Coaches.

GO BLUES!

BLUE'S BISTRO:

Another busy week last week, thanks to all those who continue to support the Club through the Blue's Bistro.

This week we have Roast Chicken, Seafood Baskets and Hamburgers to choose from.

Chicken nuggets, chips and gravy for the younger Blues at just \$5.00 Ice cream & choice of topping for \$2.00



Located at 36 Main Street, Winchelsea 3241

For any enquires or bookings please contact the clinic on 5292 8028.
Or visit our website: www.winchmc.com.au

Opening Hours:

Monday - Friday 8:00am - 5.00pm

(Monday Evening Clinics available and selected Saturdays)



Our clinic accepts online bookings via the app called HotDoc. Download the app on the App Store or Google Play or head to our website.





admin@mirneeelectricalsolutions.com

Angus Leigh: 0484139858

'THE ELECTRICAL EXPERTS'

MIRNEE
ELECTRICAL SOLUTIONS
COMMERCIAL | DOMESTIC | INDUSTRIAL

Winchelsea Star
Since 1977



HESSE RURAL HEALTH

Volunteers Required

Volunteers are one of Hesse's greatest assets, playing a vital role to enhance the quality of Hesse services & client experiences.

- Bus Driver
- Outings Assistant
- Resident Visitor
- Events & Activities Assistant
- Group Wheelchair Walkers
- Appointment Escort
- Social Support Activities
- Gardening - Winchelsea
- Hospital Auxiliary Member
- Consumer Advisory Committee
- Marketing & Fundraising Committee



For more information please contact Hesse on (03) 5267 1200 or via email reception@hesse.vic.gov.au

Funeral Planning
Working out what is best for you.

Prepaid Funerals, Funeral Bonds, Pay-by instalments...

There are many options and its important to make the right choice.

Alyson Burchell will be available by appointment to answer any questions about funerals and planning ahead.



For more information or to make an appointment contact Sue on 5221 4788

Tuckers Community Office,
Surf Coast Taxation Services, 22 Willis Street,
Winchelsea

**First Tuesday of the Month,
by appointment 10.00am - 12.00pm**

Caring for families since 1883

Tuckers
Funeral & Bereavement Service
...for a life worth celebrating

5221 4788
www.tuckers.com.au

Winchelsea Taxis is now Surfcoast Taxis

Our fleet of vehicles are growing to all late models and we are covering an extended area including Winchelsea, Colac, Bannockburn, Inverleigh, Great Ocean Road and Geelong.

We have a fleet of 10 seater Maxi Vans, all with capacity to carry wheelchairs.

Surfcoast Taxis Pty Ltd
All Bookings: 0408 325 992
Fax: 5267 2699
Email: bannotaxis@gmail.com
(Admin or Stan 0429 672 888)
66A Batson Street
Winchelsea 3241



Accounts NDIS provider. TAC, DVA etc

NDIS provider number 4050001044
NDIS provider number 4050001048

Book your next ride with **smarHAIL**



Book Track Pay Rate

Download on the App Store | GET IT ON Google Play

Wightons Lawyers

Dispute Resolution & Litigation
Debt Collection
Property Law
Wills & Estates
Powers of Attorney
Business Law
Family Law

By appointment only

22 Willis Street, Winchelsea
ph. 5221 8777

www.wightons.com.au

