



20 | PRODUCT
23 | GUIDE

AMERICA'S ARCHERY ACCESSORIES



QUALITY ARCHERY DESIGNS



MADE IN THE USA. IN GOD WE TRUST.

QUALITY ARCHERY DESIGNS has been manufacturing exceptional and innovative archery products for over 30 years. Quality is not just in our name, it's our mission. We continually strive to provide customer service which is second to none. We understand that our success is directly tied to our customers' satisfaction and we are committed to being responsive to their needs.

We love archery and strive to be an industry leader. However, God is our passion. As a company that holds these strong core values, we are committed to carrying them out by treating our customers like family. We take pride in manufacturing our products in Madison Heights, Virginia, where we provide

hardworking Americans with rewarding jobs.

We're not interested in selling a high volume of mediocre products. Our goal is to manufacture only the best products. It means a great deal to us when customers choose to spend their hard-earned money on QAD products. Not taking this for granted, we hold each and every product to precise tolerance specifications and strict quality control before leaving our facility.

I love to climb into a tree stand after work and unwind as I enjoy God's beautiful creation.

A handwritten signature in black ink, appearing to read 'Dan Summers'.

Dan Summers
President & Founder

ULTRAREST®

SMARTREST TECHNOLOGY®



Easy lock and load With the convenient thumb lever, quickly load and cock the arrow into the capture position. The arrow is now fully contained.



Arrow will never fall off With Smart Rest Technology™ the ULTRAREST® knows to drop away ONLY when fired, not at slow let-down. Even if you have to let down the draw, the arrow remains contained.



Auto rotate When the bow is drawn, the launcher auto rotates to 90° and VDT™ is activated. Only when the bow is fired the launcher drops out of the way.



Total fletching clearance When the launcher falls, LDT® locks the launcher at 0°. This guarantees no bounce back and total fletching clearance for the most accurate shot possible even at speeds over 400fps.

FOCUS. PRECISION. RESULTS.

ULTRAREST® FEATURES



ULTRAREST® arrow rests are 100% designed and manufactured in the good ol' USA. Our arrow rests include a combination of innovative features you will not find in any other rest. Choose our cutting edge Integrate ULTRAREST® to pair with your new bow outfitted with the Integrate Mounting System®, or our Berger mount ULTRAREST® for your old faithful bow that you just can't part with. Either way, you can be confident each rest is held to precise tolerance specifications and put through strict quality control before leaving our facility, ensuring rock-solid reliability in the field or on the range.

*Integrate MX features pictured.



Micro-Click Adjustment Knob

Compatible with
INTEGRATE MOUNTING SYSTEM®

Machined Aluminum Launcher

Convenient Thumb Lever: Easy Lock & Load

Full-Draw Indicator Marks

TECHNOLOGIES



TOTAL CONTAINMENT
When you're drawn back and need to let down, the arrow remains fully contained.



ANTI-BACKLASH
Remove slop from the threads. Every click is an adjustment - no guessing!



LOCK DOWN
Drops and locks down, zero bounce back, zero fletching contact.



EZ CLAMP
No serving required; quick, easy cord adjustment.



SAFETY BREAK AWAY
When launcher is forced down, it will safely break away to prevent damage or injury.



ANTI VIBRATION
Cambrake and dampers kill noise & vibrations.



MICRO-CLICK
For each click, the rest will adjust .0019 of an inch.



VELOCITY DROP-AWAY
High-tension spring drops the launcher for clearance at over 400fps.

INTEGRATE MOUNTING SYSTEM®

THE BERGER MOUNT
IS OUT

THE INTEGRATE
MOUNTING
SYSTEM® IS IN

- Secures three axes instead of two
- Auto levels the rest to the bow
- Allows for sleek, lightweight rest designs
- Even if dropped, the rest will not rotate on the riser
- Allows closer quiver mounting for better center balance

INTEGRATE MOUNTING SYSTEM®

[A dovetail mounting rail machined directly into the bow riser.]

THEY GOT IT, DO YOU?

The industry's standard for mounting arrow rests has upgraded from the Berger hole mount to the Integrate Mounting System® (IMS). If your bow only has the Berger mount option you will be stuck with old technology. This is not just a custom option, this is an industry change on how arrow rests mount to bow risers. All relevant bow brands and arrow rest brands either have or will be making the revolutionary transition from the obsolete Berger mounting hole to the Integrate Mounting System®. Arrow rest companies are designing their top of the line rests and their future rests with the IMS feature. So, if you want to make sure the latest and greatest arrow rest from your favorite rest company will fit your bow then make sure your next bow has the Integrate Mounting System®.

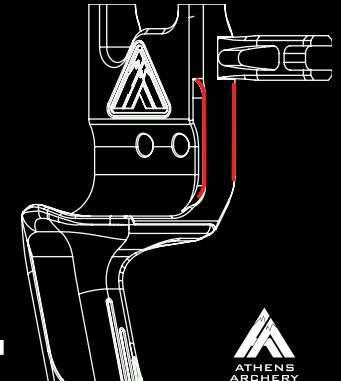
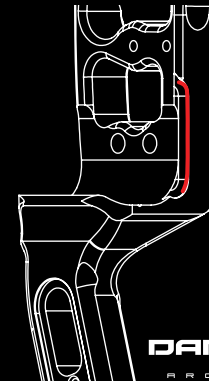
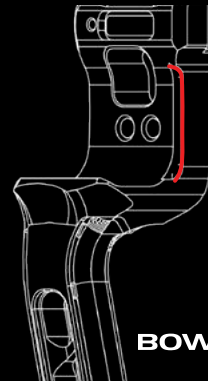
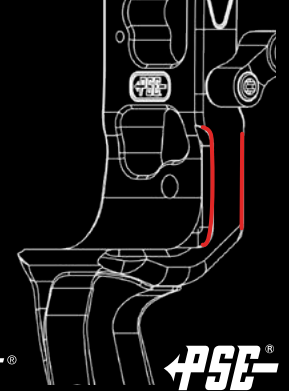
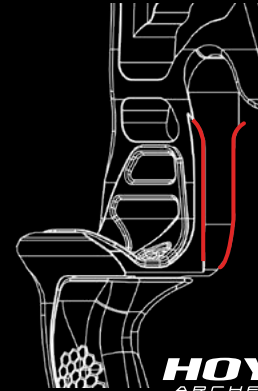
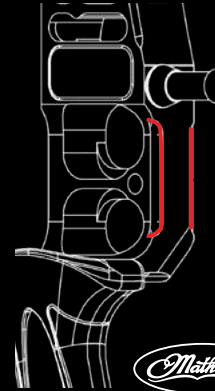

ULTRAREST® INTEGRATE MX



MSRP: \$269.99

LIMITED LIFETIME WARRANTY



See page 5 to learn more.

OUR PREMIUM ARROW REST The ULTRAREST® INTEGRATE MX features a super compact design, packed full of pro level features including precision micro-click adjustments with fine tuning capabilities of just .0019" per click.

The rest automatically levels itself when mounted to the bow, decreasing setup time. Mounting the rest to the IMS® eliminates the need for several parts making it the sleekest, lightest and most compatible rest to date. By no means was quality overlooked when crafting this rest, right down to the intricate launcher machined from high-grade aircraft aluminum. Boasting a 2X stronger hold you never have to worry about your rest moving. The seamless integrated design makes the rest look and feel like part of the bow. **Limited lifetime warranty.**

Compatible with



Custom OPTIONS



ULTRAREST® INTEGRATE R2



MSRP: \$199.99

LIMITED LIFETIME WARRANTY



See page 5 to learn more.

THE SLEEK GRIP & GLIDE REST The ULTRAREST® INTEGRATE R2 has expanded the Integrate Mounting System® revolution, making the berger button hole a thing of the past.

We have packed all the best features from our popular HDX model into a sleek, lightweight profile that fits the Integrate Mounting System®. The silky-smooth friction feel horizontal and vertical adjustments will allow you to tune this rest in record time. American ingenuity and precision engineering are evident in the fit and performance of this rest. The arrow rest market will never be the same. Made right here in the USA and backed by our **limited lifetime warranty**.



Compatible with







ULTRAREST® HDX



MSRP: \$155.95 - \$183.55
LIMITED LIFETIME WARRANTY



VDT™



EZT™



SBT™



LDT™



TCT™



AVT™



See page 5 to learn more.

QUALITY WITHOUT COMPROMISE The ULTRAREST® HDX combines innovative features with a track record of unmatched reliability.

The versatile design and rock-solid dependability has made this rest the award winning choice of archers for years. The world's leading bow manufacturers utilize our *Custom* designs to tailor this rest to their bows, reducing tuning time and optimizing performance. The HDX comes in a variety of camos and colors. Made in the USA to our exacting quality standards, we stand behind this rest with a **limited lifetime warranty**.

Custom OPTIONS



ULTRAREST® LD

ULTRAREST® HUNTER



MSRP: \$129.95
LIMITED LIFETIME WARRANTY



MSRP: \$69.95
90-DAY WARRANTY



See page 5 to learn more.

See page 5 to learn more.

THE REVOLUTION OF LOCK-DOWN ULTRAREST® LD is the rest that started the revolution of Lock-Down Technology™. This patented feature guarantees no bounce back and total fletching clearance.

The LD changed the world of drop-away rest designs, especially with high-speed bows. If you don't need all the options of the HDX but want a high-end, long lasting piece of equipment, this is the rest for you. You can also save a few bucks while you're at it. **Limited lifetime warranty.**

MORE BANG FOR YOUR BUCK The ULTRAREST® HUNTER is, by far, the highest quality drop-away you will find at it's economical price of only \$70.

We specifically set out to design a model for those that want a quality drop-away but don't have the budget for our upper models. Even at that price, we didn't compromise on anything. Every part of the HUNTER is made here in our Madison Heights, Virginia facility. **90-Day Warranty.**

ULTRAREST TRI[®] SERIES



MSRP: \$399.99
LIMITED LIFETIME WARRANTY

Compatible with

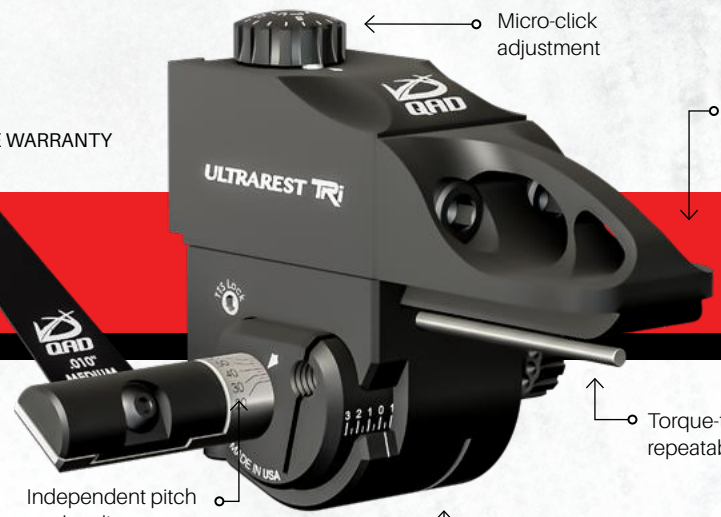

Micro-click adjustment

Removable torque tune rail

Replaceable lizard tongue (Nine options available)

Independent pitch angle adjustment

Torque-tune repeatable stop bar

Switchit™ removable housing



BERGER HOLE ADAPTER Can't part ways with your long-loved bow and haven't upgraded to a modern bow with the Integrate Mounting System? Retrofit any Integrate arrow rests to your old bow, with two different models available to accommodate the full range of riser widths.

PREMIUM TARGET REST

Thanks to years of development by QAD's innovative team and proven by World Champion Levi Morgan, the next revolution in target rest design is here. The ULTRAREST TRI[®] was designed to provide the target archer an extremely robust rest with maximum forgiveness, precision tuning, repeatable settings, the highest level of quality, and the type of accuracy that puts shooters on the podium.



LIZARD TONGUE GUARD

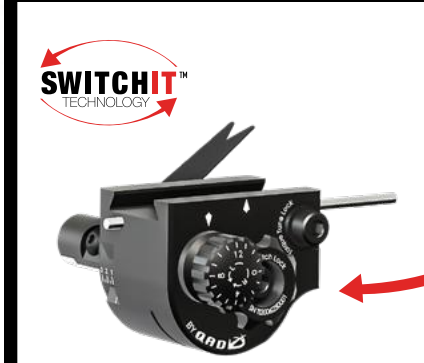

TRI TECHNOLOGY



REPEATIX

Locating features allows parts to be replaced within .001" of its original position.



MICRO XTREME CLICK ADJUST

.0019" of adjustment per click.



ANTI-ROTATION TECHNOLOGY

Eliminates the possibility of the arrow rest rotating on the riser.



DUAL CLAMPING

Two locking clamps that directly lock the rest to the bow riser.



SWITCHIT TECHNOLOGY

Easily switch out rest housings for multiple arrow setups.



AUTO LEVEL TECHNOLOGY

Once mounted, the TRI is automatically level.



Imagine a target rest that could significantly increase forgiveness and make the arrow hit the same spot, even if the bow is torqued.

QADINC.COM/PATENTS





**TOUGHEST HEADS
ON THE MARKET**



STANDARD

- Grains: 85, 100, 125



DEEP SIX™

- Grains: 100



CROSSBOW

- Grains: 100, 125
- 22/64 diameter washer

FEATURES
DEATH

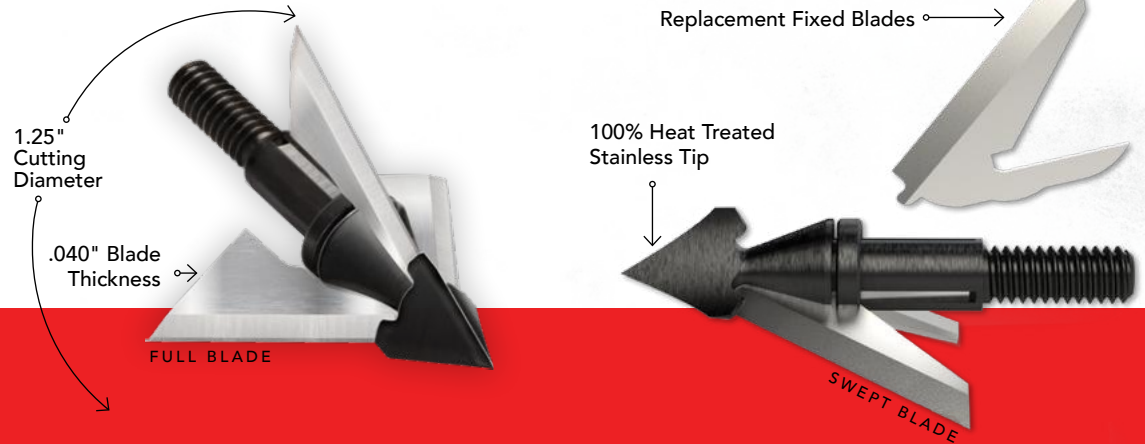

TIGHTER GROUPINGS | UNMATCHED CONSISTENCY | FLIES LIKE A FIELD POINT
BLOWS THROUGH BONE | CUTS LIKE A RAZOR | EXTREME PENETRATION | DEATH

TOUGHEST HEADS ON THE MARKET

EXODUS® broadheads are 100% designed and manufactured in the good ol' USA. The revolutionary compact head gives it the strength to bust through the toughest bones. By matching the length of a field point, the EXODUS® achieves accuracy never before experienced from a fixed blade. With razor-sharp, durable blades and a steep cutting angle, the EXODUS® tops the broadhead market in penetration.



MSRP: \$42.99 (Pack of 3)
QADINC.COM/PATENTS

**BROADHEAD
TECHNOLOGY**



PRECISION SPIN TECHNOLOGY™

Tight machining tolerances maintain consistent spin and equal weight for repeatable results.



BLADE OVER SHAFT TECHNOLOGY™

The blades sweep back over the arrow shaft creating a super short, compact head. This results in unmatched field-point flight while maintaining extreme penetration and a large cutting diameter.



QAD GEAR



COOL SHIRTS, HATS, KNIVES & MORE!

Check out our website for all the latest QAD gear. Get your stylish t-shirts, custom hats, arm guards, SOG knives and more. Visit QADinc.com for pricing and to order yours today. Supplies are limited.

ULTRANOK®

The best-selling metal nocking loop

The ULTRANOK® was designed to provide an easily adjustable, lightweight nocking point solution for all of your arrows. Easy to install and tune, the ULTRANOK® outlasts a string loop and perfectly aligns your peep sight.



TUNEANOCK®

The fastest, most accurate nocks on the planet

The TUNEANOCK® was designed to increase the accuracy, speed, and consistency of your arrow. Lightweight design combined with low string friction allow the TUNEANOCK® to add up to 4 feet per second compared to other nocks. (Shown here in available colors.)

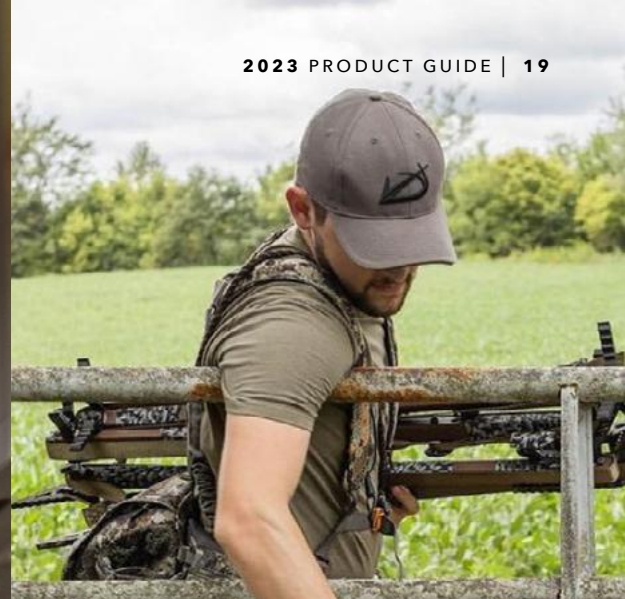



qadinc.com

