

PORT- FOLIO

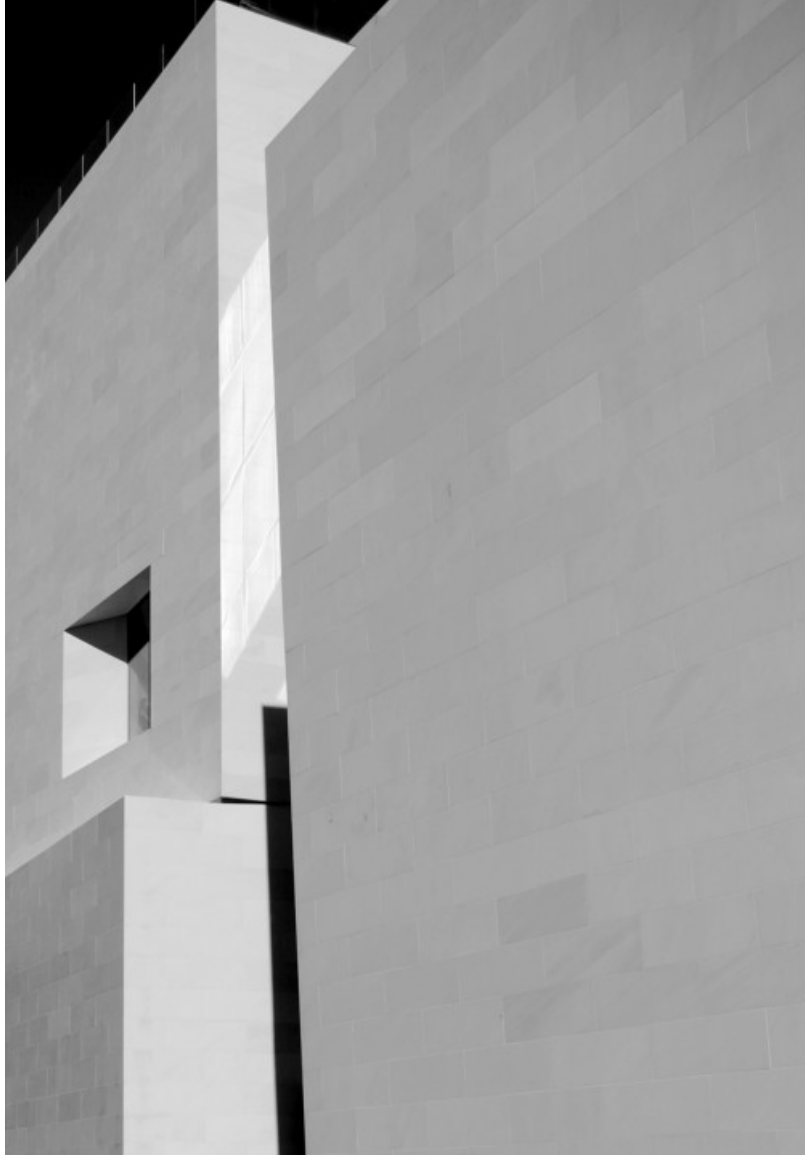

HELLO
MIAMI!

*Schwinghammer
expands its
footprint*



Boonteshop - South Korea
See on page 12

On the cover:

56 Leonard, NYC
Architect: Herzog & de Meuron

Hello Miami!

Schwinghammer Expands its Footprint

We have been wanting to share this exciting news with you for some time. Schwinghammer is coming to Miami!

To commemorate this milestone for our firm, we have been looking at our past and our future. We've seen how far we have come, and how much more opportunity for growth there is. From that intersection of the accomplished and the upcoming comes PORT-FOLIO.

PORT-FOLIO will be a periodical publication in which we will examine themes within our built work. It will not only showcase the solutions we've brought to the challenges unique to each project, but also celebrate the professional relationships and partnerships we have nurtured with architects and designers over the years.

In this introductory issue, our "Hello, Miami!" theme will take us through some iconic projects from different corners of the country and the world. All of these share some traits that made us think of the current scene at the Magic City.

Enjoy!

NYC

56 LEO- NARD

In collaboration with
Herzog & de Meuron

Architecture and custom interiors by Pritzker Prize-winning architects Herzog & de Meuron. Located in Tribeca, 56 Leonard is a 60-story expression of sculpted surfaces and sparkling glass with an original Anish Kapoor sculpture at its base. The 145 unique condominium residences, each with private outdoor space, have soaring 11'- 14' ceilings and breathtaking panoramas of the cityscape, rivers, bridges and beyond. The 17,000 square feet of amenities include a 75' lap pool with a sundeck, gym, screening room, lounge, private dining room and playroom. A Global Landmark redefining New York living.

Our approach to lighting in this project takes advantage of the sculptural and material qualities of the space to re-think the concept of residential lighting with tools ranging from a spectacular neon installation to filtered beams of light.





View of 56 Leonard tower from Tribeca





Sitting Area





4 FEET 2 INCHES

4 FEET 6 INCHES

DEEP

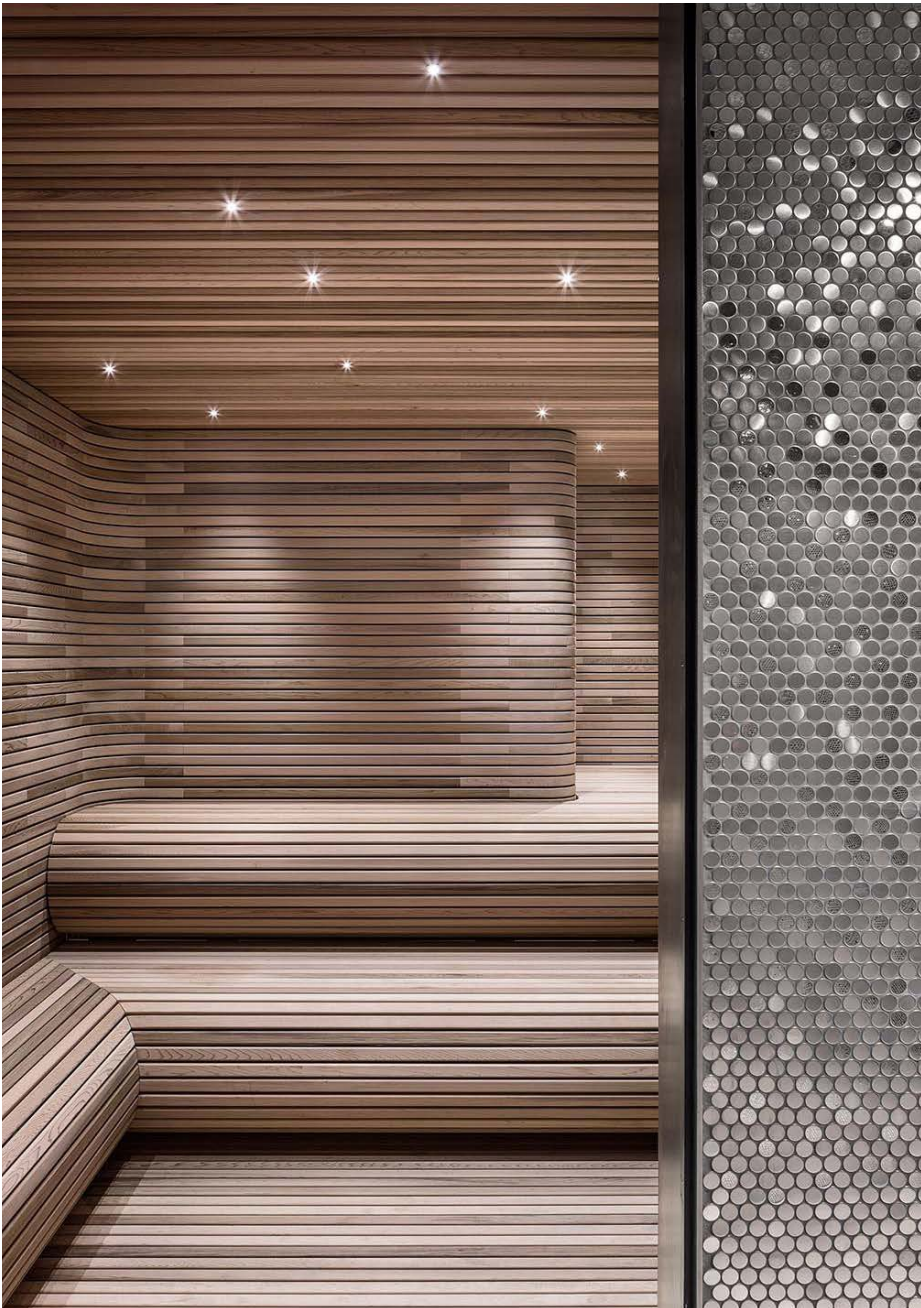

Spa

SEOUL

BOONTHE- SHOP

In collaboration with
Peter Marino Architect

The flagship for Seoul-based women's specialty store Boontheshop comprises 55,000 sq ft spread over seven floors. Located in the prominent retail district of Cheongdam, largely characterized by its dense cacophony of architectural styles, the developed project of an austere massing comprising two polished angular volumes in white marble serves as a powerful, calming statement. Our lighting strategy emphasizes the geometry of the volumes, creating sharply contrasted edges that facilitate the visual understanding of the form.



Feature Wall





Staircase

DR. BARBARA
STURM



NYC

DR- STURM

In collaboration with
Tobias Freytag + HuxHux Design

17

This is the first retail flagship for Dr. Barbara Sturm in the United States. We worked with the client's brother and project design architect, Tobias Freytag, to enhance their vision for the retail and treatment spaces with lighting. The project embodies the skincare brand's ethos and offers clients a unique way to experience both treatments and product.



Retail Area



DR. BARBARA
STURM



BLUE RIDGE



BLUEPRINT

NYC

COLOR- FACTORY

In collaboration with
Paul Bennett Architects



Color Factory is a collaborative interactive exhibit, housed in a 20,000 square feet gallery, that celebrates color and creativity. It features large-scale participatory installations of colors that were collected around the city— hues that invite curiosity, discovery and play. The palette and projects offered within Color Factory connect the visitor to the colorful moments around New York City.

Interactive Booths





Treats Room

JAMAICA

COT- TAGE

26

In collaboration with
Frank Greenwald - Architect
Mary Foley - Designer





Living Room

Pool Area





NYC

53W- 53

In collaboration with
Atelier Jean Nouvel - Architecture
The Office of Thierry W. Despont - Interiors

29

53W53 is the most architecturally significant addition to the New York skyline in recent years. A gracefully tapered, 1,050-foot-high tower rising above The Museum of Modern Art, 53W53 represents a bold artistic and technical achievement by Pritzker Prize-winning architect Jean Nouvel.

The elegant, refined interior spaces of the private residences are designed by noted architect Thierry Despont. Complementing Nouvel's innovative design, these homes offer a 21st century vision of the gracious urban living for which New York is celebrated.

Our approach to lighting this masterpiece takes inspiration from Nouvel's contemporary form and Despont's material palette. The result is a building that is fully-integrated in the skyline at night and an interior space that is warm and inviting.

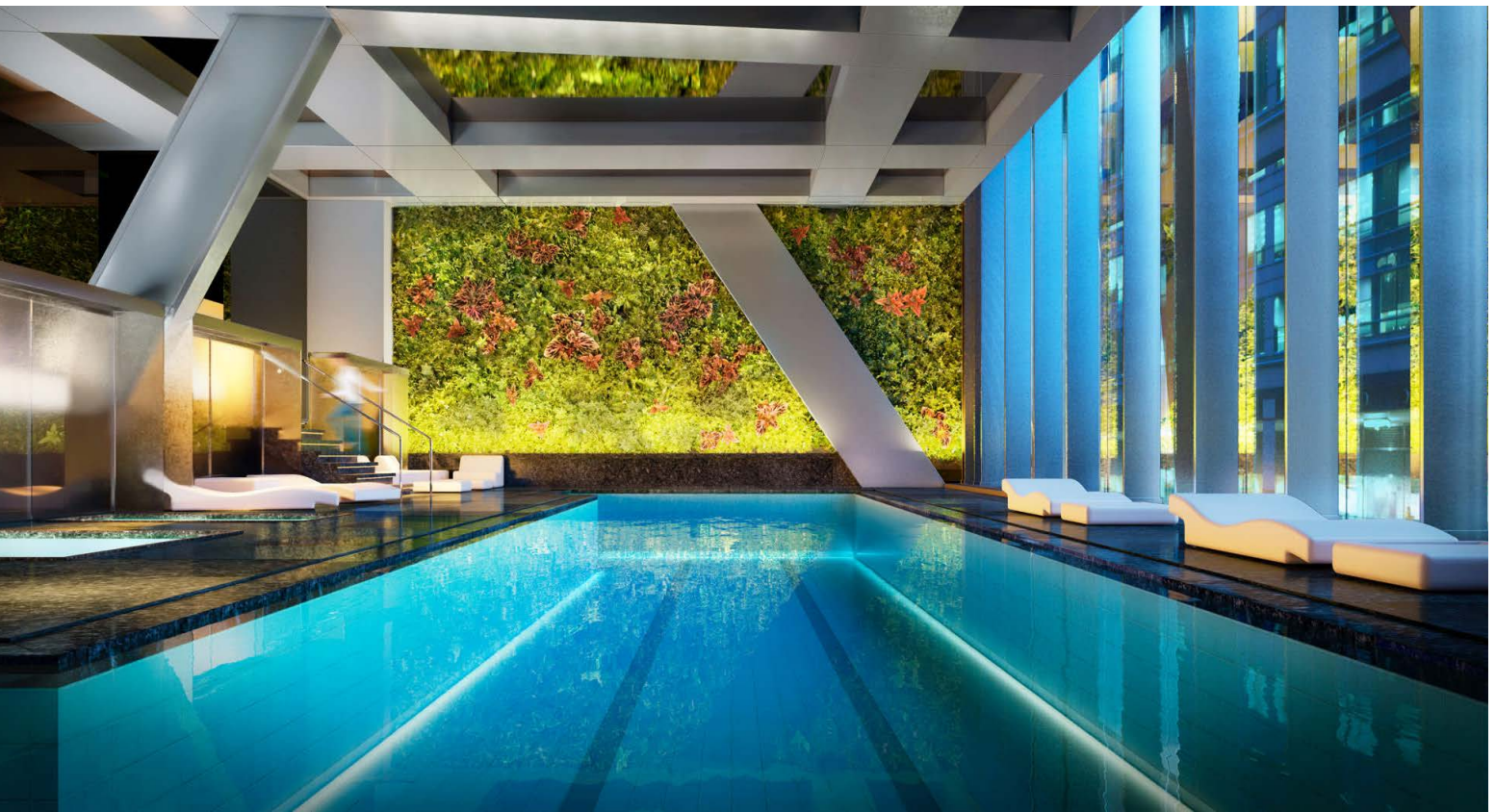

Pool Area



Gym Area

NYC

TOMMY- BAHAMA

In collaboration with
Michael Neumann Architect

Located in the Fred F. French Building, an art deco landmark skyscraper on New York's Fifth Avenue, the 13,000 SF Tommy Bahama Restaurant, Marlin Bar, and Store are conceived of as an urban resort. Feature elements in the store include window louvers of salvaged Coney Island boardwalk Ipe wood, campaign style fixtures and custom lantern pendant lights in the atrium. The bar features reclaimed, weathered oak siding, a custom, bent metal, back lit bar screen, a hand-painted mural and a monumental blackened steel and Ipe spiral staircase with solid brass "rope"-wrapped railing that links the Marlin Bar to the Restaurant above.



Bar





Restaurant



Delano South Beach
In collaboration with Philippe Starck
Miami, FL



Costa Smeralda Yatch Club
In collaboration with Peter Marino Architect
Sardinia, Italy



Villa Nara Mondadori
In collaboration with Peter Marino Architect
Saint-Jean-Cap-Ferrat, France



Boca Raton Resort & Club
In collaboration with The office of Thierry W. Despont
Boca Raton, Fl



335W 38th St
New York, NY 10018
212 967 5944

info@sl.gallery
www.sl.gallery

SLGALLERY

Established in 2017, SL Gallery is an inclusive space dedicated to presenting works that merge contemporary art, lighting and new media technologies, providing support for the diverse creative practices of emerging, mid-career and established artists within the community.

Serving as an extension of the architectural lighting office at Schwinghammer, I am heavily inspired by visual art, design, and lighting on the edge of concept.

The artists selected to exhibit at SL Gallery are a representation of this vision and have included Fabrizio Corneli, Aleksandra Stratimirovic, Anne Katrine Senstad and Karen Gunderson.

Tony Long
Gallery Director

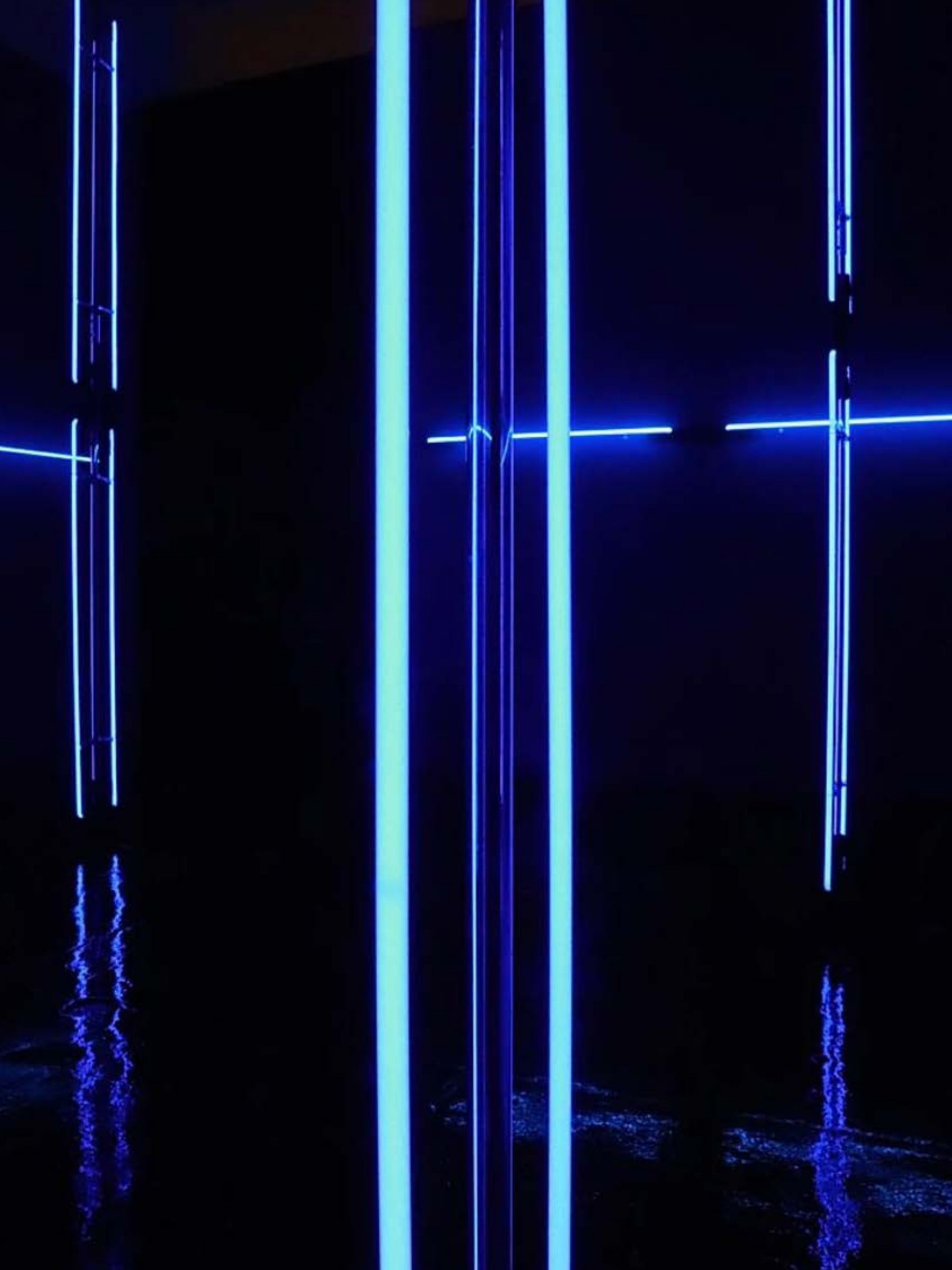



Anne Katrine Senstad: "Beckoned to Blue"
April 3 - May 31, 2019 at SL Gallery



Vicki DaSilva
"Lumen Lineation"
September 7 - October 19, 2018

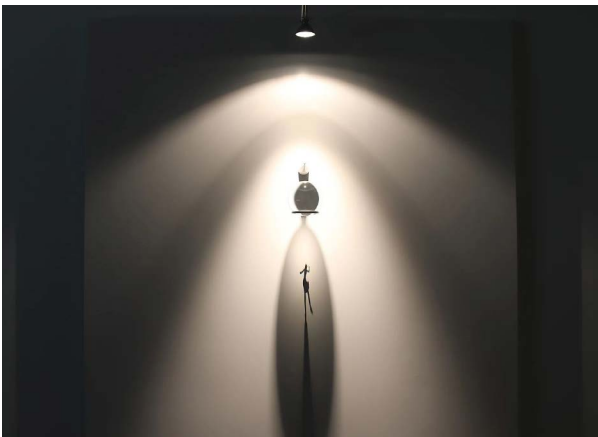

Targetti Light Art Collection
"Light Art"
May 3 - June 15, 2018

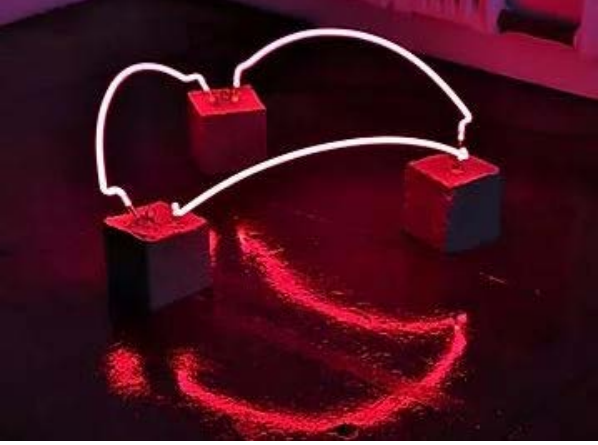

Patrick Nash
"Unfinished Business"
October 21 - December 8, 2017



Issue 1

SCHWINGHAMMER

Schwinghammer Lighting LLC

NYC: 335 West 38th St New York, NY 10018
212 967 5944

Miami: 3900 Biscayne Blvd Suite 1116 Miami, FL 33137
305 422 1791

www.schwinghammerlighting.com