



brilliant



Bathroom Edition: Shower Wall Installation

CME-2011
GECA 28-2006 v2
Furniture and Fittings

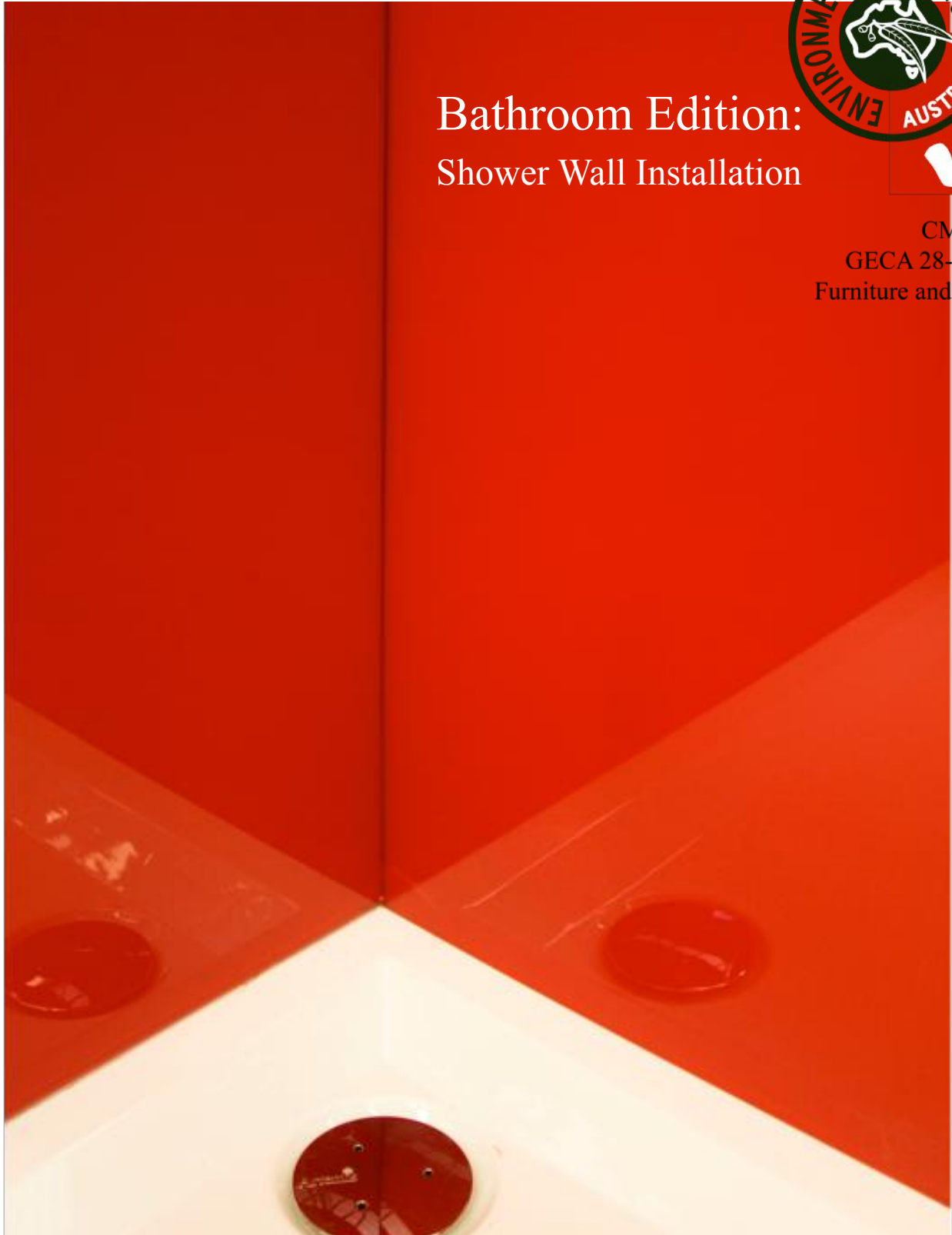

Cutting Akril Down

Circular Saw

Always cut Akril on a flat secured surface.

With quality equipment, an excellent edge finish can be achieved with Akril. The main factors in achieving the best possible outcome with a circular saw are:

- Panel rigidity. Clamp the sheet on both sides of the cut.
- Saw stability. Always use a good quality fence or guide to improve saw stability and straight-line cutting.
- Saw bearing quality. The price of a circular saw can be a good indication of the quality of the bearings used inside. Cheaper saws often use bushes that offer little to limit the blade's sideways float, and will begin to wear quickly. This will have a dramatic impact on cut quality.
- Blade selection. Always use a blade with the correct cutting geometry. Aluminum blades generally work well with Akril.

Reduce the cutting depth to allow the blade to cut approximately 7mm through the Akril, preferably cutting into a sacrificial MDF board or similar.

CIRCULAR BLADE GEOMETRY AND CONDITIONS

Circular Blades for Akril.

Akril is best cut using fine-tooth Aluminum circular blades with either a 'hollow ground' geometry or a 'triple chip' blade with the following.

Geometry and Conditions:

Blade Diameter	255-305mm
Number of Teeth	80-100
Tooth Thickness	3-3.5mm
Clearance Angle	15-20°
Cutting Angle (Rake)	-5°
Angle of Setting Band	2-3°
Blade Speed	3000-5000rpm
Surface Speed	3000-4000m/min

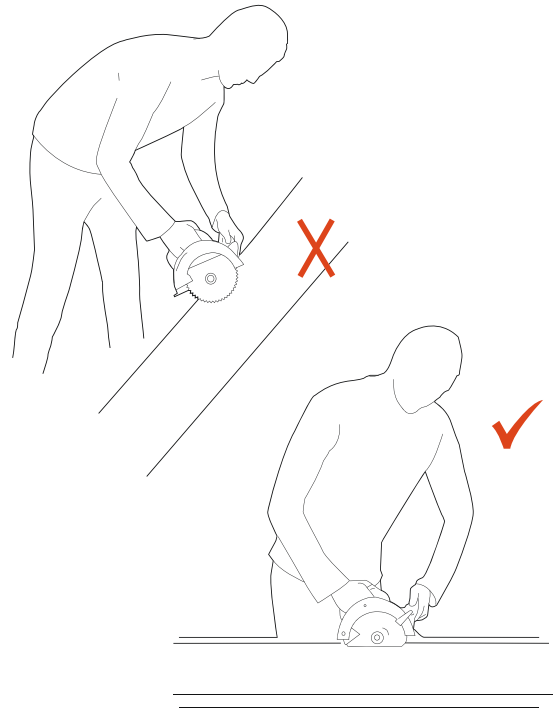

Hole Saws

Hole saws should be sharp, but the pilot drill blunt. It is recommended to drill the hole saw half way through, then turn the Akril over and finish the hole. This prevents the edge from 'blowing out'. De-bur the edge with 100-grit sandpaper.

Determine the position of the outlet on the panel and mark the centre. Now mark 20mm either side of the centre mark. Drill each hole with a 65mm hole saw.

Cutting of Penetrations

When measuring and marking for cut-outs around power outlet boxes etc, ensure enough clearance is given for the switch body and that the cover plates or bulkhead fittings will cover the finished cut-outs.

Use an approved sealer to seal the edge and a 50mm perimeter of the painted side of any Cut Outs.

The Akril logo and Akril trademarks are all the property of CME Coatings, Australia.

DISCLAIMER Akril has produced this catalogue to serve as a general guide for products offered to our clients. We have made every effort to ensure the information contained herein is accurate at time of publication, but accept no responsibility or liability for loss incurred directly or indirectly as a result of the use of these specifications and technical data.

COPYRIGHT The contents of this publication are copyright. There can be no reproduction of the material contained herein without the expressed permission of CME Coatings Pty. Ltd.

Sealing Edges, Perimeters and Cut Outs

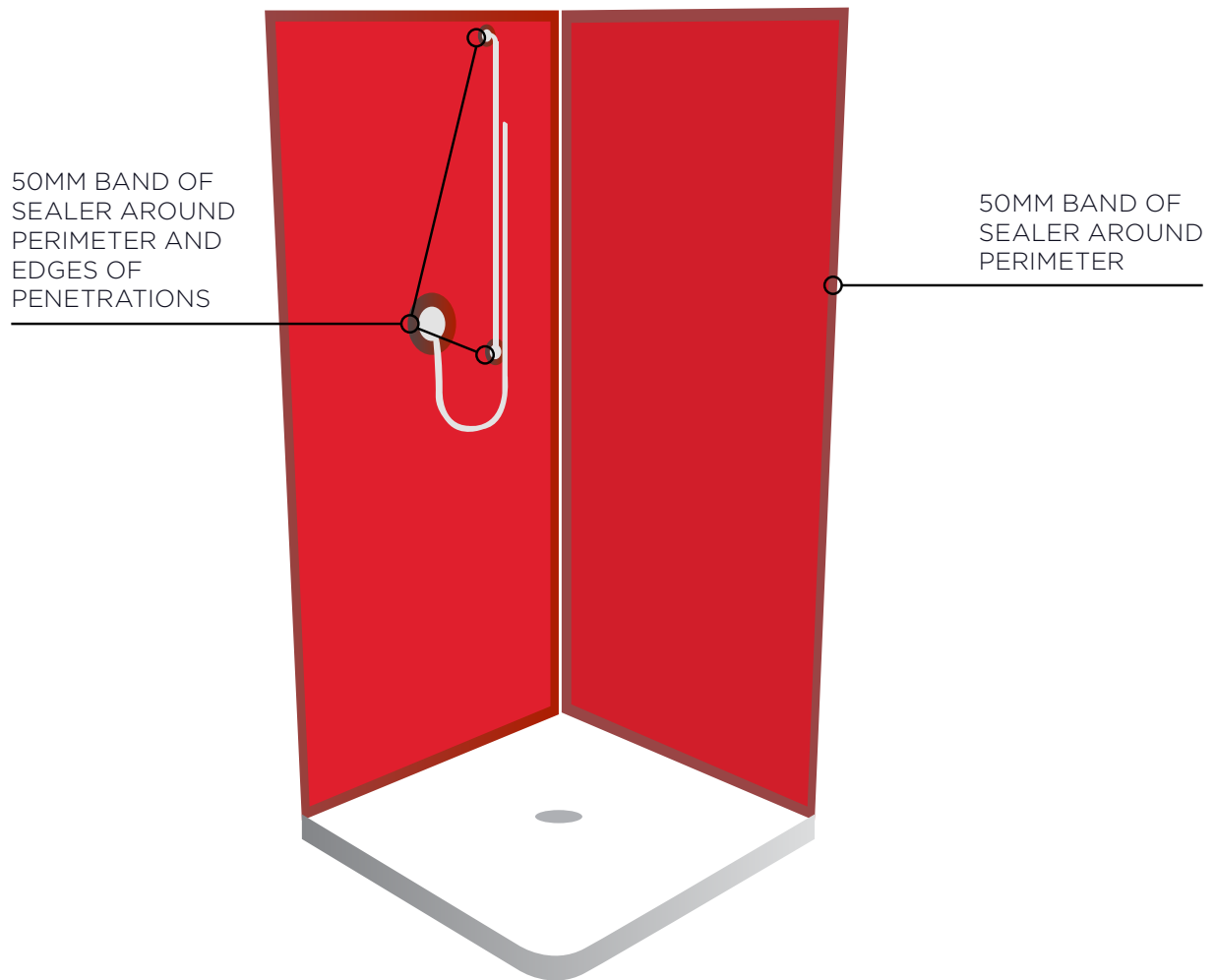

It is important to protect the rear (coated) side of Akрил from moisture. Akрил needs to be sealed with a band of neutral cure silicon extending 50mm from the edge of the panel.

This should include:

- The perimeter of the sheet including any cut outs made
- Perimeter of any penetrations made i.e. tape holes
- The edges of these cut outs

Installing Akril into a Shower Tray.

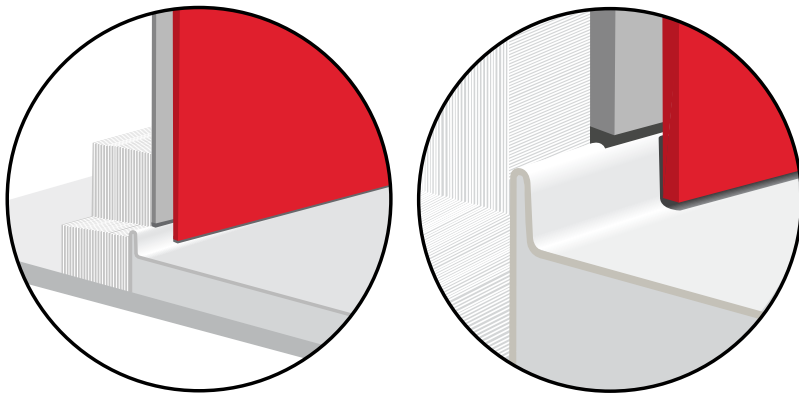
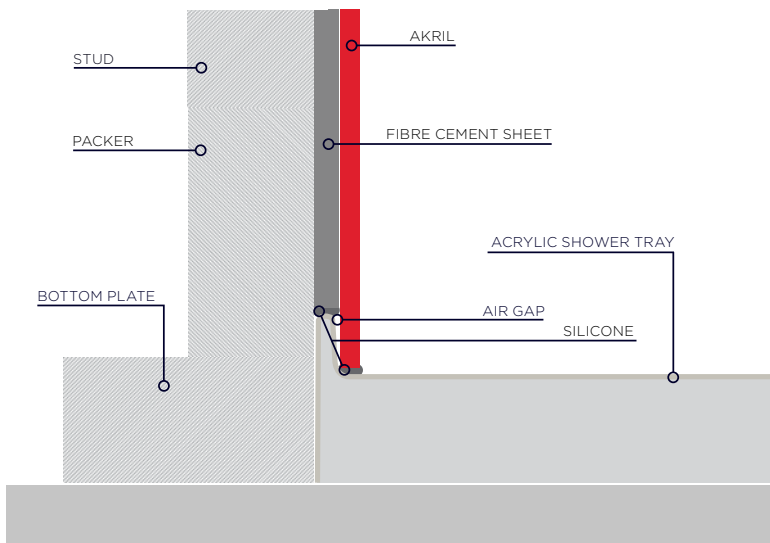

Acrylic shower trays are commonly installed using the system detailed below.

Acrylic tray should be mounted up to the bottom plate of wall in accordance with the manufacturer's installation instructions.

A manufacturer's recommended water proof board should be laid against framing following manufacturer's instructions, down to within 6mm of shower tray.

Flexible caulking should be installed between top of tray and bottom edge of wall lining in a continuous bead, then smoothed off as illustrated.

Akril is then installed over the wall lining and over the up-stand lip of the tray, as illustrated above with a bead of flexible caulking between; the back of Akril and front of tray up-stand lip, and the top of tray and bottom edge of Akril.

A gap should be left between the two caulking beads to act as a capillary break.

Note: *The waterproofing system for your bathroom or shower must meet specific Australia standard building regulations.*

Weep Hole Sealing Detail

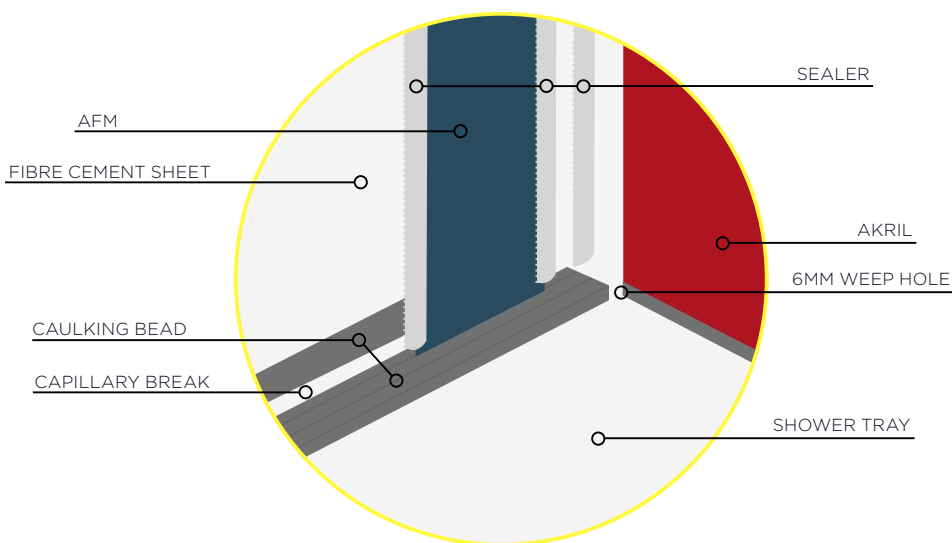
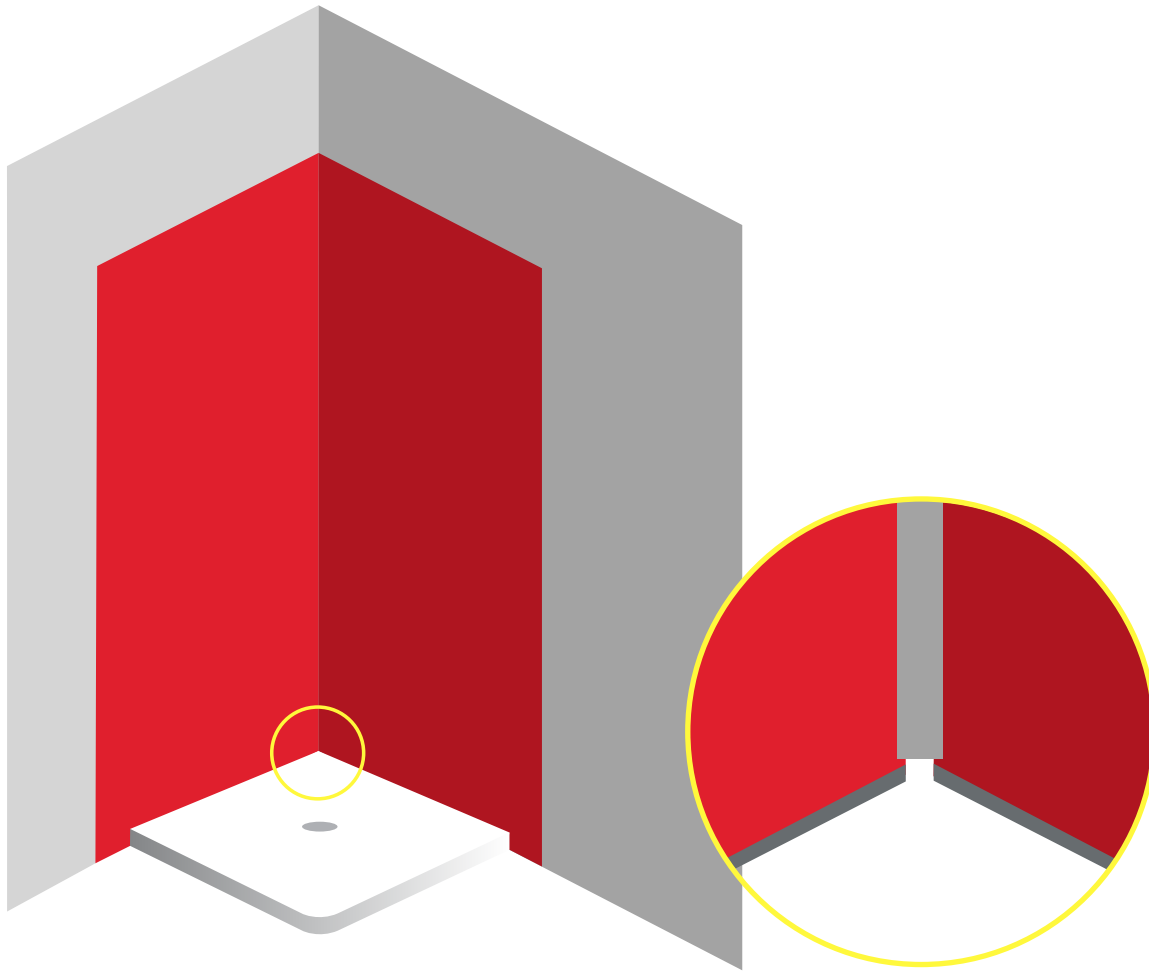

Note:

Left side Akril piece removed to show detail in more clarity.

Installing an Anti-Fracture Membrane.

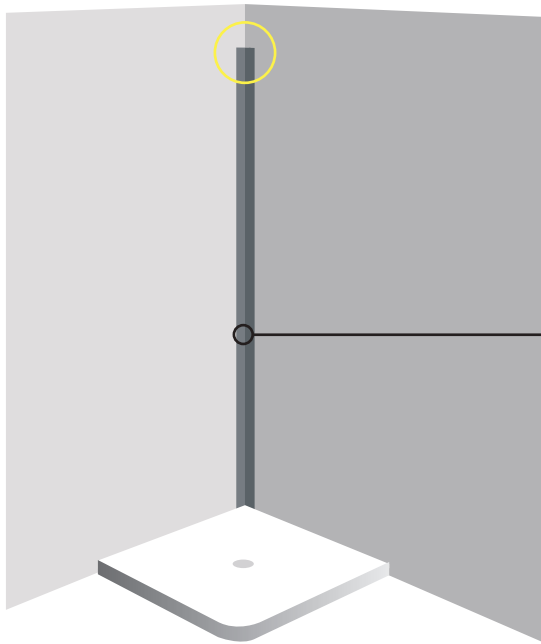

ANTI-FRACTURE
MEMBRANE (AFM)

Install a suitable anti-fracture membrane in the internal corner running from the finished installed height of the shower, down and over the lip of the tray, terminating at the bottom of the tray lip.

There should be as small a radius as possible in the wall corner.

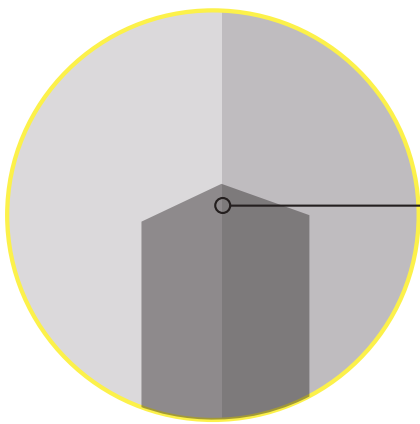

SHARP AS
POSSIBLE CORNER

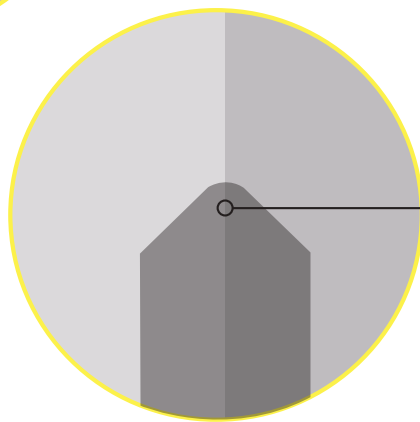

NO RADIUS IN CORNER

Pre-drilling Screw Holes (shower frame)

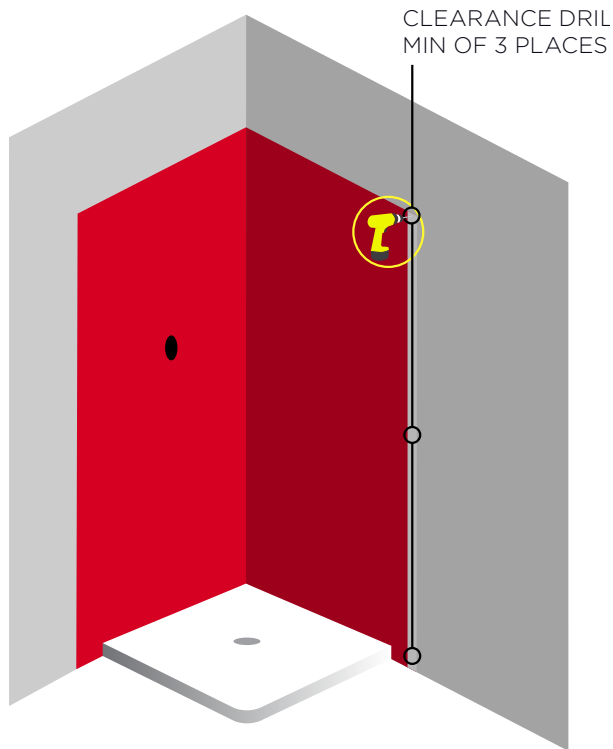

Do Not Screw Directly Into Akрил as it may cause the Akрил sheet to split.

Peel back protective film from front face of Akрил, to the width of door return + 25mm from the outer edge of Akрил.

Fit door returns in place ensuring they are in the correct position and plumb.

Drill clearance holes through Akрил and wall linings using a blunt drill bit outlined in detail for Machining Akрил.

- A minimum of 3 fixing points should be used in a 1.8m high shower.
- A minimum of 4 fixing points should be used in a 2m high shower.

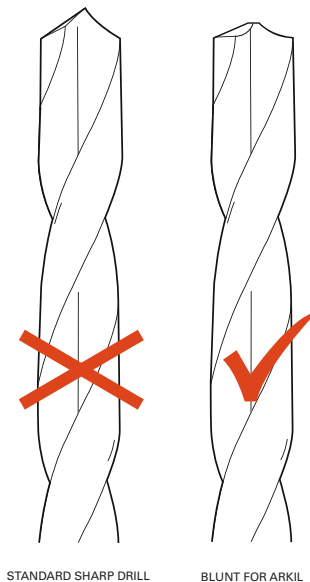
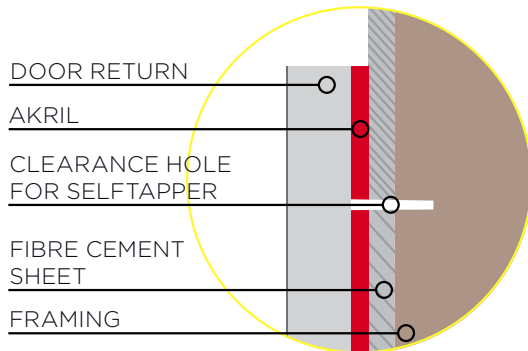

Installing the Internal Corner and Adhere Sheet

Remove the protective film from rear of Akрил.

Seal the perimeter and all penetrations and penetration edges with a band of neutral cure silicon or acrylic sealant extending 50mm from the edge of the panel as illustrated, above.

Apply adhesive to rear of Akрил as shown in the illustration, above.

Apply bead of flexible caulking to up-stand lip of tray.

Apply a bead of flexible caulking along the full height of the corner onto the liner at the edge of the anti-fracture membrane.

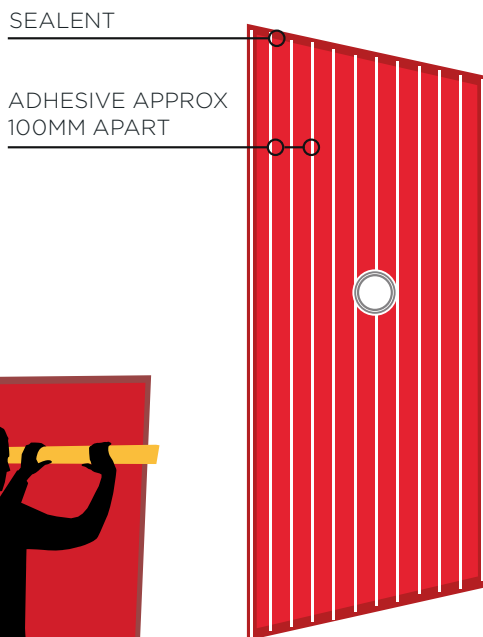
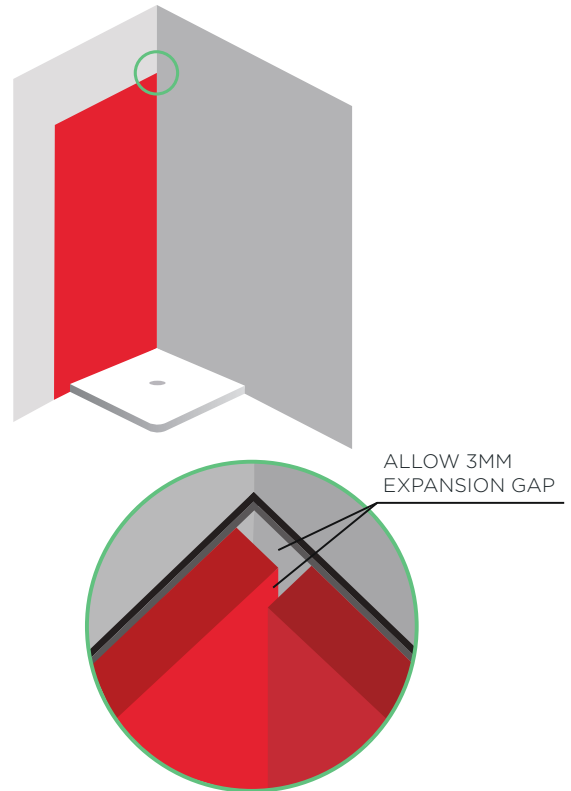

The internal corner is crucial to the installation as it will allow for thermal expansion and contraction.

Each Akрил sheet will expand and contract 3mm into and out of the corner silicone join.

The first sheet will butt into the wall and allow for 3mm expansion while the second sheet will butt onto the first Akрил sheet allowing for expansion and contraction against the first Akрил sheet which was installed. This will reduce the visible join line to 3mm instead of 6mm.

Hint: Use a straight edge to press Akрил onto the wall to ensure a flat finish.

Fixing Shower Frames and Tapes

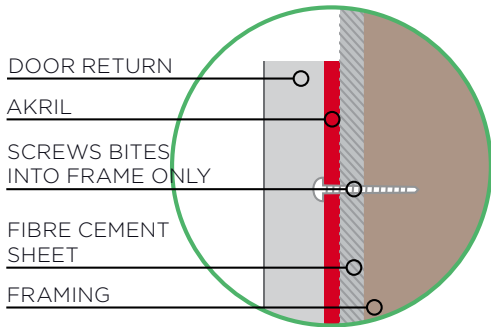
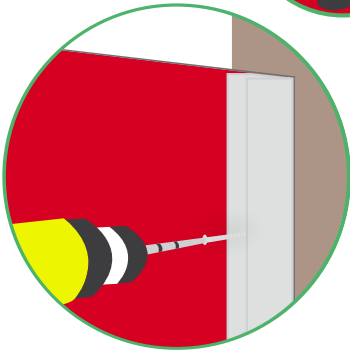

Shower Frame

Fit door returns back in place.

Fill holes with flexible caulking before screwing returns to the wall.

Check for plumb and position before final tightening of door return fastenings.

Tapes

Peel back protective film from front face of Akрил, to 25mm beyond the outer edge of the tapes installed perimeter.

Apply a bead of flexible caulking around the perimeter and a second bead around the cut out in Akрил.

Both beads should be finished as shown above to allow for any moisture to drain away.

Fix tapes as per manufacturer's instructions.

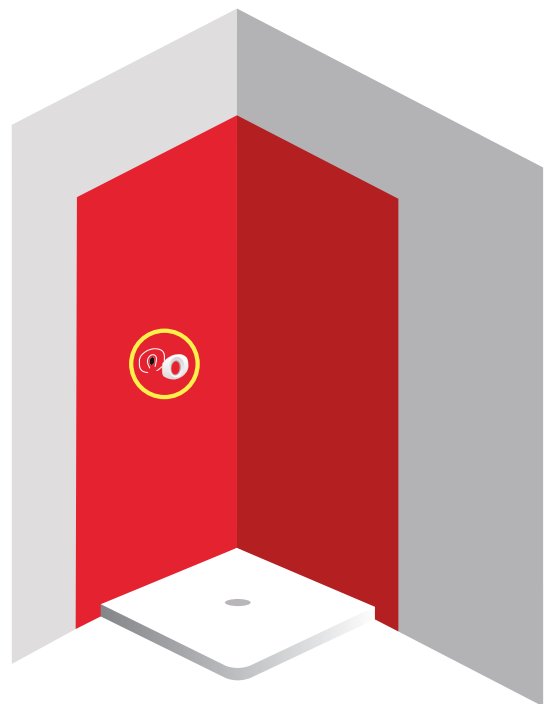

Sealing the Internal Corner

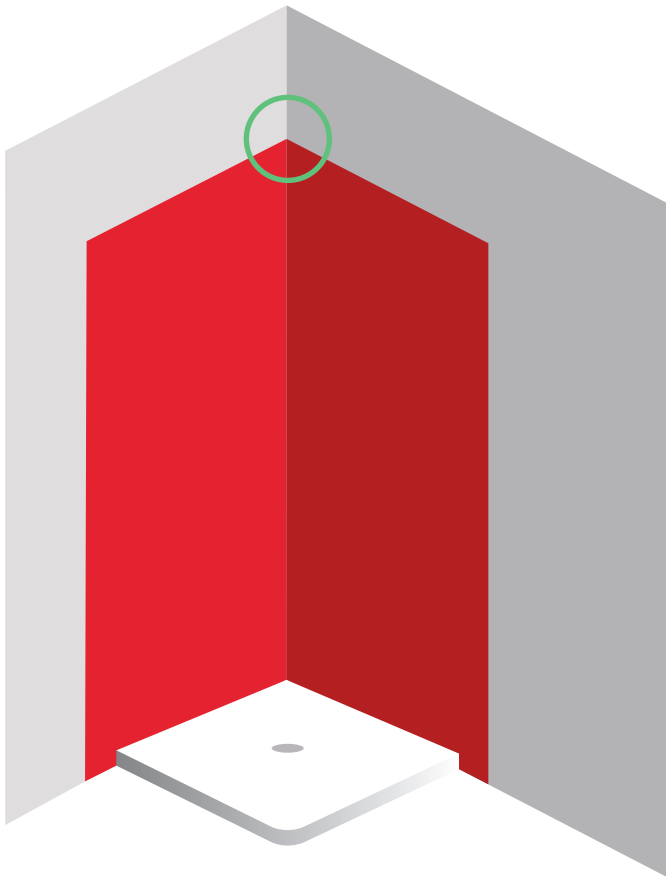

Akril suggest in accordance with water proofing standards a neutral cure silicone bead is run from the top of the Akрил down the internal corner to the bottom of the shower base to seal the panel. This is to prevent any moisture penetrating down behind the lining. Special attention should be paid to the top and bottom of the internal corner and anti-fracture membrane areas.

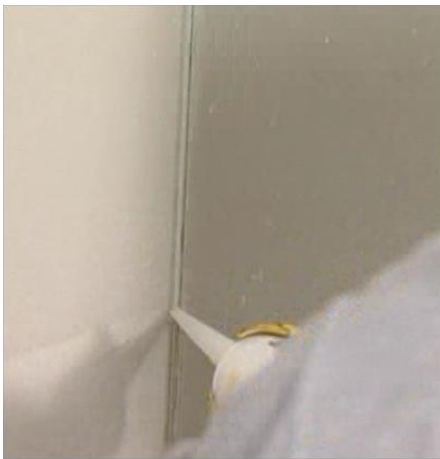

Note: Run Silicone down internal corner for water proofing

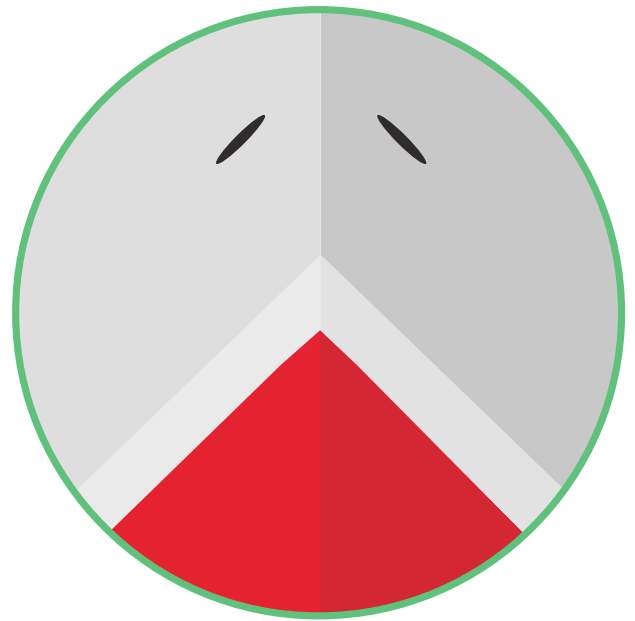

Note: *The waterproofing system for your bathroom or shower must meet specific Australia standard building regulations.*

Fitting the Showerscreen and Utilities

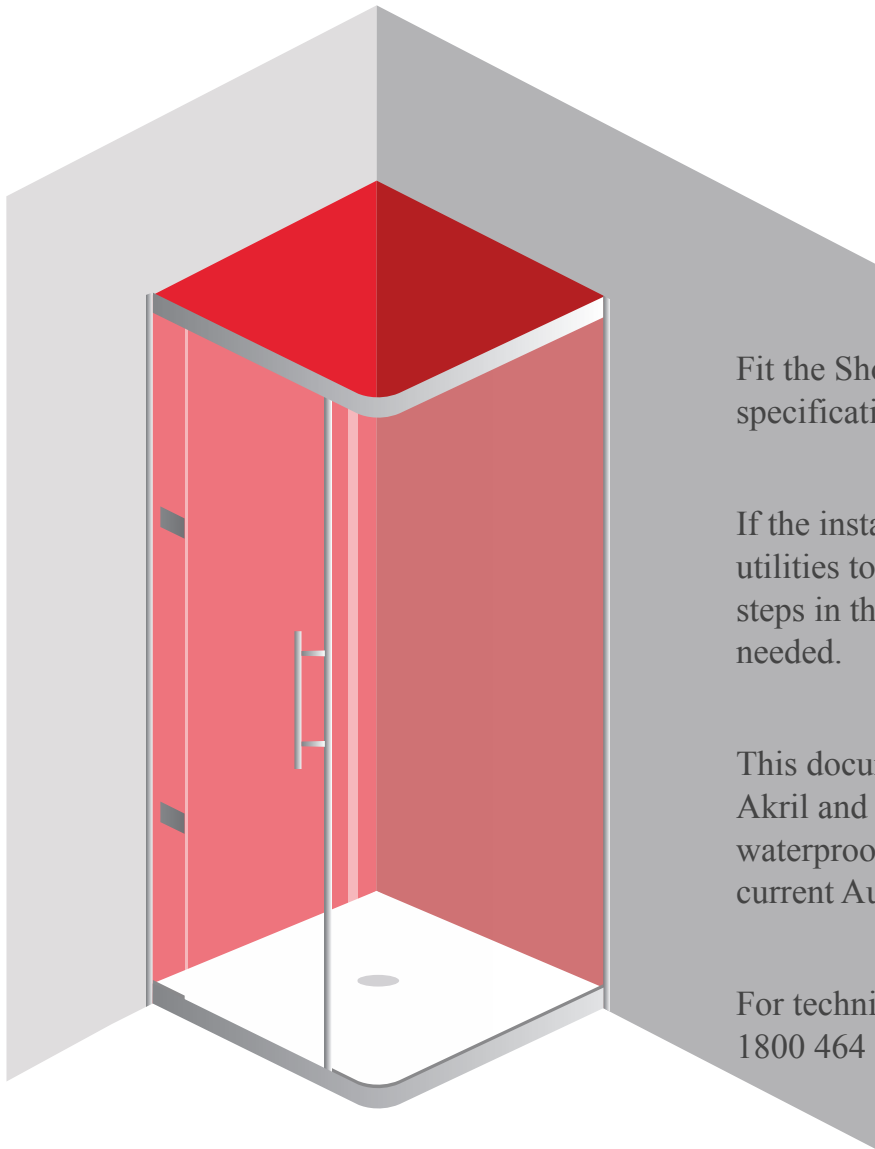

Fit the Showerscreen to manufactures specification.

If the installer is required to fit any extra utilities to the the Akril be sure to follow the steps in this document where machining is needed.

This document is a guideline for installing Akril and will not wear any liability for waterproofing which should be installed to the current Australian Standard.

For technical help please contact Akril on 1800 464 728.

Akril TM
ABN 23 007 128 289
15 – 17 Antonella Court
Dandenong
Victoria 3175
T 1800 464 728
F (03) 9768 3747
www.akril.com.au