

# The WORKSHOP Catalogue

April - September 2026 All prices quoted include GST.

**Fritzfurt**  
**Rotary Tool Kit**  
**New!**  
 276 Piece Kit

276 Piece kit consists of:

- Grinding Drums & Discs
- Precision HSS Drills
- Cutting Discs
- Diamond Burrs
- Sanding Pads
- Abrasive Wheels
- Flap Wheels
- Rotary Brushes
- Felt Polishing Discs
- Backing Pads
- Polishing Mediums & Stones

**\$59**  
 PN: RTK276



**NICRON**  
**Focusable Rechargeable Head Lamp**  
**New!**

Brightness: 500 Lm  
 Intensity: 4000 Cd

- Focusable Beam
- Rear facing (red) hazard light with flashing or constant modes
- SOS and Strobe modes

Primary Beam:  
 LOW (20Lm)  
 MED (110Lm)  
 HIGH (500Lm)

Ingress Rating: IPX4  
 Battery Indicator: 10% 100%  
 Charge Port: USB TYPE C

**\$99**  
 PN: H301

Weight: 99g

**More on page 22!**



**geiger**  
**Drill, Tap & Deburring Bit Twin Packs**

Drill

- M4 x 0.7 mm PN: GDTDM4 **\$24**
- M5 x 0.8 mm PN: GDTDM5 **\$24**

Tap

- M6 x 1.0 mm PN: GDTDM6 **\$24**
- M8 x 1.25 mm PN: GDTDM8 **\$29**

Deburr

- M10 x 1.5 mm PN: GDTDM10 **\$32**
- M12 x 1.75 mm PN: GDTDM12 **\$39**

Drive: 1/4" Hex  
 Max. Workpiece Thickness: 5 mm

**TWIN PACKS!**

**CAN BE USED WITH IMPACT DRIVERS**



**geiger**  
**1/4" Medium Die Grinder**  
**FREE!**  
 Radiused Cylinder Burr Valued over \$40

Free Speed: 22,000 RPM  
 Weight: 0.675 Kg

**\$129**  
 PN: GP2202RK

**More on page 36!**



**RED HOT RUNOUT SPECIALS**

**Quick Release Ratchet Set**  
 3-Piece Set

Was \$89  
**\$59**  
 PN: MP006009

Made in Taiwan.

- 90 tooth ratcheting mechanism
- Supplied in foam tray.

Set includes:  
 1/4", 3/8", and 1/2" drive ratchets.  
 Ratcheting mechanism:  
 90 teeth (4° swing)

**Four Page Special on page 24!**



**HARLINGEN**  
**Bulk-Buy HSS-Cobalt Jobber Drill Packs**  
**NEW Bulk-Buy Packs!**

See page 17!

**TiN Coated HSS-Cobalt Spiral Flute Step Drill Set**

- Cobalt 5% (M35)
- Faceted shanks

Set of 3 includes:  
 4-12, 4-20, 4-30 mm  
 Steps: 2 mm

**\$169**  
 PN: H-11-001B-S03

**More on page 15!**





## 150 mm Fractional Digital Plastic Caliper



- Fractional, Metric & Imperial display
- Resolution: 0.01 mm / 005"  
Accuracy: ±0.1 mm

PN: AC-117-006-12F  
**\$49**

## Fractional Digital IP54 Calipers

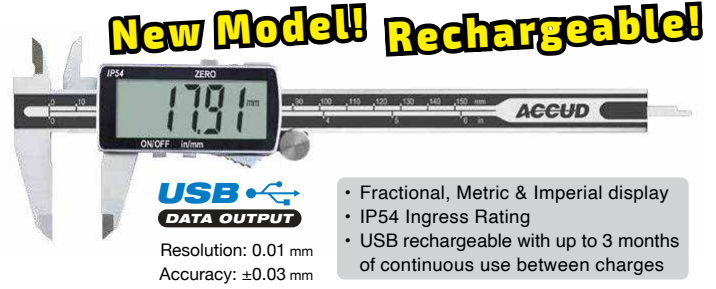

- Fractional, Metric & Imperial display
- IP54 Ingress Rating
- USB rechargeable with up to 3 months of continuous use between charges

Resolution: 0.01 mm  
Accuracy: ±0.03 mm

**150 mm Caliper** PN: AC-106-006-11F **\$149**  
**200 mm Caliper** PN: AC-106-008-11F **\$199**  
**300 mm Caliper** PN: AC-106-012-11F **\$279**

## Dual Scale Vernier Calipers

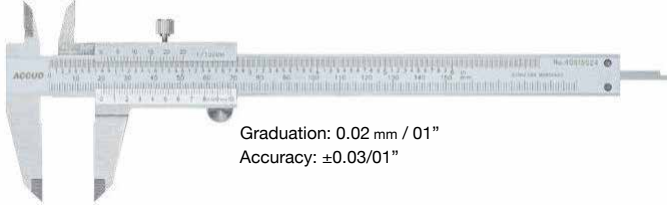

Graduation: 0.02 mm / 01"  
Accuracy: ±0.03/01"

- 150 mm Dual Scale Vernier Caliper** PN: AC-120-006-12 **\$89**
- 200 mm Dual Scale Vernier Caliper** PN: AC-120-008-12 **\$119**
- 300 mm Dual Scale Vernier Caliper** PN: AC-120-012-12 **\$229**

## Dual Scale Digital Calipers

**New Model!**

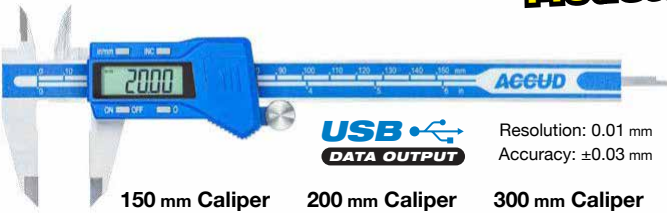

- 150 mm Caliper** PN: AC-111-006-10 **\$139**
- 200 mm Caliper** PN: AC-111-008-10 **\$159**
- 300 mm Caliper** PN: AC-111-012-10 **\$269**

## Splash Proof IP54 Dual Scale Digital Calipers

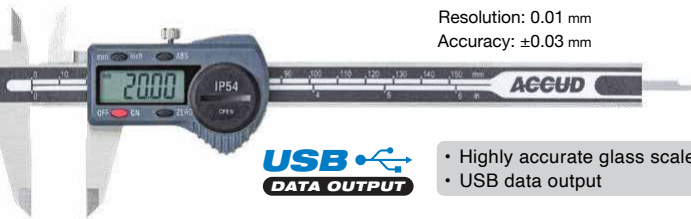

Resolution: 0.01 mm  
Accuracy: ±0.03 mm

- 150 mm Dual Scale Splash Proof IP54 Digital Caliper** PN: AC-111-006-11 **\$149**
- 200 mm Dual Scale Splash Proof IP54 Digital Caliper** PN: AC-111-008-11 **\$199**
- 300 mm Dual Scale Splash Proof IP54 Digital Caliper** PN: AC-111-012-11 **\$289**

## Fractional Metric & Imperial Digital Calipers

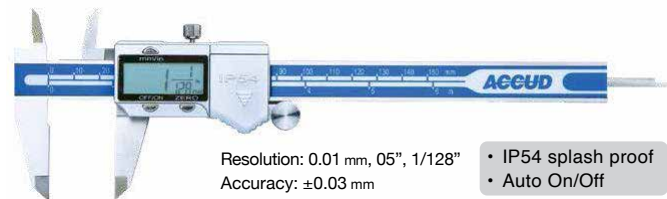

Resolution: 0.01 mm, 05", 1/128"  
Accuracy: ±0.03 mm

- 150 mm Fractional Imperial Digital Caliper** PN: AC-113-006-11 **\$159**
- 200 mm Fractional Imperial Digital Caliper** PN: AC-113-008-11 **\$219**
- 300 mm Fractional Imperial Digital Caliper** PN: AC-113-012-11 **\$299**

## Metric Dial Calipers



- 150 mm Metric Dial Caliper** Graduation: 0.01 mm Accuracy: ±0.03 mm PN: AC-101-006-11 **\$179**
- 200 mm Metric Dial Caliper** Graduation: 0.01 mm Accuracy: ±0.03 mm PN: AC-101-008-11 **\$209**
- 300 mm Metric Dial Caliper** Graduation: 0.01 mm Accuracy: ±0.04 mm PN: AC-101-012-11 **\$319**

## Coolant Proof IP67 Dual Scale Digital Calipers



**HOT PRICES!**  
**ONLY WHILE STOCKS LAST!**

- 150 mm Dual Scale Coolant Proof Digital Caliper** Resolution: 0.01 mm / 005" Accuracy: ±0.03 mm / 01" PN: AC-112-006-12 **\$259**
- 200 mm Dual Scale Coolant Proof Digital Caliper** Resolution: 0.01 mm / 005" Accuracy: ±0.03 mm / 01" PN: AC-112-008-12 **\$279**
- 300 mm Dual Scale Coolant Proof Digital Caliper** Resolution: 0.01 mm / 005" Accuracy: ±0.03 mm / 01" PN: AC-112-012-12 **\$429**

## Dual Scale Long Series Digital Calipers

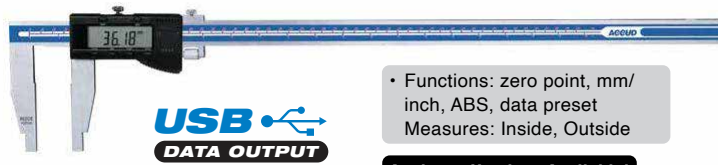

- Functions: zero point, mm / inch, ABS, data preset
- Measures: Inside, Outside

Analogue Versions Available!

- 600 mm Dual Scale Digital Caliper** Resolution: 0.01 mm / 05" Accuracy: ±0.05 mm / 02" Range: Outside 0-620 mm / 0-24.5" Inside 20-600 mm / 0-24" Jaw Reach: 100 mm PN: AC-118-024-11 **\$799**
- 1000 mm Dual Scale Digital Caliper** Resolution: 0.01 mm / 05" Accuracy: ±0.08 mm / 03" Range: Outside 0-1020 mm / 0-40.2" Inside 20-1000 mm / 0-40" Jaw Reach: 150 mm PN: AC-118-040-11 **\$1529**

## Dial Indicators

### 10 mm Jeweled Bearing Dial Indicator

Graduations: 0.01 mm  
Accuracy: 20 µm

- Jeweled Bearing
- Limit hands
- Lug back



PN: AC-222-010-11  
**\$99**

### 25mm Dial Indicator

Graduations: 0.01 mm  
Accuracy: 20 µm

PN: AC-229-025-11  
**\$129**

### 1" Dial Indicator

Graduation: 0.001"  
Accuracy: 0.004"

PN: AC-225-025-11  
**\$89**

### 25 MM Dual Scale Digital Indicator

Resolution: 0.01 mm / 005"  
Accuracy: 20 µm

- Functions: zero point, Invert measuring, inch/mm direction, data preset, ABS
- USB data output
  - Supplied with flat & lug back



PN: AC-212-025-13  
**\$229**

## Caliper Attachments

### Caliper Point Extension Kit

Measure slotted, stepped or grooved surfaces in hard to access spaces with four different point configurations. Max Jaw Thickness: 4 mm Probe length: 20 mm



PN: GCAK  
**\$49**

Caliper not included.

### 75 mm Caliper Base Attachment

Beam Width: 16 mm

PN: AC-179-000-00  
**\$49**

### 100 mm Caliper Base Attachment

Beam Width: 16 mm

PN: AC-179-000-01  
**\$89**



## Indicator Accessories

### Metric Indicator Point Extensions

Thread: M2.5x0.45 mm

25 mm - PN: AC-270-000-04

**\$19**

50 mm - PN: AC-270-000-09

**\$19**

75 mm - PN: AC-270-000-14

**\$19**

100 mm - PN: AC-270-000-17

**\$26**

IMPERIAL SIZES AVAILABLE

## Dial Indicators

### 30 mm Dial Indicator

Graduations: 0.01 mm  
Accuracy: ±35 µm

PN: AC-229-030-11  
**\$159**

- 1 mm range per revolution
- Lug and flat back

### 50 mm Dial Indicator

Graduations: 0.01 mm  
Accuracy: ±35 µm

PN: AC-229-050-21  
**\$339**

### 2" Imperial Dial Indicator

Graduations: 0.001"  
Accuracy: 0.008"

PN: AC-225-050-11  
**\$149**



## Dial Test Indicators

- Anti-magnetic metal body
- Jeweled bearing
- Carbide stylus
- Includes 4 & 8 mm clamps

### 0.14 mm Dial Test Indicator

Graduation: 0.001 mm  
Accuracy: ±4 µm

PN: AC-261-014-01  
**\$399**

### 0.80 mm Dial Test Indicator

Graduation: 0.01 mm  
Accuracy: ±13 µm

PN: AC-261-008-11  
**\$139**



## Dial Bore Gauges



### 18-35 mm Dial Bore Gauge

Graduations: 0.01 mm  
Accuracy: ±0.015 mm

PN: AC-251-035-11  
**\$269**

### 35-60 mm Dial Bore Gauge

Graduations: 0.01 mm  
Accuracy: ±0.018 mm

PN: AC-251-060-11  
**\$269**

### 50-160 mm Dial Bore Gauge

Graduations: 0.01 mm  
Accuracy: ±0.018 mm

PN: AC-251-160-11  
**\$269**

### 2-6" Dial Bore Gauge

Graduations: 0.0005"  
Accuracy: 0.0009"

PN: AC-252-060-11  
**\$299**

### 18-160 mm Dial Bore Gauge Set

Range: 18-160mm  
Indicating range: 10 mm  
Graduations: 0.01 mm  
Accuracy:  
18-35mm / ±0.015 mm  
35-60mm / ±0.018 mm  
50-160mm / ±0.018 mm

PN: AC-251-346-13  
**\$789**



## Cylinder Liner Height Gauge

Range: -5 to +5 mm  
Graduations: 0.01  
Accuracy: ±20 µm

- Jeweled Bearing
- Limit hands
- Sturdy metal base



PN: AC-438-010-11  
**\$279**

## Dial Indicator & Magnetic Stand Kits

### 10 mm Dial Indicator with Fine Adjustment Magnetic Stand

Stem hole: Ø4 mm, Ø8 mm, 3/8"  
Magnetic Force: 60 kgf  
Graduation: 0.01 mm  
Accuracy: ±20 µm

PN: AC-280-000-02  
**\$189**



### 1" Dial Indicator with Fine Adjustment Magnetic Stand

Stem hole: Ø4 mm, Ø8 mm, 3/8"  
Magnetic Force: 60 kgf  
Graduation: 0.001"  
Accuracy: ±20 µm

PN: AC-280-001-02  
**\$189**

## Universal Magnetic Stands

### Fine Adjustment Magnetic Stand

Stem holes: 8 mm  
Magnetic Force: 60 kgf

PN: AC-281-060-01  
**\$89**

### Magnetic Stand

Stem holes: 8 mm  
Magnetic Force: 60 kgf

PN: AC-281-060-02  
**\$79**

### Mini Universal Magnetic Stand

Magnetic Force: 40 kgf  
Stem holes: 8 mm  
Height: 231 mm  
Arm length: 192 mm



PN: AC-286-040-01  
**\$209**

### Universal Magnetic Stand

Stem hole: 8 mm  
Height: 395 mm  
Arm Lengths: 340 mm  
Magnetic Force: 80 kgf



PN: AC-282-080-02  
**\$239**

### Indicator Centering Mount

Mounts Indicator to chuck to indicate alignment between chuck and cylinders or holes.

PN: AC-269-060-01  
**\$49**

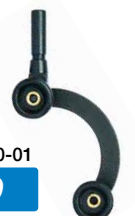



## Dual Scale Stainless Rulers



**HOT PRICE!**  
On 600 & 1000 mm Rulers!

### 150 mm Dual Scale Stainless Ruler

Graduation: PN: AC-990-006-11  
0.5 mm, 1 mm, 1/64",  
1/32", 1/16" **\$13**

### 300 mm Dual Scale Stainless Ruler

Graduation: PN: AC-990-012-11  
0.5 mm, 1 mm, 1/64",  
1/32", 1/16" **\$19**

### 600 mm Dual Scale Stainless Ruler

Graduation: PN: AC-990-024-11  
0.5 mm, 1 mm, 1/64",  
1/32", 1/16" **\$36**

### 1000 mm Dual Scale Stainless Ruler

Graduation: PN: AC-990-040-11  
0.5 mm, 1 mm, 1/64",  
1/32", 1/16" **\$56**

## Straight Edge Rulers



### 500 mm Straight Edge Ruler

Graduations: 1 mm PN: AC-991-020-01  
Beam Width: 40 mm  
Length: 500 mm **\$239**

### 300 mm Straight Edge Ruler

Graduations: 1 mm PN: AC-991-012-01  
Beam Width: 40 mm  
Length: 300 mm **\$149**

### 1000 mm Straight Edge Ruler

Graduations: 1 mm PN: AC-991-040-01  
Beam Width: 50 mm  
Length: 1000 mm **\$499**

## Double Ended Scriber

- Nickel plated with Hardened tips
- Knurled handle



PN: AC-995-009-01  
**\$19**

## Radius Gauge Sets



- Includes concave & convex gauge for each size

### 1-7 mm Radius Gauge Set

Range: 1, 1.25, 1.5, 1.75, 2, 2.25, 2.5, 2.75, 3, 3.5, 4, 4.5, 5, 5.5, 6, 6.5, 7 mm

PN: AC-941-007-34  
**\$39**

### 7.5-15 mm Radius Gauge Set

Range: 7.5, 8, 8.5, 9, 9.5, 10, 10.5, 11, 11.5, 12, 12.5, 13, 13.5, 14, 14.5, 15 mm

PN: AC-941-015-32  
**\$39**

### 15.5-25 mm Radius Gauge Set

Range: 15.5, 16, 16.5, 17, 17.5, 18, 18.5, 19, 19.5, 20, 21, 22, 23, 24, 25 mm

PN: AC-941-025-30  
**\$39**

## Wide Base Machinist Squares (Grade 2)

### 100 mm Wide Base Machinist Square

Squareness: (α) 28 μm (β) 30 μm  
Base size: 19H x 12W x 70L mm  
Blade Thickness: 3 mm

PN: AC-845-004-02  
**\$39**

### 200 mm Wide Base Machinist Square

Squareness: (α) 37 μm (β) 40 μm  
Base size: 32H x 16W x 130L mm  
Blade Thickness: 4 mm

PN: AC-845-008-02  
**\$69**

### 600 mm Wide Base Machinist Square

Squareness: (α) 75 μm (β) 80 μm  
Base size: 50H x 30W x 350L mm  
Blade Thickness: 6 mm

PN: AC-845-024-02  
**\$389**

### 150 mm Wide Base Machinist Square

Squareness: (α) 33 μm (β) 35 μm  
Base size: 25H x 16W x 100L mm  
Blade Thickness: 3 mm

PN: AC-845-006-02  
**\$59**

### 300 mm Wide Base Machinist Square

Squareness: (α) 47 μm (β) 50 μm  
Base size: 32H x 19W x 200L mm  
Blade Thickness: 4 mm

PN: AC-845-012-02  
**\$99**



## Thread Gauge Sets



### Metric & Whitworth Thread Gauge

Metric 60° Range: 0.25-6.0 mm  
Whitworth 55° Range: 4-62 TPI

PN: AC-925-062-52  
**\$39**

### Metric Thread Gauge

Metric 60° Range: 0.25 - 6.0 mm

PN: AC-922-006-24  
**\$29**

### Whitworth Thread Gauge

Whitworth 55° Range: 4-42 TPI

PN: AC-924-042-30  
**\$29**

## Circumference Tape



### 60-950 mm Circumference Tape

Range: Dia. 20-300 mm / Cir. 60-950 mm  
Graduation: 0.1 mm

PN: AC-956-012-11  
**\$45**

### 940-2200 mm Circumference Tape

Range: Dia. 300-700 mm / Cir. 940-2200 mm  
Graduation: 0.1 mm

PN: AC-956-028-11  
**\$59**

### 2190-3460 mm Circumference Tape

Range: Dia. 700-1100 mm / Cir. 2190-3460 mm  
Graduation: 0.1 mm

PN: AC-956-044-11  
**\$79**

## Dividers & Calipers

Other sizes & styles available.



### 200 mm Inside Spring Caliper

Range: 18-190 mm PN: AC-982-008-01  
Length: 200 mm **\$39**

### 300 mm Inside Spring Caliper

Range: 18-290 mm PN: AC-982-012-01  
Length: 300 mm **\$49**

### 500 mm Inside Spring Caliper

Range: 25-490 mm PN: AC-982-020-01  
Length: 500 mm **\$79**



### 200 mm Spring Divider

Range: 0-190 mm PN: AC-985-008-01  
Length: 200 mm **\$39**

### 300 mm Spring Divider

Range: 0-290 mm PN: AC-985-012-01  
Length: 300 mm **\$49**

### 500 mm Spring Divider

Range: 0-490 mm PN: AC-985-020-01  
Length: 500 mm **\$79**



### 200 mm Outside Spring Caliper

Range: 0-190 mm PN: AC-984-008-01  
Length: 200 mm **\$39**

### 300 mm Outside Spring Caliper

Range: 0-290 mm PN: AC-984-012-01  
Length: 300 mm **\$49**

### 500 mm Outside Spring Caliper

Range: 0-490 mm PN: AC-984-020-01  
Length: 500 mm **\$79**

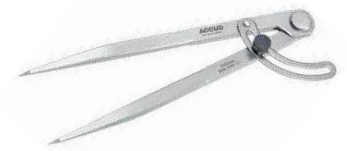

### 200 mm Dividing Caliper

Range: 0-190 mm PN: AC-986-008-01  
Length: 200 mm **\$39**

### 300 mm Dividing Caliper

Range: 0-290 mm PN: AC-986-012-01  
Length: 300 mm **\$49**

### 500 mm Dividing Caliper

Range: 0-490 mm PN: AC-986-020-01  
Length: 500 mm **\$69**

## Metric Outside Micrometers



SIZES AVAILABLE UP TO 1000 mm

- Carbide measuring faces
- Setting standard included
- Ratchet stop

### 25 mm Outside Micrometer

Graduation: 0.01 mm PN: AC-321-001-01  
Accuracy: 4 µm  
Jaw Reach: 29 mm **\$79**

### 50-75 mm Outside Micrometer

Graduation: 0.01 mm PN: AC-321-003-01  
Accuracy: 5 µm  
Jaw Reach: 53 mm **\$95**

### 100-125 mm Outside Micrometer

Graduation: 0.01 mm PN: AC-321-005-01  
Accuracy: 6 µm  
Jaw Reach: 65 mm **\$129**

### 25-50 mm Outside Micrometer

Graduation: 0.01 mm PN: AC-321-002-01  
Accuracy: 4 µm  
Jaw Reach: 39 mm **\$89**

### 75-100 mm Outside Micrometer

Graduation: 0.01 mm PN: AC-321-004-01  
Accuracy: 5 µm  
Jaw Reach: 65 mm **\$99**

## Imperial Outside Micrometers



SIZES AVAILABLE UP TO 40"

- Carbide measuring faces
- Setting standard included
- Ratchet stop

### 1" Outside Micrometer

Graduation: 0.0001" PN: AC-324-001-01  
Accuracy: ±0.00015"  
Jaw Reach: 29 mm **\$79**

### 2-3" Outside Micrometer

Graduation: 0.0001" PN: AC-324-003-01  
Accuracy: ±0.0002"  
Jaw Reach: 53 mm **\$110**

### 1-2" Outside Micrometer

Graduation: 0.0001" PN: AC-324-002-01  
Accuracy: ±0.00015"  
Jaw Reach: 39 mm **\$89**

### 3-4" Outside Micrometer

Graduation: 0.0001" PN: AC-324-004-01  
Accuracy: ±0.0002"  
Jaw Reach: 53 mm **\$119**

### 4-5" Outside Micrometer

Graduation: 0.0001" PN: AC-324-005-01  
Accuracy: ±0.00025"  
Jaw Reach: 65 mm **\$149**

## Micrometer Sets

- Supplied with Calibration certificate



IMPERIAL SETS AVAILABLE

### 150-300 mm Micrometer 6 Piece Set

Set of 6 Micrometers  
Range: 150-300 mm PN: AC-321-012-06  
Graduation: 0.01 mm  
Accuracy: ± 4-6 µm **\$1239**

### 75 mm Micrometer 3 Piece Set

Set of 3 Micrometers  
Range: 0-75 mm PN: AC-321-003-03  
Graduation: 0.01 mm  
Accuracy: 5 µm **\$229**

### 100 mm Micrometer 4 Piece Set

Set of 4 Micrometers  
Range: 0-100 mm PN: AC-321-004-04  
Graduation: 0.01 mm  
Accuracy: ± 4-5 µm **\$369**

### 150 mm Micrometer 6 Piece Set

Set of 6 Micrometers  
Range: 0-150 mm PN: AC-321-006-06  
Graduation: 0.01 mm  
Accuracy: ± 4-6 µm **\$599**

### 300 mm Micrometer 12 Piece Set

Set of 12 Micrometers  
Range: 0-300 mm PN: AC-321-012-12  
Graduation: 0.01 mm  
Accuracy: ± 4-6 µm **\$1719**

## Coolant Proof Digital Micrometers



- Functions: mm/inch, Origin, zero point, ABS, Hold
- IP65 protection level
  - Carbide measuring faces
  - Ratchet stop.

### 25 mm Coolant Proof IP65 Dual Scale Digital Micrometer

Graduation: 01 mm PN: AC-313-001-01  
Accuracy: 3 µm  
Jaw Reach: 25 mm **\$259**

### 25-50 mm Coolant Proof IP65 Dual Scale Digital Micrometer

Graduation: 01 mm PN: AC-313-002-01  
Accuracy: 3 µm  
Jaw Reach: 32 mm **\$279**

## 3 Piece Measuring Tool Set

### 150 mm Digital Caliper

Resolution: 0.01 mm  
Accuracy: ±0.03 mm

### 25 mm Outside Micrometer

Graduation: 0.01 mm  
Accuracy: 4µm

### Beveled Square

Size: 100 x 70mm  
DIN875 grade 0  
Squareness: 7µm



PN: AC-280-000-13

**\$299**

## Micrometer Stand



Micrometer not included.

PN: AC-381-000-00

**\$59**

## Tubular Inside Micrometer Sets



- Carbide measuring faces

### 50-300 mm Metric Tubular Inside Micrometer Set

Head Range: 13 mm PN: AC-352-012-01  
Graduation: 0.01 mm **\$399**

### 50-600 mm Metric Tubular Inside Micrometer Set

Head Range: 13 mm PN: AC-352-024-01  
Graduation: 0.01 mm **\$499**

## Telescopic Gauge Set

Handle lengths: 115-137 mm  
Gauge sizes: 8-12.7 mm, 12.7-19 mm, 19-32 mm, 32-54 mm, 54-90 mm & 90-150 mm



PN: AC-951-006-01

**\$89**

## 1/4" Centering Indicator

- For quick and accurate centering in boring and milling set-up
- Jeweled bearing
- Includes with 7 probes



PN: AC-297-003-11

**\$299**

## Dual Scale Digital Height Gauges

Resolution: 0.01 mm  
Accuracy: ±0.05 mm

### 300 mm Height Gauge

PN: AC-181-012-11

**\$579**

### 600 mm Height Gauge

PN: AC-181-024-11

**\$1100**



## Depth Caliper & Micrometers

### 25 mm Digital Depth Caliper

- USB data output

Resolution: 0.01 mm  
Accuracy: ±0.03 mm

PN: AC-176-001-11

**\$159**



### 0-150 mm Micrometer with Captive Anvils

Accuracy: ±3 µm  
Base size: 101.5 x 17 mm

PN: AC-392-006-01

**\$389**



### 200 mm Digital Depth Caliper

PN: AC-171-008-11

**\$199**

### 300 mm Digital Depth Caliper

PN: AC-171-012-11

**\$399**

### 500 mm Digital Depth Caliper

PN: AC-171-020-11

**\$779**

Resolution: 0.01 mm  
Accuracy: ±0.03 mm





## Contact Tachometer

Rotary Range: 0.5-19,999 rpm  
Linear Range: 0.05-1999.9 m/min  
Power Supply: 2 x AAA  
Weight: 106g

- Includes various coupling attachments



PN: AC-CT900

**\$139**

## Laser Tachometer

Range: 2.5 - 99,999 RPM  
Sampling Range: 50 - 500 mm  
Power Supply: 2 x AAA  
Weight: 106 g

Supplied with 45 cm of 3M™ Reflective Tape.

PN: AC-LT900

**\$129**



## Digital Sound Level Meter

- Fast & Slow display functions, Continuous & Min/Max functions
- Back-lit LCD
- Programmable Exceedence Alarm

Range: 30-130 db  
Accuracy: 1.5 db  
Resolution: 0.1 db  
Weight: 64g



PN: AC-SLM130

**\$129**

## Digital Anemometer

- Temperature & Wind Speed display
- Real-time/Max/Ave functions
- Back-lit LCD
- Unit: m/s, km/h, ft/min, Knots, mph

Range: 0.3-30m/s  
Accuracy: ±5%  
Resolution: 0.1m/s  
Weight: 154g



PN: AC-AM30

**\$129**

## Portable Hardness Tester

Resolution: 1 HLD, 1 HV, 1 HB, 0.1 HRC, 0.1 HRB, 1 HS, 1 MPa

Units: HV, HB, HRC, HRB, HS & tensile strength MPa  
Accuracy: ±8 HLD / 0.8 HRC (HLD=800)  
Min. sample weight: 5 kg (directly) / 2 kg (supported) / 0.1kg (coupled to plate)  
Min. sample thickness: 5 mm  
Min. sample diameter: 22 mm  
Max. sample roughness: 1.61-Jm(Ra)  
Power: 3 x AAA battery  
Dimensions: 121 x 68 x 30 mm



PN: AC-HL350

**\$899**

## Concrete Moisture Meter

Range: 0-40%  
Resolution: 0.5 %  
Accuracy: ±2%



PN: AC-WMM900

**\$489**

## Wood Moisture Meter

Temp. Range: -10-60 °C  
Humidity Range: 0.1 °C RH  
Moisture Range: 2-40/50/60/70%



PN: AC-WMM700

**\$99**

## FN Coating Thickness Gauge

- Measures thickness of non-magnetic coatings on both magnetic and electrically conductive substrates
- V-type probe for cylindrical work pieces

Range: 0 ~ 1500µm  
Resolution: 0.1µm (0-99.9µm) / 1µm (100-1500µm)  
Accuracy: 2µm (0-100µm) / 3% (100-1500µm)  
Min. measuring area: 25 x 25 mm  
Memory: 30 sets

PN: AC-CFN1500B

**\$799**



## Laser Distance & Level Meters

- Functions: Distance, Area, Volume, Indirect distance,
- Maximum & Minimum Memory
  - Laser Sight
  - Built-in Spirit Level
  - IP54 Protection Level
  - Back-light LCD Display
  - Battery Power Indicator
  - 1/4"-20 UNC Tripod Mount

Accuracy: 1.5 mm  
Units: Metre/Inch/Foot  
Light spot: Ø8 mm @ 40 m  
Memory: 20 data points  
Weight: 110 g

**HOT PRICE!**



40m Laser Distance

Power: 3 x AAA

PN: AC-TM40

**\$129**

**NEW MODEL!**



100m Rechargeable Laser Distance

Power: USB-C Rechargeable

PN: AC-TM100R

**\$186**

## Dual Scale Digital Temperature & Humidity Monitor



- Measuring Unit °C/°F
- Time, Date & Month display
- Records Max. & min. temperature & humidity
- 12 or 24 hr display modes
- Water proof IP67 Probe

Temperature Range: Indoor: -5 to 70°C  
Humidity Range: 10% RH - 99% RH  
Power supply: 1 x AAA (1.5V)  
Probe length: 95 cm  
Size 120H x 98W x 21T mm

PN: AC-HTC-70

**\$59**

## Infrared Thermometers & Imaging

- Functions: Min/Max. & Average Differential indication, High & Low Temp. Alarm & 100 Sample Point Memory
- Adjustable Emission Compensation
  - Back-light LCD Display
  - 1/4"-20 UNC Tripod Mount
  - Battery Power Indicator
  - Mutable sample capture alarm
  - Laser Sight

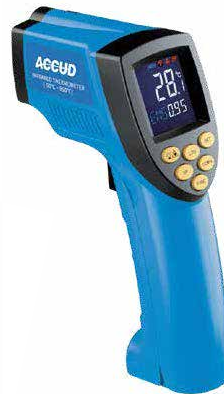

950° Infrared Thermometer

Range: -50 to 950 °C  
Accuracy: 1.5% or 1.5 °  
Distance spot ratio: 12:1

PN: AC-IT700

**\$189**

1650°C Infrared Thermometer

Range: -50 to 1650 °C  
Accuracy: 1.5% or 1.5 °  
Distance spot ratio: 12:1

PN: AC-IT1650S

**\$549**

## Refractometers

### Automotive Refractometer

- Measures concentration levels of Glycol, Propylene Glycol, Battery Fluid, Windscreen Fluid, Blinker Fluid & Adblue

Range: 0-10%  
Graduations: 0.2%  
Weight: 0.8 Kg

PN: AC-RM50S

**\$149**

### Engineering Refractometer

- Measures metal working coolant concentration levels

Range: 0-10%  
Graduations: 0.2%  
Weight: 0.8 Kg

PN: AC-RM10

**\$159**

## Combination Squares

### Combination Square

90° or 45° square  
90° square accuracy: ±8',  
45° square accuracy: ±10'

**Wear Resistant  
Cast Iron Head**



PN: AC-817-090-12  
**\$139**

### Combination Square Set

**Circle Centre Finder** 90° or 45° square  
Accuracy: ±0.15 mm 90° square accuracy: ±8',  
Ruler range: 300 mm / 12" 45° square accuracy: ±10'

**Protractor**  
Range: 0-180° PN: AC-817-180-02  
Accuracy: ±7' **\$269**



## Angle Finders



**150 mm / 180° Angle Finder**  
Length: 150 mm  
Graduation: 1°  
Accuracy: ±0.3° PN: AC-812-005-01  
**\$69**

**200 mm / 180° Angle Finder**  
Length: 200 mm  
Graduation: 1°  
Accuracy: ±0.3° PN: AC-812-006-01  
**\$99**

**300 mm / 180° Angle Finder**  
Length: 300 mm  
Graduation: 1°  
Accuracy: ±0.3° PN: AC-812-008-01  
**\$129**

## Combination Rulers



**200 mm Digital Combination Ruler**  
Length: 200 mm  
Range: 360°  
Resolution: 0.1° PN: AC-821-008-01  
**\$110**

**300 mm Digital Combination Ruler**  
Length: 300 mm  
Range: 360°  
Resolution: 0.1° PN: AC-821-012-01  
**\$129**

**500 mm Digital Combination Ruler**  
Length: 500 mm  
Range: 360°  
Resolution: 0.1° PN: AC-821-020-01  
**\$139**

## Feeler Gauges

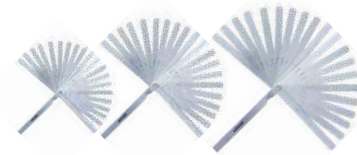

**150 mm Feeler Gauge 20 Leave Set**  
Range: 0.05-1 mm  
Length: 150 mm PN: AC-913-100-20  
**\$39**

**Dual Scale Angled Feeler Gauge**  
Metric Range: 0.005 - 0.030 mm  
Imperial Range: 0.127" - 0.762"  
Blade Length: 100 mm

**Tapered Feeler Gauge**  
Metric Range: 0.03-1.00mm  
Blade Length: 100 mm

- Meets DIN2275
- Accuracy: ±(3+T/80) μm,



**300 mm Feeler Gauge 20 Leave Set**  
Range: 0.05-1 mm  
Length: 300 mm PN: AC-915-100-20  
**\$49**



**200 mm Feeler Gauge 20 Leave Set**  
Range: 0.05-1 mm  
Length: 200 mm PN: AC-914-100-20  
**\$49**

PN: AC-912-100-32  
**\$29**

## Welding Gauges

### Fillet Weld Gauge

Sizes: 3, 4, 5, 6, 8,  
9, 10, 11, 12,  
14, 16, 19,  
22 & 25 mm  
Accuracy:  
0.5 mm

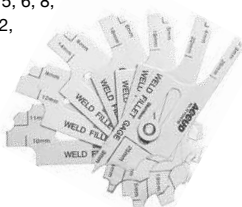

PN: AC-977-025-01  
**\$69**

### Welding Gauge

Range: 0-6 mm  
Porosity Comparison  
Range: 1.5 & 3 mm  
Graduation: 0.5 mm  
Accuracy: 0.5 mm



PN: AC-978-006-01  
**\$69**

## Metric Torque Wrenches

**Highly  
Accurate!**  
±3 Percent



- Supplied with calibration certificate
- Accuracy: ±3%
- Meets ISO6789 & ASMEB107.14

**5-25 Nm Torque Wrench**  
Anvil Size: 3/8"  
Length: 275 mm PN: AC-TWM25Q  
**\$229**

**10-50 Nm Torque Wrench**  
Anvil Size: 3/8"  
Length: 275 mm PN: AC-TWM50Q  
**\$269**

**40-200 Nm Torque Wrench**  
Anvil Size: 1/2"  
Length: 505 mm PN: AC-TWM200Q  
**\$299**

**70-340 Nm Torque Wrench**  
Anvil Size: 1/2"  
Length: 695 mm PN: AC-TWM340Q  
**\$385**

### 5-25 Nm Torque Wrench Set

Set includes 5-25 Nm Torque Wrench (AC-TWM25Q), 100 mm 3/8" extension bar and the following sockets: 2, 2.5, 3, 4, 5, 6, 8 mm hex, T10, T15, T20, T25, T27 & T30 Torx®

PN: AC-STWM25Q  
**\$369**



## Protractor & Levels

### Bluetooth Digital Block Level

- Back-light LCD colour display
- Automatic display orientation
- Built-in Bluetooth
- Data hold function
- Automatic power off
- Colour level bars indicate tilt trends in X & Y axis
- Includes telemetry software for Apple & Android systems

Units: Degrees, Slope (mm/m)  
Accuracy: ± (1 + Measured Value x 2%) x Resolution  
Repeatability: 0.01 mm/m  
Bluetooth Range: up to 10m  
Size: 200L x 58H x 46W mm



PN: AC-718-008-01  
**\$999**

### Digital Level

- Magnetic base
- Range: 0-360°  
Resolution: 0.1°  
Dimensions:  
59 x 28 mm  
Accuracy: ±0.1°  
±0.2°(other directions)



PN: AC-721-180-01  
**\$129**

### Digital Level & Protractor

- Magnetic V-groove Base

Resolution: 0.05°  
Accuracy: ±0.1°(at 0°/90°/180°/270°)  
±0.2°(other direction)



PN: AC-722-360-01  
**\$229**

### 600 mm Digital level

- Functions as level or protractor
- Absolute horizon memory
- Back-light Display
- Magnetic base

Units: Degrees, Slope %, mm/m & In/Ft Pitch.  
Resolution: 0.1°



PN: AC-725-360-01  
**\$209**

## Feeler Tapes

Size: 13 mm x 5 m  
Accuracy: ±4 μm



Larger Sizes Available.

**0.02 mm Feeler Tape**  
PN: AC-916-002-01  
**\$49**

**0.04 mm Feeler Tape**  
PN: AC-916-004-01  
**\$49**



## 1/4" Shank Double-Cut Carbide Burrs

Standard & Non-ferrous 1/4" Shank Carbide Burrs are available in three head diameters.

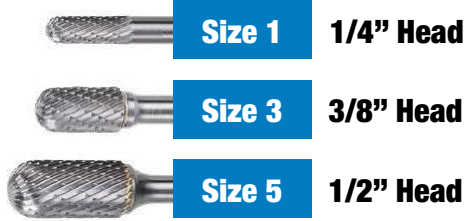

**Stainless Carbide Burrs also available.**

### Oval Burrs

Size	Length	PN	Price
1	2"	CBSE1	<b>\$47</b>
3	2 3/8"	CBSE3	<b>\$69</b>
5	2 5/8"	CBSE5	<b>\$94</b>

### Radiused Tree Burrs

Size	Length	PN	Price
1	2"	CBSF1	<b>\$47</b>
3	2 1/2"	CBSF3	<b>\$69</b>
5	2 3/4"	CBSF5	<b>\$94</b>

### Pointed Tree Burrs

Size	Length	PN	Price
1	2"	CBSG1	<b>\$47</b>
3	2 1/2"	CBSG3	<b>\$69</b>
5	2 3/4"	CBSG5	<b>\$94</b>

### Cylinder Burrs

Size	Length	PN	Price
1	2"	CBSA1	<b>\$47</b>
3	2 1/2"	CBSA3	<b>\$69</b>
5	2 3/4"	CBSA5	<b>\$94</b>

### End Cut Cylinder Burrs

Size	Length	PN	Price
1	2"	CBSB1	<b>\$47</b>
3	2 1/2"	CBSB3	<b>\$69</b>
5	2 3/4"	CBSB5	<b>\$94</b>

### Radiused Cylinder Burrs

Size	Length	PN	Price
1	2"	CBSC1	<b>\$47</b>
3	2 1/2"	CBSC3	<b>\$69</b>
5	2 3/4"	CBSC5	<b>\$94</b>

### Ball Burrs

Size	Length	PN	Price
1	2"	CBSD1	<b>\$47</b>
3	2 1/8"	CBSD3	<b>\$69</b>
5	2 1/4"	v	<b>\$94</b>

### Flame Burrs

Size	Length	PN	Price
1	2 3/4"	CBSH1	<b>\$47</b>
3	2 1/2"	CBSH3	<b>\$69</b>
5	3"	CBSH5	<b>\$94</b>

### Radiused Cone Burrs

Size	Length	PN	Price
1	2"	CBSL1	<b>\$47</b>
3	3"	CBSL3	<b>\$69</b>
5	3"	CBSL4	<b>\$94</b>

### Cone Burrs

Size	Length	PN	Price
1	1 7/8"	CBSM1	<b>\$47</b>
3	2 1/2"	CBSM4	<b>\$69</b>
5	2 3/4"	CBSM5	<b>\$94</b>

### Inverted Cone Burrs

Size	Length	PN	Price
1	2"	CBSN1	<b>\$47</b>
3	2 1/8"	CBSN3	<b>\$69</b>
5	2 1/4"	CBSN5	<b>\$94</b>

### 60° Countersink Burrs

Size	Length	PN	Price
1	2"	CBSJ1	<b>\$47</b>
3	2 1/4"	CBSJ3	<b>\$69</b>
5	2 3/8"	CBSJ5	<b>\$94</b>

### 90° Countersink Burrs

Size	Length	PN	Price
1	2"	CBSK1	<b>\$47</b>
3	2 1/8"	CBSK3	<b>\$69</b>
5	2 1/8"	CBSK5	<b>\$94</b>

## 1/4" Extended Carbide Burrs

### 6" Extended Size 3 Double-Cut Burrs

Shape	PN	Price
Cylinder	CBSA3L6	<b>\$115</b>
End Cut Cylinder	CBSB3L6	<b>\$115</b>
Radiused Cylinder	CBSC3L6	<b>\$115</b>
Ball	CBSD3L6	<b>\$115</b>
Oval	CBSE3L6	<b>\$115</b>
Radiused Tree	CBSF3L6	<b>\$115</b>
Pointed Tree	CBSG3L6	<b>\$115</b>
Radiused Cone	CBSL3L6	<b>\$115</b>

### 6" Extended Size 3 Non-ferrous Burrs

Shape	PN	Price
Radiused Cylinder	CBSC3L6NF	<b>\$115</b>
Ball	CBSD3L6NF	<b>\$115</b>
Oval	CBSE3L6NF	<b>\$115</b>
Radiused Tree	CBSF3L6NF	<b>\$115</b>
Flame	CBSH3L6NF	<b>\$115</b>

## Carbide Burr Sets

### 1/8" Head Carbide Burr 10 Piece Set

Shank Dia: 1/8"



**\$215**

PN: CBSET10

### 3/8" Head Carbide Burr 3 Piece Set

Shank Dia: 1/4"



**\$175**

PN: CBSET3

### 1/4" & 3/8" Head Burr 8 Piece Set

Shank Dia: 1/4"



**\$355**

PN: CBSET8

### 1/2" Head Carbide Burr 5 Piece Set

Shank Dia: 1/4"



**\$389**

PN: CBSET5

### 3/8" Head Non-ferrous Burr 3 Piece Set

Shank Dia: 1/4"



**\$210**

PN: CBSET3NF

### 3/8" Head Stainless Burr 3 Piece Set

Shank Dia: 1/4"



**\$219**

PN: CBSET3INOX

# Bolt Removal Kits

The four step extraction kit that enables safe & clean removal of broken studs or screws in confined spaces.

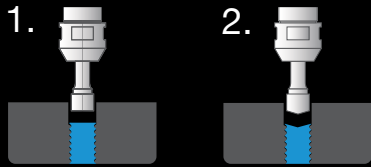

1. Flatten top of screw or stud

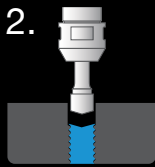

2. Form a countersink

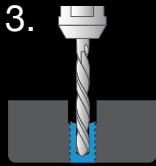

3. Drill into stud

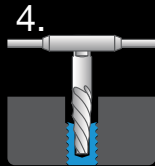

4. Extract stud



Size	PN	Price
M6	CBSETBRM6	<b>\$119</b>
M8	CBSETBRM8	<b>\$129</b>
M10	CBSETBRM10	<b>\$139</b>
M12	CBSETBRM12	<b>\$149</b>
M14	CBSETBRM14	<b>\$189</b>

# morrisflex

## NG6 NEXT GENERATION ACCELERATOR



Patent pending geometry and **ACCELERATOR** Coating has shown up to double the rate of stock removal over conventional burrs.\*

### Cylinder Burrs

Size	Length	PN	Price
3	2 1/2"	CBSA3NG6C	<b>\$95</b>
5	2 3/4"	CBSA5NG6C	<b>\$129</b>

### Radiused Tree Burrs

Size	Length	PN	Price
3	2 1/2"	CBSF3NG6C	<b>\$95</b>
5	2 3/4"	CBSF5NG6C	<b>\$129</b>

### Radiused Cylinder Burrs

Size	Length	PN	Price
3	2 1/2"	CBSC3NG6C	<b>\$95</b>
5	2 3/4"	CBSC5NG6C	<b>\$129</b>

### Ball Burrs

Size	Length	PN	Price
3	2 1/8"	CBSD3NG6C	<b>\$95</b>

\* NG6 Coated Burrs should be operated at a minimum of 25,000 RPM.

## 1/4" Shank Non-ferrous Carbide Burrs

### Cylinder Burrs

Size	Length	PN	Price
1	2"	CBSA1NF	<b>\$69</b>
3	2 1/2"	CBSA3NF	<b>\$87</b>
5	2 3/4"	CBSA5NF	<b>\$110</b>

### Radiused Cylinder Burrs

Size	Length	PN	Price
1	2"	CBSC1NF	<b>\$69</b>
3	2 1/2"	CBSC3NF	<b>\$87</b>
5	2 3/4"	CBSC5NF	<b>\$110</b>

### Ball Burrs

Size	Length	PN	Price
1	2"	CBSD1NF	<b>\$69</b>
3	2 1/8"	CBSD3NF	<b>\$87</b>
5	2 1/4"	CBSD5NF	<b>\$110</b>

### Oval Burrs

Size	Length	PN	Price
1	2"	CBSE1NF	<b>\$69</b>
3	2 3/8"	CBSE3NF	<b>\$87</b>
5	2 5/8"	CBSE5NF	<b>\$110</b>

### Radiused Cone Burrs

Size	Length	PN	Price
1	2"	CBSL1NF	<b>\$69</b>
3	3"	CBSL3NF	<b>\$87</b>
5	3"	CBSL4NF	<b>\$110</b>

### Cone Burrs

Size	Length	PN	Price
3	2 1/2"	CBSM4NF	<b>\$110</b>

### Pointed Tree Burrs

Size	Length	PN	Price
1	2"	CBSG1NF	<b>\$69</b>
3	2 1/2"	CBSG3NF	<b>\$87</b>
5	2 3/4"	CBSG5NF	<b>\$110</b>

### Radiused Tree Burrs

Size	Length	PN	Price
1	2"	CBSF1NF	<b>\$69</b>
3	2 1/4"	CBSF3NF	<b>\$87</b>
5	2 3/8"	CBSF5NF	<b>\$110</b>

## 1/8" Carbide Burrs

1/8" Shank Carbide Burrs are available in the following head diameters:

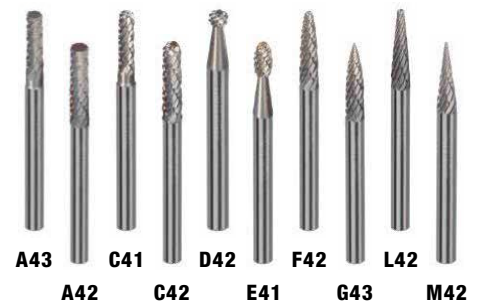

Shape	Size	PN	Price
Cylinder	0	CBSA43	<b>\$34</b>
Cylinder	00	CBSA42	<b>\$34</b>
Radiused Cylinder	0	CBSC41	<b>\$34</b>
Radiused Cylinder	00	CBSC42	<b>\$34</b>
Ball	0	CBSD42	<b>\$35</b>
Oval	0	CBSE41	<b>\$35</b>
Radiused Tree	0	CBSF42	<b>\$35</b>
Pointed Tree	0	CBSG43	<b>\$35</b>
Radiused Cone	0	CBSL42	<b>\$35</b>
Cone Burr	0	CBSM42	<b>\$36</b>

## Carbide Burr Operating Guide

These are recommended speeds for **Standard Length Burrs** with no more than a 1/2" overhang from the die-grinder collet. **NG6 Coated Burrs** should be operated at a minimum of 25K. **Extended Burrs** are generally subject to much lower maximum safe speeds.

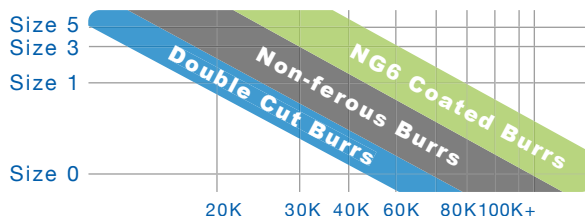



## Coated Micro-Grain Carbide Turning Inserts

• Sold in packs of 10

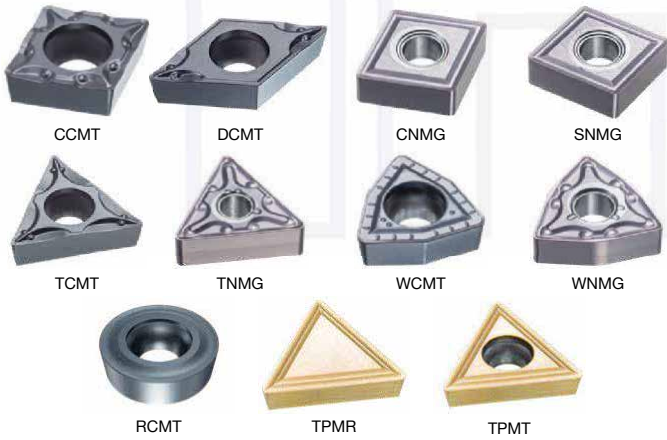

	Shape	Point Radius	Cutting Width	Thickness	
CCMT060204	80° Rhomboid	0.4 mm	6 mm	2.38 mm	\$99
CCMT09T304	80° Rhomboid	0.4 mm	9 mm	3.97 mm	\$129
CCMT120408	80° Rhomboid	0.8 mm	12 mm	4.76 mm	\$149
CNMG120404	80° Rhomboid	0.4 mm	12 mm	4.76 mm	\$139
CNMG120408	80° Rhomboid	0.8 mm	12 mm	4.76 mm	\$140
DCMT070204	55° Rhomboid	0.4 mm	7 mm	2.38 mm	\$129
DCMT11T304	55° Rhomboid	0.4 mm	11 mm	3.97 mm	\$149
DNMG150404	55° Rhomboid	0.4 mm	15 mm	4.76 mm	\$149
DNMG150408	55° Rhomboid	0.8 mm	15 mm	4.76 mm	\$149
RCMT0803MO	Circle	N/A	8 mm	3.18 mm	\$119
RCMT10T3MO	Circle	N/A	10 mm	3.97 mm	\$119
TCMT090204	Triangle	0.4 mm	9 mm	2.38 mm	\$119
TCMT110204	Triangle	0.4 mm	11 mm	2.38 mm	\$129
TCMT110208	Triangle	0.8 mm	11 mm	2.38 mm	\$129
TCMT16T304	Triangle	0.4 mm	16 mm	3.97 mm	\$119
TCMT16T308	Triangle	0.8 mm	16 mm	3.97 mm	\$119
TNMG160404	Triangle	0.4 mm	16 mm	4.76 mm	\$119
TNMG160408	Triangle	0.8 mm	16 mm	4.76 mm	\$119
SNMG120404	Square	0.4 mm	12 mm	4.76 mm	\$139
SNMG120408	Square	0.8 mm	12 mm	4.76 mm	\$139
TPMR110304	Triangle	0.4 mm	11 mm	3.18 mm	\$119
TPMR110308	Triangle	0.8 mm	11 mm	3.18 mm	\$119
TPMR160304	Triangle	0.4 mm	16 mm	3.18 mm	\$119
TPMR160308	Triangle	0.8 mm	16 mm	3.18 mm	\$119
TPMT110304	Triangle	0.4 mm	11 mm	3.18 mm	\$119
TPMT110308	Triangle	0.8 mm	11 mm	3.18 mm	\$119
WCMT050308	Trigon	0.8 mm	5 mm	3.18 mm	\$139
WCMT06T304	Trigon	0.4 mm	6 mm	3.97 mm	\$129
WNMG060404	Trigon	0.4 mm	6 mm	4.76 mm	\$112
WNMG060408	Trigon	0.8 mm	6 mm	4.76 mm	\$112
WNMG080404	Trigon	0.4 mm	8 mm	4.76 mm	\$139
WNMG080408	Trigon	0.8 mm	8 mm	4.76 mm	\$139

## Coated Micro-Grain Carbide Milling Inserts

• Sold in packs of 10



PN	Shape	Point Radius	Cutting Width	Thickness	
APKT1003	Parallelogram	0.4 mm	10 mm	3.53 mm	\$119
APKT160408	Parallelogram	0.8 mm	16 mm	4.76 mm	\$139
TPKN160308	Triangle	0.8 mm	16 mm	3.18 mm	\$129
SEMT1204	Square	N/A	12 mm	4.76 mm	\$139

## TiN Coated Carbide GTN Parting & Grooving Inserts

• Suited to general purpose steel  
• Sold in packs of 10



Cutting Width	PN	
2 mm	GTN-2	\$89
3 mm	GTN-3	\$89
4 mm	GTN-4	\$119
5 mm	GTN-5	\$139

## TiAlN Micro-Grain Carbide MGMN Parting & Grooving Inserts

• Suited to general purpose steel and stainless steel  
• Sold in packs of 10



Cutting Width	PN	
2 mm	MGMN200	\$149
3 mm	MGMN300	\$159

## TiAlN Micro-Grain Carbide Right Handed Threading Inserts

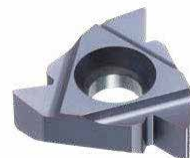

• Made of micro-grain carbide with TiAlN coating  
• Suited to cast iron, general purpose steel and stainless steel  
• Sold in packs of 10

Thread Profile	Thread Range	Insert Size	PN	
60° External	0.5 - 1.5 mm	IC 6.35 mm	11ERA60	\$159
60° External	0.5 - 3.0 mm	IC 9.525 mm	16ERAG60	\$159
55° Internal	48 - 8 TPI	IC 9.525 mm	16IRAG55	\$159
60° Internal	0.5 - 3.0 mm	IC 9.525 mm	16IRAG60	\$159
55° External	48 - 16 TPI	IC 6.35 mm	11ERA55	\$159
55° External	48 - 8 TPI	IC 9.525 mm	16ERAG55	\$159

## 45° SEMT Indexable Carbide Face Mills

- High precision and stock removal rates.
- Swiss SFS high strength insert screws.
- High grade alloy steel (HRC45-HRC48).
- Suitable for light to medium machining of steel and stainless steel.
- Less than 0.02 mm radial & axial run-out.



Diameter	Height	Hole dia.	Included Inserts	PN	
50 mm	40 mm	22 mm	4 x SEMT1204	H-231-56-001	<b>\$339</b>
80 mm	50 mm	27 mm	5 x SEMT1204	H-231-56-003	<b>\$429</b>
100 mm	50 mm	32 mm	7 x SEMT1204	H-231-56-004	<b>\$499</b>

## 90° APKT Indexable Carbide Nickel Plated Face Mill Sets

- Fitted with coated micro-grain APKT inserts allows high depth of cut and feed. Suitable for square shoulder and face milling of steel, steel alloys, heat resistant steel, stainless steel and as well as cast iron.

Cutter height: 40 mm



Diameter	Pockets	Hole dia.	Included Inserts	PN	
40 mm	4	16 mm	10 x APKT1604	H-11-374-S40-1	<b>\$229</b>
50 mm	5	22 mm	10 x APKT1604	H-11-374-S40-2	<b>\$229</b>
50 mm	5	22 mm	20 x APKT1604	H-11-374-S40	<b>\$349</b>
80 mm	6	27 mm	10 x APKT1604	H-11-374-S40-3	<b>\$499</b>
100 mm	7	32 mm	10 x APKT1604	H-11-374-S40-4	<b>\$529</b>

## 90° TCMT Indexable Nickel Plated Countersink Set

- Set includes two TCMT tool holders and ten TiAIN micro-grain carbide inserts
- Suited to semi-finishing of steel and stainless steel

Cutting Dia: 16 & 21 mm  
Shank Dia: 12 & 20 mm  
Length: 85 & 90 mm



**\$465**  
PN: H-11-374-S10

## 90° TCMT Indexable Nickel Plated Countersinks



- Cut 5 times faster than HSS tools
- Includes TiAIN TCMT carbide inserts
- Suited to semi-finishing of steel & stainless steel

Range: 1-16 mm  
Shank: 12 mm  
**\$129**  
PN: H-11-132-T10

Range: 6-21 mm  
Shank: 20 mm  
**\$159**  
PN: H-11-132-T20

Range: 12-32.5 mm  
Shank: 25 mm  
**\$169**  
PN: H-11-132-T30

## TiN Coated Two & Four Flute HSS End Mills

- Weldon shank
- DIN844 Standard



Flutes	Size	Shank Dia.	Flute	Length	PN	
2	3 mm	6 mm	5 mm	49 mm	H-11-048-T001	<b>\$11</b>
2	4 mm	6 mm	7 mm	51 mm	H-11-048-T002	<b>\$11</b>
2	5 mm	6 mm	8 mm	52 mm	H-11-048-T003	<b>\$11</b>
2	6 mm	6 mm	8 mm	52 mm	H-11-048-T004	<b>\$11</b>
2	8 mm	10 mm	11 mm	61 mm	H-11-048-T006	<b>\$15</b>
2	10 mm	10 mm	13 mm	63 mm	H-11-048-T008	<b>\$15</b>
2	12 mm	12 mm	16 mm	73 mm	H-11-048-T010	<b>\$15</b>
2	14 mm	12 mm	16 mm	73 mm	H-11-048-T011	<b>\$27</b>
2	16 mm	16 mm	19 mm	79 mm	H-11-048-T012	<b>\$31</b>
2	20 mm	20 mm	22 mm	88 mm	H-11-048-T014	<b>\$46</b>
4	3 mm	6 mm	8 mm	52 mm	H-11-047-T001	<b>\$11</b>
4	4 mm	6 mm	11 mm	55 mm	H-11-047-T002	<b>\$11</b>
4	5 mm	6 mm	13 mm	57 mm	H-11-047-T003	<b>\$11</b>
4	6 mm	6 mm	13 mm	57 mm	H-11-047-T004	<b>\$11</b>
4	8 mm	10 mm	19 mm	69 mm	H-11-047-T006	<b>\$17</b>
4	10 mm	10 mm	22 mm	72 mm	H-11-047-T008	<b>\$17</b>
4	12 mm	12 mm	26 mm	83 mm	H-11-047-T010	<b>\$22</b>
4	14 mm	12 mm	26 mm	83 mm	H-11-047-T011	<b>\$30</b>
4	16 mm	16 mm	32 mm	92 mm	H-11-047-T012	<b>\$36</b>
4	20 mm	20 mm	38 mm	104 mm	H-11-047-T014	<b>\$52</b>

## 20 Piece Two & Four Flute TiN Coated HSS End Mill Set

- High speed steel with TiN coating suited to cast iron, general purpose steel and stainless steel
- Center cut geometry
- Weldon shank
- Regular length
- DIN844 Standard

20 Piece set includes two & four flute TiN coated end mills in the following sizes:  
3, 4, 5, 6, 8, 10, 12, 14, 16 & 20 mm



**\$299**  
PN: H-522-51-2S1

## 6 Piece Four Flute TiAIN Coated Solid Carbide End Mill Set

- Made of micrograin carbide with TiAIN coating for general-purpose applications in cast iron, steel, and stainless steel
- Four flute with centre cut
- 30° flute pitch
- H6-6535HA DIN standard.

6 Piece set includes four flute TiAIN coated carbide endmills in the following sizes:  
3, 4, 6, 8, 10 & 12 mm  
**\$249**  
PN: H-11-190-S07





## 90° APKT Indexable End Mill Set

- Set includes an APKT tool holder and TiAlN micro-grain carbide inserts
- Suited to semi-finishing of steel and stainless steel

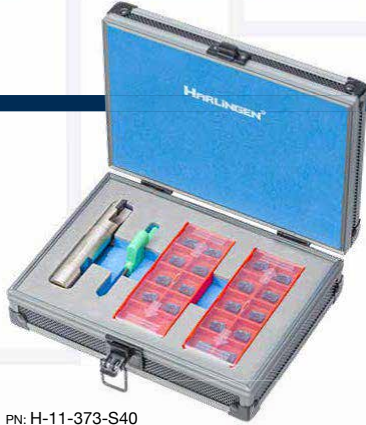

PN: H-11-373-S40

Cutting Dia	Shank Dia	Length	Included Inserts	PN	
14 mm	16 mm	80 mm	20 x APKT1604	H-11-373-S40-1	<b>\$219</b>
16 mm	16 mm	85 mm	20 x APKT1604	H-11-373-S40	<b>\$289</b>
20 mm	20 mm	90 mm	10 x APKT1604	H-11-373-S40-2	<b>\$249</b>
25 mm	25 mm	95 mm	10 x APKT1604	H-11-373-S40-3	<b>\$269</b>

## Precision Angle Lock Milling Machine Vices with Swivel Base

- Thrust ball bearing spindle for higher clamping forces
- Angle-lock designed to prevent jaw lift
- Vice body made of high grade cast iron
- Hardened and ground guide surfaces
- Replaceable hardened and ground clamping jaws
- Shielded spindle



Jaw Face	Jaw Opening	Weight	PN	
100 x 32 mm	140 mm	19 Kg	H-40-085-002	<b>\$299</b>
125 x 40 mm	145 mm	23 Kg	H-40-085-004	<b>\$369</b>
160 x 45 mm	160 mm	39 Kg	H-40-085-006	<b>\$469</b>
200 x 50 mm	235 mm	60 Kg	H-40-085-010	<b>\$899</b>

## Clamping Kits

- Kits manufactured from high quality quenched and tempered steel with black oxide finish

58 piece Kit includes 24 stud bolts (4 each in length), 75, 100, 125, 150, 175, 200 mm, 4 extension nuts, 6 stepped finger clamps (3 pairs), 6 T-slot nuts, 6 flange nuts, 3 pairs of stepped blocks



## 150 mm / 6" Tilting Machine Vice

- This machine vice features great rigidity & clamping force and has engraved quadrants on the tilt and swivel axes.

Jaw Face: 160 x 50 mm  
Jaw opening: 125 mm  
Weight: 39 Kg



**\$769**

PN: H-40-083-003

## 150 mm High Precision Modular Vice

- High precision accuracy to 0.01 mm
- Angle-lock designed to prevent jaw lift
- Made of high grade steel alloy
- Height matched

Jaw Face: 150 x 50 mm  
Jaw Opening: 200 mm  
Overall Length: 420 mm  
Hardness: HRC 58-62

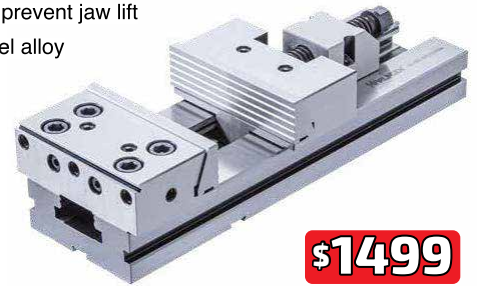

**\$1499**

PN: H-41-089-003

## Precision Angle Lock Milling Machine Vices

- Thrust ball bearing spindle for higher clamping forces
- Angle-lock designed to prevent jaw lift
- Vice body made of high grade cast iron
- Hardened and ground guide surfaces
- Replaceable hardened and ground clamping jaws
- Shielded spindle

Jaw Face: 152 x 45 mm  
Jaw opening: 230 mm  
Weight: 33 Kg



**\$989**

PN: H-40-085-007H

T-Slot	Stud	PN	
12 mm	M10	H-41-061-001	<b>\$169</b>
7/16"	3/8"	H-42-061-001	<b>\$179</b>
14 mm	M12	H-41-061-002	<b>\$189</b>
15.7 mm	M12	H-41-061-002-1	<b>\$189</b>
16 mm	M14	H-41-061-003	<b>\$199</b>
18 mm	M16	H-41-061-004	<b>\$329</b>
20 mm	M18	H-41-061-005	<b>\$579</b>

### 3/8" Shank Brake Disc Lathe Tool Holder

Insert: TCMT090204  
Shank: 9.525 mm  
Length: 50 mm

- Insert sold separately (PN: TCMT090204 see page 10)
- Corrosion resistant Nickel Plating

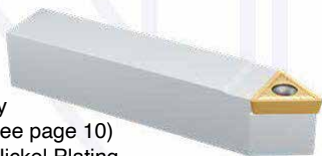

**NEW!**

**\$79**  
PN: STECN06-2

### Nickel Plated 7 Piece Indexable Negative Rake Lathe Tool Set

- Corrosion resistant Nickel Plating

Set includes the following 25 mm tool holders, inserts, torx and hex wrenches:

Left & Right Handed CNMG Tool Holders, Right Handed WNMG Tool Holder, Neutral & Right Handed DNMG Tool Holders, 4 mm Groove Tool Holder and Threading Tool Holder



**\$695**

PN: H-11-126-T35-1

### Nickel Plated CCMT Boring Bar Set

- Set includes boring bars with TiN Micro-Grain Carbide Semi-Finishing CCMT Inserts
- Suited to cast iron, general purpose steel and stainless steel

4 Piece set includes:  
8 x 100mm Boring Bar  
10 x 125mm Boring Bar  
12 x 150mm Boring Bar  
16 x 200mm Boring Bar

**\$279**

PN: H-11-383-T19



### High Precision Live Center

- Max concentricity deviation 0.005 mm
- Needle & thrust bearing design
- Hardened & ground body



### High Precision Live Centers

Mount	Max Speed	Max load	Accuracy	PN	
MT2	7000 RPM	200 Kg	0.005 mm	H-41-323-002	<b>\$229</b>
MT3	5000 RPM	500 Kg	0.005 mm	H-41-323-003	<b>\$269</b>
MT4	3800 RPM	800 Kg	0.005 mm	H-41-323-004	<b>\$309</b>
MT5	3000 RPM	2000 Kg	0.01 mm	H-41-323-005	<b>\$459</b>
MT6	2600 RPM	3500 Kg	0.01 mm	H-41-323-006	<b>\$859</b>

### High Precision Extended Point Live Centers

Mount	Max Speed	Max load	Accuracy	PN	
MT2	7000 RPM	140 Kg	0.005 mm	H-41-023-002	<b>\$249</b>
MT3	5000 RPM	400 Kg	0.005 mm	H-41-023-003	<b>\$299</b>
MT4	3800 RPM	500 Kg	0.005 mm	H-41-023-004	<b>\$359</b>
MT5	3000 RPM	1200 Kg	0.01 mm	H-41-023-005	<b>\$479</b>

### Nickel Plated WNMG Indexable Turning & Boring Tool Set

- Set includes tool holders with TiN coated Micro-Grain Carbide Inserts
- Suited to cast iron, steel and stainless steel

Set includes:  
Left & right handed WNMG tool holder, right handed boring bar and 10 x WNMG080404 inserts

20 MM Shank

**\$479**

PN: H-212-13-S02

25 MM Shank

**\$569**

PN: H-212-06-S02



### Nickel Plated 7 Piece Indexable Lathe Tool Sets

- Corrosion resistant Nickel Plating

Each set includes the following tool holders, inserts, torx and hex wrenches:

Left & Right Handed CCMT Tool Holders  
Neutral & Right Handed DCMT Tool Holders  
Right Handed WCMT Tool Holder  
Grooving Tool Holder & Threading Tool Holder

10 MM Shank 12 MM Shank 16 MM Shank 20 MM Shank

**\$299**

PN: H-11-126-T15

**\$299**

PN: H-11-126-T20

**\$339**

PN: H-11-126-T25

**\$399**

PN: H-11-126-T30



### Nickel Plated Threading Tool Holder Set

- Set includes tool holders and four ti-nite coated tungsten carbide inserts for right-handed, internal & external thread cutting
- Suited to cast iron, steel and stainless steel

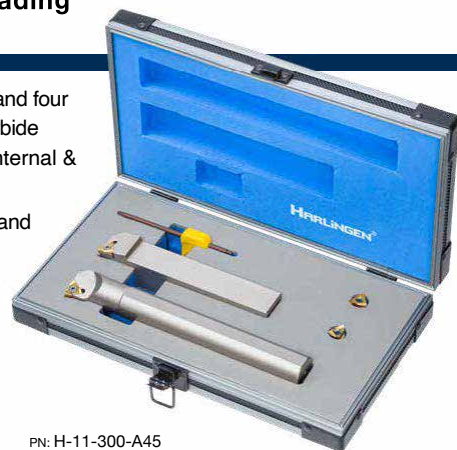

PN: H-11-300-A45

Ext. Shank	Int. Shank	Thread Pitch	PN	
16 mm	16 mm	60°	H-11-300-A30	<b>\$249</b>
20 mm	20 mm	60°	H-11-300-A40	<b>\$289</b>
25 mm	25 mm	60°	H-11-300-A45	<b>\$329</b>
25 mm	16 mm	55° & 60°	H-11-300-A45-1	<b>\$289</b>



## Nickel Plated TCMT Indexable Turning & Boring Tool Set

- Set includes tool holders with TiN coated micro-grain carbide inserts
- Suited to cast iron, steel and stainless steel

Set includes:  
Left & Right Handed Positive Rake Tool Holders  
Positive Rake Boring Bar  
10 x TCMT110204 inserts



12 mm Shank

**\$289**

PN: H-212-06-S01

16 mm Shank

**\$299**

PN: H-212-13-S01

## Cut-Off & Grooving Lathe Tool Sets

- Corrosion resistant Nickel Plating

Kit includes the following range of tool block, blades and 10 inserts



PN: H-11-262-T30

Block	Blades	Parting Inserts	PN	
12 mm	19 x 2 & 3 mm	GTN-2, GTN-3	H-11-262-T15	<b>\$269</b>
16 mm	26 x 2 & 3 mm	GTN-2, GTN-3	H-11-262-T20	<b>\$299</b>
20 mm	26 x 2 & 3 mm	GTN-2, GTN-3	H-11-262-T30	<b>\$319</b>
25 mm	32 x 4 mm x 2	GTN-4	H-11-262-T35-1	<b>\$399</b>
25 mm	32 x 3, 4 & 5 mm	GTN-3, GTN-4, GTN-5	H-11-262-T35	<b>\$489</b>

## Nickel Plated Cut-Off Tool Blades & Blocks

- Corrosion resistant Nickel Plating



### Parting Blades

Size	PN	
19 x 2 mm	NCIH19-2	<b>\$59</b>
19 x 3 mm	NCIH19-3	<b>\$59</b>
26 x 2 mm	NCIH26-2	<b>\$59</b>
26 x 3 mm	NCIH26-3	<b>\$59</b>
32 x 3 mm	NCIH32-3	<b>\$99</b>
32 x 4 mm	NCIH32-4	<b>\$99</b>
32 x 5 mm	NCIH32-5	<b>\$99</b>

### Parting Blocks

Length	Blade Width	Blade Height	Shank	PN	
56 mm	2-3 mm	19 mm	12 mm	SLTBN12-02	<b>\$89</b>
75 mm	2-3 mm	26 mm	16 mm	SLTBN16-05	<b>\$99</b>
75 mm	2-3 mm	26 mm	20 mm	SLTBN20-05	<b>\$99</b>
75 mm	2-5 mm	32 mm	25 mm	SLTBN25-06	<b>\$129</b>

## 90° HSS Three Flute Countersinks

- Achieve consistent high quality results and chatterless burr-free operation with unequally spaced flutes
- CBN ground deep flutes for significantly smoother & sharper cutting edges
- Suitable for metal, plastics & non-ferrous materials.

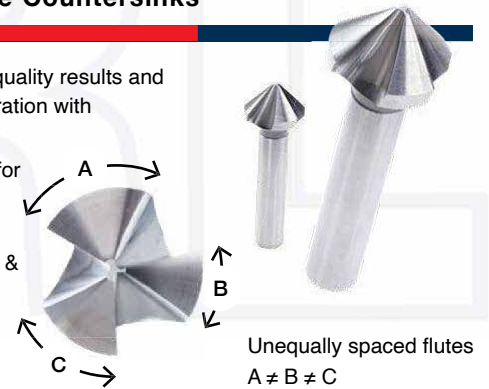

### Individual 90° HSS Three Flute Countersinks



Size	PN	
6.3 mm	H-11-039-005	<b>\$19</b>
8.3 mm	H-11-039-009	<b>\$19</b>
10.4 mm	H-11-039-012	<b>\$19</b>
12.4 mm	H-11-039-014	<b>\$22</b>
16.5 mm	H-11-039-017	<b>\$29</b>
20.5 mm	H-11-039-019	<b>\$32</b>

## 90° HSS Three Flute Countersink Set

- Achieve consistent high quality results and chatterless burr-free operation with the latest unequally spaced geometry
- CBN ground deep flutes for significantly smoother & sharper cutting edges
- Suitable for metal, plastics & non-ferrous materials.

6 Piece set includes the following sizes: 6.3, 8.3, 10.4, 12.4, 16.5, 20.5 mm



**\$119**

PN: H-11-040-S01

## 90° TiAlN Coated HSS-Cobalt Helical Flute Countersinks Set

- The latest unequally spaced helical flute geometry delivers consistent high quality results and chatterless, burr-free operation on stainless steel and a wide range of other materials
- CBN ground deep flutes for significantly smoother & sharper cutting edges
- Helical flutes further reduce vibration and improve surface finish

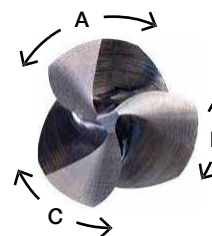

Unequally spaced flutes  
A ≠ B ≠ C

6 Piece set includes the following sizes: 6.3, 8.3, 10.4, 12.4, 16.5, 20.5 mm

**\$229**

PN: H-552-14-4S1

## Drill Press Vices

- Replaceable precision hardened & ground prisma jaws
- High quality cast iron body
- Rolled trapezoidal spindle thread



Jaw Face	Jaw Opening	Weight	PN	
100 x 27 mm	75 mm	3.5 Kg	H-41-074-002	<b>\$99</b>
150 x 34 mm	125 mm	7.0 Kg	H-41-074-004	<b>\$169</b>
200 x 40 mm	175 mm	10.0 Kg	H-41-074-005	<b>\$289</b>

## 150 mm / 6" Fabricated Offset Steel Bench Vice

- Fabricated steel construction for heavy duty metal working applications.

Jaw Face: 150 x 25 mm  
 Jaw Range: 190 mm  
 Width: 280 mm  
 Height: 190 mm  
 Weight: 22 Kg



**\$499**  
 PN: H-732-33-015

## Metric HSS Cap Screw Counter-bore Set



6 piece set includes the following sizes:  
 M3, M4, M5, M6, M8 & M10  
 Material: HSS

**\$189**  
 PN: H-562-12-1S1

## 1-13mm HSS Stepped Head Drill Set

- Stepped head with 135° split point
- 25 piece set includes drill bits from 1 to 13 mm in 0.5 mm increments
- Material: M2-HSS

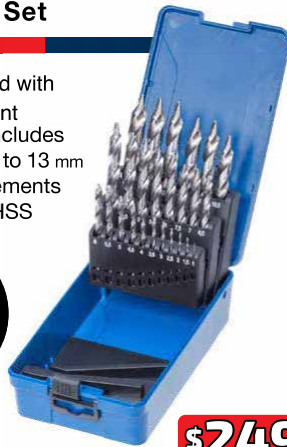

**\$249**  
 PN: H-512-96-8S2

## Welders Vices

- High quality cast iron body
- Quick-Release spindle nut
- Copper plated spindle for spatter protection



Jaw Face	Size	PN	
105 x 35 mm	85 mm	H-40-076-008	<b>\$129</b>
135 x 61.5 mm	120 mm	H-40-076-009	<b>\$169</b>

## TiN Coated HSS-Cobalt Spiral Flute Step Drill Set

- HSS, Cobalt 5% (M35)
- Faceted shanks



Set of 3 includes:  
 4-12, 4-20, 4-30 mm  
 Steps: 2 mm

**\$169**  
 PN: H-11-001B-S03

## 10 Piece Damaged Bolt Removal Kit



- Removes damaged, stripped or rusted screws, nuts or bolts
- Ideal in tight spaces

Sizes: 9, 10, 11, 12, 13, 14, 15, 16, 17 & 19 mm

**\$59**  
 PN: H-60-015-001

## Individual TiN Coated HSS Spiral Flute Step Drills

- HSS-M2
- Faceted shanks



Range	Steps	PN	
4-12 mm	1	H-11-001B-T01	<b>\$21</b>
4-20 mm	2	H-11-001B-T02	<b>\$29</b>
4-32 mm	2	H-11-001B-T06	<b>\$79</b>

## 1-10mm HSS-Cobalt Left Hand Drill Set

- For broken bolt removal
  - HSS, Cobalt 5% (M35)
  - 135° split point
- 10 piece set includes drill bits from 1 to 10 mm

Material: HSS, Cobalt 5% (M35)

**\$69**  
 PN: H-11-012-S05



## HSS Reduced Shank Drill Set

8 piece set includes 13, 14, 15, 16, 18, 20, 22 & 25 mm drills  
 Drill length: 150 mm  
 Shank: 13 mm  
 Material: HSS



**\$199**  
 PN: H-11-030-S01

## HSS Intermediate Tap & Twist Drill Set

15 piece set includes Tapping Wrench and the following drills and taps:  
 M3 x 0.50 mm  
 M4 x 0.70 mm  
 M5 x 0.80 mm  
 M6 x 1.00 mm  
 M8 x 1.25 mm  
 M10 x 1.50 mm  
 M12 x 1.75 mm



**\$99**  
 PN: H-542-36-S01



## Master Thread Repair Kits



- The most reliable and effective tool for thread repair.
- Quickly and permanently restore stripped, worn or damaged threads to their original size, condition and strength.
- Increase the strength and durability of threads in soft materials.

### M5 to M12 Master Thread Repair Kit

Set includes: HSS STI taps & drill bits 1.5D Stainless steel wire inserts in the following sizes:  
25 x M5 x 0.8, 25 x M6 x 1.0  
25 x M8 x 1.25, 25 x M10 x 1.5  
10 x M12 x 1.75

**\$179**

PN: H-11-303-A01

### 1/4" to 1/2" UNC Master Thread Repair Kit

Set includes: HSS STI taps & drill bits 1.5D Stainless steel wire inserts in the following sizes:  
25 x 1/4"-20 UNC, 25 x 5/16"-18 UNC  
25 x 3/8"-16 UNC, 25 x 7/16"-14 UNC  
10 x 1/2"-13 UNC

**\$189**

PN: H-12-303-A01UNC

### 1/4" to 1/2" UNF Master Thread Repair Kit

Set includes: HSS STI taps & drill bits 1.5D Stainless steel wire inserts in the following sizes:  
25 x 1/4"-28 UNF, 25 x 5/16"-24 UNF  
25 x 3/8"-24 UNF, 25 x 7/16"-20 UNF  
10 x 1/2"-20 UNF

**\$189**

PN: H-12-303-A02UNF

## 1-13mm HSS Drill Set

- M2-HSS
- 135° split point

25 piece set includes drill bits from 1 to 13 mm in 0.5 mm increments  
Material: HSS



**\$115**

PN: H-512-11-1S1

## 1-13mm HSS-Cobalt Drill Set

- HSS, Cobalt 5% (M35)
- 135° split point

25 piece set includes drill bits from 1 to 13 mm in 0.5 mm increments.  
Material: HSS, Cobalt 5% (M35)



**\$169**

PN: H-512-11-4S1

## Stainless Steel Threaded 1.5D Inserts



Thread Profile	Thread Length	Quantity	PN	
M5 x 0.8	7.5 mm	25	H-11-303-310	<b>\$19</b>
M6 x 1.0	9 mm	25	H-11-303-315	<b>\$19</b>
M8 x 1.0	12 mm	25	H-11-303-321	<b>\$19</b>
M8 x 1.25	12 mm	25	H-11-303-320	<b>\$19</b>
M10 x 1.0	15 mm	25	H-11-303-327	<b>\$19</b>
M10 x 1.25	15 mm	25	H-11-303-326	<b>\$19</b>
M10 x 1.5	15 mm	25	H-11-303-325	<b>\$19</b>
M12 x 1.75	18 mm	10	H-11-303-330	<b>\$19</b>
M12 x 1.25	18 mm	10	H-11-303-331	<b>\$19</b>
M12 x 1.5	18 mm	10	H-11-303-332	<b>\$19</b>
M14 x 2.0	21 mm	10	H-11-303-337	<b>\$19</b>
M14 x 1.5	21 mm	10	H-11-303-340	<b>\$19</b>
M16 x 2.0	24 mm	10	H-11-303-342	<b>\$19</b>
1/4"-20 UNC	0.375"	25	H-12-303-310	<b>\$19</b>
5/16"-18 UNC	0.46875"	25	H-12-303-315	<b>\$19</b>
3/8"-16 UNC	0.5625"	25	H-12-303-320	<b>\$19</b>
7/16"-14 UNC	0.65625"	25	H-12-303-325	<b>\$29</b>
1/2"-13 UNC	0.75"	10	H-12-303-330	<b>\$19</b>
1/4"-28 UNF	0.375"	25	H-12-303-350	<b>\$19</b>
5/16"-24 UNF	0.46875"	25	H-12-303-355	<b>\$19</b>
3/8"-24 UNF	0.5625"	25	H-12-303-360	<b>\$19</b>
7/16"-20 UNF	0.65625"	25	H-12-303-365	<b>\$29</b>
1/2"-20 UNF	0.75"	10	H-12-303-370	<b>\$19</b>

## 170 Piece HSS-Cobalt Twist Drill Set

- HSS, Cobalt 5% (M35)
- 135° split point

170 piece set includes ten sets of:  
1.0 to 8.0 mm drill bits in 0.5 mm increments  
Five sets of 8.5 to 10.0 mm drill bits in 0.5 mm increments.



**\$479**

PN: H-11-275-003

## Inner & Outer Deburrers

- Suitable for stainless steel, copper, PPR & PVC pipes

6-35 mm Deburrer

**\$69**

PN: H-10-176-A02

12-54 mm Deburrer

**\$89**

PN: H-10-170-A01



## Bulk-Buy HSS-Cobalt Jobber Drill Packs

**NEW Bulk-Buy Packs!**



- HSS, Cobalt 5% (M35)
- 135° split point for sizes above 3 mm
- Also available Individually

Size	Qty	PN	PN
1 mm	10	H-11-008-LC025-P	<b>\$25</b>
1.5 mm	10	H-11-008-LC035-P	<b>\$25</b>
1.6 mm	10	H-11-008-LC037-P	<b>\$25</b>
2 mm	10	H-11-008-LC045-P	<b>\$28</b>
2.5 mm	10	H-11-008-LC055-P	<b>\$28</b>
2.9 mm	10	H-11-008-LC063-P	<b>\$28</b>
3 mm	10	H-11-008-LC065-P	<b>\$28</b>
3.3 mm	10	H-11-008-LC068-P	<b>\$28</b>
3.5 mm	10	H-11-008-LC070-P	<b>\$28</b>
4 mm	10	H-11-008-LC075-P	<b>\$35</b>
4.2 mm	10	H-11-008-LC077-P	<b>\$35</b>
4.5 mm	10	H-11-008-LC080-P	<b>\$35</b>
5 mm	10	H-11-008-LC085-P	<b>\$40</b>
5.3 mm	10	H-11-008-LC088-P	<b>\$40</b>
5.5 mm	10	H-11-008-LC090-P	<b>\$45</b>
6 mm	10	H-11-008-LC095-P	<b>\$45</b>
6.5 mm	10	H-11-008-LC100-P	<b>\$45</b>
6.8 mm	10	H-11-008-LC103-P	<b>\$56</b>
7 mm	10	H-11-008-LC105-P	<b>\$56</b>
7.5 mm	10	H-11-008-LC110-P	<b>\$69</b>
8 mm	10	H-11-008-LC115-P	<b>\$75</b>
8.5 mm	10	H-11-008-LC120-P	<b>\$85</b>
8.8 mm	5	H-11-008-LC123-P	<b>\$55</b>
9 mm	5	H-11-008-LC125-P	<b>\$59</b>
9.5 mm	5	H-11-008-LC130-P	<b>\$62</b>
10 mm	5	H-11-008-LC135-P	<b>\$69</b>
10.2 mm	5	H-11-008-LC137-P	<b>\$70</b>
10.5 mm	5	H-11-008-LC140-P	<b>\$70</b>
10.8 mm	5	H-11-008-LC143-P	<b>\$76</b>
11 mm	5	H-11-008-LC145-P	<b>\$76</b>
11.5 mm	5	H-11-008-LC150-P	<b>\$76</b>
12 mm	5	H-11-008-LC155-P	<b>\$96</b>
12.5 mm	5	H-11-008-LC160-P	<b>\$99</b>
12.8 mm	5	H-11-008-LC163-P	<b>\$110</b>
13 mm	5	H-11-008-LC165-P	<b>\$110</b>

## 45 Piece Metric HSS Tap & Die Set

45 Piece M2-HSS set includes long handle & T-handle tap wrenches, long handle die wrench, die adapter, screwdriver and tap & dies in the following sizes:

Fine	Course
M6 x 0.75 mm	M6 x 1.0 mm
M8 x 1.0 mm	M8 x 1.25 mm
M10 x 1.25 mm	M10 x 1.5 mm
M12 x 1.5 mm	M12 x 1.75 mm
M14 x 1.5 mm	M14 x 2.0 mm
M16 x 1.5 mm	M16 x 2.0 mm
M18 x 1.5 mm	M18 x 2.5 mm
M20 x 1.5 mm	M20 x 2.5 mm
M22 x 1.5 mm	M22 x 2.5 mm
M24 x 1.5 mm	M24 x 3.0 mm



**HSS!**  
**\$999**

PN: H-11-115-001-M2

## Adjustable Tap & Reamer Wrenches

Meets DIN1814 standards



Range	Length	PN	
M1-M12	200 mm	H-11-102-003	<b>\$19</b>
M5-M20	380 mm	H-11-102-005	<b>\$39</b>
M13-M32	720 mm	H-11-102-007	<b>\$109</b>

## T-Handle Tap Wrenches

- Forward, Locked & Reverse Ratchet
- Slidable T-handle



Range	Length	PN	
M5-M12	110 mm	H-11-104-004	<b>\$33</b>
M3-M10	250 mm	H-11-104-005	<b>\$39</b>
M5-M12	300 mm	H-11-104-006	<b>\$39</b>

## Round Die Wrenches

• Meets DIN EN22568 & ISO529 standards.



Size	PN	
1" / 25 mm	H-12-103-003	<b>\$11</b>
1-1/2" / 38 mm	H-12-103-004	<b>\$21</b>
2" / 50 mm	H-12-103-005	<b>\$29</b>

## Metric Round Die Wrench

- Meets DIN EN 22568 standard



**NEW!**

Size		PN	
16 x 5 mm	#1	H-11-103-001	<b>\$11</b>
20 x 5 mm	#2	H-11-103-002	<b>\$13</b>
20 x 7 mm	#3	H-11-103-003	<b>\$13</b>
25 x 9 mm	#4	H-11-103-004	<b>\$16</b>
30 x 11 mm	#5	H-11-103-005	<b>\$18</b>
38 x 10 mm	#6	H-11-103-010	<b>\$24</b>
38 x 14 mm	#7	H-11-103-006	<b>\$24</b>
45 x 14 mm	#8	H-11-103-011	<b>\$32</b>
45 x 18 mm	#9	H-11-103-007	<b>\$32</b>
55 x 16 mm	#10	H-11-103-012	<b>\$39</b>
55 x 22 mm	#11	H-11-103-008	<b>\$39</b>
65 x 18 mm	#12	H-11-103-013	<b>\$69</b>
65 x 25 mm	#13	H-11-103-009	<b>\$69</b>
75 x 20 mm	#14	H-11-103-014	<b>\$179</b>
75 x 30 mm	#15	H-11-103-015	<b>\$189</b>
90 x 22 mm	#16	H-11-103-016	<b>\$229</b>
90 x 36 mm	#17	H-11-103-017	<b>\$249</b>
105 x 22 mm	#18	H-11-103-018	<b>\$269</b>
105 x 36 mm	#19	H-11-103-019	<b>\$289</b>



## Intermediate HSS ISO Hand Taps

- Suitable for use with steel, stainless steel, cast iron, non-ferrous materials.
- Can be used for machine and hand tapping
- ISO529 standard. M2-HSS



**HSS!**

### Metric ISO Taps

Size	PN	
M3 x 0.5mm	H-541-76-P002	\$13
M4 x 0.7mm	H-541-76-P007	\$13
M5 x 0.8mm	H-541-76-P013	\$19
M6 x 1.0mm	H-541-76-P018	\$19
M6 x 0.75mm	H-541-76-P019	\$19
M7 x 1.0mm	H-541-76-P020	\$24
M8 x 1.25mm	H-541-76-P022	\$24
M8 x 1.0mm	H-541-76-P023	\$24
M9 x 1.25mm	H-541-76-P025	\$24

### Metric ISO Taps (Continued)

Size	PN	
M10 x 1.5mm	H-541-76-P028	\$24
M10 x 1.25mm	H-541-76-P029	\$24
M10 x 1.0mm	H-541-76-P030	\$24
M12 x 1.75mm	H-541-76-P035	\$29
M12 x 1.5mm	H-541-76-P036	\$29
M12 x 1.25mm	H-541-76-P037	\$29
M14 x 2.0mm	H-541-76-P040	\$39
M14 x 1.5mm	H-541-76-P041	\$39
M16 x 2.0mm	H-541-76-P044	\$39
M16 x 1.5mm	H-541-76-P045	\$39
M18 x 2.5mm	H-541-76-P046	\$42
M18 x 1.5mm	H-541-76-P048	\$42
M20 x 2.5mm	H-541-76-P049	\$47
M20 x 1.5mm	H-541-76-P051	\$47
M22 x 2.5mm	H-541-76-P052	\$58
M22 x 1.5mm	H-541-76-P054	\$58
M24 x 3.0mm	H-541-76-P055	\$74
M24 x 1.5mm	H-541-76-P057	\$74

### Imperial ISO Taps

Size	PN	
#4 x 40 UNC	H-541-76-P209	\$13
#6 x 32 UNC	H-541-76-P213	\$13
#8 x 32 UNC	H-541-76-P215	\$13
#10 x 24 UNC	H-541-76-P217	\$15
#10 x 32 UNF	H-541-76-P218	\$15
#12 x 24 UNC	H-541-76-P219	\$15
1/4" x 20 UNC	H-541-76-P221	\$19
1/4" x 28 UNF	H-541-76-P222	\$19
5/16" x 18 UNC	H-541-76-P223	\$19
5/16" x 24 UNF	H-541-76-P224	\$19
3/8" x 16 UNC	H-541-76-P225	\$19
3/8" x 24 UNF	H-541-76-P226	\$19
7/16" x 14 UNC	H-541-76-P227	\$22
7/16" x 20 UNF	H-541-76-P228	\$22
1/2" x 13 UNC	H-541-76-P229	\$25
1/2" x 20 UNF	H-541-76-P230	\$25

### National ISO Taps

Size	PN	
1/8" - 27 NPT	H-12-097-A003	\$19

## HSS ISO Round Dies

- Suitable for use with steel, stainless steel, cast iron, nonferrous materials.
- Can be used with machine threading or die holder for hand threading.
- M2-HSS



**HSS!**

### Metric ISO Dies

Size	PN	
M3 x 0.5mm	H-11-098-A012	\$14
M4 x 0.7mm	H-11-098-A016	\$14
M5 x 0.8mm	H-11-098-A020	\$14
M6 x 0.75mm	H-11-098-A076	\$16
M6 x 1.0mm	H-11-098-A022	\$16
M7 x 1.0mm	H-11-098-A024	\$16
M8 x 1.0mm	H-11-098-A082	\$20
M8 x 1.25mm	H-11-098-A026	\$20
M9 x 1.25mm	H-11-098-A028	\$20

### Metric ISO Dies (Continued)

Size	PN	
M10 x 1.0mm	H-11-098-A084	\$24
M10 x 1.25mm	H-11-098-A088	\$24
M10 x 1.5mm	H-11-098-A030	\$27
M12 x 1.25mm	H-11-098-A092	\$29
M12 x 1.5mm	H-11-098-A094	\$29
M12 x 1.75mm	H-11-098-A034	\$33
M14 x 1.5mm	H-11-098-A100	\$38
M14 x 2.0mm	H-11-098-A036	\$42
M16 x 1.5mm	H-11-098-A104	\$55
M16 x 2.0mm	H-11-098-A038	\$58
M18 x 1.5mm	H-11-098-A108	\$55
M18 x 2.5mm	H-11-098-A040	\$58
M20 x 1.5mm	H-11-098-A112	\$55
M20 x 2.5mm	H-11-098-A042	\$64
M22 x 1.5mm	H-11-098-A116	\$79
M22 x 2.5mm	H-11-098-A044	\$64
M24 x 1.5mm	H-11-098-A120	\$89
M24 x 3.0mm	H-11-098-A046	\$99

### Imperial ISO Dies

Size	PN	
#4 x 40 UNC	H-581-22-108	\$16
#6 x 32 UNC	H-581-22-112	\$16
#8 x 32 UNC	H-581-22-114	\$16
#10 x 24 UNC	H-581-22-116	\$16
#10 x 32 UNF	H-581-22-117	\$16
#12 x 24 UNC	H-581-22-118	\$16
1/4" x 20 UNC	H-581-22-120	\$16
1/4" x 28 UNF	H-581-22-121	\$16
5/16" x 18 UNC	H-581-22-122	\$19
5/16" x 24 UNF	H-581-22-123	\$19
3/8" x 16 UNC	H-581-22-124	\$22
3/8" x 24 UNF	H-581-22-125	\$22
7/16" x 14 UNC	H-581-22-126	\$26
7/16" x 20 UNF	H-581-22-127	\$26
1/2" x 13 UNC	H-581-22-128	\$32
1/2" x 20 UNF	H-581-22-129	\$32

### National ISO Dies

Size	PN	
1/8" - 27 NPT	H-12-100-A012	\$16



## Letter Stamp Sets

27 piece set includes A-Z plus "&" character  
Made from CRV (6150).



- 10 mm Stamp Set  
PN: GYC601-10 **\$119**
- 12 mm Stamp Set  
PN: GYC601-12 **\$149**
- 16 mm Stamp Set  
PN: GYC601-16 **\$269**
- 19 mm Stamp Set  
PN: GYC601-19 **\$309**

## Alphanumeric Stamp Sets

36 piece set includes 27 "A" to "Z",  
"&", and 9 Piece 0-8 (6 is used as 9)  
Hardness: HRC 58-62°



- 3 mm Stamp Set  
PN: GYC607-3 **\$60**
- 4 mm Stamp Set  
PN: GYC607-4 **\$69**
- 5 mm Stamp Set  
PN: GYC607-5 **\$86**
- 6 mm Stamp Set  
PN: GYC607-6 **\$99**
- 8 mm Stamp Set  
PN: GYC607-8 **\$179**

## Thread Repair Kit

- Includes 1.5D long Stainless Steel threaded inserts
- HSS tap and twist drill



Replacement Thread Inserts on page 16.

- |   |             |  |             |
|---|-------------|--|-------------|
| M6 x 1.0 Metric Course<br>Includes 25 inserts<br>PN: GTRKM6         | <b>\$29</b> | M12 x 1.25 Metric Extra Fine<br>Includes 10 inserts<br>PN: GTRKM12EF | <b>\$42</b> |
| M8 x 1.0 Metric Fine<br>Includes 25 inserts<br>PN: GTRKM8F          | <b>\$34</b> | M12 x 1.5 Metric Fine<br>Includes 10 inserts<br>PN: GTRKM12F         | <b>\$42</b> |
| M8 x 1.25 Metric Course<br>Includes 25 inserts<br>PN: GTRKM8        | <b>\$34</b> | M12 x 1.75 Metric Course<br>Includes 10 inserts<br>PN: GTRKM12       | <b>\$42</b> |
| M10 x 1.0 Metric Extra Fine<br>Includes 25 inserts<br>PN: GTRKM10EF | <b>\$36</b> | M14 x 1.5 Metric Fine<br>Includes 10 inserts<br>PN: GTRKM14F         | <b>\$45</b> |
| M10 x 1.25 Metric Fine<br>Includes 25 inserts<br>PN: GTRKM10F       | <b>\$36</b> | M14 x 2.0 Metric Course<br>Includes 10 inserts<br>PN: GTRKM14        | <b>\$45</b> |
| M10 x 1.5 Metric Course<br>Includes 25 inserts<br>PN: GTRKM10       | <b>\$36</b> | M16 x 2.0 Metric Course<br>Includes 10 inserts<br>PN: GTRKM16        | <b>\$49</b> |

## Symbol Stamp Sets

27 piece 6 mm set includes:

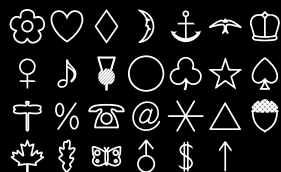

**\$99**  
PN: GYC612-6

## Number Stamp Sets

9 piece set includes 0 to 8 (6 is used as 9)  
Made from CRV (6150).



- |  |   |
|--|---|
| 3 mm Stamp Set<br>PN: GYC602-3 <b>\$30</b> | 10 mm Stamp Set<br>PN: GYC602-10 <b>\$62</b>  |
| 4 mm Stamp Set<br>PN: GYC602-4 <b>\$32</b> | 12 mm Stamp Set<br>PN: GYC602-12 <b>\$89</b>  |
| 5 mm Stamp Set<br>PN: GYC602-5 <b>\$39</b> | 16 mm Stamp Set<br>PN: GYC602-16 <b>\$99</b>  |
| 6 mm Stamp Set<br>PN: GYC602-6 <b>\$42</b> | 19 mm Stamp Set<br>PN: GYC602-19 <b>\$129</b> |
| 8 mm Stamp Set<br>PN: GYC602-8 <b>\$52</b> |   |

## Single Line Alphanumeric Stamp Sets

Made from S55C High carbon steel, HRC 58-60°.  
100 Piece set includes:  
9 Character Type Holder,  
hex wrench, A-Z, 0-9,  
&, /, - and blank space.

- 3 mm Stamp Set  
**\$499**  
PN: GYC610-3
- 6 mm Stamp Set  
**\$609**  
PN: GYC610-6



## 3 Piece Step Drill Set

- TiN coated HSS
- Helical flute

Includes:  
4-12 MM,  
4-20 MM,  
4-32 MM



**\$189**  
PN: G3SD

## Screw Extractor Set



5 piece set is suitable for extracting screws or bolts from 4M to M20.

**\$20**  
PN: GSES

## Soluble Cutting Oil

Contains emulsifiers and bactericides specifically formulated to provide excellent stability and rust prevention characteristics in hard water up to 400 ppm (expressed as calcium carbonate).

Mix between 5% to 10% with clean tap water.

- |             |              |              |
|-------------|--------------|--------------|
| 1 Litre     | 5 Litres     | 20 Litres    |
| <b>\$34</b> | <b>\$125</b> | <b>\$419</b> |
| PN: SOLOIL1 | PN: SOLOIL5  | PN: SOLOIL20 |



## Diamond Knurling Tool Holders

### 3-1 Diamond Knurling Tool Holder

Shank: 20 x 20 x 140 mm  
Knurling Pitches:  
Fine - 0.8 mm  
Medium - 1.2 mm  
Coarse - 1.8 mm

**\$129**  
PN: H-11-285-001



### Diamond Knurling Tool Holder

Shank: 20 x 12.7 x 100 mm  
Knurling Pitch: 1 mm

**\$59**  
PN: H-11-161-003

## Metric TiN Coated Tungsten Tap & Die Set

Set Includes Tap & Die Wrenches and the following fine & course metric tap & dies:

M6 x 0.75	M6 x 1.0
M8 x 1.0	M8 x 1.25
M10 x 1.25	M10 x 1.5
M12 x 1.5	M12 x 1.75
M14 x 1.5	M14 x 2.0
M16 x 1.5	M16 x 2.0
M18 x 1.5	M18 x 2.5
M20 x 1.5	M20 x 2.5
M22 x 1.5	M22 x 2.5
M24 x 1.5	M24 x 3.0

**\$229**  
PN: GTDS45



## Imperial TiN Coated Tungsten Steel Tap & Die Set

Set Includes Tap & Die Wrenches and the following fine & course Imperial tap & dies:

Imperial UNF Tap & Dies:	Imperial UNC Tap & Dies:
1/4"-28 UNF	1/4"-20 UNC
5/16"-24 UNF	5/16"-18 UNC
3/8"-24 UNF	3/8"-16 UNC
7/16"-20 UNF	7/16"-14 UNC
1/2"-20 UNF	1/2"-13 UNC
9/16"-18 UNF	9/16"-12 UNC
5/8"-18 UNF	5/8"-11 UNC
3/4"-16 UNF	3/4"-10 UNC
7/8"-14 UNF	7/8"-9 UNC
1"-14 UNF	1"-8 UNC

**\$249**  
PN: GTDS45I



## Tungsten Steel Tap & Die Sets

### 39 Piece Metric / Imperial Tungsten Steel Tap & Die Set

Set Includes: Long Handle & T-Handle Tap Wrench, Long Handle Die Wrench, Metric & Imperial Screw Pitch Gauge

Metric Tap & Dies:	Imperial Tap & Dies:
M3 x 0.5	#4-40 UNC
M4 x 0.7	#6-32 UNC
M5 x 0.8	#8-32 UNC
M6 x 1.0	1/4"-20 UNC
M7 x 1.0	5/16"-18 UNC
M8 x 1.25	3/8"-16 UNC
M10 x 1.5	7/16"-14 UNC
M12 x 1.75	1/2"-13 UNC

NPT Tap & Dies: 1/8"-27 NPT



### 60 Piece Metric / Imperial Tungsten Steel Tap & Die Set

Set Includes: T-Handle Tap Wrench, Long Handle Tap Wrench, Long Handle Die Wrench, Metric Screw Pitch Gauge, Imperial Screw Pitch Gauge

Metric Tap & Dies:	Imperial Tap & Dies:			
M3 x 0.5	M8 x 1.25	#4-40 UNC	1/4"-28 UNF	7/16"-20 UNF
M4 x 0.7	M9 x 1.25	#6-32 UNC	1/4"-20 UNC	7/16"-14 UNC
M5 x 0.8	M10 x 1.0	#8-32 UNC	5/16"-24 UNF	1/2"-20 UNF
M6 x 1.0	M10 x 1.5	#10-32 UNF	5/16"-18 UNC	1/2"-13 UNC
M7 x 1.0	M12 x 1.75	#10-24 UNC	3/8"-24 UNF	
		#12-24 UNC	3/8"-16 UNC	

NPT Tap & Dies: 1/8"-27 NPT

**\$149**  
PN: GTDS60



## Screw Extractor Kits

Kit includes left handed HSS-M35 (Cobalt 5%) drill bit & Screw Extractor

M4 PN: GSESM4	<b>\$12</b>
M5 PN: GSESM5	<b>\$14</b>
M6 PN: GSESM6	<b>\$15</b>
M8 PN: GSESM8	<b>\$16</b>
M10-M12 PN: GSESM10-12	<b>\$19</b>



## Drill Tap & Countersink Bits

Drill

Tap

Deburr

Drive: 1/4" Hex  
Sizes: M4 x 0.7, M5 x 0.8, M6 x 1.0, M8 x 1.25, M10 x 1.5  
Material: HSS M2  
Max. Workpiece Thickness: 5 mm

**CAN BE USED WITH IMPACT DRIVERS**

5-Piece Set

**\$59**

PN: GDTDS5



## Metric Course Drill & Tap Kits

Kits include HSS Drill and HSS intermediate tap.

M4 x 0.7 PN: GDTKM4	<b>\$15</b>
M5 x 0.8 PN: GDTKM5	<b>\$16</b>
M6 x 1.0 PN: GDTKM6	<b>\$18</b>
M8 x 1.25 PN: GDTKM8	<b>\$20</b>
M10 x 1.5 PN: GDTKM10	<b>\$22</b>
M12 x 1.75 PN: GDTKM12	<b>\$24</b>



## VERTEX® Drill Tooling



### Keyed Drill Chuck

Suitable for milling machines, lathes, drilling machines and woodworking machines.

Capacity: 1-13 mm	<b>\$79</b>	Capacity: 1-16 mm	<b>\$99</b>
Mount: JT6	PN: CH13JT6	Mount: JT6	PN: CH16JT6



### Precision Keyless Chucks

Especially suited to CNC machining centre and milling machine use.

Keyless 13 MM / JT6 Drill Chuck	<b>\$199</b>
Accuracy: 0.05 / 50 mm	PN: VKD102
Length: 105.3 mm (closed)	
Keyless 3-16 MM Drill Chuck	<b>\$209</b>
Accuracy: 0.05 / 50 mm	PN: VKD104
Length: 110.3 mm (closed)	

### Drill Chuck Arbors



MT2 x JT6 Arbor PN: DCAMT2J6	<b>\$29</b>
MT3 x JT6 Arbor PN: DCAMT3J6	<b>\$29</b>
MT4 x JT6 Arbor PN: DCAMT4J6	<b>\$49</b>

### Drift Slide Hammer

• Made from carbon steel  
Length: 375 mm  
Weight: 1.3 kg  
HRC: 44-48°



**\$99**  
PN: VHD1

# NICRON®

## LED TORCHES & HEADLAMPS

[nicronlight.com.au](http://nicronlight.com.au)

### TWIST Light

The head of a Twist Light can be swiveled anywhere from 0 to 90 degrees, offering extreme versatility.

Applicable to PN: B73R, B71pro, B75 & B70PLUS



### Mini Twin-Beam Headlamp



Brightness: 700 Lm  
Intensity: 4000 Cd

**\$89**  
PN: H11

- High-quality anodised aluminium body
- Primary Beam: **LOW** (50Lm) **MED** (250Lm) **HIGH** (500Lm)
- Flood Light: **LOW** (35Lm) **HIGH** (100Lm)
- Weight: 59g

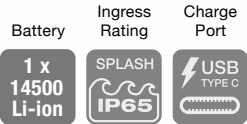

### Mini Rechargeable Headlamp



Brightness: 500 Lm  
Intensity: 160 Cd

**\$59**  
PN: H17

- Anodised aluminium body
- Angle head vertically up to 180°
- USB-C Charge Port

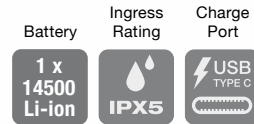

### USB Rechargeable Utility Work Lamp



**\$89**  
PN: WL86

Brightness: 1000 Lm  
Intensity: 4000 Cd

- USB-A power bank functionality
- USB-C Charge Port
- Battery State Indicator
- Magnetic 360° swivel base with interlocking lamp hangers
- 1/4 UNC tripod mount

Primary Beam: **LOW** (20Lm) **MED** (500Lm) **HIGH** (750Lm) **MAX** (1000Lm)

Weight: 333g

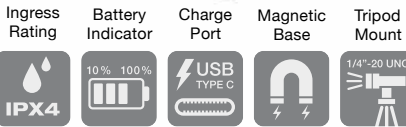

### Twin-Beam Headlamp

- Anti-slip belt for mounting directly to helmets.
- Both lamps combined output 1600 Lm
- Headlamp vertical range of motion 120°
- Includes li-ion battery



**\$129**  
PN: H35

Brightness: 1600 Lm  
Intensity: 4000 Cd

Primary Beam: **LOW** (50Lm) **MED** (250Lm) **HIGH** (500Lm) **MAX** (1000Lm)

Flood Light: **LOW** (50Lm) **MED** (200Lm) **HIGH** (400Lm) **MAX** (800Lm)

Weight: 69g

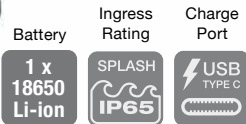

### 2 in 1 Utility Work Lamp

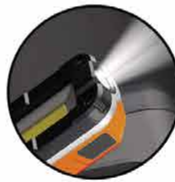

Integrated Flashlight

- Foldout stand with integrated hook
- Primary Beam: **LOW** (12 Lm) **MED** (160 Lm) **HIGH** (450 Lm)



**While Stocks Last!**

**\$110**  
PN: WL85

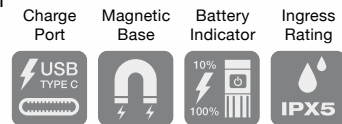

Spot Light: **LOW** (60 Lm) **HIGH** (280 Lm)

Size: 123 x 55 x 32 mm  
Weight: 180 g

### TWIST Pen Light



- Includes USB rechargeable battery
- Illuminated Multi-function Switch with Battery State Indicator

Brightness: 150 Lm  
Intensity: 650 Cd

Primary Beam: **LOW** (60Lm) **HIGH** (150Lm)

Size: 152 x 18 x 15 mm  
Weight: 75g

**\$99**  
PN: B73R



### UV PRO TWIST Light



- Illuminated Multi-function Switch with Battery State Indicator
- Pen Clip

Brightness: 1000 Lm  
Intensity: 3000 Cd

Primary Beam: **LOW** (100Lm) **MED** (500Lm) **HIGH** (1000Lm)

UV Light: **HIGH** (395nm)

Size: 160 x 28 mm  
Weight: 220g

**\$119**  
PN: B75

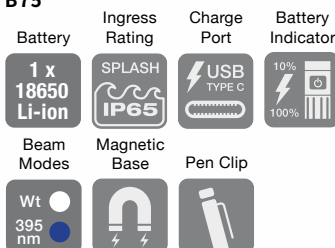

### Camo TWIST Light



- Illuminated Multi-function Switch with Battery State Indicator
- Pen Clip

Brightness: 950 Lm  
Intensity: 10000 Cd

Primary Beam: **LOW** (10Lm) **MED** (70Lm) **HIGH** (300Lm) **MAX** (950Lm) **STROBE** (950Lm)

Size: 160 x 28 mm  
Weight: 220g

**\$119**  
PN: B70PLUS

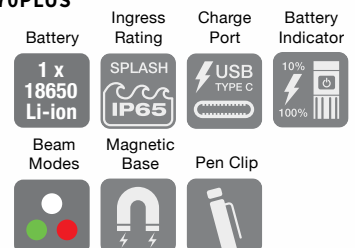



## Magnetic Base

Mount to any ferrous surface. Ideal for wheel wells and engine bays or other tight spaces.

Applicable to PN: B70PLUS, B71pro, B73R, B75, WL15, WL81, WL83, WL85, WL86 & N1pro



## Integrated Battery Indicator

A dedicated built-in LED battery indicator. Applicable to PN: B400 & WL83



## Multifunction Indicator Button

Illuminated multi-function switch with Battery State Indicator. Displays battery state with back-lit multi-colour LED button.

Applicable to PN: B200, B73R, B71pro, B75 & B70PLUS & WL81



## Dual Fuel Capability

Able to accept high capacity rechargeable and standard A series batteries.

Applicable to PN: B73R, B74BLUE, B74RED & F51



## Integrated Charging Port

Recharge without the need to remove the battery with an integrated charge port.

Applicable to PN: B10, B200, B400, B71PRO, B75, B70PLUS, F81, H11, H17, H35, WL15, WL81-83-85

## Rechargeable Bicycle Lamp

Brightness: 500 Lm  
Intensity: 160 Cd

Primary Beam:  
LOW (100 Lm)  
MED (300 Lm)  
HIGH (500 Lm)

Size: 72 x 47 x 45 mm  
Weight: 168 g

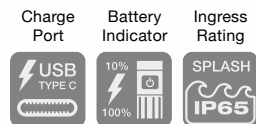

Handlebar mountable thumb controller  
Detachable Lamp Head  
Swivel Mount

**\$125**  
PN: BK10

## Mini Key Chain Flashlight

**\$49**  
PN: N1pro



Brightness: 1000 Lm  
Intensity: 1440 Cd

Primary Beam:  
LOW (120Lm)  
MED (400Lm)  
HIGH (1000Lm)  
STROBE: (1000Lm)  
Size: 85 x 16 mm  
Weight: 34 g

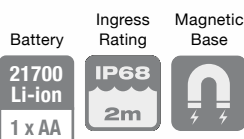

Up to 24 hour battery life  
Two-way clip mounts to caps or pockets

## Mini Focusable Flashlight

**\$89**  
PN: F51



- Focusable Beam
- Includes USB rechargeable battery
- AA batteries NOT included
- Pen Clip

Brightness: 600 Lm  
Intensity: 3800 Cd

Primary Beam:  
LOW (100 Lm)  
MED (250 Lm)  
HIGH (600 Lm)  
Size: 103 x 26 mm  
Weight: 80g



## High Performance Pocket Flashlight

**\$99**  
PN: C1



Brightness: 1200 Lm  
Intensity: 5500 Cd

Primary Beam:  
LOW (25Lm)  
MED (70Lm)  
HIGH (200Lm)  
MAX (1200Lm)  
STROBE: (1200Lm)  
Size: 65 x 20 mm  
Weight: 45g

- Two-way clip mounts to caps or pockets

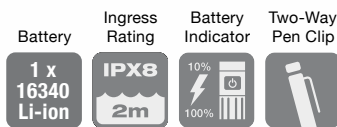

1 x 16340 Li-ion  
IPX8  
100%  
100%

## Utility Flashlight

Brightness: 500 Lm  
Intensity: 800 Cd



Primary Beam:  
LOW (80Lm)  
HIGH (200Lm)  
Flood Light:  
LOW (100Lm)  
MED (300Lm)  
HIGH (500Lm)

Size: 164 x 22 mm  
Weight: 140g

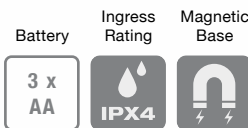

3 x AA  
IPX4

## Rechargeable Mini Focusable Flashlight

**\$59**  
PN: F72R



- USB-C Concealed Charge Port
- Focusable Beam
- Pen Clip

Brightness: 450 Lm  
Intensity: 4000 Cd

Spot Light:  
LOW (20Lm)  
MED (130Lm)  
HIGH (450Lm)  
STROBE: (450Lm)  
Size: 153 x 18.4 mm  
Weight: 64g



10850 Li-ion  
IPX4

## Long Range Tactical Flashlight

**\$179**  
PN: B200



Brightness: 1,600 Lm  
Intensity: 250,000 Cd

Primary Beam:  
LOW (100Lm)  
MED (750Lm)  
HIGH (1600Lm)  
STROBE: (1000Lm)  
Size: 235 x 59 mm  
Weight: 550g

**1000m RANGE!**

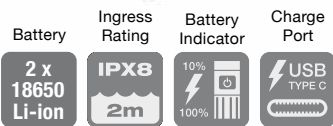

2 x 18650 Li-ion  
IPX8  
100%  
100%

## Extreme Tactical Flashlight

**\$489**  
PN: B400



- Flood & Spot functions
- Fast Charging Li-ion
- Beam proximity sensor
- USB-A power bank functionality

Brightness: 16,000 Lm  
Intensity: 19,3600 Cd

Primary Beam:  
LOW (7Lm)  
MED (170Lm)  
HIGH (3,450Lm)  
MAX (12,300Lm)  
EXTREME (16,000Lm)  
STROBE: (6,000Lm)  
Size: 175 x 82 mm  
Weight: 880g

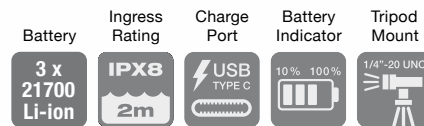

3 x 21700 Li-ion  
IPX8  
100%  
100%

## Focusable Flashlight

**\$119**  
PN: F81



- USB-C Charge Port
- Pen Clip
- Strong magnetic base

Brightness: 1000 Lm  
Intensity: 6500 Cd

Primary Beam:  
LOW (50Lm)  
MED (150Lm)  
HIGH (500Lm)  
MAX (1000Lm)  
STROBE (1000Lm)  
Size: 170 x 35mm  
Weight: 200g



1 x 18650 Li-ion  
IP64

# MICHAELPRO® RED HOT RUNOUT SPECIALS

## Metric Two-Way T-Handle Ball End Hex Key Set

Sizes: 2, 2.5, 3, 4, 5, 6, 8, 10 mm.

Hardened CR-V

8-Piece Set

Was \$89  
**\$59**

PN: MP001044



## Imperial T-Handle Ball End Hex Key Set

Sizes: 5/64", 3/32", 1/8", 5/32", 3/16", 1/4", 5/16" & 3/8".

Hardened CR-V

8-Piece Set

Was \$89  
**\$59**

PN: MP001045



## 3/4" Dr Extended Impact Sockets

6 POINT

• One-Piece Chrome Molybdenum Steel



• 200 MM Overall Length

32 MM Socket

Was \$139  
**\$59**

PN: MP005055

33 MM Socket

Was \$142  
**\$59**

PN: MP005056

41 MM Socket

Was \$146  
**\$59**

PN: MP005057

## Folding Imperial & Metric Hex Key Set

Metric set includes 1.5, 2, 2.5, 3, 4, 5, 6, 8 mm  
Imperial set includes 5/64", 3/32", 7/64", 1/8", 9/64", 5/32", 3/16", 7/32", 1/4", 17 sizes in total.  
Length: 200 mm

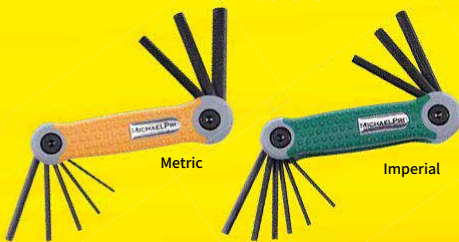

Pack of 2

Was \$39  
**\$25**

PN: MP001007

## Combination Wrenches

- Combination Wrenches with patented super comfortable spiral grip design
- The 12-Point closed end doubles the access angle compared to 6-point
- 0 & 15 degree taper at the open end allows better accessibility

Super Comfortable Wide Body Grip

15° Angled Closed End

Tapered Open End



## Metric Combination Wrenches

8 piece set includes 8, 10, 11, 12, 13, 14, 17 & 19 mm

Was \$119  
**\$89**

PN: MP001015

## Portable Socket Organizer

Size: 332 x 154 x 25 mm  
80 socket organizer holds:  
20 x 1/4" Dr per rail  
20 x 3/8" Dr per rail  
20 x 1/2" Dr per rail  
10 x 3/8" Dr &  
10 x 1/2" Dr per rail

Was \$72  
**\$49**

PN: MP014006



Sockets not included.

## 11-in-1 Ratchet Wrench with Interchangeable Gear Rings

- Our gear ring spanner replaces the need to carry a full range of wrenches. Simply insert the desired gear ring and start using it!

Includes 90 Tooth Double End Ratchet Wrench, 8, 9, 10, 11, 12, 13, 14, 15, 16, 17 & 19 mm gear rings and a durable storage case.

Quick-Release Button

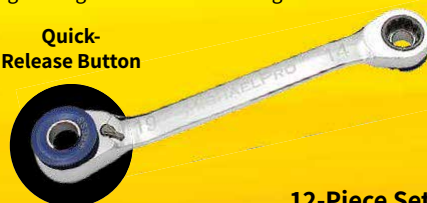

12-Piece Set

Was \$115  
**\$89**

PN: MP001204



## 1/4" & 3/8" 2 Way T-Handle Spinner Wrench Set

- Second square drive on handle
- 3 position adjustable spinner grip

2-Piece Set

Was \$149  
**\$99**

PN: MP009015



## 3 Piece Aluminium Socket Rails

Capacity: 16 x 1/4" clips, 16 x 3/8" clips and 14 x 1/2" clips, 46 sockets total  
Size: 395 x 26 mm



Sockets not included.

Was \$59  
**\$39**

PN: MP014001

## Auto Adjusting Crowsfoot Wrenches & Adapters

This spring-loaded, self adjusting design tightens it's grip as force is applied.



## Set of 3 Auto Adjusting Crowfoot Wrench Adapters

- Multiple square drive attachment point make ideal for confined spaces.

Range: 5-32 mm

Was \$99  
**\$79**

PN: MP001205



## Impact Adapter & Reducer Set

- Made from Chrome Molybdenum Steel
  - Meets or exceeds DIN & ANSI standards.
- 4-piece set includes:  
1/4"(F) to 3/8"(M)  
3/8"(F) to 1/4"(M)  
3/8"(F) to 1/2"(M)  
1/2"(F) to 3/8"(M)



4-Piece Set

Was \$26  
**\$19**

PN: MP005023

# MICHAELPRO® RED HOT RUNOUT SPECIALS

## Magnetic Parts Trays

- Specially designed swiveling rim keeps non-magnetic parts from falling out when hung vertically.

Set includes 150 mm circular magnetic tray & 240 x 150 mm magnetic tray

Weight capacity: 2 Kg (magnetic)

### 2-Piece Set

Was \$75  
**\$49**

PN: MP009014



## Curved Jaw Locking Pliers

Jaw grip range: 25 mm  
Length: 250 mm

Was \$28  
**\$19**

PN: MP003002



## Straight Jaw Locking Pliers

Jaw grip range: 25 mm  
Length: 250 mm

Was \$28  
**\$19**

PN: MP003062



## Roll Head Pry Bar Set

- Heavy duty forged steel alloy
- Supplied in foam tray
- Black oxide finish



### 4-Piece Set

Was \$139  
**\$89**

PN: MP009105

4-Piece pry bar set includes 150, 300, 405 & 510 mm sizes

## Locking Sheet Metal Clamp Pliers

Jaw grip range: 25 mm  
Jaw face: 80 x 40 mm  
Length: 200 mm

Was \$37  
**\$25**

PN: MP003064



## Locking C-Clamp

- Swivel Pads

Jaw Face: 30 x 30 mm  
Internal Jaw Size: 90W x 70L mm  
Length: 290 mm

Was \$46  
**\$29**

PN: MP003063



## 16 Oz Claw Hammer

- Fibreglass handle with soft anti-slip vibration absorbing TPR grip
- Drop-forged steel head with sand-blasted finish



Was \$39  
**\$26**

PN: MP004005

## 22 Oz / 30 cm Soft Hammer

- Shock & Spark Resistant Head
- Non-marring, Double ended Soft Mallet



Was \$49  
**\$35**

PN: MP004026

## Ball Peen Hammers

- Drop-forged steel head with sand-blasted finish
- Soft anti-slip vibration absorbing TPR grip



16 Oz / 325 mm

24 Oz / 380 mm

Was \$39  
**\$26**

Was \$49  
**\$35**

PN: MP004007

PN: MP004008



## Deep Impact Sockets



**BUY ANY 5, GET 25% OFF!**  
**BUY ANY 10, GET 40% OFF!**  
**BUY ANY 20, GET 50% OFF!**

- Made from Chrome Molybdenum Steel CR-MO.
- Meets or exceeds DIN & ANSI standards
- Suitable for use with Impact wrenches
- Socket size stamped on shank
- 6 point drive

### 3/8" Drive Deep Impact Socket

Size	PN	Price
8 mm	GXLS3808	\$13
10 mm	GXLS3810	\$13
12 mm	GXLS3812	\$13
13 mm	GXLS3813	\$13
14 mm	GXLS3814	\$13
15 mm	GXLS3815	\$13
16 mm	GXLS3816	\$15
17 mm	GXLS3817	\$15
18 mm	GXLS3818	\$15
19 mm	GXLS3819	\$15
21 mm	GXLS3821	\$18
22 mm	GXLS3822	\$18
24 mm	GXLS3824	\$18

### 1/2" Drive Deep Impact Socket

Size	PN	Price
10 mm	GXLS1210	\$14
12 mm	GXLS1212	\$14
13 mm	GXLS1213	\$14
14 mm	GXLS1214	\$14
15 mm	GXLS1215	\$15
16 mm	GXLS1216	\$15
17 mm	GXLS1217	\$15
18 mm	GXLS1218	\$15
19 mm	GXLS1219	\$15
21 mm	GXLS1221	\$17
22 mm	GXLS1222	\$17
24 mm	GXLS1224	\$18
27 mm	GXLS1227	\$19
30 mm	GXLS1230	\$26
32 mm	GXLS1232	\$28

### 3/4" Drive Deep Impact Socket

Size	PN	Price
17 mm	GXLS3417	\$35
18 mm	GXLS3418	\$35
19 mm	GXLS3419	\$35
21 mm	GXLS3421	\$35
22 mm	GXLS3422	\$35
24 mm	GXLS3424	\$35
27 mm	GXLS3427	\$35
30 mm	GXLS3430	\$35
32 mm	GXLS3432	\$35
33 mm	GXLS3433	\$39
34 mm	GXLS3434	\$39
36 mm	GXLS3436	\$41
38 mm	GXLS3438	\$44

# MICHAELPRO® RED HOT RUNOUT SPECIALS

## Precision Screwdriver Set

- Chrome Vanadium Steel Alloy.
- Permanent magnetic tips
- Soft PP+TPV Rubber Grip

Phillips Sizes: 00, 0 & 1  
Slotted Sizes:  
1.6, 2, 2.4 & 3.15 mm  
Shank: 60 mm



7-Piece Set

Was \$59  
**\$39**

PN: MP002007

## 7-in-1 Ratcheting Nut & Screwdriver Driver

Includes 25-Tooth Ratchet Screwdriver with storage for two double ended bits:

Phillips #1 / 5 mm slot & Phillips #2 / 6mm slot.

It also features a Stainless Steel Collar with magnetised 1/4 & 5/16 Hex tips tips.



Was \$35  
**\$19**

PN: MP002025

## Precision Hook & Pick Set

Includes full hook, right angled hook, angled hook and straight pick.

4-Piece Set

Was \$29  
**\$19**

PN: MP002006



## Precision Two-Way Ratcheting Screwdriver Set

Set Includes 30-Tooth Full Aluminium Ratcheting Screwdriver, H4 mm x 50 mm L Bits in

Torx: T5 / T6 / T7 / T8 / T9 / T10 / T15 / T20 / T25

Slotted: 1.0 / 1.5 / 2.0 / 2.5 / 3.0 / 4.0 / 6mm

Phillips: #000 / #00 / #0 / #1 / #2 / #3

Hex: H1.5 / H2.0 / H2.5

Square: S1/S2



31-Piece Set

Was \$69  
**\$45**

PN: MP002026

## Extendable Flex-Head Ratchet Set

- Push-Button socket release
- 72 tooth ratchet mechanism
- 180° Flex-Head
- Drop-forged and heat treated chrome vanadium (CR-V)
- Satin Chrome finish
- Supplied in foam tray

1/4" ratchet length: 140 to 185 mm

3/8" ratchet length: 185 to 245 mm

1/2" ratchet length: 225 to 310 mm

Ratcheting mechanism:

72 teeth (5° swing)

Ratchet head range;

180° (5° detents)



3-Piece Set

Was \$189  
**\$120**

PN: MP001210

Extendable Handle

## Torx Screwdriver Set

- Permanent magnetic tips.
- PP+TPV Rubber Soft Grips.
- Satin Chrome finish.
- Meets and even exceeds ANSI standards for performance and quality.

7-Piece Set

Was \$65  
**\$39**

PN: MP002010



Set Includes: T10, T15, T20, T25, T27, T30, T40  
Shank: 100 mm

## 3/8" Drive Flex Head Ratchet Wrench & Socket Set

- 72 tooth ratchet mechanism
- Standard & deep sockets
- Can be used as breaker bar by engaging ratchet lockout
- Lockable flex-head
- Quick Release socket button
- Meets ASME standards.
- Set supplied in foam tray.



19-Piece Set

Was \$119  
**\$79**

PN: MP001228

Set includes:  
1 x 3/8" Drive Flex Head Ratchet, standard & deep sockets in 8, 10, 12, 13, 14, 15, 17, 19 & 21 mm sizes

## P2 RESPIRATORS



P2 RESPIRATORS

MP AUSSIE PRODUCTS

JOB DONE



Compact enough to fit underneath welding helmets.

Was \$39  
**\$19**

PN: MPLR-P2B

## P2 Filter Twin Pack



Was \$29  
**\$19**

PN: MPRF-P2-4

## Extension Breaker Bars



Square Drive Socket End

Functions as a breaker bar and extension bar.



3/8" Drive x 300 mm Extension Breaker Bar

Was \$29  
**\$19**

PN: MP007001

## Set of 3 Extension Breaker Bars

Set includes:

1/4" drive 150 mm long breaker bar

3/8" drive 300 mm long breaker bar

1/2" drive 450 mm long breaker bar

Was \$129  
**\$89**

PN: MP007004

## Quick Release Ratchet Set

- 90 teeth ratcheting mechanism
- Ratchets supplied in foam tray.
- Chrome Vanadium steel
- Meets and exceeds ASME standards.



Set includes:

1/4", 3/8", and

1/2" drive ratchets.

Ratcheting mechanism:

90 teeth (4° swing)

3-Piece Set

Was \$89  
**\$59**

PN: MP006009

# FUJI TOOL RED HOT RUNOUT SPECIALS

## Thread Gauges



### 60° Unified Thread Gauge

- 30 Leaves, all SPCC steel construction, including the lock screw.

Increments: 4, 4-1/2, 5, 5-1/2, 6, 7, 8, 9, 10, 11, 11-1/2, 12, 13, 14, 15, 16, 18, 20, 22, 24, 26, 27, 28, 30, 32, 34, 36, 38, 40 & 42

Was \$49  
**\$39**  
PN: FT006

### 60° Metric Thread Gauge

- 30 Leaves, all SPCC steel construction, including the lock screw.

Increments: 0.25, 0.3, 0.35, 0.4, 0.45, 0.5, 0.55, 0.6, 0.65, 0.7, 0.75, 0.8, 0.85, 0.9, 1, 1.1, 1.2, 1.25, 1.3, 1.4, 1.5, 1.6, 1.7, 1.75, 1.8, 1.9, 2, 2.5 mm  
Made in Japan.

Was \$49  
**\$39**  
PN: FT156

## Radius Gauges



### 0.75-5 MM Radius Gauge

- 18 Metric Leaves, all steel construction including the lock screw.

Increments: 0.75, 1, 1.25, 1.75, 2, 2.25, 2.5, 2.75, 2.75, 3, 3.25, 3.75, 4, 4.25, 4.5, 4.75 & 5 mm.

Was \$62  
**\$49**  
PN: FT272MA

### 5.5-13 MM Radius Gauge

- All Stainless Steel Construction, including the lock screw.

Increments: 5.5, 6, 6.5, 7, 7.5, 8, 8.5, 9, 9.5, 10, 10.5, 11, 11.5, 12, 12.5 & 13 mm  
Made in Japan

Was \$72  
**\$57**  
PN: FT272MB

## 0.5-13 MM 180° Radius Gauge Set

- Measures convex curves down to 45°
- Set includes 26 Metric stainless steel gauges, quick-release gauge holder and carry case.

Increments: 0.5, 1, 1.5, 2, 2.5, 3, 3.5, 4, 4.5, 5, 5.5, 6, 6.5, 7, 7.5, 8, 8.5, 9, 9.5, 10, 10.5, 11, 11.5, 12, 12.5 & 13 mm



Was \$239  
**\$191**  
PN: FTL300MX

## 2-20 MM ISO 30° Trapezoidal Screw Pitch Gauge

Increments: 2, 3, 4, 5, 6, 7, 8, 9, 10, 12, 16 & 20 mm

Was \$259  
**\$207**  
PN: FT30720

## 1-12 TPI Acme 29° Trapezoidal Screw Pitch Gauge

Increments: 1, 1-1/3, 1-1/2, 1-3/4, 2, 2-1/2, 3, 3-1/2, 4, 5, 6, 7, 8, 9, 10, 12 inch

Was \$259  
**\$207**  
PN: FT29730

## Metric Pocket Depth Gauge

- Used for depth measurement of holes, slots, projections etc.
- All Stainless Steel Construction, Including the lock screw.
- It's compact in size for work pieces that are set on machine tools.



Was \$109  
**\$87**  
PN: FTPDG50

Range: 50 mm  
Vernier Scale: 1/20 mm  
Accuracy: ±0.05 mm



- All Stainless Steel Construction, Including the lock screw.
- Accuracy: ± 0.02 to 0.05 MM

## 14.50 Gear Metric Tooth Gauge

13 Imperial Leaves  
Increments: 0.5, 0.75, 1.0, 1.25, 1.5, 1.75, 2.0, 2.25, 2.5, 2.75, 3.0, 3.25, 3.5, 3.75, 4.0, 4.5 & 5.0 mm  
Accuracy: ±0.05 mm

Was \$149  
**\$119**  
PN: FTMPS14

## 20° Imperial Gear Tooth Gauge

8 Metric Leaves  
Increments: 6, 7, 8, 9, 10, 11, 12, 14, 16 & 18"  
Accuracy: ±0.05 mm

Was \$169  
**\$135**  
PN: FTDPS20

## 20° Metric Gear Tooth Gauge

17 Imperial Leaves  
Increments: 0.5, 0.75, 1, 1.25, 1.5, 1.75, 2, 2.25, 2.5, 2.75, 3, 3.25, 3.5, 3.75, 4, 4.5 & 5 mm  
Accuracy: ±0.05 mm

Was \$189  
**\$151**  
PN: FTMPS20



- All SPCC Steel Construction
- 13 Imperial Leaves



Was \$289  
**\$199**  
PN: KP2219

## Through Ratchet Wrench



Free Speed: 450 RPM  
Max. Torque: 30 Ft/lbs  
Weight: 0.60 Kg

Included socket sizes:  
8, 10, 12, 13, & 14 mm  
5/16, 3/8, 7/16, 1/2 & 9/16"  
1/4" & 3/8" anvils



## Halogen Lamp

- Dust and splash proof
  - Single joint, full Swivel Base with mounting holes
  - \*\*Requires External 24V Transformer, recommended: AL24024 or equivalent
- Bulb: 24V 70W



Was \$189  
**\$89**  
PN: AL101C



## 16 MM Keyless Drill Chuck

- Free MT2, MT3 or MT4 arbor with each chuck

Capacity: 3-16 mm  
Mount: J3  
Length: 110 mm



Was \$175  
**\$129**  
PN: POR40J3

## Automotive & Hardware Assortment Kits

**NEW RANGE!**

### Automotive Retainers

#### Cotter Pins

325 piece kit includes cotter pins in 6 sizes ranging from 25 mm x 1.6 mm OD to 64 mm x 4.0 mm OD.



**325**  
Piece Kit

**\$29**

PN: GAK04

#### Zinc Plated Steel Hitch Pins

150 piece kit includes hitch pins in 6 sizes ranging from 31mm x 2.0mm OD to 75 mm x 3.7 mm OD.



**150**  
Piece Kit

**\$29**

PN: GAK05

#### External Circlips

300 piece kit includes external retaining rings in 18 sizes ranging from 3mm to 32mm.



**300**  
Piece Kit

**\$29**

PN: GAK10

#### Internal Circlips

300 piece kit includes internal circlips in 18 sizes ranging from 3mm to 32mm.



**300**  
Piece Kit

**\$29**

PN: GAK11

#### E Clips

300 piece kit includes E-clips in 18 sizes ranging from 1.5mm to 22mm.



**300**  
Piece Kit

**\$32**

PN: GAK12

#### 50 MM Clevis & Hitch Pins

74 piece kit includes 50 mm clevis pins in 6 sizes ranging from 6.35 mm (1/4") OD to 12.7 mm (1/2") OD and 37 hitch pin clips.

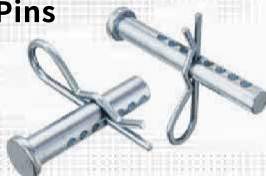

**74**  
Piece Kit

**\$59**

PN: GAK36

#### Zinc Plated Springs

200 piece kit includes compression and tension springs in 12 sizes ranging from 20.5 mm x 5mm OD to 36.5 mm x 8.5mm OD.



**200**  
Piece Kit

**\$29**

PN: GAK30

### Automotive Electrical Kits

#### Fork, Ring, Butt & Spade Terminals

520 piece kit includes 18 types of pre-insulated butt, fork, ring and male & female spade terminals, in 22-16 AWG (Red), 16-14 AWG (Blue) and 12-10 AWG (Yellow) sizes.



**520**  
Piece Kit

**\$55**

PN: GAK29

#### Heat-shrink Tubing

171 piece kit includes tubing in standard colours & lengths of 30, 60, 90 mm & 1m, diameters between 2.0 & 10.0 mm, a thermal rating of -55 to 125°C, voltage rating up to 600V, a shrink ratio of 2:1.



**171**  
Piece Kit

**\$39**

PN: GAK39

### Automotive Screws

#### Socket Head Cap Screws (Grade 12.9)

135 piece kit includes (grade 12.9) Allen head cap screws in 9 sizes ranging from M4 x 12 mm to M10 x 40mm.



**135**  
Piece Kit

**\$39**

PN: GAK07

#### Socket Head Grub Screws

200 piece kit includes (grade 10.9) Allen head grub screws in 12 sizes ranging from M3 x 3mm to M10 x 12mm in fine and coarse pitches.



**200**  
Piece Kit

**\$29**

PN: GAK21

### Automotive Grease Nipples

#### Metric Grease Fittings

110 piece kit includes straight, 45° and 90° grease fittings in 6 sizes ranging from M6 to M10.



**110**  
Piece Kit

**\$46**

PN: GAK20

#### Imperial Grease Fittings

100 piece kit includes straight, 45° and 90° grease fittings in 6 sizes ranging from 1/8"-27 and 1/4"-28 threads.



**100**  
Piece Kit

**\$46**

PN: GAK34

### Automotive Seals & Grommets

#### Stainless Steel Hose Clamps

26 piece kit includes hose clamps in 6 sizes ranging from 16 mm to 38 mm.



**26**  
Piece Kit

**\$29**

PN: GAK16

#### Annealed Copper Washers

110 piece kit includes copper washers in 6 sizes ranging from 1/4" (6.4 mm) to 5/8" (15.9 mm).



**110**  
Piece Kit

**\$39**

PN: GAK25

#### Metric NBR-70 O-Rings

386 piece kit includes O-rings in 30 sizes ranging from 3 mm to 44 mm ID.



**386**  
Piece Kit

**\$40**

PN: GAK32

#### Imperial NBR-70 O-Rings

225 piece kit includes O-rings in 18 sizes ranging from 3/32" (2.38 mm) ID to 13/16" (20.64 mm) ID.



**225**  
Piece Kit

**\$29**

PN: GAK31

#### Blind & Through Hole Grommets

125 piece kit includes through hole grommets in 11 sizes ranging from 1/8" x 1/4" to 3/4" x 15/16" and blind grommets in 7 sizes ranging from 9/32" to 1".



**125**  
Piece Kit

**\$32**

PN: GAK37

#### Through Hole Grommets

180 piece kit includes through hole grommets in 8 sizes ranging from 1/8" x 1/4" to 3/4" x 15/16".



**180**  
Piece Kit

**\$29**

PN: GAK38

## Nut & Bolt Kits

### Metric Nylon Locking Nuts

200 piece kit includes nylon lock nuts in 6 sizes ranging from M4 to M12.



**200**  
Piece Kit  
**\$29**  
PN: GAK08

### Zinc Plated Hex Nuts

350 piece kit includes hex nuts in 6 sizes ranging from M3 to M10.



**350**  
Piece Kit  
**\$29**  
PN: GAK14

### Hex & Nylon Lock Nuts

180 piece kit includes hex nuts and nylon lock nuts in 6 sizes each from M4 to M12.



**180**  
Piece Kit  
**\$29**  
PN: GAK19

### Nuts, Bolts & Washers

450 piece kit includes screws in 5 sizes from M4 x 16 mm to M6 x 20 mm, lock washers, flat washers and hex nuts in 3 sizes each from M4 to M6.



**450**  
Piece Kit  
**\$29**  
PN: GAK18

### Zinc Plated Nuts, Bolts & Washers (Grade 8.8)

240 piece kit includes hex bolts in 10 sizes from M4 x 12 mm to M10 x 40 mm, hex nuts in 5 sizes from M4 to M10 and flat washers in 5 sizes from M4 to M10.



**240**  
Piece Kit  
**\$39**  
PN: GAK33

## Wall Fasteners

### Toggle Bolts

18 piece kit includes toggle bolts in 3.2 mm (1/8") x 75 mm, 4.75 mm (3/16") x 75 mm and 6.35 mm (1/4") x 75 mm.



**18**  
Piece Kit  
**\$29**  
PN: GAK22

### Round Cable Clips

390 piece kit includes black and white cable clips in 6 sizes each from 4 mm to 12 mm.



**390**  
Piece Kit  
**\$29**  
PN: GAK23

### Hook & Eye Bolts

151 piece kit includes eye bolts in 3 sizes from 25 mm x 2.0mm OD to 50 mm x 4.0mm OD and hooks in 3 sizes from 40 mm x 2.5mm OD to 75 mm x 5.0mm OD.

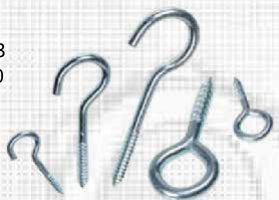

**151**  
Piece Kit  
**\$29**  
PN: GAK26

### Bradded, Standard & Concrete Nails

550 piece kit includes wire nails in 4 sizes from 20 x 1.3 mm to 38 x 2.0 mm, brad nails in 3 sizes from 30 x 1.6 mm to 31 x 2.3 mm and 38 x 2.0 mm brass plated wire nails.



**550**  
Piece Kit  
**\$29**  
PN: GAK28

## Washer Kits

### Internal & External Lock Washers

550 piece kit includes internal and external lock washers in 6 sizes each ranging from M3 to M10.



**550**  
Piece Kit  
**\$25**  
PN: GAK03

### Zinc Plated Lock Washers

600 piece kit includes lock washers in 6 sizes from M4 to M12.



**600**  
Piece Kit  
**\$29**  
PN: GAK09

### Heavy Duty Zinc Plated Flat Washers

725 piece kit includes flat washers in 6 sizes from M3 to M10.



**725**  
Piece Kit  
**\$29**  
PN: GAK13

### Zinc Plated Fender (Penny) Washers

240 piece kit includes fender washers in 6 sizes from 4 x 12 mm to 12 x 30 mm



**240**  
Piece Kit  
**\$29**  
PN: GAK35

## Screw Kits

### Self Tapping Metal Screws

525 piece kit includes screws in 13 sizes from 3 x 12 mm to 5 x 30 mm.



**525**  
Piece Kit  
**\$29**  
PN: GAK01

### Countersunk Tapping Metal Screws

525 piece kit includes countersunk screws in 6 sizes from 3 x 12 mm to 5 x 30 mm.



**525**  
Piece Kit  
**\$29**  
PN: GAK02

### Hex Drive Self Tapping Screws

200 piece kit includes hex head self tapping screws in 8 sizes from 4.2 x 13 mm to 4.8 x 25 mm.



**200**  
Piece Kit  
**\$29**  
PN: GAK06

### Countersunk Self Tapping Wood Screws

390 piece kit includes countersunk self tapping wood screws in 12 sizes from 3.5 x 12 mm to 5 x 40 mm.



**390**  
Piece Kit  
**\$29**  
PN: GAK17

### Countersunk Pozidriv Chipboard Screws

270 piece kit includes chipboard screws in 6 sizes from 3.5 x 25 mm to 5.0 x 50 mm.



**270**  
Piece Kit  
**\$29**  
PN: GAK24

## Rivet & Nutserts

### Blind Aluminium Rivets

320 piece kit includes blind rivets in 6 sizes from 2.4 x 5.5 mm to 4.8 x 8 mm.



**320**  
Piece Kit  
**\$29**  
PN: GAK15

### Zinc Plated Steel Nutserts

150 piece kit includes nutserts in 6 sizes from M3 to M10.



**150**  
Piece Kit  
**\$29**  
PN: GAK27

## Rivet & Nutsert Tool

A 2-in-1 fastening tool that sets nutserts as well as blind rivets.



- Sets steel & aluminium rivets up to 4.8 mm & Nutserts up to M6
- Sets stainless rivets up to 4.0 mm & Nutserts up to M5
- Includes a range of M3 to M6 nutserts

**INCLUDES NUTSERTS!**



**\$139**

PN: GHTJ703A

Sets 2.4, 3.2, 4.0 & 4.8 mm Rivets AND M3, M4, M5 & M6 Nutserts

## Heavy Duty Rivet & Nutsert Tool

- Sets steel & aluminium rivets up to 6.4 mm (1/4") AND nutserts up to M10
- Sets stainless steel rivets up to 4.8 mm (3/16") AND nutserts up to M8
- Space-Saving Foldable Handles
- Forged Main Arms



Sets 3.2 (1/8"), 4.0 (5/32"), 4.8 (3/16") & 6.4 mm (1/4") Rivets and M4, M5, M6, M8 & M10 Nutserts



**\$259**

PN: GHTH3

## Riveting Tools

### Medium Duty Riveting Tool

- Sets steel & aluminium rivets up to 4.8 mm (3/16")
- Sets Stainless Steel Rivets up to 4.0 mm (5/32")

Sets 2.4 (3/32"), 3.2 (1/8"), 4.0 (5/32") & 4.8 mm (3/16") rivets



**\$59**

PN: GHTJ701

### Heavy Duty Riveting Tool

- Sets steel, aluminium & stainless rivets up to 4.8 mm (3/16")

Sets 2.4 (3/32"), 3.2 (1/8"), 4.0 (5/32") & 4.8 mm (3/16") rivets



**\$119**

PN: GHTTC20

## Hex Key Sets

### 13 Piece Torx® Wrench Set

Sizes: T6, T7, T8, T9, T10, T15, T20, T25, T27, T30, T40, T45 & T50



**\$52**

PN: GXTX13

### 13 Piece Tamperproof Torx® Wrench Set

Sizes: T6H, T7H, T8H, T9H, T10H, T15H, T20H, T25H, T27H, T30H, T40H, T45H & T50H



**\$52**

PN: GXTP13

## Pistol Grip Nutsert Tools

- Average cycle time of 3 seconds
- Quick & simple to operate
- Fwd. / Rev. Toggle Switch
- Not suitable for mass production

**POWERED FORWARD + REVERSE**



### M6 Nutsert Tool

M3, M4, M5, M8 & M10 mandrels available (sold separately)

**\$789**

PN: GP400B

### M8 Nutsert Tool

M10 & M12 mandrels available (sold separately)  
Weight: 1.3 Kg

**\$799**

PN: GP200B

## Steel & Aluminium Nutserts

4 mm Max. sheet thickness



**PACKS OF 50**

M4 Aluminium PN: NM4RNA	<b>\$35</b>	M4 Steel PN: NM4PNS	<b>\$19</b>
M5 Aluminium PN: NM5RNA	<b>\$39</b>	M5 Steel PN: NM5PNS	<b>\$25</b>
M6 Aluminium PN: NM6RNA	<b>\$46</b>	M6 Steel PN: NM6PNS	<b>\$29</b>
M8 Aluminium PN: NM8RNA	<b>\$49</b>	M8 Steel PN: NM8PNS	<b>\$32</b>
M10 Aluminium PN: NM10RNA	<b>\$59</b>	M10 Steel PN: NM10PNS	<b>\$39</b>
		M12 Steel PN: NM12PNS	<b>\$65</b>

## Automotive Nutsert Gun

- Sets M4, M5, M6, M8, M10 nutserts in steel & aluminium
- Sets Stainless Steel nutserts up to M8
- Optional M3 anvil set
- Not suitable mass production applications

Traction Power: 3,640 Ft/lbs  
Stroke: 6 mm  
Weight: 1.55 Kg



**HOT PRICE!**



**\$995**

PN: KP4258

## Hook & Pick Set

Includes Straight, Right-Angle, Curved & Hooked Picks.

**\$36**

PN: GXHP4



## Helping Hand Magnifier

• Sturdy cast iron base

Main Beam: 115 mm  
Arm Reach: 75 mm  
Lens Dia.: 60 mm

**\$33**

PN: GHHM



## Gasket Punch Set

14 Piece set includes:

- 3/16" (4.76 mm)
- 1/4" (6.35 mm)
- 5/16" (7.94 mm)
- 3/8" (9.53 mm)
- 7/16" (11.11 mm)
- 1/2" (12.7 mm)
- 5/8" (15.88 mm)
- 3/4" (19.05 mm)
- 7/8" (22.23 mm)
- 1" (25.4 mm)
- 1-1/8" (28.58 mm)
- 1-1/4" (31.75 mm)
- 1-3/8" (34.93 mm)

**\$110**

PN: GGPS



- Hand guard integrated into handle
- Spring loaded driver point for accurate alignment

## Socket Sets

### 1/4" Socket Set

• Chrome Vanadium Steel

Set includes Ratchet Wrench, Driver Handle, 50 mm Extension, Tee Bar & Universal Joint.

**Standard Socket sizes:**

4, 4.5, 5, 5.5, 6, 7, 8, 9, 10, 11, 12, 13, & 14 mm

**Hex Bits:** 3, 4, 5 & 6 mm

**Philips Bits:** #1, #2, & #3

**Pozidriv Bits:** #1, #2 & #3

**Slotted Bits:** 3, 4 & 6 mm

**Torx® Bits:** T8, T9, T10 T15, T20, T25, T27, T30, & T40

**\$89**

PN: GXSS1440



### 3/8" Socket Set

• Chrome Vanadium Steel

Set includes Ratchet Wrench, 75 & 150 mm Extension Bars and Universal Joint.

**Standard Socket sizes:**

8, 9, 10, 11, 12, 13, 14, 15, 16, 17, 18, 19, 20, 21 & 22 mm

**Deep Socket sizes:**

10, 11, 12, 13, 14, 15, 17 & 19 mm

**Spark Plug Socket:** 16 & 21 mm

**\$99**

PN: GXSS3329



## Magnetic Clean-Up Tools

### Magnetic Clean-Up Wand

Capacity: 6.30 Kg  
Length 400 mm  
Weight 0.470 Kg

**\$89**

PN: MW001



### Magnetic Reach Extender

Head size: 96 MM  
Length: 960 MM  
Capacity: 4.5 Kg

**\$115**

PN: MRE001



### Magnetic Broom

- Side mounted wheels for easy use over wide areas
- Telescopic main shaft
- Easy release trigger on main shaft
- Wide section magnetic pickup

Handle Length: 720-1035 mm  
Head width: 377mm

**\$155**

PN: MB001



## Gear & Bearing Splitting Combination Set

**\$249**

PN: GBTK

### Small Bearing Separator

Jaw Range: 30-50 MM  
Working Range: 0-135 MM

### Large Bearing Separator

Jaw Range: 50-75 MM  
Working Range: 0-180 MM

Includes Centre Adapter.

S45C Drop Forged hardened Main Beam and Bearing Separators.



## Multi-Hydraulic Gear Puller Kit

**\$599**

PN: GHPK

### Bearing Separator

S45C Drop Forged hardened Bearing Separator.

Working Range: 0-370 MM  
Jaw Range: 75-105 MM

### Gear Puller

Working Range: 25-185 MM

Set includes: Twin & Triple Leg Heads  
Hydraulic Ram (12 Ton capacity)  
Carbon Steel Beam  
200 MM, 150 MM, & 100 MM arms  
85 MM, 35 MM, Spacers,  
25 MM Centre Adapter



## HB-Series Storage Bins

### Geiger Small Short Bin

Size: 105W x 137D x 76H mm



**\$6 ea**

- PN: HB210B
- PN: HB210R

### Geiger Small Bin

Size: 105W x 187D x 76H mm



**\$7 ea**

- PN: HB220B
- PN: HB220R

### Geiger Medium Bin

Size: 140W x 276D x 127H mm



**\$13 ea**

- PN: HB230B
- PN: HB230R

### Geiger Large Short Bin

Size: 210W x 273D x 178H mm



**\$22 ea**

- PN: HB239B
- PN: HB239R

### Geiger Medium Duplex Bin

- Includes duplex divider

Size: 279W x 276D x 127H mm



**\$19 ea**

- PN: HB235B
- PN: HB235R

### Geiger Large Duplex Bin

- Includes duplex divider

Size: 420W x 375D x 178H mm



**\$32 ea**

- PN: HB250B
- PN: HB250R

## Wall Storage Kit

Includes 2 Panels, 40 x HB210 Bins, screws & wall plugs.

- PN: HP1KITB
- PN: HP1KITR

**\$249 ea**



## Mobile HB Storage Cart

Make your HB bins mobile with this hanging display unit with caster wheels (2 with brakes). This is an excellent time and space saver for any workshop.

HB Bins are easily detached from the storage cart, making it easy to take only what you need to the work area, while keeping items organized.

Includes Heavy Duty Galvanized Steel Cart with 72 x HB220 and 32 x HB230 bins, in combination of ● Blue or ● Red. Overall Size: 740W x 560D x 1460H mm

**CUSTOM LOAD-OUTS ALSO AVAILABLE!**

Additional freight charges may apply.

**\$1199**

PN: MS20020K



## Wall Mountable

All HB series bins can be wall mounted when combined with HP Hanging Panels (see HP1 & HP1KITB/R). HP Panels can be tiled together and mounted horizontally or vertically.

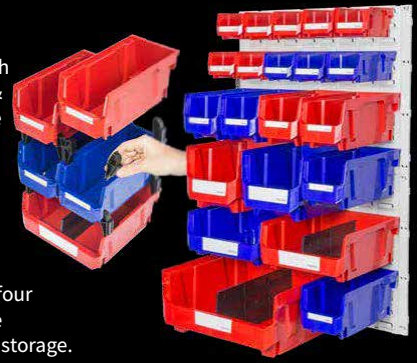

## Free Standing Bench Storage

Included with all HB bins are four interlocking legs which create free-standing versatile bench storage.

## Set of 2 HB-Series Hanging Panels

Includes 2 Panels, screws & wall plugs. Panel size: 605W x 455H x 8D mm



**\$85**

PN: HP1

## Heavy Duty A-Series Parts Cabinets

### ST2



Drawer Size: 120W x 210D x 55H mm

**60 Drawer Parts Cabinet**

**\$669**  
PN: ST2460

Size: 586W x 222D x 937H mm

### A5



Drawer Size: 163W x 289D x 69H mm

**36 Drawer Parts Cabinet**

**\$629**  
PN: A5336

Size: 586W x 290D x 937H mm

**24 Drawer Parts Cabinet**

**\$489**  
PN: A5324

586W x 290D x 640H mm

### A7



Drawer Size: 120W x 218D x 69H mm

**48 Drawer Parts Cabinet**

**\$499**  
PN: A7448

Size: 586W x 222D x 937H mm

**24 Drawer Parts Cabinet**

**\$339**  
PN: A7324

Size: 444W x 222D x 642H mm

### A8



Drawer Size: 90W x 218D x 70H mm

**60 Drawer Parts Cabinet**

**\$599**  
PN: A8560

Size: 586W x 222D x 937H mm

**32 Drawer Parts Cabinet**

**\$359**  
PN: A8432

Size: 466W x 222D x 642H mm

**15 Drawer Parts Cabinet**

**\$239**  
PN: A8315

Size: 355W x 222D x 415H mm

Size: 586W x 222D x 350H mm

## Workshop Stools

### Gas Lift Workshop Stool

- Heavy duty metal sub-frame with plastic cover
- Oil and stain resistant faux leather seat cushions with comfortable PU foam-padding
- Height adjustable gas lift seat
- Repositionable and removable tool trays
- Ball bearing casters (2 with brakes)



Seat Height: 400-540 mm  
Wheel Base: 500 mm  
Wheel size: 25 x 75 mm  
Load capacity: 136 Kg

**\$259**  
PN: GS001

### Heavy Duty Gas Lift Workshop Stool



- Durable and lightweight power-coated aluminium construction
- Oil and stain resistant faux leather seat cushions with comfortable PU foam-padding
- Height adjustable gas lift seat
- Ball bearing casters (2 with brakes)
- Wide and stable wheel base, ideal for uneven ground

Seat Height: 530-660 mm  
Wheel Base: 600 mm  
Wheel Size: 25 x 100 mm  
Load capacity: 180 Kg

**\$499**  
PN: GS002

### Heavy Duty Workshop Stool

- Durable and lightweight power-coated aluminium construction
- Oil and stain resistant faux leather seat cushions with comfortable PU foam-padding
- Ball bearing swivel mounted seat cushion
- 180 Kg load capacity

Size: 600 mm x 600 mm x 710 mm  
Load capacity: 180 Kg



**\$379**  
PN: GS004

### Heavy Duty Gas Lift Workshop Stool with Backrest



- Durable and lightweight power-coated aluminium construction
- Oil and stain resistant faux leather seat cushions with comfortable PU foam-padding
- Wide and stable wheel base, ideal for uneven ground
- Height adjustable gas lift seat
- Ball bearing casters (2 with brakes)

Seat Height: 660 - 760 mm  
Overall Height: 930-1030 mm  
Wheel Base: 600 mm  
Wheel Size 25 x 100 mm  
Load capacity: 180 Kg

**\$549**  
PN: GS003

## Workshop Trolleys

### Compact Heavy Duty Parts Trolley

- 1.6 mm steel uprights.
- 3 Shelves



Size: 410W x 760D x 885H mm (including handle)

**\$299**  
PN: GT3S

### Heavy Duty Parts Trolley

- 3 Shelves, side container and drawer
- 1.6 mm steel uprights.



Size: 470W x 785D x 825H mm (including handle)

**\$359**  
PN: GT3SD

### Heavy Duty Parts Trolley

- Takes up to 100 kg per shelf, max total weight 200 kg per unit.
- 3 Shelves, side container and drawer
- Enclosed front & rear for extra rigidity.



Size: 500W x 873D x 880H mm (including handle)

**\$599**  
PN: CTH5086

## Workshop Stools & Creepers

### Rolling Workshop Parts Tray

- 15 socket holders from 19 to 32 mm Dia.
- Four tray compartments (2 magnetised)
- Nine screwdriver pockets
- Ball Bearing Casters
- Carry handle



Size: 735 mm x 460 mm x 130 mm  
Load capacity: 60 Kg  
Wheel Size: 25 x 50 mm

**\$119**  
PN: GS005

### Mechanics Creeper

- Thick wall injection blow moulded deck
  - Integrated side trays
  - Made in Taiwan
- Size: 1005 x 470 x 135 mm  
Wheel Size: 75 x 25 mm



**STEEL REINFORCED  
CASTER MOUNTS**

**MAX RATING  
150KG**

**\$189**  
PN: GCR40

## Heavy Duty Lockable A7 Parts Cabinets

Each drawer comes with 2 movable dividers.  
The front face of each drawer features a window.

### Lockable 48 Drawer Parts Cabinet

Size: 586W x 270D x 970H mm

**\$799**

PN: A7448D

### Lockable 24 Drawer Parts Cabinet

Size: 444W x 270D x 677H mm

**\$689**

PN: A7324D



**LOCKABLE DOORS**

## Steel HD Series Parts Cabinets

HD cabinets take up to 100 kg per shelf. Each drawer comes with 2 movable dividers and is acid and oil resistant. The front face of each drawer features a window which makes it easy to identify the contents.

### 15 Drawer Steel Parts Cabinet

Size: 880W x 400D x 440H mm

Drawer size: 160W x 110H x 410D mm

**\$579**

PN: HD515



### 18 Drawer Steel Parts Cabinet

Size: 550W x 400D x 880H mm

External Size: 160W x 110H x 410D mm

### 30 Drawer Steel Parts Cabinet

880W x 400D mm x 880H mm

External size: 160W x 110H x 410D mm

## HD-Series Storage Bins

The 60 drawer NHD560 takes up to 600 kg total weight and up to 100 kg per shelf. Each drawer comes with 2 movable dividers and is acid and oil resistant. The window front makes it easy to identify the contents.  
Size: 880W x 400D x 1725H mm



The HD drawers are designed to be fully opened and not fall out, even at the 10 kg maximum weight limit and feature transparent windows for easy parts identification.

Each drawer comes with 2 movable dividers and can take up to 7 Dividers. All is acid and oil resistant.

### HD Drawer

External Size: 160W x 410D x 110H mm

Internal size: 140W x 370D x 100H mm



**\$20**

PN: HD1641

### HD Drawer Dividers

Packet of 10



**\$20**

PN: HD1641DIV

### 60 Drawer HD Series Steel Parts Cabinet

The 60 drawer NHD560 takes up to 600 kg total weight and up to 100 kg per shelf. Each drawer comes with 2 movable dividers and is acid and oil resistant. The window front makes it easy to identify the contents.

880W x 400D x 1725H mm



Additional freight charges may apply.

**\$1799**

PN: NHD560

## Multi-Function Bins & Crates

### Jumbo Storage Bin

Includes removable two stage folding lid. Made from impact resistant polypropylene.

Size: 395W x 635D x 335H mm

**TAKES UP TO 30KG!**



**50 LITRE CAPACITY!**

**\$75**

PN: HB4068B

### Foldable Crates

Stackable in both collapsed and extended configuration

Size: 535W x 360D x 280H mm

Collapsed Height: 50 mm

**SPACE SAVING COLLAPSIBLE DESIGN**



**\$49**

PN: FB5336B

### 30 Drawer Parts Cabinet

980W x 400D x 1010H mm

(Including handle and caster wheels)



**\$1159**

PN: NHD530

## Wall mountable Pivot Drawers

Pivot drawers slot together vertically or horizontally, to be safely mounted to walls or benches. Windowed drawers keep all your spare parts in plain sight with reduced exposure to dust, moisture or other contaminants.

### 8 Compartment Pivot Drawer Set

Size: 300W x 200H x 67D mm



**\$39**  
PN: FO308

### 6 Compartment Pivot Drawer Set

Size: 300W x 250H x 106D mm



**\$39**  
PN: FO306

### 5 Compartment Pivot Drawer Set

Size: 600W x 150H x 123D mm



**\$52**  
PN: FO605

### 4 Compartment Pivot Drawer Set

Size: 600W x 200H x 167D mm



**\$69**  
PN: FO604

### Single Sided 46 Bin Pivot Drawer Cart

Includes  
2 x FO308, 2 x FO306,  
2 x FO605 & 2 x FO604,  
46 bins in all

**\$899**

PN: MSFO4568

### Double Sided 92 Bin Pivot Drawer Cart

Includes 4 x FO308,  
4 x FO306, 4 x FO605 &  
4 x FO604, 92 bins in all

**\$1399**

PN: MSFO4568X2

Cart Size: 690W x 560D x 1460H mm

**UP TO  
92 BINS OF  
STORAGE!**



Additional freight charges may apply.

## part of **starmix** **haaga** Commercial Sweepers

### Haaga 375 COMMERCIAL SWEEPER

Performance: 2,900 m<sup>2</sup>/h  
Cleaning Width: 750 mm  
Capacity: 50 Liters  
Weight: 11.1 kg

**While  
Stocks  
Last!**

**\$1175**  
PN: HG375



**3 BRUSH  
SYSTEM**

### Haaga 497 COMMERCIAL SWEEPER

- Brush height adjustment to suit various flooring types and surfaces
- Vertical storage to save space
- Integrated filtration system with fine dirt roller brush to minimise dust
- Wall & Curb Roller to minimise cuffing
- Fine Dirt Roller

Performance: 3,600 m<sup>2</sup>/hr  
Cleaning Width: 970 mm  
Capacity 50 litres.  
Weight: 15.7 kg

**\$1919**  
PN: HG497



**3 BRUSH  
SYSTEM**

### Haaga 477 COMMERCIAL SWEEPER

- Brush height adjustment to suit various flooring types and surfaces
- Wall & curb roller to minimise cuffing
- Integrated filtration system with fine dirt roller brush to minimise dust
- Stores vertically in most closets (1550H x 780W x 300 mm)

Performance: 3,000 m<sup>2</sup>/h  
Cleaning Width: 770 mm  
Capacity: 50 Liters  
Weight: 15 kg

**\$1559**  
PN: HG477



**3 BRUSH  
SYSTEM**

### Haaga 677 COMMERCIAL SWEEPER

Performance: 3,600 m<sup>2</sup>/hr  
Sweeping Width: 770 mm  
Capacity 50 litres.  
Run Time: 90 mins  
Charge Time: 7 hrs  
Weight: 20.2 kg

Brush height adjustment to suit various flooring types and surfaces

Wall & Curb Roller to minimise cuffing



**ELECTRIC DRIVE  
3 BRUSH  
SYSTEM**

**New!**

Integrated filtration system with fine dirt roller brush

Twin electrically driven brush heads

Stores vertically in most closets (1550H x 780W x 300 mm)

**\$2399**  
PN: HG677

1 Year Commercial Warranty

2 Year Domestic Warranty

MADE IN GERMANY.

## Air-Hydraulic Riveters

### 3/16" Industrial Rivet Gun



Rivet Capacity:  
1/8, 5/32 & 3/16"  
Traction Power:  
1980 lbs  
Weight: 1.45 Kg

**\$399**  
PN: GP6302

### 9/32" Industrial Rivet Gun



**SUITABLE  
FOR STAINLESS  
RIVETS!**

- Interchangeable nose-pieces
- Safety cap collects spent rivets
- Swivel inlet for easier positioning

Rivet Capacity:  
3/16", 1/4", 5/32" & 9/32"  
Traction Power: 3,120 lbs  
Weight: 3.4 Kg

**\$799**  
PN: GP6304

## Engine Cleaner Gun

- Siphon type, designed to connect to an external degreaser supply
- Flow rate control with adjustable nozzle
- 1.2m hose with built in filter

Length: 405 mm



**\$59**  
PN: GPA1565

## Impact Wrenches

### 1/2" Impact Wrench

Max Torque: 500 Ft/lbs  
Weight: 2.0 Kg



**\$299**  
PN: GP260T

### 3/4" Impact Wrench

Max Torque: 1100 Ft/lbs  
Weight: 3.48 Kg



**\$699**  
PN: GP3125

## Engine Cleaner with Bowl

- Ideal for cleaning cars, trucks, bikes and marine

Bowl capacity: 700 cc  
Length: 410 mm



**\$119**  
PN: GPA034

## Reversible Drills

### Reversible 3/8" Drill

Free Speed: 1,800 RPM  
Chuck Size: 10 mm  
Weight: 1.36 Kg



**\$189** Keyless Model  
PN: GP41013K \$210  
PN: GP41013

### 1/2" Reversible Drill

Free Speed: 800 RPM  
Drilling Capacity: 13 mm  
Weight: 1.76kg



**\$269** Keyless Model  
PN: GP4204K \$349  
PN: GP4204

### 3/8" Reversible Angle Drill

- Forward / Reverse Toggle Switch
- Rear exhaust



**\$299**  
PN: GP4209

## Die Grinders

### 1/4" Medium Die Grinder

Free Speed: 22,000 RPM  
Weight: 0.675 Kg



**\$99**  
PN: GP2202

### 1/4" Medium Die Grinder

- Polymer sleeved for comfort

**FREE!**  
Radiused Cylinder Burr  
Valued over \$40



Free Speed: 21,000 RPM  
Weight: 0.833 Kg

**\$129**  
GP2202RK

### 1/4" Angle Die Grinder

Free Speed: 18,000 RPM  
Weight: 0.833 Kg



**\$199**  
PN: GP2203R

## Tyre Inflators

### 0-60psi Tyre Pressure Gauge

Range: 0-60 psi.  
Metering: Analogue  
Units: PSI & Bar  
Output: Schrader valve



**\$42**  
PN: GPATPG60

### Deluxe Tyre Inflator

Range: 0-160 PSI  
Units: PSI, KPA



**\$149**  
PN: GPA6200

### Digital Tyre Inflator

Range: 5-60 PSI  
Hose Length: 30 cm  
Units: PSI, Bar, kPa

**\$159**  
PN: GP1558-4



## Surface Preparation

### 10 MM Belt Sander

Belt Size: 10 x 330 MM

**\$289**

PN: GP1264A



### 20 MM Belt Sander

Belt Size: 20 x 520 MM

**\$459**

PN: GP1265A

## 7" Sander



**\$369**

PN: GP1206A

Free Speed: 4,500 RPM Avg Air Cons.: 12 CFM  
Spindle: Male 5/8-11UNC Weight: 2.6 kg

## 7" Polisher



**\$369**

PN: GP1206P

Free Speed: 2,500 RPM Avg Air Cons.: 12 CFM  
Spindle: Male 5/8-11UNC Weight: 2.6 kg

## Needle Scaler

- Two part construction for fast dismantling and replacement of worn needles
- Nineteen 3 x 180 MM needles

Stroke Length : 33 mm  
Impact Rate: 4,600 BPM  
Length: 420 mm  
Weight: 2.8 kg



**\$399**

PN: GP201

## Air Rust & Paint Removal Tool Kit (Non-vacuum)

Versatile support handle can be set to any position within it's 180° range.

Kit includes:  
five 105 mm (4 inch) stripping wheels, Spare disc hub & carry case.



**\$735**

PN: GP2001A

### Stripping Wheels

- 1 0.5 mm Straight Wire PN: GPA2001A-1
- 2 0.55 mm Hooked Wire PN: GPA2001A-2
- 3 Abrasive Striping PN: GPA2001A-5
- 4 Caramel Stripping PN: GPA2001A-4
- 5 0.7mm Hooked Wire PN: GPA2001A-3

**\$49 ea**

## Sandblasters

### Sand Blasting Kit

Includes 3 extra nozzles, hose and tube.  
Siphon feed  
Weight: 0.9 kg



**\$69**

PN: GP909

### All-In-One Sandblaster

- Light weight all in one design
- Ideal for spot and rust removal on small areas

Nozzle Size: 5.2 MM  
Capacity: 266cc



**\$79**

PN: GPASB100

## 3" In-Line Cut Off Grinder

- Includes 3" cut off disc.
- Adjustable guard
- Spindle lock
- Rubber grip
- Rear exhaust



**\$239**

PN: GP3203

Disc Size: 3" (75 mm)  
Free Speed: 18,000 RPM  
Weight: 0.8 kg

### 75 MM Cut Off Discs

Disc Size: 75 x 0.8 mm  
Bore: 9.53 mm  
Max Speed: 25,000 RPM



Packs of 5

**\$25**

PN: CO007K

## Air Body Saw

Free Speed: 10,000 opm  
Capacity: 3 mm mild steel  
Stroke length 9.5 mm



**\$269**

PN: GP9301

### Quality Bi-metal Blades



18 TPI PN: PT301A18

24 TPI PN: PT301A24

32 TPI PN: PT301A32

Packs of 5

**\$30 ea**

## Economical Gravity Feed Spray Guns

- Stainless steel nozzle & needle
- Brass cap
- Great atomisation
- High transfer rate

Working Pressure: 15-43 PSI  
Pattern Width: 270 mm  
Fluid Output: 200-220 mL/min  
Capacity: 600 cc  
Weight: 600 g



**\$89 ea**

1.4 mm PN: SG898-14

1.8 mm PN: SG898-18



- Individual nozzle kits also available

## Heavy Duty Angle Grinders



### 4" Heavy Duty Angle Grinder

Spindle: M10 x 1.5  
Free Speed: 11,000 RPM  
Weight: 1.95 kg

**\$359**

PN: GP8102

### 5" Heavy Duty Angle Grinder

Spindle: M14 x 2.0  
Free Speed: 11,000 RPM  
Weight: 1.95 kg

**\$399**

PN: GP31003

## Blowguns

### 4" Rubber Tipped Blowgun

**\$20**  
PN: GP1562



- Integrated metal inlet thread
- Rubber Tip

Length: 110 mm  
Material: POM/Steel

### Extendable Blow Gun

Length: 270 to 390 mm  
Material: POM/Steel

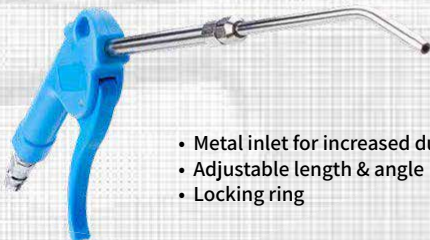

- Metal inlet for increased durability
- Adjustable length & angle
- Locking ring

**\$36**  
PN: GP1562E

### Integrated Blow Gun

- Light weight Polymer body with 1/4" steel inlet & 2 metre fitted hose



**\$69**  
PN: GPB90K

### 3/8" High Flow Blow Gun Kit

Kit includes:  
High Flow Duster,  
Easily Adjustable High Flow Nozzle, Heavy Duty High Flow Nozzle & Standard Nozzle.



**\$69**

PN: GHF60AS

### Long Nose Air Duster

- Cast aluminium body, metal trigger & nozzle.
- Inlet: 1/4" Nitto fitting  
Nozzle size: 4.5 x 70 mm



**\$29**

PN: GPA9025

**ALL METAL BODY!**

### 1 Metre Blow Gun

Overall Length: 1050 mm  
Inlet: 1/4" metal  
Material: POM / Aluminum

- Durable all metal construction
- Foam grip



**ALL METAL BODY!**

**\$79**

PN: GP1561

### Filter Cleaning Nozzle

Suitable for cleaning cylindrical filters or pipes.  
SOLD SEPARATELY  
Size: 15.5 dia. x 40 mm  
Nozzles: 12 x 2mm



**\$29**

PN: GP1561FN

### Wonder Gun Kit

- Quickly change between vacuum & blow with an integrated switch
- Heavy duty metal body

Kit includes: Blow Gun, Vacuum Hose, brush, extended small & flat nozzles, Extendable Hose (30 to 80cm) & Dust Bag



**\$129**

PN: GPA0310KB

## Economical Random Orbit Sanders

### 6" / 150 MM Random Orbit Sander

Free Speed:  
12,000 RPM  
Orbit Dia.: 5 mm  
Weight: 830 g

**\$110**

PN: GP6151-6

### 6" / 150 MM Random Orbit Dust Free Sander

Free Speed:  
12,000 RPM  
Orbit Dia.: 5 mm  
Weight: 930 g

**\$129**

PN: GP6151-6-S



## Economical 6" Backing Pads

Spindle Size: 5/16" x 24 UNF Ext.  
Max Speed: 12,000 RPM  
Pad Thickness: 10 mm

**\$20 ea**

Standard PN: E6505

Dust Free PN: E6565



## Percussive Engraving Tool

- Medium point stylus included
- Fine & wide point stylus also available

Inlet: 1/4" Male thread  
Hose Length: 1.43 m  
Weight: 0.40 kg



**\$329**

PN: GP110

## 1/8" Micro Die Grinder Kit

- Includes 10 grinding stones



Free Speed : 55,000 RPM  
Collet Size: 1/8"  
Hose length: 1.5m

**\$249**

PN: GP2204K

**Fritzfurt**

## Rotary Tool Kit

- Comprehensive 276 Piece Kit
- Shank Size: 1/8"



**See front cover!**

**\$59**

PN: RTK276

# Hammering Tools

## Air Hammer Kit

Kit includes 5 Chisels, Spring Retainer, Oiler & Case.  
Free Speed: 3,000 BPM  
Stroke Length: 19.05 mm  
Shank Size: 10.2 mm  
Weight: 1.70 Kg



**\$139**  
PN: GP102KD

## Set of 2 Spring Retainers

- Suits 10.2 mm round chisels



**\$19**  
PN: GPA70X2

## Heavy Duty Quick Change Spring Retainer

- Fits most standard air hammers & chisels



**\$39**  
PN: GPA2311

## 38 MM Flattening Hammer

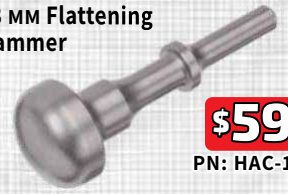

**\$59**  
PN: HAC-100

**OTHER TYPES ALSO AVAILABLE!**

## Needle Scaler Attachment

- Mounts to most standard air hammers
- Replacement needles available



Needle Array: 19 Needles  
Needle size: 3 x 180 mm

**\$110**  
PN: GP60012

## 7" Chisel Set

- 5 piece set includes 20 mm Cold Chisel, Single Blade Cutter, Tapered Punch, Panel Cutter & Rivet Cutter



Shank Dia.: 10.2 mm

**\$59**  
PN: GPA57

# KUANI PNEUMATIC TOOLS

Gear up your world™

## Compact Needle Scaler

**\$299**  
PN: KP4714



Impact Rate: 3,700 BPM  
Overall Length: 290 mm  
12 Needles Ø3 x 125 mm

## Pistol Grip Needle Scaler



**\$449**  
PN: KP4722P

Impact Rate: 3,700 BPM  
Overall Length: 350 mm  
19 Needles Ø3 x 180 mm

## Heavy Duty Air Scaling Hammer

Impact Rate: 2,400 BPM  
Stroke: 26 mm  
Length: 550 mm  
Weight: 4.45 Kg



- Replaceable carbide tips

**\$979**  
PN: KP4733

## Heavy Duty Chipping Hammer

- Moil Point & Flat Chisels available
- Side Exhaust

**Includes 2 Chisels**



Stroke: 102 mm  
Impact Rate: 1500 BPM  
Length: 350 mm  
Weight: 9 Kg

**\$979**  
PN: KP4735S3H

## Manual Grease Gun

- Re-grease any air tool transmission case fitted with a micro grease nipple.
- Easy to use, spring loaded trigger



Capacity: 80 cc  
Working Pressure: 1000 PSI  
Net Weight: 0.28 Kg

**\$42**  
PN: KPAC050

## Pittsburgh Air Hammer

- 360° Adjustable Anvil Guide

Impact Rate: 4,200 RPM  
Stroke: 50 mm  
Weight: 2.20 Kg



**\$299**  
PN: KP4711PH

## 4" Heavy Duty Extended Cut Off Tool

- 90° adjustable swivel guard with detented quick release & spindle lock
- Extended reach & ultra compact 39 mm head

Free Speed: 14,000 RPM  
Length: 345 mm  
Output: 745 Watt  
Weight: 1.40 Kg



**HOT PRICE!** **\$399**  
PN: KP4413

## 1" Super Duty Impact Wrench



Free Speed: 5,000 RPM  
Max. Torque: 1,800 Ft/lbs  
Weight: 7.10 Kg

**\$1439**  
PN: KP1838A-P

## 1" Super Duty Impact Wrenches

Free Speed: 5,500 RPM  
Max. Torque: 1,600 Ft/lbs  
Air Inlet: 1/2"

Length: 325 mm  
Weight: 5.8 Kg



**\$1339**  
PN: KP1835

## 1" HD Impact Wrench

- 4 power settings with forward & reverse selector
- Rubber body protection
- Side handle

Free Speed: 3,500 RPM  
Max. Torque: 2,500 Ft/lbs  
Length: 436 mm  
Air Inlet: 1/2"  
Weight: 15.55 Kg



**1.5" Variant**  
PN: KP1050 \$2999

**\$2679**  
PN: KP1045

**2,500 Ft/lbs**

## 1/2" Twin Hammer Impact Wrench



- Light weight composite housing
- 4 speed air regulator
- Exhausts through handle, away from the work area

Free Speed: 8,000 RPM  
Max Torque: 685 Ft/lbs (928 Nm)  
Weight: 1.98kg

**\$369**

PN: BIT260M1

## 1/4" Die Grinder

Free Speed: 20,000 RPM  
Length: 165 mm  
Weight : 0.55Kg



**\$189**

PN: BG210R

## 1/4" 115° Angle Die Grinder

Free Speed: 18,000 RPM  
Output: 0.45 hp  
Weight : 0.75 Kg



**\$229**

PN: BG230RA1

## 1/4" Right Angle Die Grinder

- Light weight composite housing

Free Speed: 18,000 RPM  
Length: 183 mm  
Weight: 0.8 Kg



**\$199**

PN: BG220RA1

## Extended 1/4" Die Grinder

Free Speed: 21,000 RPM  
Length: 280 mm  
Weight: 0.80 Kg



**\$199**

PN: BG215RA1

## 2" Angle Grinder

Free Speed: 15,000 RPM  
Output : 0.45 hp  
Weight: 0.8 Kg



**\$199**

PN: BG222RA1

2" Grinder Disc  
Thickness: 4 mm  
Max Speed: 23,500 RPM



**\$13**

PN: 3510232

## 6" Random Orbital Sander

Orbit Diameter: 5 mm  
Spindle: 5/16"x24 UNF  
Free Speed: 12,000 RPM  
Weight: 0.99 Kg



**\$289**

PN: BOS156A2

## 6" Random Orbital Dust-Free Sander

Orbit Diameter: 5 mm  
Free Speed: 12,000 RPM  
Spindle: 5/16 x 24 UNF  
Weight: 0.99 kg



**\$299**

PN: BOS156SA2

## 8" Geared Sanders

Orbit Diameter: 5 mm  
Pad mount: 5 hole  
Free Speed: 900 RPM  
Weight: 1.88 kg



Standard

**\$579**

PN: BOS258GR-D1

Dust Free

**\$589**

PN: BOS258GRC-D1

## 1/2" Reversible Keyless Drill

Free speed: 800 RPM  
Weight: 1.95 Kg



**HOT PRICE!**

**\$279**

PN: BDR208KLA1

## Heavy Duty Air Hammer Kit

- Integrated piston cushion for lower vibration and less operator fatigue
- T handle design for better tool balance

- Includes Air Hammer, 5 chisels & Quick Change Spring Retainer in blow-mount case

Impact Rate: 2,900 bpm  
Chisel shank: 10.2 mm  
Weight: 1.73 Kg

**\$289**

PN: BHA67A1



## 3" Cut Off Tool

Free Speed: 21,000 RPM  
Length: 188 mm  
Weight: 0.8 Kg



Cutting Disc not included.

**\$149**

PN: BCTA1

## 3" Cutting Discs

Ø75 x 0.8 x Ø9.53 mm  
Speed Rated to 25,000 RPM



Pack of 5

**\$25**

PN: CO007K

## 80 Series Stapler

**\$199**

PN: BN8016E



Staple Crown: 12.8 mm (80 Series)  
Staple Length: 6-16 mm  
Capacity: 100 Staples  
Weight: 0.90 Kg

## Heavy Duty Coil Nailer

**HOT PRICE!**

**Only While Stocks Last!**



Shank: 2.03-2.8 mm  
Nail Length: 32-65 mm  
Capacity: 200-400 nails  
Weight: 2.3 Kg

0° Angle PN: BC2865F1

15° Angle PN: BC2865D1

**\$369 ea**

## Heavy Duty C Brad Nailer



Shank: 1.4x1.6 mm (16 Gauge)  
Nail Length: 19-50 mm  
Capacity: 100 nails  
Weight: 1.9 Kg

**\$399**

PN: B1650B1

## 6000/L Series Stapler



Staple Crown: 5.8 mm (6000 Series)  
Staple Length: 13-40 mm  
Capacity: 100 Staples  
Weight: 1.18 Kg

**\$299**

PN: BS9040LA1

## Countersink & Nail Remover

**GREAT FOR  
TIMBER FRAME  
DEMOLITION!**



Pin Dia.: 4.8 mm  
Nail Dia.: 2-4 mm  
Weight: 0.80 Kg

**\$349**

PN: BPULLER

**REMOVE  
ASBESTOS  
SHEETS IN  
ONE PIECE!**

## 50 MM C1 Series Bradder



Shank: 1x1.25 mm (18 Gauge)  
Nail Length: 15-50 mm  
Capacity: 100 brads  
Weight: 1.25 Kg

**\$259**

PN: B1850A1



### 3/16" Medium Duty Riveter

- Suitable for Aluminium & Mild Steel rivets

Capacity:  
2.4 mm (3/32") to  
4.8 mm (3/16")  
Traction power: 1045 Kg  
Stroke: 16 mm  
Weight: 1.56 Kg



Includes an Assortment of Aluminium Rivets & Spares

**\$269**

PN: FP4821AK

### 3/16" Compact Riveter with Vacuum Extraction

- Suitable for Aluminium & Mild Steel rivets
- Vacuum Mandrel collection

- Low Recoil Technology

Capacity: 2.4 mm (3/32") to 4.8 mm (3/16")  
Traction power: 908 Kg  
Stroke: 15 mm  
Weight: 1.39 Kg



Ideal for the Aluminium Window Industry

**\$859**

PN: FP4032CVK

### 3/16" Heavy Duty Composite Riveter

- Suitable rivets of all materials
- Low Recoil Technology

Capacity: 2.4 mm (3/32") to 4.8 mm (3/16")  
Traction power: 908 Kg  
Stroke: 23.5 mm  
Weight: 1.55 Kg

**\$699**

PN: FP4831C

### 1/4" Riveter with Vacuum Extraction

- Automatic mandrel collection
- Sets steel and stainless ONLY
- Swivel air inlet

Capacity: 4.8mm (3/16"), 5.6mm (7/32") & 6.4mm (1/4")  
Traction power: 1645 Kg  
Stroke: 15 mm  
Weight: 1.8 Kg

**\$739**

PN: FP6431CVK

### 5/16" Heavy Duty Composite Riveter

- Vacuum mandrel collection
- Suitable rivets of all materials
- Swivel air inlet

Capacity: 3/16", 7/32", 1/4" & 5/16"  
Traction power: 1723 Kg  
Stroke: 22.5 mm  
Weight: 1.8 Kg



Also Sets 1/4" Monobolt® Structural Rivets FP51631CVK ONLY

**\$1279**

PN: FP51631CVK

## Premium Compressor Oil

- Specially formulated additives give superior protection against wear and corrosion
- Excellent water & air separation, to ensure reliable operation with minimal foaming and emulsification



**\$33**

PN: COMPOIL1

## 1/4" Mini Filter Regulator

Max Press.: 280 PSI  
Output Press.: 7-142 PSI  
Units: PSI, kg/cm<sup>2</sup>  
Max Flow: 38.85 CFM  
Drain Capacity: 15 mL  
Filter Element: 5 μm



**\$89**

PN: THBFR212

## 1/4" Mini Filter Regulator & Lubricator

Max Press.: 150 PSI  
Output Press.: 7-142 PSI  
Units: PSI, kg/cm<sup>2</sup>  
Max Flow: 38.85 CFM  
Drain Capacity: 15 mL  
Oil Capacity: 30 mL  
Filter Element: 5 μm



**SUPER COMPACT!**  
140W x 135H mm

**\$89**

PN: THBC202

## Filter Regulators

Max Press.: 215 PSI  
Output Press.: 7-150 PSI  
Units: PSI, kg/cm<sup>2</sup>  
Drain Capacity: 80 mL  
Filter Element: 5 μm

Port Size: 1/4" NPT  
Max Flow: 61.8 CFM

PN: THBFR802

Port Size: 3/8" NPT  
Max Flow: 88.29 CFM

PN: THBFR803

Port Size: 1/2" NPT  
Max Flow: 105.94 CFM

PN: THBFR804



**\$75 ea**

## 3/4" Hi-Flow Filter Regulator

Max Press.: 250 PSI  
Output Press.: 7-142 PSI  
Units: PSI, kg/cm<sup>2</sup>  
Max Flow: 162.45 CFM  
Drain Capacity: 300 mL

PN: THBFR926A

## 1" Hi-Flow Filter Regulator

Max Press.: 250 PSI  
Output Press.: 7-142 PSI  
Units: PSI, kg/cm<sup>2</sup>  
Max Flow: 183.64 CFM  
Drain Capacity: 300 mL

PN: THBFR928A

**\$299 ea**



**AUTO-DRAIN FUNCTION**

## Filter Regulator + Lubricators

Max Press.: 215 PSI  
Output Press.: 7-150 PSI  
Units: PSI, kg/cm<sup>2</sup>  
Oil Capacity: 125 mL  
Filter Element: 5 μm

Port Size: 1/4" NPT  
Max Flow: 61.8 CFM

PN: THBFLR802

Port Size: 3/8" NPT  
Max Flow: 88.29 CFM

PN: THBFLR803

Port Size: 1/2" NPT  
Max Flow: 105.94 CFM

PN: THBFLR804



**\$139 ea**

## Regulators



### 1/4" Regulator

Max Press.: 150 PSI  
Output Press.: 7-142 PSI  
Units: PSI, kg/cm<sup>2</sup>  
Max Flow: 38.85 CFM

**\$52**

PN: THBR202

### 1/2" Regulator

Max Press.: 215 PSI  
Output Press.: 7-150 PSI  
Units: PSI, kg/cm<sup>2</sup>  
Max Flow: 105.94 CFM

**\$62**

PN: THBR804

### 3/4" Regulator

Max Press.: 250 PSI  
Output Press.: 7-225 PSI  
Units: PSI, kg/cm<sup>2</sup>  
Max Flow: 162.45 CFM

**\$179**

PN: THBR906

### 1" Regulator

Max Press.: 250 PSI  
Output Press.: 7-225 PSI  
Units: PSI, kg/cm<sup>2</sup>  
Max Flow: 183.64 CFM

**\$179**

PN: THBR908

## Filters

### 1/2" Filter

Port Size: 1/2" NPT  
Max Press.: 215 PSI  
Max Flow: 105.94 CFM



**\$69**

PN: THBF804

### 1/2" Auto Drain Filter

Port Size: 1/2" NPT  
Max Press.: 225 PSI



**\$99**

PN: THBD704A

## Lubricators

Max Press.: 215 PSI  
Oil Capacity: 125 mL

Port Size: 1/4" NPT  
Max Flow: 61.8 CFM

PN: THBL802

Port Size: 3/8" NPT  
Max Flow: 88.29 CFM

PN: THBL803

Port Size: 1/2" NPT  
Max Flow: 105.94 CFM

PN: THBL804

**\$79 ea**



## Filter / Regulator / Dryers

- Includes desiccant

Max Press.: 250 PSI  
Output Press.: 7-150 PSI  
Units: PSI, kg/cm<sup>2</sup>  
Filter Element: 5μ-0.01μ

Port Size: 1/4" NPT  
Max Flow: 61.8 CFM

PN: THBFR-FLM862

Port Size: 3/8" NPT  
Max Flow: 88.29 CFM

PN: THBFR-FLM863

Port Size: 1/2" NPT  
Max Flow: 105.94 CFM

PN: THBFR-FLM864

**\$269 ea**

**IDEAL FOR SPRAY PAINTING!**



Replacement dryer desiccant pack of 2 PN: THBDES \$20

## SG420 Gravity Feed Air Brush



**\$149**  
PN: SG420A

Nozzle: 0.2 MM  
Working Pressure: 14-50 PSI  
Fluid Capacity: 7 cc  
Weight: 280 g

## KH818 Gravity Feed Spray Guns



**\$285 ea**

- Forged aluminum body and Stainless steel nozzle & needle
- Teflon seals & packing

Working Pressure: 30-45 PSI  
Fluid Capacity: 600 cc  
Weight: 280 g

1.3 MM Nozzle PN: K818M13  
1.4 MM Nozzle PN: K818M14  
1.8 MM Nozzle PN: K818M18  
2.5 MM Nozzle PN: K818M25

## KH818 HVLP Gravity Feed Spray Guns



**\$299 ea**

- Forged aluminum body and Stainless steel nozzle & needle
- HVLP nozzle delivers exceptional fluid atomization.
- Teflon seals & packing.
- Includes mini air regulator

Working Pressure: 20-28 PSI  
Fluid Capacity: 600 cc  
Weight: 514 g

1.3 MM Nozzle PN: KH818M13  
1.4 MM Nozzle PN: KH818M14  
1.8 MM Nozzle PN: KH818M18

## K818 Suction Feed Spray Guns



**\$289 ea**

- Forged aluminum body and Stainless steel nozzle & needle
- Teflon seals & packing

Working Pressure: 30-45 PSI  
Fluid Capacity: 1000 cc  
Weight: 514 g

1.3 MM Nozzle PN: K818S13  
1.8 MM Nozzle PN: K818S18  
2.0 MM Nozzle PN: K818S20  
2.5 MM Nozzle PN: K818S25

## KH818 HVLP Suction Feed Spray Guns



**\$325**  
PN: KH818S18

- Forged aluminum body & Stainless steel nozzle & needle
- HVLP nozzle delivers exceptional fluid atomization.
- Teflon seals & packing.
- Includes mini air regulator

Working Pressure: 20-28 PSI  
Fluid Capacity: 1000 cc  
Weight: 514 g  
Nozzle: 1.8 MM S-Steel

## K357 Mini Gravity Feed Spray Guns



Working Pressure: 30-45 PSI  
Fluid Capacity: 125 cc  
Weight: 280 g

0.8 MM Nozzle

1.2 MM Nozzle

**\$215**  
PN: K357M08

**\$245**  
PN: K357M12

## K818 Pressure Feed Spray Gun Systems



### 2 Litre Pressure Feed Spray Gun Systems

- Features:
- 3 meter hose
  - Tank Pressure Regulator
  - Air release valve
  - Safety release valve
  - Tank handle/hanger

**2 Litre Pressure Feed Tank**  
Tank dimensions:  
130L MM x 130W MM x 445H MM  
Capacity: 2 Litre  
Max. pressure: 60 PSI  
Weight total: 2.15 Kg

1.2 MM Nozzle PN: PW2LTRK12  
1.5 MM Nozzle PN: PW2LTRK15  
1.8 MM Nozzle PN: PW2LTRK18  
2.0 MM Nozzle PN: PW2LTRK20  
2.5 MM Nozzle PN: PW2LTRK25

**\$529 ea**

### 10 Litre Pressure Feed Spray Gun Systems

- Features:
- 3 meter hose
  - Tank Pressure Regulator
  - Air release valve
  - Safety release valve
  - Tank handle/hanger

**10 Litre Pressure Feed Tank**  
Tank dimensions:  
315L MM x 315W MM x 485H MM  
Capacity: 10 Litre  
Max. pressure: 60 PSI  
Weight total: 10.1 Kg

1.2 MM Nozzle PN: PW10LTRK12  
1.5 MM Nozzle PN: PW10LTRK15  
1.8 MM Nozzle PN: PW10LTRK18  
2.0 MM Nozzle PN: PW10LTRK20  
2.5 MM Nozzle PN: PW10LTRK25

**\$685 ea**

### 20 Litre Pressure Feed Spray Tank Systems

- Features:
- 10 meter hose
  - Stainless Steel Liner
  - Tank Pressure Regulator
  - Air release valve
  - Safety release valve
  - Manual Agitation

**K818 Pressure Feed 20 Litre Pressure Feed Tank**  
Tank dimensions:  
400L MM x 400W MM x 780H MM  
Capacity: 20 Litre  
Max. pressure: 60 PSI  
Weight total: 26 Kg

1.2 MM Nozzle PN: PW20LTRK12  
1.5 MM Nozzle PN: PW20LTRK15  
1.8 MM Nozzle PN: PW20LTRK18  
2.0 MM Nozzle PN: PW20LTRK20  
2.5 MM Nozzle PN: PW20LTRK25

**\$1199 ea**

## Quick-Lock Backing Pads

Attach abrasive pads to tool. Includes 1/4" shank adapter.

50 MM Quick-Lock Backing Pad

**\$19**

PN: GPA1523K



75 MM Quick-Lock Backing Pad

**\$24**

PN: GPA1524K



## Quick-lock Abrasive Pads

Packs of 10



50 MM Abrasive Fine

Fine Blue PN: GPA1527X10

Maroon Medium PN: GPA1528X10

Brown Coarse PN: GPA1526X10

**\$32 ea**

75 MM Abrasive Pads

Fine Blue PN: GPA1530X10

Maroon Medium PN: GPA1531X10

Brown Coarse PN: GPA1529X10

**\$49 ea**

## Quick-Lock Ceramic Sanding Discs

Packs of 10



50 MM Quick-Lock Ceramic Sanding Discs

36 Grit PN: AB22012S36CP

60 Grit PN: AB22012S60CP

80 Grit PN: AB22012S80CP

120 Grit PN: AB22012S120CP

**\$27 ea**

75 MM Quick-Lock Ceramic Sanding Discs

36 Grit PN: AB22013S36CP

60 Grit PN: AB22013S60CP

80 Grit PN: AB22013S80CP

120 Grit PN: AB22013S120CP

**\$32 ea**

## Quick-Lock Ceramic Flap Discs

Packs of 5



50 MM Quick-Lock Ceramic Mini Flap Discs

40 Grit PN: AB22012F40CP

60 Grit PN: AB22012F60CP

80 Grit PN: AB22012F80CP

120 Grit PN: AB22012F120CP

**\$19 ea**

75 MM Quick-Lock Ceramic Mini Flap Discs

40 Grit PN: AB22013F40CP

60 Grit PN: AB22013F60CP

80 Grit PN: AB22013F80CP

120 Grit PN: AB22013F120CP

**\$29 ea**

## Quick-Lock Preparation Kits

2" Quick-Lock Preparation Kit

7 Piece kit includes: 1/4" shank, 2" backing pad, 24 grit 2" disc, 36 grit 2" disc, 50 grit 2" disc, Brown (Coarse) surface prep 2" disc & Maroon (Medium) surface prep 2" disc.

**\$39**

PN: GPK2



3" Quick-Lock Preparation Kit

7 Piece kit includes: 1/4" shank, 3" backing pad, 24 grit 3" disc, 36 grit 3" disc, 50 grit 3" disc, Brown (Coarse) surface prep 3" disc & Maroon (Medium) surface prep 3" disc.

**\$49**

PN: GPK3



Abrasive & Sanding Pads made in USA.

## Ceramic Sanding Belts

Pack of 10 Belts

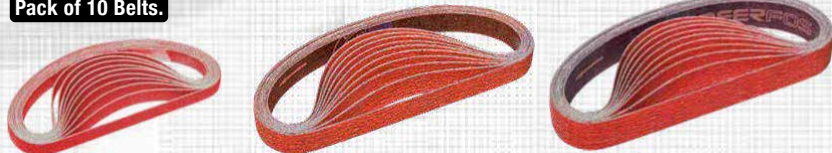

10 MM Sanding Belts

Size: 10 mm x 330 mm

40 Grit PN: AB2700-40CP

60 Grit PN: AB2700-60CP

80 Grit PN: AB2700-80CP

120 Grit PN: AB2700-120CP

**\$27 ea**

20 MM Sanding Belts

Size: 20 mm x 520 mm

40 Grit PN: AB2800-40CP

60 Grit PN: AB2800-60CP

80 Grit PN: AB2800-80CP

120 Grit PN: AB2800-120CP

**\$35 ea**

30 MM Sanding Belts

Size: 30 mm x 540 mm

40 Grit PN: AB2830-40CP

60 Grit PN: AB2830-60CP

80 Grit PN: AB2830-80CP

**\$59 ea**

## Quick-Lock Polishing Pads



50 MM Quick-Lock Felt Polishing Pad

**\$19**

PN: GPA1525



75 MM Quick-Lock Felt Polishing Pad

**\$19**

PN: GPA1575

## Polishing Mops

1/4" Shank Tapered Spindle

Fits 50 MM Calico Polishing Mops (PN: PMC50).

50 MM Calico Polish Mop

For use with Taper Spindle (PN: TS12). Width: 20 MM



**\$53**

PN: TS12



**\$39**

PN: PMC50

## Hook & Loop Backing Pads

50 MM Backing Pad

Shank Size: 1/4"



**\$39**

PN: GPA50

75 MM Backing Pad

Shank Size: 1/4"



**\$49**

PN: GPA75

## Hook & Loop Polishing Pads

60 MM Polishing Pad

Suits 50 mm Hook & Loop Backing Pad



**\$13**

PN: OWB-60

80 MM Polishing Pad

Suits 75 mm Hook & Loop Backing Pad



**\$25**

PN: 119-102

### 3" Hook & Loop Backing Pads



Pad Density: Medium  
Max Speed: 15,000 RPM

**\$31 ea**

1/4" Internal PN: ABCH-203-1/4N

1/4" External PN: ABCH-203-1/4S

5-16" Internal PN: ABCH-203-5/16N

5/16" External PN: ABCH-203-5/16S

M6 Internal PN: ABCH-203-6N

M6 External PN: ABCH-203-6S

2" Pads also available

### 6" Hook & Loop Backing Pads

Spindle Size: 5/16" x 24 UNF Ext.  
Max Speed: 12,000 RPM  
Pad Thickness: 10 mm  
Made in Taiwan.



Dust Free Pad PN: F6505

Dust Free pad PN: F6565

**\$49 ea**

### Clean & Strip Discs

- Removals of paint & light rust
- Designed not damage the original surface



Packs of 2

10 x 50 MM

**\$15**

PN: ABCH902P

10 x 75 MM

**\$25**

PN: ABCH903P

### Cut off Discs



50 MM Discs

Disc Size: 50 x 1 mm  
Bore: 1/4"  
Max Speed: 30,000 RPM

Packs of 10

**\$39**

PN: ABPCWHEELS



75 MM Discs

Disc Size: 75 x 0.8 mm  
Bore: 9.53 mm  
Max Speed: 25,000 RPM

Packs of 5

**\$25**

PN: CO007K

### 5" Turbo Backing Pad

- Lock Nut included
- Pad Thickness: 18 MM  
Max Speed: 10,000 RPM  
Thread Size: M14 x 2 Int.



**\$39**

PN: GTP162214

### 5" Clean & Strip Disc

- Removes paint & light rust
- Designed not to damage the original surface

**New!**

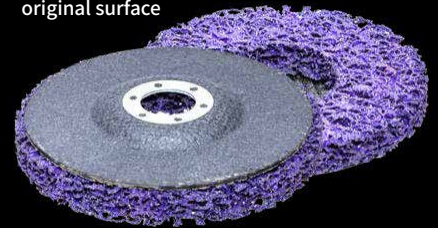

Disc Size: 125 mm  
Bore: 22 mm  
Max Speed: 16,500 RPM

**\$17**

PN: ABCH2205

### 8 Piece Flap Wheel Kit

Kit includes:

- 25 x 12 mm, 120 Grit, x 1
- 25 x 25 mm, 40 Grit, x 1
- 25 x 25 mm, 80 Grit, x 1
- 40 x 25 mm, 60 Grit, x 1
- 40 x 25 mm, 80 Grit, x 1
- 50 x 25 mm, 80 Grit, x 1
- 50 x 25 mm, 60 Grit, x 2



**\$55**

PN: GFWK

### Economical 6" Backing Pads



**\$20 ea**

Spindle Size: 5/16" x 24 UNF Ext.  
Max Speed: 12,000 RPM  
Pad Thickness: 10 mm

Standard PN: E6505

Dust Free PN: E6565

**flexipads**

WHAT QUALITY FEELS LIKE™

#### 180 MM Nylon Backing Pads

- Medium Pad Density
- Thread Size: M14 x 2 Int.
- Pad Thickness: 20 MM
- Max Speed: 8,500 RPM



**\$46**

PN: FP20305

#### Heavy Duty 5" TURBO Grinding Pads



*Ultra Tough & Rigid Pads  
ideal for grinding!*

Thread Size: M14 x 2 Int.  
Pad Thickness: 18 MM  
Max Speed: 12,250 RPM

**\$45**

PN: FP11723

#### Nylon Backing Pads

##### 100 MM Nylon Backing Pad

- Medium Pad Density
- Thread Size: M14 x 2 Int.
- Pad Thickness: 15 MM
- Max Speed: 12,250 RPM

**\$29**

PN: FP20020

##### 125 MM Nylon Backing Pad

- Medium Pad Density
- Thread Size: M14 x 2 Int.
- Pad Thickness: 16 MM
- Max Speed: 12,250 RPM

**\$29**

PN: FP20210

#### 6" Dust Free Multi-Fit Hook & Loop Pad

Thread Size: M8 & 5/16" UNF  
Pad Thickness: 14 MM  
Max Speed: 12,000 RPM

**\$89**

PN: FP17099



*Suits  
Festool & Makita  
Sanders!*

#### Sheep Skin Polishing Bonnets



**100%  
Merino Sheep  
Skin Wool!**

Disc Size: 5" (125 MM)  
Max. speed: 2,500 RPM  
Thickness: 32 MM

**\$39**

PN: FP40005

## In-line Components

1/4" In-line Water Separator

1/4" NPT Female to Male



**\$39**

PN: GPA1512

1/4" In-line Lubricator

1/4" NPT Female to Male  
Capacity: 15 mL



**\$30**

PN: GPA1025

## Swivel Connectors

Male thread to Japanese Style Plug  
Range: 22°

1/4" Thread PN: B05

3/8" Thread PN: B07

**\$20 ea**



## In-line Regulators

1/4" Air Flow Regulator

**\$22**

PN: GPA1010



1/4" Air Flow Regulator with Male plug

**\$22**

PN: GPA1011



## Air Line Quick Coupler Manifolds

2 Way Cluster Quick Coupler



**\$39**

PN: GPA1513

3 Way Cluster Quick Coupler



**\$49**

PN: GPA1514

2 Way In-line Quick Coupler



**\$39**

PN: GPA1515

3 Way In-line Quick Coupler



**\$49**

PN: GPA1516

4 Way In-line Quick Coupler



**\$49**

PN: GPA1517

## 20m Manual Hose Reel

- High quality Polyurethane braided hose
- Space Saving Foldable Handle
- 360 degree swivel base

Hose ID: 8 mm  
Hose OD: 12 mm

**\$299**

PN: GPHR1220



## 20m Wall Mount Hose Reel

- 180° swivel bracket
- Sheet metal housing
- 1.5 metre inlet hose
- Adjustable recoil stopper
- High quality braided polyurethane hose
- Shrouded air line socket

Hose ID: 6.5 mm  
Hose OD: 10 mm

**\$299**

PN: GPHR1020



## Bare In-line Manifolds

2 Way In-line Bare Manifold

**\$20**

PN: GPATA2

3 Way In-line Bare Manifold

**\$21**

PN: GPATA3

4 Way In-line Bare Manifold

**\$23**

PN: GPATA4



## One-Touch Connector Kits

- Kit includes Hose Clamps, One-Touch Socket & Plug fittings

10mm Kit  
PN: AHPACK

**\$32**

12mm Kit  
PN: AHPACK12

**\$41**



## Bare Air Line Hose



10 MM Bare Air Hoses

20m Roll

**\$59**

PN: AH1020

30m Roll

**\$99**

PN: AH1030

100m Roll

**\$279**

PN: AH10100

12 MM Bare Air Hoses

20m Roll

**\$99**

PN: AH1220

30m Roll

**\$139**

PN: AH1230

100m Roll

**\$419**

PN: AH12100

## Premium Air Tool

Add only a couple of drops daily to prolong the performance of any air operated tool  
Formulated to greatly reduce internal wear and maintain the integrity of gaskets and seals



250 ML

**\$13**

PN: SI250

1 Litre

**\$27**

PN: SI1000

5 Litre

**\$98**

PN: SI5000

## One-Touch Recoil Air Hoses



10 MM Air Hoses

6.5 MM ID x 10 MM OD

2 Metre  
PN: GPH1003LBHL **\$57**

5 Metre  
PN: GPH1006LBHL **\$72**

6 Metre  
PN: GPH1008LBHL **\$78**

8 Metre  
PN: GPH1010LBHL **\$95**

- One-Touch couplings
- Made from kink resistant polyurethane

12 MM Air Hoses

8 mm ID x 12 mm OD

5 Metre  
PN: GPH1206LBHL **\$78**

6 Metre  
PN: GPH1208LBHL **\$94**

8 Metre  
PN: GPH1210LBHL **\$99**

10 Metre  
PN: GPH1212LBHL **\$110**

## One-Touch Fitted Air Hoses



Fitted with Japanese compatible One-Touch couplings.

10 MM Fitted Air Hoses  
10 MM ID

10 Metre  
PN: AH1010F **\$52**

20 Metre  
PN: AH1020F **\$83**

30 Metre  
PN: AH1030F **\$109**

12 MM Fitted Air Hoses  
12 mm ID

20 Metre  
PN: AH1220F **\$119**

30 Metre  
PN: AH1230F **\$159**



Made in Australia

# Impact Socket Sets

**HOT PRICES!**

Made from Chrome Molybdenum Steel CR-MO.

Meet or exceed DIN & ANSI standards.

## 3/8" Drive Impact Socket Sets

8 Piece Metric  
PN: GX838SSM

Sizes: 8, 10, 11, 12, 13,  
15, 17 & 19 mm

8 Piece Imperial  
PN: GX838SSI

Sizes: 5/16", 3/8",  
7/16", 1/2", 9/16", 5/8",  
11/16" & 3/4"



was \$62  
**Now! \$49 ea**

## 1/2" Drive Impact Socket Sets

13 Piece Metric  
PN: GX1312SSM

Sizes: 10, 12, 13, 14, 15,  
17, 18, 19, 21, 22, 24,  
27 & 30 mm

13 Piece Imperial  
PN: GX1312SSI

Sizes 7/16, 1/2, 9/16, 5/8,  
11/16, 3/4, 13/16, 7/8, 15/16,  
1, 1-1/16, 1-1/8 & 1-1/4"



was \$169  
**Now! \$99 ea**

## 3/4" Drive Impact Socket Sets

8 Piece Metric  
PN: GX834SSM

Sizes: 26, 27, 29, 30, 32,  
35, 36 & 38 mm

8 Piece Imperial  
PN: GX834SSI

Sizes 1, 1-1/16, 1-1/8,  
1-1/4, 1-5/16, 1-3/8,  
1-7/16 & 1-1/2"



was \$229  
**Now! \$189 ea**

## Impact Hex & Torx® Bit Sets

Made from SNCM 8660 Steel which allows 20% more torque than CR-MO.

### 1/2" 8 Piece Imperial Hex Bit Set

Sizes: 1/4", 5/16",  
3/8", 7/16", 1/2",  
9/16", 5/8" & 3/4"



was \$99  
**Now! \$79**  
PN: GX12HBSI

### 1/2" Torx® Impact Socket Set

Sizes: T25, T27, T30, T40,  
T45, T50, T55 & T60 bits



**\$99**  
PN: GX12TX8

## Impact Universal Joints

Molybdenum  
Steel CR-MO.



3/8" Drive  
Universal Joint

**\$28**  
PN: GX38U

1/2" Drive  
Universal Joint

**\$29**  
PN: GX12U

3/4" Drive  
Universal Joint

**\$57**  
PN: GX34U

## 5 Piece Square Drive Adapter Sets



**\$29**  
PN: GX5AS

Chrome Vanadium

1/4" Female to 3/8" Male  
1/2" Female to 3/8" Male  
3/8" Female to 1/4" Male  
1/2" Female to 3/4" Male  
3/8" Female to 1/2" Male

## Wobble Impacting Bar Sets



Chrome Molybdenum Steel CR-MO.

1/4" Set of 4 Wobble  
Extension Bars

Kit includes:  
3", 6", 10" & 12" bars

**\$59**  
PN: GXWEBS14

3/8" Set of 4 Wobble  
Extension Bars

Kit includes:  
3", 6", 10" & 18" bars

**\$82**  
PN: GXWEBS38

1/2" Set of 4 Wobble  
Extension Bars

Kit includes:  
3", 5", 10" & 18" bars

**\$99**  
PN: GXWEBS12

# THE BONE™ CREEPERS & STOOLS



## THE BONE LOW PROFILE

### THE BONE ROUGH RIDER

1194L x 648W x 191H MM  
Wheels: Ø130 MM x 25 MM  
Ground Clearance: 73 MM  
Weight: 9.1 Kg



**\$649**  
PN: BONE7031

**180 KG  
CAPACITY**



1194L x 648W x 160H MM  
Wheels: Ø130 MM x 25 MM  
Ground Clearance: 45 MM  
Weight: 8 Kg

**\$599**  
PN: BONE6031

**180 KG  
CAPACITY**

## THE BONESTER SUPER LOW PROFILE



1092L x 594W x 114H MM  
Wheels: Ø75 MM x 22 MM  
Ground Clearance: 38 MM  
Weight: 6 Kg

**\$479**  
PN: BONE4031

**180 KG  
CAPACITY**



Distributed by:

# HARLINGEN®

## 45 Piece Metric HSS Tap & Die Set

45 Piece M2-HSS set includes long handle & T-handle tap wrenches, long handle die wrench, die adapter and tap & dies from M6 to M24 in fine and coarse pitches



**\$999**

**M2 HSS!**

PN: H-11-115-001-M2

Full range on page 17!

## HSS Reduced Shank Drill Set

8 piece set includes 13, 14, 15, 16, 18, 20, 22 & 25 mm drills  
Drill length: 150 mm  
Shank: 13 mm  
Material: HSS



**\$199**

PN: H-11-030-S01

Full range on page 16!

## Ezi-Shear

### PROFESSIONAL SHEET METAL CUTTING ATTACHMENTS

#### Cam-Drive Ezi-Shear

Cam-Drive Ezi-Shear to suit Milwaukee™

- |   |  |
|---|--|
| Milwaukee M18™ 14 Gauge Double Cut Shears (2636-20) | Milwaukee M18™ Double Cut Shears (2635-20) |
| Milwaukee M18™ 18 Gauge Single Cut Shears (2637-20) |  |



**\$259**

PN: EZISMIL

## geiger™

### Twin LED Rechargeable Inspection Lamp

Ideal for automotive panel & paint inspection or any confined automotive or industrial work environments.

- Precision adjustable dimmer switch
- Multistage battery indicator light
- Magnetic ball jointed adjustable base
- Dual retractable lamp hangers
- USB rechargeable Li-ion battery
- Magnetic retrieval wand at tip
- IP54 dust & water resistant

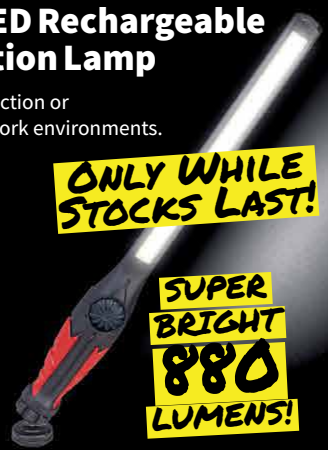

**ONLY WHILE STOCKS LAST!**

**SUPER BRIGHT 880 LUMENS!**

**HOT PRICE!**

**\$99**

PN: GLED2CIL

# ACCUD

Professional Measuring Instruments

## Fractional Digital IP54 Calipers

**Rechargeable!**



**New!**

USB DATA OUTPUT

Resolution: 0.01 mm  
Accuracy: ±0.03 mm

- Fractional, Metric & Imperial display
- IP54 Ingress Rating
- USB rechargeable with up to 3 months of continuous use between charges

150 mm Caliper

PN: AC-106-006-11F

**\$149**

200 mm Caliper

PN: AC-106-008-11F

**\$199**

300 mm Caliper

PN: AC-106-012-11F

**\$279**

## 100 mm Digital Protractor

- Button function: Hold/Rev, Set zero, On/Off
- Beam with integrated magnets
- Locking screw

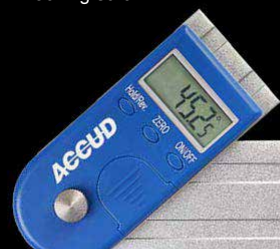

Range: 100 mm  
Resolution: 0.05°  
Accuracy: ±0.2°  
Length: 103 mm

PN: AC-824-004-11

**\$139**

## Scribing Divider

- Carbon steel arms
- Hardened scriber

Range: 200 mm  
Length: 200 mm



PN: AC-987-008-01

**\$49**

## morrisflex

## NG6 Burr Sets

3/8" Head NG6 Coated Burr Set



**\$279**

PN: CBSSET3NG6C

1/2" Head NG6 Coated Burr Set



**\$397**

PN: CBSSET35NG6C

1/4" & 3/8" Head NG6 Coated Burr Set



**\$459**

PN: CBSSET8NG6C

**NG6 NEXT GENERATION ACCELERATOR**

Full range on page 8.