

SCULPTURE LOOP

*The newsletter of the
Cotswold Sculptors Association*

AGM

Highlights:

- Meet our new Chair
- A fresh look for CSA

Opportunity updates:

- Hungary 2027 Residency
- NT - Newark Park

Artist Spotlight:

- Kay Singla
- Darren Rumley
- Elliot Dylan Quinn

Exhibitions:

- Preparations for 'Creating Spaces' 2026

Explore the **CSA Membership Map**

IN THIS ISSUE:

p.6 Exhibitions –

Upcoming, recent highlights, calls for entries

p.9 Members &

Community – New members, Friends, Hubs & *Members' Map*

p.34 Ideas &

Collaboration – Mixing it Up! & "Calling All Artists"

p.35 Events & Calendar

– Open Forums, key dates, committee meetings

p.37 Opportunities –

Residencies, Grants, workshops and other opportunities

p.39 Spotlight –

member profiles

p.46 Inspirations –

Books, podcasts, films & exhibitions to inspire

new**p.48 Association News**

– Chair's notes & committee updates

p.54 Meet the Team**p.55 Get Involved!****p.56 Resources –**

Discounts, Services, Marketplace

p.61 Stay Connected –

Social media & newsletter contributions

p.62 Join Us!

Cover Image: **'Pretty Woman'** by Kay Singla

WELCOME to the 67th edition of Sculpture Loop.

This issue includes:

- A message from our new Chair - **Gina Baum**,
- A link to our interactive **Membership Map**
- Exhibition news, opportunities, and updates from members across the CSA.

However you're involved - exhibiting, learning, collaborating or exploring - we hope you find something to inspire you.

Check out this edition's featured artists in the **Spotlight** section.



'Pretty Woman'

Kay Singla



'Luna'

Darren Rumley



Elliot Dylan

Quinn

Catch up on our February AGM highlights, meet our new Chair, **Gina Baum**, and see what's in store for the year ahead.

Read the full story in **Association News**.

A message from the new Chair

Hello everyone and welcome to another brilliant addition of *Sculpture Loop*, affectionally known as “*Sloop*” by the committee. For those members who were unable to attend the AGM in February, a hello from me your new Chair.



Gina Baum
Chair

[See a round-up of the AGM highlights here](#)

Thank you to our committee and to those members who stepped down at the AGM, your hard work on behalf of the members is really appreciated. The committee are an amazing bunch of people and should you wish to see what we do or wish to be involved please contact me or any member of the committee. The association only works if we support each other in our sculptural endeavours.

CSA's next exhibition will be [Miserden 2026](#) (both indoor and outdoor). The private view will be held on the evening of Saturday 6th June, so put the date in your diaries, more information will be sent out later. The committee will be asking for volunteers to support them closer to the date and any help with managing the bar and parking would be gratefully received.

The Committee is really close to releasing a new and exciting opportunity for up to 5 artists to be part of a pilot project created between CSA and the National Trust property Newark Park. The details are just being refined and an artist brief will hopefully be sent out to you all by April.

[See p.38](#)

I will be sending out an update in the next few weeks but in the meantime enjoy this addition of Sloop.

Best Wishes and Happy Making

Gina Baum



Gina Baum

EXHIBITIONS

[Upcoming](#), [recent highlights](#), calls for entries

'Creating Spaces' 2026 at Miserden Gardens and Club House



Behind the Scenes: Curating 'Creating Spaces' at Miserden

The magic of an exhibition often begins long before visitors arrive. At this year's CSA 'Creating Spaces' exhibition, volunteers have been working tirelessly behind the scenes, ensuring that both the outdoor and indoor displays are thoughtfully planned and beautifully presented.

For the outdoor exhibition, Ange, Lynda, Kim, and Graham have been hard at work, armed with lists, spreadsheets, and plenty of biscuits to keep them going!

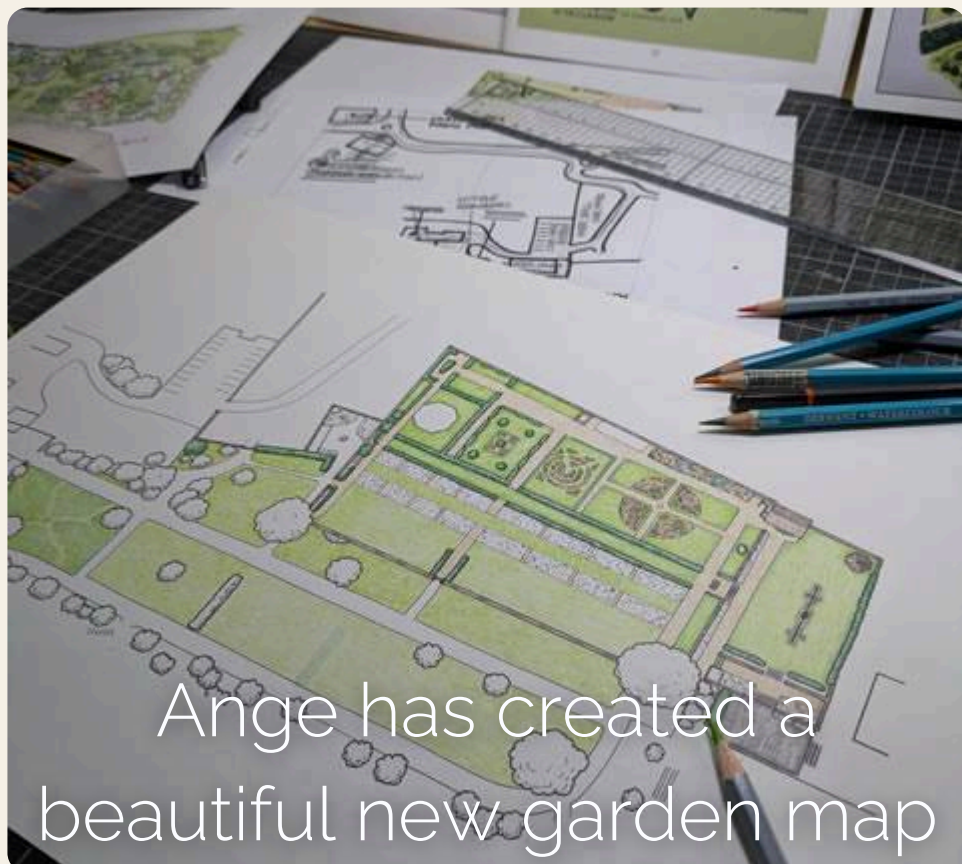

EXHIBITIONS

Meanwhile, Anna, Juli and Ian Knight have been grappling with the intricacies of indoor placement. “The complexities of curation!” sums it up perfectly.



A big shout-out also goes to Sarah Cushing, who has been kept very busy meticulously processing all the submissions. Selections for both indoor and outdoor exhibitions will be confirmed by 14th March.

Thanks to all who have applied to be part of Miserden this year!

We're especially excited to welcome the Indoor exhibition back at Miserden Club House this year. With such a dedicated team behind the scenes, it promises to be a fantastic exhibition, showcasing the very best of CSA sculpture.

Whether you're a sculptor or a visitor, we look forward to welcoming you - and **do join us for the private view on Saturday 6th June** (details coming soon).

EXHIBITIONS

Miserden

A remarkable setting for sculpture

**Creating Spaces 2026**

Set within the historic Cotswold landscape of Miserden, this much-loved exhibition places contemporary sculpture among sweeping views and intimate garden spaces — giving each work room to breathe.

Some highlights from Creating Spaces 2025 at Miserden

More details of Miserden 2025 in the **Exhibition**
Archive [here](#)

MEMBERS & COMMUNITY

[New members](#), [Friends](#), [Hubs](#), [Members' Map](#)

Welcome to Our New Members

We're pleased to welcome the latest members to the CSA community.

Each brings their own materials, ideas and making processes, adding new dimensions to our shared practice.

On the following pages, meet the sculptors behind the work.

- [Rosalind Seegobin](#)
- [Terry Merritt](#)
- [Julie Cleverly](#)
- [Lynne Littler](#)
- [Johannes Steuck](#)
- [Eleanor Lachab](#)
- [Lizzie Hill](#)
- [Sally Dorrity](#)
- [Ann Pegg](#)

Where available, please explore their websites and Instagram pages to see more of their work, and join us in giving them a warm welcome.

MEMBERS & COMMUNITY
Rosalind Seegobin

Clay and fire offer continuing surprise and challenge. This has remained a fascination as has simple mark making and the endless possibilities of creating texture on hand-built forms. Often I use found objects to mould or impress patterns later enhanced by oxides and glazes in a final firing.



Similarly, the effect of heat, vitrifying and fusing elements baking solidity into a plastic material offers endless spurs to further creativity.

MEMBERS & COMMUNITY

Rosalind Seegobin - cont.

Rudimentary knowledge of clay and techniques was gained in Birmingham and interest maintained working alongside other sculptors and ceramicists during a career in education.

Forms are made using hand construction techniques, proformas, armatures and moulds using contrasting clay bodies.

Experimenting with the different properties and frailties of varying clay bodies, recently I have referenced experiences watching volcanoes and geysers , molten bodies taking on organic forms as they cool - a fundamental process repeated in firings on a very small scale.



Email: rrsee1954@gmail.com

MEMBERS & COMMUNITY

Terry Merritt

I am a Chichester based Sculptor whose medium is stone and wood, studied at the University of Chichester achieving a BA (hons) Degree in Fine Art with Sculpture.

I hand carve beautiful sculptures from various types of stone including colourful Zimbabwean Serpentine rock, using hand and power tools incorporating Toolmaking skills.

Using sketches and bars of household soap as maquettes before upscaling to stone, I then start creating my design using diamond disc angle grinders to remove bulk, then hand chisels and mallets, then diamond riffler files to finalise the form and detail work, and finally the long process of polishing using diamond blocks and wet and dry sandpaper.

I am inspired by the natural beauty of the human anatomy, human gestures, and movement, exploring the human form combining curves,

MEMBERS & COMMUNITY

Terry Merritt - cont.

lines, and negative voids in the form of abstraction, also create beautiful modern abstracted forms, some of which rotate on their bases.

In 2023 I not only sold a large sculpture at the infamous London Art Biennale but also was awarded a place in the Chianciano Art Biennale 2024, near Tuscany, Italy, where I received "A Sculpture Special Mention Award" for my sculpture titled "UNITY".



Website: www.tmsculptor.com

Instagram: [@tm.sculptor](https://www.instagram.com/tm.sculptor)

Email: tmsculptor1@gmail.com

MEMBERS & COMMUNITY

Julie Cleverly M.A (Fine Art) B.A (Hons)

My inspiration is taken from observations of the modern and natural world. I often use objects in my sculpture with a history or reference the viewer can relate to.

I explore my ideas through the process of making, remaking, adding and subtracting. I continue to experiment with different materials until I achieve a combination of materials and process to convey a meaningful outcome.

I live and work in West Sussex and exhibit in Hampshire, Sussex, Surrey and London.

Commissions and collaborations are welcome. Studio visits are available through pre arranged appointments.

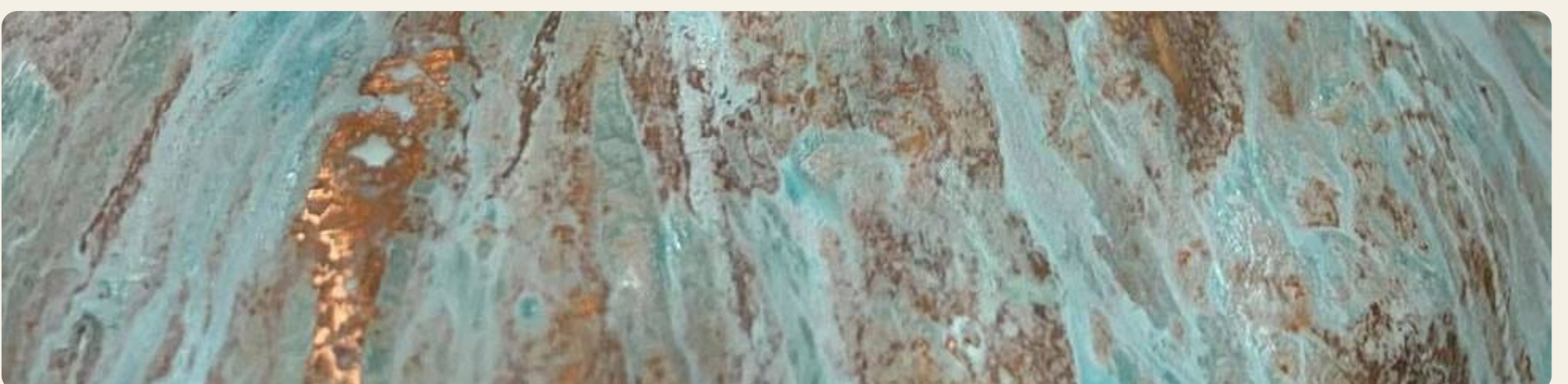

MEMBERS & COMMUNITY

Julie Cleverly - cont.



Web: www.badbstudio.com

Instagram: [@julie.cleverly](https://www.instagram.com/julie.cleverly)

Email: artistbadb@gmail.com

MEMBERS & COMMUNITY

Lynne Littler



I am a maker - a maker of things.

My medium of choice is wire - not sure if I found it or it found me either way I'm hooked. I use a variety of wires through constant experimentation.

My inspiration comes from nature with a passion for birds intrigued by the vast variety of species and sadly their decline.

My studio is based in the Wye Valley where I can sit, play and experiment while listening to the sounds of nature.



MEMBERS & COMMUNITY

Lynne Littler - cont.

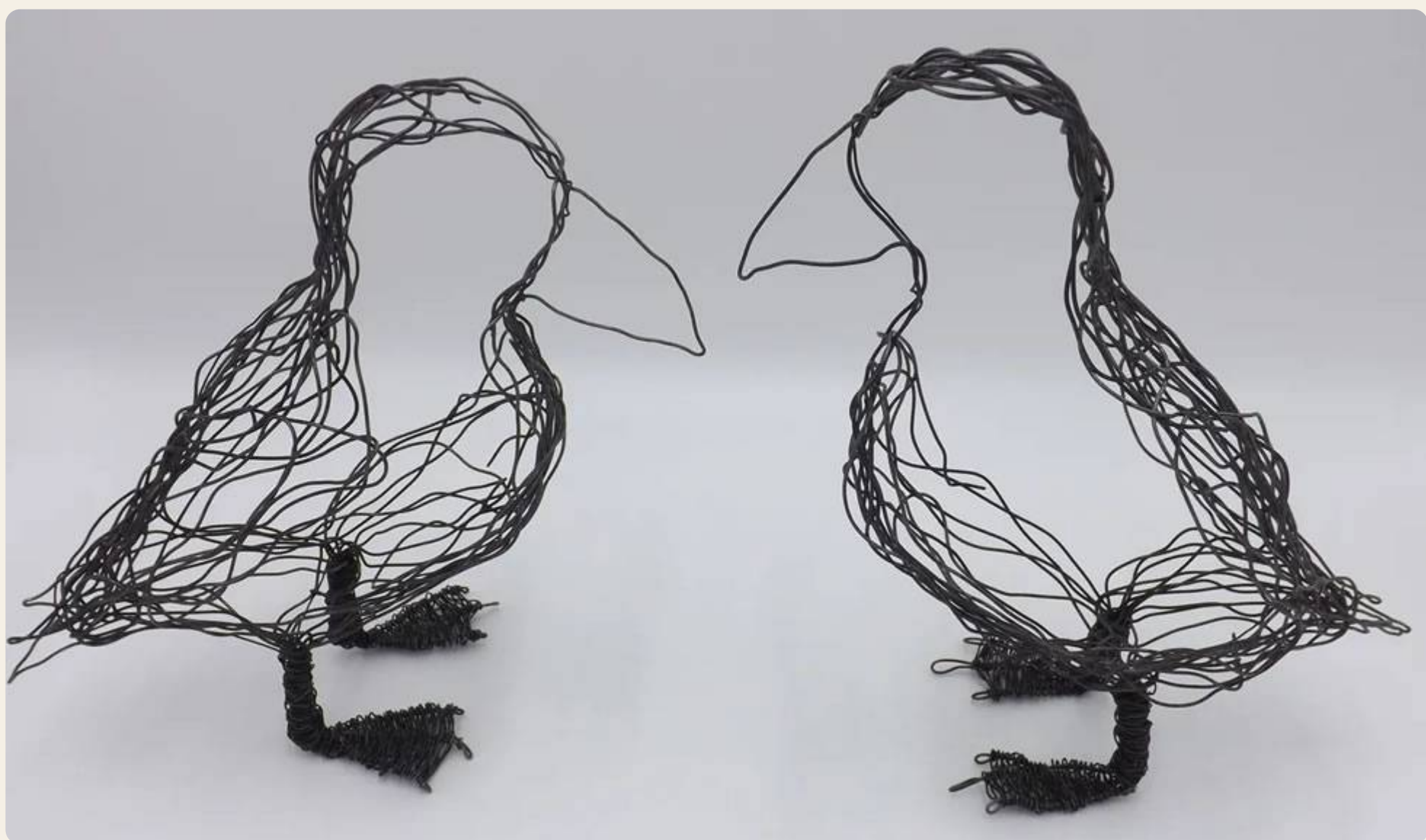

Web:

inspiredgallery.co.uk/lynne-littler-sculpture

Instagram: [@lynne_littlersculpture](https://www.instagram.com/lynne_littlersculpture)

Email: lynne@inspiredgallery.co.uk

MEMBERS & COMMUNITY

Johannes Steuck



I was born in Sweden to German parents in 1956, after a short interlude in Germany, I have lived in Britain since 1962. I completed a sculpture degree course in Winchester between 1975 and 1978. I am a multimedia artist working with stained glass, mosaic and sculpture. I have taught in schools and worked with special needs people, doing an Ms in special education in 2015.



MEMBERS & COMMUNITY

Johannes Steuck - cont.

I am a stone carver (using traditional hand tools). I mostly use limestone, it seems to carry within itself the memory of water, making it a perfect medium for organic forms. I try to simulate the effect of the elements, the action of wind, the abrasion of sand in water.

I primarily use a point, working directly into the surface, the challenge is to create volume out of an essentially negative process—the punching of tiny holes. One has to carry an imagination of positive form, to counteract the reduction of material.

My leitmotiv is to, Bringing Matter into Motion.

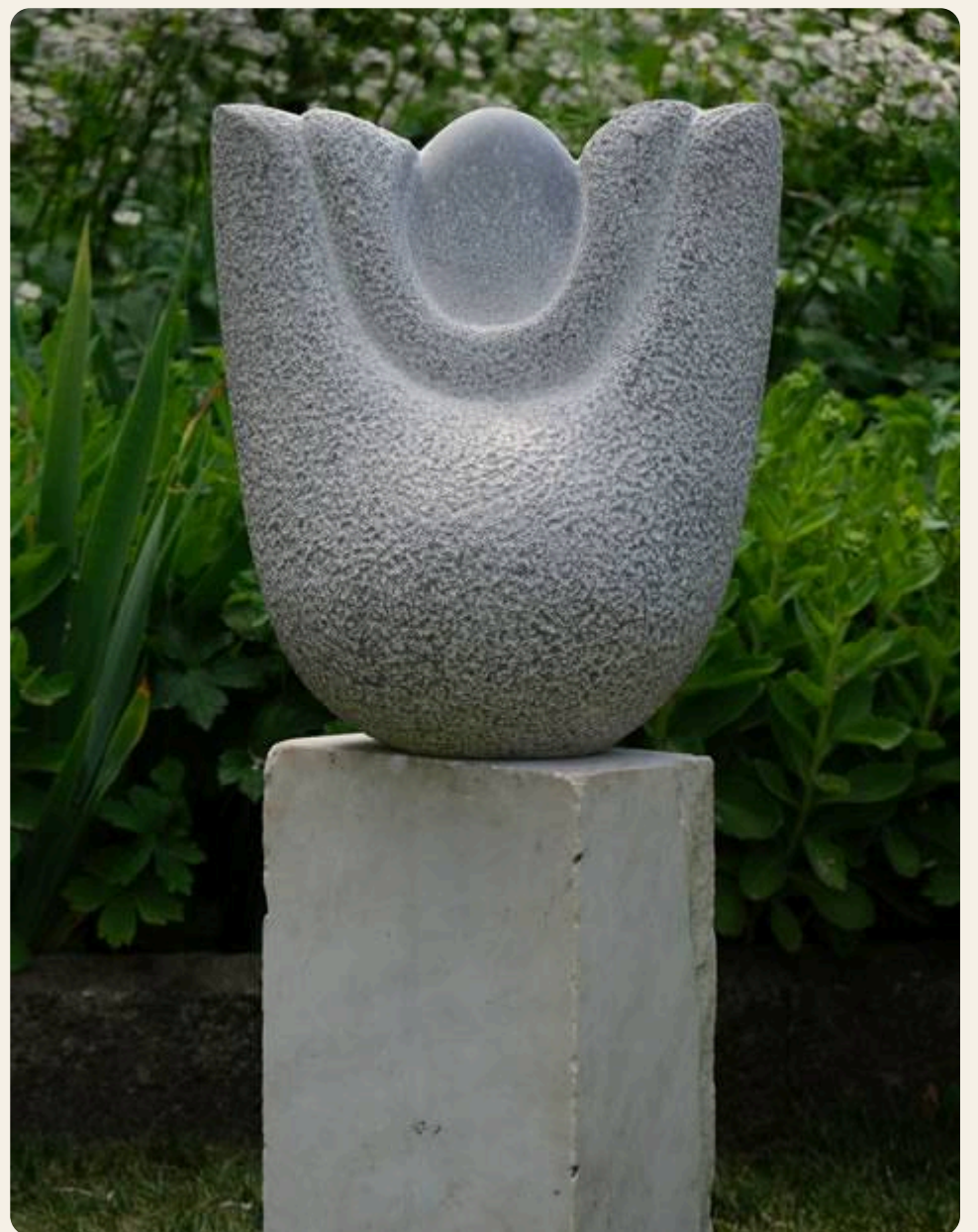

Web: johannesart.co.uk

Email: jsjohannesart4@gmail.com

MEMBERS & COMMUNITY

Eleanor Lachab



Eleanor is a stained glass artist with a long, deep interest in the complex geometric frameworks found in Gothic cathedrals. She was fascinated to find the commonality of patterns used in sacred art throughout human history and seeks to apply these ideas using light and line through her stained glass work. The meditative repetition of shape creates an interesting challenge to her craft. Discovering that each pattern can be recreated in a multiplicity of ways means that a unique piece of art is created with each rendition.



MEMBERS & COMMUNITY

Eleanor Lachab - cont.

Eleanor has been working with stained glass since 2002, initially for established Stained Glass studios until developing her own practice. In 2008 she was awarded a QEST crafts scholarship that allowed her to study MA Glass and Architecture at the National Glass Centre. She currently uses the skills she has acquired to create new glass works inspired by geometric patterns.



Web: www.glass-schemes.co.uk

Email: eleanor@glass-schemes.co.uk

MEMBERS & COMMUNITY

Lizzie Hill



Lizzie Hill weaves sculptures from waste materials, creating layered, anthropomorphic forms which reference geology, adaptation and humanity's relationship with the natural world.

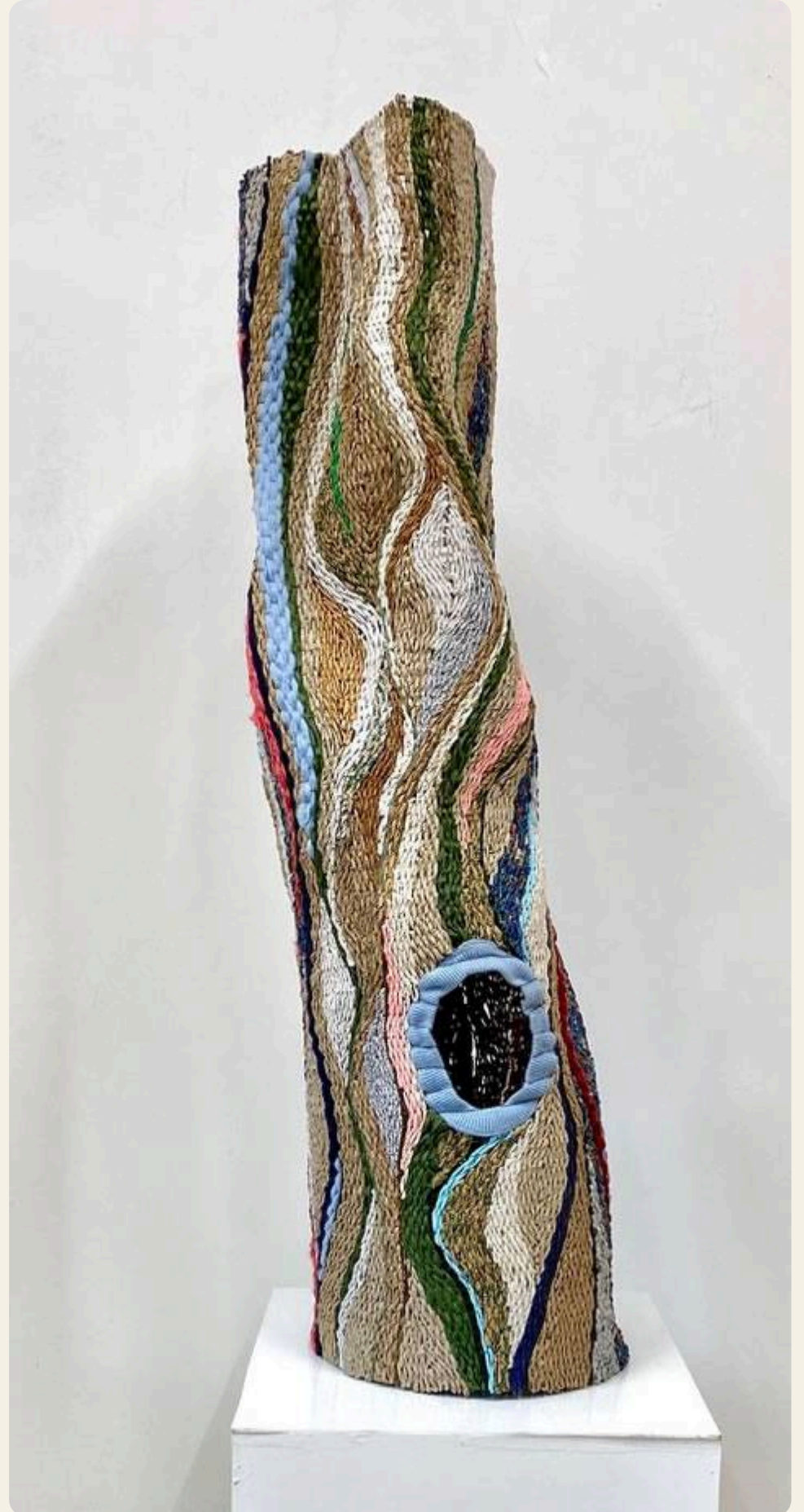

MEMBERS & COMMUNITY

Lizzie Hill - cont.

Lizzie won the Royal Academy of Arts Jack Goldhill Prize for Sculpture in 2023 and was a finalist for the Cass Art Prize in 2024. She exhibits extensively around the UK as well as the US. Lizzie lives in Bath and is a member of the Free Painters and Sculptors and an associate artist at 44AD.



Web: www.lizziehill.co.uk

Instagram: [@lizzie_j_hill](https://www.instagram.com/lizzie_j_hill)

Email: lizziehill100@gmail.com

MEMBERS & COMMUNITY
Sally Dorrity

I work in a variety of stoneware clays to hand build my pots, creating small, medium and large pieces, both functional and sculptural. These are then fired in an electric kiln. My work is frost resistant and is therefore suitable for use both indoors and outside.

Hand building allows for exploration and individuality in each piece, taking on a sculptural quality or a more traditional shape, in each case allowing me to showcase the



hues and textures I want to explore. It is a slow process and rarely results in perfect symmetry. Therefore no two pieces are exactly the same. Each piece is unique.

MEMBERS & COMMUNITY

Sally Dorrity - cont.

In my studio I am constantly experimenting with different shapes, new glazes and glaze combinations. My glazes are composed of few ingredients, relying on the magic of kiln and chemistry.

I am very drawn to movement in my work, taking my inspiration from traditional forms as well as the lines, tones and textures of nature. My ceramics and my skills are continually evolving and progressing, as I pursue my fascination with clay and its many possibilities.



Web: www.sallydorrity.co.uk

Instagram: [@sally.dorrity](https://www.instagram.com/sally.dorrity)

Email: sally.dorrity@gmail.com

MEMBERS & COMMUNITY

Ann Pegg

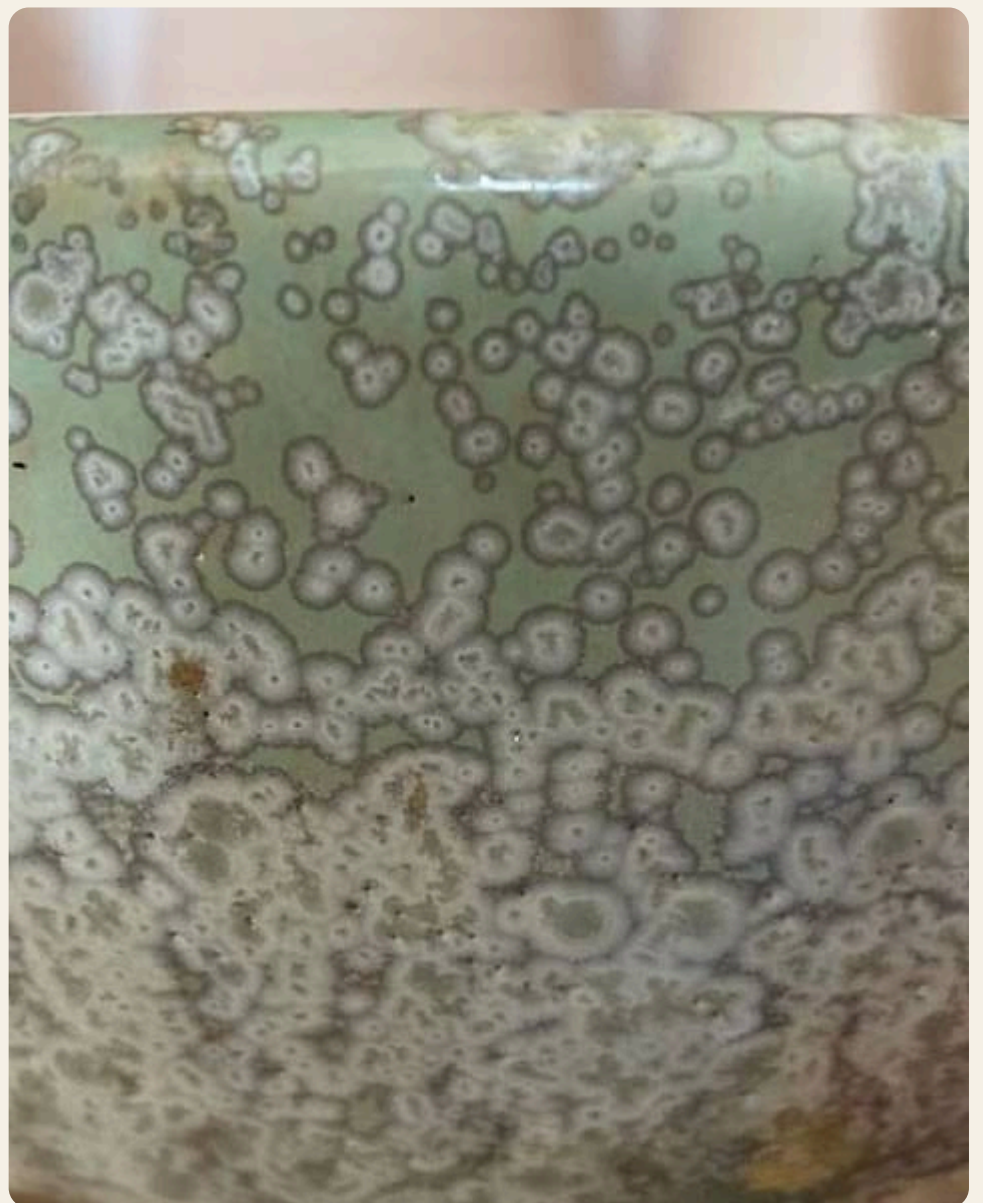

Insta: [@annelizabeth2](https://www.instagram.com/annelizabeth2)

Email: ann.pegg4@gmail.com

MEMBERS & COMMUNITY

Friend Membership

Did you know you can join the Cotswold Sculptors Association as a Friend for only £20 per annum? You can join us at Open Forums, AGM and Private views, have all the benefits of a full member apart from exhibiting.

👉 Join us today:

www.cotswoldsculptorsassociation.com/join-us



Amy Ng Kam-Mei

MEMBERS & COMMUNITY

Website

www.cotswoldsculptorsassociation.com

The CSA website is a central hub for both members and art lovers.



sharing a passion for sculpture



Welcome to the Cotswold Sculptors Association: a non-profit community connecting sculptors in and around the Cotswolds and promoting our love of sculpture through exhibitions and events.

We welcome developing and experienced makers in all mediums; art lovers and collectors, and all those who are sculpturally curious.

What's On

Applications for Creating Spaces 2026 at Miserden Gardens are now closed.

All sculptors who have applied will be contacted soon.

Sculptor Spotlight

[see all of our sculptors](#)

For Art Lovers

- Discover current and upcoming CSA exhibitions
- Explore the **Sculptors Gallery** and connect with our members
- Find courses and workshops run by CSA sculptors
- Learn how to become a member and enjoy further benefits

MEMBERS & COMMUNITY

For Members

Your website profile helps promote your practice and connect with audiences.

As a member you can:

- Showcase your work in the **Sculptors Gallery**.
- Promote courses and workshops (with direct links to your own site)
- Advertise your art services to the wider membership

In the **Members' Area**, you'll find:

- Dates for your diary
- Exclusive discount codes
- Practical guidance (from photography to packaging heavy sculptures)
- Hub contact details
- Committee information

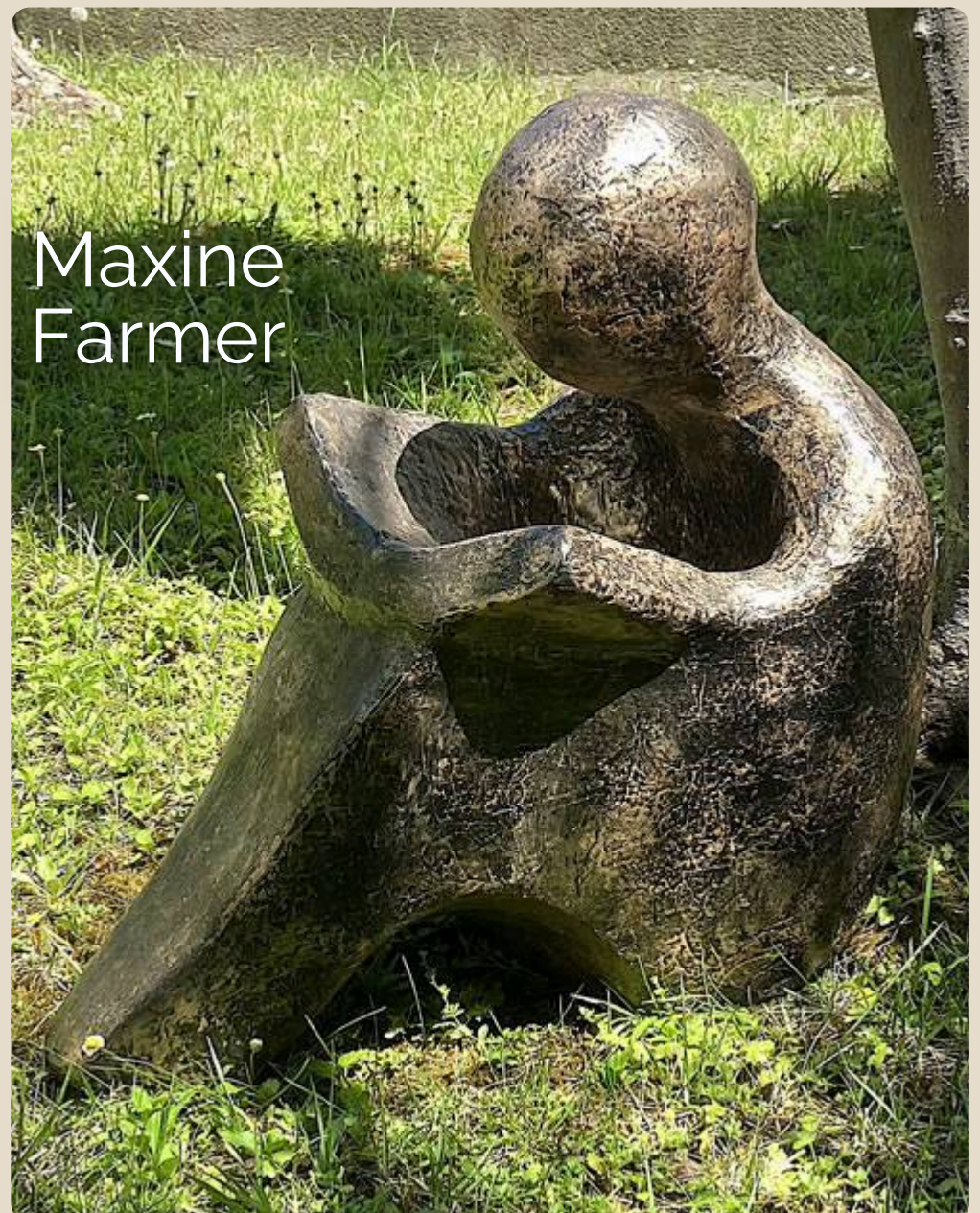
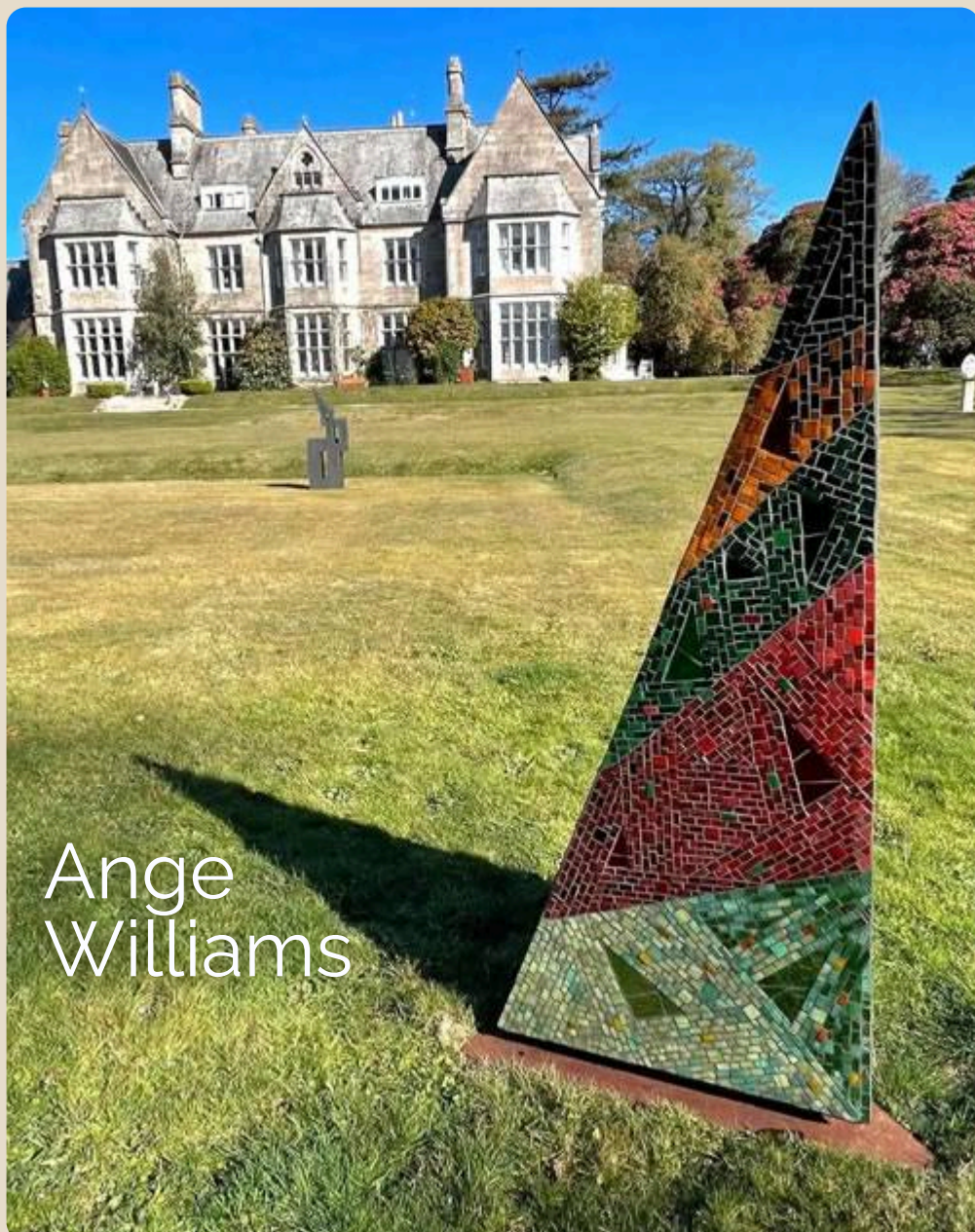

MEMBERS & COMMUNITY

Hub activity:

Many thanks to [Martin Elphick](#) for organising this trip to [The Stratford Gallery at Broadway](#).

Gallery owner Howard Clegg gave us a very informative group talk on the works of master ceramicists Katsunori Sawa, Takashi Tanimoto and Makoto Yamaguchi, each representing their own distinctive styles from the Shigaraki, Iga and Seto prefectures of Japan.



MEMBERS & COMMUNITY



www.thestratfordgallery.co.uk

MEMBERS & COMMUNITY

Regional and Interest Hubs

Hubs bring members together locally to share ideas, support one another, and organise visits, social events or exhibitions.

Members can join more than one Hub or connect with a neighbouring region. See our **Members' Map** to find your local sculpting community.

If you're organising something, please let us know — we'd love to hear from you.

Read more about hubs in the **Members' Area**



Claire Nelson

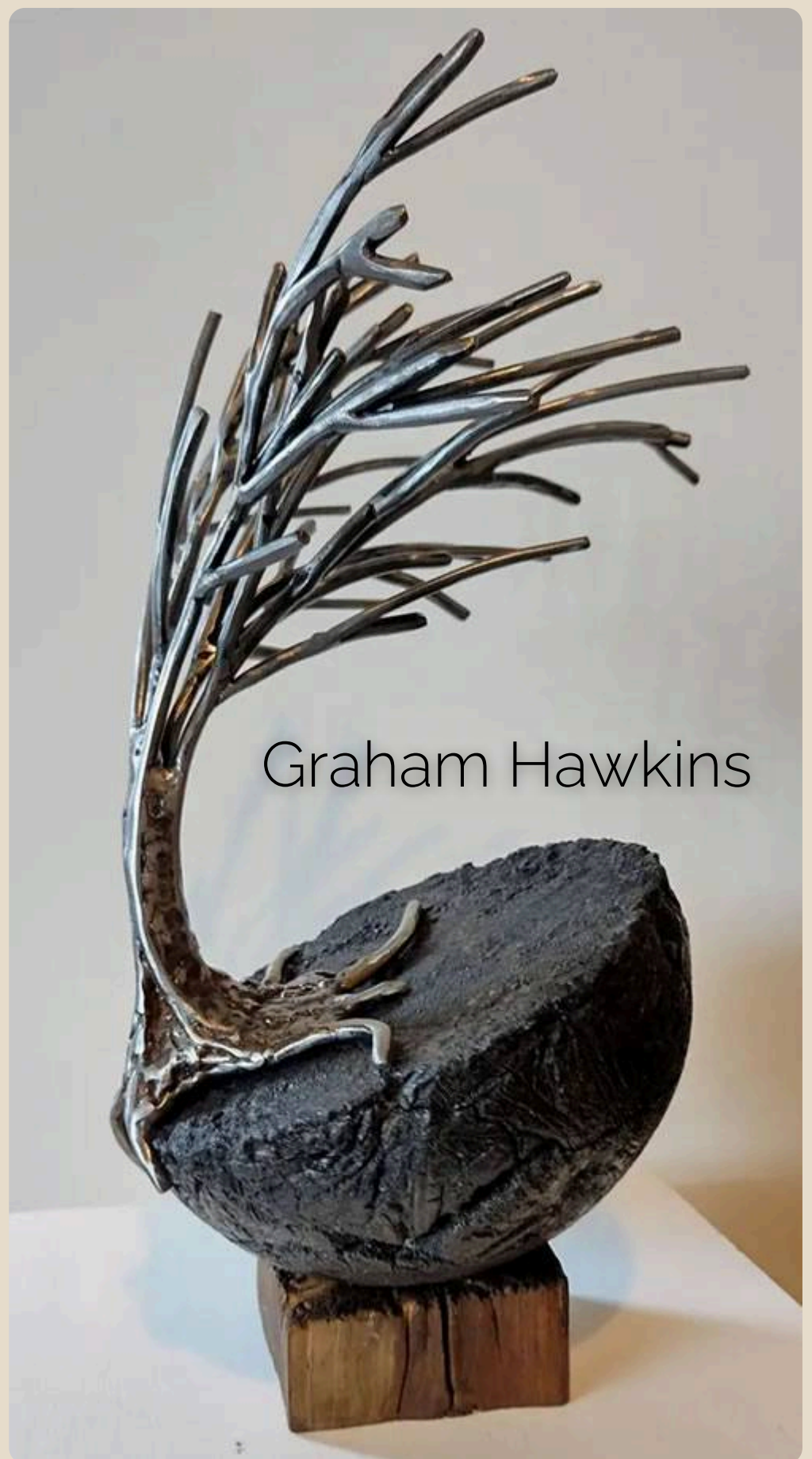

Graham Hawkins

MEMBERS & COMMUNITY

Discover and connect through the new interactive **CSA Membership Map**

Click on the map for an overview of where our members are based and find sculptors near you.



Members who'd like to appear on the map, move their pin, or update what's shown contact the team at info@cotswoldsculptorsassociation.com.

IDEAS & COLLABORATION

Mixing it Up! & "Calling All Artists"

Calling all artists

If you have a craft or skill that you'd like to share with others in a workshop or class/demo please get in touch with us to advertise your workshops/courses at:

sculptureloop@cotswoldsculptorsassociation.com

We look forward to hearing from anyone interested in sharing and showcasing their skills.



Roy Evans

EVENTS & CALENDAR

[Open Forums](#), [key dates](#), [committee meetings](#)

CSA Open Forums

Our Open Forums are a series of organised group visits and events open to all CSA members. Held several times throughout the year, they offer a chance to explore fascinating places, hear from inspiring speakers, and connect with fellow sculptors.

Last year's programme included a visit to **The Puppet Place** in Bristol, a tour of the **Gloucester Cathedral Masons' Workshop**, and a fascinating Zoom talk by our very own **Ben Broadbent**.

These visits are also a great opportunity to get together, share ideas, and chat with other members in an informal setting.

We're looking forward to developing the 2026 Open Forum programme and welcoming many of you along.

If you have any ideas for future Open Forums, please email me at:

openforums@cotswoldsculptorsassociation.com

With best wishes,

Juli

(Open Forums)

EVENTS & CALENDAR

Key dates

- Miserden:
 - **1st & 2nd June** - Installation days at Miserden
 - **3rd June - 2nd August** - Creating Spaces 2026 Indoor and Outdoor Exhibitions at Miserden (open Wednesday – Sunday)
 - **6th June** - Private view – details coming soon
 - **14th June** - Artist Demonstration Day at Miserden
 - **3rd August** - Exhibition take down

Committee Meetings

- 7th April, 5th May, 2nd June ...
- Our committee meetings are usually held on the **first Tuesday evening of each month** at **7.30pm**, and **all CSA members are welcome** to attend. We'd love to hear your views. Most meetings take place via **Zoom**, with the occasional in-person meet-up.
- If you'd like to be included, please email [**info@cotswoldsculptorsassociation.com**](mailto:info@cotswoldsculptorsassociation.com).

OPPORTUNITIES

Residencies, grants, workshops and other opportunities

Hungary Residency 2027

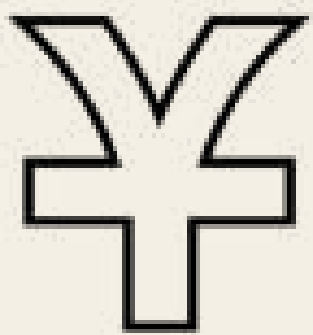

NEMZETKÖZI KERÁMIA STÚDIÓ
INTERNATIONAL CERAMICS STUDIO
<http://icshu.org>



We are thrilled that we have 9 people joining the 10 day Clay Residency in Kecskemet, Hungary next year.

The Dates 30th March - 9th April 2027.

A 50% deposit is needed in April to confirm your place and I am currently waiting to hear exactly how much this will be.

If you want to know more please get in touch asap - Shirley Sharp:

sharpsh@icloud.com

OPPORTUNITIES

Newark Park



Update: Plans are progressing behind the scenes for this exciting relationship between the CSA and National Trust, beginning with a small site specific exhibition. More details to follow very soon.

Grants / Workshops / Other Opportunities:

We'd love to share more opportunities with our members — from grants and bursaries to workshops, courses, residencies, and anything else that might support creative development.

If you know of something that could benefit fellow sculptors, please pass it on.

Send details to:

sculptureloop@cotswoldsculptorsassociation.com

SPOTLIGHT

member profiles

Member Profiles

Each edition, we shine a light on a handful of our members - sharing their stories, inspirations, and sculptural journeys:

This time, it's the turn of:

(Click on a member below to read their full profile.)



Kay Singla



Darren Rumley



**Elliot Dylan
Quinn**

Join the Sculptors Gallery

Not all CSA sculptor members yet have a profile in the online **Sculptors Gallery** - and we'd love to showcase more of your work.

Gallery pages also provide the material for our newsletter Spotlight features, so having a profile means you could be featured here too.

if you're a member and want be included, send:

- A short bio (150–200 words)
- 2–3 good quality images (jpeg, max 1mb)
- Website / social / email links (optional)

to: **info@cotswoldsculptorsassociation.com**.

SPOTLIGHT

Kay Singla



Kay has been sculpting for over thirty years and is a member of several art societies. She creates most of her work at her studio/workshop in Buckinghamshire. She is an experienced tutor and voluntarily teaches at children's schools. Kay exhibits all over the country, including at several prestigious National Trust properties. Her work is both tactile and contemporary and is a reflection and expression of happiness, family, love and togetherness. Kay's vision is for her work to be enjoyed by viewing and by feeling its texture. She works with many different materials such as clay, ciment fondu, bronze resin and marble resin. She makes a combination of indoor and outdoor pieces and most of her work is unique or limited edition.



SPOTLIGHT

Kay Singla - cont.

Kay has exhibited her work at many events and exhibitions both nationwide and abroad. Some of her most prestigious venues include the NEC in Birmingham, Winchester College and Lincoln's Inn. Over the years she has also donated many of her pieces to raise money for charitable causes. Her sculpture 'Content' won the Sculptors' Own Prize in 2013 in Chelsea and she was 'Highly Commended' for her sculpture 'My Girl' in Chelsea in 2022 as well as winning the Sloane Stanley Prize for her piece 'My Love' in 2024.



Web: www.ksculptures.co.uk

Instagram: [@singlakay](https://www.instagram.com/singlakay)

Email: ksinglasculpture@gmail.com

SPOTLIGHT
Darren Rumley

The artist behind One Artisan who has a passion for unique and functional concrete: “Concrete as you’ve never seen it!”. Creating pieces that can be used inside and outside the home, as well as commercial pieces for large scale architectural projects.

Having been born and brought up in the Cotswolds, Darren now designs and creates from his workshop in Stroud, Gloucestershire. During his early life, he struggled with severe dyslexia and has got past this disadvantage by working with his hands and creating the pieces that you can see today.

Some of his larger pieces can be seen in situ at Mermaid Quay in Cardiff, Wales and Silverburn Shopping Centre in Glasgow, Scotland. Smaller pieces, such as lamps, tables and water features, are also available for those who wish to have something unique in or around the home.

SPOTLIGHT

Darren Rumley - cont.

Endorsed by famous faces such as Toyah Willcox and featured on television programmes including Love Your Garden with Alan Titchmarsh, Darren's work can become a conversation starter and enhance the ambience of any private indoor or outdoor space.

As the One Artisan brand grows, so does the artists aspiration to add more sculptural pieces to the collection that encourage people to think about concrete itself, the art and what it represents. The very ethos of One Artisan is to create "art with a function" and to show everyone "Concrete as they've never seen it!".



Web: www.oneartisan.co.uk

Instagram: [@onerumley](https://www.instagram.com/onerumley)

Email: info@oneartisan.co.uk

SPOTLIGHT
Elliot Dylan Quinn

Originally from Suffolk, Elliot discovered a passion for clay work after moving to Oxfordshire in 2022. Their art is a deeply personal exploration, shaped by their experiences with schizophrenia. Sculptures often represent the creatures and forms they encounter during difficult times, turning what could be an isolating experience into one that can be shared and understood through art.

Elliot works primarily with clay, drawn to its raw, organic texture that allows them to mould their inner visions into tangible forms. Their sculptures often blur the line between reality and imagination, inviting viewers to engage with the unseen worlds that others may navigate silently. This creative process is both therapeutic and communicative, offering insights into mental health through a unique artistic lens.

SPOTLIGHT

Elliot Dylan Quinn - cont.

Inspired by the natural world and the surreal landscapes of the mind, Elliot's work captures a blend of earthly and fantastical elements. Their goal is to use art as a bridge to foster empathy and understanding, highlighting the complexity and beauty of the human experience.



CSA Web page: elliott-dylan-quinn

Email: elliottdylanart@gmail.com

INSPIRATIONS **new**

Films, Podcasts, Books & Exhibitions to inspire

Each edition will feature a curated selection of films, podcasts, books & exhibitions - chosen by and for sculptors and makers. Entries will also be added to our *Inspirations* collection, a growing resource of creative inspiration - coming soon. Send your recommendations to:

sculptureloop@cotswoldsculptorsassociation.com

 **Arena - Henry Moore**

John Read shares his memories of Henry Moore, who he filmed six times over 28 years. (1986)

Highly recommended!

Originally broadcast 7 Sep 1986.



50 mins

B B C

 **A masterclass with Antony Gormley**

Antony guides young artists studying at Goldsmiths in the expressive medium of clay, encouraging them to explore their creative instincts.



23 mins

B B C

INSPIRATIONS

Sculpture Vulture

A podcast hosted by conservator Lucy Branch, featuring conversations with sculptors about public and historic sculpture, materials, and creative practice. www.sculpturevulture.co.uk



 Apple Podcasts

 Google Podcasts

 Listen on
Spotify Podcasts

Extraordinary Creatives

Hosted by Ceri Hand, this inspiring art podcast features in-depth interviews with exceptional artists and creative leaders exploring ideas, resilience, and artistic journeys. cerihand.com



 Apple Podcasts

 globalPLAYER

 Listen on
Spotify Podcasts

The Sculptor's Bible

A comprehensive guide to sculpting techniques and surface effects across media, with step-by-step instructions and colour photos to inspire and inform sculptors. By John Plowman.

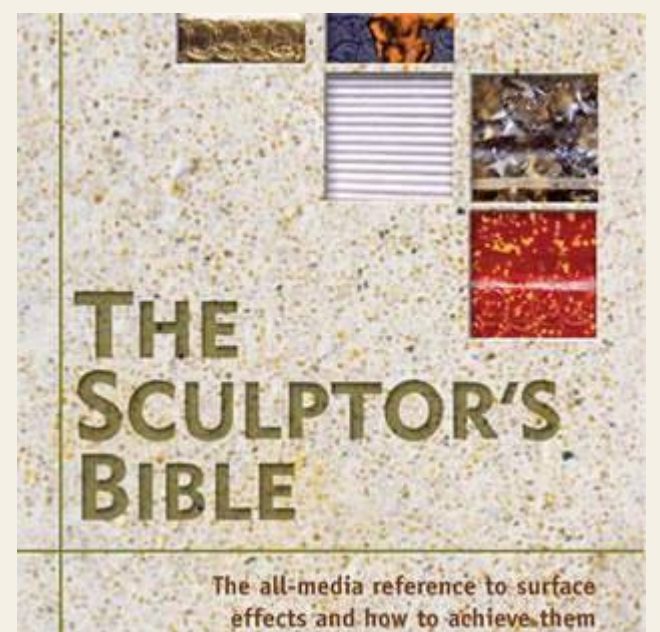

 World of Books

 goodreads

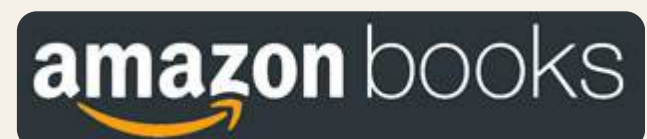
 amazon books

ASSOCIATION NEWS

[Chair's notes](#), [committee updates](#), [exhibition news](#).

Welcome to Our New Chair

We're delighted to welcome **Gina Baum** as the new Chair of the CSA.



Gina brings a wealth of experience as both a practising sculptor and an active member of the CSA community. We're very much looking forward to her leadership as the organisation continues to grow and develop.

We're grateful to Gina for stepping into the role and wish her every success.

Website: www.ginabaumart.com

Instagram: [@gina_baum_snakesholestudio](https://www.instagram.com/gina_baum_snakesholestudio)

Email: ginabo707@gmail.com

ASSOCIATION NEWS

AGM Highlights

A roundup of highlights from the **AGM** - Our hugely enjoyable Annual General Meeting which was held on 7th February 2026 in Malmesbury Town Hall:

Leadership & Thankyous:**New Chair and Treasurer Appointed**

We warmly welcomed **Gina Baum** as **Chair** and **Zoe Hawkins** as **Treasurer**.

Heartfelt thanks were given to **Shirley Sharp**, stepping down after six years as Chair, and to **Sarah Cushing**, whose six years as Treasurer have been invaluable.

Lynda Knott also steps back from committee duties but continues with Outdoor Curation.



ASSOCIATION NEWS

AGM Highlights - cont.

Membership Growth & Hubs:**Membership Now at 134 and Growing**

CSA now has 134 members, including student and friend memberships - a healthy increase from last year. Our regional hubs continue to grow and create vibrant local networks, with recent activity including exhibitions, experimental projects and collaborative firings.

We are currently seeking hub co-ordinators in **Cirencester, Bristol/Weston-super-Mare and Chipping Norton/Burford.**

**“One Thing a Year”:**

Our new Chair **Gina Baum** encouraged members to contribute just one extra thing each year - whether stewarding, writing a short SLOOP article, helping with digital skills, organising a hub meeting or supporting curation. Small contributions collectively sustain a thriving association.

ASSOCIATION NEWS

AGM Highlights - cont.

Exhibitions – Key Highlights:

**Miserden 2025 Highlights**

124 sculptures from 38 sculptors were exhibited outdoors at Miserden. A new stewarding tent increased engagement with visitors and introduced both a children's trail and a Visitors' Choice award, won by Malcolm West for *Tango Appacionata*.

Plans are underway for 2026, including improved signage between outdoor and indoor spaces.

Indoor Exhibition – Brimscombe Mill**Creating Indoor Spaces – Over 1,000 Visitors**

Our 2025 indoor exhibition at Brimscombe Mill featured 124 sculptures from 42 members and welcomed over 1,000

visitors across ten days. The collaboration with the Long Table and the Autumn Trail expanded our audience and brought new visitors to the site. In 2026 the indoor exhibition returns to Miserden to align with the outdoor show.



ASSOCIATION NEWS

AGM Highlights - cont.

Open Forum Visits & Artist Talks

The 2025 programme included a photography masterclass with **Andrew Stevens**, visits to **Puppet Place** and **Gloucester Cathedral's stonemasons**, and a reflective artist talk from **Ben Broadbent**. Recorded talks are available on the [Members Page](#).

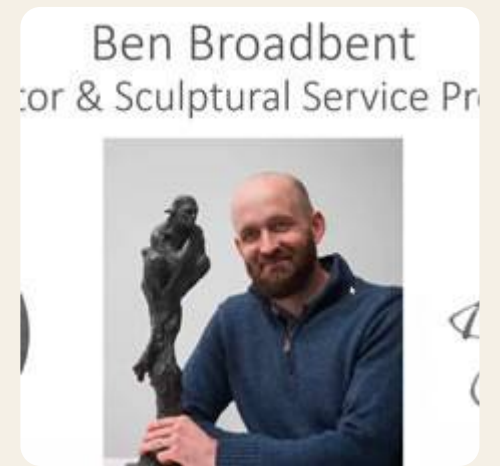

Sustainability Initiative

A new member-led Sustainability Group is being formed to share ideas and practice via WhatsApp.

In the Pipeline – Forward Momentum Looking Ahead

- National Trust residency at Newark Park (details to follow)
- Clay residency opportunity in Hungary, Easter 2027
- Continued exploration of new exhibition partnerships

ASSOCIATION NEWS

AGM Highlights - cont.

Constitution Review

The committee is reviewing aspects of the Constitution to reflect how the organisation has evolved. A Special General Meeting will be called to vote on proposed changes.

A Fresh Look for CSA



Cotswold Sculptors Association



COTSWOLD
SCULPTORS

You may notice a refreshed visual identity across our website, exhibitions and publications.

Developed by the marketing team, the updated logo and colour palette create a clearer, more contemporary presence while reflecting the inclusive, member-led structure of the Association. Branding guidelines are available to members for use in hub and main exhibitions.

Click [here](#) to learn more.

MEET THE TEAM

The committee members and roles -
new faces are always welcome!

new



Gina Baum
Chair



Anna
Simson
Secretary.



new

Zoe
Hawkins
Treasurer



Juli
Bharucha
Open
Forums



Ange
Williams
Website



Jenny
Baddeley
Marketing



Jane Yarnall
Membership
Secretary.



Jan Bruce
Sculpture
Loop

GET INVOLVED!

As our committee evolves, members will inevitably step down. To ensure smooth transitions, we're inviting members to **shadow existing committee roles** and learn how the CSA is run.

We're delighted that **Gina Baum** has now officially taken over from **Shirley Sharp** as Chair, and **Zoe Hawkins** has now taken over from **Sarah Cushing** as Treasurer. Huge thanks to Shirley and Sarah for their dedication in these roles over the years - their contribution in shaping the CSA has been hugely valued. The committee continues to go from strength to strength - and we'd now love to bring a few more people on board.

If you're interested in contributing a little time and learning how things work behind the scenes, please get in touch:

info@cotswoldsculptorsassociation.com

Current opportunities include:

- **Website Management** - **Ange Williams** keeps the CSA website up to date and would be happy to show someone how it's done.
- **Curating** - Our exhibition teams are always glad to have extra hands and fresh ideas.

Getting involved is a great way to meet other sculptors, gain experience, and help the Association thrive.

RESOURCES

[Discounts](#), [Services](#), [Marketplace](#)

Discounts

There are a number of discounts which have been negotiated for CSA members, if you are a member then login to the [members area](#) and take advantage using the codes provided.

RESOURCES

Services

Apex Art Services



With 20 years of dedicated experience in art casting, Ben Broadbent at Apex Art Services brings expert craftsmanship and an artist's sensitivity to every project.

- Mould Making– Precision mould-making services for artworks, with a careful eye for detail to capture every nuance.
- Cold Casting in Acrylic Resin – Environmentally friendly cold casting options for your sculptures with a range of finishes.
- Large Sculpture Assistance– From armature creation and scale-ups to block-outs and clay modelling support, we assist every step of the way for sculptures of all sizes.
- Foundry Assistance– Need guidance with foundry processes? We provide help with wax work, metal finishing, and foundational patinas to ensure your work looks just the way you want it.
- One-on-One Tutoring– We offer personalised instruction in any of our services for those looking to develop their skills in mould making, casting, sculpture techniques, and more.

www.benbroadbent.com/services

RESOURCES

Services

Life Model Available - Alys



With nearly two decades of experience as a professional artists' model, Alys brings a deep understanding of the artistic process and a strong, expressive presence to every session.

She began her modelling career in London, working full time with art schools, universities, independent artists, sculptors, and photographers across a wide range of creative settings.

Now based in Bristol, Alys is looking to expand her client base and welcomes collaborations with artists, institutions, and groups throughout the area. Whether you're working on traditional figure drawing, photography, sculpture, or experimental media, she's happy to discuss your specific needs and tailor her approach accordingly.

Alys has a background in performance and the arts, which informs her dynamic and thoughtful modelling style. She values the creative exchange between artist and model, and takes pride in being part of a process that fosters inspiration, focus, and artistic growth.

Feel free to get in touch with any questions or to discuss a potential booking.

References are available on request.

Email: alys_scratchley@hotmail.com

Tel: [07824_381225](tel:07824381225)

Instagram: [@alys_scratchley](https://www.instagram.com/alys_scratchley)

RESOURCES

Marketplace

For sale:

selection of marble bases for sculpture.

If interested please email me:

stephaniejcushing@gmail.com buyer to collect or
arrange meet up at open forum.



Carrara Marble
30x39x5cm
8mm pin hole:
£50



Carrara Marble
40 x40x 7cm
15mm hole not
all way through:
£50



Granite
50x25x5cm: £50

RESOURCES

Marketplace

For sale:

Walnut tree trunk

Walnut tree trunk for sale.

- Completely straight and smooth
- 3ft 8" in height
- 5 and 3/4 inches in diameter
- Open to offers but should imagine someone would need to see it first.
- Contact: Tony Gibbons, Cheltenham,
tel: 01242 232126

If you're a member and would like to advertise your items or services, please send your ad to:

sculptureloop@cotswoldsculptorsassociation.com

Ad guidelines: max 1 page, to fit width 1020px, max height 1550px. Thank you.

STAY CONNECTED

Social media & newsletter contributions

Connect with the CSA:



[Instagram](#)



[Facebook](#)



[Website](#)



[Email](#)

Connect with other members with our
WhatsApp community groups

see [here](#) for details (members only)



[WhatsApp](#)

Social Media

Please tag [@cotswoldsculptorsassociation](#) into
your posts and/or hashtag **#creatingspaces2025**

Newsletter contributions:

Sculpture Loop is an important communications channel for keeping our members and everyone who has subscribed to it updated on what is happening in CSA.

We have over 300 subscribers to Sculpture Loop and your contributions are essential in making it informative, interesting and relevant on a quarterly basis.

Please send your feedback, articles, images and information for inclusion to Jan Bruce (editor) at:

sculptureloop@cotswoldsculptorsassociation.com

JOIN US!

Join the Cotswold Sculptors Association

Become part of a vibrant sculpting community!

As a member you can:

Exhibit in stunning venues across the Cotswolds

Join artist talks, studio visits & Open Forums

Connect through local Hubs & WhatsApp groups

Share skills, ideas and opportunities

Promote your work on our website & social media

Advertise your workshops or courses

Membership from just £20 ~ £40 per year.

We are run by members, for members - your creativity and skills are welcome!

 Join us today:

www.cotswoldsculptorsassociation.com/join-us

or email us at:

membership@cotswoldsculptorsassociation.com

SUBSCRIBE & SHARE

Enjoyed this edition of Sculpture Loop?

Our quarterly newsletter is free and open to everyone - no membership required.

If this newsletter was forwarded to you and you'd like to receive future editions straight to your inbox, you can subscribe for free here:

 [Subscribe](#) 

You can unsubscribe at any time.

Do you know someone who might enjoy Sculpture Loop?

Feel free to share this edition.



[Share via](#)
[Email](#)



[Share via](#)
[WhatsApp](#)



[Share via](#)
[Facebook](#)

Stay tuned for the **next edition, coming 5th June** - and don't forget, we'd love your contributions and content recommendations.



© 2025 Cotswold Sculptors Association. All rights reserved.
Images © respective artists. Used with permission.