

# LET'S MINGLE

TERRACE MAGAZINE 2025

**SATELLIET®**  
hospitality furniture

# LET'S MINGLE

## TERRACE INSPIRATION 2025

We are pleased to present the Terrace Magazine for 2025: a reflection of our vision for hospitality. A special edition full of tips, entrepreneurial stories, and inspiration for your outdoor space. Discover a surprising mingling of projects, materials, colours, and designs that bring your terrace to life. Our goal? To inspire you to create that special place where people want to come together and make lasting memories.

A well-designed terrace is the heart of any hospitality venue – a place where guests feel welcome, regardless of the season. Whether you choose trendy, exuberant, over-the-top, bohemian, social seating, or classic vibes, our extensive collection offers everything you need to translate your concept to your terrace. Our specialists also help you find the most sustainable and efficient layout and routing for any shape, size, and location of your terrace zone. Let your outdoor space speak with a variety of seating options and create a vibe that invites connection, from the first rays of sunshine to the winter evenings. From comfortable chairs to modular sofas, tables, cushions, and stylish accessories: everything you need to furnish your terrace can be found in our extensive terrace collection. Make a statement with your terrace and a great diversity of seating options and welcome your guest at any time of day, in any season of the year.

Together, we create terrace zones that are not only functional but also memorable. Let's mingle to build places that stand out. Our motto is not without reason – creating places to remember. We wish you a successful terrace, in all seasons.





# CONTENTS

## TRENDS

- 9 Fluidity
- 23 Let's Mingle

## INSPIRATION

- 15 Brasserie De IJsboetiek Kesteren
- 29 Beekse Bergen Hilvarenbeek
- 32 Ciao Belli Breda
- 33 Our Service

## COLLECTION

- 5 BOHEMIAN ELEGANCE
- 7 SUSTAINABLE & COLOURFUL
- 11 RETRO WITH A TWIST
- 13 COOL, STYLISH & VERSATILE
- 19 SMART & CLASSY
- 21 SOCIAL SEATING
- 25 COMFORT GUARANTEED
- 27 INVITING SETTINGS
- 31 TABLES & TABLE BASES
- 35 ACCESSORIES & TABLE TOPS

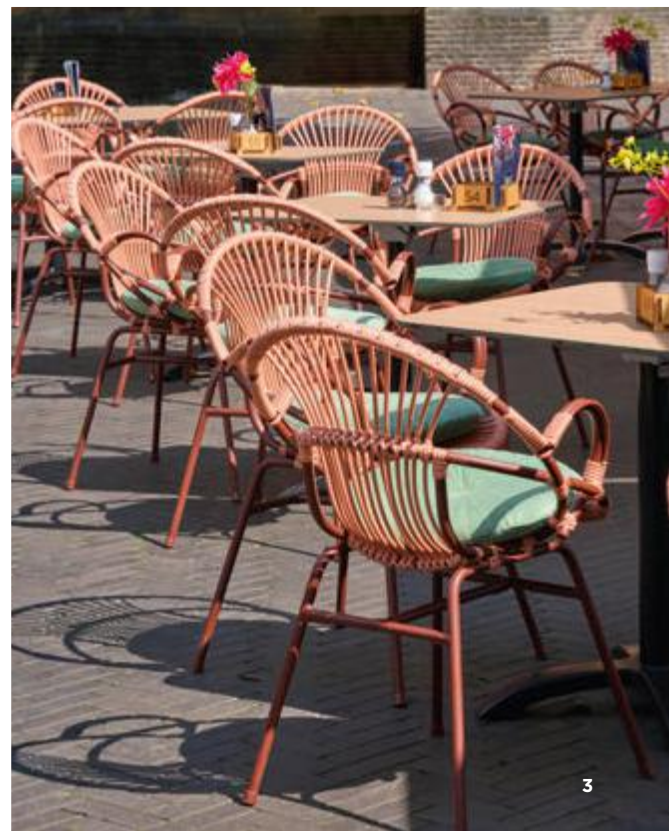



XAVA AC

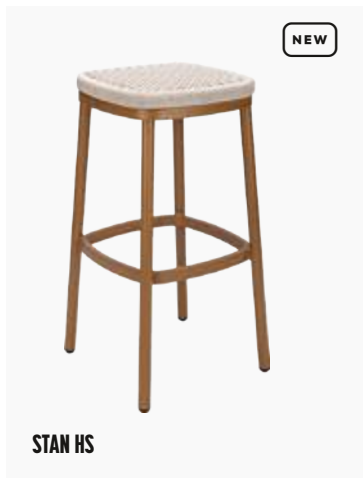

STAN HS



STAN HS



STAN HS

XAVA

# BOHEMIAN ELEGANCE

Create the restaurant experience on your terrace with this selection of classy terrace furniture. All these models guarantee an experience with class and fun. Ibiza vibes, that's what the relaxed Xava radiates. This model features woven ropes, perfectly on trend and hip. The biggest surprise lies in the tubing, which is made of aluminium, but with the look and feel of a wooden frame. This chair, designed by Studio Satelliet, is lightweight, suitable for outdoor use, and stackable. The natural character of the Xava beautifully harmonizes with natural accents and lush plants. This way, you create an outdoor space that invites relaxation and enjoyment in bohemian elegance.



NEW



LEVI AC



LEVI AC



LEVI AC



LEVI AC







ARCADIA SC



ARCADIA SC



ARCADIA SC



ARCADIA HS



CODE

NEW

# SUSTAINABLE & COLOURFUL

Colour brings joy to everyone! Popular are soft, nude shades like taupe and vanilla yellow combined with bolder, eye-catching colours like burgundy and petrol. By creating colour combinations that match, you can create a trendy terrace with inviting contrasts. Let your terrace shine with this colourful code. The frame is made of recycled aluminium, and the seat and backrest are made from 'post-consumer waste'. How? Recycled aluminium is used to extrude tubes and form the frame. The seat and backrest are made from recycled plastic. The plastic is sorted by colour and then remelted, creating the characteristic base colour with cheerful speckles. Now also in trendy ivory shade. With this sustainable approach, you effortlessly combine environmental friendliness with style.



CODE SC



CODE AC



CODE AC



CODE HS





NEW (S) CODE



INTERPLAY OF LINES

# FLUIDITY

Fluidity brings movement and flexibility to interiors with modular furniture and multifunctional spaces. Organic shapes and soft lines create a welcoming, fluid look. Fresh pastel colours like blue, mint green, and vanilla yellow, combined with materials such as glass, steel, and velvet, create a playful, modern atmosphere. Fluidity reflects diversity and change. Go with the flow.

CREATE A  
PLAYFUL MODERN  
ATMOSPHERE



NEW (S) GIROLA



CHANTILLY AC



CHANTILLY AC



CHANTILLY SC



CHANTILLY SC



CHANTILLY

# RETRO WITH A TWIST

Retro with a twist and romantic without being overly decorative. Allow space for a light, feminine retro style full of round shapes, soft fabrics, and floral patterns. A bit quaint but also tough. Round and retro, but also soft, tactile, and playful. That's Chantilly, a chair of curved steel, a classic design, and a soft touch through cushions with fringes. Give your terrace allure with this eye-catching piece from Studio Satelliet for Satelliet Originals. Its elegant shapes invite relaxation, while the playful details add a twinkle. Perfect for those who love a touch of nostalgia combined with contemporary flair.



MARAIS AC



MARAIS AC



MARAIS AC



TWINE AC



CANNES SC



CANNES AC



CANNES SC



CANNES AC



CANNES SC



CANNES AC



CANNES B



GERMAIN SC



TWINE LS



CANNES HS



TWINE AC



TWINE AC



TACO

# COOL, STYLISH & VERSATILE

Taco is the perfect mix of style and comfort. Its sleek black steel frame exudes finesse, while the seat shell made of plastic weave provides a light and playful look. Taco is available in two stylish versions: classic black or a natural rattan look. Give this showstopper a personal touch with a soft cushion in your chosen fabric. The series offers plenty of variety: an armchair, a chair without armrests, and a stool. Whether it's on your terrace, veranda, or at the bar, Taco brings character and practicality to any space. With its timeless design, Taco effortlessly fits into both modern and bohemian settings. Taco invites you to mingle and relax for hours.



550 SC



550 AC



550 HS



TACO SC



TACO AC



TACO HS



TWIST LSC

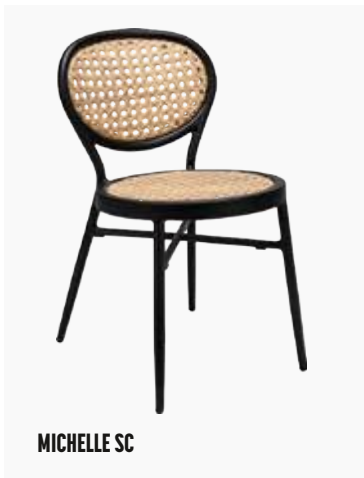

**BRASSERIE DE IJSBOETIEK**

# YEAR-ROUND TERRACE ENJOYMENT

## LA DOLCE VITA IN THE BETUWE

Nestled in Kesteren, a village surrounded by orchards and natural landscapes in the heart of the betuwe region, you'll find Brasserie De IJsboetiek. This dream spot, owned by Paul and Anisa Gootjes, offers an all-day experience of lunch, drinks, and dinner with a hint of Italian 'la dolce vita.' their newly revamped, year-round terrace allows guests to enjoy warmth, ambiance, and comfort even in the colder months. 'Our aim is to be welcoming, distinctive, and accessible,' Paul says. 'We want everyone to feel at home here, all day.'

## COUNTRY CHARM

'Kesteren is the fastest-growing village in the area,' Paul explains. 'The population has nearly doubled recently, and tourism is on the rise. This creates exciting opportunities for regional entrepreneurs. Locals now have access to everything - retail, hospitality, and leisure - right on their doorstep.' Paul and Anisa have over four decades of combined hospitality experience. About a year and a half ago, the opportunity to take over De IJsboetiek in the heart of town felt like destiny. 'The charming village, hardworking people, and local culture resonate with us. This is a forward-thinking area with rural charm, a place where we thrive. We've expanded the original ice cream parlour into a brasserie with a focus on lunch, drinks, and dinner. Ice cream and cocktails are our signature items. The location is intimate but well-planned, allowing us to host many guests with ease. Our hospitality is distinct, guests feel pampered and are met with a courteous approach.'





## ZONED TERRACE

Brasserie De Ijsboetiek has a warm Mediterranean style with rural charm, designed by Corine Roodbeen from Event & Style. 'We wanted to extend the 'wow' feeling from inside to the terrace,' Paul shares. Their slogan, 'Ice, Ice Baby,' inspired by Vanilla Ice's song, matches the bohemian vibe, eclectic decor, and concept. Paul explains, 'The outdoor area was also carefully designed to enhance ambiance. In the Satelliet showroom, we put together a mix of furniture that exudes coziness, luxury, and comfort. To connect the indoors and outdoors, we have Portuguese-tiled tabletops on the terrace, bordered with a luxurious copper edge for extra flair.'

“WE WANTED TO EXTEND THE 'WOW' FEELING FROM INSIDE TO THE TERRACE”

Efficiency is key in setting up a terrace. 'Thoughtful layout and routing make the service and logistics flow smoothly,' Paul adds. The L-shaped terrace is split into zones. Larger Sigma benches provide a spot for ice cream, while groups enjoy drinks in a sunken seating area surrounded by hedges. In the garden, by the conservatory, you can relax in bohemian Twine chairs and Taco's, sheltered among the trees. Although the terrace is cozy with varied seating, it can accommodate up to 130 guests.

[Read more >](#)





## BULL'S-EYE

‘In summer, we have ample terrace space,’ Paul says. ‘We wanted to offer that same comfort and coziness year-round, so we’ve covered the terrace with a stylish garden conservatory in line with the brasserie’s ambiance. It’s been a big hit, with bookings for birthdays, high teas, and baby showers pouring in. The conservatory has become a warm, inviting space to gather, even on colder days. We adapt the decor seasonally, as we do with the menu, and ice cream can be enjoyed year-round.’

The terrace is decorated with cozy lighting, blankets, and winter decor, making it as inviting as it is in summer. ‘Some people even drive by filming - we’ve become a real attraction,’ laughs Paul. ‘We put a lot of effort into beautiful decor, and it’s rewarding to see that we’re Instagrammable, with people sharing and posting about our ambiance.’





**“WE BELIEVE THAT FOOD AND DRINKS  
BRING PEOPLE TOGETHER. THAT’S  
WHY WE WORK WITH SO MUCH  
PASSION AND ENERGY EVERY DAY”**

## BUZZ AND EVENTS

Brasserie De IJsboetiek buzzes with liveliness year-round. ‘Each season is celebrated with a beautifully decorated terrace, complete with warm lighting, decor, and music. During village events like Winterfair, King’s Day, and the annual fair, we go all out with live music, fire pits, and a beer carousel. The terrace becomes a lively gathering place for all ages, a full-on celebration,’ says Paul excitedly as De IJsboetiek’s illuminated sign shines, catching the eye of passersby. With ‘service with a smile,’ genuine attention, and an ever-changing menu of seasonal dishes, unique ice cream flavours, signature cocktails, and beer of the day, De IJsboetiek continually surprises guests. At the same time, this motivates and challenges its employees to remain creative and innovative.

## FUTURE AMBITIONS

Paul and Anisa’s ambitions extend beyond Brasserie De IJsboetiek. Inspired by its success, they are planning a second concept: De Koffieboetiek. ‘We want to give a new dimension to the warmth and atmosphere that De IJsboetiek exudes,’ says Paul. ‘A place that connects and where hospitality always comes first.’

■ [DE-IJSBOETIEK-KESTEREN.NL](https://de-ijsboetiek-kesteren.nl)





CELSIUS

# HEAT YOUR SEAT NOT THE PLANET



Scan the QR code  
for more information  
about Celsius.



CELSIUS AC



CELSIUS AC



CELSIUS AC



CELSIUS AC



Enjoying the terrace all year round is possible with the award-winning, innovative heated terrace chair Celsius. This sustainable co-creation by Satelliet and Sit & Heat serves as a worthy replacement for traditional terrace heaters and offers your guests a pleasant, comfortable terrace experience. Heat your seat, not the planet – that's the vision behind this first terrace chair with a smart and fully integrated heating system. Guests can individually adjust the intensity of the backrest and seat heating with a three-stage switch for personalized comfort.

With the Celsius terrace chair, there's no longer a need for a terrace heater that constantly operates and heats not only the guest but the entire environment. The energy savings compared to traditional heating systems are about 95%. In multiple ways, the Celsius chair offers a sustainable way to operate a year-round terrace. In an environmentally friendly and cost-efficient manner, as the sensor in the seat registers when a guest takes a seat. This ensures that Celsius uses energy only while it is in use.



ENERGY AND  
COST SAVING



SUSTAINABLE  
ALTERNATIVE



ENHANCED  
GUEST COMFORT



SMART  
TECHNOLOGY



USER  
FRIENDLY



POSITIVE ON  
REVENUE



TAPE

# SOCIAL SEATING

NEW

Experience social seating to the max with the playful, multi-functional Tape. A comfortable, modular terrace sofa with woven straps that can be endlessly rearranged. Ideal for groups to sit together comfortably. Is a U-shape your ideal form or do you prefer a ribbon setup or half-moon? Lounging in the traditional 'sofa plus two armchairs' setup is also an option. Give your creativity all the space. The comfortable, lightweight Tape sofas are a real eye-catcher on the terrace.

The playful character of the Tape allows you to be creative without compromising on comfort. The wide cushions invite you to relax, while the modular design allows for endless possibilities. Whether you're designing a hotel terrace, setting up a trendy rooftop bar, or bringing a modern outdoor space to life – Tape offers infinite options. A cozy semicircular corner for a group of friends or an open structure? Tape adapts effortlessly.



TAPE END LEFT BA | TAPE QUARTER B

NEW



TAPE END LEFT BA | TAPE END RIGHT BA

(S)

NEW



TAPE QUARTER LB

(S)

NEW



TAPE LAC

(S)

NEW



TAPE LBA

(S)



CALYPSO LOW LAC



CALYPSO HIGH LSC

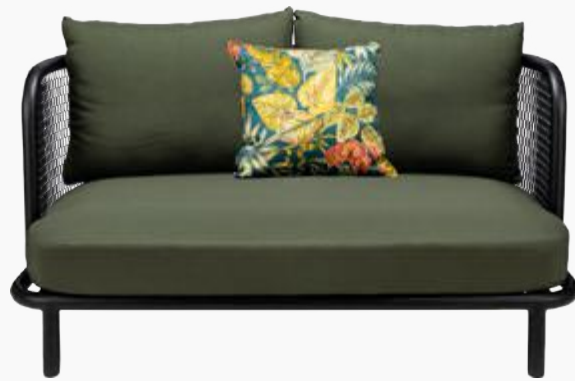

TERRA LBA



TERRA 2-SEATER BA



TERRA QUARTER B



TERRA QUARTER COVER



TERRA END LEFT BA | TERRA B | TERRA END RIGHT BA





STRENGTHEN THE TIES

# LET'S MINGLE

Take guest experience to the next level with an inviting and dynamic terrace filled with warm colours, stylish materials, and soft shapes. Let's Mingle encourages guests to come together, share experiences, and connect. Long tables, comfortable sofas, and communal seating areas foster strong social dynamics and a cosy, welcoming atmosphere. Let's Mingle strengthens the bonds.

TRENDY  
MATERIALS,  
SOFT DESIGN



NEW (S) TAPE

SEVILLA

# COMFORT GUARANTEED

Comfort guaranteed with the fully upholstered seat and back cushions of the Sevilla sofa. Two flexibly developed modules allow you to form this comfortable sofa in any imaginable setup. With Sevilla, you combine versatility and luxury, perfect for both large and compact outdoor spaces. Bring indoor comfort outside with the comfortable Sevilla sofa, as all applied materials are suitable for outdoor use. With an aluminium frame, rust stands no chance.

NEW



SEVILLA B | SEVILLA QUARTER B

NEW



SEVILLA B

NEW



SEVILLA QUARTER B



BARCA CORNER LB



BARCA CORNER LB | BARCA LB



DENTRO 4P T



DENTRO 8P T



LOEFF IROKO OUTDOOR HB



LOEFF IROKO OUTDOOR B



LUNA DINER B



LOEFF ECO OUTDOOR B



LUNA CORNER LEFT LB | LUNA LB | LUNA CORNER RIGHT LB

OLAV

# NEW MEANING TO COSY

Because this round-shaped sofa consists of separate parts, the Olav Quarter can be flexibly placed as a semicircle or three-quarter rounding. The black frame of thermally galvanized steel, combined with Iroko wooden slats, gives this model a warm appearance. Thanks to its smart design, the sofa can be easily adapted to different spaces and atmospheres. Whether you want to create an intimate corner or an open, inviting setting, Olav adapts effortlessly. The term 'cosy sitting together' takes on a whole new meaning with this beauty from Studio Satelliet.



OLAV QUARTER B



SIGMA B



SIGMA HB

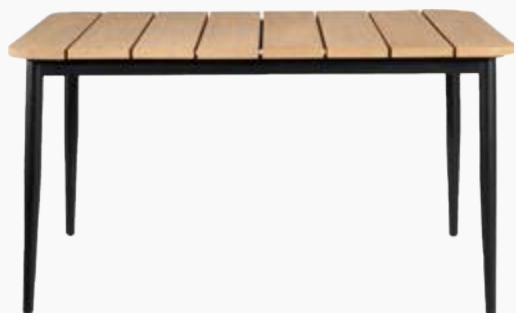

RIVER 140 T



RIVER 200 HT



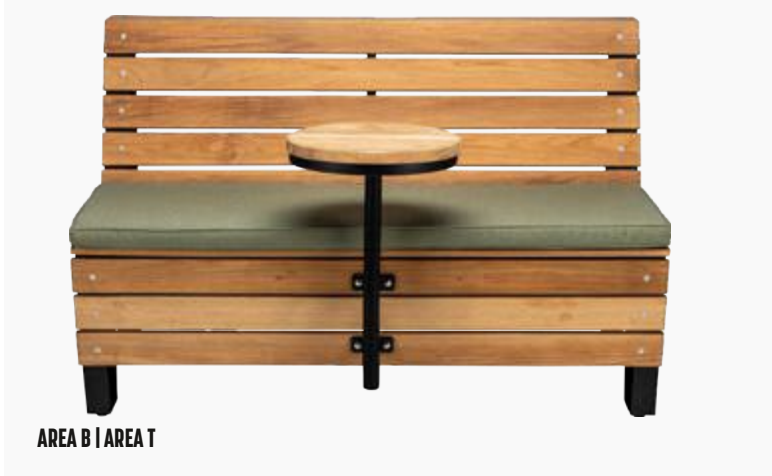

SAFARIPARK BEEKSE BERGEN

# AUTHENTIC KIKUYU FLAIR ON THE TERRACE

In the heart of Safaripark Beekse Bergen, within the African village on the savannah, Rick Merkx -designer at Libéma - has created a terrace that is both practical and an African experience. The vision is clear: the terrace must be a nod to the vibrant, traditional Kenyan Kikuyu culture with a contemporary twist. The result? A space that invites visitors to relax while being surrounded by nature and wildlife.

## A UNIQUE CHARACTER

The spacious hospitality square is divided into various zones with the Mugunda restaurant, the Kahawa coffee bar, and the Waru snack bar. 'We wanted to give each terrace its own character and identity,' Rick explains. 'It needed to align with the African village theme.' The challenge in designing this terrace lay in finding a balance between a natural appearance and modern, durable materials and furnishings suitable for heavy use. 'Choosing the right colours is an important detail,' Merkx notes. 'We wanted to preserve the vibrant, authentic colours of the Kikuyu culture and translate them into a contemporary, user-friendly style. For the base materials, we opted for plastic and metal due to their durability and strength. However, these materials have the look and feel of natural materials, which allows them to perfectly match the safari park's theme.'

## FUNCTIONAL ROUTING

A terrace must be practical as well as visually appealing, with attention to accessibility, flow, and the needs of diverse visitors. Rick elaborates: 'Our guests range from families with young children to older visitors with limited mobility and everything in between. The wide pathways accommodate wheelchairs, handcarts, and prams. By incorporating height variations in the seating landscape with different types of chairs, stools, and tables, everyone can enjoy optimal views of the animals and the surroundings, no matter where they sit on the terrace.'





## HEART OF THE SAVANNAH

At the Rhino and Elephant terraces, Safari Park Beekse Bergen offers truly spectacular views of the animals. 'Visitors can enjoy food and drinks in a relaxed, family-friendly setting while watching the animals in their natural habitat,' says Rick. 'The terrace – where all sightlines converge – is the heart of the savannah. The nature, the wildlife, and the terrace surroundings combine to create a harmonious experience that visitors will remember for a long time.'

■ [BEEKSEBERGEN.NL](http://BEEKSEBERGEN.NL)



## ADVICE ROUTING & LAY-OUT

When creating the most efficient possible layout for your terrace – while preserving seating capacity, comfort, appearance, and atmosphere – we are here to advise you. We collaborate with you on various configurations and a flexible layout so you can adapt to the continuously changing wishes and needs of your guests. Together, we will search for the ideal solution for your terrace, including considerations of budget, investment, and return. Ensuring that your terrace has an optimal routing and layout is what we stand for. Contact us for an initial consultation.

■ [SATELLIET.NET/TERRACE](http://SATELLIET.NET/TERRACE)

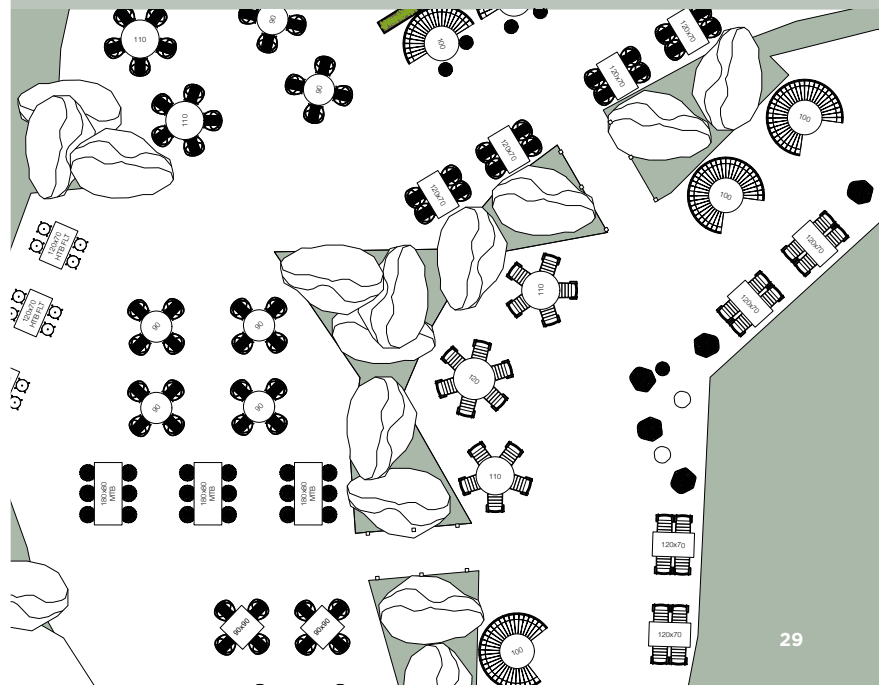

“A TERRACE MUST BE PRACTICAL AS WELL AS VISUALLY APPEALING, WITH ATTENTION TO ACCESSIBILITY AND FLOW”

TIPI

NEW

# VERSATILE FOR EVERY OCCASION

The versatile Tipi table is a recipe for fun in the sun. Choose your favourite tabletop, set it up on the terrace, and decorate it to your heart's content with flowers, plants, garlands, or lighting. You can place the functional, decorative table alone or connect multiple tables for even more variety and social interaction. With Tipi available in seated, standing, or counter heights, there's always a reason to celebrate.



TIPI HTB | TIPI TB



PILON OUTDOOR SMALL TB



STABLETABLE NOUVEAU TB



STABLETABLE SMALL TB



STABLETABLE RISE TB



STABLETABLE HTB



STABLETABLE RISE FLIPTOP TB



MIKADO TB



DOMINIQUE-3 TB



DOMINIQUE-4 TB



## TERRACE INSPIRATION

# LA DOLCE VITA

### ITALIAN ALLURE

Ciao Belli's terrace on the Grote Markt in Breda exudes a warm Italian charm that immediately invites you to sit down. Here - among the custom-built benches with red, cane, and whimsical striped upholstery - is where la dolce vita is experienced. A harmonious colour palette aligns with the striking Germain chairs.

“THE TERRACE SHOULD SPARK CURIOSITY AND BE AN EXTENSION OF THE INDOOR EXPERIENCE”

The symmetrical setup of the terrace highlights the entrance, complete with an inviting walkway that pulls you inside. Maurits Leeftang from Horeca Sfeermakers explains: 'The terrace should spark curiosity and be an extension of the indoor experience.' Functionality and style make Ciao Belli's terrace a true hotspot.





## SUSTAINABLE & FLEXIBLE

Furniture as a service means taking good care of your furnishings – from purchase to end-of-life cycle. With special services, we can keep your furnishings in good shape and give them a second life after use. To fully close the loop, we offer a flexible leasing structure for hospitality furnishings, taking care of the furniture throughout its lifespan and taking it back at the end. You can then opt for a new terrace while we incorporate the used furniture into our collection of pre-owned items. Additionally, we offer various solutions to keep your furnishings in top condition, including maintenance advice and parts.

Plus, a regular maintenance service that prolongs the lifespan of the furniture, winter storage, and a trade-in service with Euroseat. All these sustainable solutions provide you, our partner, with the opportunity to save costs and reduce your ecological footprint.

## OUR SERVICE

- Maintenance advice
- MOT service
- Winter storage
- Relocation
- Collection used furniture
- Furniture leasing *and more*



Scan the QR code for more information about our service.



## ACCESSORIES

# SMART & CREATIVE SOLUTIONS

All solutions that are perfect for creating a flexible terrace setup are our smart & creative solutions. Multifunctional terraces meet the needs of guests who may want to work remotely, relax, be secluded, or sit together. In this way, terraces are created that can adapt to the circumstances of the moment. Whether it's about storage, screening, or decorating your outdoor space, these items ensure an effective and attractive terrace. Complete the experience and create an inviting and comfortable terrace where your guests and staff feel at ease. Discover the many 'smart & creative solutions'.



FLAG LT



PICK UP LT



PLUS LT



BOTANIA PLANTER



BLOOM PLANTER



RIO PILLOWCASE



SERVICE TROLLEY



BLOOM WALL



NOMAD TROLLEY



TERRACE CHAIN SET



KILO



VERJO SQ



HEATED CUSHIONS



THERMO FRAKÉ



MANSONIA



TEAK NATURAL



IROKO



WERZALIT | EDGE BRASS



WERZALIT



COMPACT



ALUMINIUM

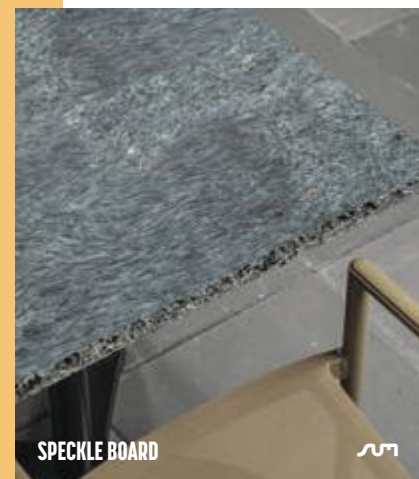

SPECKLE BOARD

## TERRACE TABLETOPS

Our extensive collection of tabletops offers a wide variety of materials. Whether you're looking for a natural ambience, a durable material, or a bold, timeless, or modern style, there's something for everyone. Each material has its unique characteristics and benefits, allowing you to choose what best complements the style and atmosphere you want to create. Sustainable Mansonia offers a warm, natural appearance that fits perfectly with a rustic or country setting, while aluminium is ideal for a modern, industrial look. Werzalit is extremely practical and low maintenance, while natural teak provides a timeless, luxurious look that lasts for years. When choosing the right tabletop material, you can consider both aesthetics and functionality. Find the perfect combination that seamlessly fits into your concept.

“EVERY MATERIAL  
HAS ITS OWN UNIQUE  
CHARACTERISTICS  
AND BENEFITS”



Scan the QR code for the complete fabrics & finishes collection.

# SATELLIET®

hospitality furniture

## Satelliet hospitality furniture

BREDA | THE NETHERLANDS | HEAD OFFICE

+31 76 522 53 10 • [www.satelliet.net](http://www.satelliet.net)



SATELLIETHOSPITALITYFURNITURE

## The Netherlands

### Amsterdam

tt. Melissaweg 43  
1033 SP Amsterdam  
Tel.: +31 20 633 51 88

### Dalfsen

Korenstraat 71  
7722 RS Dalfsen  
Tel.: +31 529 43 53 35

### Breda

Haagweg 241-243  
4812 XD Breda  
Tel.: +31 76 522 53 10

### Proud partner of

Inspirium Breda  
Inspirium Amsterdam  
[www.inspirium.nl](http://www.inspirium.nl)

## Satelliet international

### Belgium

Satelliet Belgium BVBA  
[www.satellietbelgium.be](http://www.satellietbelgium.be)

### Norway

Satelliet Norge AS  
[www.satelliet.no](http://www.satelliet.no)

### Germany

Satelliet Deutschland  
[www.satelliet.de](http://www.satelliet.de)

### Switzerland

Satelliet Schweiz  
[www.satelliet.ch](http://www.satelliet.ch)

### Luxembourg

Satelliet Luxembourg  
[www.satelliet.lu](http://www.satelliet.lu)

### United Kingdom

Satelliet-UK  
[www.satelliet.co.uk](http://www.satelliet.co.uk)

## International partners

### Estonia

Nord Interactives  
[www.nord-interactives.com](http://www.nord-interactives.com)

### Finland

Modeo Oy  
[www.modeo.fi](http://www.modeo.fi)

### Sweden

Resize Design  
[www.resizedesign.se](http://www.resizedesign.se)



**REQUEST NOW:  
CATALOGUE 2025**



Scan the QR Code,  
to request the  
catalogue 2025.