

PREFABRICATED BULKHEADS
FOR WINE CABINET & WINE CELLAR



SOPRA & CIELO



With 20 years of experience in the industry, we have encountered many work site situations that make the integration of refrigeration units difficult. That's why we have developed **simple and aesthetic refrigeration solutions** that integrate **seamlessly and harmoniously** to wine cabinets or custom wine cellars.

THE STARTING POINT FOR YOUR PROJECT.

Prefabricated in our factory and containing an LVG evaporator, the bulkheads are **ready to be installed on-site**. Designed to reduce installation costs, they make self-management easy and minimize the risk of errors related to coordination problems.

The bulkheads are designed to meet the essential conditions for the proper operation and performance of the refrigeration system. They ensure a completely insulated environment without thermal bridges. Their functional design makes it easy to connect the equipment and avoids the need for different trades to work at the same time in a confined space.

BENEFITS

- STANDARDIZED MODELS THAT CAN BE ADAPTED TO YOUR NEEDS
- QUIET, VIBRATION-FREE CONSTRUCTION
- LVG FORCED AIR EVAPORATOR
- URETHANE INSULATION, WITHOUT THERMAL BRIDGES
- SEVERAL DRILLING OPTIONS FOR THE PIPES
- PRECISE FINISHED PRODUCT MANUFACTURED IN FACTORY
- SHORT PRODUCTION TIME
- DETAILED INSTALLATION DRAWINGS PROVIDED
- ASSESSMENT OF SPECIFIC NEEDS
- EASY AND QUICK TO INSTALL

SOPRA



PREFAB BULKHEAD FOR WINE CABINET

With Sopra, there is no need to build, insulate and finish a bulkhead to integrate an evaporator. Everything is included with the housing, the drywall siding and even the lighting! The bulkhead can be anchored to the ceiling and/or rear wall and also in a wall corner.

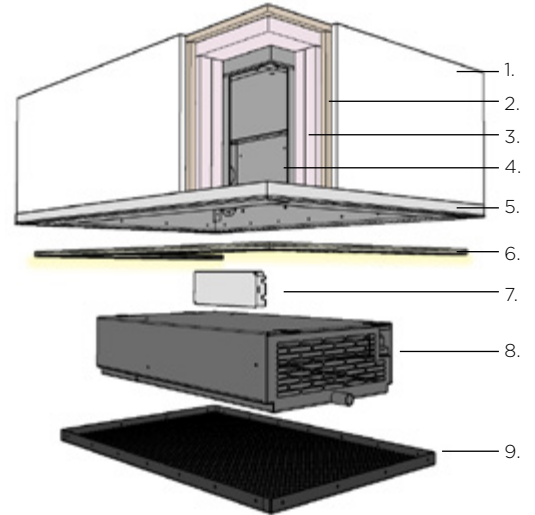

1. Drywall Board
2. Plywood
3. 2" urethane insulation
4. Aluminum case
5. Finishing moulding for drywall
6. 3000K Warm White LED Strip Light
7. Transformer
8. LVG Evaporator
9. Removable finishing grid

SECTIONAL VIEW

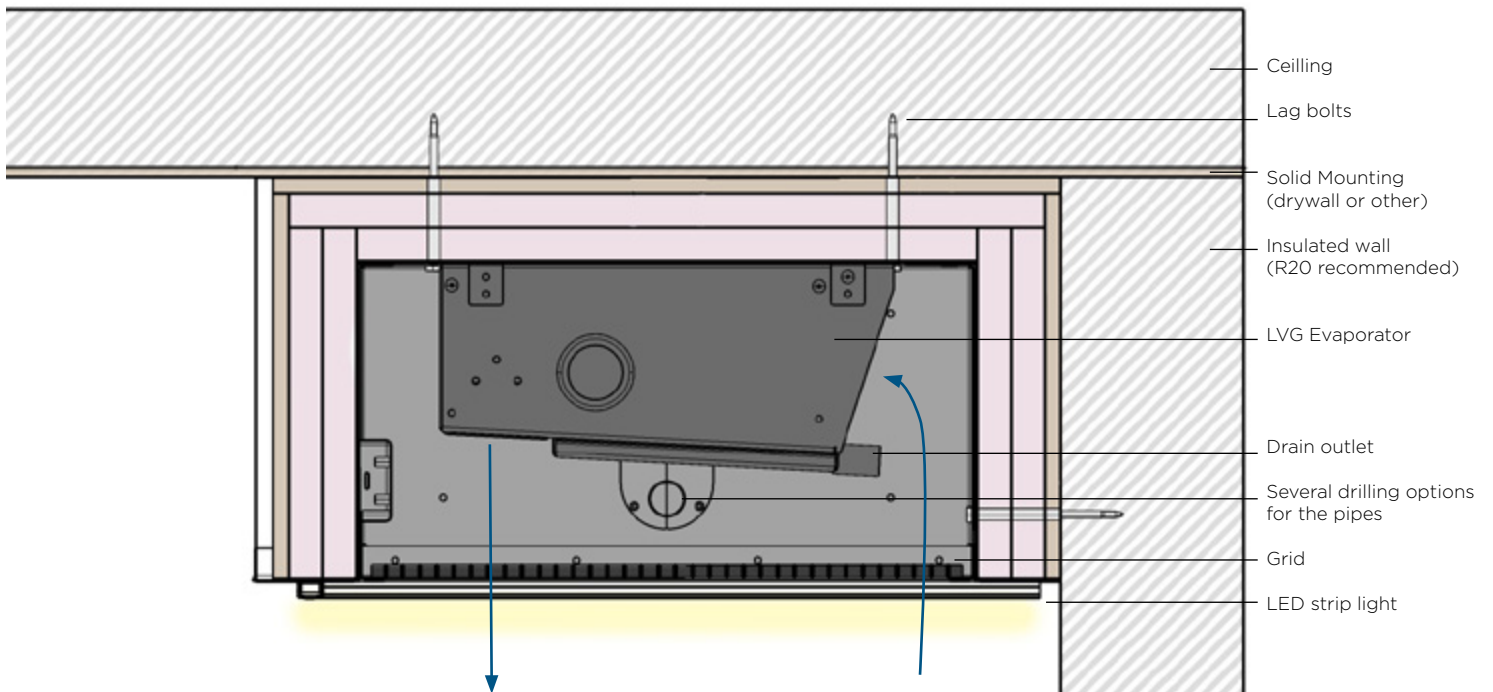



OUR MODELS

Sopra is available in four standardized bulkhead models for wine cabinets. The minimum and maximum dimensions have been calculated to provide an adequate BTU capacity according to the cubic footage of the space to be refrigerated. Sopra's width can therefore be adjusted according to your needs, while ensuring the ideal conditions for optimal performance.



SOPRA18

- LVG18 EVAPORATOR
- 1800 BTU
- MAX OF 200 BOTTLES
- FOR A SPACE OF 40 FT³ TO 81,6 FT³
- ADJUSTABLE WIDTH: MIN. 36", MAX. 49"
- 24" FIXED DEPTH
- 12" FIXED HEIGHT
- MIN. CELLAR HEIGHT 84", MAX. 120"
- MINIMUM CLEARANCE OF 7" UNDER THE GRID

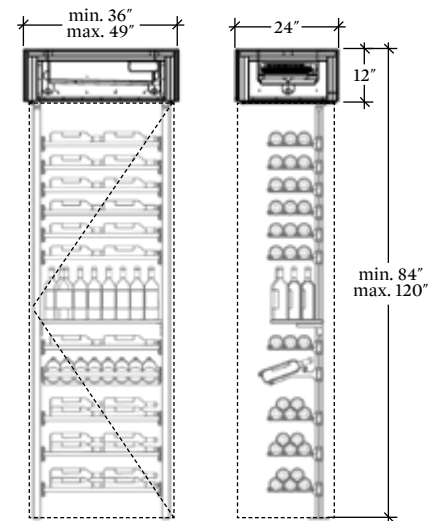

SUGGESTED USE

Designed for small spaces, its size is ideal for a front panel design with a tempered glass door. The interior space available under the bulkhead is suitable for a 27" Frontenac webkit.



SOPRA32

- LVG32 EVAPORATOR
- 3200 BTU
- MAX OF 400 BOTTLES
- FOR A SPACE OF 58,3 FT³ TO 108,3 FT³
- ADJUSTABLE WIDTH: MIN. 50", MAX. 65"
- 24" FIXED DEPTH
- 12" FIXED HEIGHT
- MIN. CELLAR HEIGHT 84", MAX. 120"
- MINIMUM CLEARANCE OF 7" UNDER THE GRID

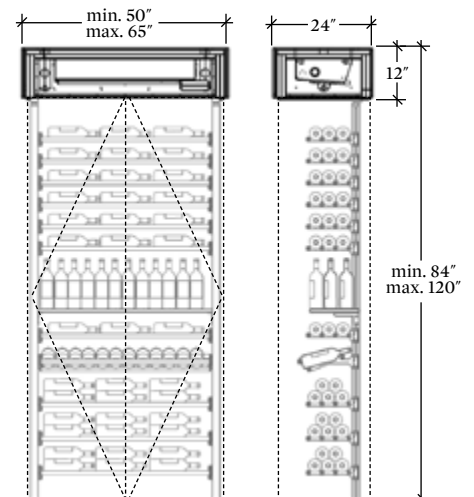

SUGGESTED USE

Perfect for small to medium spaces, its size is ideal for a wine cabinet with double tempered glass doors. The interior space available under the bulkhead is suitable for a 41" Frontenac webkit.



SOPRA50

- LVG50 EVAPORATOR
- 5000 BTU
- MAX OF 600 BOTTLES
- FOR SPACES OF 77 FT³ TO 160 FT³
- ADJUSTABLE WIDTH: MIN. 66", MAX. 96"
- 24" FIXED DEPTH
- 12" FIXED HEIGHT
- MIN. CELLAR HEIGHT 84", MAX. 120"
- MINIMUM CLEARANCE OF 7" UNDER THE GRID

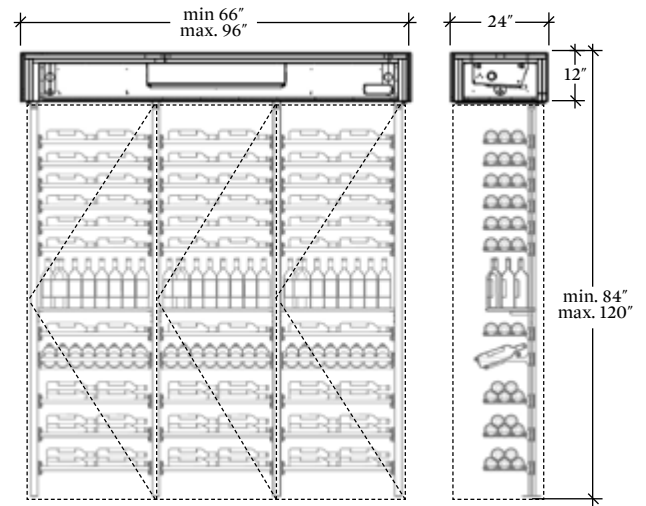

SUGGESTED USE

For medium to large spaces, its size is a good fit for a two to three front door design. The interior space available under the bulkhead is suitable for two 41" Frontenac webkits to three 27" Frontenac webkits.



SOPRA64

- 2X LVG32 EVAPORATOR
- 6400 BTU
- MAX OF 800 BOTTLES
- FOR SPACES OF 113,2 FT³ TO 200 FT³
- ADJUSTABLE WIDTH: MIN. 97", MAX. 120"
- 24" FIXED DEPTH
- 12" FIXED HEIGHT
- MIN. CELLAR HEIGHT 84", MAX. 120"
- MINIMUM CLEARANCE OF 7" UNDER THE GRID

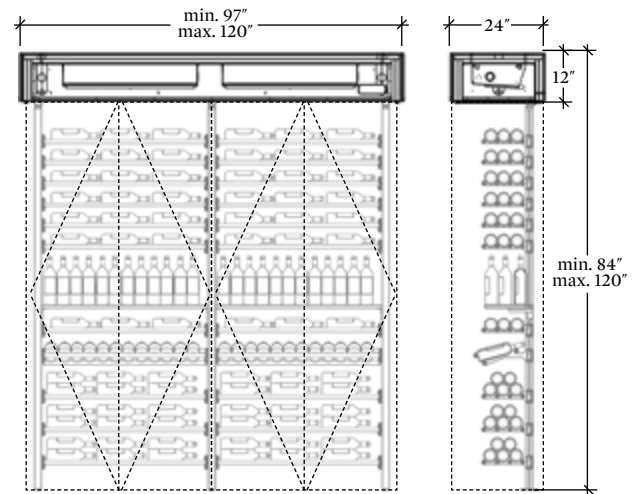

SUGGESTED USE

For long walls of bottles, it is ideal for a multi-door tempered glass front. The interior space available under the bulkhead is suitable for two 41" Frontenac webkits.

COMPONENTS

- ALUMINUM CASE WITH MATTE BLACK FINISH
- 2" URETHANE BOARD INSULATION
- BLACK FINISHING GRID
- LVG FORCED AIR EVAPORATOR
- BLACK FINISH ANTI-CORROSION PROTECTION
- FAN SPEED CONTROL
- EXPANSION VALVE
- CPVC DRAIN FITTING
- MOUNTING HARDWARE
- 3000K LED STRIP LIGHT + TRANSFORMER
- DRYWALL EXTERIOR FINISH (OTHER OPTIONS UPON REQUEST)

LVG SERVICES INCLUDED

- ROOM-SPECIFIC BTU CALCULATION
- COMPRESSOR REQUIREMENT ANALYSIS
- LIST OF ITEMS TO PURCHASE

NOT INCLUDED

- COMPRESSOR REMOTE
- REFRIGERATION LINES
- TEMPERATURE CONTROL
- WINE RACKS
- GLASS AND HARDWARE

CIELO



BUILT-IN INSULATED CASE FOR WINE CELLAR

Cielo is designed to be fitted directly into the ceiling of a wine cellar or the bulkhead of a walk-in cellar. Cielo offers a seamless and simple integration for small and large spaces, and makes it easy to put the finishing touches around unit.

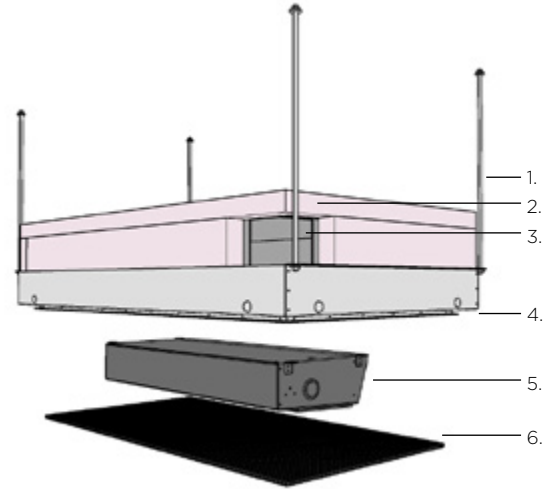

1. Threaded rod
2. 2" Insulation
3. Aluminum case
4. Fitting moulding for drywall
5. LVG evaporator
6. Removable finishing grid

SECTIONAL VIEW

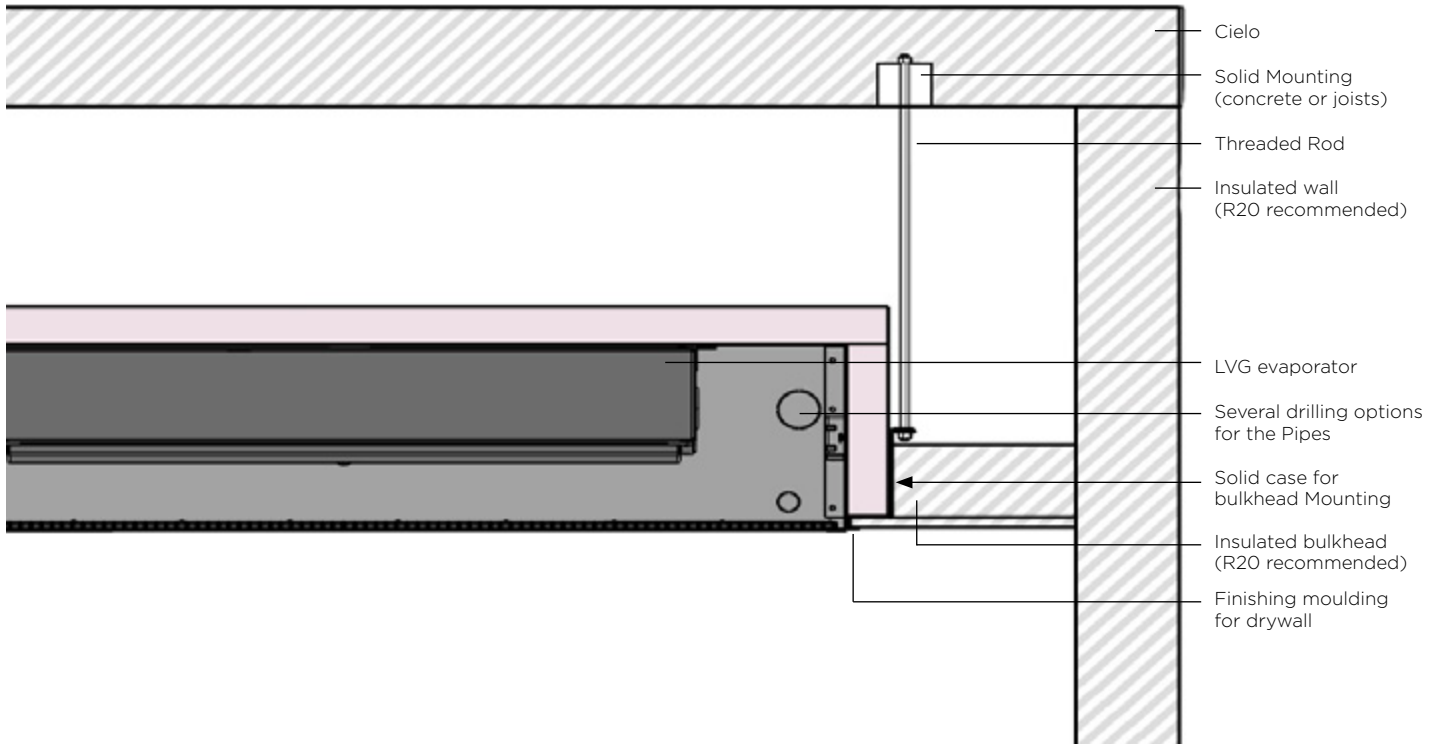

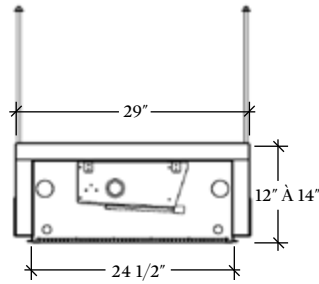
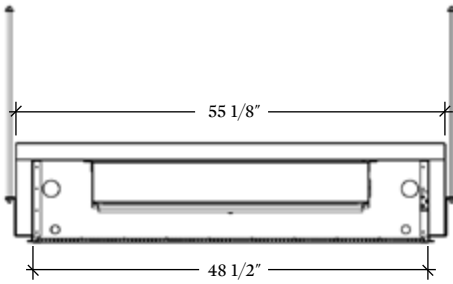

CIELO32

- LVG32 EVAPORATOR
- 3200 BTU
- MAX OF 400 BOTTLES
- OVERALL WIDTH: 55 1/8"
- OVERALL DEPTH: 29"
- HEIGHT: 12" TO 14" DEPENDING ON DISTANCE FROM DRAIN
- VISIBLE PART (GRID): 48 1/2" X 24 1/2"

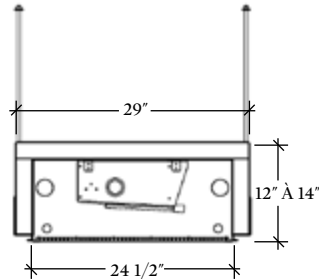
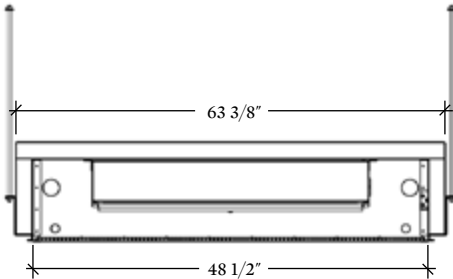

CIELO50

- LVG50 EVAPORATOR
- 5000 BTU
- MAX OF 600 BOTTLES
- OVERALL WIDTH: 68 3/8"
- OVERALL DEPTH: 29"
- HEIGHT: 12" TO 14" DEPENDING ON DISTANCE FROM DRAIN
- VISIBLE PART (GRID): 61 3/4" X 24 1/2"

COMPONENTS

- ALUMINUM CASE WITH MATTE BLACK FINISH
- 2" URETHANE BOARD INSULATION
- BLACK FINISHING GRID
- LVG FORCED AIR EVAPORATOR
- BLACK FINISH ANTI-CORROSION PROTECTION
- FAN SPEED CONTROL
- EXPANSION VALVE
- CPVC DRAIN FITTING
- MOUNTING HARDWARE

LVG SERVICES INCLUDED

- ROOM-SPECIFIC BTU CALCULATION
- COMPRESSOR REQUIREMENT ANALYSIS
- LIST OF ITEMS TO PURCHASE

NOT INCLUDED

- COMPRESSOR REMOTE
- REFRIGERATION LINES
- TEMPERATURE CONTROL
- WINE RACKS
- GLASS AND HARDWARE
- FRAME AND EXTERIOR FINISH OF THE CEILING





LVG EVAPORATOR



FORCED AIR EVAPORATORS

LVG evaporators are entirely manufactured in our factory with great precision. Our modern design has been developed for easy installation and connection of the unit. The integrated fans are powerful horizontal propulsion turbines that create a large airflow. The larger and more even airflow considerably reduces the noise normally produced by standard fans. The rear drain outlet offers a better drainage slope and a much lower profile design.

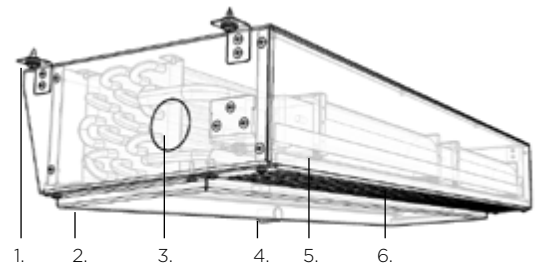

1. External mounting bracket
2. Rear air intake
3. Hole for the passage of the lines
4. Drain outlet at the back
5. Horizontal propulsion turbine
6. Wide air outlet

LVG18 CP

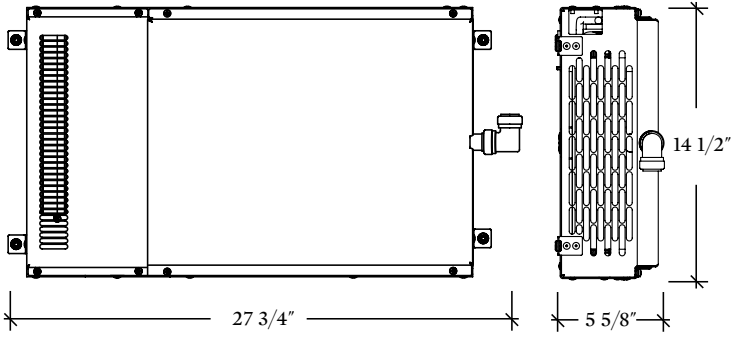

LVG18

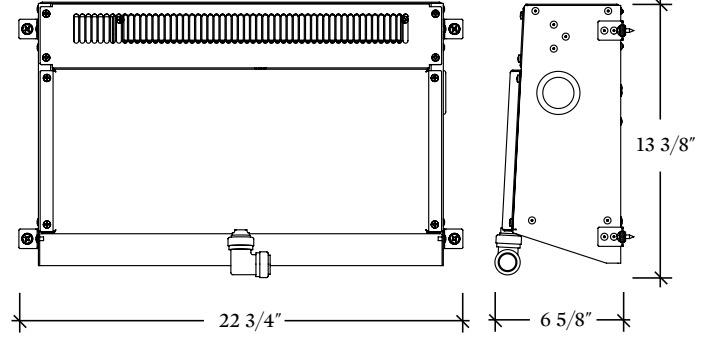

LVG32

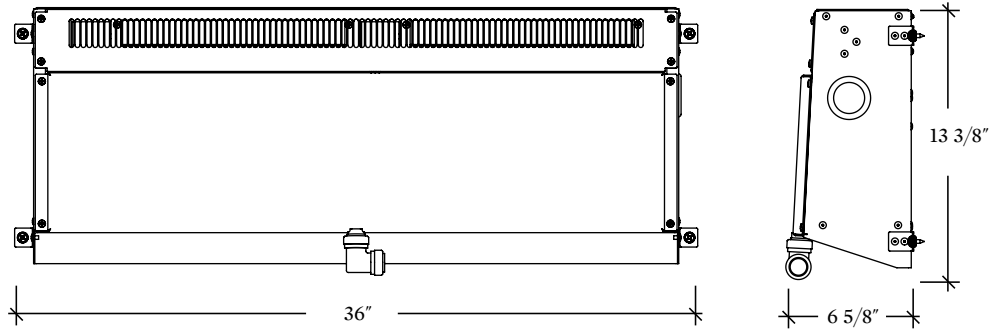

LVG50

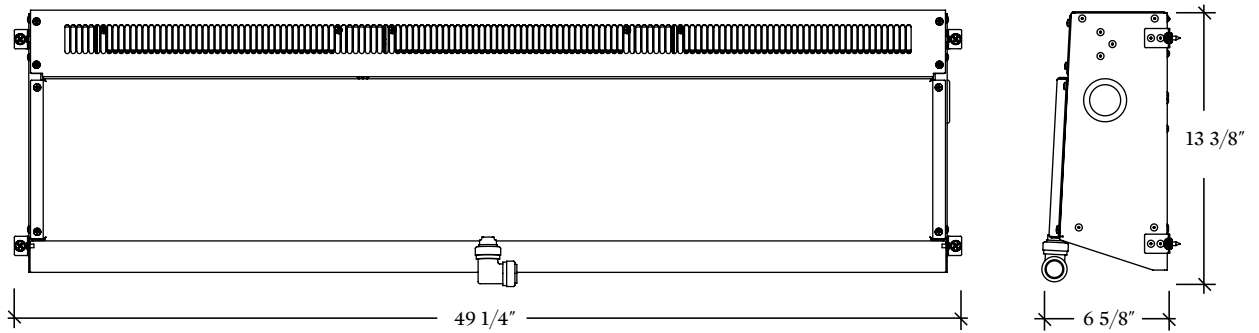

	LVG18 CP	LVG18	LVG32	LVG50
DIMENSIONS	27 3/4" x 14 1/2" x 5 5/8"	22 3/4" x 13 3/8" x 6 5/8"	36" x 13 3/8" x 6 5/8"	49 1/4" x 13 3/8" x 6 5/8"
BTU	1800	1800	3200	5000
SCFM	106	117	190	285
FANS	1x 120v	1x 120v	2x 120v	3x 120v
EXPANSION VALVE	1/4T	1/4T	1/4T	1/2T

INSTALLATION



THE STARTING POINT FOR YOUR PROJECT.

Refabricated bulkheads are designed to be the first step in your project and to simplify your work site. Whether for a new construction or a renovation, the bulkhead makes it easy for all trades to access the mechanical system; drain connection by the plumber, electrical connection by the electrician and refrigeration line connection by the refrigeration specialist.

LVG includes in its sales service a technical evaluation as well as a BTU load calculation for a complete and precise mechanical connection, simplifying budget management.

INSTALLATION TIPS

We recommend you work with specialized construction contractors for the installation of a Sopra or Cielo bulkhead. Professional contractors will ensure that the installation meets the requirements of the building code and complies with the plans provided by LVG in order to guarantee the proper functioning of the unit. For a proper installation without surprises, the installation must be done safely and with the right equipment.

1. Use of a forklift to safely raise the bulkhead according to the positioning provided in the plans.
2. Connection of mechanical systems
3. Connected bulkhead ready for the plaster finish.

SOPRA INSTALLATION

In addition to being adjustable to your dimensions, Sopra can be installed on a single wall, in a wall corner or on the ceiling. Its integrated exterior finish includes drywall moulding, making it ready to be plastered as soon as the installation is complete.



CIELO INSTALLATION

Cielo's threaded rods can be anchored to concrete or ceiling joists. Its sturdy construction allows the structure of the bulkhead to be built directly on the solid case around the housing. The covering is then easily done by inserting the drywall sheets into the integrated finishing mouldings, thus creating a clean finish without wasting time.





LA VIEILLE GARDE
3111 BOUL. MARTEL
ST-HONORÉ, QC
G0V 1L0

1.866.673.4832 X101
WWW.LAVIEILLEGARDE.COM