

Welcome to
HARBOUR PLAZA NORTH POINT



HARBOUR
PLAZA

NORTH POINT • HONG KONG



OVERVIEW

Welcome to **HARBOUR PLAZA NORTH POINT**

Conveniently located in the East Side of Hong Kong Island, right opposite to MTR Quarry Bay station, Harbour Plaza North Point is your home base for exploring all that Hong Kong has to offer.

LOCATION

Harbour Plaza North Point is just 2-minute walking distance to MTR Quarry Bay Station (Exit C), various public transportation is in front of hotel from airport bus (Route A12) , tram and bus to all main areas in Hong Kong and Kowloon districts. The strategic location allows easy access to all main shopping and business spots including Causeway Bay, Taikoo Place and Hong Kong Convention and Exhibition Centre.



ACCOMMODATION

Harbour Plaza North Point has 719 tastefully designed guests rooms and serviced suites from 24 to 43 sq. m for your selection. Room and Suites are categorized as Superior, Studio, Premier and Suite with choices of City View, Hill View and Harbour View. Hill View rooms offer bright, ample view of Braemar Hill whilst Harbour View rooms offering spectacular view of Kai Tak Cruise Terminal and the eastern side of Victoria Harbour.

All of our comfy rooms and suites come with either one double bed or two single beds, equipped with Wi-Fi service and a long work desk to facilitate guests with work / study needs. To serve different staying needs of our guests, cooking and dining utensils, microwave oven, double hotplate and mini bar or 2-door refrigerator are available in Studio and Suite. Interconnecting and disable rooms are also available.





Superior Room

The 24 sq. m Superior Room offers views over King's Road or the eastern side of Victoria Harbour, it also comes with either one double bed or two single beds and equipped with a writing desk enabling a comfortable work area.

Studio

Our 24 sq. m Studio overlooks tranquil hill view or the eastern side of Victoria Harbour, comes with either one double bed or two single beds. It is equipped with cooking and dining utensils, microwave oven, double hotplate and mini bar or 2-door refrigerator, perfectly fit the needs of long stay guests.





Premier Room

Located on 29 - 33/F and renovated in recent years, the tastefully appointed Premier Room in 24 sq. m is the epitome of urban dwelling with elegance with Hill View Room offering bright, ample view of Braemar Hill and Harbour View Room offering spectacular view of Kai Tak Cruise Terminal and the eastern side of Victoria Harbour. The clean and sleek room combines comfort living with classy and refined decor featuring designer chair and an artistic feature wall, giving guests' stay a stylish yet homey touch. Each room is equipped with a chic chaise longue for guests to sit back and relax, while it can also be transformed into a bed to accommodate an extra accompanying guest for a delightful and cosy stay.



Side Harbour View Suite

Our 43 sq. m Suite boasts partial Victoria Harbour view or spectacular view of Kai Tak Cruise Terminal, fully furnished and modernly decorated. The Suite includes a cozy bedroom, spacious living room (with sofa bed on selective suites), fabulous dining area and along with a fully equipped kitchen, an excellent residence for leisure or long stay.



TRANSPORTATION

Strategically located in the East Side of Hong Kong Island, the hotel is accessible from different districts via a seamless transportation hub by land and rail with just 9-minute away from one of the busiest shopping districts, Causeway Bay.

AIRPORT

There are numerous options for reaching Harbour Plaza North Point. Guests can choose from Hotel Limousine (Airport Representative Counter B09), the Airport Express (the closest station is Hong Kong Station), taxis or buses (Bus Route A12).

HIGH SPEED RAIL WEST KOWLOON STATION

Hong Kong West Kowloon Station is located in the city center, adjacent to the MTR Austin Station on the Tuen Ma Line. Guests have the options to travel to and from the hotel via taxis or private cars, with a convenient 20-minute drive from the station. Alternatively, guests can easily access the MTR to reach the hotel.

MTR (MASS TRANSIT RAILWAY)

MTR Quarry Bay Station connects the Hotel to the city's busiest areas including Causeway Bay, Wanchai and Central; the most popular tourist attractions are all within reach, for instance, the renowned shopping district Causeway Bay is just 4 stops away with just 9-minute ride. Famous tourist sightseeing spots Tai Kwun and Ocean Park is just 20-minute ride from the Hotel. For guests attend exhibitions, it is only 5 stops to Hong Kong Convention and Exhibition Centre in Wanchai.



RECREATION FACILITIES

Our comprehensive facilities include a well-equipped fitness centre and an outdoor swimming pool overlooking the stunning view of Victoria Harbour, absolutely ideal for all guests to unwind in the bustle of the city.



FITNESS CENTRE

Our well-equipped fitness centre with sauna is the place to come for an invigorating workout.





SWIMMING POOL

Chill out and escape from the hustle and bustle of the city, hop into the 25-meter long outdoor swimming pool to embrace the glamorous view of Victoria Harbour.

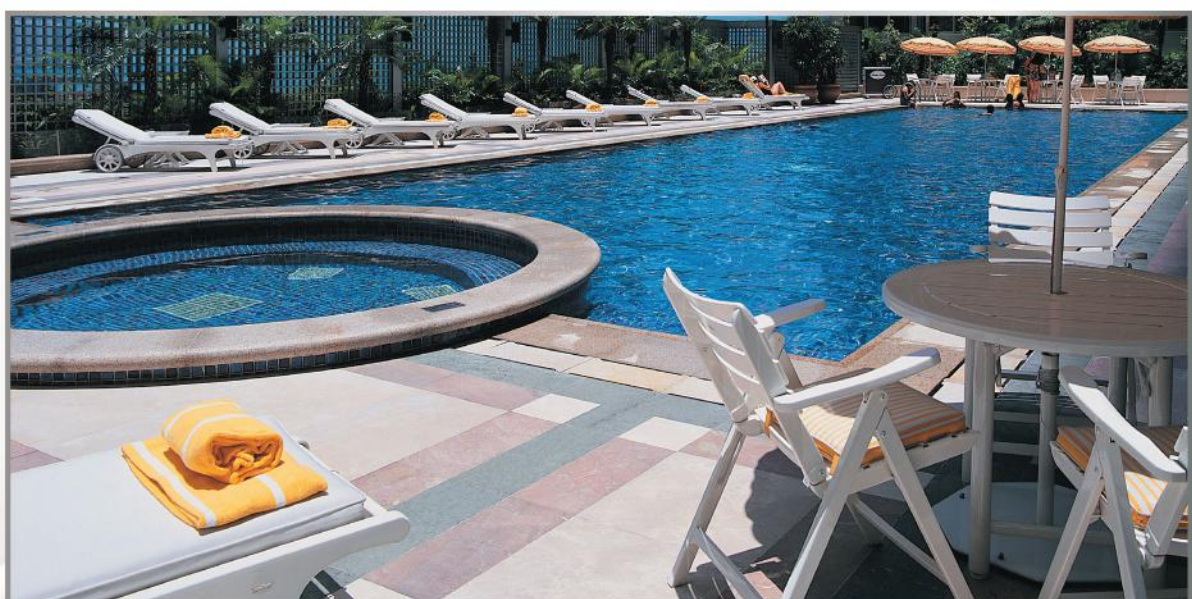

DINING

Harbour Plaza North Point aims at bringing our guests a remarkable culinary experience. Savor the bountiful international menu and buffets at Greens Café. Sit back and relax in cozy environment to enjoy signature drink and fine wine at The Point Lobby Lounge. Refresh your day with simple yet scrumptious takeaway breakfast and lunch box at Java Mama Deli Corner.





GREENS CAFÉ

Greens Café offers an extensive all day international menu and serves some of the most generous breakfast, lunch and dinner buffets in town. We also serve Halal breakfast and a la carte menu. The spacious outlet with comfortable contemporary décor makes this restaurant a popular choice for families and groups.





THE POINT LOBBY LOUNGE

The Point Lobby Lounge is a perfect venue to catch up with friends and colleagues. Sit back and relax in a cozy environment to enjoy afternoon tea set and all time favourite drinks, or come down and cheer on your team during major sports events.





JAVA MAMA DELI CORNER

Java Mama Deli Corner serves various choices of delicious Grab and Go Breakfast Set and healthy takeaway lunch box for your enjoyment.





MEETING & EVENTS

Our multi-purpose and versatile function rooms offer an excellent space for a variety of events and meeting, cocktail receptions, buffet parties, training and conference, fully equipped with state-of-the-art audio-visual equipment and wireless internet services.

Located on Basement 1, Harbour Plaza Rooms with approximately 108 sq. m in three versatile function rooms are suitable for medium sized events. When combined, they turn into the perfect venue for meetings up to 130 persons or a banquet dinner for up to 84.

Featuring elegant and contemporary decor, Java Rooms on the Second Floor with approximately 141 sq. m, are adjacent to Greens Café. They are ideal venues for private parties or intimate dinner gatherings, as well as a perfect venue for meetings and conferences.



FLOOR PLAN AND CAPACITY

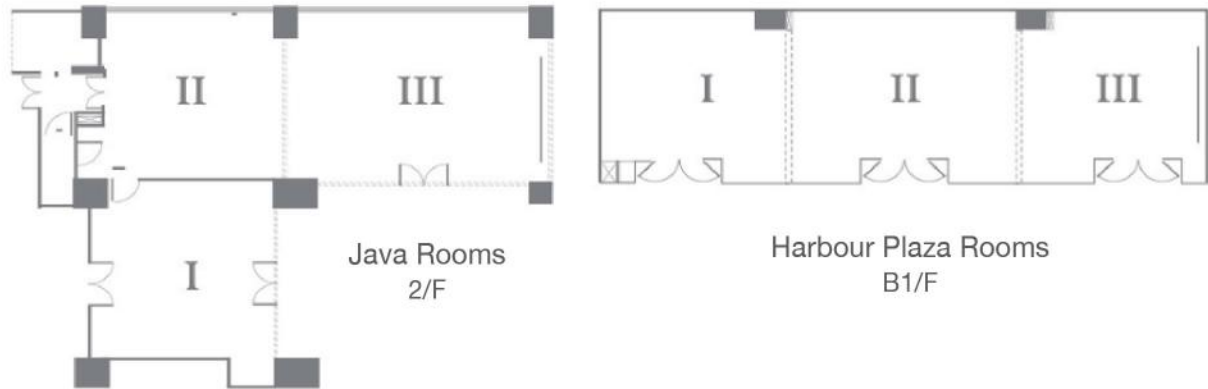

Venue	Sq. ft.	Sq. m.	Length		Width		Height	
			ft.	m.	ft.	m.	ft.	m.
Java Room I	485	45	22	6.7	22	6.7	10	3
Java Room II & III	1,040	96	52	16	20	6	10	3
Harbour Plaza Rooms	1,160	108	61	18.6	19	5.8	9	2.7

Venue	Classroom Theatre Boardroom U-shape Buffet Cocktail Round Table						
	(No. of Person)						
Java Room I	18	50	20	18	40	40	36
Java Room II & III	54	96	50	44	80	80	72
Harbour Plaza Rooms	60	130	50	44	84	110	84

665 King's Road, North Point, Hong Kong
(MTR Quarry Bay Station, Exit C)
Tel: (852) 2187 8888 | Email: hnp@harbour-plaza.com
www.harbour-plaza.com/northpoint