

Committed to Quality,  
Committed to You

# PRODUCT CATALOGUE





# INDEX

<b>Product Name:</b>	<b>Page No.</b>
Woodpecker Endo Radar Pro:	01
Woodpecker Endo Free:	01
Unicorn DenMart Y Smart Endomotor:	02
Woodpecker Apex Locator Dpex V:	02
Woodpecker PT3 Scaler:	03
Woodpecker U6 LED Scaler:	04
Woodpecker DTE - D5 Scaler:	04
Woodpecker DTE - D3 Scaler:	04
Woodpecker Inbuilt Scaler V2 LED:	05
Light Cure Unit:	05 - 07
LubriMax 5 Pro:	07
Intraoral Camera:	08-09
DentXpert Dental Simulator:	10-12
Bio-Art Articulator:	13
Micromotors:	14
FX Plus With ARV:	15
Tornado Handpieces:	16
Tealth Handpieces Range:	17 - 25
Hi-Clean Spray:	26
Digital Ultrasonic Cleaner:	26
UV Chamber:	26
Primedent Kit:	27
Water Distiller:	27
API Other Premium Instrument:	28-33

## Endo Radar Pro

Brushless Endomotor with integrated Apex Locator

- Improved Brushless Endomotor with integrated Apex Locator
- The two-in-one function allows root canal preparation with simultaneous length determination
- Ultra-compact cordless handpiece with super-mini contra-angle
- 360° rotatable contra angle with apex action
- Wireless charging of the handpiece with large capacity battery
- Speed range: 100–2500 rpm
- Torque Range: 0.4–5.0 Ncm
- 6:1 gear ratio handpiece with 11 user-defined modes
- ATR mode: After the pre-set torque is reached, the file will reciprocate according to the set angle



ATR mode : After the preset torque is reached, the file will reciprocate according to the set angle



Wireless charging for longer endurance

CE/EC ISO 13485:2016

## Endo Free

High Performance Brushless Endo Motor

- Low wear, low heat and longer service life
- Lightweight cordless handpiece offers better hand feeling
- Compatible with Apex Locator DPEX V
- 6:1 mini contra-angle delivers broader operation field
- High performance brushless motor
- High torque and fast response
- More accurate and more stable output, enabling more efficient preparation
- Speed: 100rpm- 1500rpm
- Torque: 0.4N.com-4.2N.cm



360° rotatable  
contra-angle

CE/EC ISO 13485:2016

## Y Smart Endomotor

- Ergonomically designed body with small ultra-mini head contra-angle
- Integrated LED light for a better view
- The LED screen on the handpiece itself for easy change of speed and torque
- 6 Programs with memory set option
- Left-Right reciprocation function for high precision root canal preparation
- In-built large capacity Lithium-Polymer battery
- Speed range: 120 – 500 rpm
- Torque range: 0.6 – 4.0 Ncm
- 16:1 gear ratio contra-angle can be easily autoclavable at 135° C



LED Light



## DPEX V



Woodpecker Apex Locator, with more than accurate value to help you in workinglength determination during root canal treatment.

- 6th generation apex locator for measurement in presence of blood, pus, residual pulp or saliva etc.
- 97.71% accurate than the conventional radiography method
- Multi-frequency impedance technology precisely measure irrespective of the tooth type
- File clip, hook, file probe can be easily Autoclavable to avoid cross-contamination
- Display: Multi-color 4.5" LCD display
- Main unit weight: 385gm
- Dimensions: 138mm x 77mm x 107mm



**PT3 Scaler**

# Ahead of time

## Redefine painless treatment



Woodpecker PT-3 Scaler is a multi-function scaler that is beautifully designed with automatic water supply system and a smart touch screen to provide the flexibility of operation to the dentist in Oral prophylaxis & periodontal therapy.

### Intelligent Touching Technique System

- Clear control panel
- Ultra-sensitive
- Waterproof design
- Using stickers, wearing gloves bring no effect.



### Save Scaling

Elliptical vibration track disperse the impact force between tip and teeth while realizing 360° scaling and polishing. Tip amplitude is about 20-60 μm, equivalently third of diameter of a single hair. Excellent sci-tech outcome assures your save and painless treatment.

### Automatic water Supply System

- Easy to change water
- Increase operating efficiency (working efficiency)
- Hydrogen peroxide, sodium hypochlorite, and chlorhexidine is usable
- Clear 20ml scale mark makes it convenient for matching liquid

Modes	General, Perio & Endo
Comes with 8 Tips	3 scaling, 3 Perio & 2 Endo Irrigation
Bottle Capacity	700 ml
Power Output	3W – 20W
Vibration Frequency	28kHz±3kHz
Weight of the main unit	1.8 KG

## U6 LED Scaler

- Sine wave drive that increases patient comfort
- Smart ultrasensitive touch system with waterproof design
- Detachable Aluminium alloy handpiece with sealing technique makes it easy to autoclave
- Automatic frequency tracking for more efficient removal of hard calculus
- Intelligent degenerative system to boost clinical performance
- Enhanced endo functions
- 3 Modes: General, Perio & Endo
- Comes with 7 Tips: 2S, 3P & 2 Endo Irrigation



Detachable metal aluminum alloy handpiece with latest sealing technique making it able to be autoclaved

## DTE - D5 Scaler

### Optic

- Detachable & autoclavable handpiece
- Works on 3 modes: General, Perio & Endo
- Automatic frequency tracking
- Microcomputer controlled
- Enhanced Endo function
- Automatic degenerative feedback for constant power output
- With 6 Titanium Scaling tips (3 S, 1 P, 1 Stain Removal) & 1 Endo attachment



## DTE - D3 Scaler

### Fixed Handpiece

- Detachable & autoclavable handpiece
- Works on 2 modes: General & Perio
- Automatic frequency tracking
- Microcomputer controlled
- Automatic degenerative feedback for constant power output
- Athermic Stainless steel 5 Tips (3S, 1 P, 1 Stain Removal)



## Inbuilt Scaler V2 LED

### Optic

- Device with Endo mode for enhanced accuracy in root canal treatment
- Detachable & autoclavable handpiece at 134°C handpiece
- Handpiece is compatible with Satelac, NSK tips
- Automatic frequency tracking facility for easy removal of hard calculus
- Automatic degenerative feedback provides a constant power output
- Athermic & golden coated tips are highly durable



## O Light Plus Light Cure Unit

- Upgraded wide spectrum 385nm-515nm
- Poly wave Blue-violet light, it can cure all types of resins
- New style resins material contains TPO (photo initiator), can also be cured
- 360° curing - reach every angle
- Modes: 1> High Mode – Suitable for Orthodontic Brackets, Porcelain Veneers, Post and 2> Standard Mode – Suitable for General Dental Restorative Procedures
- Light Intensity: High Mode: 2300~2500 mw/cm<sup>2</sup>  
Standard Mode: 1000~1200 mw/cm<sup>2</sup>
- Time Settings: High Mode: 1 Sec, 3 Sec Standard Mode: 5 Sec, 10 Sec, 15 Sec, 20 Sec



**O-Light Plus**

**1 Sec  
Curing**

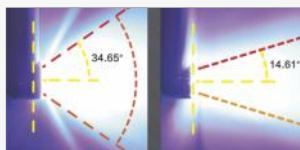

Upgraded focussed light output

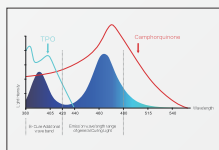

O-light plus spectral curve & resin spectral absorptivity



Metal head prevents anti-shock & cracks

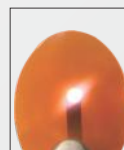

Light hood prevents eyes from blue-ray injury



## O Light Light Cure Unit

- 1 Sec Curing of Composite Resin
- High power LED Light with imported wick from America
- High-intensity light output with strong penetration
- 360° rotatable probe
- High power Visible Blue LED light
- Wavelength: 420 – 490 nm
- Modes: high mode: 1 sec, 3 sec
- Standard Mode: 5 sec, 10 sec, 15 sec, 20 sec
- High mode for fast curing of post & core, orthodontic brackets, veneers in intensity 2300 mw/cm<sup>2</sup>
- Standard mode for curing in restoration cases in intensity 1200 mw/cm<sup>2</sup>



CE/EC ISO 13485:2016

## Digital LED Light Cure Unit

- Material of shell handle: Aluminium
- Size: Diameter 23 X 160mm
- Mode: Three kinds of working mode
- Working Volt: 4.2~4.5 volts
- Electric current: 0.7 amperes
- Battery Type: Lithium-Ion
- Battery capacity : 1400Mah
- Wave Length: 420-480nm
- Luminous Intensity: 1200mW/cm<sup>2</sup> 5W



## UltraCure Light Cure Unit

- Special lens condenser design
- Broad spectrum blue-violet light with 12W high power LED light source
- 360° rotation curing head
- 2 working modes:  
Strong light mode: 1s, 3s, 5s  
Standard mode: 10s, 20s, 30s
- 7 Magnetic special lens
- 6 Month warranty

**1** sec  
Light  
Curing  
Broad Spectrum



## LubriMax 5 Pro

Multinozzle Lubrication Spray Adaptor

- Universal Compatibility
- Efficiency Enhancer
- Portability
- Connectivity Assurance
- Cost-Effective
- Time-Saver
- Peak Performance
- Endorsement



## Intraoral Camera

# High Resolution 12 Mega Pixel Sony CCD Intraoral Camera with 17" HD Screen

### Features

- Image & Video Format: JPG & Mp4
- High-speed image processing technology
- Ergonomic design for the overall handling experience
- Length of the monitor -38.5cm
- The breadth of the monitor -36.5cm
- Auto Focus
- 4 x Zoom
- 1280 x 1024 resolution
- Six high intensity LED lights
- Ultimate Patient Safety
- SD Card Storage



### Specifications

- Power Input: AC 100~240 V,50/60Hz
- Pixels: 12 Mega Pixels
- Focal Distance: 3-50mm, Auto Focus
- Image Sensor: ¼ Sony HADCCD
- Handpiece: 6 pcs of LED Lights
- Signal system: NTSC/PAL
- Weight of Handpiece: 50 grams



### Advantages

- Enhanced Diagnostics
- Early Detection
- Visual Progress Tracking
- Trust and Communication
- Awareness and Accountability
- Efficient Documentation
- Precision Diagnosis
- Empowered Decision-Making
- Transparency and Confidence
- Motivation for Care
- Educational Tool

## All in-1 PC - Intraoral Camera

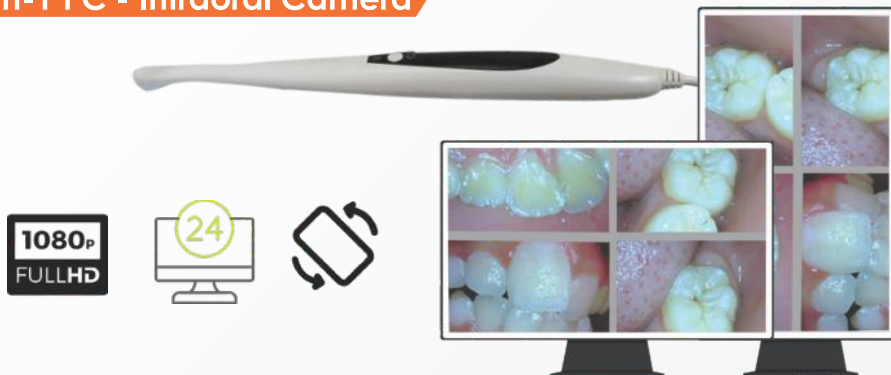

### Features:

- 1. Equipped with a 1/4-CMOS lens for high-quality imaging
- High resolution of 13.0 Mega pixels, providing clear and detailed images
- Operates at a voltage of 5V
- Features 6 WHITE LED lights, ensuring adequate illumination for capturing detailed intraoral images.
- Focus range of 10-40 mm allows for versatile imaging of different areas within the oral cavity
- Provides a wide angle of view at 105°, enabling comprehensive examination of the oral cavity.

## OraCam Wired HD Intraoral Camera



Wired Intraoral Camera



### Features:

- 1. Super High-Resolution 12 MP HD CMOS camera
- High Image Resolution of 1280x720
- Capable of capturing 720P HD videos up to 15 seconds
- USB-port connection
- Built-in 8-piece white LED (5600K)
- Optical hi-tech anti-dust and anti-fog lens
- Compatible with imaging software
- Includes 50 disposable sleeves to prevent cross-contamination



## DentXpert Dental Simulator

**Precision Dentistry at Your Fingertips  
For 2 Students + Four-Handed Operation**

Dual Bench Dental Simulators with training and practice equipment allows the dentist & dental students to work on the simulated patient -Dental Phantom head with the look and feel close to a real patient and real dental procedure, training both their manual dexterity and problem-solving skills. Designed for universities and dental training centres, they feature a modular structure that helps to maximise space by creating self-contained learning stations. They reduce the gap between pre-clinical and clinical education. They provide a complete, ergonomic simulation that simulate lifelike situations, as in a clinical setting.

Single / Dual workbench for dental student clinical training simulation.

A complete system for 1 / 2 students reproducing the dental clinic environment and simulating realistically various clinical treatment procedures.

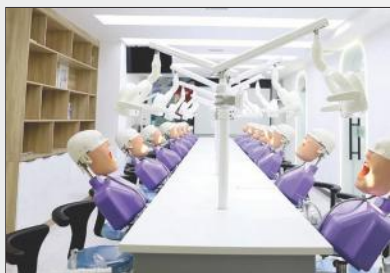

### ITEMS DETAILS

1	<b>Workbench 1200*700*800mm</b>	<b>1 Set</b>
2	LED Lamp	2 Set
3	Phantom With Body-Nissin Type, Silicon mask can add tube, Articulator can open & close. Mouth can open to 5cm.	2 Set
4	Nissin Type Jaw-Fransaco Type AG4 or AG3, 28 pieces teeth or 32 pieces of teeth are available	2 Set
5	3-Way Syringe	2 Set
6	Dentist Stool	2 Set
7	Clean Water Bottle	2 Set
8	Waste Water Bottle	2 Set
9	Foot Control	2 Set
10	Pneumatic Suction	2 Set

## DentXpert Dental Simulator

### Precision Dentistry at Your Fingertips For 2 Students

Integrated Dental Simulator allows dental students to work on the simulated patient -Dental Phantom head manikin with the look and feel close to a real patient, training both their manual dexterity and problem-solving skills.



#### ITEMS DETAILS

1	<b>Body 580*380*800mm</b>	1 Set
2	LED Lamp	2 Set
3	Phantom with torso	2 Set
4	Dental typodont	2 Set
5	3-Way Syringe	2 Set
6	Stool	2 Set
7	Clean Water Bottle	1 Set
8	Waste Water Bottle	1 Set
9	Foot Control	2 Set
10	Pneumatic Suction	2 Set



Stool

## DentXpert Dental Phantom Head

### Precision Dentistry at Your Fingertips

They are series of dental practice simple phantom head models, which is used for dental school, universities and oral medicine specialized student before clinical practice teaching simulation.

It has such advantages as solid structure, handsome shape, easy operation and high reliability as an ideal upgraded product for the modern dental clinics.

It can make the professional theory teaching, experiment teaching and clinical teaching easy & effective.



#### ITEMS DETAILS

1	<b>With Clips</b>	<b>1 Piece</b>
2	Transparent Mask	1 Piece
3	Jaw Set	1 Piece
4	Drain Pipe	1 Piece
5	Face	1 Piece

## DentXpert Dental Jaw Set

### Precision Dentistry at Your Fingertips



## Scaler Handpieces & Tips

- **Efficient Plaque/Tartar Removal:** Quick and effective, ideal for challenging areas
- **Time-Saving:** Speeds up scaling procedures, optimizing clinic time
- **Precision with Patient Comfort:** Targets specific areas gently, improving patient experience
- **Ergonomic Design:** Reduces physical strain during long procedures.
- **Adjustable Settings:** Customizable for patient sensitivity and specific oral conditions
- **Increased Patient Satisfaction:** Comfortable, less invasive and faster treatments
- **Improved Oral Health Outcomes:** Aids in better hygiene management and disease prevention
- **Versatile Use:** Suitable for a variety of dental procedures.



## A7Plus Articulator

Robust structure made of aluminum, assuring greater stability.  
Design that provides greater visibility.



- Semi-adjustable/Arcon type
- Fixed intercondylar distance at the average 110mm
- Curved condylar guide
- Adjustable condylar guide angle
- Cental lock
- Motion stabilizer system with silicon joint
- Pin to support the upper frame at the open position
- Can be supplied with standard or elite facebow. Pin to support the upper frame at the open position
- Can be supplied with standard or elite facebow





## Clinical Micromotor

- Speed upto 35,000 RPM
- One spare carbon brush set
- Low heat generation suitable for long use



CE / EC ISO 13485:2016

## Lab Micromotor

- Speed upto 40,000 RPM
- One spare carbon brush set
- Low heat generation suitable for long use



CE / EC ISO 13485:2016

## Micromotor Control Box

- 0-35,000 RPM
- Forward & Reverse direction selection
- Hand & Foot Operation
- Extra torque for smooth working



CE / EC ISO 13485:2016

## Micromotor Control Box

- 0-35,000 RPM
- Forward & Reverse direction selection
- Hand & Foot Operation
- Extra torque for smooth working



## FX Plus With ARV

30W Power for faster cutting

### Anti-Retraction Valve (ARV)



Prevents the reverse flow of debris into the handpiece thus avoiding cross-contamination.

### 60% Power Boost



60% Power Boost-FX Plus is dramatically more powerful with its newly designed scoop-type rotor than a normal handpiece

### Air Pressure Regulating Valve

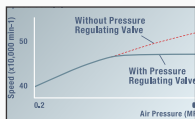

For maintenance of a stable pressure supply to the rotor

### Quattro Spray



The NSK Quattro Water Spray effectively cools the entire operating field and prevents damage to living tissue

### Clean Head System



Anti suck back mechanism to prevent cross-contamination



### Ceramic Bearings

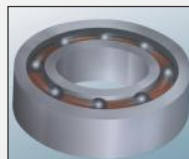

Ceramic Bearings- Ceramic Bearings are 25% harder than conventional steel bearings. Because of less friction, the heat production & vibration are significantly reduced which increases its efficiency & durability

## TORNADO HIGH SPEED AIR ROTOR HANDPIECE

- Speed 3,50,000 - 4,30,000 RPM
- Light weight
- Available with Mini Head, Standard Head, Super Torque & Super Torque with Push Button



## TORNADO LOW SPEED MICRO MOTOR HANDPIECE

- Speed 35,000 - 40,000 RPM
- Light weight
- Available with Straight & Contra Angle



**External Irrigation Low Speed Dental Handpiece**

**Straight Head**

ORDER: SEN-08C

CE: 1024-B2



- Ergonomic Design
- Smaller head and enhanced technology
- Smooth operation
- Comfortable Grip
- Used for Pre-clinical Lab work
- Rust Free
- Swivel ring type
- 1:1 Gear Ratio
- **Bur size:** Ø 2.35mm
- Maximum speed of 20,000 min-1
- Autoclavable at 135° Celsius

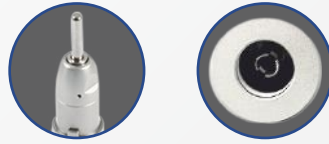

**Surgical Handpiece**

**Surgical Straight Head**

ORDER: SEN-05C

CE: 1024-B2



- The surgical straight handpieces have been specially designed for oral and maxillofacial surgery and implantology
- Smooth operation, Comfortable Grip
- 1:1 Gear Ratio with external irrigation
- **Bur size:** Ø 2.35mm
- Maximum speed of 20,000 min-1
- Autoclavable at 135° Celsius

## Internal Irrigation Low Speed Dental Handpiece

### Straight Head



ORDER: SIF-01C

CE: 1020L-M4



- Premium Quality Handpiece
- Bur stopper included for precise and controlled cutting
- Smaller head & enhanced technology with Fiber Optic
- Ergonomic design for a comfortable grip
- Constructed with high-quality raw materials
- 1:1 Gear Ratio with Internal irrigation for efficient & precise cooling
- **Bur size:** Ø 2.35mm
- Maximum speed of 40,000 min<sup>-1</sup>
- Autoclavable at 135° Celsius



## Internal Irrigation Low Speed Dental Handpiece

### Straight Head

ORDER: SIN-03C

CE: 1020-M4



- Premium Quality Handpiece
- Bur stopper included for precise and controlled cutting
- Ergonomic design for a comfortable grip
- Constructed with high-quality raw materials
- 1:1 Gear Ratio with Internal irrigation for efficient and precise cooling
- **Bur size:** Ø 2.35mm
- Maximum speed of 40,000 min<sup>-1</sup>
- Autoclavable at 135° Celsius



## Increasing Dental Handpiece

### 1:5 Fiber Optic Contra Angle I05F-01C



CE: 1024L-M4



- More stable with lower noise
- Powerful cutting force, greatly shorten the treatment time
- Fiber optic ensures clear vision
- 1:5 Increasing Gear Ratio
- Internal irrigation for efficient and precise cooling
- **Bur size:** Ø 1.60mm
- Maximum speed of 200,000 min-1
- Autoclavable at 135° Celsius



## Air Motor

### Surgical Straight Head

ORDER: BEN-02C

CE: 1024-B2



- Motion 360° rotation of the contra-angle handpiece on the motor
- Rust Free Corrosion Resistant
- **Air pressure:** 245-392 kPa
- Atomize water pressure: 200kPa
- E-type ISO international standard
- Maximum speed of 20,000 min-1
- Autoclavable at 135° Celsius

## High Speed Dental Handpiece

### Torque Head

ORDER: CK-08-B2

CE: 2305P-B2



- Stainless steel body for durability and corrosion resistance
- Ceramic bearings for smooth operation and extended lifespan
- Single spray system for effective cooling and irrigation
- Push Button chuck for easy bur changes
- Non-LED design for cost-effectiveness
- Inbuilt Clean head System for infection control
- **Bur size:** Ø 1.60 mm
- **Rotation speed:** 320,000-350,000min-1
- Autoclavable at 135° Celsius



## High Speed Dental Handpiece

### 45° Handpiece

ORDER: 45SPN-B-B2

CE: 2300P-45B

Extended burs available

Easy detachable structure

Single water spray accurate cooling the tip of bur



- The unique 45°angle provides improved access to difficult-to-reach areas in the oral cavity, enhancing precision during dental procedures.
- Powerful cutting force, greatly shorten the treatment time.
- **Reliable Build:** Constructed with high-quality materials to ensure durability and long-lasting performance in a dental practice.

## Mini High Speed Dental Handpiece



**Clean head system, stop blood & foreign matter from entering the head**

ORDER: MPN1-U-B2

CE:2303PL-B2

- Mini head is designed for children, easy to operate
- Ceramic bearings for smooth operation & extended lifespan
- Single spray system for effective cooling & irrigation
- Push Button chuck for easy bur changes
- Non-LED design for cost-effectiveness
- Inbuilt Clean head System for infection control
- **Bur size:** Ø 1.60 mm
- **Rotation speed:** 360,000-400,000 r/min
- Autoclavable at 135° Celsius



H2-02

## Mini LED High Speed Dental Handpiece



LED



H2-02

ORDER: MPL1-U-B2

CE: 2303PL-M4

- Anti back suction
- Rotation speed: 360,000-400,000r/min
- E-generator
- Self-illuminated
- Single water spray
- **Ultra Mini Head Design:** The Ultra mini head design provides excellent access to tight and hard-to-reach areas of the oral cavity, allowing for more precise dental work
- **Chuck Type:** It utilizes a chuck mechanism that securely holds dental burs and tools, ensuring they remain in place during procedures
- **High Precision:** This airtor offers high precision and accuracy, making it suitable for a wide range of dental treatments, including restorative and prosthodontic procedures
- **Smooth Operation:** The handpiece operates smoothly, reducing patient discomfort and providing better control for the dentist
- **Autoclavable:** The airtor can be autoclaved, simplifying the sterilization process and maintaining strict infection control standards
- **Durable Construction:** It is constructed with durable materials to withstand the rigours of daily dental practice



## LED High Speed Dental Handpiece

ORDER: TPL3-W-B2

CE: 2300PL-M4



- Rotation speed: 300,000-350,000 r/min
- Triple spray
- Noise:  $\leq 60$ dB
- Head height: 13.3mm
- **Super Torque:** The Airtor boasts exceptional torque, allowing for efficient tooth preparations, cavity preparations, and various dental procedures. Its powerful performance ensures quick and accurate results.
- **Push Button Operation:** The push-button mechanism simplifies tool changes during procedures. With a single press, you can release the current attachment, replace it with another, and secure it firmly in place, streamlining your workflow.
- **LED Illumination:** This model features built-in LED illumination, providing clear and shadow-free lighting of the treatment area. The bright LED light enhances visibility, allowing for precise and detailed work even in hard-to-reach areas of the mouth.
- **Ergonomic Design:** Airtor is designed with ergonomics in mind, ensuring a comfortable grip and reduced hand fatigue during prolonged procedures. Dentists can work with precision while maintaining patient comfort.
- **Versatile Compatibility:** It is compatible with standard dental burs and attachments, making it suitable for a wide range of dental applications, including restorative and surgical procedures.

## External Irrigation Low Speed Dental Handpiece

ORDER: CEN-01C

CE: 1024-B2



- **Chuck Type:** Push-button type, which allows for quick and easy changing of burs and other attachments
- **Head Size:** Small, which allows for better access to hard-to-reach areas of the mouth
- **Noise Level:** Designed to operate quietly, which can be beneficial for both the patient and the dentist
- **Weight:** Light and ergonomic, which can help to reduce hand fatigue and improve overall comfort during use
- **Max speed:** 20,000 r/min
- Autoclavable at 135° Celsius



## Surgical Handpiece For Implant

**Max Torque: 70N.cm**

ORDER: R20L-01C(201L)

CE: 3201CH



- Independent power supply with integrated generator
- Longer life compared to conventional LED bulbs
- Fatigue-free working thanks to optimal ergonomics
- Durable and robust
- 20:1 Reduction Gear Ratio
- Internal /external irrigation
- **Bur size:** Ø 2.35 mm
- Maximum speed of 2,000 min-1
- Autoclavable at 135° Celsius



## Increasing Dental Handpiece

ORDER: R20N-04C (201N)

CE: 3203CH



- Easy detachable structure
- Fatigue-free working thanks to optimal ergonomics
- Durable and robust
- 20:1 Reduction Gear Ratio
- Internal /external irrigation
- **Bur size:** Ø 2.35 mm
- **Maxtorque :** 80N.cm
- Maximum speed of 2,000 min-1
- Autoclavable at 135° Celsius



## External Irrigation Low Speed Dental Handpiece

ORDER: CEN-21C

CE: 1024-B2



- Premium Quality Handpiece
- Smaller head and enhanced technology
- Ergonomic design for a comfortable grip
- Constructed with high-quality raw materials, Long life span
- **Bur size:**  $\varnothing$  2.35 mm
- **Max speed:** 20,000 r/min
- Autoclavable at 135° Celsius



## External Irrigation Low Speed Dental Handpiece

ORDER: CEN-08C

CE: 1024-B2



- Ergonomic Design
- Smaller head and enhanced technology
- Push button
- Material Made up of Stainless steel
- Rust Free Corrosion
- **Bur size:**  $\varnothing$  2.35 mm
- **Max speed:** 20,000 r/min
- Autoclavable at 135° Celsius



**Hi-Clean Spray**

Hi-Clean Spray is a specially formulated, highly effective general handpiece and air motor lubricant. Frequent application of Hi-Clean will assure handpiece and air motor performance and durability. Apply Hi-Clean Spray every time before autoclaving any handpiece / air motor



**Multi Nozzle Adaptor for Effective Lubrication**



## Hi-Clean Spray

- Advanced lubricating cleaning agent
- Recommended by NSK
- CE & ISO certified
- FDA Approved
- Suitable for different dental handpieces & Air motors
- Safe for Autoclaving
- High Wear & Tear Prevention to mechanical parts
- Different Nozzles available for various handpieces
- Bottle Volume: 550ml



## Digital Ultrasonic Cleaner

- 3 colour LED display
- 1 to 30 - minute full range timer
- 5 temperature settings
- Solution usage timer
- Degas feature
- Independent power switch and detachable power cord, convenient to use
- Tank capacity 3 Ltr
- Frequency 35,000 Hz
- Tank Size 25 x 17.4 x 7.8 cm and Weight 5.1 Kg
- Tank material stainless steel SUS304

 **COVYSON**



Basket

Optional Accessories:

- SS Tray
- Rack
- Beaker
- Beaker Holder

## UV Chamber

- S.S. Chamber with 12 S.S Trays
- Imported Phillips 8W UV-C tube
- Equipped with 1 LED light to improve visibility when the door is open
- For storage of Sterilized instruments for longer period
- The door switch interlock prevents the emission of UVC light when the chamber is opened.



## Prime-Dent 7 Syringe Hybrid Kit

A light-cured resin-based composite used for all types of cavity preparations. An ideal choice for both anterior and posterior applications. Easy to mold, sculpt and polish to a high luster. Has high compressive strength as well as low shrinkage and resists wear and staining. Radiopaque for easy identifications in radiographs. Incisal (translucent) and dentin (opaque) shades available.



## Prime-Dent Flowable 4 Syringe Kit

- Hybrid Composite 4 Syringes
- 001-0144 x 4.5 g syringes (A2, A3, A3.5, B2)
- 3ml light curedentin/enamel bonding adhesive bottle
- 3ml etchant liquidbottle, brush holder
- 15 brush tips, mixing pad and IFU.



## Water Distiller

The water distiller is the best in its class. This distiller completes one litre of pure steam-distilled water in 1 hour. The boil chamber and condensing coils are high-grade 304 Stainless Steel. It comes with a high-quality plastic collection bottle, the lid and handle are made of food-grade polypropylene, and the lid is removable for convenience. Distilling your own water can't get any easier, simply fill the boiling chamber, press the start button, and walk away, the distiller will automatically shut off at the end of the cycle. It's very easy and convenient.

### Features

- Easy to use, produces pure steam distilled water
- Lightweight compact design, great for home and for medical use
- Eliminates plastic bottles from the store & saves you money
- Capacity - 4 Litres
- High-quality collection bottle for the purest water



## API Instrument Range

<b>API CROWN REMOVER</b>	TISSUE FORCEPS - ADSON TOOTH / NON-TOOTH – 7"
CROWN REMOVER (AUTOMATIC, GUN TYPE)	FORCEPS SET OF 14 (1, 4, 7, 13, 17, 18, 22, 51, 67, 74, 79, 86, 89, 90)
CROWN REMOVER (AUTOMATIC, GUN TYPE) Turkey	FORCEPS SET OF 12 (1, 7, 13, 17, 18, 73, 51A, 67A, 74N, 86, 89, 90)
CROWN REMOVER (SEMI - AUTOMATIC)	PEDO FORCEPS SET OF 7,
CROWN REMOVER (MANUAL)	<b>API-ELEVATORS</b>
CROWN & BRIDGE HOLDING FORCEPS WITH RING	ROOT ELEVATORS
<b>API-FORCEPS</b>	ROOT ELEVATORS – ASH MODEL
ALLIS FORCEPS	ROOT ELEVATORS – CROSS BAR
ARTERY FORCEPS 5" / 5.5"	ROOT ELEVATORS- WARWICK JAMES
ARTERY FORCEPS 6" / 7"	PERIOSTAL ELEVATORS – MOLT (SMALL / LARGE)
ARTERY FORCEPS 8"	PERIOSTAL ELEVATORS – BENQUE
ARTICULATING PAPER FORCEPS (Str. / Cvd.)	PERIOSTAL ELEVATORS – OHL
CHEETAL FORCEPS	PERIOSTAL ELEVATORS – FREER / ALAN
CROWN & BRIDGE HOLDING FORCEPS WITH RING	PERIOSTAL ELEVATORS – HOWARTH (Flat & Long)
FORCEPS – ADULT / PEDO ( Regular)	ROOT ELEVATORS SET OF 13
FORCEPS – ADULT / PEDO # 41, 44, 45, 68, 233, 235	ROOT ELEVATORS SET OF 9 (WITH CROSS BAR ELEVATORS)
FORCEPS – 22R / 22L / 88R / 88L	ELEVATORS – ROOT TIP (SET OF 3)
MOSQUITO FORCEPS	ROOT ELEVATORS WARWICK GEMS - SET OF 3
ROOT SPLINTER FORCEPS	ROOT ELEVATORS SET OF 3 (Hospital Pattern)
R. D. FORCEPS 99-497, 498	<b>API-NEEDLE HOLDER</b>
SINUS FORCEPS 6"	NEEDLE HOLDER -4"/ 5" / 5.5" (STRAIGHT / CURVED)
SPONGE FORCEPS 14.5 cm.	NEEDLE HOLDER – 6" & 7.5" (STRAIGHT / CURVED)
SPONGE FORCEPS 18 cm.	NEEDLE HOLDER – 8" (STRAIGHT / CURVED)
SUTURE FORCEPS 12 cm.	NEEDLE HOLDER – ADSON
SUTURE FORCEPS 15 cm.	NEEDLE HOLDER WITH CUTTER - OLSON
TISSUE FORCEPS TOOTH / NON-TOOTH	
TISSUE FORCEPS - ADSON TOOTH / NON- TOOTH	

## API Instrument Range

NEEDLE HOLDER – MATHIEW / WITH RING / CASTROVIJO
NEEDLE HOLDER – SAMHA
<b>API-RETRACTORS</b>
CHEEK RETRACTOR – ORINGER
CHEEK RETRACTOR -UNIVERSITY OF MINNESOTA
RETRACTOR – FARABEAUF (SET OF 2) 99-423 / 99-424
RETRACTOR – AUSTIN
RETRACTOR – LARGE
RETRACTOR – MEDIUM
RETRACTOR – SMALL
<b>API-SCISSOR</b>
SCISSORS - GOLDMAN FOX STR / CVD / D-CVD
SCISSORS - SPENCER (SMALL)
SCISSORS - SPENCER (Large)
SCISSORS – ANGULAR
SCISSORS - CASTROVEIJO
SCISSORS - CROWN Str. / Cvd.
SCISSOR - CROWN & PLATE CUTTING
SCISSORS – MAYO 4" / 6 " Cvd. / Str. (Surgical Scissor)
SCISSORS – METZENBAUM 14.5cm - Cvd. / Str
SCISSORS - SURGICAL "Kelly" – 6" Str. / Cvd.
SCISSORS - GUM (Double Upper Curved)
SCISSORS -GUM Straight / Side Curved / Upper Curved
SCISSOR – LOCKLIN
SCISSOR – SURGICAL 6" / 8"
SCISSOR – HEATH

<b>API-CHIESELS</b>
CHIESELS - 1mm / 2mm
CHIESELS - 3mm to 6 mm
CHIESELS - 8mm
PERIOSTAL CHIESEL – HOWARD / MEAD
ENAMEL CHIESELS -1mm - 2mm
<b>API - PROBE</b>
PROBE – CPITN
PROBE – GOLDMAN FOX
PROBE – MOONS
PROBE – UNC15
PROBE – NEBBERS
PROBE – MARQUES COLOUR CODED
PEOBE – WHO
<b>API - HAND INSTRUMENTS</b>
SCALERS
CARVERS
PROBE S/E
PROBE D/E
PLUGGERS
M M HANDLE
BURNISHERS
EXCAVATORS
CONDENSORS
PROBE - DG16
PROBE WILLIAM
CEMENT SPATULA
GRACY CURETTES
ENAMEL HATCHET
FILLING INSTRUMENTS



## API Instrument Range

UNIVERSAL CURETTES 2R-2L / 4R-4L
ENAMEL CHISELS -1mm - 2mm
GINGIVAL MARGINAL TRIMER #26, 27, 28, 29
PKT (MODELLING & CARVING) INSTRUMENTS
ENDO PROBE / SPREDERS 99-553 to 559
R.C. PLUGGER 99-569 to 572
PERIODONTEL POCKET PROBE 99-573 to 576
<b>API PLIERS</b>
PLIER ADAM, HOW, BIRD BEAK, BIRD BEAK-LONG TIP, OPTIC, UNIVERSAL, 3PRONG
PLIER BAND PINCHING – SET OF 2
PLIER BAND REMOVER POSTERIOR
PLIER BAND REMOVER ANTERIOR
PLIER CANINE CONTOURING / JOHNSON
PLIER CROWN CRIMPTING
PLIER DELA ROSA BAND CONTOURING
PLIER DELAROSA
PLIER NANCY
PLIERS REYNOLD
PLIER RIBAN ARCH
PLIER TWEED
PLIER WEIN GART UTILITY
PLIER WEINGART
PLIER BRACKET REMOVER DEBONDING STR / CVD
PLIER LINGUAL ARCH
PLIER CINCH
PLIER METHIEW WITH RING
PLIER CRIMPABLE HOOK PPLACEMENT
PLIER BAND FORMING

PLIER BALL & SOCKET
PLIER V BENDING
PLIER UNIVERSAL - LAB
PLIER SCHWARZ
PLIER WALDSACHS
<b>API- INSTRUMENTS KITS</b>
IMP. TRAY SET OF 10 (DENTULAS - PERFORATED / NON-PER.)
IMP TRAY SET OF 8 (E-DENTULAS-PERFORATED / NON-PER.)
IMP. TRAY SET OF 8 – DENTULAS – HALF
IMP. TRAY SET OF 6 (DENTULAS - PERFORATED)
IMPRESSION TRAY – HALF - ADJUSTABLE
RUBBER DAM KIT – With 10 Clamp & Clamp Holder
RUBBER DAM KIT - Paedo With 6 Clamp & Clamp Holder
ORAL SURGERY KIT (Set of 10)
MINOR / MICRO ORAL SURGERY KIT (Set of 25)
PLASTIC FILLING INSTRUMENT KIT (Set of 6) Regular
PLASTIC FILLING INSTRUMENT KIT (Set of 6) TC SOLID
P K THOMAS (CARVER) INSTRUMNETS KIT (Set of 5)
CONSERVATIVE INSTRUMENTS KIT (Set of 12, Blister Pack)
CONSERVATIVE INSTRUMENTS KIT (Set of 20)
PERIO SCALERS KIT-Set of 8
SCALERS KIT-8's (Sub-Zingawal) 1235/1, 2, 3, 4, 5, 6, 7, 8

## API Instrument Range

SCALERS KIT-Sub- 7's – with eye curettes (Sub-zingawal)
SCALERS KIT-8's (Suprazingawal)
SCALER KIT Set of 3 (1235-2-3, 235-2-3, 15/30) / MANIPAL SCALERS
CLINIC SET UP KIT
ORTHO. INSTRUMENT KIT SET OF 10
COMPOSITE INSTS. INTERIOR & POSTERIOR (S/10) BLACK T.C.
COMPOSITE GOLD T.C. HOLLOW HANDLE (SET OF 6)
COMPOSITE S.S. FINISH HOLLOW HANDLE (SET OF 6)
COMPOSITE INSTRUMENTS ASSORTED GOLD/BLUE/BLACK
FORCEPS SET OF 14 (1,4,7,13,17,18,22,51,67,74,79,86,89,90) Steel Finish
<b>API PREMIUM FORCEPS</b>
FORCEPS SET OF 14 (1,4,7,13,17,18,22,51,67,74,79,86,89,90) Steel Finish
FORCEPS SET OF 12 (1,7,13,17,18,73,51A,67A,74N,86,89,90) Dull Finish
FORCEPS SET OF 12 (1,7,13,17,18,73,51A,67A,74N,86,89,90) T.C. BLUE
FORCEP ATRUMATIC SET OF 6
FORCEP FINGER PATTERN SET OF 7(PEDO)
FORCEP SECURE (SET OF 11)
FORCEP FINGER PATRAN DULL FINISH /S.S. FINISH ASSORTED
FORCEP T.C. BLUE ASSORTED
FORCEP SECURE ASSORTED
FORCEP ATRUMATIC ASSORTED
PERIOSTEAL ELEVATORS GLICKMAN P24G HOLLOW

SINUS LIFT INSTRUMENTS (SET OF 8)
<b>API PREMIUM PLIERS</b>
PLIER BAND CONTOURING JOHNSON TC
PLIER BIRDBEAK LIGHT WIRE TC
PLIER CANINE CONTOURING TC
Plier Crimpable Hook Placement with TC Tip
PLIER CROWN CRIMPTING TC TIP
PLIER DISTEL END CUTTER T.C-API
PLIER HOW (CVD) TC
PLIER HOW (STR) TC
PLIES LIGATURE WIRE CUTTER WITH TC-API
PLIER Micro Ligature Cutter TC Tip
PLIER MICRO LIGATURE WIRE CUTTER (HARD WIRE)
PLIER MICRO LIGATURE CUTTER
PLIER SEPARATING TC TIP # 99-291
PLIER THREE BEAK/ 3 PRONG TC TIP
PLIER WEIN GART UTILITY TC TIP
PLIER WEIN GART UTILITY SLIM TC TIP
PLIER -Bracket Remover DEBONDING STR / CVD TC
PLIER -V BENDING TC
<b>API PREMIUM SCISSORS</b>
Scissor Castroviejo STR / CVD - Small / Large T.C.
Scissor Crown Stright / Curved T.C.
Scissor Goldman Fox T.C.
Scissor Gum Angular T.C.
Scissor Gum Straight / Curved T.C.
Scissor Heath 15.5cm T.C.

## API Instrument Range

Scissor Lagrange Double Curved T.C.
Scissor Metzbaum 14.5cm
Scissor Metzbaum 14.5cm T.C.
<b>API OTHER PREMIUM INSTRUMENTS</b>
Amalgam Carrier Back Push SWISS PATTERN
B P HANDLE MICRO HOLLOW RING TYPE
Bone Caliper with / without Slide Scale
Bone Chisel 3mm /4mm/ 5mm/ 7mm
Bone Collector 7mm/ 12mm
Bone File Schluger File # FS9/10S Hollow Handle
Bone File Sugarman # 1S/2S Hollow Handle
Bone File Sugarman # 3S/4S Hollow Handle
Bone Injector 2.5mm/ 3.5mm/ 4.4mm/ 7mm
Bone Mallet 17cm / 19cm
Bone Mill (Titanium Teeth)
Bone Punch Set of "2"
BONE ROUNDER Double Action
Bone Scraper Set of "2"
BUCCAL TUBE HOLDER SMALL
BUCCAL TUBE HOLDER LARGE
Caliper Castroviejo Straight / Curved
Caliper Weiss Modified Castroviejo
COMPOSITE INSTS. INTERIOR & POSTERIOR (S/10) BLACK T.C.
COMPOSITE GOLD T.C. HOLLOW HANDLE (SET OF 6)
COMPOSITE S.S. FINISH HOLLOW HANDLE (SET OF 6)
COMPOSITE INSTRUMENTS ASSORTED GOLD/ BLUE/BLACK
CONSERVATIVE INSTRUMENTS (SET OF 19)
CURETTES KRAMER NAVINS PKN1

CURETTES LANGER 1/2, 3/4, 5/6
CURETTES UNIVERSAL Columbia 2R-2L / 4R-4L Hollow Handle
CURRETE MC CALL #17S/18S HOLLOW HANDLE
CURRETE MC CALL SMTC 13S/14S HOLLOW HANDLE
ROOT ELEVATORS LINDO-LEVIAN SET OF 6
ROOT ELEVATOR T.C. BLUE
ROOT ELEVATOR S.S. FINISH
ENDO-SURGICAL KIT (SET OF 13)
GRACY CURETTES (Set of 7)
GRACY CURETTES (Set of 9)
GRACY CURETTES (Set of 11)
Krikland Kinfe # 15k/16k Hollow Handle
MAMBRANE HOLDER T.C. BLUE
Needle Holder Castroviejo STR / CVD T.C.
Needle Holder DERF 12.5cm T.C.
Needle Holder DERF 16 cm T.C.
Needle Holder MATHIEW SMAHA
Needle Holder OLSEN HEGAR
Ochsenbien Chisel # CO4 Hollow Handle
Orban Knife # KO 1/2 Hollow Handle
Osteotomes Bone Chisel 7.5mm
Osteotomes Bone Chisel 7.5mm Curved
Osteotomes with / without Stoppers (Set of 12) Concave / Convex
Osteotomes with / without Stoppers (Set of 10) Concave / Convex
Osteotomes/ Bone Expander (Set of 4)
Periosteal ELEVATORS Benque # PBO Hollow Handle
Periosteal ELEVATORS BUSER PBU HOLLOW

## API Instrument Range

PERIOSTAL ELEVATORS GLICKMAN P24G HOLLOW
PERIOSTAL ELEVATORS GOLDMAN FOX P14
PERIOSTAL ELEVATORS HIRSCHFELD P20
Periostal ELEVATORS P24G Hollow Handle
PERIOSTAL ELEVATORS MOLT9 Large P9
PERIOTOME WITH 3 TIPS
P K THOMAS (CARVER) INSTRUMNETS KIT (set of 5)
PLASTIC FILLING INSTRUMENTS (SET OF 6)
PMT (Probe + Mirror with Handle+ Tweezer)
Pocket Marker GOLDMAN FOX (Left)
Pocket Marker GOLDMAN FOX (Right)
Probe UNC # PCP 15/11.5 Hollow Handle D/E
Probe UNC #PCUNC 156 Hollow Handle
Probe WHO # PCP11.5B Hollow Handle
Probe William Hollow Handle
ROOT ELEVATORS Warwick Gems Set of 3
ROOT FRAGMENTS STRIGHT/45°/90°
ROOT CANAL PLUGGER COLOUR CODED (SET OF 8)
ROOT CANAL PLUGGER COLOUR CODED
ROOT CANAL PLUGGER ASSORTED
Scaler # SH 6/7 Hollow Handle
Scaler #SCM152 Hollow Handle
Scaler 1235/5-6 Hollow Handle
Scaler Anterior # SN 137 Hollow Handle
Scaler Posterior # 204 SA Hollow Handle
SCALER POSTERIOR 204S
SCALER POSTERIOR SN135
SCALER SC NEVI -1 HOLLOW

SCALER SC NEVI -2 HOLLOW
Scaler SU 15/30 Hollow Handle
SINUS LIFT INSTRUMENTS (SET OF 8)
SINUS LIFT INSTRUMENTS ASSORTED
SUTURE PLIER
Tissue Forceps Micro Gerald 1:1 / 1:2 Teeth
Tissue Nipper
TWEEZER - With / Without Hole Handle
BRACKET HOLDING TWEEZER LOCKING BHT5
Wire Twister 13cm T.C.
Wire Twister 16 cm T.C.
CARTRIDGE SYRINGE - INTRALIGAMENTRY- INDEX FINGER PUSH



## Unicorn MediDent Pvt. Ltd.

Delhi Office:

3, LSC, MOR Land, Near J Block,  
New Rajinder Nagar, New Delhi -110060



Ver 01/24



SCAN TO VISIT  
WEBSITE