

POOL & SPA EQUIPMENT



2025
PRODUCTS CATALOGUE

DIVE INTO QUALITY >>>

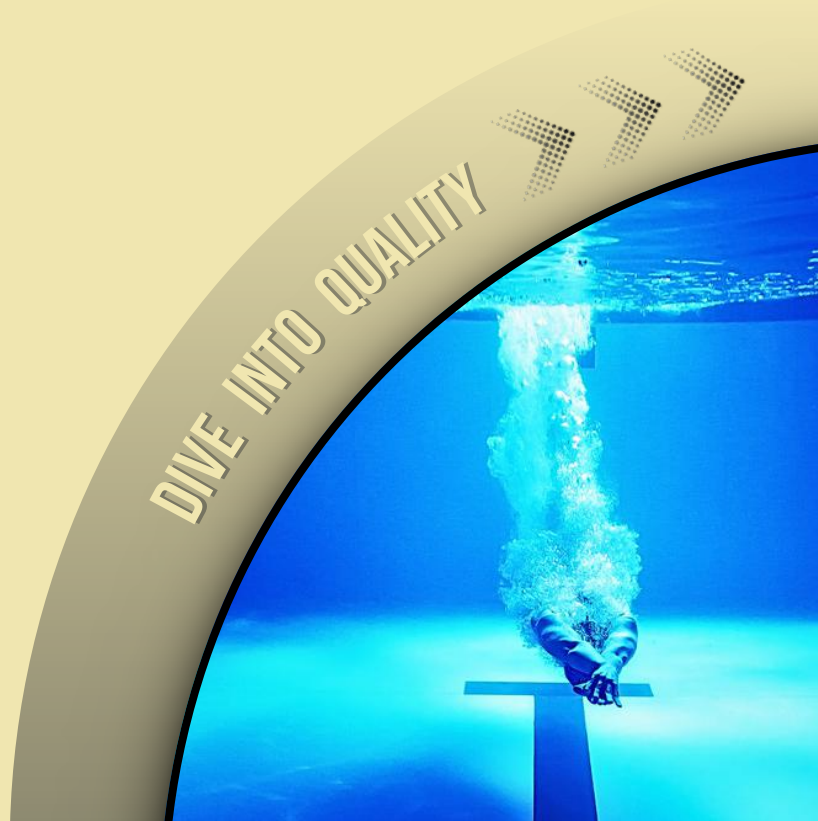





TABLE OF CONTENTS

Introduction

- 02 Company Introduction
- 03 About FÉNIX
- 04 Signature products
- 05 Product Warranty

Pool Robots

- 08 FR20 Robot

Heating & Cooling

- 12 F-PH Heat Pump
- 14 FI-PH Inverter Heat Pump
- 16 Caldor Heat Exchanger

Pool Pumps

- 20 Ongane Pump
- 22 FSB Pump
- 24 Ongane Excel-Power Pump
- 26 Ongane Ultime-Power Pump
- 28 OnganeMini Pump

Air Blowers

- 30 Aria Spa

Pool Filters

- 34 Citrin Side-Mount Series
- 36 Citrin Top-Mount Series
- 38 CitrinEco Series
- 40 Massif Series
- 42 Sablex Series
- 44 SablexBleu Series
- 46 CitrinPlus Series

Cleaning Tools

- 49 Cleaning Tools

Pool Fittings

- 52 Standard Skimmer
- 53 Surface Skimmer
- 54 Vacuum & Inlet Fitting
- 55 Main Drain
- 56 Gratings, Tiles & Spa Jet
- 57 Extra Fittings

Ladders

- 60 FLST / FLMI / FLOF Ladder Series

Underwater Lights

- 64 FXD Light Series
- 66 FWH / FL Light Series
- 67 D64 Light Series & Accessories

Disinfection Systems

- 70 UV-C / UV-Ozone Systems
- 73 Inline Zinc Anode Shield
- 75 Chemical Feeder

Dehumidification

- 78 F-DH108B Dehumidifier



FÉNIX

Your Ultimate Pool Equipment Solution

With over thirty years of experience in the industry, we are experts in designing, developing, and distributing top-of-the-line swimming pool & spa equipment.

Design & Engineering

Production of high-quality equipment



Research & Development

Innovative, reliable and long-lasting



Distribution Network

Serving Europe, Middle East & Africa

Marketing Support

Ensuring successful partnership



Technical Support

Pre-sale & After-sale services



Quality Assurance

Through rigorous testing processes

About Us

www.fenixpool.fr

At **FÉNIX Équipement De Piscines Ets.**, we take pride in providing top-quality products, cutting-edge solutions, and expertly crafted designs, backed by 30+ years of experience in the swimming pool industry. As trusted suppliers in the field, we recognize the vital role our products play in enhancing your well-being and quality of life.

Our mission is to establish thriving partnerships with our clients, empowering them to provide their customers with top-notch products and exceptional experiences. We believe in building long-term relationships based on trust, reliability, and mutual success.

Our aim is to create unforgettable experiences for our partners & their customers, transforming pools and spas into gateways for enhanced well-being and enjoyment for all.

FÉNIX Is Here To Meet Your Needs

Experience the power of a thriving partnership with FENIX.

We are committed to constantly improving and staying at the forefront of the industry, embracing advancements in technology and engineering while mastering the art of designing premium pool and spa equipment. By offering a wide range of high-quality products and services, we strive to meet the diverse needs and preferences of our partners and their customers.

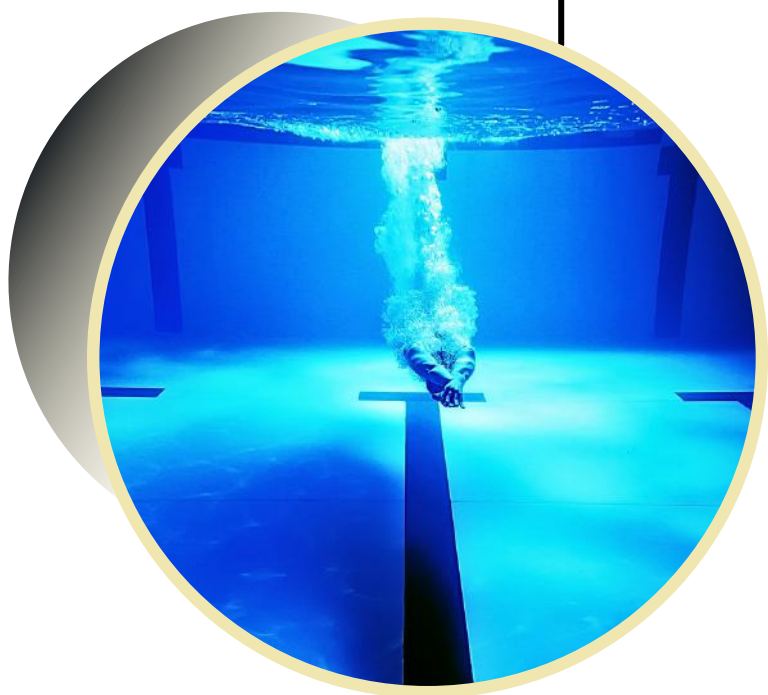



FÉNIX SIGNATURE PRODUCTS

Quality Pool Equipment Collection



FR20 Robotic Cleaner

For Floor, Wall & Waterline

Offers efficient cleaning for your pool: Crystal clear water, smart cleaning, economical solution.



Ongane Pool Pump

Self-Priming Pump

Designed with expertise, advanced technology, and strict quality control to meet international standards.

FI-PH Inverter Heat Pump



Eco-Friendly & Silent Operation

Advanced full inverter technology, intelligent defrosting, Eco-Friendly R32 Refrigerant, and Easy Smart Control via the Smart Life App.



FXD Underwater Light



Elegant Design & Vibrant Colors

Offers both beauty and functionality illuminating your pool with stunning, energy-efficient LED lighting.





PRODUCT WARRANTY POLICY

Warranty Policy

Introduction

Fénix Equipement De Piscines Ets., (FENIX), ensures its products adhere to the highest standards of craftsmanship, utilizing top-quality materials and advanced processes. This warranty replaces any prior publications. FENIX reserves the right to update or modify the warranty terms and conditions without prior notice. It is the responsibility of the customer to regularly review the latest version of the warranty policy for any changes or updates.

This warranty does not apply in the case of:

1. Damage due to misapplication, misuse, abuse or failure to operate and install the equipment as specified in FENIX's installation instructions.
2. Damage due to mishandling, improper repackaging, or shipping.
3. Damage due to use or installation of the equipment beyond the professional level required for similar equipment or installation types.
4. Damage due to unauthorized product modifications or failure to use original replacement parts of FENIX.
5. Damage caused by negligence or failure to properly maintain products as specified in the owner's manual.
6. Damage caused by failure to maintain water chemistry in accordance with industry standards for any duration.
7. Damage caused by water freezing inside the product.
8. Wear and tear of product parts are not covered.
9. Accidental damage, fire, misapplication of electricity, physical force or other circumstances outside the control of FENIX.
10. Intentional modification, alteration, or repair made to any part of the product by an unauthorized person, not authorized by FENIX.

FENIX Product Warranty List

Product	Warranty Period
PUMP	
Ongane Pump	3 years (Seal & O-ring - 1 year)
OnganEX Pump	3 years (Seal & O-ring - 1 year)
Ongane Ultime-Power Pump	3 years (Seal & O-ring - 1 year)
FSB Series Pump	3 years (Seal & O-ring - 1 year)
HEATING & COOLING EQUIPMENT	
Heat Pumps	1 Year
CALDOR Heat Exchanger	1 Year
FILTER	
Citrin Series Filter	5 Years Pro-rata* - filter tank, 1 year - all other parts
CitrinEco Series Filter	5 Years Pro-rata* - filter tank, 1 year - all other parts
Massif Series Filter	5 Years Pro-rata* - filter tank, 1 year - all other parts
Sablex Series Filter	3 Years - filter tank, 1 year - all other parts
SablexBleu Series Filter	3 Years - filter tank, 1 year - all other parts
CitrinPlus Series Filter	3 Years - filter tank, 1 year - all other parts
POOL ROBOTS	1 Year
AIR BLOWERS	1 Year
CLEANING TOOLS	1 Year
POOL FITTINGS	1 Year
UNDERWATER LIGHT	1 Year
DEHUMIDIFICATION	1 Year
DISINFECTION	
UV-C & UV-Ozone	2 Years (1 year Sleeve & lamp)
Salt Chlorinator	2 Years
Dosing Control Pump	2 years
Chemical Feeder	1 Year

Effective From Date of Invoice

* Pro-rata = 3yrs full, 4th 50%, 5th 30%

How To Make a Warranty Claim

Customers initiate a warranty claim by contacting FENIX's dedicated sales representative. This initial contact involves providing detailed information about the claim, including essential details such as part numbers, serial numbers, a clear description of the complaint or failure, and supporting images/videos. Once the complaint is submitted, FENIX team will review and perform a thorough examination of the claim by adhering to FENIX warranty policy guidelines to assess its validity and determine the appropriate course of action.

Upon the completion of the investigation, the FENIX team engages directly with the customer, providing comprehensive updates about the claim and addressing their needs accordingly.

FENIX Limitations Of Liability

In the event of a valid warranty claim, FENIX will, at its discretion, either repair or replace the defective product or part covered by the warranty at its own cost and expense. All repaired or replacement products will undergo rigorous quality checks to ensure they meet FENIX's high standards of workmanship and performance.

FENIX does not cover shipping or transportation costs for returning products to the company or delivering repaired or replacement products to the customer. FENIX is not liable for any loss of time, inconvenience, or incidental expenses such as labor costs, phone calls, legal costs, or material costs associated with the replacement or removal of the product. Moreover, FENIX shall not be held responsible for any consequential or incidental damages to persons or assets. Business profit loss due to operational stoppage and non-conformity of the product is also outside the scope of FENIX's responsibility. No indemnity or damages can be claimed under any circumstances.

Disclaimer Regarding External Warranties and Representations

- No dealer or individual holds the authority to provide or extend warranties on behalf of FENIX.
- FENIX explicitly disclaims responsibility for any such warranties or representations made by dealers or other parties.
- In the event of disputes, Fénix Equipement De Piscines Ets. retains the ultimate right to exercise all warranties. This underscores the importance of referring to the official and current FENIX Warranty Policy for accurate and up-to-date information regarding warranty claims and dispute resolution.





POOL ROBOTS



FENIX FR20

Robotic Pool Cleaner - Floor & Wall



CE



Integrated remote control.



Cable length: 18m.

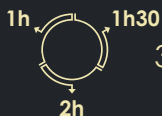

3 Cycles are available.



A water depth $\leq 2\text{m}$ is recommended.



FENIX FR20

Robotic Pool Cleaner - Floor, Wall & Waterline

**The Fénix FR20 pool Robot offers efficient cleaning for your pool:
Crystal clear water, smart cleaning, economical solution.**

The Fénix FR20 is capable of cleaning the pool's floor, walls, and waterline, and is suitable for both above-ground and in-ground pools of up to 200m² in any shape. It comes with three pairs of filter bags that have different filtration accuracies. It is easy to remove the filter bag for cleaning and maintenance.

The control box is a handy feature that allows users to select one of three working cycles based on the amount of debris present in the pool. Additionally, an "Auto Start" program is included in the control box, enabling users to schedule the Fénix FR20 to clean the pool daily, every three days, or every seven days.

Specifications

- Rated input voltage: 220VAC (230VAC)
- Frequency: 50Hz / 60Hz
- Output voltage: DC20V
- Power: 200W
- Cleaning cycle: 1H/1.5H/2H
- Cleaning Surface: 200m²
- Auto-start timer: 1D/3D/7D
- Filter capacity: approx. 20m³/h
- Filtration accuracy: 100/200/400µm
- Moving speed: approx. 12.5m/min
- IP grade: Cleaner IPX8; Power supply: IPX5
- Working temperature: 0°C-40°C
- Remote distance: < 20m
- Frequency of remote control: 433MHz

Accessories



Cable



Control Unit



Filter Bags





HEATING & COOLING



F-PH HEAT PUMP

Residential Pool Heating & Cooling



Smart Control Using:



Aquatemp App



App Store



Google Play



-7 ~ 43°C Operating Air Temperature



R32 Refrigerant Type



50mm Pool Water Connection



F-PH HEAT PUMP

Residential Pool Heating & Cooling

Key Features of FPH Heat Pump:

- **Intuitive Rotary Button:** The FPH controller is designed to seamlessly match your preferred style and usage patterns, featuring a user-friendly rotary button.
- **Spiral Titanium Tube:** The heat pump incorporates a high-quality Spiral Titanium Tube, known for its exceptional corrosion resistance and ability to enhance heat exchange efficiency.
- **Smart PCB:** The PC1002 model boasts an advanced temperature control system and utilises a powerful 32-bit Processor on its main board, enabling high-speed operations. Additionally, the main board is equipped with an RS485 interface, facilitating integration with a centralised control system for your pool.
- **Environmentally-friendly Refrigerant R32:** The heat pump utilizes the eco-friendly refrigerant R32, which has minimal environmental impact, with an Ozone Depletion Potential (ODP) of 0 and a Global Warming Potential (GWP) of 675.

Technical Information:

Fénix FPH Swimming Pool Heat Pump								
Power Supply 230V~/50Hz	F-PH15	F-PH25	F-PH35	F-PH45	F-PH60	F-PH70	F-PH100	F-PH110
Power Supply 380V~/50Hz	-	-	-	F-PH45T	F-PH60T	F-PH70T	F-PH100T	F-PH110T
Performance Condition (Air 27°C / Water 24.3°C / Humidity 80%)								
Heating Capacity (kW)	3.93	5.81	8.31	11.50	13.50	16.10	23.10	25.80
Heating Capacity (Btu)	13362	19754	28254	39000	45900	54740	78540	87720
Input Power (kW)	0.68	0.99	1.31	1.95	2.35	2.48	3.60	4.10
COP	5.78	5.87	6.34	5.90	5.74	6.49	6.42	6.29
Performance Condition (Air 24°C / Water 19°C / Humidity 62%)								
Heating Capacity (kW)	3.57	5.10	7.50	9.70	12.50	14.10	20.20	23.50
Heating Capacity (Btu)	12138	17340	25500	33100	42500	47940	68680	79900
Input Power (kW)	0.68	0.96	1.26	1.80	2.30	2.26	3.36	3.80
COP	5.25	5.31	5.95	5.22	5.43	6.24	6.01	6.18
Performance Condition (Air 15°C / Water 12°C / Humidity 70%)								
Heating Capacity (kW)	3.04	4.12	5.71	7.80	9.80	11.12	16.20	19.10
Heating Capacity (Btu)	10336	14008	19414	27200	33320	37808	55080	64940
Input Power (kW)	0.73	0.97	1.32	1.70	2.17	2.18	3.20	3.75
COP	4.20	4.25	4.33	4.59	4.52	5.10	5.06	5.09
Other Technical Details								
Fan Quantity	1	1	1	1	1	1	2	2
Fan Speed (RPM)	840	840	850	850	830	830	850	850
Sound Pressure 1m (dB(A))	48	50	52	54	55	56	58	60
Water Flow Volume (m³/h)	1.5	2.2	3.0	4.5	5.3	6.0	7.5	9.0
Max. Water Pressure Drop (kPa)	2.0	2.5	2.5	2.6	2.8	3.0	8.5	10.1
Advised Pool Volume (m³)	17	25	35	45	58	70	100	108
Product Dimensions (mm)	800*340*575		996*403*600		1155*470*868		1042*455*1250	



FI-PH INVERTER HEAT PUMP

Residential Pool Heating & Cooling



Smart Control Using:



Smart Life App



App Store



Google Play



-7 ~ 43°C Operating Air Temperature



R32 Refrigerant Type



50mm Pool Water Connection



FI-PH INVERTER HEAT PUMP

Residential Pool Heating & Cooling

Key Features of FI-PH Inverter Heat Pump:

- **Full Inverter Technology:** The heat pump is equipped with advance full inverter technology, which allows precise and efficient control of the compressor motor's speed. This results in higher energy efficiency and reduced operating costs.
- **Quiet Operation:** The full inverter heat pump operates with reduced noise levels, ensuring a peaceful and relaxing pool environment.
- **Intelligent Defrosting:** The heat pump incorporates advanced defrosting technology that allows automatic defrosting according to the ambient temperature. This ensures optimal functionality and protect the device from damage.
- **Environmentally-friendly Refrigerant R32:** The heat pump utilises the eco-friendly refrigerant R32, which has minimal environmental impact, with an Ozone Depletion Potential (ODP) of 0 and a Global Warming Potential (GWP) of 675.
- **Easy Control:** User-friendly controls and smart display, making it easy to set and adjust the desired temperature and operational settings. Users can also leverage the use of the Smart Life App for smart control of the heat pump.

Technical Information:

Fénix FI-PH Full Inverter Swimming Pool Heat Pump									
Heat Pump Model	FI-PH45	FI-PH55	FI-PH70	FI-PH80	FI-PH95	FI-PH110	FI-PH95T	FI-PH110T	FI-PH120T
Advised Pool Volume (m³)	20 ~ 45	30 ~ 55	40 ~ 70	40 ~ 80	50 ~ 95	55 ~ 110	50 ~ 95	55 ~ 110	65 ~ 120
Performance Condition (Air 27°C, Inlet / Outlet Water 26°C / 28°C, Humidity 80%)									
Heating Capacity (kW)	1.78 ~ 9.22	2.93 ~ 11.38	3.56 ~ 15.48	4.48 ~ 18.15	4.68 ~ 21.15	5.25 ~ 25.12	4.69 ~ 21.16	5.28 ~ 25.14	5.62 ~ 28.40
Consumed Power (kW)	0.11 ~ 1.42	0.18 ~ 1.79	0.22 ~ 2.50	0.27 ~ 2.91	0.29 ~ 3.38	0.32 ~ 3.96	0.29 ~ 3.37	0.32 ~ 3.94	0.34 ~ 4.53
COP	16.18 ~ 6.49	16.27 ~ 6.35	16.18 ~ 6.19	16.59 ~ 6.23	16.13 ~ 6.25	16.40 ~ 6.34	16.17 ~ 6.27	16.50 ~ 6.38	16.52 ~ 6.26
Performance Condition: Air Temperature: 15°C, Inlet Water Temperature: 26°C, Humidity 70%									
Heating Capacity (kW)	1.65 ~ 7.76	2.32 ~ 8.46	2.75~11.32	3.52 ~ 13.14	3.61 ~ 14.34	3.61 ~ 17.34	3.63 ~ 14.36	3.63 ~ 17.35	4.35 ~ 18.76
Consumed Power (kW)	0.20 ~ 1.49	0.28 ~ 1.59	0.33 ~ 2.13	0.43 ~ 2.48	0.42 ~ 2.78	0.44 ~ 3.38	0.42 ~ 2.77	0.44 ~ 3.37	0.52 ~ 3.36
COP	8.25 ~ 5.20	8.28 ~ 5.32	8.33 ~ 5.31	8.18 ~ 5.29	8.59 ~ 5.15	8.20 ~ 5.13	8.64 ~ 5.18	8.25 ~ 5.14	8.36 ~ 5.58
Performance Condition (Air 35°C, Inlet Water 28°C, Humidity 80%)									
Cooling Capacity (kW)	3.98	4.86	6.78	8.65	9.32	11.05	9.3	11.02	13.05
EER	2.05	1.93	1.88	1.84	1.91	1.82	1.9	1.85	1.95
Other Technical Details									
Max. Power Input (kW)	1.7	2.3	3.2	3.9	4.3	4.5	4.3	4.5	5.2
Max. Current (A)	7.9	10.5	14.5	15.9	17.6	19.6	9.2	10.1	12.3
Fan Specifications	Motor Type: DC, Blade Type: Axial Flow Fan, Motor Quantity: 1, Fan Speed: 500 ~ 830 RPM								
Sound Pressure 1m (dB(A))	36 ~ 47	36.5 ~ 47.5	38.5 ~ 49	40 ~ 50	41 ~ 51	41 ~ 52	41 ~ 51	41 ~ 52	41.5 ~ 52.5
Sound Pressure 10m (dB(A))	16 ~ 27	16.5 ~ 27.5	18.5 ~ 29	20 ~ 30	21 ~ 31	21 ~ 32	21 ~ 31	21 ~ 32	21.5 ~ 32.5
Advised Water Flow (m³/h)	4.0	5.0	6.5	7.8	9.1	10.8	9.1	10.8	12.0
Water Pressure Drop (kPa)	13	15	18	20	35	35	35	35	38
Net Dimensions L/W/H (mm)	911×367×603		986×400×650		1126×430×755				
Gross Dimensions L/W/H (mm)	974×384×610		1054×430×660		1193×464×765				
Net Weight (Kg)	43	45	53	56	76	87	76	87	91
Gross Weight (Kg)	50	52	60	64	85	96	85	96	100
Power Supply / Frequency	220-240V ~ / 1Ph, 50Hz/60Hz						380V ~/3Ph, 50Hz/60Hz		
Compressor Brand	Mitsubishi								
Heat Exchanger	Spiral titanium tube in PVC shell								
Operating Air Temp. (°C)	-10 ~ 43								
Refrigerant	R32								



CALDOR HEAT EXCHANGER

Outstanding Heat Transfer Capacity



Premium Acid-resistant AISI-316 Stainless Steel



Max. Water Temperature: 130°C



Max. Pressure: Primary 10.0 bar / Secondary 5.0 bar



CALDOR HEAT EXCHANGER

Outstanding Heat Transfer Capacity

A CALDOR heat exchanger is designed to efficiently transfer heat energy from one medium to another, ensuring that the two media remain separate. With its cross-flow operation, CALDOR heat exchangers deliver impressive performance and exceptional heat transfer efficiency. A CALDOR heat exchanger can be integrated with various heat sources including electric, boilers, heat pumps and solar panel systems.

The CALDOR heat exchanger is made from premium acid-resistant AISI-316 stainless steel for exceptional durability. It is equipped with seamless pipes featuring flow restrictors, maximizing heat exchange capacity.

Product Dimensions:

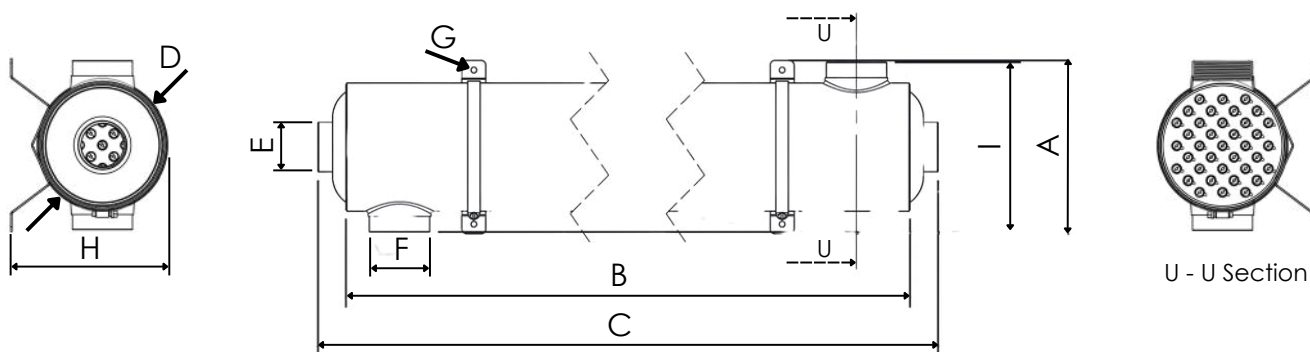

Model	A (mm)	B (mm)	C (mm)	D (mm)	E (mm)	F (mm)	G (mm)	H (mm)	I (mm)
CALDOR135	180	302	360	Ø133	25.4 (1.0")	38.1 (1.5")	Ø6	165	170
CALDOR200	180	422	480	Ø133	25.4 (1.0")	38.1 (1.5")	Ø6	165	170
CALDOR260	180	542	600	Ø133	25.4 (1.0")	50.8 (2.0")	Ø6	165	176
CALDOR400	180	1012	1070	Ø133	38.1 (1.5")	50.8 (2.0")	Ø6	165	176

Technical Information:

Max. Pressure: Primary 10 bar / Secondary 5 bar

Max. Water Temperature: 130°C

Model	Capacity			Pool Water Flow Rate	Hot Water Flow Rate	Length (C)	Diameter (D)
	kBtu/h	kW	kcal/h	m³/h	m³/h	mm	mm
CALDOR135	135	40	34000	12.0	1.5	360	Ø133
CALDOR200	200	60	51000	15.0	1.8	480	Ø133
CALDOR260	260	75	65000	18.0	2.1	600	Ø133
CALDOR400	400	120	100000	21.6	3.0	1070	Ø133

The heat exchanger should not be utilised in saltwater or swimming pools with a chlorinator.





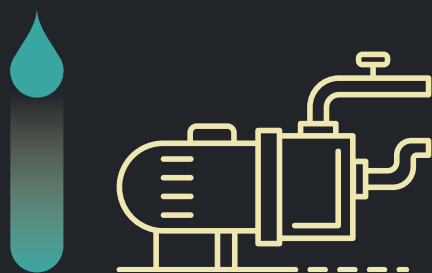

POOL PUMPS



ONGANE PUMP

Self-Priming pool pump



CE



Self-Priming Up To 2.5m
Above Water Level



Motor Insulation Class F



IPX5 Waterproof Standard



2 Liter Basket Volume



Testing Pressure 3.5 bar



Overload Protection



ONGANE PUMP

Self-priming Pool Pump

The Fénix Ongane pool pump has been designed through a combination of extensive experience, cutting-edge technology, and a rigorous quality control system that adheres to internationally accepted standards. This approach ensures that the pump not only meets but exceeds the expectations of pool owners, delivering outstanding performance and reliability.

The pump is a self-priming type, featuring a built-in pre-filter with a 2-liter basket to enhance the overall efficiency of the filtration system. Its two-pole motor is equipped with a shaft and a mechanical seal spring, both made of 316 stainless steel with close tolerances to ensure an effective sealing system. The dynamically balanced rotary parts of the pump provide a smooth and quiet operation, free from vibrations and noise. Crafted from high-quality materials, all parts of the Ongane pump and motor are designed to maximize longevity and efficiency, providing reliable performance for your pool.

Product Dimensions:

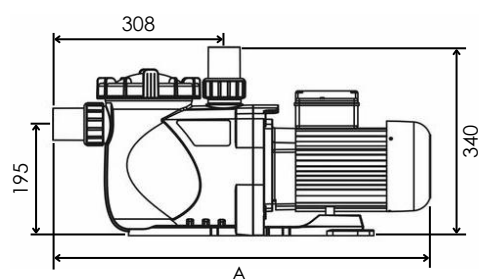

All dimensions in mm

Models FO075 - FO200:
A = 652 mm

Model FO300:
A = 682 mm

Item	Material
Motor Shaft	Stainless Steel 316
Pump Casing	Glassfiber reinforced ABS
Base	Polypropylene + Glassfiber
Strainer Basket	Polypropylene + Glassfiber
Impeller	Polyphenylene Oxide
Seal Bellows	EPDM
Stationary Face	SIC
Rotating Face	Graphite
Spring	Stainless Steel 316

Technical Information:

Model	Voltage	Input Power (kW)	Current (Amp)	Noise (dB)	Horsepower (hp)	Weight (Kg)	Flow Rate (m³/h) @					
							6m	8m	10m	12m	14m	16m
FO075	220 - 240V / 50Hz	0.75	3.5	65	0.75	13.6	15.0	12.5	9.5	5.0	-	-
FO100	220 - 240V / 50Hz	1.1	5.0	65	1.0	13.8	19.5	17.5	15.2	12.5	9.0	3.0
FO150	220 - 240V / 50Hz	1.5	6.8	67	1.5	14.0	24.0	22.0	19.9	17.5	14.0	10.0
FO200	220 - 240V / 50Hz	1.8	8.2	67	2.0	14.2	27.5	25.5	23.0	21.7	18.0	14.5
FO300	220 - 240V / 50Hz	2.2	10.0	68	3.0	14.5	30.0	28.5	26.0	23.8	21.0	18.0
FO100	380 - 400V / 50Hz	1.1	5.0	65	1.0	13.8	19.5	17.5	15.2	12.5	9.0	3.0
FO150	380 - 400V / 50Hz	1.5	6.8	67	1.5	14.0	24.0	22.0	19.9	17.5	14.0	10.0
FO200	380 - 400V / 50Hz	1.8	8.2	67	2.0	14.2	27.5	25.5	23.0	21.7	18.0	14.5
FO300	380 - 400V / 50Hz	2.2	10.0	68	3.0	14.5	30.0	28.5	26.0	23.8	21.0	18.0

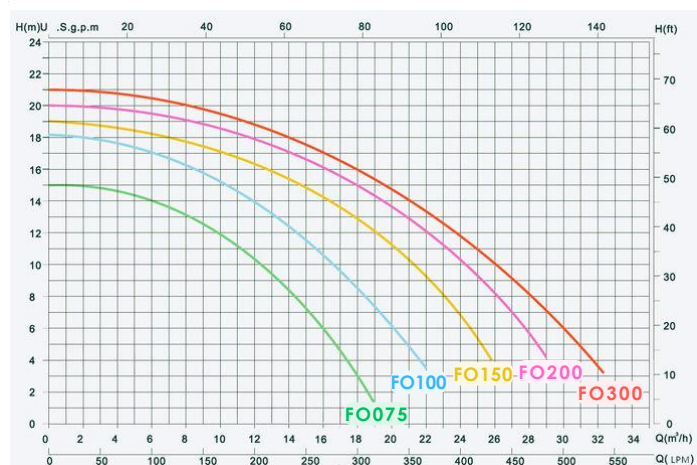

RPM: 2850 rev./min
Connection Size: 1.5" (50 mm) / 2.0" (63 mm)





FSB POOL PUMP SERIES

Reliable Lasting Performance



Asynchronous,
two-pole motor



316SS Shaft & mechanical seal



Motor Insulation Class B



Testing Pressure 3.5 bar



IPX5 Waterproof Standard



Thermal & Overload Protection



FSB POOL PUMP SERIES

Reliable Lasting Performance

The FENIX FSB Series Pump combines high flow with energy-efficient ultra performance.

It features 2-inch suction and discharge ports with a transparent lid, while its ring-lock seal design ensures leak elimination and optimized suction efficiency. Powered by an asynchronous two-pole motor, the pump includes motor insulation Class B for reliable operation. Its IPX5 waterproof rating offers enhanced protection against water ingress, while built-in thermal protection and overload protection ensure safe and durable performance.

The FENIX FSB Pump has specially designed unions which are compatible with both Imperial and Metric standards, making installation seamless. With a testing pressure of 50 psi (3.5 Bar), it features a robust 316 stainless steel shaft and mechanical seal for long-lasting durability and corrosion resistance.

Product Dimensions:

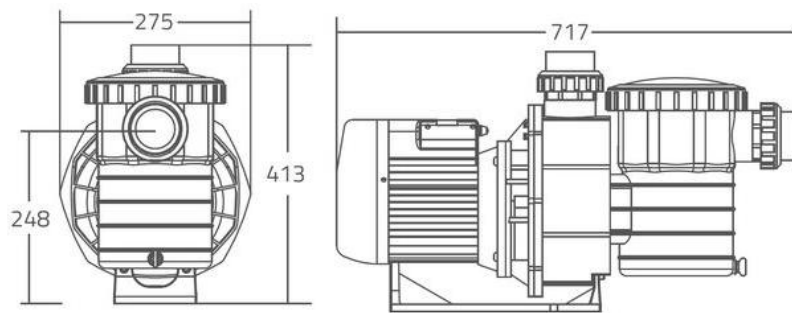

Connection Size: 2.0" (63 mm)

Technical Information:

Model	Voltage	Input Power (kW)	Current (Amp)	Noise (dB)	Horsepower (hp)	Connection Size	Weight (Kg)
FSB10	230V / 50Hz	0.97	4.7	67	1.0	2" / 63mm	16
FSB15	230V / 50Hz	1.30	5.9	67	1.5	2" / 63mm	17
FSB20	230V / 50Hz	1.80	8.2	69	2.0	2" / 63mm	23
FSB30	230V / 50Hz	2.18	10.5	69	3.0	2" / 63mm	24

Model	Flow Rate (m³/h) @					
	6m	8m	10m	12m	14m	16m
FSB10	16.4	14	11	7	-	-
FSB15	24	22	19.5	16	12	2
FSB20	31	28	25.2	22	18	12
FSB30	34	32	28.4	26	23	19.2

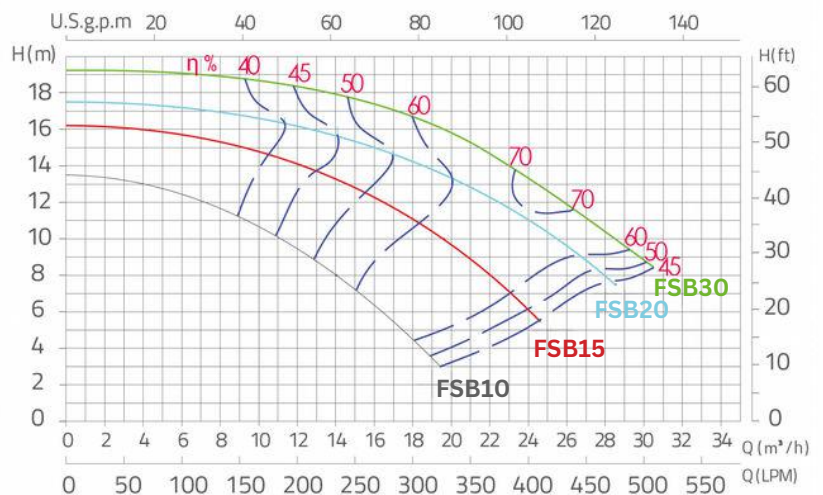



ONGANE EXCEL-POWER

Self-priming Pool Pump



CE



Self-Priming Up To 2.5m
Above Water Level



Motor Insulation Class B



IPX5 Waterproof Standard



5 Liter Basket Volume



Testing Pressure 3.5 bar



Overload Protection



ONGANE EXCEL-POWER

Self-priming Pool Pump

Introducing our high-performing self-priming pool pump, the Ongane Excel-Power pool pump. Engineered with precision and powered by an asynchronous, two-pole motor, this pump is designed to elevate your pool experience with cutting-edge features. The ring lock seal design ensures the elimination of suction leaks, maximizing suction efficiency for optimal performance.

Key Product Features:

- Motor: Asynchronous, Two poles motor.
- Insulation Class: 130(B)
- Waterproof Standard: IPX5
- Thermal Protection: Built-in for added safety.
- Overload Protection: Safeguards the motor from excessive loads.
- Voltage Options: Available in 50Hz or 60Hz with 220V/380V.
- Union Compatibility: Special design for both imperial and metric standards.
- Shaft Material: 316 Stainless steel for durability.
- Mechanical Seal: 316 Stainless steel for enhanced sealing.
- Self-Priming: Capable of priming up to 2.5m above water level.
- Testing Pressure: 50 PSI (3.5 Bar)
- Basket Volume: 5 litres for efficient debris collection.

With its advanced features and robust construction, the Ongane Excel-Power pump is your reliable choice for efficiently circulating pool water.

Product Dimensions:

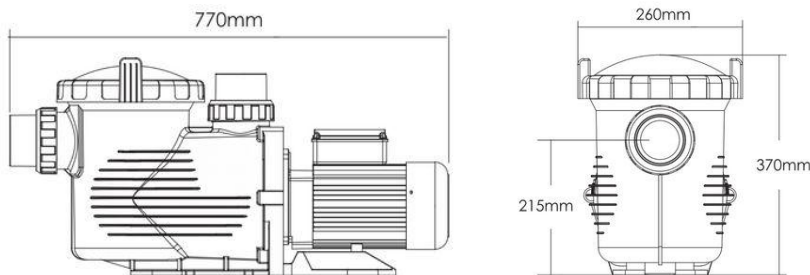

Technical Information:

Model	Voltage	Input Power (kW)	Current (Amp)	Noise (dB)	Horsepower (hp)	Weight (Kg)	Flow Rate (m³/h) @					
							6m	8m	10m	12m	14m	16m
FO200EX	220 - 240V / 50Hz	1.8	8.2	68	2.0	23.0	32	30	27	24	21	17
FO300EX	220 - 240V / 50Hz	2.2	10.0	69	3.0	24.0	37	45	32	29	26	22
FO400EX	220 - 240V / 50Hz	2.8	12.5	71	4.0	25.0	45	42	39	36	32	28
FO200EX	380 - 400V / 50Hz	1.8	8.2	68	2.0	23.0	32	30	27	24	21	17
FO300EX	380 - 400V / 50Hz	2.2	10.0	69	3.0	24.0	37	35	32	29	26	22
FO400EX	380 - 400V / 50Hz	2.8	12.5	71	4.0	25.0	45	42	39	36	32	28

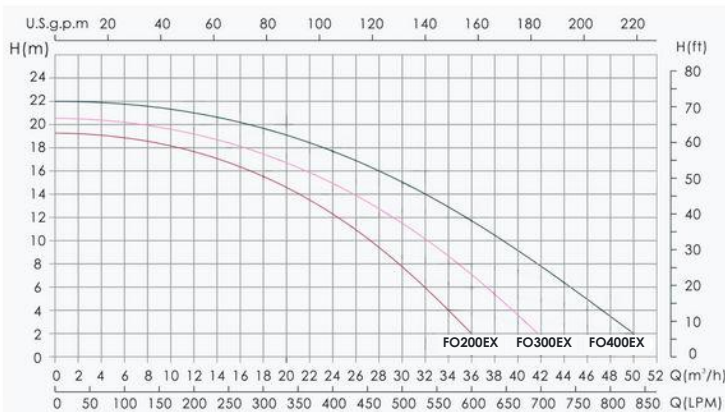

RPM: 2850

Connection Size: 2.0" (63 mm) / 2.5" (75 mm)





ONGANE ULTIME-POWER

Commercial Pool Pump



IE3 UK CA CE



Self-Priming Up To 3.0m
Above Water Level



IE3 Class Motor



IPX5 Waterproof Standard



8 Liter Basket Volume



Testing Pressure 3.5 bar



Working Voltage: 380-415V



ONGANE ULTIME-POWER

Commercial Pool Pump

The Ongane Ultime-Power Pumps are designed for top-notch performance, achieving the highest flows among similar products in the market. Thanks to cutting-edge engineering, these pumps stand out with a one-piece molded body and a large 8-liter strainer basket. Made from durable materials like corrosion-resistant thermoplastic and a superior seawater graded mechanical seal, they ensure a long-lasting and reliable working life.

The Ongane Ultime-Power Pumps feature 3-phase motors with three varying power choices: 4.0hp, 5.5hp, and 7.0hp and 3" connection union. The pumps are suitable for commercial and seawater facilities due to their energy-saving and highly efficient hydraulic performance.

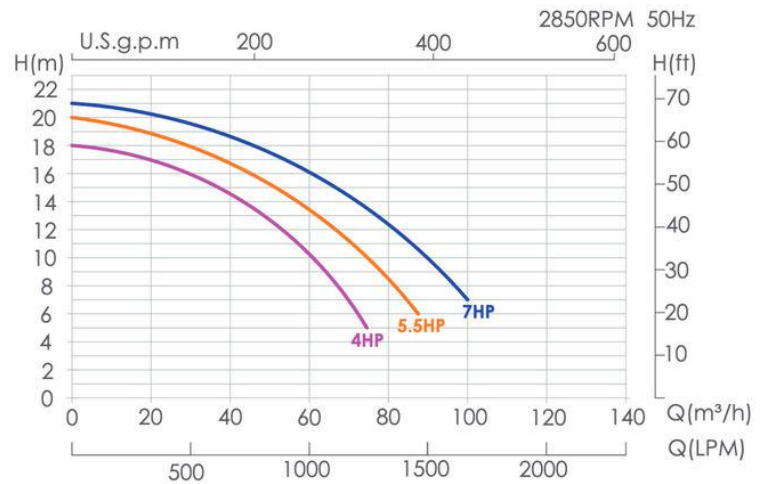

Technical Information:

Model	Voltage	Input Power (kW)	Current (Amp)	Noise (dB)	Horsepower (hp)	RPM	Flow Rate (m³/h) @					
							8m	10m	12m	14m	16m	18m
FO400UP	380 - 415V / 50Hz	3.0	5.5	70	4.0	2850	64	62	53	42	30	-
FO550UP	380 - 415V / 50Hz	4.0	8	72	5.5	2850	82	75	66	58	43	28
FO700UP	380 - 415V / 50Hz	5.0	10.0	72	7.0	2850	96	90	82	72	60	45

Product Specifications:





ONGANE-MINI PUMP

Silent-operation and Low running costs

The OnganeMini Pool Pump is expertly designed to offer a quiet operation and reduce running costs with its low energy consumption. It is powered by an asynchronous two-pole motor with built-in thermal protection. The OnganeMini is designed for above-ground pools. It is supplied with 1.5" / 50mm union connectors and flexible hose adaptors for easy connection.

The OnganeMini features a pre-filter with a transparent lid for simple maintenance and has an IPX5 waterproof standard. It comes with a built-in timer for users who prefer minimal monitoring. The timer feature allows users to set the duration period for the pump to automatically operate accordingly every day.



Product Dimensions:

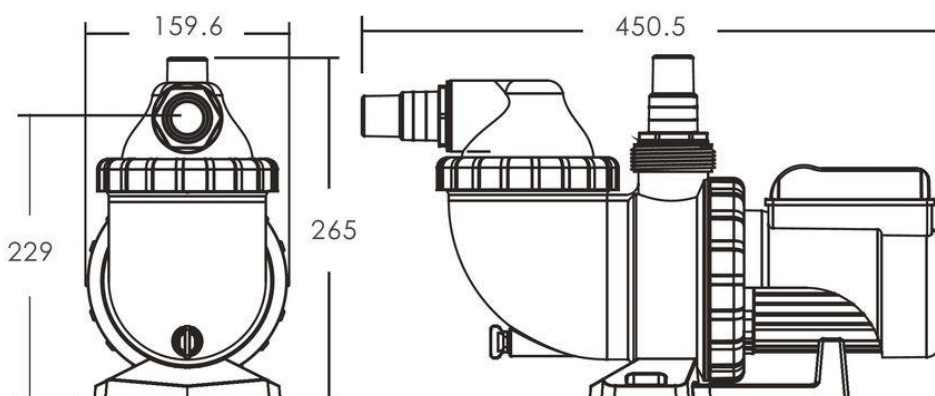

Technical Information:

Model	FO020M			
Voltage	220V / 50Hz			
Input Power (KW)	0.25			
Current (Amp)	1.2			
Noise (dB)	55			
Horsepower (hp)	0.2			
Connection	1.5" / 50 mm			
Flow Rate (m³/h) @				
2m	3m	4m	5m	
9.1 m³/h	8.1 m³/h	6.9 m³/h	5.1 m³/h	

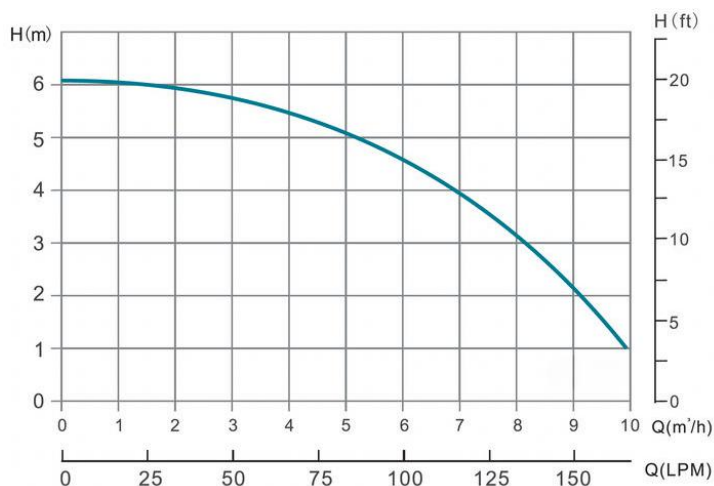

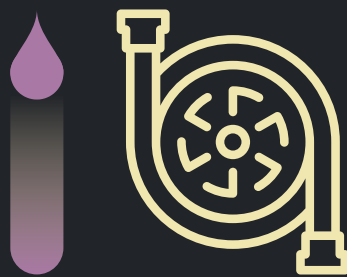

AIR BLOWERS



ARIA SPA

Air blower for swimming pool or spa

The ARIA SPA air blower is a medium pressure and high flow rate air source.

It is a high quality, low noise air source pump with the following characteristics:

- Oil-free.
- Water-free.
- Quiet.
- Energy saving.
- Service-ease.

The ARIA SPA Air blower is CE certified and available in 50Hz and 60Hz.

Technical Information:

Model	Voltage	Power (HP)	Pressure (kPa)	Output (m³/h)	Weight (Kg)	Box Dimensions (mm)
AS10	220V/50Hz	1.0	12	102	13	350*300*340
AS15	220V/50Hz	1.5	15	102	14	350*300*340
AS20	220V/50Hz	2.0	19	144	16	350*300*340
AS30	380V/50Hz	3.0	19	210	21	430*410*400
AS10	220V/60Hz	1.0	15	120	13	350*300*340
AS15	220V/60Hz	1.5	16	120	14	350*300*340
AS20	220V/60Hz	2.0	19	174	16	350*300*340
AS30	380V/60Hz	3.0	21	255	21	430*410*400

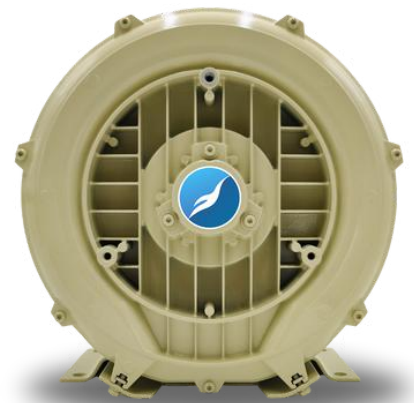

Product Dimensions:

AS10 - AS15 Models

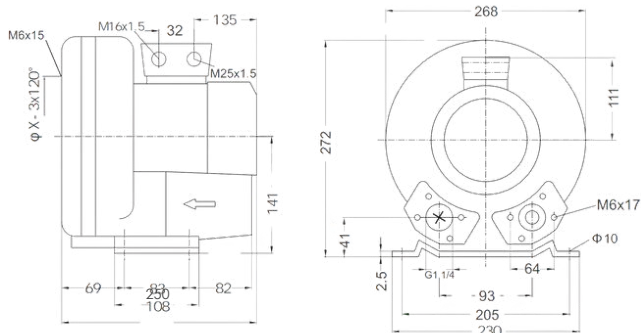

AS30 Model

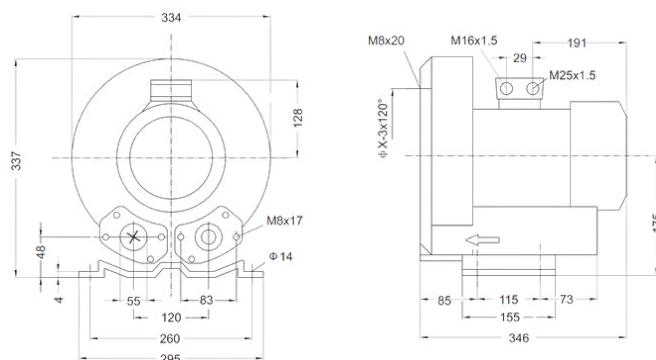

AS20 Model

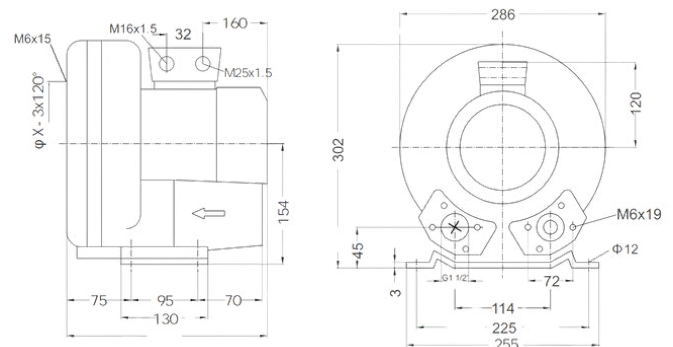





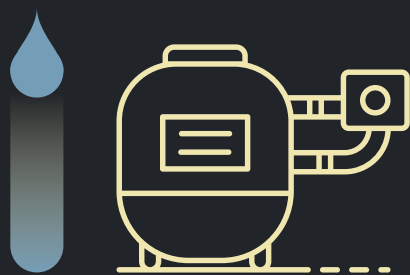

POOL FILTERS



CITRIN SIDE-MOUNT FILTER

A Fiberglass Bobbin-Wound Filter Built To Last



43°C Max. Operating Temperature



2.5 bar Max. Operating Pressure



UV Resistant Fibreglass Filter Tank



CITRIN SIDE-MOUNT FILTER

A Fiberglass Bobbin-Wound Filter Built To Last

The Fénix Citrin filter has unbeatable durability. A bobbin-wound filter built to last.

The Citrin bobbin-wound filter is produced using advanced computerized technology that winds fiberglass filaments to create a strong tank capable of withstanding pressure.

The fiberglass and resin used are durable, UV-resistant composite materials.

This enables the Citrin filter series to withstand extreme weather conditions and last for a long time without exposure to corrosion.

Technical Information:

Model	Filtration Area (m²)	Diameter (mm)	Height (mm)	Max. Flow Rate (m³/h)	Valve Connections	Sand (Kg) (0.5 - 0.8 mm)	Sand (Kg) (1.0 - 2.0 mm)	Gravel (Kg) (3.0 - 5.0 mm)
C450	0.16	455	730	8.10	1.5" / 50 mm	35	10	-
C500	0.22	535	770	11.10	1.5" / 50 mm	65	20	-
C650	0.32	635	850	15.60	1.5" / 50 mm	110	40	-
C700-1.5	0.40	710	960	19.50	1.5" / 50 mm	150	60	-
C720-2.0	0.41	723	890	20.16	2.0" / 63 mm	155	25	35
C820	0.53	820	1050	24.10	2.0" / 63 mm	250	45	60
C920	0.66	920	1180	29.70	2.0" / 63 mm	325	55	75
C1000	0.82	1020	1220	41.00	2.5" / 75 mm	450	75	100
C1200	1.17	1220	1410	58.50	3.0" / 90 mm	620	110	130

The media quantities and sizes provided above are for reference only and may vary depending on the purpose of water filtration as well as the media type, source, and density.

Product Dimensions:

Model	A (mm)	B (mm)	C (mm)	D (mm)	E (mm)	F (mm)	G (mm)
C450	360	420	730	210	455	390	125
C500	390	450	770	235	535	500	125
C650	430	490	850	300	635	500	125
C700-1.5	450	510	960	330	710	500	125
C720-2.0	520	606	890	390	723	500	220
C820	560	646	1050	425	820	780	220
C920	610	696	1180	480	920	780	220
C1000	700	770	1220	580	1020	780	220
C1200	836	1079	1410	640	1220	1000	236

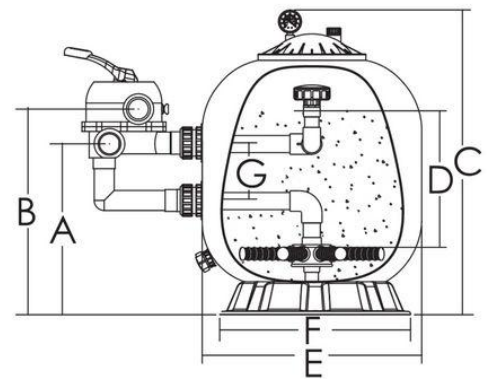



CITRIN TOP-MOUNT FILTER

A Fiberglass Bobbin-Wound Filter Built To Last



43°C Max. Operating Temperature



2.5 bar Max. Operating Pressure



UV Resistant Fibreglass Filter Tank



CITRIN TOP-MOUNT FILTER

A Fiberglass Bobbin-Wound Filter Built To Last

The Fénix Citrin filter has unbeatable durability. A bobbin-wound filter built to last.

The Citrin bobbin-wound filter is produced using advanced computerized technology that winds fiberglass filaments to create a strong tank capable of withstanding pressure.

The fiberglass and resin used are durable, UV-resistant composite materials.

This enables the Citrin filter series to withstand extreme weather conditions and last for a long time without exposure to corrosion.

Technical Information:

Model	Filtration Area (m ²)	Diameter (mm)	Height (mm)	Max. Flow Rate (m ³ /h)	Valve Connections	Sand (Kg) (0.5 - 0.8 mm)	Sand (Kg) (1.0 - 2.0 mm)	Gravel (Kg) (3.0 - 5.0 mm)
C350T	0.09	355	726	4.32	1.5" / 50 mm	20	-	-
C400T	0.13	410	757	6.48	1.5" / 50 mm	35	-	-
C450T	0.16	455	814	8.10	1.5" / 50 mm	35	10	-
C500T	0.22	535	845	11.10	1.5" / 50 mm	65	20	-
C650T	0.32	635	950	15.60	1.5" / 50 mm	105	40	-
C700T-1.5	0.40	710	1020	19.50	1.5" / 50 mm	150	60	-
C720T-2.0	0.41	723	1092	20.16	2.0" / 63 mm	155	25	35
C800T	0.50	800	1200	24.90	2.0" / 63 mm	250	45	60
C900T	0.64	900	1300	31.20	2.0" / 63 mm	330	60	75
C1000T	0.79	1000	1434	39.50	2.5" / 75 mm	450	75	100
C1200T	1.13	1200	1634	56.50	2.5" / 75 mm	620	110	130
C1400T	1.54	1400	1845	69.30	2.5" / 75 mm	980	170	250

The media quantities and sizes provided above are for reference only and may vary depending on the purpose of water filtration as well as the media type, source, and density.

Product Dimensions:

Model	A (mm)	B (mm)	C (mm)	D (mm)	E (mm)	F (mm)
C350T	726	619	550	160	355	298
C400T	757	640	590	175	410	390
C450T	814	698	638	210	455	390
C500T	845	730	670	235	535	500
C650T	950	835	775	300	635	500
C700T-1.5	1020	905	845	330	710	500
C720T-2.0	1092	960	877	390	723	500
C800T	1200	1085	1002	425	800	780
C900T	1300	1172	1090	480	900	780
C1000T	1434	1410	1160	580	1000	780
C1200T	1634	1620	1368	740	1200	1000
C1400T	1845	1683	1586	750	1400	1000

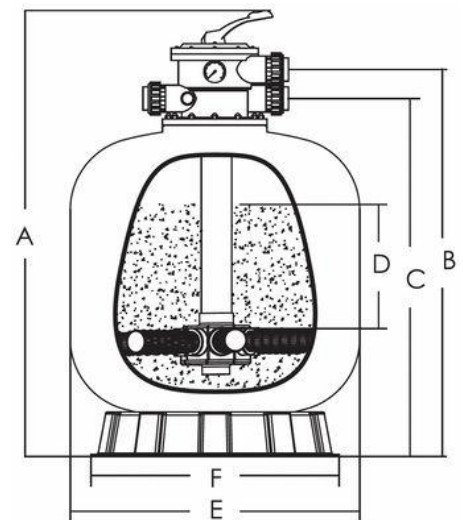



CITRINECO FILTER SERIES

Blow-molded Filter Tank



50°C Max. Operating Temperature



2.8 bar Max. Operating Pressure



HDPE Tank Material



CITRINECO FILTER SERIES

Blow-molded Filter Tank

FENIX's CitrinEco Sand filter series combines innovative design and advanced technology to offer superior filtration performance and crystal-clear water. These filters are a more affordable version of the Citrin series, featuring a seamless, one-piece blow-molded filter tank made of high-density polyethylene ensuring durability for heavy-duty use, reliability, and cost-effectiveness.

Key Features & Components:

- 6-way multiport valve made from durable ABS and marine-grade stainless steel.
- Universal standard union connection for easy compatibility with various systems.
- Easy-to-read pressure gauge for inspection and monitoring.
- PVC & ABS lateral system, along with a piping kit, for efficient water flow management.
- Unique one-piece clamp with a screw-type lock for simplified installation and tool-free servicing, providing easy access to the interior.

Product Dimensions:

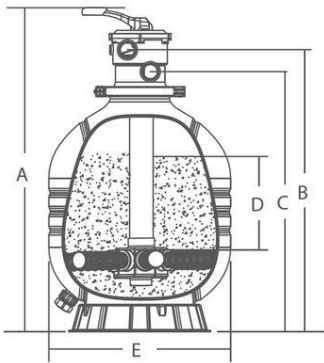

All dimensions in mm

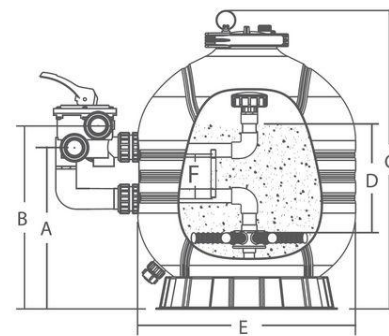

All dimensions in mm

Model	A	B	C	D	E
CET450	816	695	625	195	425
CET500	889	772	712	225	500
CET600	980	860	800	280	600
CET700	1133	976	910	300	675
CET800	1178	1021	955	370	775
CET900	1296	1139	1073	440	875

Model	A	B	C	D	E	F
CES450	355	418	670	195	425	125
CES500	396	549	760	225	500	125
CES600	430	493	825	280	600	125
CES700	460	546	946	300	675	130
CES800	508	594	968	370	775	130
CES900	564	650	1086	440	875	130

Technical Information:

CitrinEco Top Mount	CitrinEco Side Mount	Valve Connection	Filtration Area (m ²)	Diameter (mm)	Max. Flow Rate (m ³ /h)	Sand (Kg) (0.5 - 0.8 mm)	Sand (Kg) (1.0 - 2.0 mm)	Gravel (Kg) (3.0 - 5.0 mm)
CET450	CES450	50 mm / 1.5"	0.14	425	7.0	40	-	-
CET500	CES500	50 mm / 1.5"	0.20	500	10.0	55	15	-
CET600	CES600	50 mm / 1.5"	0.28	600	14.0	95	30	-
CET700	CES700	63 mm / 2.0"	0.36	675	18.0	140	45	-
CET800	CES800	63 mm / 2.0"	0.47	775	23.5	185	40	25
CET900	CES900	63 mm / 2.0"	0.61	875	30.5	245	50	30

The media quantities and sizes provided above are for reference only and may vary depending on the purpose of water filtration as well as the media type, source, and density.



MASSIF FILTER SERIES

Double-Layered Lateral System



50°C Max. Operating Temperature



2.8 bar Max. Operating Pressure



HDPE Tank Material



MASSIF FILTER SERIES

Double-Layered Lateral System

The Fénix Massif filter is a featured design for producing high-quality water:

The filter tank is made of high-density polyethylene material that is structurally engineered to maximize its strength. This one-piece blow-molded tank is engineered to provide superior clarity of filtered water and the filter boasts an exceptional pressure standard that outperforms industry benchmarks. Additionally, the filter contains a multiport valve that is made of durable components to ensure efficiency, reliability, and ease of use. The Massif Filter is strategically positioned as a top-quality product that delivers an exceptional filtration experience while providing great value for money in the market.



A double layered lateral system provides effective backwashing of the filter media and uniform collection of filtered water to ensure superior filter performance.



Improved water quality is achieved through deeper filtration resulting from a 30% higher filtration bed.



The T-shaped filter tank, made of HDPE material, is a cutting-edge design that enables superior backwashing and withstands high water pressure and temperature.

Technical Information:

Model	Filtration Area (m ²)	Valve Connections	Max. Flow Rate (m ³ /h)	Sand (Kg) (0.5 - 0.8 mm)	Sand (Kg) (1.0 - 2.0 mm)	A (mm)	B (mm)	C (mm)
M450	0.16	1.5" / 50 mm	8.0	55	20	954	457	353
M500	0.20	1.5" / 50 mm	10.0	70	25	1040	508	400
M600	0.29	1.5" / 50 mm	14.6	120	45	1090	610	457
M700-1.5	0.39	1.5" / 50 mm	19.5	145	55	1180	711	516
M700-2.0	0.39	2.0" / 63 mm	19.5	145	55	1232	711	516

The media quantities and sizes provided above are for reference only and may vary depending on the purpose of water filtration as well as the media type, source, and density.

Product Strengths:

- Superior Water Quality:** With 30% more filtration bed volume than competing filters, it ensures enhanced water purification for cleaner, clearer results.
- Reduced Backwashing:** The larger filtration bed captures more debris, minimizing the need for frequent backwashing and maintenance.
- Convenient and Cost-Effective:** Designed for easy installation, maintenance, and replacement, with affordable spare parts readily available.
- Highly Compatible:** The filter system is versatile and works seamlessly with a wide range of pool types and configurations.
- Durable and Weather-Resistant:** Built with an HDPE filter body, it offers exceptional durability and protection, even in harsh weather conditions.

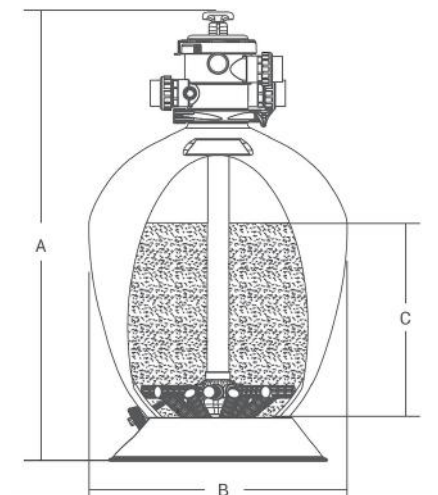



SABLEX FILTER SERIES

Blow-Molded Filter Tank



40°C Max. Operating Temperature



2.0 bar Max. Operating Pressure



UV Resistant Filter Tank



SABLEX FILTER SERIES

Blow-Molded Filter Tank

The Sablex Series Filters are specially designed with high-density polyethylene to withstand the demands of outdoor environments, including prolonged exposure to sunlight and other natural elements. These filters feature a UV-resistant, one-piece blow-molded filter tank that has received industry recognition for its outstanding resilience, reliable performance, and cost-effectiveness. Built to withstand the challenges presented by changing weather conditions, temperature changes, and other external factors, Sablex ensures long-term reliability and exceptional value.

Product Dimensions:

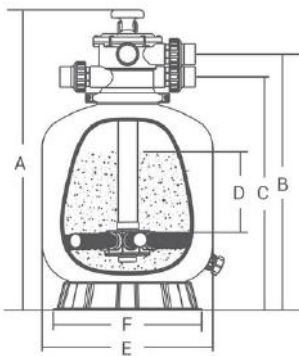

All dimensions in mm

Model	A	B	C	D	E	F
ST350	726	619	550	160	350	298
ST400	757	640	590	175	400	390
ST450	814	698	638	210	449	390
ST500	845	730	670	235	527	500
ST650	950	835	775	300	627	500
ST700	1020	905	845	330	703	500

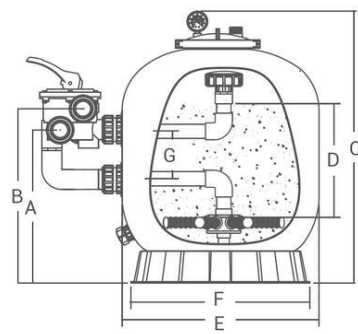

All dimensions in mm

Model	A	B	C	D	E	F	G
SS450	370	433	730	210	449	390	125
SS500	375	438	770	235	527	500	125
SS650	425	488	850	300	627	500	125
SS700	460	523	960	330	703	500	125

Technical Information:

Sablex (Top Mount)	Sablex (Side Mount)	Valve Connection	Filtration Area (m ²)	Diameter (mm)	Max. Flow Rate (m ³ /h)	Sand (0.5 - 0.8 mm) (Kg)	Sand (1.0 - 2.0 mm) (Kg)
ST350	-	50 mm / 1.5"	0.10	350	4.32	20	-
ST400	-	50 mm / 1.5"	0.13	400	6.12	35	-
ST450	SS450	50 mm / 1.5"	0.16	449	7.80	45	-
ST500	SS500	50 mm / 1.5"	0.22	527	10.8	70	15
ST650	SS650	50 mm / 1.5"	0.31	627	15.3	115	30
ST700	SS700	50 mm / 1.5"	0.39	703	19.2	150	60

The media quantities and sizes provided above are for reference only and may vary depending on the purpose of water filtration as well as the media type, source, and density.



SABLEX *Bleu* FILTER SERIES

Blow-Molded Filter Tank



40°C Max. Operating Temperature



2.0 bar Max. Operating Pressure



UV Resistant Filter Tank



SABLEX *Bleu* FILTER SERIES

Blow-Molded Filter Tank

The SablexBleu Series Filters are specially designed with high-density polyethylene to withstand the demands of outdoor environments, including prolonged exposure to sunlight and other natural elements. These filters feature a UV-resistant, one-piece blow-molded filter tank that has received industry recognition for its outstanding resilience, reliable performance, and cost-effectiveness. Built to withstand the challenges presented by changing weather conditions, temperature changes, and other external factors, Sablex ensures long-term reliability and exceptional value.

Product Dimensions:

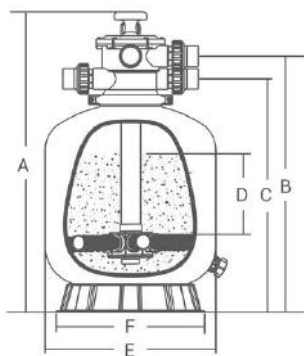

All dimensions in mm

Model	A	B	C	D	E	F
STB350	726	619	550	160	350	298
STB400	757	640	590	175	400	390
STB450	814	698	638	210	449	390
STB500	845	730	670	235	527	500
STB650	950	835	775	300	627	500
STB700	1020	905	845	330	703	500

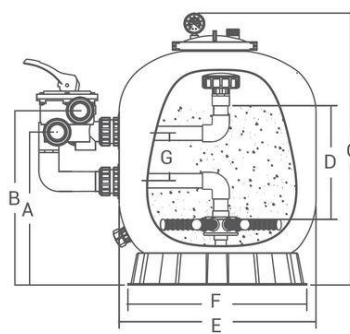

All dimensions in mm

Model	A	B	C	D	E	F	G
SSB450	370	433	730	210	449	390	125
SSB500	375	438	770	235	527	500	125
SSB650	425	488	850	300	627	500	125
SSB700	460	523	960	330	703	500	125

Technical Information:

Sablex (Top Mount)	Sablex (Side Mount)	Valve Connection	Filtration Area (m ²)	Diameter (mm)	Max. Flow Rate (m ³ /h)	Sand (0.5 - 0.8 mm) (Kg)	Sand (1.0 - 2.0 mm) (Kg)
STB350	-	50 mm / 1.5"	0.10	350	4.32	20	-
STB400	-	50 mm / 1.5"	0.13	400	6.12	35	-
STB450	SSB450	50 mm / 1.5"	0.16	449	7.80	45	-
STB500	SSB500	50 mm / 1.5"	0.22	527	10.8	70	15
STB650	SSB650	50 mm / 1.5"	0.31	627	15.3	115	30
STB700	SSB700	50 mm / 1.5"	0.39	703	19.2	150	60

The media quantities and sizes provided above are for reference only and may vary depending on the purpose of water filtration as well as the media type, source, and density.



CITRINPLUS FILTER SERIES

For Commercial Pools & Spas, Aquatic Parks



43°C Max. Operating Temperature



2.5 bar / 4.0 bar Max. Operating Pressure



UV Resistant Filter Tank



CITRINPLUS FILTER SERIES

For Commercial Pools & Spas, Aquatic Parks

The CitrinPlus Commercial Filter is constructed from robust and non-corrosive fiberglass and resin, the filter tank utilizes automatic bobbin winding technology and UV-resistant composites. These features enable the filter to function effectively even in the face of challenging weather conditions.

The filter is available with laterals or nozzle plate system. It offers excellent filtration performance with deep sand bed. Optional accessories includes sight glass, manhole and union drain.

Technical Information:

Model (2.5 bar)	Model (4.0 bar)	Filtration Area (m ²)	Diameter (mm)	Height (mm)	Max. Flow Rate (m ³ /h)	Valve Connections	With Laterals System		With Nozzles System	
							Sand (Kg) (0.5 - 0.8 mm)	Sand (Kg) (1.0 - 2.0 mm)	Sand (Kg) (0.5 - 0.8 mm)	Sand (Kg) (1.0 - 2.0 mm)
CP1400-2.5	CP1400-4.0	1.54	1400	1570	77.0	4.0" / 110 mm	941	460	778	382
CP1600-2.5	CP1600-4.0	2.01	1620	1740	100.5	4.0" / 110 mm	1412	771	1208	496
CP1800-2.5	CP1800-4.0	2.54	1790	2040	126.0	6.0" / 160 mm	2366	1343	2167	609
CP2000-2.5	CP2000-4.0	2.97	1945	2210	148.5	6.0" / 160 mm	2781	1375	2550	715
CP2300-2.5	CP2300-4.0	4.34	2375	2510	217.0	8.0" / 210 mm	5539	1682	5075	972
CP2500-2.5	CP2500-4.0	4.89	2495	2670	244.5	8.0" / 210 mm	6366	1972	5815	1117

The media quantities and sizes provided above are for reference only and may vary depending on the purpose of water filtration as well as the media type, source, and density.

Product Components

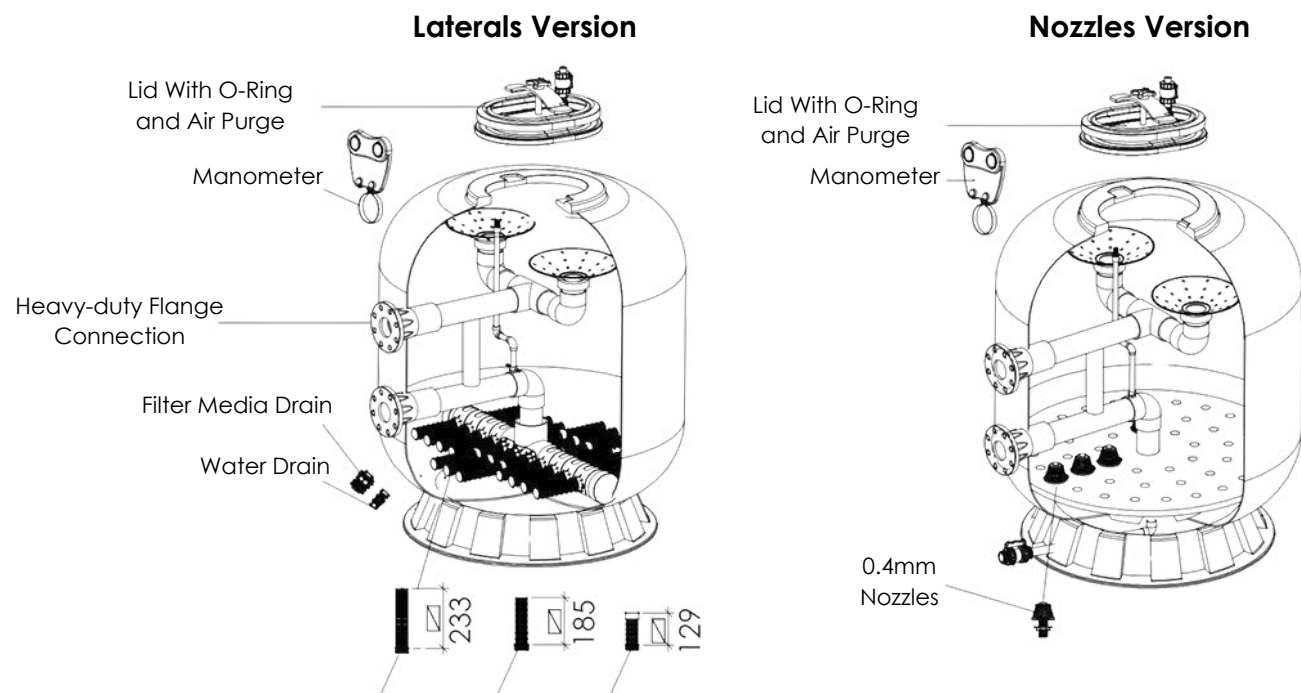





CLEANING TOOLS

For Swimming Pool Maintenance



Aluminium Vacuum Head

Vacuum head with flexible wheels. 1.5" hose connection.

Model	Length	Connection
FAV01	35 cm	Ø38 mm
FAV02	45 cm	Ø38 mm



Hand Skimmer & Leaf Rake

Deep and surface net models in Pantone Color.

Model	Description
FEHS01	Heavy-duty pool surface leaf skimmer
FEHS02	Heavy-duty pool deep leaf rake

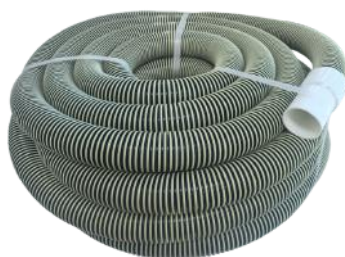

Heavy-duty Vacuum Hose

Spiral-wound high-quality hose with UV and abrasion protection.

Model	FEVH06	FEVH09	FEVH12	FEVH15	FEVH30
Size	Ø38mm x 6.0m	Ø38mm x 9.0m	Ø38mm x 12.0m	Ø38mm x 15.0m	Ø38mm x 30.0m



Aluminium Telescopic Pole

1.2mm aluminium tubing thickness. Soft comfortable grip and lock.

Model	Size
FTP500	2 x 2.4m
FTP700	2 x 3.5m



Floating Chemical Dispenser

Accommodates chlorine tablets and allows to adjust flow rate.

Model	Description
FECH08	Floating Dispenser made of ABS plastic



Floating Thermometer

Accurate and easy to read temperatures in Celsius & Fahrenheit.

Model
FETH01
FETH02





POOL & SPA ACCESSORIES



POOL SKIMMERS

Durable Weather-Resistant ABS & Fiberglass Accessories

15L Standard Wall Skimmer

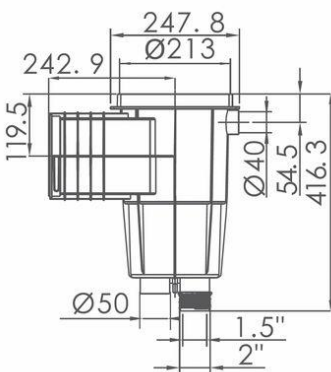

FEWS15-C

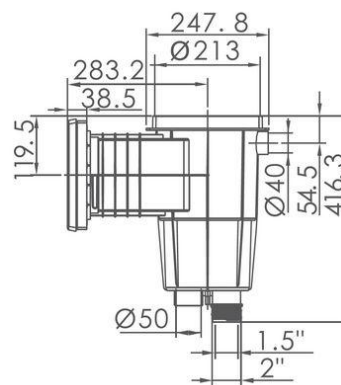
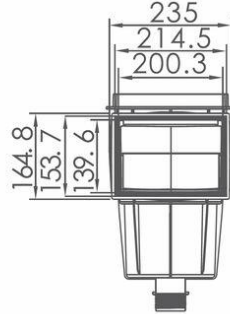

FEWS15-V

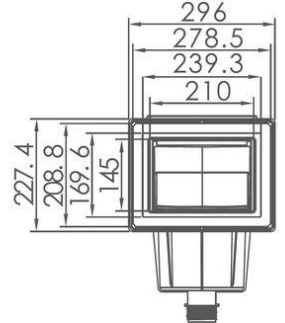

Model	Type	Flow Rate (L/min)
FEWS15-C	Concrete Pool	150 - 200
FEWS15-V	Vinyl Pool	150 - 200

Suction Connections: 1.5" / 2" Threaded and 1.5" Solvent.

15L Wide-Mouth Wall Skimmer

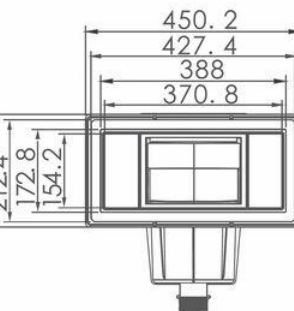
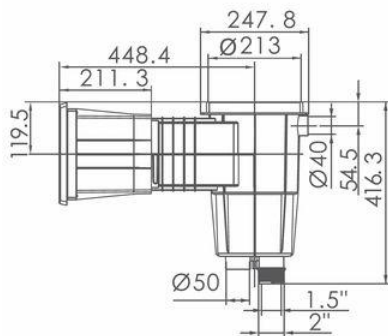

FEWS15-C - FEWS15-V



Model	Type	Flow Rate (L/min)
FEWS15-C	Concrete Pool	150 - 200
FEWS15-V	Vinyl Pool	150 - 200

Suction Connections: 1.5" / 2" Threaded and 1.5" Solvent.



POOL SKIMMERS

Durable Weather-Resistant ABS & Fiberglass Accessories

15L Surface Wall Skimmer

The Fénix Surface Wall Skimmer combines sleek design with exceptional efficiency. Its 600mm wide mouth is crafted to bring the waterline close to the pool deck, creating a sophisticated, overflow-like effect. The wide opening and large basket maximize water circulation, enhancing the skimming process and effectively removing debris for a cleaner, more pristine pool environment.

Technical Information:

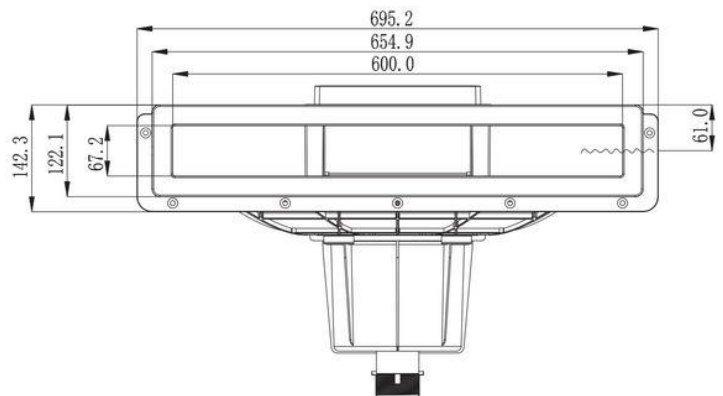
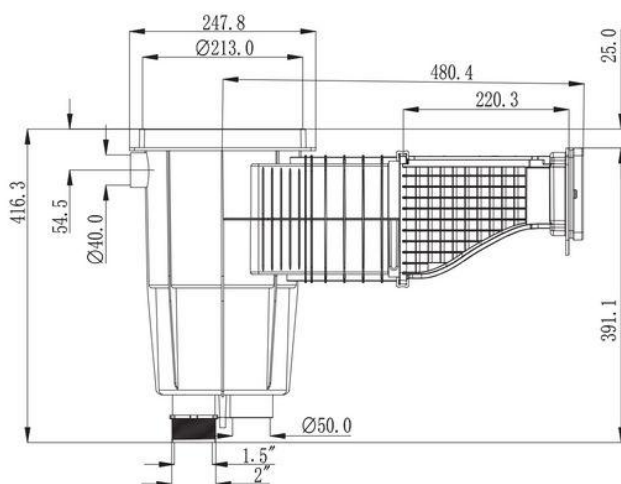
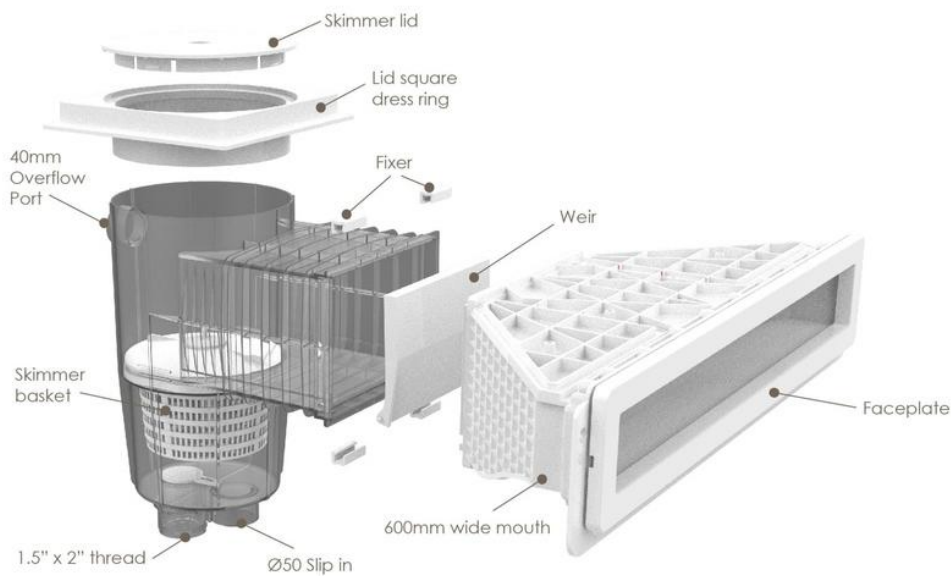

FESS-C / FESS-V

Model	Pool Type	Flow Rate (L/min)
FESS-C	Concrete Pool	150
FESS-V	Vinyl Pool	150

Suction Connections: 1.5" / 2" Threaded and 1.5" Solvent.



VACUUM & INLETS FITTINGS

Durable Weather-Resistant ABS & Fiberglass Accessories

Vacuum Fittings

Solvent Vacuum Fitting

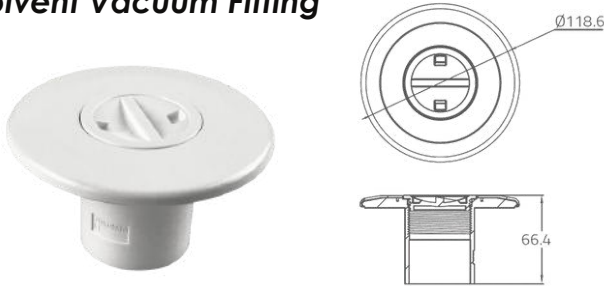

Model	Connection	Flow Rate (L/min)
FEV01	2" Solvent 15Bar (Imperial)	150 - 240
FEV02	63mm Solvent 16Bar (Metric)	150 - 240
FEV03	2" Solvent 12Bar (Imperial)	150 - 240
FEV04	63mm Solvent 10Bar (Metric)	150 - 240

Threaded Vacuum Fitting

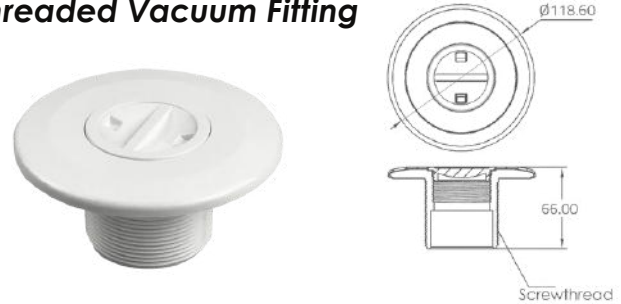

Model	Connection	Flow Rate (L/min)
FEV01T	2" Threaded	150

Inlet Nozzles

Floor Inlet Nozzle



Model	Connection	Flow Rate (L/min)
FEFN01	2" Solvent 12Bar (Imperial)	200
FEFN02	2" Solvent 15Bar (Imperial)	200
FEFN03	63mm Solvent 10Bar (Metric)	200
FEFN04	63mm Solvent 16Bar (Metric)	200

Wall Inlet Nozzle

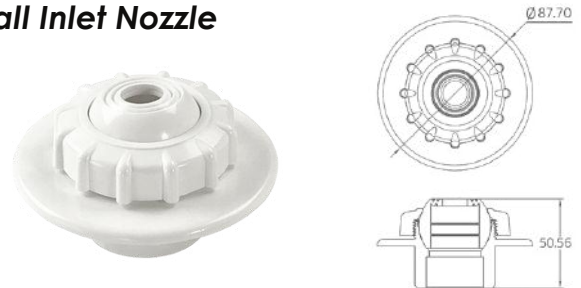

Model	Connection	Flow Rate (L/min)
FEWN01	1.5" Solvent 12Bar (Imperial)	50 - 150
FEWN06	1.5" Solvent 15Bar (Imperial)	50 - 150
FEWN08	50mm Solvent 10Bar (Metric)	50 - 150
FEWN04	50mm Solvent 16Bar (Metric)	50 - 150

Wall Inlet Nozzle



Model	Connection	Flow Rate (L/min)
FEWN02	2" Solvent 12Bar (Imperial)	150
FEWN03	2" Solvent 15Bar (Imperial)	150
FEWN07	63mm Solvent 10Bar (Metric)	150
FEWN05	63mm Solvent 16Bar (Metric)	150

Threaded Wall Inlet Nozzle

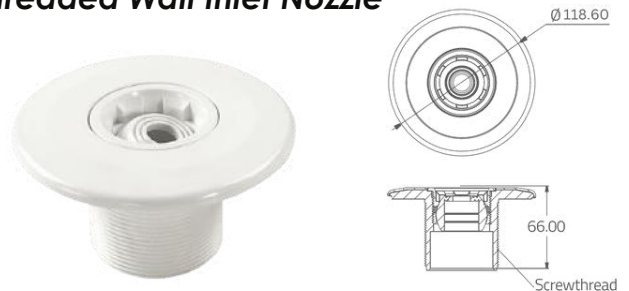

Model	Connection	Flow Rate (L/min)
FEWN02T	2" Threaded	150



POOL DRAINS

Durable Weather-Resistant ABS & Fiberglass Accessories

Main Drains

Anti-vortex Round Main Drain



Model	Size	Flow Rate (L/min)
FERD195AV	Ø195mm	558

Round Main Drain



Model	Size	Flow Rate (L/min)
FERD195	Ø195mm	558

Anti-vortex Square Main Drain

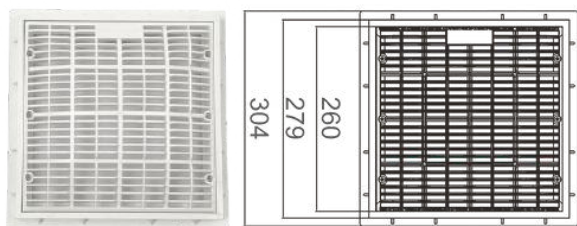

Model	Size	Flow Rate (L/min)
FESD260AV	260*260mm	900

Square Main Drain

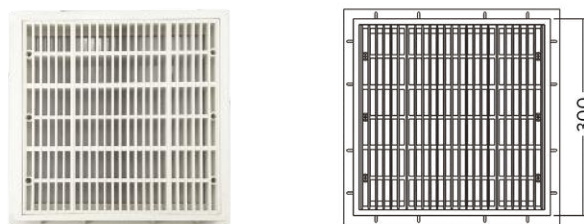

Model	Size	Flow Rate (L/min)
FESD300	300*300mm	600

Anti-Vortex Round Box Main Drain

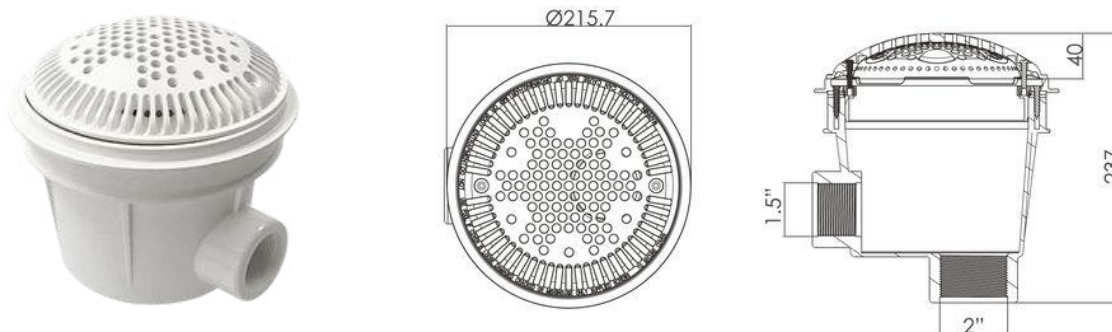

Model	Connection	Type	Flow Rate (L/min)
FCRD215AV	1.5" / 2" Internal Threaded	Concrete Pool	240



GRATINGS, TILES & SPA JET

Durable Weather-Resistant ABS & Fiberglass Accessories

Grating & Corner Tiles

Triple-Link Anti-Slip Overflow Grating

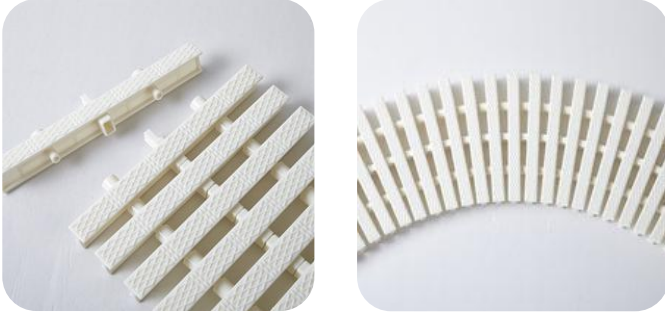

Model	Color	Width	Height
FOF-3H20	White	20cm	25mm
FOR-3H25	White	25cm	25mm

Anti-Slip Overflow Grating



Model	Color	Width	Height
FOF-I20	White	20cm	22mm
FOF-I25	White	25cm	22mm

90° ABS Corner Tile



Model	Width	Height
FOF-C20	20cm	25mm
FOF-C25	25cm	25mm

90° Fiberglass Corner Tile

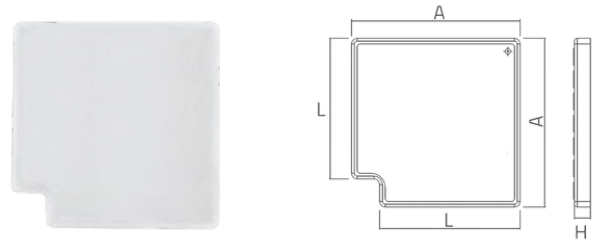

Model	A (mm)	L (mm)	H (mm)
FT2090	250	200	28.5
FT2590	300	250	28.5
FT3090	350	300	28.5

Spa Jet

Concrete Pool Spa Jet

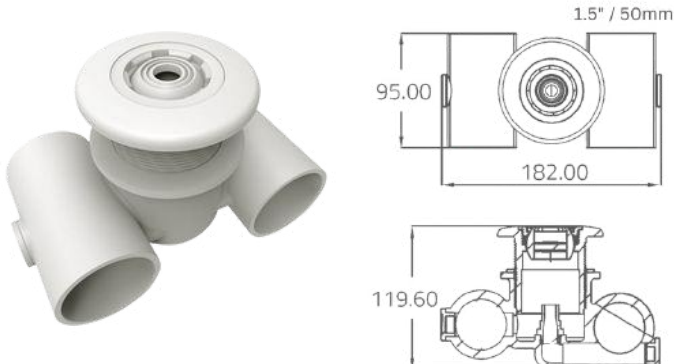

Durable Pool Spa Jet made of ABS Plastic. 1.5" or 50mm connection for water and air inlets with a flow of 4.5 m³/h.

Model	Connection	Flow Rate (L/min)
FESJ1.5	1.5" Solvent (Imperial)	50
FESJ50	50mm Solvent (Metric)	50



OTHER POOL ACCESSORIES

Durable Weather-Resistant ABS & Fiberglass Accessories

Extra Fittings

Water Level Regulator

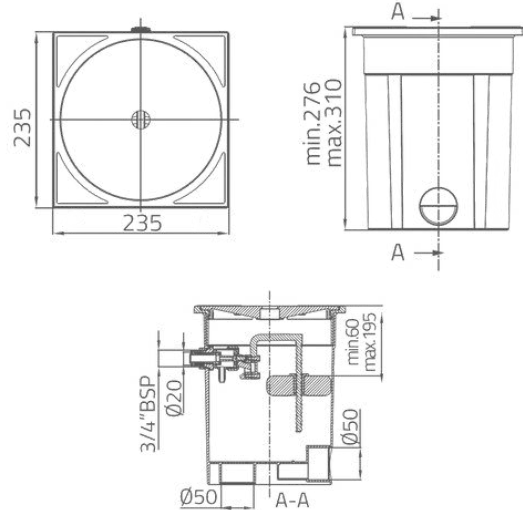

Automatically maintains the optimal water level, preventing water loss, overflow, and pump damage due to low levels. Made from UV-treated white ABS, it features a square lid, an adjustable buoy, and connects directly via the skimmer for seamless integration. It reduces manual monitoring, and enhances the efficiency of both residential and commercial pools.

Model	Connection	Flow Rate (L/min)
FELR235	Inlet: Ø20mm or 3/4" BSP Outlet: Ø50mm	30 - 50

Concrete Pool Wall Conduit

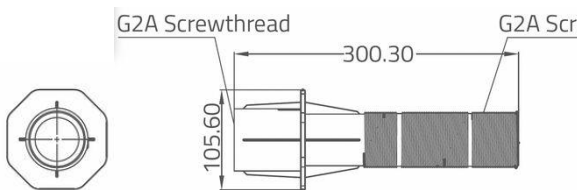

Model	Connection	Flow Rate (L/min)
FEWC240	2" Threaded	150 - 240

Check Valves

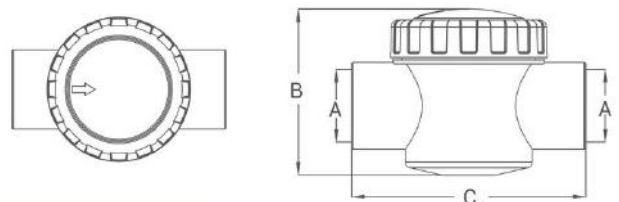

Model	Connection	A (mm)	B (mm)	C (mm)
FCV50	50mm	Ø50	115	164
FCV1.5	1.5"	Ø48	115	164
FCV63	63mm	Ø63	129	190
FCV2.0	2.0"	Ø60	129	190





POOL LADDERS



POOL LADDERS

Stainless Steel with Anti-slip Pads

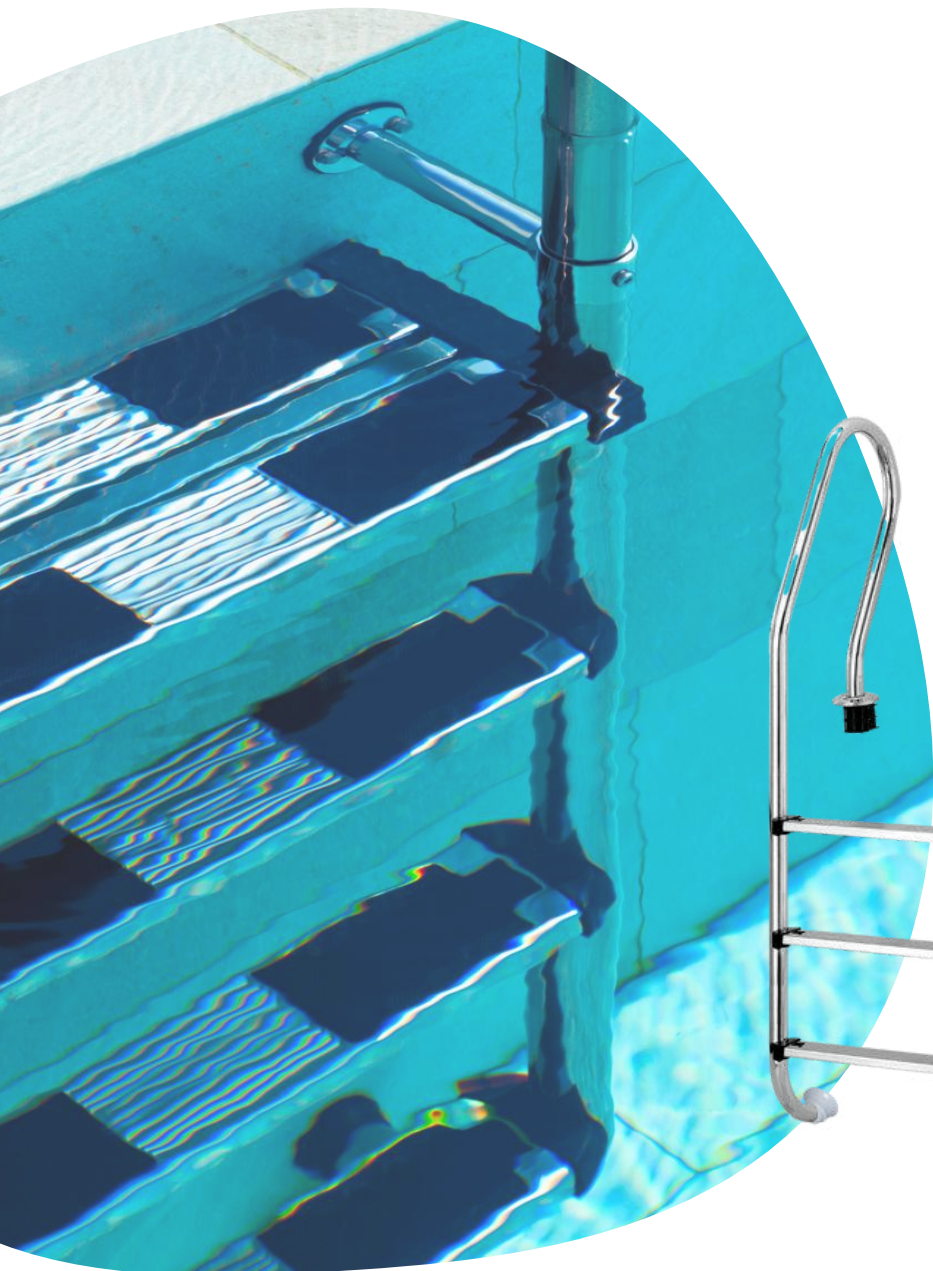

Stainless Steel Steps (with anti-slip pads)



Anchor type connection for easy installation



POOL LADDERS

Stainless Steel with Anti-slip Pads

Fénix ladders are meticulously crafted using 42mm tubes made of polished stainless steel 304, known for its durability and resistance to corrosion.

These ladders are specifically designed for proper placement and easy access in and out of the pool, ensuring the utmost safety for swimmers. The ladders steps with anti-slip pads provide a stable foothold as users enter or exit the water, reducing the risk of slipping or accidents. The polished stainless steel finish not only adds an aesthetic appeal but also serves as a protective layer against rust and harsh pool chemicals, ensuring longevity in outdoor environments.

Standard Ladder - Anchor Type - Stainless Steel AISI-304 Step (With Anti-Slip Pad)

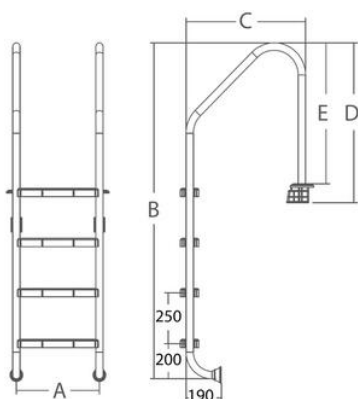

Model	A	B	C	D	E
FL2ST304	493	1320	686	788	708
FL3ST304	493	1570	686	788	708
FL4ST304	493	1820	686	788	708
FL5ST304	493	2070	692	788	619

All dimensions in mm



Mix Ladder - Anchor Type - Stainless Steel AISI-304 Step (With Anti-Slip Pad)

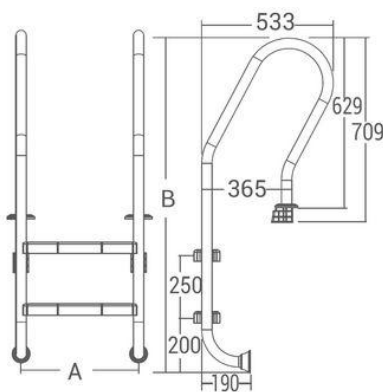

Model	A	B
FL2MI304	493	1330
FL3MI304	493	1580
FL4MI304	493	1830
FL5MI304	493	2080

All dimensions in mm



Overflow Ladder - Anchor Type - Stainless Steel AISI-304 Step (With Anti-Slip Pad)

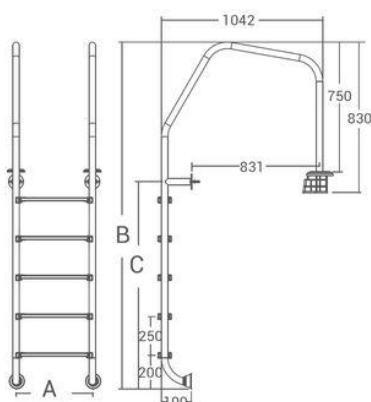

Model	A	B	C
FL2OF304	493	1460	561
FL3OF304	493	1710	811
FL4OF304	493	1960	1061
FL5OF304	493	2210	1311

All dimensions in mm





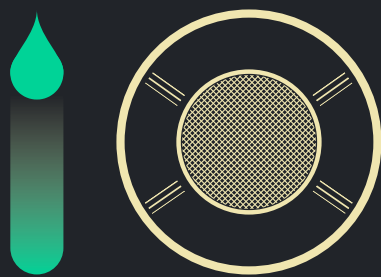

UNDERWATER LIGHTS



FXD UNDERWATER LIGHT SERIES

100% Resin Filled (Ø160 / Ø200 / Ø265 mm)



Energy Saving



2 Meters Cable Length



Switch, Remote Control for
RGB Model (Optional)



Waterproof Standard IP68



FXD UNDERWATER LIGHT SERIES

100% Resin Filled (Ø160 / Ø200 / Ø265 mm)

The FENIX FXD Underwater Pool Light Series is the perfect solution for illuminating your pool with stunning, energy-efficient LED lighting.

The FXD Underwater Light Series offer both beauty and functionality. Available in warm white, cool white or RGB and three sizes to fit different pool designs and needs.

Key Features:

- **Resin Coating:** 100% resin-filled for perfect sealing and protection of light electronics.
- **Energy Savings:** Highly efficient, reducing power use while delivering bright illumination.
- **Easy Installation:** Wall-mounted with a stable base and includes a 2-meter cable for flexible setup.
- **Waterproof IP68:** Fully submersible and built for long-lasting underwater performance.
- **Switch/Remote Control (RGB Models):** Change colors and lighting modes easily with a switch or optional remote for RGB Models.

Installation

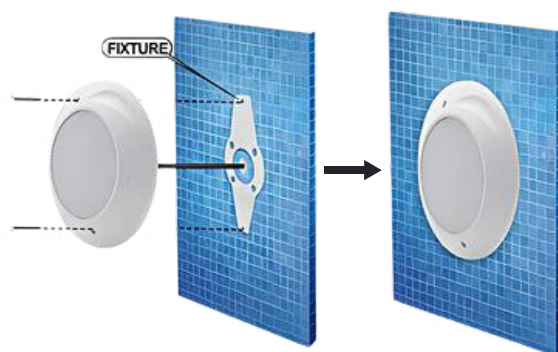

Technical Information:

Model	Power	LED QTY	LED Source	Color
FXD Ø160*22 mm / AC12V				
FXD160L144WW	12W	144 LEDs	SMD2835	Warm White
FXD160L144CW				Cool White
FXD160L144RGB				RGB
FXD160L252WW	18W	252 LEDs		Warm White
FXD160L252CW				Cool White
FXD160L252RGB				RGB
FXD Ø200*25 mm / AC12V				
FXD200L252WW	18W	252 LEDs	SMD2835	Warm White
FXD200L252CW				Cool White
FXD200L252RGB				RGB
FXD200L333WW	24W	333 LEDs		Warm White
FXD200L333CW				Cool White
FXD200L333RGB				RGB
FXD Ø265*22 mm / AC12V				
FXD260L252WW	18W	252 LEDs	SMD2835	Warm White
FXD260L252CW				Cool White
FXD260L252RGB				RGB
FXD260L333WW	24W	333 LEDs		Warm White
FXD260L333CW				Cool White
FXD260L333RGB				RGB
FXD260L441WW	30W	441 LEDs		Warm White
FXD260L441CW				Cool White
FXD260L441RGB				RGB

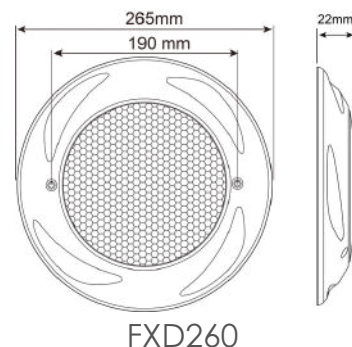
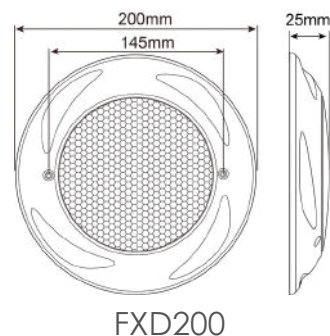
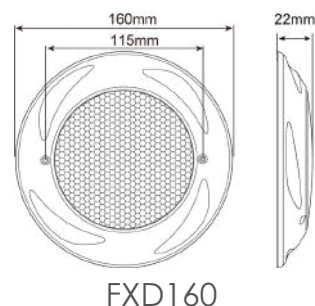



FWH & FL UNDERWATER LIGHTS

100% Resin Filled

FWH150 Underwater Light Series

The FENIX FWH underwater light is a mini and slim model featuring a stylish design.

Key features:

- Made of super bright LED with high quality Acid-proof, alkali-proof and UV resistant material.
- The lamp is filled with epoxy resin inside, which make it 100% waterproof.
- Low power consumption, high stability.
- Supports 16 different kinds of color changing programs.
- Long working life up to 60, 000 hours.
- Easy to install, suitable for swimming pools, fountains, jacuzzi and spas.
- Easy control with a switch, or an optional remote control.

Technical Information:

FWH Ø150*25 mm / AC12V					
Model	Power	LED QTY	LED Source	LED Chip	Color
FWH150L108	10W	108 LEDs	SMD2835	Epistar	RGB
FWH150L144	12W	144 LEDs			
FWH150L252	18W	252 LEDs			



FL230 Underwater Light Series

The FENIX FL underwater light is 2cm ultra-thin pool light with a sleek and modern design.

Key features:

- Made of super bright LED with high quality Acid-proof, alkali-proof and UV resistant material.
- The lamp is filled with epoxy resin inside, which make it 100% waterproof.
- 2-meter cable length.
- Available in warm white color or RGB.
- Easy to install, suitable for swimming pools, fountains, jacuzzi and spas.
- Easy control with a switch, or an optional remote control.

Technical Information:

FL Ø230*20 mm / AC12V					
Model	Power	LED QTY	LED Source	LED Chip	Color
FL230L252WW	18W	252 LEDs	SMD2835		Warm White
FL230L252RGB	18W	252 LEDs	SMD2835		RGB





POOL LIGHT ACCESSORIES

For All Types Of Pool Lightings

D64 Underwater Light Series

Model	Power	Color	LED Qty	Cable
D64L18RGB	1W/12V	Auto RGB	18 LEDs Bulb	3 meters
D64L18CW		Cool White		
D64L18WW		Warm White		

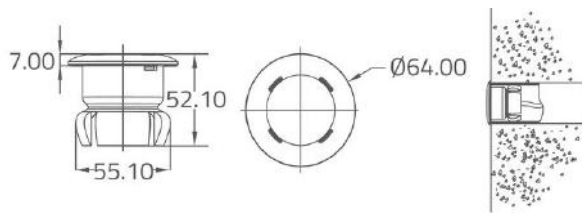

Fits in 2" PVC Pipe Class 12



Toroidal Waterproof Transformer

Model	Power	Input	Output
FT50W	50W	AC220V 50/60Hz	AC12V
FT105W	105W	AC220V 50/60Hz	AC12V
FT200W	200W	AC220V 50/60Hz	AC12V
FT300W	300W	AC220V 50/60Hz	AC12V



Junction Box

Model	Description
FJB01	Junction Box With Adapters
FJB02	Junction Box With Adapters & 1m Hose
FJB03	Junction Box Only



Remote Control for RGB Lights

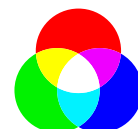
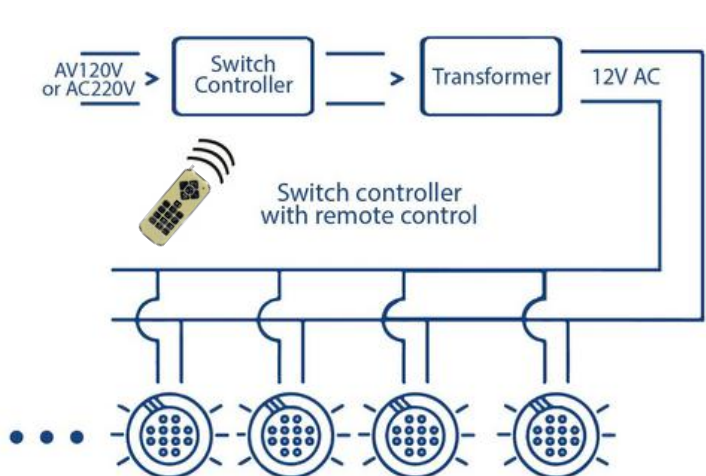

7 RGB Colors



14 Light Modes



18 Keys Control



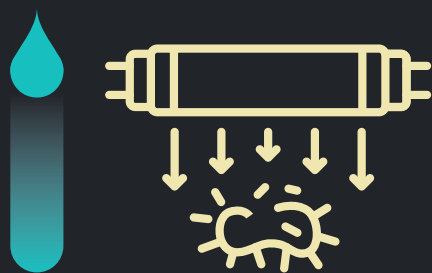

DISINFECTION SYSTEMS



UV / UV-OZONE DISINFECTION

For Crystal Clear Disinfected Water



Crystal Clear Disinfected Water



Up to 35% Increased Efficiency



Protection Against Pathogenic Organism



AISI-316 Stainless Steel Housing



Environmentally Friendly



UV-C DISINFECTION

A Non-chemical Approach To Water Sanitization

UV-C Disinfection System

The FENIX UV-C Disinfection System is an advanced solution designed to maintain clean and safe water in swimming pools, spas, and other aquatic facilities. The system has a precise and compact design with its robust housing, mirror-polished interior and quartz sleeve. There are three main models: The FENIX UV-C Standard Model, FENIX UV-C Timer Model which includes a built-in timer to monitor UV lamp operating hours and FENIX UV-C Flow Switch Model which has better resistance to temperature changes and cuts off the power when overheating

All models feature a high-intensity ultraviolet lamp that emits a wavelength of 254 nm in the UV spectrum. The 254 nm wavelength deactivates the DNA of bacteria, viruses, and other pathogens preventing them from replicating and causing disease. This advanced ultraviolet technology provides a non-chemical solution for pool disinfection, offering a straightforward, cost-efficient, and low-maintenance option.

Key Benefits:

- **High Transmission:** High-quality quartz sleeve ensures nearly 100% transmission of UV-C at 254 nm, providing protection against air and water flow, breakage, and temperature fluctuations.
- **Eco-Friendly:** Reduces chlorine consumption by up to 70% and minimizes water renewal needs.
- **Efficient and Cost-Effective:** The mirror-polished interior of the housing increases the UV reflection rate by up to 35% and thus enhances the work efficiency. The operational costs over time are lower due to the reduced need for chemical disinfectants and maintenance efforts.
- **Better Protection:** Ensures water is free of unpleasant smells and does not irritate the eyes, significantly reducing the number of chloramines.
- **Compatibility:** Can be seamlessly integrated with existing pool filtration systems, making them a versatile option for both new and existing pools.

Technical Information:

Model	Max Flow Rate	Pool Volume	Input Power	Max Current	Max Pressure	Connection	Electric Ballast	UV Lamp Lifetime
FENIX UV-C Standard								
FUV7	7m³/h	15m³	16W	0.29A	3bar	1.5" (50mm) or 2.0" (63mm)	120 - 240V AC 50-60Hz	9000hr
FUV20	20m³/h	40m³	40W	0.29A				9000hr
FUV25	25m³/h	75m³	75W	0.57A				9000hr
FENIX UV-C Timer								
FUV20-T	20m³/h	40m³	40W	0.44A (120V) 0.20A (240V)	3bar	1.5" (50mm) or 2.0" (63mm)	120 - 240V AC 50-60Hz	9000hr
FUV25-T	25m³/h	75m³	75W	0.82A (120V) 0.38A (240V)				9000hr
FENIX UV-C Flow Switch (Timer version is available as an option)								
FUV30-F	30m³/h	130m³	130W	0.95A	3bar	1.5" (50mm) or 2.0" (63mm)	240V AC	12000hr
FUV30-TF	30m³/h	130m³	130W	0.95A			240V AC	12000hr



UV-OZONE DISINFECTION

(2 in 1) For crystal clear disinfected water

UV-Ozone Disinfection System

The FENIX UV-Ozone Disinfection System is an advanced solution designed to maintain clean and safe water in swimming pools, spas, and other aquatic facilities. This system utilizes the combined power of ultraviolet (UV-C) light and ozone generation to effectively neutralize harmful microorganisms, including bacteria, viruses, and protozoa, as well as to break down organic contaminants and eliminate unpleasant odors.

The system features a high-intensity ultraviolet lamp that emits two distinct wavelengths within the UV spectrum: 254 nm and 185 nm. The 254 nm wavelength deactivates the DNA of bacteria, viruses, and other pathogens, while the 185 nm wavelength converts the oxygen within the quartz sleeve area into ozone. The ozone generated is introduced into the water stream using the Venturi effect. Together, the ozone and ultraviolet radiation eliminate microorganisms like molds, Legionella bacteria, parasites, algae, and viruses. They also break down substances such as urine, sweat, cosmetics, and sunscreen particles, without leaving any by-products.

Key Benefits:

- **Enhanced Water Quality:** UV-C and ozone work together to keep water crystal clear, eliminating harmful microorganisms and organic pollutants.
- **Reduced Chemical Use:** Reduces chlorine use by up to 80%, lowering the risk of eye and skin irritation while preventing harmful by-products like chloramines.
- **Eco-Friendly:** Ozone and UV-C provide effective disinfection without leaving harmful residues in the water.
- **Odor & Taste Improvement:** Ozone removes unpleasant odors and improves water taste for a better swimming experience.
- **Efficient & Cost-Effective:** A mirror-polished housing enhances UV reflection, improving efficiency. Lower chemical use also reduces long-term costs.

UV-Ozone Operation Diagram:

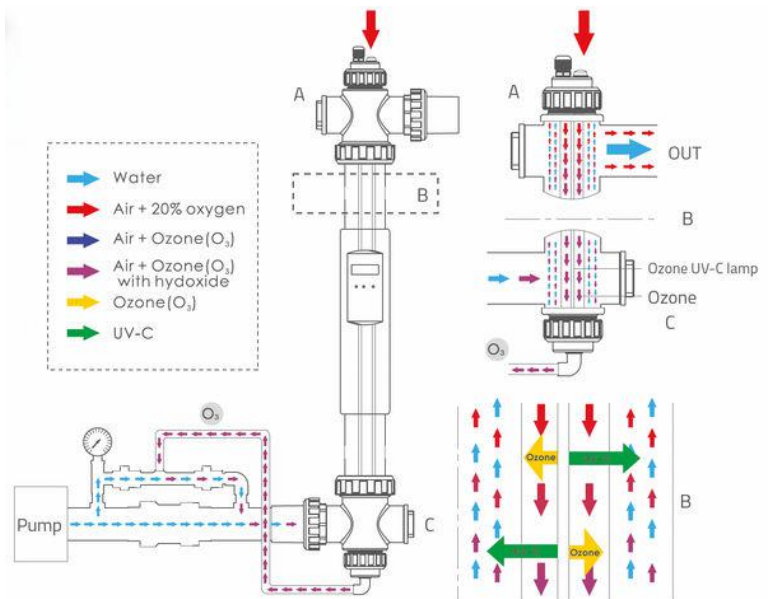

Technical Information:

Model	Max Flow Rate	Pool Volume	Input Power	Max Current	Max Pressure	Connection	Electric Ballast
FUV25-OZ	25m ³ /h	90m ³	87W	0.5A	3bar	1.5" (50mm) / 2.0" (63mm)	240V AC 50-60Hz



CHEMICAL FEEDER

For Automatic Maintenance of Chlorine Levels

FENIX Chemical Feeder (2Kg / 4Kg)

FENIX In-line Chemical Feeder is an essential component for maintaining optimal chlorine levels for swimming pools. It is installed directly into the existing pool's filtration setup and plumbing system, eliminating the need for manual dosing.

Available in two sizes and can be used with either chlorine or bromine tablets.

Technical Information:

Specifications				
Model	Chlorine Tablet Size	Quantity	Total Weight	Valve Connection
FCL-01	Ø76x26mm/pc	11 Pcs	2 Kg	1.5" / 50 mm
FCL-02	Ø76x26mm/pc	22 Pcs	4 Kg	1.5" / 50 mm

This feeder is specifically designed for use with slow-dissolving Tri-Chlor ONLY.

Do NOT mix with other type of chlorine or chemical.

Always switch off pump and close all available valves before opening.



Product Dimensions

Model	Dimensions		
	A (mm)	B (mm)	C (mm)
FCL-01	420	330	110
FCL-02	705	330	110

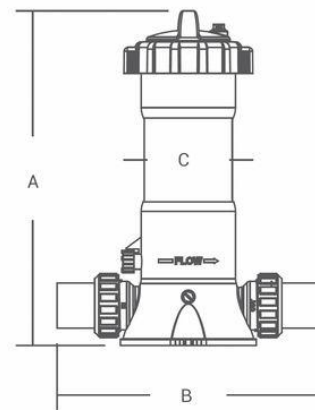

Installation - In-line

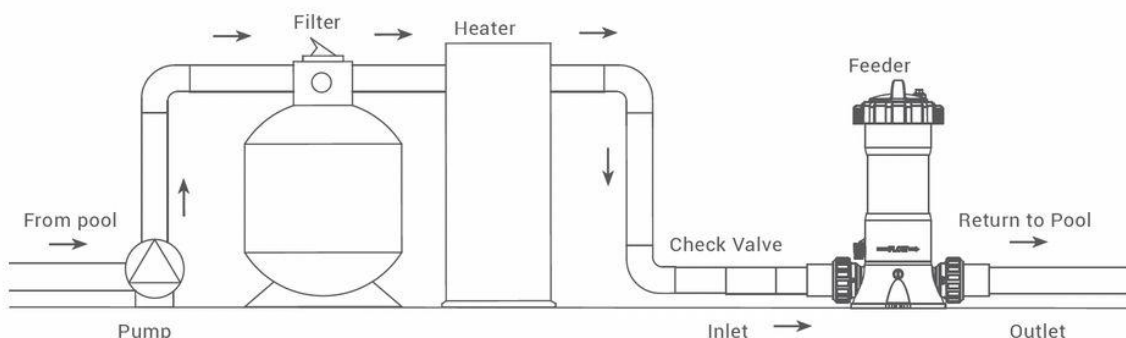



INLINE ZINC ANODE SHIELD

Protect Your Pool Equipment from Corrosion



Electric Shock Prevention
In Fiberglass Pools



Corrosion Protection of
metal components



Durable High-purity Zinc
Alloy Anode



4 Bar Working Pressure



INLINE ZINC ANODE SHIELD

Electric Shock & Electrolytic Corrosion Protection

The Inline Zinc Sacrificial Anode Shield is designed to prevent galvanic corrosion in your pool's plumbing and equipment. By neutralizing harmful electrolysis, this anode extends the lifespan of metal components such as pool heaters, ladders, and lights. Easy to install and highly effective, it ensures long-term protection for both saltwater and chlorinated pools.

Technical Information:

Model	Connection	A (mm)	B (mm)	C (mm)	Material
FDF63	63mm	Ø63	129	190	ABS & PVC
FDF2.0	2.0"	Ø60	129	190	ABS & PVC

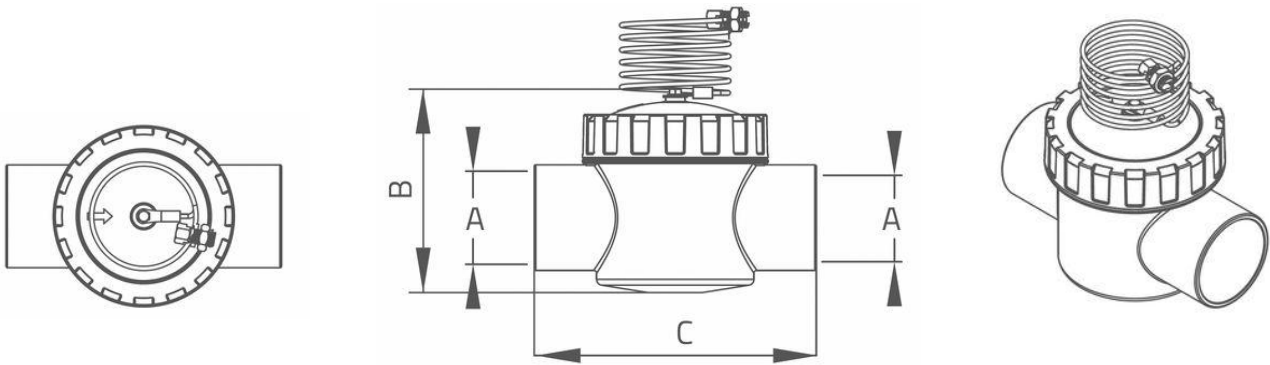

Standard Installation

Installation:

1. Cut the pipe to match the size of the "TEE" shield.
2. Attach the "TEE" to the pipe using glue.
3. Secure the copper wire to the pump ground with a split connector.

Location:

- The best location for installation of the shield is in the water pipe after the filter.
- With a pool heater, the shield should be placed after the filter and before the heater.
- With a salt chlorinator, the shield should be placed after the filter and before the cell.

Replacement:

The anode should be replaced after half of it has been eroded, approximately every three years.

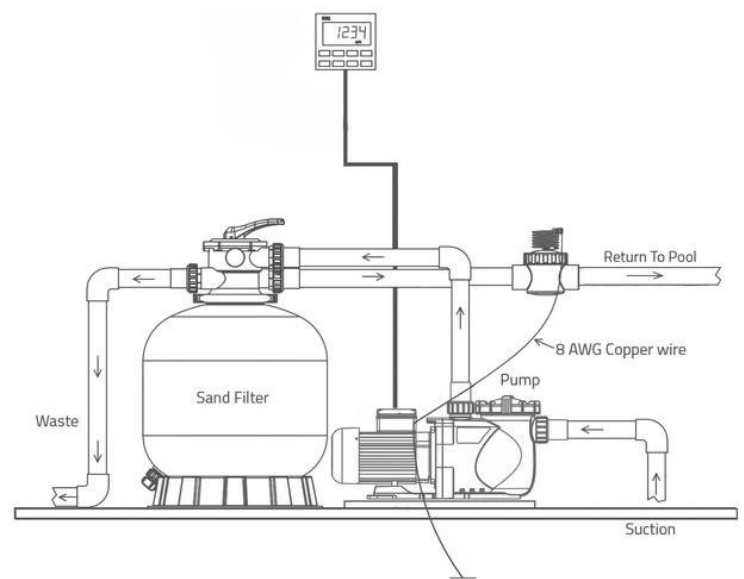



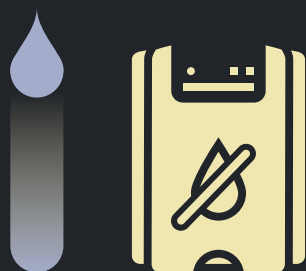

DEHUMIDIFIERS



F-DH108B DEHUMIDIFIER

For comfortable and moisture-free environment

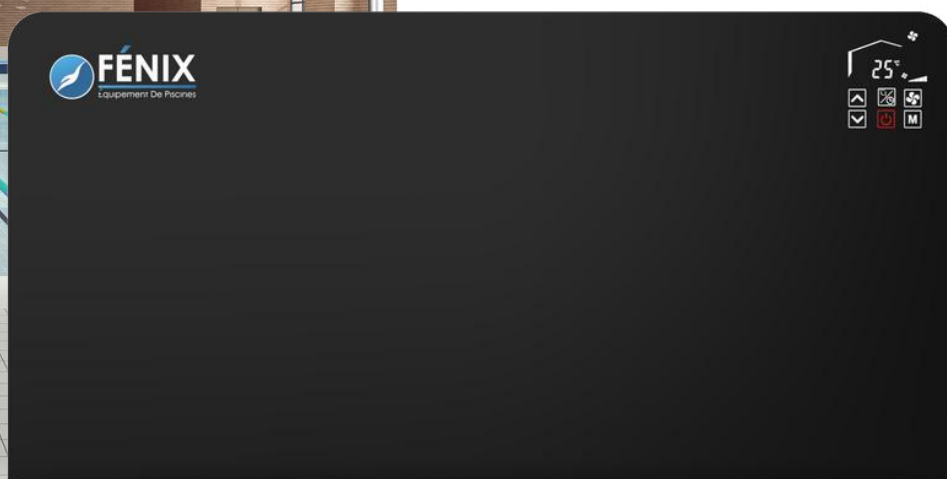

Super Silent Operation



Comfortable Air Temperature



Gold Epoxy Fin Exchanger



F-DH108B DEHUMIDIFIER

For comfortable and moisture-free environment

The F-DH108B Dehumidifier offers a comprehensive solution to combat condensation and furniture corrosion by efficiently absorbing clammy air and converting it into warm & dry air.

Whisper-Quiet Operation:

Thanks to a new noise-reduction improvement and DC fan motor adopted for air circulation, the FENIX Dehumidifier operates silently at 44-46dB(A), even quieter than a moderate rainfall.

Enhanced Air Comfort:

The FENIX dehumidifier is equipped with a warm and comfortable air outlet, utilizing a hot water coil heater that can be connected to your own heat source, like a water tank.

Corrosion-Resistant Technology:

The FENIX Dehumidifier utilizes a gold epoxy fin heat exchanger, ensuring excellent anti-corrosion performance and a long-lasting working life.

Eco-Friendly R32 Refrigerant:

The FENIX Dehumidifier is designed with environmental consciousness in mind. It employs the use of R32 refrigerant, which is known for its lower global warming potential (GWP) compared to traditional refrigerants. By opting for R32, this dehumidifier helps reduce its impact on the environment while still delivering efficient and effective dehumidification performance.

Rated Capacity (30°C ambient temperature, 80% relative humidity)	L/h	4.5
Dehumidification Capacity Per Day	L	108
Air Flow (Min. speed)	m³/h	350
Air Flow (Midial speed)	m³/h	500
Air Flow (Max. speed)	m³/h	750
Rated Voltage/Freq	/	220-240V~/50Hz
Rated Power Input	kW	1.95
Rated Running Current	A	8.80
Max. Power Input	kW	2.70
Max. Running Current	A	12.0
Relative Humidity	%RH	40~90
Temperature	°C	10-32
Dimensions (L×W×H)	mm	1743×248×790
Condensation Pipe Diameter	mm	7

Operation Principle

The unit operates by using a small fan to pull moist air over a refrigerated coil. As the air passes over the cold coil, moisture condenses and is removed.

The dry air is then reheated by the hot coil before being released.



Noise dB Level Comparison

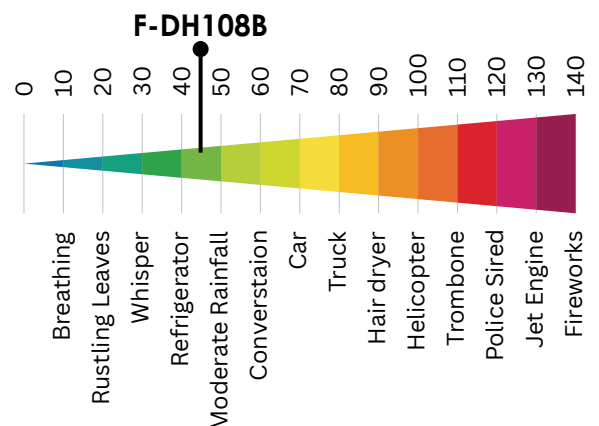

NOTES

PLONGER DANS LA QUALITÉ

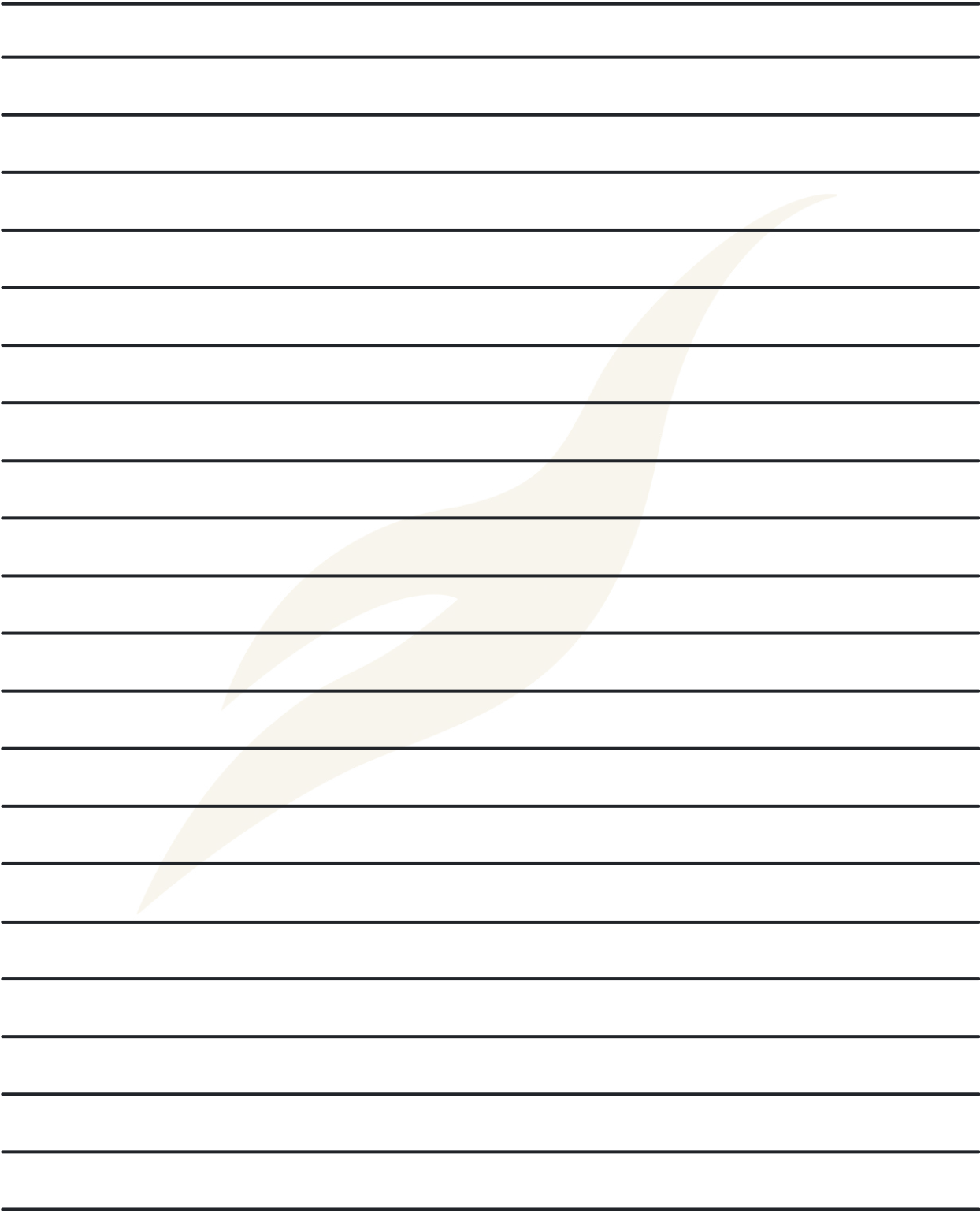

A series of horizontal lines for writing notes, with a large, faint, stylized graphic of a swimmer or fish in the background.

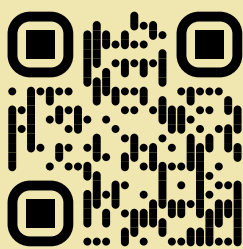

WWW.FENIXPOOL.FR

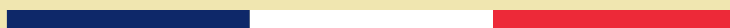

FRANCE

9 rue Louis Armand, 95600 Eaubonne.

+33 651 444 300

info@fenixpool.fr