

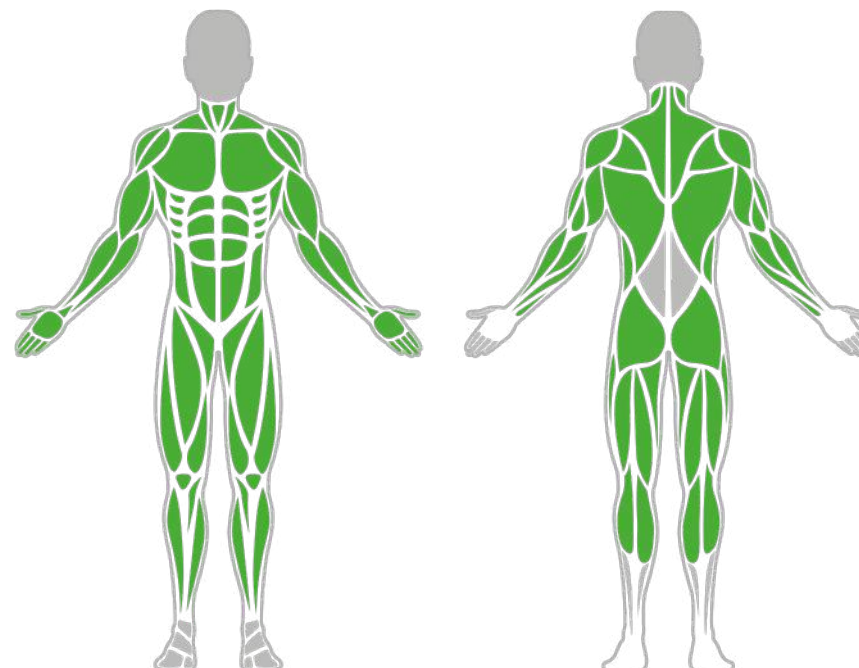

beststrongworld beststrongworld usa.beststrong.com usa@beststrong.com



## Muscle Groups Focus



### Net Climber

The Net Climber is a dynamic obstacle course element designed to challenge agility, grip strength, and full-body coordination. Participants must ascend and traverse the suspended net using both hands and feet, engaging core and stabilizing muscles to maintain control. The shifting surface demands focus, rhythm, and balance, making it an exciting test of endurance and climbing ability.

### Attributes

Product code	1-1-646
Certificate	EN 16630, ASTM F3101
Age group	14 + years
Capacity	1 person
Max. weight load	218.26 lbs
Type	Obstacle Course
Difficulty level	Medium

## Side View

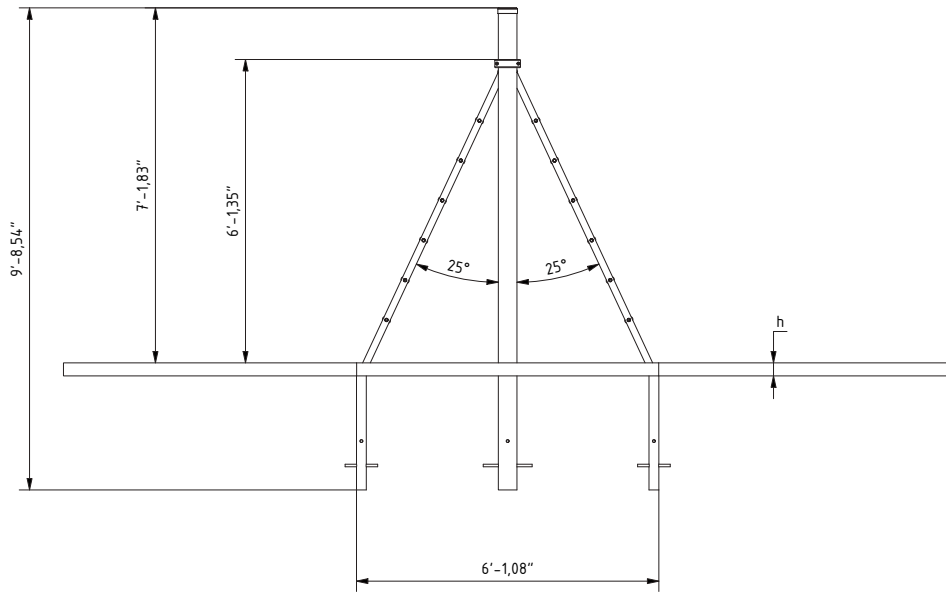

## Plan View

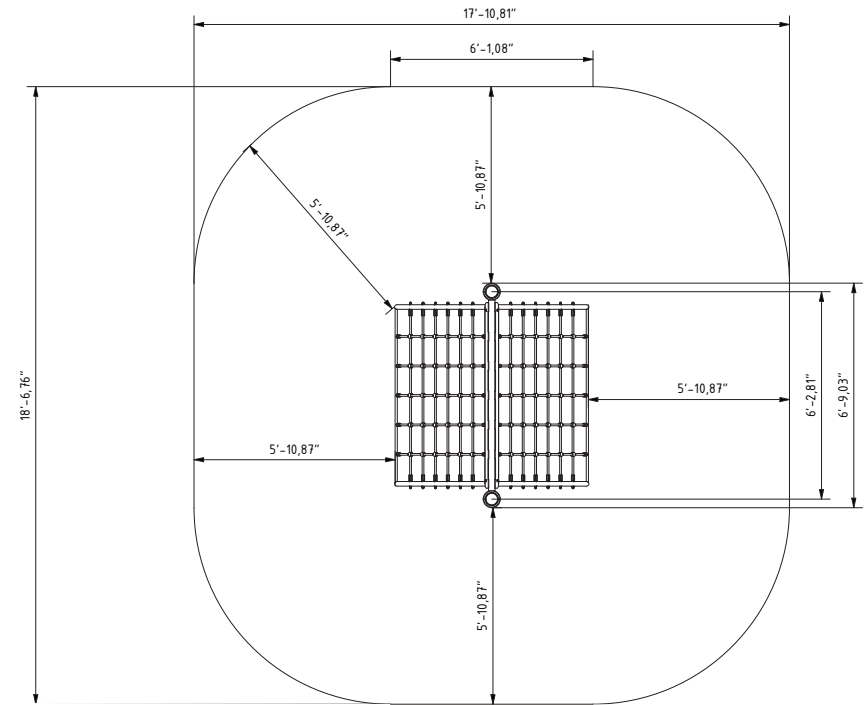

## Installation information

Number of installers (concrete)	At least 2 people
Total installation time (concrete)	80-140 min.
Number of installers (equipment)	At least 2 people
Total installation time (equipment)	60 min.
Excavation volume	36.74 ft <sup>3</sup>
Concrete volume	28.25 ft <sup>3</sup>
Size of the base structure	4 × 19.69" × 19.69" × 31.50"
Anchoring options	In-ground or surface
In combined structures, the volume of concrete required varies.	

## Technical specification

- Safety surface area
- Net weight
- Material
- Critic fall height
- Color options

For more color options, discuss with your sales representative.

Around 4.92 ft radius  
281,13 lbs  
S235,HDPE  
74,80"



## Warranty

Structure	25-15 years
Steel	5-10 years
Paint	2 years
Plastic	5-10 years
Rubber	1-3 years
Moving parts	2 years
Detailed information in the warranty document	

# Material specification

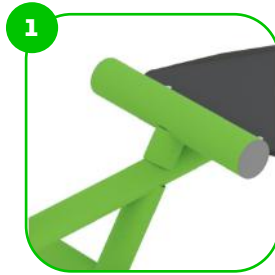
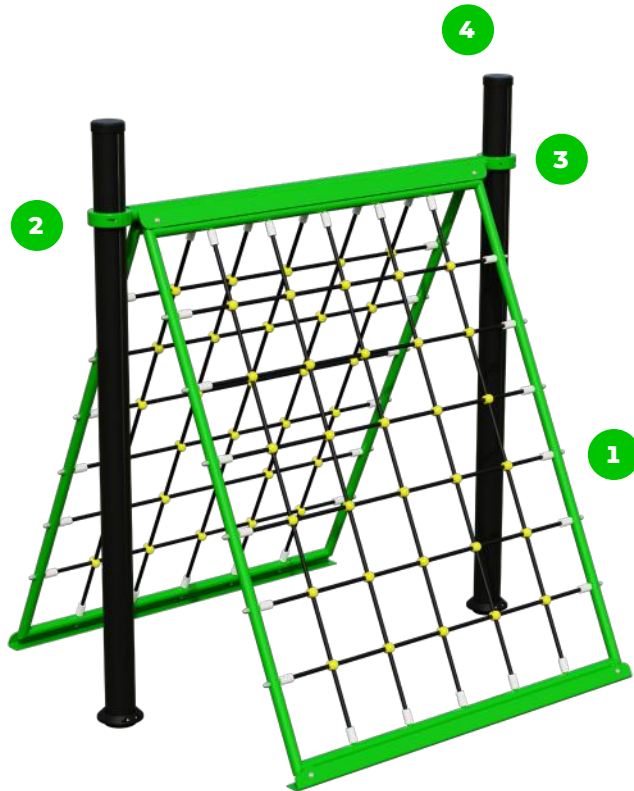

The element is made of high quality S235 steel, which has been cleaned via sandblasting. A corrosion resistant powder coating finish is then applied. Also available with galvanized surface for even greater protection and longevity!



The clamp system allows for easy assembly and extreme stability.



The connecting elements are fastened with vandal-proof stainless steel screws and nuts.



The ends of the bars and posts are sealed with injection-moulded plastic caps.

# BESTRONG

 [bestrongworld](#)  [bestrongworld](#)  [usa.bestrong.com](#)  [usa@bestrong.com](#)



Sport and fitness products are compliant with the EN16630 and ASTM F3101 Standards.