



2 LYNWOOD AVENUE PH ONE
SOUTH HILL



PENTHOUSE ONE 2 LYNWOOD AVENUE SOUTH HILL BOUTIQUE LUXURY LIVING

An extraordinary two-storey penthouse residence offering nearly 5,000 square feet of interior space in an exclusive 16-suite building in the heart of Toronto's prestigious South Hill.

Penthouse One offers soaring architectural drama, refined craftsmanship, and a rare level of privacy and scale.



KEY FEATURES

- Nearly 5,000 sq ft of interior living space over two levels
- Boutique 16-suite building in South Hill offering unparalleled privacy
- Soaring two-storey entry with oak herringbone floors and marble water feature
- Dramatic great room with 25-foot ceilings, open-flame gas fireplace, and floor-to-ceiling windows
- Elegant dining area with black marble flooring and wall-to-wall windows
- Commercial-grade chef's kitchen
- Cozy family room adjacent to main living with solarium feature
- Main-floor primary suite with five-piece ensuite and walk-in closet
- Primary ensuite complete with in-floor heating and steam shower
- Curved staircase under skylight leading to upper level
- Second-floor library with gas fireplace, wet bar, and custom built-ins
- Two additional upper-level bedrooms with southern exposure
- Refined finishes throughout, including crown mouldings and custom shelving

BUILDING AMENITIES

- Concierge, indoor pool, gym, sauna, party room, visitor parking

ADDITIONAL HIGHLIGHTS

- Four underground parking spaces (two tandem)
- Oversized private storage locker
- Balcony can be returned to outdoor space with building permit
- One of only 16 suites in the building

A RARE OPPORTUNITY

Experience the pinnacle of boutique luxury living in one of Toronto's most coveted neighbourhoods. Penthouse One at 2 Lynwood Avenue is a true masterpiece — offering unrivalled elegance, privacy, and architectural excellence.















2 LYNWOOD AVENUE PH ONE

Floor Plans

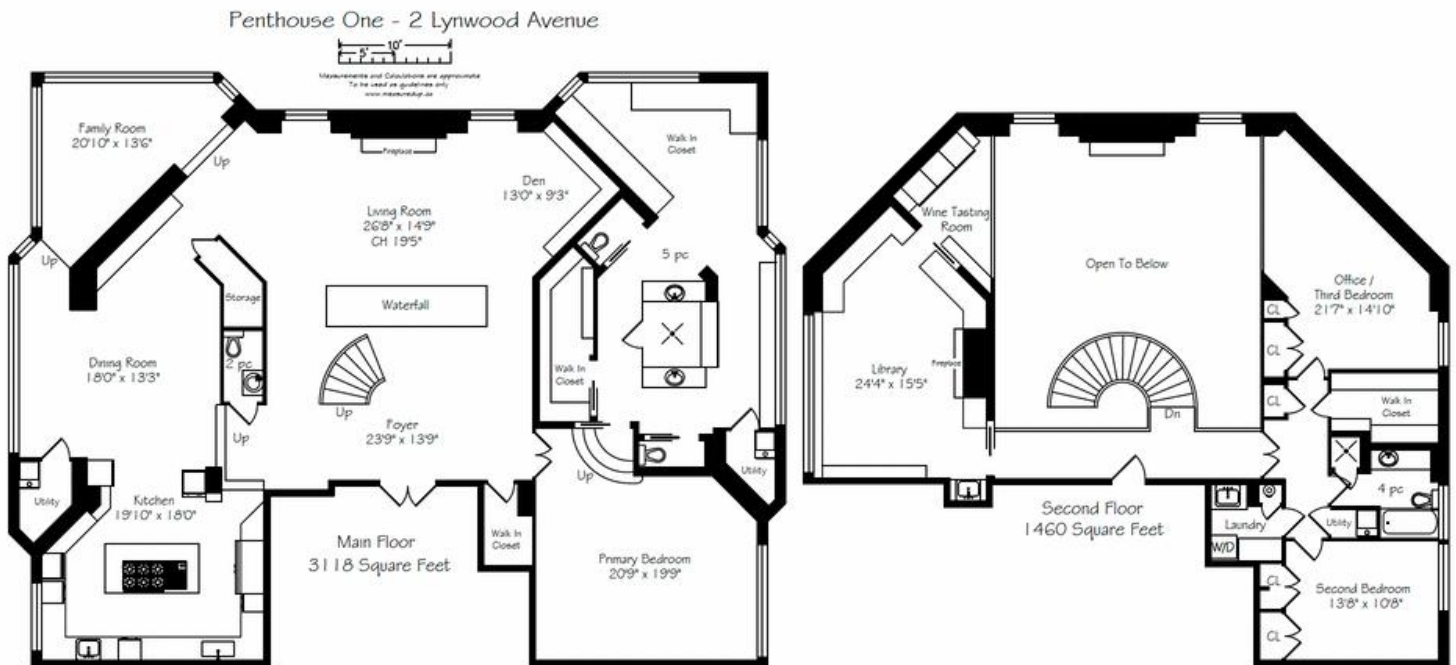

MAINTENANCE FEES

- \$10,412.33/month (Includes: Building Insurance, Water, Common Elements, Parking)

POSSESSION

- 30/60 Days / Flexible

EXPOSURE

- South East

LOCKER

- 1 Oversized Owned Locker (B22)

HEATING/COOLING

- Electric Forced Air / Central Air

CONDO CORP

- MTCC #660

PROPERTY TAXES

- \$16,952 (2024)

SQUARE FOOTAGE

- Approx. 4,578 sq ft (Per Floor Plan)

PARKING

- 4 Underground Owned (2 Tandem Spots – B10 & B11)

PETS

- Allowed with restrictions

PROPERTY MANAGEMENT

- Wilson Blanchard Property Management (416-642-2807)



ELEVATE YOUR EXPECTATIONS

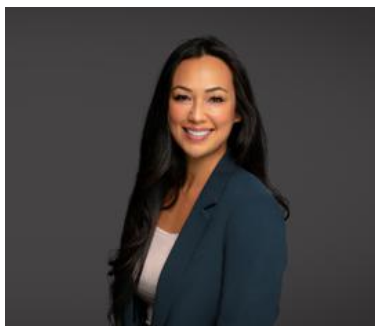

Brenna Whyte, BSc, MSc
Real Estate Agent
647.895.3827
brenna@heapsestrin.com



For Royal LePage Real Estate Services Heaps Estrin Team, Brokerage. All information and statements contained herein, provided by Royal LePage Real Estate Services Heaps Estrin Team, Brokerage regarding property for sale, rental or financing is from sources deemed reliable and assumed correct, but no warranty or representation is made as to the accuracy thereof and same is submitted subject to errors, omissions, changes in price, rental or other conditions, prior sale or withdrawal without notice.

Royal LePage Real Estate Services Heaps Estrin Team, Brokerage Independently Owned and Operated