

# H I G H S P E E D D O O R S







 PAW®  
www.paw.com.tr

# Contents

 **About**  
Us

 **Export**  
Countries

 **Business**  
Areas

 **Products**

## High Speed Doors

- Paw-Turbo Spiral Doors
- Paw-Roll Roll-Up Doors
- Paw-Robo Robot Front Doors
- Paw-Conveyor Doors
- Paw-Roll Safety Roll-Up Doors
- Paw-Zipper Self Repairing Doors
- Paw-Izo Insulated Doors
- Paw-Eagle Self Repairing Doors
- Paw-Fold-Up Doors

## Hangar Doors

- Power XL Hangar Doors
- Maxi Hangar Doors

## Industrial Doors

- Sectional Doors
- Full Vision Sectional Doors

## Loading Systems

- Dock Levelers
- Dock Shelters

## Fire Rated Doors

- Emergency Exit Doors
- Roll-Up Fire Shutters

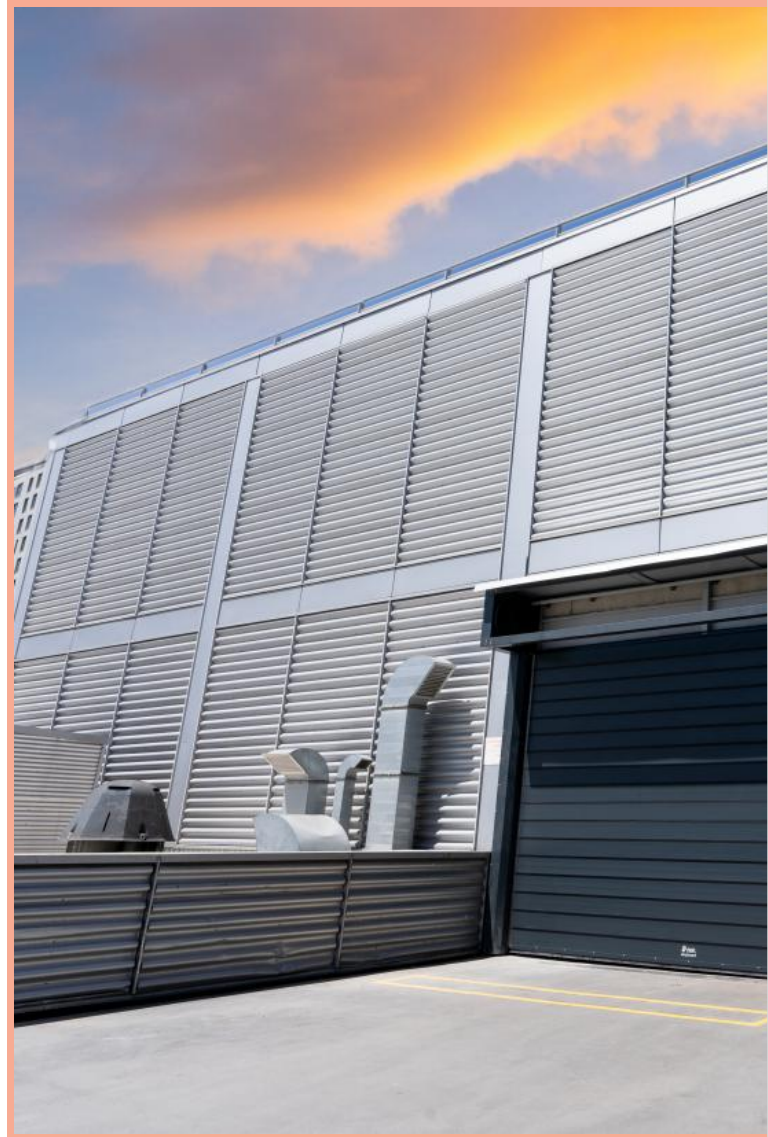



**Ezer Automatic Door Systems Inc.** started its production in 1989. Since its inception, the company has offered its registered brand, **PAW** high-speed door systems, for the use of customers in the interior and exterior areas of factories and facilities in Turkey and around the world. Thanks to their high performance and aesthetic appearance, these systems have gained significant attention from customers.

Through its partners, Ezer serves a wide range of customers in domestic and international markets. Continuously penetrating new markets worldwide, the company maintains its seriousness and commitment in the industry.

Key principles of the company include high production quality, research and development efforts, rapid production times, on-time delivery, economic spare parts guarantee, and service. By keeping up with advancing global technology, Ezer aims to reflect the development in its production to provide maximum benefit and competitive prices to its customers.

In addition to the design and economic distinctiveness of **PAW** products, their environmental compatibility sets them apart. Ezer strives to keep the interest in **PAW** products alive in global markets every day by basing competition on ethical values and enhancing customer satisfaction to the maximum level. The company anticipates and meets customer expectations and needs by formulating, planning, and implementing policies.

**Ezer's** business philosophy is to produce durable goods and pioneer the industry with its own new models, designs, and technologies.

# Export Countries

## N.America

Dominic Republic  
Mexico  
USA

## Europe

Austria	Germany	Portugal
Azerbaijan	Greece	Romania
Belgium	Hungary	Russia
Bulgaria	Ireland	Serbia
Czech Republic	Italy	Slovenia
Estonia	Lithuania	Spain
Finland	Moldova	Sweden
France	Netherlands	Switzerland
Georgia	Norway	United Kingdom

## Oceania

Australia  
New Zealand

## S.America

Argentina  
Brazil  
Chile  
Colombia  
Venezuela

## Africa

Algeria  
Egypt  
Ethiopia  
Ghana  
Libya  
Morocco  
Nigeria  
South Africa  
Tunisia

## Asia

India	Oman
Indonesia	Qatar
Iran	Saudi Arabia
Kazakhstan	UAE
Kuwait	Uzbekistan
Lebanon	Vietnam
Malaysia	Jordan

“ We are opening **the door** to more success with our growing potential in exports every day! ”



## Business Areas

- Airports
- Shipyards
- Warehouses
- Pharmaceutical Industry
- Food Industry
- Automotive Industry
- Manufacturing Facilities
- ...





## High Speed Doors

-  Paw-Turbo Spiral Doors
-  Paw-Roll Spiral Doors
-  Paw-Robo Robot Front Doors
-  Paw-Conveyor Doors
-  Paw-Roll Security Spiral Doors
-  Paw-Zipper Self-Repairing Doors
-  Paw-Izo Insulated Doors
-  Paw-Eagle Self-Repairing Doors
-  Paw-Folding Doors

# Paw-Turbo Spiral Doors



## EZ-8010

### PAW-TURBO FULL-VISION DOORS

These doors facilitate the entry of light into the facility through transparent panels, creating a brighter and more energetic working environment. Specially designed EPDM rubber seals between the panels ensure maximum energy savings.

Paw-Turbo doors can be integrated into your automation system for a fast production flow, operating in synchronization with production lines and conveyors in your facilities.

With specially designed double-bearing wheel systems, these doors provide high performance and long-lasting use.

## EZ-8020

### PAW-TURBO PANEL DOORS

Designed entirely from aluminum with a supporting system and special panels, Paw-Turbo visually enhances the architectural structure of your facility by combining industrial functionality with aesthetic appeal.

With superior thermal insulation, it reduces energy costs, maintains internal temperature to prevent cooling, and minimizes heat loss due to its high-speed operation.

The specially designed, spring-balanced manual opening handle provides a temporary solution during power outages and emergency situations.

**Designed to bring together rapid opening and closing, durability, and aesthetic design, these doors are crafted to optimize your business processes and enhance operational efficiency.**



## EZ-8030

### PAW-TURBO PVC DOORS

High-performance spiral PVC tarp doors are designed for use in both interior and exterior environments of your facilities to support fast operational flow.

They prevent the passage of dust and air with their special insulation, ensuring the safety of products through high hygiene security measures. Paw-Turbo provides space-saving by winding the door around a special spiral drum during the opening process.

As standard safety equipment, CE certified, IP 65 protected, and photoelectric sensor systems are utilized.

“ We invite you to a world where modern industrial design and high performance come together! ”

**Our TURBO Spiral Doors offer the key to safely propel your businesses into the future by seamlessly combining aesthetics and functionality in perfect balance.**

# Paw-Turbo Spiral Doors

## EZ-8010

Paw - Turbo / Full Vision

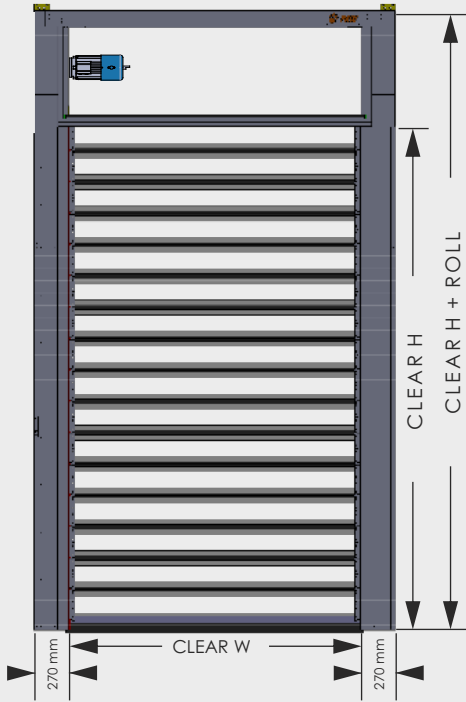

## EZ-8020

Paw - Turbo / Panel

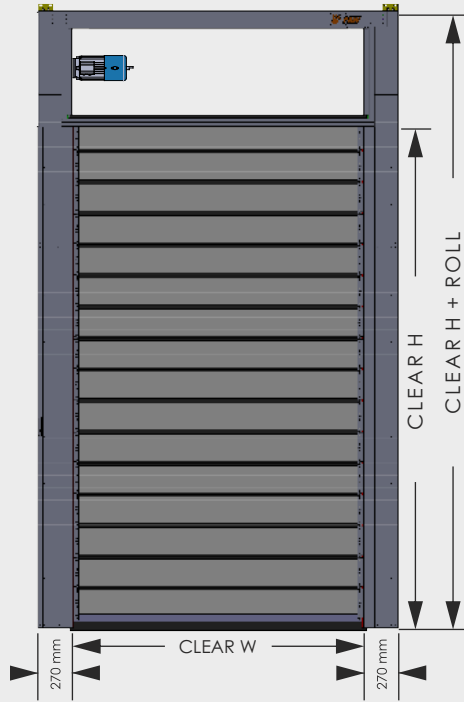

## EZ-8030

Paw - Turbo / PVC

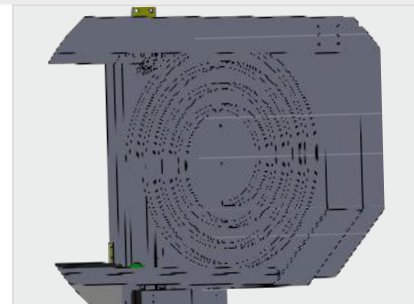
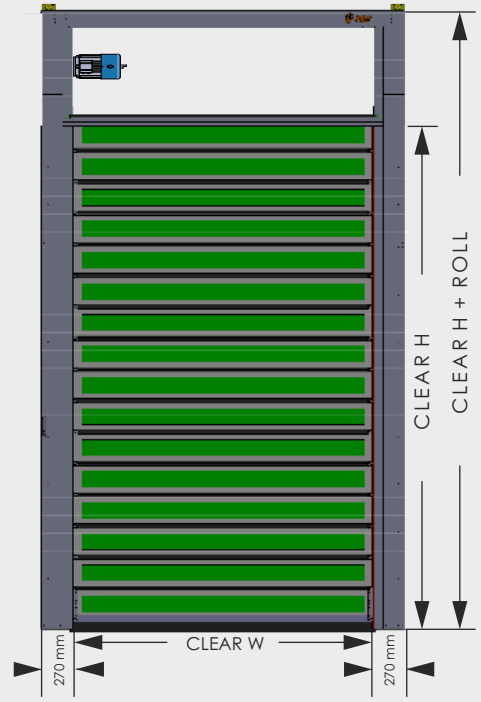

TURBO SPIRAL



FULL VISION PANEL

- Standard
- Optional
- X Not available

## EZ-8010 / 8020

Opening Speed	± 3.0 m/s
Closing Speed	± 1.5 m/s
Emergency Opening	Spring-balanced
Aluminum Panel Thickness	3 mm
Panel Thickness	40 mm
Panel Height	238 mm
PVC Curtain	-
Polycarbonate Glass	5 mm
Custom Design Bearing Wheel	√
EPDM Gasket	√
Wind Resistance	Class 4
Loop Detector	○
Safety Beam Sensor	●
Interlock System	●
Radar	○
Hand Sensor	○
Remote Control System	○
Additional Button	○
Warning Flasher	○
Traffic Light	○
Motor Cover	○

- Standard
- Optional
- X Not available

## EZ-8030

Opening Speed	± 3.5 m/s
Closing Speed	± 1.5 m/s
Emergency Opening	Spring-balanced
Aluminum Panel Thickness	3 mm
Panel Thickness	40 mm
Panel Height	238 mm
PVC Curtain	900 gr
Polycarbonate Glass	5 mm
Custom Design Bearing Wheel	√
EPDM Gasket	√
Wind Resistance	Class 2
Loop Detector	○
Safety Beam Sensor	●
Interlock System	●
Radar	○
Hand Sensor	○
Remote Control System	○
Additional Button	○
Warning Flasher	○
Traffic Light	○
Motor Cover	○

SPRING SYSTEM

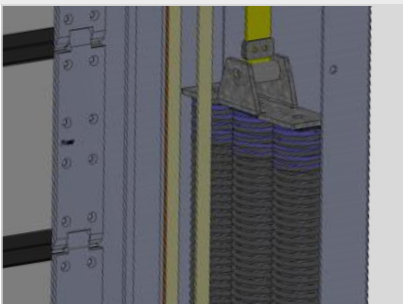

ALUMINIUM PANEL

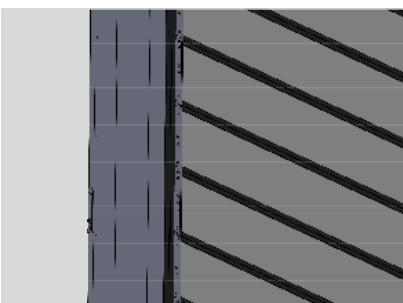

SPRING BALANCED RELEASE

# Paw-Roll Roll-Up Doors

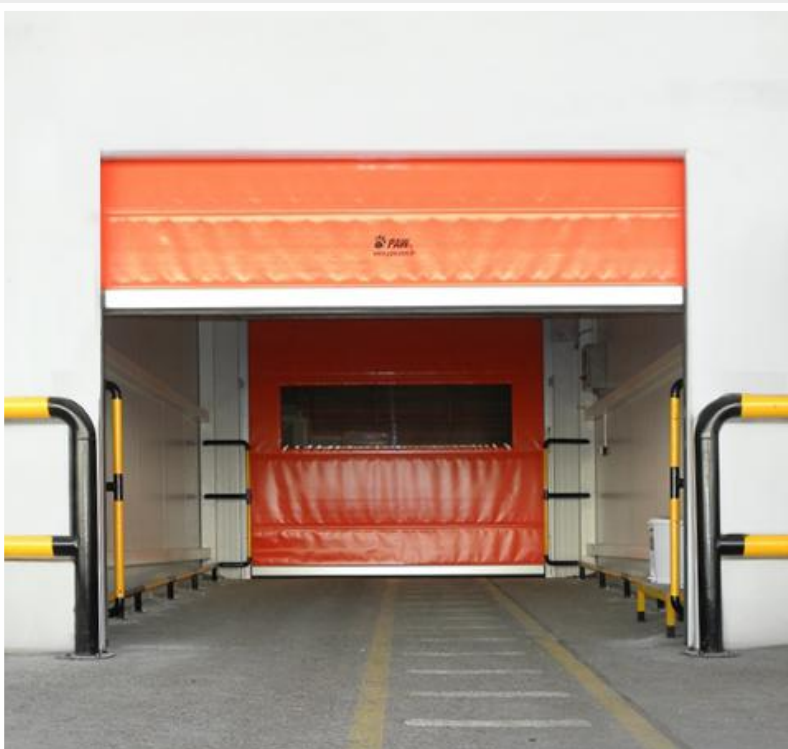

## PAW-S5

PAW High-Speed Doors are an ideal choice for businesses seeking modern industrial solutions. Designed with high performance, energy efficiency, and durability in mind, these doors will help make your business operations more effective and efficient.

The rapid opening and closing feature of Spiral Doors optimizes the workflow of your business. This characteristic increases energy savings, maintains internal temperature, and thereby reduces operating costs.

Our doors are manufactured using high-quality materials that comply with European standards, ensuring a robust structure for long-lasting performance even in demanding usage conditions. Additionally, they are designed to meet safety standards, enhancing the security of your business. The friction-resistant and durable tarp material, along with the long-life motor, provides 24/7 service. They are ideal for use in shift-based facilities such as automotive, pharmaceutical, and food industries.

The PVC curtain and PVC transparent window are combined using a high-frequency welding machine. The unique design ensures maximum sealing through double-directional rubber gaskets mounted on aluminum rails. The one-piece PVC curtain structure complies with hygiene standards.

With its experience in the industry since 1989, EZER manufactures doors that meet the needs of its customers. From the selection process to fast after-sales service, EZER provides support to its customers and has become a significant solution partner in the industrial door sector.

Colors, sizes, options, and features are tailored to customer preferences, ensuring perfect compatibility for all types of industrial environments.



Our PVC High-Speed Doors stand out with low maintenance requirements. Thanks to their user-friendly design, maintenance and service procedures can be carried out quickly and easily.

The production infrastructure and products have been CE certified by Applus, one of Europe's leading testing and certification organizations. EZER continues to be a reliable solution partner in the industrial door sector, prioritizing customer satisfaction.



“ High Speed,  
Maximum Protection ”

# Paw-Roll

## Roll-Up Doors

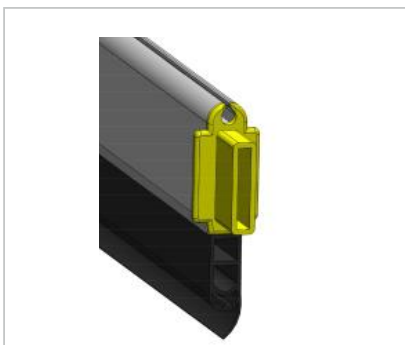
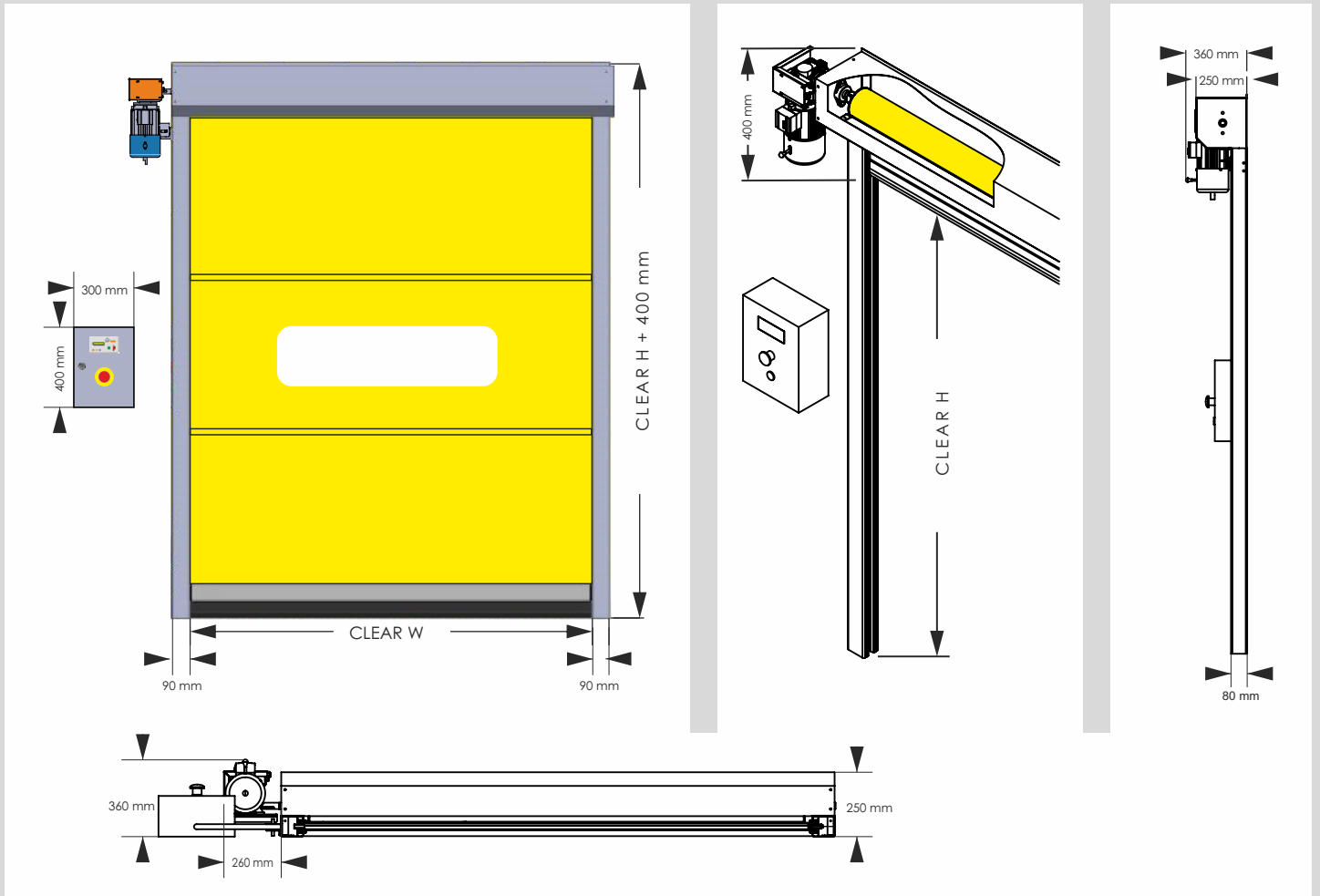

ALUMINUM BAR

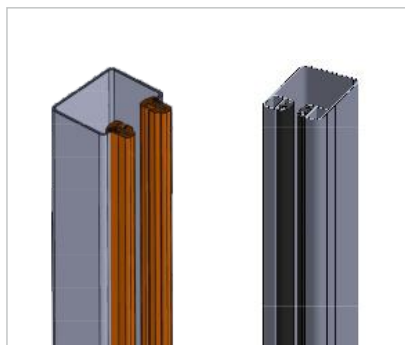

GALVANIZED/ALUMINUM GUIDES

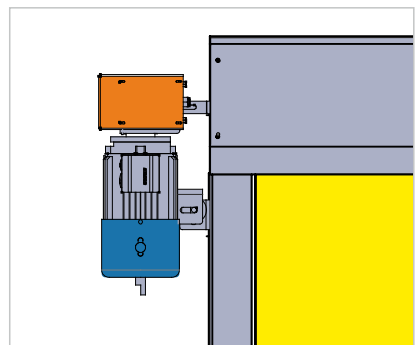

MOTOR SYSTEM



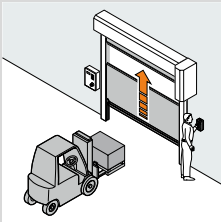

Hand Sensor

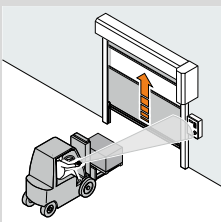

Remote Control

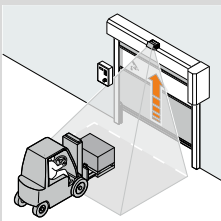

Radar

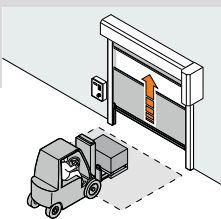

Loop

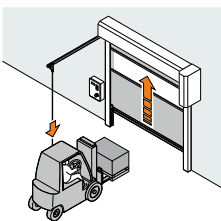

Rope Switch

- Standard
- Optional
- X Not available

	ROLL-UP	
	S-1	S-5
Maximum Size	4500 X 4500 mm	4500 X 4500 mm
Motor Power	0.75 / 1.5 kW	0.75 / 1.5 kW
Motor Voltage	400 V. AC. 50 / 60 Hz	230 V. AC. 50 / 60 Hz
Control Panel	Ip 65	Ip 55 Lcd Screen
Speed Driver		0.75 / 1.5 kW
Opening Speed	0.70 m / sec.	0.70 m/sec.-1.30 m/sec.
Closing Speed	0.70 m / sec.	0.70 m / sec.
Fuse Protection	16 A	16 A
PVC Thickness	900 gr	900 gr
PVC Heat Resistance	-30 + 70 °C	-30 + 70 °C
Wind Resistance	Class 1/2	Class 1/2
Carrier Rail System	Galvanized	Aluminum
Aluminum Bottom Bar	○	●
Stainless Steel Rail	○	○
Safety Edge System	○	○
Safety Photocell	● 1 Set	● 1 Set
Anti-crash System	○	○
Rope Switch	○	○
Additional Photocell	○	○
Light Barrier	○	○
Interlock System	●	●
Radar	○	○
Loop Detector	○	○
Hand Sensor	○	○
Remote Control System	○	○
Additional Button	○	○
Warning Flasher	○	○
Traffic Light	○	○
Motor Cover	○	○
Front Cover	○	○
Manual Handle	●	●
Spring-Loaded Emergency Exit	○	○

## PAW PVC CURTAIN COLORS



**MH 907**  
(RAL 9010)



**MH 168**  
(RAL 1018)



**MH 370**  
(RAL 3002)



**MH 221**  
(RAL 2008)



**MH 544**  
(RAL 5002)



**MH 679**  
(RAL 6005)



**MH 717**  
(RAL 7035)



**MH 782**  
(RAL 7016)

"The mentioned PVCcolor codes are similar to RAL, and there might be tonal differences with RAL codes. The desired tarpaulin colors should be selected according to the tarpaulin codes. (Optional custom colors are available upon request.)"

\*PVC Thickness: 900 Gr/m<sup>2</sup> (\*\*Optional : 1700 Gr/m<sup>2</sup>)

# Paw-Roll

## Robot Front Doors

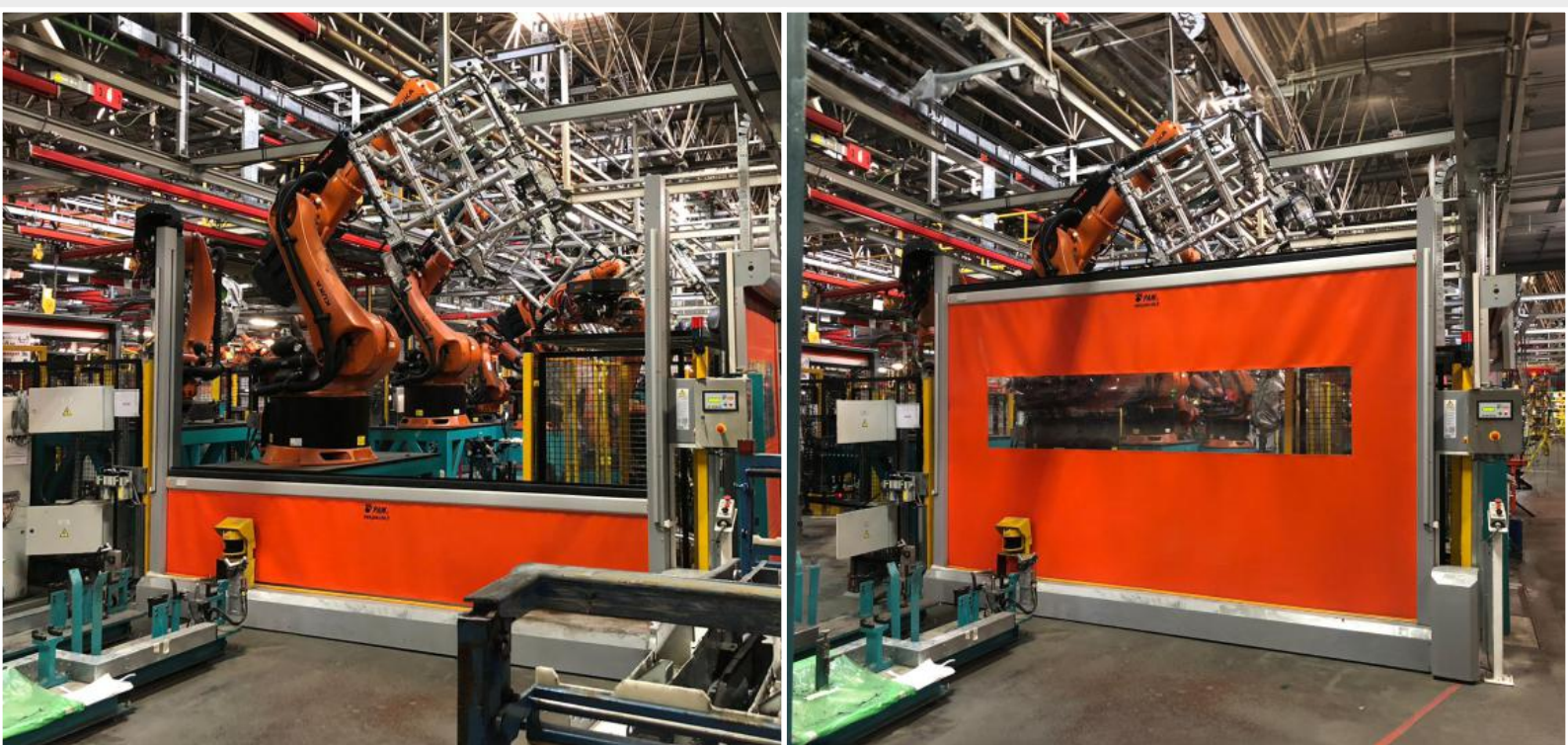

## PAW-RB5

PAW-ROBO, a series of high-speed spiral doors designed for the next generation of factories, is equipped with state-of-the-art technology and seamlessly integrates with all types of automation systems. In touchless factories, these doors integrate seamlessly with fast production lines.

The easy adaptation of Paw-Robo to automation systems and its special design, combined with high opening and closing speeds, provide secure and maintenance-free longevity, offering unique solutions in the industry. The specially selected Tarp system enhances durability against welding sparks, maximizing the door's lifespan.

It can be customized according to the needs of any space and can adapt to different requirements. Robot Front Doors offer an innovative and versatile solution designed to meet the requirements of modern industrial facilities, aiming to enhance efficiency and safety in production processes.

**High Adaptability and Flexibility:** Ability to adapt to the variable needs of next-generation factories, integrating with different automation systems and production processes.

**Fast Operation:** Accelerates production flow with high opening and closing speeds, leading to time savings in business processes.

**Safety and Durability:** The special PVC system and European-origin motor system enhance durability while ensuring safety in various industrial environments.



**Maintenance-Free Design:** Supports continuous operation with low maintenance needs due to its long-lasting structure.

**Customization Possibility:** Offers solutions tailored to customer preferences and space requirements by providing custom production based on the project.

**Optimized Performance:** Designed to meet the needs of industrial automation, it enhances production efficiency by effectively managing workflow.

## INTEGRATED CONTROL SYSTEMS

Designed for seamless integration with other automation systems, it provides easy control and management capabilities.

**Application Diversity:** Provides the possibility of custom production suitable for various industrial sectors. It can be adapted to a wide range of applications, from the food industry to logistics, automotive to the pharmaceutical sector.

**Aesthetic and Ergonomic Design:** Provides an eye-catching appearance in industrial settings while increasing work efficiency with user-friendly ergonomic features.

**Fast Assembly and Installation:** Minimizes time loss with easy assembly and quick installation, ensuring rapid business continuity.

# Paw-Roll

## Robot Front Doors

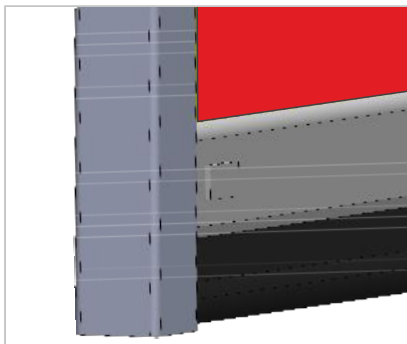
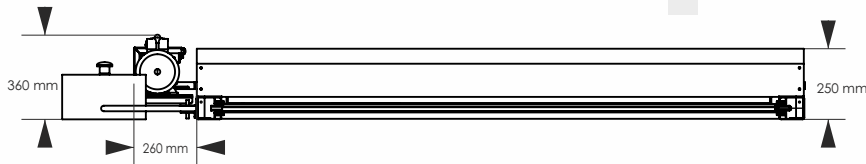
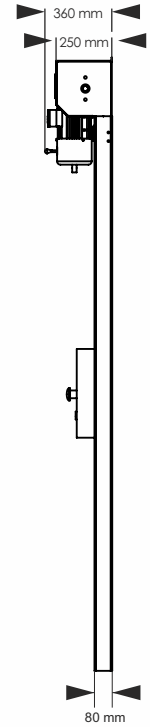
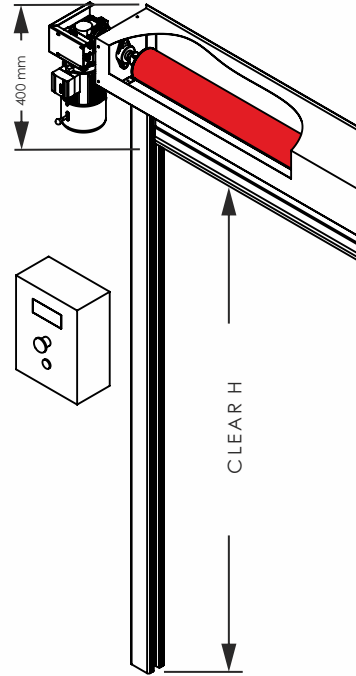
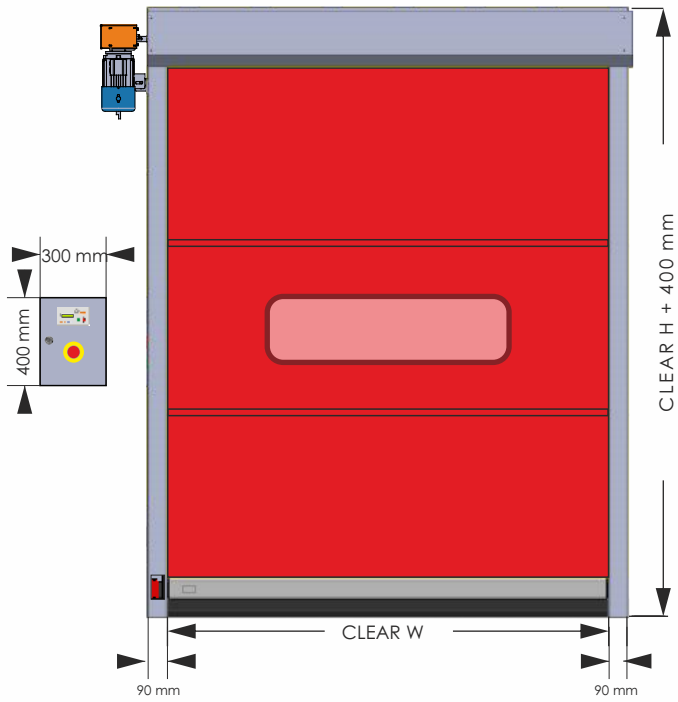

SAFETY EDGE SYSTEM

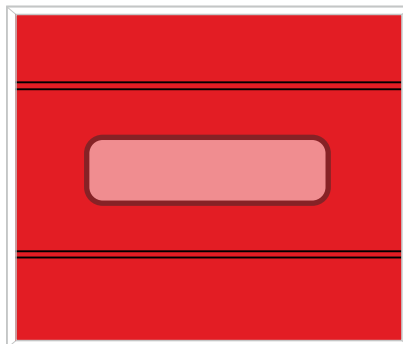

WELDING WINDOW

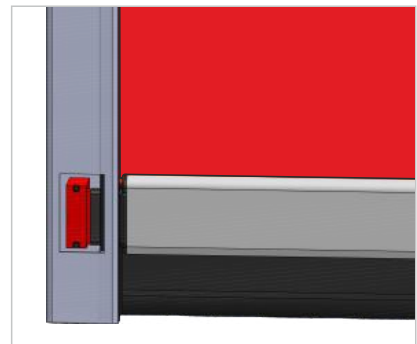

SAFETY SWITCH

	ROBOT	
	RB-1	RB-5
● Standard		
○ Optional		
X Not available		
Maximum Size	4500 x 4500 mm	4500 x 4500 mm
Motor Power	0.75 / 1.5 kW	0.75 / 1.5 kW
Motor Voltage	400 V. AC. 50 / 60 Hz	230 V. AC. 50 / 60 Hz
Control Panel	-	IP 55 LCD Screen
Speed Driver	-	0.75 / 1.5 kW
Opening Speed	-	0.70 m/sec. -1.30 m/sec.
Closing Speed	-	0.70 m / sec.
Fuse Protection	-	16 A
PVC Thickness	1700 gr	1700 gr
PVC Heat Resistance	-30 + 70°C	-30 + 70°C
Wind Resistance	Class 1/2	Class 1/2
Carrier Rail System	Galvanized	Aluminum
Aluminum Bottom Bar	●	●
Stainless Steel Rail	○	○
Safety Edge System	○	●
Safety Photocell	● 1 Set	● 1 Set
Anti-crash System	○	○
Rope Switch	○	○
Additional Photocell	○	○
Light Barrier	○	○
Limit Switch	○	○
Interlock System	●	●
Radar	○	○
Loop Detector	○	○
Hand Sensor	○	○
Remote Control System	○	○
Additional Button	○	○
Warning Flasher	○	○
Traffic Light	○	○
Motor Cover	●	●
Front Cover	●	●
Manual Handle	●	●
Spring-Loaded Emergency Exit	○	○

## PAW PVC CURTAIN COLORS



**SL 1018**  
(RAL 1018)



**SL 3015**  
(RAL 3002)



**SL 3056**  
(RAL 2008)



**SL 5031**  
(RAL 5002)



**SL 7166**  
(RAL 7038)



**WELDING WINDOW**

The mentioned PVC color codes are similar to RAL, and there might be tonal differences with RAL codes. The desired tarpaulin colors should be selected according to the tarpaulin codes.

(Optional custom colors are available upon request.)

PVC Thickness: 1700 Gr/m<sup>2</sup>

# Paw-Roll Conveyor Doors



## PAW-CK5

Paw high-speed doors, as part of the automation system, ensure the continuity, isolation, and security of products on moving belts between production and shipment.

Especially in systems where conveyors are used, it prevents the undesired transfer of materials from one area to another. By connecting to various automation systems, it can be set to operate at desired intervals and in desired manners. This ensures full compatibility with your production, minimizing energy and time loss.

Conveyor doors, essential for an effective and efficient workflow in the modern industrial world, are key elements in optimizing your business processes and providing a seamless transition experience. Designed to save time, enhance safety, and optimize productivity in every step of your industry, our conveyor doors offer unique features to make your operations smoother.

Our conveyor doors, combining technological innovation and quality, deliver top-notch performance in managing material flow in industrial facilities.



Our conveyor doors, made from durable materials, increase the profitability of your business with long-lasting use and low maintenance costs. Equipped with advanced sensor technology and automatic control systems, our conveyor doors are designed to maximize safety and optimize operational efficiency.

Thanks to easy integration capabilities, they can be seamlessly integrated into your existing systems. Additionally, with energy-saving features, they provide an environmentally friendly solution.

With our customer satisfaction-focused approach, our expert teams provide support for the installation and use of our conveyor doors. With our reliable and professional service at every step, we help make your business processes more efficient and gain a competitive advantage.



**Elevate the safety standards in your workplace and leave your concerns behind with automatic detection systems and emergency mechanisms.**

# Paw-Roll Conveyor Doors

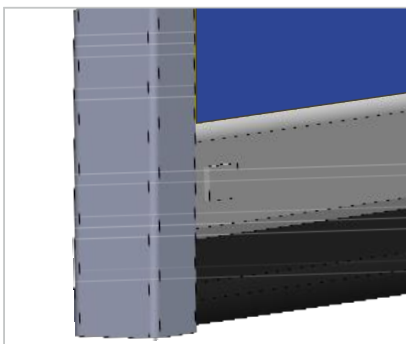
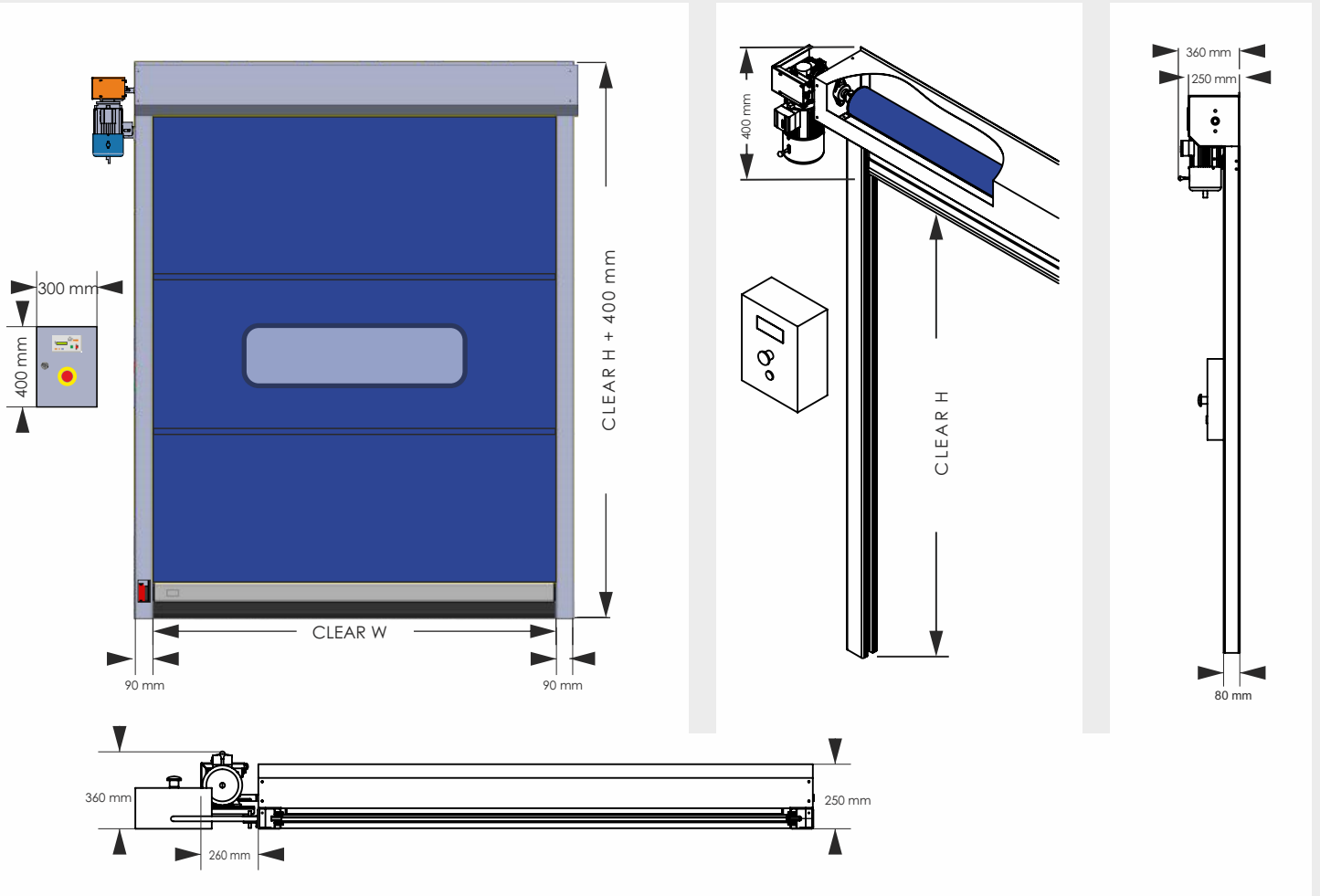

SAFETY EDGE SYSTEM

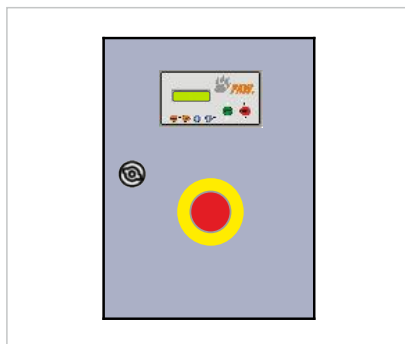

PAW ROBOT CONTROL UNIT

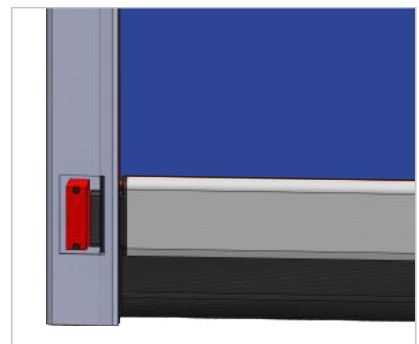

SAFETY SWITCH



	CONVEYOR	
	CK-1	CK-5
Maximum Size	4500 x 4500 mm	4500 x 4500 mm
Motor Power	0.75 / 1.5 kW	0.75 / 1.5 kW
Motor Voltage	400 V. AC. 50 / 60 Hz	230 V. AC. 50 / 60 Hz
Control Panel	-	IP 55 LCD Screen
Speed Driver	-	0.75 / 1.5 kW
Opening Speed	-	0.70 m/sec. -1.30 m/sec.
Closing Speed	-	0.70 m / sec.
Fuse Protection	-	16 A
PVC Thickness	1700 gr	1700 gr
PVC Heat Resistance	-30 + 70 °C	-30 + 70 °C
Wind Resistance	Class 1/2	Class 1/2
Carrier Rail System	Galvanized	Aluminum
Aluminum Bottom Bar	●	●
Stainless Steel Rail	○	○
Safety Edge System	○	●
Safety Photocell	● 1 Set	● 1 Set
Anti-crash System	○	○
Rope Switch	○	○
Additional Photocell	○	○
Light Barrier	○	○
Limit Switch	○	○
Interlock System	●	●
Radar	○	○
Loop Detector	○	○
Hand Sensor	○	○
Remote Control System	○	○
Additional Button	○	○
Warning Flasher	○	○
Traffic Light	○	○
Motor Cover	●	●
Front Cover	●	●
Manual Handle	●	●
Spring-Loaded Emergency Exit	○	○

## PAW PVC CURTAIN COLORS



**SL 1018**  
(RAL 1018)



**SL 3015**  
(RAL 3002)



**SL 3056**  
(RAL 2008)



**SL 5031**  
(RAL 5002)



**SL 7166**  
(RAL 7038)



**WELDING WINDOW**

The mentioned PVC color codes are similar to RAL, and there might be tonal differences with RAL codes. The desired tarpaulin colors should be selected according to the tarpaulin codes.

(Optional custom colors are available upon request.)

PVC Thickness: 1700 Gr/m<sup>2</sup>

## Paw-Roll Safety Roll-Up Doors



### PAW-SG5

It is manufactured by placing aluminum slats filled with polyurethane between two fabric layers. Suitable for heavy usage, it is preferred in areas requiring high security, wind resistance, and insulation.

Spiral Door systems are characterized by a double PVC fabric curtain rapidly moving up and down within a channel, wrapped around an aluminum shaft connected to a 380 Vac motor. They ensure safe and fast traffic flow within the facility, reducing time and energy loss for businesses.

With a friction-resistant fabric and a durable motor of European origin, it provides 24/7 service. It is commonly used in shift-based facilities such as automotive, pharmaceutical, and food industries.

The PVC fabric and PVC transparent window are joined using a high-frequency welding machine. The unique design, with double-directional rubber seals attached to aluminum rails, ensures maximum sealability. The one-piece PVC fabric structure is compatible with hygienic environments.

From the selection process to fast after-sales service, the company has always been by the customer's side. This success has made it a significant solution partner in the Industrial Door sector.

It is compatible with many automatic passage systems with its control unit and up-to-date safety equipment. The opening and closing speeds of the doors can be adjusted with the technological speed drive.

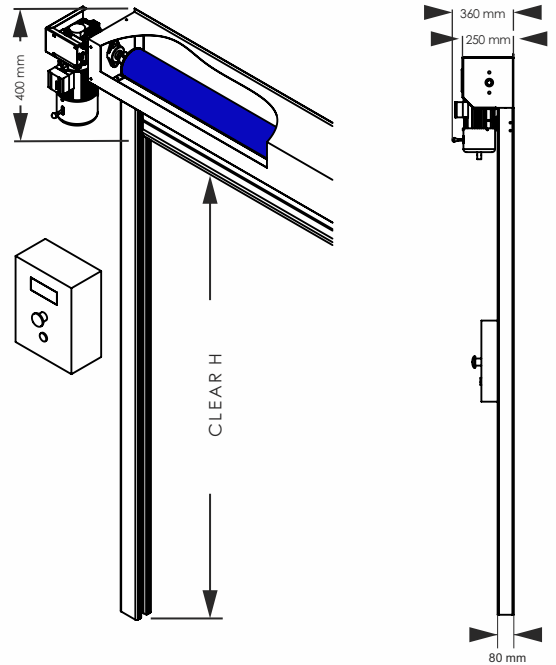
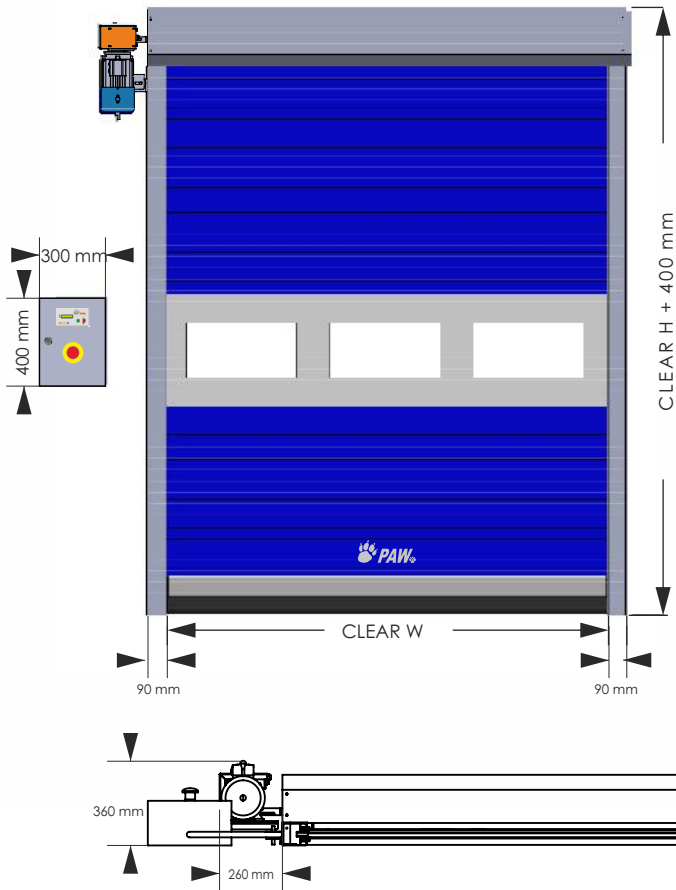

DOUBLE LEAF CURTAIN

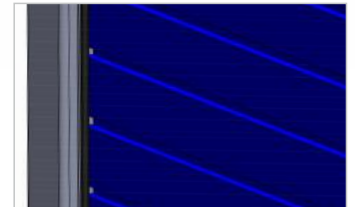

- Standard
- Optional
- X Not available

### SAFETY ROLL

#### SG-5

Maximum Size	4500 X 4500
Motor Power	0.75 / 1.5 kW
Motor Voltage	230 V. AC. 50 / 60 Hz
Control Panel	Ip 55 Lcd Screen
Speed Driver	0.75 / 1.5 kW
Opening Speed	0.70 m/sec. -1.30 m/sec.
Closing Speed	0.70 m/ sec.
Fuse Protection	16 A
PVC Thickness	900 gr X 2 nos.
PVC Heat Resistance	-30 + 70°C
Wind Resistance	Class 1/2
Carrier Rail System	Aluminum
Aluminum Bottom Bar	●
Stainless Steel Rail	○
Safety Edge System	○

Safety Photocell	● 1 Set
Anti-crash System	○
Rope Switch	○
Additional Photocell	○
Light Barrier	○
Interlock System	●
Radar	○
Loop Detector	○
Hand Sensor	○
Remote Control System	○
Additional Button	○
Warning Flasher	○
Traffic Light	○
Motor Cover	○
Front Cover	○
Manual Handle	●
Spring-Loaded Emergency Exit	○
Lamella Type	Polyurethane-filled

# Paw-Zipper

## Self Repairing Doors

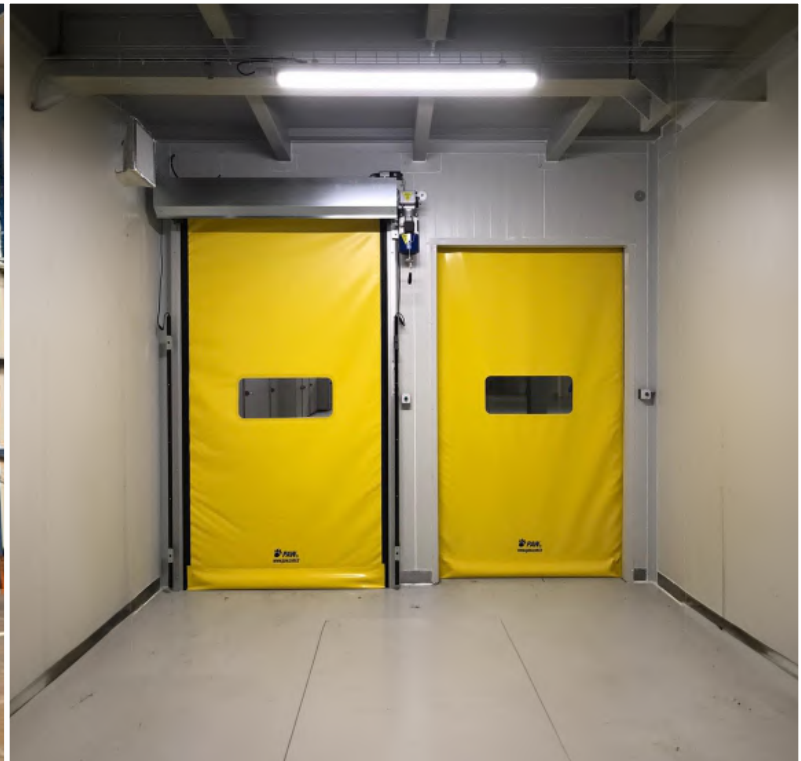

## PAW-ZF5

### SELF REPAIRING ZIPPER DOORS

Paw-Zipper's features, high-speed performance, self-repair capability, and aesthetic appearance make our product profitable and indispensable for your facility.

Paw-Zipper, with its unique columned zipper and flexible rail systems, disengages the curtain system from the track after an impact without requiring service. Automatically, the system winds up the curtain, places it back onto its special rail, and repairs itself without the need for manual intervention. This ensures uninterrupted traffic flow and production. Thanks to this feature, repair and maintenance costs are minimized.

Its robust zippered columns and special flexible rail systems provide maximum wind and pressure resistance. Paw-Zipper combines aesthetics and functionality, offering a reliable solution for your industrial facilities. Designed to ensure safety and continuity from every aspect, this product enhances the efficiency of your business while minimizing costs.



**"Always Ready: Security and Continuity with Paw-Zipper!"**



## PAW-ZE5



### ZIPPER EMERGENCY EXIT DOORS

Emergency exit doors are designed and presented for the fastest passage in case of any malfunction, power outage, or emergency.

In these situations, easy exit is facilitated by pressing the center of the door, thanks to its special design. Afterwards, the door is returned to its original position and continues to operate with the same performance.

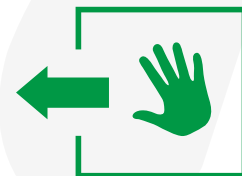

# Paw-Zipper

## Self Repairing Doors

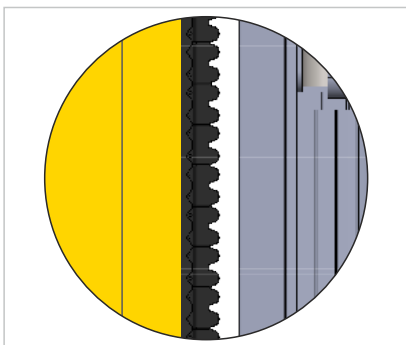
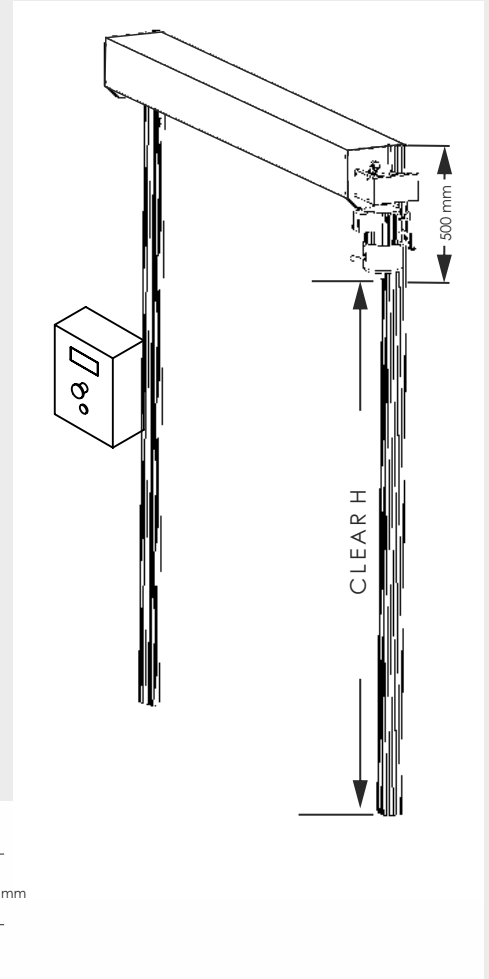
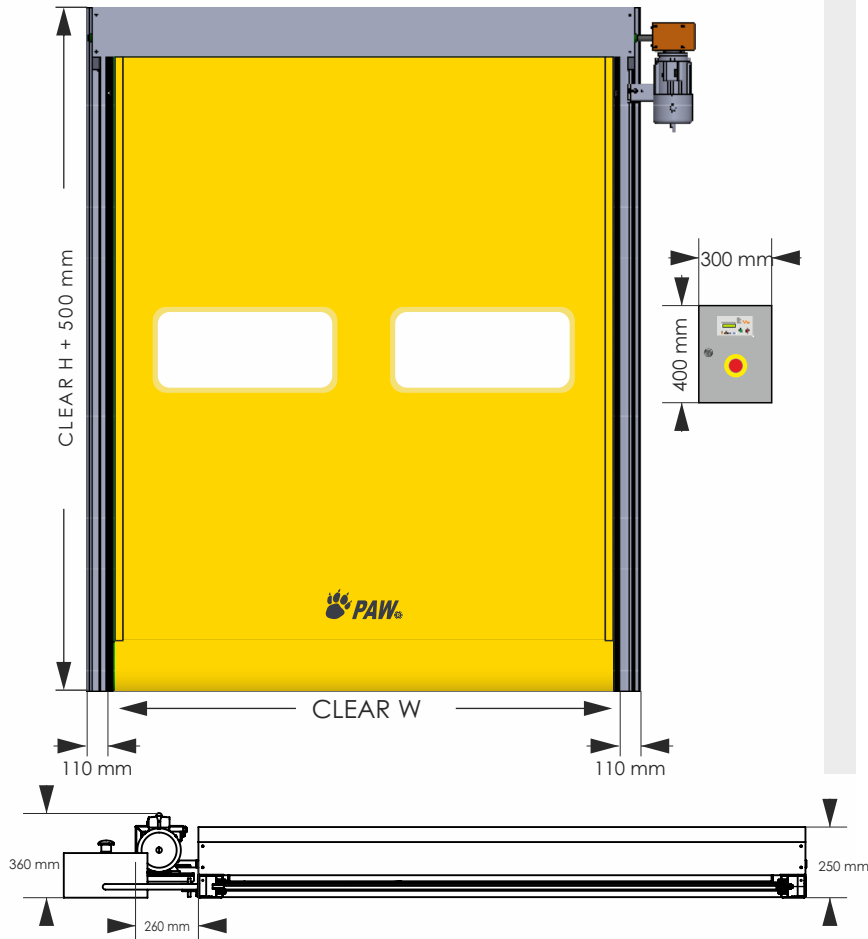

ZIP SYSTEM

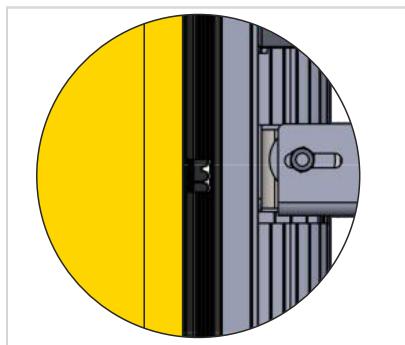

GUIDE SYSTEM

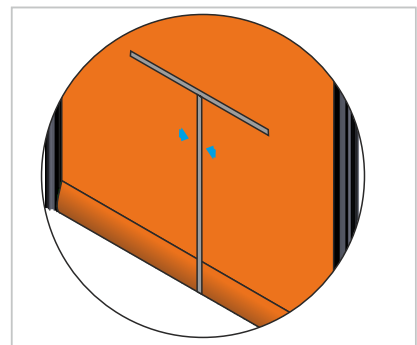

EMERGENCY EXIT SYSTEM

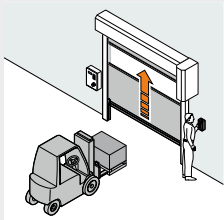

Hand Sensor

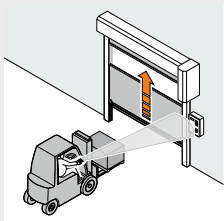

Remote Control

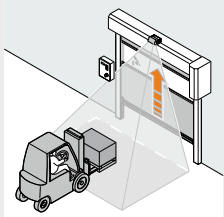

Radar

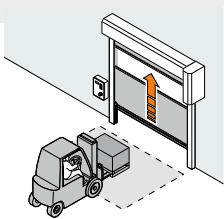

Loop

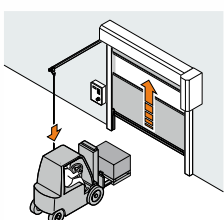

Rope Switch

- Standard
- Optional
- x Not available

	ZIPPER	
	ZF-1 / ZE-1	ZF-5 / ZE-5
Maximum Size	4500 x 4500 mm	4500 x 4500 mm
Motor Power	0.75 / 1.5 kW	0.75 / 1.5 kW
Motor Voltage	400 V. AC. 50 / 60 Hz	230 V. AC. 50 / 60 Hz
Control Panel	IP 65	IP 55 LCD Screen
Speed Driver	x	0.75 / 1.5 kW
Opening Speed	0.70 m / sec.	0.70 m/sn. -1.30 m/sec.
Closing Speed	0.70 m / sec.	0.70 m / sec.
Fuse Protection	16 A	16 A
PVC Thickness	900 gr	900 gr
PVC Heat Resistance	-30 + 70 °C	-30 + 70 °C
Wind Resistance	Class 1/2	Class 1/2
Carrier Rail System	Aluminum	Aluminum
Aluminum Bottom Bar	x	x
Stainless Steel Rail	○	○
Safety Edge System	○	○
Safety Photocell	● 1 Set	● 1 Set
Anti-crash System	○	○
Rope Switch	○	○
Additional Photocell	○	○
Light Barrier	○	○
Interlock System	●	●
Radar	○	○
Loop Detector	○	○
Hand Sensor	○	○
Remote Control System	○	○
Additional Button	○	○
Warning Flasher	○	○
Traffic Light	○	○
Motor Cover	●	●
Front Cover	●	●
Manual Handle	●	●
Spring-Loaded Emergency Exit	○	○

## PAW PVC CURTAIN COLORS



**MH 907**  
(RAL 9010)



**MH 168**  
(RAL 1018)



**MH 370**  
(RAL 3002)



**MH 221**  
(RAL 2008)



**MH 544**  
(RAL 5002)



**MH 679**  
(RAL 6005)



**MH 717**  
(RAL 7035)



**MH 782**  
(RAL 7016)

The mentioned PVC color codes are similar to RAL, and there might be tonal differences with RAL codes. The desired tarpaulin colors should be selected according to the tarpaulin codes. (Optional custom colors are available upon request.) PVC Thickness: 900 Gr/m<sup>2</sup>

## Paw-Izo Insulated Doors

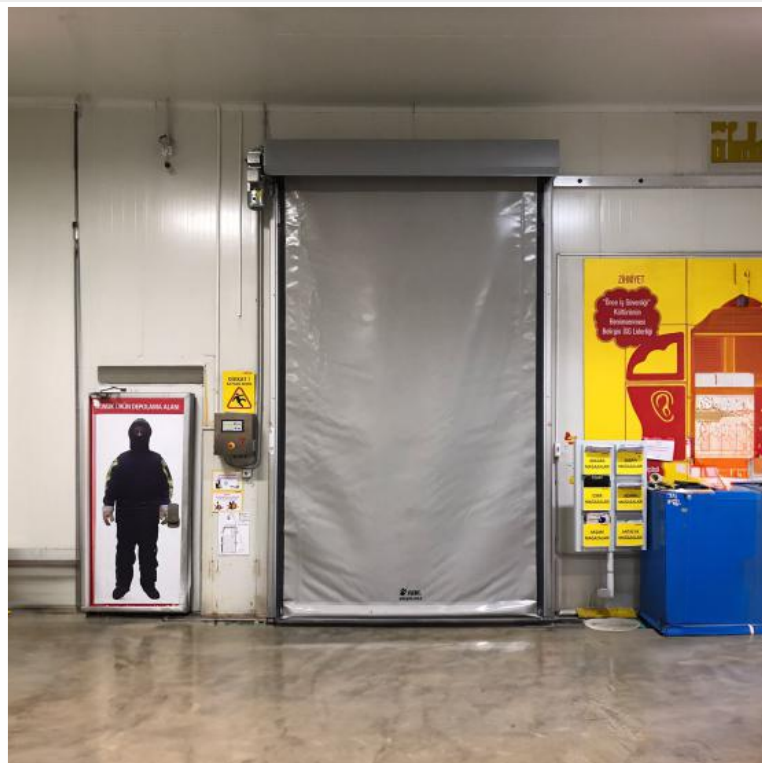
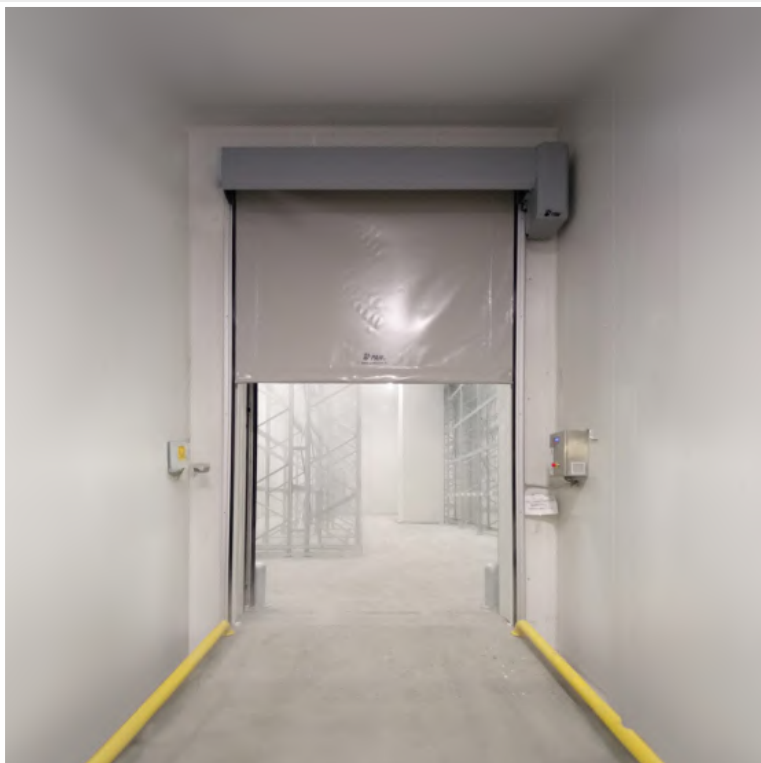

### PAW-I5

Paw-Izo high-speed doors provide maximum insulation in sections of the food, pharmaceutical, chemical, logistics, and other industries that require isolation. The insulated supporting and guiding channels ensure complete harmony with the internal and external movable curtain system. Insulated High-Speed Doors minimize heat loss in areas where sliding rigid doors, which can be cumbersome or left open due to user errors, are present by allowing quick passage in cold rooms.

Through the special fabric system, it maximizes heat and sound efficiency. Compatible with all types of automation systems based on workplace traffic flow, insulated fabric doors have special insulation features to ensure temperature control and energy efficiency. This feature is essential for maintaining indoor temperatures or achieving a specific temperature level.

Paw-Izo high-speed doors, with their special design, work quickly and intensively in areas of your facility that require low-pressure area control and sound insulation, minimizing unwanted losses. Thus, they eliminate issues of time waste and energy loss, offering many positive economic benefits.

Meeting your isolation, hygiene, and efficiency requirements in the control area, it helps your products be stored correctly for an extended period. With low maintenance requirements, our doors, made of easily cleanable materials and durable structures, can be used smoothly for many years.

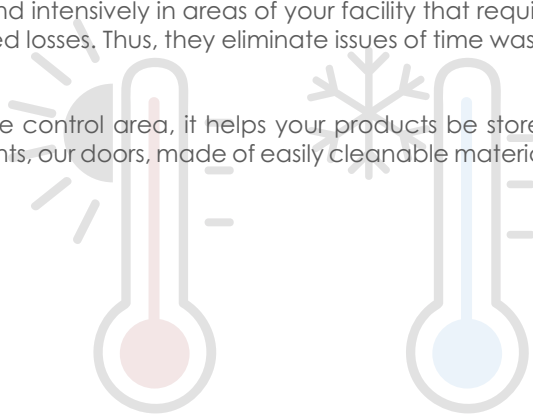





# Paw-Izo

## Insulated Doors

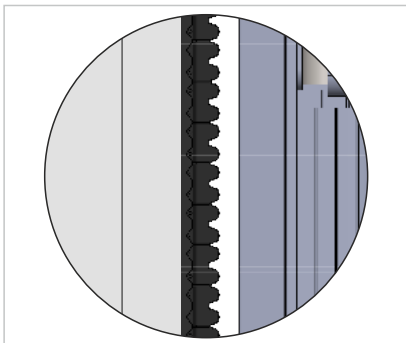
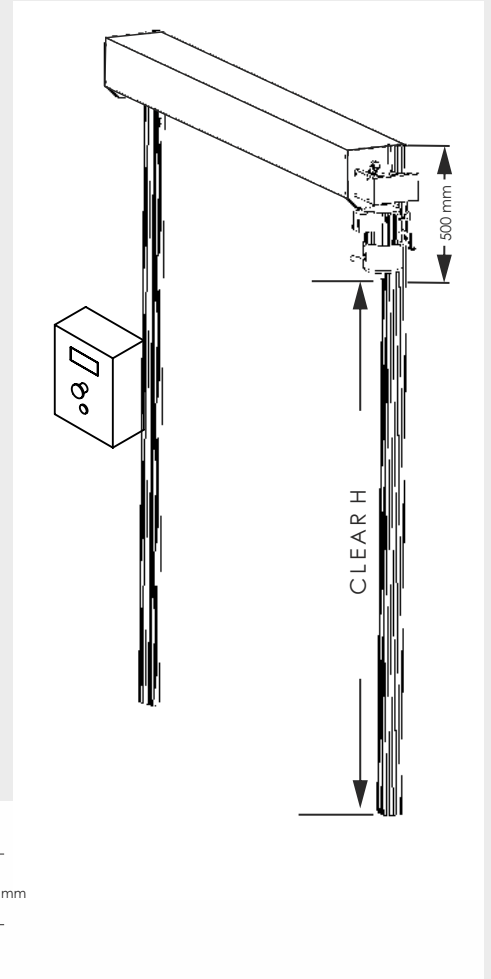
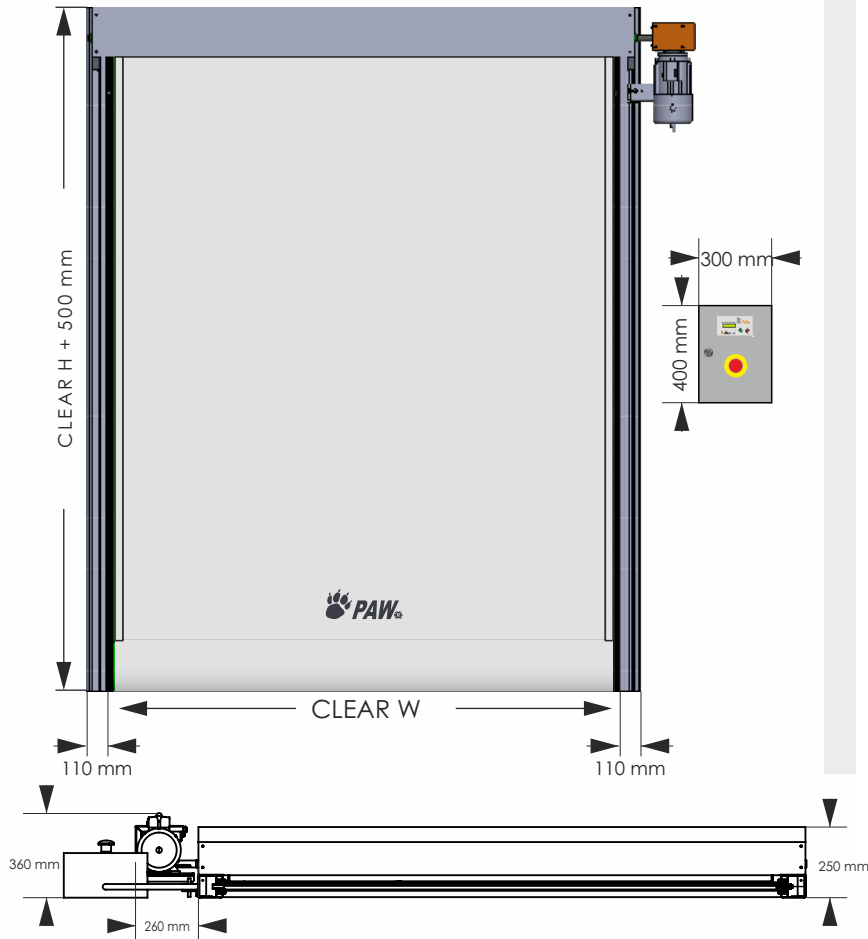

ZIPPER SYSTEM WITH SPECIAL GUIDE

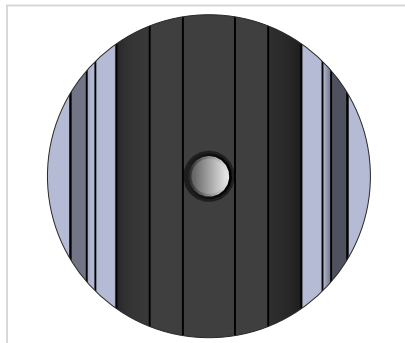

SAFETY BEAM



POLYFOAM  
INSULATED PVC

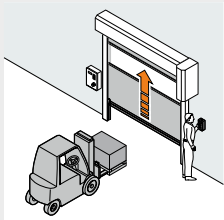

Hand Sensor

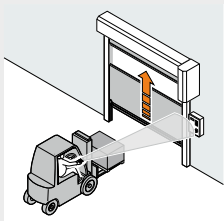

Remote Control

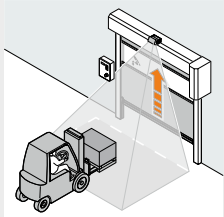

Radar

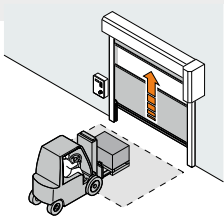

Loop

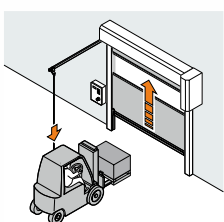

Rope Switch

- Standard
- Optional
- x Not available

	INSULATED	
	I-1	I-5
Maximum Size	4500 x 4500 mm	4500 x 4500 mm
Motor Power	0.75 / 1.5 kW	0.75 / 1.5 kW
Motor Voltage	400 V. AC. 50/60 Hz	230/400 V. AC. 50/60 Hz
Control Panel	IP 65 LCD Screen	IP 65 LCD Screen
Speed Driver	x	0.75 / 1.5 kW
Opening Speed	0.70 m/sec.	0.50 m/sec. - 1.30 m/sec.
Closing Speed	0.70 m / sec. ±	0.50 m / sec. ±
Fuse Protection	16 A	16 A
PVC Thickness	1300 gr	1300 gr
PVC Heat Resistance	-30 + 70°C	-30 + 70°C
Wind Resistance	Class 1/2	Class 1/2
Carrier Rail System	Powder Coated Galv.	Powder Coated Galv.
Manual Handle	●	●
Stainless Steel Rail	○	○
Reflected Safety Device	○	○
Safety Photocell	● 1 Set	● 1 Set
Anti-crash System	○	○
Rope Switch	○	○
Additional Photocell	○	○
Light Barrier	○	○
Interlock System	○	○
Radar	○	○
Loop Detector	○	○
Hand Sensor	○	○
Remote Control System	○	○
Additional Button	○	○
Warning Flasher	○	○
Traffic Light	○	○
Motor Cover	○	○
Front Cover	●	●
Spring-Loaded Emergency Exit	○	○
Aluminum Bottom Bar	x	x



**MH 717**  
(RAL 7035)

## PAW IZO CURTAIN COLOR

The mentioned PVCcolor codes are similar to RAL, and there might be tonal differences with RAL codes.

\*PVC Thickness: 1300 Gr/m<sup>2</sup>

## Paw-Eagle Self Repairing Doors

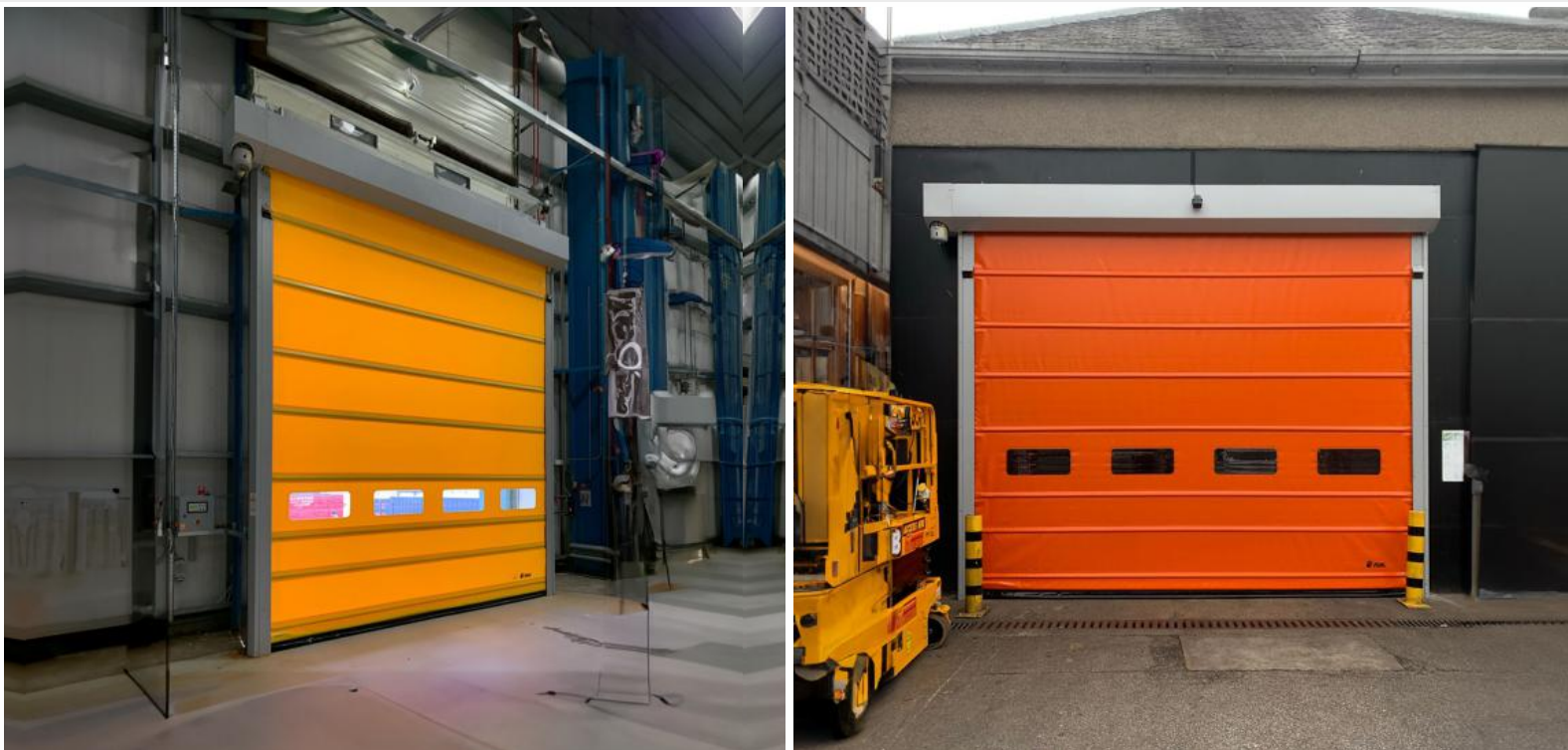

### PAW-E5

Paw-Eagle self-repairing doors are resistant to collisions and accidents that may occur in areas with heavy forklift and vehicle traffic.

Thanks to its special bars, in the event of any collision, it disengages from its position, reopens correctly, and continues its operation by entering the specially designed upright channels. **Traffic flow and production remain uninterrupted**, minimizing repair and maintenance costs.

The high-speed performance, self-repair capability, and aesthetic appearance of the Eagle Door make it a profitable and indispensable solution for your facility.

With its robust rails and special flexible wind profiles, it provides maximum wind and pressure resistance. Therefore, it is particularly preferred in areas where wind resistance is needed, especially in outdoor environments.

EZER, with its experience dating back to 1989 in the industry, manufactures doors tailored to the needs of its customers. It provides support to its customers from the selection process to fast after-sales service. It has succeeded in becoming a significant solution partner in the industrial door sector.

Colors, sizes, options, and features are produced according to customer requests, ensuring perfect compatibility for all types of industrial environments.

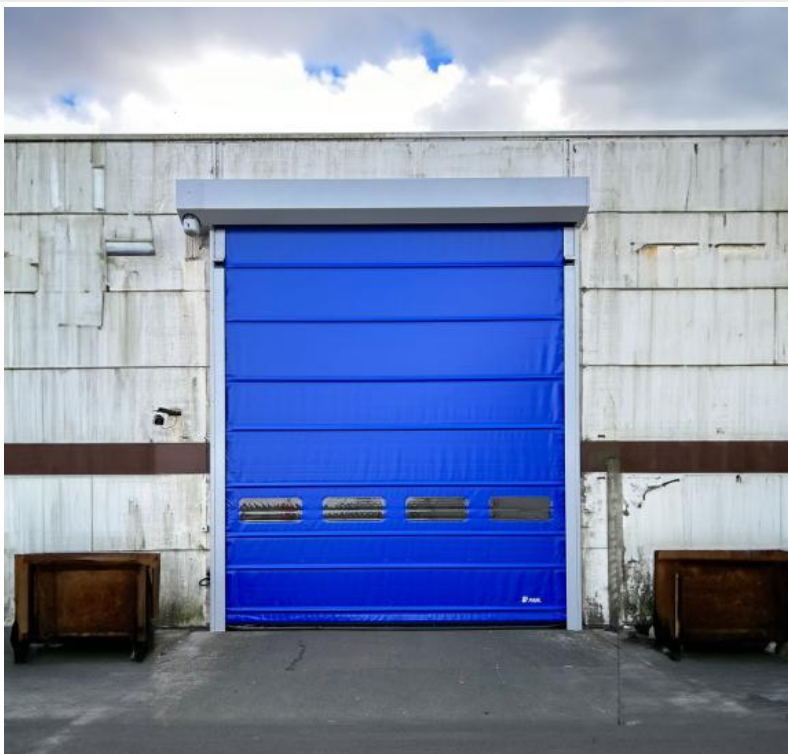

# Paw-Eagle

## Self Repairing Doors

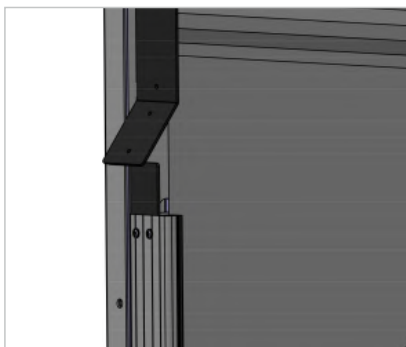
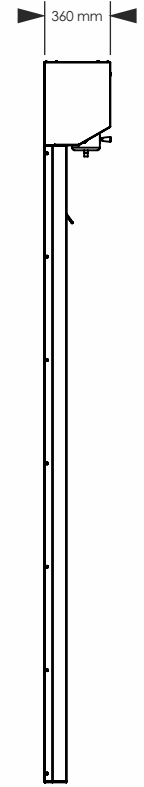
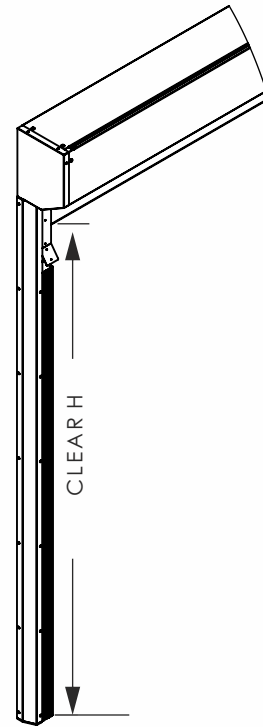
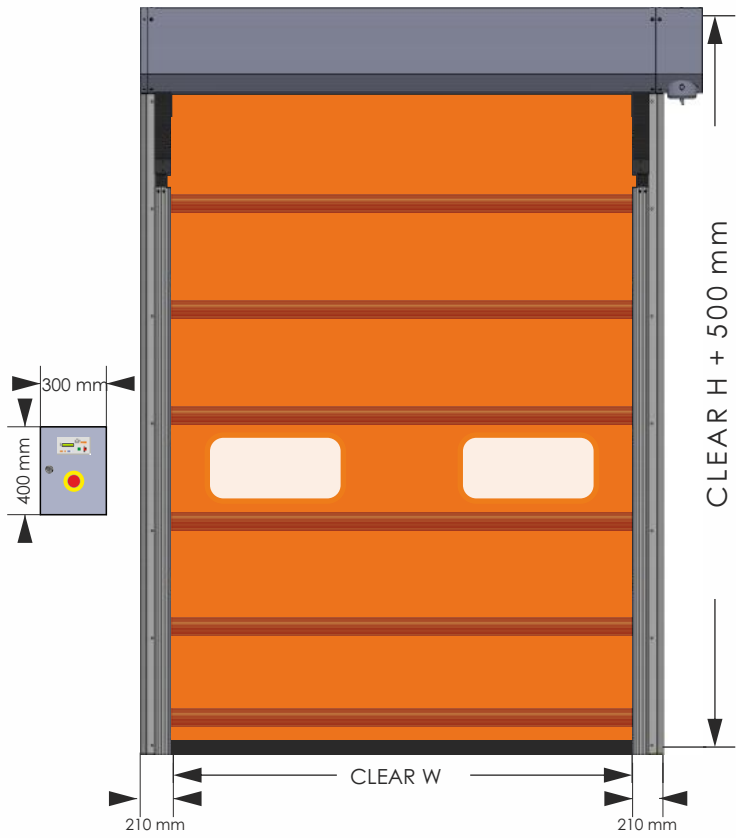

RE-FEEDING SYSTEM



SIDE GUIDE

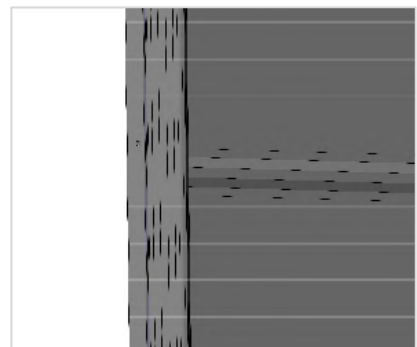

WIND PROFILE

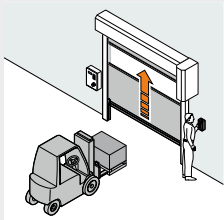

Hand Sensor

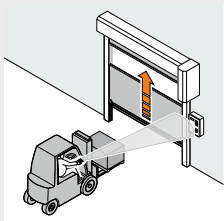

Remote Control

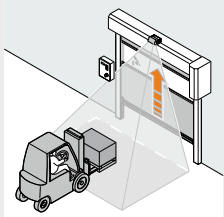

Radar

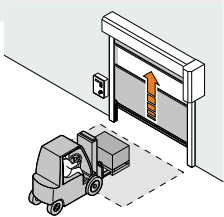

Loop

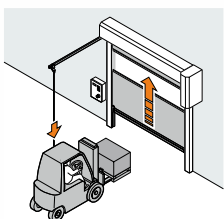

Rope Switch

- Standard
- Optional
- x Not available

## Eagle

### E-5

Maximum Size	5000 x 6000 mm
Motor Power	0.75 / 2.2 kW
Motor Voltage	230/400 V. AC. 50/60 Hz
Control Panel	IP 65 LCD Screen
Speed Driver	0.75 / 1.5 kW
Opening Speed	0.50 m/sec. -1.30 m/sec.
Closing Speed	0.50 m / sec. ±
Fuse Protection	16 A
PVC Thickness	900 gr / 1.700 gr
PVC Heat Resistance	-30 + 70°C
Wind Resistance	Class 1/2
Carrier Rail System	Powder Coated Galv.
Manual Handle	●
Stainless Steel Rail	x
Safety Edge System	○
Safety Photocell	● 1 Set
Anti-crash System	x
Rope Switch	○
Additional Photocell	○
Light Barrier	○
Interlock System	○
Radar	○
Loop Detector	○
Hand Sensor	○
Remote Control System	○
Additional Button	○
Warning Flasher	○
Traffic Light	○
Motor Cover	●
Front Cover	●

## PAW PVC CURTAIN COLORS



**MH 907**  
(RAL 9010)



**MH 168**  
(RAL 1018)



**MH 370**  
(RAL 3002)



**MH 221**  
(RAL 2008)



**MH 544**  
(RAL 5002)



**MH 679**  
(RAL 6005)



**MH 717**  
(RAL 7035)



**MH 782**  
(RAL 7016)

The mentioned PVCcolor codes are similar to RAL, and there might be tonal differences with RAL codes. The desired tarpaulin colors should be selected according to the tarpaulin codes. (Optional custom colors are available upon request.) PVC Thickness: 900 Gr/m<sup>2</sup>

## Paw-Flex Fold-Up Doors

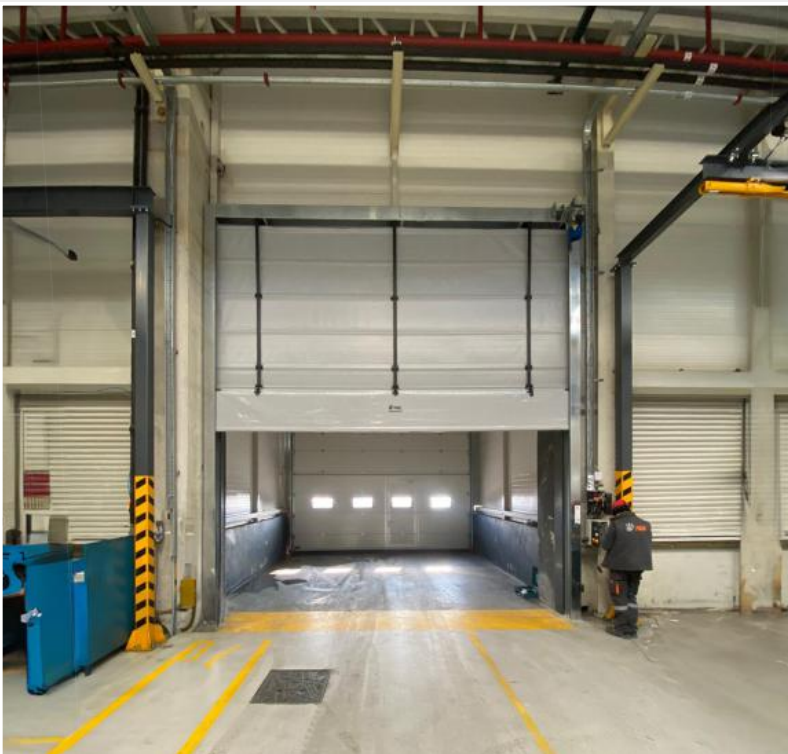

## PAW-K5

Foldable PVC high-speed doors, if your expectations from industrial doors in your facility include operating in heavy traffic, under challenging and variable weather conditions, opening and closing hundreds of times a day, reducing time waste, minimizing air currents, making your existing space more hygienic, and reducing visual and noise pollution, then your door should be the Paw-Flex industrial PVC foldable high-speed door.

Designed with strong wind profiles to maximize wind resistance, it also ensures durability and long-lasting use.

The body structure of the product is made of galvanized steel, and stainless steel and painted versions are also available as optional.

Paw-Flex folding PVC high-speed doors are fast door solutions that can easily meet the intense entry and exit needs in industrial workspaces.

These doors not only isolate air currents but also isolate dust, moisture, visual, and noise pollution, making them indispensable solutions that make working environments more livable.

**Paw-Flex Folding Doors provide top-level protection  
against the challenging force of the wind!**



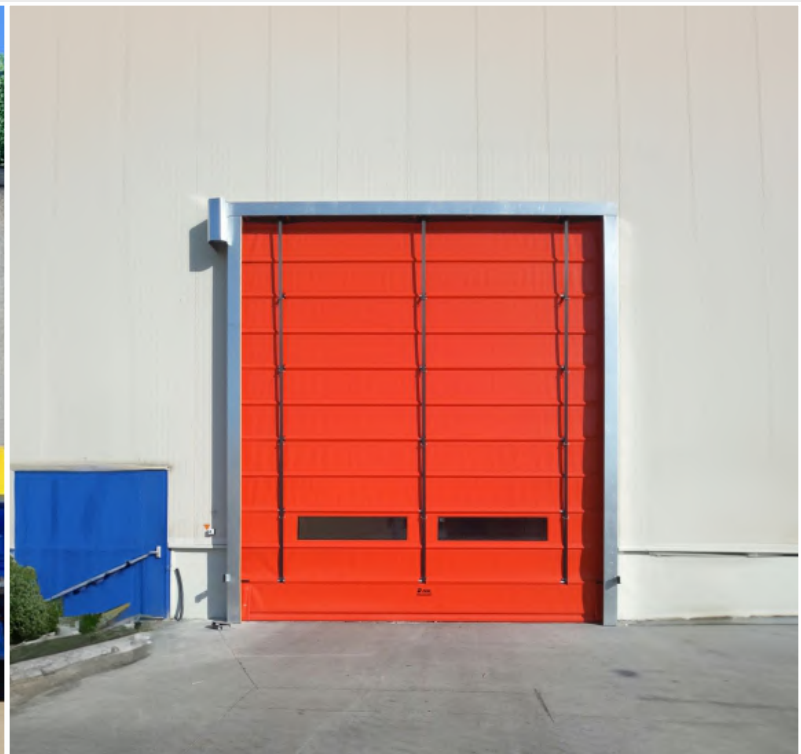

# Paw-Flex Fold-Up Doors

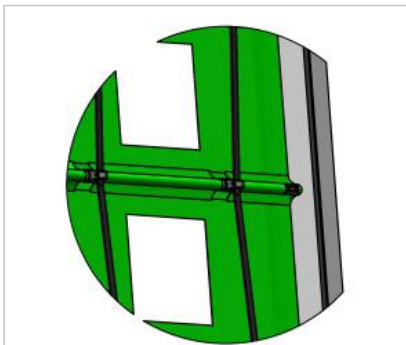
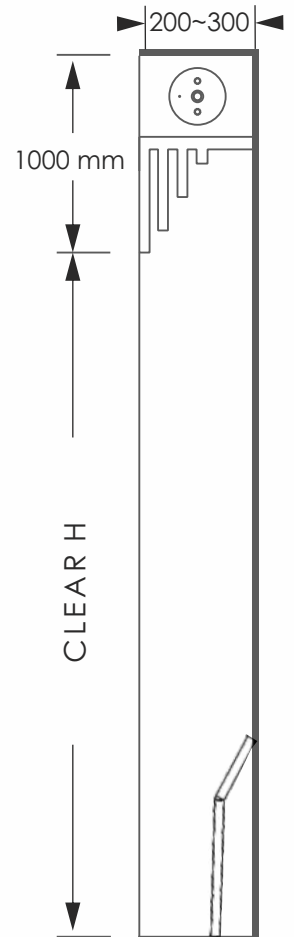
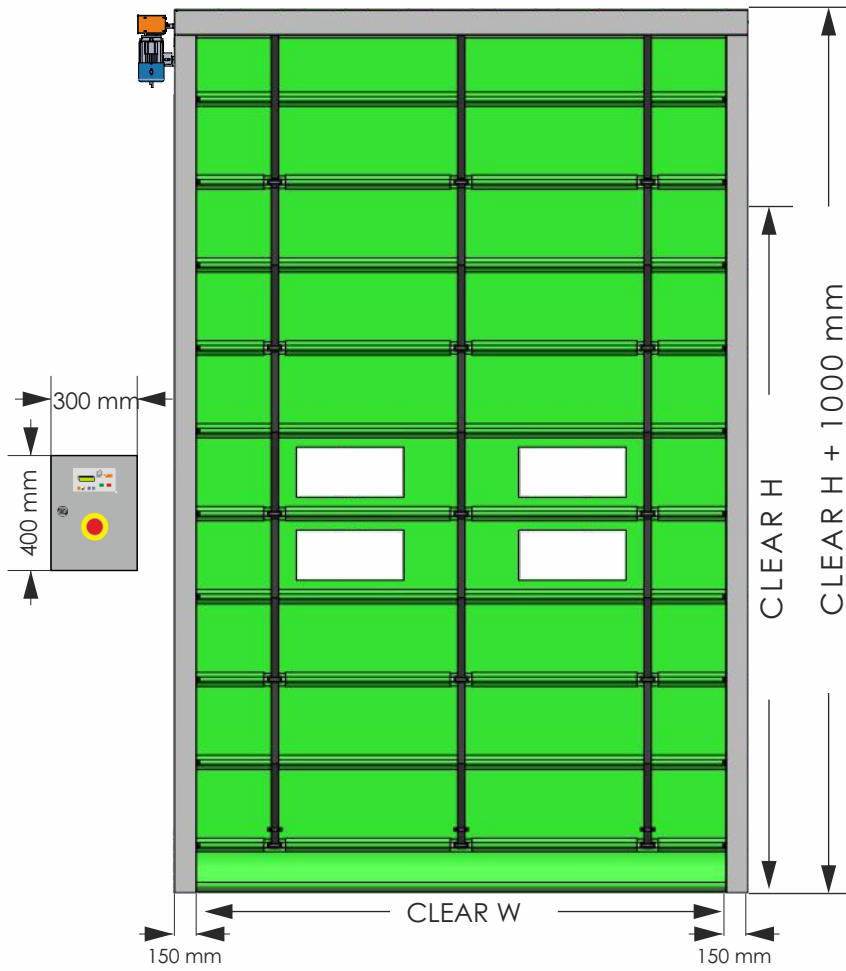

PROTECTION BUMPERS

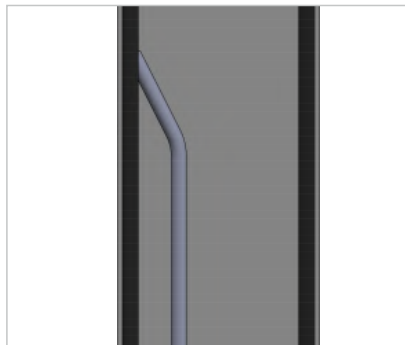

WIND STOPPER

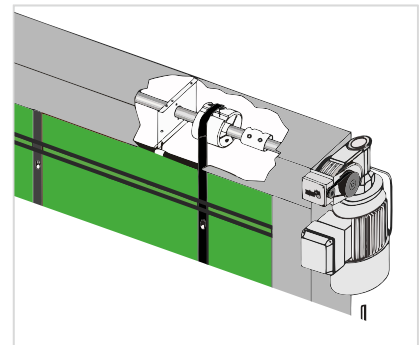

DRUM SYSTEM

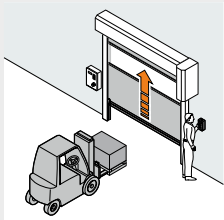

Hand Sensor

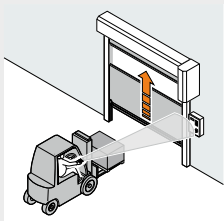

Remote Control

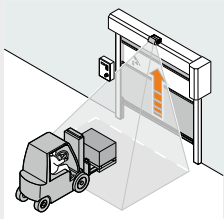

Radar

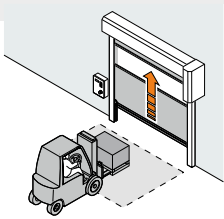

Loop

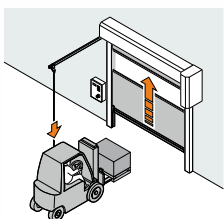

Rope Switch

- Standard
- Optional
- X Not available

	FOLD-UP	
	K-1	K-5
Maximum Size	7.000 x 7.000 mm	7.000 x 7.000 mm
Motor Power	0.75 / 3.0 kW	0.75 / 3.0 kW
Motor Voltage	400 V. AC. 50 / 60 Hz	230 / 400 V. AC. 50 / 60 Hz
Control Panel	IP 65	IP 55 LCD Screen
Speed Driver	-	0.75 / 1.5 kW
Opening Speed	0.70 m / sec.	0.50 m/sn. -1.30 m/sec.
Closing Speed	0.70 m / sec.	0.50 m / sec.
Fuse Protection	16 A	16 A
PVC Thickness	900 gr	900 gr
PVC Heat Resistance	-30 + 70 °C	-30 + 70 °C
Wind Resistance	Class 3/4	Class 3/4
Carrier Rail System	Galvanized	Galvanized
Stainless Steel Rail	○	○
Safety Edge System	○	○
Safety Photocell	● 1 Set	● 1 Set
Anti-crash System	○	○
Rope Switch	○	○
Loop Detector	○	○
Additional Photocell	○	○
Light Barrier	○	○
Interlock System	○	○
Radar	○	○
Hand Sensor	○	○
Remote Control System	○	○
Additional Button	○	○
Warning Flasher	○	○
Traffic Light	○	○
Motor Cover	○	○
Front Cover	X	X
Manual Handle	●	●
Spring-Loaded Emergency Exit	○	○

## PAW PVC CURTAIN COLORS



**MH 907**  
(RAL 9010)



**MH 168**  
(RAL 1018)



**MH 370**  
(RAL 3002)



**MH 221**  
(RAL 2008)



**MH 544**  
(RAL 5002)



**MH 679**  
(RAL 6005)



**MH 717**  
(RAL 7035)



**MH 782**  
(RAL 7016)

The mentioned PVC color codes are similar to RAL, and there might be tonal differences with RAL codes. The desired tarpaulin colors should be selected according to the tarpaulin codes. (Optional custom colors are available upon request.) PVC Thickness: 900 Gr/m<sup>2</sup>



# Hangar Doors

 Paw-Maxi Hangar Doors

 Paw-Power XL Hangar Doors



# Paw-Maxi

## Maxi Hangar Doors



## PAW-MAXI

Our hangar doors, revolutionizing the aviation, shipbuilding, and industrial sectors, are specially designed to meet the needs of wide openings and high-security requirements.

Thanks to Paw-Maxi's special extruded aluminum rails, the door not only guides the body up and down but also minimizes the entry of air currents into the usage area. Hangar doors consist of double-walled fabric and provide high wind resistance with a reinforced body structure. The control panel is fully compliant with IP 65 standards.

The most notable features of the door system require minimal space at the installation locations and maximize the use of your door passage area.

Our various models offer a perfect fit to meet the unique requirements of your hangar. Designed to contribute to the growth of your business, hangar doors combine high technology and durability.

Excellent design and the use of durable materials are standout features of our hangar doors. Their weather-resistant structures ensure long-lasting performance and low maintenance costs.

Our models come in different sizes and specifications, designed to meet a wide range of needs from large commercial hangars accommodating extensive aircraft fleets to small private aviation facilities.

The automatic control systems and smart sensor technology integrated into our hangar doors are designed to maximize security and operational efficiency.





# Paw-Maxi

## Maxi Hangar Doors

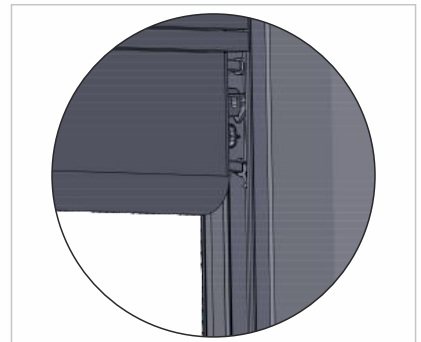
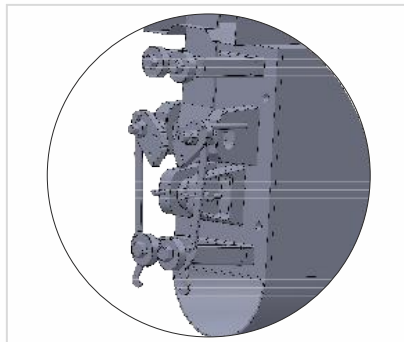
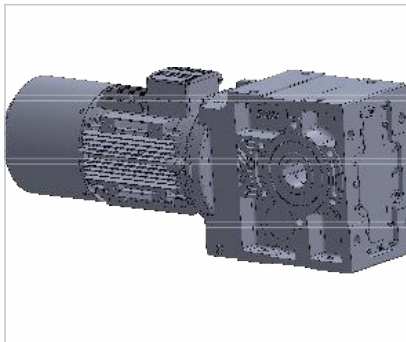
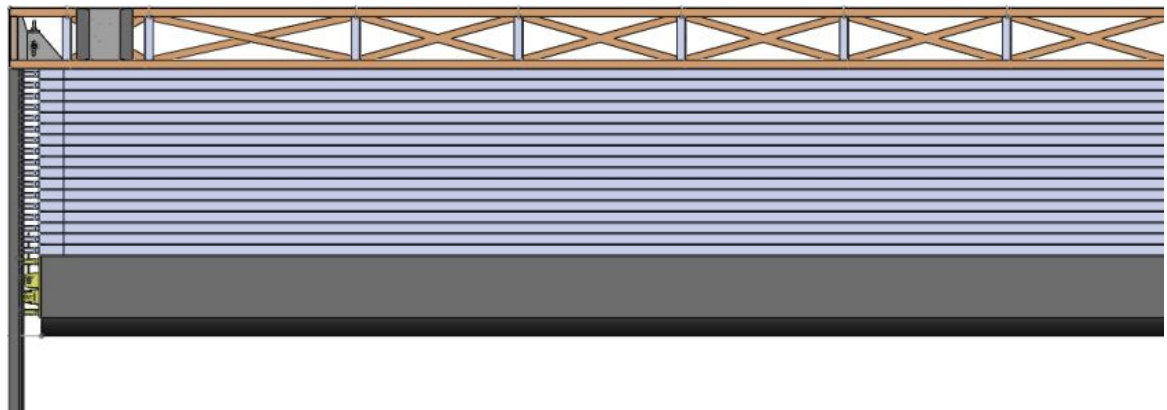
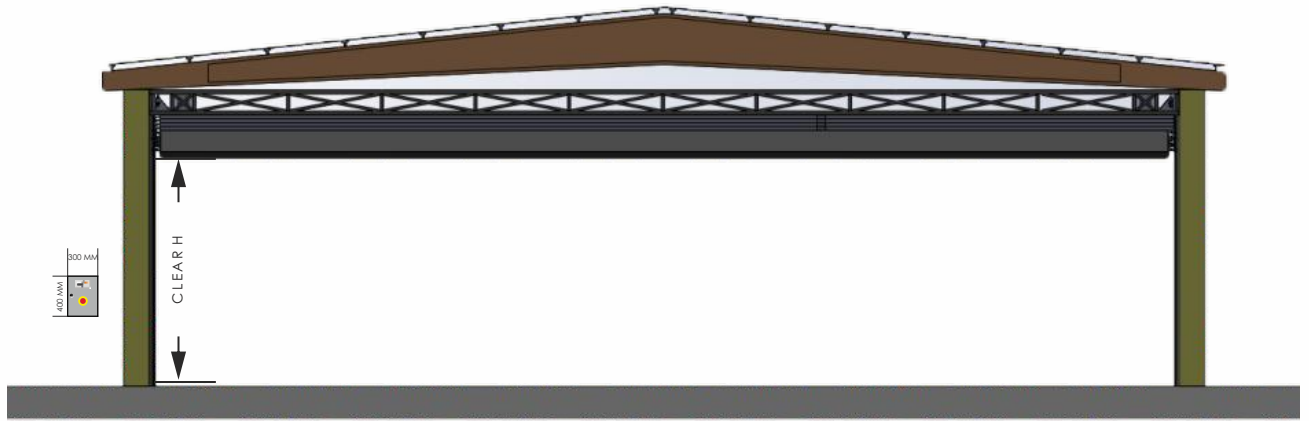



# Technical Specifications

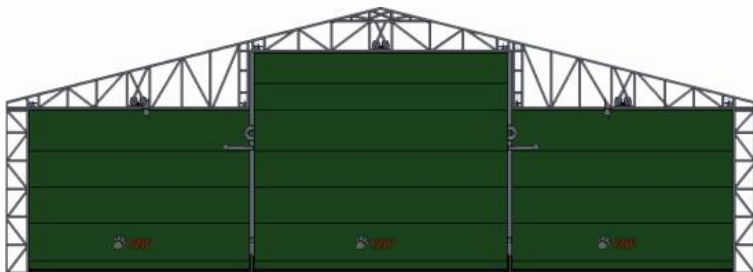
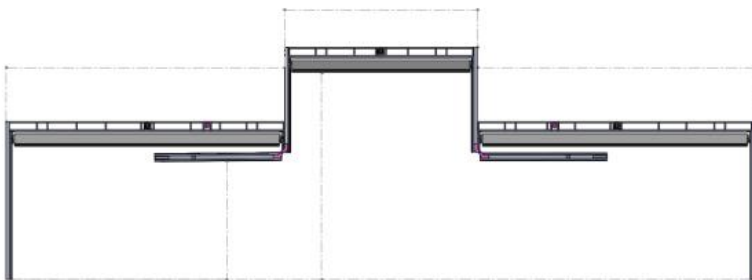
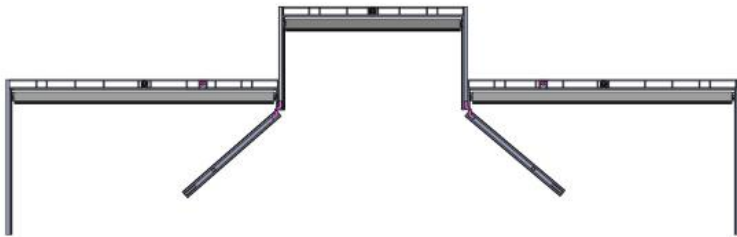

- Standard
- Optional
- X Not available

## MAXI

Maximum Size	20.000 x 20.000 mm ±
Motor Power	2.2 / 5.5 kW
Motor Voltage	400 V. AC. 50 / 60 Hz
Control Panel	IP 55/65
Speed Driver	●
Opening Speed	0.15 m / sn. -0.35 m/sec.
Closing Speed	0.15 m / sn. -0.35 m/sec.
Fuse Protection	32 A
PVC Thickness	0.9 / (● 1.7) mm
PVC Heat Resistance	-30 + 70 °C
Wind Resistance	Class 2/3
Carrier Rail System	Aluminum
Aluminum Bottom Bar	X
Stainless Steel Rail	○
Safety Edge System	X
Safety Photocell	○
Anti-crash System	X
Rope Switch	X
Additional Photocell	○
Light Barrier	X
Interlock System	X
Radar	X
Loop Detector	X
Hand Sensor	X
Remote Control System	X
Additional Button	○
Warning Flasher	○
Traffic Light	○
Motor Cover	○
Front Cover	X
Manual Handle	○
Spring-Loaded Emergency Exit	X

### PAW PVC CURTAIN COLORS



The mentioned PVC color codes are similar to RAL, and there might be tonal differences with RAL codes. The desired tarpaulin colors should be selected according to the tarpaulin codes. (Optional custom colors are available upon request.) PVC Thickness: 900 Gr/m²

## Paw-Power

# Power XL Hangar Doors



## PAW-POWER

Paw-Power XL doors are specially designed to withstand challenging conditions such as mud, dirt, dust, moisture, abrasive materials, high wind loads, and extreme temperatures. With high-performance adaptability to any industrial environment, they are used in manufacturing facilities, aircraft hangars, shipyards, and recycling plants.

These doors feature a robust and reliable structure, providing long-term durability for maximum security and efficient access to your facilities.

Designed specifically for large and medium-sized openings and intensive use, these doors are virtually limitless in configuration possibilities.

Power Doors are developed with a focus on tight sealing, ensuring a secure seal even in the most demanding environments. The combination of few moving parts and corrosion-resistant fabric makes this product an ideal solution, particularly for challenging mining applications.

Constructed with special extruded aluminum wind bars and double-layered fabric, these doors offer enhanced resistance to wind with a reinforced body structure. The control panel is fully compliant with IP 65 standards.

The most prominent features of the door system are that it requires minimal space at the installation locations and provides the opportunity to maximize the use of your door passage area.

**Challenging the power of the wind, we bring together high insulation and comfort!**





# Paw-Power

## Power XL Hangar Doors

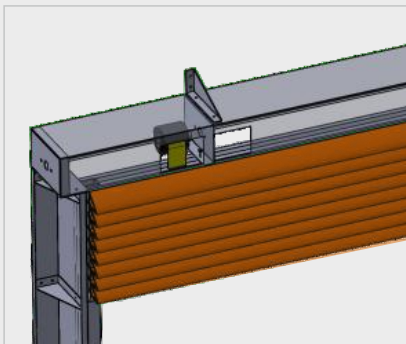
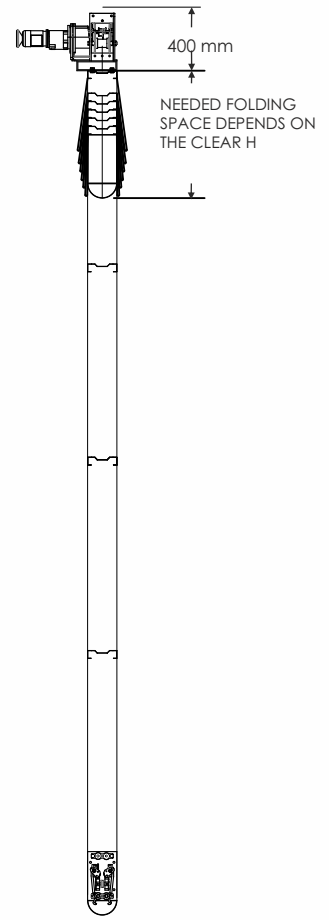
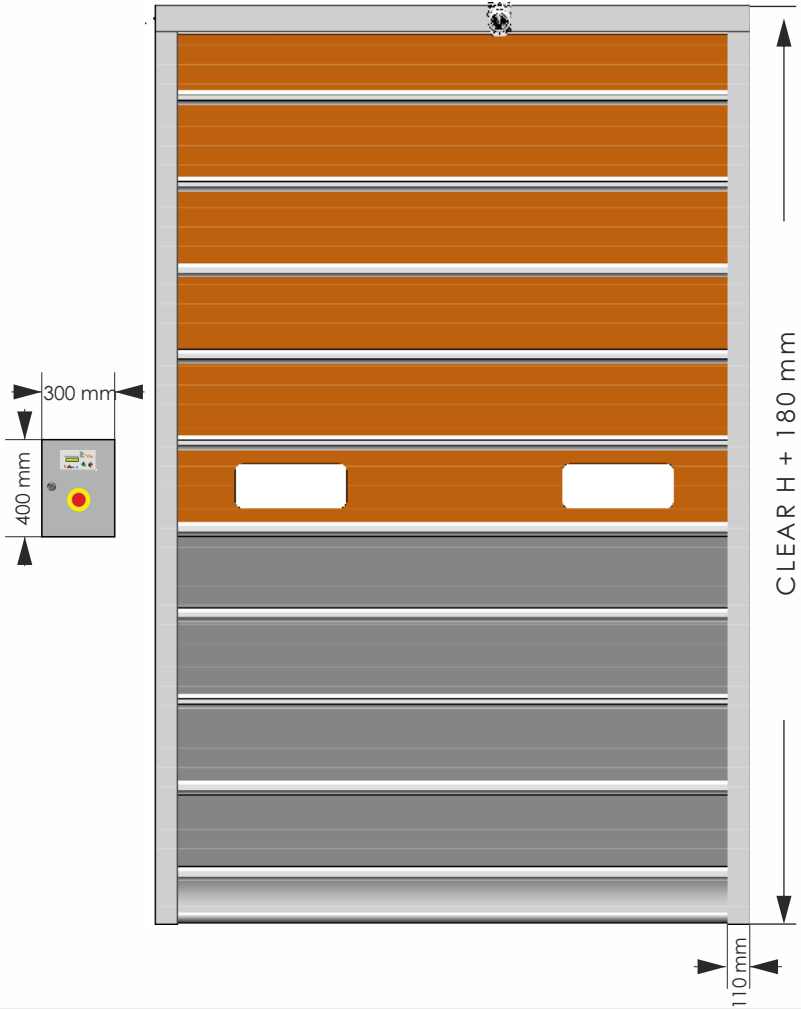

ROPE SYSTEM

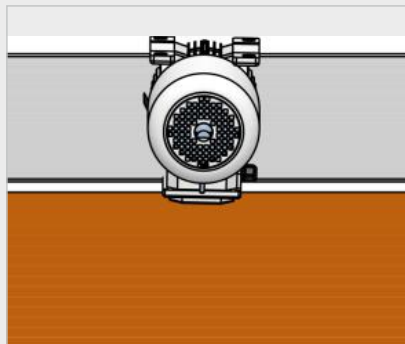

PAW MOTOR SYSTEM

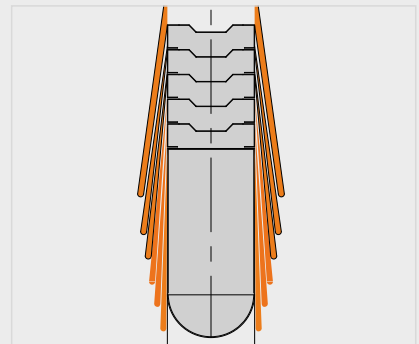

DOUBLE LEAF SYSTEM

# Technical Specifications

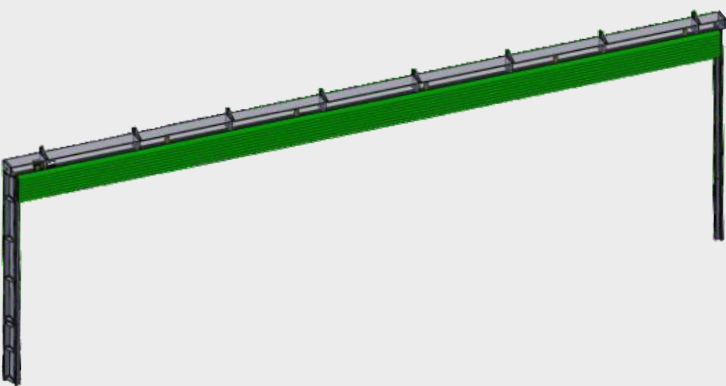
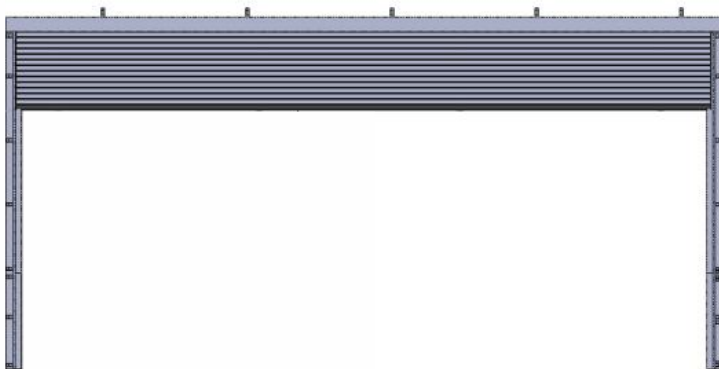
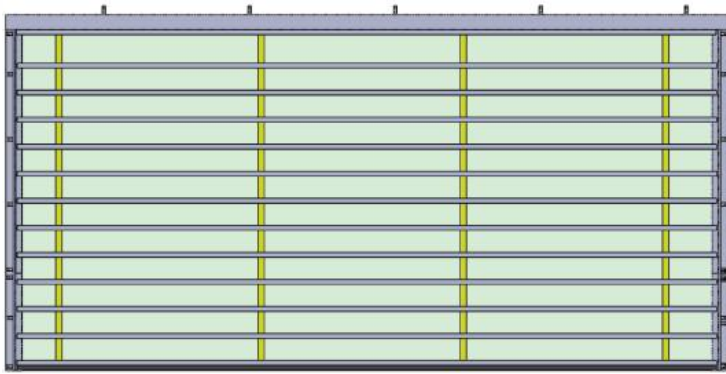

- Standard
- Optional
- X Not available

## POWER

Maximum Size	15.000 x 20.000 mm
Motor Power	1.5 / 5.5 kW
Motor Voltage	400 V. AC. 50 / 60 Hz
Control Panel	IP 55/65
Speed Driver	●
Opening Speed	0.15 m / sn. -0.35 m/sn.
Closing Speed	0.15 m / sn. -0.35 m/sn.
Fuse Protection	32 A
PVC Thickness	0.9 / (● 1.7) mm
PVC Heat Resistance	-30 + 70 °C
Wind Resistance	Class 1/3
Carrier Rail System	Galvanized
Aluminum Bottom Bar	X
Stainless Steel Rail	○
Safety Edge System	X
Safety Photocell	○
Anti-crash System	X
Rope Switch	X
Additional Photocell	○
Light Barrier	○
Interlock System	X
Radar	X
Loop Detector	○
Hand Sensor	○
Remote Control System	○
Additional Button	○
Warning Flasher	○
Traffic Light	○
Motor Cover	○
Front Cover	X
Manual Handle	○
Spring-Loaded Emergency Exit	X



## PAW PVC CURTAIN COLORS





The mentioned PVC color codes are similar to RAL, and there might be tonal differences with RAL codes. The desired tarpaulin colors should be selected according to the tarpaulin codes. (Optional custom colors are available upon request.) PVC Thickness: 900 Gr/m²





## Industrial Doors

-  Sectional Doors
-  Full-Vision Doors

## Loading Systems

-  Dock Levelers
-  Dock Shelters

## Hangar Doors

-  Emergency Exit Doors
-  Roll-Up Fire Shutters

# Paw-Panel

## Sectional Doors



## PAW-PANEL

Sectional industrial doors are durable and long-lasting doors used to facilitate circulation at the entrances, exits, loading, and unloading points of factory or warehouse buildings.

The 40 mm sandwich panels forming the body of the sectional door provide sound and thermal insulation in the applied space, thanks to the dense insulation-enhanced polyurethane injected between galvanized steel sheets (48-50 kg/m<sup>3</sup>).

Among sectional door models, industrial doors are the most preferred for their high-level insulation and emphasis on safety. They can be used as normal installation, high installation, or vertical installation according to the beam section of the application area. Sectional industrial door systems, when applied together with level-adjustable ramps and truck body compressing PVC bellows, enable smooth and safe loading and unloading in businesses. Industrial door systems, sliding parallel to the ceiling, save space in the facility, and the door opening can be fully utilized. Industrial door systems can be manufactured according to the passage width and height in factories, warehouses, or buildings. The sectional industrial door, sliding within the side guides, works by making the most efficient use of the gap between the ceiling height and the top cot of the door. The door can be mounted in different ways depending on the distance of this gap. (It can be applied with standard, low, high, and guillotine bedding options.) Sectional door systems with standard white-colored panels (RAL 9002 inside and outside) can also be applied in different RAL colors suitable for the building's external facade. Additionally, depending on the details of the area of application, different bedding methods can be used.

Sectional doors, playing an effective role in vehicle and pedestrian traffic, can be applied as standard push-button, chain manual pull type, or remote-controlled. Sectional industrial doors can be easily opened manually using the 380 V-AC/50 Hz electric motor installed or the torsion spring system (manual winding spring) that handles the door weight. The door weight does not affect the user. The springs are manufactured as standard with a durability of 15,000 movements. Optionally, longer-lasting springs can be used.





## Paw-Full Vision Sectional Doors



## PAW-FULL VISION

Full View doors are among the most preferred models among sectional door types, emphasizing the aesthetics of your structures. These doors can be used as normal, high, or vertical bedding depending on the area to be applied. Profile thicknesses vary according to the sections used and are specially designed to be compatible with each other. Typically, 3 mm Plexiglas glasses are used, but optionally, a double-glass model with insulated glass can also be preferred.

Different structures can apply tempered or laminated glass options for our doors to achieve maximum compatibility. Panels that make up Full View doors are made of 500 mm - 610 mm finger-protected aluminum profiles. The standard color is usually a natural anodized coating, but it can also be applied in different RAL colors according to the external facade color or as desired.

These doors can be applied with standard control unit and remote control. Thanks to the opto laser and wireless pneumatic bottom safety system, the door automatically opens when it comes into contact with any object.

Sectional Full View door panels are connected to each other with hinges made of galvanized steel. The wheel sets that provide the movement of the door on the rails are made of noise-reducing polyamide to ensure quiet operation. The door panels are pulled by winding steel cables on various drums depending on the size and bedding type of the door.

In case of cable breakage, spring breakage, or damage, there are safety systems such as cable breakage safety and spring breakage safety to prevent the door from falling.

Sectional Full View doors are durable and long-lasting doors designed to provide fast and safe passage, especially in modern businesses where aesthetics are important, such as automotive sales offices and factory entrances and exits.



Full View sectional doors can be manually lifted regardless of the weight of the door, thanks to the torsion spring system. In the event of a power outage or motor failure, the door can be easily operated manually or with a chain.

# Paw-Panel & Full Vision Sectional Doors



STANDARD LIFTING



INCLINED HIGH LIFTING



CABLE BRAKE DEVICE



WINDOW



PEDESTRIAN DOOR

## PAW PANEL STANDARD COLORS



RAL 7016  
Anthracite  
Grey



RAL 9002  
White



RAL 5010  
Blue



RAL 9006  
Grey



RAL 3000  
Red

"Mentioned color codes are similar to RAL. There might be tonal differences with RAL codes. The desired panel color should be selected according to the panel color codes. (Optional custom colors are available upon request.)"



HIGH LIFTING



VERTICAL LIFTING

- Standard
- ◐ Optional
- ✕ Not available

	PAW PANEL	FULL VISION
Panel Thickness	40 mm	40 mm
Sealing Gasket	●	●
Panel Thermal Transmittance Coefficient	0.50 w/m <sup>2</sup>	0.50 w/m <sup>2</sup>
Polyurethane Foam Density	50 kg/m <sup>3</sup>	✕
Polyurethane Thermal Conductivity	9.97 °C	9.97 °C
Wind Resistance	EN 12424 - CLASS 3	EN 12424 - CLASS 3
Water Tightness Value	EN 12425 - CLASS 3	EN 12425 - CLASS 3
Air Permeability	EN 12426 - CLASS 2	EN 12426 - CLASS 2
Finger Pinch Protection	●	●
Panel Weight	11 kg/m <sup>2</sup>	11 kg/m <sup>2</sup>
Spring Life	15.000 ● /100.000 ◐	15.000 ● /100.000 ◐
Rope Break Safety System	●	●
Exterior Sealing Gasket	●	●
Window	◐	◐
Pedestrian Door	◐	◐
Pneumatic	●	●
Control Panel	IP 55	IP 55
Light Barrier	◐	◐
Interlock System	◐	◐
Radar	◐	◐
Loop Detector	◐	◐
Hand Sensor	◐	◐
Remote Control System	◐	◐
Additional Button	◐	◐
Warning Flasher	◐	◐
Traffic Light	◐	◐

# Paw-Pass

## Dock Levelers

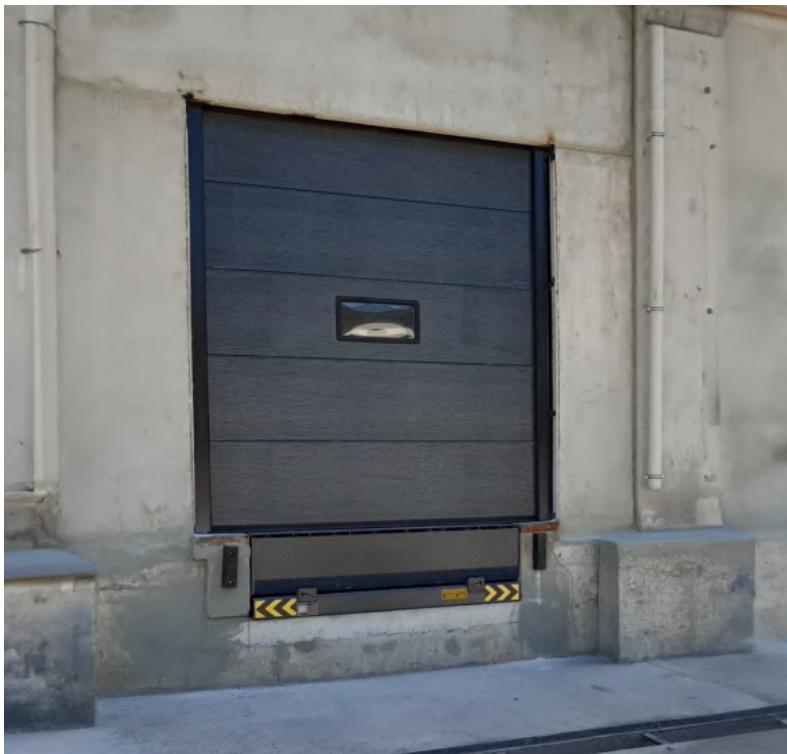





## PAW-PASS

### HINGED DOCK LEVELER

Paw-Pass Hinged Tongue Hydraulic Levelers are designed to eliminate differences and gaps between the ground and the vehicle at loading, unloading, and shipping points. Paw-Pass Hydraulic Levelers are carefully calculated to respond to heavy usage with powerful carrying capacities.

The Front Flap opens at a 90-degree angle to descend onto the vehicle trailer. In hinged tongue ramps, the standard tongue length is 400 mm and can optionally be 500 mm. Hydraulic folding hinged tongue loading ramps provide a robust folding tongue support with tempered plates.

All impact forces are optimally absorbed, avoiding damage and ensuring the longevity of the products. Another notable feature is its open-hinged tongue design, which requires low maintenance, guaranteeing the smooth operation of the products.

-  **It shortens the loading time, increasing operational efficiency.**
-  **It provides compatibility with every vehicle during loading and unloading with its high range of motion.**
-  **Thanks to its tear-patterned sheet, it prevents the forklift from slipping.**
-  **Due to its structure, it automatically adjusts its level according to the vehicle height.**



### TELESCOPIC LEVELER

Telescopic leveler is a space-saving solution embedded in concrete, designed with hydraulic equipment for versatility, and particularly suitable for situations where the hinged ramps fall short, especially in container loading scenarios.

The hydraulic leveling adjusters are meticulously designed to handle heavy loads, catering to very intensive usage.

Periodic maintenance procedures can be easily and quickly performed to ensure functionality.

The ability to stop at any desired position ensures safe usage.



**The hydraulic ramp with a thickness of 12/13 mm, manufactured in sizes ranging from 600 mm to 1000 mm, provides a complete solution for container loading.**

### VERTICAL LEVELER

Hinged Vertical leveler systems, whether manually or motorized, provide an ergonomic, economical, and reliable solution for loading ramps.

Serving as a bridge between your facility and the truck bed, Hinged Vertical loading ramps offer ease of use and zero energy cost in the case of manual systems.

Optionally, the manual ramp system can be upgraded with a motor system to enhance ease of use.

-  **Does not require additional construction work.**
-  **The most suitable model for two-story businesses.**
-  **When not in use, it goes into an upright position, minimizing space occupation.**

# Paw-Pass

## Dock Levelers

### HINGED LEVELER

Leveler Dimensions	2000 mm x 2500 mm x 600 mm
Pit Dimensions for the leveler	2040 mm x 2520 mm x 600 mm
Maximum Lifting Height	+ 650 mm
Minimum Lowering Height	- 300 mm
Motor Power	1.1 kW
Maximum Carrying Capacity	Dynamic: 600 kg, Static: 9000kg
Operating Temperature	- 10°C; +40°C
Control Panel Safety Class	Ip55
Leveler Color	RAL 5017
Platform Material	6/8 mm tear patterned steel
Tongue Material	12/14 mm tear patterned steel
Motor Voltage	380 V 50 Hz
Telescopic Tongue Length	-

### TELESCOPIC LEVELER

Leveler Dimensions	2000 mm x 2500 mm x 600 mm
Pit Dimensions for the leveler	-
Maximum Lifting Height	- 650 mm
Minimum Lowering Height	- 300 mm
Motor Power	1.1 kW
Maximum Carrying Capacity	Dynamic : 600 kg, Static : 9000 kg
Operating Temperature	- 10°C; +40°C
Control Panel Safety Class	Ip55
Leveler Color	RAL 5017
Platform Material	8/10 mm tear patterned steel
Tongue Material	12/14 mm tear patterned steel
Motor Voltage	380 V 50 Hz
Telescopic Tongue Length	600 mm

### MINI HINGED LEVELER

Leveler size	300 mm x 2000 mm
Platform material	8/10 tear patterned steel
Tongue size	400 mm x 2000 mm
Tongue material	10/11 tear patterned steel
Maximum lifting distance	+ 150 mm
Minimum lowering distance	- 150 mm
Type of movement	By Hand
Maximum carrying capacity	6000 kg
Total platform size	700 mm x 2000 mm
Leveler color	RAL 5002

### VERTICAL LEVELER

Leveler dimensions	2000 mm x 2000 mm
Maximum lifting distance	85 degree vertical position
Minimum lowering distance	- 400 mm
Motor power	0.75 kW
Maximum carrying capacity	6000 kg
Operating temperature	-10°C ; +40°C
Control panel safety class	Ip55
Leveler color	RAL 5017
Platform material	6/7 mm tear patterned steel
Motor voltage	380 V 50 Hz



HINGED LEVELER

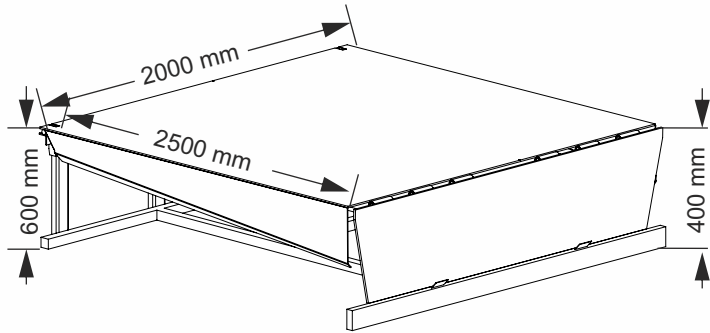

TELESCOPIC LEVELER

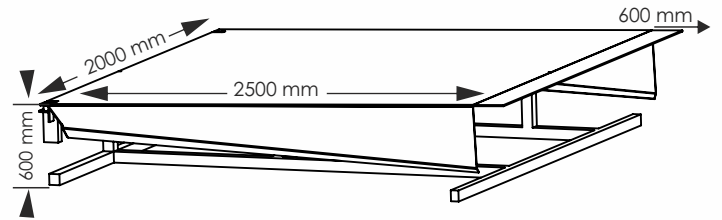

MINI HINGED LEVELER

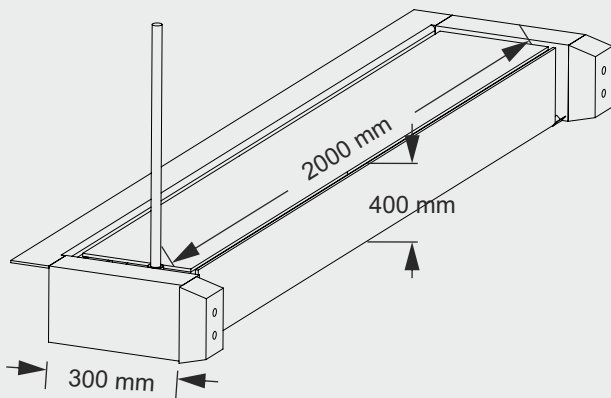

VERTICAL LEVELER

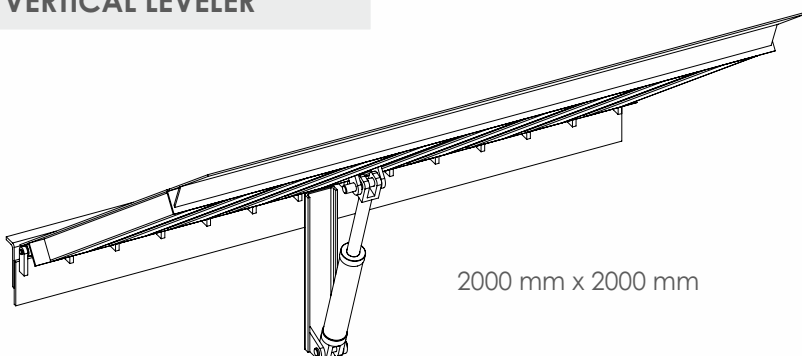

# Paw-Pax Dock Shelters



## PAW-PAX

Paw-Pax dock shelter system is specially developed to integrate shipping vehicles into the structure of logistics operations.

Loading docks, which are an essential part of loading systems, protect your cargo from external factors such as heat, cold, dust, and rain, and contribute to energy efficiency by preventing energy loss in businesses.

They are preferred in industries such as storage, textiles, pharmaceuticals, and food where the cleanliness, temperature, and humidity of indoor environments are crucial. This helps prevent irreversible damage in these industries.

The system provides cost-effectiveness, low maintenance expenses, and efficiency in all logistics and shipping processes of your business.

Loading shelters produced in compliance with internationally recognized standards and norms also play a crucial role in creating safe loading areas. Standard-compliant production is safe in daily use as well as during application and maintenance.

Loading shelters are designed to integrate seamlessly with loading ramps and sectional doors. Tailored to the type of loading and unloading operations and the physical conditions of the building, these shelters enhance operational efficiency for businesses.

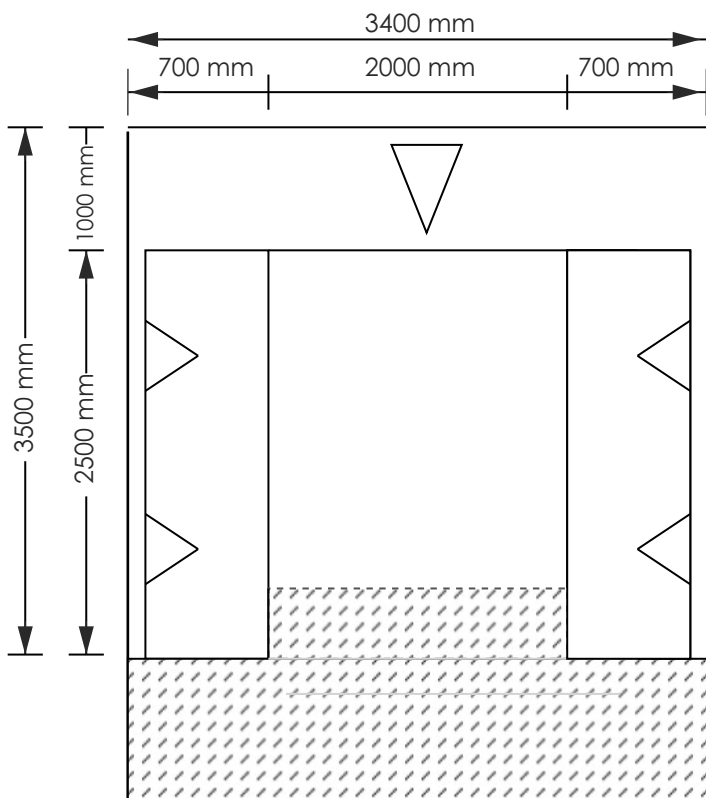

## Paw-Ex

### Emergency Exit Doors

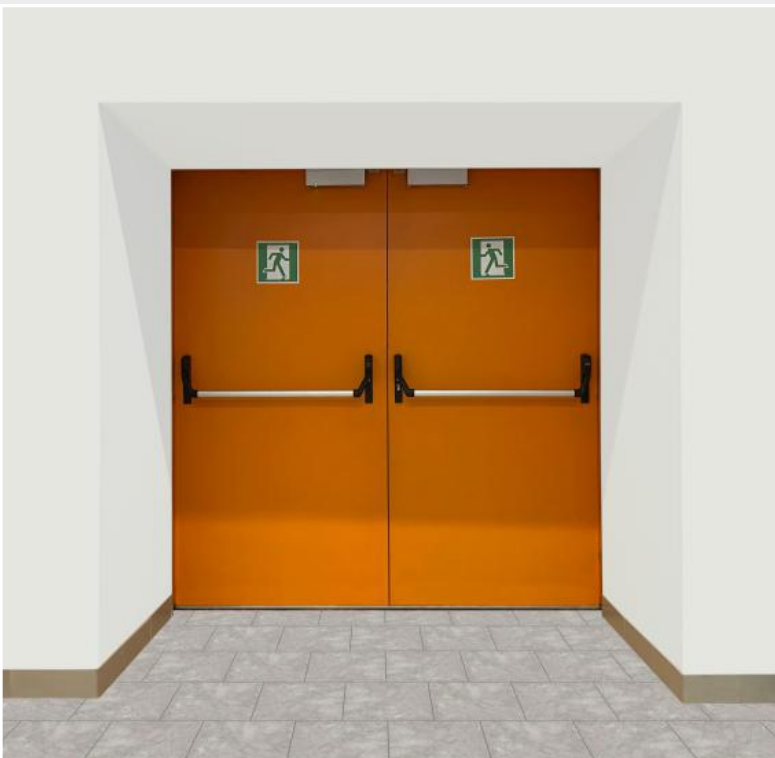

## PAW-EX

Fire-resistant doors, produced in modern and functional facilities utilizing the latest technologies to maintain a high level of quality and product consistency, offer an economical and durable solution.

With a wing thickness of 60 mm, they provide a rigid structure while minimizing the weight of the wing, thus reducing the burden on the implementers.

In addition to the requested colors, they seamlessly match the building with decorative coatings using NDD coating technology.

These fire-resistant doors are produced in accordance with harmonized standards **EN 16034** and **EN 14351** and are presented with the **CE** mark.

Model	W x H (mm)
E 60 - 1 Leaf	900 x 2150
E 60 - 1 Leaf	1000 x 2150
E 90 - 1 Leaf	900 x 2150
E 90 - 1 Leaf	1000 x 2150
EI 60 - 1 Leaf	900 x 2150
EI 60 - 1 Leaf	1000 x 2150
EI 90 - 1 Leaf	900 x 2150
EI 90 - 1 Leaf	1000 x 2150
EI 60 - 2 Leafs	1800 x 2150
EI 90 - 2 Leafs	1800 x 2150

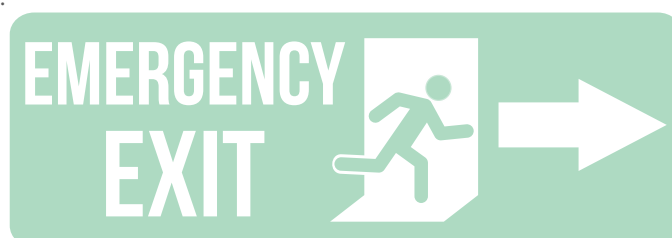

# Paw-Fire Roll Fire Shutters



## PAW-FIREROLL

Paw-Fireroll fire-resistant shutters are structural elements that prevent the spread of fire within a building. Throughout the resistance period, they create safe escape corridors, allowing people to be easily evacuated from the building. Until the fire department intervenes, they direct the fire towards a compartment and prevent the potential growth of material damage.

Fireroll Doors can withstand temperatures up to 1150°C for up to 240 minutes in compliance with the EN16034 standards.

Fire shutters are manufactured according to the desired dimensions. In emergencies, they automatically close with fire automation and contain the arising danger until intervention occurs.



## Some of our References







**EZER OTOMATIK KAPI  
SISTEMLERİ A.S.**

Osmangazi Mah. Yıldırım Beyazıt  
Cad. No:7 B-1, 34887 Sancaktepe  
İstanbul, Türkiye

+ 90 216 311 83 00

[www.pawdoors.com](http://www.pawdoors.com)

[paw@paw.com.tr](mailto:paw@paw.com.tr)