

FIND ZEN IN YOUR PRIVATE COURTYARD GARDEN

- 103 villas spread across 6.75 acres
- 4 BHK villas from 2655 sq. ft. to 3389 sq. ft.
- An added personal space to explore your passions
- 20+ sports and recreational amenities



Artistic Impression





**4 BHK Villas with
Private Courtyard Garden**

IMAGINE HAVING 5 PRIVATE GARDENS IN YOUR HOME

**PRIVATE
COURTYARD**
GARDEN

OPEN SKY DECK
GARDEN

ROOFTOP
GARDEN

PORCH
GARDEN

SIDE
GARDEN

It's easy to stay connected with nature when you are surrounded by greenery. Villas at Spring Woods are designed to seamlessly integrate nature into your living spaces. Ease your conscience by adding more green spaces to the urban landscape.

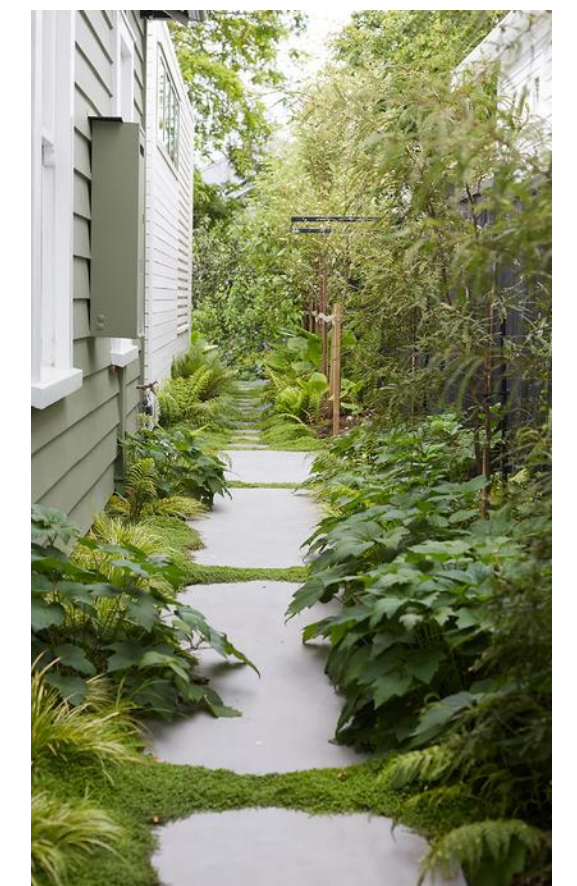

Artistic Impressions

MAKE MORE SPACE FOR LIFE

Spread across 3 floors, Buildiko Spring Woods villas offers a spacious and relaxing atmosphere. The ground floor houses a living room, kitchen, and parents bedroom with an attached bath. 1st floor accommodates master bedroom and children bedroom, the 2nd floor hosts a guest bedroom and your own personal space to pursue your passions.



Artistic Impression

THE PRIVACY OF VILLA LIFE

Buildiko Spring Woods offers you a private sanctuary away from the fast pace of urban life. These villas represent the balance between modern, sustainable architecture and a serene environment.



Artistic Impression



Artistic Impression

A PERSONAL SPACE TO EXPLORE YOUR PASSIONS

While 4 bedrooms accommodate your family and their needs, the 5th room is your personal space. A room that can be converted into a home theatre, gym, library, jamming space, content generation studio, artist's den or just about anything. Explore your passions freely with no restrictions. This is your space.

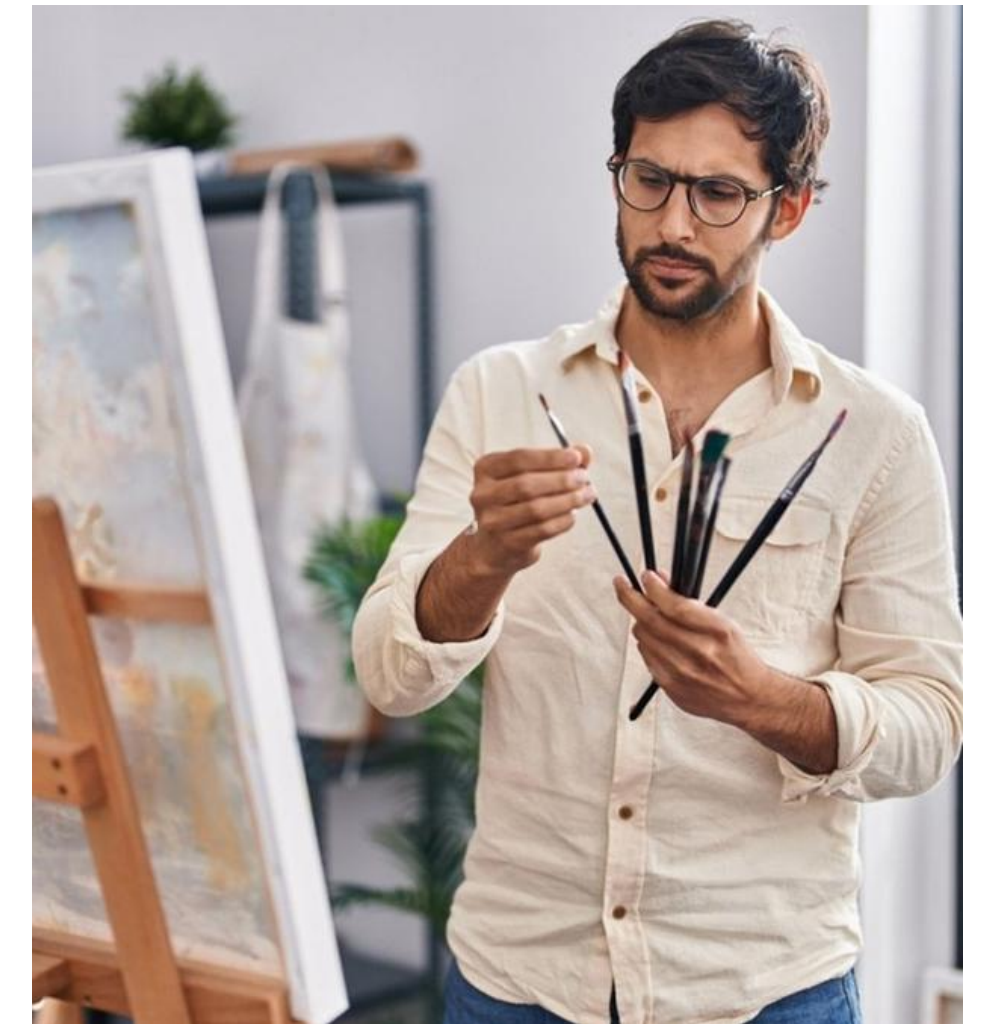



A PIONEERING IDEA CALLED LIVING STREETS

Living streets are an attractive use of public space. It's a novel concept thoughtfully designed to encourage social interaction and promote pedestrian safety. With maximum usage of green spaces, these streets are both eco-friendly and safe.

- Grass pavers create a cushioned surface that prevents injuries
- Internal paths have roll-over kerbs and intersections to reduce vehicular speed
- Designed tactile ramps and paving promote walkability

**ENTER A WORLD
OF COMFORT WITH
BEST-IN-CLASS
AMENITIES**

CLUBHOUSE

UPTO 14,000 SQ. FT.

INDOOR

BADMINTON COURT

MULTIPURPOSE

HALL











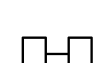

INDOOR GAMES

HEALTH CLUB



Artistic Impression

AMENITIES

-  Jogging Track
-  Pavillion/Gazebo
-  Kids Play Area
-  Lawn
-  Exercise Pod
-  Park Plaza
-  Amphitheatre
-  Skating Rink
-  Community Garden
-  Yoga Pavillion
-  Mini Forest
-  Reflexology Track
-  Swimming Pool



MASTER PLAN

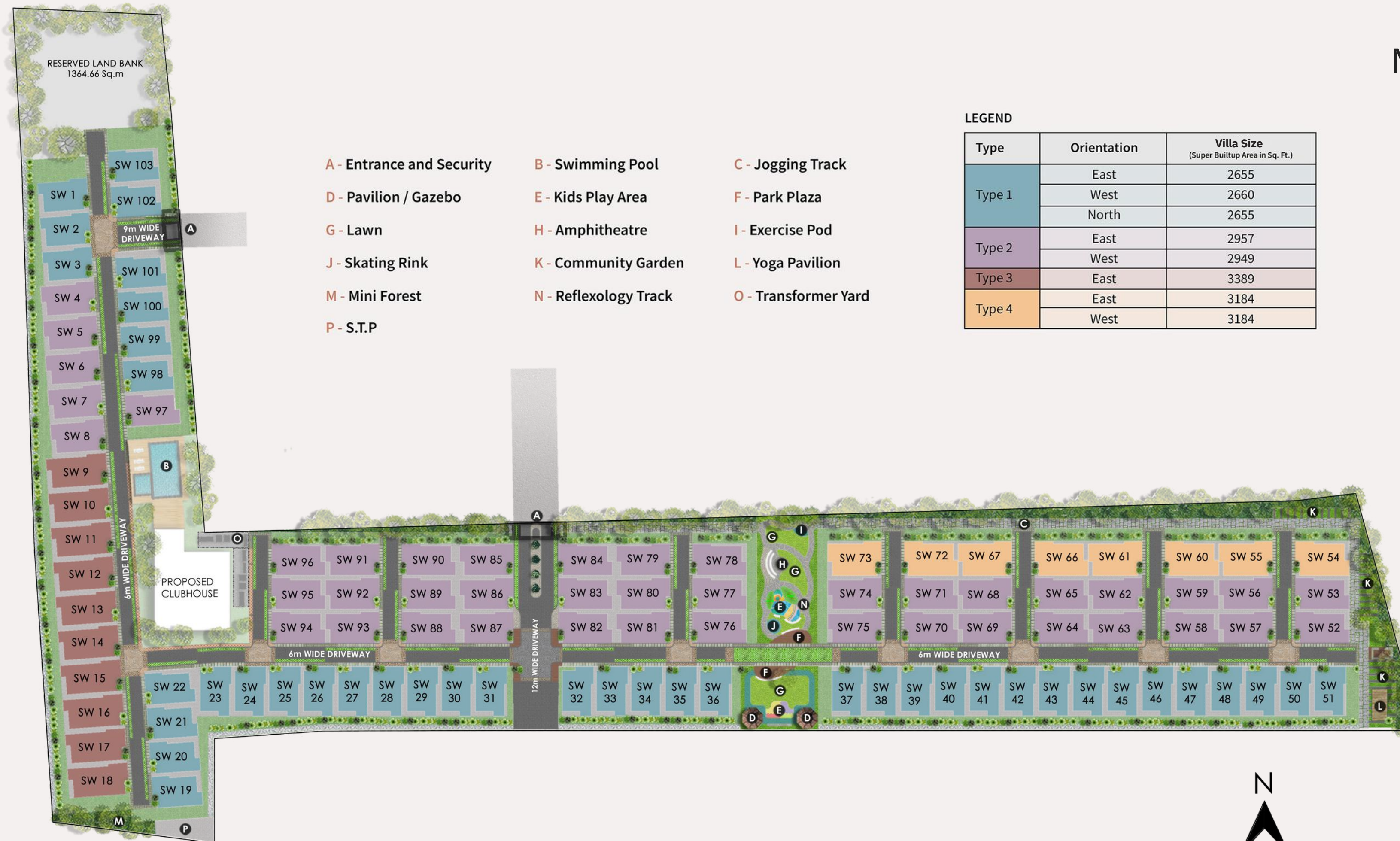

- A - Entrance and Security
- B - Swimming Pool
- C - Jogging Track
- D - Pavilion / Gazebo
- E - Kids Play Area
- F - Park Plaza
- G - Lawn
- H - Amphitheatre
- I - Exercise Pod
- J - Skating Rink
- K - Community Garden
- L - Yoga Pavilion
- M - Mini Forest
- N - Reflexology Track
- O - Transformer Yard
- P - S.T.P

LEGEND

Type	Orientation	Villa Size (Super Builtup Area in Sq. Ft.)
Type 1	East	2655
	West	2660
	North	2655
Type 2	East	2957
	West	2949
Type 3	East	3389
Type 4	East	3184
	West	3184



LOCATION MAP

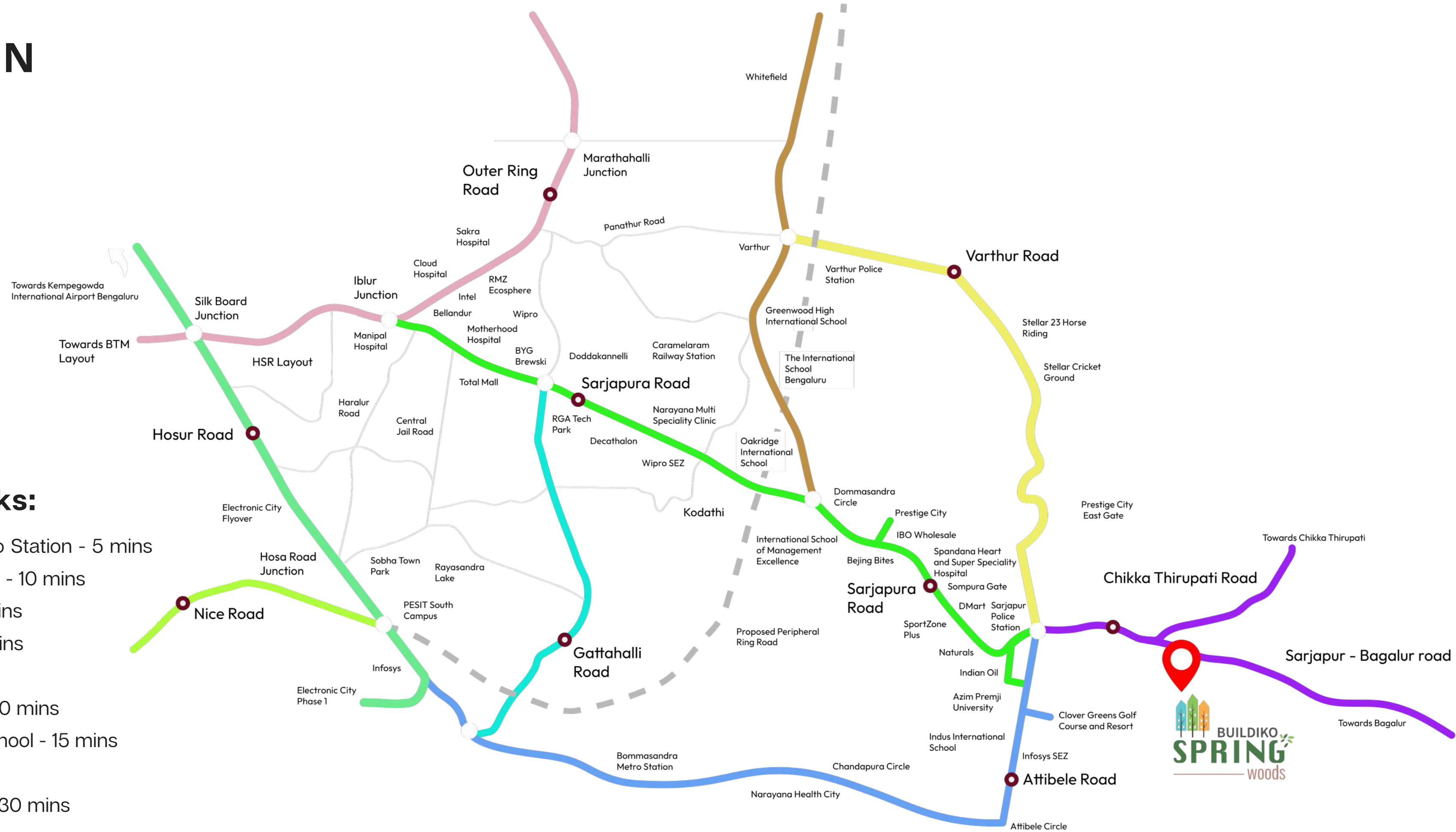

Major Landmarks:

- Upcoming Sarjapur Metro Station - 5 mins
- Indus International School - 10 mins
- Delhi Public School : 10 mins
- Spandana Hospital - 10 mins
- DMart - 10 mins
- Azim Premji University - 10 mins
- Oakridge International School - 15 mins
- Prestige City - 15 mins
- Wipro Corporate Office - 30 mins
- Manipal Hospital - 35 mins
- Electronic City - 35 mins



SPECIFICATIONS AND FIXTURES



Flooring & Dado

Ground Floor - Flooring

- (A) Foyer, Living & Dining - Superior Quality Vitrified Tiles
- (B) Bedroom 1 - Superior Quality Vitrified Tiles
- (C) Kitchen - Superior Quality Vitrified Tiles
- (D) Balcony - Anti-Skid Ceramic Tiles
- (E) Toilets - Anti-Skid Ceramic Tiles
- (F) Utility - Anti-Skid Ceramic Tiles
- (G) Parking - Parking Tiles

Ground Floor - Dado

- (A) Kitchen Dado Up To 2'0" Height - Superior Quality Ceramic Tiles
- (B) Toilet Wall Dado Up To 7'0" - Superior Quality Ceramic Tiles
- (C) Utility Dado Up To Sill - Superior Quality Ceramic Tiles

First Floor & Second Floor - Flooring

- (A) Bedroom 2 - Laminated Wooden Flooring
- (B) Bedroom 3 - Superior Quality Vitrified Tiles
- (C) Bedroom 4 - Superior Quality Vitrified Tiles
- (D) Toilets - Anti-Skid Ceramic Tiles
- (E) Terrace - Anti-Skid Ceramic Tiles

First Floor & Second Floor - Dado

- (A) Toilet Wall Dado Up To 7'0" - Superior Quality Ceramic Tiles



Walls

- (A) External Wall - 150 Mm Solid Block Masonry + Plastering
- (B) Internal Wall - 100 Mm Solid Block Masonry + Plastering



Kitchen Counter

Modular Type of Kitchen Counter



Doors

- (A) Entrance - Teak Wood Frame, Factory-Made BST Shutter With Beading, Polish Finish, And Necessary Hardware Fittings
- (B) Bedrooms And Toilets - Engineered Wooden Laminated / Skin Shutters / Doors



Windows

- (A) Living, Dining And Bedrooms - UPVC Sliding Windows With Bug Screen
- (B) Kitchen - UPVC Window
- (C) Ventilators - UPVC Louvers With Exhaust Fan Provision



Painting

- (A) Internal - Plastic Emulsion For Ceilings & Internal Walls
- (B) External - Combination Of Emulsion (80%) & Textured Paint (20%)
- (C) Fabrication Work - Enamel Paint



Sanitary Ware Fittings

- (A) Wall Mounted Std. Quality Coupled Sanitary
- (B) Fixtures - Jaquar Or Equivalent

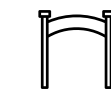

Project Facilities

- (A) Sewage Treatment Plant
- (B) Rainwater Harvesting
- (C) Compound Wall For Project
- (D) Entrance Arch With Gate



Common Area

- (A) Staircase Internal Flooring - Granite
- (B) Internal Handrail For Staircase - Ss Fittings With Rails
- (C) Railing For Balcony - Glass Railing With Ss Handrail
- (D) Parking - Parking Tiles

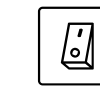

Electrical Fittings

Modular Switches



BESCOM Power

3 Phase 7 KW



Video Door Phone

Non-Biometric Digital Lock

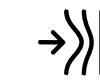

Super Structure

Framed Structure/Load Bearing Structure



CP Fittings

Superior Quality Fittings - Jaquar Or Equivalent



Sub Structure

Isolated/Load Bearing



BUILD TOGETHER: BUILDING VALUES & TRUST

Buildiko is a premium real estate company specialising in designing luxury residential villa projects in the Bengaluru district of Karnataka. Founder and Chairman of Buildiko, Mr. Chinnapa Reddy, is a civil engineer who holds extensive experience in handling large-scale real estate projects of over 2.5 million sq. ft.

OUR VISION AND MISSION

At Buildiko, we are committed to sustainable design practices and strive to create homes that are luxuriously designed and environmentally conscious. We aim to create living spaces for lavish lifestyles and high-value residential landmark communities. We go the extra mile, one brick at a time, ensuring quality, standards, and timely delivery of our projects.



Buildiko Spring Woods

Sarjapur, Bengaluru, Karnataka 562125

Contact us at:

+91 6366 833 003

www.buildikospringwoods.co.in

Disclaimer: The amenities, specifications, facilities, surrounding infrastructure, stock images and features shown and/or mentioned and the image renders used herein are purely indicative and for representational purposes and may differ from the actuals. Products, features, light fittings, pictures, images, etc. shown as illustrations are for reference only. The colours, shades of walls, tiles etc. shown in the images are for the purpose of representation only and may vary upon actual construction. The purpose of this brochure is to indicate to the customers the extent of the amenities and facilities that may come up in the project as per the present approved layout. Any prospective sale shall strictly be governed by the terms and conditions of the agreement for sale to be entered into between the parties.

Exclusive
Marketing Partner

ceyone[®]

Agent RERA No.:
PRM/KA/RERA/1251/309/AG/180727/001045

