

# 1



Section 1

## Whiteboard Cabinets

Contact us for a quote!



[sales@educatedfurniture.co.nz](mailto:sales@educatedfurniture.co.nz)



0508 645 397



[educatedfurniture.co.nz](http://educatedfurniture.co.nz)



## Section 1

# Whiteboard Cabinets

Units and Combinations ..... 1-3

The Best Cabinet on the Market..... 1-6

## Units and Combinations

### 915 & 945 Whiteboard Cabinets



#### Customise the perfect whiteboard cabinet for your classroom or learning environment

Choose from a wide a array of cabinet bases that include cupboards, drawers, open shelving and cube crates and tote trays to enhance your unit. All the upper levels having adjustable shelving, hiding behind the sliding whiteboards.

Pick the sizes you require to make up the overall measurement, keeping this between 1600mm and 4800mm.

All units are 2000mm high x 400mm deep with the interior shelf depth in the top section being 290mm. Some of the width sizes may vary depending on your combinations.

We also offer 600 deep cabinets which have been designed especially for STEM rooms where bulkier items may need to be stored. Base cabinets are 600mm deep with shelving behind the whiteboards being 490mm deep. All shelves are adjustable.

Our skilled and dedicated sales team are extremely knowledgeable about the different options available and can assist you every step of the way to create the display and storage system of your dreams!

#### 400mm Deep Base Units

915A 800w 4 Cube	915B 1200w 6 Cube	915C 900w 3 Row Tote	915D 1200w 4 Row Tote	915E 700w Cupboard	915F 800w Cupboard	915G 1200w Cupboard	915H 700w Drawers	915I 800w Drawers
915P (TV) 1200w TV Unit	915Q (TV) 1600w TV Unit	915R 700 700 L/R 12 Devices	915R 800 800 L/R 24 Devices	915S 700w Open Shelving	915T 800w Open Shelving	915U 1200w Open Shelving	V (END) 800w Cupboard	W (END) 800w Bookcase

Colour range - all of our Melteca units can be made in any of the colours/finishes below



## 600mm Deep Base Units

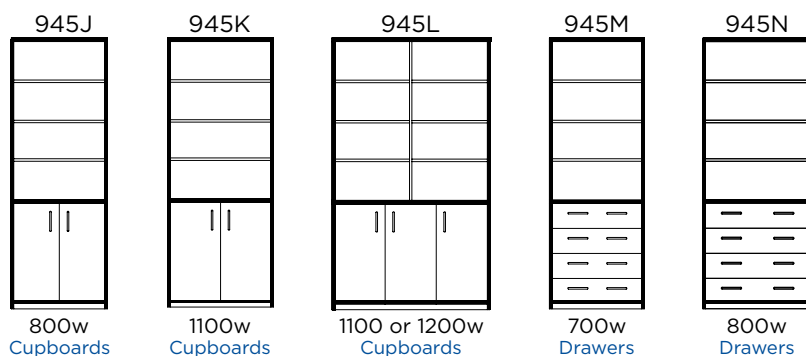

## R 700 Modules - 700 left or right

- Holds 12 devices
- Supplied with 2 x 6 gang surge protected 10 amp power boards to charge the devices
- Single power cable exits through the side
- Ventilation through side and doors
- Locking doors



## R 800 Modules - 800 left or right

- Holds 24 devices
- Supplied with 4 x 6 gang surge protected 10 amp power boards to charge the devices
- Single power cable exits through the side
- Ventilation through side and doors
- Locking doors

Add locks to whiteboards, doors and drawers for secure storage of televisions, devices and other resources

### Add Tote Trays

Small 400 x 270 x 75  
Large 400 x 270 x 150  
Grey | Red | Blue | Clear



### Add Cube Crates

Stand alone or stack  
360L x 360W x 280H  
Clear | Blue | Grey



## P/Q (TV) Units

- Solid 18mm back to mount a TV bracket
- No adjustable shelving behind whiteboards
- P Unit has an internal size of 1142w x 1195h
- Q Unit has an internal size of 1542 x 1195h

### Cabinet Specifications

6400W x 2000H x 400D  
4 x 1200W Whiteboards  
1 x Unit V (End Cupboard)  
1 x Unit W (End Cupboard)  
1 x Unit G (Cupboard)  
1 x Unit B (6 Cube Crate)  
1 x Unit G (Cupboard)  
1 x Unit C (3 Row Tote)  
+ 18 Tote Trays  
+ 6 Cube Crates



Colour range - all of our Melteca units can be made in any of the colours/finishes below





## Whiteboard standard sizes

1800W x 2000H Cabinet - 2 x 900W x 1200H porcelain whiteboards

2400W x 2000H Cabinet - 2 x 1200W x 1200 porcelain whiteboards

3000W x 2000H Cabinet - 2 x 1200 x 1500 porcelain whiteboards

3600W x 2000H Cabinet - 2 x 1200 x 1800 porcelain whiteboards

4800W x 2000H Cabinet - 2 x 1200 x 2400 porcelain whiteboards

Standard cabinet depths are 400 or 600mm



### Cabinet Specifications

2600W x 2000H x 400D  
2 x 1300W Whiteboards  
1 x Unit C (3 Row Tote)  
1 x Unit F (Cupboard)  
1 x Unit C (3 Row Tote)  
+ 36 Tote Trays



### Cabinet Specifications

2400W x 2000H x 400D  
2 x 1200W Whiteboards  
1 x Unit R700 (12 slots)  
1 x Unit C (3 Row Tote)  
1 x Unit A (4 Cube Crate)  
+ 18 Tote Trays  
+ 4 Cube Crates



### Cabinet Specifications

3200W x 2000H x 400D  
2 x 1600W Whiteboards  
1 x Unit R700 (12 Slots)  
1 x Unit C (3 Row Tote)  
1 x Unit Q (TV Unit)  
+ 18 Tote Trays

Colour range - all of our Melteca units can be made in any of the colours/finishes below



## The Best Cabinet on the Market

Educated Furniture whiteboard cabinets are second to none and here are just some of the reasons why we believe they are worth the investment for every classroom in New Zealand.

### The ultimate all-in-one storage solution that every classroom needs

Our whiteboard (WB) cabinets are the ultimate all-in-one solution, combining all your classroom storage into a single, lockable unit. Better still, they provide an important work space for group discussion and collaboration. For this reason we think they are must in every classroom!

Through careful design, we have optimised our cabinets to ensure our customers get maximum use from their unit. When configured correctly, we believe the whiteboard cabinet can act as the main storage solution in the classroom or administration environment.

In addition to the lower level storage, the cabinets also feature adjustable shelving or display mounting space, neatly hidden behind the sliding whiteboards.

### A unique and unrivalled track system that is second to none

Our WB cabinets feature a high quality, unique track system that sets them apart from all other WB cabinets on the New Zealand market.

With rollers at the top and bottom, the dual whiteboards run incredibly smoothly along their anodized aluminium tracks. Horizontal and vertical adjustment of the guide runners also ensures that the boards always close true and are much less prone to jamming.

### Premium porcelain whiteboards with a forever surface guarantee

All our cabinets come with two premium porcelain whiteboards that are fully magnetic and come with a forever surface guarantee (subject to it being used for its designed purpose). Featuring a solid MDF core, strong corners and slimline aluminium frame, our whiteboards are designed to withstand the rigours of high use while also maximising the work surface area.

### Free up space and mount your television or display unit inside your whiteboard cabinet

In addition to device storage, our WB cabinet range also includes two modules that can house televisions or monitors up to 65 inches. Hidden neatly behind the sliding whiteboards, the upper level can be made fully lockable so you can safely secure the screen when not in use. If your screen is larger than 65 inches, no problem, we can custom make a television unit that will meet your needs.



### Create lockable spaces for all your laptops and tablets to charge and stay safe

Our WB cabinets can be made fully lockable to safely secure and protect valuable items such as tablets, laptops, televisions and monitors. Included in our cabinet range, we have two modules that are designed specifically for locking and charging tablets and laptops. Each device has its own individual shelf, power point and plenty of ventilation to ensure safe and secure charging when not in use.

### Refined design and a wide array of cabinet modules to choose from

More than a decade ago, we pioneered the design, manufacture and introduction of NZ's first classroom WB cabinets.

With the benefit of experience and years of customer feedback, we have continued to refine our cabinets to provide an unparalleled quality product and a vast range of configurations to suit the needs of any environment.

This innovation continues today, with the quality and functionality of our modern WB cabinets performing at a level above any other comparative product on the market.

### Achieve DQLS acoustic requirements with fitted coverings

Most of our cabinet modules can be fitted with acoustic absorbent coverings, helping designers achieve DQLS acoustic requirements.

There are endless acoustic covering options available and we can take care of everything from the design right through to installation.



Colour range - all of our Melteca units can be made in any of the colours/finishes below



## Endless flexibility and customisation with our whiteboard cabinets

Over the past decade we have developed a vast range of base modules to create any configuration of WB cabinet you desire. Not only is the range of standard modules extensive, but each module can also be modified to achieve complete customisation of the cabinet, at minimal extra cost. This includes changing the overall height or width of the cabinet to fit within a specific space.

The internal shelving arrangements in the upper and lower sections of the cabinet can also be customised to house specific items. This could include sloping shelves within the cupboard or bookcase modules or the addition of extra adjustable shelves.

With an EF WB cabinet, customers have the flexibility to design their unit to complement the look and feel of their unique environment. Choose the colour/finish of the carcass, doors, drawers and shelves as well as the colours and combinations of tote trays and cube crates.

## Maintaining the highest level of quality control

We do all the critical assembly work for each module prior to dispatch from our factory. This ensures that our cabinets are always built to the highest standard and only leave our factory when the required quality control checks have been completed. This approach also ensures that our cabinets are easy and efficient to assemble and helps to mitigate shipping and installation costs.

In order to provide maximum storage capacity and plenty of usable space in the lower section of the cabinet, we have designed our units with a slim 40mm toe kick. When adding an EF WB cabinet to a classroom or learning space, we recommend they are installed as one of the last items in the fit out, once carpet is down and walls are finished.

## Installation is quick and easy

Our modules are shipped fully assembled and once on site, the cabinet can be easily put together by a builder or school caretaker. All instructions and fittings are provided and Installation typically only takes one hour. Wall anchor kits are optional for those wanting to attach their cabinets to the wall.

## Hassle-free installation service available

For those customers that need it, we also offer an installation service, which is always completed by an in-house EF representative. Our installation service takes care of everything from delivery and placement right through to clean up and removal of any waste and shipping materials.

## 10 year repair and replacement warranty

We're so confident in the quality of our product that we offer a 10 year repair/replacement warranty on our cabinets and a "Forever" guarantee on most of our whiteboards.

We've been making our cabinets for a long time and customers keep coming back for more – such is the quality, value and service we offer.

## Get all the help you need with our free consultation and design service

We understand that ordering a new WB cabinet is an big investment and can seem like a daunting task for some customers. For this reason we highly recommend all our customers take advantage of our free consultation and design service. Our skilled and dedicated sales team have designed and installed hundreds of WB cabinets over the past decade and are extremely knowledgeable about the different options available and what will work best in any given space.

Where a bespoke unit is required, our sales team will always complete a site visit to measure up the space and provide concept drawings prior to quote acceptance. The following job is an example of the bespoke customisation service we offer to all our customers.

The school needed to have units designed and built to fit precisely within three existing alcove spaces. Furthermore, the units had to be specifically modified to fit around a load bearing beam that ran from the floor to the top of the alcove. This required extreme precision with the measure up, design, build and installation of the cabinets which we completed successfully. This fantastic result allowed the school to effectively install the WB cabinets without sacrificing any floor space.



Colour range - all of our Melteca units can be made in any of the colours/finishes below







## Cabinet Specifications

3200W x 2000H x 400D  
2 x 1600W Whiteboards  
1 x Unit V (End Cupboard)  
2 x Unit T (Open Shelving)  
1 x Unit V (End Cupboard)



## Cabinet Specifications

3600W x 2000H x 400D  
2 x 1800W Whiteboards  
1 x Unit V (End Cupboard)  
1 x Unit B (6 Cube Crate)  
1 x Unit D (4 Row Tote)  
1 x Unit E (Cupboard)  
+ 24 Tote Trays  
+ 6 Cube Crates



## Cabinet Specifications

700W x 2000H x 400D  
1 x Unit R700 (12 Slots)

NB Cabinet modules  
can also be ordered as  
individual units



Colour range - all of our Melteca units can be made in any of the colours/finishes below

