

Randolph and Peoria Fulton Market, Chicago, IL



RANDOLPH AND PEORIA, FULTON MARKET



Grit. Creation. Rejuvenation.

PROPERTY

Highly visible 2nd floor retail space with direct access onto Randolph in Chicago's most dynamic neighborhood; Fulton Market. The retail at Gin Alley offers retailers and showrooms close proximity to the high performing restaurants that populate the market as well as an emerging, trendy soft goods co-tenancy. With Madewell, Warby Parker, Billy Reid, Uncommon James, Malbon, Allbirds and 4 Hogsalt restaurant concepts already open in the project, the only question is; when will YOU open at Gin Alley?

THE ALLEY

All the retailers utilize the alley connecting Green Street to Peoria Street for a dynamic inside/outside shopping and dining experience.

AVAILABLE SPACE (SECOND FLOOR)

- 2,951 sf of second level space with direct access from Randolph and front and rear windows.

DEMOGRAPHICS

| | ½ MILE | 1 MILE | 1 ½ MILE |
|--------------------|-----------|-----------|-----------|
| POPULATION | 23,632 | 70,215 | 155,023 |
| AVERAGE HH INCOME | \$193,890 | \$191,510 | \$178,503 |
| DAYTIME POPULATION | 45,045 | 306,150 | 564,486 |

NEIGHBORHOOD SNAPSHOT



20
2024 Michelin recognized restaurants

155K
People in a 1.5 mile radius

82%
Population with white collar jobs in a two block radius

1,105
Hotel rooms in Fulton Market

\$257K
Average HH income in a two block radius

7.7K
Average vehicles per day on Randolph

AREA OFFICE TENANTS



EXCLUSIVE AGENTS

John Vance 312/782-1373
jvance@stonerealestate.com

William Winter 312/878-9445
wwinter@stonerealestate.com

 **NEWCASTLE** INVESTORS  **STONE** REAL ESTATE

RANDOLPH AND PEORIA, FULTON MARKET

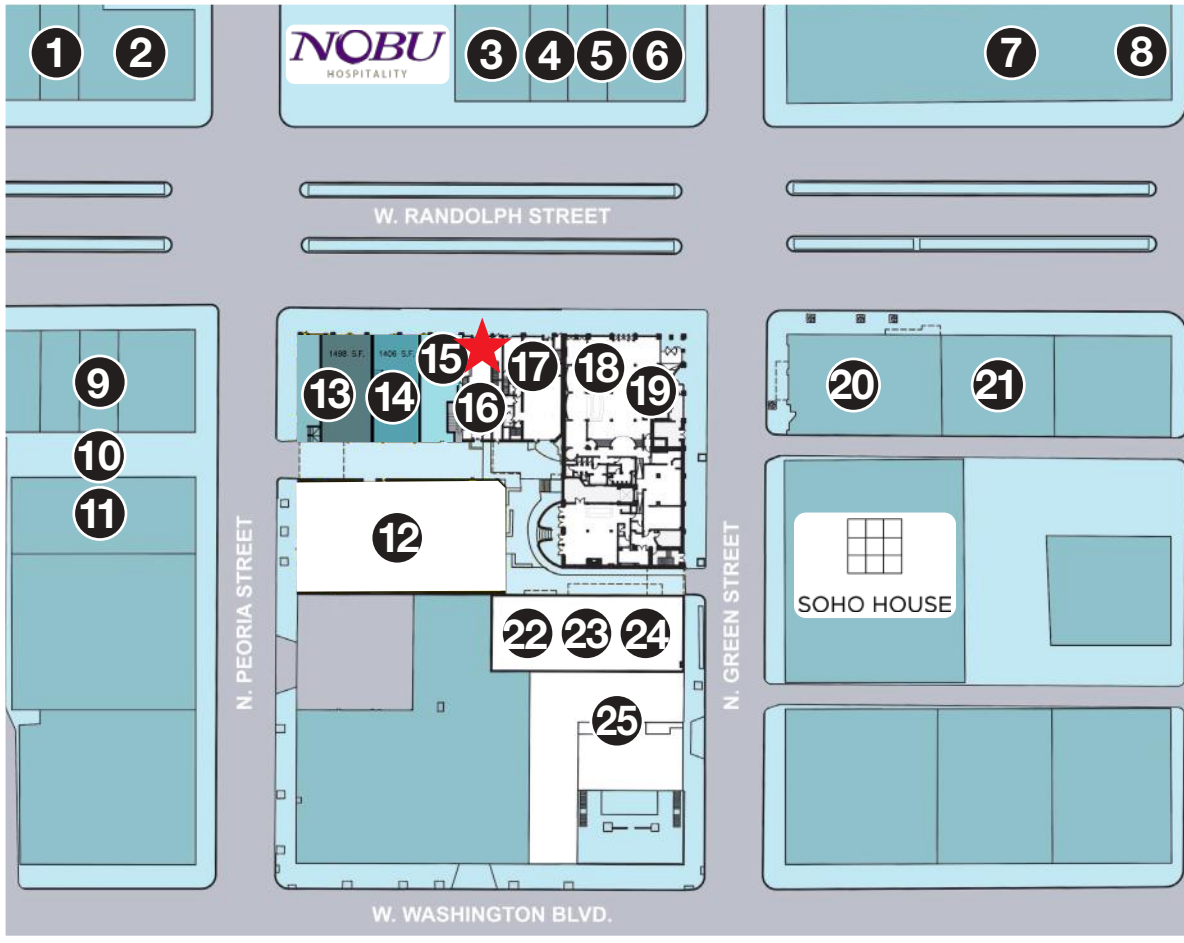

- 1.
- 2.
- 3.
- 4.
5. HIDE + SEEK
- 6.
- 7.
- 8.
- 9.
- 10.
11. NOTRE
12. TRIVOLI TAVERN
- 13.
- 14.
- 15.
16. BILLY REID
- 17.
- 18.
- 19.
- 20.
- 21.
- 22.
- 23.
- 24.
- 25.

RANDOLPH AND PEORIA, FULTON MARKET - SECOND LEVEL PLAN

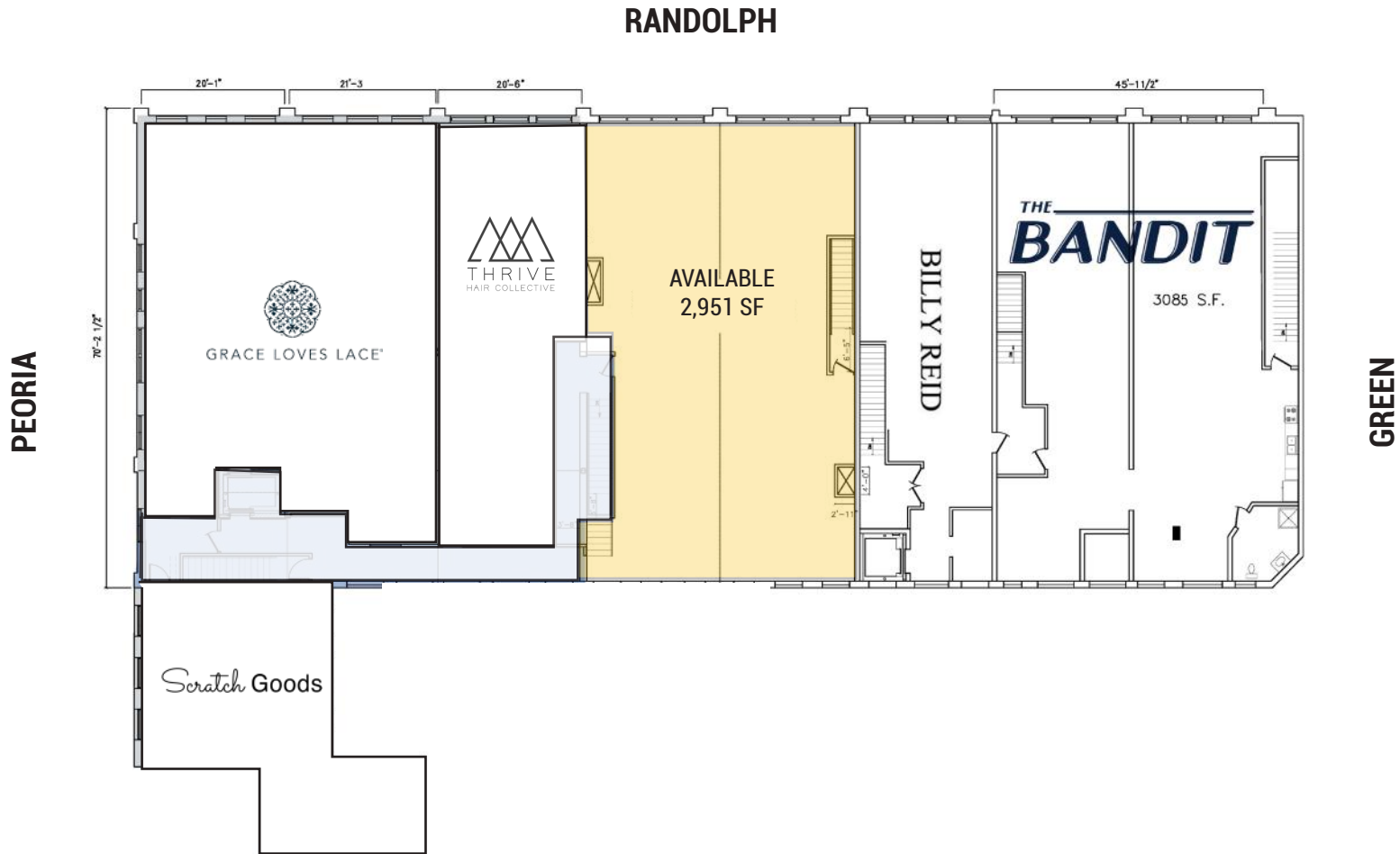

EXCLUSIVE AGENTS

John Vance 312/782-1373
jvance@stonerealestate.com

William Winter 312/878-9445
wwinter@stonerealestate.com

RANDOLPH AND PEORIA, FULTON MARKET - FIRST LEVEL PLAN

NOBU HOTEL



EXCLUSIVE AGENTS

John Vance 312/782-1373
jvance@stonerealestate.com

William Winter 312/878-9445
wwinter@stonerealestate.com

RANDOLPH AND PEORIA, FULTON MARKET



EXCLUSIVE AGENTS

John Vance 312/782-1373
 jvance@stonerealestate.com

William Winter 312/878-9445
 wwinter@stonerealestate.com



STONE
REAL ESTATE

333 N. Michigan Avenue
Suite 1330
Chicago, IL 60601