

Gulmohar School

A new residential school for children with disabilities.



**Help Us to provide
Modern facilities to these children**

Background of Gulmohar School

Gulmohar Special School for Blind and Mentally Challenged children is run by Shree Gurudev Bahu-Uddeshiya Samajik Sanstha (the organisation)

Sewa UK aims to improve the life of the rural population - especially for these children with special needs.



At present, the school operates from a small rented derelict building and caters for only 50 children



Moving To A Brighter Future

At present the same room is the classroom, the playroom, the dining room, the dormitory and the storage room.



The new school will provide for up to 100 students



Gulmohur School for Special Education

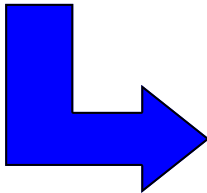

- The plot is subdivided into four zones.
- Zone 'A' is mandatory setback land from the road.
- Zone 'B' is the school zone admeasuring to about 1430.00 sq.m. where the school building is located.
- Zone 'C' is the hostel zone admeasuring to 1635.00 sq.m. where hostel building is located.
- Zone 'D' is residence area admeasuring to 900.00 sq.m. where staff quarters and guest house is located.
- All the four zones are accessible from a 9.0m wide road along the southern boundary. Sloping along natural contours with necessary pitching along northside wherever required.

Due Diligence

Memorandum of Understanding

This Memorandum of Understanding dated 1st June 2013 is between the following parties:-

(a) Sewa International UK (Sewa UK), a company limited by guarantee (company number 0976220) and registered charity (registration number 1135425) whose registered office is 110 High Street, Edgware, Middlesex HA8 7HF UK authorised representative:

I. Introduction

1.1. In this Memorandum of Understanding, the following expressions have the following meanings:

- 1.1.1. "MOU" This Memorandum of Understanding
- 1.1.2. "Services" The services provided by the parties to the MOU
- 1.1.3. "Date of Commencement" Shall mean 1st June 2013 (date when agreement starts)
- 1.1.4. "Clients" Shall mean tribal boys and girls with special needs who receive education and shelter.
- 1.1.5. "Confidential Information" Shall mean any and all information, whether in writing or otherwise, that is disclosed by any party before, on or after the commencement date including, but not limited to, financial information, marketing data, procedures, business plans, lists of funders, personnel data, business relationships, current products, services and anticipated products and

Approved
AK
24/7
(R)

Reminder:

Send over MOU

Bill of quantities (a summary)

PROPOSED RESIDENTIAL SCHOOL FOR BLIND & SPECIAL CHILDREN ON PLOT BEARING S. NO. 216/2/4 PART OF VLLAGE RAYTHALA, TALUKA JAWHAR AT JAWHAR TRIAMBAK ROAD FOR SHREE GURUDEV BAHUUDDESHIYA SANSTHA

Sr.No	Description	School Building	Hostel Building	Guest House	Staff Quarter	Total Amount
1	RCC work	7903194.81	9886968.85	2622149.44	2022129.27	22434442.37
2	Civil Work	6562629.12	7412070.25	2873748.84	2300210.54	19148658.74
3	Plumbing Work	400974.58	541393.99	508402.68	259700.63	1710471.88
	Total (1 + 2 + 3)	14866798.51	17840433.08	6004300.95	4582040.45	43293572.99
	Total Area	1142.33	1340.87	369.93	271.99	3125.12
				16230.78	16846.47	13853.39

Project Plans

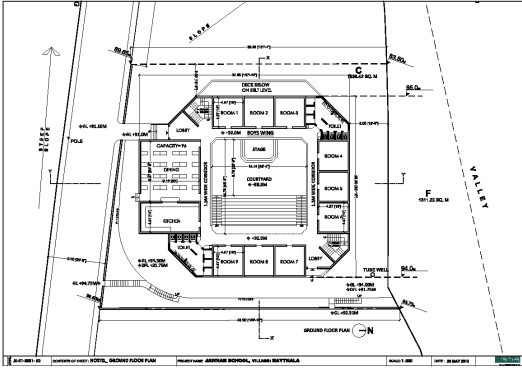

Site inspection and planning

REMINDER
Staff Quarters Layout

School Plans

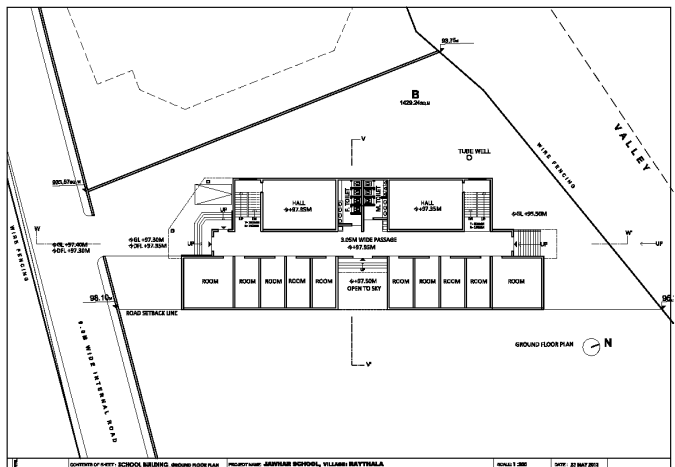

Help Make A Difference

**You donation will be acknowledged with a plaque
(Max of 30 Characters)**

CLASSROOMS

Description	No of units	Area of each unit	Cost of <u>each</u> unit in £
Class Room Ground Floor	8	200 sft.	£8,000
Class Room First Floor	8	400 sft	£13,000

HOSTEL

Description	No of units	Area of each unit	Cost of <u>each</u> unit in £
Dormitory Ground Floor	9	225 sft.	£9,500
Dormitory First Floor	9	225 sft	£9,500

DINING & KITCHEN

Description	No of units	Area	Cost of <u>each</u> flat in £
Dining Hall + Kitchen	1	1350 sft.	£60,000

HALL

Description	No of units	Area	Cost of <u>each</u> unit in £
Hall in School	2	600 sft.	£20,000
Hall in Hostel	1	1350 sft	£60,000

STAFF QUARTERS

Description	No of flats	Area of each flat	Cost of <u>each</u> flat in £
Flats	4	750 sft.	£18,000

Donor Details

I wish to support SEWA UK

Please select one of the following options

£50

£100

£200

£ Any other amount

Please contact Sewa UK if you wish to sponsor a classroom/dormitory/etc

Your details

Name

Address

..... Post Code

Email Tel

SECTION A

Gift Aid declaration

As a tax payer, I would like SEWA UK to treat this donation and all future donations I make as a gift aid donations.

Signature Date

N.B You must pay an amount of Income Tax and/or Capital Gains Tax at least equivalent to the tax than SEWA UK will receive on your donation in the tax year.

SECTION B

To pay by cheque

I am/We are enclosing a cheque made payable to: Sewa UK

SECTION C

To pay by card

To donate by card, please visit www.btmydonate.com
Click on Donate to Charity and type SEWAUK into search bar

Local Contact:

SEWA UK
1100 Stratford Road
Hall Green
Birmingham
B28 8AD

Email: info@sewauk.org
Telephone: 0121 777 4045
Website: www.sewauk.org

Sewa International a registered charity (No 1135425)
A company registered in England and Wales (No 6976220) and limited by guarantee
Registered Office: Sewa UK, 110 High Street, Edgware, Middlesex, HA8 7HF, United Kingdom

This leaflet was printed on paper from sustainable sources.