

THE CHARETTE



edition 1.2 – autumn 2022

a studio+ quarterly

Autumn





charette noun

cha·rette

variants: charrette \ she'ret \

definition: the intense final effort made by architects to complete their solutions to a given architectural problem in an allotted time.



THE CHARETTE

contents

1	damon's desk: a letter from the ceo	4
2	babcock high school	8
3	experts corner: security at the campus perimeter	14
4	projects on the rise	20
5	product parade	22
6	culture	30
7	events	46

damon's desk:

A letter from the CEO

School is in Session.

Summer is over, and school is back in session. As a Floridian, I'll admit I have a "love-heat" relationship with summer. The tireless humidity brings frustration yet, I am grateful for the long days, family weekends, fishing adventures, and everything in between. As my kids quickly approach their college years, I embrace our family's summer traditions to the fullest.

Unlike at home, workweeks do not slow at Studio+ in the summertime, but that does not keep us from maintaining our firm's summer traditions – company retreats, half-day Fridays, and inner office culture activities.

In the spirit of back to school, you'll find our autumn issue focuses on educational design – a market growing exponentially given our recent acquisition and growth of team members across our California and Florida offices. Within these pages, you'll find stories on inspirational school projects with designs that break the prototypical mold of traditional facilities. Diving deeper in the pattern of education, our design professionals provide innovative

concepts surrounding school security that safeguard students and teachers.

We are parents and citizens, so naturally we are proud to provide design solutions that inspire change, build community, and transform lives of students and educators around the nation.



Damon Romanello
CEO | Founder
Studio+



We create design
solutions that
inspire change

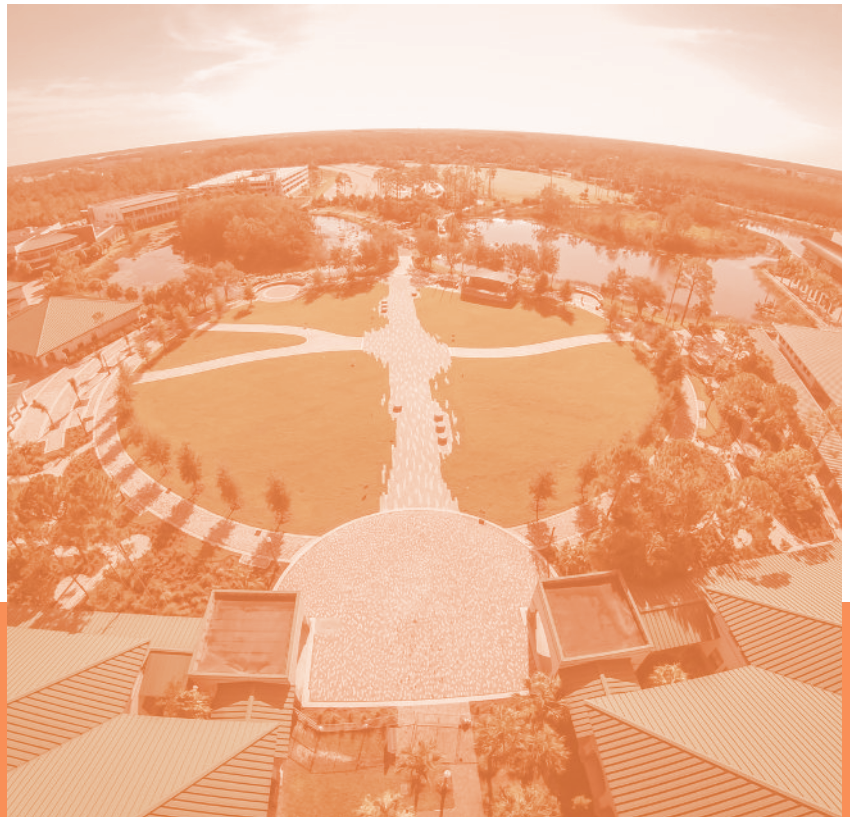

THE CHARETTE

autumn edition 1.2

contributors.

CREATIVE DIRECTOR Joy Brownworth

CONTENT EDITOR Brianna Quiggle

FACT CHECKER Tara Thompson

GUEST WRITERS

Taylor Brewington

Damon Romanello

Steve Bull

CONTRIBUTORS

Trevor Wright

Dinara Usmanhodjaeva

Jesse Kirkland

studio+

Studio+ provides a wide array of services within architecture and interior design across numerous markets including education, healthcare, senior living, and corporate. We unite these services to bring a unique product to our clients – seamless services that deliver results beyond typical expectations.

wearestudioplus.com

marketing@wearestudioplus.com

239.476.8888

12271 Towne Lake Drive
Fort Myers, Florida, 33913

about the cover.

Babcock High School

Consisting of approximately 43,000 square feet, Babcock High School is designed to reflect the project-based learning and STEAM education offered to this hometown community. BHS includes 26 classrooms, science labs, multiple assembly areas, wood-working areas, media rooms, and administrative offices. The new high school is situated south of the existing Babcock Neighborhood School, which serves kindergarten through 8th grade students, providing an easy transition into the high school years.

Additionally, Babcock Ranch is introducing The Hive, a centrally located open-office teacher's area on the first and second floor, which overlooks the open assembly hall and hallway corridors. The Hive is fully surrounded by glass to offer transparency while providing teachers and faculty a space to hold meetings, build out curriculum, and exchange information. This assembly hall boasts a large dual staircase and acts as a platform at the heart of the high school perfectly suited to relay school announcements and host group gatherings.

the editors.



BRIANNA QUIGGLE

communications & content strategist
studio+

From internship to senior associate, Brianna is a Studio+ veteran of eight years. We like to call her a jack-of-all-trades since she has had a hand in everything from public relations and marketing to finance and operations. She is a graduate of Florida Gulf Coast University with a BS in Marketing and currently guides strategic content messaging and proposal pursuits at Studio+. A Florida girl, despite her New England origins, Brianna resides in Naples, FL. When she is not seeking out information for the next content piece, she puts on her mom jeans and becomes CEO of the Quiggles.



JOY BROWNWORTH

creative director
studio+

Joy is an award-winning designer with a proven track-record of developing brand identities, strategic marketing campaigns, and new business development. Today you'll find her as the Creative Director at Studio+, where she is dedicated to company marketing and branding. Born in Texas, raised in Georgia, Joy graduated from the Savannah College of Art and Design with a BFA in Visual Effects. Outside the office, you can find her making plans to visit a new country or trying to lower her handicap on the golf course.

questions, comments, or concerns? email us at marketing@wearestudioplus.com



babcock h

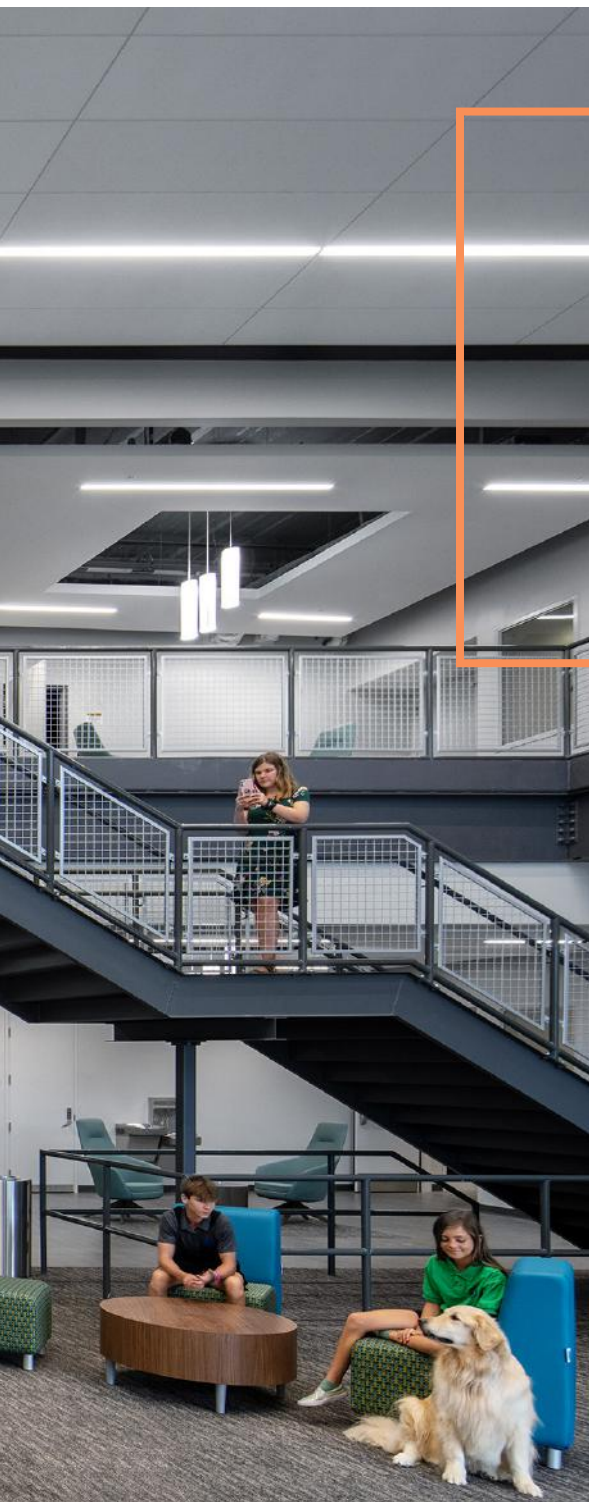

babcock high school:

Unlocking the power, potential, and future pattern of education

Babcock Ranch, America's first fully solar town, is known as the "Hometown of Tomorrow." Naturally, its school should be an extension of the community's ambitions to leave a tremendous impact on society with a **minimal footprint on the environment.**

To achieve this, Studio+ spearheaded a design team including leadership stakeholders from Babcock's existing K-8 neighborhood school, education experts at DAG Design, as well as an extensive team of educational engineering and construction experts. The end result is something truly special—a future pattern for how education can be enhanced through the built environment.

What's so different about this school?

Most modern schools are designed, built, and programmed according to a set prototype. They are highly institutional with little room for flexibility. If you were to tour two schools in two different states, you'd probably see a great deal of consistency between the two spaces. Babcock Ranch wanted something outside of the ordinary—so we went to the drawing table and created something new.

dog-friendly!

igh school

Learning Choice



A core element of the school's programming that would go on to guide and influence all of our design decisions was the idea of Learning Choice.

Learning Choice is an idea borrowed from entrepreneurial-minded start-up businesses. These businesses enable young employees to grow and thrive by creating highly flexible environments that can accommodate individuals with differing styles of work. Open environments, closed environments, collaboration, and isolation all have a spot in a Workplace Choice environment.

So, we brought this level of freedom into the realm of education.



What does learning choice look like?

The Babcock Ranch High School isn't just a building filled with classrooms. There are a variety of interconnected spaces beyond typical classrooms that work together to give students of all types an equal opportunity to succeed:



Gathering Areas

Two levels of common gathering space within the school have the capacity to host the entire student body.

Alcoves

Within the building are alcoves that help students escape the noise of the larger spaces for quiet studying, reading, and reflection.

Atriums

Large atriums connect rooms together, lending a sense of openness that is traditionally restricted by narrow corridors. The atriums themselves serve as additional gathering space.

Focus Rooms

Rooms designed for small group huddles introduce the idea that some students excel in smaller environments, and provide an environment traditionally unseen in a public school environment.

These alternative forms of educational spaces provide all new opportunities for young learners to excel in environments that are more reflective of the actual universities and workplaces that they will eventually attend.

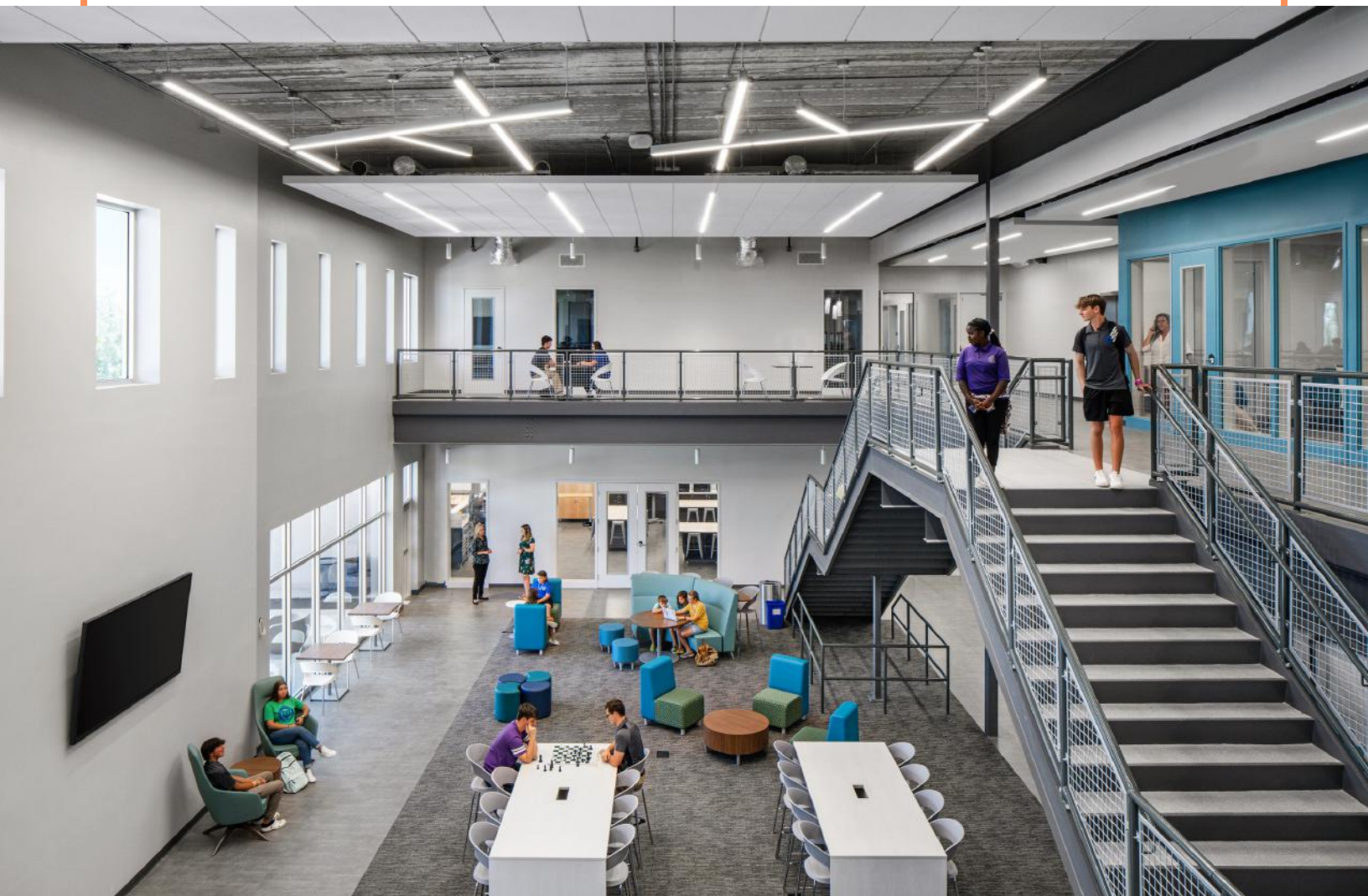

How does openness serve the student body?

The town of Babcock Ranch is all about celebrating and preserving its local ecosystem—so the school showcases the natural beauty of its surrounding neighborhood.

Beyond the drastic choice in incorporating far more collaborative, public spaces versus traditional classroom/corridor design, the key difference in the design of the Babcock Neighborhood High School is the **incorporation of openness**. Even in the most inward areas of the building, there are open lines of sight to the outdoors. Architectural glazing is incorporated throughout the entire facility, flooding the halls with beautiful, natural Florida light.

BNHS's openness extends beyond the structure of the building—it is part of an educational campus with an existing K-8 school and a neighborhood shelter. Covered walkways conjoin the separate buildings on the shared campus, lending even further to the university feel of the school. And while the buildings all serve different purposes, they speak the same design language with matching colors and exterior elements, all while remaining distinct and unique in their own right.



cohesive campus design



Is this alternative “open” approach to school design actually safe?

Safety is an ever-growing priority in the education field, and it remained on our minds during all phases of the design process. But we chose to believe that innovative, attractive design and effective means of protecting students could coexist.

To some, a school campus designed around openness and the freedom of student movement between different types of environments would present unnecessary risks. We’ve found that the **openness of the facility actually creates wide lines of sight for increased effectiveness of surveillance and observation.** Problems putting students at risk can be identified from a distance.

Beyond observation, a full perimeter protects the campus from outsiders wandering on. A badge system is incorporated into all campus entrances, ensuring that everybody at the Babcock Neighborhood High School has a good reason to be there.

By controlling the flow of people in and out, and maintaining persistent lines of sight, the Babcock Neighborhood High School is safe without feeling fortified.



A real reason to plant roots in a new community.

The idea of living in a solar-powered town is enough to perk up the ears of potential homebuyers, but an innovative school with impressive safety that prepares young adults for the future through an environment designed to promote Learning Choice is a real reason to plant roots in Babcock.

We believe this open, collaborative environment will inspire generations of young adults to reach higher and achieve great things. +

Author

Taylor Dupree Brewington is a writer and researcher focused primarily on subjects that express creativity and promote wellness. He frequently collaborates with industry experts to create compelling, publishable work in a variety of fields.



security

at the campus perimeter

⊖ Written by Steve Bull

Design should keep our kids safe

Over the past 20 years, schools have become the second most frequent target for an active shooter¹. This sobering statistic has quickly evolved the principles and philosophies of security design in K12 educational environments.

As architects, designers, and educational programmers, we must respond—policies, procedures, and planning must be set in place to mitigate risk and deal with emergencies quickly.



Districts are encouraged to research strategies with security consultants, architects, and law enforcement to ensure campuses create a safe learning environment. However, campuses all have unique architectural features, and even with consistent design principles, implementation will vary. We've highlighted some useful resources in the footnotes below².

We've identified three layers of campus security most impacted by building design, and will explore each layer individually over the next few issues of The Charette:

- I. Campus Perimeter Security**
- II. Building Security**
- III. Classrooms Security**

Today, we begin with a discussion on campus perimeter security.

¹ Partner Alliance for Safer Schools

² [Crime Prevention Through Environmental Design \(CPTED\) Principles](#); [Partner Alliance for Safer Schools \(PASS\) Safety and Security Guidelines for K12 Schools](#).

Campus Perimeter Security

Safety begins outside the school

Over recent years, defining and maintaining a “secure perimeter” from an active shooter has been a hotly debated topic at school board meetings across the country. Campus security naturally begins at the campus perimeter, and when properly implemented, effective perimeter security can protect students while still maintaining a comfortable, positive learning environment.

Creating a security barrier begins with evaluation of fencing products. Height should be 8'-0" minimum and “non-climbable”—openings in the fence must be too small to gain a foothold. With countless systems to choose from, today we’ll focus on three types of barriers: **ornamental, chain link, and welded wire.**

Prefabricated and custom ornamental fencing should be designed with vertical pickets so a ladder effect isn’t created. However, even prefabricated ornamental fencing is nearly twice as expensive as standard chain link. And even at a lower cost, chain link fabric still comes in a variety of options, including a non-climb mini-mesh. Manufacturers are now also creating a non-climbable welded wire mid-range option with small spacing that is tamper-resistant against bolt cutters.



ornamental

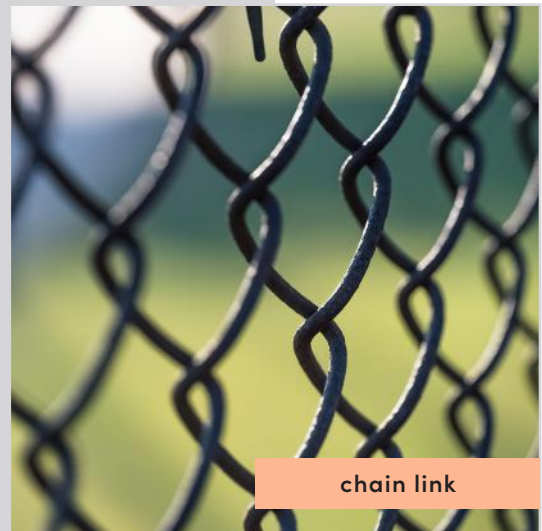

chain link



welded wire

Further, campuses can decrease linear footage of campus fencing by using **campus structures** to define the perimeter. If a school building is to be used as a piece of the perimeter, existing doors that have an outside exit must have proper door hardware and must recognize access to safe dispersal areas from the original design.

Like buildings, **planters** can serve as perimeter defenses. Planters installed on exterior sides with openings less than 8' wide can successfully deter potential vehicles from breaching the campus perimeter. However, they should be kept low to maintain interior-to-exterior visual surveillance.

Campus control through curb-to-core

A trending idea in perimeter design is the creation of a single-entry vestibule. This entry is staffed by a greeter who identifies visitors and permits/denies access into the school. This vestibule creates a high level of security, intelligence, and control without creating an overly militarized or institutionalized feel. Instead, security can feel welcoming and inviting.

If single vestibule entry is not an option, additional security solutions like voice communication or card access can be installed at additional strategic entry loca-

tions. This ensures campus visitors make contact with a trained staff member, who will unlock the door, prior to entry.

Controlled access gates should be locked from the exterior during school hours, with access on the interior side only during an emergency. Vehicle access should be a full height barrier if it penetrated the security perimeter. Vehicle maintenance gates should lock mechanically or electronically, and any fire access gates should utilize Knox boxes to give the fire department exclusive access.



continued ►

four final take- aways

The perimeter is only the beginning of school safety, and we are of the belief that schools can be safe without sacrificing quality design. We'd like to leave you with four additional brief ideas to further enhance perimeter security:



1

Signage.

During operating hours, signage should direct visitors to sign-in at the office. Hours of available public access as well as community groups should be posted. Prohibited items and notice of visual surveillance should be displayed.

2

Surveillance.

Wide-angle video surveillance at the perimeter allows visitors and loiterers to be observed and identified. Infra-red cameras are a solution for monitoring a campus that is closed at night. A perimeter that is well-lit (with motion sensors at a minimum) is vital, particularly at points of entry. Patrolling of the perimeter should occur once school is in session to ensure gates are latched—surveillance of the perimeter not only exposes loiterers, but also helps identify students attempting to leave unexpectedly.

3

Training.

Infrastructure can be funded and installed, but if it is not properly utilized or maintained, breaches may occur. Mistakes may happen: access doors can be propped open, latches can fail—the scenarios are endless. Routine inspection and maintenance are key.

4

Audit.

Have the local police and fire department audit your security perimeter once a year. The perimeter should be assessed to ensure it is intact with no openings below the panels. Access gate hardware should be inspected, particularly the closers and latches, to ensure the gate is automatically locked. Check lights, cameras, and communication devices to ensure it works as intended. +



Steve Bull is a registered architect with over 26 years of experience and serves as Principal in the Studio+ Orange County office. With a passion for collaborative solutions, Steve manages complex project teams within various disciplines, and remains focused on the future generation's well-being in the educational environment.



**GULFSHORE
BUSINESS**

**BEST
OF
BUSINESS
2022**

THANK YOU FOR VOTING US GULFSHORE BUSINESS

BEST COMMERCIAL ARCHITECTURE FIRM



**THANK YOU FOR ALSO AWARDING US A FINALIST IN
BEST COMMERCIAL INTERIOR DESIGN FIRM**

A large orange circle representing a sun is positioned in the upper left. Below it, several dark grey mountain peaks are shown, some with white outlines and others filled with fine horizontal lines. The text 'PROJECTS ON THE RISE' is arched over the top of the sun.

PROJECTS ON THE RISE

recently awarded projects.

LEE HEALTH

Continuing Services Contract for Outpatient and Acute Care

Studio+ has been awarded the continuing services contract with Lee Health in which we provide architectural and interior design services for both Outpatient and Acute Care projects under a \$4 million dollar construction cost through 2026.



UNIVERSITY OF SOUTHERN CALIFORNIA

Seaver Science Center Labs

Professional design services related to alterations within existing labs 115, 117, and a full remodel of lab 320 in the Seaver Science Center (SSC).



POMONA VALLEY HOSPITAL MEDICAL CENTER

1818 Building Renovation

Architectural planning services for office tenant improvements in Suites 305 and 308 at the 1818 Orange Grove Avenue building.

UNIVERSITY OF SOUTHERN CALIFORNIA

Thornton School of Music

Architectural services for alterations to Office L414 and Records Storage L416 on the lower level of the Northwest Building.

LEE HEALTH

Gateway Building

30,000 SF renovation of space on the first floor of the Lee Health building in Gateway Florida. The work consists of the new lobby and café, computer classrooms and training classrooms, offices and cubicles, new sim lab, bathroom upgrades.

LEE COUNTY

Library Administration

The project involved the interior build-out of the 4th floor of the Lee County Administration East building. The space will be occupied by the administrative offices of the Lee County Library System.

LEE HEALTH

Cape Coral Hospital Angio

Renovation and reconfiguration of the IR suite at Cape Coral Hospital to accommodate two new IR Rooms, a control room, and associated spaces.

NEWPORT HARBOR HIGH SCHOOL

Home Arts Courtyard

Architectural services related to kiln yard revisions and gender neutral restroom renovations within the Home Arts Courtyard at Newport Harbor High School.

LEE HEALTH

BCHC Adult GI Renovation

Renovation of existing suite 2310 located on the first floor of the Bonita Community Health Center, which has a total area of 4,463 SF.

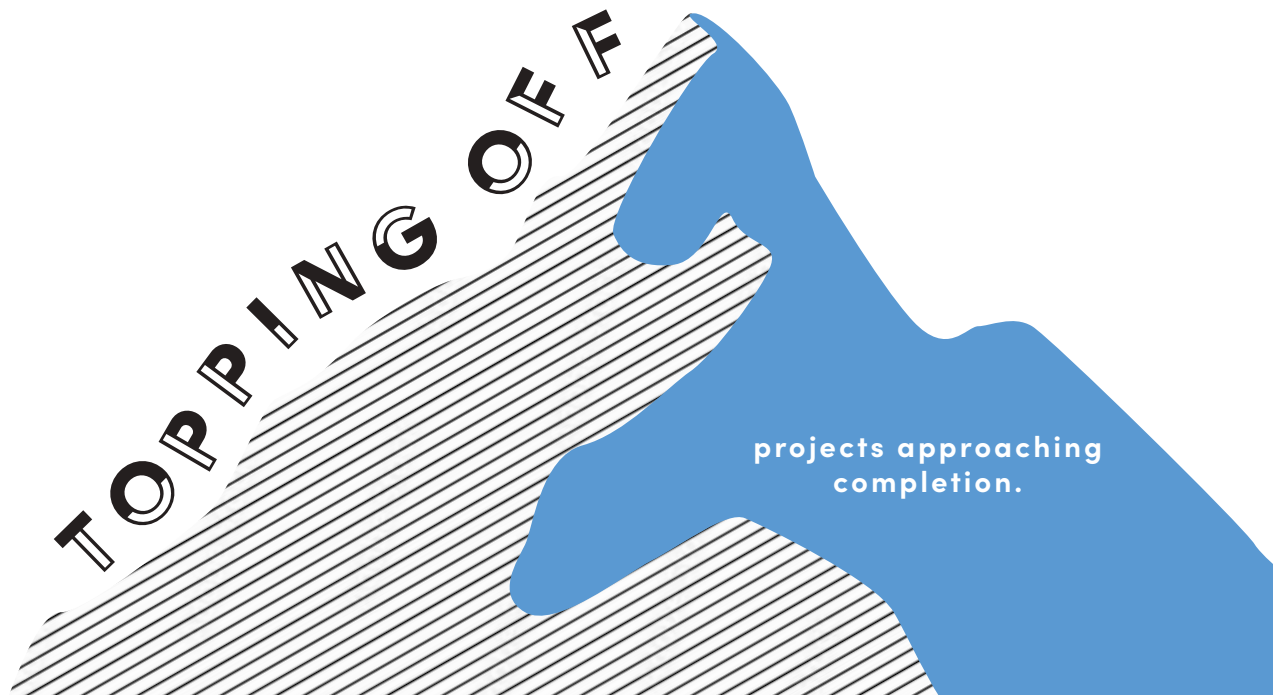

product parade

innovative products, from brands we love





Haworth Compose Echo



With mobile elements and a design made for movement, Compose Echo lets people fluidly maneuver and shift between individual and collaborative workstyles to support the dynamic range of work activities.



The future of work is in motion

Compose® Echo is a scalable workplace system that redefines flexibility, creating dynamic team spaces where both individual and collaborative work happen fluidly. Each element was thoughtfully designed to fit together to maximize space and human performance, with the freedom to easily switch between work modes. **Compose Echo moves the way you do**, to support a variety of workstyles now and respond to workplace needs of the future.

HAWORTH

representative contact

Janelle Pusateri | janelle.pusateri@bos.com
bos.com



High luxury in a modest package

A spherical polycarbonate diffuser smoothly distributes the light source, which is then refracted through the high clarity crystal structure. The handmade crystal core is balanced with a flush fitting shade in a variety of insightful finishes. Humbly luminous on its own, or arranged in numbers. Easy on-site height adjustment and magnetic easy-installation canopy.



representative contact

-

Jason Bridge | jbridge@envisionlightingsystems.com
envisionlightingsystems.com

Eureka Monk Lighting



Squad Goals: An ideal fixture for clustering and combination, capable of filling and brightening large spaces.

Hokki Stool

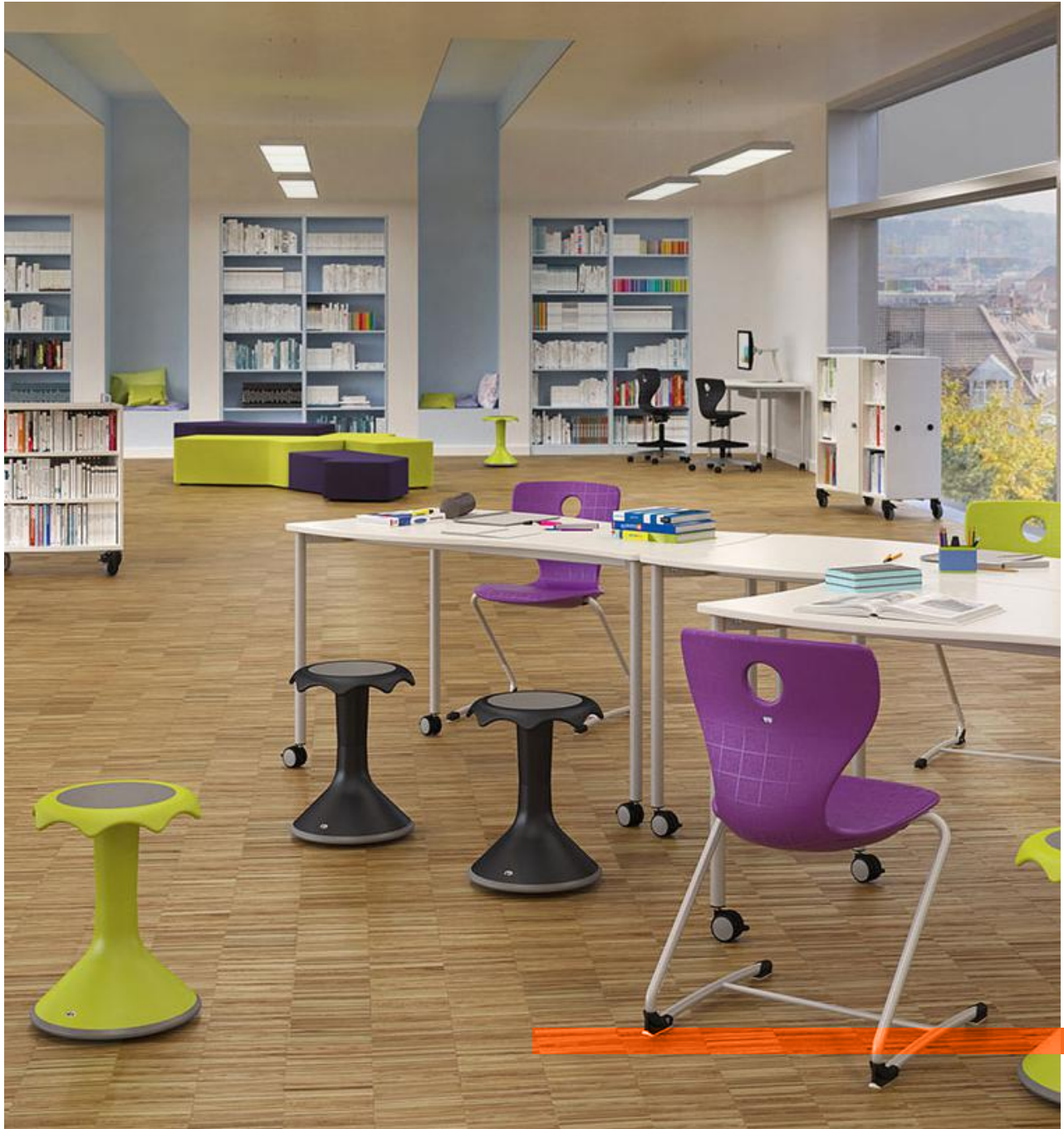

When picking out furniture for your modern classroom, consider the seat preferred by parents, teachers, and kids alike. With an appealing design focused on safety and well-being, the Hokki stool will have your students happy to take their seats.



Iconic wobble

The Hokki stool offers freedom of movement in controlled conditions thanks to curved surfaces that stimulate the entire musculo-skeletal system. The wobble motion and **support for the spine** and posture make for superior focus, natural breathing, and improved mental agility. Lightweight, stackable, and equipped with an innovative hang on desk feature, the Hokki stool is **perfect for maximizing space**. Height adjustable models available with all-round activation mechanism and ergonomic depth suspension.



contact information

info@vsamerica.com
hokki.com



culture: breeds PRODUCTIVITY



studio+

new faces

Wendy Gilmartin, AIA, LEED AP

Managing Principal



Los Angeles, California



about wendy

My professional background combines architecture, communications, organizational leadership, and business strategy. I bring a broad skill set, multidisciplinary perspective, and rigorous analytical process to each of our projects. At the Studio+ Los Angeles office, our team develops projects which actively support communities. Our approach combines technical know-how and a client-first approach, combined with an expert knowledge of building in the region.

I'm also a faculty member at the Architecture Department at California State Polytechnic University in Pomona, where I'm lucky to mentor young talent in our field. I'm an active member of the AIA, serve on the Advisory Board of the Los Angeles Forum for Architecture & Urban Design, and I publish an occasional op-ed in the Los Angeles Times.

Prior to my life in Architecture and design, I was a music critic for 10+ years with LAWeekly newspaper. I stay engaged in the music scene by seeing as much live music as I can, and by volunteering with the non-profit organization "Rock n Roll Camp for Girls Los Angeles," where I've been a camp counselor and band coach.

Outside of the office, I'm the proud dog mom of my retired racing greyhound, Taffy, who keeps me on my toes. I'm a lifelong L.A. Dodgers fan and I "bleed blue." I'm proud and passionate about LGBTQ issues facing my community and I work to serve as an advocate for marginalized groups our profession has historically excluded.

want to work at studio+?
apply at wearestudioplus.com/careers

retur

about sandra

My name is Sandy Troffer. I am a relentless achiever and I love new challenges and the opportunity to learn, grow, share my expertise, and help others to do the same.

I was raised in Maryland and moved to upstate New York to complete my formal architectural education at Rensselaer Polytechnic Institute, with time studying abroad at Tongji University in Shanghai, China. After graduation, I've lived and worked in Washington DC, Kazakhstan, and now Florida. My experience in architectural markets is diverse, from science and technology and governments facilities, through health-care, education and senior living. I'm passionate about evidence-based design and designing spaces to best serve, care for and support end-users and occupants. Architecture should be useful, healthy, empathetic and engaging.

Community is also very important to me, which is why I'm so glad to start our office in Lakeland. To be able to serve, support and help grow other people and businesses in the community where I live with my family is such an impactful opportunity and I am so grateful for it.

I believe the best work comes from teams of people with diverse talents and perspectives. I believe a good argument can and should lead to learning on both sides and better outcomes and solutions in the future. I love collaborating with people who think differently than I do for this reason.

Outside of work, I love spending time with my family and friends-- traveling, hiking, kayaking, crafting, building, volunteering and learning. I also love any opportunity I can get to visit the many preserves, springs and parks close to me in central Florida.

want to work at studio+?
apply at wearestudioplus.com/careers

ning faces

Sandra Troffer, AIA, WELL AP, LEED AP, EDAC

Principal



Lakeland, Florida





We are providing leadership training to everyone!

We are incredibly excited to announce a firmwide, 12-month leadership program we've begun to deliver meaningful education and leadership development to everyone in Studio+. These trainings are not only an investment into our team's future at Studio+, but in all aspects of their lives!

Leadership Facilitator

Adam James facilitates all trainings. He has extensive leadership development experience and is also the founder of the Mindful Journey (journeymindful.com). The Mindful Journey is an online community committed to well-being and performance featuring mini-courses, weekly challenges, monthly group coaching calls, live guest interviews, a digital journal, etc. Additionally, all Studio+ team members receive a free yearly membership to the Mindful Journey!

We could not be more excited about making this investment in all Studio+ Team Members and really look forward to giving everyone meaningful training to become better, stronger, and more confident in both their professional and personal life.

"Leadership has often been perceived as an esoteric concept and an attribute held only by individuals who have an innate ability. Though some may naturally possess characteristics that enhance their likelihood to be an effective leader, the truth is, leadership can and should be learned. One of the many components being unpacked and learned in our time together is how to lead toward a compelling vision."

- Adam James

63%

**WANT MORE
PURPOSE**

In a 2021 study conducted by McKinsey & Company, sixty-three percent of workers surveyed across varying industries noted that they want more purpose in their work.

Purpose is directly aligned with vision. In other words, if team members within an organization don't feel as though they have something they're working toward, and there's not a compelling vision for the future, it's likely they'll do the bare minimum to get by in their role and/or look elsewhere for work.

key take aways

To help lead others toward a more compelling vision, you don't need a fancy title, a certain designation, or a distinguished degree. Whether you lead a team of one hundred, or lead internal processes, below are a few components essential to helping others see and believe in that vision:

Clarity.

What's the end goal?

Many often assume that people understand the expectations. Truly effective leaders don't work off of assumptions though. They consistently remind their team of what they're working toward and outline the steps to get there. Ambiguity is diminished and clarity embraced.

Optimism.

Conveying hope even in moments of despair.

Optimism isn't about lying to yourself or others about what's happening. It's about embracing what is but having the courage to identify new ideas, strategies, etc., and then sharing with others how the implementation of such will allow for effective navigation through the potential hardship.

Consistency.

Doing what you say you're going to do.

The surest way to decrease trust in any relationship is to do the opposite of what you said you'd do. When leaders actions are consistently in congruence with their words (and the organization mission, vision, & values) team members become more inclined to follow because they trust where they're going.

Passion.

How do you show up each day?

Though passion isn't a tangible that can be quantified, it's undoubtedly able to be identified. As leaders, showing up in the workplace with negativity, low energy, and/or minimal passion sends an unspoken message that you don't care about the future. And if you don't care, why would others care?

Below are a few questions to consider and help measure your potential effectiveness as a leader:

1. Are you a leader that you'd like to follow? Why or why not?
2. Does your work and effort empower others? How do you know?



Studio+ team members participated in a company-wide walking challenge! We set-up our tracking system through an app called The Outbreak, where virtual teams compete against one another to “outwalk” the zombies lurking not too far behind...

Company walking challenges
are a great way to explore your
city, build comradery, and create
more healthy habits!

We passed our
company goal of
9.4MM steps over 6
weeks with a total of
**12,585,000
steps!**

DID YOU KNOW?

It takes **20 million steps**
to go around the Earth

10.8 million steps along
the Amazon River

And 7.5 million steps to walk
across the United States

The Outbreak: Escape™ is your
new favorite excuse to exercise.
Your real-world activity fuels your
in-game character. Will you survive
the wasteland and earn your medal,
or will you become zombie food?

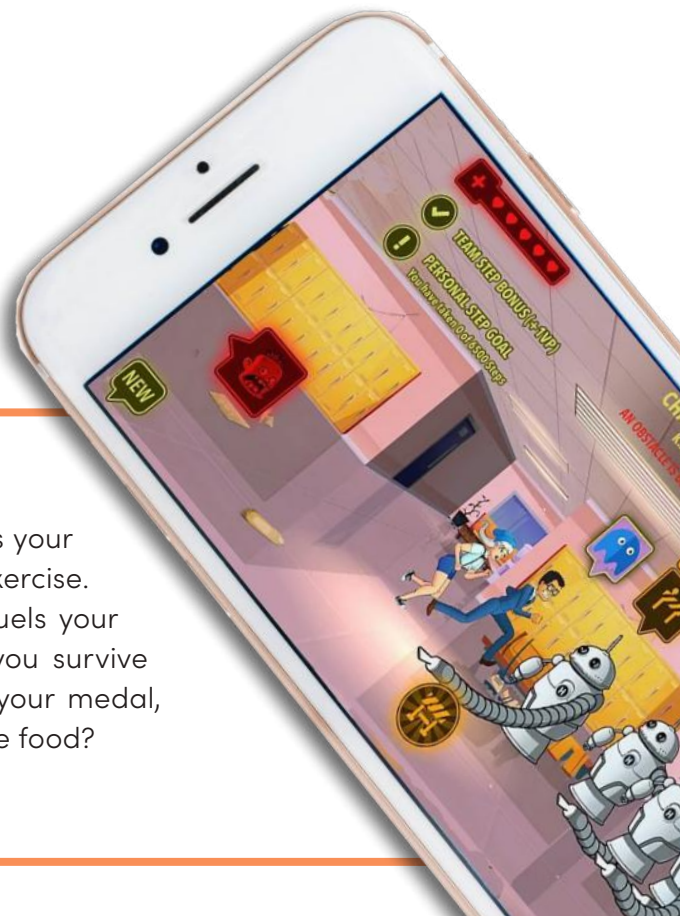



ten year anniversary // celebrating a decade of design

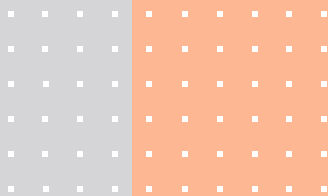

Reflecting on the past 10 years and saying 'thanks' to our clients, our community, and our employees for the progress and evolution of Studio+.

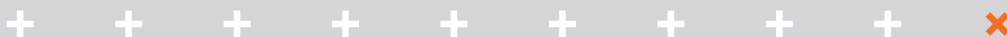
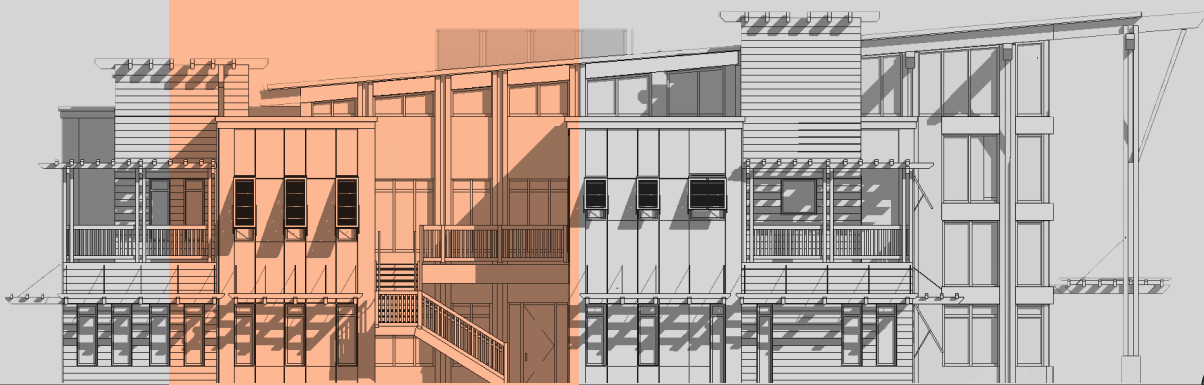

REFLECTION

As our anniversary celebrations near a close, we look back on ten years of company milestones, employee recognition, and client satisfaction. We've taken the time to reflect on how far we have come and how those experiences have shaped where we are headed. Thank you for being a part of our journey, and may the future be as gracious to you as it has been to us.

10

10 YEARS & 10 ACTS

We celebrated our community by doing an act of kindness for each year we have been in business. From beach clean-ups and blood drives to monetarily supporting our local organizations who do so much behind the scenes of our community. Our 10 acts of kindness have not only benefit the surrounding community, but they have built stronger relationships amongst our team members and our families.



\$30K

Over \$30K worth of donations and sponsorships were collected and distributed to local community organizations.



140+

Over 140 volunteer hours spent on community initiatives.



DECADE of DESIGN

Look out for our upcoming book, Studio+ Ten Year Anniversary: Celebrating a Decade of Design, where we've captured our most coveted projects. Whether it was from their grand design or the lives they continue to support today, the stories and images contained in this book are all connected. The faces of our team and the size of our projects have grown, but every single project you'll see within started with the same question: how can this project transform lives?



ANNIVERSARY CELEBRATIONS

SEPTEMBER

Brianna Quiggle 9 Years
Jonathan Trevett 2 Years
Hemal Tilvawala 1 Year

OCTOBER

Damon Romanello 11 Years
Andrea Gil 11 Years
Mark Shannon 11 Years
Valerie Marino 11 Years

NOVEMBER

Maria Villa 6 Years
Dushan Milinovich 1 Year
Austin Newcomb 1 Year

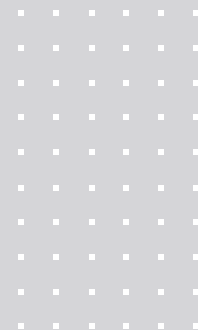

back to

Summer is over and our future architects and designers head back to the classrooms. Check out the fun from their first day of school!

school



Learning today. Leading tomorrow ☺





BLANKET FORT
ARCHITECT

SANDCASTLE
DESIGNER

BUILDING BLOCK
EXPERT

I AM THE FUTURE OF
studio+

events



JOIN OUR WELLNESS INSPIRED BBQ!

September is National Wellness Month!
Join us at our BBQ, where we will serve up
wholesome food, on-site health screening,
nutritional recipes, and wellness resources to
bolster your physical and mental well-being.

Studio+ is hosting OnSpot Dermatology's
Mobile Clinic to provide full body screenings.
Pricing will vary depending on insurance.
Use the QR Code below to register now!

12-2PM | SEPT. 23, 2022
12271 TOWNE LAKE
DRIVE FORT MYERS

ONSPOT
DERMATOLOGY 
REGISTER AT LINK BELOW

RSVP NOW



Visit www.onspotdermatology.com/studioplus to register for your screening!

NO TRICKS,
ONLY TREATS.



SAVE THE DATE AND JOIN OUR
**SPOOKTACULAR HALLOWEEN PARTY
& COSTUME CONTEST**

COSTUME CONTEST
BITES AND BOOS
A WICKED GOOD TIME



10.28.22

October 28th, 2022 12-2pm EST
12271 Towne Lake Drive
Fort Myers, Florida 33913





THE CHARETTE

studio+

the charette | studio+ quarterly
edition 1.2
autumn 2022

email us to subscribe
marketing@wearestudioplus.com

www.wearestudioplus.com