

Healthcare Design

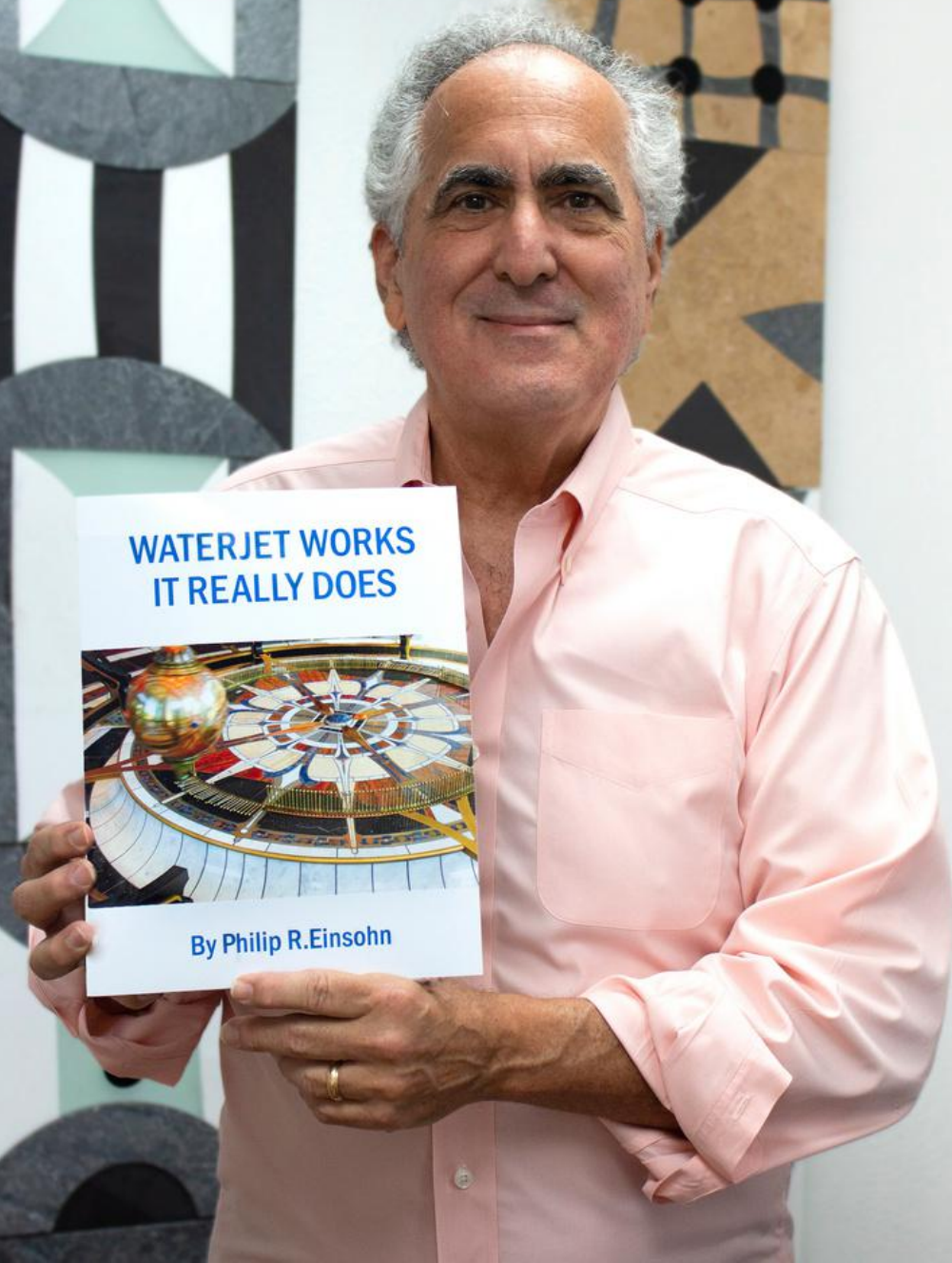

WATERJET WORKS

Est. 1999



Philip Einsohn launched Dallas-based Waterjet Works in 1999. He developed it into a unique business focusing on waterjet design for education, health care, hospitality, commercial, residential and interior design, architecture, civic spaces, and public art.

Precision Waterjet design allows your art to shine, not the lines. Waterjet technology will cut tight-fitting, intricate shapes, fine points, and curves in most resilient materials.



Acoustical
Carpet: Tiles and Broadloom
Glass
LV Plank and LV Tile
Laminate Plastic
Marmoleum
Metal (aluminum, stainless steel, steel, copper, brass)
Mosaic Tiles
Porcelain
Rubber
Stone
Terrazzo Tiles
VCT
Wood

Our machines can cut 95% of requested materials and can also combine materials, like mosaic and brass or stone and stainless steel (the other 5% is logical).

Lakeland
Regional Health
Medical Center
Lakeland, FL
2001







WW
WATERJET WORKS™



WW
WATERJET WORKS™



**Monroe Carell Jr.
Children's Hospital at
Vanderbilt University
Nashville, TN
2002**











Earl Swenson Associates

Architecture

May 12, 2005

Philip Einsohn
Waterjet Works
11305 Indian Trail
Dallas, TX 75229

Dear Philip,

Vanderbilt Children's Hospital turned out better than we imagined. We have numerous companies to thank for that success. We were given a great opportunity to design a world-class children's hospital. We knew we could design it, but we were unsure of whether we had the support of the trades to implement our designs in an economical manner. Waterjet Works helped eliminate our concerns not only on the craftsmanship aspect of the floors, but also from an economic perspective.

That only tells part of the story. As you know, the number of details, and approval drawings was rather large. If ESa didn't have a company like yours who would take the time and interest to understand and support our thinking, we would have had a very different looking project. The floors were an integral part of the overall design and your input, and coordination with James Smith was invaluable.

We now understand how important writing specifications are for the waterjet cutting process. We would probably still be there if hand cutting had been an option. ESa has received numerous accolades on Vanderbilt and we want you to know how much we appreciate all that you did towards the success of the project.

Sincerely,

EARL SWENSSON ASSOCIATES, INC.

Molly Alspaugh, IIDA, ASID

Molly Alspaugh, IIDA, ASID
Interior Designer

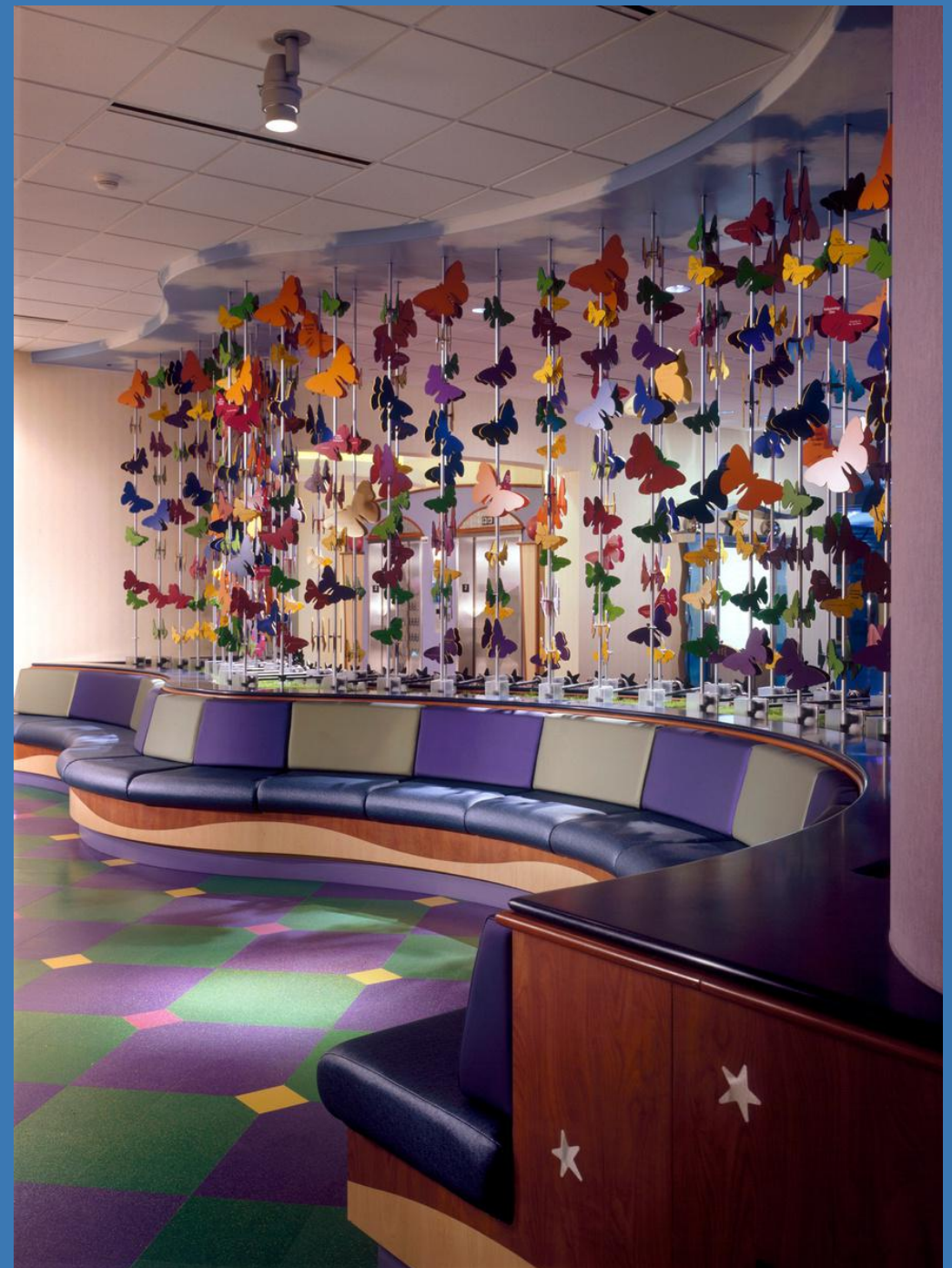

Covenant Women's Center





Children's Medical Center Dallas, TX

**Scottish Rite
for Children**
Dallas, TX



Baylor, Scott & White Medical Center Temple, Texas





waterjetworks.com



waterjetworks.com



waterjetworks.com



waterjetworks.

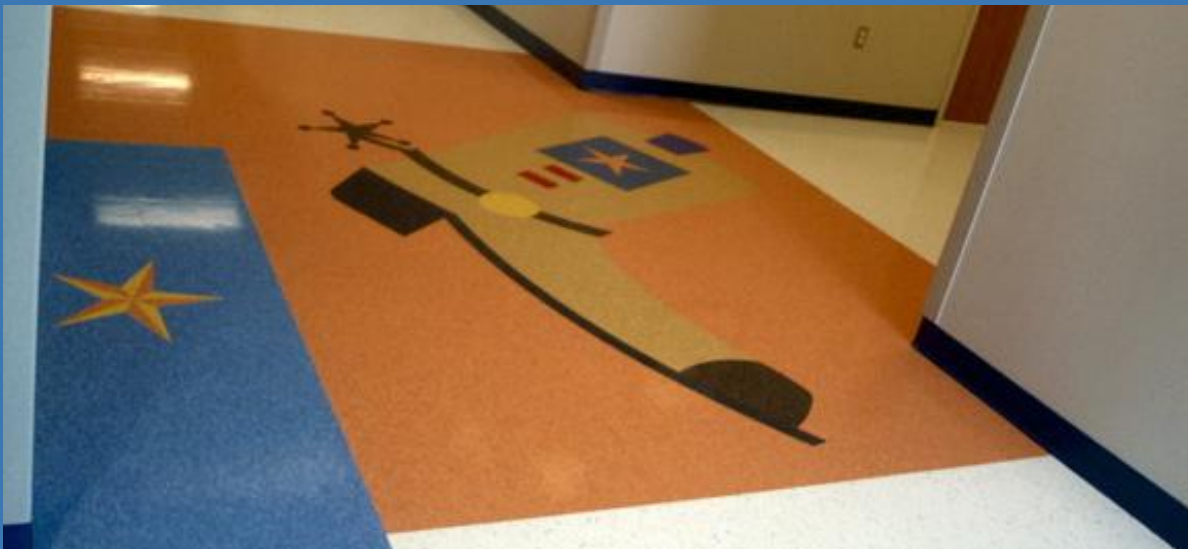

waterjetworks.com



**John C. Lincoln
Medical Center**
Phoenix, AZ





MD Anderson Cancer Center

The University of Texas
Houston, TX





**Holmes Regional
Medical Center
Melbourne, FL**





San Jorge Women & Children's Hospital

San Juan, Puerto Rico





**Children's of
Alabama**
Birmingham, AL





Nemour Children's Hospital Orlando, FL



Kadlec Regional Medical Center Richland, Washington

Material: Linoleum











Arkansas Children's Hospital Little Rock, AR

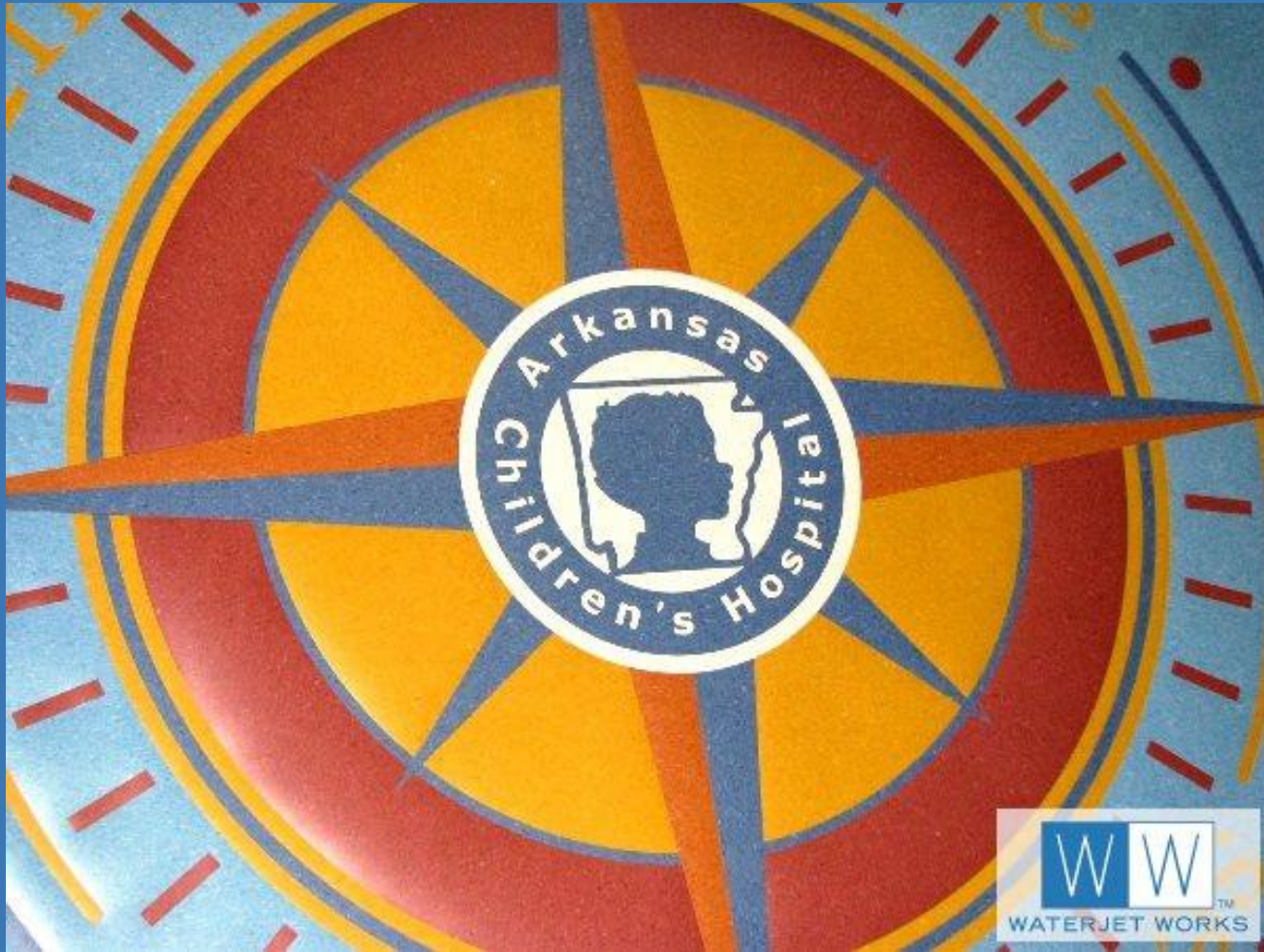



**Kapi'olani
Medical
Center for
Women &
Children
Hawai'i**



NOTES: Waterjet cut portion must be dry laid prior to installation. Prior to installation, we encourage you to confirm substrate is flat.

Due to shifting of material in shipping, contractor must remove face tape immediately after placement for final adjustment.



WORK SPECIFICATIONS: Sheet panel size = 47" x 96"
Quantity = 1

Material Grain Direction North - South Benchmark Grid starts here

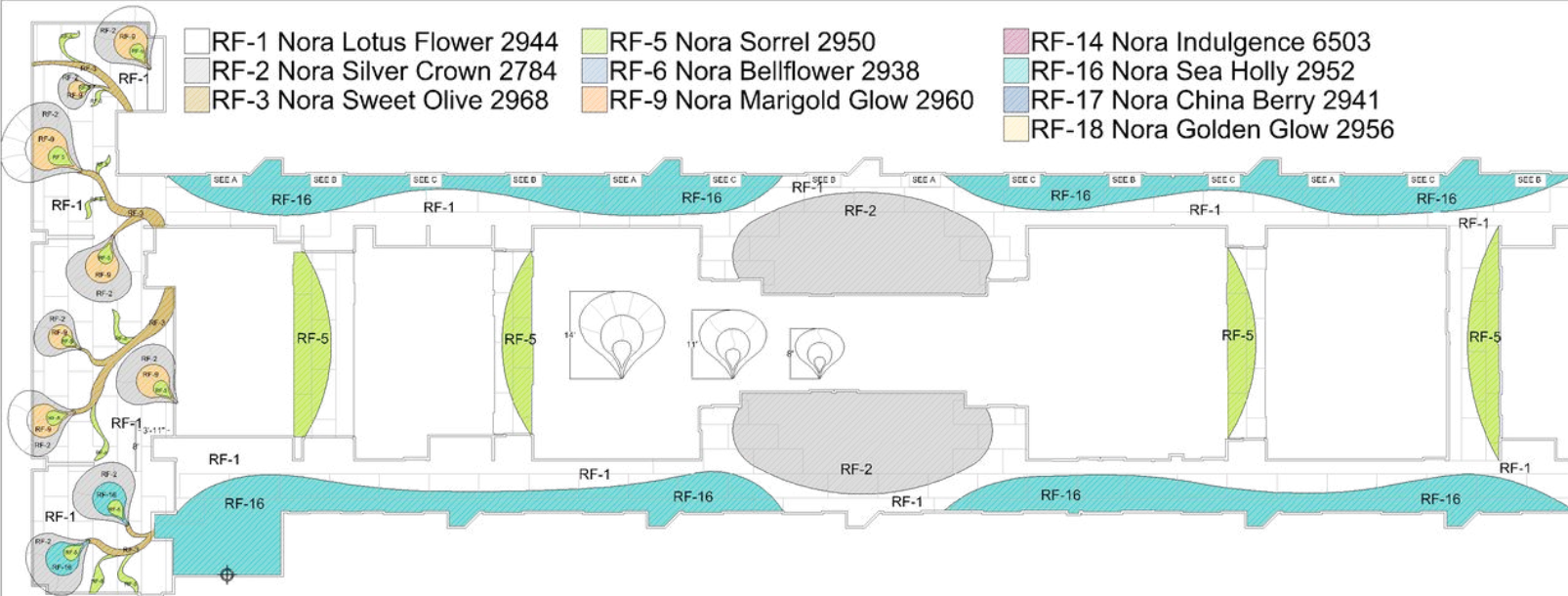

- RF-1 Nora Lotus Flower 2944
- RF-5 Nora Sorrel 2950
- RF-14 Nora Indulgence 6503
- RF-2 Nora Silver Crown 2784
- RF-6 Nora Bellflower 2938
- RF-16 Nora Sea Holly 2952
- RF-3 Nora Sweet Olive 2968
- RF-9 Nora Marigold Glow 2960
- RF-17 Nora China Berry 2941
- RF-18 Nora Golden Glow 2956

WORK NOTES:

- Materials provided by client.
- Please verify material schedule, color placement, geometry, dimensions, grid placement, and grain direction.
- Project installer responsible for final placement.
- Design lines or pattern to extend 4" or one full additional tile of design material is shown at wall or door edge.

MATERIAL SCHEDULE

A
Qty. 4

B
Qty. 5

C
Qty. 5

APPROVAL DRAWING

Company : Spectra
Project : Kapio'lan Med Center
Section : Level 5
Job Number : 14124
Date : 4/13/2015
Programmer : CL

NO EXCEPTIONS TAKEN
 MAKE CORRECTIONS NOTED
 REVISED & RESUBMITTED
 REJECTED - NO SUBSTITUTIONS
 REJECTED
 NO ACTION TAKEN

Approval: Desg. Review No.: 1 2 3
By: _____
Date: _____
Internal review: _____

A1.0
Drawing Sheet No.









Sanford USD Medical Center
Castle of Care Children's
Hospital
Sioux Falls, SD





Waterjet Works: Sanford Children's Hospital



Share



Watch on YouTube



**Knapp
Medical
Center**
Westlaco, TX





WW
WATERJET WORKS™



WW
WATERJET WORKS™



WW
WATERJET WORKS™

Joe DiMaggio Children's Hospital Hollywood, FL



Banner Children's Specialists

Phoenix, AZ



The Children's Hospital at St. Francis Tulsa, OK



Mercy Hospital

Kansas City, KS



Montefiore Medical Center
New York, NY



South Texas Health System Children's Edinburg, TX



Dr. Radwan
Private
Practice



Cardwell Collaborative

El Paso, TX







Fenton River
Veterinary
Hospital
Tolland, CT



Yuma Regional Medical Center Cafeteria Yuma, AZ



**United States of America
Department of
Veterans Affairs**

El Paso, TX

2020





United States
of America
Department
of Veterans
Affairs
Ohio



U.S. Dept. of Veterans Affairs Logo

Material: LVT

Approval Drawing

NOTES:

- Waterjet cut portion must be dry laid prior to installation.
- Prior to installation, we encourage you to confirm substrate is flat.
- Due to shifting of material in shipping, contractor must remove face tape immediately after placement for final adjustment.

WORK SPECIFICATIONS: Tile Size = 12" x 24"
Quantity = 1

Material Grain Direction East - West

Code	Description
LVT1	Panel LVT6 with tile
LVT2	Panel LVT6 with tile
LVT3	Panel LVT6 with tile
LVT4	Panel LVT6 with tile
LVT5	Panel LVT6 with tile
LVT6	Panel LVT6 with tile
LVT7	Panel LVT6 with tile
LVT8	Panel LVT6 with tile
LVT9	Panel LVT6 with tile

APPROVAL DRAWING
Company : Diversified
Project : Department of Veterans Affairs Logo
Job Number : 21159
Date : 19 January, 2022
Programmer : DC

Approved (Sig. Name) by: _____
Date: _____
Material order: _____

A1.0



Final Installation



Have you walked a Labyrinth?

Inspire
meditative
moments
in your
healthcare
design.

Material: Waterjet cut
Mannington Carpet



www.waterjetworks.com

Sensory Motor Corridor Milford, OH



Shriners Hospitals for Children
Galveston, TX



Give our exhausted Healthcare Heroes a hand. Integrate bold ADA accessible graphics.

Increase safety by visually indicating which way automatic doors swing open. In or out?

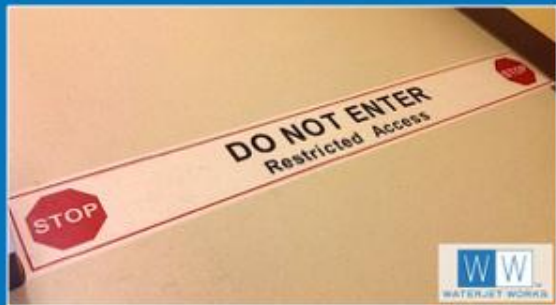

Rubber



VCT



Rubber

Numbers, Letters, & Symbols in Carpet, Ceramic Tile & more.

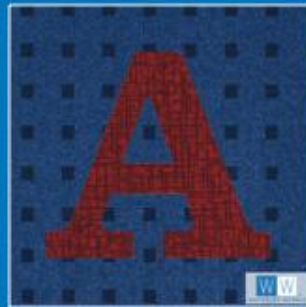
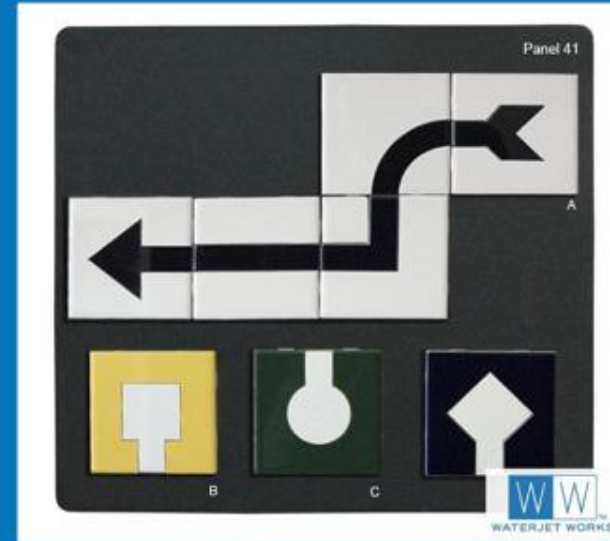
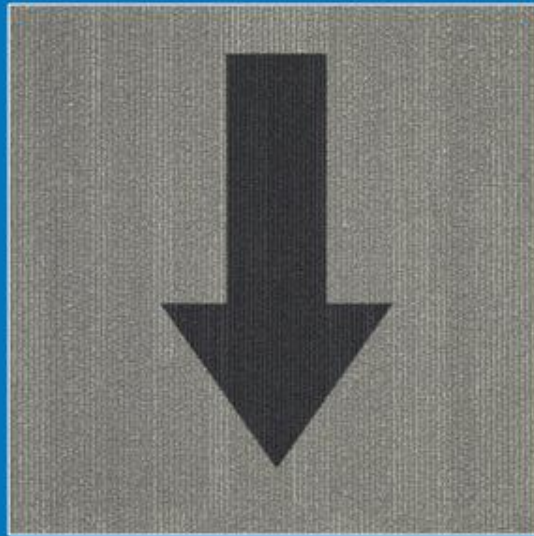

Baylor, Scott & White

Ft Worth, TX



Dentistry Logo





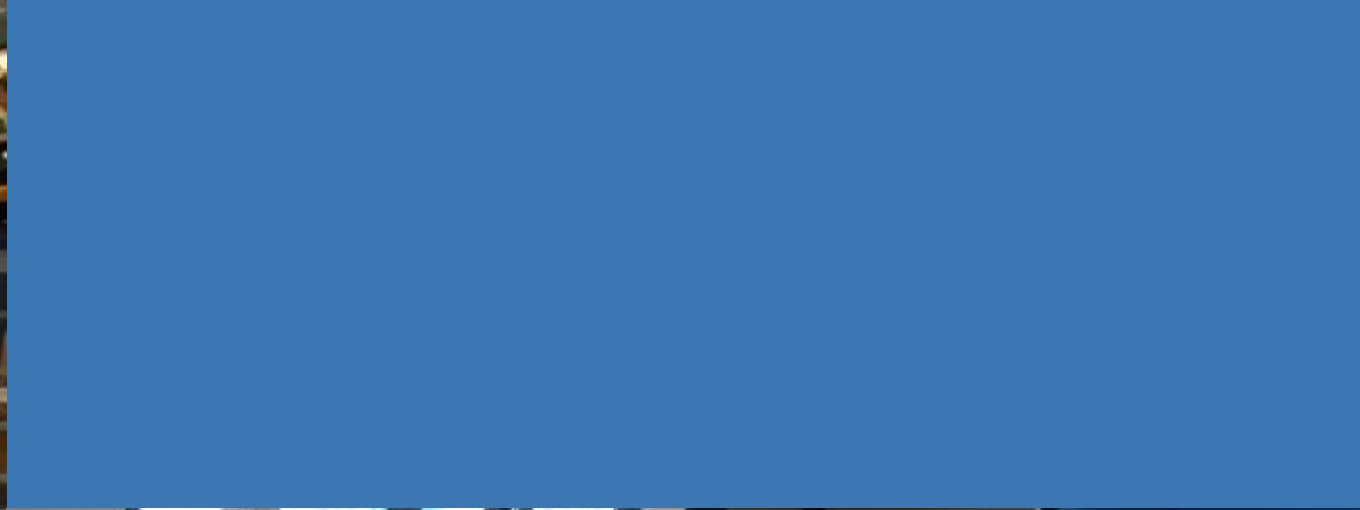

How does it work?

How do I request a quotation for my Healthcare Design project?

Email service@waterjetworks.com and include:

1. Project Name and related architect/designers.

2. Your Address, Phone Numbers, Email.

3. How did you hear about us? Referral? Manufacturers? Google?

4. Details:

- Materials
- Who is providing materials? Customer Provided or Waterjet Works?
- High-res Artwork / Floor Plan (PDF, JPG, PNG, Autocad, Napkin)

What's the process once I've submitted an RFQ?

Step 1: A proposals is generated.

Step 2: When the proposal is signed, WW will generate a deposit invoice. Receipt of the deposit will generate an acknowledgment.

Step 3: Receipt of the signed acknowledgment and the deposit, will begin the approval drawing process.

Step 4: After approval drawings have been internally reviewed we will send for customers signature.

Step 5: Upon receipt of signed approvals, we will provide material requirements.

Step 6: Upon receipt of materials, we are generally 4-6 weeks from shipping.

Step 7: As production begins you will receive progress updates and a final invoice.

Step 8: When accounting notifies customer service of receipt of final payment, we will ship your order.

Step 9: Shortly after your shipment is picked up, customer service will send an installation map and tracking number for your shipment. Freight will be quoted only at time of shipping, not up front.

Sample Proposal

crm.zoho.com

Field Incorporated: Yes	Materials: Luxury Vinyl Tile
Grain Direction:	Manufacturer: Patcraft

Lead Time: 4-6 weeks after receipt of signed approval and materials.

Description:
Waterjet cutting approx. 10' Diameter Department of Veterans Affairs logo in 9/10 colors of COM Patcraft LVT.

Logo consists of an eagle grasping (2) flags with (5) stars above the eagle. In the outer band there are the words "Department of Veterans Affairs" "United States of America" and a rope band.

Terms & Conditions:
Please Note: Current lead times vary from 4-6 weeks from receipt of materials and signed approval drawings. Waterjet Works will work with you to provide a more focused lead time upon receipt of signed acknowledgment and required deposit. We appreciate your business.

Item	Description	Qty	Unit	Total
1. Luxury Vinyl - Logo	Waterjet cutting approx. 10' Diameter DETAILED Department of Veterans Affairs logo in 9/10 colors of COM Patcraft LVT. Logo consists of an eagle grasping (2) flags with (5) stars above the eagle. In the outer band there are the words "Department of Veterans Affairs" "United States of America" and a rope band. Plank field is included. Please Note: Waterjet Works logo must be installed prior to the adjacent field to insure proper placement of planks.	1	\$ 10,645.00	\$ 10,645.00

Grand Total \$ 10,645.00

** Please note: WW logo and included field should be installed before the balance of the field. **

*** Successful installation of your material is predicated on a flat surface ***

Signature: _____ Date: _____

Notice to Proceed Signature and Date
Please Email Signed Proposal to service@waterjetworks.com

 **Thank You!**

Terms and Conditions

Quote is valid for 60 days
50% Deposit due with order. Balance due prior to shipping. Freight will be added.
Programming fee covers the first approval drawing as well as one revision.
Any further revisions may incur a reprogramming fee.

(For Steps 1 - 3)

Rendering



Approval Drawing

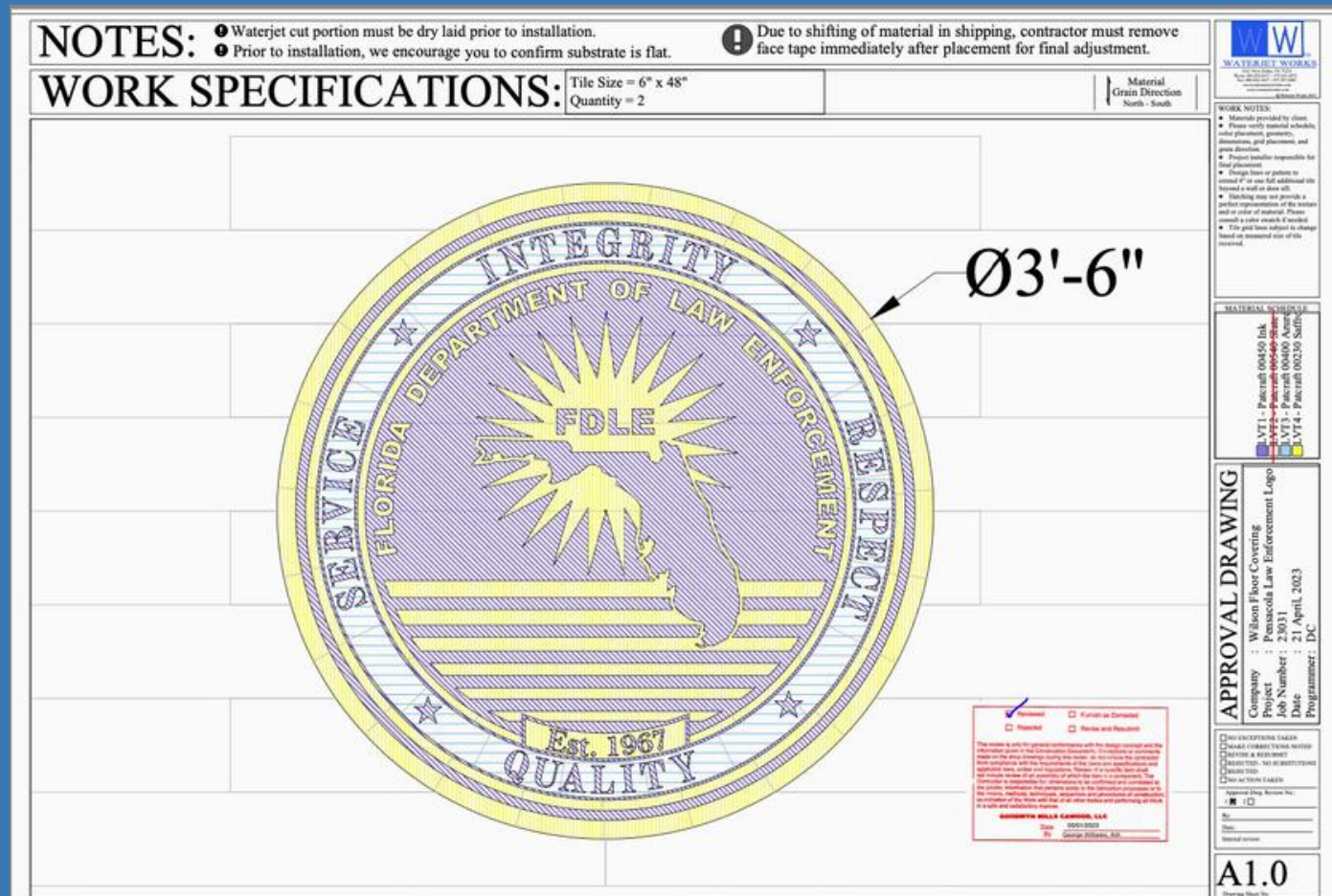

(For Steps 3 - 5)

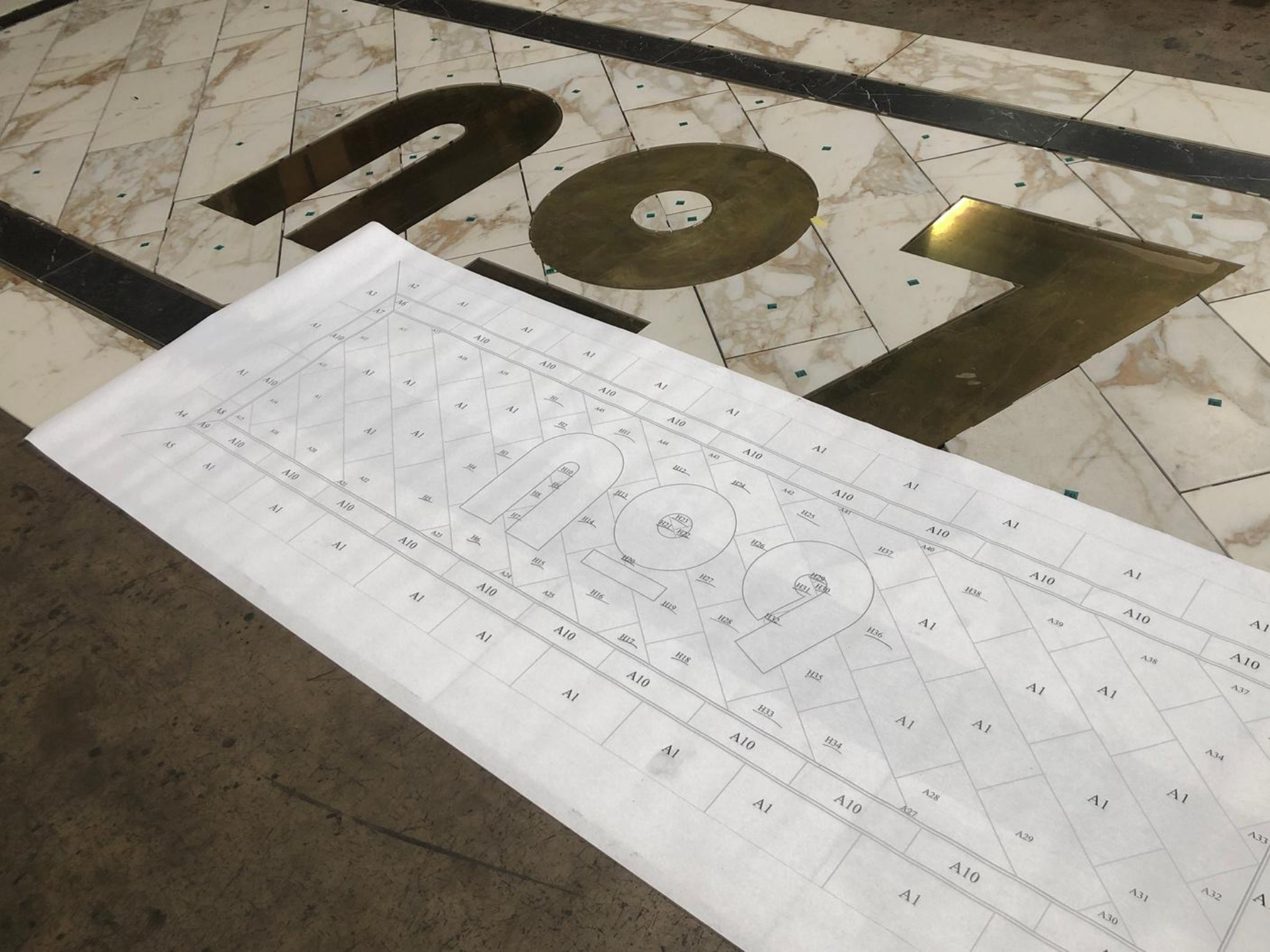

Each project is assembled in our facility and checked with an installation map before shipping.

(For Steps 8 - 9)

EXAMPLE: project with multiple materials and design details...



Note: The red outline around the letters essentially results in cutting the letters twice



Note how the black outline enhances the logo.

Also, the staggered field is on a 45 degree angle. We got this !



Note: This project includes a combo of materials: Brass AND Porcelain



FAQ's

Does Waterjet Works offer rendering services?

Waterjet Works has excellent relationships with numerous material manufacturers who include renderings and may be able to contact them on your behalf. Please let us know if you require a rendering when you send us your RFQ.

Why do you need a deposit?

Your project is a “custom” project. There is no place else to go with your order if something should happen down the timeline. Your deposit pays for your programming of the approval drawing and is also a placeholder in the production queue when your materials arrive.

FAQ's

How often do you have to change an approval drawing?

80% of the time our customer service department asks all the appropriate questions in order to get your approval drawings correct the first time. 20% of the time we have to make changes to that initial approval drawing due to numerous reasons... errors on our part, errors on your part, errors by the design firm, materials being substituted, and the list goes on. We will provide one revision at no additional charge. Beyond that, there will be a charge applied to your final invoice. Our goal is “measure twice, cut once.” Better to change it on paper, then to redo an entire logo after installation!

How can we shorten the production time?

Communication is a great place to start. Usually, we are waiting on materials. If materials are the only hold up, but have an expected delivery date, then we can better prepare to get your order taken care of in a timely manner. Also, logic prevails. If your logo is smaller and there are less pieces to the puzzle, then we can move it along quicker. We will do what we can to satisfy your needs. Please also know that in a crunch, there is always overtime.

FAQ's

How can I determine “accurate” material requirements in the bid process?

Based on our history, you can't. You can get close. Our experience has been that if we offer material requirements, we will be wrong 80% of the time. The 20% is in VCT, for example. So many things change from bid date to approval date, such as color names in the wrong place, modified width of materials, tiles are specified and then it turns out to be plank, etc.

I have been experiencing freight issues and delays, what has your recent experience been? (How do shipping costs work?)

The global pandemic has most definitely caused both inbound and outbound freight issues. Our customer service department is focused on communicating all the information we receive.

We look forward to hearing from you!

 service@waterjetworks.com

 philip@waterjetworks.com



waterjetworks.com



waterjetworksstore.com

 [@waterjet_works](https://www.instagram.com/waterjet_works)

 [@waterjetworks](https://www.facebook.com/waterjetworks)

 [wjwvideos](https://www.youtube.com/wjwvideos)

Thank You

Keep an eye out for more flipbooks to come ;)

