



# Foamalux

Foam PVC Sheets



DESIGN.  
CREATE.  
INNOVATE.



# Design, create & innovate with Foamalux Foam PVC

With bright white, matt and gloss, colours and environmentally friendly options for digital and screen printing, cutting, routing, engraving, forming, vinyl graphics, bending, shaping and bonding - there has never been a greater choice.

White | Light LW | Xtra

Brett Martin is a leading international manufacturer of a range of sign and display substrates. The company works in partnership with a worldwide network of distributors to supply the versatile and durable Foamalux range.

## CONTENTS

- 05 Features & Benefits
- 06 Applications
- 08 Foamalux Range
- 10 Foamalux White
- 12 Foamalux Light LW
- 14 Foamalux Xtra
- 16 Material Properties
- 18 Approved Partners



# Foamalux



# Features & Benefits



## Lightweight

Even in large format, Foamalux is only a fraction of the weight of solid display material of similar strength, making it much easier to handle and install.

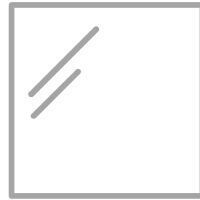

## Smooth

The smooth, flat and flawless surface of Foamalux provides a consistently even and reliable high performance surface for different types of printing and mounting.



## Strong

Offering an exceptional strength to weight ratio, Foamalux provides a rigid sheet which is durable and offers superior resistance to knocks and scratches.



## Moisture Resistant

Foamalux is moisture and mould resistant so will not rot or decay.



## Low Flammability

Foamalux offers excellent fire performance and has been independently tested to various Fire Standards. For the correct certification for your location, please contact the Technical Department.

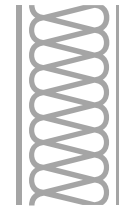

## Insulation

Provides acoustic and thermal insulation.



## Performance

Foamalux is a durable, versatile and flexible material suitable for indoor and short term outdoor use.

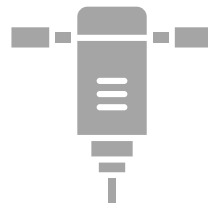

## Ease of Fabrication

Foamalux is easily cut, routed, engraved, drilled, printed, thermoformed and bonded.

# Applications

## Sign & Display

Our Foamalux range has a smooth surface which is optimised for print. It is also easy to fabricate and thermoform, making it perfect for signage, point of sale and 3D displays.



Foamalux White



## Fabrication

Foamalux can be easily printed, cut, drilled, shaped and bonded allowing flexibility and creativity of design when fabricating everyday products or one-off items.



Foamalux Xtra | Foamalux White



## Outfitting

Foamalux is low maintenance, lightweight and easy to assemble making it ideal for shopfitting, hospitality or office fit outs or temporary constructions such as pop-ups and exhibition stands.



Foamalux White



## Pet and Animal Enclosures

Foamalux is ideal for pet and animal enclosures. It is low maintenance, and does not need to be painted. It provides good thermal insulation, is non-toxic, waterproof and mould proof.



Foamalux White

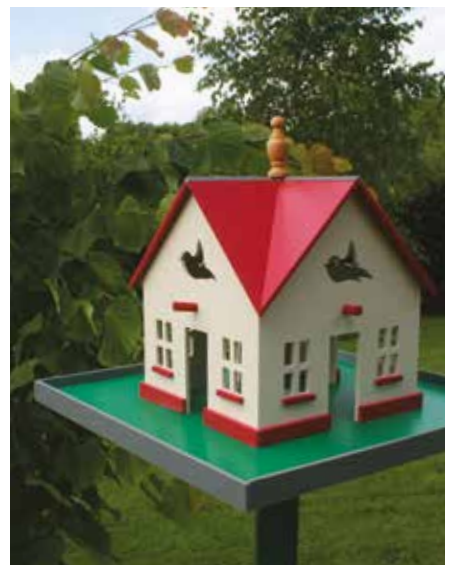

# FOAMALUX RANGE

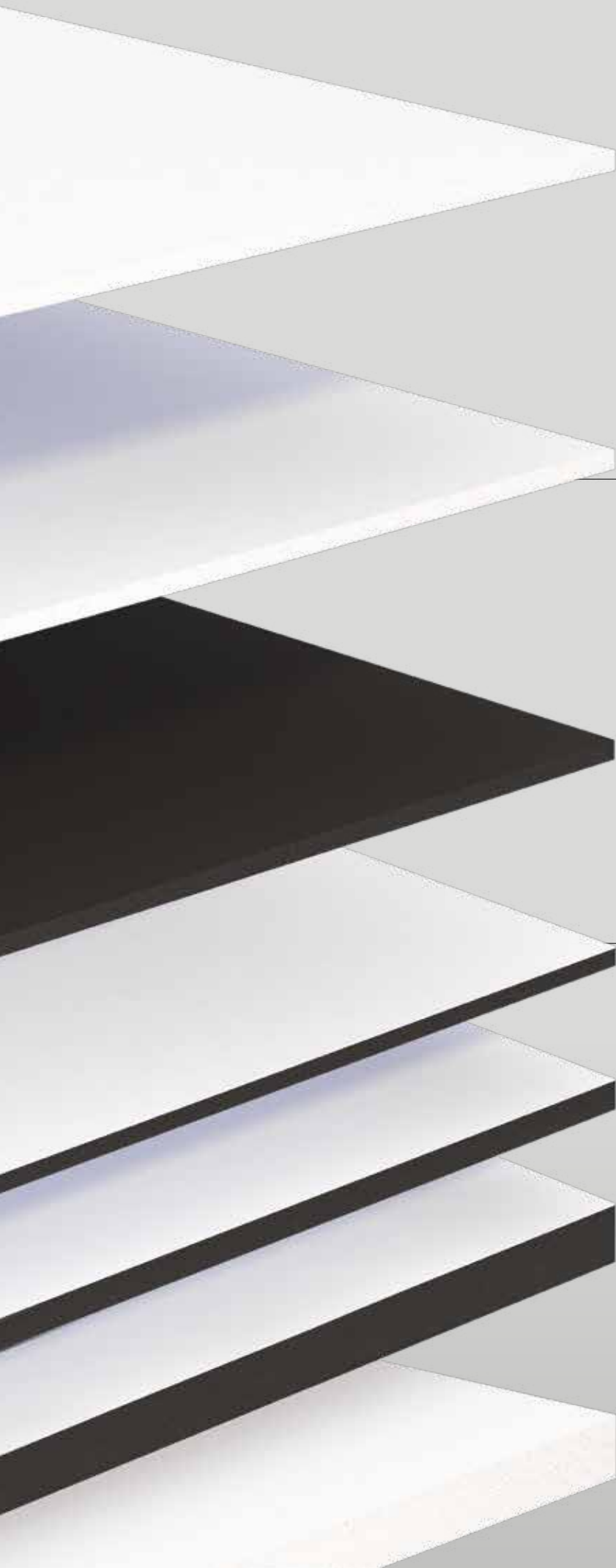



# Foamalux White

## PREMIUM CHOICE WHITE SHEET

Sheet Size (mm)	Thickness (mm)
1220 x 2440 - Liner 1 side	1 & 10
1220 x 2440 - Liner 2 sides	2, 3 & 5
1560 x 3050 - Liner 2 sides	3 & 5

\* Colours available on indent only

\* No liner available on indent only

\* Other sheet sizes available on indent only

# Foamalux Light LW

## IDEAL FOR DIGITAL PRINTING

Sheet Size (mm)	Thickness (mm)
1220 x 2440	2, 3 & 5
1560 x 3050	2, 3 & 5

\* Liner 1 side

\* No liner available on indent only

\* Other sheet sizes available on indent only

# Foamalux Xtra



## ENVIRONMENTALLY FRIENDLY

Sheet Size (mm)	Thickness (mm)	Double Sided Thickness (mm)
1220 x 2440	3 & 5	10

\* Other sheet sizes available on indent only



# Foamalux White

## Premium Choice White Sheet

Foamalux White is our premium choice foam PVC sheet. Its bright white formulation, greater stiffness and surface properties make it suitable for a wide range of printing and design applications. The finely balanced blend of pigments combined with its smooth, flat and flawless surface provide a consistent, clean, crisp printing surface resulting in photographic print clarity.

Sheet Size (mm)	Thickness (mm)
1220 x 2440 - Liner 1 side	1 & 10
1220 x 2440 - Liner 2 sides	2, 3 & 5
1560 x 3050 - Liner 2 sides	3 & 5

- \* Colours available on indent only
- \* No liner available on indent only
- \* Other sheet sizes available on indent only

### Applications

POS and 3D displays, Shop fitting, Exhibition stands, Fabrication, Signage, Digital and screen printing, Vinyl application, Cladding

Excellent fabrication capability for 3D displays

Flat rigid sheet with greater stiffness

Bright white colour formulation

Excellent colour reproduction

Consistent silky smooth matt surface

Outstanding, photographic print quality

Easy to clean

Indoor or short term outdoor use



White





# Foamalux Light LW

## Optimised for digital printing

Foamalux Light LW is specifically formulated for digital printing. Its bright white colour combined with a flat even surface optimises print quality and clarity for outstanding results every time. It is lighter weight for easy handling and can be easily cut, routed and finished – perfect for all signage and display applications.

Sheet Size (mm)	Thickness (mm)
1220 x 2440	2, 3 & 5
1560 x 3050	2, 3 & 5

\* Liner 1 side

\* No liner available on indent only

\* Other sheet sizes available on indent only

### Applications

Signage, Digital and screen printing, Vinyl application, POS and 3D displays, Shop fitting, Exhibition stands, Fabrication, Pet and animal enclosures



White

Lighter weight for easy handling

Optimised for direct digital and screen printing

Good opacity even at thinner gauges

Bright white colour formulation

Flat smooth printing surface

Suitable for vinyl application

Suitable for fabrication, cutting and routing

Easy to clean

Indoor or short term outdoor use





# Foamalux Xtra

## Environmentally Friendly

Foamalux Xtra is the environmentally friendly sign and display solution. Containing up to 80% reclaimed content, Foamalux Xtra uses waste that would otherwise go to landfill making it a greener choice. It comprises a black core, manufactured from post-production waste, with one or two surfaces of premium quality virgin white PVC, making it ideal for engraving to reveal the core or printing on the white surface.

Sheet Size (mm)	Thickness (mm)	Double Sided (S2) Thickness (mm)
1220 x 2440	3 & 5	10

\* Other sheet sizes available on indent only

### Applications

Signage, Digital and screen printing, Vinyl application, POS and 3D displays, Shop fitting, Exhibition stands, Fabrication, Pet and animal enclosures



White

Environmentally friendly reclaimed black core

Bright white surface, excellent for printing

Suitable for engraving applications

Single or double sided sheet formats

Consistently smooth and even

Hard and resilient

Quality digital and screen printing

Excellent vinyl adhesion

Easy to clean



---

# Material Properties

---

## Foamalux White

PROPERTY	STANDARD	VALUE	UNITS
Density	-	0.55-0.75	g/cm <sup>3</sup>
Moisture Absorption	ISO 62	<0.25	% by weight
Shore Hardness	ISO 868	>30	-
Tensile Strength	ISO 527	15	MPa
Flexural Modulus	ISO 178	1100-1300	MPa
Impact Resistance (Charpy)	ISO 179-1/1eU	11	kJ/m <sup>2</sup>
Thermal Expansion	ISO 11359-2	0.068	mm/m°C
Service Temperature	-	-20 to +60	°C

## Foamalux Light LW

PROPERTY	STANDARD	VALUE	UNITS
Density	-	0.45-0.55	g/cm <sup>3</sup>
Moisture Absorption	ISO 62	<0.25	% by weight
Shore Hardness	ISO 868	>30	-
Tensile Strength	ISO 527	15	MPa
Flexural Modulus	ISO 178	900-1100	MPa
Impact Resistance (Charpy)	ISO 179-1/1eU	10	kJ/m <sup>2</sup>
Thermal Expansion	ISO 11359-2	0.068	mm/m°C
Service Temperature	-	-20 to +60	°C

## Foamalux Xtra

PROPERTY	STANDARD	VALUE	UNITS
Density	-	0.55-0.65	g/cm <sup>3</sup>
Moisture Absorption	ISO 62	<0.25	% by weight
Shore Hardness	ISO 868	>30	-
Tensile Strength	ISO 527	17	MPa
Flexural Modulus	ISO 178	1000-1200	MPa
Impact Resistance (Charpy)	ISO 179-1/1eU	12	kJ/m <sup>2</sup>
Thermal Expansion	ISO 11359-2	0.068	mm/m°C
Service Temperature	-	-20 to +60	°C





PRINTED ON

**Foamalux**  
**Light**

PRINTED ON

**Foamalux**  
**Light**

PRINTED ON  
**Foamalux**  
**Light**

PRINTED ON  
**Foamalux**  
**Light**

PRINTED ON  
**Foamalux**  
**Light**

PRINTED ON  
**Foamalux**  
**Light**

PRINTED ON  
**Foamalux**  
**Light**

PRINTED ON  
**Foamalux**  
**Light**



# Brett Martin's Approved Partners

At Brett Martin, we work closely with a number of printing, and cutting machine manufacturers to test and showcase the capabilities of our semi-finished product portfolio.

Our Approved Partner programme gives you and your customers the confidence that Brett Martin's products can be successfully processed on a wide range of the most common equipment used in our industry. In addition, by collaborating with the world's top manufacturers we ensure our range is continuously evolving and performing to the highest standards and is kept up to date with the latest technological advances.

This table contains information about the equipment on which Brett Martin's products have been tested. For more details, please go to: [brettmartin.com/plastic-sheets/approved-partners](http://brettmartin.com/plastic-sheets/approved-partners)



Approved Partner	Equipment tested	Products tested	
<b>AGFA</b> 	Anapura hybrid series LED (1650/2050/2500/3200) Anapura FB2540 LED flatbed printer Jeti Mira LED flatbed printer Jeti Tauro H2500 LED Jeti Tauro H3300 S LED/ H3300 LED/ H3300 UHS LED	Foamalex	
<b>efi</b>	VUTEK 32h LED VUTEK H3 LED VUTEK H5 LED Pro 30H	Foamalex White Foamalex Xtra	
<b>PRINTING</b>	 	Certified for HP Latex inks on HP Latex R1000 and HP Latex R2000	Foamalex White Foamalex Light LW
		HP Scitex FB7500 (FB 225) HP Scitex FB 7600	Foamalex Light LW Foamalex Xtra
<b>JETRIX</b>	Jetrix LXi6 UV Flatbed Printer Jetrix LXi8 UV Flatbed Printer	Foamalex White	
<b>Mimaki</b>	Mimaki JFX200-2513 EX	Foamalex White	
 <b>Roland</b>	IU-1000F, S series	Foamalex White Foamalex Xtra	
<b>swissprint</b>	Nyala 3 Flatbed Printer	Foamalex	

CUTTING

Approved Partner	Equipment tested	Products tested
	Genesis-V CNC machine	Foamalux
	Sharpcut Pro	Foamalux White Foamalux Xtra
	EUROPA Cutter Rail NEMESIS Intergated Cutting System HELIOS All In One Cutting System ATHENA A3 Integrated Cutting System APOLLO XL Multi-substrate Cutter	Foamalux
	Kongsberg C Series Kongsberg X Series	Foamalux Xtra Foamalux White
	Summa F Series flatbed cutters with standard router and high frequency (HF) router modules	Foamalux White 1, 3, 5mm Foamalux Light 2,3,5mm
	Zund G3 3XL-3200	Foamalux Light LW Foamalux Xtra

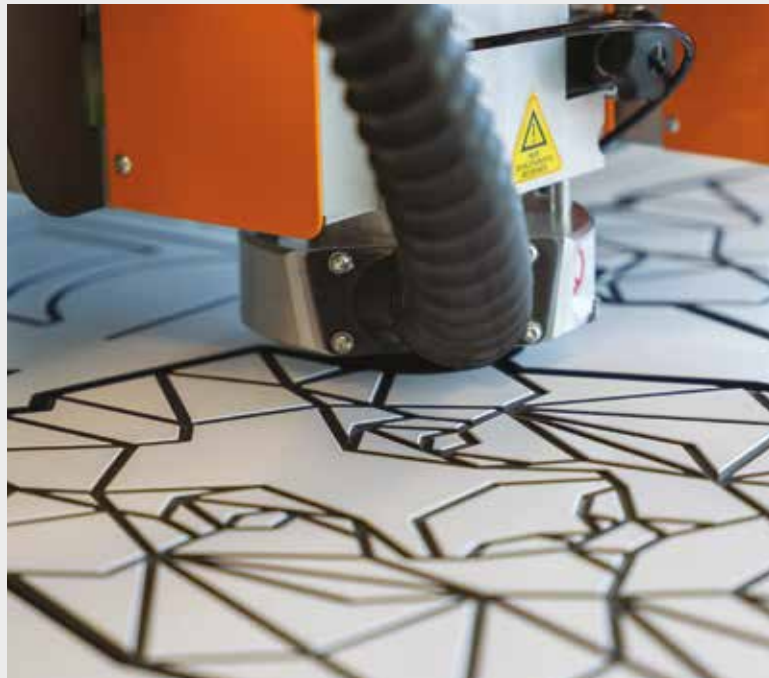

## Brett Martin Ltd

24 Roughfort Road  
Newtownabbey  
Co. Antrim  
BT36 4RB

t: +44 (0) 28 9084 9999  
f: +44 (0) 28 9083 6666  
e: technical@brettmartin.com  
commercial@brettmartin.com

For the latest information visit  
**brettmartin.com**



All reasonable care has been taken in the compilation of the information contained within this literature. All recommendations on the use of our products are made without guarantee as conditions of use are beyond the control of Brett Martin. It is the customer's responsibility to ensure that the product is fit for its intended purpose and that the actual conditions of use are suitable. Brett Martin pursues a policy of continuous product development and reserves the right to amend specifications without prior notice. Foamalux is a registered trademark of Brett Martin Ltd.



For enquiries please contact your  
local Spicers representative.

1300 132 644

spicers.com.au

### Victoria

155 Logis Boulevard  
Dandenong South  
Victoria 3175  
t: (03) 9768 8400  
f: (03) 9768 8401  
info.vic@spicers.com.au

### New South Wales

Unit 2, 100 Lockwood Road  
Erskine Park  
NSW 2759  
t: (02) 9735 2666  
f: (02) 9735 2600  
salesnsw@spicers.com.au

### QLD Brisbane

75 Tradecoast Drive  
Eagle Farm  
QLD 4009  
t: (07) 3084 5200  
f: (07) 3084 5297  
info.qld@spicers.com.au

### QLD Townsville

28A Casey Street  
Aitkenvale  
Queensland 4818  
t: (07) 3084 5200  
f: (07) 3084 5297  
info.qld@spicers.com.au

### Western Australia

19 Milly Court  
Malaga  
Western Australia 6090  
t: (08) 6310 4300  
f: (08) 9248 6515  
info.wa@spicers.com.au

### Northern Territory

57 Winnellie Road  
Winnellie  
Northern Territory 0820  
t: (08) 8947 0188  
f: (08) 8947 1366  
info.nt@spicers.com.au

### South Australia

113 Ledger Road  
Beverley  
South Australia 5009  
t: (08) 8243 9393  
f: (08) 8243 9397  
info.sa@spicers.com.au

### Tasmania

4-8 Sunmont Street  
Derwent Park  
Tasmania 7009  
t: (03) 6272 5333  
f: (03) 6272 8103  
info.tas@spicers.com.au