



# STUDIO BROCHURE

Kontichsesteenweg 39, 2630 Aartselaar (BE)  
+32 3 843 25 85 | [dbvideo.tv](http://dbvideo.tv) | [hello@dbvideo.tv](mailto:hello@dbvideo.tv)

 **DB VIDEO**  
YOUR FULL SERVICE MEDIA PARTNER



# CONTENT

## MODULAR STUDIO 1

8	Modular studio 1
9	LED wall
10	Blackbox
11	Greenkey
12	Let's get technical
14	Floor plan studio & control room

## INTRODUCTION

4	Introduction
---	--------------

## LOCATION

6	Location
---	----------





## DISCOVER MORE!

26 Discover more!

## MODULAR STUDIO 2

- 16 Modular studio 2
- 18 Let's get technical
- 20 Floor plan studio & control room

## STUDIO SERVICES

- 22 Studio services
- 24 Optional lighting





# INTRODUCTION





Welcome to our studios in Aartselaar: the perfect environment for any type of video production. From livestreams and webinars to talk shows, e-learning, product launches, or television recordings – at DB Video, you'll find a professional setting that adapts seamlessly to your content and ambitions.

Our studios are fully equipped with cameras, lighting, sound, control rooms, livestream facilities, and set design options. Choose between a compact studio for smaller shoots or a larger modular space for more complex productions with multiple setups or a live audience.

Prefer working with your own crew? You can also rent the studio as a dry-hire, with or without technical support.

Whether you arrive with a detailed script or are still shaping your concept, our experienced team is here to guide you from start to finish – technically, creatively, and logistically.

This brochure introduces you to all available setups, studio configurations, and additional services designed to bring your message to life on screen.







STUDIO 1



STUD

# LOCATION

Our location offers convenience, comfort, and a warm welcome — right between Brussels and Antwerp. With generous on-site parking, including reserved spots right at the studio entrance, accessibility is never an issue, even for tight schedules or larger teams. Upon arrival, your guests are welcomed with care, ensuring a smooth and professional experience from the very first contact.

Need catering during your shoot? We've got you covered — from in-studio catering to delicious meals at our on-site restaurant, Foodconcept 42. For team briefings, client meetings, or production planning, we offer a variety of fully equipped meeting rooms that can be booked alongside your studio rental.

You'll also have access to a dedicated make-up and dressing room, reliable high-speed Wi-Fi, and printer facilities — everything you need to stay connected, comfortable, and in control throughout the day.

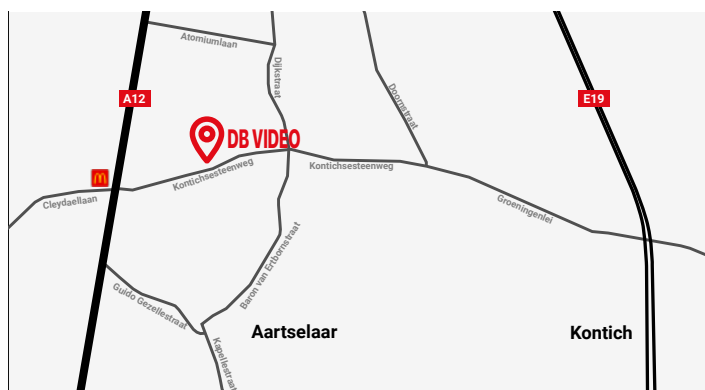

Kontichsesteenweg 39, 2630 Aartselaar





# MODULAR STUDIO 1 - 120M<sup>2</sup>



# A STUDIO THAT ADAPTS TO YOUR STORY

## LED WALL

In our 120m<sup>2</sup> modular studio, flexibility meets high-end production. Whether you're recording a talk show, keynote, product launch, e-learning, or branded video content — this space is designed to fit your concept, not the other way around.

One of the most impactful setups is our LED-wall configuration, offering a dynamic, high-resolution backdrop that brings your visuals to life in real time. Looking for something even more immersive? Our post-production team can build fully custom virtual environments, enabling virtual production that adds depth, movement, and branding — without the need for physical sets.

The studio is fully equipped with professional lighting, sound, multi-camera setups, and livestream capabilities. And we don't stop at the tech: we can also support you in set design, including the selection and setup of tables, chairs, stage layouts, and full spatial styling — tailored to the tone and message of your production.

From minimalistic to dynamic, from real to virtual — our studio scales with your story and brings it to life, in every detail.

Wanna see our LED studio in action?



Watch video!

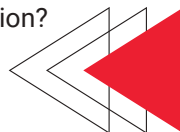

# MODULAR STUDIO

## BLACKBOX

For productions that require total freedom, the space can be transformed into a full black box, with 360° black draping — allowing you to start from scratch and build your set entirely according to your concept. Whether you're going for sleek and corporate, bold and branded, or something highly stylized, the space adapts to the visual tone you want to create. Our team can also support you in curating the full look and feel of your shoot — from stage layout and furniture to overall set styling.



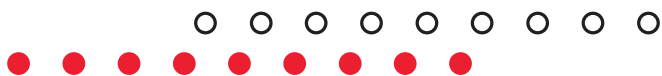

## GREENKEY

Another versatile option within the studio is the greenkey setup, ideal for productions that require keying techniques or full virtual integration. Whether you're replacing the background in post-production or using it as a base for live virtual production, the greenkey offers maximum creative flexibility. It's perfectly suited for presentations, e-learning content, corporate explainers, and also widely used for music videos – where stylized effects and animated environments can take the visuals to the next level. Combined with motion graphics, 3D elements, or interactive overlays, this setup allows your content to break free from physical limitations and stand out visually.

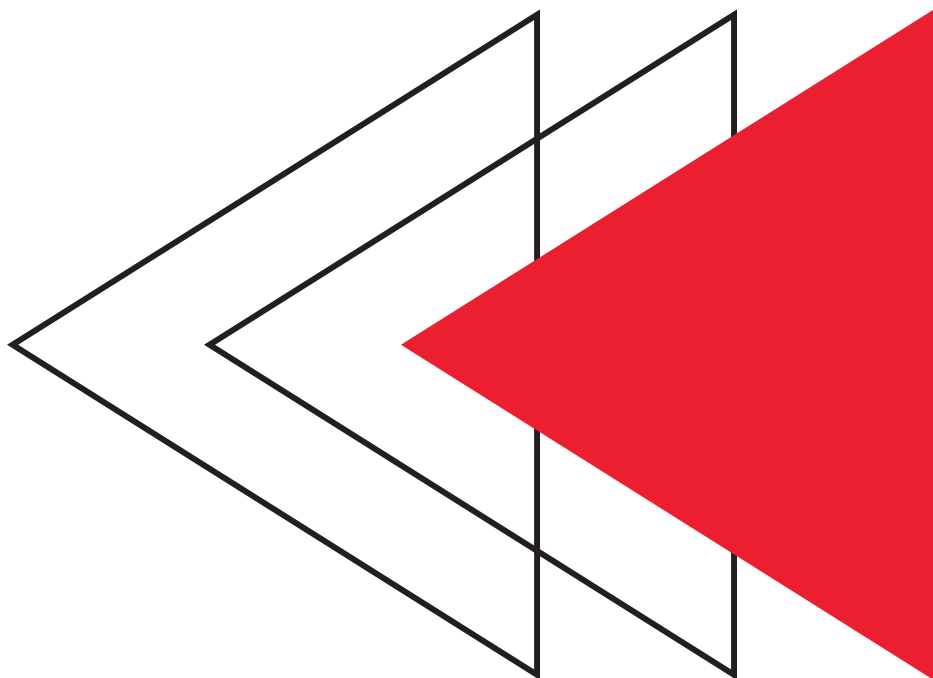

# LET'S GET TECHNICAL





# SPECIFICATIONS



## SETTINGS

- » LED wall
- » Blackbox
- » Greenkey



## DIMENSIONS

- » Width: 8,8m
- » Depth: 11m
- » Ceiling: 4,9m
- » Max working height: 3,38m
- » Surface area: 120m<sup>2</sup>



## LED WALL

- » U-shaped
- » 5760 x 1536 pixels
  - » Left panel: 1344 x 1536
  - » Center panel: 3072 x 1536
  - » Right pane: 1344 x 1536
- » Video content preferable in H.265 codec



## LIGHTING

- » Greenkey: LED panels from 3200-5600K
- » Front & Side: LED panels from 3200-5600K
- » Backlights: 2 LED panels from 3200-5600K or 4 Fresnel LED full colour incl. colour temperature



## PRODUCTION

- » VMIX 6in - 2out
  - » Companion/Streamdeck Powered
- » BM Videohub 40x40
- » Laptop integrations (Teams, Zoom, PowerPoint, etc.)
- » 2x 55" monitor in Studio



## CAMERAS

- » 4x AW-UE150KEJ PTZ Cameras
  - » Prompter
- » Extendable when needed



## AUDIO

- » DIGICO S21
- » 6x Clip-on microphone
- » 2x in-ear monitor



## RECORDING, PLAYBACK & STREAMING

- » 4x BM Hyperdeck - SSD recording
- » 1x BM Hyperdeck mini - SD recording



## COMMUNICATION

- » Riedel ARTIST FRAME 64
- » 6x RCP/DCP panel



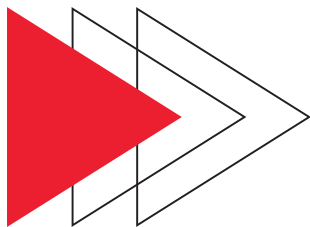

# FLOOR PLAN STUDIO & C

Greenkey

LED wall

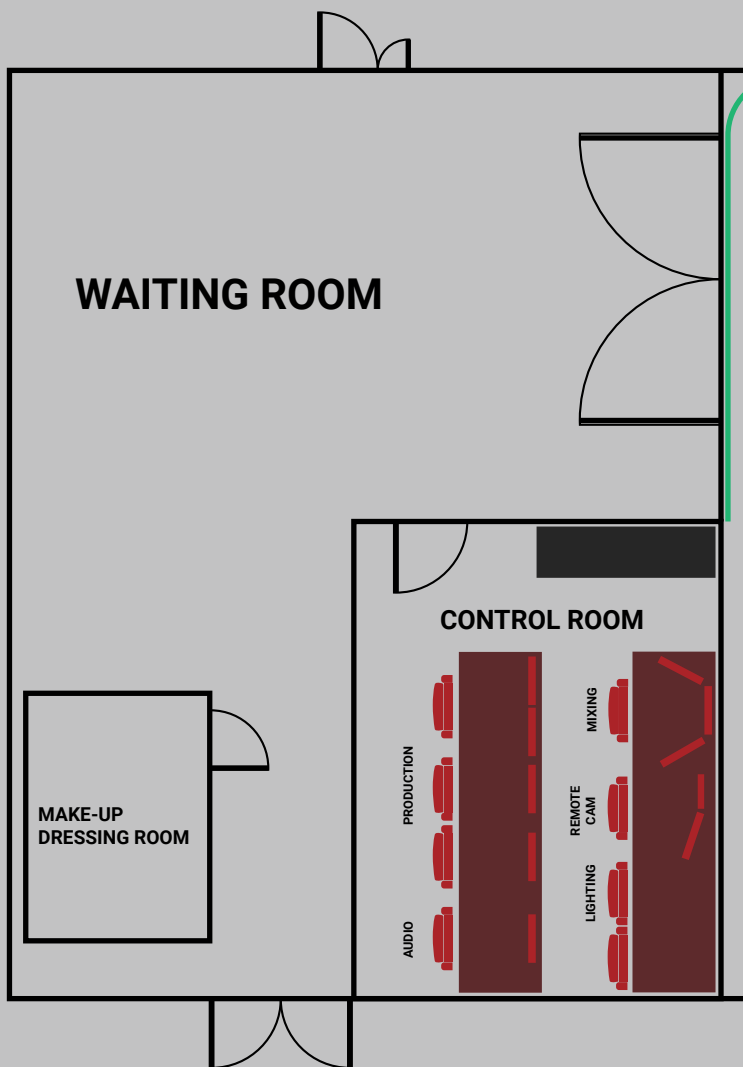

# CONTROL ROOM

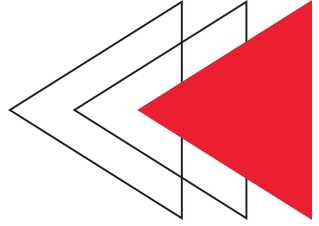

— — Blackbox curtain

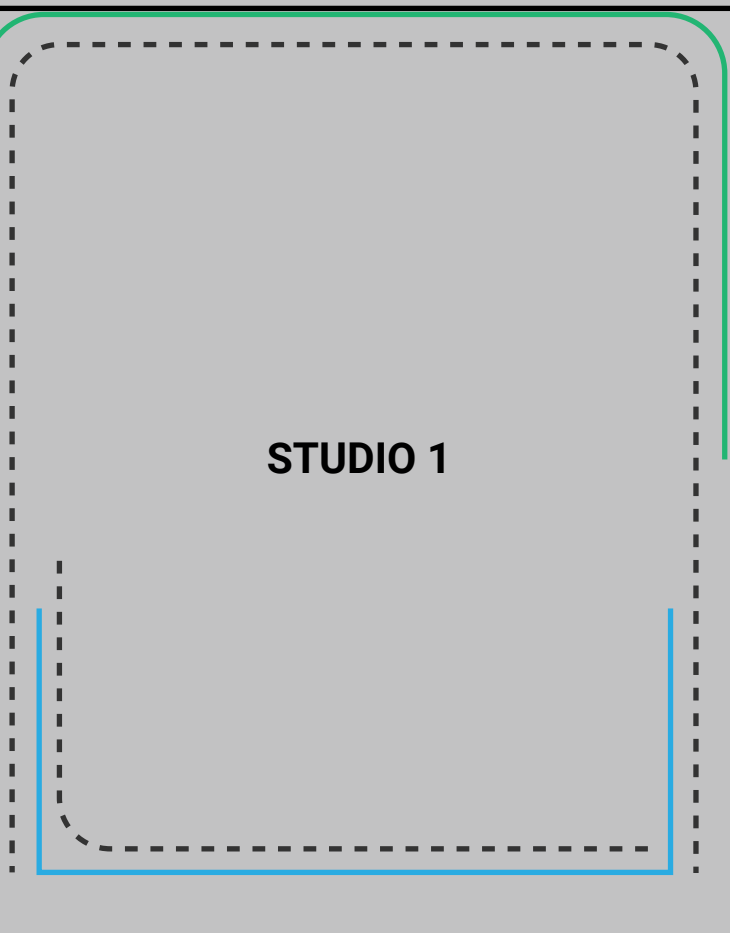



# MODULAR STUDIO 2 - 40M<sup>2</sup>



## COMPACT, VERSATILE AND PRODUCTION-READY

Looking for a smaller-scale studio with the same professional capabilities? Our 40m<sup>2</sup> modular studio offers all the core functionalities of our larger space — including high-end lighting, audio, multi-camera setup and livestream options — but in a more intimate setting that's ideal for focused productions.

The space can be configured in several ways. As a black box, it offers a clean slate for set design and controlled lighting. While there's no LED wall in this studio, we offer a clever visual alternative: custom-printed backdrops, mounted in LED-lit frames, which create the illusion of a vivid, high-resolution background. Choose from pre-designed prints — like office spaces, skylines or library walls — or provide your own branded visuals for a tailored look.

The studio is also available as a greenkey setup, ideal for keying in virtual elements or animated environments. While this space isn't suitable for full-body chroma keying, it works perfectly for seated or waist-up framing — making it a great fit for e-learning, interviews, corporate messages or content creators.

Compact in size, big on possibilities — the Modular Studio 40m<sup>2</sup> gives you all the tools to create polished, professional content in a flexible and efficient environment.

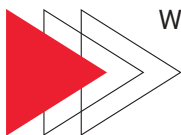

Wanna see our studio 2 in action?

Watch video!



# LET'S GET TECHNICAL



# SPECIFICATIONS



## SETTINGS

- » Blackbox
- » Greenkey
- » Whitekey
- » Backdrop wall
- » Flatscreen



## DIMENSIONS

- » Width: 8m
- » Depth: 5m
- » Ceiling: 2,5m
- » Max working height: 2,5m
- » Surface area: 40m<sup>2</sup>



## BACKDROPS

- » Width: 5m
- » Height: 2,5m
- » Optional backgrounds
  - » Wooden screen
  - » Leaf screen
  - » Skyline
  - » Bookcase



## LIGHTING

- » LED panels from 3200-5600K
- » 2 Fresnel LED full colour incl. colour temperature



## PRODUCTION

- » VMIX 6in - 2out
  - » Companion/Streamdeck Powered
- » BM Videohub 24x24
- » Laptop integrations (Teams, Zoom, PowerPoint, etc.)
- » 2x 55" monitor in Studio



## CAMERAS

- » 3x AW-HN130KEJ PTZ Cameras
  - » Prompter
- » Extendable when needed



## AUDIO

- » DIGICO S21
- » 4x Clip-on microphone
- » 2x in-ear monitor



## RECORDING, PLAYBACK & STREAMING

- » 3x BM Hyperdeck - SSD recording
- » 1x BM Hyperdeck mini - SD recording



## COMMUNICATION

- » Riedel ARTIST FRAME 64
- » 3x RCP/DCP panel



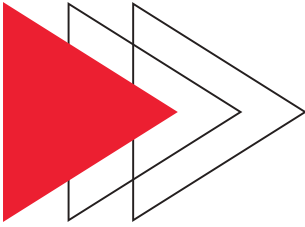

# FLOOR PLAN STUDIO & C

 Greenkey

 Backdrop

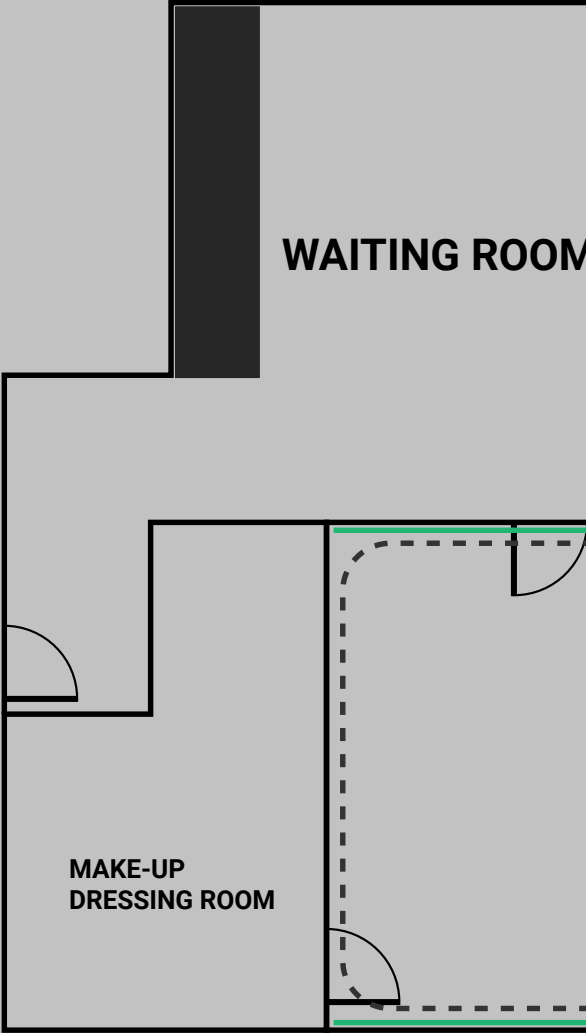



# CONTROL ROOM



— — Blackbox curtain

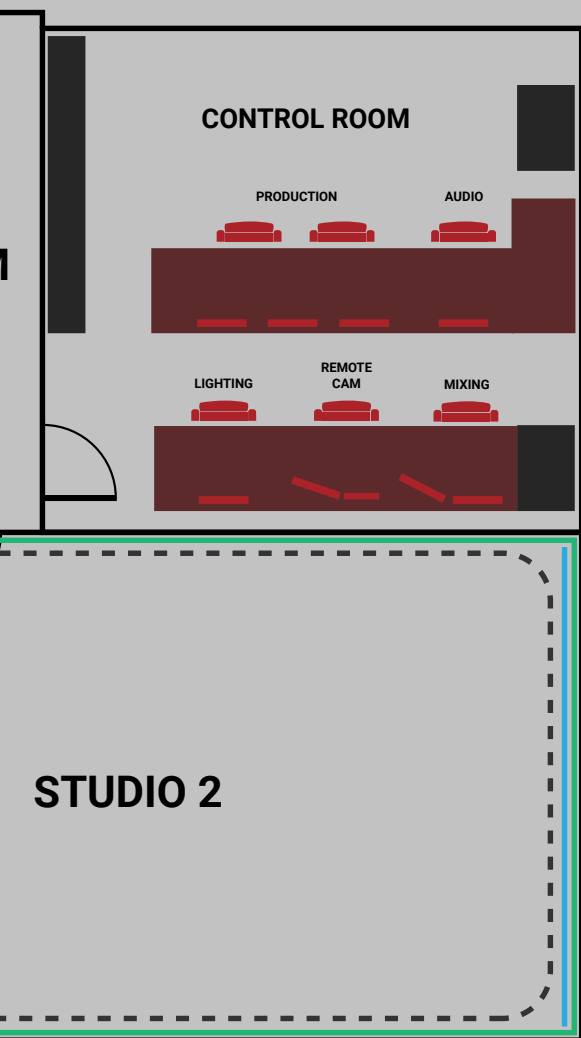



# STUDIO SERVICES

# STUDIO SERVICES

## PARKING

Each studio building has a spacious parking area. For each production, we reserve 4 parking spaces at the entrance with logo signs. Your guests or colleagues will see where they can park upon arrival.

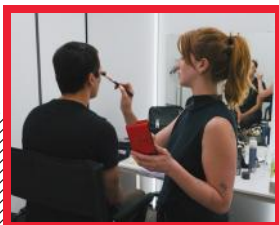

## MAKE-UP & LOGES

Each studio has a space where your guests can relax, prepare, or wait in peace. A professional makeup mirror is provided. A completely separate dressing room, further away from the production area, can be arranged upon request.



## CATERING

Throughout the building, drinking fountains are available. Each studio location is equipped with a kitchen that includes coffee and tea. For each production, we provide chilled soft drinks and small snacks. If you would like sandwiches, breakfast, or a full meal, this can be arranged upon request.

## FOODCONCEPT 42

At Foodconcept 42, our company restaurant, you can enjoy a relaxing lunch between recordings. With its inviting atmosphere, it's the perfect place to unwind and recharge. Whether you prefer a quick bite or a leisurely meal, Foodconcept 42 offers a variety of delicious options to suit every taste. Join us for a break from the action and experience a culinary retreat right on-site.



# OPTIONAL LIGHTING

BRAND	MODEL	DESCRIPTION
Astera	Helios tubes FP2-BTB	Set of 8
Astera	Titan tubes FP1-BTB	Set of 8
Astera	ART7-WIFI	-
Astra	1x1 Bi color panels	3 sets of 2
Chauvet	Uplighters Freedom Par quad-4 IP	4 sets of 10
Chauvet DJ	Flarecon Air V1	-
Chauvet DJ	Flarecon V1 remotes	-
Kino Flo	4 Bank ballast	-

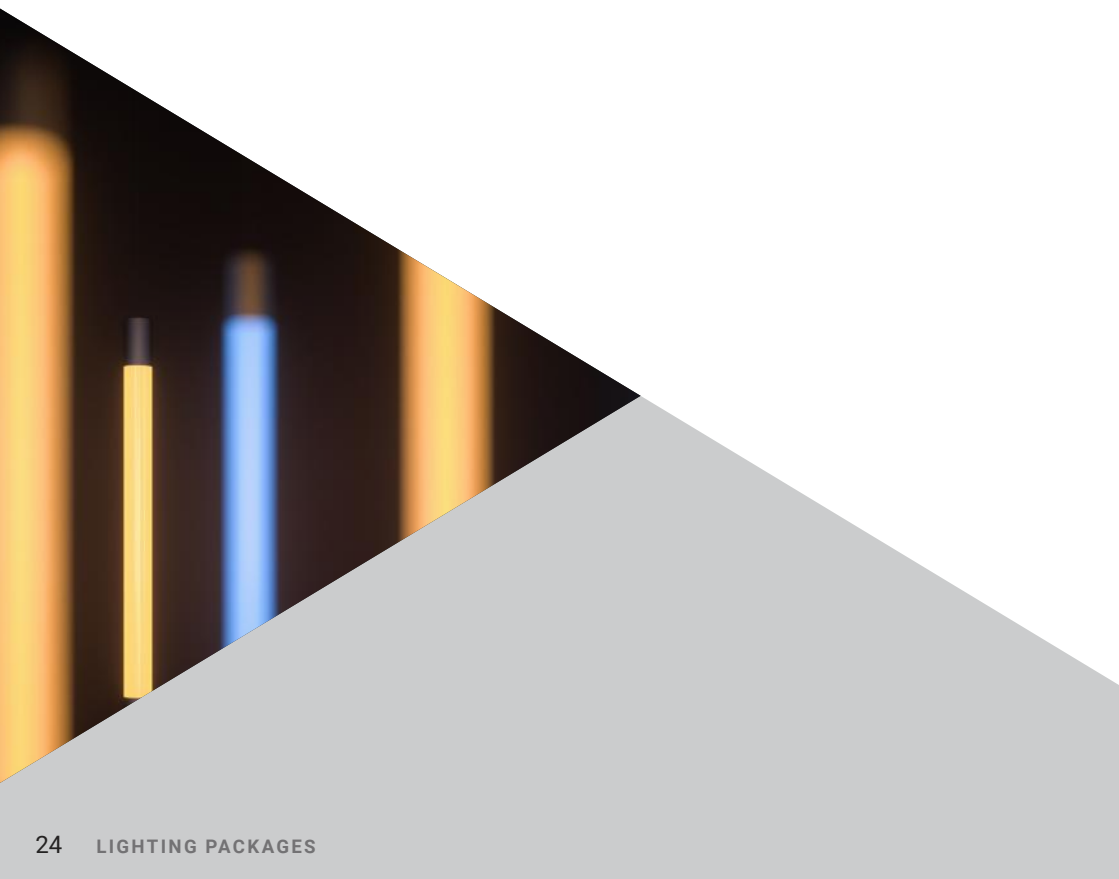

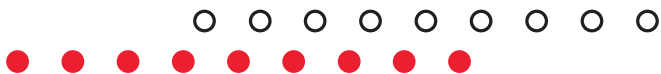

BRAND	MODEL	DESCRIPTION
Aputure	Lightstorm 300x	-
Aputure	MC 12-light	-
F&V	K4000S	Set of 3 Led panels
Lupo	Hyperpanelpro dual color soft 30	Led panel
Lupo	Hyperpanelpro dual color soft 30	Led panel
Lupo	Hyperpanelpro soft 60	Large
Lupo	Softbox	defusers, honeycones for all Lupo panels





**DISCOVER MORE!**





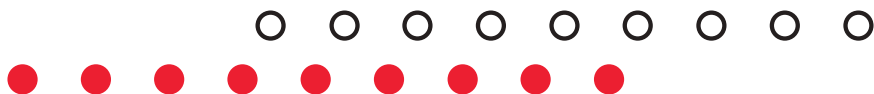

Want to see how our multi-camera productions come to life? From corporate events and sports to concerts and broadcast productions – our footage speaks for itself.

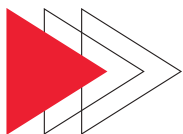

Curious to discover more?

[Watch our portfolio!](#)

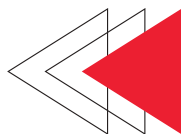

# DB VIDEO

+32 3 843 25 85  
hello@dbvideo.tv  
<https://dbvideo.tv/>

---

BV DB Video Productions  
Kontichsesteenweg 39  
2630 Aartselaar  
Antwerpen, België

---



DB Video



**DB VIDEO**  
YOUR FULL SERVICE MEDIA PARTNER