



GUIL®

Since 1983

TRUSSES & RIGGING



TPN290 series is a lightweight modular 29 cm parallel truss system, made from extruded aluminium tube (Alloy: EN-AW 6082 T6) and TIG welded for maximum strength.

The TPN290 truss connection is made using the UTR-01 rapid coupling system, which ensures that the connections fit together perfectly. The trusses come supplied with the connecting systems necessary for their assembly (2 sets of UTR-10: 2 solid aluminium double-cone couplers; 4 conical locking pins and 4 safety R-clips). This UTR-10 assembly system makes assembly quick and easy.



SPECIFICATIONS TPN290

- ▶ Size: **29 cm**
- ▶ Standard Lengths: **50 – 100 – 200 y 300 cm**
- ▶ Main tubes: **Ø 50 x 2 mm**
- ▶ Braces/diagona: **Ø 20 x 2 mm**
- ▶ Coupling System: **UTR-10 (included)**
- ▶ Material: **Aluminium (Alloy: EN-AW 6082 T6)**

Parallel truss, although lightweight, combine strength with versatility; being used for both decorative and load bearing functions. These features guarantee maximum safety and reliability when assembling truss structures for applications such as:

- Advertising displays, Projection screens.
- Trade show booths & Photocalls
- Staging applications
- Theatres, Museums & Night clubs
- Decoration purposes (shop fitters, interior design...)
- Exhibition and conference centres

Our ladder truss can be personalised with oven-applied powder coating paint, so that the structure will have the colour necessary for each project.

STANDARD LENGTHS

REFERENCES	LENGHT	NET WEIGHT
TPN290-500	29 x 50 cm	2.74 Kg
TPN290-1000	29 x 100 cm	3.98 Kg
TPN290-2000	29 x 200 cm	6.29 Kg
TPN290-3000	29 x 300 cm	8.76 Kg



90° Flat two-way corner, made with **29 cm parallel truss**, manufactured from extruded aluminium tube (Alloy: EN-AW 6061 T6) and TIG welded for maximum resistance.



TPN290-A



TPN290-B

SPECIFICATIONS

- ▶ Size: **29 cm** - Length: **50x50 cm**
- ▶ Main tubes: **Ø 50 x 2 mm**
- ▶ Braces/diagonals: **Ø 20 x 2 mm**
- ▶ Coupling System: **UTR-10 (included)**
- ▶ Material: **Aluminium** - Alloy: **EN-AW 6082 T6**
- ▶ Net Weight: **TPN290-A: 2.80 Kg / TPN290-B: 4.72 Kg**

TPN290-A & TP290-B corners are essential items to configure frames with TPN290 parallel trusses to make: photocalls; publicity frames; structures for projection screens, etc. Note: The corner can be painted in the colour required.

This corner block ref. TPN290-B is an indispensable element to make complex structures with parallel trusses ref. TPN290, such as quadrilaterals or cubes..

The different modules are connected using the UTR-10 rapid coupling system, which ensures that the connections fit together perfectly. The trusses come supplied with the connecting systems necessary for their assembly (2 sets of UTR-10: 2 solid aluminium double-cone couplers; 4 conical locking pins and 4 safety R-clips).

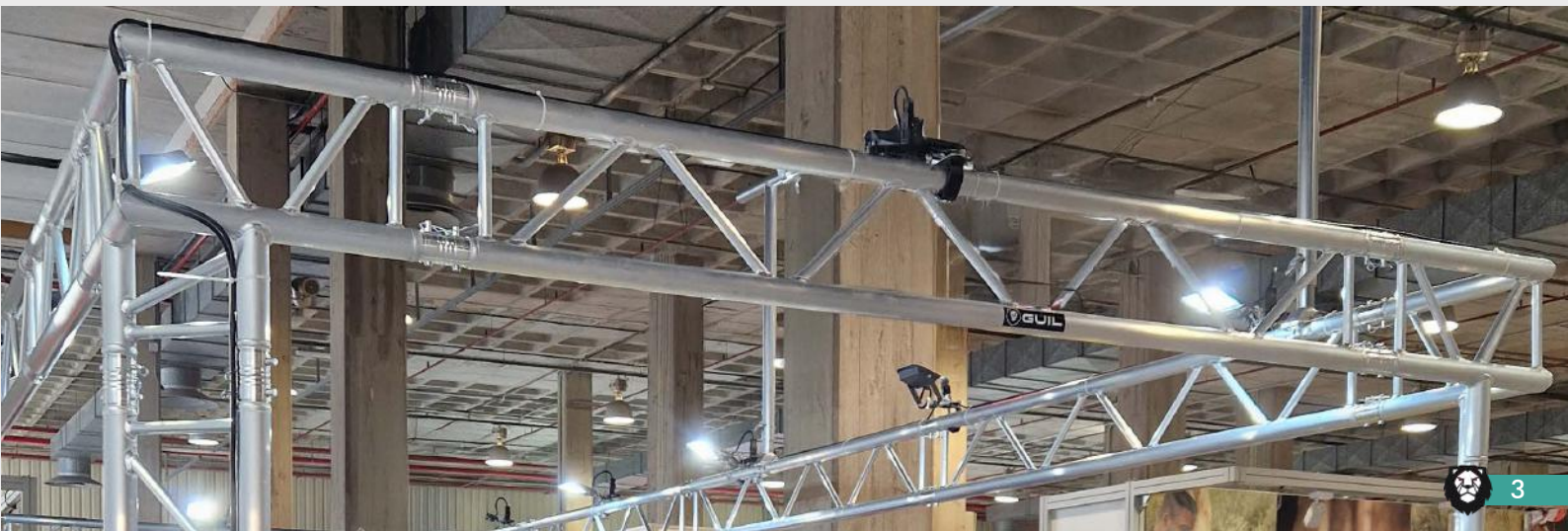

Aluminium square truss of 29 x 29 cm with quick connection system, made from extruded aluminium tube (Alloy: EN-AW 6082 T6), to guarantee maximum strength and reliability.

The TQN290 square truss connection is made using the UTR-10 coupling system, made up of solid aluminium conical coupler, locking pins (spigots) and safety R-Springs, which allows a fast, quick and reliable assembly. Each truss comes complete with the coupling system included (4 x UTR-10: 4 double conical couplers, 8 locking pins and 8 safety R-springs).

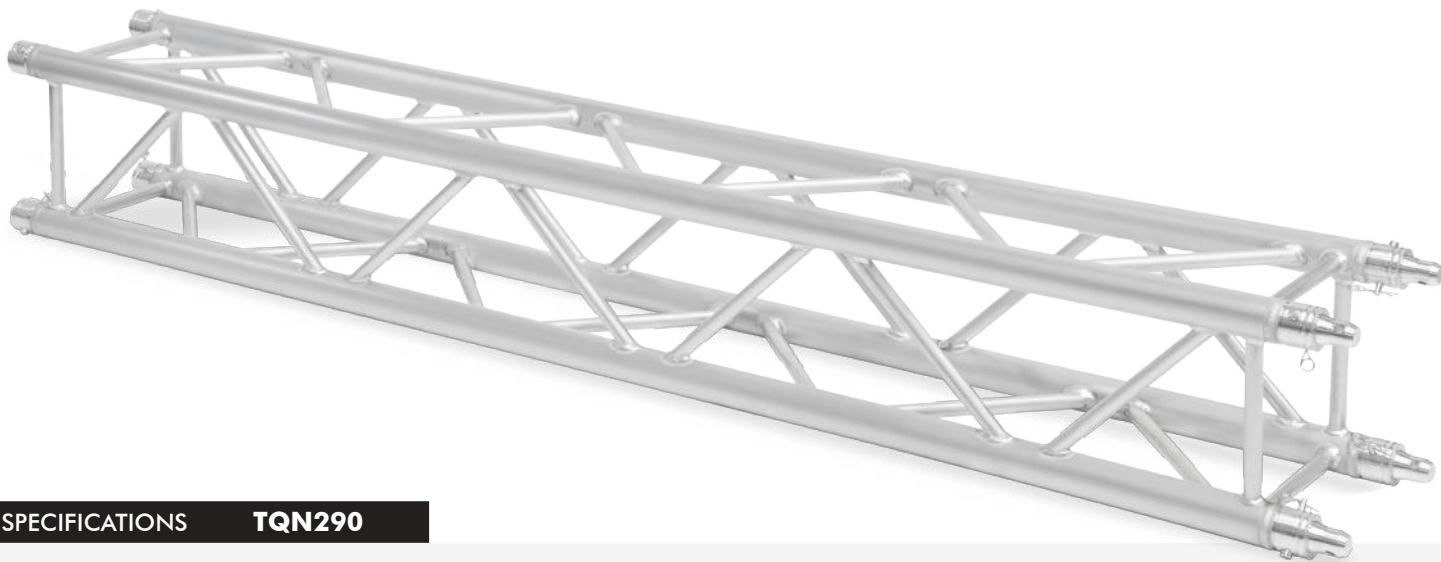

SPECIFICATIONS **TQN290**

- ▶ Size: **29 x 29 cm**
- ▶ Lengths: **25 – 50 – 100 – 200 and 300 cm**
- ▶ Main tubes: **Ø 50 x 2 mm**
- ▶ Braces/diagonals: **Ø 20 x 2 mm**
- ▶ Coupling System: **UTR-10 (incluidos)**
- ▶ Material: **Aluminium (Alloy: EN-AW 6082 T6)**

Our Square truss can be painted in any colour you require with powder coating treatment.

TQN290 Square truss, although lightweight, combine strength with versatility; being used for both architectural and decorative functions. These features guarantee maximum safety, reliability and give a visually attractive solution for many applications like:

- Events & Staging applications
- Trade show booths & Photocalls
- Theatres, Museums
- Decoration purposes (shop fitters, interior design...)
- Exhibition and conference centres
- Night clubs, TV sets & advertising displays

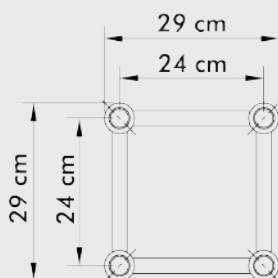

STANDARD LENGTHS

REFERENCES	LENGHT	NET WEIGHT
TQN290-250	29 x 29 x 25 cm	4.15 Kg
TQN290-500	29 x 29 x 50 cm	5.25 Kg
TQN290-1000	29 x 29 x 100 cm	7.40 Kg
TQN290-2000	29 x 29 x 200 cm	12.55 Kg
TQN290-3000	29 x 29 x 300 cm	17.20 Kg



29 x 29 cm box corner to join square truss ref. TQN290, manufactured in aluminium (Alloy: EN-AW 6082 T6) and TIG welded for maximum strength. This useful and versatile element offers multiple configurations with the 290 x 290 mm square truss without needing any additional elements.

The DDO/TQN290 six-sided box corner allows the creation of multiple configurations using as many sides of the cube (2, 3, 4, 5 or 6) as needed. By simply screwing on more connectors (ref. UTR-07) to the selected additional side, more usable sides can be added on according to the requirements of your setup.



SPECIFICATIONS DDO/TQN290

- ▶ Size: **29x29x29 cm**
- ▶ Main Tubes: **Ø 50 x 2 mm**
- ▶ Material: **Aluminium**
- ▶ Alloy: **EN-AW 6082 T6**
- ▶ Net Weight: **6.39 kg (w/o connectors)**

The 6-way corner block for TQN290 square truss has different references depending on the number of faces to be used:

- **DDO/TQN290-2:** 2-way aluminium box corner (8 UTR-07 connectors included) - Weight: 8.70 kg
- **DDO/TQN290-3:** 3-way aluminium box corner (12 UTR-07 connectors included) - Weight: 9.40 kg
- **DDO/TQN290-4:** 4-way aluminium box corner (16 UTR-07 connectors included) - Weight: 10.15 kg
- **DDO/TQN290-5:** 5-way aluminium box corner (20 UTR-07 connectors included) - Weight: 10.85 kg
- **DDO/TQN290-6:** 6-way aluminium box corner (24 UTR-07 connectors included) - Weight: 11.60 kg

UTR-07



PERMISSIBLE LOAD TABLE

Truss TQN290 290x290 mm	Uniformly distributed load (q)		Point loads (P)									
Length (L) (m)	Load (kg/m)	Deflection (mm)	Load (kg)	Deflection (mm)	Load (kg)	Deflection (mm)	Load (kg)	Deflection (mm)	Load (kg)	Deflection (mm)	Load (kg)	Deflection (mm)
4	501	17	922	13	672	15	496	15	393	15		
5	344	25	763	20	528	24	411	23	324	22		
6	241	37	649	29	455	34	346	32	274	32		
7	177	47	562	36	398	38	297	41	237	40		
8	135	60	494	49	353	58	260	55	208	56		
9	106	71	440	58	316	65	230	68	185	68		
10	85	83	395	67	285	76	205	74	166	74		
11	69	98	357	87	258	92	185	94	150	90		
12	58	115	324	100	236	106	168	104	136	108		
13	48	139	296	114	216	128	153	125	125	124		
14	41	158	271	130	199	149	140	148	114	146		
15	35	194	249	159	183	182	128	180	105	175		

Load data is accurate only when referring to static loads and individual gantries supported at both ends.

Data is calculated following & completely observing European Standards (Eurocode). The weight of the trusses themselves is already taken into account.



The TQN400XL square truss connection is made using the UTR-10 coupling system, made up of solid aluminium conical coupler, locking pins (bolts) and safety R-Springs, which makes assembly fast, quick and reliable. Each truss comes complete with the coupling system included (4 x UTR-10: 4 double conical couplers, 8 locking pins and 8 safety R-springs).

luminium square truss of 40 x 40 cm with 3 mm thick tubes and a quick connection system, made from **extruded aluminium tube (Alloy: EN-AW 6082 T6)**, to guarantee maximum strength and reliability.

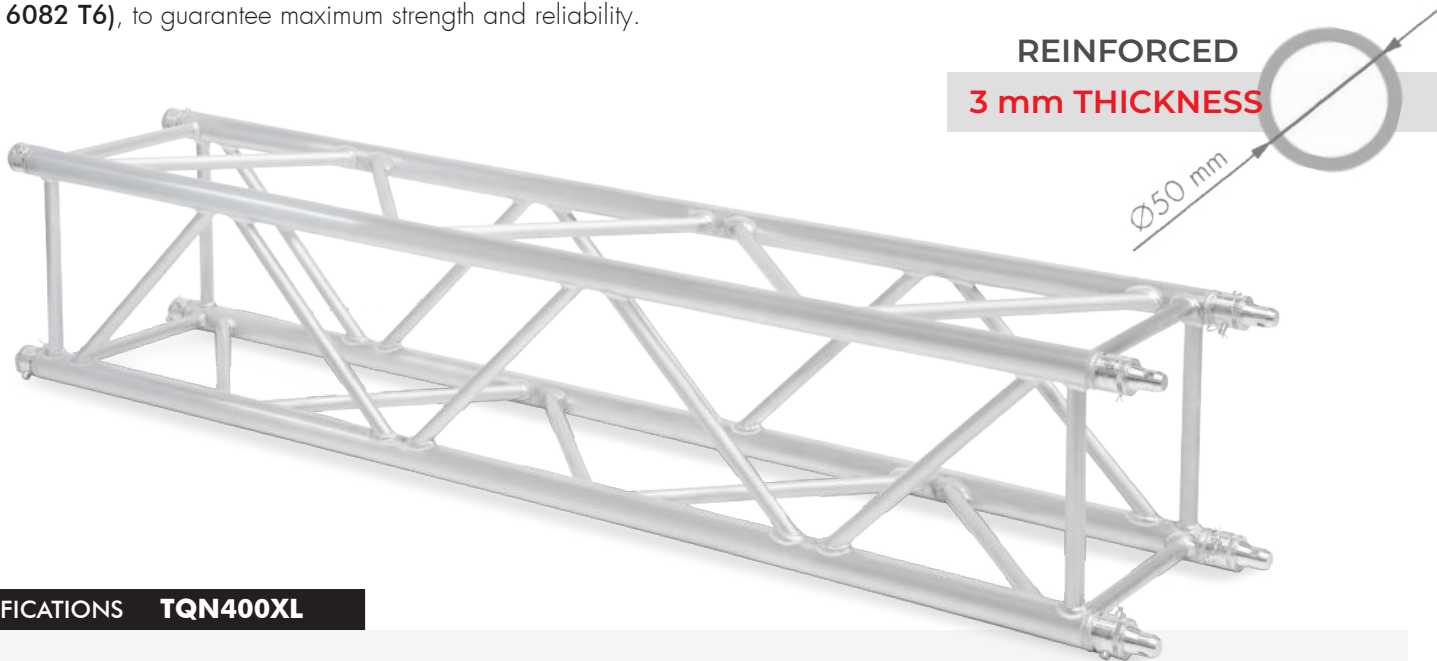

SPECIFICATIONS **TQN400XL**

- ▶ Size: **40 x 40 cm**
- ▶ Lengths: **25 – 50 – 100 – 200 and 300 cm**
- ▶ Main tubes: **Ø 50 x 3 mm**
- ▶ Braces/diagonals: **Ø 25 x 2 mm**
- ▶ Coupling System: **UTR-10 (included)**
- ▶ Material: **Aluminium (Alloy: EN-AW 6082 T6)**

Our square truss can be painted in any colour you require with powder coating treatment.

- TQN400XL Square truss, although lightweight, combine strength with versatility; being used for both architectural and decorative functions. These features guarantee maximum safety, reliability and give a visually attractive solution for many applications like:

- Events & Staging applications
- Trade show booths & Photocalls
- Theatres, Museums
- Decoration purposes (shop fitters, interior design...)
- Exhibition and conference centres
- Night clubs, TV sets & advertising displays

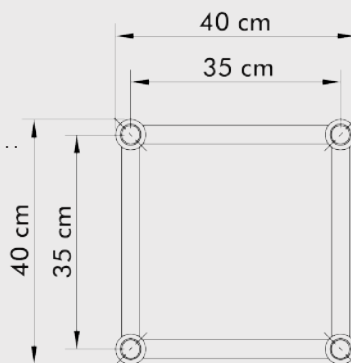

STANDARD LENGTHS

REFERENCES	LENGHT	NET WEIGHT
TQN400XL-500	40 x 40 x 50 cm	6.40 Kg
TQN400XL-1000	40 x 40 x 100 cm	9.55 Kg
TQN400XL-2000	40 x 40 x 200 cm	16.45 Kg
TQN400XL-3000	40 x 40 x 300 cm	22.25 Kg



40 x 40 cm Box corner to join square truss ref. TQN400XL, manufactured in aluminium (Alloy: EN-AW 6082 T6) and TIG welded for maximum strength.

This useful and versatile element offers multiple configurations with the 40 x 40 cm square truss without needing any additional elements.

The DDO/TQN400XL six-sided box corner allows the creation of multiple configurations using as many sides of the cube (2, 3, 4, 5 or 6) as needed. By simply screwing on more connectors (ref. UTR-07) to the selected additional side, more usable sides can be added on according to the requirements of your setup.



SPECIFICATIONS DDO/TQN400XL

- ▶ Size: **40x40x40 cm**
- ▶ Main Tubes: **Ø 50 x 3 mm**
- ▶ Material: **Aluminium**
- ▶ Alloy: **EN-AW 6082 T6**
- ▶ Net Weight: **7.27kg (w/o connectors)**

The 6-way corner block for TQN400XL square truss has different references depending on the number of faces to be used:

- **DDO/TQN400XL-2:** 2-way aluminium box corner (8 UTR-07 connectors included) - Weight: 9.58 kg
- **DDO/TQN400XL-3:** 3-way aluminium box corner (12 UTR-07 connectors included) - Weight: 10.12 kg
- **DDO/TQN400XL-4:** 4-way aluminium box corner (16 UTR-07 connectors included) - Weight: 10.76 kg
- **DDO/TQN400XL-5:** 5-way aluminium box corner (20 UTR-07 connectors included) - Weight: 11.30 kg
- **DDO/TQN400XL-6:** 6-way aluminium box corner (24 UTR-07 connectors included) - Weight: 11.84 kg

UTR-07



PERMISSIBLE LOAD TABLE

Truss TQN400XL 400x400 mm	Uniformly distributed load (q)		Point loads (P)									
Length (L) (m)	Load (kg/m)	Deflection (mm)	Load (kg)	Deflection (mm)	Load (kg)	Deflection (mm)	Load (kg)	Deflection (mm)	Load (kg)	Deflection (mm)	Load (kg)	Deflection (mm)
4	942	15	1801	8	1180	9	888	11	757	10		
5	706	18	1520	11	1018	15	787	14	650	15		
6	503	23	1311	20	893	24	706	22	559	23		
7	374	32	1151	25	793	28	624	28	489	30		
8	288	45	1023	32	712	38	549	39	433	38		
9	228	56	919	43	644	49	490	49	389	49		
10	185	67	832	49	588	59	441	55	352	57		
11	152	75	759	55	539	69	401	69	321	64		
12	127	90	697	63	497	78	366	74	294	72		
13	108	102	642	71	460	84	336	86	271	89		
14	92	118	594	89	427	103	310	105	251	102		
15	79	130	552	102	398	121	288	120	233	118		
16	69	149	514	115	372	138	267	132	217	134		
17	60	162	480	124	349	148	249	147	202	150		
18	53	175	449	137	327	162	233	167	189	169		
19	47	204	420	169	307	195	218	193	177	190		
20	42	249	395	198	289	223	204	222	166	218		

Load data is accurate only when referring to static loads and individual gantries supported at both ends.

Data is calculated following & completely observing European Standards (Eurocode). The weight of the trusses themselves is already taken into account.



GUIL ground bases for truss **provide stability, safety and protection** for both, the truss and the supporting surface. They are ideal for structures, exhibition stands, totems, photocalls, exhibitions, presentations and advertising applications. They are supplied complete with the necessary connectors for **quick and safe assembly**.

Technical specifications:

- **Rounded edges** to prevent damage.
- **Materials:** aluminium or steel with black finish.
- **Connectors included:** 4 sets of connectors ref. UTR-06.
- **Integrated handles** for transport and handling (except BST-01).
- **Floor anchoring:** option to anchor to the floor using bolts (not included).
- **MOBILITY:** option to install the wheel set ref. SRD-01 to move the structure without dismantling it (except BST-01).
- **LEVELLING:** levelling spindles with non-slip rubber end to adjust height and level the base on uneven surfaces. The spindles allow height adjustment of up to 20 mm. "/N" models include the 4 spindles (except BST-01).

BASE PLATES BST	BST-01	BST-02	BST-02/N	BST-03	BST-03/N	BST-04	BST-04/N
Dimensions (mm)	292x292x4	450x450x5	450x450x5	990x330x8	990x330x8	800x800x6	800x800x6
Connectores	4 x UTR-06 (included)						
Net Weight	1.65 Kg	8 Kg	8.40 Kg	20.80 Kg	21.25 Kg	31 Kg	31.5 Kg
Material	Aluminium	Steel - Black colour					
Levellers	No	Yes (not included)	Yes (INCLUDED)	Yes (not included)	Yes (INCLUDED)	Yes (not included)	Yes (INCLUDED))
Wheels	No	Yes, the wheel set Ref. SRD-01 (not included) can be added.					
FOR TRUSSES							
TPN290	No	Yes	Yes	Yes	Yes	No	No
TQN290	Yes	Yes	Yes	Yes	Yes	Yes	Yes
TQN400XL	No	Yes	Yes	No	No	Yes	Yes

SRD-01

A set consisting of four double swivelling wheels of Ø75 mm, two of them with brakes, to be fitted on the square section truss base plates ref. BST-02, BST-03 and BST-04.

This practical accessory makes the bases highly mobile, allowing structures for purposes such as photocall, publicity, etc to be moved from one room to another without having to dismantle them.



BST-01

292 x 292 x 4 mm
ALUMINIUM



BST-03

990 x 330 x 8 mm
STEEL

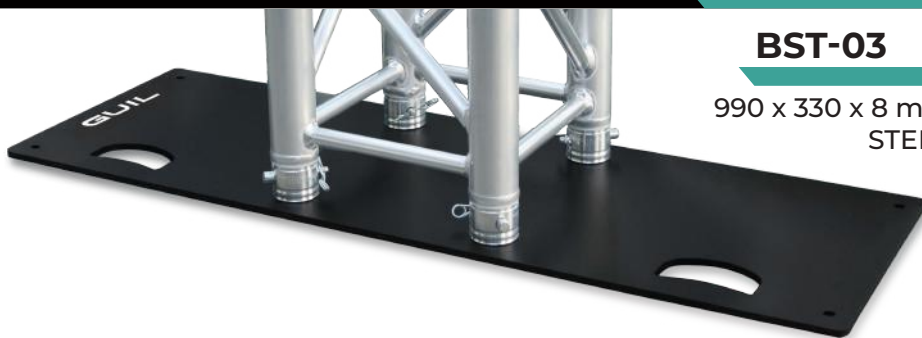

BST-02

450 x 450 x 5 mm
STEEL



BST-04

800 x 800 x 6 mm
STEEL



BASE PLATES WITH LEVELLERS

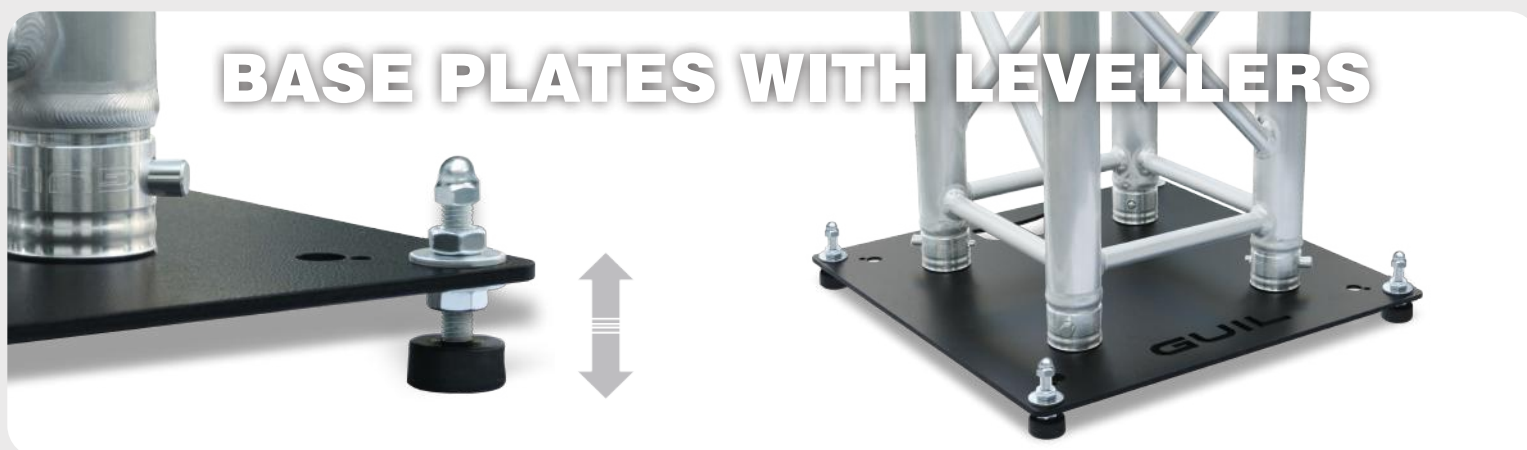

BST-02/N

450 x 450 x 5 mm
STEEL



BST-04/N

800 x 800 x 6 mm
STEEL



BST-03/N

800 x 800 x 6 mm
STEEL



TQN290-BS/1

TQN400XL-BS/1



ALUMINIUM HINGE FOR TRUSS STRUCTURES

The aluminium hinge **TQN290-BS/1** & **TQN400XL-BS/1** are a vital accessory for assembly and installation of truss structures, allowing them to be connected at different angles.

- Includes 8 Ref. UTR-06 connectors to attach it to the trusses
- Angle blocking system incorporated, to fix the hinge in the desired position.
- Allows angled structures to be created with ease.

Our hinges are not only a connector, but also a source of creative and operative freedom, proving a very practical solution for the construction of demanding, dynamic structures in the world of entertainment, technical installation and events.

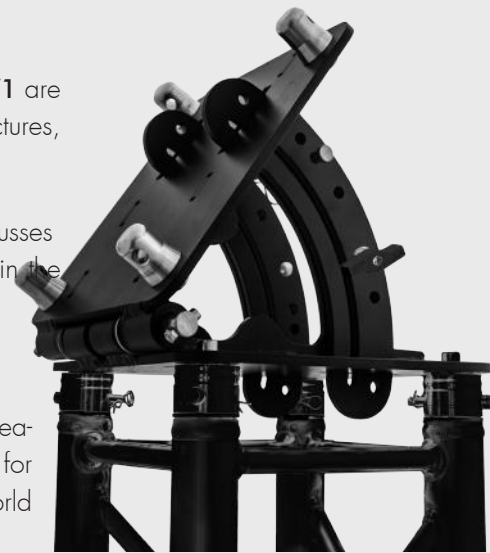

TTL-01/N

TELESCOPIC DROP ARMS FOR LIGHTING

TTL-02/N

They are manufactured in aluminium (black painted), with an outer tube Ø 50 mm and 2.5 mm wall thickness, and an extendable inner tube Ø 45 mm with 2 mm wall thickness. It incorporates a high-strength aluminium coupler (ref. ABZ-24) for secure fastening to trusses or tubes with an external diameter from 45 to 52 mm.

The position is secured with a metallic ergonomic knob, ensuring maximum safety.

TTL-01/N: Can be set to 4 different positions: **63,7 cm – 73,7 cm – 83,7 cm – 93,7 cm.**

▶ Maximum Load: **100 Kg** ▶ Net Weight: **2 Kg**

TTL-02/N: Can be set to 9 different positions: **115 cm – 125 cm – 135 cm – 145 cm – 155 cm – 165 cm – 175 cm – 185 cm – 195 cm.**

▶ Maximum Load: **100 Kg** ▶ Net Weight: **3 Kg**



TQ-AD1

ACCESSORIES TO LIFT & HANG TRUSSES

TS-AD1



High load-capacity adapters for lifting and suspending trusses using chain hoists or winches, creating a temporary or permanent fixing point.

Their design allows them to be used with trusses of different sizes.

TQ-AD1: For Trusses from 20 cm to 30 cm. Weight: 3.30 Kg

TS-AD1: For Trusses from 20 cm to 52 cm. Weight: 3.70 Kg

CS-10

BEAM CLAMP



The CS-10 beam clamp is designed to hang hand or electric hoists from beams/girders for multiple heavy lifting tasks. It allows creating a temporary or permanent fixing point for lifting equipment in "IPN" beams or H-shaped profiles. **Wide adjustment range from 75 to 230 mm**

▶ Max Load: **2000 Kg** ▶ Weight: **5.50 Kg**

GF-01

Reinforced heavy duty hook clamp with protective plate



0,42 kg
 75 kg \varnothing 30 - 50 30 x 7 mm
 M10 x 50 mm

GF-03

Reinforced hook clamp with protective plate



1,05 kg \varnothing 30 - 60 mm 40 x 10 mm
 200 kg M16 x 60 mm

GF-06

Aluminium hook clamp for theatre

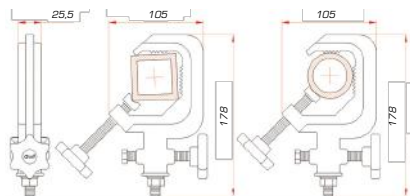

0,48 kg \varnothing 28 - 50 mm 25 x 23 mm
 50 kg \square 28 - 50 mm M10 x 50 mm

Professional lighting clamp specially designed for the theatre industry. It combines strength and durability with a high level of safety.

Its special design, allows to use this sturdy clamp with round and also square tubes with an external diameter from 28 to 50 mm.

ABZ-38

Light-weight aluminium clamp coupler with wing nut and bolt, for light loads and thin tubes.

Our coupler ref. ABZ-38 comes with bolt and wing nut to secure, spotlights, electronic devices, etc up to 30 kg..

Especially suitable for simple and light-weight installations, our ref. ABZ-38 coupler is designed to



0,11 kg \varnothing 35 - 40 mm 56 x 30 mm
 30 kg M 08 x 35 mm

ABZ-60



This hinge for hook clamps and couplers saves space when storing and transporting lighting equipment, moving heads and any device that can be attached and installed on a clamp or coupler.

When storing an electronic device in a flightcase or to simply save set-up time as you don't have to attach the coupler or clamp used to install the device, as with the ABZ-60 adaptor you don't have to remove the clamp or coupler after every event.

Compact and discrete together with its black finish, it is not bulky nor does it have any unnecessary parts, making it almost invisible to the eye within the installation from only a few meters away.

75 kg 50 x 50 mm
 0,40 kg

ABZ-53/N

Aluminium Coupler with M10 bolt

- 📦 0,17 kg
- SWL 100 kg
- ∅ 48-51 mm
- 🔧 M10 x 30

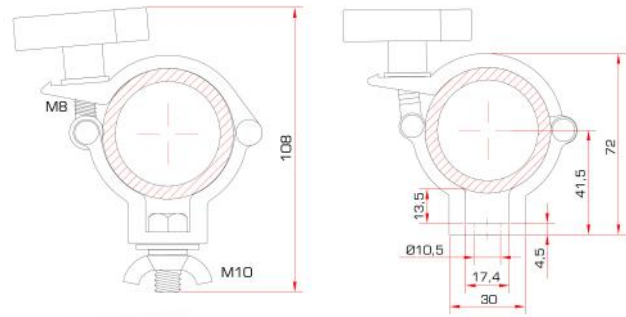

ABZ-58/N

Aluminium Hanging Coupler

- 📦 0,23 kg
- SWL 100 kg
- ∅ 48-51 mm
- 🔧 M8

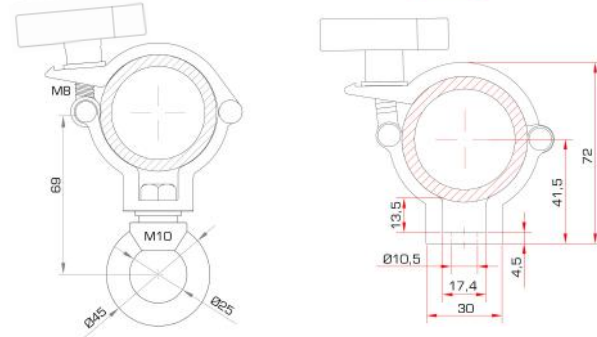

ABZ-21/N

Aluminium Swivel Coupler

- 📦 0,24 kg
- SWL 100 kg
- ∅ 48-51 mm

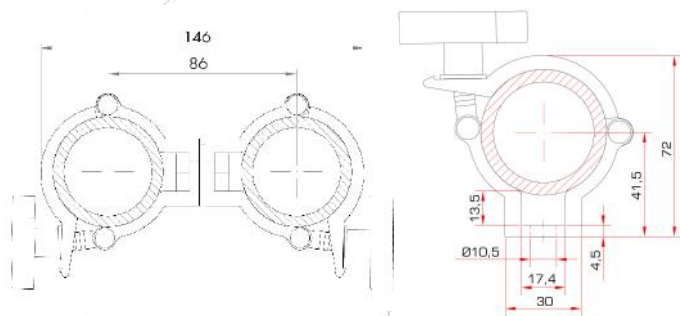

ABZ-01

Aluminium Claw Clamp

- 📦 0,39 kg
- SWL 100 kg
- ∅ 50-51 mm

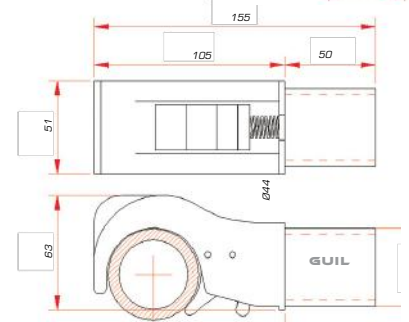

ABZ-54/N

Aluminium Coupler with pressure lever

- 📦 0,39 kg
- SWL 100 kg
- ∅ 50-51 mm

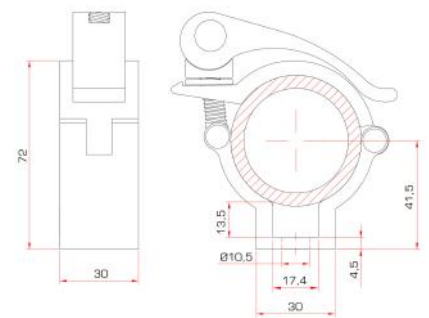

ABZ-16

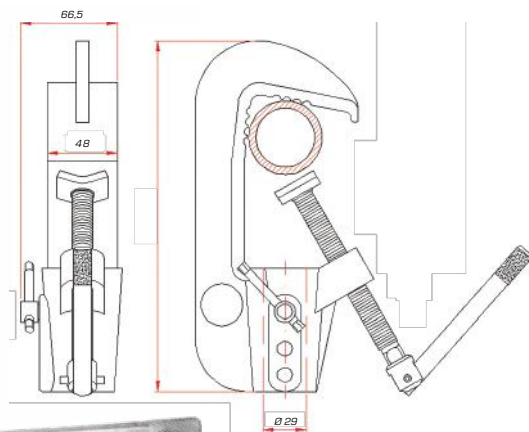

Aluminium Clamp (∅ 29 mm)

- 📦 1,13 kg
- SWL 300 kg
- ∅ 18-80 mm / 20 x 20 mm a 70 x 70mm
- 🔧 A: M14 x 115 / B:



ABZ-02

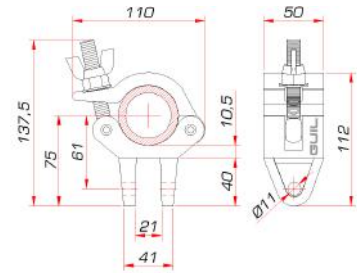

Aluminium Stabiliser coupler

-  0,55 kg
-  SWL 250kg
-  \varnothing 45-52 mm



ABZ-23

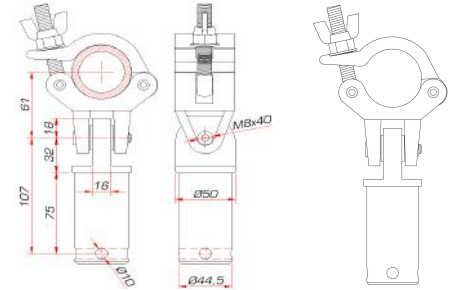

Aluminium Stabiliser coupler with Adapter

-  1,00 kg
-  SWL 250 kg
-  \varnothing 45-52 mm



ABZ-24

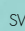

Aluminium Coupler

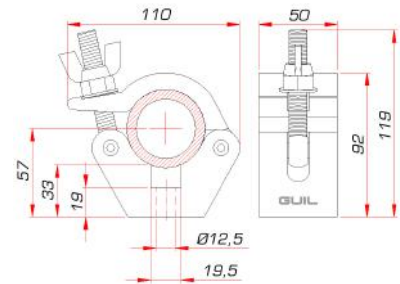
-  0,63 kg
-  SWL 750 kg
-  \varnothing 45-52 mm



ABZ-03

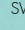

Aluminium Coupler with M12 bolt

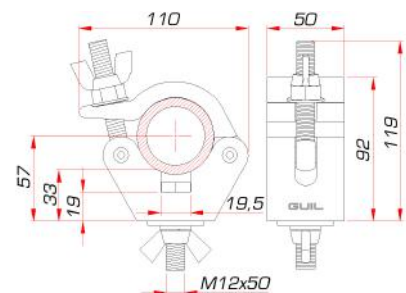
-  0,86 kg
-  SWL 500 kg
-  \varnothing 45-52 mm
-  T M12 x 50



ABZ-04

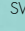
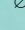

Aluminium Hanging Coupler

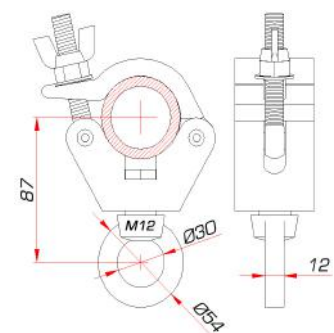
-  0,84kg
-  SWL 340 kg
-  \varnothing 45-52 mm
-  M12

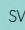

ABZ-05

Aluminium Swivel Coupler (360°)

-  1,33 kg
-  SWL 750 kg
-  \varnothing 45-52 mm

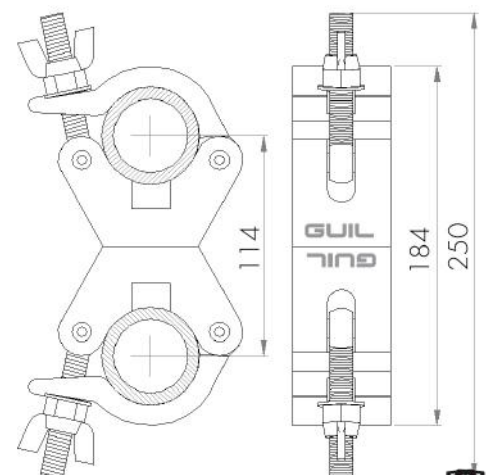

ABZ-35/N

Aluminium Coupler with bolt M12

- ⚖ 0,50 kg
- SWL 500 kg
- ∅ 45-52 mm
- T M12X50

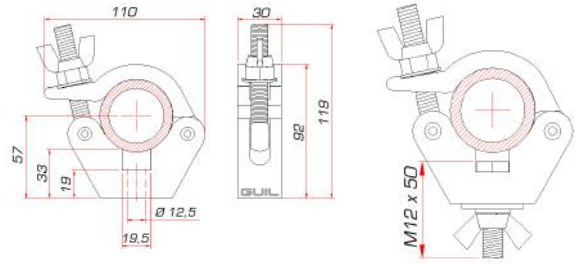

ABZ-29/N

Aluminium Coupler

- ⚖ 0,40 kg
- SWL 500 kg
- ∅ 45-52 mm

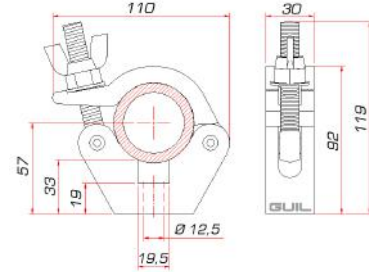

ABZ-03/R

Aluminium coupler with wheel

- ⚖ 1,43 kg
- SWL 100 kg
- ∅ 45-52 mm

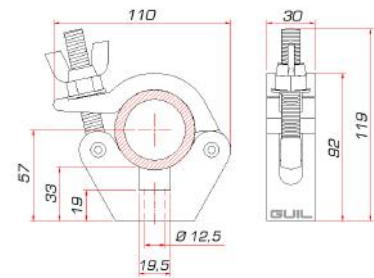

ABZ-30/N

Aluminium Double Swivel Coupler 360°

- ⚖ 0,86 kg
- SWL 500 kg
- ∅ 45-52 mm

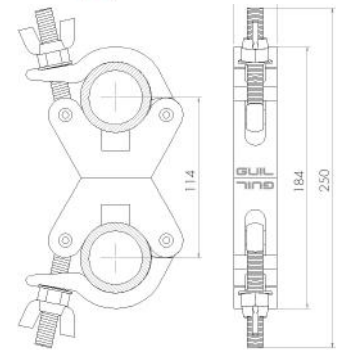

ABZ-31

Aluminium Stabiliser coupler with hinge/plug adaptor

- ⚖ 2,30 kg
- SWL 750 kg
- ∅ 45-52 mm

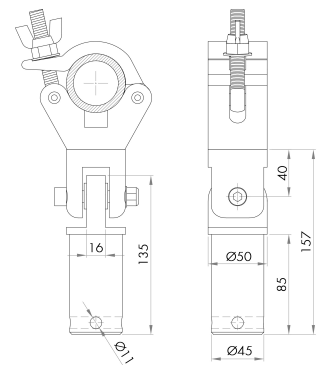

ABZ-32



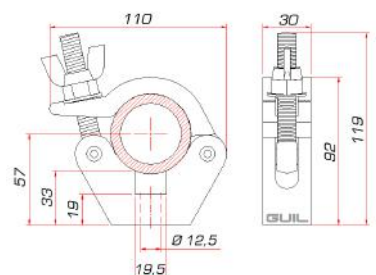

Aluminium Pivot Hinge Clamp Coupler

- ⚖ 1,75kg
- SWL 750 kg
- ∅ 45-52 mm



ABZ-34/N



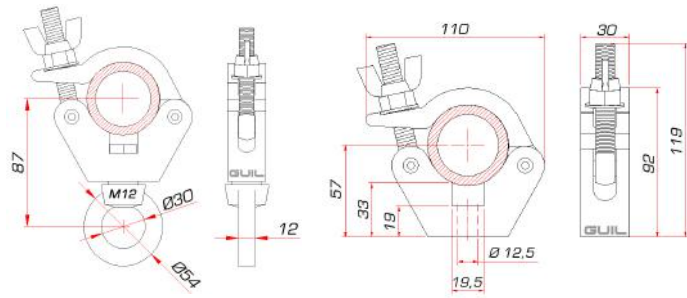

Aluminium Hanging Coupler

-  0,60 kg
-  SWL 300 kg
-  \varnothing 45-52 mm
-  M12



ABZ-35/N

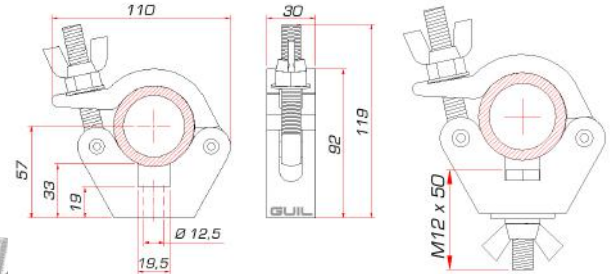

Aluminium Coupler with M12 bolt

-  0,48 kg
-  SWL 500 kg
-  \varnothing 45-52
-  T M12 x 50



ABZ-37



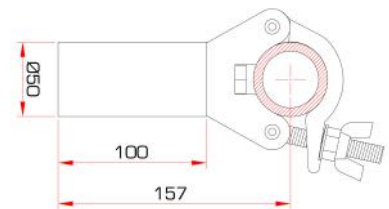

Aluminium Coupler with 50 mm spigot

-  1,20 kg
-  SWL 500 kg
-  \varnothing 45-52 mm



ABZ-51/N

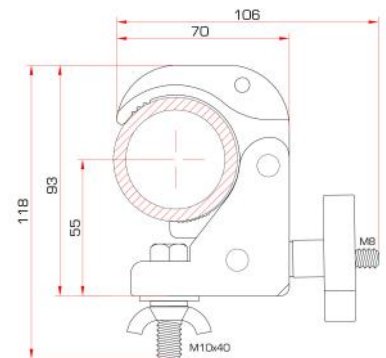

Mini quick fix Aluminium Clamp

-  0,30 kg
-  SWL 100 kg
-  \varnothing 48-51 mm
-  T M10 x 40

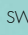

ABZ-07/E-N

Aluminium quick fix Clamp

-  0,54kg
-  SWL 100 kg
-  \varnothing 38-51 mm
-  T M10 x 35

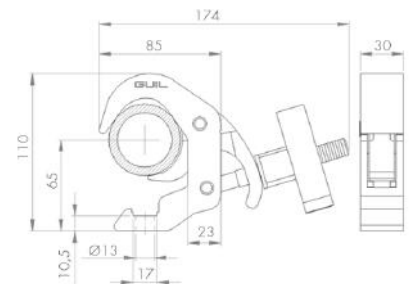

ABZ-55



Beam clamp adaptor to hang sound & light in marquees

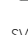

-  0,49 kg
-  SWL 50 kg
- \varnothing 80-110 mm
- T M10 x 35

Beam clamp with coupler to hang tubes and/or trusses in marquees



-  0,84 kg
-  SWL 50 kg
- \varnothing 45-52 mm
- \varnothing 80-110 mm

ABZ-56



BULL200D



Auto-brake winch with two handles

- Lifting capacity 275 Kg.
- Pulling capacity 550 Kg.

BULL300D



Auto-brake winch with two handles

- Lifting capacity 400 Kg.
- Pulling capacity 800 Kg.

BULL400D



Auto-brake winch with two handles

- Lifting capacity 590 Kg.
- Pulling capacity 1180 Kg.

BULL500D



Auto-brake winch with two handles

- Lifting capacity 650 Kg.
- Pulling capacity 1495 Kg.



CHAIN HOISTS

POLI-10



8 M - 1000 KG



POLI-11



10 M - 1000 KG



POLI-12



6 M - 2000 KG



BLC-01

CHAIN BAG WITH DOUBLE HANDLE

Reinforced internal base

- Internal Height: 32 cm
- Load Capacity: 35 Kg
- Base: Ø 25 cm
- Net Weight: 0,78 kg



BLC-05

CHAIN BAG WITH DOUBLE HANDLE

Reinforced internal base

- Internal Height: 53 cm
- Load Capacity: 35 Kg
- Base: Ø 25 cm
- Net Weight: 1 kg

