

Built for the Biggest Moments

Hilton San Francisco Union Square

Floor Plans &
Capacity Charts

TO
FI
FI

Floor Plans

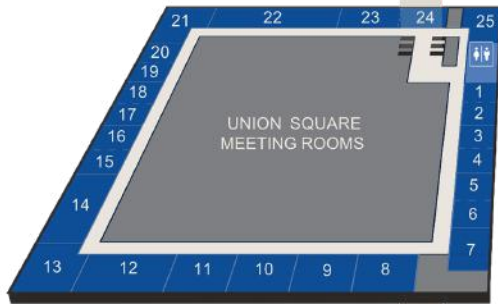
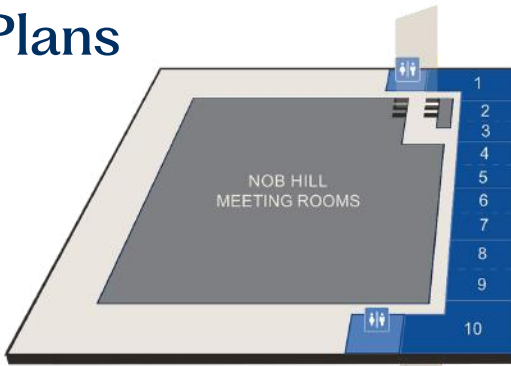

- ESCALATOR
- ELEVATOR
- STAIRS
- RESTROOM WOMEN
- RESTROOM MEN
- FITNESS
- DINING
- 1** T1 ELEVATOR
- 2** T2 ELEVATOR
- 3** T3 ELEVATOR

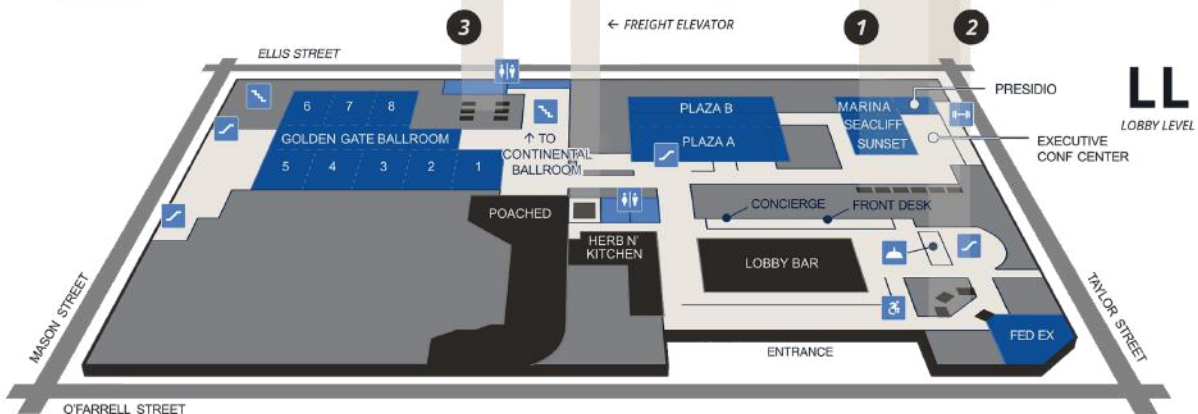
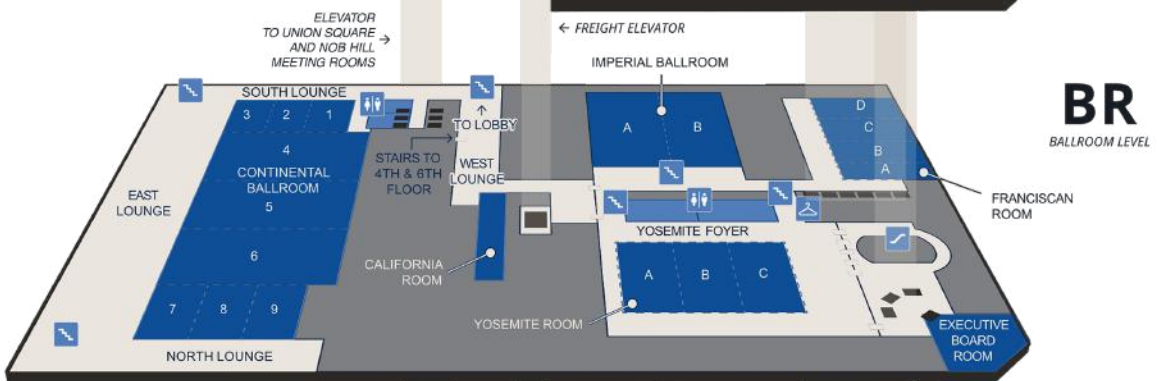
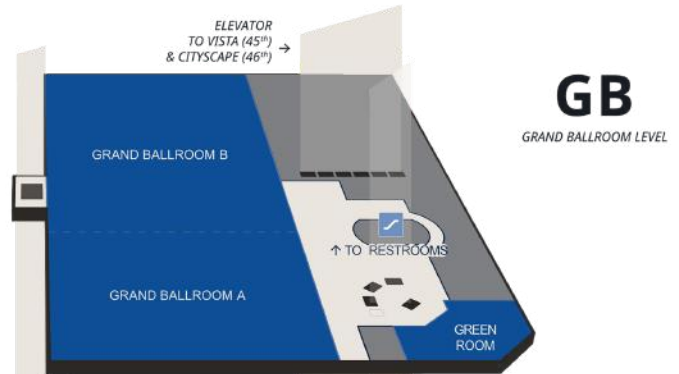

Tower 1, 2 & 3 / Lobby Level

Lobby Level	Square Feet	L x W x H	Classroom (2/3)	Theater	Conference	Banquet	U-Shape	Reception	Hollow Square	Exhibits 8 x 10	Exhibits 10 x 10
Golden Gate	14,312	163'6" x 158'8" x 10'6"	—	—	—	700	—	929	—	43	36
Golden Gate 1	759	23' x 33' x 10'6"	30/45	70	28	50	24	90	30	—	—
Golden Gate 2	1,032	24' x 43' x 10'6"	42/63	110	34	70	30	120	36	—	—
Golden Gate 3	1,032	24' x 43' x 10'6"	42/63	110	34	70	30	120	36	—	—
Golden Gate 4	1,032	24' x 43' x 10'6"	42/63	110	34	70	30	120	36	—	—
Golden Gate 5	984	24' x 41' x 10'6"	42/63	110	34	70	30	120	36	—	—
Golden Gate 6	1,008	24' x 42' x 10'6"	42/63	110	34	70	30	120	36	—	—
Golden Gate 7	1,032	24' x 43' x 10'6"	42/63	110	34	70	30	120	36	—	—
Golden Gate 8	1,032	24' x 43' x 10'6"	42/63	110	34	70	30	120	36	—	—
Plaza Room	6,237	77' x 81'7" x 10'	232/348	—	—	480	—	720	—	36	31
Plaza A	3,240	81'7" x 39'9" x 10'	134/201	360	—	230	60	370	48	17	12
Plaza B	2,997	81'7" x 36'10" x 10'	134/201	350	—	220	60	350	48	19	13





Executive Conference Center	Square Feet	L x W x H	Classroom (2/3)	Theater	Conference	Banquet	U-Shape	Reception	Hollow Square	Exhibits 8 x 10	Exhibits 10 x 10
Sunset Room	308	21'10" x 15'9" x 9'6"	—	—	12	—	—	—	—	—	—
Seacliff Room	456	22'3" x 20'6" x 9'6"	—	—	16	—	—	—	—	—	—
Marina Room	342	17'8" x 20'8" x 9'6"	—	—	10	—	—	—	—	—	—
Presidio Room	330	17'4" x 23'9" x 9'6"	—	—	12	—	—	—	—	—	—

Tower 1, 2 & 3 / Ballroom Level

Ballroom Level	Square Feet	L x W x H	Classroom (2/3)	Theater	Conference	Banquet	U-Shape	Reception	Hollow Square	Exhibits 8 x 10	Exhibits 10 x 10
Continental Ballroom	19,000	84'6" x 228'5" x 20'	800/1,200	2,200	—	1,620	—	2,100	—	101	91
Continental Ballroom 1	920	39'7" x 22'6" x 11'	40/60	90	34	70	30	106	36	—	—
Continental Ballroom 2	1,080	39'7" x 27'1" x 11'	48/72	110	34	80	30	124	36	—	—
Continental Ballroom 3	920	39'8" x 22'5" x 11'	40/60	90	34	70	30	106	36	—	—
Continental Ballroom 4	4,116	83'6" x 48'3" x 20'	180/270	475	—	400	66	475	72	25	15
Continental Ballroom 5	4,200	83'6" x 48'4" x 20'	180/270	475	—	400	66	483	72	25	15
Continental Ballroom 6	4,116	83'6" x 48'3" x 20'	180/270	475	—	400	66	475	72	25	15
Continental Ballroom 7	920	39'9" x 22'5" x 11'	40/60	90	34	70	30	106	36	—	—
Continental Ballroom 8	1,080	39'9" x 27'2" x 11'	48/72	110	34	80	30	124	36	—	—
Continental Ballroom 9	920	39'9" x 22'7" x 11'	40/60	90	34	70	30	106	36	—	—
North Lounge	1,625	25' x 13' x 9'8"	—	—	—	80	—	187	—	—	—
South Lounge	1,625	125' x 13' x 9'8"	—	—	—	—	—	187	—	—	—
East Lounge	6,200	260' x 26' x 9'8"	—	—	—	130	—	500	—	—	—
West Lounge	2,300	110' x 25' x 9'8"	—	—	—	80	—	250	—	—	—
California Room	794	17'11" x 102' x 9'8"	—	—	—	—	—	—	—	—	—
Imperial Ballroom	6,642	82'5" x 81'10" x 13'6"	300/450	750	—	500	—	765	80	32	27
Imperial A	3,280	82'5" x 40'9" x 13'6"	140/210	360	64	230	66	380	72	17	12
Imperial B	3,280	82'5" x 40'8" x 13'6"	140/210	360	64	230	66	380	72	17	12
Franciscan Room	5,600	54'8" x 96'4" x 10'	—	—	—	460	—	645	—	28	20
Franciscan A	990	44'9" x 21'8" x 10'	40/60	110	40	80	36	115	40	—	—
Franciscan B	990	44'9" x 24'10" x 10'	40/60	110	40	80	36	115	40	—	—
Franciscan C	990	44'9" x 24'9" x 10'	40/60	110	40	80	36	115	40	—	—
Franciscan D	990	44'9" x 24'7" x 10'	40/60	110	40	80	36	115	40	—	—
Yosemite Room	11,685	122'8" x 94'9" x 13'	—	—	—	742	—	1350	—	55	45
Yosemite A	1,127	48'4" x 23'1" x 13'	48/72	130	38	90	36	130	42	—	—
Yosemite B	1,200	48'4" x 32'1" x 13'	60/90	160	38	130	39	140	46	—	—
Yosemite C	1,127	48'4" x 23'2" x 13'	48/72	130	38	90	36	130	42	—	—
Executive Boardroom	680	32'6" x 32'5" x 10'	—	—	20	30	—	—	—	—	—

Tower 2 / Grand Ballroom Level

Grand Ballroom Level	Square Feet	L x W x H	Classroom (2/3)	Theater	Confence	Banquet	U-Shape	Reception	Hollow Square	Exhibits 8 x 10	Exhibits 10 x 10
Grand Ballroom	29,637	267'6" x 111' x 23'2"	1,132/1,698	3,000	—	2,600	—	3,415	—	182	157
Grand Ballroom A	9,657	87'2" x 111' x 14'9"	400/600	800	—	740	—	1,110	—	56	45
Grand Ballroom B	19,980	180' x 111' x 23'2"	800/1,200	2,250	—	1,760	—	2,290	—	126	108
Grand Ballroom Foyer	1,311	69'9" x 19'4" x 11'6"	—	—	—	—	—	—	—	—	—
Green Room	680	32'11" x 33' x 11'6"	—	—	20	30	—	—	—	—	—

-  ESCALATOR
-  ELEVATOR
-  STAIRS
-  RESTROOM WOMEN
-  RESTROOM MEN
-  FITNESS
-  DINING
-  T1 ELEVATOR
-  T2 ELEVATOR
-  T3 ELEVATOR

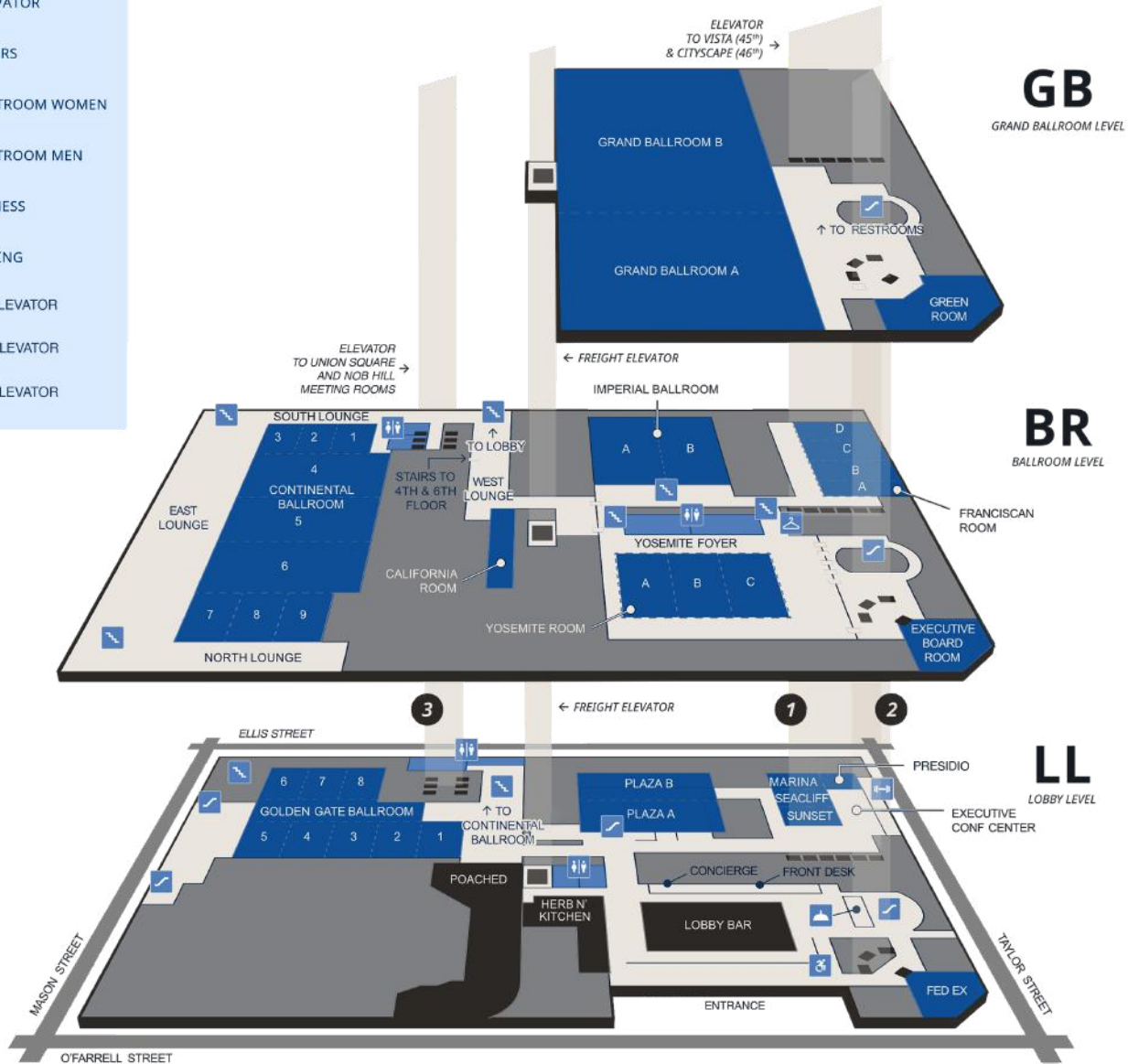

Tower 3 / Fourth Floor

Fourth Floor	Square Feet	L x W x H	Classroom (2/3)	Theater	Conference	Banquet	U-Shape	Reception	Hollow Square	Exhibits 8 x 10	Exhibits 10 x 10
Union Square 1 & 2	730	49'7" x 15'8" x 8'3"	32/48	90	40	60	40	85	—	—	—
Union Square 1	340	22'2" x 15'8" x 8'3"	14/21	35	16	30	16	40	—	—	—
Union Square 2	380	27'3" x 15'8" x 8'3"	14/21	45	22	30	22	45	—	—	—
Union Square 3 & 4	760	49'7" x 15'8" x 8'3"	32/48	90	40	60	40	85	—	—	—
Union Square 3	340	22'2" x 15'8" x 8'3"	14/21	35	16	30	16	40	—	—	—
Union Square 4	418	27'2" x 15'8" x 8'3"	14/21	45	22	30	22	45	—	—	—
Union Square 5 & 6	760	48'7" x 15'8" x 8'3"	32/48	90	40	60	40	85	—	—	—
Union Square 5	356	22'2" x 15'8" x 8'3"	14/21	35	16	30	16	40	—	—	—
Union Square 6	403	26'2" x 15'8" x 8'3"	14/21	45	22	30	22	45	—	—	—
Union Square 7	320	23'1" x 13'7" x 8'3"	8/12	20	10	20	10	40	—	—	—
Union Square 8	365	15'7" x 23'7" x 8'3"	14/21	35	16	20	16	40	—	—	—
Union Square 9	380	15'8" x 24'7" x 8'3"	14/21	35	16	30	16	40	—	—	—
Union Square 10	380	15'8" x 24'7" x 8'3"	14/21	35	16	30	16	40	—	—	—
Union Square 11	380	15'8" x 24'7" x 8'3"	14/21	35	16	30	16	40	—	—	—
Union Square 12	365	15'8" x 23'8" x 8'3"	14/21	35	16	30	16	40	—	—	—
Union Square 13	518	15'8" x 36'10" x 8'3"	24/36	60	34	50	34	60	—	—	—
Union Square 14	620	40'4" x 15'7" x 8'3"	24/36	60	34	50	34	70	—	—	—
Union Square 15 & 16	960	62'9" x 15'7" x 8'3"	40/60	110	52	80	50	110	—	—	—
Union Square 15	480	31' x 15'7" x 8'3"	20/30	50	24	40	24	55	—	—	—
Union Square 16	480	31'5" x 15'7" x 8'3"	20/30	50	24	40	24	55	—	—	—
Union Square 17 & 18	760	49'6" x 15'6" x 8'3"	32/48	90	40	60	40	85	—	—	—
Union Square 17	341	21'5" x 15'6" x 8'3"	14/21	35	16	30	16	40	—	—	—
Union Square 18	419	27'10" x 15'6" x 8'3"	14/21	45	22	30	22	50	—	—	—
Union Square 19 & 20	930	60'3" x 15'7" x 8'3"	49/60	105	52	80	50	105	—	—	—
Union Square 19	465	29'11" x 15'7" x 8'3"	20/30	45	24	40	24	55	—	—	—
Union Square 20	465	30' x 15'7" x 8'3"	20/30	45	24	40	24	55	—	—	—
Union Square 21	532	36'11" x 15'7" x 8'3"	26/39	70	34	50	34	60	—	—	—
Union Square 22	960	15'8" x 61'11" x 8'3"	40/60	110	52	80	50	110	—	—	—
Union Square 23 & 24	930	15'7" x 60'3" x 8'3"	40/60	100	52	80	50	105	—	—	—
Union Square 23	465	15'7" x 29'7" x 8'3"	20/30	50	24	40	24	55	—	—	—
Union Square 24	465	15'7" x 30'4" x 8'3"	20/30	50	24	40	24	55	—	—	—
Union Square 25	518	36'11" x 15'8" x 8'3"	26/39	70	34	50	34	60	—	—	—

Tower 3 / Sixth Floor

Sixth Floor	Square Feet	L x W x H	Classroom (2/3)	Theater	Conference	Banquet	U-Shape	Reception	Hollow Square	Exhibits 8 x 10	Exhibits 10 x 10
Nob Hill 1	518	36'8" x 15'6" x 8'3"	26/39	50	34	50	34	60	—	—	—
Nob Hill 2/3	760	48'5" x 15'7" x 8'3"	32/48	90	40	60	40	85	—	—	—
Nob Hill 2	370	23'7" x 15'6" x 8'3"	14/21	40	16	30	16	40	—	—	—
Nob Hill 3	390	24'7" x 15'6" x 8'3"	14/21	40	22	30	22	45	—	—	—
Nob Hill 4/5	760	49'6" x 15'6" x 8'3"	32/48	90	40	60	40	85	—	—	—
Nob Hill 4	370	24'9" x 15'6" x 8'3"	14/21	40	16	30	16	40	—	—	—
Nob Hill 5	390	24'6" x 15'6" x 8'3"	14/21	40	22	30	22	45	—	—	—
Nob Hill 6/7	760	49'7" x 15'6" x 8'3"	32/48	90	40	60	40	85	—	—	—
Nob Hill 6	370	24'9" x 15'6" x 8'3"	14/21	40	16	30	16	40	—	—	—
Nob Hill 7	390	24'7" x 15'6" x 8'3"	14/21	40	22	30	22	45	—	—	—
Nob Hill 8/9	760	48'6" x 15'6" x 8'3"	32/48	90	40	60	40	85	—	—	—
Nob Hill 8	370	24'9" x 15'6" x 8'3"	14/21	40	16	30	16	40	—	—	—
Nob Hill 9	390	23'5" x 15'6" x 8'3"	14/21	40	22	30	22	45	—	—	—
Nob Hill 10	518	37'1" x 15'6" x 8'3"	26/39	50	34	50	34	60	—	—	—

Tower 1 / Forty-Fifth Floor

Forty-Fifth Floor	Square Feet	L x W x H	Classroom (2/3)	Theater	Conference	Banquets	U-Shape	Reception	Hollow Square	Exhibits 8 x 10	Exhibits 10 x 10
Vista	1,675	107' x 16' x 9'6"	—	—	—	70	—	100	—	—	—

Tower 1 / Forty-Sixth Floor

Forty-Sixth Floor	Square Feet	L x W x H	Classroom (2/3)	Theater	Conference	Banquet	U-Shape	Reception	Hollow Square	Exhibits 8 x 10	Exhibits 10 x 10
Cityscape	8,516	67' x 132'	—	—	—	180	—	270	—	—	—

Hilton®

SAN FRANCISCO
UNION SQUARE

Hilton San Francisco
Union Square

HiltonSanFranciscoUnionSquare.com

333 O'Farrell Street
San Francisco, CA 94102
T: +1 (415) 771-1400
SFOFH-SalesADM@Hilton.com

© 2026 Hilton. All rights reserved.