



REBUILD
to **SERVE**

Strengthening Our Foundation for the Future



As each one has received a gift, use it to serve one another as good stewards of God's varied grace.
— 1 Peter 4:10

LETTER FROM OUR PASTOR, FR FABIO

Dear Parishioners,

In early 1993, 44 families gathered with the guidance of Fr. John Giuliani, on faithful hope and prayer, to establish a Mission Church known as the Fort Mill/Tega Cay Catholic Community. Initially, Masses were celebrated on Saturday afternoons at Lake Wylie Lutheran Church in Fort Mill before moving to the Fellowship Hall at Philadelphia United Methodist Church. In 1994, after being named St. Philip Neri Catholic Church, the parish began a journey of growing and building, culminating in the dedication of the sanctuary in May 2013.

More than a quarter century after the founding of our parish, St. Philip Neri Catholic Church continues to serve the growing Fort Mill community. Now, the Holy Spirit prompts us to take additional steps to enable our parish community to continue evolving and growing closer to Christ.

In my time as your pastor, I have witnessed Christ at work in our faith community, and I know He has guided us in the building of its rich history. I am blessed and privileged to be a part of all that is happening here at St. Philip Neri. I am deeply grateful to those individuals and families who have come before me to build the church we enjoy today and who have established the foundation of what we hope to pass on to future generations.

So how do we strengthen our foundation for the future? After months of prayer, study and consideration, the leadership of our parish has decided to move forward and rebuild an expanded Fr. John Giuliani Parish Center on the existing location and build a new 2 story building that will include the St. Philip Neri Child Development Center (CDC) on the first floor and a future Activity Center for the parish on the second floor.

This will ensure the faith life of our parish family both today and tomorrow for generations to come and provide an unrestricted opportunity to continue to carry out the mission of our parish – to form a church family dedicated to continuing the ministry of Christ. The proposed buildings will provide much needed additional space for evangelization, adult, youth and family faith formation, hospitality and outreach, ministry growth and community opportunities.

With the theme, ***Rebuild to Serve: Strengthening Our Foundation for the Future***, we are embarking on an ambitious \$8 million campaign. Through your faithful generosity, \$2 million has already been allocated from our Future Growth and Expansion Fund combined with our parish savings, leaving the remaining \$6 million to be raised through this campaign. The information in this brochure provides an overview of this critical project. I understand this campaign is an important undertaking. All of us must pray for the success of this campaign, lend our many God-given talents to its completion, and make a financial commitment on all our parts to make it happen.

Thank you for all you have done and continue to do to make St. Philip Neri Catholic Church such an incredible parish community and thank you for your support and generosity in this endeavor.

God bless you all,



Fr Fabio Refosco, C.O.
Pastor



The best path forward to strengthen our foundation for the future is to rebuild.

THE NEED

Our current Fr. John Giuliani Parish Center has been problematic since being built in 1998. Beginning with the damage to the roof caused by the “storm of the century” in 2004, the building has continued to present ongoing challenges. Even after initial repairs, over time, the cost to repair the Parish Center had ballooned to over \$2 million, and with the current prevailing economic challenges, the cost of repairs will only increase. Even still, the Parish Center would not meet our current or future needs. With the Child Development Center occupying the building Monday through Friday until noon, that leaves little opportunity for other ministry activities. Quite simply, there is no place for parish ministries and activities to grow.

THE SOLUTION

Based on previous feasibility studies, and after much prayer and planning, parish leadership has determined that the best path forward to strengthen our foundation for the future is to rebuild an expanded Fr. John Giuliani Parish Center on the existing location and build a new, 2 story building that will house the St. Philip Neri Child Development Center on the first floor and a future Parish Activity Center on the second floor.

The proposed and better equipped Fr, John Giuliani Parish Center, as well as the new future Parish Activity Center, will provide much needed additional space for evangelization, outreach, hospitality and community service and involvement. The new Child Development Center will help us better carry out our educational mission.





FENCED
PLAY AREA

FUTURE CHILD
DEVELOPMENT CENT

COURTYARD

MINISTRY
BUILDING

COLUMBARIUM

FUTURE
PARISH HA

MAINTENANCE

FUTURE
COLUMBARIUM



REBUILD
to **SERVE**

Today and tomorrow for generations to come.

FR JOHN GIULIANI PARISH CENTER & FLOOR PLAN

For years, faithful parishioners like you have desired to increase ministry and community opportunities. As ideas for these opportunities have been presented to parish leaders, more often than not, they have gone unfulfilled. Quite simply, our facilities are at full capacity and unable to accommodate any growth. The new, expanded Fr. John Giuliani Parish Center will finally provide a place for us to expand our parish and local community involvement.

Upon entering the building, the lobby will house a pre-function space with restrooms located adjacent to the Parish Center Hall. The Parish Center Hall has been enlarged to provide additional gathering space to accommodate events. An enlarged and better equipped kitchen will be located adjacent to the Hall with direct access for catering. In addition, the new space will provide much needed additional space for evangelization, formation opportunities and ministry growth to better serve our faith and local community today and tomorrow for generations to come.

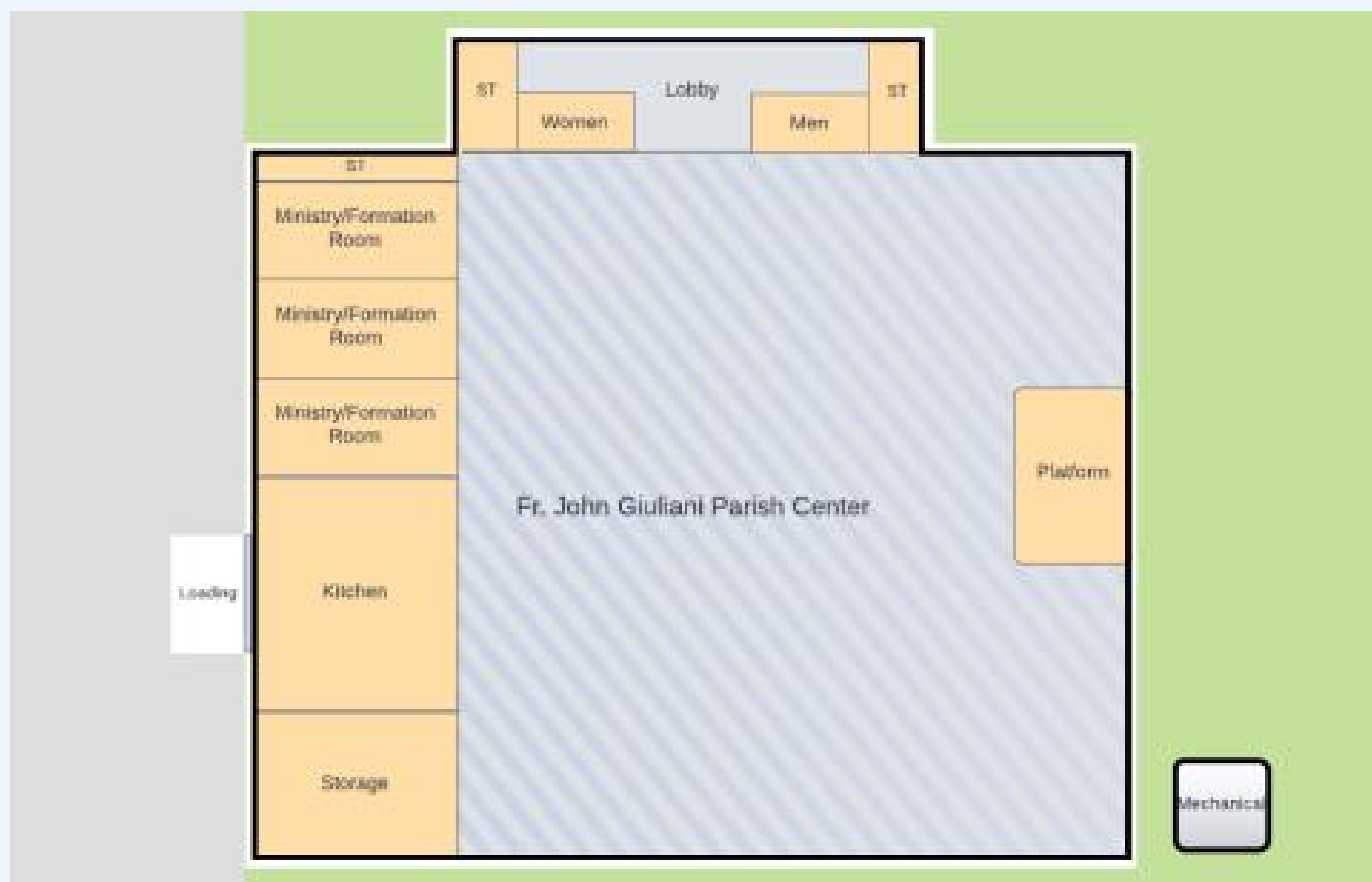

(Please note that the building renderings and floor plans represented in this brochure are illustrations of the initial architectural designs of the project. Actual designs may vary as the project progresses.)

CHILD DEVELOPMENT CENTER & FLOOR PLAN

Many years ago, our parish leadership felt the prompting of the Lord to begin a faith-based early child development center. This has become part of our educational mission here at St. Philip Neri Catholic Church. At our center, we believe that each child is unique and a special gift from God. We focus on developing social and school behaviors in a nurturing Christian environment while gently guiding each child to his/her potential spiritually, socially and academically. The new Child Development Center space will better enable us to carry out these goals.

The first level of the new 2 story building will be dedicated to the Child Development Center. Entry will be provided from the revised courtyard drop-off loop on the south side of the building. Administrative offices and public spaces are located near the entry, with restricted access to the classroom areas beyond. The classroom wing is a double corridor of classrooms with shared restroom facilities that will provide capacity for 124 children. Additional specialty rooms will include a computer lab, library, and music room. Two secured play areas will be provided near the courtyard and the western edge of the site to ensure the safety of the children.



(Please note that the building renderings and floor plans represented in this brochure are illustrations of the initial architectural designs of the project. Actual designs may vary as the project progresses.)

FUTURE PARISH ACTIVITY CENTER & FLOOR PLAN

The second level of the new building will be dedicated for parish use. Initially the interior will remain unfinished and ready for future configuration of additional ministry, meeting, and formation rooms as we continue to respond to the needs of our growing faith and local community.

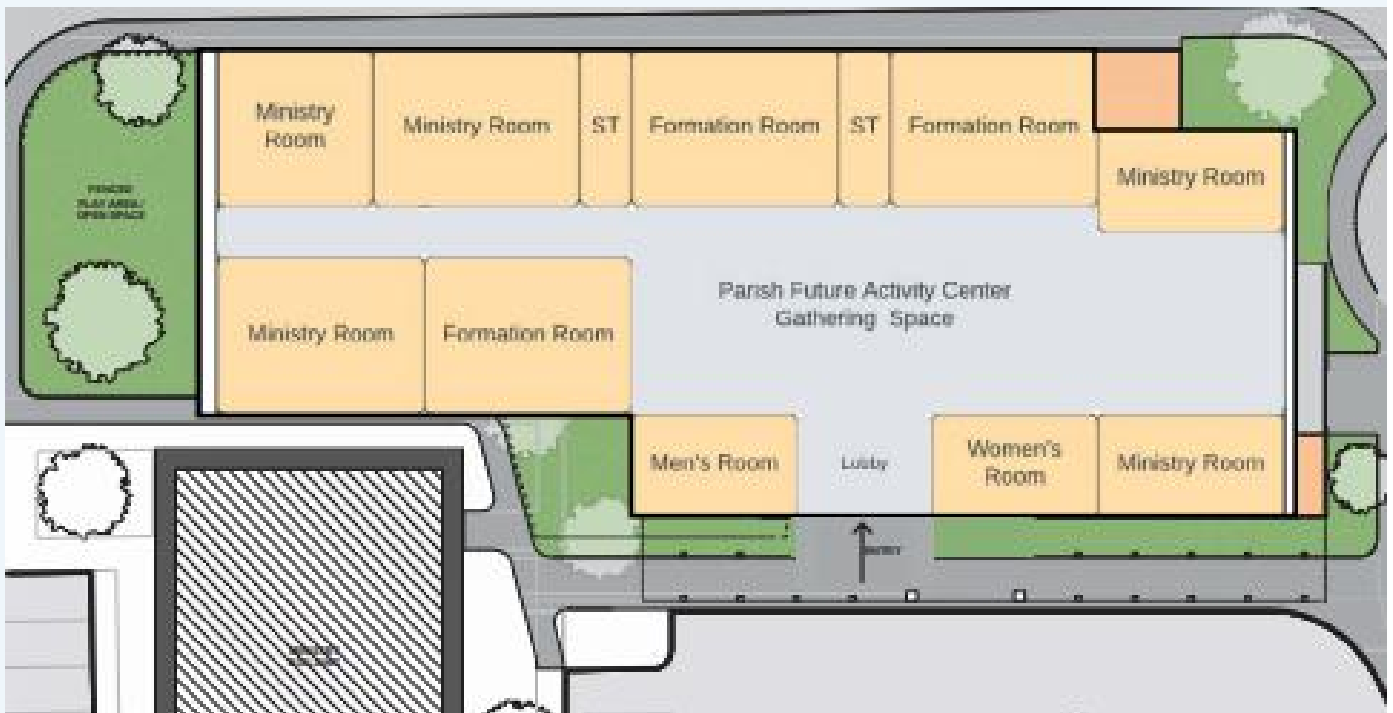

(Please note that the building renderings and floor plans represented in this brochure are illustrations of the initial architectural designs of the project. Actual designs may vary as the project progresses.)

It is about God's people.

THE COST

Expanding our campus footprint to ensure that we are able to respond to our growing parish and local community has been on the minds and hearts of our parish leadership for many years. This past year, our leadership looked into what it would take to build our new Fr. John Giuliani Parish Center and the new 2-story building that would house the St. Philip Neri Child Development Center and the future Parish Activity Center. The group met with several contractors and took bids on the project. After careful consideration, we have finalized our plan to administer the project, and we are now ready to begin to ***Rebuild to Serve and Strengthen Our Foundation for the Future.***

The cost of the project is an estimated \$8 million. Through your faithful generosity, \$2 million has already been allocated from our Future Growth and Expansion Fund combined with our parish savings, leaving the remaining \$6 million to be raised through this campaign. Going forward, the Future Growth & Expansion Fund will become the Rebuild to Serve Fund.

Ultimately, this campaign is not just about money or buildings; it is about God's people. It is about how can we be good disciples and grow our community to serve the mission set forth by the parishioners of St. Philip Neri Catholic Church.



HOW CAN I SUPPORT THE BUILDING CAMPAIGN?

MAKE A FIVE-YEAR FINANCIAL PLEDGE

There are many ways for us to fund this project, but no matter what method is utilized, we are reliant upon your generosity. Please consider an ongoing gift over the five-year life of the campaign. In addition to one-time gifts, ongoing gifts are essential to us reaching our campaign goal. We are grateful for all commitments regardless of the size and scope of the gift. A pledge to a campaign like this is not legally binding; it is merely a statement of your faith and intentions.

WHAT CAN I USE TO MAKE A PLEDGE?

Pledges can be made with cash, check, or a credit/debit card. Complete the pledge card, making sure to indicate both the method of payment, as well as the timeframe for the payment (monthly, quarterly, semi-annually, annually). You will be sent payment reminders in accordance with the payment schedule you select.

DO YOU ACCEPT GIFTS OF PROPERTY, LIFE INSURANCE, OR ANNUITIES?

Yes, we can work with you on ways to give using those resources. For individuals age 70 1/2 and over, it is possible to make a tax-free transfer as part of your Required Minimum Distribution for your IRA directly to St. Philip Neri. Contact the parish office for more information.

WHAT ABOUT GIFTS OF STOCK AND SECURITIES?

A gift of stock and securities is another giving option. If you wish to make a gift of stock or securities, consult with your financial advisor, and contact the parish office for information and to make the necessary arrangements.

KEEP IN MIND THE TWO FACETS OF GIVING:

Offertory: Your weekly or regular contribution to the parish collection is just as important now as ever. Please do not deduct from that to make a gift to the campaign.

Rebuild to Serve Campaign: Commitments and payments to the campaign are in addition to your regular offertory contributions. Gifts to the campaign are restricted to the goals and purposes of this particular campaign.

Gifts are essential to us
reaching our campaign goal.

HOW CAN I SUPPORT THE CAPITAL CAMPAIGN

IF YOUR GOAL IS TO:



THEN YOU CAN:



AND YOUR BENEFITS ARE:

Make a quick and easy gift	Simply write a check now	A possible income tax deduction and immediate impact for us
Limit taxable income	For qualifying individuals, donate by fulfilling your Required Minimum Distribution	A possible income tax reduction
Avoid a tax on capital gains	Contribute long-term appreciated stock or other securities	A possible charitable deduction plus no capital gains tax
Share your enjoyment of a collection/personal item	Donate tangible personal property related to our exempt function	A possible charitable deduction plus no capital gains tax
Make a revocable gift during your lifetime	Name us the beneficiary of assets in a living trust	Full control of the trust terms for your lifetime
Defer a gift until after your lifetime	Put a bequest in your will (give us cash, specific property, or a share of the residue)	Your donations are fully exempt from estate tax
Make a large gift with little cost to yourself	Contribute a life insurance policy you no longer need	Possible charitable deductions
Avoid the twofold taxation on IRA or other employee benefit plans	Name us as the beneficiary of the remainder of the assets after your lifetime	Avoid probate and possible lower tax liability for your family
Avoid capital gains tax on the sale of a home or other real estate	Donate the property to us, or sell it to us at a bargain price	A possible income tax deduction, plus reduction or elimination of capital gains tax

For more detailed information, please consult with your tax and financial/investment advisor.



Do not let a day pass without doing some good in it.

ST. PHILIP NERI MISSION STATEMENT

St. Philip Neri Catholic Church is made up of a vibrant, faithful people who serve our parish and our community in numerous ways, from worship, religious education and formation, sacramental preparation and spiritual development, to community outreach and social activities.

We strive to be a welcoming parish that reflects the heart, mercy and teachings of Christ, the traditions of the Roman Catholic Church, and the spirit of joy manifested by our patron saint St. Philip Neri. We pray you find St. Philip Neri Church a warm and welcoming home and a place where you can deepen your faith and become a special part of our Catholic community.

PRAYER TO ST. PHILIP NERI

O holy St. Philip Neri, patron saint of joy, you who trusted Scripture's promise that the Lord is always at hand and that we need not have anxiety about anything, in your compassion heal our worries and sorrows and lift the burdens from our hearts.

We come to you as one whose heart swells with abundant love for God and all creation. Hear us we pray. Keep us safe through your loving intercession and may the joy of the Holy Spirit which filled your heart, St. Philip, transform our lives and bring us peace.

AMEN



**REBUILD
to SERVE**

LETTER FROM OUR CAMPAIGN LEADERS

Fellow Parishioners,

We are fortunate to be members of St. Philip Neri Catholic Church.

This faith community is incredibly unique with its rich foundation, warm hospitality, and ongoing work in the surrounding community. As fellow parishioners, our faith lives have grown through our continual involvement in parish life.

Like you, we want to continue the good work St. Philip Neri parish has done **by *Strengthening Our Foundation for the Future***. This Church has had a tremendous impact on us and the development of our faith. That is why we are willing to serve as the chairperson and advisors of the campaign in the effort to raise the \$8 million for the new Fr. John Giuliani Parish Center and the new Child Development and Future Activity Center.

We believe these new buildings are needed for our current families and future generations to continue to flourish. These new spaces will help us to live out our parish mission to be a welcoming parish that reflects the heart, mercy, and teachings of Christ, serving our parish and our community in numerous ways, from worship, religious education and formation, and spiritual development to community outreach and social activities.

We are all blessed by those parishioners who previously established the foundation of our parish community, and we have also been blessed with the leadership and guidance of our pastor, Fr. Fabio Refosco.

We are honored to serve as leaders for the building campaign, and we thank you for your generosity in all that you have done to make St. Philip Neri a place where people can feel welcome. As you are aware, to complete a project of this magnitude is very costly, as there are many up-front costs for planning and site preparation. Parish leadership has engaged in discussions, reviewed facility studies, and carefully considered many different options to bring us to this point today.

The new Fr. John Giuliani Parish Center, and the new Child Development and Parish Activity Center building will provide a viable place for our parish community to serve for many generations to come. We must consider this a tremendous opportunity to give something back to the parish community of St. Philip Neri in an incredible way.

Blessings,

Jerry Sajbel, *Campaign Chairperson*

Tim and Cindy Kelly, *Campaign Advisors*



REBUILD TO SERVE Strengthening Our Foundation for the Future

I/We pledge over a 5-year period:

NO GIFT IS TOO LARGE; NO GIFT IS TOO SMALL!

MONTHLY \$ _____ QUARTERLY \$ _____ SEMI-ANNUALLY \$ _____ ANNUALLY \$ _____

TOTAL PLEDGE \$ _____ PAYMENT AT THIS TIME \$ _____ BALANCE \$ _____

Please select ONE payment method:

CREDIT CARD: CARD # _____ EXP. DATE _____ CV# _____

NAME ON CARD _____

CHECK: Please make check payable to *St. Philip Neri Catholic Church*, noting it is for the "Rebuild to Serve" Campaign.

I would like to give a gift of property, life insurance, annuities, stocks, or securities to the campaign.
We will contact you to make the necessary arrangements.

ELECTRONIC FUNDS TRANSFER: Please include your voided check.

NAME _____ EMAIL _____

STREET _____ CITY/STATE/ZIP _____ PHONE _____

AUTHORIZED SIGNATURE _____



**REBUILD
to SERVE**

ST. PHILIP NERI CATHOLIC CHURCH 292 MUNN ROAD EAST FORT MILL, SC 29715

SUGGESTED GIFT PLANS OVER FIVE YEARS

TOTAL COMMITMENT	10% INITIAL PAYMENT	5 ANNUAL PAYMENTS	20 QUARTERLY PAYMENTS	60 MONTHLY PAYMENTS	AMOUNT PER WEEK	AMOUNT PER DAY
\$100,000	\$10,000	\$18,000	\$4,500	\$1,500	\$346	\$49.32
\$50,000	\$5,000	\$9,000	\$2,250	\$750	\$173	\$24.66
\$30,000	\$3,000	\$5,400	\$1,350	\$450	\$104	\$14.79
\$25,000	\$2,500	\$4,500	\$1,125	\$375	\$87	\$12.33
\$20,000	\$2,000	\$3,600	\$900	\$300	\$69	\$9.86
\$15,000	\$1,500	\$2,700	\$675	\$225	\$52	\$7.40
\$10,000	\$1,000	\$1,800	\$450	\$150	\$35	\$4.93
\$7,500	\$750	\$1,350	\$338	\$113	\$26	\$3.70
\$5,000	\$500	\$900	\$225	\$75	\$18	\$2.47
\$2,500	\$250	\$450	\$113	\$38	\$9	\$1.23
\$1,000	\$100	\$180	\$45	\$15	\$3	\$0.49

Payment schedules shown reflect an initial payment of 10%. Without such an initial payment, subsequent periodic payments will be slightly higher.



REBUILD TO SERVE: STRENGTHENING OUR FOUNDATION FOR THE FUTURE

CAMPAIGN PRAYER

Heavenly Father,

We, the community of St. Philip Neri, give thanks to you for our past and present gifts of faith and fellowship that we have experienced in the spirit of caring and giving.

As we embark upon this campaign to Rebuild to Serve on the foundation laid by our dedicated forebearers in faith, we lift our hearts in gratitude to you, O Lord, for their wisdom, devotion, worship, service, and love for this blessed parish.

Trusting in your love, help us to move forward with willing and generous hearts, so that we can continue to serve with courage, love, and steadfastness, in gratitude and joy to glorify you, our Lord and Savior.

We ask this through the intercession of our Patron Saint Philip Neri, and our Lord Jesus Christ, who lives and reigns forever and ever.

AMEN

OUR SCHEDULE

Plan Design & Cost Estimate

February 2022

Solicitation of Pledges

Spring/Summer 2023

Campaign Results & Recommendations

Fall 2023

Begin Construction

Planned for 2023/24

Project Complete

Planned for 2025