

TEENUT® FASTENERS

Round Base: 3 Rivet or Nail Holes for Assembly

Material: Low Carbon Steel, Zinc Finish

For applications into materials of high density and where repeated bolt removal and replacement is expected.

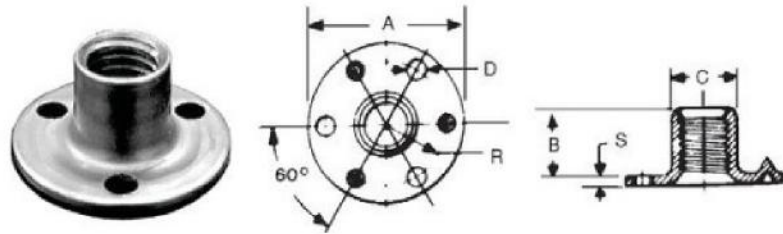

Part No.	Thread Size	A	B	C	D + .005	R	S	Unit Pkg.
18341	1/4"-20	3/4"	5/16"	.311/.306"	.098"	19/64"	.050"	50
2262	3/8"-16	1"	1/2"	.471/.466"	.145"	5/64"	.075"	100

Claw Prongs: Round Base

Material: Low Carbon Steel, Plain Finish

This Long Prong Teenut has six claw-like prongs that penetrate into wood, toe in, and grip so tightly that you have to drive it to back it out of its hole.

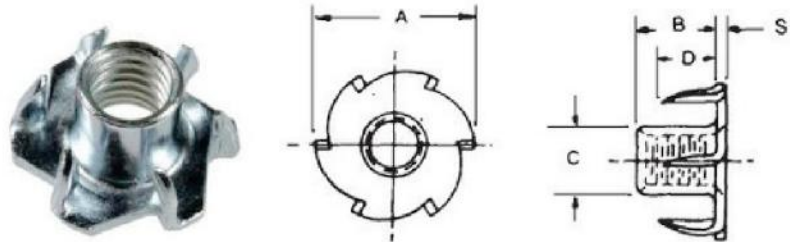

Part No.	Thread Size	A	B	C	D	S	Unit Pkg.
10729	10-24	3/4"	9/32"	.232/.227"	13/64"	.035"	50
11324	1/4"-20	3/4"	5/16"	.294/.289"	15/64"	.042"	50
10730	1/4"-20	3/4"	7/16"	.294/.289"	15/64"	.042"	50
10731	5/16"-18	7/8"	3/8"	.369/.364"	19/64"	.052"	50
10732	3/8"-16	1.0"	7/16"	.448/.443"	11/32"	.062"	25

Claw Prongs: Slimline, Round Base

Material: Low Carbon Steel, Plain Finish

Recommended where superior retention in soft wood is required.

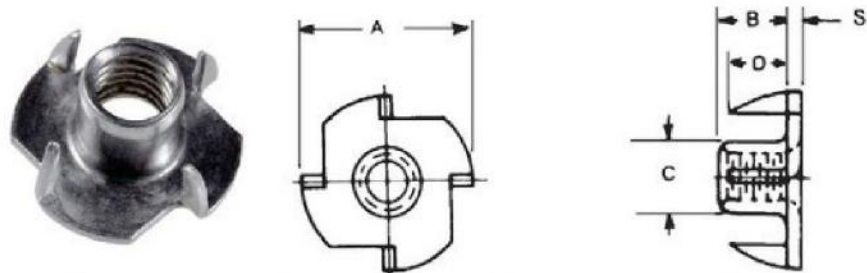

Part No.	Thread Size	A	B	C	D	S	Unit Pkg.
11325	1/4"-20	3/4"	5/16"	.294/.289"	15/64"	.042"	100
11326	5/16"-18	7/8"	3/8"	.369/.364"	19/64"	.052"	50
11327	3/8"-16	1.00"	7/16"	.448/.443"	11/32"	.062"	25

Claw Prongs: Slimline, Round Base

Material: 300 Series Stainless Steel, Plain Finish

Part No.	Thread Size	A	B	C	D	S	Unit Pkg.
17013	1/4"-20	3/4"	5/16"	19/64"	3/16"	.047"	25

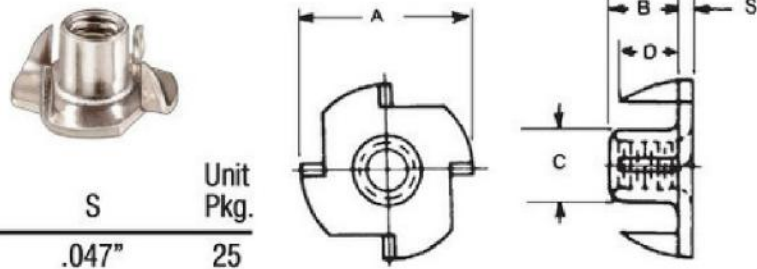

Straight Prongs: Round Base

Material: Low Carbon Steel, Plain Finish

This Teenut is recommended for thick material applications and applications requiring the top of the barrel to provide a bearing surface for mating parts.

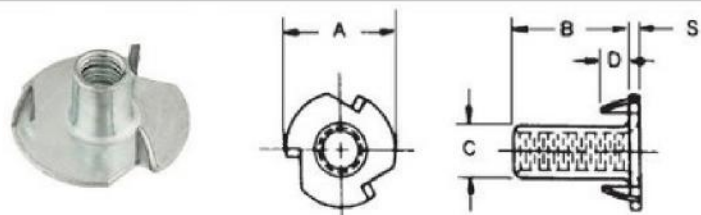

Part No.	Thread Size	A	B	C	D	Type	S	Unit Pkg.
11328	6-32	9/16"	15/64"	.164/.157"	1/8"	3 Prongs	.020"	50
11331	10-32	3/4"	9/32"	.232/.227"	13/64"	3 Prongs	.035"	50
11332	1/4-20	3/4"	5/16"	.311/.306"	15/64"	4 Prongs	.050"	50

THIN SHEET NUTSERT® INSERTS

U.S.S., S.A.E. & Metric - Steel and Aluminum

How it Works

The Thin Sheet Nutsert, held securely by the tool, is placed into a prepared hole. Upon the tool's actuation, the threaded portion is pulled until the fastener's wall collapses radially outward, clinching it tight against the sheet. The tool is withdrawn, leaving the Thin Sheet Nutsert ready to receive a bolt or screw. This complete operation takes only a few seconds and can be performed by anyone.

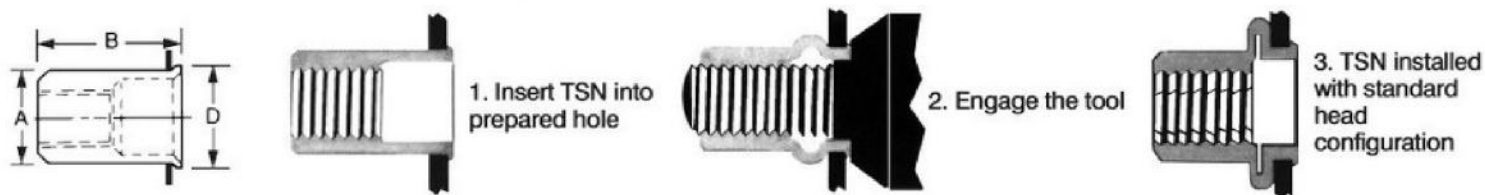

Strength Tests: Torque Strength: with an attaching part over the Thin Sheet Nutsert, offering a bearing surface, the TSN will remain intact past the point of the screw or bolt breaking (head torqued off). In almost all cases the threads of the TSN will remain undistorted and serviceable; an exception to this statement is when an extremely high tensile bolt is used.

Steel: 1010 Low Carbon Steel, Type 11 Class 3 with Zinc Plate, Clear Chromate

Aluminum: Aluminum Alloy 5056, Plain Finish, Metric Class 6H, U.S. Class 2B

U.S.S. & S.A.E.

Steel	Part No. Aluminum	Unit Pkg.	Thread Size after Installation	Recommended Grip Range	A Max.	B Max.	D Ref.	Hole Size	Drill Size
11310	13476	50	6-32 U.S.S.	.020-.080"	.249"	.410"	.287"	.250-.254"	1/4"
11315	13477	100							
11311		50	8-32 U.S.S.	.020-.080"	.249"	.410"	.287"	.250-.254"	1/4"
11316		100							
11312	13480	50	10-24 U.S.S.	.020-.130"	.280"	.465"	.320"	.281-.285"	9/32"
11317	13481	100							
12978		50	10-32 S.A.E.	.020-.130"	.280"	.465"	.320"	.281-.285"	9/32"
12979		100							
11313		25	1/4"-20 U.S.S.	.030-.165"	.347"	.610"	.415"	.375-.379"	3/8"
11318		100							
11314		25	5/16"-18 U.S.S.	.040-.200"	.499"	.720"	.540"	.500-.504"	1/2"
11319		100							
16785*		15	3/8"-16 U.S.S.	.040-.200"	.499"	.720"	.540"	.500-.504"	1/2"

Regular Pitch Metric

Steel	Aluminum	Unit Pkg.	Thread Size after Installation	Recommended Grip Range	A Max.	B Max.	D Ref.	Hole Size	Drill Size
12980		50	M4-.7	.020-.080" .508/2.030mm	.249" 6.32mm	.410" 10.41mm	.287" 7.29mm	.250-.254" 6.35mm/6.45mm	1/4"
12981		100							
12982		50	M5-.8	.020-.130" .508/3.300mm	.280" 7.11mm	.465" 11.81mm	.320" 8.13mm	.281-.285" 7.14/7.24mm	9/32"
12983		100							
12984	13494	25	M6-1.0	.030-.165" .762/4.190mm	.374" 9.50mm	.610" 15.49mm	.415" 10.54mm	.375-.379" 9.53/9.63mm	3/8"
12985	13495	100							
12986		25	M8-1.25	.040-.200" 1.020/5.080mm	.499" 12.67mm	.720" 18.29mm	.540" 13.72mm	.500-.504" 12.71/12.80mm	1/2"
12987		100							

LARGE FLANGE THIN SHEET NUTSERT® INSERTS

U.S.S., S.A.E. & Metric - Steel & Aluminum

The Large Flange system provides captive threads in materials too thin to independently support threads, or where costly tapping operations are to be eliminated. The Large Flange fastener can be used as a rivet to join materials that will ultimately have a separate component attached.

Materials: Low Carbon Steel, Zinc Plated
(Metric: Zinc & Yellow Plated)
Aluminum Alloy, Plain Finish

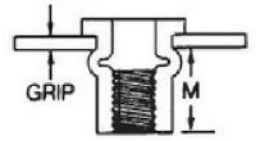
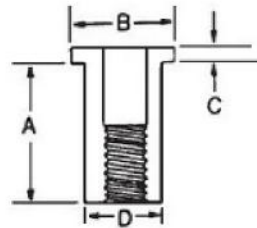

U.S.S. & S.A.E.

Aluminum	Steel	Unit Pkg.	Thread Size	Grip Range	Hole Size	A + .015	B + .015	C (NOM)	D + .000 - .004	M (Ref.)
16177	16187	50	8-32 U.S.S.	.010-.075"	.221-.226"	.438"	.357"	.032"	.221"	.300"
16178	16188	50	10-24 U.S.S.	.010-.080"	.250-.256"	.531"	.406"	.038"	.250"	.380"
16179	16189	50	10-24 U.S.S.	.080-.130"	.250-.256"	.594"	.406"	.038"	.250"	.390"
16180	16190	25	10-32 S.A.E.	.010-.080"	.250-.256"	.531"	.406"	.038"	.250"	.380"
16182*	16192*	25	1/4"-20 U.S.S.	.020-.080"	.332-.338"	.625"	.475"	.058"	.332"	.450"
16183*	16193*	25	1/4"-20 U.S.S.	.080-.140"	.332-.338"	.687"	.475"	.058"	.332"	.450"
16184*	16194*	25	5/16"-18 U.S.S.	.030-.125"	.413-.423"	.750"	.665"	.062"	.413"	.505"
	16195*	25	5/16"-18 U.S.S.	.125-.200"	.413-.423"	.875"	.665"	.062"	.413"	.555"
16789*		10	3/8"-16 U.S.S.	.030-.115"	.490-.500"	.844"	.781"	.088"	.490"	.585"
	16788*	10	3/8"-16 U.S.S.	.115-.200"	.490-.500"	.938"	.781"	.088"	.490"	.595"

Regular Pitch Metric

Aluminum	Steel	Unit Pkg.	Thread Size	Grip Range	Hole Size	A ± .015	B ± .015	C (NOM)	D + .000 - .004	M (Ref.)
	16978	25	M6-1.0	.020-.118" .5-3.0mm	.358" 9.1mm	.630" 16mm	.510" 13mm	.059" 1.5mm	.356" 9mm	.450" 11.5mm

HAVE YOU VISITED US ONLINE?

www.faccfasteners.com



NUTSERT® INSERTS

U.S.S. & S.A.E. Thread

A simple hand tool installs the Nutsert, it is ready for use in seconds and no finishing is required after installation.

Nutsert's advanced design offers unlimited grip range in a minimum of sizes. Inventory is minimized to one body dimension per thread size; ideally suited for blind, buried and through holes. The ingenious "taper-lock" principle locks-in the Nutsert preventing spin or twist; installs in flat or curved surfaces and is self-tightening with repeated use. The unique design of the installation tool eliminates marring of the parent material surface



Material: Mild Steel, Tin Plated
Minimum Grip: .030"

To set Nutserts use tool 11805 & Conversion Kits

Part No.	Unit Pkg.	Thread (Class 2B)	A	B	L	M	C	D	Nominal Hole Size	Thousand (In lbs)
10264	25	6-32 U.S.S.	.218"	.238"	.185"	.370"			7/32"	1.50
10265	100									
10266	1000									
10267	25	8-32 U.S.S.	.249"	.264"	.185"	.370"			1/4"	2.00
10268	100									
10269	1000									
10270	25	10-24 U.S.S.	.280"	.300"	.185"	.370"			9/32"	2.25
10271	100									
10272	1000									
10273	25	10-32 S.A.E.	.280"	.300"	.185"	.370"			9/32"	2.25
10274	100									
10275	1000									
10276	25	1/4"-20 U.S.S.	.374"	.398"	.255"	.510"			3/8"	6.00
10277	100									
10278	1000									
10279	25	1/4"-28 S.A.E.	.374"	.398"	.255"	.510"			3/8"	6.00
10280	100									
10282	10	5/16"-18 U.S.S.	.499"	.524"	.305"	.610"			1/2"	12.87
10283	100									
10284	500									
10285	10	5/16"-24 S.A.E.	.499"	.524"	.305"	.610"			1/2"	12.87
10286	100									
10288*	10	3/8"-16 U.S.S.	.561"	.590"	.370"	.740"			9/16"	18.00
10289*	50									
10290*	100									

Diameters vary with material density in blind application

Dependent upon material thickness and application

NUTSERT® HAND TOOL & US/METRIC CONVERSION KITS



11805

Nutsert Hand Tool
For regular and thin sheet Nutserts
(Does not include any conversion kits)
Hand tool only with wrench

UNIT PACKAGE: 1

Conversion Kits for Item 11805 Gun

Size	Use Tool 11805 with Auveco Conversion Kit Listed
6-32 U.S.S.	11807
8-32 U.S.S.	11808
10-32 S.A.E.	11809
10-24 U.S.S.	11810
1/4"-20 U.S.S.	11811
1/4"-28 S.A.E.	11812
5/16"-18 U.S.S.	11813
5/16"-24 S.A.E.	11814
3/8"-16 U.S.S.	11815
M4-.7	12988
M5-.8	12989
M6-1.0	12990
M8-1.25	12991

UNIT PACKAGE: 1



11806

Nutsert Tool Kit in metal case
Includes hand tool 11805, nose piece wrench, and conversion kits (nose piece & mandrel) for the following sizes: 6-32, 8-32, 10-24, 10-32, 1/4"-20 & 5/16"-18.

UNIT PACKAGE: 1

16341

Metric Nutsert Tool Kit in metal case
Includes hand tool 11805, nose piece wrench, and conversion kits (nose piece & mandrel) for the following sizes: M4-.7, M5-.8, M6-1.0 (2 in kit) & M8-1.25.

UNIT PACKAGE: 1



15544

Mandrel Puller
Replacement Mandrel Puller
for 11805 Nutsert Tool
1/4"-28 Left-Hand Thread

UNIT PACKAGE: 1

THREAD REPAIR INSERTS

Professional Insert Installation Tool



Tool No.	Installs Insert Sizes (Internal Thread)
12394	1/4"-20 & 1/4"-28
12395	5/16"-18 & 5/16"-24
12396	3/8"-16 & 3/8"-24
12397	7/16"-14 & 7/16"-20
12399	M5-0.8
12400	M6-1.0
16163	5/8"-11 H.D. & 5/8"-18 H.D.
16164	3/4"-10 H.D. & 3/4"-16 H.D.

Economy Driver Tool



12404

Will install approximately 10 Inserts.
Use with Thinwall Inserts up to 1/2" and 10mm internal diameter and Heavy Duty Inserts up to 1/2" internal diameter

UNIT PACKAGE: 5

THREAD REPAIR INSERTS

Heavy Duty Thread Repair Inserts

Part No.	Internal Thread Size (Bolt Size)	External Thread Size	Number of Kees	Insert Length	Drill Size	Tap Size	Professional Installation Tool Part No.†	Inserts Per Unit Package
17238	10-24	3/8"-16	2	.31"	"Q"	3/8"-16	◆	4
17239	10-32							4
17241	1/4"-28	7/16"-14	2	.37"	"X"	7/16"-14	◆	4
17242	5/16"-18	1/2"-13	4	.43"	29/64"	1/2"-13	◆	4
17243	5/16"-24							4
17244	3/8"-16	9/16"-12	4	.50"	33/64"	9/16"-12	◆	3
17245	3/8"-24							3
17246	7/16"-14	5/8"-11	4	.62"	37/64"	5/8"-11	◆	3
17248	1/2"-13	3/4"-16	4	.62"	45/64"	3/4"-16	◆	2
17249	1/2"-20							2
16159	5/8"-11	7/8"-14	4	.87"	53/64"	7/8"-14	16163	2
17533								15
16161	3/4"-10	1-1/8"-12	4	1.12"	1-1/16"	1-1/8"-12	16164	2
17535								10
16162	3/4"-16	1-1/8"-12	4	1.12"	1-1/16"	1-1/8"-12	16164	2
17536								10

† Not packaged with the Thread Repair Inserts

◆ Professional tool not available. Can be set with 12404 Economy Drive Tool one kee at a time.

Metric Thread Repair Inserts®

Part No.	Internal Thread Size (Bolt Size)	External Thread Size	Number of Kees	Insert Length	Drill Size	Tap Size	Professional Installation Tool Part No.†	Inserts Per Unit Package
12386	M5-0.8	M8-1.25	2	.315"	"H"	M8-1.25	12399	3*
17537								15
12387	M6-1.0	M10-1.25	2	.394"	"S"	M10-1.25	12400	3*
17538								15
12389	M8-1.0	M12-1.25	4	.472"	27/64"	M12-1.25	◆	2*
17539								10
12390	M8-1.25	M12-1.25	4	.472"	27/64"	M12-1.25	◆	2*
17540								10
12391	M10-1.25	M14-1.5	4	.551"	1/2"	M14-1.5	◆	2*
17541								10
12392	M10-1.5	M14-1.5	4	.551"	1/2"	M14-1.5	◆	2*
17542								10

*Contains Economy Drive Tool 12404

† Not packaged with the Thread Repair Inserts

◆ Professional tool not available. Can be set with 12404 Economy Drive Tool one kee at a time.

Thread Repair Insert Assortments

12405

Assortment Kit Contains

Part No.	Qty.	Size
12374	3	10-24
12376	3	1/4"-20
12378	3	5/16"-18
12380	3	3/8"-16
12404	2	Installation Tools

12406

Assortment Kit Contains

Part No.	Qty.	Size
12375	3	10-32
12377	3	1/4"-28
12379	3	5/16"-24
12381	3	3/8"-24
12404	2	Installation Tools

12407

Assortment Kit Contains

Part No.	Qty.	Size
12387	2	M6-1.0
12389	2	M8-1.0
12390	2	M8-1.25
12391	2	M10-1.25
12404	1	Installation Tool

HELICAL THREAD REPAIR INSERTS & KITS

For repairing stripped or damaged threads



The most effective and universally accepted method of thread repair. Inserts quickly and permanently restores stripped, worn or damaged threads to their original size and condition.

Easy to use... 1: Drill 2: Tap 3: Install
Now you're back to the original size and the original size fastener can be used.



When threads become stripped, worn or damaged for any reason, the strength and reliability are greatly reduced. When this happens on critical threaded assemblies, cars, and other types of equipment, it may become unsafe to operate.

These potentially dangerous situations are eliminated when the damaged thread is repaired with a thread repair insert. The threaded insert provides stronger, more reliable threads than the original tapped hole and at the same time eliminates the possibility of thread wear, seizing and corrosion.

Go from Stripped

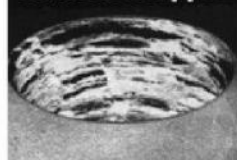

To Fixed



Thread Size & Length	Kits		Insert		Metal Installation Tool		Tap		Required Drill Size
	Contents: Number of inserts shown, one installation tool & one tap.		Part No.	Unit Pkg.	Part No.	Unit Pkg.	Part No.	Unit Pkg.	
	Kit No.	Inserts Per Kit							
U.S.S. COARSE THREAD (18-8 Stainless Steel)									
1/4"-20 x .375"							18597	1	17/64"
3/8"-16 x .562"	18624	10	18547	10					25/64"
7/16"-14 x .656"			18548	10					29/64"
1/2"-13 x .750"	18626	5			18576	1			17/32"
S.A.E. FINE THREAD (18-8 Stainless Steel)									
1/4"-28 x .375"	18630	10							17/64"
5/16"-24 x .469"			18554	10					21/64"
3/8"-24 x .562"							18607	1	25/64"
1/2"-20 x .750"			18557	10					33/64"
METRIC REGULAR PITCH (18-8 Stainless Steel)									
M8-1.25 x 12.0mm					18586	1			21/64"
M10-1.50 x 15.0mm							18613	1	13/32"
METRIC FINE PITCH (18-8 Stainless Steel)									
M10-1.25 x 15.0mm			18563	10					13/32"
M12-1.25 x 18.0mm							18619	1	31/64"
SPARK PLUG THREAD (Mild Carbon Steel)									
M14-1.25 x 3/8"			18568	2					Do Not Drill. Use Piloted Tap
M14-1.25 x 1/2"			18569	2	18595	1			

JACK NUTS®

Material: 1010 Steel, Zinc Plated

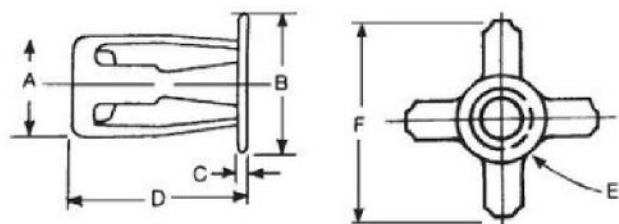

Type 1



Type 2



Type 3

Part No.	Unit Pkg.	Type	Thread (E)	Body Dia. (A)	Head Dia. (B)	Cap Thick (C)	Overall Length (D)	Grip Range	Required Hole Dia.	Maximum Spread (F)**
13012	25	1	6-32	.318"	.468"	.073"	.653"	1/64"-3/16"	.315"-.330"	.660"
13014	25	1	10-24	.382"	.531"	.073"	.716"	1/64"-3/16"	.385"-.400"	.760"
13016	25	1	1/4"-20	.438"	.625"	.073"	.731"	1/64"-3/16"	.434"-.450"	.890"
13017	25	1	1/4"-20	.438"	.625"	.073"	.919"	3/16"-3/8"	.434"-.450"	.890"

Special Purpose Jack Nuts

Part No.	O.E.M. Number	Type	Thread	Finish	O.E.M. Application	Unit Pkg.
12995	GM: 367292 Chry: 6031438	3	1/4"-20	Zinc w/Sealer	GM Mirror Mounting Nut	25
12996	GM: 367292 Chry: 6031438	3	1/4"-20	Zinc w/ Sealer	GM Mirror Mounting Nut	100
12997	GM: 1635218, 10014363	1	M6-1.0	Zinc	GM License Plate Nut	25
12999	GM: 14007940	2	M6-1.0	Zinc w/Raintite	GM "X" & "Y" Roof Rack Mounting Nut	10

Jack Nut Installation Tools

Photos not actual size



22402

Professional Jack Nut Installation Tool

UNIT PACKAGE: 1

An economical tool for rapidly installing Jack Nuts in any material. Takes interchangeable screw rods. Just screw rod into Jack Nut, push into hole, squeeze to set and remove. Sets all size Jack Nut Threaded Inserts.

Tool comes with 22403 (6-32 Thread) Installation Rod

Jack Nut Installation Rods

Use with 22402 Installation Tool



Part No.	Unit Pkg.	Thread
22403	1	6-32
22404	1	10-24
22405	1	1/4"-20
22406	1	4mm
22407	1	5mm
22408	1	6mm

22342

Friction Wrench



For use when installing a limited quantity of Jack Nuts. Insert the wrench between the screw and the head of the fastener, hold wrench and run in screw to set Jack Nut.

UNIT PACKAGE: 3



Mirror Mounting Screws and Jack Nuts

Part No.	Description	Unit Pkg.
13231	1/4"-20 x 7/8" Screw (Phos.)	25
13232	1/4"-20 x 7/8" Screw (Phos) & Jack Nut	25
14947	M6 x 26mm Screw (Chrome)	25
14976	1/4"-20 x 1-1/4" Screw (Stainless Steel)	25
14977	1/4"-20 x 1-1/4" Screw (Stainless Steel) & Jack Nut	10

WELL NUTS®

WELL NUTS

Material - Neoprene with Captive Brass Nut

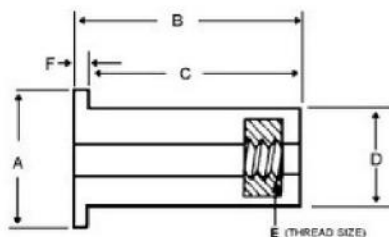

Part No.	Unit Pkg.	(E) Thread	(A) Head Dia.	(B) Overall Length	(C) Shank Length	(D) Shank Dia.	(F) Head Thick	Hole Size	For Wall Thickness	O.E.M. Number	O.E.M. Application
13006	25	#6-32	.452"	.499"	.437"	.312"	.062"	5/16"	.015"-.156"		
16236	25	#6-32	.554"	.981"	.946"	.240"	.035"	1/4"	.375"-.607"		
16237	25	#8-32	.438"	.499"	.447"	.312"	.052"	5/16"	.015"-.156"	Chry: 6026166 GM: 347065	Rear Compt. Cover Support
13005	25	#8-32	.750"	.575"	.500"	.312"	.062"	5/16"	.015"-.172"	GM: 14048060	License Plate
16240	25	#10-24	.562"	.767"	.580"	.375"	.187"	3/8"	.030"-.227"	GM: 3876130	Voltage Reg & Dome Light
13007	25	#10-32	.500"	.554"	.518"	.377"	.036"	3/8"	.015"-.192"		
13009	10	#10-32	.562"	.665"	.625"	.377"	.040"	3/8"	.035"-.232"	GM: 12338025	Luggage Rack
17586	15	#10-32	.750"	.703"	.625"	.375"	.078"	3/8"	.030"-.227"		
16244	25	#10-32	.750"	.807"	.620"	.375"	.187"	3/8"	.030"-.227"		
13008	10	#10-32	.562"	1.051"	1.000"	.375"	.051"	3/8"	.312"-.643"		
13004	25	1/4"-20	.625"	.641"	.594"	.500"	.051"	1/2"	.015"-.111"	GM: 528846 AMC: 4003120	Luggage Rack
16255	15	1/4"-20	.635"	.801"	.750"	.500"	.051"	1/2"	.187"-.343"		
13010	10	1/4"-20	.740"	.829"	.642"	.500"	.187"	1/2"	.031"-.187"		
16253	25	1/4"-20	.635"	1.051"	1.000"	.500"	.079"	1/2"	.250"-.457"	GM: 342271	Luggage Rack
13011	10	5/16"-18	.875"	.725"	.600"	.620"	.125"	5/8"	.015"-.187"		
16242	25	M5-.8	.500"	.554"	.518"	.375"	.036"	3/8"	.015"-.192"		
16248	25	M5-.8	.562"	.665"	.625"	.375"	.040"	3/8"	.035"-.232"	GM: 14005097	Service Part
13002	10	M6-1.0	.787"	.630"	.579"	.500"	.051"	1/2"	.015"-.094"	GM: 20130258 GM: 14002811	Station Wagon Roof Rack
13003	50									GM: 20130258 GM: 14002811	Station Wagon Roof Rack
16251	25	M6-1.0	.630"	.630"	.579"	.500"	.051"	1/2"	.015"-.111"	GM: 15505451 AMC: 8934201293	Luggage Rack License Plate
16252	25	M6-1.0	.750"	.829"	.642"	.500"	.187"	1/2"	.031"-.187"	VW: 175 820 435	Luggage Rack
16256	10	M8-1.25	.875"	.725"	.600"	.620"	.125"	5/8"	.015"-.156"	AMC: 8934201493	Radiator Brkt.

MISSING SOMETHING?

Is there an item you are looking for that doesn't seem to be in our catalog?

We welcome all suggestions for new items to add to our expansive line of body hardware and specialty fastener selection.

contact us at info@faccafasteners.com

TUBULAR TYPE NUTS

Listed by Stud Size

Photo not actual size



3776

Phosphate

Stud Size: 3/32"
Panel Range: .032"-.040"
Fits into 1/8" Hole

UNIT PACKAGE: 100

Photo not actual size



3137

Phosphate

Stud Size: 3/32"
Panel Range: .025"-.175"
Fits into 1/8" Hole

UNIT PACKAGE: 100



11293

(375890-S102)
Green with Sealer

Stud Size: 1/8"
Panel Range: .035"-.045"
Fits into 3/16" Hole

UNIT PACKAGE: 50



13964

Natural Nylon

Stud Size: 1/8"
Barrel Length: 11/32"
Head Diameter: 15/64"
Head Thickness: 1/32"
Fits into 11/64" Hole

UNIT PACKAGE: 50



2595

Phosphate

Stud Size: 1/8"
Panel Range: .040"-.045"
Fits into 3/16" Hole

UNIT PACKAGE: 100



3777

Phosphate

Stud Size: 1/8"
Panel Range: .038"-.044"
Fits into 5/32" Hole

UNIT PACKAGE: 100



2611

Phosphate

Stud Size: 1/8"
Panel Range: .030"-.036"
Fits into 5/32" Hole

UNIT PACKAGE: 100



5854

(373528-S32), (6000605)
Phosphate

Stud Size: 1/8"
Panel Range: .025"-.045"
Fits into 3/16" Hole

UNIT PACKAGE: 100



5195

(375480-S100)
(3783794)
Phosphate

Stud Size: 1/8"
Panel Range: .036"-.046"
Fits into 1/4" Hole

UNIT PACKAGE: 100



13965

(4006316)
White Nylon

Stud Size: 5/32"
Barrel Length: 1/4"
Head Diameter: 1/4"
Head Thickness: 1/32"
Fits into 3/16" Hole

UNIT PACKAGE: 100



8545

Phosphate

Stud Size: 5/32"
Panel Range: .062"-.068"
Fits into 7/32" Hole

UNIT PACKAGE: 100



8546

Phosphate

Stud Size: 5/32"
Panel Range: .049"-.055"
Fits into 7/32" Hole

UNIT PACKAGE: 100



10073

(6000558)
Phosphate

Stud Size: 3/16"
Panel Range: .038"-.044"
Fits into 7/32" Hole

UNIT PACKAGE: 100

TUBULAR TYPE AND FLAT NUTS

Listed by Stud Size



13966
(8934-201-767)
Black Nylon

Stud Size: 3/16"
Barrel Length: 17/64"
Head Diameter: 5/16"
Head Thickness: 1/32"
Fits into 17/64" Hole

UNIT PACKAGE: 100



5196
(354341-S)
Phosphate

Stud Size: 1/4"
Panel Range: .034"-.040"
Fits into 9/32" Hole

UNIT PACKAGE: 100



8578
White Nylon

Thread Screw Size: #10
Fits into 5/16" Hole

UNIT PACKAGE: 50



19537
(6000258)
Phosphate

Stud Size: 1/4"
Panel Range: .030"-.034"
Fits into 5/16" Hole

UNIT PACKAGE: 50

FLAT NUTS

For Screws



1896
Phosphate

7/32" x 3/8"
Machine Screw Size: #2-56

UNIT PACKAGE: 100



2089
Phosphate

5/16" x 1/2"
Machine Screw Size: #6-32

UNIT PACKAGE: 100



1898
Phosphate

1/2" x 7/8"
Machine Screw Size: #6-32

UNIT PACKAGE: 100



5563
Phosphate

13/32" x 5/8"
Tapping Screw Size: No. 8

UNIT PACKAGE: 100



3793
Phosphate

13/32" x 5/8"
Tapping Screw Size: No. 8

UNIT PACKAGE: 100

For Screws



1899
Phosphate

1/2" x 7/8"
Machine Screw Size: #8-32

UNIT PACKAGE: 100



2091
Phosphate

5/16" x 1/2"
Machine Screw Size: #8-32

UNIT PACKAGE: 100



1900
Phosphate

1/2" x 7/8"
Tapping Screw Size: #10

UNIT PACKAGE: 100



2092
Phosphate

7/16" x 3/4"
Machine Screw Size: #10-24

UNIT PACKAGE: 100



1912
Phosphate

1/2" x 3/4"
Tapping Screw Size: #12

UNIT PACKAGE: 100

FLAT NUTS

For Screws

**1903**

Phosphate

9/16" x 1"
Machine Screw Size: 1/4"-20

UNIT PACKAGE: 100

For Studs

**2098**

Phosphate

7/32" x 3/8"
Stud Size: 1/16"

UNIT PACKAGE: 100

**2100**

Phosphate

1/4" x 7/16"
Stud Size: 3/32"

UNIT PACKAGE: 100

**1906**

Phosphate

7/32" x 7/16"
Stud Size: .100" or 3/32"

UNIT PACKAGE: 100

**2099**

Phosphate

5/16" x 9/16"
Stud Size: 1/8"

UNIT PACKAGE: 100

**2102**

Phosphate

3/8" x 9/16"
Stud Size: 5/32"

UNIT PACKAGE: 100

For Studs

**1905**

Phosphate

7/16" x 3/4"
Stud Size: 5/32"

UNIT PACKAGE: 100

**2426**

Phosphate

3/8" x 5/8"
Stud Size: 3/16"

UNIT PACKAGE: 100

**2103**

Phosphate

3/8" x 5/8"
Stud Size: 3/16"

UNIT PACKAGE: 100

**2105**

Phosphate

7/16" x 5/8"
Stud Size: 1/4"

UNIT PACKAGE: 100

**3138**

Phosphate

1/2" x 11/16"
Stud Size: 5/16"

UNIT PACKAGE: 100

All items available in bulk quantities.

contact us at [1-800-265-7606](tel:1-800-265-7606)
or send us email at
sales@faccafasteners.com

U & J TYPE NUTS BY SCREW SIZE



9625

Phosphate

Screw Size: #6
Panel Range: .090" - .110"
Center of Hole to Edge: 9/32"

UNIT PACKAGE: 100



11292

(445429, 9422552)
Phosphate

Screw Size: #8
Panel Range: .045" - .062"
Center of Hole to Edge: 3/8"

UNIT PACKAGE: 50



21007

Phosphate

Screw Size: #6-32
Panel Range: .045" - .062"
Center of Hole to Edge: 5/16"

UNIT PACKAGE: 50



11768

(388248-S-36B)
Phosphate

Screw Size: #8
Panel Range: .075" - .090"
Center of Hole to Edge: 9/32"

UNIT PACKAGE: 50



5571

Phosphate

Screw Size: #8
Panel Range: .025" - .040"
Center of Hole to Edge: 1/4"

UNIT PACKAGE: 100



19826

(382163-S)
Phosphate

Screw Size: #8
Panel Range: .145" - .160"
Center of Hole to Edge: 9/32"
Replaces Auvenco 11063

UNIT PACKAGE: 50



5836

Phosphate

Screw Size: #8
Panel Range: .025" - .035"
Center of Hole to Edge: 3/8"

UNIT PACKAGE: 100



8337

Phosphate

Screw Size: #8-18
Panel Range: .025" - .040"
Center of Hole to Edge: 3/8"

UNIT PACKAGE: 50



2346

Phosphate

Screw Size: #8
Panel Range: .025" - .040"
Center of Hole to Edge: 9/32"

UNIT PACKAGE: 100



14822

(25527289)
Phosphate

Screw Size: M4.2-1.41 (#8)
Panel Range: .094" - .109"
Center of Hole to Edge: 7/32"

UNIT PACKAGE: 50



3796

(9428481)
Phosphate

Screw Size: #8
Panel Range: .025" - .040"
Center of Hole to Edge: 1/4"

UNIT PACKAGE: 100



14814

(N803183-S32)
Phosphate

Screw Size: M4.2-1.41 (#8)
Panel Range: .094" - .156"
Center of Hole to Edge: 1/2"

UNIT PACKAGE: 25



10666

Phosphate

Screw Size: #8
Panel Range: .025" - .035"
Center of Hole to Edge: 11/32"

UNIT PACKAGE: 100



18208

Phosphate

Screw Size: #10
Panel Range: .015" - .085"
Center of Hole To Edge: 11/32"

UNIT PACKAGE: 100

U & J TYPE NUTS BY SCREW SIZE



11429

Phosphate

Screw Size: #10
Panel Range: .015"-.060"
Center of Hole to Edge: 15/32"

UNIT PACKAGE: 50



2303

Phosphate

Screw Size: #10
Panel Range: .027"-.045"
Center of Hole to Edge: 3/16"

UNIT PACKAGE: 100



3797

Phosphate

Screw Size: #10
Panel Range: .045"-.062"
Center of Hole to Edge: 13/32"

UNIT PACKAGE: 100



1913

Phosphate

Screw Size: #10
Panel Range: .020"-.051"
Center of Hole to Edge: 15/32"

UNIT PACKAGE: 50



3770

Phosphate

Screw Size: #10
Panel Range: .030"-.037"
Center of Hole to Edge: 3/8"

UNIT PACKAGE: 100



2422

Phosphate

Screw Size: #10
Panel Range: .025"-.064"
Center of Hole to Edge: 3/8"

UNIT PACKAGE: 100



5576

Phosphate

Screw Size: #10
Panel Range: .045"-.062"
Center of Hole to Edge: 13/32"

UNIT PACKAGE: 100



8341

Phosphate

Screw Size: #10
Panel Range: .025"-.060"
Center of Hole to Edge: 11/32"

UNIT PACKAGE: 100



5197

Phosphate

Machine Screw Size: #10-24
Panel Range: .045"-.062"
Center of Hole to Edge: 9/16"

UNIT PACKAGE: 100



2057

Phosphate

Screw Size: #14
Panel Range: .032"-.040"
Center of Hole to Edge: 1/2"

UNIT PACKAGE: 100



2420

Phosphate

Screw Size: #14
Panel Range: .028"-.056"
Center of Hole to Edge: 15/32"

UNIT PACKAGE: 100



2293

(9431647)

Phosphate

Machine Screw Size: 1/4"-20
Panel Range: .064"-.125"
Center of Hole to Edge: 9/16"

UNIT PACKAGE: 100



1907

Phosphate

Tapping Screw Size: 5/16"-10
Panel Range: .032"-.064"
Center of Hole to Edge: 1/2"

UNIT PACKAGE: 50

J TYPE CAGE AND SPRING TYPE U NUTS

J TYPE CAGE NUTS

Phosphate Finish



Part No.	Screw Size	Panel Range	Center of Hole to Edge	Unit Pkg.
5586	1/4"-20 USS	.032/.093"	1/2"	50
3616	5/16"-18 USS	.087"-.093"	9/16"	25
5589	5/16"-18 USS	.087"-.093"	9/16"	50
5170	3/8"-16 USS	.050/.090"	9/16"	25

SPRING TYPE U-NUTS



10064

Phosphate

Screw Size: #6
Panel Range: .025"-.125"
Center of Hole to Edge: 3/8"

UNIT PACKAGE: 50



10065

Phosphate

Screw Size: #8
Panel Range: .025"-.125"
Center of Hole to Edge: 3/8"

UNIT PACKAGE: 25

16267

Same as 10065 except for unit package quantity

UNIT PACKAGE: 100



9880

(9424837, 9431530; 381818-S2)
Phosphate

Screw Size: #8
Panel Range: .025"-.150"
Center of Hole to Edge: 3/8"
GM, Ford

UNIT PACKAGE: 100



9879

(9440178, 11504531; 381863-S2)
Phosphate

Screw Size: #8
Panel Range: .025"-.150"
Center of Hole to Edge: 5/8"
GM, Ford

UNIT PACKAGE: 100



20582

(9433156)

Phosphate

Screw Size: #8
Panel Range: .125" - .250"
Center of Hole to Edge: 3/8"
GM

UNIT PACKAGE: 100



10066

Phosphate

Screw Size: #10
Panel Range: .025"-.125"
Center of Hole to Edge: 11/32"

UNIT PACKAGE: 25



15752

Phosphate

Screw Size: #10
Panel Range: .025"-.150"
Center of Hole to Edge: 9/16"

UNIT PACKAGE: 50



9881

(9425491)

Phosphate

Screw Size: #14
Panel Range: .025"-.150"
Center of Hole to Edge: 5/16"
GM

UNIT PACKAGE: 100



10067

Phosphate

Screw Size: #14
Panel Range: .025"-.125"
Center of Hole to Edge: 3/8"

UNIT PACKAGE: 25

U-TYPE SPECIAL NUTS



14526

(N802538-S100)
Green Phosphate

Screw Size: #8
Panel Range: 1/16"-5/32"
Center of Hole to Edge: 5/16"
Width: 17/32", Length: 51/64"
Ford

UNIT PACKAGE: 50



14527

(10041588, 25530441)
Phosphate

Screw Size: #8
Panel Range: 1/16"-3/16"
Center of Hole to Edge: 19/32"
Width: 35/64", Length: 1-1/32"
GM

UNIT PACKAGE: 50



14750

(Toyota: 53879-14010-A,
53879-14020, 53879-22030;
GM: 94841226;
Mazda: LA01-56-135)

Nylon U-Nut Fender/
Wheel Housing Applications
Screw Size: #10
Panel Range: Up to 1mm
Center of Hole to Edge: 11mm
Width: 20mm, Length: 31mm
Toyota, Geo Prizm, Nova & Mazda

UNIT PACKAGE: 15

19669

Same as 14750 except for unit package quantity

UNIT PACKAGE: 25



20956

(90467-05114)
Black Nylon

Bumper & Fender Apron
Nylon U-Nut

Screw Size: M5.5 (#12)
Center of Hole to Edge: 14mm
Panel Range: Up to 1mm
Width: 20mm, Length: 36mm
Lexus & Toyota

UNIT PACKAGE: 10



19162

(1638575, 25512688)
Zinc

Screw Size: M4.2 (#8)
Panel Range: .035"-.049"
Center of Hole to Edge: 9/16"
GM

UNIT PACKAGE: 25



19163

Zinc

3 Position U-Nut
Screw Size: M4.2 (#8)
Panel Range: Up to 3/32"
Center of Hole to Edge: 15/32"
Width: 27/32", Length: 7/8"

UNIT PACKAGE: 25



19164

Phosphate

4 Position U-Nut
Screw Size: M4.2 (#8)
Panel Range: Up to 5/32"
Center of Hole to Edge: 7/16"
Width: 15/16", Length: 29/32"

UNIT PACKAGE: 25



19165

Phosphate

Multi-Position U-Nut
Screw Size: M4.2(#8)
Panel Range: Up to 5/64"
Center of Hole to Edge: 25/64"
Width: 3/4", Length: 11/16"

UNIT PACKAGE: 25



19166

(1260888, 25556911)
Phos. & Blue

Multi-Position U-Nut
Screw Size: M4.2 (#8)
Panel Range: 1/16"-5/64"
Center of Hole to Edge: 7/16"
Windshield Defroster Nozzle & Various
Instrument Panel Applications
GM 1984 - On

UNIT PACKAGE: 25

EXTRUDED U-NUTS

Fold Over Nuts

**10048**(45262)
PhosphateScrew Size: #8-32
Panel Range: .025"-.150"
Center of Hole to Edge: 3/8"
Ford

UNIT PACKAGE: 50

**8375**(152266)
PhosphateScrew Size: 5/16"-18
Panel Range: .025"-.060"
Center of Hole to Edge: 9/16"
GM

UNIT PACKAGE: 50

**18898**(45262)
PhosphateScrew Size: #8-32
Panel Range: .079"-.118"
Center of Hole to Edge: 3/8"
Ford

UNIT PACKAGE: 50

**10053**(Chry: 6023171; Ford: 45264)
PhosphateScrew Size: 5/16"-18
Panel Range: .025"-.150"
Center of Hole to Edge: 9/16"
Ford

UNIT PACKAGE: 50

**15677**

(152273)

Phosphate

Screw Size: #10-24
Panel Range: .025"-.125"
Center of Hole to Edge: 15/32"
GM

UNIT PACKAGE: 50

**12265**(45264-S2)
PhosphateScrew Size: 5/16"-18
Panel Range: .040"-.125"
Center of Hole to Edge: 9/16"
Ford

UNIT PACKAGE: 50

**8359**(1480627, 1494252)
PhosphateScrew Size: 1/4"-20
Panel Range: .025"-.150"
Center of Hole to Edge: 17/32"
GM

UNIT PACKAGE: 50

**8377**(1480909)
PhosphateScrew Size: 5/16"-18
Panel Range: .060"-.090"
Center of Hole to Edge: 9/16"
GM

UNIT PACKAGE: 50

**10050**(45263-S2)
PhosphateScrew Size: 1/4"-20
Panel Range: .025"-.150"
Center of Hole to Edge: 17/32"
Ford

UNIT PACKAGE: 25

**8372**(152267)
PhosphateScrew Size: 5/16"-18
Panel Range: .120"-.150"
Center of Hole to Edge: 9/16"
GM

UNIT PACKAGE: 50

**10051**(45267; 1494257)
PhosphateScrew Size: 1/4"-20
Panel Range: .025"-.150"
Center of Hole to Edge: 25/32"
Ford, GM

UNIT PACKAGE: 50

**10830**(1494253)
PhosphateScrew Size: 5/16"-18
Panel Range: .025"-.150"
Center of Hole to Edge: 9/16"
GM

UNIT PACKAGE: 50

EXTRUDED U-NUTS

Fold Over Nuts



8814
(1494258; 379831-S)
Phosphate

Screw Size: 5/16"-18
Panel Range: .025"-.150"
Center of Hole to Edge: 27/32"
GM & Ford

UNIT PACKAGE: 25



10052
(10008002; 45268-S2)
Phosphate

Screw Size: 5/16"-18
Panel Range: .025"-.150"
Center of Hole to Edge: 7/8"
GM & Ford

UNIT PACKAGE: 25



10054
(1494254, 12337873, 45265-S2)
Phosphate

Screw Size: 3/8"-16
Panel Range: .050"-.200"
Center of Hole to Edge: 3/4"
GM & Ford

UNIT PACKAGE: 25



10055
(45269)
Phosphate

Screw Size: 3/8"-16
Panel Range: .050"-.200"
Center of Hole to Edge: 1-1/8"
Ford

UNIT PACKAGE: 25

Metric Extruded U-Nuts



18337
(GM: 11500654;
Ford: N623330-S2)
Zinc Organic

Screw Size: M4-.7
Panel Range: .60mm-3.8mm (.024"-.150")
Center of Hole to Edge: 9.5mm (3/8")
GM & Ford

UNIT PACKAGE: 50



11625
(11500655)
Phosphate

Screw Size: M4-.7
Panel Range: .80mm-4.00mm (.030"-.160")
Center of Hole to Edge: 13.5mm (17/32")
GM

UNIT PACKAGE: 50



20339
(11516397)
Zinc Organic

Locking Thread
Screw Size: M4.2-1.41 (#8)
Panel Range: .5mm-2.0mm (.020"-.079")
Center of Hole to Edge: 10mm (25/64")
GM

UNIT PACKAGE: 50



21040
(11513599)
Zinc Organic

Locking Thread
Screw Size: M4.2-1.41 (#8)
Panel Range: .65mm-3.8mm (.025"-.150")
Center of Hole to Edge: 9.5mm (3/8")
GM

UNIT PACKAGE: 25



22074
(GM: 11515638)
Zinc Organic

Locking Thread
Metric Extruded U-Nut
Screw Size: M4.2-1.41 (#8)
Panel Range: .65mm-3.80mm (.025"-.150")
Center of Hole to Edge: 15mm
GM

UNIT PACKAGE: 25

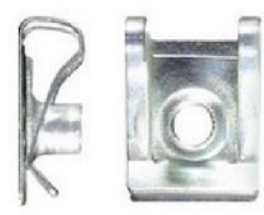

22113
(BMW: 51127070202;
VW: N90168602)
Zinc Finish

Metric Extruded U-Nut
Screw Size: M5-.8
Panel Range: .45mm - 1.5mm
Center of Hole to Edge: 11.5mm
BMW 1999 - 1992
VW 1993 - On

UNIT PACKAGE: 25



18338
(GM: 11505596; Ford: N623331-S2)
Phosphate

Screw Size: M5-.8
Panel Range: .60mm-3.8mm (.024"-.150")
Center of Hole to Edge: 11mm (7/16")
GM, Ford

UNIT PACKAGE: 50

EXTRUDED U-NUTS

Fold Over Nuts



11626

(11500657)
Phosphate

Screw Size: M5-.8
Panel Range: .80mm-4.00mm (.030"-.160")
Center of Hole to Edge: 15.8mm (5/8")
GM

UNIT PACKAGE: 50



21540

(GM: 24449408)
Orange Nylon

Screw Size: M5.5 (#12)
Panel Range: Up to 2mm (.079")
Center of Hole to Edge: 12mm (15/32")
GM & Saab

UNIT PACKAGE: 25



16846

(6502152)
Phosphate

Tri-Lobular Locking Thread
Screw Size: M6-1.0
Panel Range: .80mm-4.00mm (.030"-.160")
Center of Hole to Edge: 12mm (15/32")
Chrysler

UNIT PACKAGE: 50



16842

(11504047; N802331-S53)
Phosphate

Screw Size: M6-1.0
Panel Range: 3.4mm-6.3mm (.140"-.250")
Center of Hole to Edge: 13.5mm (17/32")
GM & Ford

UNIT PACKAGE: 25



18449

(6101308)
Phosphate

Locking Thread
Screw Size: M6-1.0
Panel Range: .80mm-4.00mm (.030"-.160")
Center of Hole to Edge: 13.5mm (17/32")
Chrysler

UNIT PACKAGE: 50



11864

(11503714, 11503716)
Phosphate

Screw Size: M6-1.0
Panel Range: .80mm-4.00mm (.030"-.160")
Center of Hole to Edge: 13.5mm (17/32")
GM

UNIT PACKAGE: 50



12669

1016937, 11503957; 12337917
N623332-S2, -S53 & -S100;
W5220822-S426)
Phosphate

Screw Size: M6-1.0
Panel Range: .80mm-4.00mm (.030"-.160")
Center of Hole to Edge: 13.5mm (17/32")
GM, Ford

UNIT PACKAGE: 25



22105

(Honda: 90675-SA5-003)
Zinc

Metric Extruded U-Nut
Screw Size: M6-1.0
Panel Range: 2mm - 4mm
Center of Hole to Edge: 14.5mm (9/16")
Acura 2007 - 1998; Honda 2014 - 1983

UNIT PACKAGE: 25



12666

(11504978)
Zinc Organic

Screw Size: M6-1.0
Panel Range: 3.4mm-6.3mm (1.35"-.250")
Center of Hole to Edge: 14.5mm (9/16")
GM

UNIT PACKAGE: 25



20416

(11516372)
Zinc Organic

Screw Size: M6-1.0
Panel Range: 2.0mm-5.0mm (.079" - .197")
Center of Hole to Edge: 14.5mm (9/16")
GM

UNIT PACKAGE: 25



12575

(11503715, 11508241,
11609385)
Phosphate

Screw Size: M6-1.0
Panel Range: .80mm-4.0mm (.030"-.160")
Center of Hole to Edge: 19.5mm (25/32")
GM

UNIT PACKAGE: 25



16322

(14040999)
Phosphate

Screw Size: M6-1.0
Panel Range: 1.0mm-2.5mm (.045"-.095")
Center of Hole to Edge: 19.5mm (25/32")
GM

UNIT PACKAGE: 50

EXTRUDED U-NUTS

Fold Over Nuts



19480
(N805889-S100)
Phosphate

Screw Size: M6-1.0
Panel Range: 4.3mm-5.6mm
(.172"-.219")

Center of Hole to Edge: 21mm (13/16")
Ford

UNIT PACKAGE: 15



11627
(11502785, 11504035)
Phosphate

Screw Size: M6.3-1.0
Panel Range: .80mm-4.00mm (.030"-.160")
Center of Hole to Edge: 13.5mm (17/32")
GM

UNIT PACKAGE: 25



11628
(9433043, 11500658)
Phosphate

Screw Size: M6.3-1.0
Panel Range: .80mm-4.00mm (.030"-.160")
Center of Hole to Edge: 13.5mm (17/32")
GM

UNIT PACKAGE: 25



12667
(11503455, 11504288)
Zinc Organic

Screw Size: M8-1.25
Panel Range: 1.50mm-5.50mm
(.060"-.216")
Center of Hole to Edge: 14.5mm (9/16")
GM

UNIT PACKAGE: 25



11629
(11500660, 11502617;
N623333-S2; 6101283)
Phosphate

Screw Size: M8-1.25
Panel Range: .80mm-4.00mm (.030"-.160")
Center of Hole to Edge: 14.5mm (9/16")
GM, Ford, Chrysler

UNIT PACKAGE: 25



11630
(11500661, 11503317,
11516150;
N623343-S2 & S100)
Phosphate

Screw Size M8-1.25
Panel Range: .80mm-4.00mm (.030"-.160")
Center of Hole to Edge: 20mm (13/16")
GM, Ford

UNIT PACKAGE: 25



19644
(10084751)
Phosphate

Screw Size: M8-1.25
Panel Range: 1.7mm-5.5mm (.067"-.217")
Center of Hole to Edge: 28.5mm (1-1/8")
GM

UNIT PACKAGE: 15



18401
(N801117-S100)
Black Phosphate

Locking Thread
Screw Size: M8-1.25
Panel Range: 4mm-7mm (.157"-.276")
Center of Hole to Edge: 21mm (13/16")
Ford

UNIT PACKAGE: 25



11631
(11500662, 22531616)
Phosphate

Screw Size: M10-1.50
Panel Range: 1.0mm-6.0mm
(.040"-.230")
Center of Hole to Edge: 19mm (3/4")
GM

UNIT PACKAGE: 25



18339
(GM: 11500663;
Ford: N623344-S2)
Phosphate

Screw Size: M10-1.5
Panel Range: 1.5mm-5.5mm (.060"-.215")
Center of Hole to Edge: 28mm (1-3/32")
GM, Ford

UNIT PACKAGE: 25