

Elevating
your everyday
home
experience



Index

Elleci District	4
Materials	6
Drain System	8
Sinks	10
Mixology	10
Dialogo	14
Sintesi	18
Best Workstation	22
Best	24
Zen	28
Dynamo	30
Quadra Inset	32
Quadra Undermount	36
Unico	40
Waste Disposal	42

elleci district

A growing space for constantly evolving ideas

For more than 30 years we have been creating innovative materials and shaping design solutions that improve people's quality of life.

We combine technology, Italian style and matchless ability to anticipate desires to elevate everyday experiences in the kitchen and bathroom.

100.000 mq

Total Area

50.000 mq

Production area

1,2

Million units/year

Production capacity

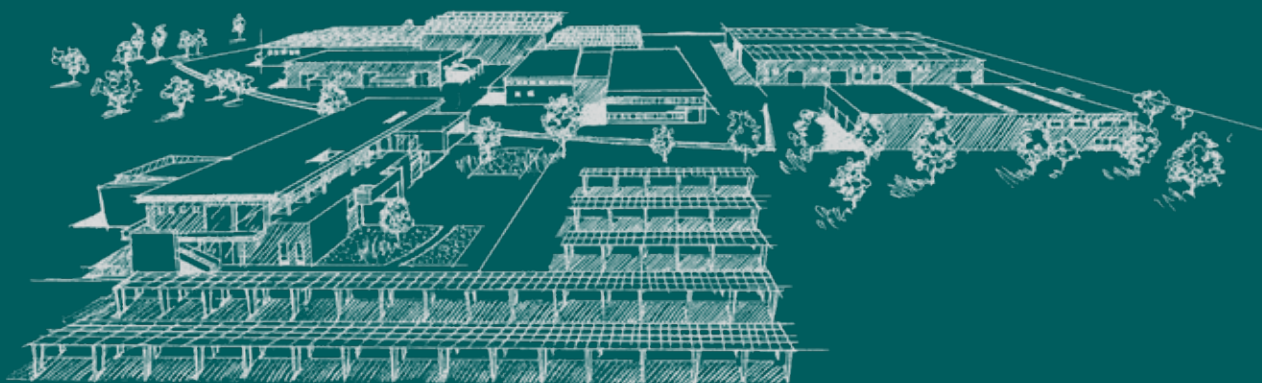

elleci plant 1

Historic manufacturing plant focused on flexibility and customization of production.

elleci plant 2

Independent, highly sustainable and technological production plant where tradition and know-how meet modernity and automation.

elleci innovation center

Dedicated to research and development where the most ambitious ideas take shape.

elleci care

Value and caring relationships: this space is fully directed at enhancing the relationship of trust with customers in pre- and post-sales phases.

elleci home

A hospitality and training area; a place where past and future visions coexist. A complete experience of Elleci world.

Today, more than ever, innovation means responsibility.
We base every business decision on fixed goals:



- Program
“Road to 2030-2050”
- Sustainable supply chain
- Believe in talents
and territory
- Transparent financial
governance



Materials

50% of the material
formulation matrix
made from renewable
raw materials



Energy

50% energy
produced from
renewable sources



Water

50% reduction
in water consumption
for production



Emissions

50% reduction in
CO₂eq emissions



Waste

50% reduction in waste
generated by the
production cycle

Sustainability report:
elleci.com



ISO 45001/2018
Health and safety



ISO 14001/2015
Environment



ISO 9001/2015
Quality

Materials

At the Elleci Innovation Center, the team of researchers combines expertise and technological leadership with innovation. This is how high-performance materials are created, designed to make a positive impact on people's daily lives.

GRANITEK

A material made of quartz sand, characterized by a slightly textured surface and natural colours. The technology enhances the intrinsic properties of the stone and improves its performance, ensuring cleanliness, durability, and resistance.

Surface
**Stony
Materic**

Colours
**Natural
Matte**

Insight
**Made
to last**

20%
Acrylic Resin

80%
Engineered
Quartz

elleci innovation center

Forging solutions by technology

KERATEK

The premium material with nanotechnology, which stands out for its pleasantly smooth surface and deep, matte colours. Nanoparticles provide extreme structural solidity, elevating both technical performance and aesthetic value.

Surface
**Silky
Smooth**

Colours
**Deep
Dusty**

Insight
**High
Tech**

20%
Microceramic

2% Nano-techs

20%
Acrylic Resin

58%
Engineered
Quartz

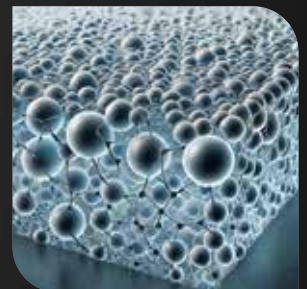

Drain System

The modern drain system:
attractive, efficient, easy to use and maintain

Open Up

The push-control remote control
with a flat, minimal chic look.



Flow Pro

Elleci's exclusive solution is
designed to provide maximum
functionality and to fit seamlessly
in with the sink. The choice of
finish - Black, Gold and Brushed
Stainless Steel - transforms it
into a design element that blends
in with elegant components.



Black



Gold



Inox

Design is functional aesthetic

The optional remote controls interact with the different **Flow Pro**, **Flow** and **Ghost** systems to elevate the user experience by allowing you to open and close the drain remotely.

Flow

Clean lines and a touch of style are the distinguishing traits of Flow, which is designed to improve water outflow and usability compared to traditional drain systems.

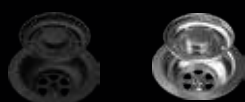

Black

Inox

Ghost

The cover conceals the drain and becomes a design feature, matching seamlessly with the bowl, mixer and accessories or used to create colour contrasts.

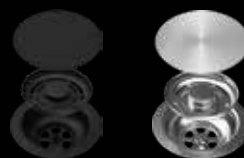

Black

Inox

Mixology

Smart shapes, modular solutions and flexibility create a finite space with an infinite number of uses. Creatively inspired by professional workstations, Mixology juxtaposes and superimposes the figure of the home chef with that of the **bartender**, turning the spotlight on the art of mixing drinks and new trends in entertaining at home.



MIXOLOGY MODEL

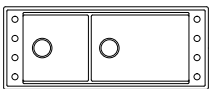

Mixology 590

KERATEK



DESIGN
AWARD
2025



red dot winner 2025

Mixology 590

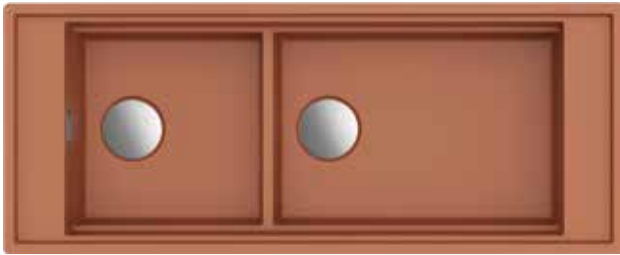

2 Bowl sink

Dimensions 1140 x 460 mm
 Base 1200 mm
 Built-IN 1130 x 450 R5 mm
 (Inset)
 see technical drawing
 (Flushmount)
 Bowl depth 1 190 mm
 Bowl depth 2 190 mm
 Installation Inset/Flushmount
 Reversible

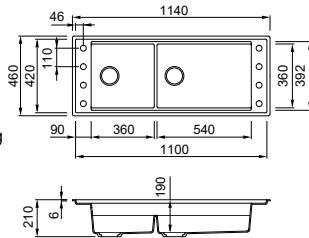

KERATEK



ELC-LKM59086FBXCB



ELC-LKM59087FIXCI



ELC-LKM59099FIXCI



ELC-LKM59083FIXCI

Pod 250

Included with Mixology sink
 Silicon multi-use pod



DIMENSIONS
 250 x 250 x 150 mm

FINISHES

Matching with sink:

● Black

● Clay

Sprayer Show

Single-jet pull-out sprayer, only cold water



DIMENSIONS OF HOLE FOR BUILT-IN INSTALLATION
 Ø 35

DIMENSIONS
 Ø 50

FINISHES

● Black
ELC-MOKSHOBK

● Inox
ELC-MIKSHOCS



Kit Chef

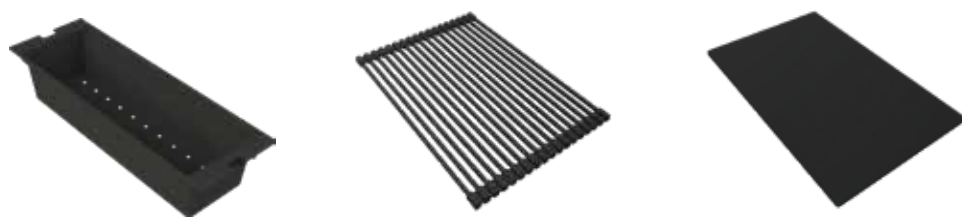

Kit contains: Colander 410 Black, Drainer Flex 440 Black, Chopping Board 460 Black

Kit Chef
ELC-KCH001BK

Kit Bartender



Kit contains: Tray Holder 410 Black, Pod 250 Black, Gourmet 378 1/9 Inox

Kit Bartender
ELC-KBA001BK



Dialogo

Intuition is a light-bulb moment. The preparation area evolves into a seamless system in which all elements work together, enhancing performance.

The rational design exploits the size of the extra-large bowl, slanted to improve drainage.



DIALOGO MODELS



Dialogo 360



Equipped track Dialogo 86

KERATEK



Dialogo 360



1 Bowl sink

Dimensions 860 x 460 mm
Base 900 mm
Built-IN 850 x 450 R5 mm (Inset)
820 x 420 R4 mm (Undermount)
Bowl depth 220 mm
Installation Inset / Undermount
Reversible

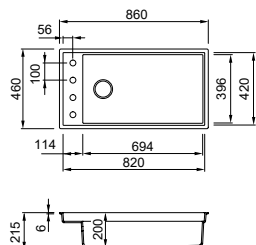

KERATEK



ELC-LKD36086BKM



ELC-LKD36097BKM

Equipped track Dialogo 86



1 Bowl sink

Dimensions 860 x 180 mm
Base 900 mm
Built-IN 850 x 170 R5 mm (Inset)
820 x 140 R4 mm (Undermount)
Bowl depth 150 mm
Installation Inset / Undermount
Reversible

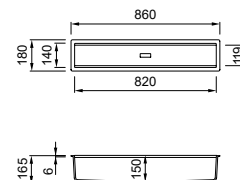

KERATEK



ELC-LKDC8686BKM



ELC-LKDC8697BKM

Tray

Aluminium Tray



DIMENSIONS
408 x 137 x 11 mm

FINISHES
● Black
ELC-AMA103BK

Dish Rack

Aluminium Dish Rack/Drainer



DIMENSIONS
408 x 137 x 78 mm

FINISHES
● Black
ELC-ADA103BK

Colander

Polypropylene colander



DIMENSIONS
410 x 138 x 84 mm

FINISHES
● Black
ELC-AVP033BK

Rollmat

Flexible drainer with silicon-coated steel bars

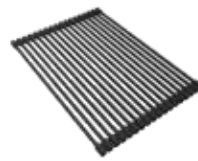

DIMENSIONS
440 x 300 x 10 mm

FINISHES
● Black
ELC-ARS013BK

Chopping Board

Aluminium/HPL



DIMENSIONS
408 x 137 x 180 mm

FINISHES
● Black
ELC-KTA001BK

Sprayer Show

Single-jet pull-out sprayer, only cold water



**DIMENSIONS OF
HOLE FOR BUILT-IN
INSTALLATION**
Ø 35

DIMENSIONS
Ø 50

FINISHES
● Black
ELC-MOKSHOBK
● Inox
ELC-MIKSHOCS



Sintesi

The aim of Sintesi collection is to achieve the highest level of style and comfort in all modular kitchens. A range that comes in a variety of models to add value to any space: from spacious XL bowls with lowered work area and compact workstation solutions.



SINTESI MODELS

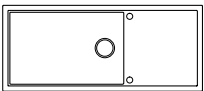

Sintesi 510

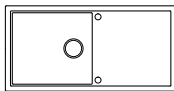

Sintesi 480

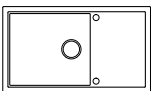

Sintesi 410

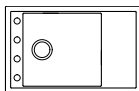

Sintesi 305

KERATEK

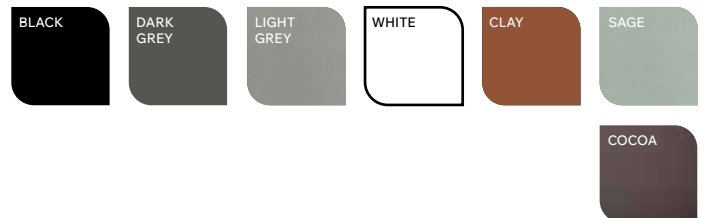

Sintesi 510



1 Bowl sink with drainer

Dimensions
1160 x 500 mm

Built-IN

Inset:
1140 x 480 mm
Flushmount:
see technical
drawing

Base Inset
Top ≥ 35 mm **800 mm**
Top < 35 mm **1200 mm**

Base Flushmount
Top ≥ 40 mm **800 mm**
Top < 40 mm **1200 mm**

Reversible

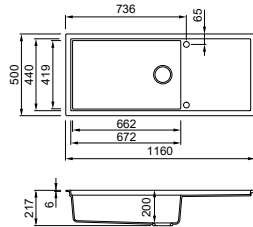
**KERATEK**

ELC-LKS51086



ELC-LKS51083



ELC-LKS51097



ELC-LKS51082



ELC-LKS51096

Sintesi 480



1 Bowl sink with drainer

Dimensions
1000 x 500 mm

Built-IN

Inset:
980 x 480 mm
Flushmount:
see technical
drawing

Base Inset
Top ≥ 35 mm **600 mm**
Top < 35 mm **1200 mm**

Base Flushmount
Top ≥ 40 mm **600 mm**
Top < 40 mm **1200 mm**

Reversible

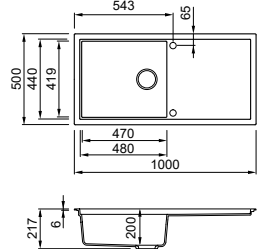
**KERATEK**

ELC-LKS48086



ELC-LKS48097



ELC-LKS48096

Sintesi 410



1 Bowl sink with drainer

Dimensions
860 x 500 mm

Built-IN

Inset:
840 x 480 mm
Flushmount:
see technical
drawing

Base Inset
Top ≥ 35 mm **600 mm**
Top < 35 mm **900 mm**

Base Flushmount
Top ≥ 40 mm **600 mm**
Top < 40 mm **900 mm**

Reversible

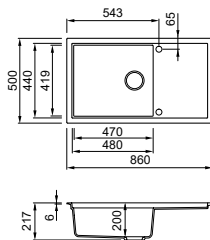
**KERATEK**

ELC-LKS41086



ELC-LKS41097



ELC-LKS41096

Sintesi 305



1 Bowl sink with drainer

Dimensions
780 x 500 mm

Built-IN

Inset:
760 x 480 mm
Flushmount:
see technical
drawing

Base Inset
Top ≥ 20 mm **600 mm**
Top < 20 mm **800 mm**

Base Flushmount
Top ≥ 30 mm **600 mm**
Top < 30 mm **800 mm**

Reversible

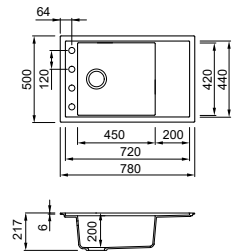
**KERATEK**

ELC-LKS30586



ELC-LKS30583



ELC-LKS30599



ELC-LKS30587

Chopping Board 500

Chopping board in Woodtech / HPL

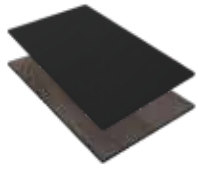

DIMENSIONS
500 x 300 x 9 mm

FINISHES

- Black
ELC-ATH093BK
- Wood
ELC-ATH093WD

Chopping Board 433

Chopping board in Woodtech / HPL

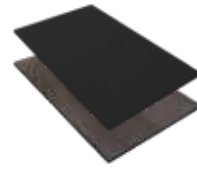

DIMENSIONS
433 x 220 x 8 mm

FINISHES

- Black
ELC-ATH103BK
- Wood
ELC-ATH103WD

Gourmet Drain 433 1/3

Woodtech frame and stainless steel tray



DIMENSIONS
433 x 220 x 65 mm

FINISHES

- Inox
ELC-KD011065IN
- Gold
ELC-KD011065GD
- Black
ELC-KD011065BK

Gourmet Drain 433 1/6

Woodtech frame and stainless steel trays



DIMENSIONS
433 x 220 x 65 mm

FINISHES

- Inox
ELC-KD012100IN
- Gold
ELC-KD012100GD
- Black
ELC-KD012100BK

Gourmet Drain 433 1/9

Woodtech frame and stainless steel trays



DIMENSIONS
433 x 220 x 65 mm

FINISHES

- Inox
ELC-KD013100IN
- Gold
ELC-KD013065GD
- Black
ELC-KD013065BK

Sprayer Show

Single-jet pull-out sprayer, only cold water



**DIMENSIONS OF
HOLE FOR BUILT-IN
INSTALLATION**
Ø 35

DIMENSIONS
Ø 50

FINISHES

- Black
ELC-MOKSHOBK
- Inox
ELC-MIKSHOCS



Best

WORKSTATION

A well-organised kitchen is an excellent starting point for any recipe: Best Workstation has an XL bowl and a series of accessories specifically designed to ensure you have everything at your fingertips.



BEST WORKSTATION MODELS

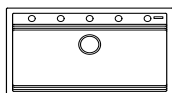

Best 360

KERATEK

WHITE

GRANITEK

BLACK

CEMENTO

Best WS 360



1 Bowl sink

Dimensions 860 x 510 mm
Base 900 mm
Built-IN 840 x 480 mm
Bowl depth 200 mm
Tap counter Yes
Installation Inset
Non Reversible

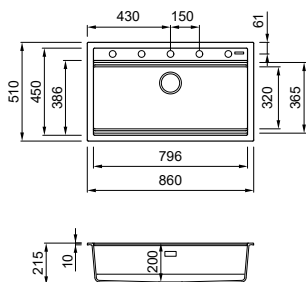

KERATEK



ELC-LKB36096

GRANITEK



ELC-LGB36040



ELC-LGB36048

SQUARE SOAP DISPENSER



FINISHES

Inox
ELC-ADI02301

DRAIN SYSTEM KIT FLOW PRO



FINISHES

Black
ELC-KITWPT-F-1VSELLB

Gold
ELC-KITWPT-F-1VSELLG

Best WS 360 Bundle



GRANITEK



ELC-LGB36040K3FBX

ACCESSORIES INCLUDED:
Drainer, Colander, Chopping Board & Kit Flow Pro

DRAINER FLEX 500

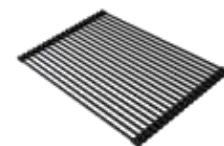

Black

COLANDER BEST WS



Black

CHOPPING BOARD



Black

KIT FLOW PRO



Black

Best

A modern aesthetic is the inspiration behind the pared-back, no-nonsense lines that give Best's capacious bowl and premium drainer their distinctive look. Each element has been designed to optimize space, interact with the various accessories and keep the worktop clean and tidy.



BEST MODELS

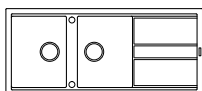

Best 500

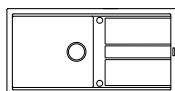

Best 480

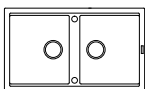

Best 450

KERATEK



GRANITEK



Best 500



2 Bowl sink with drainer

Dimensions 1160 x 510 mm
Base 800 mm
Built-IN 1140 x 480 mm
Bowl depth 1 200 mm
Bowl depth 2 200 mm
Tap counter Yes
Installation Inset
Reversible

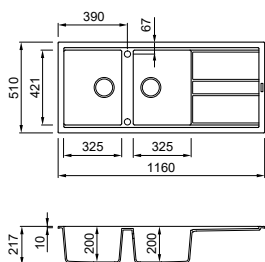

KERATEK



ELC-LKB50096

GRANITEK



ELC-LGB50040



ELC-LGB50048

Best 480



1 Bowl sink with drainer

Dimensions 1000 x 510 mm
Base 600 mm
Built-IN 980 x 480 mm
Bowl depth 1 200 mm
Bowl depth 2 Yes
Tap counter Inset
Installation Reversible

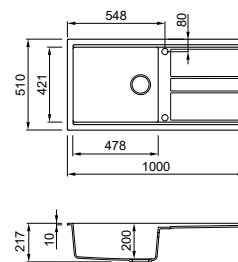

KERATEK



ELC-LKB48096

GRANITEK



ELC-LGB48040



ELC-LGB48048

Best 450



2 Bowl sink

Dimensions 860 x 510 mm
Base 900 mm
Built-IN 840 x 480 mm
Bowl depth 1 200 mm
Bowl depth 2 200 mm
Tap counter Yes
Installation Inset
Reversible

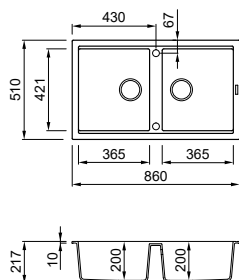

GRANITEK



ELC-LGB45040



ELC-LGB45048



KITCHEN

CHOPPING BOARD BEST LINE



FINISHES

● Grey
ATH020GR

DRAIN SYSTEM KIT FLOW PRO



FINISHES

● Black
ELC-KITWPT-F-1VSELLB

● Gold
ELC-KITWPT-F-1VSELLG



SQUARE SOAP DISPENSER



FINISHES

● Inox
ELC-ADI02301



Zen

Understated elegance showcased in exemplary shapes and the symmetrical perfection of the elements. Zen is the collection of premium sinks, created to evoke a sense of balance and contemporary elegance, thanks to its discrete yet iconic personality.



ZEN MODEL

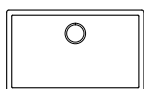

Zen 130

KERATEK



KITCHEN

Zen 130

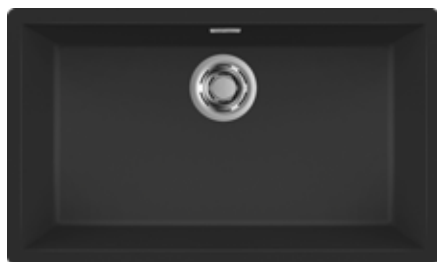

1 Bowl sink

Dimensions 756 x 456 mm
 Base 800 mm
 Built-IN 745 x 445 mm R5
 (Inset)
 700x 400 mm R10
 (Undermount)
 Bowl depth 200 mm
 Tap counter No
 Installation Inset / Undermount
 Non Reversible

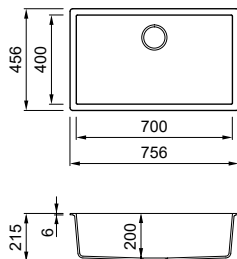

KERATEK



ELC-LKZ13086



ELC-LKZ13093

CHOPPING BOARD 418

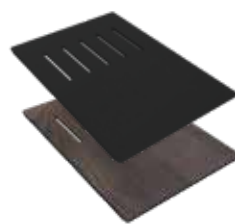

FINISHES

- Black
ELC-ATH040BK
- Wood
ELC-ATH040QU

DRAINER FLEX 440

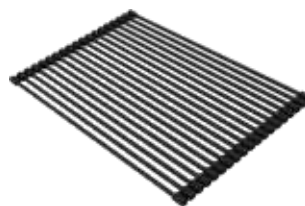

FINISHES

- Black
ELC-ARS013BK

COLANDER ZEN/QUADRA



FINISHES

- Chrome
ELC-AVI03305

DRAIN SYSTEM KIT FLOW PRO



FINISHES

- Black
ELC-KITWPT-F-1VSELLB
- Gold
ELC-KITWPT-F-1VSELLG



Dynamo

We have developed a new line that emphasises both Elleci's technology and its attention to detail and that stands out from the competition because of its versatility. In a word ... Dynamo



DYNAMO MODEL

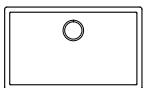

Dynamo 130

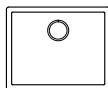

Dynamo 105

GRANITEK



KITCHEN

Dynamo 130

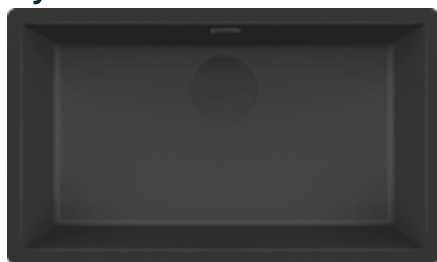

1 Bowl sink

Dimensions 756 x 456 mm
Base 800 mm
Built-IN 745 x 445 mm R5
(Inset)
700x 400 mm R10
(Undermount)
Bowl depth 200 mm
Tap counter No
Installation Inset / Undermount
Non Reversible

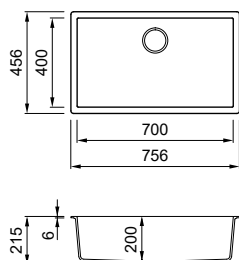

GRANITEK

BLACK ELC-LGZ13040FBXCB

CEMENTO ELC-LGZ13048FIXCI

Dynamo 105

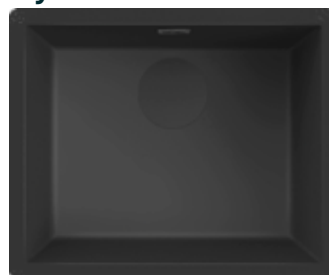

1 Bowl sink

Dimensions 556 x 456 mm
Base 600 mm
Built-IN 545 x 445 mm R5
(Inset)
500x 400 mm R10
(Undermount)
Bowl depth 200 mm
Tap counter No
Installation Inset / Undermount
Non Reversible

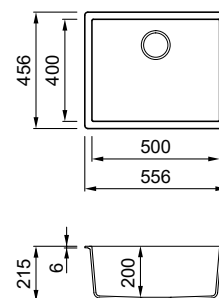

GRANITEK

BLACK ELC-LGZ10540FBXCB

CEMENTO ELC-LGZ10548FIXCI

CHOPPING BOARD 418



FINISHES

- Black ELC-ATH040BK
- Wood ELC-ATH040QU

DRAINER FLEX 440

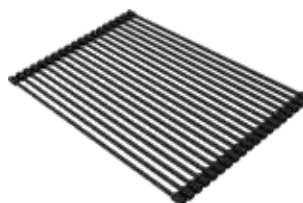

FINISHES

- Black ELC-ARS013BK

Quadra INSET

A minimalist collection with a simplicity that brings out its clean, modern lines. Each model can be combined with a range of accessories and various colours.



QUADRA MODELS



Quadra 102

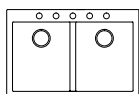

Quadra 340

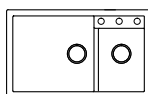

Quadra 440

KERATEK

WHITE

GRANITEK

BLACK

CEMENTO

TITANIUM

Quadra 102



1 Bowl sink

Dimensions	470 x 500 mm
Base	450 500 mm if first component
Built-IN	450 x 480 mm
Bowl depth	200 mm
Tap counter	Yes
Installation	Inset
	Non Reversible

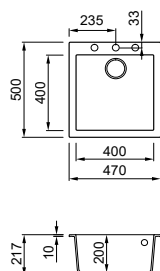

KERATEK



ELC-LKQ10296

GRANITEK



ELC-LGQ10240



ELC-LGQ10248

Quadra 340

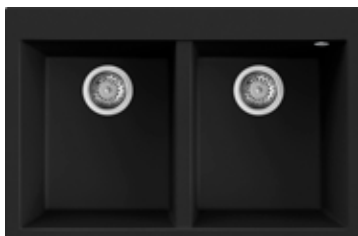

2 Bowl sink

Dimensions	800 x 530 mm
Base	800 900 mm if first component
Built-IN	780 x 510 mm
Bowl depth 1	215 mm
Bowl depth 2	215 mm
Tap counter	Yes
Installation	Inset
	Non Reversible

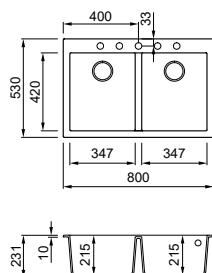

GRANITEK



ELC-LGQ34040BTP



ELC-LMQ34073BTP

Quadra 440

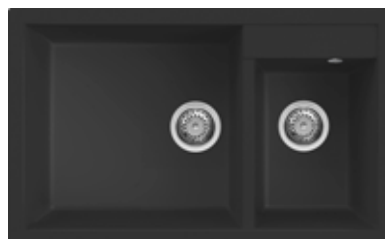

2 Bowl sink

Dimensions	815 x 500 mm
Base	800 900 mm if first component
Built-IN	800 x 480 mm
Bowl depth 1	215 mm
Bowl depth 2	190 mm
Tap counter	Yes
Installation	Inset
	Non Reversible

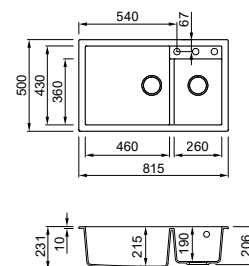

GRANITEK



ELC-LGQ44040



ELC-LMQ44073

KITCHEN

SQUARE SOAP DISPENSER



FINISHES

● **Inox**
ELC-ADI02301

DRAINER FLEX 440

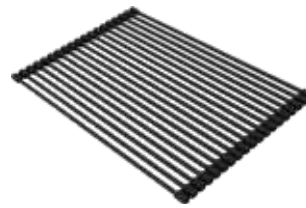

FINISHES

● **Black**
ELC-ARS013BK



Quadra UNDERMOUNT

This collection has been designed to optimise the built-in aspects of the sink and enable total cleaning of the worktop.



QUADRA UNDERMOUNT MODELS

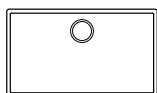

Quadra 130

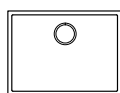

Quadra 110



Quadra 100

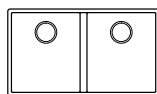

Quadra 350

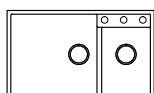

Quadra 440

KERATEK



GRANITEK



KITCHEN

Quadra 130 Undermount

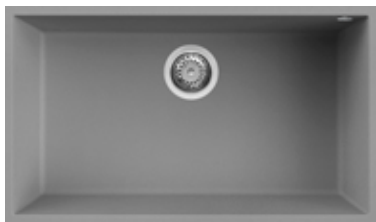

1 Bowl sink

Dimensions 760 x 440 mm
Base 800 mm
Built-IN 720 x 400 mm R5
Bowl depth 200 mm
Tap counter No
Installation Undermount
Non Reversible

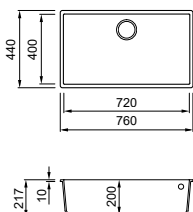

KERATEK



ELC-LKQ13095BSO



ELC-LKQ13096BSO

GRANITEK



ELC-LGQ13040BSO



ELC-LGQ13048BSO

Quadra 110 Undermount

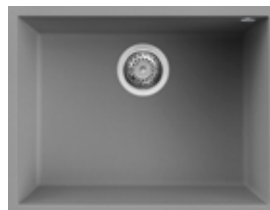

1 Bowl sink

Dimensions 580 x 440 mm
Base 750 mm
Built-IN 540 x 400 mm R5
Bowl depth 190 mm
Tap counter No
Installation Undermount
Non Reversible

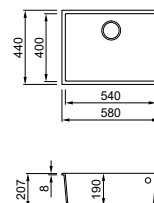

KERATEK



ELC-LKQ11096BSO

GRANITEK



ELC-LGQ11040BSO



ELC-LGQ11048BSO

Quadra 100 Undermount



1 Bowl sink

Dimensions 380 x 440 mm
Base 450 mm
Built-IN 340 x 400 mm R5
Bowl depth 190 mm
Tap counter No
Installation Undermount
Non Reversible

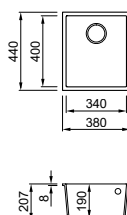

KERATEK



ELC-LKQ10096BSO

GRANITEK



ELC-LGQ10040BSO



ELC-LGQ10048BSO

Quadra 350 Undermount



2 Bowl sink

Dimensions 760 x 435 mm
Base 800 mm
Built-IN 720 x 395 mm R5
Bowl depth 1 220 mm
Bowl depth 2 220 mm
Tap counter No
Installation Undermount
Non Reversible

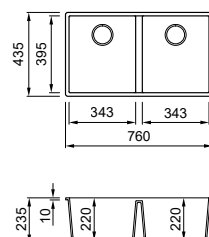

KERATEK



ELC-LKQ35096BSO

GRANITEK



ELC-LGQ35040BSO



ELC-LGQ35048BSO

Quadra 440 Undermount



1 Bowl & 1/2 sink

Dimensions	785 x 470 mm
Base	900 mm
Built-IN	745 x 430 mm R5
Bowl depth 1	215 mm
Bowl depth 2	190 mm
Tap counter	Yes
Installation	Undermount
	Non Reversible

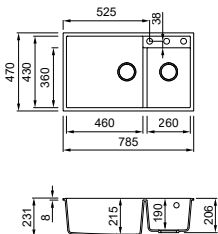

GRANITEK



ELC-LGQ44040BSO

DRAINER FLEX 440

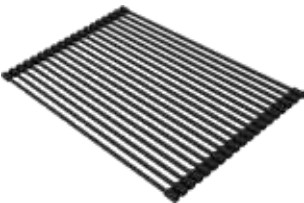

- FINISHES
- Black ELC-ARS013BK

COLANDER ZEN/QUADRA



- FINISHES
- Chrome ELC-AV103305

CHOPPING BOARD 418

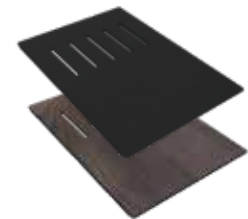

- FINISHES
- Black ELC-ATH040BK
 - Wood ELC-ATH040QU



Unico

Unico is the sink with a spacious bowl and a minimalist drainer design, available in different models to fit kitchens of any modularity. The new Flow Drain System enhances both aesthetics and functionality in a single detail.



UNICO MODELS

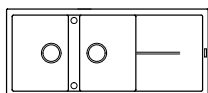

Unico 500

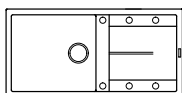

Unico 480

KERATEK

BLACK

Unico 500



2 Bowl sink with drainer

Dimensions	1160 x 500 mm
Base	800 mm
Built-IN	1140 x 480 mm
Bowl depth 1	200 mm
Bowl depth 2	200 mm
Tap counter	Yes
Installation	Inset
	Reversible

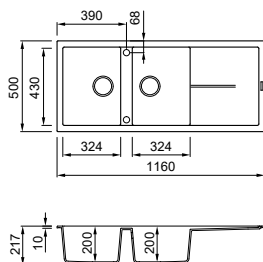

KERATEK



ELC-LKU50086

Unico 480



1 Bowl sink with drainer

Dimensions	1000 x 500 mm
Base	600 mm
Built-IN	980 x 480 mm
Bowl depth	200 mm
Tap counter	Yes
Installation	Inset
	Reversible

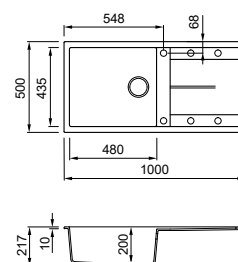

KERATEK



ELC-LKU48086

SQUARE SOAP DISPENSER



FINISHES

- Inox
- ELC-ADI02301

Waste Disposal

A waste disposal unit is an essential modern appliance that disposes of organic waste and makes life easier in the kitchen. With the simple press of a button, the food is ground up and eliminated. Easy to install, compact, quiet and safe. Food waste is reduced to small particles and discharged into the sewage system with the waste water.



1000 TOP

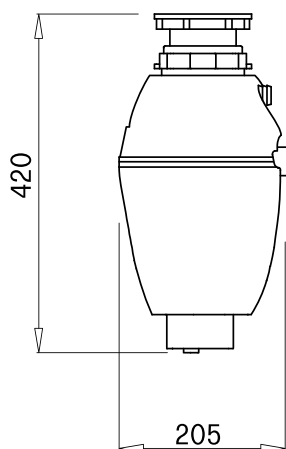

ELC-TDH01000

Dimensions (mm)
205 X 420
Deluxe 1 Hp

SANIPEXGROUP

For 30 years, we have built our prestigious product portfolio, extended our client base and propelled our business to service Middle East, Africa, Europe, Asia & Oceania through our Retail, Trade, Project and digital channels. Combining the highest quality bathroom, kitchen, surfaces, lifestyle, lighting and outdoor living solutions with exceptional customer service, SANIPEX GROUP always delivers.

Established in Dubai, UAE in 1995, SANIPEX GROUP has grown to encompass flagship showrooms in key locations including Dubai, Abu Dhabi and London, alongside an established presence with partner retailers worldwide.

From commercial projects to residential developments, we assist our client base of architects, designers, developers, retailers and consumers to create beautiful spaces.

Working with many market-leading brands and supported by its own strong portfolio of products ensures SANIPEX GROUP is ready to deliver for your next project with strategically placed logistics centres in key locations.

Offering consistently high service levels, at SANIPEX GROUP, the customer always comes first.

WWW.SANIPEXGROUP.COM
INFO@SANIPEXGROUP.COM



/BAGNODESIGNUAE
/SANIPEXGALLERYUAE



/BAGNODESIGNOFFICIAL
/SANIPEXGALLERY



COMPANY/SANIPEXGROUP



/SANIPEXGROUP



/SANIPEXGROUP



SHOP ONLINE
WWW.SANIPEXGROUP.COM

DISCLAIMER

Products are subject to availability. | Pictures are for representation only. | Actual product colours may differ. | Products do not come with accessories. SANIPEX GROUP cannot be held responsible for any technical errors and reserves the right to make revisions without notice.

SANIPEXGROUP

OUR SHOWROOMS

DUBAI

BAGNODESIGN
Jumeirah Beach Road, Umm Suqeim 1
+971 4 507 6000
info@sanipexgroup.com

SANIPEX GALLERY
Between Junction 2 & 3, Sheikh Zayed Road
+971 4 507 6000
info@sanipexgroup.com

BAGNODESIGN
Between Junction 2 & 3, Sheikh Zayed Road
+971 4 507 6000
info@sanipexgroup.com

SANIPEX GALLERY
Umm Suqeim Street
+971 4 718 1754
info@sanipexgroup.com

BAGNODESIGN
Umm Suqeim Street
+971 800 2782
info@sanipexgroup.com

BAGNODESIGN - Deira
Salahuddin Road
+971 4 239 7466
info@sanipexgroup.com

ABU DHABI

SANIPEX GALLERY
Waterfront Tower, Al Zahiya St.
+971 2 585 9222
info@sanipexgroup.com

BAGNODESIGN
Al Falah St.
+971 2 585 9759
info@sanipexgroup.com

SHARJAH

SANIPEX GALLERY
Maleha Road
+971 4 507 6000
info@sanipexgroup.com

RAS AL KHAIMAH

SANIPEX GALLERY
Sheikh Muhammad Bin Salem Road
+971 7 235 7809
info@sanipexgroup.com

AL AIN

BAGNODESIGN
Sanaiya
+971 3 766 3300
info@sanipexgroup.com

QATAR

BAGNODESIGN - Doha
310 Airport Road, Bldg 332
+974 4 438 0200
info@bagnodesign.qa

KSA

BAGNODESIGN - Riyadh
Al-Thaghir Plaza
+966 11 489 5476
info@sanipexsaudi.com

BAGNODESIGN - Jeddah
Ar Rawdah
+966 12 206 7232
info@sanipexsaudi.com

FOR OVERSEAS & PROJECT ENQUIRIES

+971 4 507 6000
info@sanipexgroup.com

WWW.SANIPEXGROUP.COM

CAT-ELC-2025

