

BAKER STREET BOYS
LONDON







"WE TRANSFORM ORDINARY MATERIALS INTO LUXURY EXPERIENCE" - TOMASZ DANIELEC



CONTENT

1. ABOUT BAKER STREET BOYS P. 7 - 8
2. CRAFT P. 9 -14
3. THE LINE P. 15 - 34
4. THE WHITE LINE P. 35 - 38
5. THE LINE PERSPEX P. 39 - 48
6. THE LINE MARBLE P. 49 - 56
7. THE BOX P. 57 - 66
8. THE PYRAMID P. 67 - 76
9. DRAWING DIMENSIONS P. 77 - 79

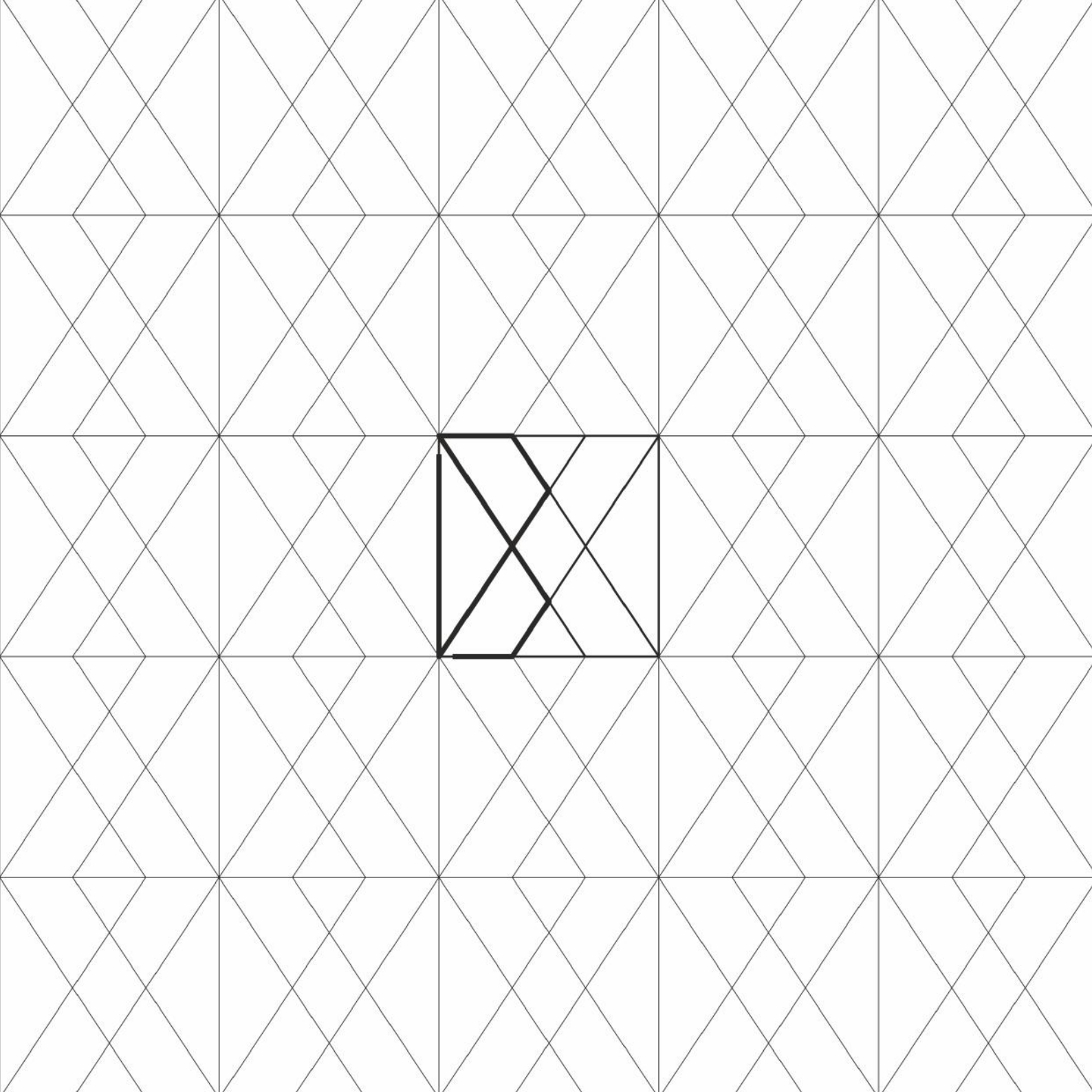

ABOUT BAKER STREET BOYS

BAKER STREET BOYS IS A CONTEMPORARY DESIGN BRAND FOUNDED IN LONDON, IN 2014, BY TOMASZ DANIELEC AND ARKADIUSZ GLANOWSKI.

THE ETHOS OF THE BRAND IS TO REDEFINE THE UNDERSTANDING OF LUXURY DESIGN BY UNVEILING THE HIDDEN BEAUTY WITHIN THE NATURAL, OFTEN-UNAPPRECIATED MATERIALS.

TOMASZ, AN AWARD-WINNING, POLISH ARCHITECT, IS THE CREATIVE FORCE BEHIND THE BRAND. OVER THE COURSE OF HIS 20-YEAR CAREER TOMASZ WORKED ALONGSIDE RENOWNED INDUSTRY FIGURES SUCH AS RAFAEL VIÑOLY, ROBIN PARTINGTON OR TOMASZ KONIOR. ALL OF THIS EXPERIENCE IS REFLECTED AND EMBODIED WITHIN THE GEOMETRY, CONTRASTS AND LINES OF ALL HIS DESIGNS AND PROJECTS.

SCULPTURAL AND FUNCTIONAL FORMS, MINIMALIST ELEGANCE AND THE ARTISTRY OF CRAFT. THE APPLIANCE OF THIS PHILOSOPHY IS WHAT MAKES THE BRAND'S DESIGN INDISPENSABLE AND TIMELESS.

BAKER STREET BOYS' COLLECTIONS GAINED INTERNATIONAL RECOGNITION. THE BRAND WAS CURATED TO EXHIBIT AT THE DESIGN MUSEUM OF LONDON OR DURING THE CLERKENWELL DESIGN WEEK. SINCE ITS OFFICIAL LAUNCH, IN 2016, IT HAS BEEN REPEATEDLY PUBLISHED BY THE INFLUENTIAL PRESS SUCH AS THE WORLD OF INTERIORS, ELLE DECORATION, THE TIMES AND THE EVENING STANDARD. THE BRAND HAS ALSO PARTNERED WITH RETAILERS INCLUDING LIBERTY OF LONDON OR HARVEY NICHOLS.

BAKER STREET BOYS CONTINUOUSLY SATISFY THE EXCEEDINGLY HIGH STANDARDS OF THEIR NOTABLE CLIENTS INCLUDING CELEBRITIES AND ROYALS.



CRAFT

USING SKILLED CRAFTSMEN FROM SOUTHEAST POLAND, KNOWN FOR THEIR EXCEPTIONAL TRAINING IN BOTH METALWORK AND WOODWORK, REMAINS TRADITION AT BAKER STREET BOYS SINCE ITS FOUNDING IN 2014.

STRONG FAMILY VALUES WERE BUILT AROUND THE BRAND THROUGH THE COOPERATION WITH THE LOCAL ARTISANS. THE ORIGIN OF THE CRAFTSMEN, WHO ALL COME FROM THE VILLAGE WHERE THE BRAND'S DESIGNER, TOMASZ DANIELEC, WAS BORN AND RAISED, CREATES EMOTIONAL ATTACHMENT POURED INTO EACH AND EVERY DESIGN.

MATERIALS SELECTED FOR THE OBJECTS ARE CURATORY SOURCED FROM FRANCE, ITALY, UK, GERMANY AND POLAND. THEIR TREATMENT UNCOVERS NEW, HIDDEN FEATURES AND EMPHASISES OLD, UNLOVED SCARS.

AT BAKER STREET BOYS THE QUALITY OF FINISH COMBINED WITH NATURAL IMPERFECTIONS OF MATERIALS DELIVER TIMELESS, DIVERSE AND SOULFUL DESIGNS.







Palme stans
subrotine

MAG
350





THE LINE

MINIMALISM OF THE FORM, SIMPLICITY OF THE PROCESS, TIMELESSNESS OF THE DESIGN.

THE LINE COLLECTION IS THE EMBODIMENT OF MINIMALISM. CLEAN LINES, FOLDED INTO GEOMETRIC, FUNCTIONAL SHAPES CONNECT WITH UNSPOILED, NATURAL MATERIALS. THE SIMPLICITY OF THE FUSION IS WHAT GIVES THE DESIGN ITS LUCIDITY, STRENGTH AND LONGEVITY.

THE LINE CONSISTS OF 4 UNIQUE OBJECTS: THE LINE SIDE TABLE, THE LINE COFFEE TABLE, THE LINE BAR STOOL AND THE LINE FOOT STOOL. TOGETHER THEY CREATE A UNIQUE GEOMETRIC CONSTELLATION.

CRAFT

AS STATED ABOVE IN THE MOTTO OF THE LINE COLLECTION, THE CRAFTING PROCESS OF ITS DESIGNS FOCUSES ON SIMPLICITY. IT IS LOW TECH AND IT PUTS GREAT ATTENTION TO DETAILS SUCH AS HAND ROUNDED AND POLISHED EDGES OF THE STEEL OR THE UNTOUCHED STAINS AND BENDING LINES ON THE METAL SURFACE.

IN ORDER TO ACHIEVE THE TIMELESSNESS OF THE DESIGN THE RAW STEEL CONNECTS WITH THE HISTORIC APPROX. 300-YEAR-OLD OAK. IT IS BEING DRUMMED UP FROM THE RECLAIMED, FRENCH AND BRITISH BEAMS AND AIR-DRIED IN THE AREA OF COTSWOLDS, UK FOR 10-15 YEARS. LATER ON IT IS BEING CUT INTO SMALLER PIECES AND IT ARRIVES IN POLAND WHERE THE LOCAL JOINER PROCESSES AND PREPARES THE OAK FOR THE FUTURE USE.

FOR THIS COLLECTION BAKER STREET BOYS OFFER CUSTOMISED OPTIONS: NERO MARQUINA/BIANCO CARRARA MARBLE TOPS, CONCRETE TOPS, WHITE FINISHED STEEL BASE, PERSPEX BASE, STAINLESS STEEL BASE.







THE LINE SIDE TABLE

THE G SHAPED TABLE ATTENTIVELY CRAFTED OUT OF THE VINTAGE, TREATED OAK AND THE RAW STEEL. THE TABLE HAS A WIDE, STEEL SLOT FOR MAGAZINES, BOOKS OR LAPTOP AND A STEEL SHELF FOR YOUR PHONE OR WATCH.

DIMENSIONS: H 48.5 X W 25 X L 25 CM

MATERIALS: RAW STEEL & APPROX. 300-YEAR-OLD, RECLAIMED OAK

DESIGNER: TOMASZ DANIELEC

WEIGHT: 15KG

HANDMADE IN POLAND.
NUMBERED AND CERTIFIED.
MADE TO ORDER.







THE LINE COFFEE TABLE

THE SWAN SHAPED TABLE CRAFTED OUT OF THE VINTAGE, TREATED OAK AND THE RAW STEEL. DUE TO ITS GEOMETRICAL SHAPE THE TABLE PROVIDES A STEEL SLOT FOR BOOKS OR MAGAZINES AS WELL AS AN OVER-SOFA PLATFORM FOR LAPTOP OR COFFEE. THE IMPLEMENTATION OF THE FOOT STOOL FORM, AT THE LOWER PLATFORM, ENSURES THE RESTING SPACE FOR YOUR FEET.

DIMENSIONS: H1 50 X H2 30 X W 25 X L 82 CM

MATERIALS: RAW STEEL & APPROX. 300-YEAR-OLD, RECLAIMED OAK

DESIGNER: TOMASZ DANIELEC

WEIGHT: 24KG

HANDMADE IN POLAND.
NUMBERED AND CERTIFIED.
MADE TO ORDER.







THE LINE BAR STOOL

THE G SHAPED BAR STOOL SKILFULLY CRAFTED OUT OF THE VINTAGE, TREATED OAK AND THE RAW STEEL. THE STOOL'S STEEL BASE BENDS INTO FUNCTIONAL FOOTREST ENSURING A COMFORTABLE USE OF THE DESIGN. THE CONNECTION OF SUBSTANTIAL WEIGHT AND THE FELT PADDINGS BOTH PRESERVE THE STOOL FROM FALLING AND ALLOW IT TO BE EASILY MOVED AROUND.

DIMENSIONS: H 75 X W 25 X L 25 CM

MATERIALS: RAW STEEL & APPROX. 300-YEAR-OLD, RECLAIMED OAK

DESIGNER: TOMASZ DANIELEC

WEIGHT: 29KG

HANDMADE IN POLAND.
NUMBERED AND CERTIFIED.
MADE TO ORDER.







THE LINE FOOT STOOL

THE H SHAPED STOOL CREATED OUT OF THE VINTAGE, TREATED OAK AND THE RAW STEEL. IT HAS A WOODEN PLATFORM ENSURING A FUNCTIONAL SPACE TO REST YOUR FEET AND CAN ALSO WORK AS LOW SIDE TABLE OR LAMP STAND.

DIMENSIONS: H 30 X W 25 X L 47 CM

MATERIALS: RAW STEEL & APPROX. 300-YEAR-OLD, RECLAIMED OAK

DESIGNER: TOMASZ DANIELEC

WEIGHT: 13KG

HANDMADE IN POLAND.
NUMBERED AND CERTIFIED.
MADE TO ORDER.







THE WHITE LINE



IN THE WHITE LINE COLLECTION THE RAW STEEL RECEIVES THE HIGHEST QUALITY, HAND APPLIED, WHITE MATT, FINISH.





THE LINE PERSPEX



THE LINE MARBLE PERSPEX COFFEE TABLE

THE LINE MARBLE PERSPEX COFFEE TABLE TAKES THE VERSATILE COFFEE TABLE OF THE LINE COLLECTION AND REPLACES RAW STEEL WITH STRONG BENDED PERSPEX AND BEAUTIFUL, NATURAL, ITALIAN MARBLE. THROUGH CONNECTION OF THE TRANSPARENT BASE AND THE SOLID MARBLE WE RECEIVE THE GREAT GAME OF CONTRASTS EMPHASIZING THE SCULPTURAL FORM OF THE DESIGN.

DIMENSIONS: H1 50 X H2 20,5 X W 25 X L 82 CM

MATERIALS: PERSPEX & BIANCO CARRARA MARBLE, PERSPEX & NERO MARQUINA MARBLE

DESIGNER: TOMASZ DANIELEC

WEIGHT: 10KG

HANDMADE IN POLAND.
CERTIFIED.
MADE TO ORDER.







THE LINE PERSPEX COFFEE TABLE

BASED ON THE LINE COFFEE TABLE, BAKER STREET BOYS CREATED A VERSION THAT REPLACED RAW STEEL WITH STRONG BENDED PERSPEX FOR A CLEAN, MINIMAL LOOK. IT IS A STATEMENT PIECE IN WHICH PLASTIC SERVES AS INDISPOSABLE MATERIAL. THE IDEA OF THE DESIGN IS TO BE KEPT FOR GENERATIONS THUS DENYING THE USUAL APPROACH TO PLASTIC OBJECTS.

DIMENSIONS: H1 50 X H2 30 X W 25 X L 82 CM

MATERIALS: PERSPEX & APPROX. 300-YEAR-OLD, RECLAIMED OAK

DESIGNER: TOMASZ DANIELEC

WEIGHT: 10KG

HANDMADE IN POLAND.
CERTIFIED.
MADE TO ORDER.







THE LINE MARBLE



THE LINE MARBLE COFFEE TABLE

THE LINE MARBLE TAKES THE VERSATILE TABLES OF THE LINE AND FUSES THE STEEL WITH BEAUTIFUL, NATURAL, ITALIAN MARBLE. THE COHABITANCE OF WHITES AND BLACKS GIVES THE DESIGN LIGHT, MINIMAL LOOK, ENRICHED BY THE SCULPTURAL VALUE.

MATERIALS: RAW STEEL & BIANCO CARRARA MARBLE, WHITE FINISHED STEEL & NERO MARQUINA MARBLE

DIMENSIONS: H1 50 X H2 20.5 X W 25 X L 82 CM

WEIGHT: 24KG

DESIGNER: TOMASZ DANIELEC

HANDMADE IN POLAND.
NUMBERED AND CERTIFIED.
MADE TO ORDER.



THE LINE MARBLE SIDE TABLE

THE G SHAPED TABLE CRAFTED OUT OF THE RAW STEEL AND PRECISELY CURATED ITALIAN MARBLE. THE TABLE HAS A WIDE, STEEL SLOT FOR MAGAZINES, BOOKS OR LAPTOP AND A STEEL SHELF FOR YOUR PHONE OR WATCH.

MATERIALS: RAW STEEL & BIANCO CARRARA MARBLE, WHITE FINISHED STEEL & NERO MARQUINA MARBLE

DIMENSIONS: H 48.5 X W 25 X L 25 CM

WEIGHT: 15KG

DESIGNER: TOMASZ DANIELEC

HANDMADE IN POLAND.
NUMBERED AND CERTIFIED.
MADE TO ORDER.







THE BOX COLLECTION

THE BOX REPRESENTS THE COLLABORATION BETWEEN THE ARTISTS AND THE CREATIVE FORCES OF NATURE.

IT IS THE INTERVENTION AND THE HARNESSING OF THE RUST PROCESSES FROM WHICH ITS HIDDEN BEAUTY IS BEING UNCOVERED.

THROUGH RICHNESS OF THE PATTERN COMBINED WITH SIMPLICITY OF THE FORM THE BOX BECOMES A UNIQUE COLLECTION OF FUNCTIONAL ART.

CRAFT

EACH SIDE OF THE PRECISELY, WELDED STEEL BOX ACTS AS A SEPARATE CANVAS FOR CREATION. USING ACID AS A PAINT AND GRINDER AS A BRUSH ARTISTS BREAK THE CONVENTIONS IN ORDER TO ACHIEVE UNUSUAL RESULTS.

CAREFULLY OXIDISED AND POLISHED STEEL SURFACES ARE COVERED WITH THE HIGH QUALITY, GLOSS VARNISH FURTHER EMPHASISING THE EXCEPTIONAL, RICH PATTERNS.

ALL OF THE PATINAS ARE HANDCRAFTED BY TOMASZ, BRAND'S DESIGNER, AND HIS YOUNGER SISTER AGNIESZKA, TRAINED CHEMIST AND MATHEMATICIAN. UNPREDICTABLE REACTIONS GUIDE THEM THROUGH THE PROCESS MAKING THE NATURE CO-CREATOR OF THE DESIGN.



THE BOX BAR STOOL

THE BOX SHAPED BAR STOOL CREATED OUT OF THE PRECISELY WELDED,
RAW STEEL COVERED WITH THE HAND-CRAFTED RUST PATINAS.
THE STOOL HAS THE FUNCTIONAL FOOTREST EMBEDDED IN ITS FORM.

DIMENSIONS: H 75 X W 30 X L 30 CM

MATERIALS: OXIDISED AND POLISHED RAW STEEL, GLOSS VARNISH

DESIGNER: TOMASZ DANIELEC, AGNIESZKA BAR

WEIGHT: 39KG

LIMITED EDITION | 50 + 3AP

HANDCRAFTED IN POLAND, IN TWARDAWA CASTLE.
NUMBERED AND CERTIFIED.
MADE TO ORDER.







THE BOX TABLES

THE BOX SHAPED SET OF THREE TABLES CRAFTED OUT OF THE RAW STEEL, PRECISELY COVERED WITH THE RUST PATINAS. EACH OF THE OBJECTS HAS THE FUNCTIONAL, STEEL 'SHELF' AND ITS OWN CHARACTERISTIC PATTERNS OF RUST MAKING THEM ALL ONE OF A KIND.

DIMENSIONS:

SMALL BOX - H 30 X W 30 X L 30 CM

MEDIUM BOX - H 37.5 X W 37.5 X L 37.5 CM

BIG BOX - H 45 X W 45 X L 45 CM

MATERIALS: OXIDISED AND POLISHED RAW STEEL, GLOSS VARNISH

DESIGNER: TOMASZ DANIELEC, AGNIESZKA BAR

WEIGHT:

SMALL BOX - 13.5KG, MEDIUM BOX - 21.5KG, BIG BOX - 29.5KG

LIMITED EDITION | 15 SETS + 3AS

HANDCRAFTED IN POLAND, IN TWARDAWA CASTLE.
NUMBERED AND CERTIFIED.
MADE TO ORDER.







THE PYRAMID

THE PYRAMID IS THE MINIMALISTIC, MULTIFUNCTIONAL OBJECT THAT CAN BE REARRANGED INTO 3 DIFFERENT SCULPTURAL FORMS. IT WAS ORIGINALLY DESIGNED FOR THE CHRISTMAS EXHIBITION ON THE REQUEST OF THE DESIGN MUSEUM IN LONDON, IN 2016.

DESIGNER'S FIRST IDEA WAS FOR IT TO SERVE AS A CHRISTMAS TREE THAT COULD BE USED THROUGHOUT THE WHOLE YEAR IN THE FORM OF A TABLE, MAKING A STRONG ENVIRONMENTAL STATEMENT.

THE PYRAMID IS AN ESSENCE OF FUNCTIONAL ART. IT GIVES THE FREEDOM OF CHOICE AND REZONATES WITH USERS EMOTIONS CREATING FIRM, EMOTIONAL CONNECTION.

CRAFT

THE PYRAMID PROJECT IS THE DEFINITION OF ARTISTRY AT METALWORK AND WOODWORK.

USING YEARS OF WELDING EXPERIENCE, BAKER STREET BOYS' LOCAL LOCKSMITH CREATES THE PERFECT FORM OF THE PYRAMID ENRICHED BY THE HAND POLISHED FINISH. THE PROCESS THEN MOVES INTO THE HANDS OF THE BRAND'S TRUSTED JOINER WHO 'TAILORS' THE WOODEN BASE OF THE DESIGN TO THE METAL PYRAMID.

THIS PROJECT IS SIMPLY THE POWER OF PRECISION WHERE TWO ELEMENTS, OAK AND STEEL, HAVE TO PERFECTLY MATCH WITH EACH OTHER IN ORDER TO CREATE MINIMALIST AND FUNCTIONAL FURNITURE ART.



THE PYRAMID

THE PYRAMID SHAPED TABLE CREATED OUT OF THE EUROPEAN OAK AND THE HANDCRAFTED RAW STEEL. IT CAN BE TRANSFORMED INTO JEWELLERY STAND, CHRISTMAS TREE, WOODEN-TOP SIDE TABLE AND STEEL-TOP SIDE TABLE.

DIMENSIONS: H 62.5 (PYRAMID FORM) X H 57.5 (TABLE FORM) X W 30 X L 30 CM

MATERIALS: RAW STEEL & EUROPEAN OAK

DESIGNER: TOMASZ DANIELEC

WEIGHT: 12.5KG

HANDMADE IN POLAND.
NUMBERED AND CERTIFIED.
MADE TO ORDER.















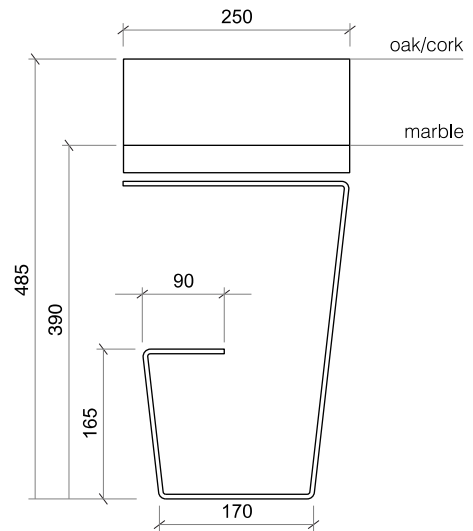
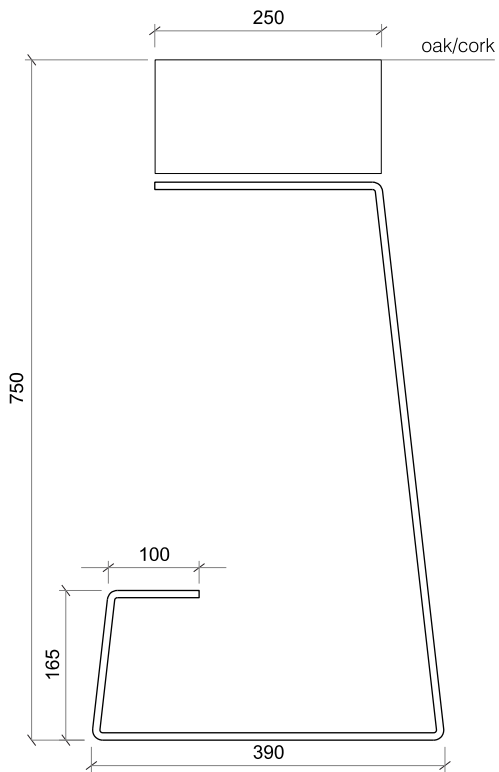
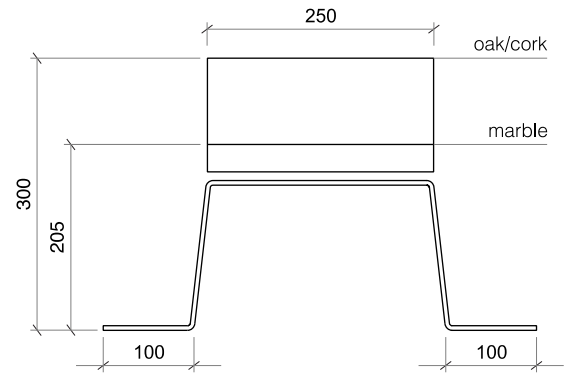
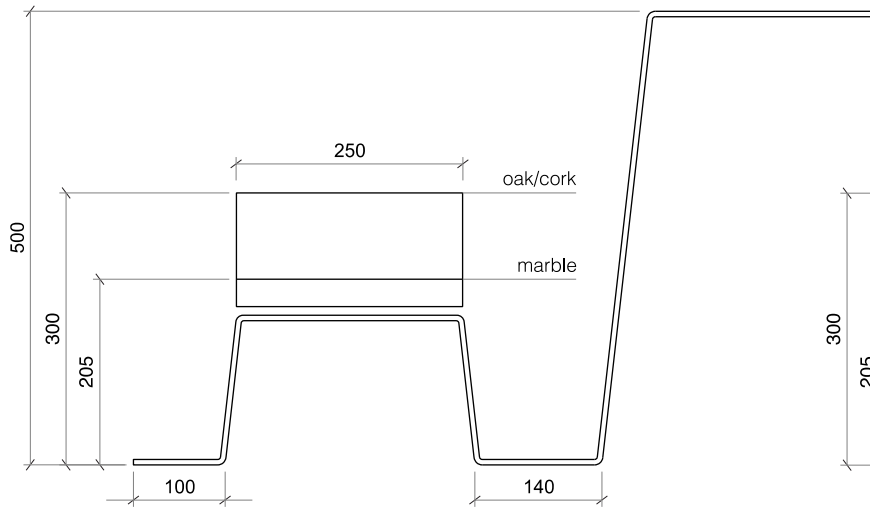

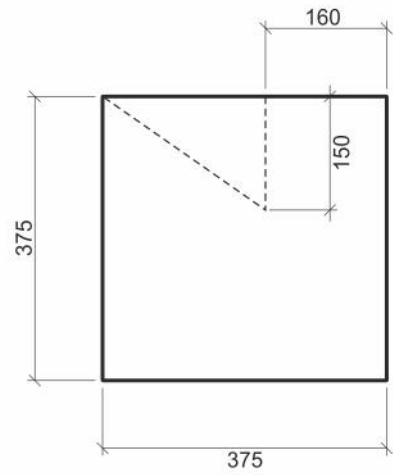
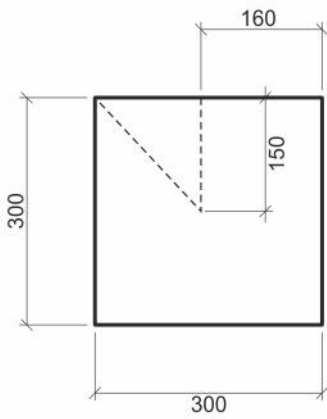
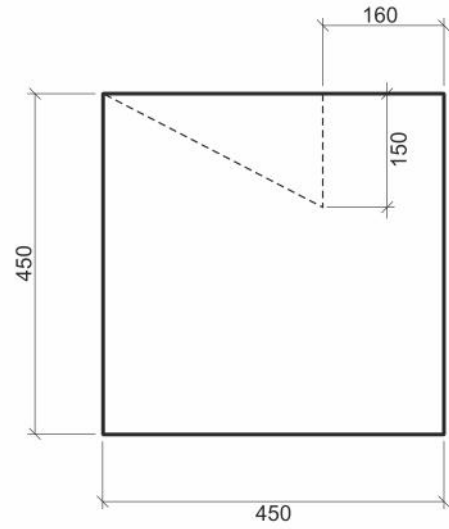
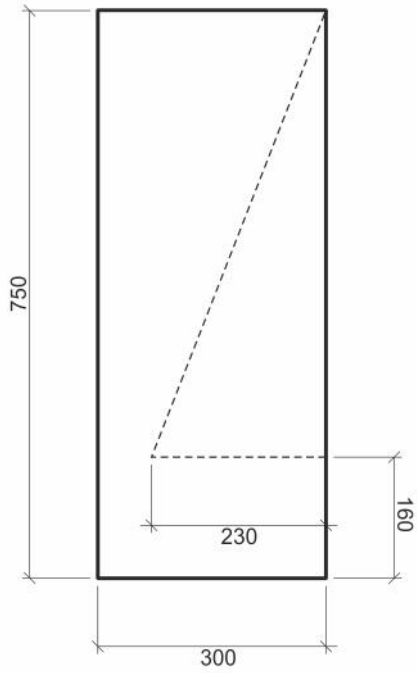

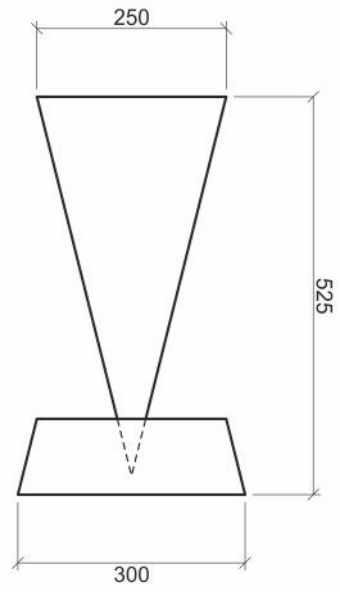
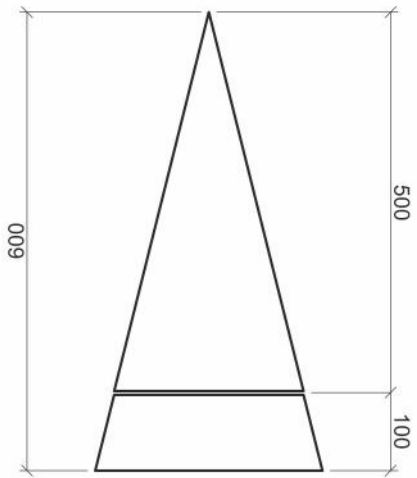

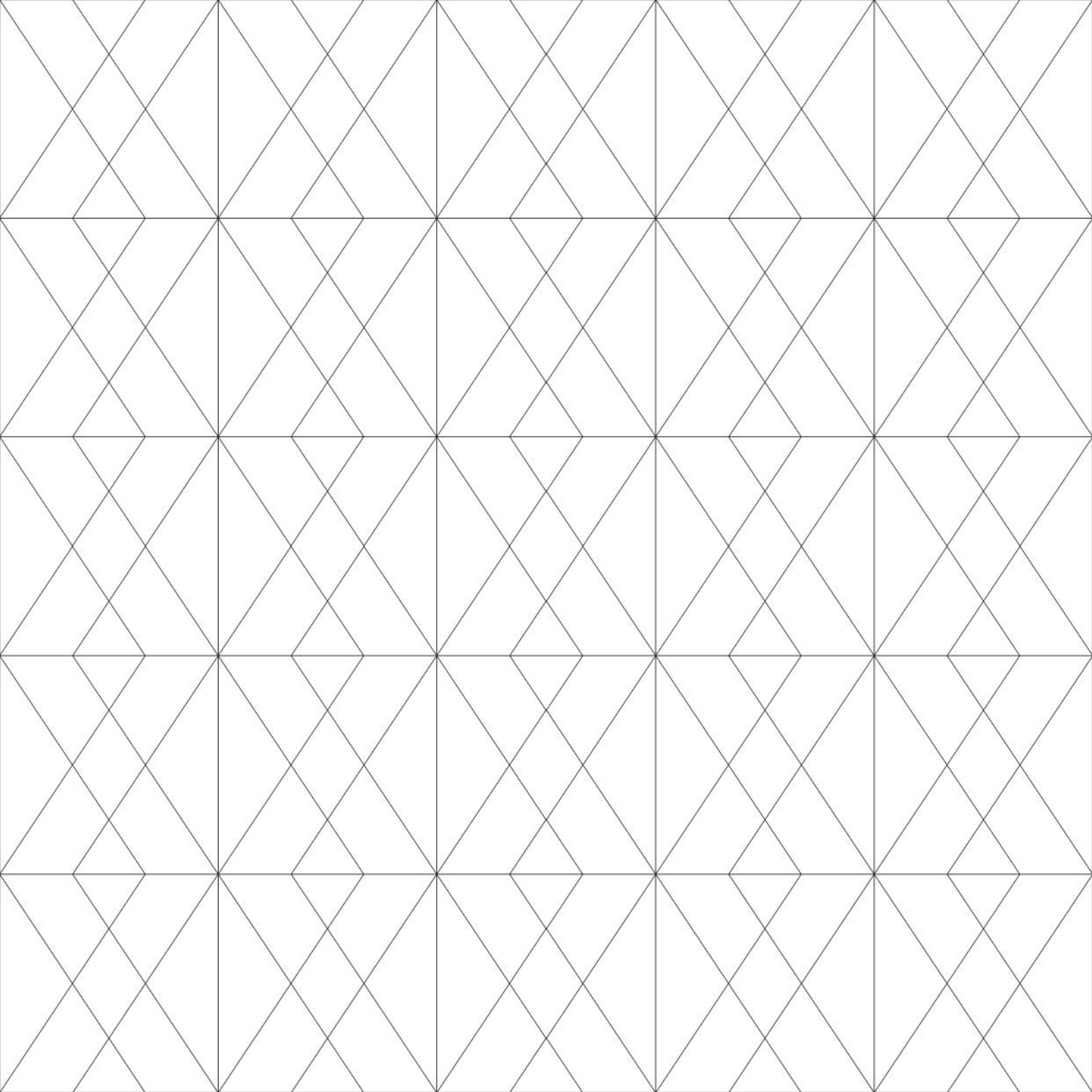

BAKERSTREETBOYS.COM
INFO@BAKERSTREETBOYS.COM
#BAKERSTREETBOYS



© 2023 BAKER STREET BOYS LIMITED
PHOTOGRAPHER: ERNEST WIŃCZYK, PATRYK KIEŁBOŃ,
BAKER STREET BOYS