



## The Hidden Palace

### Emperor Suite

The 200-square-meter Emperor Suite is a serene sanctuary perched above the jungle, offering stunning views of the Ayung River and tropical gardens. Floor-to-ceiling windows merge indoor and outdoor spaces, while elegant bathrooms feature a luxurious bathtub for ultimate relaxation.

### Room Specifications

Details	Description
Size	200 SQM
Bed Type	Emperor Size Bed
Occupancy	2 Persons
Pool	Olympic Size Pool
Outdoor Features	Outdoor Gazebo & Sunbeds
Bathub	Deluxe Handmade Terrazzo Bathtub
Other	Shared Dining & Living Area

### Features

- Minibar
- Safety Box
- Hair Dryer
- Wireless Internet
- Luxurious Toiletries
- Cotton Bathrobes & Slippers
- Home Audio & Visual System
- Coffee & Tea Making Facilities







## The Hidden Palace

### Presidential Suite

The 200-square-meter Presidential Suite is a private retreat that combines homey comfort with natural beauty. Nestled on the resort's lower level, it offers sweeping views of the jungle, Ayung River, and pool. Expansive balconies invite you to unwind, while the suite exudes refined tranquility.

### Room Specifications

Details	Description
Size	200 SQM
Bed Type	Emperor Size Bed
Occupancy	2 Persons
Pool	Olympic Size Pool
Outdoor Features	Outdoor Gazebo & Sunbeds
Bathub	Deluxe Handmade Terrazzo Bathtub
Other	Shared Dining & Living Area

### Features

- ✎ Minibar
- 🛀 Luxurious Toiletries
- 🔒 Safety Box
- 🛀 Cotton Bathrobes & Slippers
- 💨 Hair Dryer
- 🔊 Home Audio & Visual System
- 📶 Wireless Internet
- ☕ Coffee & Tea Making Facilities







## The Hidden Palace

### Majestic Suite

Majestic Suite is a peaceful retreat in the heart of the Ubud jungle. Located on the resort's lower level, it features balconies with views of the jungle, pool, and Ayung River. Inside, a spacious living area connects to indoor and outdoor bathrooms, complemented by a private spa bale and thoughtful, elegant design.

### Room Specifications

Details	Description
Size	200 SQM
Bed Type	Emperor Size Bed
Occupancy	2 Persons
Pool	Olympic Size Pool
Outdoor Features	Outdoor Gazebo & Sunbeds
Bathub	Deluxe Handmade Terrazzo Bathtub
Other	Shared Dining & Living Area

### Features

- Minibar
- Safety Box
- Hair Dryer
- Wireless Internet
- Luxurious Toiletries
- Cotton Bathrobes & Slippers
- Home Audio & Visual System
- Coffee & Tea Making Facilities







## The Hidden Palace

### Gardens Suite 1 & 2

The Garden Suites are tranquil sanctuaries with lush jungle, pool, and river views. Each offers elegant comfort with luxurious bedding, a spacious bathroom, and a private terrace facing the Ayung River. Contemporary Balinese design and handcrafted local art add a refined, residential touch.

### Room Specifications

Details	Description
Size	55 SQM
Bed Type	Emperor Size Bed
Occupancy	2 Persons
Pool	Olympic Size Pool
Outdoor Features	Outdoor Gazebo & Sunbeds
Bathub	Deluxe Handmade Terrazzo Bathtub
Other	Shared Dining & Living Area

### Features

- Minibar
- Safety Box
- Hair Dryer
- Wireless Internet
- Luxurious Toiletries
- Cotton Bathrobes & Slippers
- Home Audio & Visual System
- Coffee & Tea Making Facilities

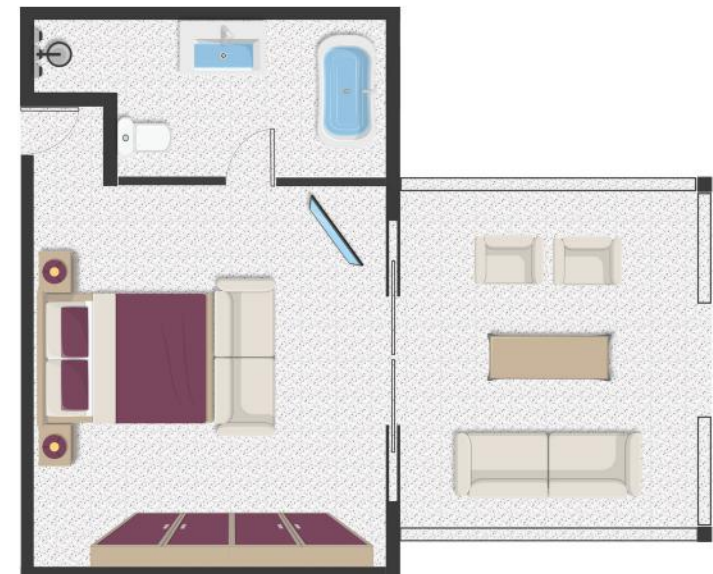





## The Hidden Palace

### The Hidden Palace Pool

The Hidden Palace features a private Olympic-sized swimming pool spanning 144 square meters, surrounded by dense tropical foliage and offering a tranquil escape in complete seclusion. Designed for both leisure and relaxation, the pool provides a serene setting with natural jungle sounds and uninterrupted views, ideal for swimming, sunbathing, or quiet reflection in nature.

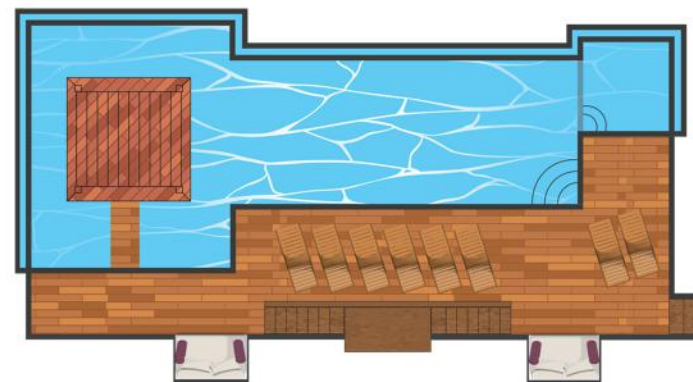

### The Hidden Palace Lounge

A refined 126-square-meter venue designed for private events and bespoke weddings, combining tropical sophistication with timeless Balinese design. Surrounded by lush jungle views, it features artisanal details and an intimate atmosphere—perfect for elegant gatherings.



\*Alongside the main suite, The Hidden Palace includes three extra rooms for your entourage, ensuring everyone in your party enjoys a private and comfortable stay.