

GET SMART

THE CONNECTED SHOP



**OUTDOOR SMART CAMERA MONITOR
USER MANUAL**

Welcome to the Outdoor Smart Camera Monitor User Manual. Your easy, step-by-step guide to set up and connect your Outdoor Smart Camera Monitor. The device is designed to be easy-to-use and to replace all average camera monitors with this modern one.



SUMMARY

I. Device Set Up



- 1. Set-up Guide
 - a) Set-up Video

II. Mobile App Connection



- 3. Registering on the Mobile App
 - a) Downloading the Mobile App
 - b) Adding Devices

PACKAGING DETAILS

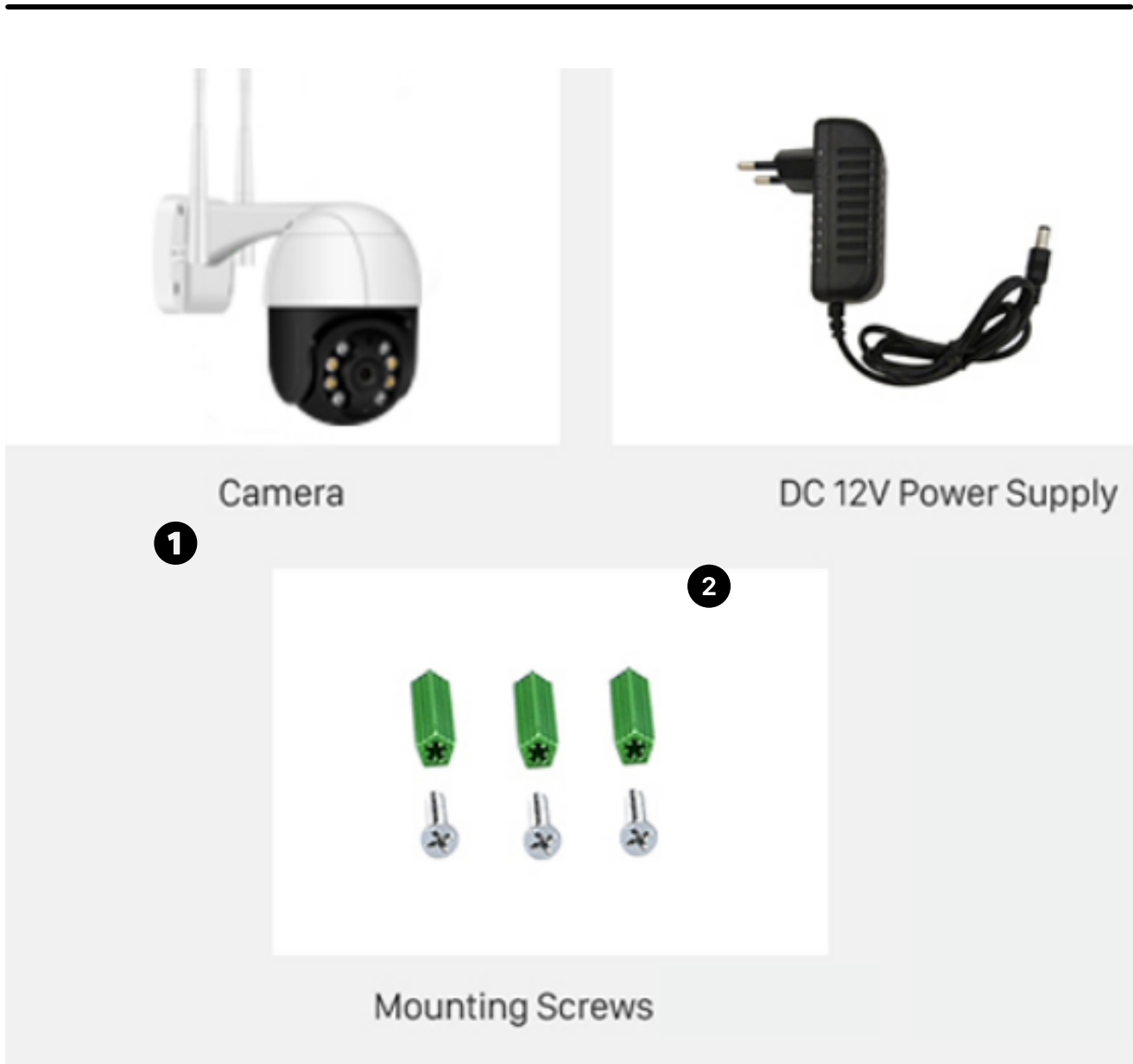

1 Smart Camera Monitor

2 Mounting Screws and Plug

STEP-BY-STEP SET-UP GUIDE



1. SET UP



- a. Remove all items from their original box and insert the SD Card
- b. Use the screws to install the device on a flat surface and to keep it in place
- c. Keep the device plugged in when in use
- d. Proceed to the following steps on how to pair the device with the mobile app to remotely manage it
- e. Make sure to generate a QR code from the mobile app and scan it using the device to finish pairing



3. MOBILE APP CONNECTION



a) Downloading the App

Download the application on the Google Play Store or Apple AppStore by searching “ICSee” or by scanning the QR code below:



After downloading the app

- Register or log in to an account
- Enable your Bluetooth and phone location
- Activate the device
- Keep your device near your phone

3. MOBILE APP CONNECTION



b) Adding Devices

To add devices on the app, please follow the instructions below. Your devices and phone must be connected to the same Wi-Fi network in order for this to work.

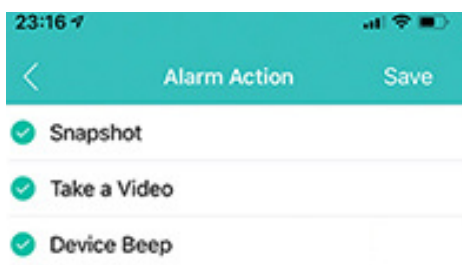

- To add a device on the mobile app, click the '+' icon on the main page of the app and follow the next steps on your phone
- It will begin searching for nearby devices

- Wait for the app to finish searching
- Enter your Wi-Fi name and password
- Continue to generate a QR code and place your phone in front of the device to scan it
- Finish inputting all the details for your device
- Proceed to remotely manage the device through your phone once it has successfully paired



Congratulations!

You have successfully set up your very own Outdoor Smart Camera Monitor.

Thank you for being a valued customer of The Connected Shop.

www.theconnectedshop.com





THE CONNECTED SHOP