



THREE MODULE POLE MOUNT

UNI-PGRM/3P1 (for modules 38" - 72" long)

UNI-PGRM/3P1-47 (for modules 72" - 96" long)

VERTICAL AND HORIZONTAL SCHEDULE-40* PIPE IS NOT INCLUDED. PURCHASE LOCALLY.

* Some wind speeds and snow loads require two vertical poles and/or Sch-80 horizontal/vertical pipe.

If an additional vertical pole is required order a 70-0300-PGM-B Pole Cap.

- Mount three solar modules with a total area of 75 sq-ft and a frame thickness between 1.18 and 2 inches*
- Suitable for wind speed up to 150 MPH and snow load up to 100 PSF
- Maximum post height of 6-feet above ground
- Tilt angle from 10° to 60°
- Ships via UPS
- Simple one-person installation and adjustment

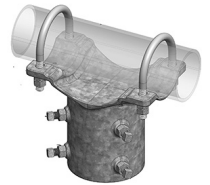

70-0300-PGM-B

* Larger modules can be mounted with reduced wind and snow load.

User supplies: Vertical pole - 4-inch steel pipe (4.5-inch OD)

Horizontal beam - 3-inch steel pipe (3.5-inch OD)

See table below to determine pipe requirements. See engineering memo for pier diameter & depth.

Depths range from 5 to 10 feet with diameters of 18-inches or 24-inches.

3-inch horizontal beam must be a minimum of 7-inches wider than 3-times the solar module width.

Pipe Requirements for Various Tilt Angle, Wind and Snow Load - UNI-PGRM/3P1

Angle	Wind Speed	0 psf	10 psf	20 psf	30 psf	50 psf	80 psf	100 psf
10°	105 MPH	A	A	A	A	C	C	D
	130 MPH	A	A	B	B	C	C	D
	150 MPH	C	C	C	C	C	C	D
20°	100 MPH	A	A	A	A	B	C	C
	110 MPH	A	A	A	B	C	C	C
	150 MPH	C	C	C	C	C	C	C
30°	100 MPH	A	A	A	A	B	C	C
	110 MPH	A	A	A	B	B	C	C
	150 MPH	C	C	C	C	C	C	C
40°	90 MPH	A	A	B	B	C	C	C
	110 MPH	C	C	C	C	C	C	C
	150 MPH	CC	CC	CC	CC	CC	CC	CC
50°	105 MPH	C	C	C	C	C	C	C
	110 MPH	CC	CC	CC	CC	CC	CC	CC
	150 MPH	FC	FC	FC	FC	FC	FC	FC
60°	100 MPH	C	C	C	C	C	C	C
	130 MPH	EC	EC	EC	EC	EC	EC	EC
	150 MPH	GC	GC	GC	GC	GC	GC	GC



SCAN ME

Scan the QR Code above to download manuals and engineering certifications from the Tamarack Solar website.

Note A requires 1 Schedule 40 Poles and a Schedule 40 Beam

Note B requires 1 Schedule 80 Poles and a Schedule 40 Beam

Note C requires 2 Schedule 40 Poles and a Schedule 40 Beam

Note CC requires 2 Schedule 40 Poles filled with concrete and a Schedule 40 Beam

Note D requires 2 Schedule 80 Poles and a Schedule 40 Beam

Note EC requires 2 Sch 40 Poles filled w/concrete with 1-foot bollard and a Sch 40 Beam

Note FC requires 2 Sch 40 Poles filled w/concrete with 2-foot bollards and a Sch 40 Beam

Note GC requires 2 Sch 40 Poles filled w/concrete with 3-foot bollards and a Sch 40 Beam

Blocks that are shaded gray require 2 vertical poles. Order an additional 70-0300-PGM-B