



Joining Westfield School

September 2026



Westfield School

Chorus Education Trust

Contents

Welcome.....	3
Key dates.....	4
Who’s who?	6
Who can help me?	7
School Map	8
Life at School.....	10
School Uniform and Equipment	12
Reading and numeracy.....	13
Attitude to learning (ATL).....	14
Enrichment activities	14
The Westfield Way.....	15

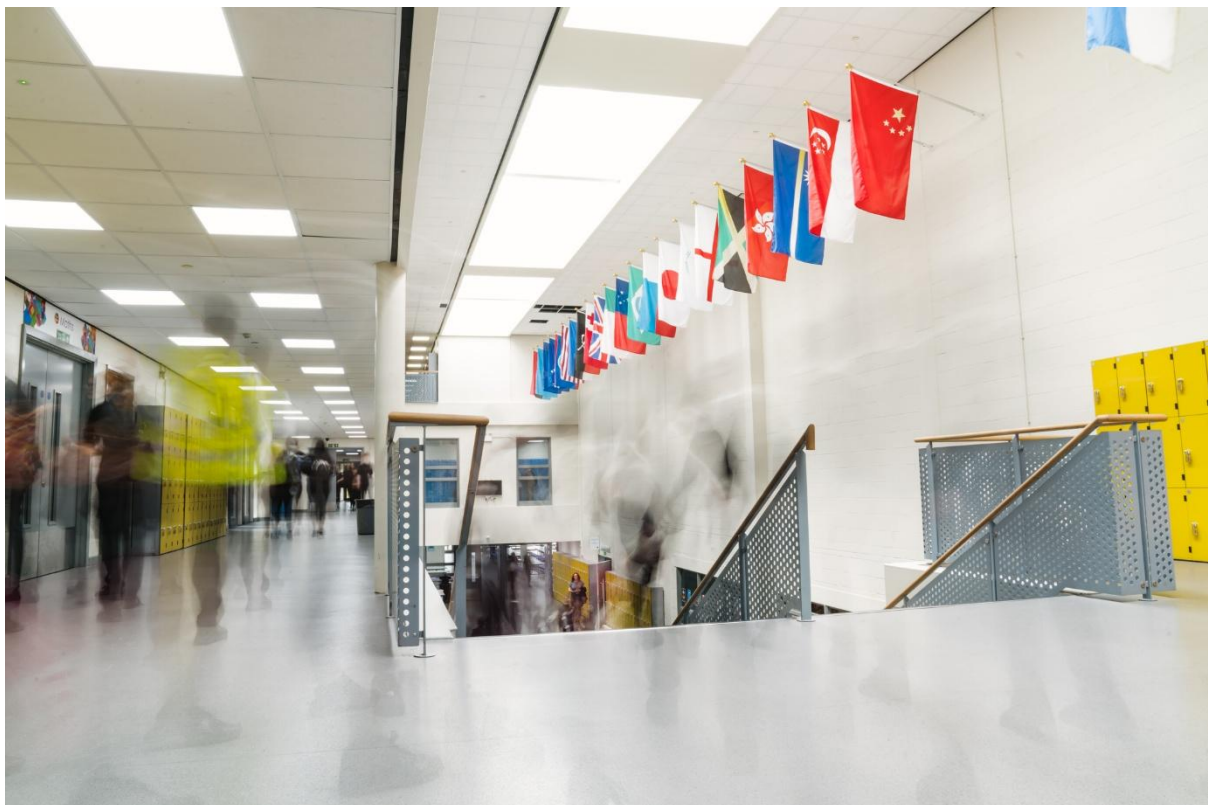

Welcome

Dear Student,

Welcome to Westfield School!

Whichever school you come from; we look forward to welcoming you into our community.

I know what a big milestone this is in your life and want to reassure you that we will do everything to make the transition as smooth as possible.

All the staff team are extremely ambitious for every student at Westfield. We want you to be the best that you can be, and we are committed to ensuring you realise your true potential. Our curriculum offers you a wide variety of subjects – whether your passion lies in the arts, science, technology, languages, sports, business, or humanities – I know you will find something you love.



Many of you will already have visited our amazing building to see the facilities and learn about the exciting, new opportunities for your teaching and learning experiences. You will be able to take advantage of our sports centre, swimming pool, music rooms, design and technology equipment and ICT facilities, to name but a few.

Moving to a new school is always going to feel a little bit daunting and at the same time exciting. We have high expectations of everyone who is part of our community, our key values of kindness, respect and resilience will be part of everything we do together to support your transition. We want you to belong to our school community and become part of the future.

I hope this booklet gives you a flavour of our school without overwhelming you with information. We look forward to being able to meet you later this year to continue your preparations to join Westfield School. In the meantime, please look at our website to find out more about the school before you join us: www.westfield.chorustrust.org

Mrs G Jones, Headteacher of Westfield School

Key dates

Over the next few months, we will invite you to meet us, find new friends and explore your new school at a series of events. You will be able to ask any questions that you may have and sample some of the activities that we offer our students.

There are lots of events and we encourage you to make the most of the opportunities to get to know us. These events are designed to ensure that you feel happy and confident about joining us in September.

www.westfield.chorustrust.org/transition

Welcome evening

You and your parents or carers will be invited to our welcome evening on:

Wednesday 1 July, at a time between 4pm and 7pm

This evening is carefully designed so that you can meet your new form and form tutor/s. You will spend time with your form, getting to know your classmates.

While you are doing this, your parents and carers will receive presentations from the Head of School and information from the Senior Team.



Primary school visits

The Year 7 transition team will visit you in your primary school to help you to get 'Westfield Ready'. They will also discuss your needs with your primary teachers, so we can be ready for your arrival at Westfield.

SEND induction events

If you have a special educational need or disability our Learning Support Team will work with you, your family and your primary school to help you get ready for your move to Westfield School.

Our Learning Support Team will communicate directly with your child's school to offer additional support.

Transition Days

Tuesday 7 July, 8.30am – 2.50pm and

Wednesday 8 July, 8.30am – 2.50pm

You will be invited to spend two days at Westfield, during which you will meet your classmates and some of your teachers. You will take part in activities designed to help you to settle into Westfield and find your way around your new school.

We ask that you:

- Bring a pen, pencil and ruler.
- Wear your primary school uniform.
- Wear footwear that is suitable for PE.
- Bring a packed lunch (if you are entitled to free school meals, you will receive your lunch in our restaurant)



Who's who?

Leadership Team

Mrs Jones

Headteacher of
Westfield School



Mr Dobrowolski

Assistant
Headteacher



Miss Charlton

Deputy Headteacher



Mrs Halliday

Assistant
Headteacher

Ms Hassall

Deputy
Headteacher



Mrs Jenkinson

Assistant
Headteacher



Mr Davies

Assistant
Headteacher

Mrs Newton

Business Manager



The Year 7 Team

Miss Blackburn

Head of Year 7



TBC

Year 7 Pastoral Manager

Find out more at www.westfield.chorustrust.org/ourteam

Who can help me?

Your Form Tutor

There are lots of people here to support you, including your form tutor.

You will meet your form tutor when you visit school. You will start most mornings with your form group. This is a chance for your form tutor to talk to your form about any important news, and to check how you are doing.

Other help

Mr Dobrowolski

Designated Safeguarding Lead



Mrs Hague

Inclusion and Safeguarding Officer



Mrs Swift

Learning Support Coordinator



Mrs Jenkinson

Acting Special Educational Needs and Disabilities Coordinator (SENDCo)



Mrs Johnson

Deputy SENDCo



School Map

Westfield School is arranged over three floors, but we call them 'decks'.

You will find most of your lessons on the upper deck and main deck. Each subject area has its own set of classrooms and each classroom has a number. Each deck has toilets and stairs so that you can reach the other decks.

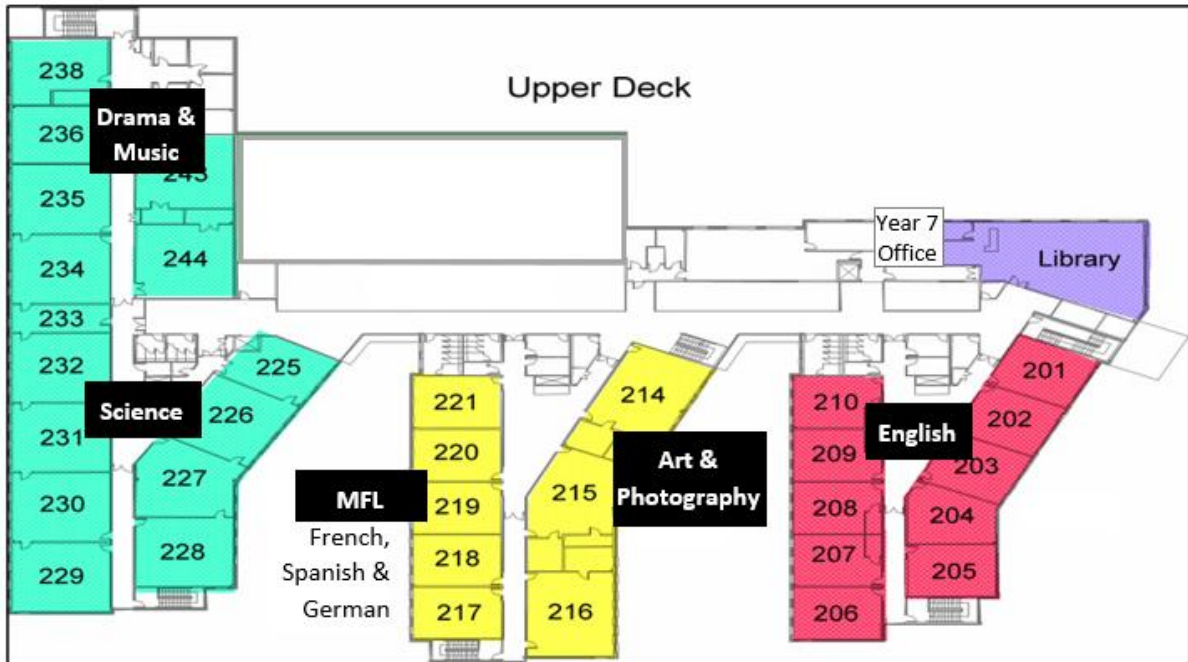

Upper deck

If a classroom number starts with a '2', that means they are on the upper deck (second floor). You'll also find our wonderful library and the Year 7 office (where Miss Blackburn and Miss Batty sit). on the upper deck.



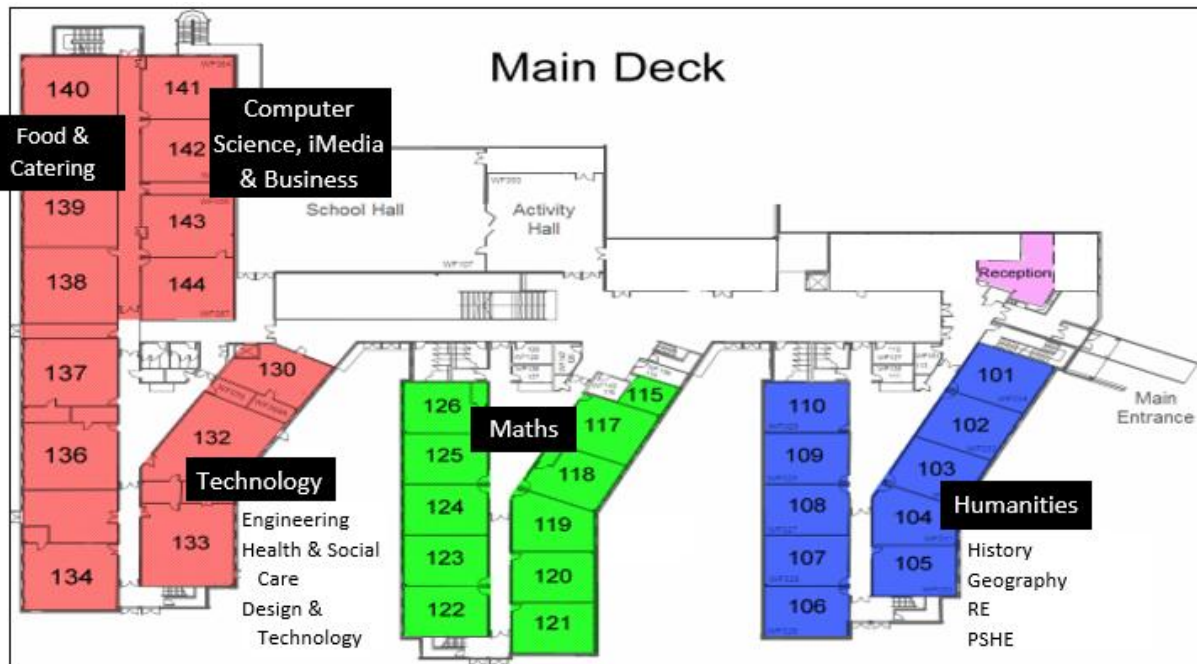

Main deck

If it starts with a '1' then it's on the main deck (first floor). You'll also find the school halls (where you will have assemblies) and student reception (where you can go if you need help).

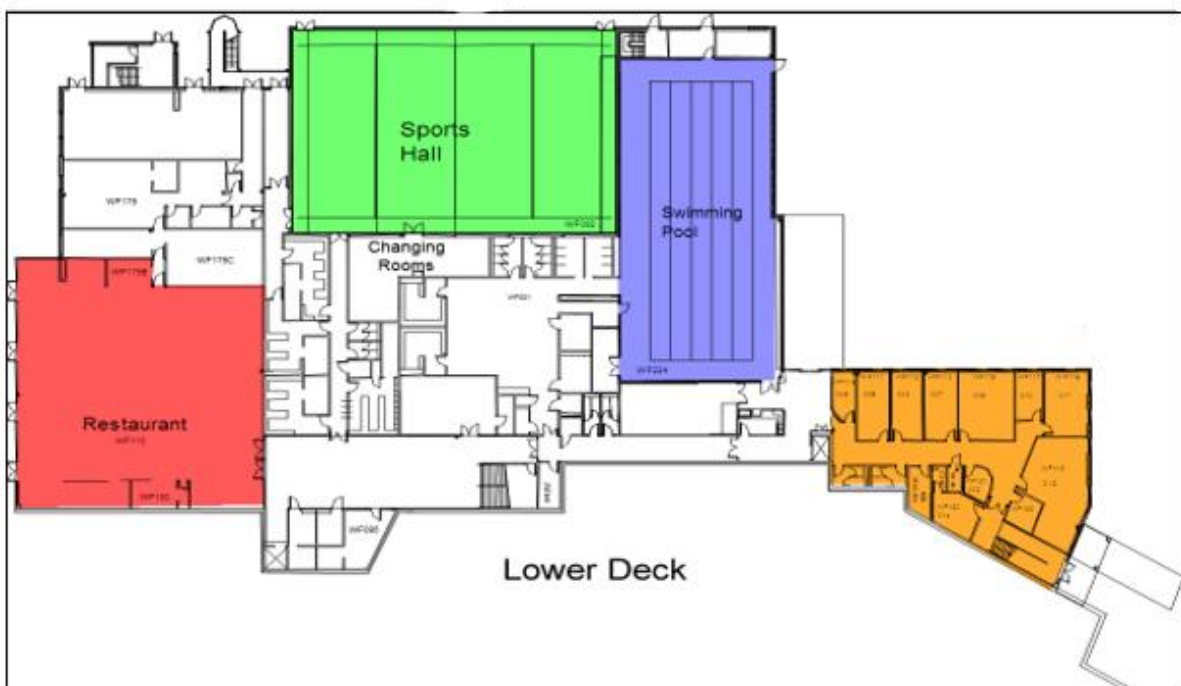

Lower deck

Our lower deck is where you will go for lunch in our restaurant. You will also have some of your PE lessons in the sports hall and swimming pool. Our learning support team have offices and classrooms on the lower deck.

Life at School

School day

The school day starts at 8.30am, and you are welcome to come into school from 8.10am so that you are ready for the start of the day. We start with registration, personal development time or assembly.

www.westfield.chorustrust.org/schoolday

Timings for year 7

- 8.10** School open for students
- 8.30** Personal Development Time
- 8.55** Period 1
- 9.55** Period 2
- 10.55** Break
- 11.15** Period 3
- 12.15** Lunch
- 13.00** Period 4
- 14.00** Period 5
- 15.00** End of school day or enrichment activities

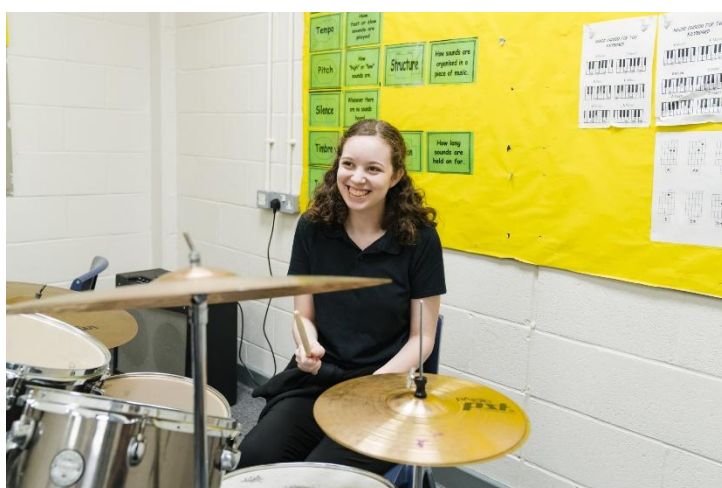

Lessons and subjects

There are five lessons each day, each one hour long, as well as a morning break and a lunch break. Each lesson will take place in a different room, with a different teacher. You can use the map to find your way around—or ask if you think you are lost.

You will study a wide range of subjects. Your teachers will teach

you in specially equipped classrooms. These include science laboratories, drama and dance studios, swimming pool, gym, design and technology rooms and indoor and outdoor PE facilities.

www.westfield.chorustrust.org/curriculum

Lunch

You will visit our restaurant to have lunch—we offer a fantastic choice of breakfasts, lunches, and snacks. You will pay for your lunch using your fingerprint or PIN code.

www.westfield.chorustrust.org/catering

Mellors FOOD HAPPY

KEY 1 OF YOUR 5 A DAY (5) MEAT-FREE (VEGETARIAN) (M) CHEF'S CHOICE (C) PLANT-BASED (VEGGI) (P)

Allergens and intolerances: All of our food is locally hand crafted and prepared on site daily. We have an allergen procedure in place. To please advise you of any allergies or intolerances prior to using the restaurant. Our kitchen also uses the multi-purpose production line.



School Uniform and Equipment

Uniform

We are very proud of our school uniform, which was inspired by ideas from our students.

www.westfield.chorustrust.org/uniform

- Black sweatshirt or black V-neck jumper with embroidered Westfield badge.
- Black or white polo shirt either with or without embroidered Westfield badge.
- Plain black tailored trousers or skirt or shorts.
- Plain black shoes



PE kit

You will always change into PE kit when you have a PE lesson. The kit that you need to have is given opposite. There is lots more information on the website, and also a handy checklist for you or your parents/carers to use.

- Westfield or plain black polo shirt/t-shirt.
- Black shorts, tracksuit bottoms or sports leggings.
- Westfield or plain black hoodie/sweatshirt (only to be used in PE lessons).
- Trainers.
- Swimming trunks or one-piece swimming costume.



Equipment

We want you to be ready to learn when you come to school, so you should bring with you every day:

- School bag, preferably a rucksack
- Student planner
- Pencil case
- Three black pens
- One purple pen
- Pencil
- Rubber
- Ruler
- Sharpener
- Highlighter pen
- Whiteboard pen
- Scientific calculator (can be purchased through school)
- Reusable water bottle

Reading and numeracy

Reading

At Westfield, we love to read! We will encourage you to read for pleasure, learn new knowledge, to be taken on wonderful journeys, and consider new ideas.

You will develop your reading and love of books in lessons and in reading lessons in our fantastic library.

www.westfield.chorustrust.org/reading

www.westfield.chorustrust.org/library

Numeracy

Numeracy is part of all subjects that you will study—not just maths. We will help you to develop your confidence and ability with numbers and measures so that you are able to go confidently to whatever is your next step after school.



Attitude to learning (ATL)

We want to make sure that students develop the skills and abilities necessary to be successful. We focus on ‘attitude to learning’ to help them achieve this.

Students receive an ATL grade from their teachers each term. These are shared with parents, and tutors will help students to use this information to develop an exceptional attitude to learning.

We will help you to be:



Find out more at <https://www.westfield.chorustrust.org/atl>

Enrichment activities

At Westfield, we aim to nurture your talents and interests.

A wide range of enrichment activities – and all students are welcome and encouraged to take part.

		ENRICHMENT CLUBS				
		MONDAY	TUESDAY	WEDNESDAY	THURSDAY	FRIDAY
BEFORE SCHOOL		Library 8.10-8.25am	Library 8.10-8.25am	Library 8.10-8.25am	Library 8.10-8.25am	Library 8.10-8.25am
LUNCH		SPARK Science Room 226	Code Club Room 141	KS3 Art Homework Club Room 214	Attenborough Club Room 232	Morris Dancing Room 108
		Library	Library	Library	Library	Library
		Duke of Edinburgh Room 216	Hair & Beauty Club Year 9 & 10 Room 229			
		Careers Club Drop in Y10 & Y11 Room 216				
AFTER SCHOOL		Rugby All years	Badminton Club All Years	Board Game Cafe / Chess Club Room 221	Crochet Club Room 118	Library
		Library	Library	Library	Library	
		Music Club All years - Room 235		Netball Y7/R/9/10	Boys Football Y7	<p>THIS HALF TERMS ENRICHMENT CLUBS</p>
		Girls Football All years with SUFC		Fitness Club All Years	Art and Clay Club Room 2.14 and 215	
		Debating & Critical Thinking Room 202		Boys Football Y9 / 10	Entrepreneur Club Room 216	
				Dungeons & Dragons Room 238	Sport Leaders Invitation Only	
			School Musical Rehearsal Room 243			

www.westfield.chorustrust.org/extracurricular

The Westfield Way

To ensure our school environment is one in which we are learning focused, calm, respectful and safe, we ask that students follow 'The Westfield Way'. This is our simple and manageable set of behaviour expectations that all students must follow, all day, every day.

Please read, understand and learn these expectations so that when you join us you are prepared to contribute positively to our wonderful school community. The Westfield Way will also support you, so that you are prepared and equipped to achieve incredible things and have successful futures and lives beyond Westfield.

The Westfield Way

Ready	Respectful	Safe
Ready 1 Be on time and fully equipped.	Respect 1 Polite and kind to all, never being discriminatory.	Safe 1 Calmly move around school with pace and purpose.
Ready 2 Calmly sit in seating plan, planner and equipment on the desk.	Respect 2 Meet expectations and follow reasonable requests first time, every time, everywhere.	Safe 2 Always keep hands and feet to ourselves.
Ready 3 Start work straight away and try hard all lesson.	Respect 3 Listen carefully to the person who is meant to be talking.	Safe 3 Phones and headphones are switched off and in our bags at all times.



Westfield School

Chorus Education Trust

We can't wait to meet you!

In the meantime, if you have any queries, our contact details are below.

Westfield School

Eckington Road, Sheffield S20 1HQ

Tel: +44 (0) 114 248 5221

Email: enquiries@westfield.chorustrust.org

Website: www.westfield.chorustrust.org