

Cabinetry Built To Scale

SPRING FOREST
C A B I N E T R Y



EDITION
2026

Welcome to

Spring Forest Cabinetry

We take pride in being a reliable partner for all your **kitchen and bath cabinetry needs**. As a premier wholesaler, we serve contractors, retailers, builders, and remodelers with exceptional products designed for performance, durability, and style. Based in Greensboro, NC, we understand your priorities and are dedicated to supporting your business as it grows and evolves.



Why Choose Us



First in the Industry. Proudly serving more than 50,000 clients who trust Spring Forest for quality, consistency, and long-term reliability in every project.



10M+ SQFT
We manufacture 600,000 Cabinets per month in Vietnam and Thailand



+23 Years of expertise
We were founded in 2002.



Over 8 Location
We have distributors centers in North America



Vision

To be the recognized leader in the cabinetry industry, known for delivering exceptional value, innovative designs, and unparalleled customer service, making Spring Forest Cabinetry the first choice for cabinetry needs throughout Greensboro and beyond.



Mission

To be the premier provider of high-quality, cost-effective kitchen and bath cabinetry solutions for contractors, stores, builders, and remodelers in the Greensboro area, empowering them to exceed customer expectations and achieve project success.



We are here
For You

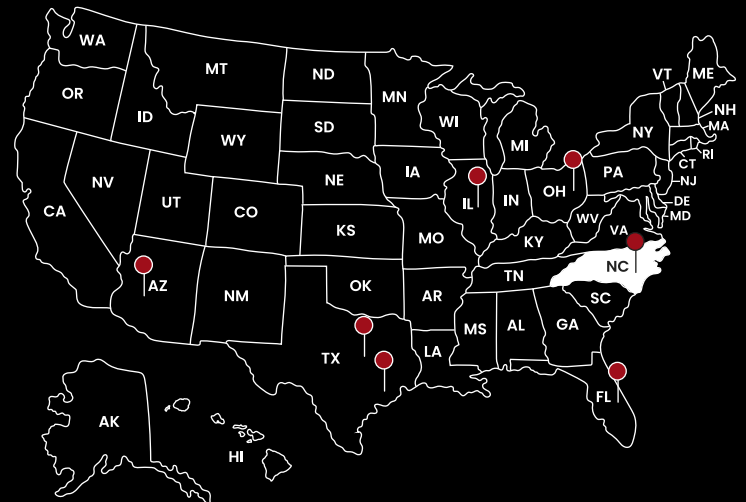

MEET OUR FRAMED CABINETS

Single Package Cabinets

Essential COLLECTION



SW - Shaker White

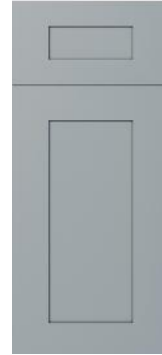

GR - Gray Shaker



SE - Shaker Espresso

Classic COLLECTION



AC - Aspen Charcoal



AW - Aspen White



CW - Charleston White

Slim Shaker COLLECTION



SDW - Slim Dove White



SWO - Slim White Oak

Charm COLLECTION



NB - Navy Blue

Cabinet Construction Premium Grade

- Essential
- Classic

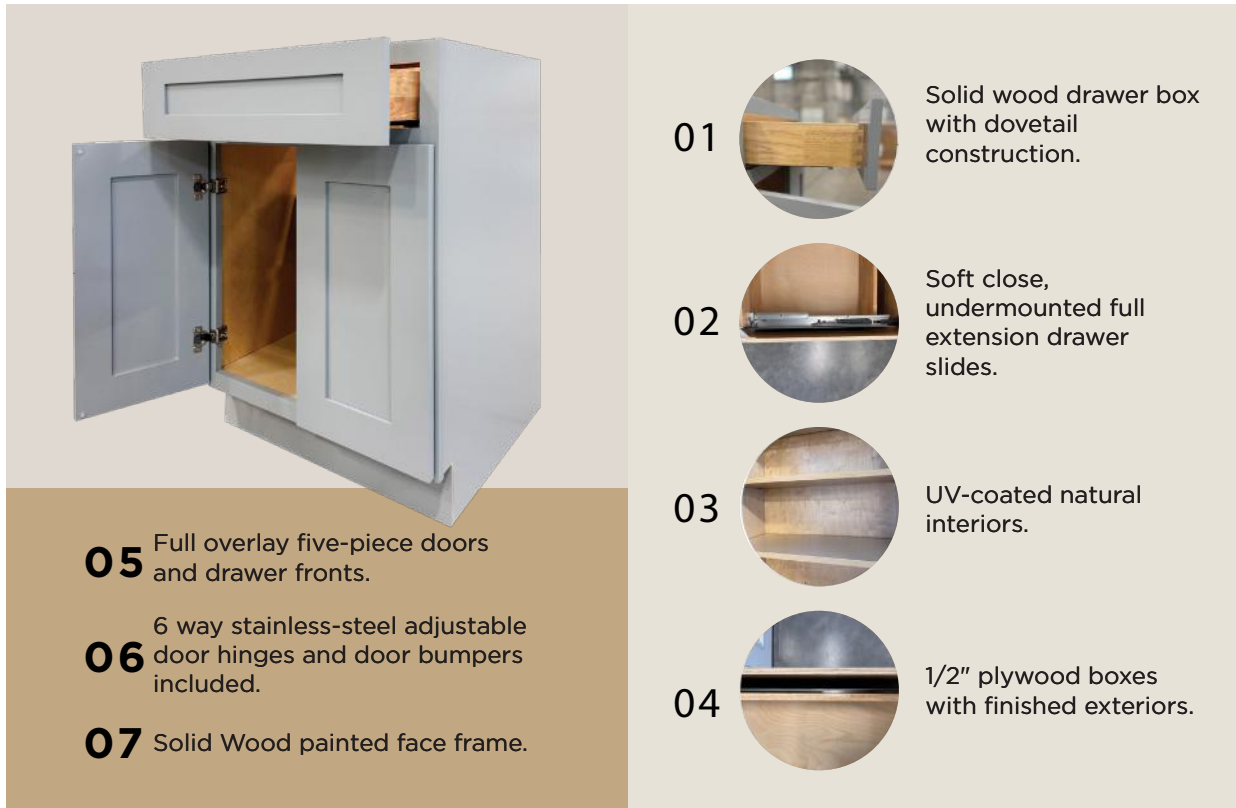

05 Full overlay five-piece doors and drawer fronts.

06 6 way stainless-steel adjustable door hinges and door bumpers included.

07 Solid Wood painted face frame.

01



Solid wood drawer box with dovetail construction.

02



Soft close, undermounted full extension drawer slides.

03



UV-coated natural interiors.

04

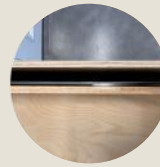

1/2" plywood boxes with finished exteriors.

A **Door & Drawer Front:** Full overlay, 5-pieces door & drawer, solid wood with MDF center panel.

B **Face Frame:** 3/4" solid wood frame

C **Cabinet Box:** 1/2" cabinet grade plywood box.

D **Drawer Box:** Solid wood, dovertail construction, 2 1/2 depth

E **Drawer Glides:** Concealed undermount full extension glides with soft-close feature.

F **Hinges:** 6-way adjustable with soft-close feature

G **Exterior Finish:** Matching color exterior.

H **Interior Finish:** Clear UV coated natural plywood.

I **Shelves:** 3/4" thick plywood with front edge banding.

J **Accessories:** Door bumper, metal shelf pin, metal clips, L bracket for base cabinet.

K **Package:** One box per cabinet.

L **Certification:** TSCA VI, KCMA, CARB2, NGBS Green.

MEET OUR FRAMED CABINETS

Two Package Cabinets

Charm COLLECTION



RW - Rustic Wood

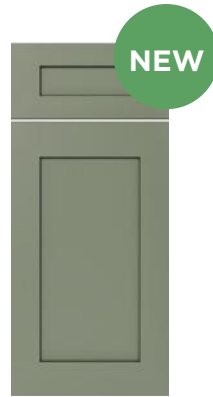

SB - Sage Breeze



LG - Lunar Gray



AG - Aston Green



SA - Smokey Gray



TC - Treasure Chest



IB - Iron Black

Slim Shaker COLLECTION



SAO
Slim Amber Oak



SIB
Slim Iron Black



SAG
Slim Aston Green

Double Shaker COLLECTION



DDW
Double Dove White







DSG
Double Smokey Gray

Cabinet Construction Universal Box

- Charm
- Double Shaker
- Slim Shaker



- 05** Shelf 3/4" thick plywood with front edge banding.
- 06** Full overlay, 5-pieces door & drawer, solid wood with MDF center panel.
- 07** 6-way adjustable with soft-close feature
- 08** 3/4" solid wood frame.

- 01**  Solid wood, dovetail construction, 3 1/8" depth.
- 02**  Concealed undermount full extensions glides with soft-close feature.
- 03**  Interior and Exterior: Clear UV coated natural plywood.
- 04**  1/2" cabinet grade plywood box.

A **Door & Drawer Front:** Full overlay, 5-pieces door & drawer, solid wood with MDF center panel.

B **Face Frame:** 3/4" solid wood frame

C **Cabinet Box:** 1/2" cabinet grade plywood box.

D **Drawer Box:** Solid wood, dovertail construction, 3 1/8 depth

E **Drawer Glides:** Concealed undermount full extension glides with soft-close feature.

F **Hinges:** 6-way adjustable with soft-close feature

G **Exterior Finish:** Clear UV coated natural plywood.
Need to add BSV, WSV, USV for the expose part.

H **Interior Finish:** Clear UV coated natural plywood.

I **Shelves:** 3/4" thick plywood with front edge banding.

J **Accessories:** Door bumper, metal shelf pin, metal clips, L bracket for base cabinet.

K **Package:** 2 packages, universal box & front set.

L **Certification:** TSCA VI, KCMA, CARB2, NGBS Green.

SKU Selection

FRAMED

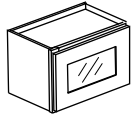

W1212GD
W1512GD
W1812GD
W2112GD

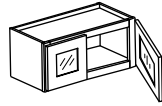

W2412GD
W2712GD
W3012GD
W3312GD
W3612GD
W3018GD

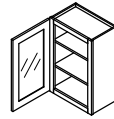

W1530GD
W1830GD
W1536GD
W1836GD
W1542GD
W1842GD

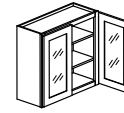

W2430GD
W3030GD
W2436GD
W3036GD
W2442GD
W3042GD

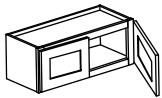

W3012 W3318
W3312 W3618
W3612 W301224
W3015 W301524
W3315 W301824
W3615 W331224
W2418 W331524
W3018 W331824

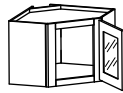

DCW2412GD
DCW2430GD
DCW2436GD
DCW2442GD
DCW2712GD

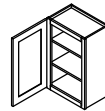

W0930 W1836
W1230 W2136
W1530 W0942
W1830 W1242
W2130 W1542
W0936 W1842
W1236 W2142
W1536

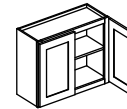

W3024 W2436 W3642
W3324 W2736 W302424
W3624 W3036 W332424
W2430 W3336 W361224
W2730 W3636 W361524
W3030 W2442 W361824
W3330 W2742 W362424
W3630 W3042
W3930 W3342

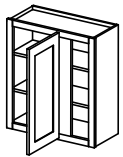

WBC2430
WBC2730
WBC3630
WBC2736
WBC2442
WBC2742
WBC3642

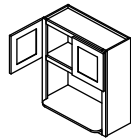

MO3030
MO3036
MO3042



DCW2430
DCW2436
DCW2442
DCW2736
DCW2742

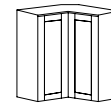

WER2430
WER2436
WER2442

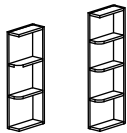

OE630
OE636
OE642

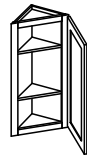

AW1230
AW1236
AW1242



WD1848
WD1854
WD1860



PR3015



WRC3015
WRC3018
WRC2430

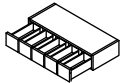

WSD630

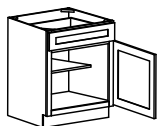

B12
B15
B18
B21

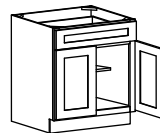

B24
B27



B30
B33
B36
B42

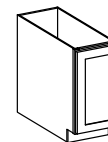

BFH12
BFH15
BFH18
BFH21

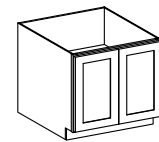

BFH24
BFH27
BFH30
BFH33
BFH36



2DB24
2DB30
2DB36

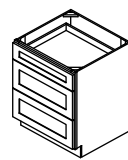

3DB12
3DB15
3DB18
3DB21
3DB24
3DB27
3DB30
3DB33
3DB36

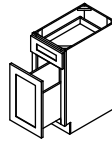

DFB18
(29 1/2" H)
BWB18

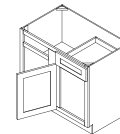

BBC36
BBC39
BBC42

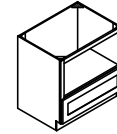

MB30
MB33

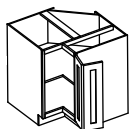

ERB33
ERB36

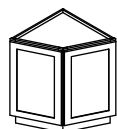

BEC24

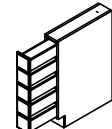

BSDC6

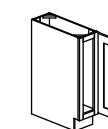

BT09

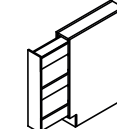

SPB6
SPB9



WOOD TRAY CHROME TRAY
33" OR 36"



CSB36

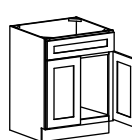

SB27

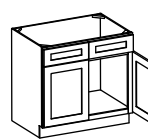

SB30
SB33
SB36

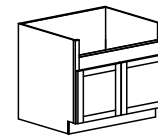

FSB36

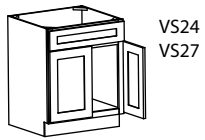

VS24
VS27

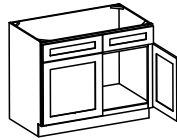

VS30
VS33
VS36

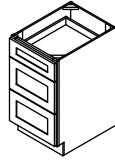

3VDB12
3VDB15
3VDB18
3VDB21
3VDB24

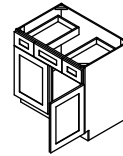

VSD36
VSD42
VSD48

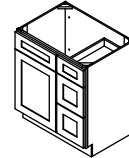

V3021DL
V3021DR
V3321DL
V3321DR
V3621DL
V3621DR

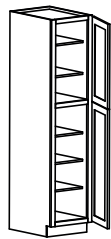

U188424
U189024
U189624

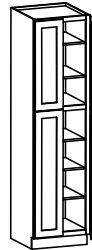

U248624
U249024
U249624
U308424
U309024
U309624

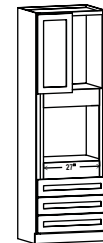

O308424
O309024
O309624
O338424
O339024
O339624

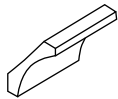

COV

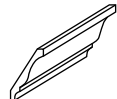

BCM8 (DCM)

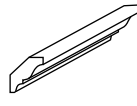

CM8

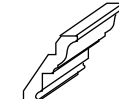

RCM45 (LCM)

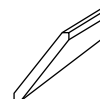

ACM8



ALRM8



LRM8



FBM

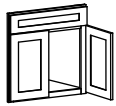

DCSF42



BES12

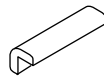

OCM8

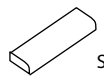

SM8

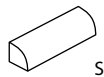

SHM



BAM



TKC

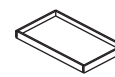

RS18
RS21
RS24
RS27
RS30
RS33
RS36



F342
F396
F642
F696



SBF4242

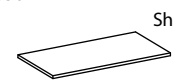

Shelf Interior W and B

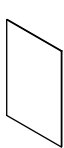

BSV - (23 1/4" x 34 1/2" x 1/4")
USV2496 - (23 1/4" x 96" x 1/4")
FPV4296 - (42" x 96" x 1/4")
S2496 - (24" x 96" x 3/4")
WSV24 - (15" x 24" x 1/4")
WSV30 - (15" x 30" x 1/4")
WSV36 - (15" x 36" x 1/4")
WSV42 - (15" x 42" x 1/4")
Skin Panel - Interior - (48" x 48" x 1/4")



BSV - (23 1/4" x 34 1/2" x 1/4")
USV2496 - (23 1/4" x 96" x 1/4")

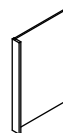

DWR3 - (24" x 34 1/2" x 3/4")
REPV2496 - (24" x 96" x 1/2")
REPV2796 - (27" x 96" x 1/2")



SD - (11" x 15" x 3/4")
WDEP30 - (11 1/2" x 29" x 3/4")
WDEP36 - (11 1/2" x 35" x 3/4")
WDEP42 - (11 1/2" x 41" x 3/4")
BDEP - (23 1/2" x 29" x 3/4")
VDEP - (20 1/2" x 29" x 3/4")



Sample Door - Display

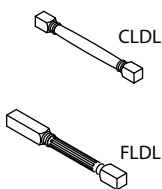

CLDL

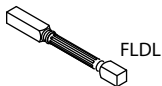

FLDL



TDEP2484
TDEP2490
TDEP2496

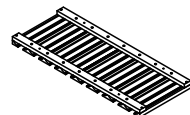

SGH30

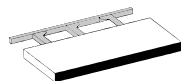

FS24
FS30
FS36

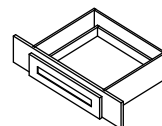

VA30
VA36
VA42
VA48

VKD36



CBT



CB9



Trash Bin

MEET OUR FRAMELESS CABINETS

Two Package Cabinets

Frameless COLLECTION

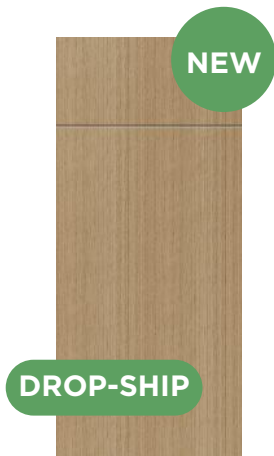

OB - Oak Blonde



OS - Oak Shade

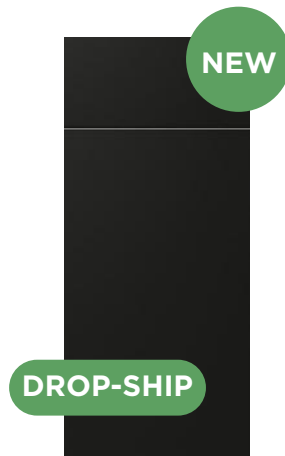

MB - Matte Black

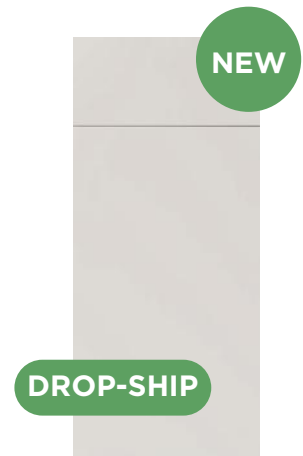

MI - Matte Ivory



**CG
Crystal Glass**



**MG
Midnight Glass**

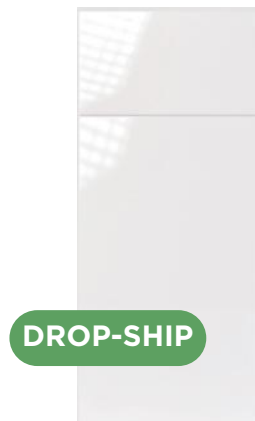

**HW
High Glossy White**







**HG
High Glossy Gray**

Cabinet Construction

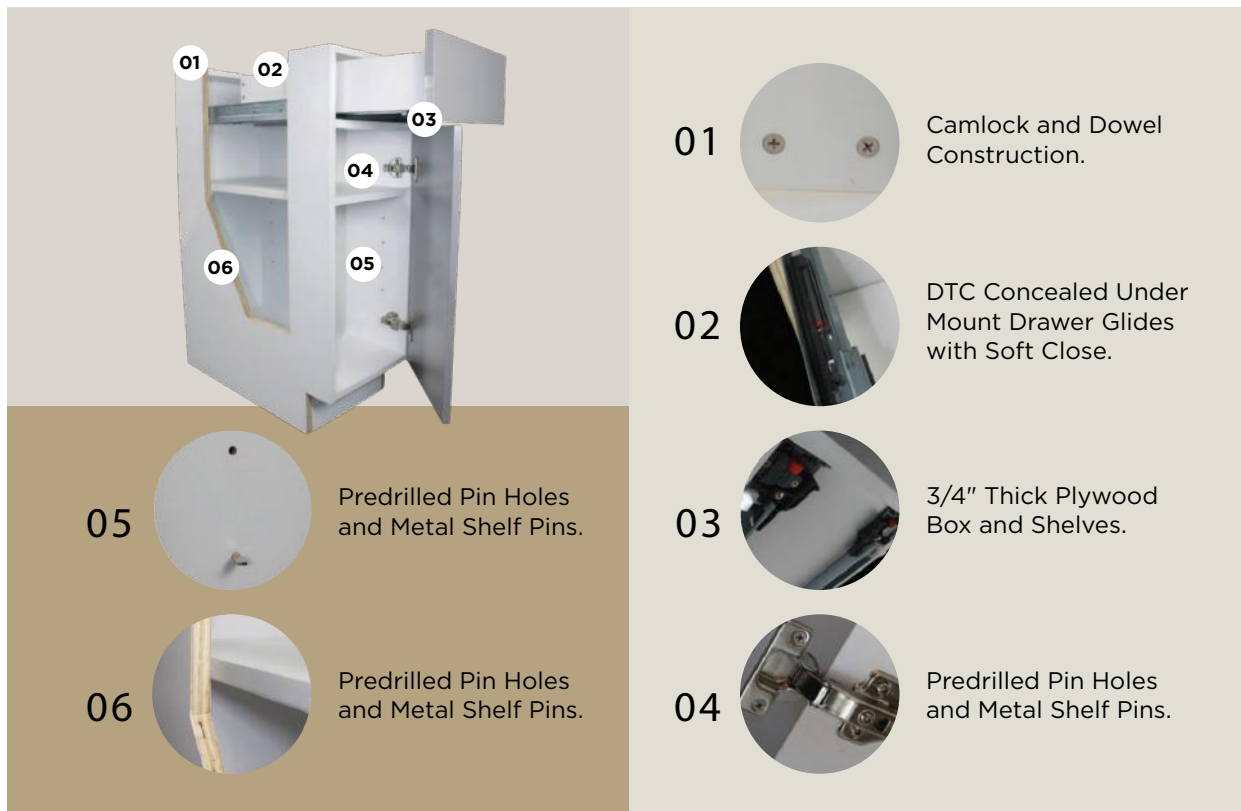
Frameless Box

EDITION
2026

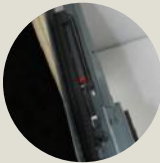
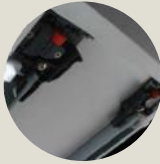

- 01  Camlock and Dowel Construction.
- 02  DTC Concealed Under Mount Drawer Glides with Soft Close.
- 03  3/4" Thick Plywood Box and Shelves.
- 04  Predrilled Pin Holes and Metal Shelf Pins.

- 05  Predrilled Pin Holes and Metal Shelf Pins.
- 06  Predrilled Pin Holes and Metal Shelf Pins.

A **Door & Drawer Front:** Front Full overlay PET high glossy slab door style.

B **Face Frame:** No frame, frameless style.

C **Cabinet Box:** 3/4" thick plywood box with white melamine finish.

D **Drawer Box:** 3/4" thick plywood box with white melamine finish.

E **Drawer Glides:** Concealed undermount full extension glides with soft-close feature.

F **Hinges:** 6-way adjustable with soft-close feature

G **Exterior Finish:** White melamine.

H **Interior Finish:** White melamine.

I **Shelves:** 3/4" plywood with white melamine finish and front edge banding.

J **Accessories:** Door Bumper, metal shelf pin.

K **Package:** 2 packages, universal box and front set.

L **Certification:** TSCA VI, KCMA, CARB2, NGBS Green.

SKU Selection

FRAMELESS

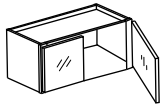

W3012GD
W3312GD
W3612GD
W3015GD
W3315GD
W3615GD
W3018GD
W3318GD
W3618GD

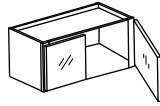

W3021GD
W3321GD
W3024GD
W3324GD
W3624GD
W3027GD
W3327GD

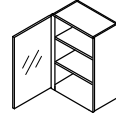

W0930GD
W1230GD
W1530GD
W1830GD
W2130GD

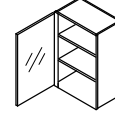

W0936GD
W1236GD
W1536GD
W1836GD
W2136GD

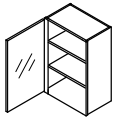

W0942GD
W1242GD
W1542GD
W1842GD
W2142GD

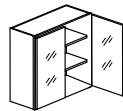

W2730GD
W2736GD
W2742GD
W3330GD
W3336GD
W3342GD

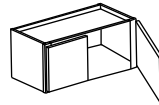

W301224
W331224
W361224
W301824
W331824
W361824
W302424
W332424
W362424

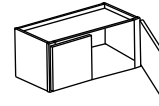

W3012
W3312
W3612
W3015
W3315
W3615
W3018
W3318
W3618

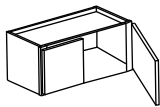

W3024
W3324
W3624

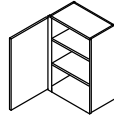

W0930
W1230
W1530
W1830
W2130
W0936
W1236
W1536
W1836
W2136

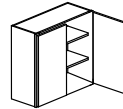

W2430
W2730
W3030
W3330
W3630
W2436
W2736
W3036
W3336
W3636

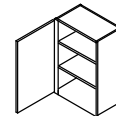

W0942
W1242
W1542
W1842
W2142

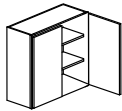

W2442
W2742
W3042
W3342
W3642

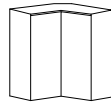

WER2430
WER2436
WER2442

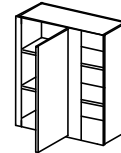

WBC2730
WBC3630
WBC2736

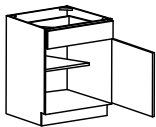

B12
B15
B18
B21

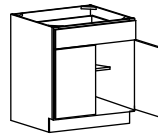

B24
B27



B30
B33
B36
B42

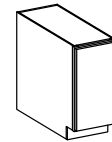

BFH09
BFH18

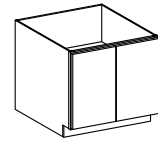

BFH24
BFH30
BFH36



2DB24
2DB30
2DB36

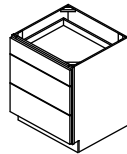

3DB12
3DB15
3DB18
3DB21
3DB24
3DB27
3DB30
3DB33
3DB36

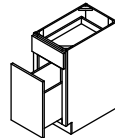

BWB18

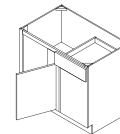

BBC36
BBC39
BBC42
BBC45

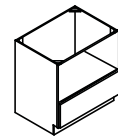

MB30

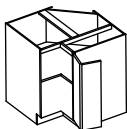

ERB33
ERB36



CHROME TRAY
33" OR 36"

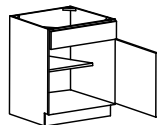

SB27

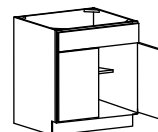

SB30
SB33
SB36
SB42

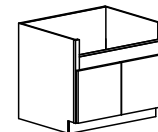

FSB36

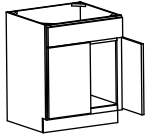

VS24
VS27

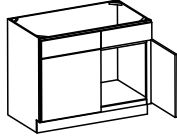

VS30
VS36

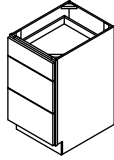

3VDB12
3VDB15
3VDB18

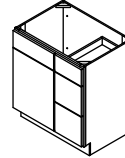

V30TDL
V30TDR
V36TDL
V36TDR

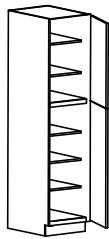

U188424
U189024
U189624

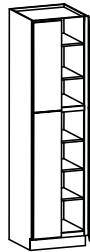

U248624
U249024
U249624
U308424
U309024
U309624

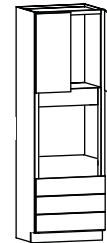

O308424
O309024
O309624
O338424
O339024
O339624

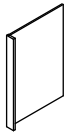

DWR3 - (24" x 34 1/2" x 3/4")
REPV2496 - (24" x 96" x 3/4")
REPV2796 - (27" x 96" x 3/4")

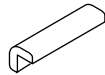

OCM8



SM8



SHM



TKC



F342
F396
F642
F696

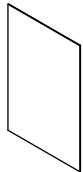

FPL2496 - (24 3/8" x 96" x 3/4")
FPL3796 - (37 3/8" x 96" x 3/4")

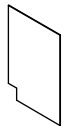

BSPR - (23 3/4" x 34 1/2" x 3/4")
BSPL - (23 3/4" x 34 1/2" x 3/4")
VSPR - (21" x 34 1/2" x 3/4")
VSPL - (21" x 34 1/2" x 3/4")



WDEP30 - (12 3/4" x 30" x 3/4")
WDEP36 - (12 3/4" x 36" x 3/4")
WDEP42 - (12 3/4" x 42" x 3/4")

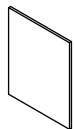

BDEP - (24 1/2" x 34 1/2" x 3/4")

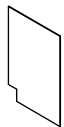

USPR - (23 3/4" x 96" x 3/4")
USPL - (23 3/4" x 96" x 3/4")



WSP30 - (11 7/8" x 30" x 3/4")
WSP36R - (11 7/8" x 36" x 3/4")
WSP36L - (11 7/8" x 36" x 3/4")
WSP42R - (11 7/8" x 42" x 3/4")
WSP42L - (11 7/8" x 42" x 3/4")

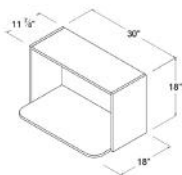

MOS3018 - (30" x 18" x 11 7/8")

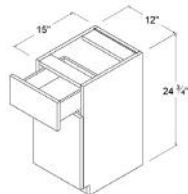

Mini Base - (12" x 24 3/4" x 15")



Sample Door - (11" x 15" x 3/4")

Builder Grade

COLLECTION



Model Name:
FW - Floral White

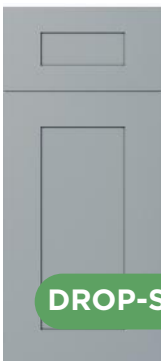

DROP-SHIP

Model Name:
FG - Floral Gray



Model Name:
FE - Floral Espresso

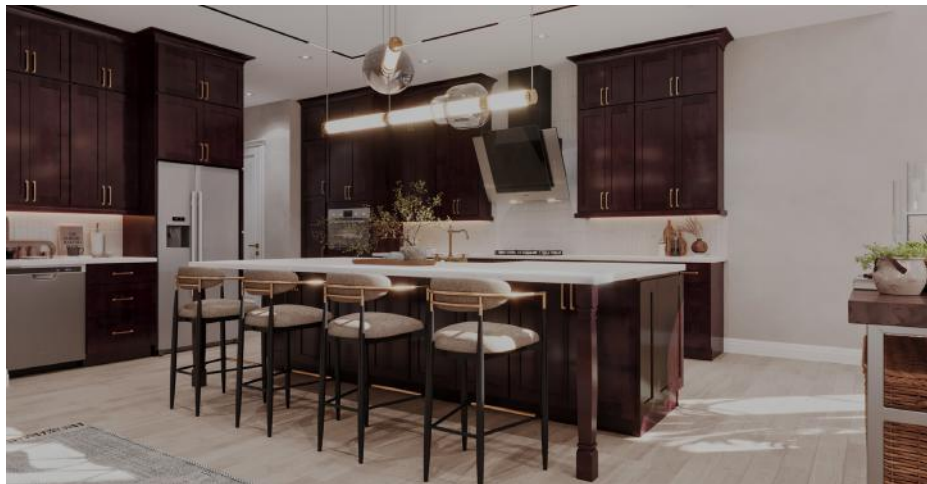

Cabinet Construction Builder Grade



05 Full overlay five-piece doors and drawer fronts.

06 6 way stainless-steel adjustable door hinges and door bumpers included.

07 Solid Wood painted face frame.

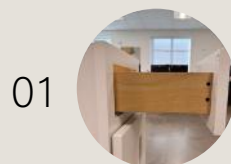

1/2" plywood drawer box construction.

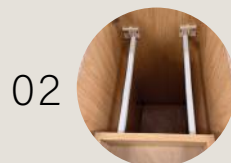

Undermount builder grade standard glides.



1/2" cabinet grade furniture board box with melamine natural interior.



Full dado joints with L bracket for strength.

A Door & Drawer Front: Full overlay, 5-pieces door & drawer, solid wood with MDF center panel.

B Face Frame: 3/4" solid wood frame

C Cabinet Box: 1/2" cabinet grade furniture board box.

D Drawer Box: Plywood, rebate joint drawer box.

E Drawer Glides: Builder grade undermount drawer glides.

F Hinges: 6-way adjustable, non soft-close feature

G Exterior Finish: Matching color exterior.

H Interior Finish: Melamine natural interior.

I Shelves: 5/8" furniture board with natural melamine, edge banding on all sides.

J Accessories: Door bumper, metal shelf pin, metal clips, L bracket for base cabinet.

K Package: One box per cabinet.

L Certification: TSCA VI, KCMA, CARB2, NGBS Green.

Kitchen Design

SHOWCASE



RW-Rustic Wood



SB - Sage Breeze



SB - Sage Breeze & LG - Lunar Gray



OB - Oak Blonde & OS - Oak Shade

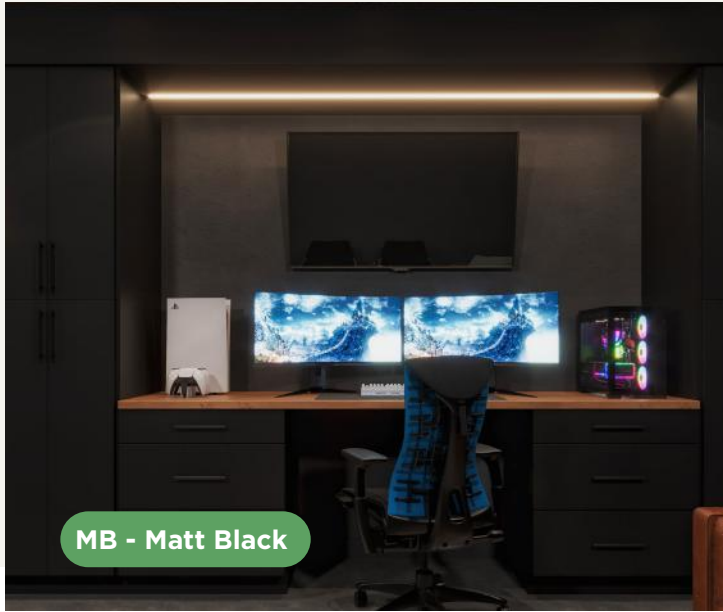

MB - Matt Black

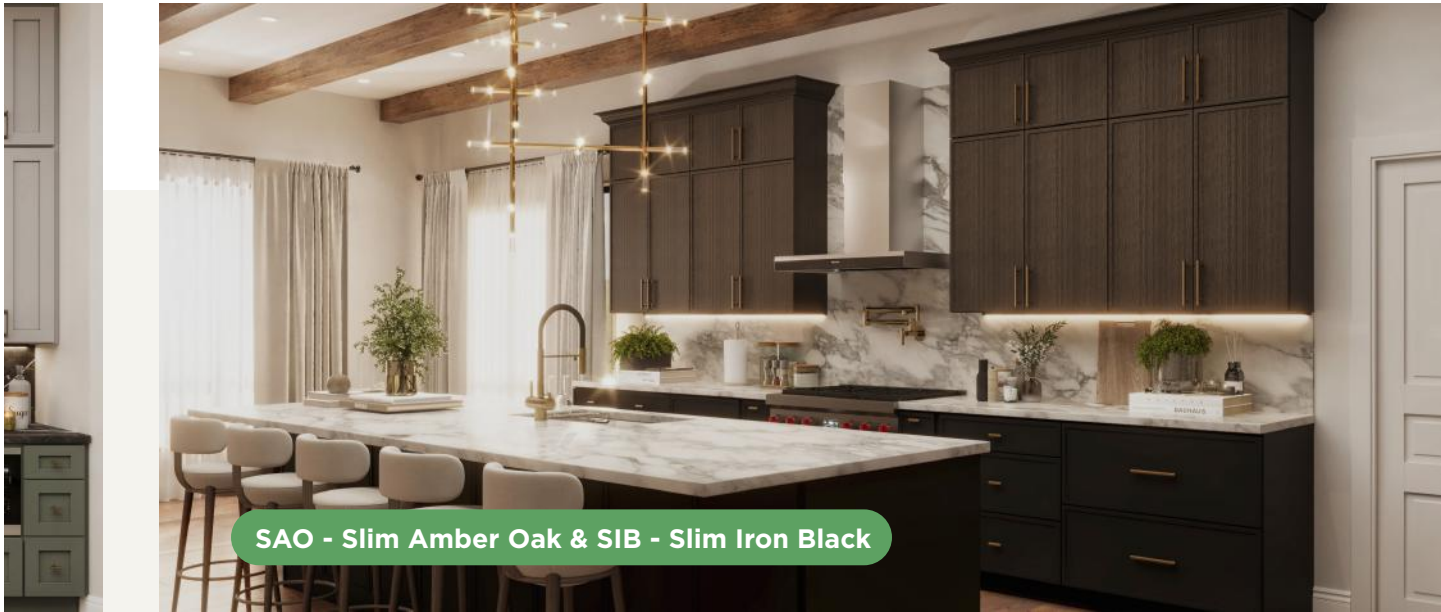

SAO - Slim Amber Oak & SIB - Slim Iron Black



Factory Direct Orders

Our factory specializes in providing fully customized cabinetry solutions designed to meet the unique needs of your project.

Our professional team is ready to review your specifications and guide you through our special-order options.

Choose from thousands of door styles and finishes—paint, stain, thermofoil, melamine, and more. We also offer custom designs upon request to bring your vision to life.

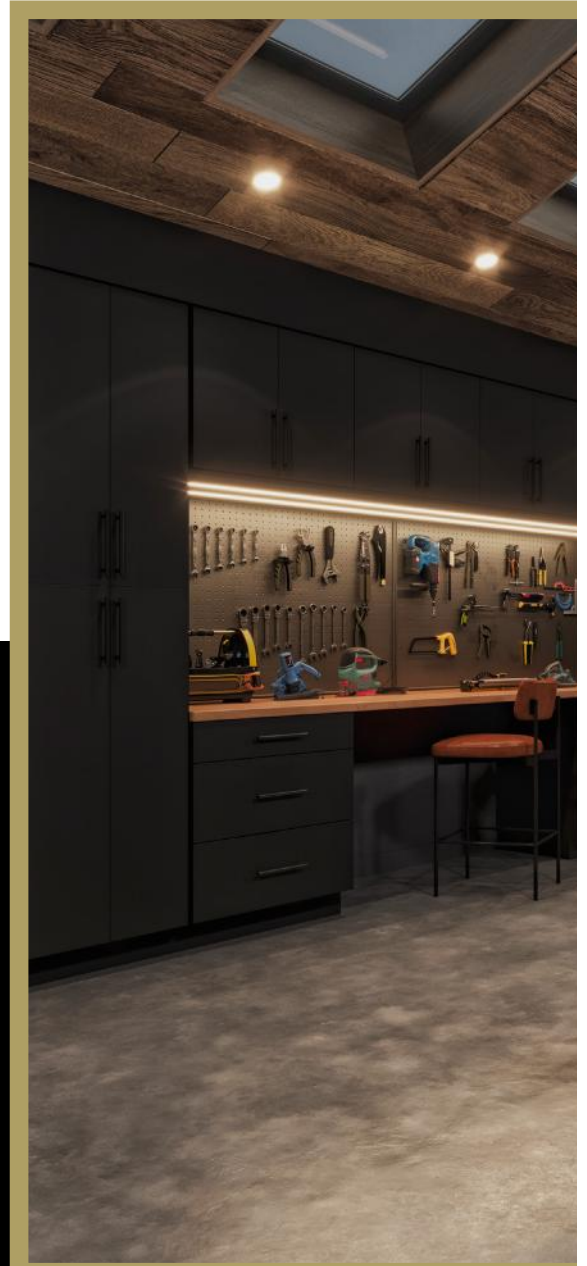

EDITION

2026



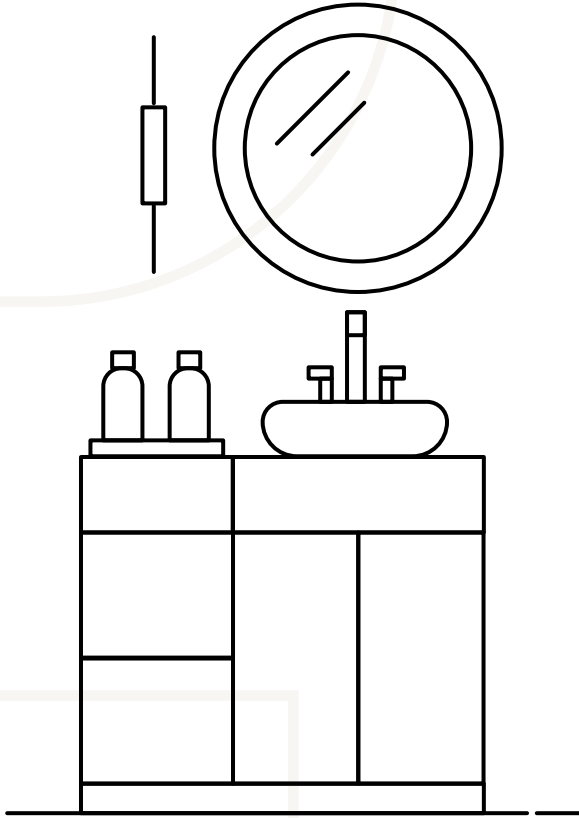

New Accounts
Application Form



See Our Products



Visit Our Website
www.springforestcabinetry.com

Contact Info



888-666-2608



4755 Mc Connell Center Drive, Suite B
Greensboro NC 27406



info@springforestcabinetry.com