



**spenard builders supply** ▀

# **COMMERCIAL DOORS & HARDWARE**

[WWW.SBSALASKA.COM](http://WWW.SBSALASKA.COM)



# COMMERCIAL MILLWORK



Most everyone knows that SBS Millwork stocks high quality residential products and offers in-house millwork services and custom machining, but we may be one of Anchorage's best kept secrets for commercial projects. SBS commercial millwork strives to supply you with the products you need, on time and at a competitive price. From the start to the finish of your project we are here to help with an in-house fully staffed commercial door and hardware department.

SBS Millwork stocks a wide variety of commercial products and services committed to the best customer service and quality. We can generate proprietary professional door and hardware schedules to help get your job started, or for fully detailed projects provide professional quotes, submittals and shipping logistics services for state wide delivery.

With the knowledge that doors and hardware that look good make an impact on any project, SBS represents the top manufacturers in the industry including, Curries hollow metal doors and frames, Timely Frames, Stanley/Best locks and hardware, Pemko sills and gaskets, Rockwood Hardware, Corrim FRP doors and frames, Lynden and Graham architectural doors, Schlage Locks, Von-Duprin Exits, McKinney Hinge and many more.

## FEATURED PROJECTS

### Fire Station 6 on Debar

SR Bales Construction

### Eagle River Dental

G2 Construction

### Eagle River Senior Housing

Neeser Construction







### Strip Mall

F&W Construction



# COMMERCIAL MILLWORK

## Table of Contents

	Prefinished Wood Doors. . . . .	2
	Prefinished Frames. . . . .	3
	Doors. . . . .	4
	C & M Frame.. . . .	5- 6
	Omni Door System. . . . .	7
	Hinges. . . . .	8
	Best Cores & Keys. . . . .	9
	45H Mortise Lock. . . . .	10
	Levers & Deadbolts. . . . .	11- 13
	Exit Devices & Mullions . . . . .	14-17
	Padlocks & Closer . . . . .	18- 20
	Commercial Thresholds. . . . .	21- 22
	HD Gaskets, Astragal. . . . .	23
	Door Bottoms/Sweeps. . . . .	24
	Brush Gasketing & Sill Nosing. . . . .	25
	Adhesive Gasketing. . . . .	25
	Surface Bolt. . . . .	26
	Lever Extension Bolt. . . . .	26
	Kickplate/ Latch Protector... . . . .	27
	Pull Plate/ Push Plate . . . . .	28
	Hes Electric Strikes . . . . .	28
	Wall Stop. . . . .	29
	Door Sliencer. . . . .	29
	Lite Kit. . . . .	30
	Info & Resources. . . . .	31- 36

## WOOD VENEER, HARD-BOARD & PREFINISHED PARTICLEBOARD CORE

### APPLICATIONS & BENEFITS

Recommended for a wide range of residential and light commercial applications. The particle board core offers good stability against warpage and reduces telegraphing. Available as either nonrated or 20 minute fire-rated in a wide variety of Veneered, Hardboard, and Prefinished faces.

(20 minute-rated)

Single doors

Maximum size door/transom

Paired doors: Dependent on hardware used, up to

Note: GP Firestop II meeting edges may be used for 20 minute pairs in lieu of metal edges.

### DOOR THICKNESS

1<sup>3</sup>/<sub>4</sub>" standard.

### STILES

1<sup>3</sup>/<sub>4</sub>" doors: Minimum 1<sup>1</sup>/<sub>4</sub>" (before trim) clear or fingerjointed stiles.

### RAILS

1<sup>3</sup>/<sub>4</sub>" doors: Minimum 2<sup>5</sup>/<sub>8</sub>" (before trim) mill option wood rails.

### LOOSE LAY CORE AND FRAME ASSEMBLY

Particle board core with an average density of 28 to 34 lbs.

### FACES

Pregraded: Hardboard or Premium 2-, 3-, or 4-ply veneered skins (minimum 1/60" veneer before sanding). Veneers available in a wide variety of species and cuts.

### ADHESIVES

Core and frame assembly and veneer application all with Type II water-resistant adhesives. Type I waterproof adhesive available upon request.

### BLOCKING

Special inner blocking options may be specified for hardware reinforcement.

### FACTORY MACHINING/DETAILING

Complete range of machining capabilities and detailing available. Rated doors must be in accordance with Warnock Hersey International, Inc. and National Fire Protection Association Standards (NFPA 80, latest edition). Lynden Door, Inc. recommends factory prefitting on all fire doors.

### LIGHT OPENINGS

Cutout area may not exceed 40% of the face or half of the door height to comply with the warranty. For 20 minute-rated doors, the total visible area of single or multiple lights may not exceed 1,296 sq. in. per leaf, with a maximum width of 36", or a maximum height of 54". All cutouts must be 6" from the edge of the door or any other cutouts and/or hardware preps. Louvres are not allowed in 20 minute doors.

### WARRANTY

One year for interior use only. See warranty terms and conditions. Use of Lynden Door, Inc. interior doors in exterior applications is neither recommended nor warranted.

Clear Finished SKU's	
PFEB2668	2668 CLEAR FINISHED BIRCH
PFEB2868	2868 CLEAR FINISHED BIRCH
PFEB3068	3068 CLEAR FINISHED BIRCH
PFEB3070	3070 CLEAR FINISHED BIRCH
DEO2668SBS	2668 CLEAR FINISHED OAK
DEO2868SBS	2868 CLEAR FINISHED OAK
DEO3068SBS	3068 CLEAR FINISHED OAK
DWC3070SRO	3070 CLEAR FINISHED OAK
DWC306890NB	3068 90MIN RNB BIRCH DOOR
DWC306890RO	3068 90MIN PS REDOAK DOOR
DWC307090NB	3070 90MIN RNB BIRCH DOOR
DWC307090RO	3070 90MIN PS REDOAK DOOR

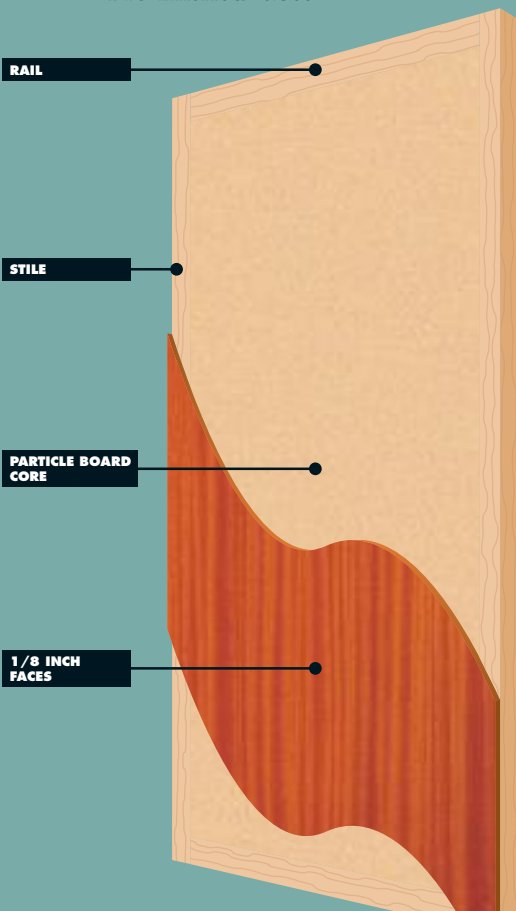

## ADJUSTABLE FRAME (A-Series)

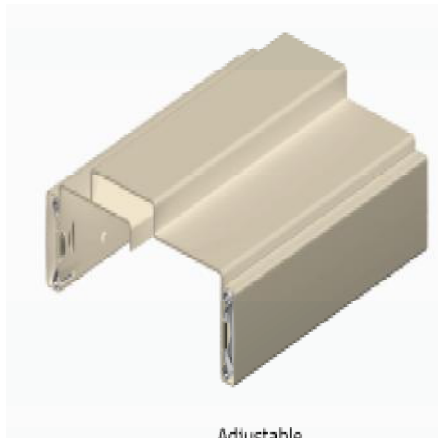

The galvanized prefinished steel **A-Series** Adjustable Frame is the perfect companion for the **Standard Frame**. Use **A-Series** Adjustable Frames to prevent jobsite problems resulting from walls of varying wall thickness or non-standard Jamb depth. **A-Series** Adjustable Frames are also the solution where pre-hung assemblies are required. Our **A-Series** Adjustable Frames are made using 18 gauge galvanized Powder Coated steel. 90 minutes are available for non-glazed openings, and up to 45 minutes for glazed openings. Mullions are not available for **A-Series** Adjustable Frames.

Our **A-Series** Adjustable Frames will accommodate a 1 3/4" door weighing up to 250 lbs.

### ADJUSTABLE FRAME (A-Series) | Casing Included

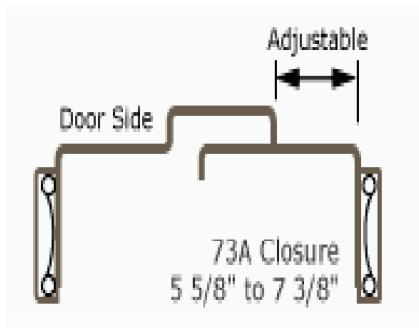
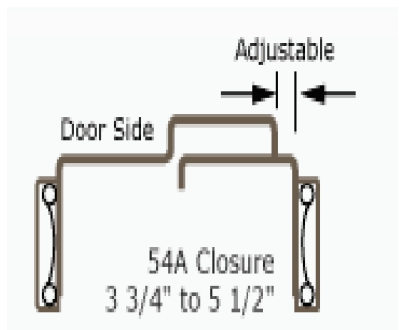
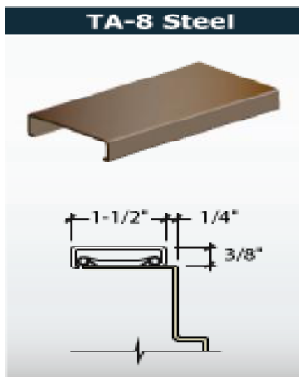

### Timely Prefinished Frames SKU's

14111003	WESTERN WHITE 3-0 HEAD 54A
14111010	WESTERN WHITE 2-8 HEAD 54A
14111011	WESTERN WHITE 2-6 HEAD 54A
14111004	WESTERN WHITE 6-8 FRAME REVERSIBLE 54A
14111007	WESTERN WHITE 7-0 FRAME REVERSIBLE 54A

### Timely Prefinished Frames SKU's

14111005	WESTERN WHITE 3-0 HEAD 73A
14111012	WESTERN WHITE 2-8 HEAD 73A
14111013	WESTERN WHITE 2-6 HEAD 73A
14111006	WESTERN WHITE 6-8 FRAME REVERSIBLE 73A
14111008	WESTERN WHITE 7-0 FRAME REVERSIBLE 73A

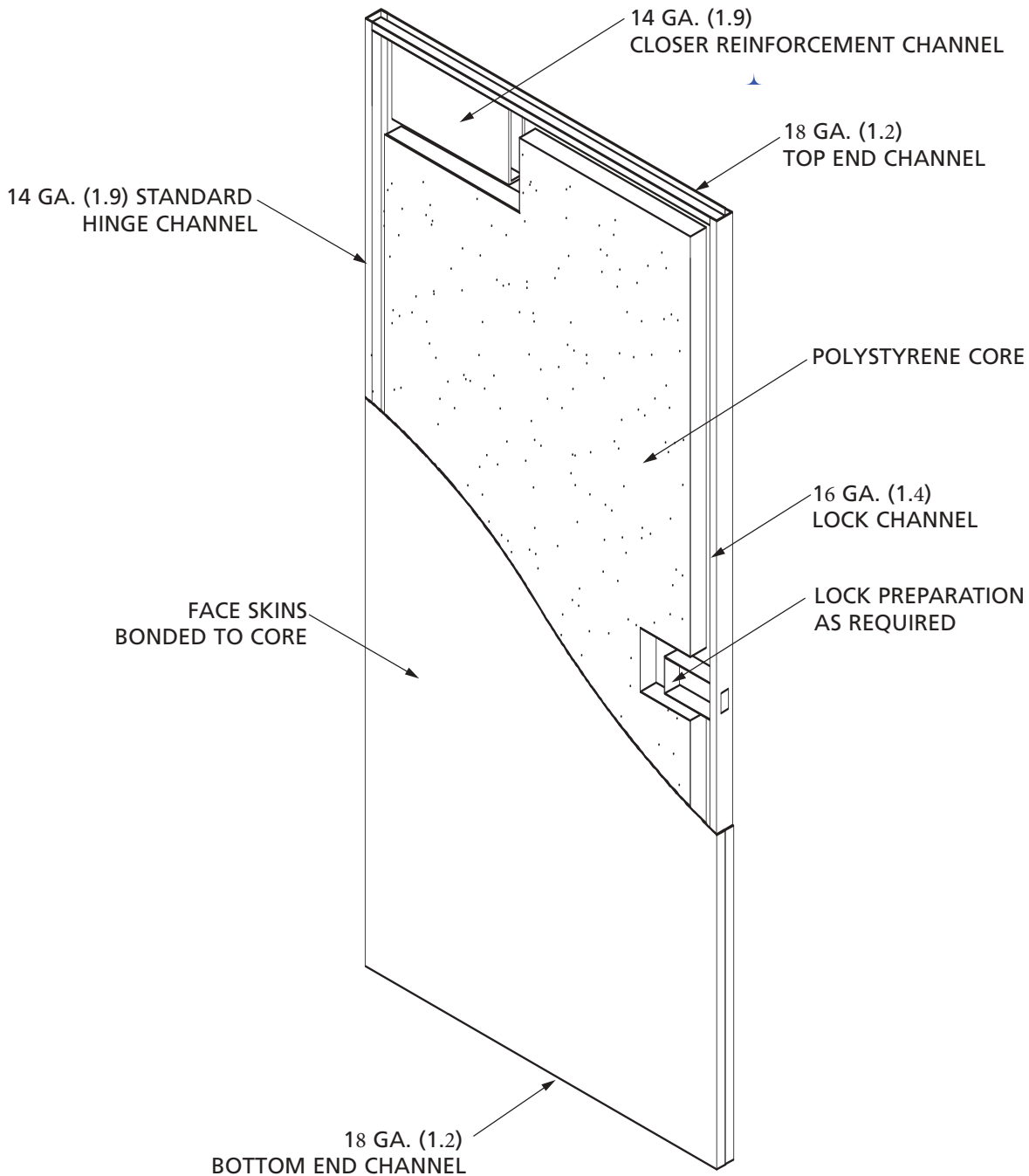

Curries Doors SKU's	
14130687	3068 SINGLE BORE 18GA
14130689	3070 SINGLE BORE 18GA
14253489	3068 NO BORE 18GA
14253488	3070 NO BORE 18GA
ALL STOCK DOORS ARE 18GA & 90 MIN FIRE RATED	

- **Economical** - Only 3 frame pieces for faster, easier installation.
- **Durable** - Tested to 1 million cycles.

## Versatility to Handle Nearly Any Drywall Installation

For any combination of wood stud, wire truss or steel stud construction. CURRIES can wrap your wall condition with double rabbet frames

### 3-Piece, Simplified Design Frame with Features that Save Time and Money

Solid interlocking corners with 16-ga. corner clip reinforcing. Hairline seam at corner face is aesthetically pleasing to the eye.

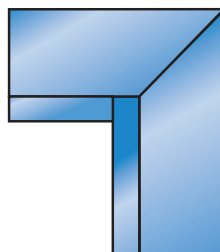
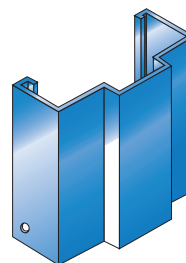
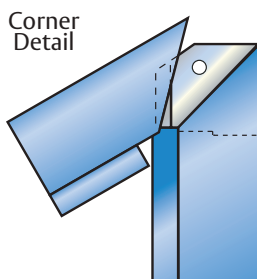

Easily, quickly installed, dependable compression bar anchor system at top of each jamb, secures frame in opening.

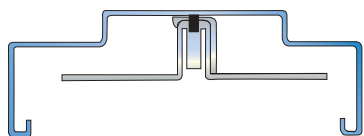

SHOWN WITH COMPRESSION ANCHOR

Curries C Frame SKU's	
14253466	C FRAME 5-7/8" 6068
14253472	C FRAME 5-7/8" 3068 LH
14253473	C FRAME 5-7/8" 3068 RH
14253467	C FRAME 5-7/8" 6070
14253470	C FRAME 5-7/8" 3070 LH
14253471	C FRAME 5-7/8" 3070 RH
ALL STOCK FRAMES ARE 16GA & 90 MIN FIRE RATED	

Some specifications require the use of M series frames in wood stud or metal stud type wall construction. Various types of stud combinations and wall coverings result in a wide range of wall thickness' used in today's construction. For instance, a typical 3-5/8 inch metal stud, with one layer of 5/8 inch sheetrock on each side, results in a wall thickness of 4-7/8 inches. This is the most popular wall size currently used and that is why the 5-3/4 inch frame with 7/16 inch backbend has a 4-7/8 inch throat opening.

The wall construction combinations, as shown below, are detailed on the architectural plans and this determines the jamb depth of the frame for each opening.

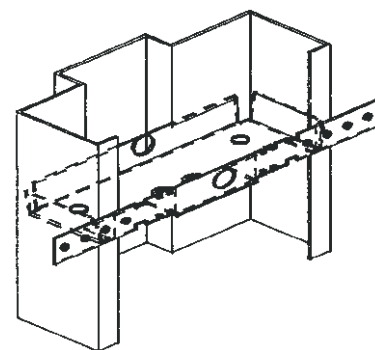

MULTI PURPOSE ANCHOR

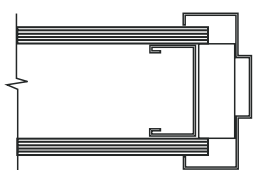

CHANNEL STEEL STUD  
WITH 5/8" SHEETROCK

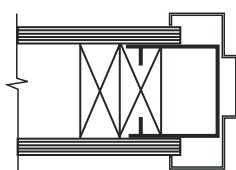

2 X 4 WOOD STUD  
WITH 5/8" SHEETROCK

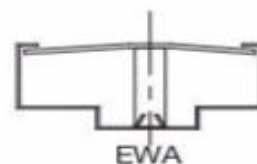

EXISTING WALL ANCHOR

**NOTE:** Anchors for the M series frames are available for all of the common wall construction types. The multipurpose anchor (M.P.) is by far the most popular as it can be used in woodstud, metalstud, wiretruss, or existing wall frame installations.



Curries M Frame SKU's	
142004553	MULTI-PURPOSE 5-3/4" ANCHOR
14570564	5-3/4" EWA ANCHOR
142495	3/8" X 5" FH WOOD LAG
20203850	RED FS-3850 CONCRETE SLEEVE
DEXPD	PUNCH AND DIMPLE METAL FRAME
Curries M Frame SKU's	
14253468	M16 5-3/4" 3068 FRAME LH CURRIES
14253469	M16 5-3/4" 3068 FRAME RH CURRIES
14253476	M16 5-3/4" 3070 FRAME LH CURRIES
14253477	M16 5-3/4" 3070 FRAME RH CURRIES
14253495	M16 5-3/4" 6068/E18/H5 FRAME REV FRAME
14253496	M16 5-3/4" 6070/E18/H5 FRAME REV FRAME
ALL STOCK FRAMES ARE 16GA & 90 MIN FIRE RATED	

## Only Omni Offers You All these Benefits in an Expandable Steel Frame

The patented slider mechanism operates smoothly and positively.



Adjustable door  
frame closed to fit  
wall 4-1/2" wide.

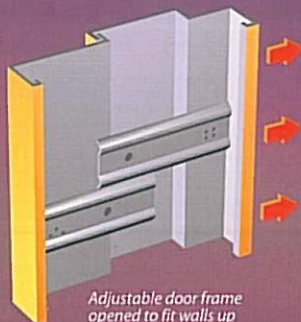

Adjustable door frame  
opened to fit walls up  
to 7-5/8" wide.

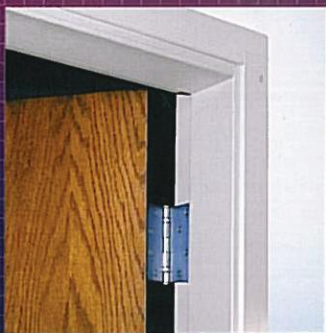

Omni Expandable Steel Frame for  
Double Doors is Ideal for Steel Fire  
Doors or Wooden Doors.



Serving the  
Automotive,  
Appliance,  
and  
Commercial  
Hardware  
Industries.

OMNI Does It All!

### • Fully Expandable & Reversible

Over 3" of expansion fits any wall thickness from 4-1/2" to 7-5/8". Stocking is simplified and many installation costs are eliminated. No sanding required. Ready to be painted.

### • One-Piece Design

Side jambs and headers are each of one piece. No need to choose various extension sections. No loose pieces to lose or damage.

### • Strength

The strength of 18 g. steel and the safety of 90-minute fire rating for both single and double door units.

### • Long Life

The long term protection of hot-dipped galvanizing: an excellent base for the finish of your choice.

#### Specifications:

Height.....	6'8" or 7'0"
Width.....	2'0" to 6'0" (Standard Widths)
Rabbet.....	1-3/4"
Fire Rating.....	90 Minute (W.H.I.) for Single & Double Openings.
Machining.....	Prepared for 3 x 4-1/2" Screw-On Butts & Single 2-3/4" T-Strike for Self Tapping Screws. ANSI 4-7/8" Prep. Available as Option. Deadlock Strike & Closer or Panic Reinforcing Optional.
Finish.....	Hot Dipped Galvanized 18 g Steel.
Anchoring System.....	14 x 2-1/2" #8 Drywall Screws.
Rough Openings.....	Door Width Plus 1-3/4" Door Height Plus 2" from Finished Floor.
Patents.....	Canadian #1129253, USA #4395885

Your Local Distributor is:

#### OMNI

DSFSGL90	STEEL FRAME 90M
DSFSGLNR	STEEL FRAME NON-RATED

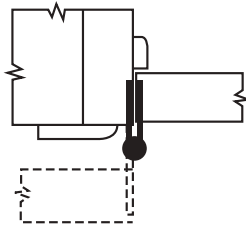

## Full Mortise

### Doors

Solid Core Wood  
Hollow Metal  
Mineral Core Wood Doors  
with minimum  $\frac{3}{4}$ " Edge Style

### Frames

Wood  
Hollow Metal

## Standard Ball Bearing Hinge



## Non-Removable Pins



- NRP – Set screw in barrel intercepts groove in loose pin as shown. Set screw is not accessible when door is closed. Not available on size 3" (76mm) and smaller. Specify "**NRP**" (non-removable pin) when ordering

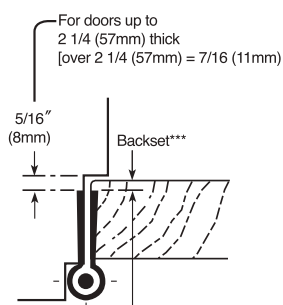
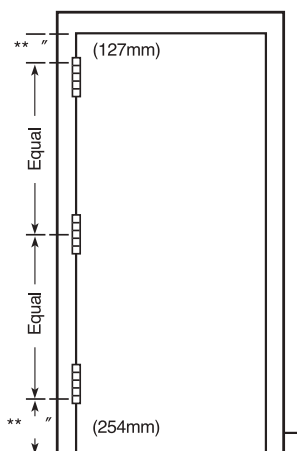

For doors up to  
2 1/4 (57mm) thick  
[over 2 1/4 (57mm) = 7/16 (11mm)]

5/16" (8mm)

Backset\*\*\*

1/4 (6.4mm)  
For doors up to  
2 1/4 (57mm) thick  
[over 2 1/4 (57mm) = 3/8 (9.5mm)]

### TYPICAL BACKSET

## Stanley Hinges

14100179	FBB179 4.5 X 4.5 BALL BEARING 26D
14100180	FBB179 4.5 X 4.5 NRP BB 26
14100190	FBB191 4.5 X 4.5 BALL BEARING 32D
14100181	FBB191 4.5 X 4.5 NRP BB 32D
17302060	2060R 4.5 X 4.5 SPRING HINGE 26D

## BEST Standard Cores and Keys

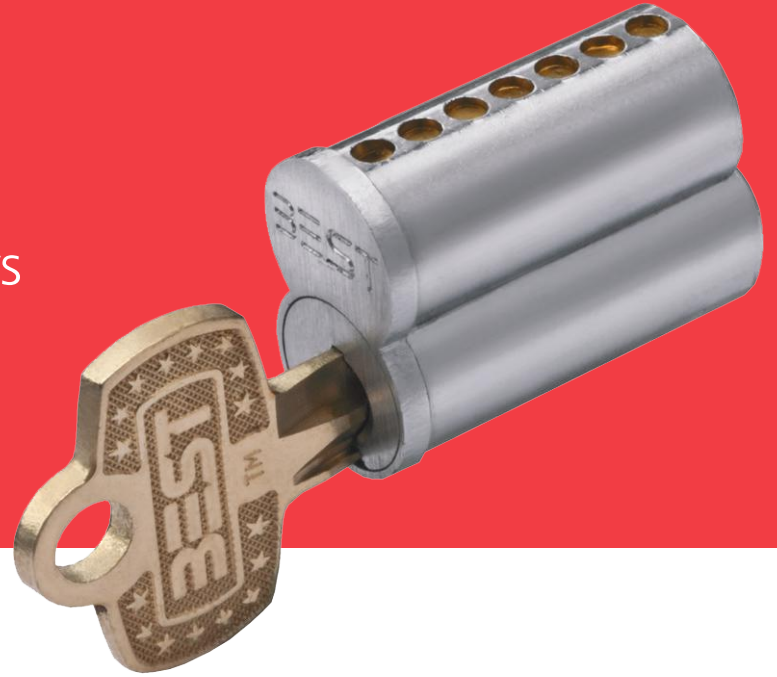

**BEST Standard Cores and Keys**  
deliver exceptional quality and  
performance for flexible solutions  
that fit a variety of applications.

### Exceptional solutions for more applications.

Our Standard Cores and Keys stand at the pinnacle of mechanical locking solutions, with features that exceed industry standards and deliver results in a wide range of applications.

#### BEST Standard Cores and Keys Specifications

<b>Certifications</b>	ANSI/BHMA A156.5 Series—Grade 1 BAA & TAA compliant		
<b>Product Specifications</b>	Core: Brass alloy Key: Nickel silver SFIC Construction Core available	626: Satin Chrome	
<b>Keying</b>	7-pin SFIC 29 unique keyways <a href="#">available upon request</a>		

#### Features

##### BEST Standard Cores and Keys

- **Enhanced integrity.** We manufacture Standard Cores and Keys with tighter tolerances for greater lock integrity and the highest mechanical security.
- **Industry-leading quality.** Each Standard offering is subject to our stringent internal quality requirements, which meet or exceed industry standards.
- **Long-term durability.** Brass alloy core construction and nickel silver keys and pins result in reliable performance over time.
- **Easy retrofit.** BEST's small format interchangeable cores make retrofitting and rekeying simple. Individually capped core pin chambers reduce repinning labor.

#### BEST CORES

17361024	1C7A1-626 A KEYWAY UNCOMBINED CORE
17361009	1A1A1-626 A KEYWAY KEY BLANK
DEXKEY	KEY CUT CHARGE
DEXCORE	CORE PINNING CHARGE

## UNIVERSAL MORTISE LOCK

### ONE MORTISE LOCK CAPABLE OF MULTIPLE FUNCTIONS

In addition to the ability to quickly change the lock handing, the universal case design of the 40H provides the ability to reconfigure a lock into many different functions easily and quickly, often by rearranging existing parts without disassembling

the lock case. The efficiency of the design enables 9 of the most commonly used lock functions to be included in just 2 case configurations.



The 40H provides the ability to postpone decisions on how the lock will be configured all the way up to the point of installation, making it one of the most flexible and user-friendly mortise locks available. This translates into value for anyone involved in the process, whether they're an architect, specification writer, distributor, or end-user.

UNR	ANSI	UNAB	ANSI
A – office	F04	AB – office	F20
AT – office	F04	TA – dormitory	F12
D – storeroom	F07	TD – dormitory	
N – passage	F01		
NX – exit	F31		
R – classroom	F05		









UNR CASE AND UNAB CASE CAN BE CHANGED TO ACCOMMODATE ALL THE ANSI FUNCTIONS LISTED BELOW THEM.

BEST UNIVERSAL MORTISE LOCK	
17361131	45H7UNAB15H626RH
17361130	45H7UNR15H626RH
17361047	CYLINDER LESS CORE

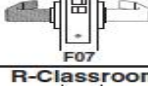

LOCKS ARE LESS CORE

### FUNCTIONS

Function & Diag. ANSI No.	Description Latch operated by	Function & Diag. ANSI No.	Latch operated by
<b>Single Keyed</b>			
<b>A-Office</b>  F04	<ul style="list-style-type: none"> <li>Rotating inside lever,</li> <li>Rotating outside lever—only when locking toggle is in unlocked position,</li> <li>Turning key in outside cylinder.</li> </ul>	<b>N-Passage</b>  F01	Rotating inside or outside lever
<b>AB-Office</b>  F20	<ul style="list-style-type: none"> <li>Rotating inside lever,</li> <li>Rotating outside lever—only when locking toggle is in unlocked position,</li> <li>Turning key in outside cylinder.</li> </ul>	<b>NX-Exit</b>  F31	Rotating inside lever
<b>AT-Office</b>  F04	<ul style="list-style-type: none"> <li>Rotating inside lever,</li> <li>Rotating outside lever only when unlocked by key or turn lever,</li> <li>Turning key in outside cylinder.</li> </ul>	The latchbolt is deadlocked with an auxiliary deadlatch	
<b>D-Storeroom</b>  F07	<ul style="list-style-type: none"> <li>Rotating inside lever,</li> <li>Turning key in outside cylinder.</li> </ul>	The latchbolt is deadlocked with an auxiliary deadlatch	
<b>R-Classroom</b>  F05	<ul style="list-style-type: none"> <li>Rotating inside lever,</li> <li>Rotating outside lever only when unlocked by key,</li> <li>Turning key in outside cylinder.</li> </ul>	The latchbolt is deadlocked with an auxiliary deadlatch	
<b>TA- Dormitory</b>  F12	<ul style="list-style-type: none"> <li>Rotating inside lever,</li> <li>Rotating O/S lever only when locking toggle is in unlocked position and deadbolt is retracted,</li> <li>Turning key in outside cylinder.</li> </ul>	<b>TD-Dormitory</b>  F12	<ul style="list-style-type: none"> <li>Rotating inside lever,</li> <li>Turning key in outside cylinder.</li> </ul>
		The latchbolt is deadlocked with an auxiliary deadlatch	



## 9K SERIES

### Heavy Duty Locks – Levers

#### SPECIFICATIONS

**Backset**– 2 ¾"

**Finish**: 626– satin chromium plated

**Interchangeable core**– Solid brass, pin-tumbler type in lever with 7-pin core.

**Material**– Component parts include brass, bronze or zinc. Internal parts are zinc dichromate steel.

**Mounting**– 2 1/8" diameter bore for lock housing, 1" diameter for latch tube.

**Rose**– D– 3 1/2" diameter mounting screws concealed.

**Strike**– **STK S3**– 4 7/8" x 1 1/4" with curved lip & box.

**Door thickness**– 1 3/8" to 2" .



## 7K SERIES

### Medium Duty Locks – Levers

#### 9K Heavy Duty Locks-Levers

17352507	9K30L15D-S3-66 LVR PRIVACY
17352508	9K30N15D-S3-626 LVR PASSAGE
17352510	9K37AB15D-S3-626-LC LVR ENTRANCE
17352511	9K37D15D-S3-626-LC LVR STOREROOM
17352512	9K37R15D-S3-626-LC LVR CLASSROOM

#### 7K Medium Duty Locks-Levers

17361124	7K30L15D-S3-626 LVR PRIVACY
17361125	7K30N15D-S3-626-LC LVR PASSAGE
17361127	7K37AB15D-S3-626-LC LVR ENTRANCE
17361128	7K37D15D-S3-626-LC LVR STOREROOM

**LOCKS ARE LESS CORE.** If cores are needed please contact Millwork



## Performance Features

- Tested to meet Grade 2 specification of 400,000 cycles.
- Standard clutching mechanism provides resistance to damage caused by physical force.

## Certifications



## Product Specifications

- Handing – All QCL200 Series Levers Locksets are non-handed.
- Door thickness – 1 3/8" - 2" (35mm-51mm) standard.
- Backset – 2 3/4" (70mm) square standard.  
2 3/8" and 5" (60mm, 127mm) available.
- Exposed trim – Pressure cast zinc, plated to match finish designation.
- Strike – ANSI Strike 1 1/4" x 4 7/8" (32mm x 124mm) standard.
- Door prep – 2 1/8" (54mm) diameter cross bore.
- Latch bolt – Keyed/Exterior 1/2" (12.7mm) steel throw;  
Interior 1/2" (12.7mm) spring latch.
- Latch faceplate – 1 1/8" x 2 1/4" (29mm x 57 mm) standard.

## Keying

- 6-pin brass cylinders. Many keying options available from our factory to include, but not limited to, master keying, grand master keying and construction keying.
- 2 keys per lockset.

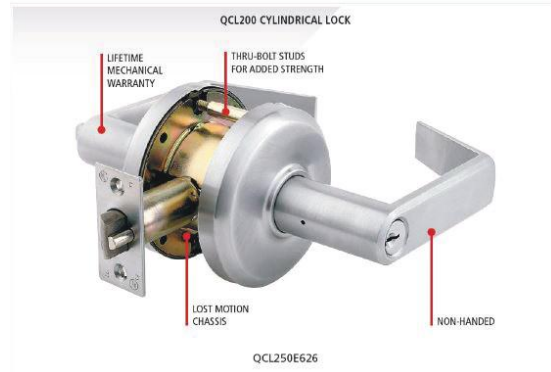

## Finishes

BHMA	Description
626	Satin Chrome

Functions		Description
<b>QCL230</b> <i>Passage</i>		Both levers always unlocked and always free for immediate ingress & egress.
<b>QCL240</b> <i>Privacy</i>		Push-button locking. Can be opened from outside with a small screwdriver. Turning inside lever or closing door releases button. Inside lever is always free for immediate egress. Clutch feature disengages outside lever from latch when locked to prevent vandalism.
<b>QCL250</b> <i>Entry/Office</i>		Turn/push-button locking; pushing and turning button locks outside lever, requiring use of key until button is manually unlocked. Push-button locking; pushing button locks outside lever until unlocked by key or by depressing inside lever. Clutch feature disengages outside lever from latch when locked to prevent vandalism. Inside lever is always free for immediate egress.
<b>QCL270</b> <i>Storeroom</i>		Outside lever always locked. Entrance by key only. Inside lever unlocked and free for immediate egress. Clutch feature disengages outside lever from latch when locked to prevent vandalism.

## Grade 2 Commercial Locks

17323026	QCL230 PNN PASS LEVER 626
17323027	QCL240 PNN PRIV LEVER 626
17323028	QCL250 PNN ENTRY LEVER 626
17327090	QCL270 PNN STOREROOM LEVER 626

INCLUDES SCHLAGE CORE



## DEADBOLT FEATURES

1. No exposed mounting screws standard
2. Full 1" stainless steel throw deadbolt
3. Free-turning, wrench-resistant, tapered cylinder ring
4. 83T-solid extruded brass or bronze cylinder
5. Stainless steel for strength and corrosion resistance
6. Simple installation; self-aligning and reversible strike
7. May be keyed into existing BEST® masterkeyed system
8. The original interchangeable core permits instant, economical re-lock
9. ADA turn lever
10. Deadbolt UL listed for use as auxiliary lock type on 3 hr. fire doors (GWXT). These locks also carry the C-UL mark which is now officially accepted in all of Canada, indicating compliance with appropriate Canadian standards and codes

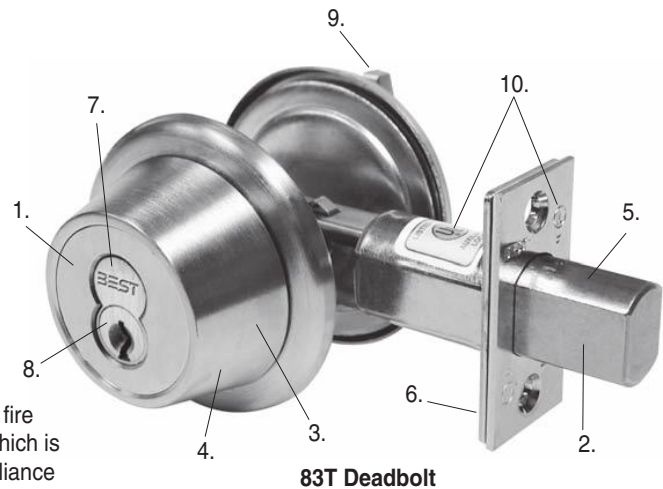

**83T Deadbolt**



**8TSTK Standard Strike**  
Dimensions— 1 1/8" x 2 3/4"

### Grade 1 Deadbolt

17352503

83T7K-STK-626-LC DEAD BOLT

**DEADBOLT IS LESS CORE.** If cores are needed please contact Millwork

## Performance Features

- Tested to meet Grade 2 specification of 150,000 cycles.
- Full 1" (25.4mm) throwbolt with saw-resistant hardened steel roller pin.
- Anti-drill design – two (2) ball bearings inserted to prevent drill attacks.
- ADA thumbturn.

## Product Specifications

- Door range – 1 3/8" (35 mm) to 2" (51 mm).
- Backset – 2 3/4" (70mm) square standard.
- Exposed trim – .
- Strike – Standard deadbolt strike 1 1/8" x 2 3/4" (32mm x 70mm).
- Door prep – 2 1/8" (54mm) diameter cross bore.
- Latch bolt – Full 1" (25.4mm) throw with hardened steel roller;
- Faceplate – 1 1/8" x 2 1/4" (29mm x 57mm).

*Single Cylinder*



### Grade 2 Deadbolt

17362623

QDB280 K2 DEADBOLT 626 with core

17362624

QDB281 K2 DEADBOLT 626

**280 INCLUDES SCHLAGE CORE**  
**281 LESS CORE / ACCEPTS SFIC CORE**

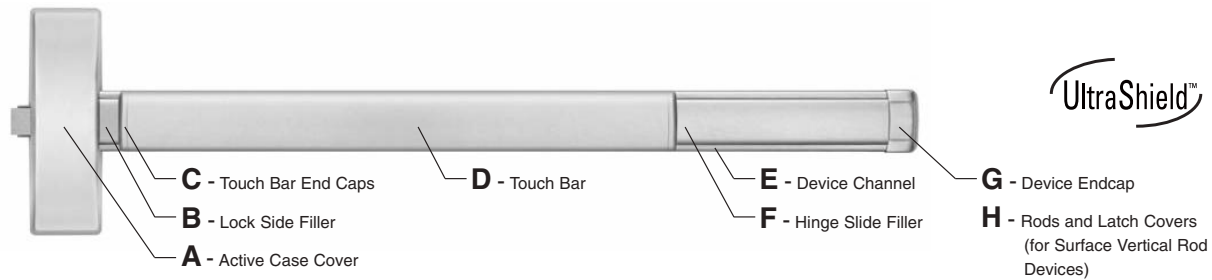

### Base Materials

Finishes	ANSI/BHMA	US
Satin Stainless Steel	630	US32D

### Door Sizes

Stock sizes for door widths and heights are listed below. If required, cut to size in the field.

Furnished standard with machine screws and full thread wood/sheet metal screws.

Door Widths	Stock Sizes
2'-7" TO 3'-0"	3'-0"

Exits	
17352527	12E72S2R626 Cylinder <b>LESS CORE</b>
17352518	2101-630 Exit Only
17352523	FL-2101-630 Fire Rated Exit Only

### 4900



1. All the escutcheons and levers are castings or forgings.

626 Trim furnished.

- 
- Trims are BHMA certified for ANSI 156.3, Grade 1.
- Trims are through bolted and will cover 161 and 86 cutouts (except for 2000C Trim).

ANSI Function	03	08	14
	Key Retracts Latchbolt	Key Locks/Unlocks Lever/Knob	No Cylinder Lever/Knob Always Active

Trim	
17361072	4903A-626 Exit Trim Night Latch
17361074	4908A-626 Exit Trim Keyed Office
17352521	4914-626 Exit Trim Passage Only

**EXIT TRIM IS LESS CORE AND CYLINDER**



### Surface Vertical Rod (SVR) Type

#### Performance Features

- Tested and certified to significantly exceed 500,000 cycles required for Grade 1 certification.
- Field sizeable, 36" to 32" door application (91.44cm-81.28cm).
- Thru-bolt trim design for increased security and durability.

#### Product Specifications

- Handing – All QED300 Series Exit Devices are non-handed.
- Door thickness – 1 3/4" standard (44.5mm).
- Door height – 7' standard with 84" rods
- Latch bolt – 1/2" (12.7mm) throw on top latch; 3/8" (9.53mm) on bottom latch.
- Fasteners – Wood and machine screws standard.
- Stile width – 3 1/2" minimum (89mm).
- Standard backset – 2 1/4" (57mm) to face of doorstop.

#### Finishes

BHMA	Description
689	Painted Aluminum

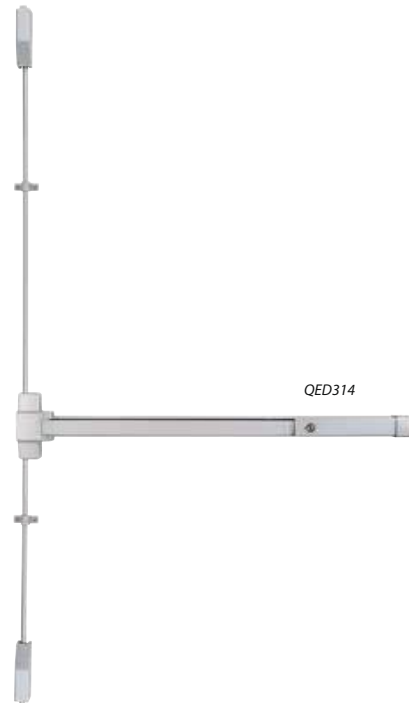

Exit Devices	
17323041	QED 314 SVR Hex Dog

### Escutcheon Trims Sierra (E)



Trim	
17321193	QET330 Passage Lever Escutcheon 689
17321194	QET360 Keyed Lever Escutcheon (Classroom) 689
17321199	QET370 Night Latch Lever Escutcheon (Storeroom) 689

INCLUDES SCHLAGE CORE

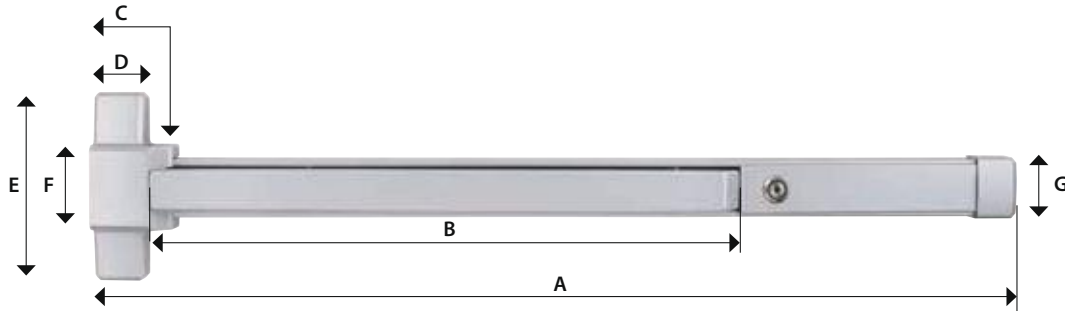

QED300 Series	36" Device							
	Minimum Door Width	Device Length	Pushpad Length	Head Cap Length	Head Cap Length	Head Cap Width	Head Cap Width	
Measurement		A	B	C	D	E	F	G
Panic Rated (with Dogging)	30"	27"	19"	2.75"	1.75"	6.25"	3"	2"
	762mm	685.80mm	482.60mm	69.90mm	44.50mm	158.80mm	76.20mm	50.80mm
Fire-Rated or Panic with Dogging Removed	28"	25"	19"	2.75"	1.75"	6.25"	3"	2"
	711.20mm	635mm	482.60mm	69.90mm	44.50mm	158.80mm	76.20mm	50.80mm

Exit Device	
17331190	QED311 RIM HEX DOG
17323029	QED313 RIM FIRE-RATED

### Escutcheon Trims Sierra (E)



Trim	
17321193	QET330 Passage Lever Escutcheon 689
17321194	QET360 Keyed Lever Escutcheon (Classroom) 689
17321199	QET370 Night Latch Lever Escutcheon (Storeroom) 689

INCLUDES SCHLAGE CORE



### MULLIONS



**Mullion Cap**  
MC822



**Key Removable  
Mullion Cap**  
KMC822  
(Rim Cylinder required)



**Mullion Cap Spacer**  
RPMCS822

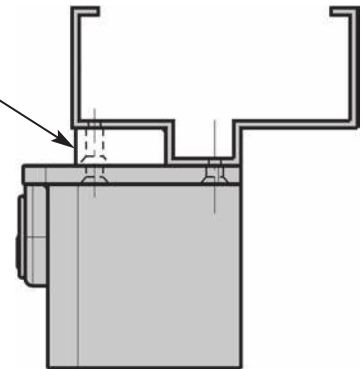

822  
Mullion



**RPBM  
Mullion  
Base**

### Removable Mullions

The Mullion is used to adapt a double door opening to two single door openings with Rim Exit Devices. When the full width of an opening is required, the mullion may be removed.

**KEY REMOVABLE MULLION (KR)** - Provides a secure yet quick & easy means of removing the 822

**FINISHES** - 600

**CYLINDER** - not furnished standard.

**Mullion can be cut down to fit required height**

Mullkon Parts	
17352515	#822-600 8' Steel Mullion 2" x 3"
17362627	MC822-600 Allen Wrench Removable Cap, No Key
17362626	KMC822-600 Keyed Removable Cap, requires cylinder
17322600	RPMCS822-600 Mullion Cap Spacer
17352516	RPBM822-600 Mullion Base
17352527	12E72S2R626 Cylinder / <b>Less Core</b>
If cores are needed please contact Millwork	

**21B SERIES**

**Specifications**

**Case** – Machined from solid extruded brass.  
Standard finish is 626 satin chromium plated.

**Width** – 1 <sup>25</sup>/<sub>32</sub>”

**Length** – 2 <sup>1</sup>/<sub>16</sub>”

**Thickness** – <sup>13</sup>/<sub>16</sub>”

**Shackle** – The shackle locks at both heel and toe. The length of shackle opening is measured from top of case to inside of shackle when padlock is locked.

**Material** – Stainless steel

**Diameter** – <sup>5</sup>/<sub>16</sub>”

**Width of opening** – <sup>7</sup>/<sub>8</sub>”

**ASTM F883** – Meets Grade 4 with stainless steel shackle.



21B72 approx. size

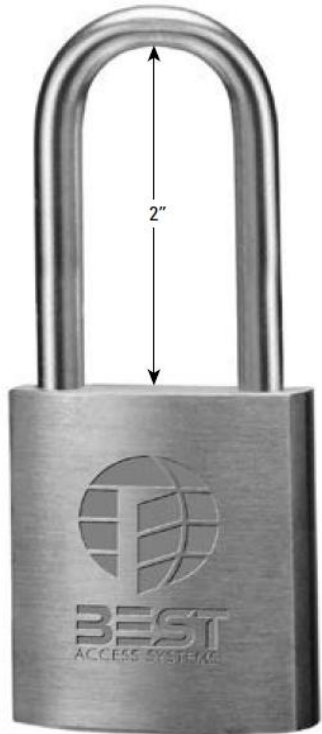

21B772 appr. size

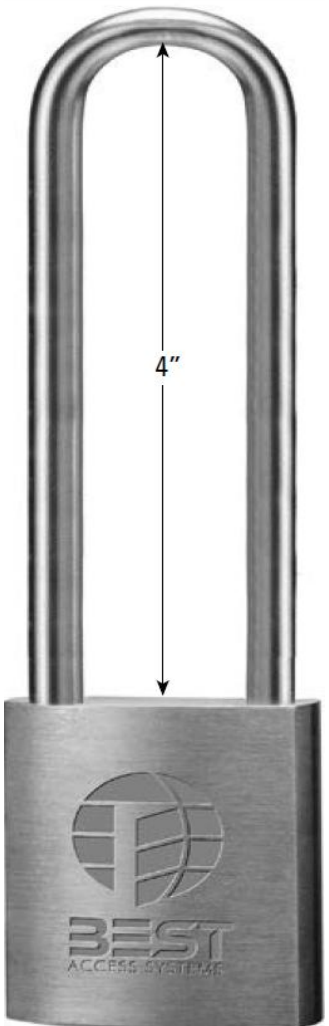

21B782 approx size

BEST PADLOCK	
17321572	21B72 BEST PADLOCK
17321772	21B772 BEST PADLOCK
17361059	21B782 BEST PAKLOCK
PADLOCK IS LESS CORE If cores are needed please contact Millwork	



### Performance Features

- Fully adjustable from 1 - 6 allowing for maximum flexibility.
- All-weather fluid ensures optimal operational performance in multiple climate conditions.
- Delayed action and backcheck are standard in the same door closer body.

### Certifications



- ANSI/BHMA A156.4 Series – Grade 1
- ANSI A117.1 Accessibility Code (ADA Compliant)
- UL/cUL listed (3 hour) for self closing
- UL10C Positive Pressure Rated
- UL10B Pressure Rated

### Product Specifications

- Handing – All QDC100 Series Closers are non-handed (QDC116 arms & metal covers are handed).
- Cast-iron closer body.
- All-weather fluid.
- Stacked valves prevent oil leaks from screws being backed out too far.
- Cover – metal and plastic covers available.
- Arms & brackets – Tri-pack standard, additional arms optional.
- Arm material – Heat-treated carbon steel.
- Springs – High-impact hand-drawn steel wires.
- Pinions – Heat-treated chrome molybdenum steel.
- Cylinder construction – Heat-treated free-cutting carbon steel.
- Fasteners – Wood and machine screws standard; sex nuts and self-reaming, self-tapping screws shipped standard.
- Door weights & sizes:

Size	Applicable Door Weight	Door Width Ranges	
		Interior	Exterior
1	33 – 55 LBS (15 – 30 Kg)	32" (0.81m)	28" (0.71m)
2	56 – 99 LBS (30 – 45 Kg)	36" (0.91m)	32" (0.81m)
3	99 – 143 LBS (45 – 65 Kg)	42" (1.07m)	36" (0.91m)
4	143 – 187 LBS (65 – 85 Kg)	48" (1.22m)	42" (1.07m)
5	187 – 264 LBS (85 – 120 Kg)	54" (1.37m)	48" (1.22m)
6*	264 – 330 LBS (120 – 150 Kg)	58" (1.47m)	54" (1.32m)

\*50% spring power adjustment over size 6.

### Warranty

- Lifetime Mechanical and 3-year finish



QDC111



Rounded Plastic Cover (R)  
(Ships Standard)

### Finishes

BHMA	Description
689	Painted Aluminum

Door Closer	
17321191	QDC 111 XTRA H/D CLOSER 689 TRI
17323034	QDC 115 689 CLOSER (EDA)



## Performance Features

- Fully adjustable from 1 - 6 allowing for maximum flexibility.
- Delayed action and backcheck are standard in the same door closer body.
- All-weather fluid ensures optimal operational performance in multiple climate conditions.

## Certifications



- ANSI/BHMA A156.4 Series – Grade 1
- ANSI A117.1 Accessibility Code (ADA Compliant)
- UL/cUL listed (3 hour) for self-closing doors without hold open
- UL10C Positive Pressure Rated
- UL10B Pressure Rated

## Product Specifications

- Handing – **Both** Series Closers are non-handed.
- Material – Cast aluminum closer body.
- All-weather fluid.
- Arms & brackets – Tri-pack standard (regular, top jamb, parallel configurations). Hold open and dead stop arms also available.
- Arm material – Heat-treated carbon steel.
- Springs – High-impact hand-drawn steel wires.
- Pinions – Heat-treated chrome molybdenum steel.
- Cylinder construction – Heat-treated free-cutting carbon steel.
- Fasteners – Wood and machine screws standard; sex nuts and self-tapping screws shipped standard.
- Door weights & sizes:

Size	Applicable Door Weight	Door Width Ranges	
		Interior	Exterior
1	33 – 55 LBS (15 – 30 Kg)	32" (0.81m)	28" (0.71m)
2	56 – 99 LBS (30 – 45 Kg)	36" (0.91m)	32" (0.81m)
3	99 – 143 LBS (45 – 65 Kg)	42" (1.07m)	36" (0.91m)
4	143 – 187 LBS (65 – 85 Kg)	48" (1.22m)	42" (1.07m)
5	187 – 264 LBS (85 – 120 Kg)	54" (1.37m)	48" (1.22m)
6	264 – 330 LBS (120 – 150 Kg)	58" (1.47m)	54" (1.32m)

## Warranty

- Lifetime Mechanical and 3-year finish



311 closer

## Finishes

BHMA	Description
689	Painted Aluminum



211 closer

Door Closers	
17323031	QDC311 Tri-Pack Arm
17321190	QDC211 Tri-Pack Arm

## ASSA ABLOY

### COMMERCIAL THRESHOLDS: THERMAL BARRIER SADDLES

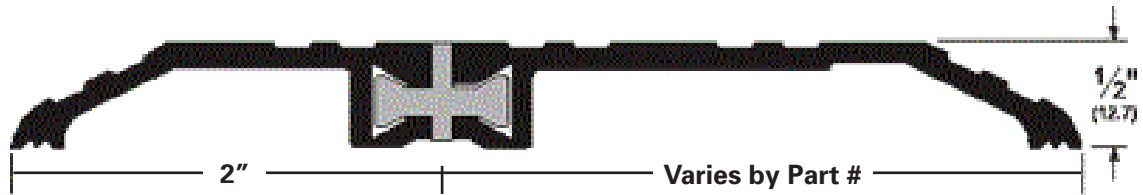

Thermal Barrier Saddles SKU'S		
145252336	252X3AFG 36"	5-1/8" WIDTH
14525231	252X3AFG 72"	5-1/8" WIDTH
145252337	252X4AFG 36"	6-1/8" WIDTH
14518102	252X4AFG 72"	6-1/8" WIDTH
14425236	252X5AFG 36"	7-1/8" WIDTH
14425272	252X5AFG 72"	7-1/8" WIDTH

## ASSA ABLOY

### COMMERCIAL THRESHOLDS: THERMAL BARRIER SADDLES



HEIGHT: 1/2" (12.7 mm)

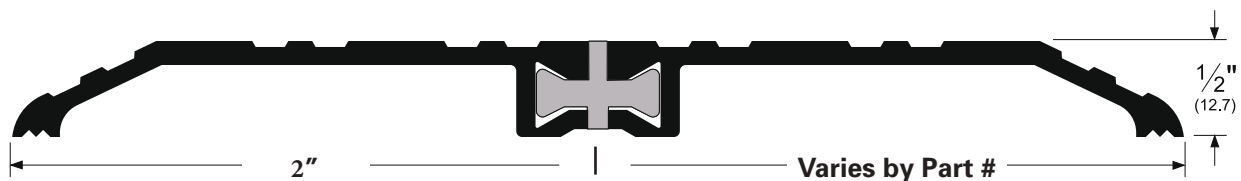

Thermal Barrier Saddles SKU'S		
145254436	252X6AFG 36"	8-1/8" WIDTH
145254472	252X6AFG 72"	8-1/8" WIDTH

## ASSA ABLOY

### COMMERCIAL THRESHOLDS: SADDLE THRESHOLDS



HEIGHT: 1/4" (6.4 mm)



Saddle Thresholds SKU'S			
14527136	271A	36" LONG	5"WIDTH
14527172	271A	72" LONG	5"WIDTH
14527236	272A	36" LONG	6"WIDTH
14527272	272A	72" LONG	6"WIDTH
14527636	276A	36"LONG	7"WIDTH
14272127	276A	72"LONG	7"WIDTH
145274836	2748A	36"LONG	8"WIDTH
145274872	2748A	72"LONG	8"WIDTH

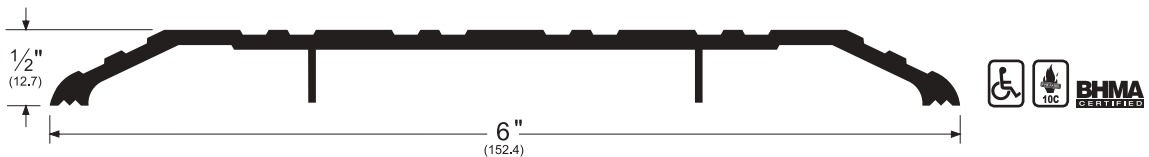

Saddle Thresholds SKU'S			
14517236	172A	36" Long	6" WIDTH

## PERIMETER GASKETING: HEAVY DUTY PERIMETER GASKETING - STANDARD JAMB

**290AS**   

WIDTH: 1/4" (6.4 mm)

PROFILE HEIGHT: 1-1/2" (38.1 mm)

TOTAL HEIGHT WITH INSERT: 1-3/4" (44.5 mm)

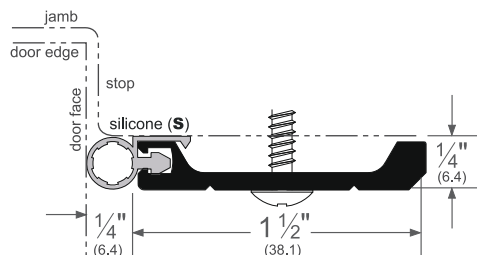

### Gasketing: Standard Jamb SKU'S

145290284	290AS2/84 2EA Legs 84"
-----------	------------------------

## PERIMETER GASKETING: HEAVY DUTY PERIMETER GASKETING - HEAD SECTION

**2891AS**   

WIDTH: 1/4" (6.4 mm)

PROFILE HEIGHT: 1-1/2" (38.1 mm)

TOTAL HEIGHT WITH INSERT: 1-3/4" (44.5 mm)

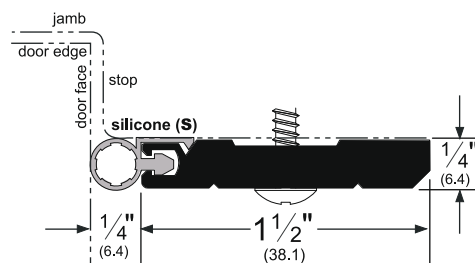

### Gasketing: Head Section SKU'S

145289136	2891AS36 36" Head Gasket
145289172	2891AS72 72" Head Gasket

## ASTRAGAL

**18061CNB**

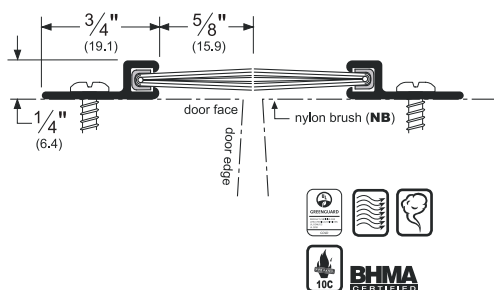

NOTE: Brush should mesh from 1/32" to 1/16".

### Overlap Steel Astragal SKU'S

1451806184	84" Brush Meeting Stile Gasket
------------	--------------------------------

Requires 2 legs for diagram above

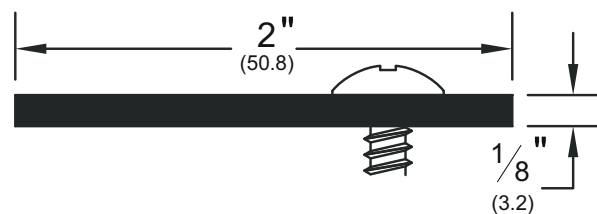

### Overlap Steel Astragal SKU'S

14435784	7' Overlap Steel Astragal
----------	---------------------------

## DOOR BOTTOMS: DOOR BOTTOM SWEEPS

**315<sub>c</sub>N**

**BHMA**  
CERTIFIED

WIDTH: 1/4" (6.4 mm)

PROFILE HEIGHT: 1-1/4" (31.8 mm)

TOTAL HEIGHT WITH INSERT: 1-11/16" (42.9 mm)

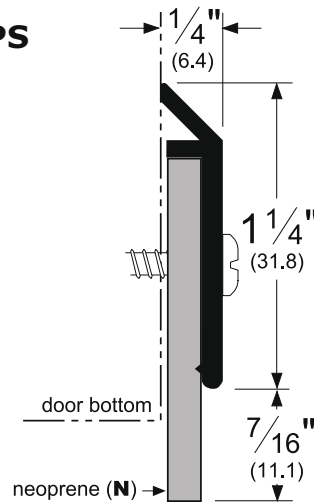

### Door Bottom Sweeps SKU'S

14531536	36" Neoprene Sweep
----------	--------------------

## DOOR BOTTOMS: AUTOMATIC DOOR BOTTOMS

**4131<sub>c</sub>RL**

**BHMA**  
CERTIFIED

HEIGHT: 1-27/32" (46.8 mm)

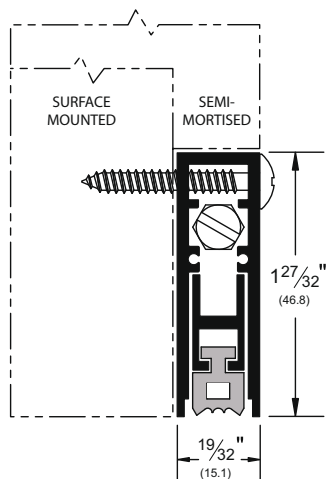

### Automatic Door Bottoms SKU'S

14518103	4131CLR 36" Auto Door Bottom
----------	------------------------------

## ADJUSTABLE SWEEP

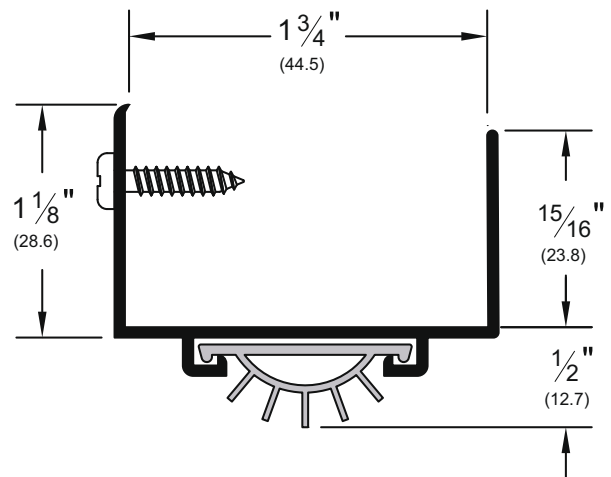

### Adjustable Sweep SKU'S

14521736	217AV36 36" Adjustable Sweep
----------	------------------------------

## BRUSH GASKETING: 180° ALUMINUM RETAINERS

**18061C**<sub>NB</sub>



WIDTH: 1/4" (6.4 mm)  
 PROFILE HEIGHT: 3/4" (19.1 mm)  
 HEIGHT INCLUDING BRUSH: 1-3/8" (35.0 mm)

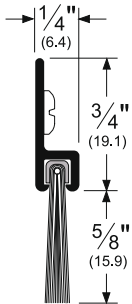

### 180 Aluminum Retainers SKU'S

1451806136	36" x 5/8" Brush Sweep
------------	------------------------

## BRUSH GASKETING: 45° ALUMINUM RETAINERS

**45061C**<sub>NB</sub>



WIDTH: 5/16" (7.9 mm)  
 PROFILE HEIGHT: 3/4" (19.1 mm)  
 HEIGHT INCLUDING BRUSH: 1-3/16" (30.2 mm)

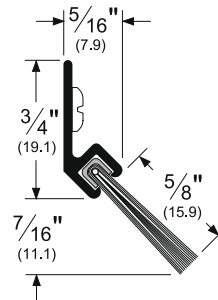

### 45° Aluminum Retainers SKU'S

145450613684	36" x 84" Brush / 1 Head 2 Legs
145450617284	72" x 84" Brush / 1 Head 2 Legs

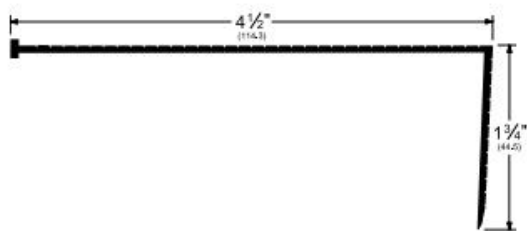

327\_

### Sill Nosing

145615	327A Sill Nosing Alum
145620	327D Sill Nosing Bronze

## ADHESIVE GASKETING: SILICONSEAL™ ADHESIVE-BACKED FIRE/SMOKE GASKETING

**S88**<sub>D</sub>



AVAILABLE LENGTHS: 17', 21'  
 WIDTH: 1/2" (12.7 mm)  
 HEIGHT: 1/4" (6.4 mm)

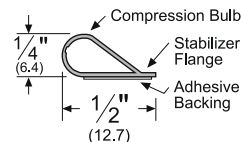

### Adhesive Backed Gasketing SKU'S

25951841	17' Smoke Gasket
14168266	21' Smoke Gasket

## 580-8 - Surface Bolt 8" Bolt Length

### Specifications:

Material: Steel, Stainless Steel

Fastener: 8 ea. #10 x 1-1/4 FH SMS, 8 ea. 10-24 x 1 FH MS

Other: 1-1/8" bolt throw, 1/4" x 3/4" bolt material.

Features:

- UL listed for use on inactive leaf of a pair of 3-hour labeled fire doors.
- Includes a universal top strike and a mortise bottom strike.

Bolt Length: 8"      Weight: 1.1 lbs.      ANSI A156.16: L04161

BOLT	
14500580	US32D Surface Bolt 8"

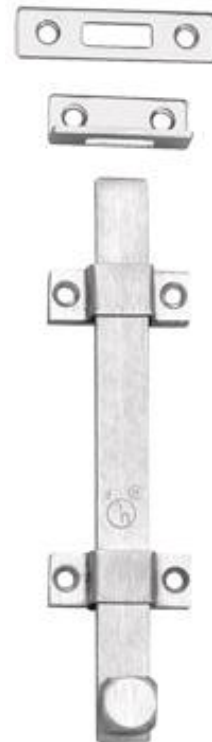

## 555 - Lever Extension Flush Bolt

### Specifications:

Fastener: 8 ea. #8 x 3/4 FH Combo Screws

Features:

- Fits ANSI A115 door and frame preparation.
- 3/4" bolt throw, 3/4" rod backset.
- 12" rod length (center of face to bolt end - retracted).
- 1-1/2" adjustable bolt head.

SIZE

Face Plate: 1" x 6-3/4"

Strike: 15/16" x 2-1/4"

Guide: 1" x 2"

Weight: 1.5 lbs./2

ANSI A156.16: L04251

FLUSH BOLT	
14500555	555 FLUSH BOLT 12"26D

Sold as one box with 2 bolts



## K1050 - .050" Thick - Metal Kick Plate-Standard Duty



### Specifications:

Material: .050" , Stainless Steel Fastener:

#6 x 5/8 OH SMS

Weight: 8" x 34" = 4.0 lbs.

Width of Plates:

Push Side: 2" less than door width. Pull Side: 1-1/2" less than door width.

NFPA 80 STANDARDS - 2-4.5 Protection Plates: Factory-installed protection plates shall be installed in accordance with the listing of the door.

Field-installed protection plates shall be labeled and installed in accordance with their listing.

Exception: Labeling is not required where the top of the protection plate is not more than 16 in. (406 mm) above the bottom of the door.

KICK PLATE	
14810343	US32D Kickplate 10"x34"

## 320CXL - Latch Protector



### Specifications:

Material: Steel, Stainless Steel

Fastener: 5/16 -18 Carriage Bolts and Hex Drive Sex Nuts.

Ordering: Product number and finish.

Features: Jamb pin prevents prying of door. Non-handed.

Notched for 2-1/4"-3-3/4" diameter rose on cylindrical lockset.

Material Size: 3" x 11"

Thickness: .105"

Lock Type: cylindrical

Weight: 1.2 lbs.

Latch Protector	
14532032	320CXL32D LATCH GUARD



## Low Dome Stops No. 441CU

**Other:** No. 441 is packed with both WS and MS fasteners

**Features:** For doors without thresholds (not undercut).

**ANSI A156.16** L02141



## Solid Cast Wall Stops No. 403

Concealed mounting concave bumper. Back plate prevents damage to wall

**ANSI A156.16** L02251



## Wrought Wall Stops No. 406

Concealed mounting concave bumper. Back plate prevents damage to wall

**ANSI A156.16** L02101



## 608 - Door Silencer

### Specifications:

Size: 1/2" dia. x 5/8"

Frame Type: metal

**ANSI A156.16:** L03011

Rockwood 461 - Kick Down Door Stop

462 Kickdown Stop



Stops/Silencers	
14500441	441 Low Dome Floor Stop 26D
14500403	403 Concave Wall Stop 26D
14500404	406 Convex Wall Stop 26D
14500608	608 Door Silencer / Grey
14500405	461 Kickdown Door Stop 26D

### 70C - Push Plate - .050" Thick

#### Specifications:

##### MATERIAL:

Stainless Steel

##### FASTENER:

#6 x 5/8" OH SMS

##### FEATURES:

Four beveled edges

Standard Size: 4"x16"

Weight: 1.0 lbs.

ANSI A156.6:J301



### 110 x 70C - Pull Plate 8" CTC Pull 4" x 16" Plate

Pull: 1" dia.

CTC: 8"

Plate: 70

Size: 4" x 16"

Weight: 3.9 lbs.

ANSI A156.6: J405



#### PUSH PLATE

14500070	70C 4x16 PUSH PLATE 32D
----------	-------------------------

#### PULL PLATE

14500110	4x16 PULL PLATE 32D
----------	---------------------

# hes

## Rim Exit & Cylindrical Lock Electric Strikes

9500 Surface Mounted Electric Strike for rim exit devices with 3/4" throw. For use in metal or wood jambs. 630 finish



5200C Complete Pac for cylindrical locksets in metal, aluminum or wood jambs. 630 finish

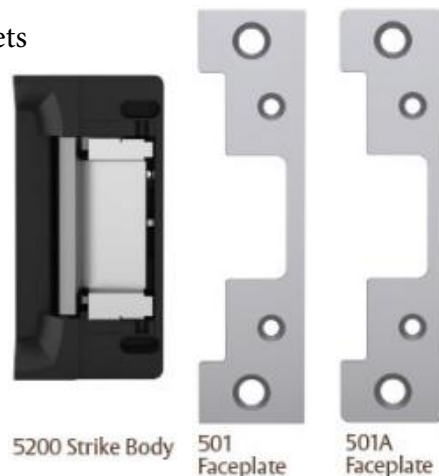

#### Hes 9400 Electric Strike for exit device

14240063	Hes 9500 Rim Exit Electric Strike 630
----------	---------------------------------------

#### Hes 5200 Electric Strike for cylindrical locks

14205200	Hes 5200C Complete Pac 630
----------	----------------------------

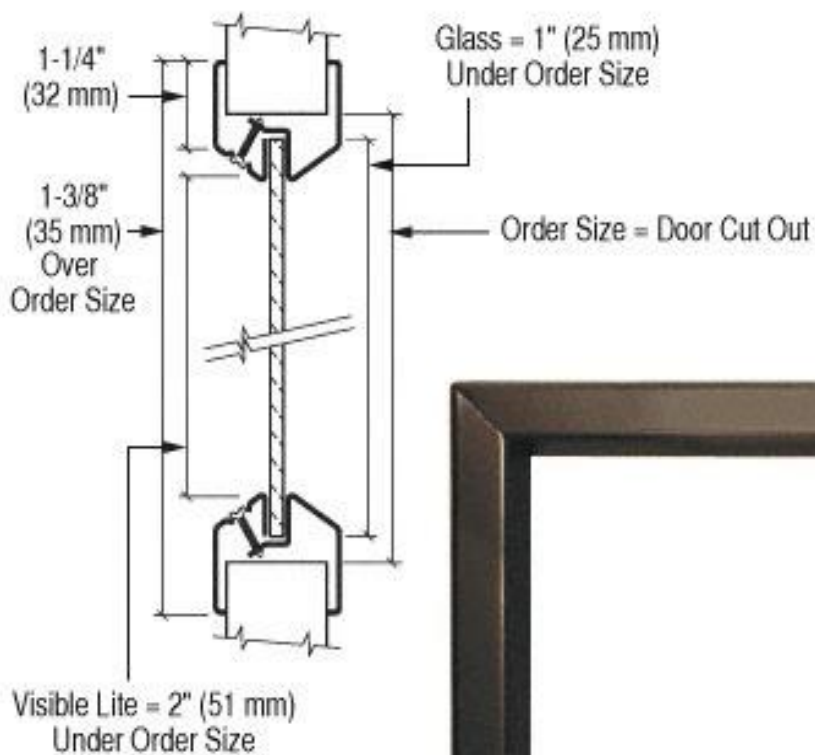

Glass thickness varies

\*



24 x 30 Vision Kit		
14800641	VSIG2430B	INSUL TEMP PAK 1" O.A. INSULATED GLASS
14202430	VSL2430B	TEMP PAK 1/4" TEMP GLASS
14806273	VSL 2430B	PFF PAK 90 MIN FIRE RATED

6 x 27 Vision Kit		
14800642	VSIG627B	INSUL TEMP PAK 1" O.A. INSULATED GLASS
14200627	VSL627B	TEMP PAK 1/4" TEMP GLASS
14800643	VSL627B	PFF PAK 90 MIN FIRE RATED

# Hinge & Strike Comparison Chart

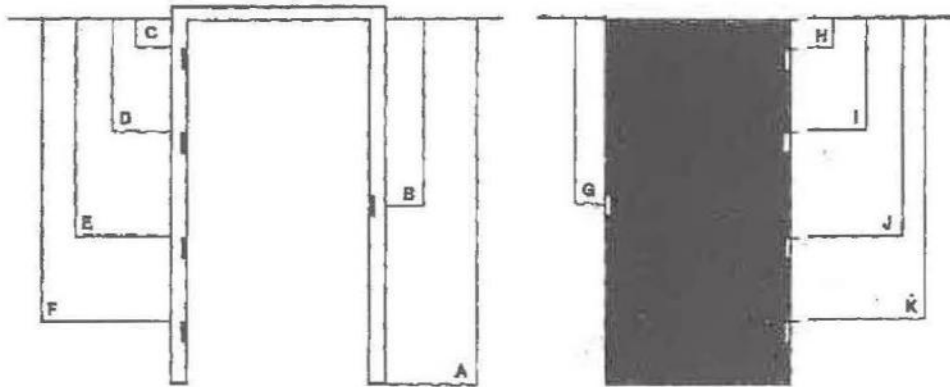

STOCK  
ITEMS ARE  
HIGHLIGHTED

MANUFACTURER	A	B	C	D	E	F	G*	H	I	J	K
Republic	6'8"	39-11/16	7 1/2	37-7/16	67-3/8		39-9/16	7 3/8	37-5/16	67-1/4	
	7'0"	43-11/16	9 1/2	39-7/16	69-3/8		43-9/16	9 3/8	39-5/16	69-1/4	
	7'2"	45-11/16	9 1/2	40-7/16	71-3/8		45-9/16	9 3/8	40-5/16	71-1/4	
	8'0"	55-11/16	5	30-1/2	56	81-1/2	55-9/16	4 7/8	30-3/8	55-7/8	81-3/8
Ceco	6'8"	38-3/16	6 3/4	37-3/4	68-3/4		38-1/16	6 5/8	37-5/8	68-5/8	
	7'0"	42-3/16	6 3/4	39-3/4	72-3/4		42-1/16	6 5/8	39-5/8	72-5/8	
	7'2"	44-3/16	6 3/4	40-3/4	74-3/4		44-1/16	6 5/8	40-5/8	74-5/8	
	8'0"	54-3/16	6 3/4	32-3/4	58-3/4	84-3/4	54-1/16	6 5/8	32-5/8	58-5/8	84-5/8
Mesker	6'8"	39-11/16	5	35-1/4	65-1/2		39-9/16	4 7/8	35-1/8	65-3/8	
	7'0"	43-11/16	5	37-1/4	69-1/2		43-9/16	4 7/8	37-1/8	69-3/8	
	7'2"	45-11/16	5	38-1/4	71-1/2		45-9/16	4 7/8	38-1/8	71-3/8	
	8'0"	55-11/16	5	30-1/2	56	81-1/2	55-9/16	4 7/8	30-3/8	55-7/8	81-3/8
Pioneer	6'8"	42	5	35-1/4	65-1/2		41-7/8	4 7/8	35-1/8	65-3/8	
	7'0"	46	5	37-1/4	69-1/2		45-7/8	4 7/8	37-1/8	69-3/8	
	7'2"	48	5	38-1/4	71-1/2		47-7/8	4 7/8	38-1/8	71-3/8	
	8'0"	58	5	30-1/2	56	81-1/2	57-7/8	4 7/8	30-3/8	55-7/8	81-3/8
Amweld	6'8"	39-11/16	7 1/2	37-7/16	67-3/8		39-9/16	7 3/8	37-5/16	67-1/4	
	7'0"	43-11/16	7 1/2	39-7/16	71-3/8		43-9/16	7 3/8	39-5/16	71-1/4	
	7'2"	45-11/16	7 1/2	39-7/16	71-3/8		45-9/16	7 3/8	39-5/16	71-1/4	
	8'0"	55-11/16	7 1/2	32-51/64	58-5/64	83-3/8	55-9/16	7 3/8	32-43/64	57-61/64	83-1/4
Steelcraft	6'8"	39-11/16	7 1/2	37-7/16	67-3/8		39-9/16	7 3/8	37-5/16	67-1/4	
	7'0"	43-11/16	7 1/2	39-7/16	71-3/8		43-9/16	7 3/8	39-5/16	71-1/4	
	7'2"	45-11/16	7 1/2	40-7/16	73-3/8		45-9/16	7 3/8	40-5/16	73-1/4	
	8'0"	55-11/16	7 1/2	32-51/64	58-3/32	83-25/64	55-9/16	7 3/8	32-43/64	57-31/32	83-17/64
Curries	6'8"	40	5	35-1/4	65-1/2		39-7/8	4 7/8	35-1/8	65-3/8	
	7'0"	44	5	37-1/4	69-1/2		43-7/8	4 7/8	37-1/8	69-3/8	
	7'2"	46	5	38-1/4	71-1/2		45-7/8	4 7/8	38-1/8	71-3/8	
	8'0"	56	5	30-1/2	56	81-1/2	55-7/8	4 7/8	30-3/8	55-7/8	81-3/8
Fleming	6'8"	39-11/16	7 1/2	37-7/16	67-3/8		39-9/16	7 3/8	37-5/16	67-1/4	
	7'0"	43-11/16	7 1/2	39-7/16	71-3/8		43-9/16	7 3/8	39-5/16	71-1/4	
	7'2"	45-11/16	7 1/2	40-7/16	73-3/8		45-9/16	7 3/8	40-5/16	73-1/4	
	8'0"	55-11/16	7 1/2	32-51/64	58-5/64	83-3/8	55-9/16	7 3/8	32-43/64	57-61/64	83-1/4
Rediframe	6'8"	40-1/8	8 3/8	37-7/8	67-3/8		40	8 1/4	37-3/4	67-1/4	
	7'0"	44-1/8	8 3/8	39-7/8	71-3/8		44	8 1/4	39-3/4	71-1/4	
Timely	6'8"	40-3/32	8 3/8	37-7/8	67-3/8		39-31/32	8 7/32	37-23/32	67-7/32	
	7'0"	44-3/32	8 11/32	39-27/32	71-11/32		43-31/32	8 7/32	39-23/32	71-7/32	

# ROUGH OPENINGS

## Curries Hollow Metal

### M type 2" face frame- Doors

4-1/4" to 4-1/2" larger than nominal door width and 2-1/4" to 2-1/2" larger than nominal door height.

3-0 Width would be 40-3/8" (+/- 1/8")

6-0 Width would be 76-3/8" (+/- 1/8")

6-8 Height would be 82-3/8" (+/- 1/8")

7-0 Height would be 86-3/8" (+/- 1/8")

### C type 2" face frame- Doors

2-1/8" to 2-1/4" larger than nominal door width and 3/4" to 1" larger than nominal door height.

3-0 Width would be 38-3/16" (+/- 1/16")

6-0 Width would be 74-3/16" (+/- 1/16")

6-8 Height would be 80-7/8" (+/- 1/8")

7-0 Height would be 84-7/8" (+/- 1/8")

### M type 2" face frame- Borrowed lites

4-1/2" larger than glass opening size

3-0 Width & Height would be 40-1/2"

5-0 Width & Height would be 64-1/2"

### C type 2" face frame- Borrowed lites

2-1/2" larger than glass opening size

3-0 Width & Height would be 38-1/2"

5-0 Width & Height would be 62-1/2"

## Timely door frames

Nominal door width + 1-1/4"

Nominal door Height + 1"

3-0 Width would be 37-1/4"

6-0 Width would be 73-1/4"

6-8 Height would be 81"

7-0 Height would be 85"

## Omni door frames

Nominal door width + 1-1/2"

Nominal door Height + 1" from finished floor

3-0 Width would be 37-1/2"

6-0 Width would be 73-1/2"

6-8 Height would be 81" from finished floor

7-0 Height would be 85" from finished floor

# SINGLE OPENINGS - TO HAND A DOOR - STAND FROM THE OUTSIDE OR KEY SIDE.

## LEFT HAND

Hinges on left opens inward



## RIGHT HAND

Hinges on right opens inward



## LEFT HAND REVERSE

Hinges on left opens outward



## RIGHT HAND REVERSE

Hinges on right opens outward



# DOUBLE OPENINGS - TO HAND A DOOR - STAND FROM THE OUTSIDE OR KEY SIDE.

## LEFT HAND

Hinges on left opens inward

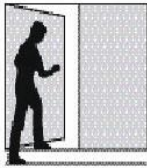

## RIGHT HAND

Hinges on right opens inward

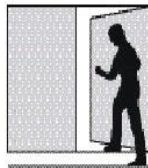

## LEFT HAND REVERSE

Hinges on left opens outward

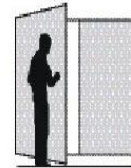

## RIGHT HAND REVERSE

Hinges on right opens outward

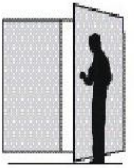

**SPACE PLUS™**  
A division of the Sliding Door Company

### ALASKA

Spenard Builders  
4412 Lois Dr.  
Anchorage, AK 99517  
t 907-261-9280  
kfurlong@sbsalaska.com  
See map: Google Maps

Anchorage Millwork is the Alaska distributor for Space Plus Doors and wall systems, the systems can be used in both residential and commercial interior applications. Space Plus specializes in room dividers, barn doors, privacy walls, swinging doors, suspended systems and pass through windows. This system fits the trend for a more modern interior look. Available by special order.



# WINDOW & DOOR INSTALLATION AND REPLACEMENT

IMPROVING THE HOMES OF ALASKA FOR OVER 60 YEARS



A SERVICE PROVIDED BY SPENARD BUILDERS SUPPLY

CALL OR EMAIL  
FOR A **FREE**  
ESTIMATE!

**AMY GARNER**  
SBS INSTALLATION SERVICES  
PHONE: 907.646.9416

[SBSINSTALL@SBSALASKA.COM](mailto:SBSINSTALL@SBSALASKA.COM)

**VISIT OUR WEBSITES:**  
[WWW.PROBUILD.COM](http://WWW.PROBUILD.COM)  
[WWW.SBSALASKA.COM](http://WWW.SBSALASKA.COM)

## Certified Installation by SBS InstallationMasters™

InstallationMasters certification ensures your windows achieve peak performance.

- Energy Savings
- No air or water leakage
- Protection from water damage and mold growth



Our performance-crafted, Energy Star-qualified windows in vinyl, wood, fiberglass or aluminum help protect your home from the elements and enhance the comfort and value of your home.

## THE SBS ADVANTAGE

### • FREE IN-HOME CONSULTATION

We will provide options for your home and your budget, including recommendations on safety glazing and egress requirements.

### • SBS PREFERRED PRICING

We offer preferred pricing to help you accomplish your window replacement goals. Free screens are also included with every window order from SBS.

### • SBS PROJECT TEAMWORK

Our team will manage your project from ordering to installation. We guarantee the highest standards in installation, job-site safety and quality control.

### • PROFESSIONAL INSTALLATION

Our installers have completed the InstallationMasters™ program.

### • FINAL INSPECTION

Our final inspection check-list will include product maintenance and warranties. Your satisfaction is guaranteed.



**spenard builders supply**

# SKU INDEX

## Frames - Timely 54A

Sku	Description
14111003	TIMELY 3-0 WTW 54A HEAD
14111004	TIMLEY 6-8 WTW 54A FRAME REV
14111007	TIMELY 7-0 WTW 54A FRAME REV
14111010	TIMELY 2-8 WTW 54A HEAD
14111011	TIMELY 2-6 WTW 54A HEAD

## 73A

Sku	Description
14111012	TIMELY 2-8 WTW 73A HEAD
14111013	TIMELY 2-6 WTW 73A HEAD
14111005	TIMELY 3-0 WTW 73A HEAD
14111006	TIMELY 6-8 WTW 73A FRAME REV
14111008	TIMELY 7-0 WTW 73A FRAME REV

## Curries C-Frame

Sku	Description
14253466	C16 5-7/8" 6068 REV H5 FRAME
14253467	C16 5-7/8" 6070 REV H5 FRAME
14253470	C16 5-7/8" 3070 FRAME LH CURRI
14253471	C16 5-7/8" 3070 FRAME RH CURRI
14253472	C16 5-7/8" 3068 FRAME LH CURRI
14253473	C16 5-7/8" 3068 FRAME RH CURRI

## M-Frame

Sku	Description
14253468	M16 5-3/4" 3068 FRAME LH CURRI
14253469	3068 5-3/4" RH M-FRAME
14253476	M16 5-3/4" 3070 FRAME LH CURRI
14253477	M16 5-3/4" 3070 FRAME RH CURRI
14253495	M16 5-3/4" 6068/E18/H5 REV FRA
14253496	M16 5-3/4" 6070/E18/H5 REV FRA
14253504	M16 5-3/4" 3070 LH/A60 WELDED

## Omni

Sku	Description
DSFSGL90	STEEL FRAME 90 MIN RATED DOOR
DSFSGLNR	STEEL FRAME NON-RATED DOOR

## Doors Prefinished

Sku	Description
PFEB2668	2668 P4 RN BIRCH, LDI CLEAR
PFEB2868	2868 P4 RN BIRCH, LDI CLEAR
PFEB3068	3068 P4 RN BIRCH, LDI CLEAR
PFEB3070	3070 P4 RN BIRCH, LDI CLEAR
DEO2668SBS	2668 SBS OAK EXT. BLANK
DEO2868SBS	2868 SBS OAK EXT. BLANK
DEO3068SBS	3068 SBS OAK EXT. BLANK
DWC3070SRO	3070 CLEAR RED OAK

## Curries

Sku	Description
14130687	3-0X6-8 CURRIES 707S G2/ED
14130689	3-0X7-0 CURRIES 707S G2/ED
14253488	3070 18GA G11 FLUSH CURRIES
14253489	3068 18GA G11 FLUSH CURRIES

## Hinges

Sku	Description
14100168	FBB168 4.5X4.5 26D HINGE
14100179	FBB179 4.5X4.5 US26D BB HINGE
17302060	2060 4.5X4.5 26D SPRING HINGE
14100190	FBB191 4.5X4.5 US32D BB HINGE

## NRP

Sku	Description
14100169	FBB168 4.5X4.5 NRP26D HINGE
14100180	FBB179 4.5X4.5 NRP US26D BB HI
14100181	FBB191 4.5X4.5 NRP US32D BB HI
14100182	FBB199 4.5X4.5 BB NRP US32D HI
14100183	FBB199 5X4.5 NRP US32D HINGE

## Closers Extra Heavy Duty

Sku	Description
17321191	QDC111 XTRA H/D CLOSER 689 TRI
17323034	QDC115 689 CLOSER (EDA)

## Heavy Duty

Sku	Description
17321190	QDC211F 689 TRI-PACK CLOSER

# SKU INDEX

## Standard Duty

Sku	Description
17323031	QDC311 F 689 TRI PACK CLOSER

## Exit

Sku	Description
17361072	4903A-630 EXIT TRIM ONLY NIGHT
17361074	4908A-630 EXIT TRIM ONLY KEYLO
17352518	2101-630 EXIT ONLY
17352523	FL-2101-630 EXIT RATED
17352521	4914A-630 PASSAGE

## Exit Heavy Duty

Sku	Description
17331190	QED311 689 36" EXIT DEVICE
17323029	QED313 689 36" RIM EXIT F/R
17323041	QED314 689 SVR EXIT HEX DOGGED

## Trim Heavy Duty

Sku	Description
17321193	QET330 PNN PASSAGE TRIM 689
17321194	QET360PNN 689 SC KEYED
17321199	QET370PNN 689 SC KEYED

## Cyl Locks Standard Duty

Sku	Description
17323026	QCL230 PNN PASS LEVER 626
17323027	QCL240 PNN PRIV LEVER 626
17321201	QCL250 PNN ENTRY LEVER 613
17323028	QCL250 PNN ENTRY LEVER 626
17327090	QCL270PNN STORE RM LEVER 626

## Deadbolt

Sku	Description
17352503	83T7K-STK-626-LC DEAD BOLT
17361148	83T7L-STK-626-DB-LC DEADBOLT
17362623	QDB180 K2 DEADBOLT 626

## Strike

Sku	Description
17323032	26D K2 4-7/8 ASA STRIKE

## 9K

Sku	Description
17352507	9K370L15D-S3-626 LVR PRIVACY
17352508	9K30N15D-S3-626 LVR PASSAGE
17352510	9K37AB15D-S3-626-LC LVR ENTRAN
17352511	9K37D15D-S3-626-LC LVR STORAGE
17352512	9K37R15D-S3-626-LC LVR CLASSRO

## 7K

Sku	Description
17361124	7KC30L15DS3-626-LC LVR PRIVACY
17361125	7KC30N15D-S3-626-LC LVR PASSAG
17361127	7KC37AB15DS3-626-LC LVR ENTRAN
17361129	73KC7R15DS3-626-LC LEVER

## Mullion

Sku	Description
17361189	MKR822-600 MULLION KIT
17352515	M822-600-8 REM. MULLION

## Thresholds

Sku	Description
14425236	252X5AFG-36" TB THRSHOLD 7-1/8
14425272	252X5AFG-72" TB THRSHOLD 7-1/8
14517236	172A-36 THRESHOLD
14518102	252X4AFG-72" TB THRSHOLD 6-1/8
14525231	%252X3AFG-72" TB THRSHLD 5-1/8
145252336	252X3AFG-36" TB THRSHOLD 5-1/8
145252337	252X4AFG-36" TB THRSHOLD 6-1/8
145254436	254X4AFG 36" THRESHOLD
145254472	254X4AFG-72" THRESHOLD
14527136	271A-36 THRESHOLD
14527172	271A-72 THRESHOLD
14527236	272A-36" THRESHOLD
14527272	272A-72" THRESHOLD
145274872	2748A-72" THRESHOLD
14527636	276A-36 THRESHOLD
14272127	276A-72 THRESHOLD 7"

# SKU INDEX

## Sweeps

SKU	Description
1451806136	18061CNB-36" BRUSH SWEEP
1451806184	18061CNB-84" BRSH MEET STL SEA
4531536	315CN-36" NEOPRENE SWEEP

## Adjustable Sweep

SKU	Description
14521736	217AV-36 DOOR SWEEP

## Door Bottom

SKU	Description
14518103	4131 ARL-36 AUTO DOOR BOTTOM

## Gasketing

SKU	Description
14520008	HSS2000XS88D-18
14168266	S88D 21' BRZ SMOKE GASKET
25951841	S88D17 17' PKG ROLL GASKET

## Brush Gasketing

SKU	Description
145450613684	45061CNB-36"X84" BRUSH W/S SET
145450617284	45061CNB7284 BRUSH W/S SET

## Heavy Duty Preimeter Gasketing-Head Section

SKU	Description
145289136	2891AS36 HEAD W/S
145289172	2891AS72 HEAD W/S

## Heavy Duty Perimeter Gasking-Standard Jam

SKU	Description
145290284	290AS 84" 2/LEG W/S 5/EA

## Astragal

SKU	Description
14435784	357SP84 1/8X2X84 OVERLAP ASTRA
14429784	297AS84 SPLIT BULB ASTRAGAL 28/EA

## Surface Bolt

SKU	Description
14500580	#580 SURFACE BOLT 8" US32D

## Flush Bolt

SKU	Description
14500555	#555 FLUSH BOLT 12" 26D

## Kickplate

SKU	Description
14810343	K1050 10X34 KICK PLATE 32D

## Push Plate

SKU	Description
14500070	#70C 4X16 PUSH PLATE 32D

## Pull Plate

SKU	Description
14500110	110X70C 4X16 PULL PLATE 32D

## Stops Wall

SKU	Description
14500403	#403 WALL STOP US26D CONCAVE
14500404	#406 CONVEX 26D STOP

## Floor

SKU	Description
14500441	441CU 26D COMBO DOME FLOOR STO

## Latch Protector

SKU	Description
14532032	320CLX32D LATCH GUARD

## Door Silencer

SKU	Description
14500608	% 608 ROCKWOOD DOOR SILENCER

## Lite Kit

SKU	Description
14200627	VSL627B TEMP PAK
14202430	VSL2430B TEMP PAK
14800641	VSIG2430B 01 INSUL TEMP PAK
14800642	VSIG627B 01 INSUL TEMP PAK
14800643	VSL627B PFF PAK
14806273	VSL 2430B PFF PAK PLAT

## NOTES

[illegible]



# spenard builders supply

Contact our commercial  
millwork team at 907-261-9317  
Div8@sbsalaska.com



**BEST**

**McKINNEY**



**PEMKO**

**SCHLAGE**

**TIMELY**  
PREFINISHED STEEL DOOR FRAMES  
A DIVISION OF S.D.S. INDUSTRIES, INC.

**CURRIES**

**ROCKWOOD**

**VON DUPRIN**

**STANLEY**  
Security

**LCN**

The Right Products  
at the Right Price -  
No Matter Where  
You Are in Alaska.

## Lois Drive

4412 Lois Drive, Anchorage, Alaska 99517  
Phone: (907) 563-3141 or Toll Free: 1-800-478-3141

Millwork Sales	Phone: (907) 261-9317
Residential Sales	Phone: (907) 563-3141
Commercial Sales	Phone: (907) 563-3141
Rural Sales	Phone: (907) 261-9313
Contractor Counter	Phone: (907) 261-9314
Paint Center	Phone: (907) 261-9186
Design Center	Phone: (907) 261-9318

## Additional Locations:

### Fairbanks

2460 Phillips Field Rd., Fairbanks, Alaska 99701  
Phone: (907) 452-5050

### Galco

10010 Old Seward Hwy., Anchorage, Alaska 99515  
Phone: (907) 261-9380

### Homer

3978 Lake Street, Homer, Alaska 99603  
Phone: (907) 235-8506

### Kenai

40575 K-Beach Road, Kenai, Alaska 99611  
Phone: (907) 283-7584

### Kodiak

1600 Mill Bay Road, Kodiak, Alaska 99615  
Phone: (907) 486-4168

### Palmer

97 E. Inner Springer Loop, Palmer, Alaska 99645  
Phone: (907) 746-7001

### Sitka

104 Smith Street, Sitka, Alaska 99835  
Phone: (907) 747-3339

### Soldotna

48855 Funny River Road, Soldotna, Alaska 99669  
Phone: (907) 262-9143

### Wasilla

1700 West Parks Hwy., Wasilla, Alaska 99654  
Phone: (907) 376-5237

### SBS Eklutna Truss Plant

28373 Denaina Elders Rd  
Phone: (907) 261-9299

### Birchwood Panel Plant

Chugk, AK  
Phone: (907) 688-4161