

BUNA-N RUBBER O-RINGS

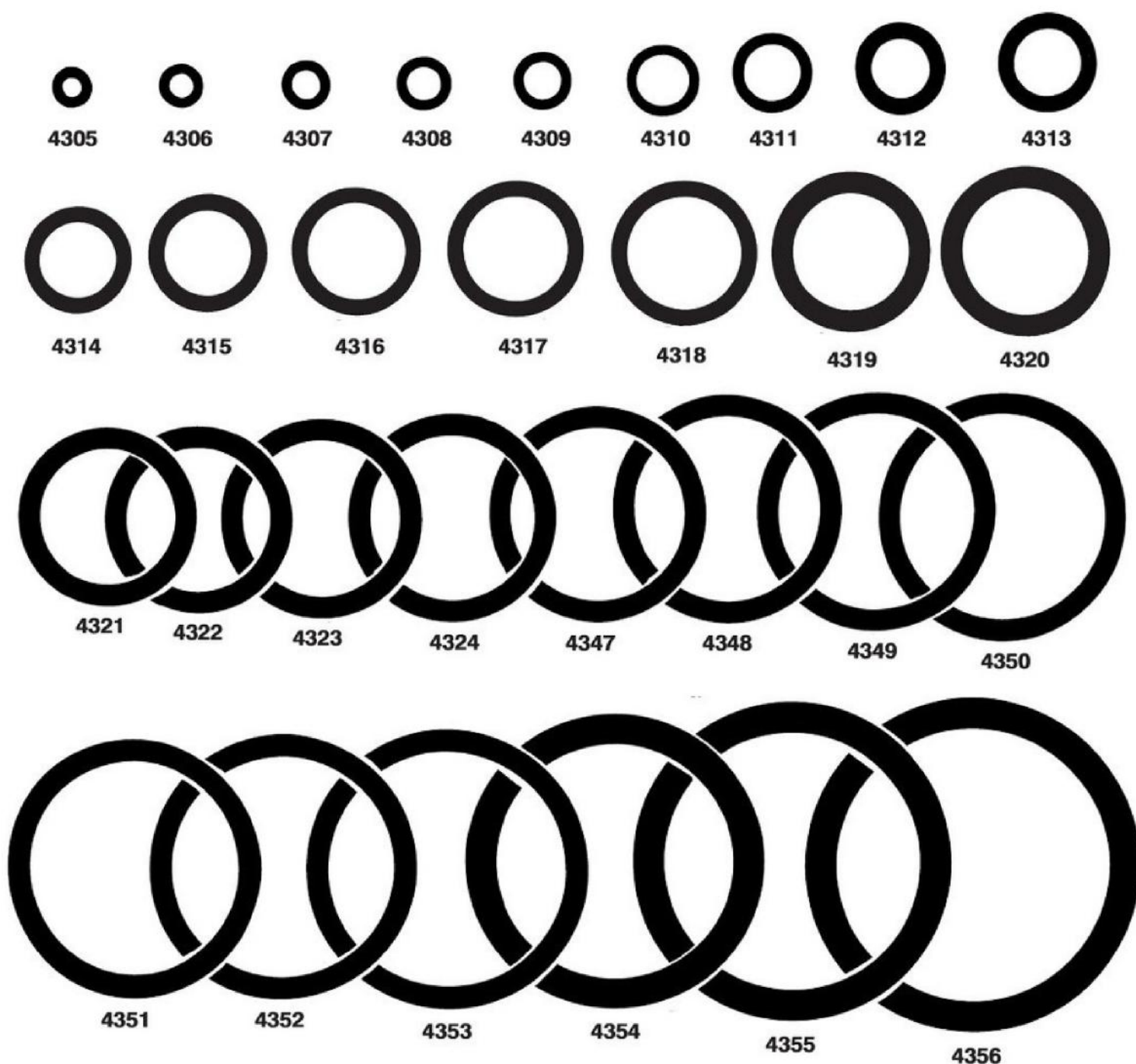

Part No.	Ind. Std.	I.D.	O.D.	Unit Pkg.
4305 thru 4311		1/8"	1/4"	50
4312 thru 4318		3/16"	5/16"	50
4319 thru 4353		1/4"	3/8"	50
4354 thru 4356		1/2"	11/16"	50
Temperature Rating: 70 hours at 100°C				

Part No.	Ind. Std.	I.D.	O.D.	Unit Pkg.
4305	006	1/8"	1/4"	50
4306	007	5/32"	9/32"	50
4307	008	3/16"	5/16"	50
4308	009	7/32"	11/32"	50
4309	010	1/4"	3/8"	50
4310	011	5/16"	7/16"	50
4311	012	3/8"	1/2"	50
4312	110	3/8"	9/16"	50
4313	111	7/16"	5/8"	50
4314	112	1/2"	11/16"	50
4315	113	9/16"	3/4"	50
4316	114	5/8"	13/16"	50
4317	115	11/16"	7/8"	50
4318	116	3/4"	15/16"	50
4319	210	3/4"	1"	50
4320	211	13/16"	1-1/16"	50
4321	212	7/8"	1-1/8"	50
4322	213	15/16"	1-3/16"	50
4323	214	1"	1-1/4"	50
4324	215	1-1/16"	1-5/16"	50
4347	216	1-1/8"	1-3/8"	25
4348	217	1-3/16"	1-7/16"	25
4349	218	1-1/4"	1-1/2"	25
4350	219	1-5/16"	1-9/16"	25
4351	220	1-3/8"	1-5/8"	25
4352	221	1-7/16"	1-11/16"	25
4353	222	1-1/2"	1-3/4"	25
4354	325	1-1/2"	1-7/8"	25
4355	326	1-5/8"	2"	25
4356	327	1-3/4"	2-1/8"	25

METRIC BUNA-N RUBBER O-RINGS

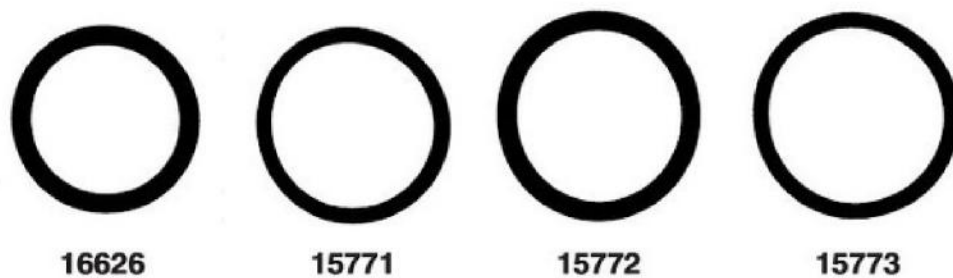
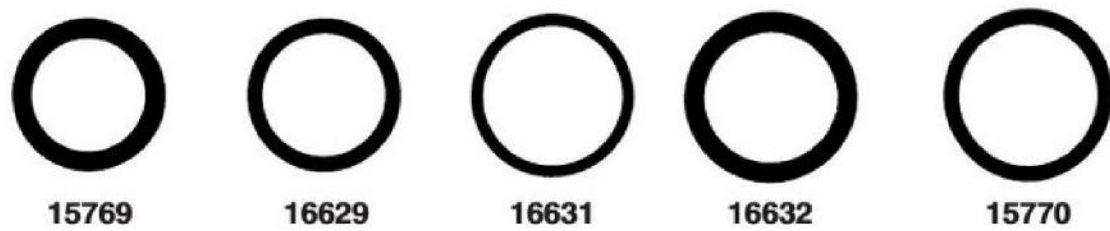
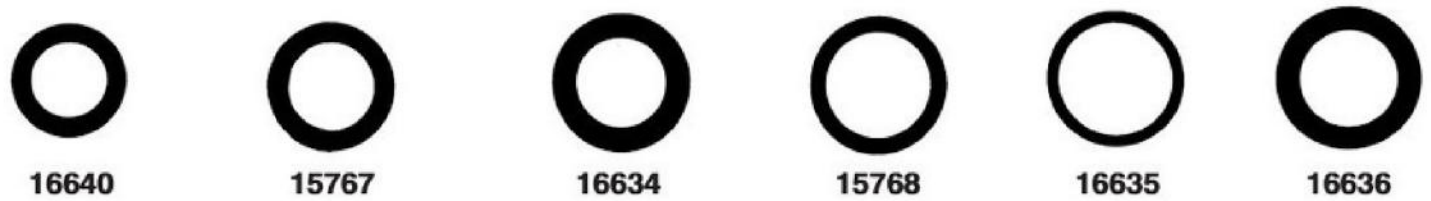
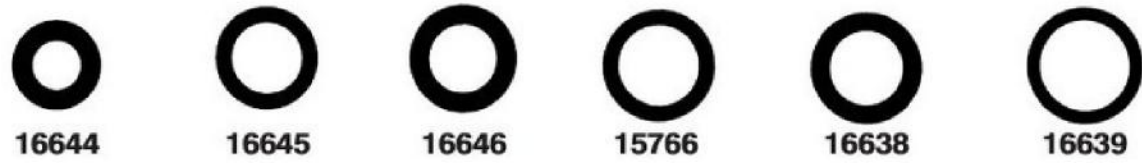
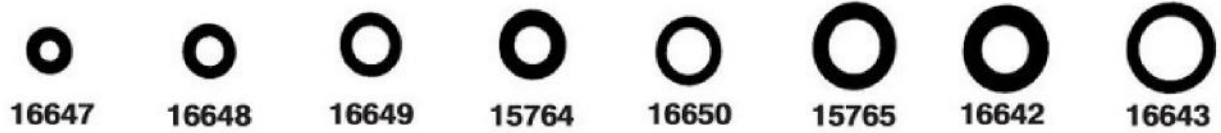

Part No.	Inner Diameter	Outer Diameter	Thickness	Unit Pkg.
16647	2.2mm	5.4mm	1.6mm	50
16648	3.1mm	6.3mm	1.6mm	50
16649	4.1mm	7.3mm	1.6mm	50
15764	4mm	8mm	2mm	100
16650	5mm	8mm	1.5mm	50
15765	6mm	10mm	2mm	100
16642	5.3mm	10.1mm	2.4mm	50
16643	7.1mm	10.3mm	1.6mm	50
16644	5.6mm	10.4mm	2.4mm	50
16645	8mm	12mm	2mm	50
16646	7.6mm	12.4mm	2.4mm	50
15766	9mm	13mm	2mm	100
16638	8.3mm	13.1mm	2.4mm	50
16639	10.1mm	13.3mm	1.6mm	50
16640	8.6mm	13.4mm	2.4mm	50

Part No.	Inner Diameter	Outer Diameter	Thickness	Unit Pkg.
15767	10mm	15mm	2.5mm	100
16634	10mm	16mm	3mm	50
15768	12mm	16mm	2mm	100
16635	13mm	16mm	1.5mm	50
16636	11mm	17mm	3mm	50
15769	13mm	18mm	2.5mm	100
16629	14mm	18mm	2mm	50
16631	16mm	19mm	1.5mm	50
16632	15mm	20mm	2.5mm	50
15770	16mm	20mm	2mm	50
16626	17mm	22mm	2.5mm	25
15771	19mm	23mm	2mm	50
15772	19mm	24mm	2.5mm	50
15773	20mm	24mm	2mm	50

O-RINGS

Air Conditioning O-Rings

For use with R12 Refrigerant only

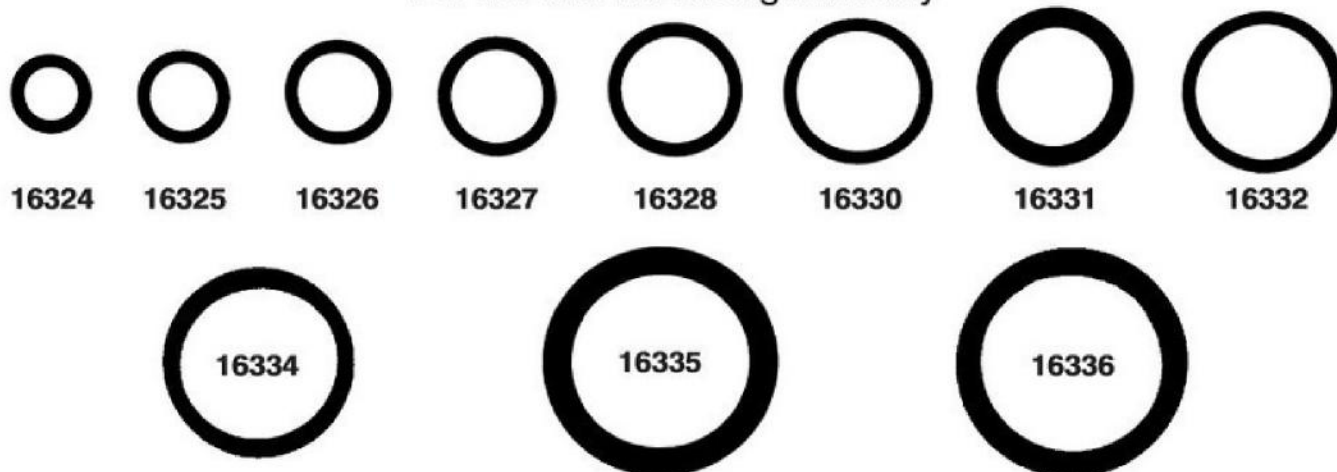

For original air conditioning systems. Not for use with R134A refrigerant.

Part No.	Ind. Std.	I.D.	O.D.	Thick-ness	Unit Pkg.	Part No.	Ind. Std.	I.D.	O.D.	Thick-ness	Unit Pkg.
16324	010	1/4"	3/8"	1/16"	50	16331	113	9/16"	3/4"	3/32"	25
16325	011	5/16"	7/16"	1/16"	50	16332	016	5/8"	3/4"	1/16"	50
16326	012	3/8"	1/2"	1/16"	50	16334	018	3/4"	7/8"	1/16"	25
16327	013	7/16"	9/16"	1/16"	50	16335	211	13/16"	1-1/16"	1/8"	10
16328	014	1/2"	5/8"	1/16"	50	16336	118	7/8"	1-1/16"	3/32"	25
16330	015	9/16"	11/16"	1/16"	50						

Nitrile Air Conditioning O-Rings

For use with R12 & R134A Refrigerant

These O-Rings are either green or black with an orange dot.

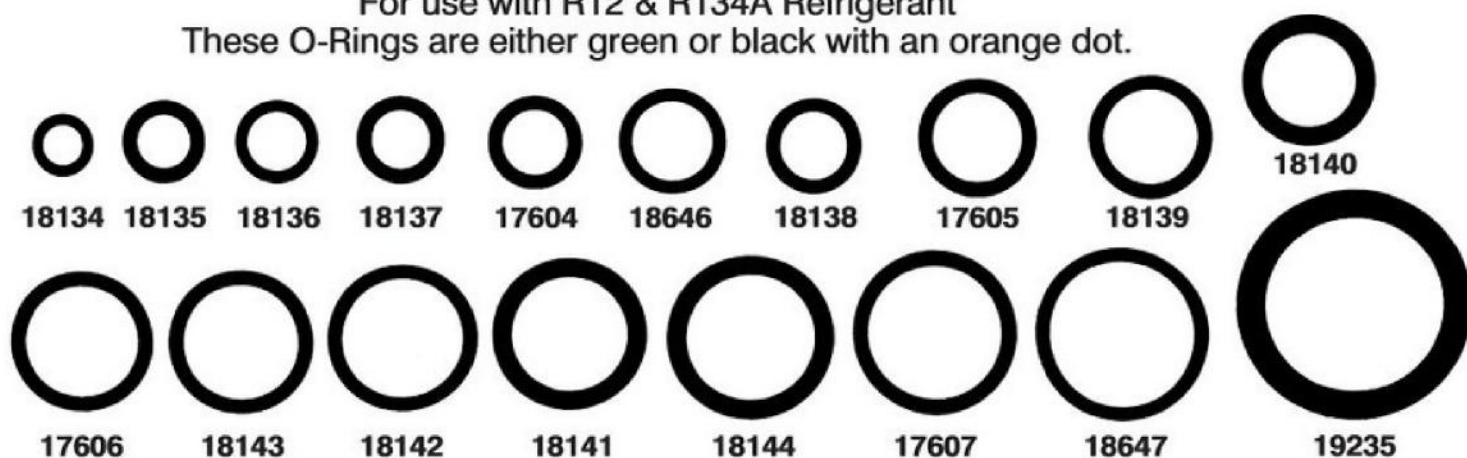

Part No.	I.D.	O.D.	Thickness	OEM No.	Unit Pkg.
18134	4.5mm	7.3mm	1.4mm	Nissan: 92472-N8200	25
18135	6mm	9.6mm	1.8mm	Nissan: 92470-N8200	25
18136	6.5mm	9.5mm	1.5mm	Toyota: 90099-14044	25
18137	6.6mm	10.2mm	1.8mm	Acura: 80873-ST7-000	25
17604	.290"	.432"	.071"	Ford: 391396	25
18138	7.7mm	11.3mm	1.8mm	Nissan: 92474-N8200	25
18646	.375"	.500"	.063"		25
17605	.400"	.546"	.073"	Ford: 391397	25
18139	10.8mm	14.4mm	1.8mm	Nissan: 92471-N8200	25
18140	10.7mm	15.5mm	2.4mm	Acura: 80872-ST7-000	25
				Nissan: 92475-W1000	
17606	.509"	.655"	.073"	Ford: 391304	25
18143	13.4mm	17.2mm	1.9mm	Toyota: 90099-14045	15
18142	14mm	17.6mm	1.8mm	Nissan: 92473-N8200	25
18141	13.3mm	18.1mm	2.4mm	Acura: 80871-ST7-000	25
18144	14.8mm	19.6mm	2.4mm	Nissan: 92475-W2100	15
17607	.617"	.769"	.076"	Ford: 391305	15
18647	.688"	.813"	.063"		25
19235	13/16"	1-1/16"	1/8"		10

O-RINGS & GROMMETS

Blue Neoprene Air Conditioning O-Rings

Teflon Coated • For use with R134A & R12 Refrigerant



18533



18534



18535



18536



18537

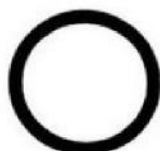

18539

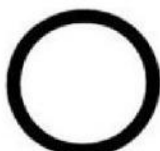

18540

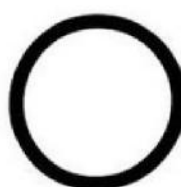

18543



19666

Part No.	Industry Standard	Inner Diameter	Outer Diameter	Thickness	Unit Pkg.
18533	108	1/4"	7/16"	3/32"	25
18534	011	5/16"	7/16"	1/16"	25
18536	110	3/8"	9/16"	3/32"	25
18537	013	7/16"	9/16"	1/16"	25
18539	112	1/2"	11/16"	3/32"	25
18540	015	9/16"	11/16"	1/16"	25
18543	017	11/16"	13/16"	1/16"	25
19666	115	11/16"	7/8"	3/32"	25

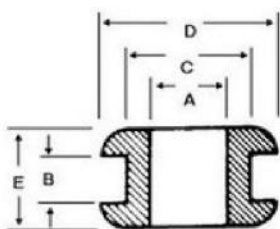

Rubber Grommet

Made of SBR Material • Durometer Hardness 60

UNIT PACKAGE: 25



Part No.	A Bore Dia.	B Groove Width	C Groove Dia.	D Outside Dia.	E Overall Thickness
4408	1/8"	3/32"	3/8"	1/2"	5/16"
4410	5/32"	1/16"	1/4"	3/8"	3/16"
4411	5/32"	3/32"	1/4"	7/16"	3/8"
4413	3/16"	1/16"	5/16"	1/2"	1/4"
4414	3/16"	3/32"	9/32"	3/8"	5/16"
4415	3/16"	1/4"	5/16"	7/16"	3/8"
16454	1/4"	1/16"	3/8"	1/2"	3/16"
4417	1/4"	1/16"	7/16"	5/8"	3/16"
4418	1/4"	1/16"	1"	1-1/4"	1/4"
4419	5/16"	1/16"	7/16"	9/16"	3/16"
4420	5/16"	1/16"	9/16"	13/16"	5/16"
16455	5/16"	1/16"	3/4"	1"	5/16"
4421	5/16"	1/8"	9/16"	13/16"	3/8"
4422	5/16"	1/4"	9/16"	13/16"	1/2"
4423	3/8"	1/16"	1/2"	11/16"	9/32"

Part No.	A Bore Dia.	B Groove Width	C Groove Dia.	D Outside Dia.	E Overall Thickness
16456	3/8"	1/16"	5/8"	7/8"	11/32"
4425	3/8"	1/16"	1"	1-1/4"	1/4"
4426	3/8"	1/4"	5/8"	7/8"	1/2"
16457	7/16"	1/16"	9/16"	3/4"	1/4"
4428	1/2"	3/32"	3/4"	31/32"	9/32"
4429	1/2"	3/32"	25/32"	1"	11/32"
16458	1/2"	1/8"	3/4"	1"	1/2"
4430	1/2"	1/4"	13/16"	1-1/16"	1/2"
4431	5/8"	1/8"	7/8"	1-1/8"	3/8"
4432	5/8"	1/16"	7/8"	1-1/8"	5/16"
4433	3/4"	1/16"	15/16"	1-1/8"	1/4"
4434	3/4"	1/16"	1-1/16"	1-3/8"	3/8"
4435	3/4"	1/16"	1-1/4"	1-5/8"	1/4"
4436	3/4"	1/4"	1-1/4"	1-5/8"	7/16"

GROMMETING & TIRE VALVES

Vinyl Grommet

- Black Vinflex 163
- Exceptional Aging Qualities
- High Dielectric Properties
- Oil Resistant
- Non-Conductive
- Durometer Hardness 60
- Excellent Resistance to
- Ozone and Sunlight

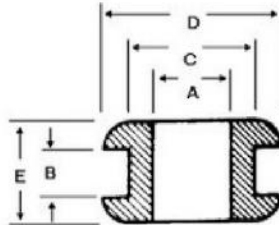

14765

- "A" Bore Diameter: 5/16"
- "B" Groove Width: 1/16"
- "C" Groove Diameter: 7/16"
- "D" Outside Diameter: 5/8"
- "E" Overall Thickness: 1/4"

UNIT PACKAGE: 50

Tubeless Tire Valves



Length: 1-1/4"
Rim Hole: 29/64"
(TR413)

10184

UNIT PACKAGE: 5

10191

UNIT PACKAGE: 25

10192

UNIT PACKAGE: 100

PICKUP TRUCK CAP WEATHERSTRIP TAPE

Photo not actual size



Closed-cell foam weatherstrip tape. Used on the bottom lip of the cap or the truck's flange to form a moisture, dust and vibration resistant seal. Features an aggressive acrylic adhesive.

**Exact Size
Profile**



20922

Light Gray

1-1/4" Width x 30 Ft. Length
Thickness: 3/16"

UNIT PACKAGE: 1 Roll

SPONGE WEATHERSTRIPS

Peel-Bak Adhesive Neoprene Sponge Weatherstrip

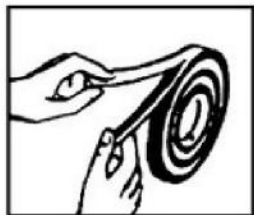

Peel back liner.

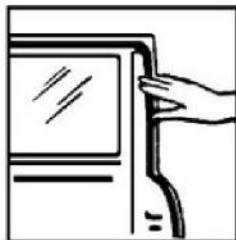

Press on clean dry surface

Peel-Bak is a light-weight closed cell sponge material. It is an easy to apply weatherstrip for auto and household use. Can also be used on boats, refrigerators or any place a weatherproof, permanent seal is required. Simple to use: Peel back the liner tape and press into place. No cement or tacking required. Surface must be clean and dry.



Photo not actual size

Thickness	Width	Part No.	Part No.
		10 Ft. Roll	50 Ft. Roll
5/32"	3/8"	4800	4850
5/32"	1/2"	4801	4851
5/32"	5/8"	4802	
5/32"	3/4"	4803	4852
5/32"	1"	4804	4853
5/16"	3/8"	4805	4854
5/16"	1/2"	4806	4855
5/16"	5/8"	4807	
5/16"	3/4"	4808	4856
5/16"	1"	4809	4857
7/16"	3/8"	4810	4858
7/16"	1/2"	4811	4859
7/16"	3/4"	4812	4860
7/16"	1"	4813	4861

Exact Size Profile

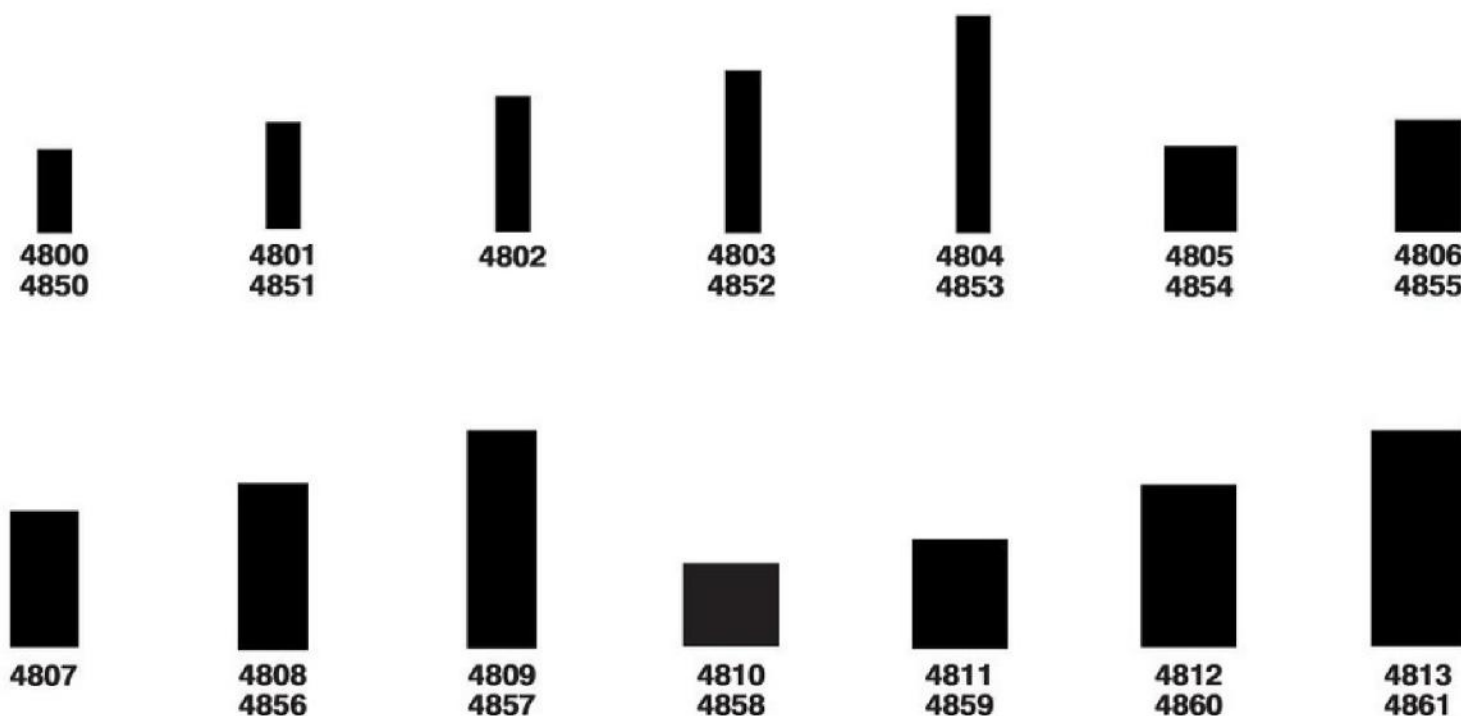

WEATHERSTRIPS

PVC Foam Adhesive Weatherstrips

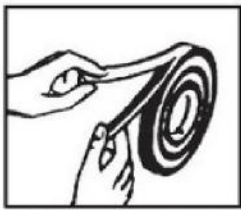

Peel back liner.

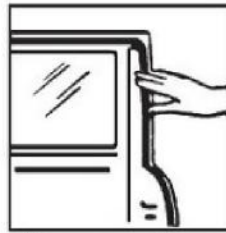

Press on clean dry surface

Photo not actual size



Low density, PVC (polyvinyl chloride) foam weatherstrip with a permanent acrylic adhesive for easy application even on irregular or curved surfaces. Seals out air, moisture, dust and light. It is also cushioning against vibration and noise. Remains flexible at -20° C to 80° C (-4° F to 176° F).

Color: Light Gray

Thickness	Width	10 Ft. Roll		50 Ft. Roll	
		Part No.	Part No.	Part No.	Part No.
3/16"	1/2"	20912			
5/16"	3/4"	20914		20915	
5/16"	1"	20916		20917	
7/16"	3/4"	20918		20919	
7/16"	1"	20920			

Exact Size Profile



Sponge Rubber Weatherstrips

EPDM Closed Cell • Light Weight • Weather Resistant



16390

Door Flange Weatherstrip
GM, Ford & Chrysler
Cars & Trucks

UNIT PACKAGE: 15 Ft.



4675

Same as 16390 except for unit package quantity

UNIT PACKAGE: 50 Ft.



4707

Door Flange Weatherstrip
Chrysler 1954-50
Ford 1958-50

UNIT PACKAGE: 50 Ft.



4747

Door Inner Belt Weatherstrip
All Cars 1970-55

UNIT PACKAGE: 50 Ft.



16395

Trunk & Rear Deck Gutter Weatherstrip
GM

UNIT PACKAGE: 15 Ft.



4703

Same as 16395 except for unit package quantity

UNIT PACKAGE: 50 Ft.



4731

Door Flange Weatherstrip
GM 1954-53
Universal

UNIT PACKAGE: 50 Ft.



16392

Door Flange Weatherstrip
Ford 1955-On

UNIT PACKAGE: 15 Ft.



4745

Same as 16392 except for unit package quantity

UNIT PACKAGE: 50 Ft.

SPONGE RUBBER WEATHERSTRIPS

EPDM Closed Cell • Light Weight • Weather Resistant



4742

Trunk & Lid
Weatherstrip
GM 1959 - On
Ford 1949 - On
Studebaker 1967 - 55



UNIT PACKAGE: 50 Ft.



16394

Deck Lid
Weatherstrip
GM 1956 - On



UNIT PACKAGE: 15 Ft.

4749

Same as 16394 except for unit package quantity.

UNIT PACKAGE: 50 Ft.



16391

Door Flange Weatherstrip
GM: 1955 - On



UNIT PACKAGE: 15 Ft.

4744

Same as 16391 except for unit package quantity.

UNIT PACKAGE: 50 Ft.



16393

Door Flange
Weatherstrip
Chrysler 1958 - On



UNIT PACKAGE: 15 Ft.

4746

Same as 16393 except for unit package quantity.

UNIT PACKAGE: 50 Ft.



16890

Door Flange
Weatherstrip
Ford 1956 - 53



UNIT PACKAGE: 25 Ft.

16891

Same as 16890 except for unit package quantity.

UNIT PACKAGE: 50 Ft.



4743

Trunk
Weatherstrip
Universal



UNIT PACKAGE: 35 Ft.

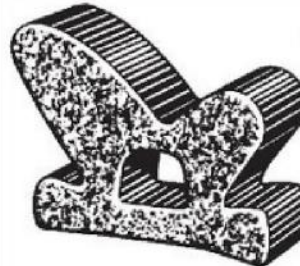

16892

Roof Rail Weatherstrip
GM 1977 - 68



UNIT PACKAGE: 25 Ft.



4750

(C5AZ-6243720-B)

Deck Lid
Weatherstrip
Ford 1956 - On



UNIT PACKAGE: 50 Ft.

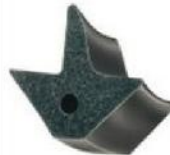

20928

Door Flange,
Trunk & Tail Gate
Weatherstrip
Hole Diameter: 3/32"
Universal



UNIT PACKAGE: 25 Ft.



16525

Door Seal Weatherstrip
GM 1963 - 55



UNIT PACKAGE: 50 Ft.



**Extruded Closed Cell
Sponge Rubber**

Will not absorb water or moisture.
Without Cement.

19341

Exact Size Profile 

1/8" Thick - 3/4" Wide

UNIT PACKAGE: 25 Ft.

4740

Exact Size Profile 

1/8" Thick - 1-1/2" Wide

UNIT PACKAGE: 25 Ft.

SPONGE RUBBER WEATHERSTRIPS

EPDM Closed Cell • Light Weight • Weather Resistant



Closed Cell Half Round Sponge Rubber

UNIT PACKAGE: 50 Ft.



4736

1/4" Half Round



4737

3/8" Half Round



4738

1/2" Half Round



Closed Cell Sponge Rubber Windlace Cord

Flexible filler for cloth covered
windlace on door, windshield
pillars and door bottoms.

UNIT PACKAGE: 50 Ft.



4654

1/4" Diameter



4655

3/8" Diameter



4656

1/2" Diameter

RUBBER BUMPERS & GROMMETS



4280

(3745361, 3762180)

License Plate Bumper
GM

UNIT PACKAGE: 25



4260

(17562)

Windshield Wiper Rubber Grommet
Inner Diameter: 11/32"
Outer Diameter: 5/8"
Thickness: 3/16"
Ford

UNIT PACKAGE: 25



4246

(357811)

Gas Tank Lid Rubber Bumper
Ford

UNIT PACKAGE: 25



4242

(4137121)

Trunk, Rear Deck Lid, &
Hood Bumper
GM

UNIT PACKAGE: 25



4243

(513388)

Hood to Ledge Bumper
GM

UNIT PACKAGE: 25



4265

(3711168)

Door Lock Striker Plate, Window Glass
Stop & License Plate Bumper
GM

UNIT PACKAGE: 25



4188

(4081765)

Door & Quarter Glass and
Door Opening Header Bumper
GM

UNIT PACKAGE: 25



4237

(3664645)

General Purpose
GM

UNIT PACKAGE: 25



4235

(3688811)

Hood Top Panel Side
Bumper to Fender
GM

UNIT PACKAGE: 25



4248

(16758)

General Purpose
Ford

UNIT PACKAGE: 25

RUBBER BUMPERS & GROMMETS



4258
(352839)

General Purpose
Ford

UNIT PACKAGE: 25



4447
(7724826)

Trunk Lid Bumper
GM

UNIT PACKAGE: 10



13967

General Purpose
Outer Diameter: 1/2"
Head Height: 5/16"
Fits into 1/4" Hole
Durometer: 55-65

UNIT PACKAGE: 25



4446
(4872948)

Trunk Lid Bumper
GM

UNIT PACKAGE: 25



4264
(4564974)

Front Door Bumper
GM

UNIT PACKAGE: 25



4441
(4565591, 7637192)

Front Door Bumper
GM

UNIT PACKAGE: 25



4357
(C60Z-16758-A)

Hood to Fender Bumper
Ford

UNIT PACKAGE: 25



4233
(3655015)

General Purpose
GM

UNIT PACKAGE: 25



4273
(B7A-16758-A)

Hood Bumper
Ford

UNIT PACKAGE: 25



4369
(3900684, 15029828)

Pillar Bumper
GM Trucks

UNIT PACKAGE: 25



4249
(1304225)

General Purpose
GM

UNIT PACKAGE: 25



4250
(3693292)

Glove Box Door Bumper
GM

UNIT PACKAGE: 25



4155
(16758A)

General Purpose
Ford

UNIT PACKAGE: 25



4244
(972724)

General Purpose
Chrysler

UNIT PACKAGE: 25

RUBBER BUMPERS & GROMMETS



4204
(4023030)

General Purpose
Ford & Chrysler

UNIT PACKAGE: 25



4240
(4563173, 4565415)

Door Bumper
GM

UNIT PACKAGE: 25



4236
(3689084)

General Purpose
GM

UNIT PACKAGE: 25



4281
(4721222)

Trunk Lid Bumper
GM

UNIT PACKAGE: 25



20698
Black Rubber

Cigarette Lighter Safety Plug
Used to replace unwanted
cigarette lighters. Prevents
accidental shocks and burns.
Discourages smoking in the car.
The tight fit deters removal.

UNIT PACKAGE: 2



15453
(472450, 12338034)

Hood Bumper
Across the Flats: 1"
Diameter: 15/16"
Overall Length: 1-29/32"
GM X Cars 1980 - On

UNIT PACKAGE: 10



4474
(400764, 400765)

5/16-18 x 2-1/8"
Hood Adjusting Bolt & Bumper
GM

UNIT PACKAGE: 5

4473

Same as 4474 except for unit package quantity

UNIT PACKAGE: 10



16849
(Not Supplied by O.E.M.)
Nylon

Hood Adjustment Nut
Threaded Insert: M6-1.0
Ford 1989 - On

UNIT PACKAGE: 10

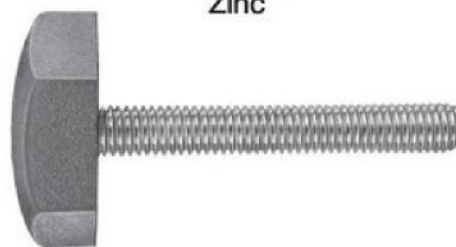

16850
(Not Supplied by O.E.M.)
Zinc

M6-1.0 x 44mm
Hood Adjustment Bumper
Hex: 23mm
Ford 1989 - On

UNIT PACKAGE: 5



16832
(E83Z-16758-A)

Hood Adjustment Nut & Bumper
Ford 1989 - On

UNIT PACKAGE: 2 Sets

DOOR SEALS, WINDOW SEALS & CHANNELS



Door Seals

Years	Vehicle	Application	O.E.M. Number	Part No.
1991-73	Blazer, Jimmy & Suburban	Driver & Passenger Rear Side	15606409, 15227654, 15227655	20792
1987-73	Pickup	Driver & Passenger Side	15606409, 15227654, 15227655	20792



Window Channels



Years	Vehicle	Application	O.E.M. Number	Part No.
1991-73	Blazer, Jimmy & Suburban	Complete Glass Run with metal clip Front – Driver Side	14027777	20793
1991-73	Blazer, Jimmy & Suburban	Complete Glass Run with metal clip Front-Passenger Side	14027778	20794
1987-73	Pickup	Complete Glass Run with metal clip Front-Driver Side	14027777	20793
1987-73	Pickup	Complete Glass Run with metal clip Front-Passenger Side	14027778	20794

Belt Weatherstrips



Years	Vehicle	Application	O.E.M. Number	Part No.
1991-81	Blazer, Jimmy & Suburban	Inner-Driver Side	15569071	20797
1991-81	Blazer, Jimmy & Suburban	Inner-Passenger Side	15569072	20798
1991-73	Blazer, Jimmy & Suburban	Outer-Driver Side	14027775	20799
1991-73	Blazer, Jimmy & Suburban	Outer-Passenger Side	14027776	20800
1987-81	Pickup	Inner-Driver Side	15569071	20797
1987-81	Pickup	Inner-Passenger Side	15569072	20798
1987-73	Pickup	Outer-Driver Side	14027775	20799
1987-73	Pickup	Outer-Passenger Side	14027776	20800
1980-73	Pickup, Jimmy, Blazer & Suburban	Inner-Driver Side	470433	20795
1980-73	Pickup, Jimmy, Blazer & Suburban	Inner-Passenger Side	470434	20796



Vent Window Seals

Years	Vehicle	Application	O.E.M. Number	Part No.
1980-73	Pickup, Jimmy, Blazer & Suburban	Front Driver Side (Vertical sold separately)	6271903	20801
1980-73	Pickup, Jimmy, Blazer & Suburban	Front Passenger Side (Vertical sold separately)	6271904	20803
1980-73	Pickup, Jimmy, Blazer & Suburban	Rear Vertical-Driver Side	6271905	20802
1980-73	Pickup, Jimmy, Blazer & Suburban	Rear Vertical-Pass. Side	6271906	20804

GLASS SETTING CHANNELS

EPDM Dense Rubber



4511

For 1/8" Glass
Glass Setting Channel
Height: 11/32"
Width at Base: 1/4"
Inside Base: 1/8"

UNIT PACKAGE: 50 Ft.



4512

For 3/16" Glass
Windshield and Rear Window
Glass Setting Channel
Height: 7/16"
Width at Base: 27/64"
Inside Base: 3/16"

UNIT PACKAGE: 50 Ft.



4670

For 1/4" Glass
Windshield &
Rear Window Glass Setting
Channel and Weatherstrip
Ford, Mercury Early Models

UNIT PACKAGE: 50 Ft.



4515

For 1/4" Glass
Glass Setting Channel
Height: 9/16"
Width at Base: 25/64"
Inside Base: 1/4"

UNIT PACKAGE: 50 Ft.



4513

For 1/4" Glass
Windshield and Rear Window
Glass Setting Channel
Height: 7/16"
Width at Base: 31/64"
Inside Base: 1/4"

UNIT PACKAGE: 50 Ft.



4688

For 1/4" Glass
Rear Window Glass
Setting Channel
Chrysler Early Models

UNIT PACKAGE: 50 Ft.



4588

For 1/4" Glass
Windshield and Rear Window
Glass Setting Channel
Height: 9/16"
Width at Base: 7/16"
Inside Base: 1/4"

UNIT PACKAGE: 50 Ft.



4671

For 1/4" Glass
Rear Window Glass
Setting Channel and
Weatherstrip
Chrysler Early Models

UNIT PACKAGE: 50 Ft.

Molded Dense Rubber Tee Rubber Concave Head

UNIT PACKAGE: 50 Ft.



4530

Head: 9/32"
Height: 3/4"

4531

Head: 9/32"
Height: 1"



4581

For 1/4" glass
Windshield Glass Weatherstrip

UNIT PACKAGE: 50 Ft.

Universal Windshield & Rear Window Flex-Fit Rubber Moulding



Photo not actual size

20342

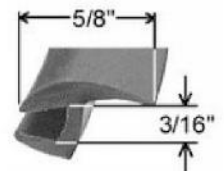

A universal windshield rubber moulding for domestic and import vehicles. Made of EPDM rubber, this moulding contains a butyl bead that adheres to the glass during installation. The profile design allows for the moulding to attach easily to the glass edge and lay evenly on the vehicle body along straight areas and around corners. Extruded with a metal filament to prevent stretching and shrinkage.

UNIT PACKAGE: 15 Feet

EPDM RUBBER WEATHERSTRIP FOR GLASS

Photos not actual size



17509

Glass Thickness: 1/4"
Body Thickness: 1/16"
Self-Locking Type

UNIT PACKAGE: 50 Ft.



17513

Glass Thickness: 1/4"
Body Thickness: 1/8"
Bead Lock Type
Use with
17514

UNIT PACKAGE: 50 Ft.



17510

Glass Thickness: 1/4"
Body Thickness: 1/8"
Self-Locking Type

UNIT PACKAGE: 50 Ft.



17514

Glass Thickness 1/4"
Locking Bead
Use with 17513

UNIT PACKAGE: 50 Ft.

Caps & Hooks

Rubber Caps

Special Heat Resistant EPDM Rubber
Can be used for capping lines and hoses while testing carburetors, emission control systems, vacuum lines, etc



Part No.	Fits Tube O.D.	Inside Length	Unit Pkg.
12209	1/8"	9/16"	25
4440	3/16"	9/16"	25
16264	3/16"	9/16"	100
19000	3/16"	1-1/4"	25
4439	1/4"	9/16"	25
19001	1/4"	1-1/4"	25
19002	5/16"	9/16"	25
12907	5/16"	1-1/4"	25
12210	3/8"	31/32"	25
19003	3/8"	1-1/2"	25
12908	1/2"	11/16"	10

Vinyl Vacuum Caps

Can be used for capping lines and hoses while testing carburetors, emission control systems, vacuum lines, etc. Color coded for size identification.



Part No.	I.D.	Fits Tube O.D.	Color	Length	Unit Pkg.
18202	1/8"	3/16"	Blue	5/8"	50
18203	3/16"	1/4"	Red	5/8"	50
18204	1/4"	5/16"	White	5/8"	50
18205	5/16"	3/8"	Black	5/8"	50

Rubber Hold Down Straps with Hooks



Part No.	Length	Span Range	Unit Pkg.
4448	9"	15" to 20"	10
4449	15"	20" to 30"	10
4450	20"	30" to 40"	10
4451	31"	40" to 55"	10

11298

Galvanized

3/16" x 3"
"S" Hook

Used with
Rubber Hold Down
Straps 4448, 4449,
4450 and 4451

UNIT PACKAGE: 50

11299

Same as 11298 except
for unit package quantity

UNIT PACKAGE: 100

