

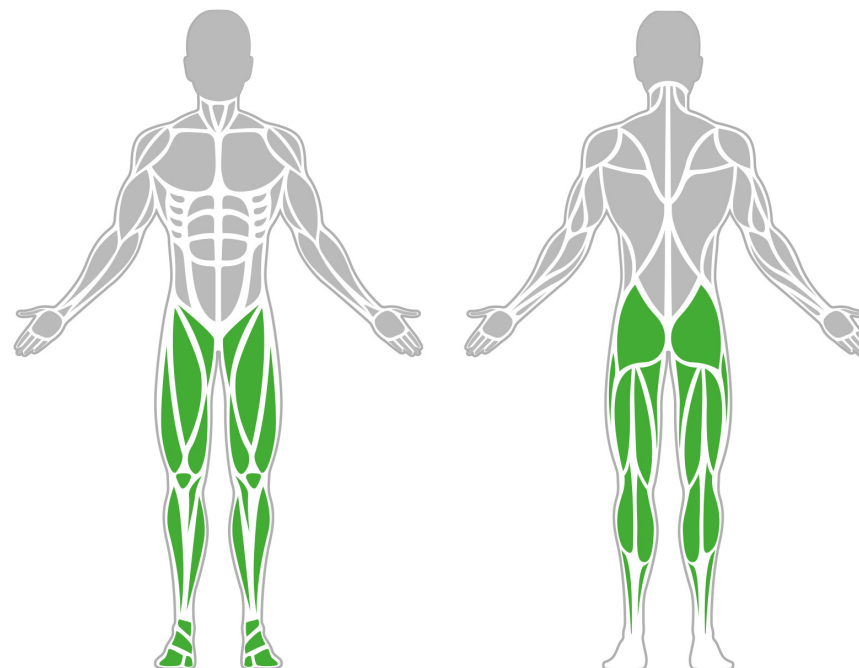

## Muscle Groups Focus



## Jumping Bars Low

The Jumping Bars are a classic obstacle course challenge designed to test explosiveness, coordination, and lower body strength. Participants must jump with precision from one bar to the next, maintaining rhythm and balance while overcoming the sequence of elevated hurdles.

## Attributes

|                  |                      |
|------------------|----------------------|
| Product code     | 1-1-606              |
| Certificate      | EN 16630, ASTM F3101 |
| Age group        | 14 + years           |
| Capacity         | 1 person             |
| Max. weight load | 218.26 lbs           |
| Type             | Obstacle Course      |
| Difficulty level | Medium               |

## Side View

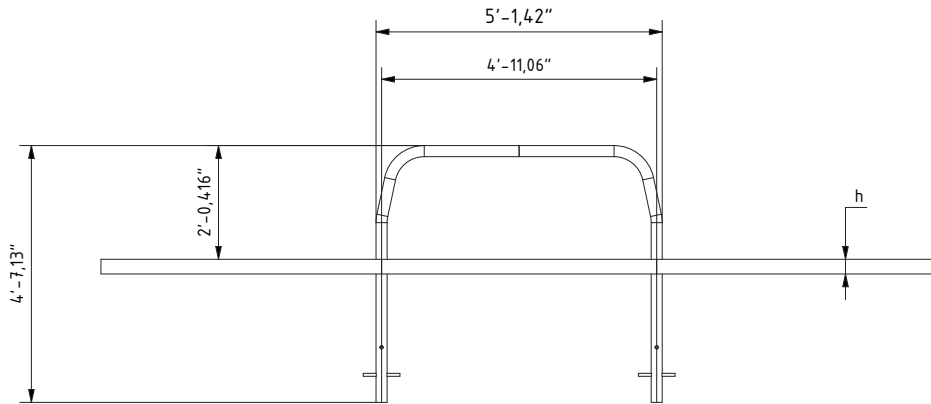

## Plan View

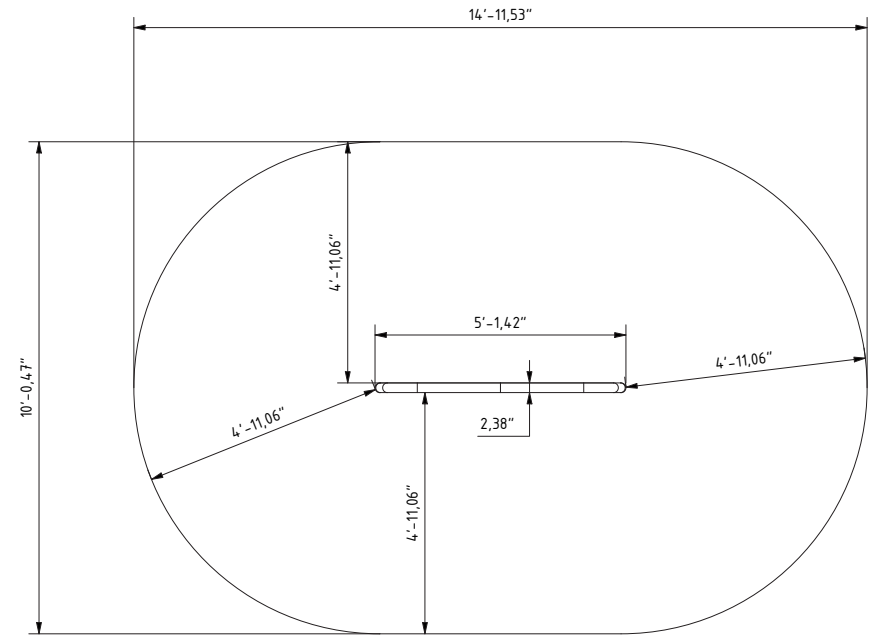

## Installation information

|   |                              |
|---|------------------------------|
| Number of installers (concrete)                                 | At least 2 people            |
| Total installation time (concrete)                              | 80-140 min.                  |
| Number of installers (equipment)                                | At least 2 people            |
| Total installation time (equipment)                             | 60 min.                      |
| Excavation volume   | 18.36 ft <sup>3</sup>        |
| Concrete volume   | 14.13 ft <sup>3</sup>        |
| Size of the base structure                                      | 2 × 19.69" × 19.69" × 31.50" |
| Anchoring options   | In-ground or surface         |
| In combined structures, the volume of concrete required varies. |                              |

## Technical specification

|                     |
|---------------------|
| Safety surface area |
| Net weight          |
| Material            |
| Critic fall height  |
| Color options       |

For more color options, discuss with your sales representative.

|                       |
|-----------------------|
| Around 4.92 ft radius |
| Net weight            |
| Material              |
| 27.56"                |



## Warranty

|   |
|---|
| Structure                                     |
| Steel   |
| Paint   |
| Plastic                                       |
| Rubber  |
| Moving parts                                  |
| Detailed information in the warranty document |

|             |
|-------------|
| 25-15 years |
| 5-10 years  |
| 2 years     |
| 5-10 years  |
| 1-3 years   |
| 2 years     |

## Material specification

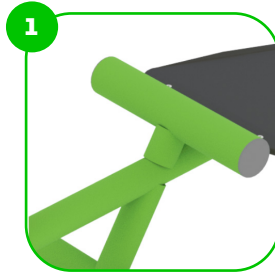

The element is made of high quality S235 steel, which has been cleaned via sandblasting. A corrosion resistant powder coating finish is then applied. Also available with galvanized surface for even greater protection and longevity!

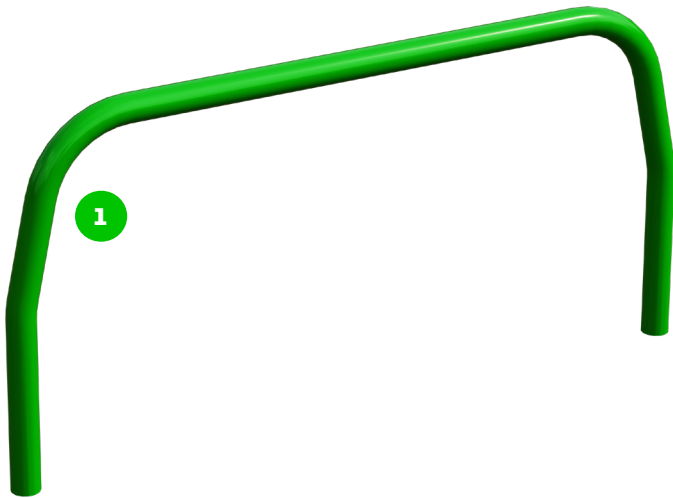

# BESTSTRONG

 [beststrongworld](#)  [beststrongworld](#)  [usa.beststrong.com](#)  [usa@beststrong.com](mailto:usa@beststrong.com)



Sport and fitness products are compliant with the EN16630 and ASTM F3101 Standards.