



ARCHITECTURAL

# PORTFOLIO

SHIVAM RAJPOOT



**01**

CV

**02**

**RESEDENCE**

- 2.1 PLAN
- 2.2 SECTION
- 2.3 ELEVATION

**03**

**DESIGN**

- 3.1 PLAN
- 3.2 SECTION
- 3.3 ELEVATION

**04**

**MEASURE DRAWING**

- 4.1 SHIKARA DETAIL
- 4.2 PILLAR DETAIL
- 4.3 DOOR DETAIL

# CONTENTS

**05**

**SHEETS CPMPOSITION**

- 6.1 RESIDENCE
- 6.2 DESIGN RESIDENCE

**06**

**TWINMOTION**

- 5.1 VIEWS

**07**

**MISCELLANEOUS**

- 7.1 SKETCHES
- 7.2 PHOTOGRAPHY
- 7.3 ACADMICS WORK

# Hello, I'M Shivam Rajpoot



Architecture Student

“Passionate architecture student focused on creative spatial design, architectural visualization, and culturally inspired concepts. Interested in blending traditional architectural elements with modern design thinking to create functional and engaging spaces. Skilled in drafting, digital tools, model making, and visual storytelling through architectural representation”

## EDUCATION

2020-2023

### SENIOR SECONDARY EDUCATION

SHRI VINAYAK SENIOR SECONDARY SCHOOL, ORAI, UTTAR PRADESH

2024-2029

### BACHLOR OF ARCHITECTURAL

AAYOJAN SCHOOL OF ARCHITECTURE , JAIPUR

## SOFTWARES

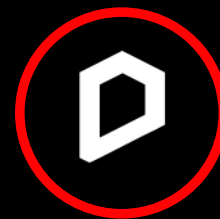

D5



INDESIGN



ADOBE PHOTOSHOP

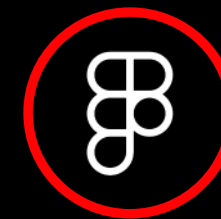

FIGMA



REVIT



AUTOCAD



SKECHUP

## PARTICIPATION

IIDC EXHIBITION 2025  
NASA THROPHY GRIHA 2026  
COA JAIPUR EXHIBITION 2026

## ACADMIC PROJECTS

ONE DAY STAY FOR STUDENTS  
KASHMIR CRAFT CENTRE  
PADHSAALA PRIMARY SCHOOL  
DESIGN  
JAL MAHAL CHOWPATTI

## INTEREST



PHOTOGRAPHY



SKETCHING



TRAVELLING



GAMING



PHONE  
9451956976



GMAIL  
Shivamd16rajpoot@gmail.com



LOCATION  
C-1607 OSIS VENETIA HEIGHTS,  
GREATER NOIDA



SECTION AA'



# FRONT ELEVATION

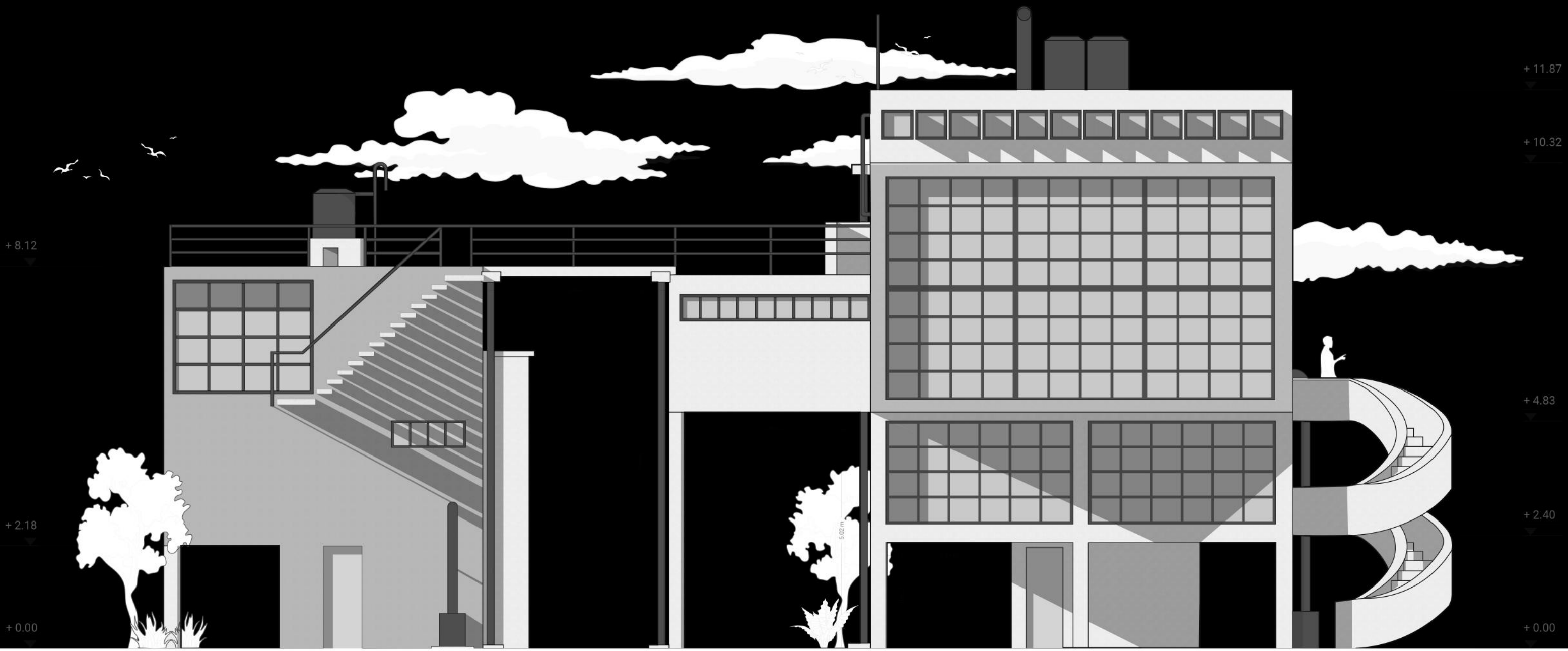

# Ground Floor Plan

- 1. Entrance
- 2. Pool
- 3. Dining & Kitchen
- 4. Livingroom
- 5. Bedroom
- 6. Bathroom







# SHIKHARA ELEVATION (FRONT)

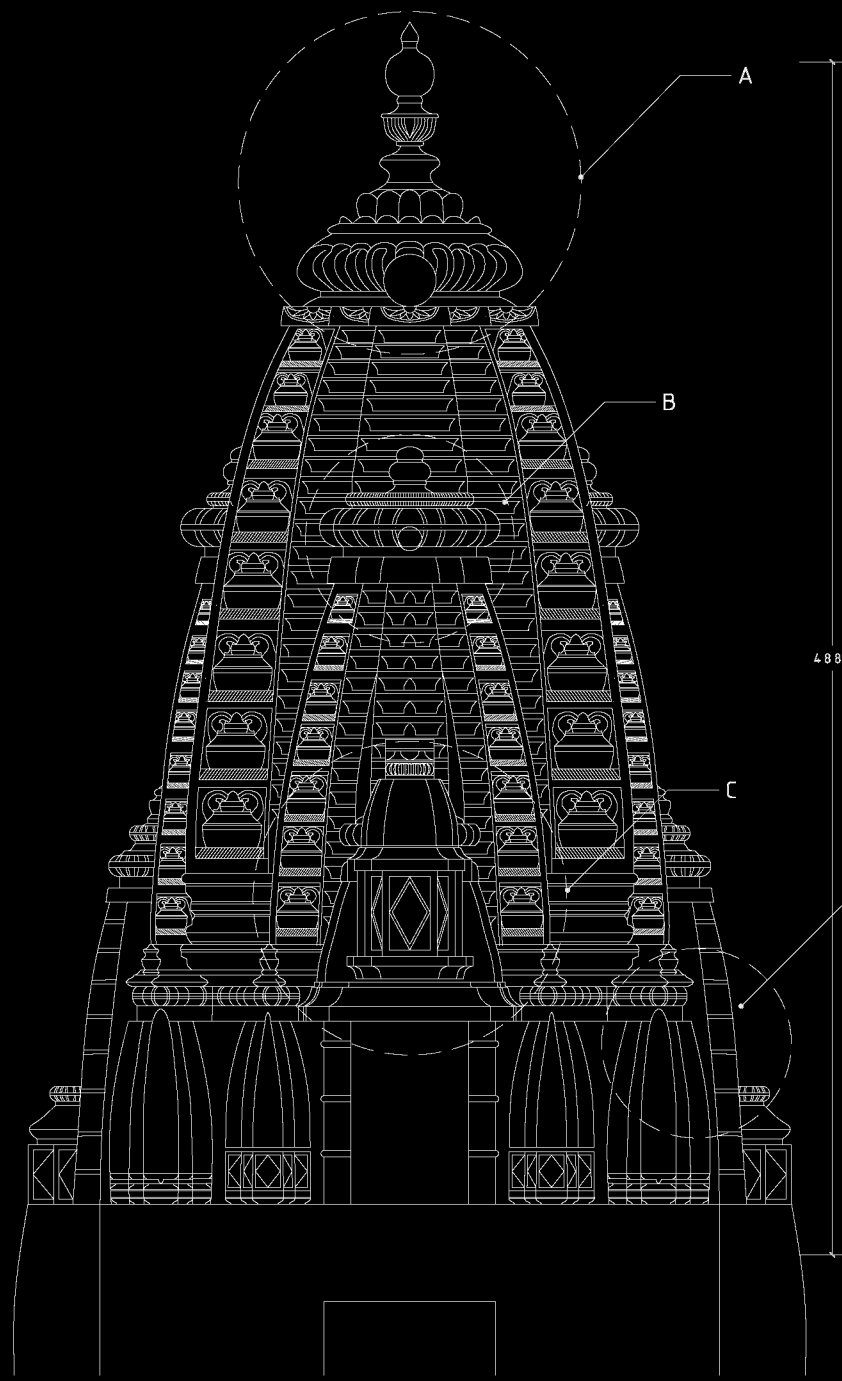

FIRST FLOOR FRONT ELEVATION

# SHIKHARA PLAN

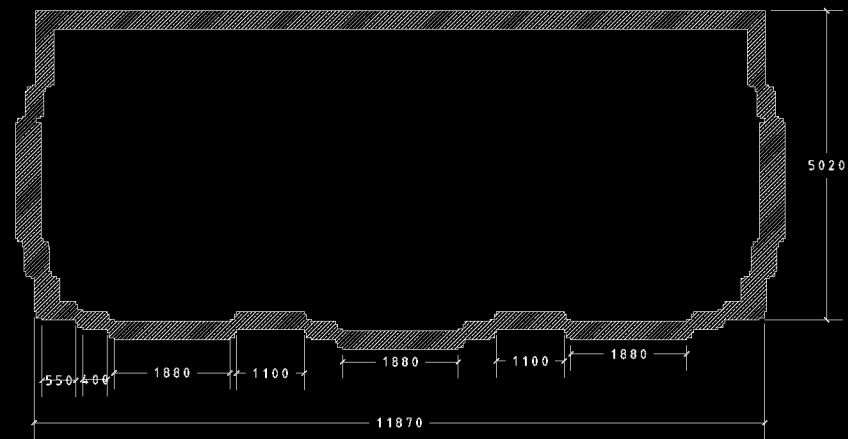

STONE

THE SHIKHARA BELONGS TO THE NAGARA STYLE OF NORTH INDIAN TEMPLE ARCHITECTURE, CHARACTERIZED BY ITS CURVILINEAR FORM AND STRONG VERTICAL EMPHASIS. THE STRUCTURE FOLLOWS A HIERARCHICAL COMPOSITION CONSISTING OF BASE, BODY, AND CROWNING ELEMENTS SUCH AS AMALAKA AND KALASH. THE PROPORTIONS ARE DEFINED BY A GREATER HEIGHT COMPARED TO THE BASE, ALONG WITH A GRADUAL TAPERING AS THE STRUCTURE RISES. REPETITION OF ARCHITECTURAL ELEMENTS CREATES RHYTHM AND BALANCE, RESULTING IN A VISUALLY HARMONIOUS AND SPIRITUALLY EXPRESSIVE FORM

# SHIKHARA ELEVATION (SIDE)

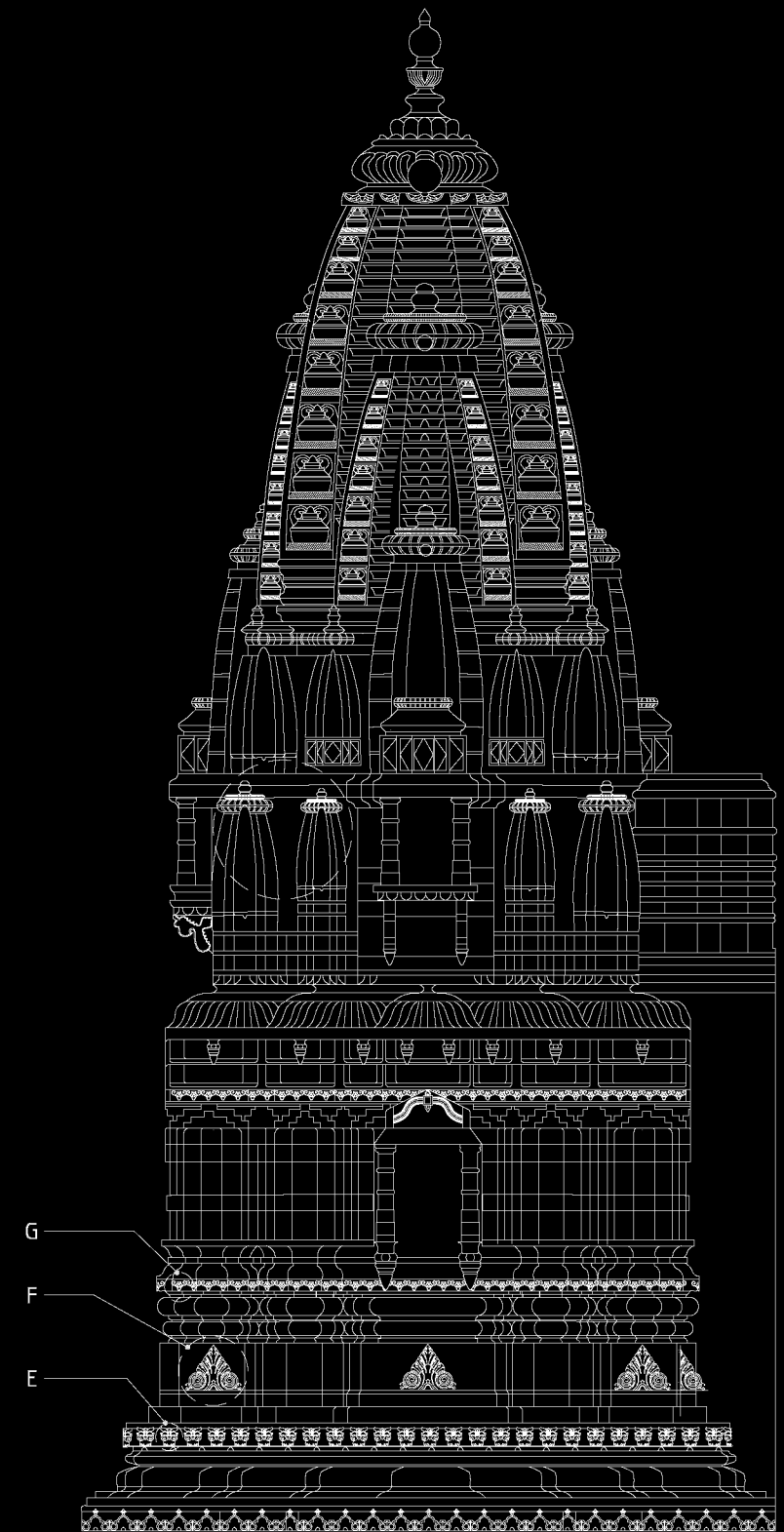

GROUND FLOOR SIDE ELEVATION



DETAIL A

Shikhara Crown Assembly

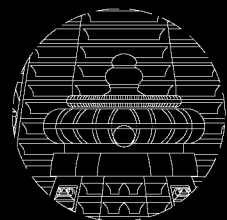

DETAIL B

Amalaka

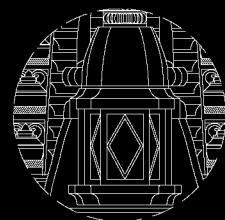

DETAIL C

Urushringa

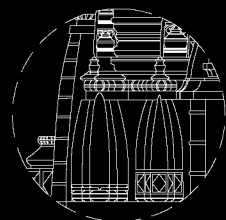

DETAIL D

Miniature Shikhara Motif



DETAIL E

Kirtimukha (Face of Glory)



DETAIL F

Udgam

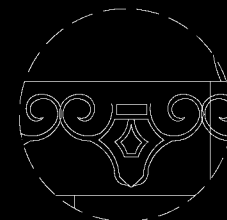

DETAIL G

Lata-Patra Scroll

## DOOR DETAIL (D1)

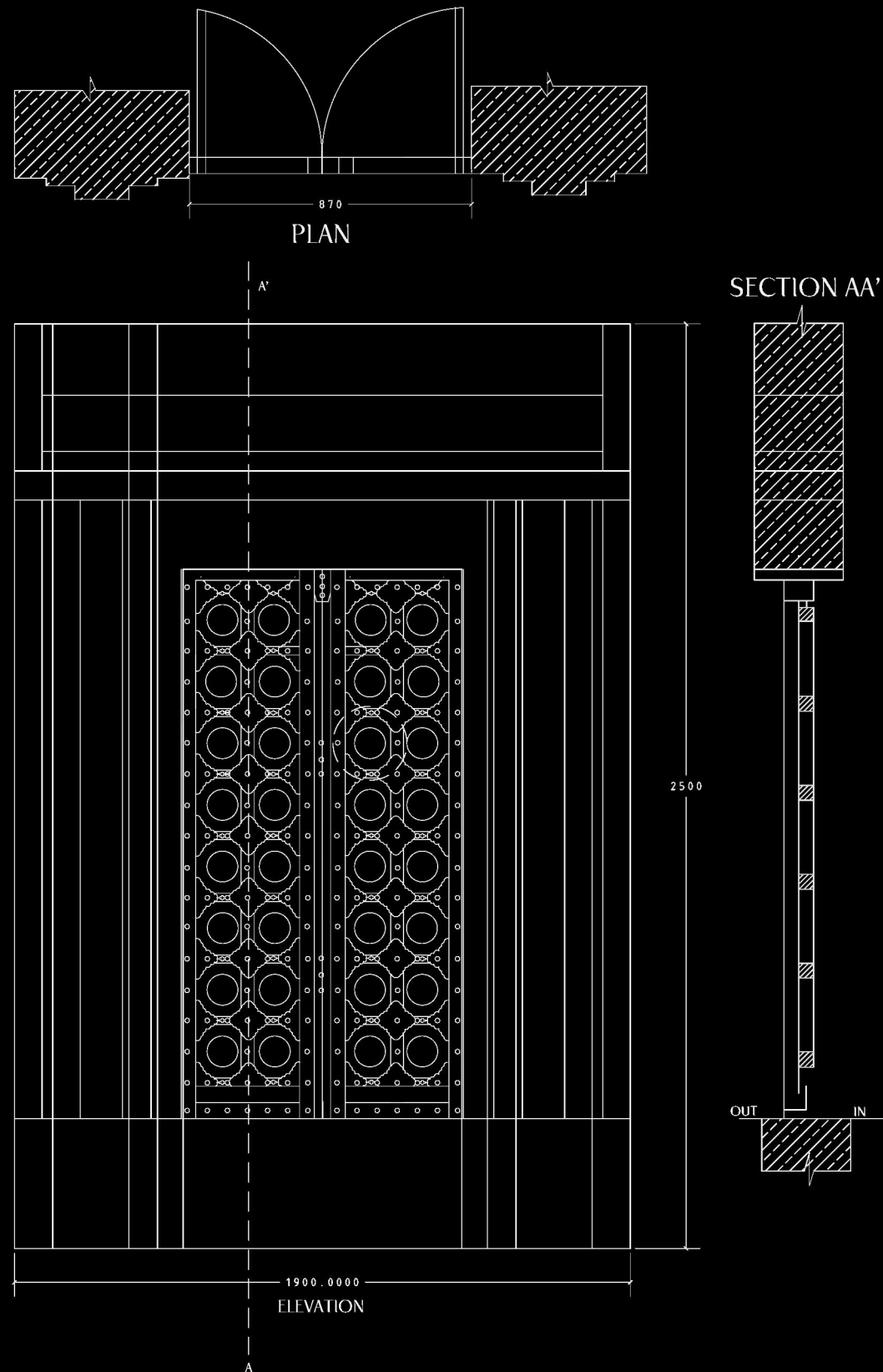

## DOOR DETAIL (D2)

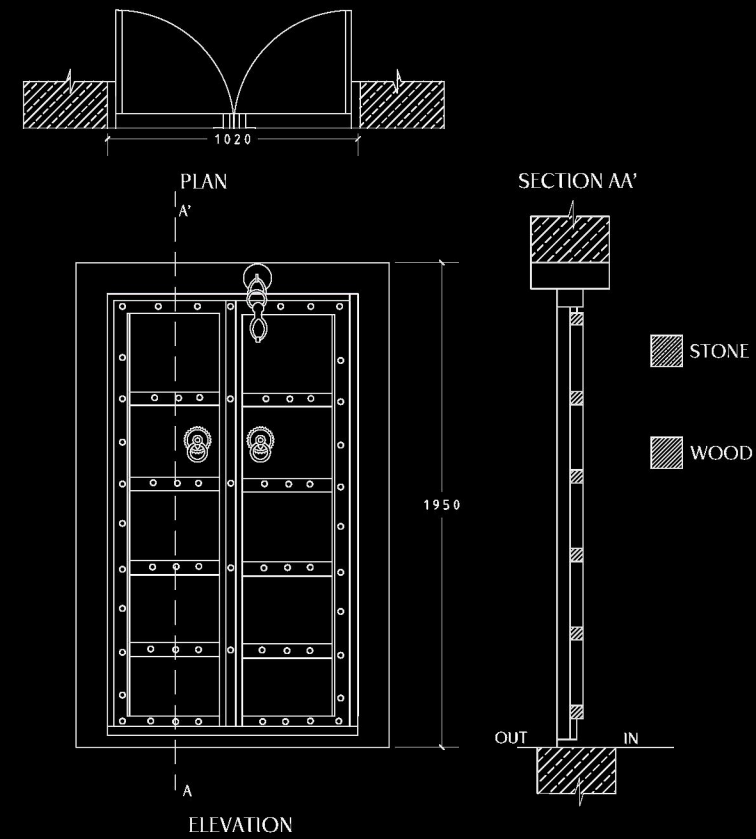

## DOOR DETAIL (D3)

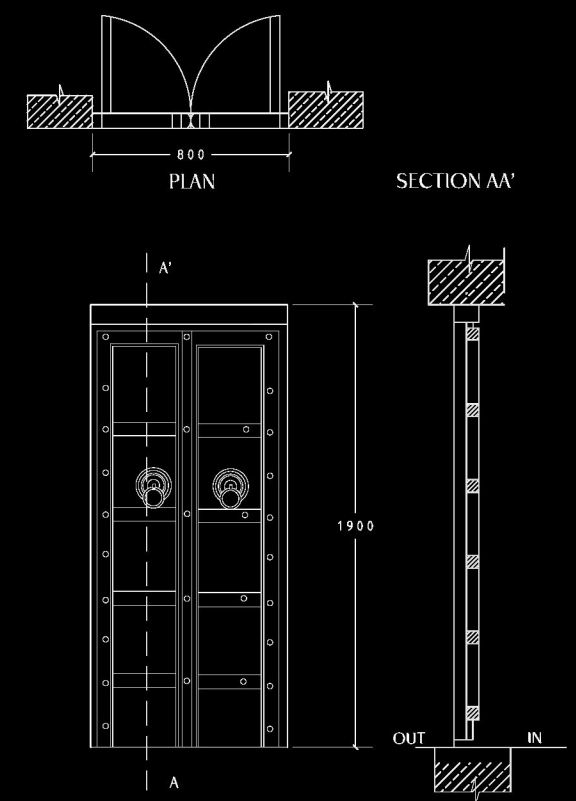

## DOOR DETAIL (D4)

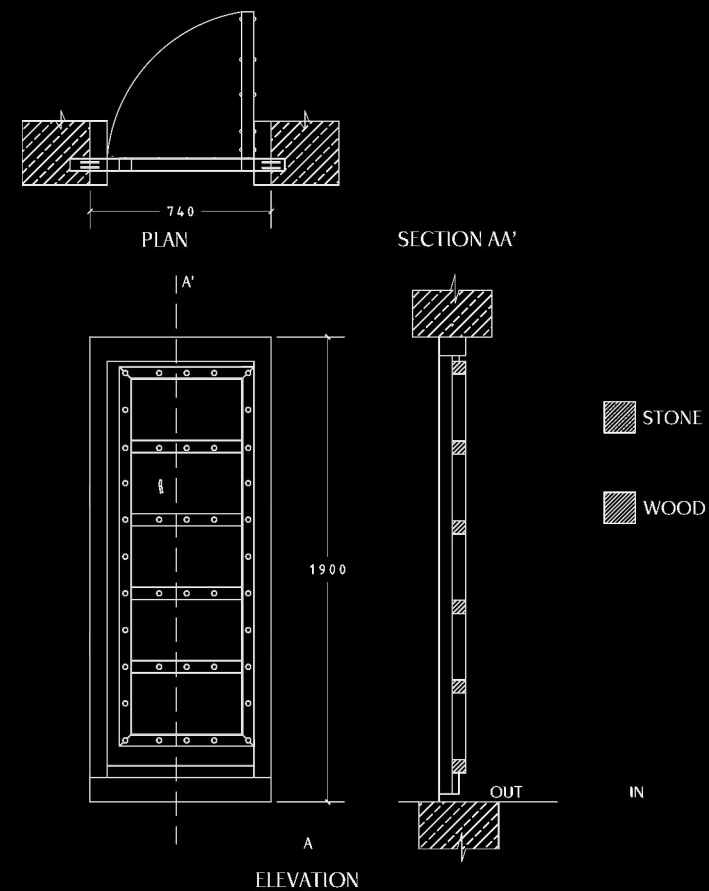

## DOOR DETAIL (D5)

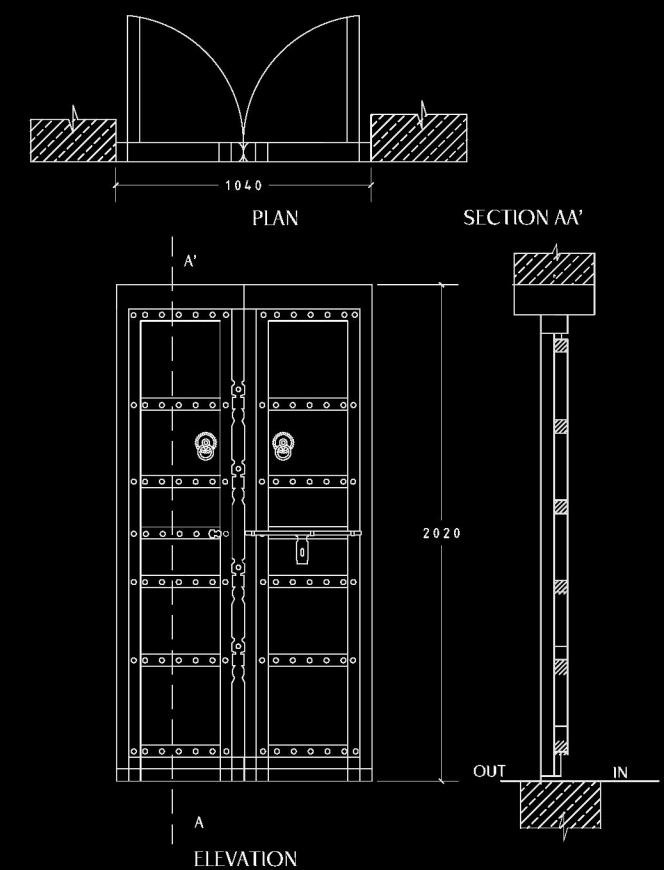

"THE DOOR DESIGNS REFLECT A BALANCE BETWEEN FUNCTIONALITY AND ORNAMENTATION, WITH VARIATIONS IN SCALE AND DETAILING. THE MAIN ENTRANCE DOOR FEATURES INTRICATE CARVINGS AND SYMMETRICAL PATTERNS, WHILE OTHER DOORS FOLLOW PANEL-BASED CONSTRUCTION FOR STRUCTURAL STABILITY. THE USE OF PLAN, SECTION, AND ELEVATION DRAWINGS HELPS IN UNDERSTANDING THEIR CONSTRUCTION, PROPORTION, AND OPENING MECHANISM."

# PILLAR DETAILS (C1)

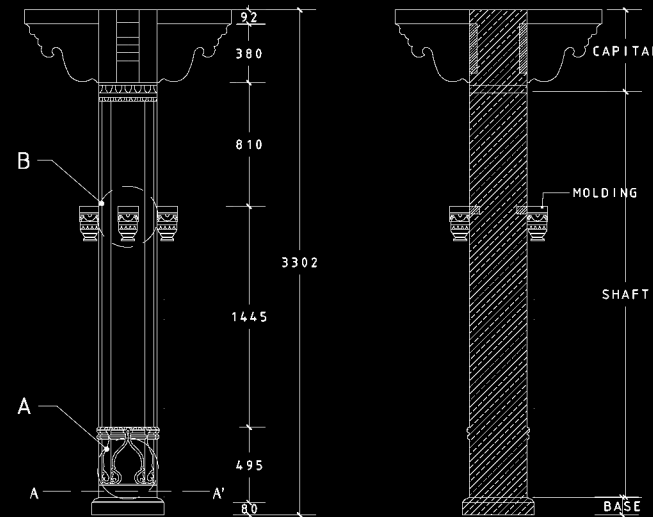

SINGLE PILLAR (BRACKET TYPE)  
 SOLID SINGLE SHAFT COLUMN  
 DOUBLE-TIER BRACKET SYSTEM FOR LOAD TRANSFER  
 BASE WITH MOULDINGS & NICHE-LIKE CARVINGS  
 WIDE PROJECTING CAPITAL  
 REPRESENTS STRONG STRUCTURAL SUPPORT + HEAVY DETAILING

STONE

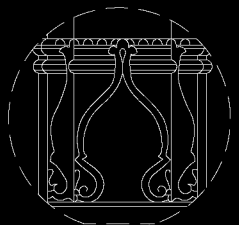

DETAIL A  
 Ghata-Pallava Motif

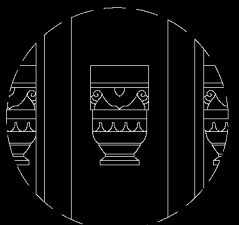

DETAIL B  
 Kumbha Capital Band

VERTICAL SECTION

SCALE-1:25

# PILLAR DETAILS (C2)

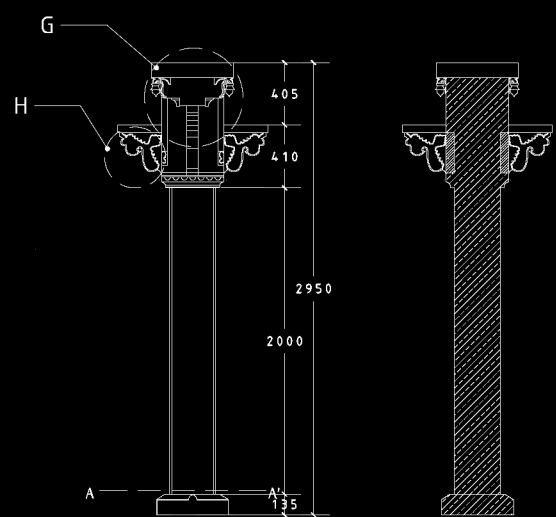

SINGLE PILLAR (DECORATIVE CAPITAL)  
 TALL AND ELEGANT PROPORTION  
 SIMPLE SHAFT + HIGHLY DETAILED CAPITAL  
 MINIMAL BASE TREATMENT  
 CAPITAL ACTS AS VISUAL FOCAL ELEMENT  
 USED IN IMPORTANT / HIGHLIGHTED AREAS

STONE

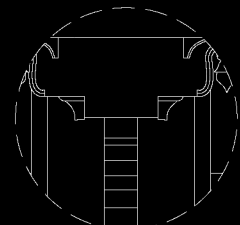

DETAIL H  
 Pushpa-Polika Bracket



DETAIL G  
 Phalaka Capital

ELEVATIONS

VERTICAL SECTION

SCALE-1:25

# PILLAR DETAILS (C3)

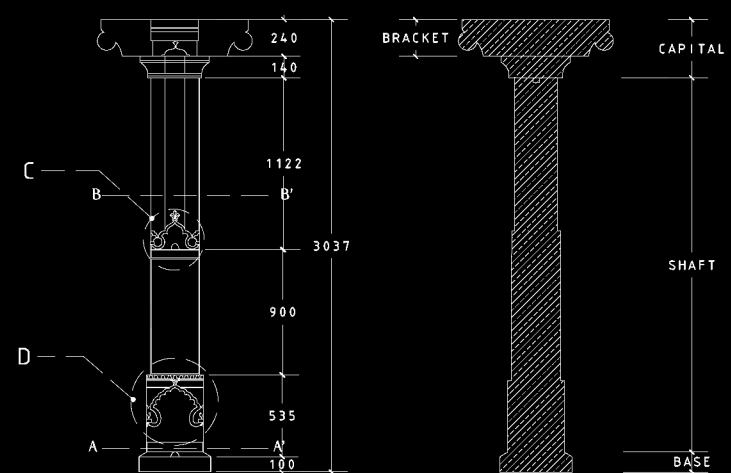

SINGLE PILLAR (ORNAMENTAL SHAFT)  
 SLENDER VERTICAL PROPORTION  
 SHAFT DIVIDED USING DECORATIVE BANDS  
 MODERATE DETAILING AT BASE & CAPITAL  
 BALANCED COMPOSITION (NOT TOO HEAVY)  
 FOCUS ON VISUAL RHYTHM & PROPORTION

STONE

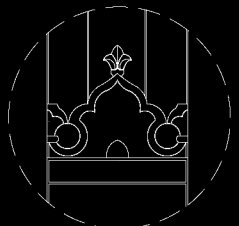

DETAIL D  
 Chandrashala Arch Motif

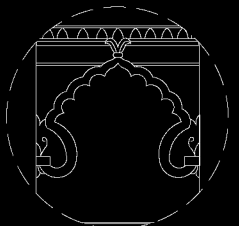

DETAIL C  
 Padma Base Ornament

VERTICAL SECTION

SCALE-1:25

# PILLAR DETAILS (C4)

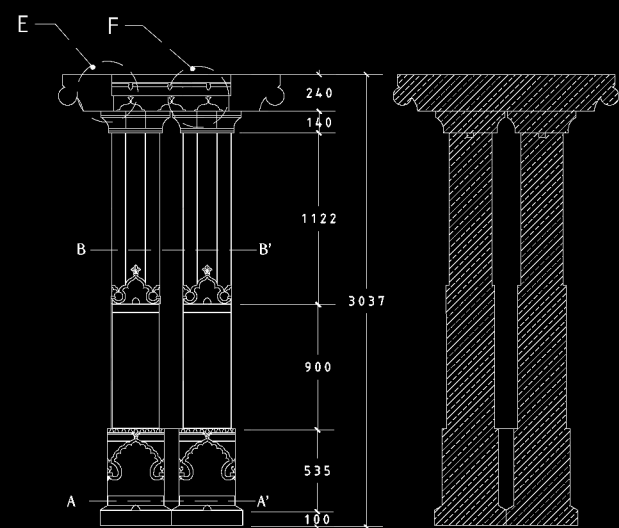

DOUBLE PILLAR (COMPOUND COLUMN)  
 TWO SHAFTS SHARING COMMON BASE & CAPITAL  
 USED FOR LARGER SPAN / WIDER BAYS  
 INCREASES STRUCTURAL STABILITY  
 CREATES REPETITION & VISUAL RICHNESS  
 MORE DOMINANT THAN SINGLE COLUMNS

STONE

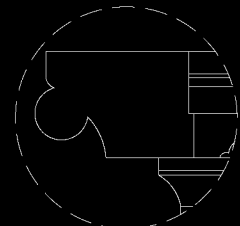

DETAIL E  
 Potika Beam Bracket

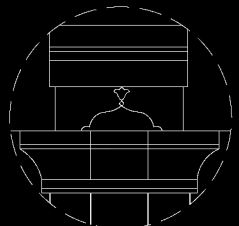

DETAIL F  
 Kapota Cornice Moulding

ELEVATIONS

VERTICAL SECTION

SCALE-1:25

SCALE-1:5

SCALE-1:5

# TWINMOTION RENDERS



1. MORNING VIEW



2. AFTERNOON VIEW



3. EVENING VIEW



4. NIGHT VIEW

# 01 PRAVAH HOUSE

is designed on the concept of flow and spatial transition. The house revolves around a central courtyard that acts as the heart of the space, providing light, ventilation, and social interaction. Curved circulation creates a seamless movement between public and private zones, enhancing user experience and spatial continuity. The material palette is inspired by local Jaipur architecture, using sandstone, brick, and lime plaster to create a climate-responsive and contextual design.”

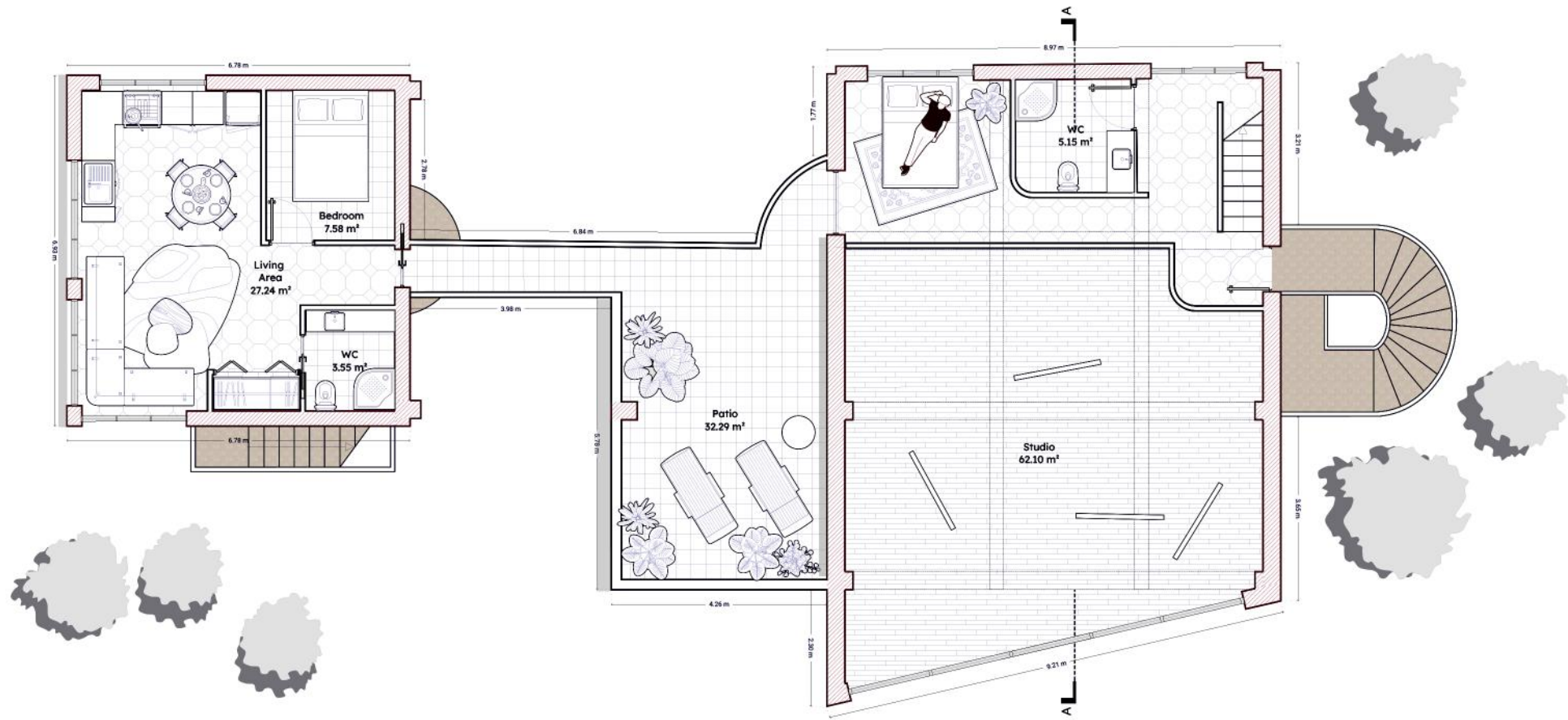

**GROUND FLOOR PLAN**

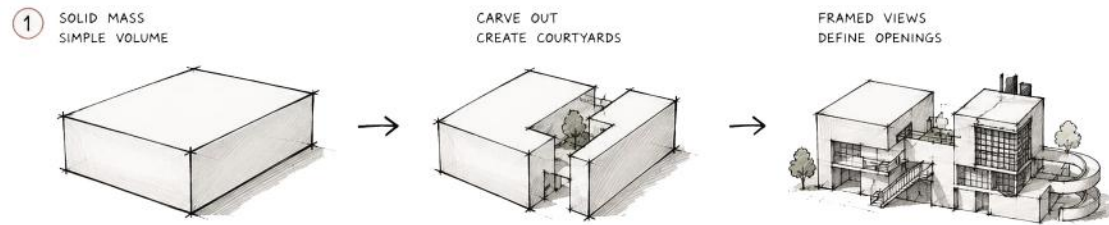

**SECTION AA'**



**FRONT ELEVATION**

# 02 FRAMED LIVING

\designed to create a seamless connection between indoor and outdoor living. The planning revolves around an open central recreational space with a pool, allowing natural light, ventilation, and visual connectivity throughout the house. Clean horizontal forms, transparent facades, and a minimal material palette enhance the modern architectural character while maintaining harmony with the surrounding landscape. The design focuses on spatial openness, comfort, and a balanced living experience through the interaction of built and open spaces.

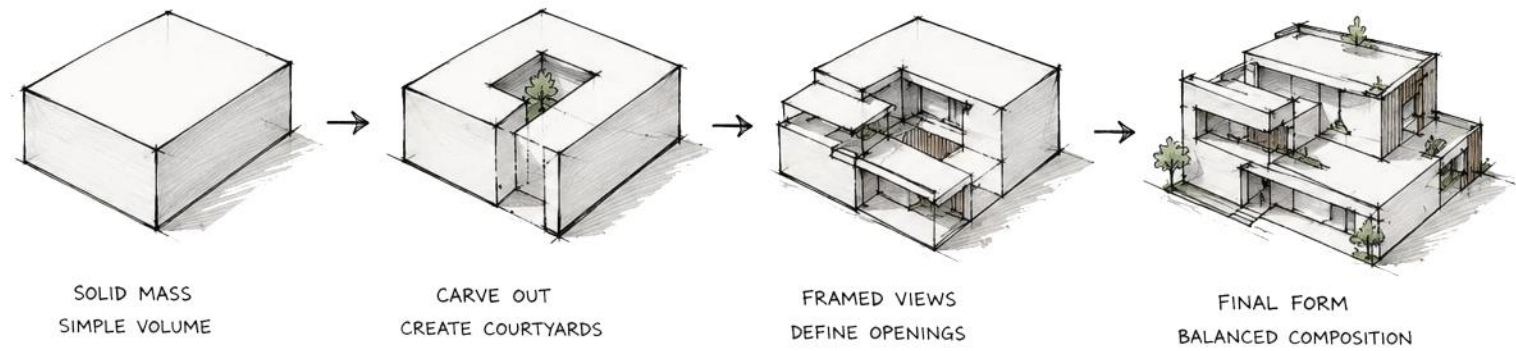

**GROUND FLOOR PLAN**



**SECTION AA'**



**FRONT ELEVATION**

# PHOTOGRAPHY

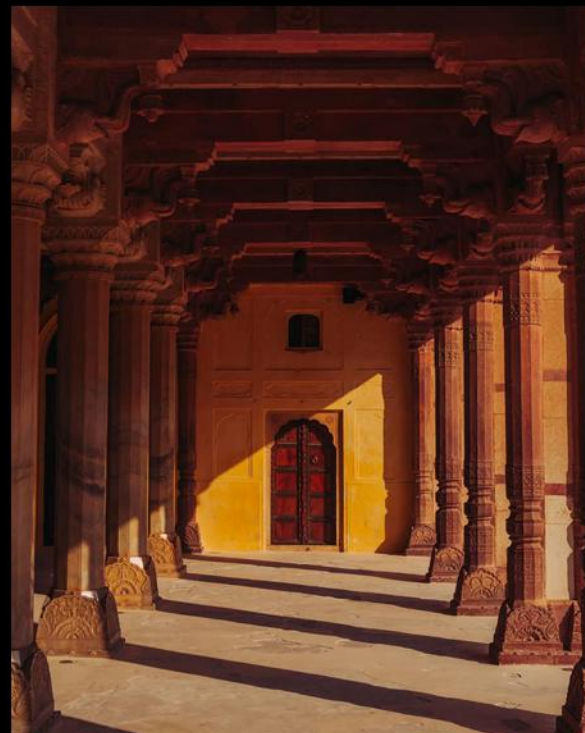

# SKETCHES

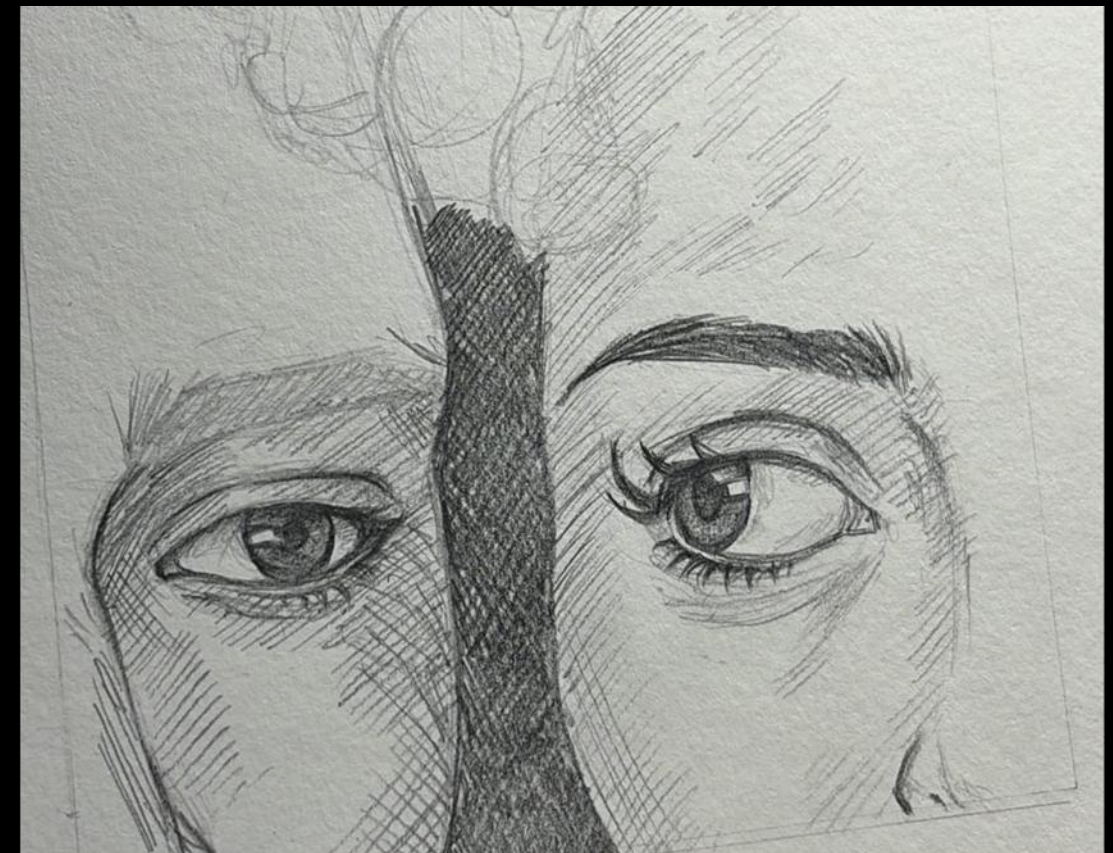
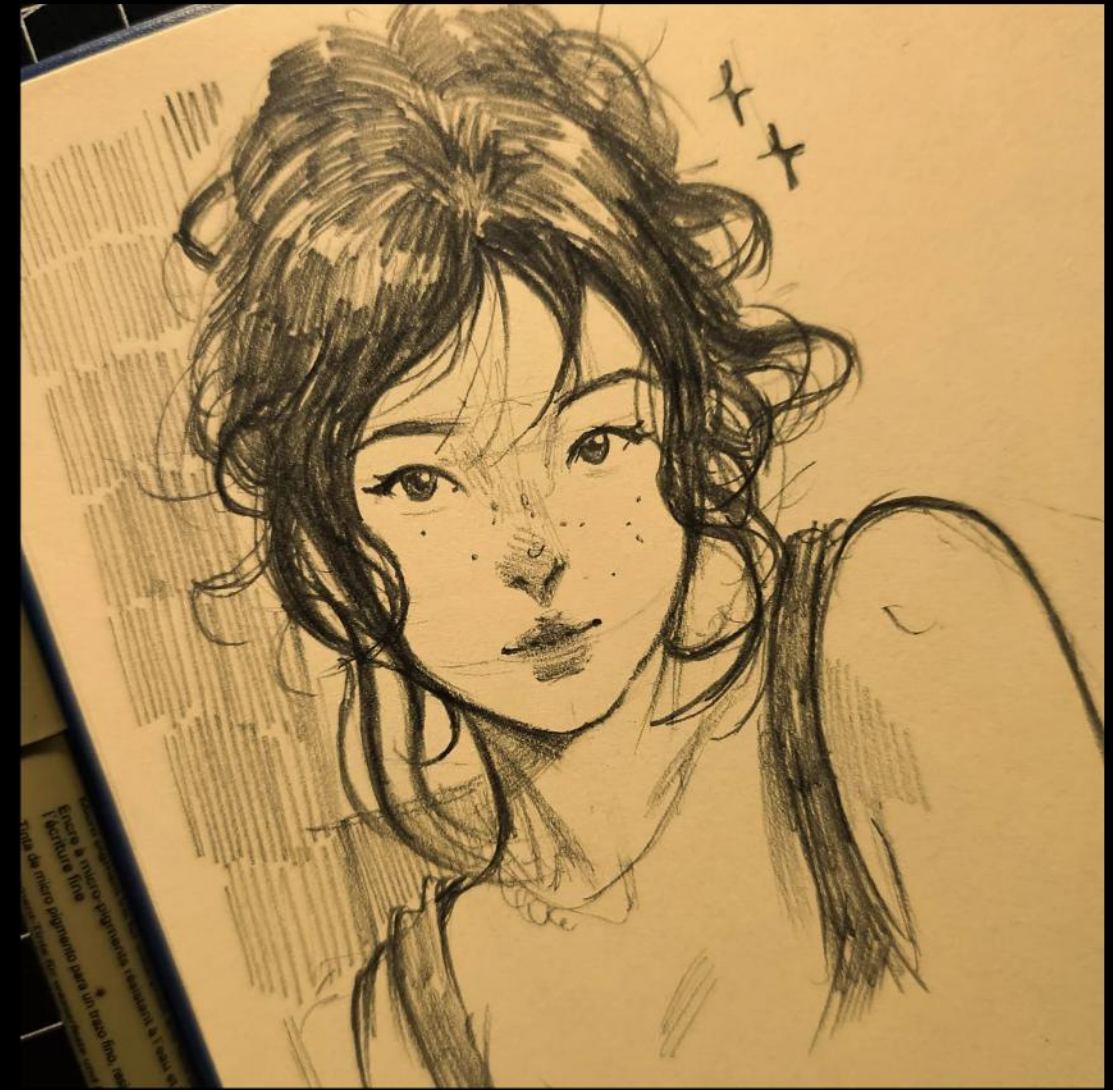

# ACADEMICS

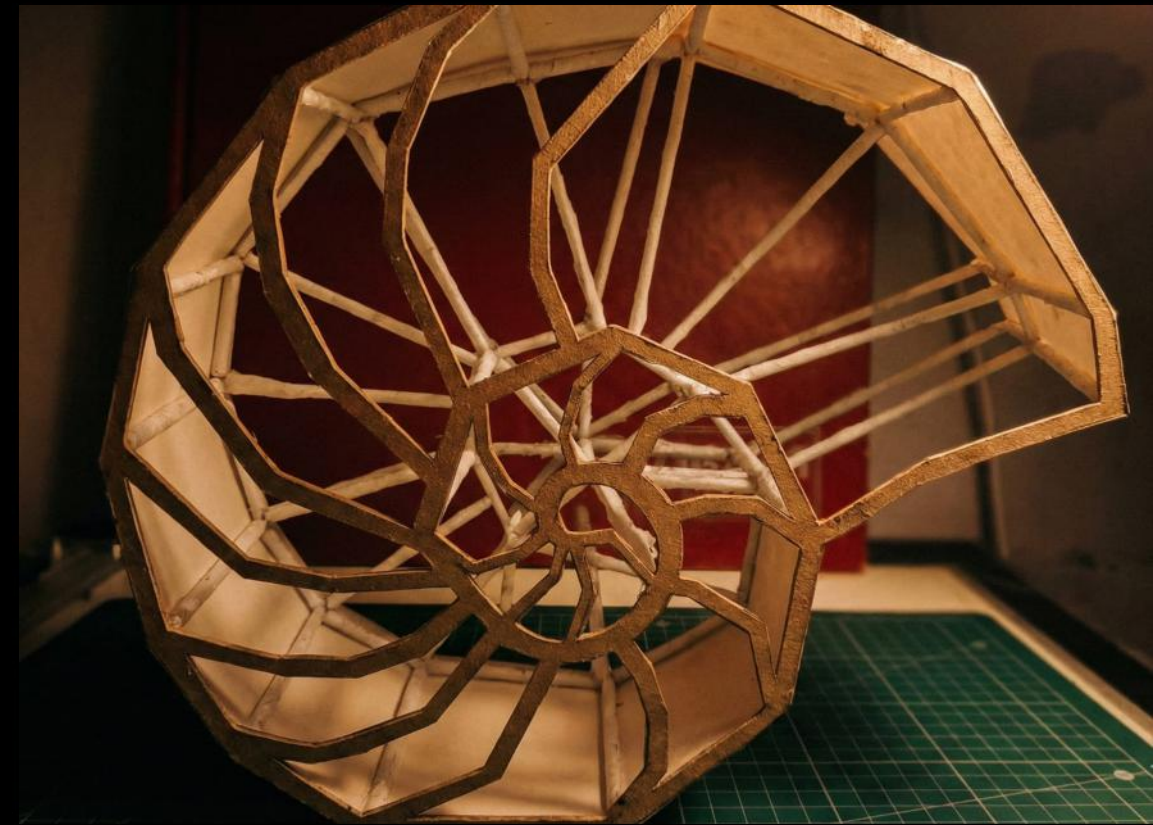
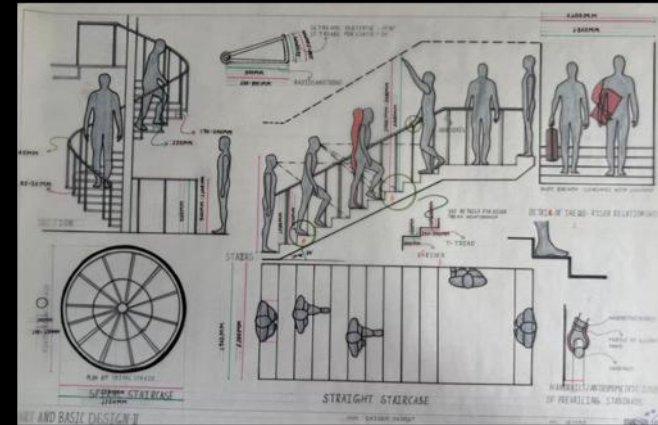
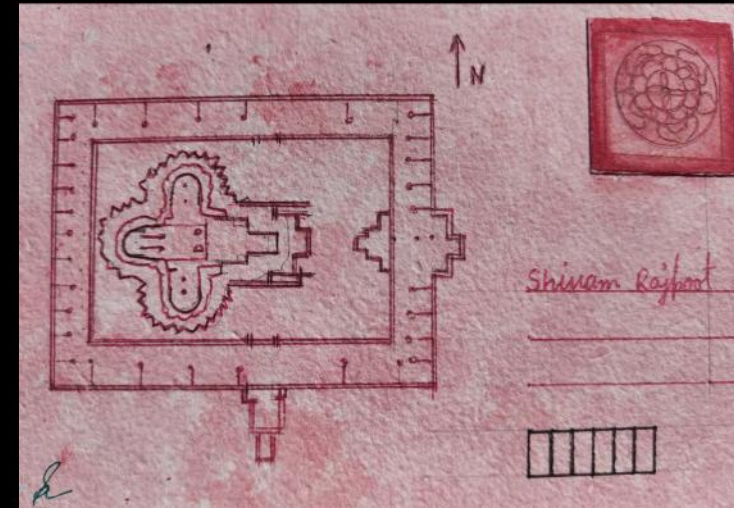
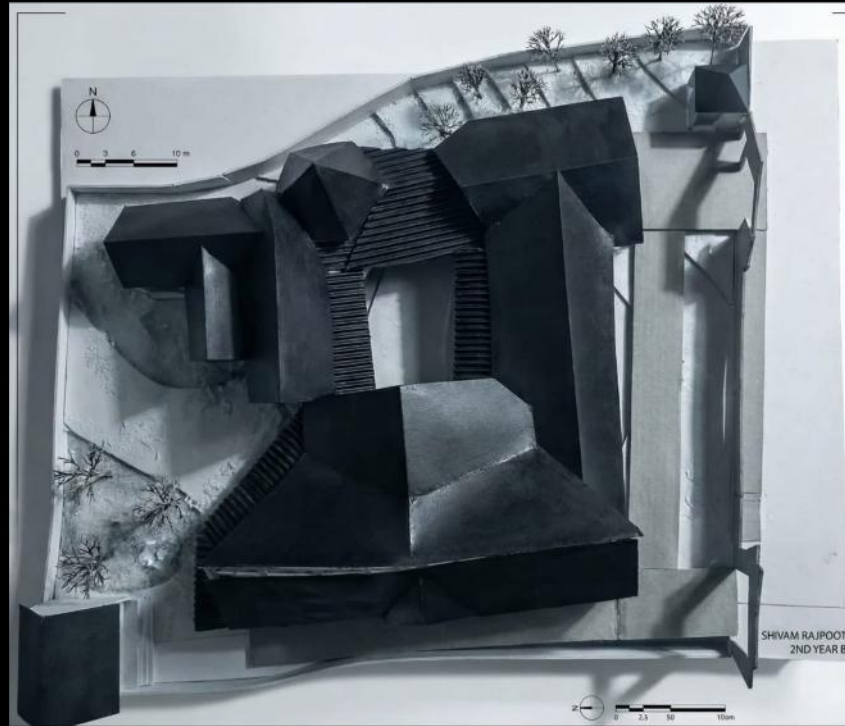



**THANK YOU**

2025-2026