

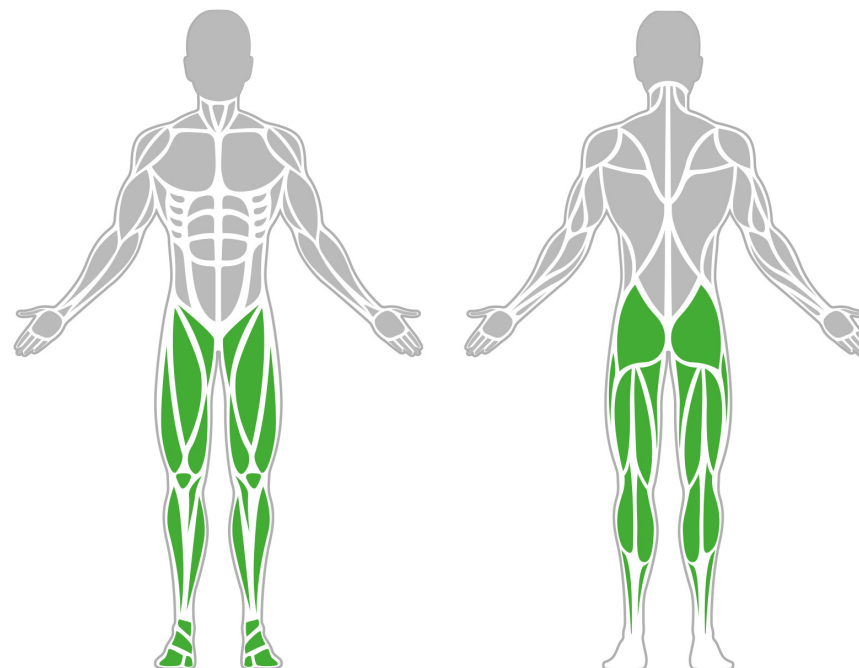

beststrongworld beststrongworld usa.beststrong.com usa@beststrong.com



Muscle Groups Focus



Leaping Pads

The Leaping Pads are outdoor obstacle course elements that build agility, strength, and coordination. With angled, non-slip platforms, they challenge users to leap and land with precision. Durable and weather-resistant, they're perfect for fitness parks, schools, and community spaces.

Attributes

Product code	1-1-604
Certificate	EN 16630, ASTM F3101
Age group	14 + years
Capacity	1 person
Max. weight load	218.26 lbs
Type	Obstacle Course
Difficulty level	Medium

Side View

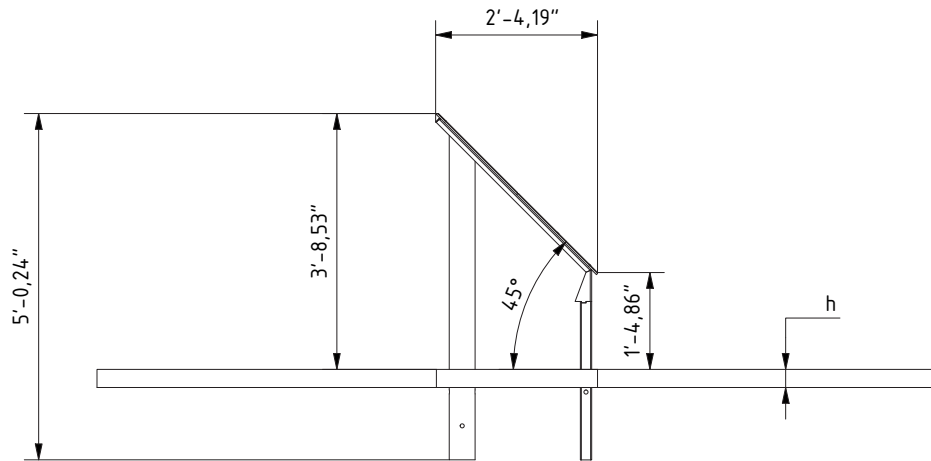

Plan View

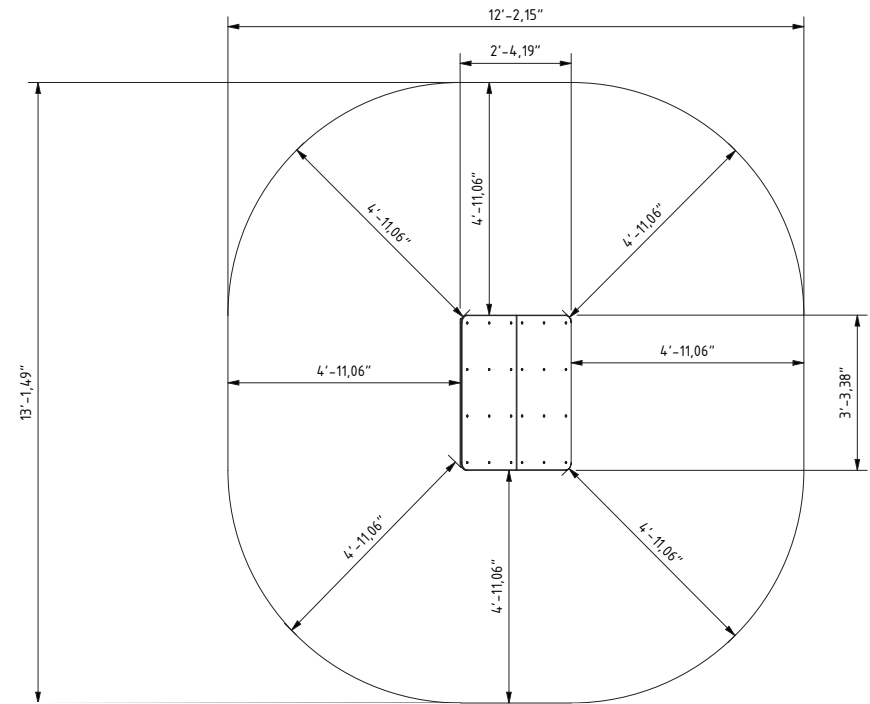

Installation information

Number of installers (concrete)	At least 2 people
Total installation time (concrete)	80-140 min.
Number of installers (equipment)	At least 2 people
Total installation time (equipment)	60 min.
Excavation volume	35.28 ft ³
Concrete volume	27.13 ft ³
Size of the base structure	47.24" × 31.50" × 31.50"
Anchoring options	In-ground or surface
In combined structures, the volume of concrete required varies.	

Technical specification

Safety surface area
Net weight
Material
Critic fall height
Color options

For more color options, discuss with your sales representative.

Around 4.92 ft radius
Net weight
133.6 lbs
Material
S235,HDPE
47.24"



Warranty

Structure
Steel
Paint
Plastic
Rubber
Moving parts
Detailed information in the warranty document

25-15 years
5-10 years
2 years
5-10 years
1-3 years
2 years

Material specification

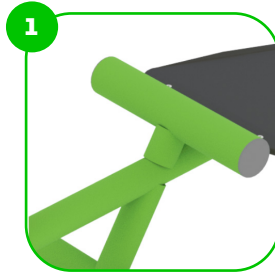

The element is made of high quality S235 steel, which has been cleaned via sandblasting. A corrosion resistant powder coating finish is then applied. Also available with galvanized surface for even greater protection and longevity!

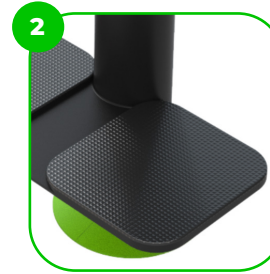

The top surface of the device is covered with the highest quality non-slip HDPE.



BESTRONG

 [bestrongworld](#)  [bestrongworld](#)  [usa.bestrong.com](#)  [usa@bestrong.com](#)



Sport and fitness products are compliant with the EN16630 and ASTM F3101 Standards.